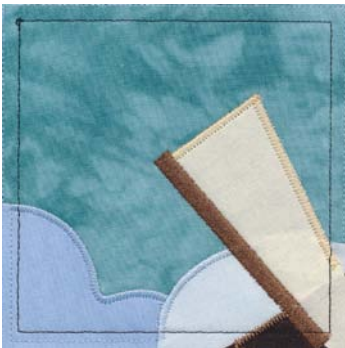


Finished size approx. 12" x 16"

It is a violation of Copyright law to make and distribute copies of software or artwork.  
Software is licensed to the original purchaser for use at one location. ©2012 OESD, LLC. All rights reserved.



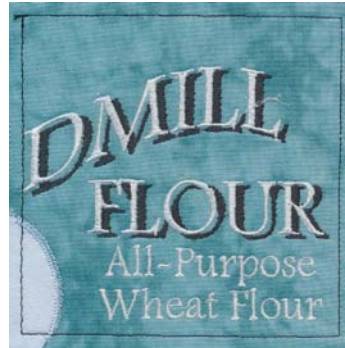
Note: Some designs in this collection may have been created using unique special stitches and/or techniques. To preserve design integrity when rescaling or rotating designs in your software, always rescale or rotate designs using the handles directly on-screen.



**12377-01 Tile 1**  
4.52 X 4.50 in.  
114.81 X 114.30 mm  
3,392 St.



**12377-02 Tile 2**  
4.50 X 4.49 in.  
114.30 X 114.05 mm  
10,702 St.



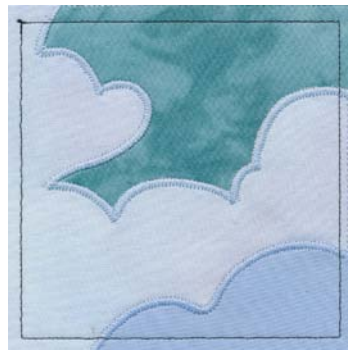
**12377-03 Tile 3**  
4.49 X 4.50 in.  
114.05 X 114.30 mm  
11,645 St.



**12377-04 Tile 4**  
4.50 X 4.50 in.  
114.30 X 114.30 mm  
5,205 St.



**12377-05 Tile 5**  
4.49 X 4.50 in.  
114.05 X 114.30 mm  
6,058 St.



**12377-06 Tile 6**  
4.49 X 4.49 in.  
114.05 X 114.05 mm  
1,794 St.



**12377-07 Tile 7**  
4.48 X 4.49 in.  
113.79 X 114.05 mm  
2,901 St.



**12377-08 Tile 8**  
4.49 X 4.49 in.  
114.05 X 114.05 mm  
7,276 St.



**12377-09 Tile 9**  
4.49 X 4.49 in.  
114.05 X 114.05 mm  
3,622 St.



**12377-10 Tile 10**  
4.50 X 4.50 in.  
114.30 X 114.30 mm  
7,698 St.



**12377-11 Tile 11**  
4.49 X 4.49 in.  
114.05 X 114.05 mm  
8,656 St.



**12377-12 Tile 12**  
4.49 X 4.49 in.  
114.05 X 114.05 mm  
7,919 St.

- ⌘ Design contains a loose fill.
- ⚙ Some white areas shown are not stitched.

- L Design is larger than 5" (127 mm) in either direction.
- S Design is smaller than 1.5" (38.1 mm) in either direction.

Listings below indicate color sample, stitching order and suggested thread color number in Isacord, YLI Fine Metallic, Yenmet or YLI Variegated threads.

### 12377-01 Tile 1

1. Sky Appliqué Placement Stitch	3761
2. Sky Appliqué Tackdown	3761
3. Dark Blue Cloud Appliqué Placement Stitch	3761
4. Light Blue Cloud Appliqué Placement Stitch	3761
5. Cloud Appliqués Cover Stitch	3761
6. Roof Appliqué Placement Stitch	0853
7. Roof Appliqué Cover Stitch	0853
8. Windmill Blade Appliqué Placement Stitch	0651
9. Windmill Blade Appliqué Cover Stitch	0651
10. Brown Edge on Windmill Blade	1055
11. Seam Stitch	0020

### 12377-02 Tile 2

1. Sky Appliqué Placement Stitch	3761
2. Sky Appliqué Tackdown	3761
3. Cloud Appliqué Placement Stitch	3761
4. Cloud Appliqué Cover Stitch	3761
5. Roof Appliqué Placement Stitch	0853
6. Roof Appliqué Cover Stitch	0853
7. Windmill Blade Appliqué Placement Stitch	0651
8. Windmill Blade Appliqué Cover Stitch	0651
9. Brown Edge on Windmill Blade	1055
10. Shadows on Lettering	4174
11. White Lettering	0015
12. Seam Stitch	0020

### 12377-03 Tile 3

1. Sky Appliqué Placement Stitch	3761
2. Sky Appliqué Tackdown	3761
3. Cloud Appliqué Placement Stitch	3761
4. Cloud Appliqué Cover Stitch	3761
5. Shadows on Lettering	4174
6. White Lettering	0015
7. Seam Stitch	0020

### 12377-04 Tile 4

1. Top Dark Cloud Appliqué Placement Stitch	3761
2. Top Dark Cloud Appliqué Tackdown	3761
3. Light Cloud Appliqué Placement Stitch	3761
4. Bottom Dark Cloud Appliqué Placement Stitch	3761
5. Clouds Appliqué Cover Stitch	3761
6. Windmill Building Appliqué Placement Stitch	1172
7. Windmill Building Appliqué Cover Stitch	1172
8. Roof Appliqué Placement Stitch	0853
9. Roof Appliqué Cover Stitch	0853
10. Windmill Blade Appliqué Placement Stitch	0651
11. Windmill Blade Appliqué Cover Stitch	0651
12. Brown Edge on Windmill Blade	1055
13. Light Yellow Inside Window	0660
14. Tan Above Window	0651
15. Window Frame	0945
16. Dark Tan Detail Above Window	0832
17. Seam Stitch	0020

### 12377-05 Tile 5

1. Light Cloud Appliqué Placement Stitch	3761
2. Light Cloud Appliqué Tackdown	3761
3. Dark Cloud Appliqué Placement Stitch	3761
4. Dark Cloud Appliqué Cover Stitch	3761
5. Windmill Building Appliqué Placement Stitch	1172
6. Windmill Building Appliqué Tackdown	1172
7. Windmill Building Appliqué Cover Stitch	1172
8. Light Yellow Inside Window	0660
9. Tan Above Window	0651
10. Brown Line Details	0722
11. Window Frame	0945
12. Dark Tan Detail Above Window	0832
13. Roof Appliqué Placement Stitch	0945
14. Center of Windmill Blades	0945
15. Roof Appliqué Cover Stitch	0853
16. Windmill Blades Appliqué Placement Stitch	0651
17. Windmill Blades Appliqué Cover Stitch	0651
18. Brown Edges on Windmill Blades	1055
19. Seam Stitch	0020

### 12377-06 Tile 6

1. Sky Appliqué Placement Stitch	3761
2. Sky Appliqué Tackdown	3761
3. Light Cloud Appliqué Placement Stitch	3761
4. Dark Cloud Appliqué Placement Stitch	3761
5. Clouds Cover Stitch	3761
6. Seam Stitch	0020

### 12377-07 Tile 7

1. Dark Cloud Appliqué Placement Stitch	3251
2. Purple Background Appliqué Placement Stitch	3251
3. Purple Background Appliqué Cover Stitch	3251
4. Windmill Building Appliqué Placement Stitch	1172
5. Windmill Building Appliqué Cover Stitch	1172
6. Ground Appliqué Placement Stitch	0453
7. Ground Appliqué Cover Stitch	0453
8. Light Yellow Inside Window	0660
9. Window Frame	0945
10. Flower Appliqué Placement Stitch	2022
11. Light Pink Petal Highlights	1840
12. Flower Appliqué Cover Stitch	2022
13. Seam Stitch	0020

### 12377-08 Tile 8

1. Light Cloud Appliqué Placement Stitch	3761
2. Dark Cloud Appliqué Placement Stitch	3761
3. Clouds Appliqué Cover Stitch	3761
4. Purple Background Appliqué Placement Stitch	3251
5. Purple Background Appliqué Cover Stitch	3251
6. Windmill Building Appliqué Placement Stitch	1172
7. Windmill Building Appliqué Tackdown	1172
8. Windmill Building Cover Stitch	1172
9. Tan Above Door	0651
10. Dark Tan Above Door	0832
11. Light Yellow Inside Window and Door	0660
12. Window Frame and Door	0945
13. Door Details	1154
14. Door Knob	0552
15. Ground Appliqué Placement Stitch	0453
16. Ground Appliqué Cover Stitch	0453
17. Flower Appliqué Placement Stitch	1860
18. Flower Highlights	1860
19. Flower Shading	1521
20. Flower Appliqué Cover Stitch	2022
21. Seam Stitch	0020

### 12377-09 Tile 9

1. Light Cloud Appliqué Placement Stitch	3761
2. Dark Cloud Appliqué Placement Stitch	3761
3. Clouds Appliqué Cover Stitch	3761
4. Purple Background Appliqué Placement Stitch	3251
5. Purple Background Appliqué Cover Stitch	3251
6. Ground Appliqué Placement Stitch	0232
7. Medium Green Leaf Shade	0232
8. Dark Green Leaf Lines	5933
9. Ground Appliqué Cover Stitch & Leaf Border	0453
10. Flower Appliqué Placement Stitch	1521
11. Flower Shading	1521
12. Flower Highlights	1860
13. Flower Appliqué Cover Stitch	2022
14. Seam Stitch	0020

### 12377-10 Tile 10

1. Ground Appliqué Placement Stitch	0232
2. Ground Appliqué Tackdown	0232
3. Medium Green Leaf & Stem Shade	0232
4. Dark Green Leaf Lines	5933
5. Leaf & Stem Outlines	0453
6. Flower Appliqué Placement Stitch	2022
7. Flower Highlights	1860
8. Flower Shading	1521
9. Flower Appliqué Cover Stitch & Linework	2022
10. Seam Stitch	0020

Listings below indicate color sample, stitching order and suggested thread color number in Isacord, YLI Fine Metallic, Yenmet or YLI Variegated threads.

### 12377-11 Tile 11

	1. Ground Appliqué Placement Stitch.....	6141
	2. Light Green Leaf Shade.....	6141
	3. Medium Green Leaf & Stem Shade.....	0232
	4. Dark Green Leaf Lines.....	5933
	5. Leaf & Stem Borders.....	0453
	6. Flower Appliqué Placement Stitch.....	1521
	7. Flower Appliqué Tackdown.....	1521
	8. Flower Shading.....	1521
	9. Flower Highlights.....	1860
	10. Flower Appliqué Cover Stitch.....	2022
	11. Seam Stitch.....	0020

### 12377-12 Tile 12

	1. Ground Appliqué Placement Stitch.....	0232
	2. Ground Appliqué Tackdown.....	0232
	3. Green Leaf Shading.....	0232
	4. Light Green Leaf Shading.....	6141
	5. Dark Green Leaf Lines.....	5933
	6. Leaf Outlines.....	0453
	7. Flower Appliqué Placement Stitch.....	1860
	8. Flower Highlights.....	1860
	9. Flower Appliqué Cover Stitch & Linework.....	2022
	10. Seam Stitch.....	0020

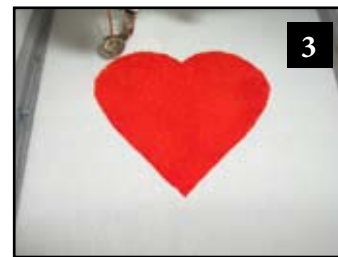
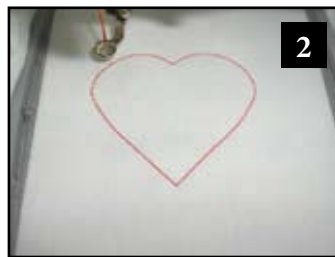
**NOTE: Appliqué fabric not included.**

## Appliqué Instructions

1. Print out the necessary pages from the PDF of the appliqué pattern(s).
2. Mark the right side of the pattern pieces so you'll know which direction to lay the pattern on the fabric.
3. Lightly spray the wrong side of the pattern pieces with temporary adhesive spray and allow it to set for a few minutes.
4. Place the pattern pieces on the right side of the fabric and carefully cut them out. **PHOTO 1**
5. Sew the placement stitch on your hooped fabric. **PHOTO 2**
6. With the paper still stuck to the right side of the appliqué fabric, spray the wrong side of the fabric with temporary spray adhesive.
7. Place the fabric inside the sewing placement stitch so that it matches the stitching line then remove the paper pattern. **PHOTO 3**
8. Sew the tackdown. **PHOTO 4**
9. Sew the remainder of the design and repeat for any remaining pieces. **PHOTO 5**

**NOTE: The patterns are sized for the designs as they were made. If you resize the design, you will need to resize the pattern the same amount. You can print out the pattern at the normal size then copy it on a copy machine at the changed size, i.e. resize the designs to 80%, resize the printed pattern to 80%.**

**TIP: When Printing the patterns, make sure that the "Fit to page" option is UNCHECKED in the Print Dialog Box. If this option is checked the printed patterns will not be actual size.**





# A Vintage Spring Wall Hanging

### Supplies:

- OESD Signature Pack #12377 A Vintage Spring
- Polyester Embroidery Thread
- Bobbin Thread
- Temporary Spray Adhesive
- Medium Weight Tear-Away Stabilizer
- 2 yards of fabric (this will include the blocks, backing and binding)
- Quilt Batting 12"x 20"

### Optional:

- Stitch Witchery Fusible Bonding Web ¼" wide roll (widely available in 20yd roll)
- 3 yards satin ribbon ¼" wide

### Embroidery:

1. Embroider one of each design file 12377-01 through 12377-12 for the wall hanging using two layers of Medium Weight Tear-Away stabilizer in each hooping. Be sure to use temporary spray adhesive to adhere all layers of stabilizer and fabric together for best stitch results.
2. Refer to the Pre-Cut Applique Instructions for directions to apply the applique areas.
3. The last thing that will stitch in each of these designs is a border that is referred to on the thread chart as "Seam Stitch". This stitch is very important in the process assembling the wall hanging. It is vital that it is not skipped when embroidering. Stitch this in the same thread color as your background fabric. *NOTE: In our sample pictures we stitched our "Seam Stitch" in black to ensure they would show in photographs.*
4. Once the embroidery process is complete, remove excess stabilizer then trim away excess fabric by cutting ½" outside the "Seam Stitch". This process is easily done using a rotary cutter and ruler. *NOTE: It may be easier to cut with the back of the block showing since the "Seam Stitch" was stitched in the same color as your background fabric. (Photo 01)*

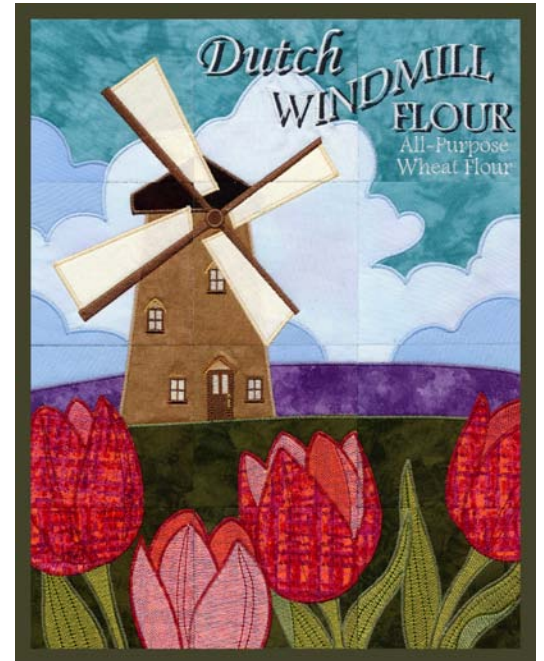


Photo 1

### Construction:

1. After each block has been trimmed, lay out the pieces near your machine so that it is easy to put the blocks together. Refer to **Diagram A (On next page)**.
2. Stitch the horizontal rows together by laying the first two pieces together with right sides matching. Cut edges should match but more importantly, the "Seam Stitch" on both pieces must match. Stitch the pieces together by straight stitching just to the inside of the "Seam Stitch". (Photo 02)



Photo 2

3. Attach the third square to the first two squares in the same fashion to complete your first row. (**Photo 03**)
4. Press seams open.
5. Referring to diagram A, repeat for rows two through four.
6. When step five is complete you will have four stitched rows. (**Photo 04**)
7. Stitch the four rows together in the same manner to complete the front of the wall hanging. Make sure as you sew that your intersections line up between the rows and that the "Seam Stitch" stays matched. (**Photo 05**)
8. Cut backing fabric and batting to be at least 2 inches larger than the finished size of your project. Using temporary spray adhesive, spray the batting and adhere it to the wrong side of the backing fabric.
9. Using temporary spray adhesive, spray the batting and adhere it to the wrong side of the completed wall hanging. This will create a "quilters' sandwich".
10. Quilt as desired. In our sample we simply stitched in the ditch. *NOTE: steps 11-13 are optional, follow these steps if you would like to add ribbon to cover the seams of the wall hanging (this can be useful if your stitching ended up a bit crooked). If you do not want to add ribbon, simply skip to step 14 to finish the wall hanging.*
11. Cover all of the seams with satin ribbon. Cut ribbon into strips approximately 1" longer than the seam you are covering. Spray one side of ribbon with temporary spray adhesive. Adhere a layer of Stitch Witchery to each ribbon strip. Be careful not to stretch the Stitch Witchery as this will cause your ribbons to draw up and tend to not want to lay flat. Lay ribbon in place, making sure each is straight, and iron to permanently fuse ribbon in place. Since Stitch Witchery is permanent, stitching ribbons in place is not necessary.
12. Place ribbons in the following order: Place the two vertical ribbons first followed by the three horizontal ribbons.
13. Trim away any excess strips of ribbon so that the outer edges of the project are even.
14. Trim away the excess backing fabric and batting then bind the wall hanging using your favorite binding method.

**Diagram A**

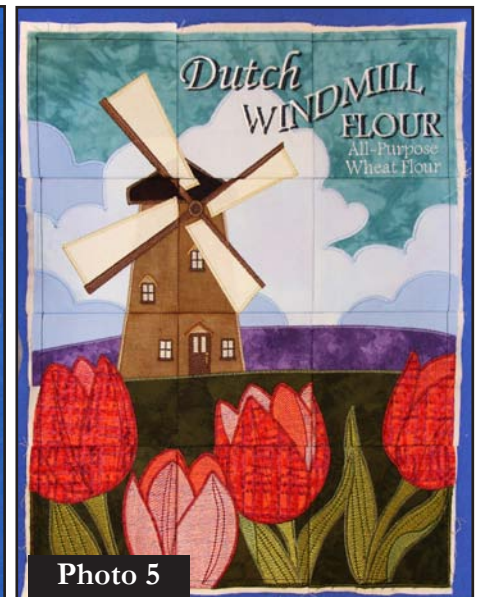
12377-01	12377-02	12377-03
12377-04	12377-05	12377-06
12377-07	12377-08	12377-09
12377-10	12377-11	12377-12



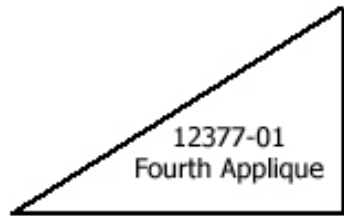
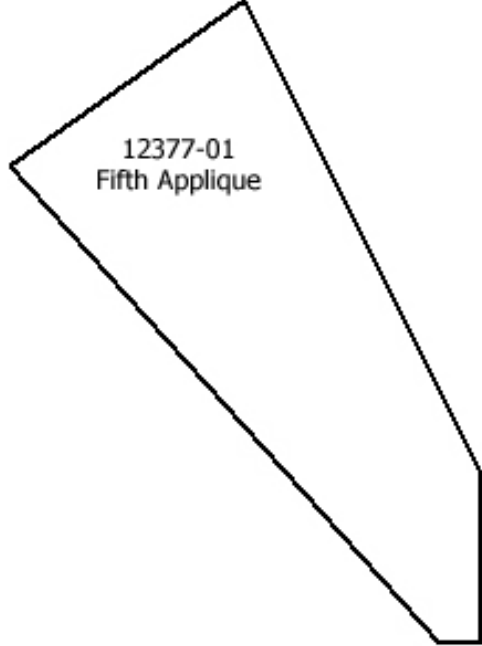
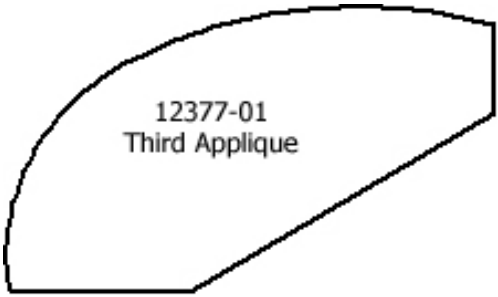
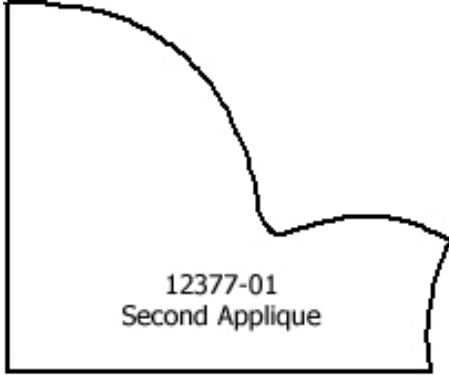
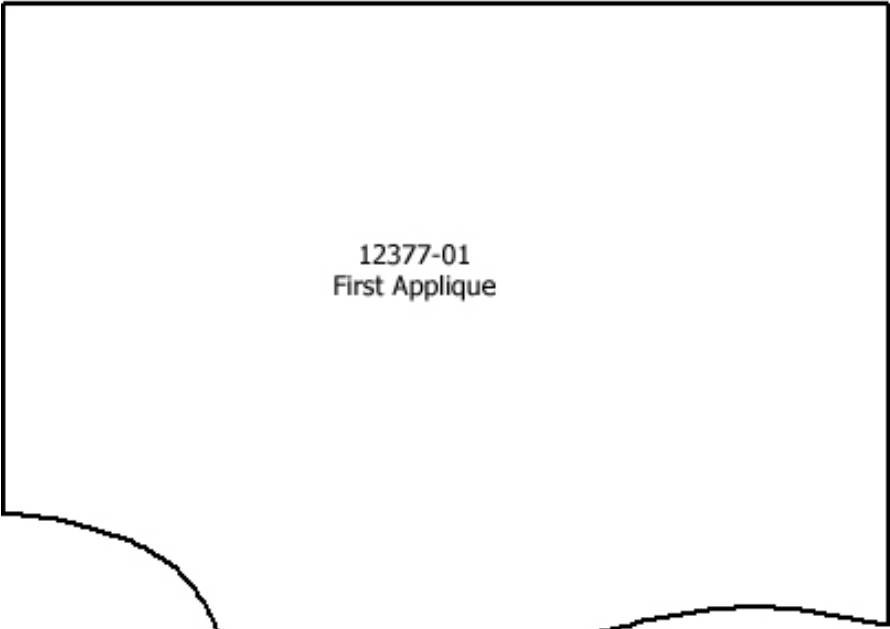
**Photo 3**

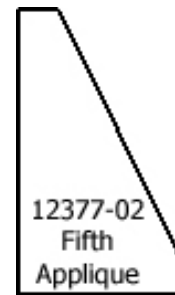
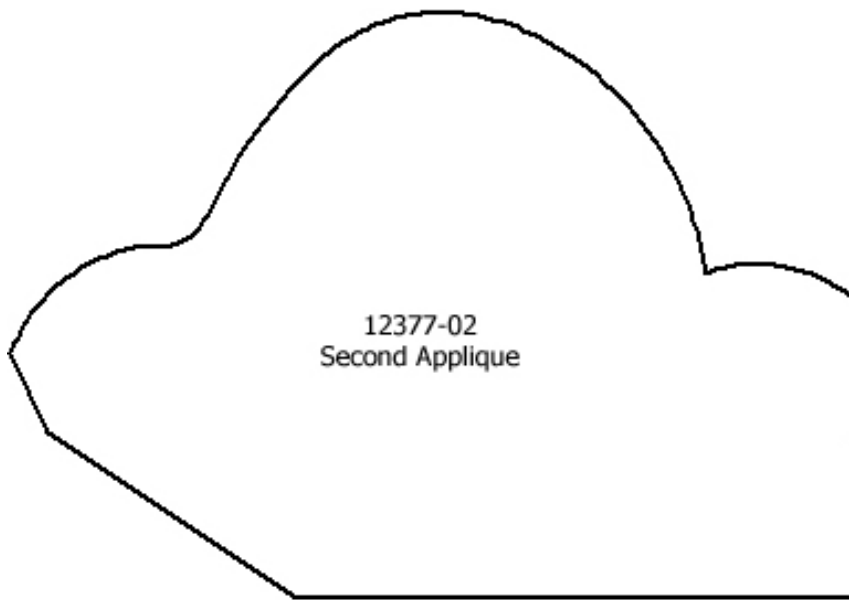
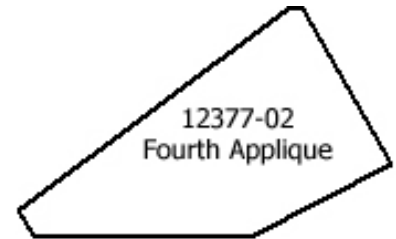
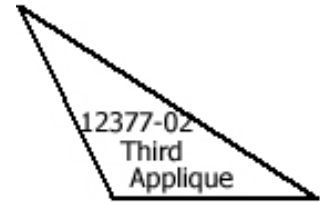
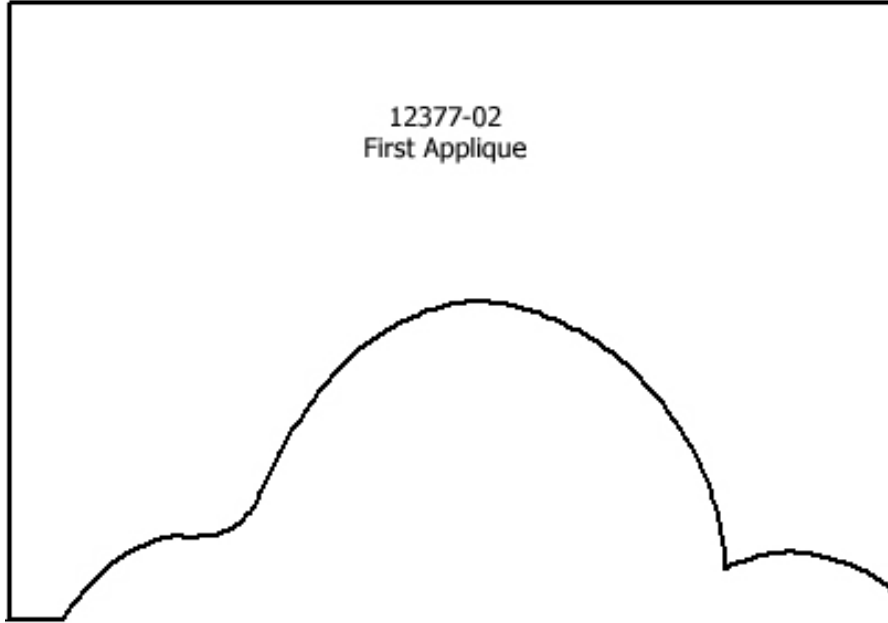


**Photo 4**

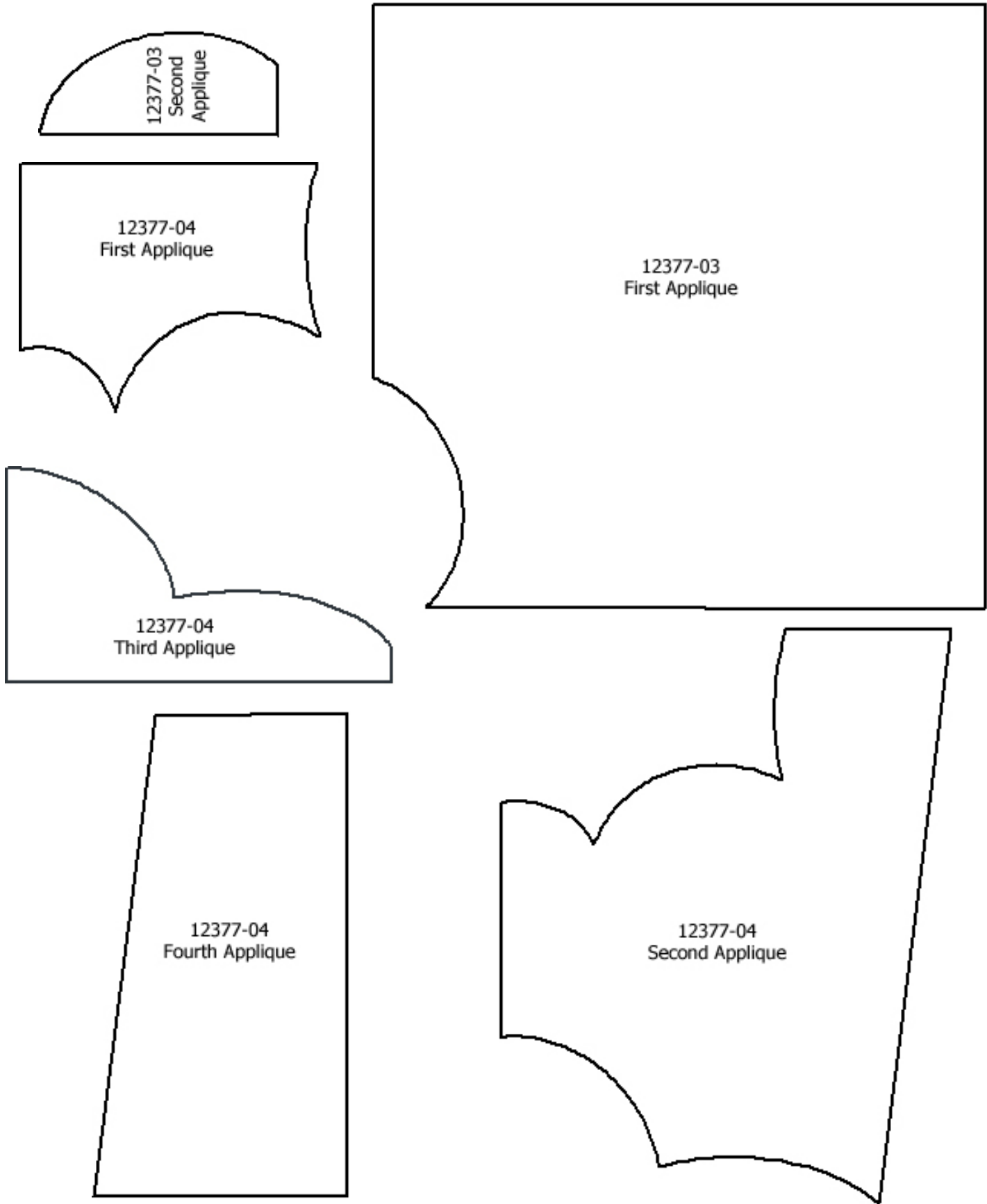


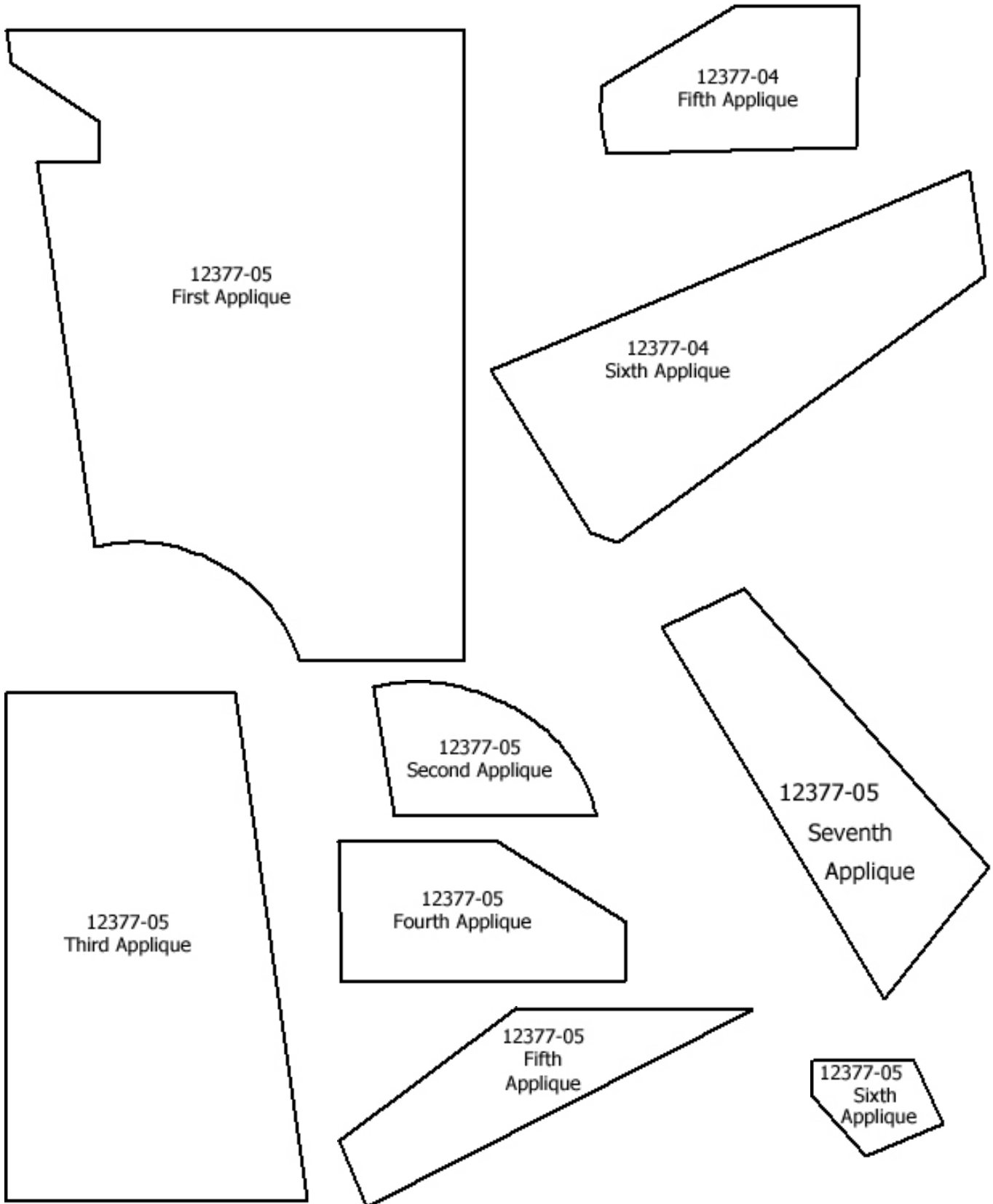
**Photo 5**



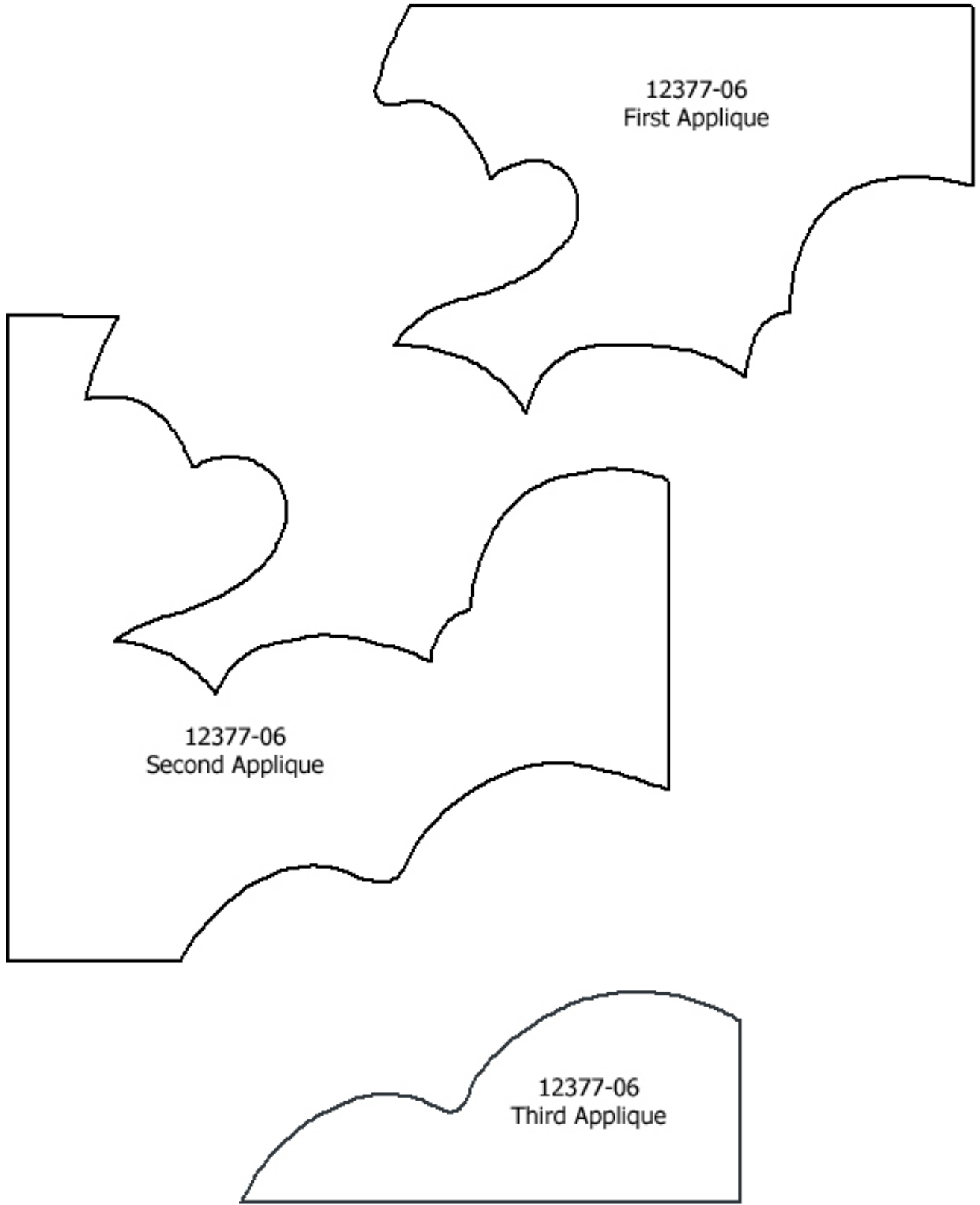


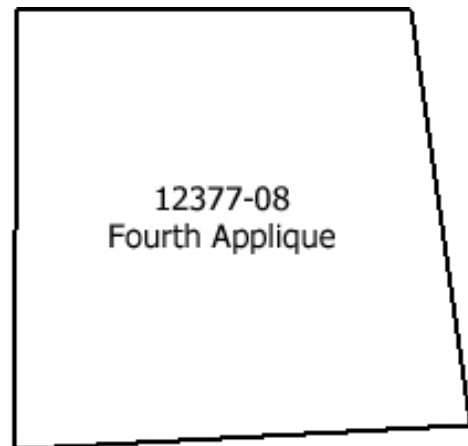
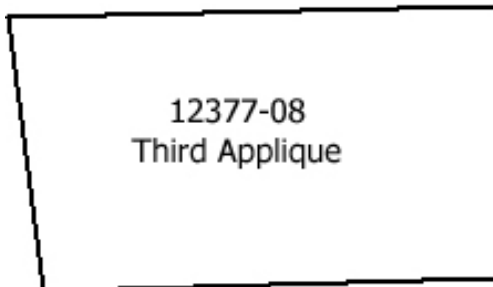
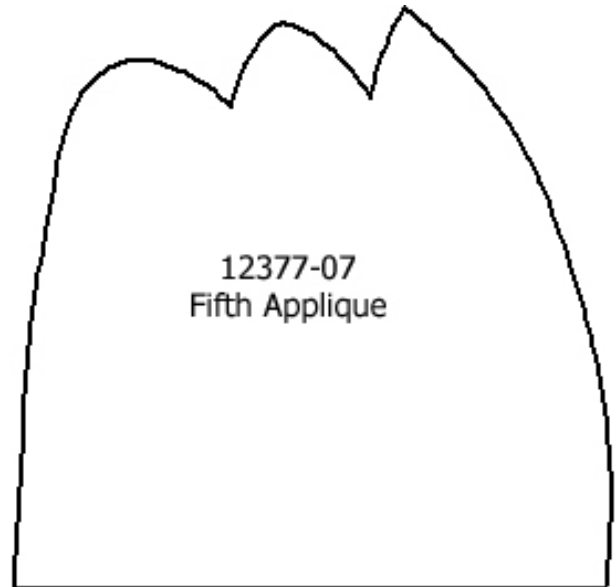
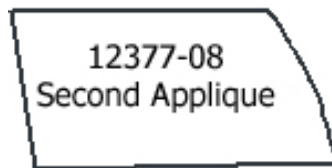
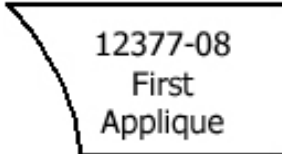
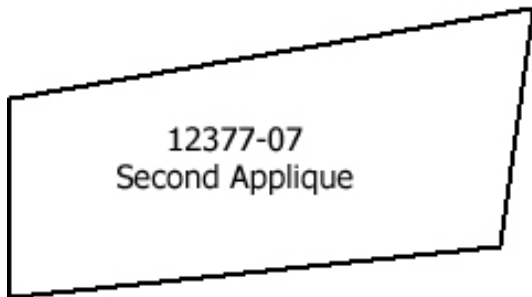
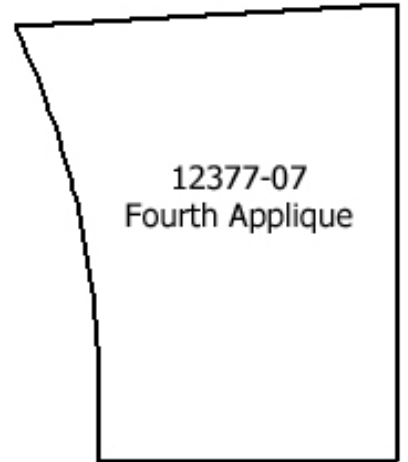
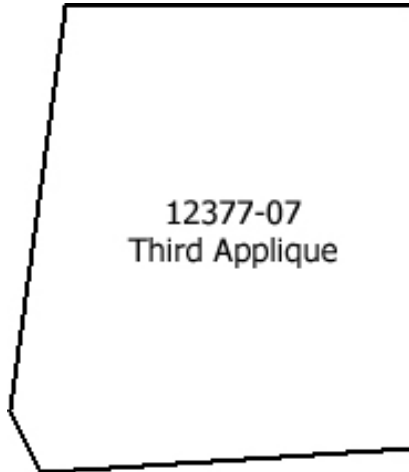
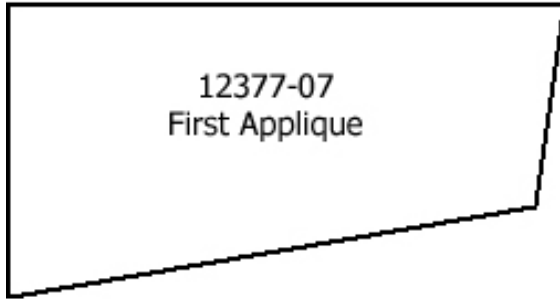




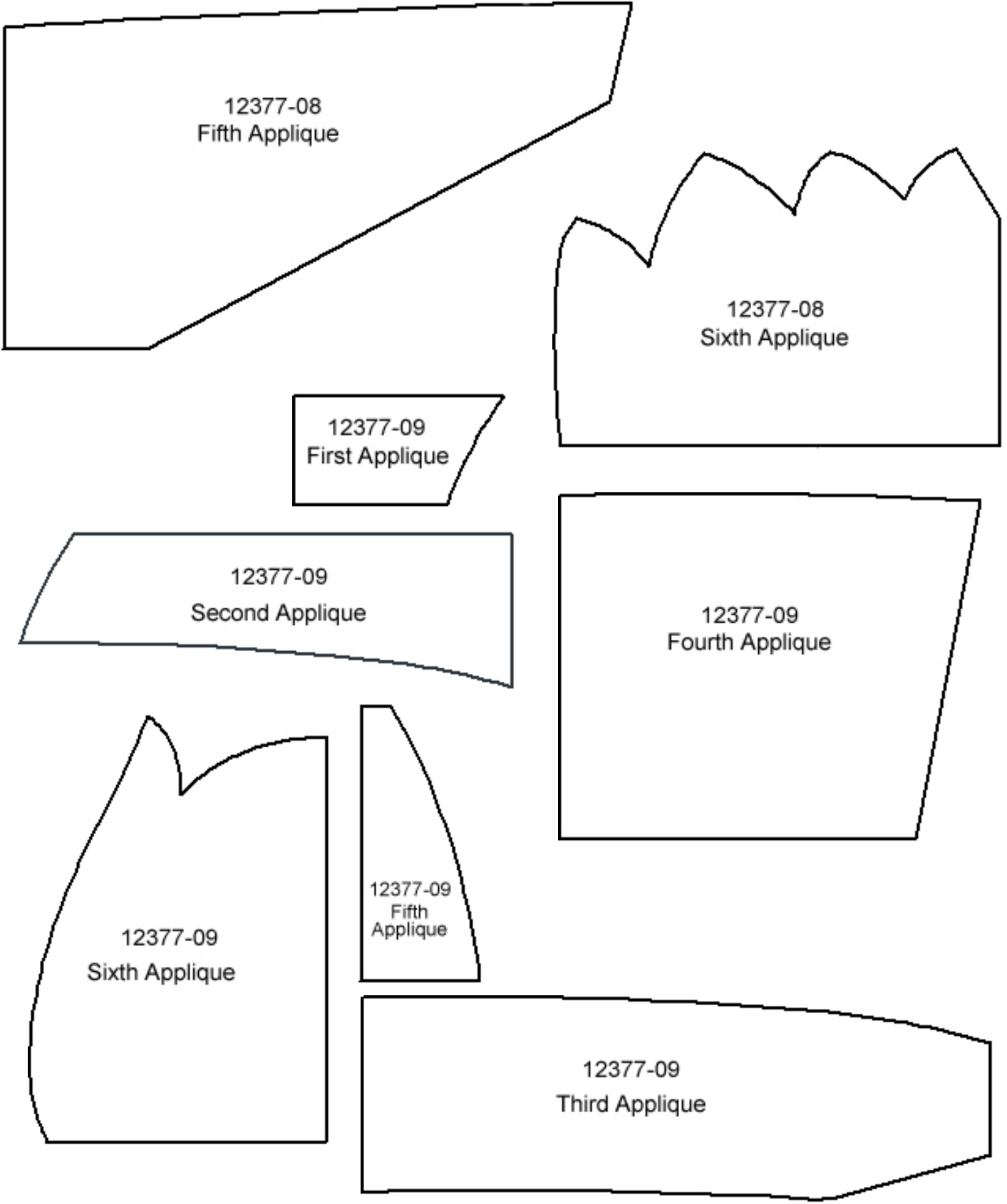


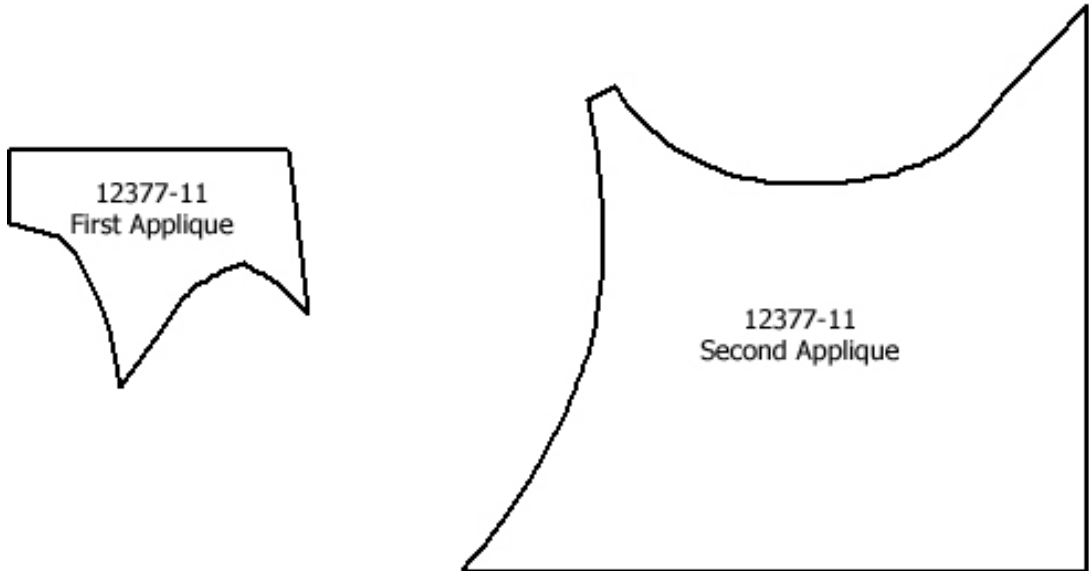
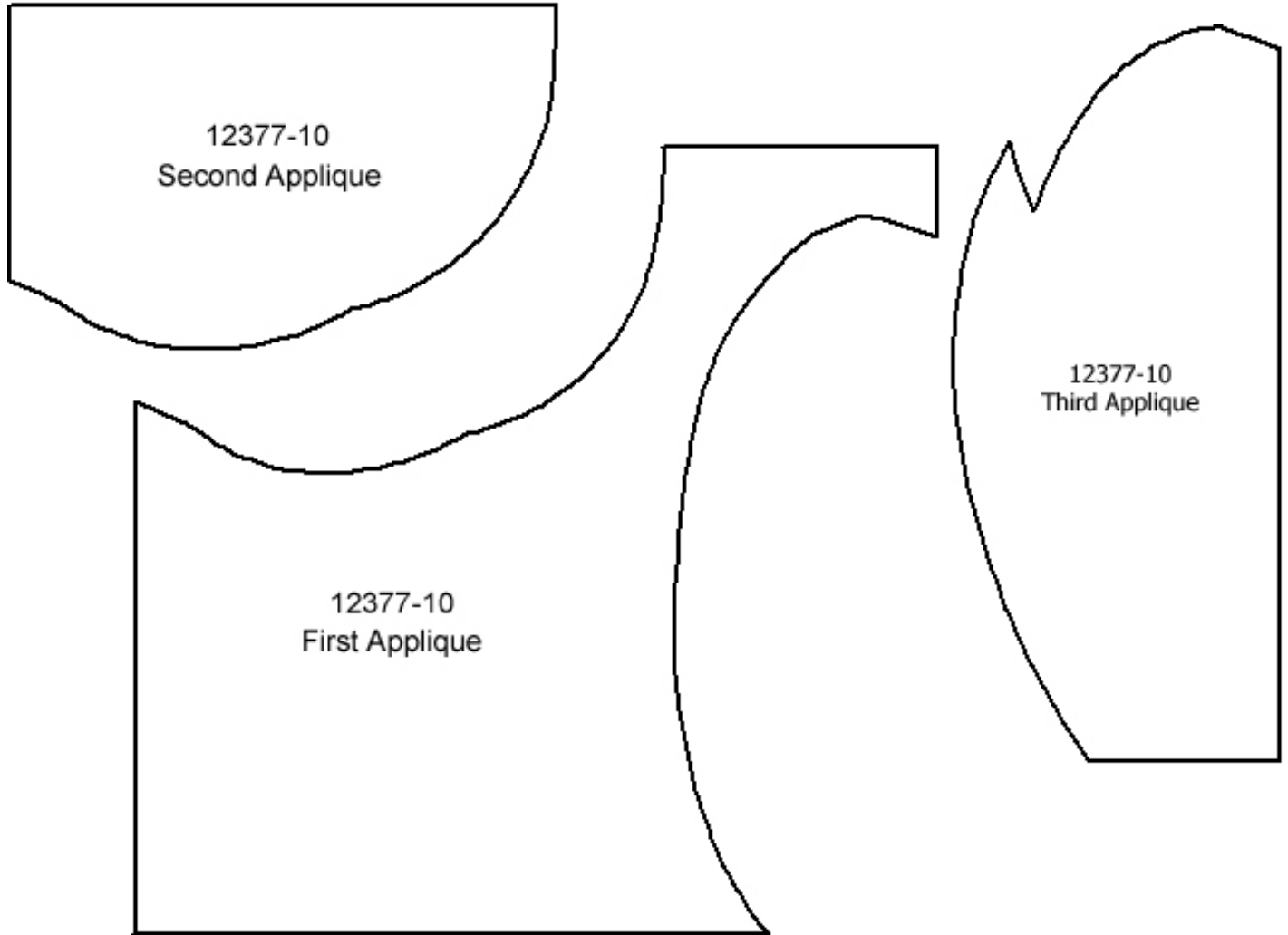




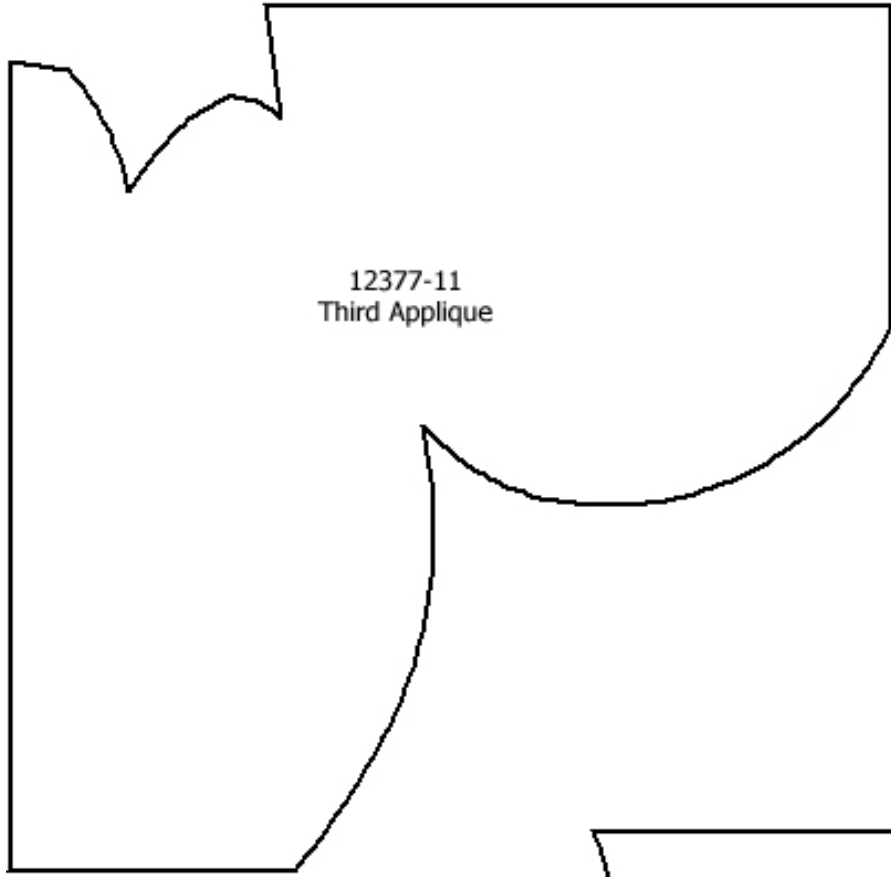




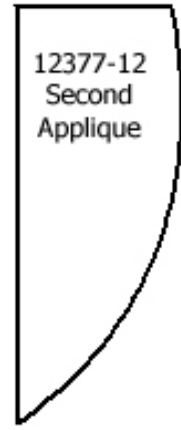




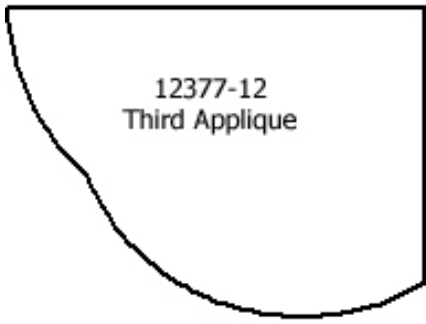




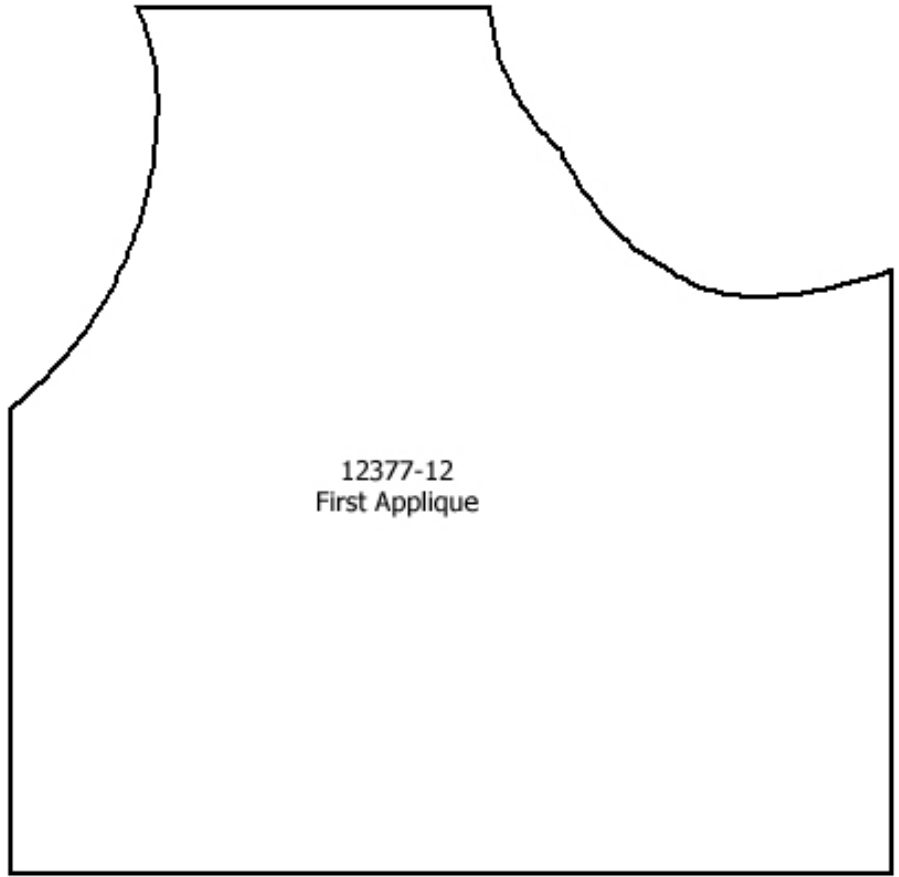
12377-11  
Third Applique



12377-12  
Second  
Applique



12377-12  
Third Applique



12377-12  
First Applique