

Note: Some designs in this collection may have been created using unique special stitches and/or techniques. To preserve design integrity when rescaling or rotating designs in your software, always rescale or rotate designs using the handles directly on-screen.



**12383-01 Blue Flowers Stamp Appliqué**  
1.96 X 2.22 in.  
49.78 X 56.39 mm  
4,664 St.



**12383-02 Swan Stamp Appliqué**  
1.73 X 1.82 in.  
43.94 X 46.23 mm  
3,984 St.



**12383-03 Butterfly Stamp Appliqué**  
2.24 X 1.53 in.  
56.90 X 38.86 mm  
5,551 St.



**12383-04 Robin Stamp Appliqué**  
1.82 X 2.45 in.  
46.23 X 62.23 mm  
6,864 St.



**12383-05 Profile Stamp Appliqué**  
1.95 X 2.21 in.  
49.53 X 56.13 mm  
5,419 St.



**12383-06 Red 2 Stamp Appliqué**  
1.77 X 1.84 in.  
44.96 X 46.74 mm  
3,328 St.



**12383-07 Rose Stamp Appliqué**  
1.93 X 2.21 in.  
49.02 X 56.13 mm  
8,812 St.



**12383-08 Dove Stamp Appliqué**  
1.76 X 1.84 in.  
44.70 X 46.74 mm  
4,479 St.

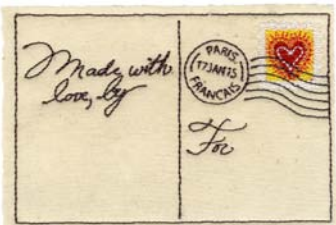

**12383-09 Quilt Label Appliqué**  
4.45 X 3.04 in.  
113.03 X 77.22 mm  
4,903 St.

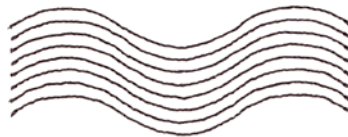

**12383-10 Cancellation Stripes**  
3.57 X 1.34 in.  
90.68 X 34.04 mm  
1,417 St. **S**



**12383-11 Buenos Aires Postmark**  
1.60 X 6.50 in.  
40.64 X 165.10 mm  
2,686 St. **L**



**12383-12 NY Postmark**  
2.24 X 2.52 in.  
56.90 X 64.01 mm  
5,332 St. **L**

**⌘** Design contains a loose fill.  
**⚙** Some white areas shown are not stitched.

**L** Design is larger than 5" (127 mm) in either direction.  
**S** Design is smaller than 1.5" (38.1 mm) in either direction.

Note: Some designs in this collection may have been created using unique special stitches and/or techniques. To preserve design integrity when rescaling or rotating designs in your software, always rescale or rotate designs using the handles directly on-screen.



12383-13 Venice Postmark  
2.48 X 2.47 in.  
62.99 X 62.74 mm  
5,578 St. ⚙️



12383-14 Paris Postmark  
1.90 X 1.89 in.  
48.26 X 48.01 mm  
1,541 St. ⚙️



12383-15 Swiss Postmark  
2.00 X 2.00 in.  
50.80 X 50.80 mm  
4,385 St. ⚙️



12383-16 Carte Postale  
2.53 X 5.25 in.  
64.26 X 133.35 mm  
4,563 St. ⚙️ L



12383-17 Post Card  
1.78 X 5.55 in.  
45.21 X 140.97 mm  
4,622 St. ⚙️ L



12383-18 Music Notes  
3.57 X 6.74 in.  
90.68 X 171.20 mm  
5,251 St. ⚙️ L



12383-19 Air Mail Stamp  
2.41 X 1.47 in.  
61.21 X 37.34 mm  
3,383 St. ⚙️ S



12383-20 Corner  
2.57 X 2.57 in.  
65.28 X 65.28 mm  
3,206 St. ⚙️



12383-21 Border  
5.14 X .64 in.  
130.56 X 16.26 mm  
3,008 St. L S



12383-22 Border Piece  
.86 X .64 in.  
21.84 X 16.26 mm  
541 St. S

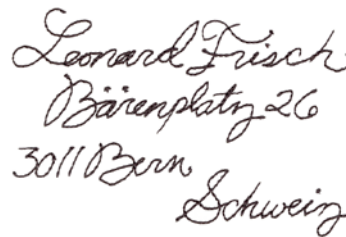

12383-23 Swiss Address  
3.83 X 2.58 in.  
97.28 X 65.53 mm  
2,519 St. ⚙️

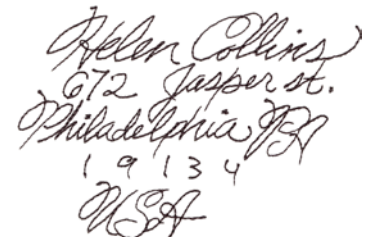

12383-24 US Address  
4.35 X 2.99 in.  
110.49 X 75.95 mm  
3,343 St. ⚙️

⚙️ Design contains a loose fill.  
⚙️ Some white areas shown are not stitched.

L Design is larger than 5" (127 mm) in either direction.  
S Design is smaller than 1.5" (38.1 mm) in either direction.

Note: Some designs in this collection may have been created using unique special stitches and/or techniques. To preserve design integrity when rescaling or rotating designs in your software, always rescale or rotate designs using the handles directly on-screen.

Monsieur Gaston  
Calle de los Canteros 75  
4607 Valencia  
España

Mr Army Dubois  
39 Scott St.  
Liverpool, Merseyside  
L17 2RF  
United Kingdom

Vourei che fossi  
con me.

Haben eine schöne  
Zeit. Sie würde  
geliebt haben das  
Museum!

Ich werde bald  
zue Hause sein.

### 12383-25 Spain Address

4.29 X 2.30 in.  
108.97 X 58.42 mm  
2,863 St.

### 12383-26 UK Address

3.31 X 2.86 in.  
84.07 X 72.64 mm  
3,049 St.

### 12383-27 Italian Note

3.59 X 1.27 in.  
91.19 X 32.26 mm  
993 St.

### 12383-28 German Note

4.08 X 2.91 in.  
103.63 X 73.91 mm  
4,260 St.

You would love Switzerland!  
We are about to go to the  
Museum - Tomorrow we  
want to the Chateau de Chillon  
and this morning we ate at  
a cafe with a view of the  
Matterhorn.

Te m'amuse beaucoup  
à Paris. J'aimerais  
que tu sois là.

Es hermosa aquí!  
Fue un viaje genial  
volvere a Argentina  
en el futuro. Voy  
al aeropuerto ahora  
espero dormir en el  
avión.

Saludos  
Camila

### 12383-29 Swiss Note

2.92 X 6.07 in.  
74.17 X 154.18 mm  
7,702 St.

### 12383-30 French Note

3.61 X 1.83 in.  
91.69 X 46.48 mm  
2,125 St.

### 12383-31 Spanish Note

4.07 X 3.69 in.  
103.38 X 93.73 mm  
4,840 St.

Design contains a loose fill.  
 Some white areas shown are not stitched.

Design is larger than 5" (127 mm) in either direction.  
 Design is smaller than 1.5" (38.1 mm) in either direction.

Listings below indicate color sample, stitching order and suggested thread color number in Isacord thread.

### 12383-01 Blue Flowers Stamp Appliqué

1. Placement Stitch	0184
2. Cut Line & Tackdown	0184
3. White Linework	0015
4. Stamp Border	0184

### 12383-02 Swan Stamp Appliqué

1. Placement Stitch	0184
2. Cut Line & Tackdown	0184
3. Swan	0101
4. Brown Details	0853
5. Stamp Border	0184

### 12383-03 Butterfly Stamp Appliqué

1. Placement Stitch	0184
2. Cut Line & Tackdown	0184
3. Light Blue Shading	3730
4. Medium Blue Shading	3630
5. Dark Blue Outlines	3654
6. Dark Gray Body & Wing Edges	4174
7. Stamp Border	0184

### 12383-04 Robin Stamp Appliqué

1. Placement Stitch	0184
2. Cut Line & Tackdown	0184
3. Green Leaves	5912
4. Light Green on Leaves	6011
5. Tree Limbs	0873
6. White on Bird	0015
7. Light Brown Bird Shading	0862
8. Light Orange on Bird	1010
9. Orange Shading	0931
10. Red Orange Shading	1322
11. Dark Brown Outlines	1874
12. Eye & Number	0020
13. Stamp Border	0184

### 12383-05 Profile Stamp Appliqué

1. Placement Stitch	0184
2. Cut Line & Tackdown	0184
3. Light Purple Details	3150
4. Stamp Border	0184

### 12383-06 Red 2 Stamp Appliqué

1. Placement Stitch	0184
2. Cut Line & Tackdown	0184
3. Linework	1352
4. Stamp Border	0184

### 12383-07 Rose Stamp Appliqué

1. Placement Stitch	0184
2. Cut Line & Tackdown	0184
3. Light Green Leaves	5664
4. Dark Green Leaves Details	5374
5. Red Petals	1900
6. Dark Red Shading	2022
7. Pink Highlights	1753
8. Number	0020
9. Stamp Border	0184

### 12383-08 Dove Stamp Appliqué

1. Placement Stitch	0184
2. Cut Line & Tackdown	0184
3. Leaves	5531
4. Dove	0015
5. Light Blue Shading	3150
6. Blue Outlines	3151
7. Beak	1010
8. Eye	0020
9. Stamp Border	0184

### 12383-09 Quilt Label Appliqué

1. Placement Stitch	0015
2. Linework	4174
3. Yellow on Stamp	0608
4. Heart	2101
5. Dark Pink Details	1600
6. White Details & Stamp Border	0015
7. Words	4174

### 12383-10 Cancellation Stripes

1. Single Color Design	4174
------------------------	------

### 12383-11 Buenos Aires Postmark

1. Single Color Design	4174
------------------------	------

### 12383-12 NY Postmark

1. Single Color Design	4174
------------------------	------

### 12383-13 Venice Postmark

1. Single Color Design	4174
------------------------	------

### 12383-14 Paris Postmark

1. Single Color Design	4174
------------------------	------

### 12383-15 Swiss Postmark

1. Single Color Design	4174
------------------------	------

### 12383-16 Carte Postale

1. Single Color Design	4174
------------------------	------

### 12383-17 Post Card

1. Single Color Design	4174
------------------------	------

### 12383-18 Music Notes

1. Single Color Design	4174
------------------------	------

### 12383-19 Air Mail Stamp

1. Single Color Design	3830
------------------------	------

### 12383-20 Corner

1. Single Color Design	4174
------------------------	------

### 12383-21 Border

1. Single Color Design	4174
------------------------	------

### 12383-22 Border Piece

1. Single Color Design	4174
------------------------	------

### 12383-23 Swiss Address

1. Single Color Design	4174
------------------------	------

### 12383-24 US Address

1. Single Color Design	4174
------------------------	------

### 12383-25 Spain Address

1. Single Color Design	4174
------------------------	------

### 12383-26 UK Address

1. Single Color Design	4174
------------------------	------

### 12383-27 Italian Note

1. Single Color Design	4174
------------------------	------

### 12383-28 German Note

1. Single Color Design	4174
------------------------	------

### 12383-29 Swiss Note

1. Single Color Design	4174
------------------------	------

### 12383-30 French Note

1. Single Color Design	4174
------------------------	------

### 12383-31 Spanish Note

1. Single Color Design	4174
------------------------	------

Note: Appliqué fabric not included.

## Pre-Cut Appliqué Instructions

1. Print out the necessary pages from the PDF of the appliqué pattern(s).
2. Mark the right side of the pattern pieces so you'll know which direction to lay the pattern on the fabric.
3. Lightly spray the wrong side of the pattern pieces with temporary adhesive spray and allow it to set for a few minutes.
4. Place the pattern pieces on the right side of the fabric and carefully cut them out. **PHOTO 1**
5. Sew the placement stitch on your hooped fabric. **PHOTO 2**
6. With the paper still stuck to the right side of the appliqué fabric, spray the wrong side of the fabric with temporary adhesive.
7. Place the fabric inside the sewing placement stitch so that it matches the stitching line then remove the paper pattern. **PHOTO 3**
8. Sew the tackdown. **PHOTO 4**
9. Sew the remainder of the design and repeat for any remaining pieces. **PHOTO 5**

**NOTE:** The patterns are sized for the designs as they were made. If you resize the design, you will need to resize the pattern the same amount. You can print out the pattern at the normal size then copy it on a copy machine at the changed size, i.e. resize the designs to 80%, resize the printed pattern to 80%.

**TIP:** When Printing the patterns, make sure that the "Fit to page" option is **UNCHECKED** in the Print Dialog Box. If this option is checked the printed patterns will not be actual size.

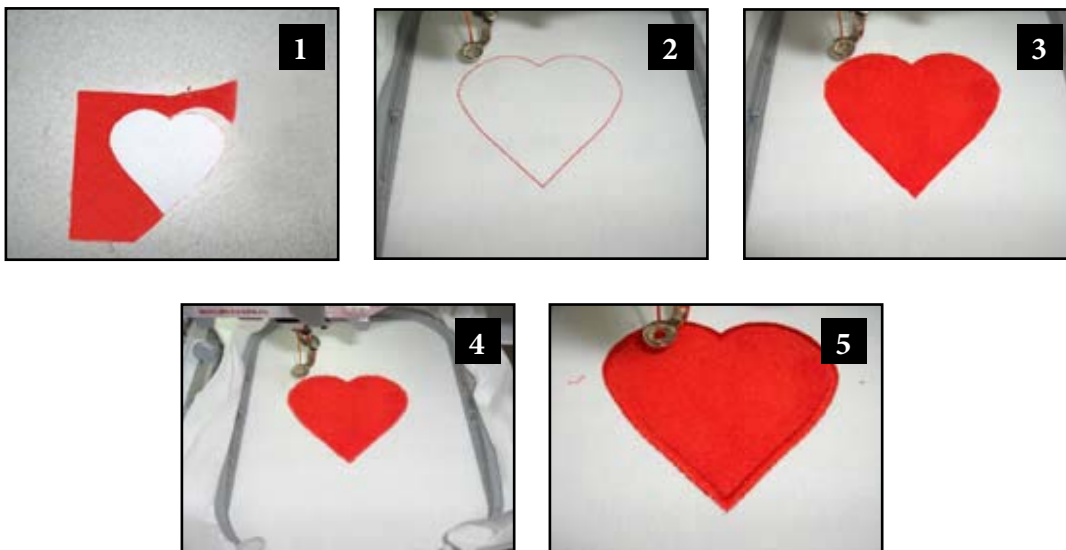

## Cut in Place Appliqué Instructions

1. Hoop your fabric and backing.
2. Sew the pattern/placement. **PHOTO 1**
3. Place a piece of appliqué fabric over the pattern/placement so that it is completely covered.
4. Sew the trim stitch/tackdown.
5. Carefully cut away the excess appliqué fabric. **PHOTO 2**
6. Sew the remainder of the design and repeat for any remaining pieces. **PHOTO 3**

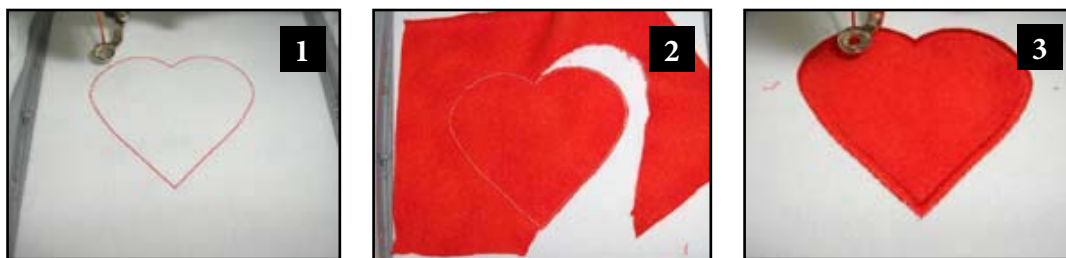

## ATTENTION

When printing this document, any page scaling or page fitting options in your print dialog box must be turned OFF or set to NONE so that your files will print out at their actual size. Images not printed at actual size will not function as intended.

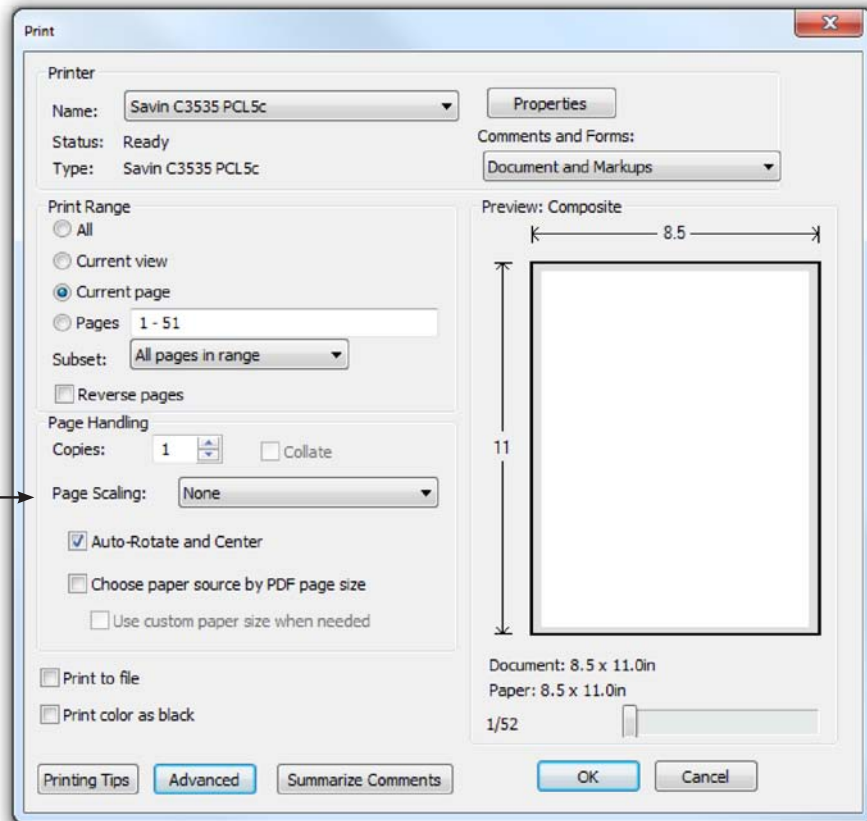

## TO SAVE PAPER

Only print the desired image by navigating to the image's page, go to File > Print and select "Current page" in the print dialog box. Repeat for each desired image.

