

Note: Some designs in this collection may have been created using unique special stitches and/or techniques. To preserve design integrity when rescaling or rotating designs in your software, always rescale or rotate designs using the handles directly on-screen.



**12461-01 Floral Couture**  
**Appliqué 1**  
 4.27 X 5.73 in.  
 108.46 X 145.54 mm  
 7,163 St. ❄️ L



**12461-02 Floral Couture**  
**Appliqué 2**  
 4.85 X 5.99 in.  
 123.19 X 152.15 mm  
 10,323 St. ❄️ L



**12461-03 Floral Couture**  
**Appliqué 3**  
 4.17 X 6.88 in.  
 105.92 X 174.75 mm  
 8,303 St. ❄️ L



**12461-04 Floral Couture**  
**Appliqué 4**  
 4.96 X 6.72 in.  
 125.98 X 170.69 mm  
 8,271 St. ❄️ L



**12461-05 Floral Couture**  
**Appliqué 5**  
 4.52 X 4.40 in.  
 114.81 X 111.76 mm  
 5,899 St. ❄️



**12461-06 Floral Couture**  
**Appliqué 6**  
 4.28 X 4.19 in.  
 108.71 X 106.43 mm  
 5,369 St. ❄️



**12461-07 Floral Couture**  
**Appliqué 7**  
 4.84 X 5.08 in.  
 122.94 X 129.03 mm  
 7,262 St. ❄️ L



**12461-08 Couture Flower**  
**Appliqué 1**  
 4.57 X 4.60 in.  
 116.08 X 116.84 mm  
 5,230 St. ❄️



**12461-09 Couture Flower**  
**Appliqué 2**  
 3.02 X 3.04 in.  
 76.71 X 77.22 mm  
 3,059 St. ❄️



**12461-10 Couture Flower**  
**Appliqué 3**  
 2.24 X 2.30 in.  
 56.90 X 58.42 mm  
 2,140 St. ❄️



**12461-11 Couture Butterfly**  
**Appliqué**  
 3.41 X 4.39 in.  
 86.61 X 111.51 mm  
 4,268 St. ❄️



**12461-12 Couture Bird Appliqué**  
 4.87 X 5.04 in.  
 123.70 X 128.02 mm  
 8,122 St. ❄️ L

❄️ Design contains a loose fill.

❄️ Some white areas shown are not stitched.

L Design is larger than 5" (127 mm) in either direction.

S Design is smaller than 1.5" (38.1 mm) in either direction.

It is a violation of Copyright law to make and distribute copies of electronic designs or artwork.

Electronic designs are licensed to the original purchaser for use at one location. ©2013 OESD, LLC. All rights reserved.

Note: Some designs in this collection may have been created using unique special stitches and/or techniques. To preserve design integrity when rescaling or rotating designs in your software, always rescale or rotate designs using the handles directly on-screen.



**12461-13 Couture Leaves**  
**Appliqué 1**  
 4.25 X 4.71 in.  
 107.95 X 119.63 mm  
 4,651 St. ⚙️



**12461-14 Couture Leaves**  
**Appliqué 2**  
 2.56 X 2.66 in.  
 65.02 X 67.56 mm  
 2,018 St. ⚙️



**12461-15 Couture Leaves Vine**  
 3.53 X 4.13 in.  
 89.66 X 104.90 mm  
 3,269 St. ⚙️

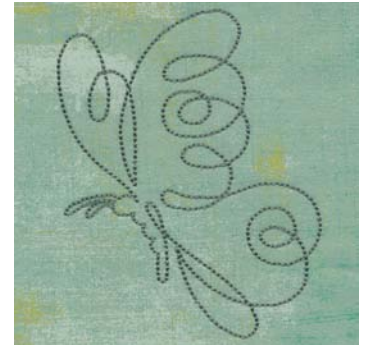

**12461-16 Couture Butterfly**  
 2.72 X 3.43 in.  
 69.09 X 87.12 mm  
 2,844 St. ⚙️



**12461-17 Couture Leaf Mini**  
 1.42 X 1.64 in.  
 36.07 X 41.66 mm  
 959 St. ⚙️ S



**12461-18 Couture Background Swirl 1**  
 4.92 X 7.22 in.  
 124.97 X 183.39 mm  
 4,474 St. ⚙️ L



**12461-19 Couture Background Swirl 2**  
**Swirl 2**  
 5.52 X 4.38 in.  
 140.21 X 111.25 mm  
 3,001 St. ⚙️ L



**12461-20 Couture Background Swirl 3**  
**Swirl 3**  
 3.37 X 4.78 in.  
 85.60 X 121.41 mm  
 2,027 St. ⚙️

⚙️ Design contains a loose fill.  
 ⚙️ Some white areas shown are not stitched.

L Design is larger than 5" (127 mm) in either direction.  
 S Design is smaller than 1.5" (38.1 mm) in either direction.



# Garden Couture

#12461 / 20 Designs

Listings below indicate color sample, stitching order and suggested thread color number. "I" refers to Isacord Thread and "T" refers to Timeless. Colors beginning with 20501 refer to YLI Fine Metallics, 7 refer to Yenmet Metallic, 8 refer to YLI Variations Variegated Thread and 9 refer to Isacord Multicolor Variegated.

	I	T		I	T		I	T
<b>12461-01 Floral Couture Appliqué 1</b>			<b>12461-07 Floral Couture Appliqué 7</b>			<b>12461-13 Couture Leaves Appliqué 1</b>		
1. Placement Stitch.....	5450	14175	1. Placement Stitch.....	5450	14175	1. Placement Stitch.....	5450	14175
2. Tackdown.....	0640	22106	2. Tackdown.....	0640	22106	2. Tackdown.....	0640	22106
3. Linework.....	5664	18214	3. Linework.....	5664	18214	3. Linework.....	5664	18214
<b>12461-02 Floral Couture Appliqué 2</b>			<b>12461-08 Couture Flower Appliqué 1</b>			<b>12461-14 Couture Leaves Appliqué 2</b>		
1. Placement Stitch.....	5450	14175	1. Placement Stitch.....	5450	14175	1. Placement Stitch.....	5450	14175
2. Tackdown.....	0640	22106	2. Tackdown.....	0640	22106	2. Tackdown.....	0640	22106
3. Linework.....	5664	18214	3. Linework.....	5664	18214	3. Linework.....	5664	18214
<b>12461-03 Floral Couture Appliqué 3</b>			<b>12461-09 Couture Flower Appliqué 2</b>			<b>12461-15 Couture Leaves Vine</b>		
1. Placement Stitch.....	5450	14175	1. Placement Stitch.....	5450	14175	1. Single Color Design.....	5664	18214
2. Tackdown.....	0640	22106	2. Tackdown.....	0640	22106			
3. Linework.....	5664	18214	3. Linework.....	5664	18214			
<b>12461-04 Floral Couture Appliqué 4</b>			<b>12461-10 Couture Flower Appliqué 3</b>			<b>12461-16 Couture Butterfly</b>		
1. Placement Stitch.....	5450	14175	1. Placement Stitch.....	5450	14175	1. Single Color Design.....	5664	18214
2. Tackdown.....	0640	22106	2. Tackdown.....	0640	22106			
3. Linework.....	5664	18214	3. Linework.....	5664	18214			
<b>12461-05 Floral Couture Appliqué 5</b>			<b>12461-11 Couture Butterfly Appliqué</b>			<b>12461-17 Couture Leaf Mini</b>		
1. Placement Stitch.....	5450	14175	1. Placement Stitch.....	5450	14175	1. Single Color Design.....	5664	18214
2. Tackdown.....	0640	22106	2. Tackdown.....	0640	22106			
3. Linework.....	5664	18214	3. Linework.....	5664	18214			
<b>12461-06 Floral Couture Appliqué 6</b>			<b>12461-12 Couture Bird Appliqué</b>			<b>12461-18 Couture Background Swirl 1</b>		
1. Placement Stitch.....	5450	14175	1. Placement Stitch.....	5450	14175	1. Single Color Design.....	0442	18181
2. Tackdown.....	0640	22106	2. Tackdown.....	0640	22106			
3. Linework.....	5664	18214	3. Linework.....	5664	18214			
						<b>12461-19 Couture Background Swirl 2</b>		
						1. Single Color Design.....	0442	18181
						<b>12461-20 Couture Background Swirl 3</b>		
						1. Single Color Design.....	0442	18181

1. Print out the necessary pages from the PDF of the appliqué pattern(s).
2. Mark the right side of the pattern pieces so you'll know which direction to lay the pattern on the fabric.
3. Lightly spray the wrong side of the pattern pieces with temporary adhesive spray and allow it to set for a few minutes.
4. Place the pattern pieces on the right side of the fabric and carefully cut them out. **PHOTO 1**
5. Sew the placement stitch on your hooped fabric. **PHOTO 2**
6. With the paper still stuck to the right side of the appliqué fabric, spray the wrong side of the fabric with temporary spray adhesive.
7. Place the fabric inside the sewing placement stitch so that it matches the stitching line, and then remove the paper pattern. **PHOTO 3**
8. Sew the tackdown. **PHOTO 4**
9. Sew the remainder of the design and repeat for any remaining pieces. **PHOTO 5**

**NOTE: The patterns are sized for the designs as they were made. If you resize the design, you will need to resize the pattern the same amount. You can print out the pattern at the normal size then copy it on a copy machine at the changed size. For example, resize the designs to 80%, resize the printed pattern to 80%.**

**TIP: When Printing the patterns, make sure that the “Fit to page” option is UNCHECKED in the Print Dialog Box. If this option is checked the printed patterns will not be actual size.**

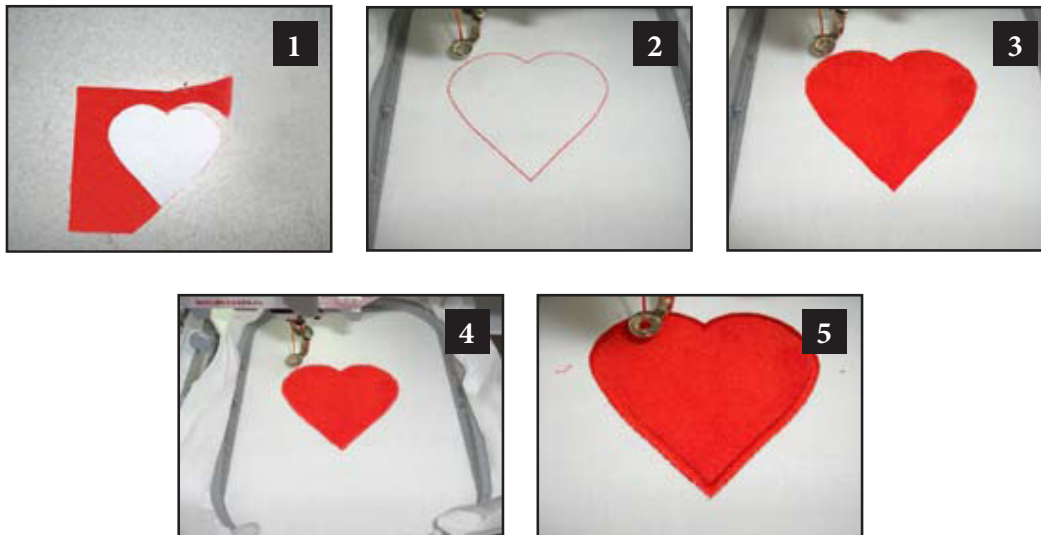

Note: Some of the appliqué pieces in this collection are attached to the design by a looser density stitch rather than the traditional full satin stitch. This means that the edges of the appliqué may begin to fray, creating a more informal and natural look. The collection was created with this effect in mind. If you wish the appliqué pieces to keep a sharper edge, you will need to select the appliqué fabric with this in mind. You may also choose to apply a non-fray treatment to the appliqué fabric before attaching it, or use a sticky backing on the appliqué fabric before cutting out the appliqué pattern piece.

## ATTENTION

When printing this document, any page scaling or page fitting options in your print dialog box must be turned OFF or set to NONE so that your files will print out at their actual size. Images not printed at actual size will not function as intended.

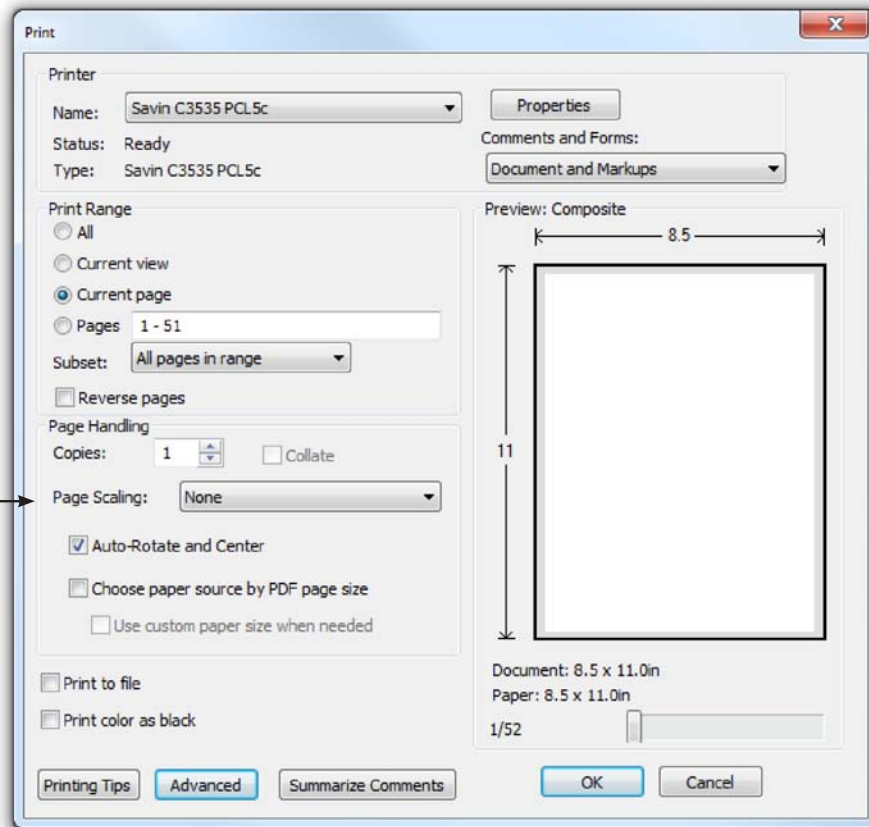

## TO SAVE PAPER

Only print the desired image by navigating to the image's page, go to File > Print and select "Current page" in the print dialog box. Repeat for each desired image.

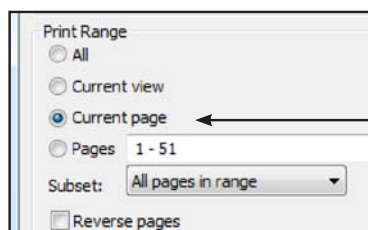

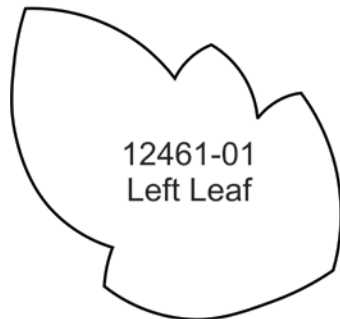
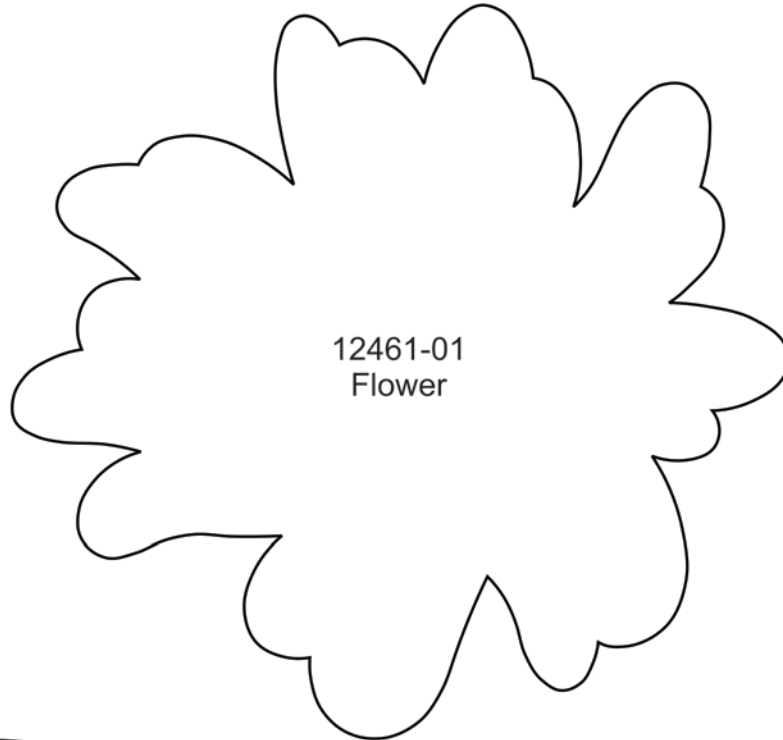

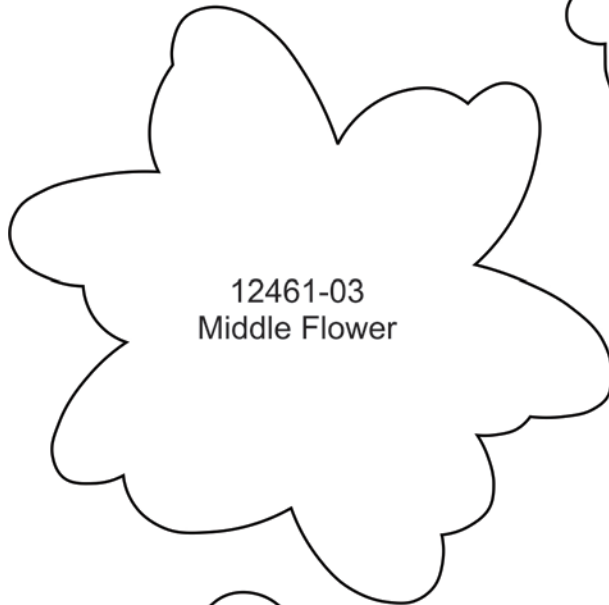
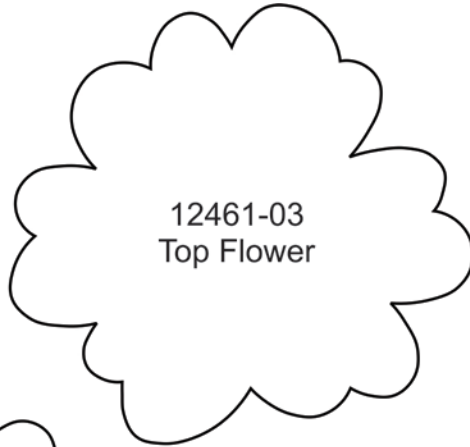

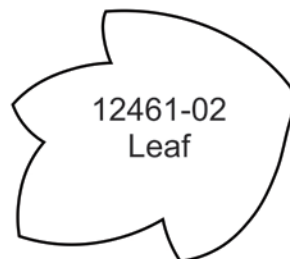
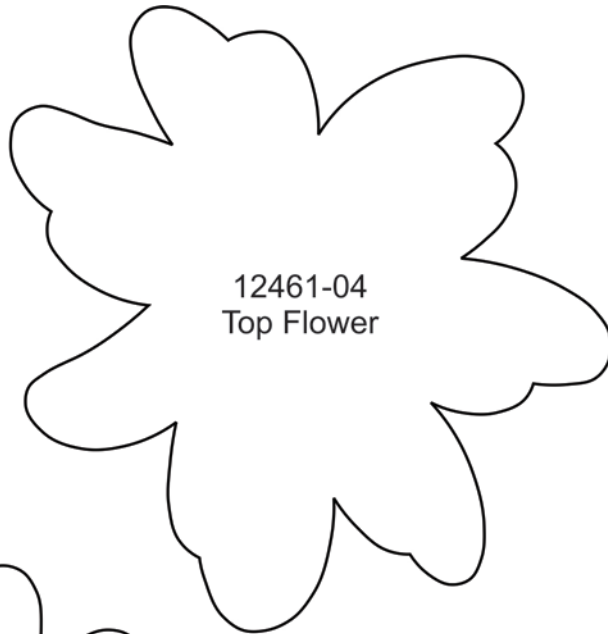





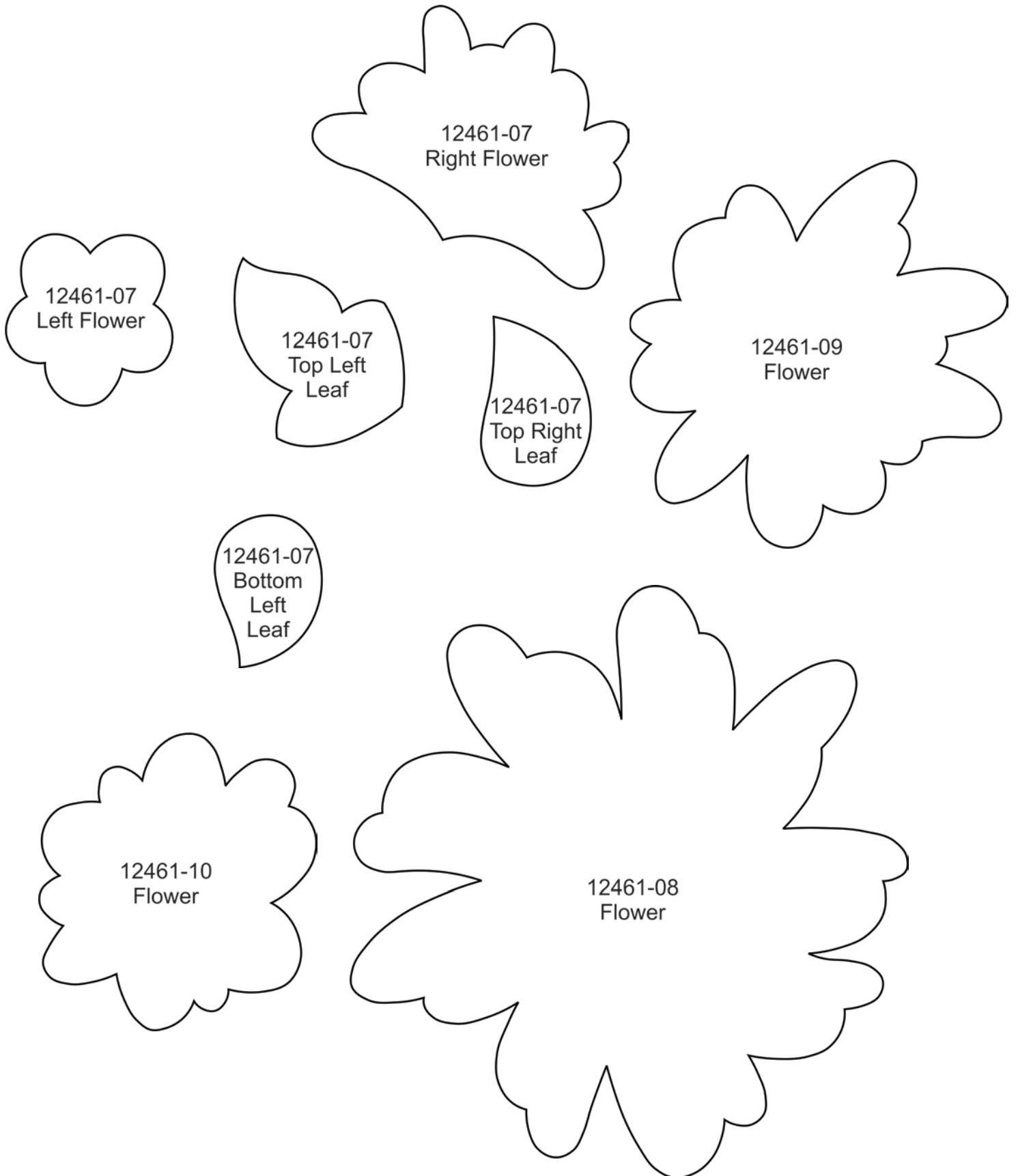

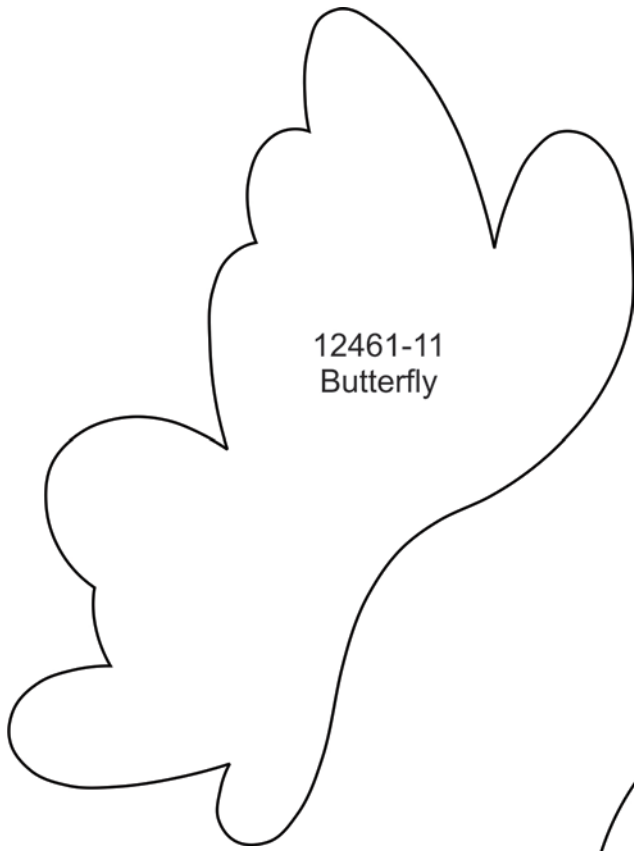

12461-11  
Butterfly



12461-14  
Leaf

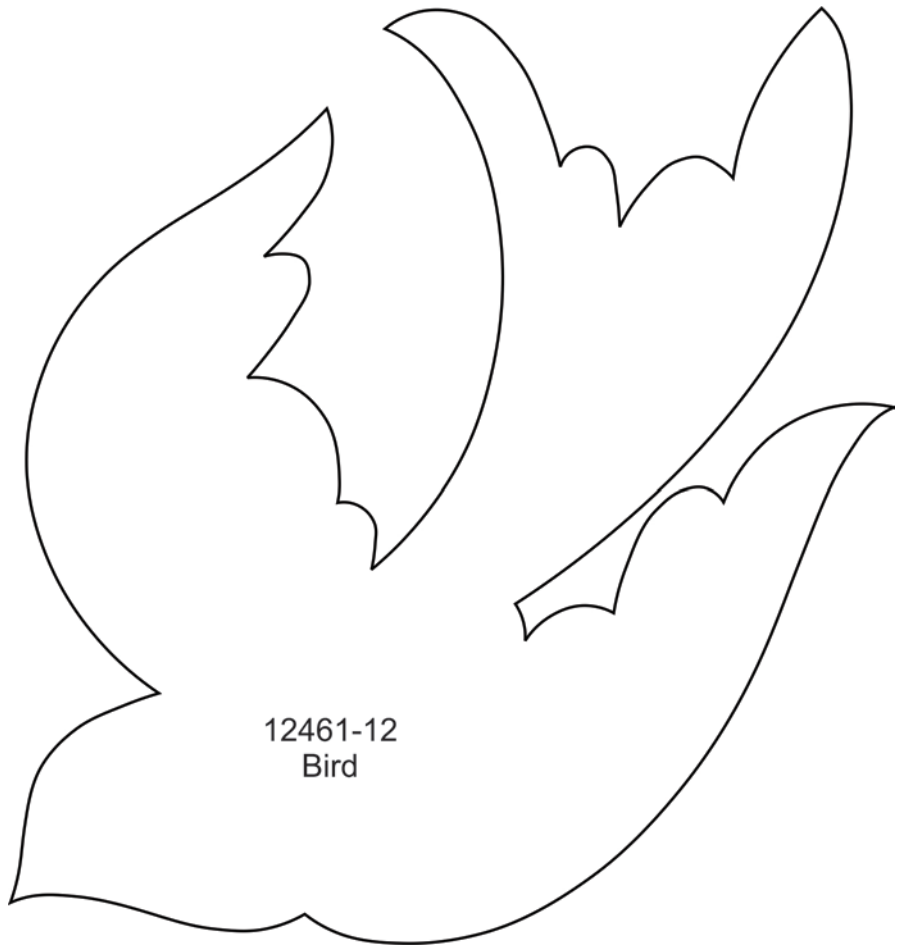

12461-12  
Bird



12461-13  
Leaf Leaves

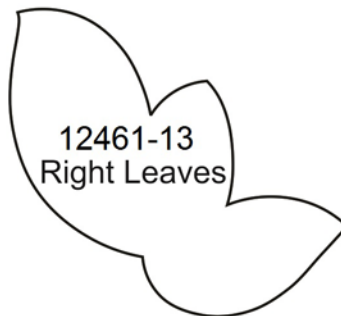

12461-13  
Right Leaves