

Note: Some designs in this collection may have been created using unique special stitches and/or techniques. To preserve design integrity when rescaling or rotating designs in your software, always rescale or rotate designs using the handles directly on-screen.

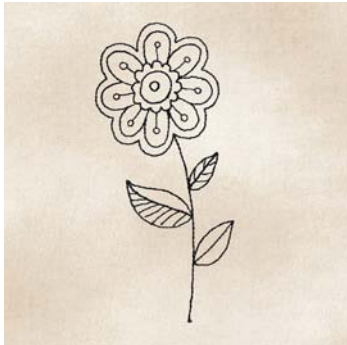

**12498-01 Linework Flower**

2.03 X 4.46 in.  
51.56 X 113.28 mm  
2,110 St. ⚙️



**12498-02 Appliqué Flower**

2.31 X 5.97 in.  
58.67 X 151.64 mm  
2,162 St. ⚙️ L



**12498-03 Appliqué Flowers**

3.44 X 5.60 in.  
87.38 X 142.24 mm  
3,909 St. ⚙️ L



**12498-04 Appliqué Tree**

4.29 X 6.30 in.  
108.97 X 160.02 mm  
4,168 St. ⚙️ L



**12498-05 Appliqué Bunting**

3.81 X 1.63 in.  
96.77 X 41.40 mm  
756 St. ⚙️



**12498-06 Appliqué Countryside**

8.90 X 3.20 in.  
226.06 X 81.28 mm  
5,747 St. ⚙️ L



**12498-07 Appliqué Cityscape**

6.91 X 4.32 in.  
175.51 X 109.73 mm  
9,002 St. ⚙️ L



**12498-08 Appliqué Home**

6.54 X 4.65 in.  
166.12 X 118.11 mm  
9,466 St. ⚙️ L



**12498-09 Appliqué Car**

3.83 X 2.03 in.  
97.28 X 51.56 mm  
1,646 St. ⚙️

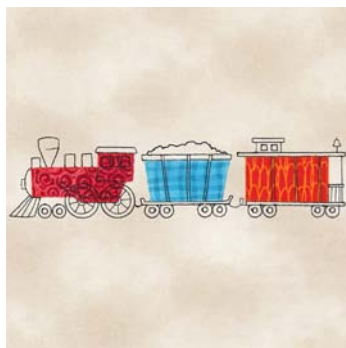

**12498-10 Appliqué Train**

9.10 X 2.18 in.  
231.14 X 55.37 mm  
5,878 St. ⚙️ L

⚙️ Design contains a loose fill.  
⚙️ Some white areas shown are not stitched.

L Design is larger than 5" (127 mm) in either direction.  
S Design is smaller than 1.5" (38.1 mm) in either direction.



# Scenic Land Appliqué

#12498 / 10 Designs

Listings below indicate color sample, stitching order and suggested thread color number. "I" refers to Isacord thread and "T" refers to Timeless thread. Colors beginning with 20501 refer to YLI Fine Metallics, 7 refer to Yenmet Metallic, 8 refer to YLI Variations Variegated Thread and 9 refer to Isacord Multicolor Variegated.

<p><b>12498-01 Linework Flower</b></p> <table border="0"> <thead> <tr> <th></th> <th>I</th> <th>T</th> </tr> </thead> <tbody> <tr> <td>1. Single Color Design</td> <td>0020</td> <td>28151</td> </tr> </tbody> </table>		I	T	1. Single Color Design	0020	28151	<p><b>12498-05 Appliqué Bunting</b></p> <table border="0"> <thead> <tr> <th></th> <th>I</th> <th>T</th> </tr> </thead> <tbody> <tr> <td>1. Purple Flag Placement Stitch</td> <td>2830</td> <td>16127</td> </tr> <tr> <td>2. Tackdown</td> <td>2830</td> <td>16127</td> </tr> <tr> <td>3. Yellow Flag Placement Stitch</td> <td>0506</td> <td>22133</td> </tr> <tr> <td>4. Tackdown</td> <td>0506</td> <td>22133</td> </tr> <tr> <td>5. Green Flag Placement Stitch</td> <td>5912</td> <td>18130</td> </tr> <tr> <td>6. Tackdown</td> <td>5912</td> <td>18130</td> </tr> <tr> <td>7. Blue Flag Placement Stitch</td> <td>4240</td> <td>14178</td> </tr> <tr> <td>8. Tackdown</td> <td>4240</td> <td>14178</td> </tr> <tr> <td>9. Linework</td> <td>0020</td> <td>28151</td> </tr> </tbody> </table>		I	T	1. Purple Flag Placement Stitch	2830	16127	2. Tackdown	2830	16127	3. Yellow Flag Placement Stitch	0506	22133	4. Tackdown	0506	22133	5. Green Flag Placement Stitch	5912	18130	6. Tackdown	5912	18130	7. Blue Flag Placement Stitch	4240	14178	8. Tackdown	4240	14178	9. Linework	0020	28151	<p><b>12498-08 Appliqué Home</b></p> <table border="0"> <thead> <tr> <th></th> <th>I</th> <th>T</th> </tr> </thead> <tbody> <tr> <td>1. Round Tree Placement Stitch</td> <td>5934</td> <td>18193</td> </tr> <tr> <td>2. Tackdown</td> <td>5934</td> <td>18193</td> </tr> <tr> <td>3. Long Tree Placement Stitch</td> <td>5934</td> <td>18193</td> </tr> <tr> <td>4. Tackdown</td> <td>5934</td> <td>18193</td> </tr> <tr> <td>5. House Placement Stitch</td> <td>0506</td> <td>22133</td> </tr> <tr> <td>6. Tackdown</td> <td>0506</td> <td>22133</td> </tr> <tr> <td>7. Linework</td> <td>0020</td> <td>28151</td> </tr> </tbody> </table>		I	T	1. Round Tree Placement Stitch	5934	18193	2. Tackdown	5934	18193	3. Long Tree Placement Stitch	5934	18193	4. Tackdown	5934	18193	5. House Placement Stitch	0506	22133	6. Tackdown	0506	22133	7. Linework	0020	28151									
	I	T																																																																					
1. Single Color Design	0020	28151																																																																					
	I	T																																																																					
1. Purple Flag Placement Stitch	2830	16127																																																																					
2. Tackdown	2830	16127																																																																					
3. Yellow Flag Placement Stitch	0506	22133																																																																					
4. Tackdown	0506	22133																																																																					
5. Green Flag Placement Stitch	5912	18130																																																																					
6. Tackdown	5912	18130																																																																					
7. Blue Flag Placement Stitch	4240	14178																																																																					
8. Tackdown	4240	14178																																																																					
9. Linework	0020	28151																																																																					
	I	T																																																																					
1. Round Tree Placement Stitch	5934	18193																																																																					
2. Tackdown	5934	18193																																																																					
3. Long Tree Placement Stitch	5934	18193																																																																					
4. Tackdown	5934	18193																																																																					
5. House Placement Stitch	0506	22133																																																																					
6. Tackdown	0506	22133																																																																					
7. Linework	0020	28151																																																																					
<p><b>12498-02 Appliqué Flower</b></p> <table border="0"> <tbody> <tr> <td>1. Flower Placement Stitch</td> <td>2830</td> <td>16127</td> </tr> <tr> <td>2. Tackdown</td> <td>2830</td> <td>16127</td> </tr> <tr> <td>3. Top Leaf Placement Stitch</td> <td>5934</td> <td>18193</td> </tr> <tr> <td>4. Tackdown</td> <td>5934</td> <td>18193</td> </tr> <tr> <td>5. Bottom Leaf Placement Stitch</td> <td>5643</td> <td>18196</td> </tr> <tr> <td>6. Tackdown</td> <td>5643</td> <td>18196</td> </tr> <tr> <td>7. Linework</td> <td>0020</td> <td>28151</td> </tr> </tbody> </table>	1. Flower Placement Stitch	2830	16127	2. Tackdown	2830	16127	3. Top Leaf Placement Stitch	5934	18193	4. Tackdown	5934	18193	5. Bottom Leaf Placement Stitch	5643	18196	6. Tackdown	5643	18196	7. Linework	0020	28151	<p><b>12498-06 Appliqué Countryside</b></p> <table border="0"> <tbody> <tr> <td>1. Barn Placement Stitch</td> <td>1902</td> <td>12121</td> </tr> <tr> <td>2. Tackdown</td> <td>1902</td> <td>12121</td> </tr> <tr> <td>3. Linework</td> <td>0020</td> <td>28151</td> </tr> </tbody> </table>	1. Barn Placement Stitch	1902	12121	2. Tackdown	1902	12121	3. Linework	0020	28151	<p><b>12498-09 Appliqué Car</b></p> <table border="0"> <tbody> <tr> <td>1. Car Placement Stitch</td> <td>5912</td> <td>18130</td> </tr> <tr> <td>2. Tackdown</td> <td>5912</td> <td>18130</td> </tr> <tr> <td>3. Linework</td> <td>0020</td> <td>28151</td> </tr> </tbody> </table>	1. Car Placement Stitch	5912	18130	2. Tackdown	5912	18130	3. Linework	0020	28151																														
1. Flower Placement Stitch	2830	16127																																																																					
2. Tackdown	2830	16127																																																																					
3. Top Leaf Placement Stitch	5934	18193																																																																					
4. Tackdown	5934	18193																																																																					
5. Bottom Leaf Placement Stitch	5643	18196																																																																					
6. Tackdown	5643	18196																																																																					
7. Linework	0020	28151																																																																					
1. Barn Placement Stitch	1902	12121																																																																					
2. Tackdown	1902	12121																																																																					
3. Linework	0020	28151																																																																					
1. Car Placement Stitch	5912	18130																																																																					
2. Tackdown	5912	18130																																																																					
3. Linework	0020	28151																																																																					
<p><b>12498-03 Appliqué Flowers</b></p> <table border="0"> <tbody> <tr> <td>1. Flower Placement Stitch</td> <td>3652</td> <td>14124</td> </tr> <tr> <td>2. Tackdown</td> <td>3652</td> <td>14124</td> </tr> <tr> <td>3. Top Leaf Placement Stitch</td> <td>5643</td> <td>18196</td> </tr> <tr> <td>4. Tackdown</td> <td>5643</td> <td>18196</td> </tr> <tr> <td>5. Bottom Leaf Placement Stitch</td> <td>5934</td> <td>18193</td> </tr> <tr> <td>6. Tackdown</td> <td>5934</td> <td>18193</td> </tr> <tr> <td>7. Linework</td> <td>0020</td> <td>28151</td> </tr> </tbody> </table>	1. Flower Placement Stitch	3652	14124	2. Tackdown	3652	14124	3. Top Leaf Placement Stitch	5643	18196	4. Tackdown	5643	18196	5. Bottom Leaf Placement Stitch	5934	18193	6. Tackdown	5934	18193	7. Linework	0020	28151	<p><b>12498-07 Appliqué Cityscape</b></p> <table border="0"> <tbody> <tr> <td>1. Purple Building Placement Stitch</td> <td>2830</td> <td>16127</td> </tr> <tr> <td>2. Tackdown</td> <td>2830</td> <td>16127</td> </tr> <tr> <td>3. Dark Green Building Placement Stitch</td> <td>5643</td> <td>18196</td> </tr> <tr> <td>4. Tackdown</td> <td>5643</td> <td>18196</td> </tr> <tr> <td>5. Green Building Placement Stitch</td> <td>5934</td> <td>18193</td> </tr> <tr> <td>6. Tackdown</td> <td>5934</td> <td>18193</td> </tr> <tr> <td>7. Yellow Building Placement Stitch</td> <td>0506</td> <td>22133</td> </tr> <tr> <td>8. Tackdown</td> <td>0506</td> <td>22133</td> </tr> <tr> <td>9. Linework</td> <td>0020</td> <td>28151</td> </tr> </tbody> </table>	1. Purple Building Placement Stitch	2830	16127	2. Tackdown	2830	16127	3. Dark Green Building Placement Stitch	5643	18196	4. Tackdown	5643	18196	5. Green Building Placement Stitch	5934	18193	6. Tackdown	5934	18193	7. Yellow Building Placement Stitch	0506	22133	8. Tackdown	0506	22133	9. Linework	0020	28151	<p><b>12498-10 Appliqué Train</b></p> <table border="0"> <tbody> <tr> <td>1. Engine Placement Stitch</td> <td>1701</td> <td>12103</td> </tr> <tr> <td>2. Tackdown</td> <td>1701</td> <td>12103</td> </tr> <tr> <td>3. Coal Car Placement Stitch</td> <td>4240</td> <td>14178</td> </tr> <tr> <td>4. Tackdown</td> <td>4240</td> <td>14178</td> </tr> <tr> <td>5. Caboose Placement Stitch</td> <td>1301</td> <td>24101</td> </tr> <tr> <td>6. Tackdown</td> <td>1301</td> <td>24101</td> </tr> <tr> <td>7. Linework</td> <td>0020</td> <td>28151</td> </tr> </tbody> </table>	1. Engine Placement Stitch	1701	12103	2. Tackdown	1701	12103	3. Coal Car Placement Stitch	4240	14178	4. Tackdown	4240	14178	5. Caboose Placement Stitch	1301	24101	6. Tackdown	1301	24101	7. Linework	0020	28151
1. Flower Placement Stitch	3652	14124																																																																					
2. Tackdown	3652	14124																																																																					
3. Top Leaf Placement Stitch	5643	18196																																																																					
4. Tackdown	5643	18196																																																																					
5. Bottom Leaf Placement Stitch	5934	18193																																																																					
6. Tackdown	5934	18193																																																																					
7. Linework	0020	28151																																																																					
1. Purple Building Placement Stitch	2830	16127																																																																					
2. Tackdown	2830	16127																																																																					
3. Dark Green Building Placement Stitch	5643	18196																																																																					
4. Tackdown	5643	18196																																																																					
5. Green Building Placement Stitch	5934	18193																																																																					
6. Tackdown	5934	18193																																																																					
7. Yellow Building Placement Stitch	0506	22133																																																																					
8. Tackdown	0506	22133																																																																					
9. Linework	0020	28151																																																																					
1. Engine Placement Stitch	1701	12103																																																																					
2. Tackdown	1701	12103																																																																					
3. Coal Car Placement Stitch	4240	14178																																																																					
4. Tackdown	4240	14178																																																																					
5. Caboose Placement Stitch	1301	24101																																																																					
6. Tackdown	1301	24101																																																																					
7. Linework	0020	28151																																																																					
<p><b>12498-04 Appliqué Tree</b></p> <table border="0"> <tbody> <tr> <td>1. Tree Placement Stitch</td> <td>5934</td> <td>18193</td> </tr> <tr> <td>2. Tackdown</td> <td>5934</td> <td>18193</td> </tr> <tr> <td>3. Linework</td> <td>0020</td> <td>28151</td> </tr> </tbody> </table>	1. Tree Placement Stitch	5934	18193	2. Tackdown	5934	18193	3. Linework	0020	28151																																																														
1. Tree Placement Stitch	5934	18193																																																																					
2. Tackdown	5934	18193																																																																					
3. Linework	0020	28151																																																																					

## Cut-in-Place Appliqué

1. Hoop your fabric and backing.
2. Sew the pattern/placement. **PHOTO 1**
3. Place a piece of appliqué fabric over the pattern/placement so that it is completely covered.
4. Sew the trim stitch/tackdown.
5. Carefully cut away the excess appliqué fabric. **PHOTO 2**
6. Sew the remainder of the design and repeat for any remaining pieces. **PHOTO 3**

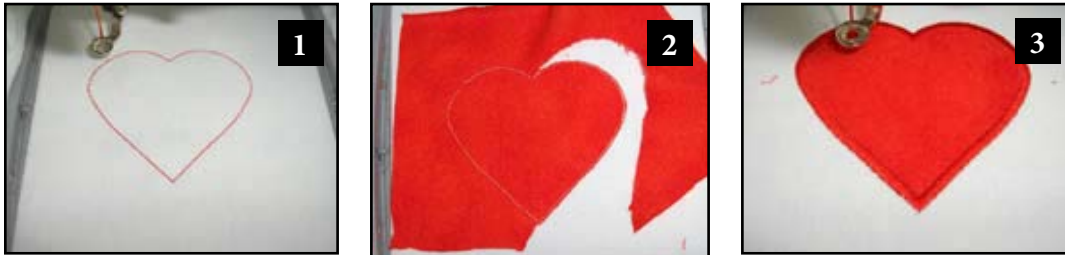

## Pre-Cut Appliqué

1. Print out the necessary pages from the PDF of the appliqué pattern(s).
2. Mark the right side of the pattern pieces so you'll know which direction to lay the pattern on the fabric.
3. Lightly spray the wrong side of the pattern pieces with temporary adhesive spray and allow it to set for a few minutes.
4. Place the pattern pieces on the right side of the fabric and carefully cut them out. **PHOTO 1**
5. Sew the placement stitch on your hooped fabric. **PHOTO 2**
6. With the paper still stuck to the right side of the appliqué fabric, spray the wrong side of the fabric with temporary spray adhesive.
7. Place the fabric inside the sewing placement stitch so that it matches the stitching line, and then remove the paper pattern. **PHOTO 3**
8. Sew the tackdown. **PHOTO 4**
9. Sew the remainder of the design and repeat for any remaining pieces. **PHOTO 5**

**NOTE: The patterns are sized for the designs as they were made. If you resize the design, you will need to resize the pattern the same amount. You can print out the pattern at the normal size then copy it on a copy machine at the changed size. For example, resize the designs to 80%, resize the printed pattern to 80%.**

**TIP: When Printing the patterns, make sure that the "Fit to page" option is UNCHECKED in the Print Dialog Box. If this option is checked the printed patterns will not be actual size.**

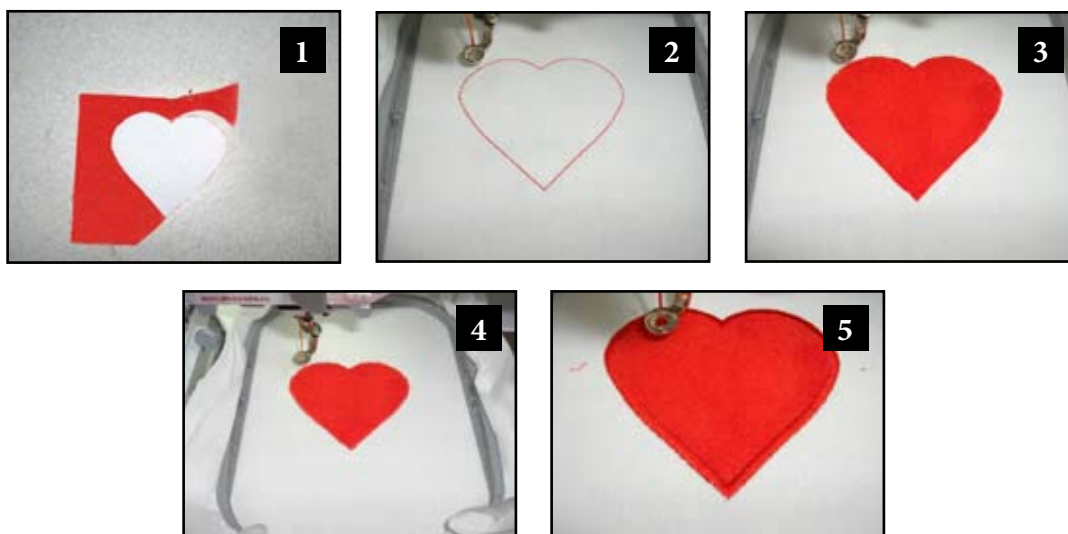

## ATTENTION

When printing this document, any page scaling or page fitting options in your print dialog box must be turned OFF or set to NONE so that your files will print out at their actual size. Images not printed at actual size will not function as intended.

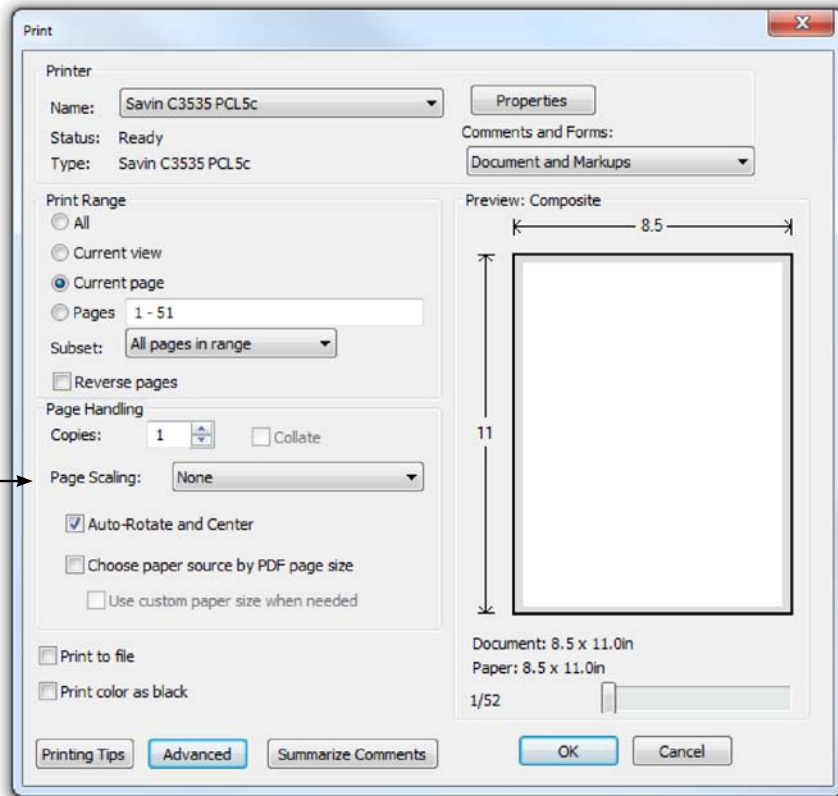

## TO SAVE PAPER

Only print the desired image by navigating to the image's page, go to File > Print and select "Current page" in the print dialog box. Repeat for each desired image.

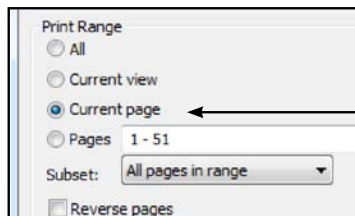

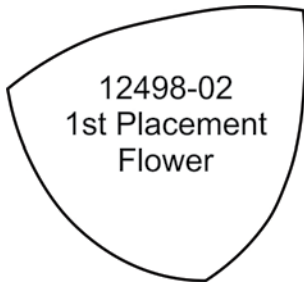

12498-02  
2nd Placement  
Left Leaf

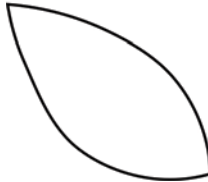

12498-02  
Last Placement  
Right Leaf



12498-03  
2nd Placement  
Left Leaf

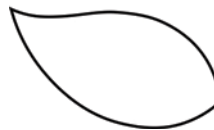

12498-03  
Last Placement  
Right Leaf



12498-05  
1st Placement  
Purple Flag

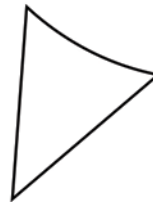

12498-05  
2nd Placement  
Yellow Flag

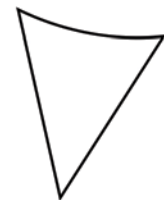

12498-05  
3rd Placement  
Green Flag



12498-05  
Last Placement  
Blue Flag

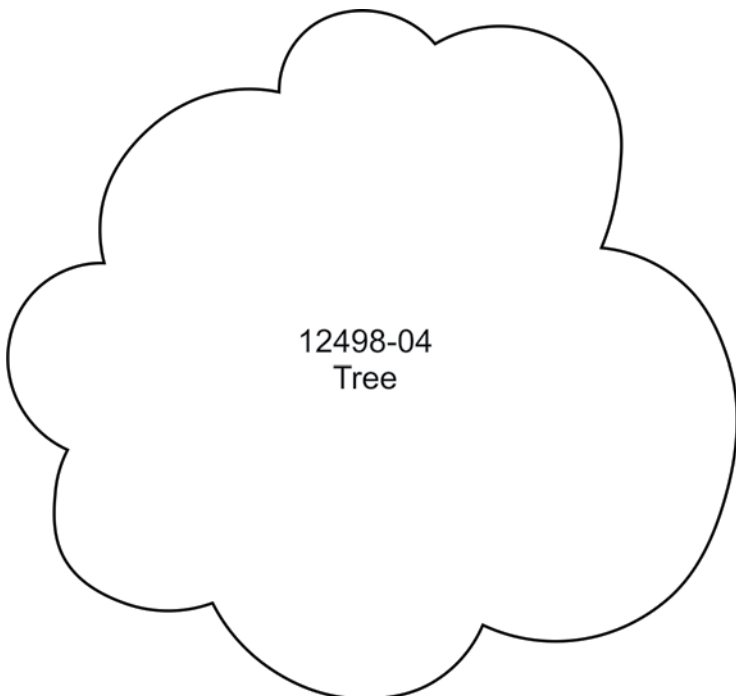
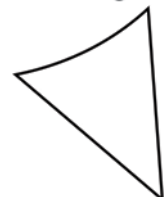

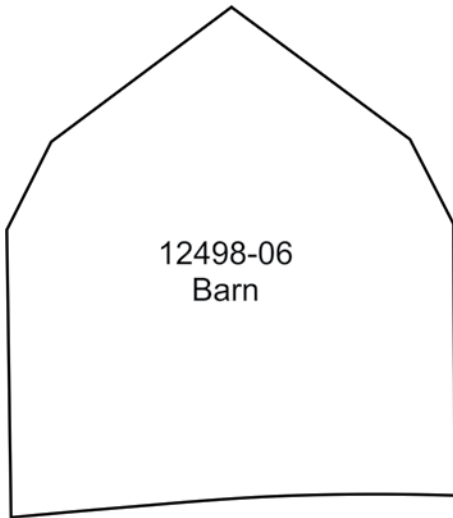

12498-07  
1st Placement  
Right Building

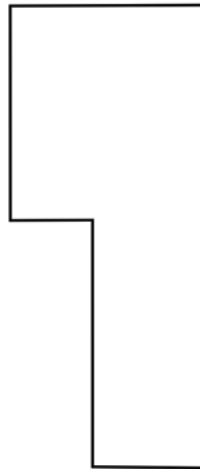

12498-07  
2nd Placement  
Middle Right Building

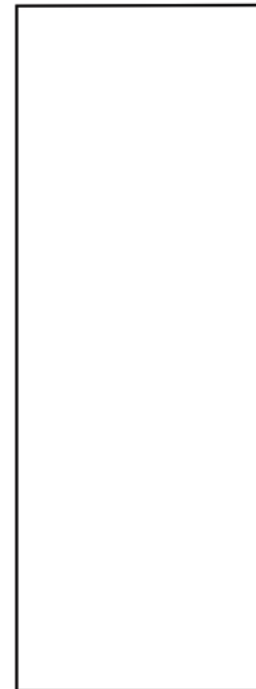

12498-07  
3rd Placement  
Middle Left Building



12498-07  
Last Placement  
Left Building

