



Note: Some designs in this collection may have been created using unique special stitches and/or techniques. To preserve design integrity when rescaling or rotating designs in your software, always rescale or rotate designs using the handles directly on-screen.



12554-01 Numeral 1
2.22 X 3.61 in.
56.39 X 91.69 mm
5,124 St. 



12554-02 Numeral 2
2.57 X 3.63 in.
65.28 X 92.20 mm
6,661 St. 



12554-03 Numeral 3
2.46 X 3.63 in.
62.48 X 92.20 mm
6,325 St. 



12554-04 Numeral 4
2.69 X 3.61 in.
68.33 X 91.69 mm
5,683 St. 



12554-05 Numeral 5
2.37 X 3.75 in.
60.20 X 95.25 mm
6,116 St. 



12554-06 Numeral 6
2.53 X 3.63 in.
64.26 X 92.20 mm
5,850 St. 



12554-07 Numeral 7
2.64 X 3.58 in.
67.06 X 90.93 mm
3,870 St. 



12554-08 Numeral 8
2.45 X 3.64 in.
62.23 X 92.46 mm
6,013 St. 



12554-09 Numeral 9
2.51 X 3.64 in.
63.75 X 92.46 mm
6,019 St. 



12554-10 Numeral 0
2.52 X 3.62 in.
64.01 X 91.95 mm
6,150 St. 

 Design contains a loose fill.

 Some solid areas shown are not stitched.

L Design is larger than 5" (127 mm) in either direction.

S Design is smaller than 1.5" (38.1 mm) in either direction.

It is a violation of Copyright law to make and distribute copies of electronic designs or artwork.

Electronic designs are licensed to the original purchaser for use at one location. ©2015 OESD, LLC. All rights reserved.



Ombre Numerals

#12554 / 10 Designs

Listings below indicate color sample, stitching order and suggested thread color number. Most numbers indicate Isacord thread. Colors beginning with 20501 refer to YLI Fine Metallics, 7 refer to Yenmet Metallic, 8 refer to YLI Variations Variegated Thread and 9 refer to Isacord Multicolor Variegated.

12554-01 Numeral 1

1. Tan Detail	0842
2. Brown Detail	1322
3. Plum Detail	2944
4. Number Outlines	2222

12554-05 Numeral 5

1. Tan Detail	0842
2. Brown Detail	1322
3. Plum Detail	2944
4. Number Outlines	2222

12554-08 Numeral 8

1. Tan Detail	0842
2. Brown Detail	1322
3. Plum Detail	2944
4. Number Outlines	2222

12554-02 Numeral 2

1. Tan Detail	0842
2. Brown Detail	1322
3. Plum Detail	2944
4. Number Outlines	2222

12554-06 Numeral 6

1. Tan Detail	0842
2. Brown Detail	1322
3. Plum Detail	2944
4. Number Outlines	2222

12554-09 Numeral 9

1. Tan Detail	0842
2. Brown Detail	1322
3. Plum Detail	2944
4. Number Outlines	2222

12554-03 Numeral 3

1. Tan Detail	0842
2. Brown Detail	1322
3. Plum Detail	2944
4. Number Outlines	2222

12554-07 Numeral 7

1. Tan Detail	0842
2. Brown Detail	1322
3. Plum Detail	2944
4. Number Outlines	2222

12554-10 Numeral 0

1. Tan Detail	0842
2. Brown Detail	1322
3. Plum Detail	2944
4. Number Outlines	2222

12554-04 Numeral 4

1. Tan Detail	0842
2. Brown Detail	1322
3. Plum Detail	2944
4. Number Outlines	2222

Isacord Thread Colors Used in “Ombre Numerals”
Collection #12554

0842 Toffee	2222 Burgundy
1322 Dirty penny	2944 Scrumptious plum

Create your own calendar for the New Year using the Ombre Numerals #12554 embroidery collection. Included is a 2015 calendar to print onto an iron-on transfer. It is a simple project to start the New Year.

Supplies

- OESD embroidery collection Ombre Numerals #12554
- 18" x 29" or ½ yd. off-white linen fabric
- ½" diameter dowel rod
- 2 dowel caps with ½" hole
- Iron-on Transfer paper
- Embroidery threads
- Medium Tear Away Stabilizer
- Temporary Spray Adhesive

Instructions

NOTE: Designs used in sample are #12554-01, #12554-02, #12554-10, and #12554-05. They are combined in embroidery software and stitched in the maxi hoop. The final size of the calendar is approximately 12" x 16 ¾".

- Using temporary spray adhesive, spray between two layers of medium tear away stabilizer and adhere to each other and to the wrong side of the off-white linen fabric leaving approximately 4" above the top of the numerals. Hoop the fabric and stabilizer. **PHOTO 1**
- Embroider the numerals. Remove hoop and the stabilizer.
- Trim the embroidered piece to 13" x 19", centering the numerals and leaving 3" from the top of the numerals. **PHOTO 2**
- Create a narrow hem on the long edges by folding and pressing ¼" and again ¼". Edgestitch. **PHOTO 3**
- To create the top rod pocket, fold and press ½" and then 1". Pin in place. Edgestitch. **PHOTO 4**
- To create the hem, fold and press ¼" and again ¼". Edgestitch. Press.
- Carefully follow manufacturer's directions, print the calendar onto an iron-on transfer.

NOTE: The calendar provided is already reversed.

- Measure ¾" from the bottom of the lower numbers of the calendar and cut off the blank iron-on transfer. Measure with a clear ruler ¾" from the bottom of the numerals and 1¾" from the sides to center and place the iron-on transfer. **PHOTO 5**
- Tape the calendar in place to move to the ironing board. Remove the tape. Press in place according to manufacturer's directions.
- Insert the dowel rod into the rod pocket. Add end caps to either end of the dowel rod.
- Hang and enjoy.

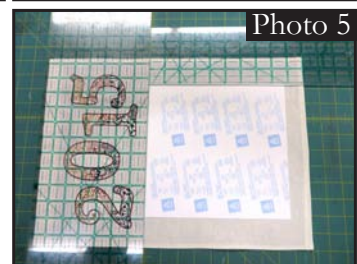
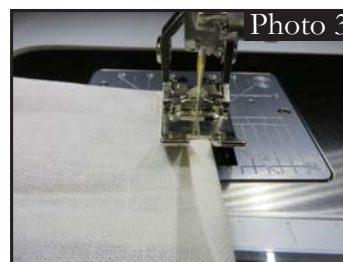

ATTENTION

When printing this document, any page scaling or page fitting options in your print dialog box must be turned OFF or set to NONE so that your files will print out at their actual size. Images not printed at actual size will not function as intended.

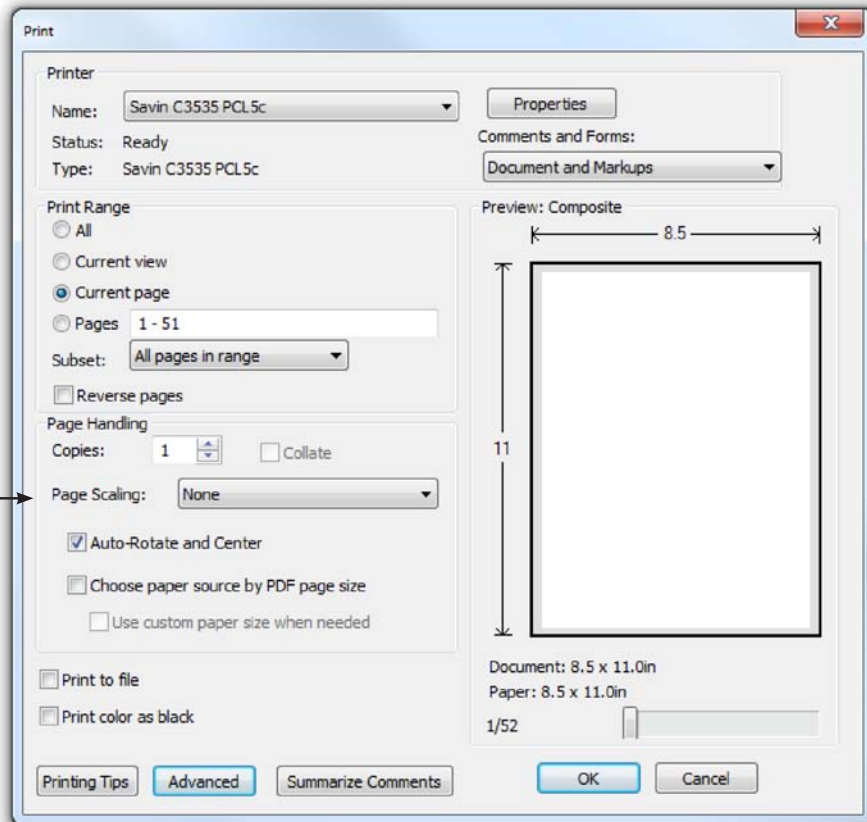

TO SAVE PAPER

Only print the desired image by navigating to the image's page, go to File > Print and select "Current page" in the print dialog box. Repeat for each desired image.

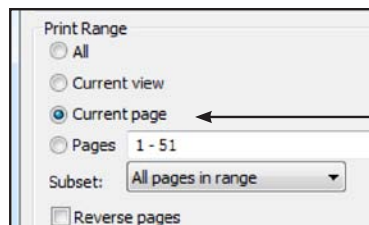

January

2u	Mo	Tu	We	Th	Fr	Sa
				1	2	3
4	5	6	7	8	9	10
11	12	13	14	15	16	17
18	19	20	21	22	23	24
25	26	27	28	29	30	31

February

2u	Mo	Tu	We	Th	Fr	Sa
1	2	3	4	5	6	7
8	9	10	11	12	13	14
15	16	17	18	19	20	21
22	23	24	25	26	27	28

March

2u	Mo	Tu	We	Th	Fr	Sa
1	2	3	4	5	6	7
8	9	10	11	12	13	14
15	16	17	18	19	20	21
22	23	24	25	26	27	28
29	30	31				

April

2u	Mo	Tu	We	Th	Fr	Sa
			1	2	3	4
5	6	7	8	9	10	11
12	13	14	15	16	17	18
19	20	21	22	23	24	25
26	27	28	29	30		

May

2u	Mo	Tu	We	Th	Fr	Sa
				1	2	3
4	5	6	7	8	9	10
11	12	13	14	15	16	17
18	19	20	21	22	23	24
25	26	27	28	29	30	31

June

2u	Mo	Tu	We	Th	Fr	Sa
			1	2	3	4
5	6	7	8	9	10	11
12	13	14	15	16	17	18
19	20	21	22	23	24	25
26	27	28	29	30		

July

2u	Mo	Tu	We	Th	Fr	Sa
			1	2	3	4
5	6	7	8	9	10	11
12	13	14	15	16	17	18
19	20	21	22	23	24	25
26	27	28	29	30	31	

August

2u	Mo	Tu	We	Th	Fr	Sa
				1	2	3
4	5	6	7	8	9	10
11	12	13	14	15	16	17
18	19	20	21	22	23	24
25	26	27	28	29	30	31

September

2u	Mo	Tu	We	Th	Fr	Sa
			1	2	3	4
5	6	7	8	9	10	11
12	13	14	15	16	17	18
19	20	21	22	23	24	25
26	27	28	29	30		

October

2u	Mo	Tu	We	Th	Fr	Sa
			1	2	3	4
5	6	7	8	9	10	11
12	13	14	15	16	17	18
19	20	21	22	23	24	25
26	27	28	29	30	31	

November

2u	Mo	Tu	We	Th	Fr	Sa
			1	2	3	4
5	6	7	8	9	10	11
12	13	14	15	16	17	18
19	20	21	22	23	24	25
26	27	28	29			

December

2u	Mo	Tu	We	Th	Fr	Sa
			1	2	3	4
5	6	7	8	9	10	11
12	13	14	15	16	17	18
19	20	21	22	23	24	25
26	27	28	29	30	31	