

Note: Some designs in this collection may have been created using unique special stitches and/or techniques. To preserve design integrity when rescaling or rotating designs in your software, always rescale or rotate designs using the handles directly on-screen.



**12556-01 Small Burlap Doll**  
 5.28 X 6.28 in.  
 134.11 X 159.51 mm  
 4,045 St. **L**



**12556-02 Large Burlap Doll Head & Body with Appliqué**  
 3.79 X 6.88 in.  
 96.27 X 174.75 mm  
 2,355 St. **L**



**12556-03 Large Burlap Doll Legs**  
 4.68 X 3.36 in.  
 118.87 X 85.34 mm  
 1,461 St.

**12556-04 Large Burlap Doll Arms**  
 4.19 X 2.98 in.  
 106.43 X 75.69 mm  
 1,318 St.

⌘ Design contains a loose fill.  
 ⚙ Some solid areas shown are not stitched.

**L** Design is larger than 5" (127 mm) in either direction.  
**S** Design is smaller than 1.5" (38.1 mm) in either direction.



# Burlap Pincushion Dolls

#12556 / 4 Files / 2 Dolls

Listings below indicate color sample, stitching order and suggested thread color number. Most numbers indicate Isacord thread. Colors beginning with 20501 refer to YLI Fine Metallics, 7 refer to Yenmet Metallic, 8 refer to YLI Variations Variegated Thread and 9 refer to Isacord Multicolor Variegated.

### 12556-01 Small Burlap Doll

■ 1. Doll Placement Stitch.....	0020
■ 2. Tackdown .....	0020
■ 3. Heart .....	1902
■ 4. Heart Detail .....	1805
■ 5. Mouth .....	0020
■ 6. Button Placement.....	0020
■ 7. Hair Tackdown.....	0020
■ 8. Seam.....	0020

### 12556-02 Large Burlap Doll Head & Body with Appliqué

■ 1. Head & Body Placement Stitch.....	0020
■ 2. Head & Body Tackdown .....	0020
■ 3. Heart Placement Stitch .....	1805
■ 4. Heart Tackdown & Detail .....	1805
■ 5. Mouth .....	0020
■ 6. Button Placement.....	0020
■ 7. Limb Centers & Attach Points .....	0020
■ 8. Hair Tackdown.....	0020
■ 9. Seam.....	0020

### 12556-03 Large Burlap Doll Legs

■ 1. Legs Placement Stitch .....	0020
■ 2. Tackdown .....	0020
■ 3. Legs Centers & Attach Points .....	0020
■ 4. Seam.....	0020

### 12556-04 Large Burlap Doll Arms

■ 1. Arms Placement Stitch.....	0020
■ 2. Tackdown .....	0020
■ 3. Arms Centers & Attach Points.....	0020
■ 4. Seam.....	0020

**Isacord Thread Colors Used in “Burlap Pincushion Dolls”**  
Collection #12556

0020 Black

1805 Strawberry

1902 Poinsettia

1. Print out the necessary pages from the PDF of the appliqué pattern(s).
2. Mark the right side of the pattern pieces so you'll know which direction to lay the pattern on the fabric.
3. Lightly spray the wrong side of the pattern pieces with temporary adhesive spray and allow it to set for a few minutes.
4. Place the pattern pieces on the right side of the fabric and carefully cut them out. **PHOTO 1**
5. Sew the placement stitch on your hooped fabric. **PHOTO 2**
6. With the paper still stuck to the right side of the appliqué fabric, spray the wrong side of the fabric with temporary spray adhesive.
7. Place the fabric inside the sewing placement stitch so that it matches the stitching line, and then remove the paper pattern. **PHOTO 3**
8. Sew the tackdown. **PHOTO 4**
9. Sew the remainder of the design and repeat for any remaining pieces. **PHOTO 5**

**NOTE: The patterns are sized for the designs as they were made. If you resize the design, you will need to resize the pattern the same amount. You can print out the pattern at the normal size then copy it on a copy machine at the changed size. For example, resize the designs to 80%, resize the printed pattern to 80%.**

**TIP: When Printing the patterns, make sure that the "Fit to page" option is UNCHECKED in the Print Dialog Box. If this option is checked the printed patterns will not be actual size.**

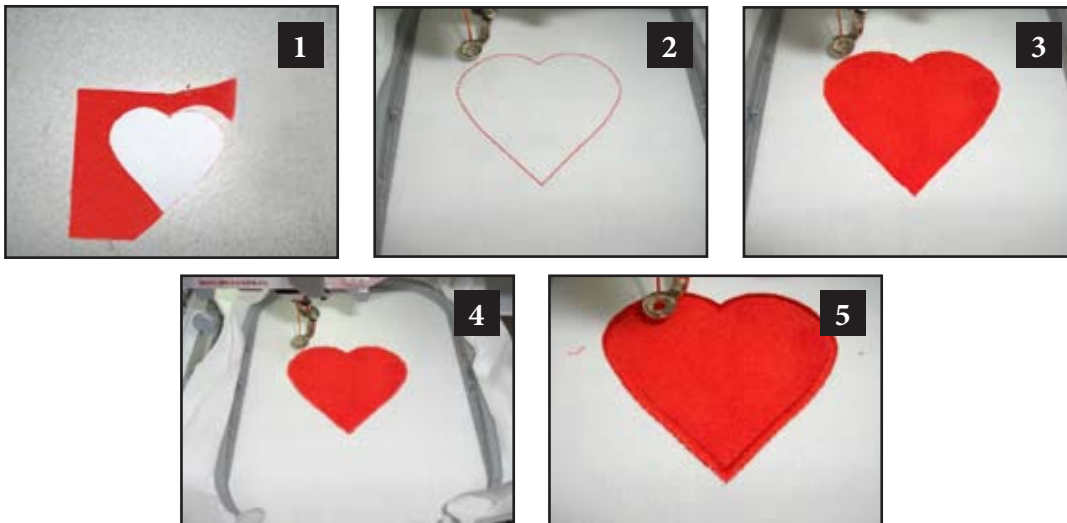

The Burlap Pincushion Dolls #12556 embroidery collection showcases two different sizes, one stitched completely in the hoop and the other which requires stitching together. Use burlap fabric for the front and cotton fabric for the back or use any type of fabric for the front and back. Be creative with the hair and button eyes. Any type of yarn can be used for the hair. The button eyes can be different colors, shapes and styles. Make several to give to your “crafting” friends.

### Supplies

- OESD embroidery collection Burlap Pincushion Dolls #12556
- Mesh wash away stabilizer
- Isacord embroidery thread
- Embroidery machine
- Polyester fiberfill
- Hand needle
- Fabrics and notions for Small Burlap Doll (#12556-01)
  - 6 ½" x 7" piece burlap (doll front)
  - 6 ½" x 7" piece fabric (doll back)
  - Yarn (hair)
  - 2 buttons (eyes)
- Fabrics and notions for Large Burlap Doll (#12556-02, #12556-03 & #12556-04)
  - 5 ½" x 8" piece burlap (doll front)
  - 5 ½" x 8" piece fabric (doll back)
  - (2) 5 ½" x 5" piece burlap (doll legs & arms front)
  - (2) 5 ½" x 5" piece fabric (doll legs & arms back)
  - 2 ½" sq. red felt (heart appliqué)
  - Yarn (hair)
  - 2 buttons (eyes)



**NOTE:** We recommend using fabric instead of burlap for the back of the doll because burlap is a loosely woven fabric and when slit will fray.

### Large Burlap Doll – Summary

Required Large Burlap Doll Head & Body w/ Appliqué #12556-02

Required Large Burlap Doll Legs #12556-03

Required Large Burlap Doll Arms #12556-04

### Small Burlap Pincushion Doll Instructions

- Hoop two layers of mesh wash away stabilizer.
- Stitch the first color called Placement Stitch. **PHOTO 1**
- Place Doll Front Fabric (6 ½" x 7") right side up onto the stabilizer, being sure to cover the Placement Stitch. Stitch the second color called Tackdown. **PHOTO 2**
- Stitch the Heart, Heart Detail, Mouth and Button Placement.
- Using yarn, wrap around end of fingers 10-12 times. Cut loops at one end and lay out. **PHOTOS 3 & 4**
- Tape the yarn with the cut ends even with the raw edge of the burlap in the center of the upper head. **PHOTO 5**

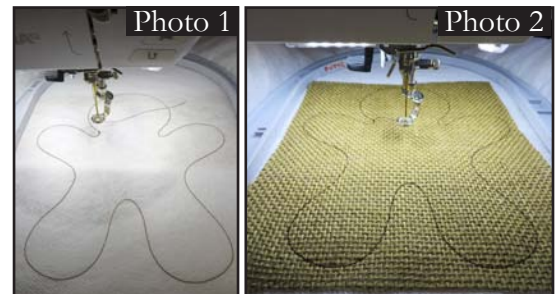

- Stitch the Hair Tackdown.
- Place the Doll Back Fabric (6 1/2" x 7") fabric right side down directly over the first piece. **PHOTO 6**
- Stitch the final color called Seam. **PHOTO 7**
- Remove the hoop from the machine and the fabric from the hoop.
- Carefully cut out the small doll close to the stitching line. Clip curves. **PHOTO 8**



**NOTE:** Use pinking shears if available.

- Cut a slit in the back of the project. **PHOTO 9**
- Turn the project right side out. Use a chopstick or point turner to turn out curves. Stuff with polyester fiberfill.



**NOTE:** For a smooth project, use small amounts of fiberfill instead of large pieces. The larger pieces appear lumpier. **PHOTO 10**

- Slip stitch the slit closed with hand needle and small stitches. **PHOTO 11**
- Handstitch or glue the buttons on for eyes over the Button Placement stitch. **PHOTO 12**



## Large Burlap Pincushion Doll Instructions

- Pre-cut the felt heart appliqué. Set aside.
- Load file Large Burlap Doll Head & Body w/ Appliqué #12556-02 design on your embroidery machine.
- Hoop two layers of mesh wash away stabilizer.
- Stitch the first color called Head and Body Placement Stitch. **PHOTO 13**
- Place Doll Front Fabric (5 1/2" x 8") right side up onto the stabilizer, being sure to cover the Placement Stitch. Stitch the second color called Head and Body Tackdown. **PHOTO 14**
- Stitch the next color called Heart Placement Stitch. Place pre-cut heart appliqué over Heart Placement Stitch. **PHOTO 15**
- Stitch the next color called Heart Tackdown and Detail.
- Stitch the Mouth, Button Placement, and Limb Centers and Attach Points.
- Using yarn, wrap around end of fingers 15-18 times. Cut loops at one end and lay out. **PHOTO 3 & 4**
- Tape the yarn with the cut ends even with the raw edge of the burlap in the center of the upper head. **PHOTO 16**
- Stitch the Hair Tackdown.
- Place the Doll Back Fabric (5 1/2" x 8") fabric right side down directly over the first piece. **PHOTO 17**

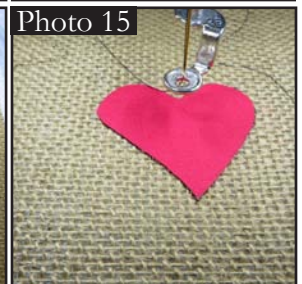

- Stitch the final color called Seam. **PHOTO 18**
- Remove the hoop from the machine and the fabric from the hoop.
- Using Large Burlap Doll Legs #12556-03 design file stitch using legs front and back fabrics.
- Using Large Burlap Doll Arms #12556-04 design file stitch using arms front and back fabrics.
- Carefully cut out the project close to the stitching line. Clip curves.

**NOTE:** Use pinking shears if available.

- Cut a slit in the back. The large burlap doll head and body with appliqué is shown. **PHOTO 19**
- Turn the project right side out. Use a chopstick or point turner to turn out curves. Stuff with polyester fiberfill.

**NOTE:** For a smooth project, use small amounts of fiberfill instead of large pieces. The larger pieces appear lumpier.

- Slip stitch the slit closed with hand needle and small stitches.
- Repeat with the arms and legs.
- Attach the legs, matching the legs centers and attach points of each leg to the bottom of the body.

**TIP:** To make the pieces easier to sew, squish the stuffing out of the area where the limb centers and attach points are.

- Place the pieces right sides together and bring needle through all the layers taking close stitches one way and then crisscrossing back over the stitches. Knot to secure. **PHOTO 20**
- Next attach the arms, matching the arms centers and attach points of each arm to either side of the body, following the same method of stitching.
- Handstitch or glue the buttons on for eyes over the Button Placement stitch. **PHOTO 21**
- Your doll is complete.



Photo 18



Photo 19



Photo 20



Photo 21

## ATTENTION

When printing this document, any page scaling or page fitting options in your print dialog box must be turned OFF or set to NONE so that your files will print out at their actual size. Images not printed at actual size will not function as intended.

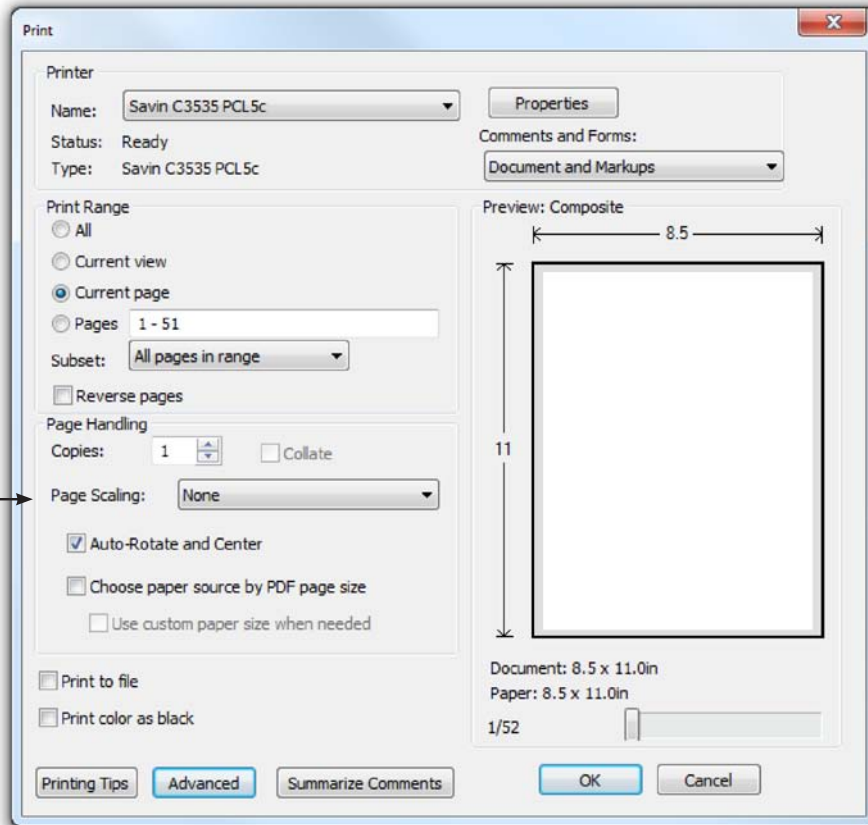

## TO SAVE PAPER

Only print the desired image by navigating to the image's page, go to File > Print and select "Current page" in the print dialog box. Repeat for each desired image.

