

Note: Some designs in this collection may have been created using unique special stitches and/or techniques. To preserve design integrity when rescaling or rotating designs in your software, always rescale or rotate designs using the handles directly on-screen.



12562-01 Springtime Flower Appliqué
4.58 X 6.68 in.
116.33 X 169.67 mm
10,184 St. **L**



12562-02 Springtime Butterfly Appliqué
4.83 X 5.71 in.
122.68 X 145.03 mm
10,951 St. **L**



12562-03 Springtime Tulip Appliqué
4.48 X 6.75 in.
113.79 X 171.45 mm
9,850 St. **L**



12562-04 Springtime Mushroom Appliqué
4.75 X 6.06 in.
120.65 X 153.92 mm
8,733 St. **L**



12562-05 Springtime Bird Appliqué
4.74 X 6.47 in.
120.40 X 164.34 mm
10,572 St. **S**



12562-06 Springtime Birdhouse Appliqué
4.63 X 6.77 in.
117.60 X 171.96 mm
9,216 St. **L**

S Design contains a loose fill.
S Some solid areas shown are not stitched.

L Design is larger than 5" (127 mm) in either direction.
S Design is smaller than 1.5" (38.1 mm) in either direction.

It is a violation of Copyright law to make and distribute copies of electronic designs or artwork.
Electronic designs are licensed to the original purchaser for use at one location. ©2015 OESD, LLC. All rights reserved.



Springtime Appliqués

#12562 / 6 Designs

Listings below indicate color sample, stitching order and suggested thread color number. Most numbers indicate Isacord thread. Colors beginning with 20501 refer to YLI Fine Metallics, 7 refer to Yenmet Metallic, 8 refer to YLI Variations Variegated Thread and 9 refer to Isacord Multicolor Variegated.

12562-01 Springtime Flower Appliqué

- 1. Right Leaf Placement Stitch..... 0015
- 2. Right Leaf Cut Line & Tackdown..... 0015
- 3. Left Leaf Placement Stitch..... 0015
- 4. Left Leaf Cut Line & Tackdown..... 0015
- 5. Bottom Left Petal Placement Stitch..... 0015
- 6. Bottom Left Petal Cut Line & Tackdown..... 0015
- 7. Bottom Right Petal Placement Stitch..... 0015
- 8. Bottom Right Petal Cut Line & Tackdown..... 0015
- 9. Top Left Petal Placement Stitch..... 0015
- 10. Top Left Petal Cut Line & Tackdown..... 0015
- 11. Top Right Petal Placement Stitch..... 0015
- 12. Top Right Petal Cut Line & Tackdown..... 0015
- 13. Left Stamen Placement Stitch..... 0015
- 14. Left Stamen Cut Line & Tackdown..... 0015
- 15. Right Stamen Placement..... 0015
- 16. Right Stamen Cut Line & Tackdown..... 0015
- 17. Cover Stitch..... 0015

12562-03 Springtime Tulip Appliqué

- 1. Left Leaf Bottom Placement Stitch..... 0015
- 2. Left Leaf Bottom Cut Line & Tackdown..... 0015
- 3. Left Leaf Top Placement Stitch..... 0015
- 4. Left Leaf Top Cut Line & Tackdown..... 0015
- 5. Right Leaf Placement Stitch..... 0015
- 6. Right Leaf Cut Line & Tackdown..... 0015
- 7. Left Petal Bottom Placement Stitch..... 0015
- 8. Left Petal Bottom Cut Line & Tackdown..... 0015
- 9. Left Petal Top Placement Stitch..... 0015
- 10. Left Petal Top Cut Line & Tackdown..... 0015
- 11. Right Petal Bottom Placement Stitch..... 0015
- 12. Right Petal Bottom Cut Line & Tackdown..... 0015
- 13. Right Petal Top Placement Stitch..... 0015
- 14. Right Petal Top Cut Line & Tackdown..... 0015
- 15. Center Petal Placement Stitch..... 0015
- 16. Center Petal Cut Line & Tackdown..... 0015
- 17. Cover Stitch..... 0015

12562-05 Springtime Bird Appliqué

- 1. Bottom Leaf Placement Stitch..... 0015
- 2. Bottom Leaf Cut Line & Tackdown..... 0015
- 3. Top Leaf Placement Stitch..... 0015
- 4. Top Leaf Cut Line & Tackdown..... 0015
- 5. Stem Placement Stitch..... 0015
- 6. Stem Cut Line & Tackdown..... 0015
- 7. Flower Placement Stitch..... 0015
- 8. Flower Cut Line & Tackdown..... 0015
- 9. Bird Body Placement Stitch..... 0015
- 10. Bird Body Cut Line & Tackdown..... 0015
- 11. Tail Placement Stitch..... 0015
- 12. Tail Cut Line & Tackdown..... 0015
- 13. Head Placement Stitch..... 0015
- 14. Head Cut Line & Tackdown..... 0015
- 15. Wing Placement Stitch..... 0015
- 16. Wing Cut Line & Tackdown..... 0015
- 17. Cover Stitch..... 0015

12562-02 Springtime Butterfly Appliqué

- 1. Bottom Wings Lower Placement Stitch..... 0015
- 2. Bottom Wings Lower Cut Line & Tackdown..... 0015
- 3. Bottom Wings Middle Placement Stitch..... 0015
- 4. Bottom Wings Middle Cut Line & Tackdown..... 0015
- 5. Top Wings Upper Placement Stitch..... 0015
- 6. Top Wings Upper Cut Line & Tackdown..... 0015
- 7. Top Wings Middle Placement Stitch..... 0015
- 8. Top Wings Middle Cut Line & Tackdown..... 0015
- 9. Body Placement Stitch..... 0015
- 10. Body Cut Line & Tackdown..... 0015
- 11. Cover Stitch..... 0015

12562-04 Springtime Mushroom Appliqué

- 1. Stem Bottom Placement Stitch..... 0015
- 2. Stem Bottom Cut Line & Tackdown..... 0015
- 3. Stem Top Placement Stitch..... 0015
- 4. Stem Top Cut Line & Tackdown..... 0015
- 5. Mushroom Placement Stitch..... 0015
- 6. Mushroom Cut Line & Tackdown..... 0015
- 7. Bottom Spot Placement Stitch..... 0015
- 8. Bottom Spot Cut Line & Tackdown..... 0015
- 9. Middle Spot Placement Stitch..... 0015
- 10. Middle Spot Cut Line & Tackdown..... 0015
- 11. Top Spot Placement Stitch..... 0015
- 12. Top Spot Cut Line & Tackdown..... 0015
- 13. Cover Stitch..... 0015

12562-06 Springtime Birdhouse Appliqué

- 1. House Bottom Placement Stitch..... 0015
- 2. House Bottom Cut Line & Tackdown..... 0015
- 3. House Lower Middle Placement Stitch..... 0015
- 4. House Lower Middle Cut Line & Tackdown..... 0015
- 5. House Upper Middle Placement Stitch..... 0015
- 6. House Upper Middle Cut Line & Tackdown..... 0015
- 7. House Top Placement Stitch..... 0015
- 8. House Top Cut Line & Tackdown..... 0015
- 9. Roof Placement..... 0015
- 10. Roof Cut Line & Tackdown..... 0015
- 11. Hole Placement Stitch..... 0015
- 12. Hole Cut Line & Tackdown..... 0015
- 13. Cover Stitch..... 0015

Note: Optional buttons can be sewn on by hand or machine.

1. Print out the necessary pages from the PDF of the appliqué pattern(s).
2. Mark the right side of the pattern pieces so you'll know which direction to lay the pattern on the fabric.
3. Lightly spray the wrong side of the pattern pieces with temporary adhesive spray and allow it to set for a few minutes.
4. Place the pattern pieces on the right side of the fabric and carefully cut them out. **PHOTO 1**
5. Sew the placement stitch on your hooped fabric. **PHOTO 2**
6. With the paper still stuck to the right side of the appliqué fabric, spray the wrong side of the fabric with temporary spray adhesive.
7. Place the fabric inside the sewing placement stitch so that it matches the stitching line, and then remove the paper pattern. **PHOTO 3**
8. Sew the tackdown. **PHOTO 4**
9. Sew the remainder of the design and repeat for any remaining pieces. **PHOTO 5**

NOTE: The patterns are sized for the designs as they were made. If you resize the design, you will need to resize the pattern the same amount. You can print out the pattern at the normal size then copy it on a copy machine at the changed size. For example, resize the designs to 80%, resize the printed pattern to 80%.

TIP: When Printing the patterns, make sure that the "Fit to page" option is **UNCHECKED** in the Print Dialog Box. If this option is checked the printed patterns will not be actual size.

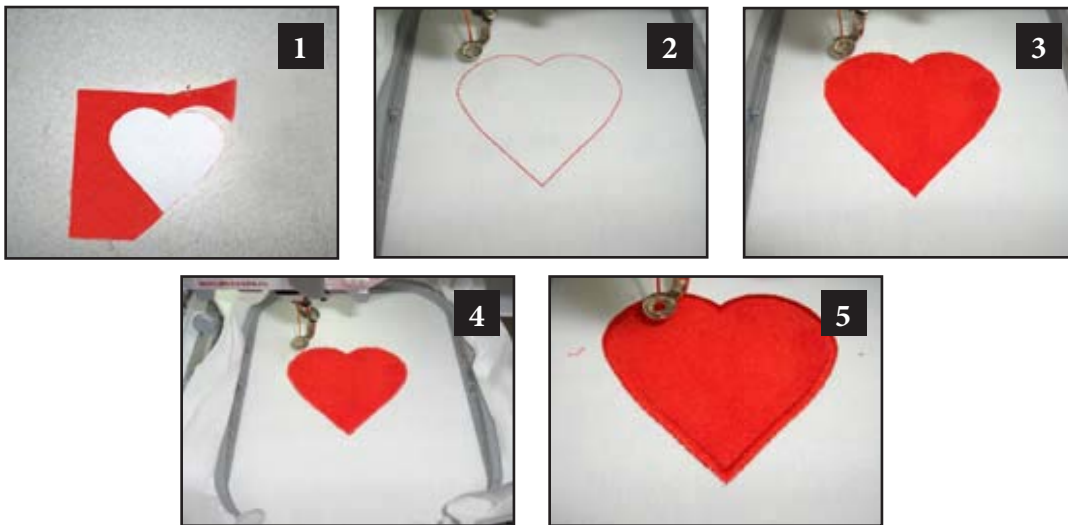

ATTENTION

When printing this document, any page scaling or page fitting options in your print dialog box must be turned OFF or set to NONE so that your files will print out at their actual size. Images not printed at actual size will not function as intended.

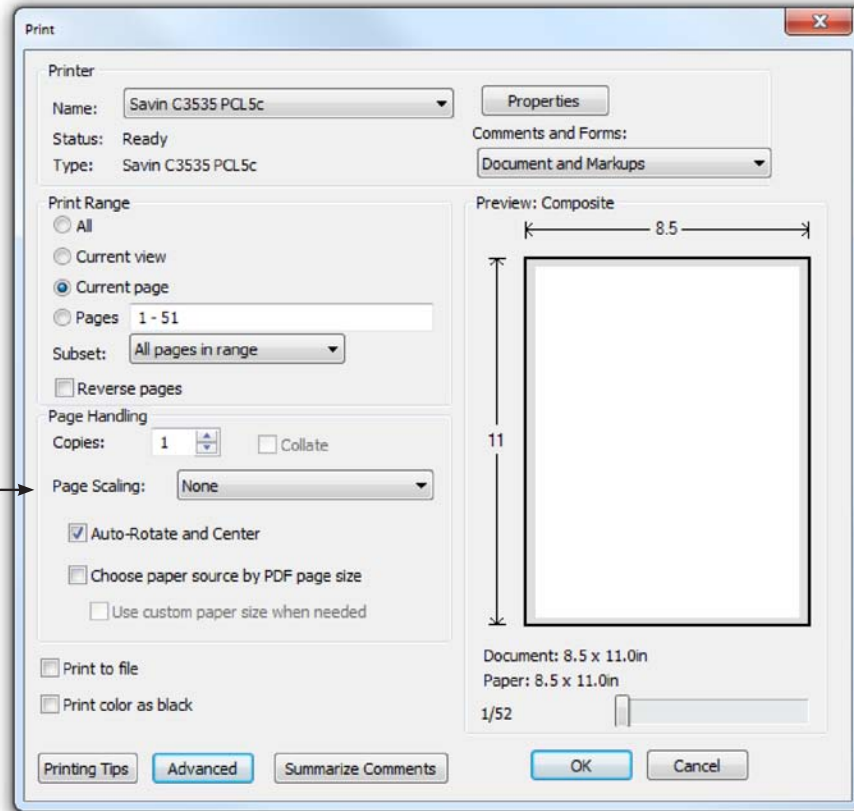

TO SAVE PAPER

Only print the desired image by navigating to the image's page, go to File > Print and select "Current page" in the print dialog box. Repeat for each desired image.

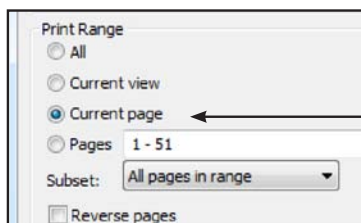

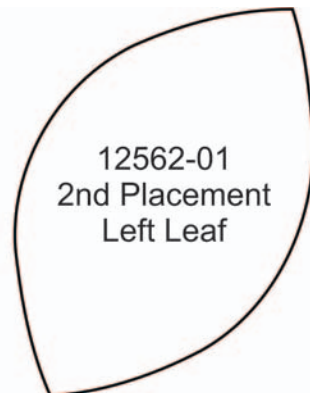
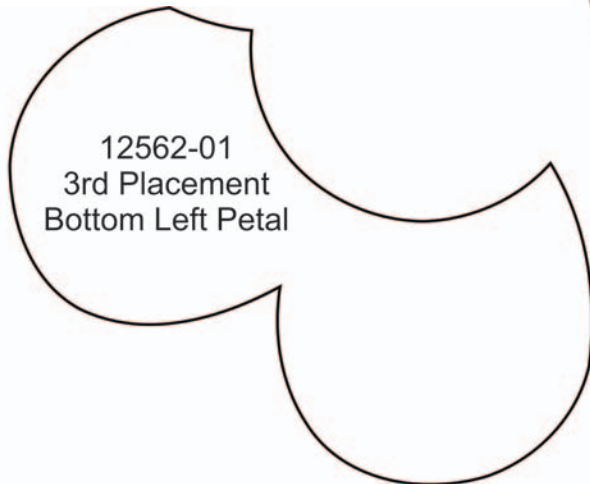
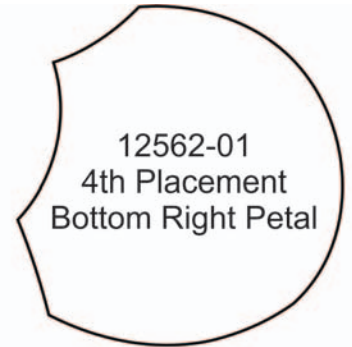
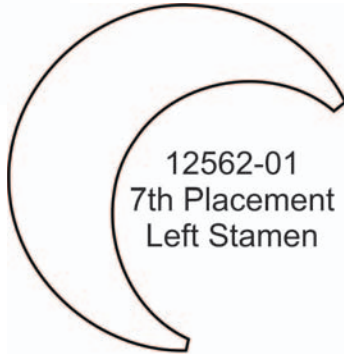
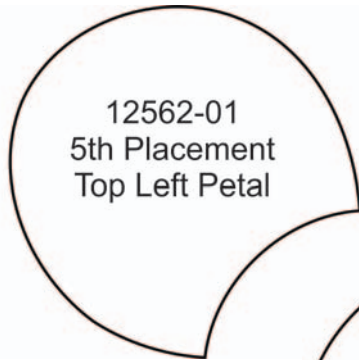



12562-02
Last Placement
Body

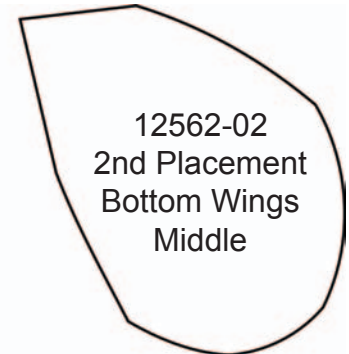
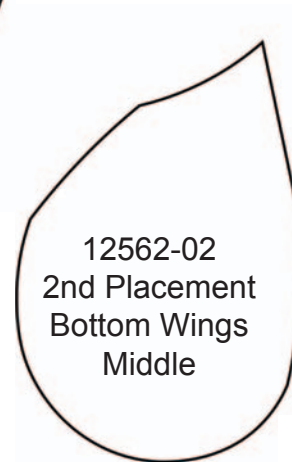
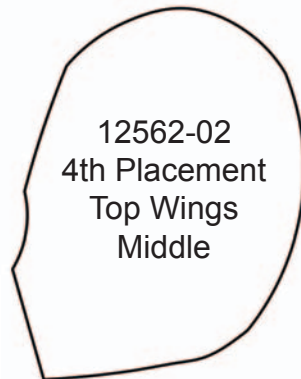

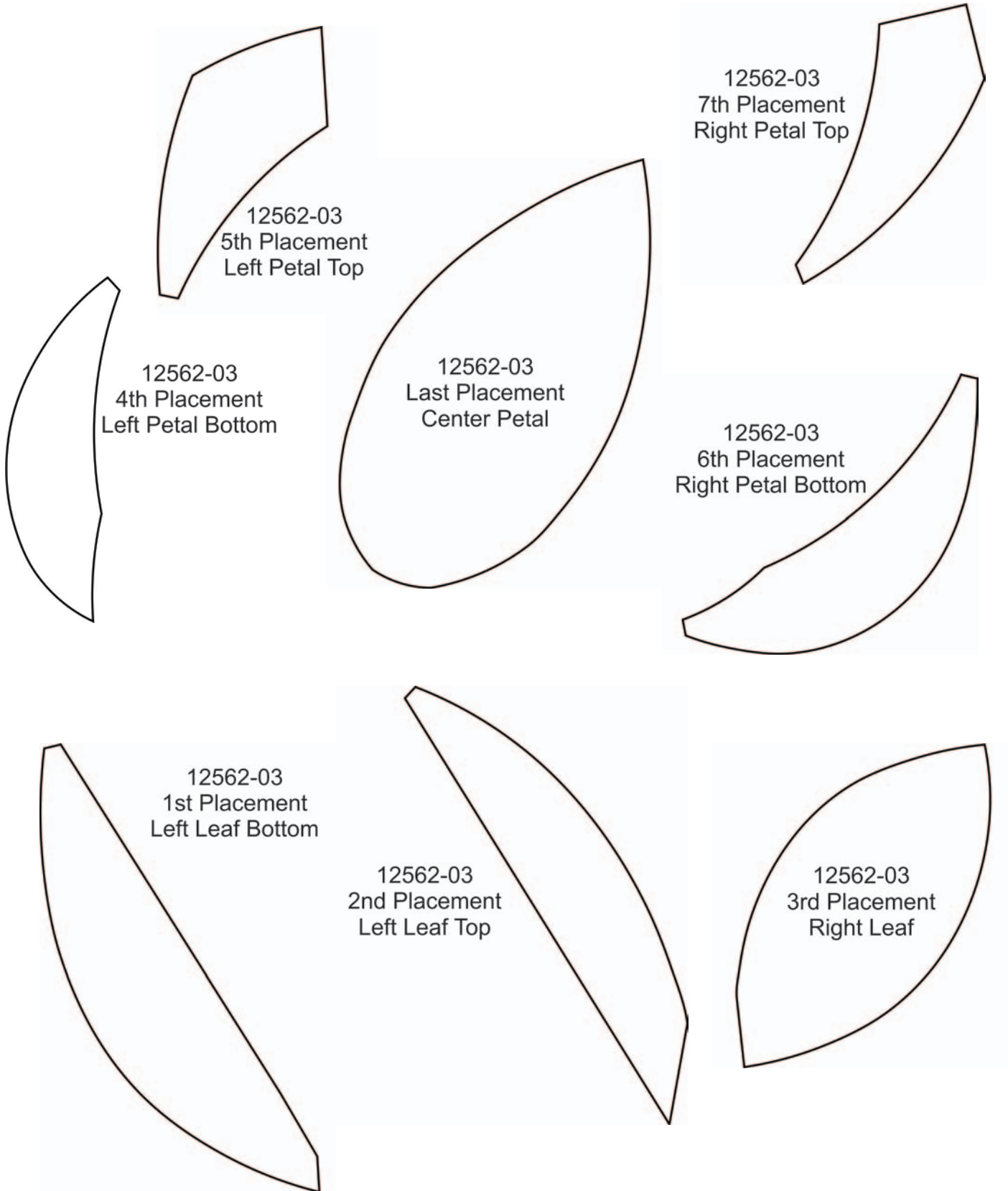

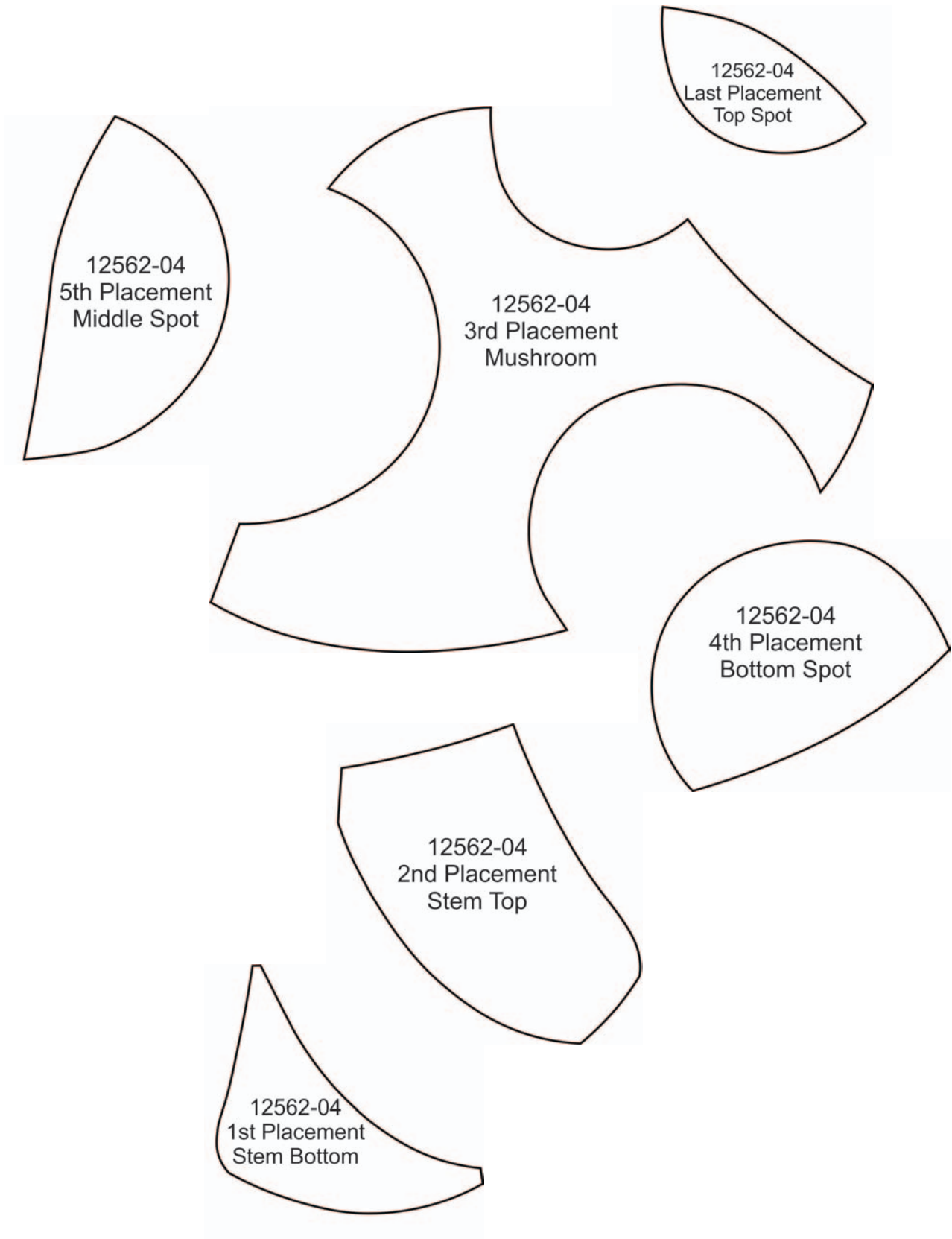

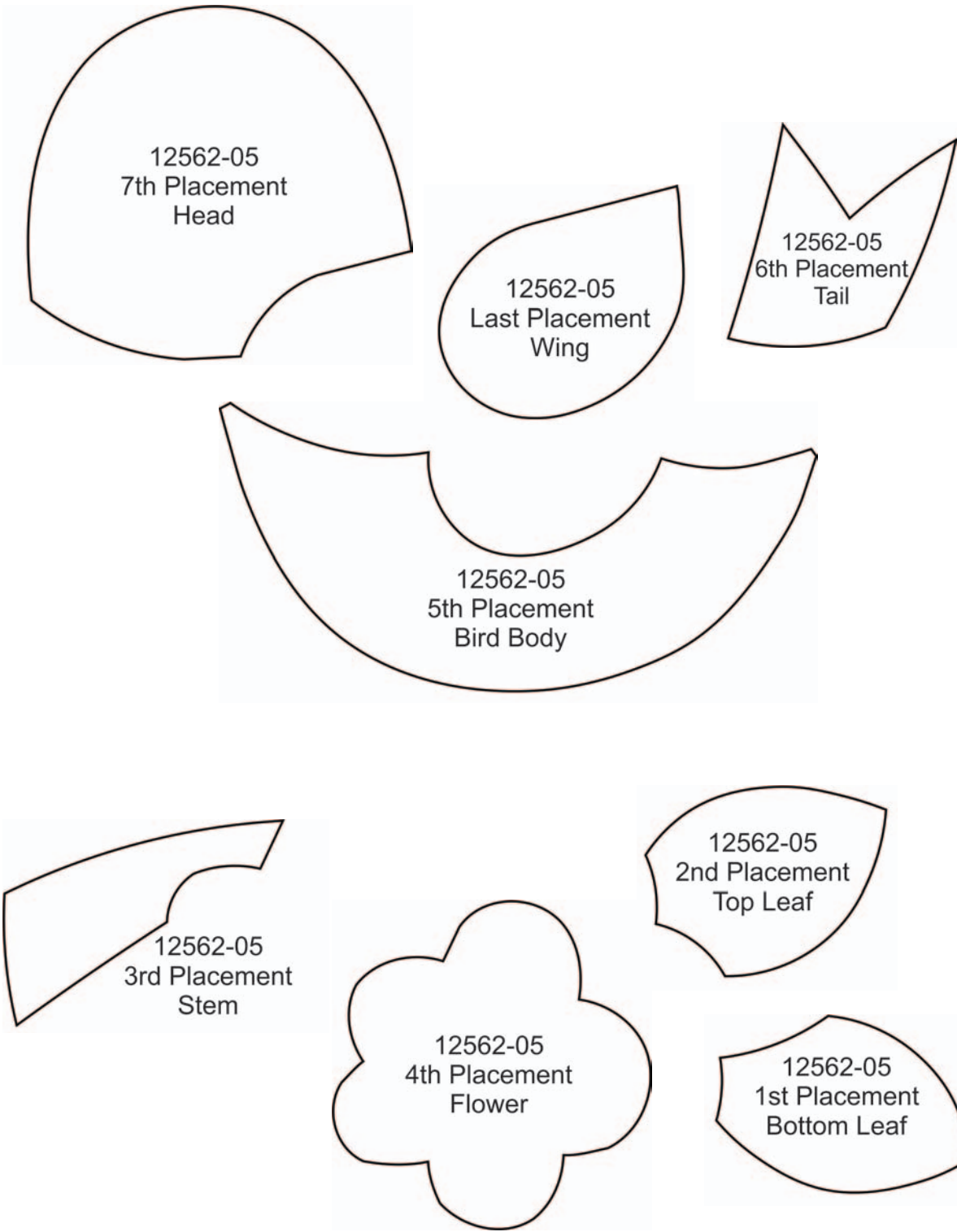

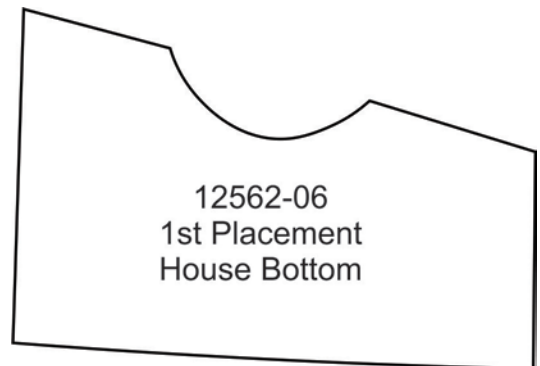
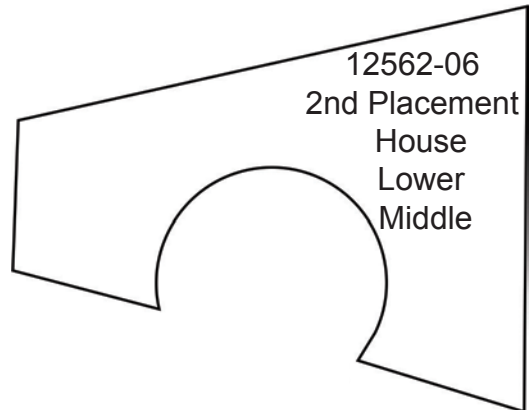
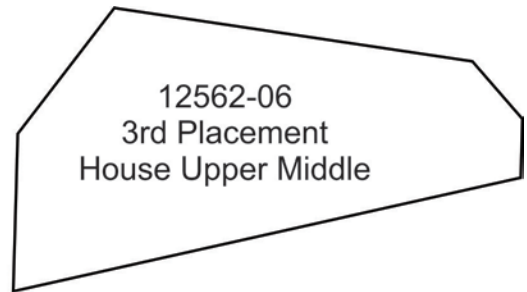
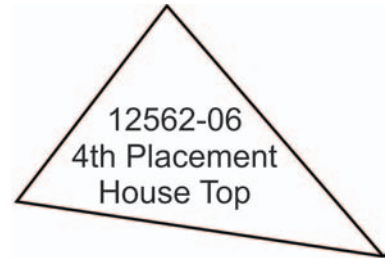
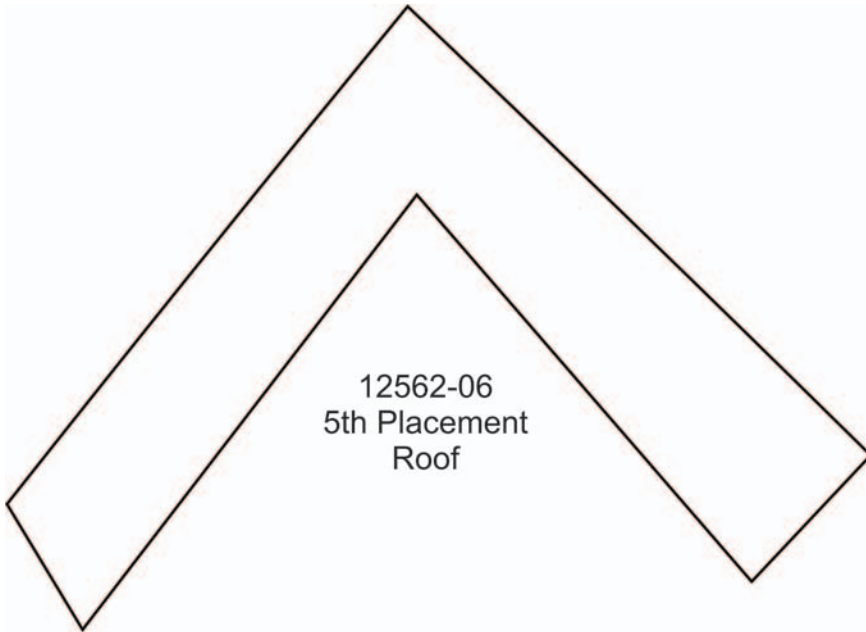

Springtime Appliqués #12562 embroidery collection features 6 spring appliqué designs. This small collection of two different flowers, a butterfly, a mushroom, a birdhouse and a bird feature a simple appliqué technique. Use bright and colorful spring fabrics to add pizzazz. These are so quick you will use them time after time with different fabrics. Stitch out the designs for one project or for several projects.

Supplies

- OESD embroidery collection Springtime Appliqués #12562
- 2/3 yd. gold fabric (embroidered blocks)
- 1/2 yd. pink fabric (wide border)
- 1/4 yd. green fabric (trim border)
- Assorted fabrics for appliqué pieces
- 2/3 yd. fabric (backing) (sample uses pink fabric)
- 1/4 yd. fabric (binding) OR 1/2 yd. fabric (bias binding)(sample uses bias plaid binding)
- 2/3 yd. or 24" x 27" piece cotton batting
- Isacord embroidery threads
- Medium weight tear away stabilizer
- Temporary spray adhesive
- curved safety pins
- thread for piecing



Cut

- (6) 10" x 14" gold fabric (embroidered blocks)
- (7) 2" strips pink fabric (wide border)
- (8) 1" strips green fabric (trim border)
- (1) 24" x 27" fabric (back)
- (1) 24" x 27" cotton batting
- (3) 2" strips fabric (binding) (If cutting bias, make enough strips to equal approx. 102")

Embroider

Note: There are multiple appliqués in each design. Stitch out each of the designs from the Springtime Appliqués #12562 embroidery collection.

- Cut tear away stabilizer big enough to fit your hoop. Using temporary spray adhesive, spray between two pieces of tear away stabilizer and adhere to each other and to the wrong side of the gold fabric. Hoop the layers. Embroider one of the appliqué designs. Remove from hoop and remove stabilizer. Repeat for the remaining appliqué designs.



Assembly

1/4" seam allowance

- Cut the appliqué embroidered blocks to measure 7" x 9". Arrange the embroidered blocks in the order you want them placed in the wall décor. **PHOTO 1**
- Wrong sides together, fold in half and press the trim border pieces.
- Right sides together and raw edges even, pin the wide border and trim border to one long side of the embroidered block with the trim border in between the wide border and embroidered block. **PHOTO 2**



- Stitch. Press so the trim border lies on the wide border. **PHOTO 3**
- Continue adding the wide border and trim border in the same manner with three of the embroidered blocks. **PHOTO 4**
- To create a row: Right sides together and raw edges even, pin and stitch the first row by stitching the embroidered block with borders along the side of the next embroidered block without a border and adding the trim border in between the wide border and embroidered block. Press so the trim border lies on the wide border. Right sides together and raw edges even, pin and stitch the two block section to the last embroidered block along the side and adding the trim border in between the wide border and embroidered block. Press so the trim lies on the wide border. **PHOTO 5**
- Repeat for the second row. **PHOTO 6**
- Right sides together and raw edges even, pin and stitch the first row and second row together by stitching a wide border to the bottom of the first row and adding the trim border in between the wide border and first row. Press so the trim border lies on the wide border. Right sides together and raw edges even, pin and stitch the bottom of the wide border to the top of the second row and adding the trim border in between the wide border and second row. Press so the trim lies on the wide border. **PHOTO 7**
- Right sides together and raw edges even, pin and stitch the wide border and trim border to either side of the wall décor with the trim border in between the wide border and the wall décor. Press so the trim border lies on the wide border. **PHOTO 8**
- Right sides together and raw edges even, pin and stitch the wide border and trim border to the top and bottom of the wall décor with the trim border in between the wide border and the wall décor. Press so the trim border lies on the wide border. **PHOTO 9**
- Layer a quilt sandwich, by placing back wrong side up, cotton batting, and the wall décor top right side up. Use curved safety pins to baste the layers together. **PHOTO 10**
- Quilt as desired. Our sample features free-motion quilting around each of the designs and in the borders. **PHOTO 11**
- Square up the quilt, this is trimming the quilt until the sides are equal. This prepares the quilt for stitching on the binding. **PHOTO 12**
- Stitch on the binding as desired. For stitching on the binding the mitered corner technique was used. **PHOTO 12**

