

Note: Some designs in this collection may have been created using unique special stitches and/or techniques. To preserve design integrity when rescaling or rotating designs in your software, always rescale or rotate designs using the handles directly on-screen.

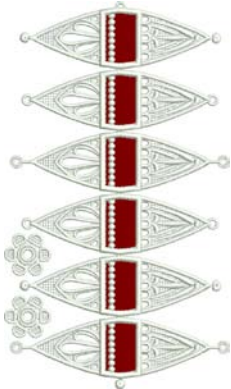

12588-01 3D Ball Ornament FSA
5.03 X 8.66 in.
127.76 X 219.96 mm
49,468 St. **☞☺ L**

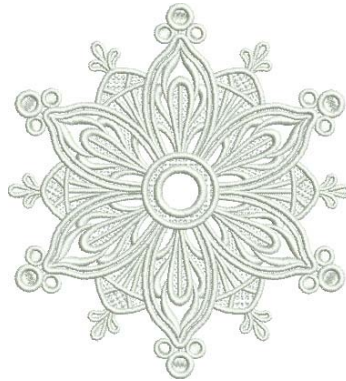

12588-02 Loopy Ornament Center 1 FSL
3.95 X 4.31 in.
100.33 X 109.47 mm
29,808 St. **☞☺**



12588-03 Loopy Ornament Center 2 FSL
3.50 X 3.50 in.
88.90 X 88.90 mm
27,236 St. **☞☺**



12588-04 Loopy Ornament Ribbon FSL
1.02 X 7.46 in.
25.91 X 189.48 mm
22,378 St. **☞☺ L S**



12588-05 Ball Ornament 1 FSA
4.02 X 4.83 in.
102.11 X 122.68 mm
34,220 St. **☞☺**



12588-06 Ball Ornament 2 FSA
3.19 X 3.85 in.
81.03 X 97.79 mm
16,803 St. **☞☺**



12588-07 Bauble Ornament 1 FSA
2.71 X 6.13 in.
68.83 X 155.70 mm
18,920 St. **☞☺ L**



12588-08 Bauble Ornament 2 FSL
2.81 X 4.08 in.
71.37 X 103.63 mm
17,516 St. **☞☺**



12588-09 Bauble Ornament 3 FSA
3.32 X 5.16 in.
84.33 X 131.06 mm
20,269 St. **☞☺ L**



12588-10 Candy Cane FSA
3.73 X 5.79 in.
94.74 X 147.07 mm
23,523 St. **☞☺ L**



12588-11 Snowflake Ornament FSL
4.26 X 5.28 in.
108.20 X 134.11 mm
34,654 St. **☞☺ L**



12588-12 Stocking Ornament FSA
3.25 X 6.29 in.
82.55 X 159.77 mm
19,851 St. **☞☺ L**

☞ Design contains a loose fill.

☺ Some solid areas shown are not stitched.

L Design is larger than 5" (127 mm) in either direction.

S Design is smaller than 1.5" (38.1 mm) in either direction.

It is a violation of Copyright law to make and distribute copies of electronic designs or artwork.

Electronic designs are licensed to the original purchaser for use at one location. ©2015 OESD, LLC. All rights reserved.

Note: Some designs in this collection may have been created using unique special stitches and/or techniques. To preserve design integrity when rescaling or rotating designs in your software, always rescale or rotate designs using the handles directly on-screen.



12588-13 Star Ornament FSA

4.16 X 4.41 in.
105.66 X 112.01 mm
21,733 St.



12588-14 Frame 1 FSA

6.61 X 6.98 in.
167.89 X 177.29 mm
53,042 St. L



12588-15 Frame 2 FSA

7.01 X 7.30 in.
178.05 X 185.42 mm
31,793 St. L



12588-16 Ball Ornament Wrap FSL

2.71 X 6.87 in.
68.83 X 174.50 mm
27,863 St. L

Listings below indicate color sample, stitching order and suggested thread color number. Most numbers indicate Isacord thread. Colors beginning with 20501 refer to YLI Fine Metallics, 7 refer to Yenmet Metallic, 8 refer to YLI Variations Variegated Thread and 9 refer to Isacord Multicolor Variegated.

12588-01 3D Ball Ornament FSA

- 1. Placement Stitch0101
- 2. Cut Line & Tackdown0101
- 3. Lace0101
- 4. Lace Toppers.....0101

12588-02 Loopy Ornament Center 1 FSL

- 1. Single Color Design0101

12588-03 Loopy Ornament Center 2 FSL

- 1. Single Color Design0101

12588-04 Loop Ornament Ribbon FSL

- 1. Single Color Design0101

12588-05 Ball Ornament 1 FSA

- 1. Placement Stitch0101
- 2. Cut Line & Tackdown0101
- 3. Lace0101

12588-06 Ball Ornament 2 FSA

- 1. Placement Stitch0101
- 2. Cut Line & Tackdown0101
- 3. Lace0101

12588-07 Bauble Ornament 1 FSA

- 1. Placement Stitch0101
- 2. Cut Line & Tackdown0101
- 3. Lace0101

12588-08 Bauble Ornament 2 FSL

- 1. Single Color Design0101

12588-09 Bauble Ornament 3 FSA

- 1. Placement Stitch0101
- 2. Cut Line & Tackdown0101
- 3. Lace0101

12588-10 Candy Cane FSA

- 1. Placement Stitch0101
- 2. Cut Line & Tackdown0101
- 3. Ribbon Placement Stitch.....0101
- 4. Cut Line & Tackdown0101
- 5. Lace0101
- 6. Hanger0101

12588-11 Snowflake Ornament FSL

- 1. Lace0101
- 2. Hanger0101

12588-12 Stocking Ornament FSA

- 1. Cuff, Heel & Toe Placement Stitch0101
- 2. Cut Line & Tackdown0101
- 3. Stripe Placement Stitch.....0101
- 4. Cut Line & Tackdown0101
- 5. Lace0101
- 6. Hanger0101

12588-13 Star Ornament FSA

- 1. Placement Stitch0101
- 2. Cut Line & Tackdown0101
- 3. Lace0101
- 4. Hanger0101

12588-14 Frame 1 FSA

- 1. Placement Stitch0101
- 2. Cut Line & Tackdown0101
- 3. Lace0101

12588-15 Frame 2 FSA

- 1. Placement Stitch0101
- 2. Cut Line & Tackdown0101
- 3. Lace0101

12588-16 Ball Ornament Wrap FSL

- 1. Single Color Design0101

Design contains a loose fill.
 Some solid areas shown are not stitched.

L Design is larger than 5" (127 mm) in either direction.
S Design is smaller than 1.5" (38.1 mm) in either direction.

General Freestanding Lace Guidelines

Supplies:

Embroidery Thread:

- Use the same embroidery thread in the bobbin as the needle.

Needles:

- Use an Organ 80/12 Titanium needle for extended needle life.

Stabilizer:

- Use water-soluble stabilizer or film water-soluble stabilizer.

Handy Hints:

For Stiffer Lace:

- DO NOT rinse away all of the stabilizer for a “stiffer” lace. Note that the thread may appear a shade darker if stabilizer is not removed completely.
- If you happen to wash too much out, easily re-stiffen by diluting some stabilizer scraps in water and dipping the item in the solution.

For Very Soft Lace:

- Cut away excess stabilizer. Remove remaining stabilizer by rinsing under warm running water until all traces of the stabilizer are gone. **Note:** If lace should become too limp to work with, dissolve stabilizer scraps in warm water and apply to the lace.

General Instructions

1. Hoop two layers of water-soluble stabilizer.
2. Attach the hoop to the machine and select the design of your choice.
3. Stitch the design.
4. Remove the hoop from the machine and the design from the hoop. Trim excess stabilizer from the design.
5. Rinse away remaining stabilizer and allow it to dry.

Drying Lace:

- The lace looks best when left to dry completely. Lay lace piece with right side down to dry. This will minimize the tendency for the lace to curl. Be sure to flatten the piece out entirely and allow ample time to dry.

Diagram 1

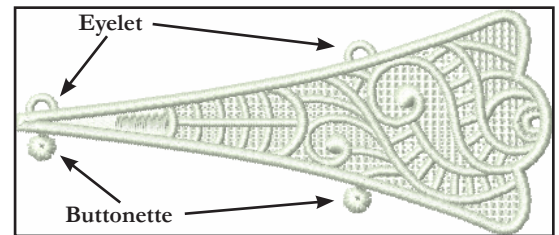

General Freestanding Appliqué Guidelines

Supplies:

Embroidery Thread:

- Use the same embroidery thread in the bobbin as the needle.

Needles:

- Use an Organ 80/12 Titanium needle for extended needle life.

Stabilizer:

- Use water-soluble stabilizer or film water-soluble stabilizer.

General Appliqué Instructions

1. Hoop two layers of water-soluble stabilizer.
2. Attach the hoop to the machine and select the design of your choice.
3. Stitch the Placement Stitch. **Photo 1**
4. Place a piece of appliqué fabric over the Placement Stitch so that it is completely covered.
5. Stitch the Cut Line & Tackdown Stitch.
6. Carefully cut away the excess appliqué fabric. **Photo 2**
7. Stitch the remainder of the design and repeat for any remaining pieces. **Photo 3**
8. Remove the hoop from the machine and the design from the hoop.
9. Trim excess stabilizer from the design.
10. Rinse away remaining stabilizer and allow it to dry.

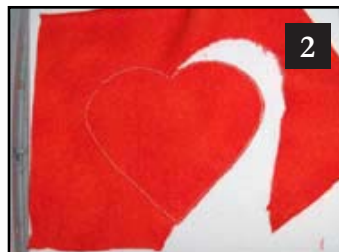

A set of freestanding ornaments to grace your Christmas tree is here! Elegant new snowflakes and baubles, as well as a few options for 3D ornament projects are all included.

Supplies

- OESD embroidery collection Enchanting Ornaments #12588
- Fabric for appliqués
- Wash away stabilizer
- Isacord embroidery threads
- Embroidery machine

Follow the *General Freestanding Lace Guidelines* and *General Freestanding Appliqué Guidelines* to stitch the ornaments.

#12588-01 3D Ball Ornament

- To create a 3D Ball Ornament: Insert the buttonette into the opposite eyelet, creating a circle. **PHOTO 1**
- For the top and bottom of the ornament, insert the buttonette into an opposite eyelet. **PHOTO 2**
- Place the Lace Toppers over the ends on the top and bottom of the ornament. **PHOTO 3**
- Bring a piece of ribbon through the top and tie to make a hanger. **PHOTO 4**

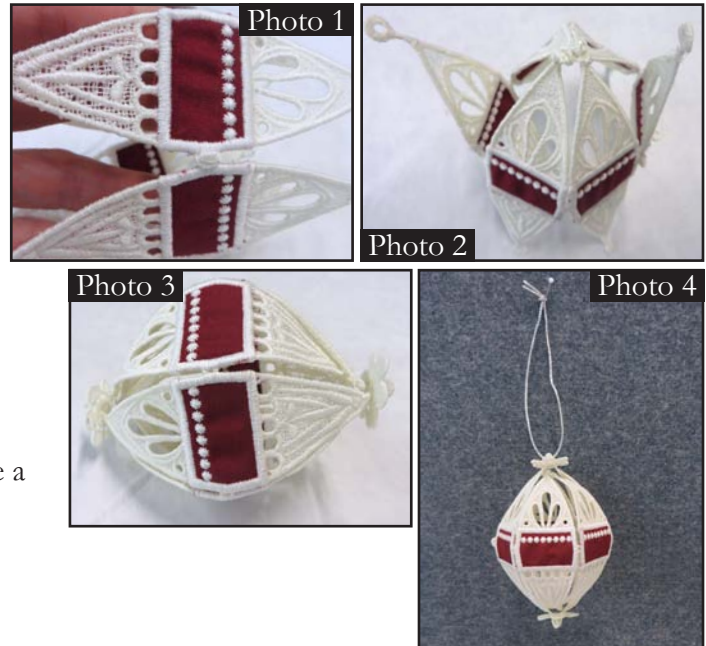

Loopy Ornament

(1) #12588-02 Loopy Ornament Center 1 OR

(1) #12588-03 Loopy Ornament Center 2

(6) #12588-04 Loopy Ornament Ribbon

- To create a loopy ornament: Take each Loopy Ornament Ribbon and fold in half to create a loop. Butt two ends of two loops and zigzag across the straight edges. **PHOTOS 5 & 6**
- Repeat with the four remaining loops to have a total of 3 sets stitched together. Arrange the loops on each other to create a bow effect. Bar tack in the center of the loops in a couple of places.
- Stitch a decorative button ($\frac{1}{2}$ " – $\frac{5}{8}$ " size) in the middle of the loops. **PHOTO 7**
- Button the Loopy Ornament Center 1 (#12588-02) OR Loopy Ornament Center 2 (#12588-03) onto the button. **PHOTO 8**
- Add a ribbon hanger for hanging on the tree or glue onto a package for a gift bow.
- *Optional:* Add tulle or fabric to create color and more dimension before adding the button.

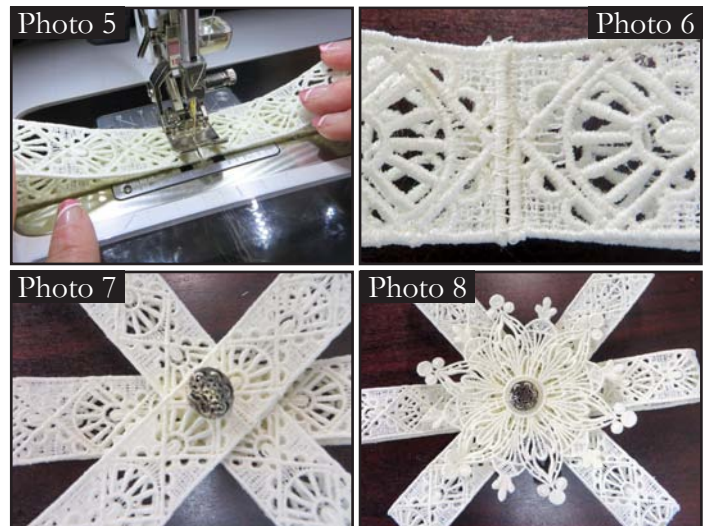

#12588-16 Ball Ornament Wrap

- Wrap around a ball ornament and tie in place using ribbon.
- *Optional:* Make a Garland: Stitch 6-10 Ball Ornament Wraps (#12588-16) depending on the length. Tie together with ribbons creating a garland. **PHOTO 9**



Photo 9

