

Note: Some designs in this collection may have been created using unique special stitches and/or techniques. To preserve design integrity when rescaling or rotating designs in your software, always rescale or rotate designs using the handles directly on-screen.



**12688-01 Spring Square 1**  
5.08 X 5.08 in.  
129.03 X 129.03 mm  
33,913 St.



**12688-02 Spring Square 2**  
5.32 X 5.22 in.  
135.13 X 132.59 mm  
26,349 St.



**12688-03 Spring Square 3**  
5.19 X 5.21 in.  
131.83 X 132.33 mm  
25,563 St.



**12688-04 Spring Square 4**  
5.17 X 5.20 in.  
131.32 X 132.08 mm  
28,853 St.



**12688-05 Spring Square 5**  
5.20 X 5.24 in.  
132.08 X 133.10 mm  
33,254 St.



**12688-06 Spring Square 6**  
5.26 X 5.28 in.  
133.60 X 134.11 mm  
24,783 St.



**12688-07 Spring Square 7**  
5.16 X 5.22 in.  
131.06 X 132.59 mm  
24,329 St.



**12688-08 Spring Square 8**  
5.20 X 5.23 in.  
132.08 X 132.84 mm  
31,104 St.



**12688-09 Spring Square 9**  
5.20 X 5.17 in.  
132.08 X 131.32 mm  
29,065 St.



**12688-10 Spring Square 10**  
5.21 X 5.21 in.  
132.33 X 132.33 mm  
25,622 St.



**12688-11 Spring Square 11**  
5.23 X 5.19 in.  
132.84 X 131.83 mm  
26,594 St.



**12688-12 Spring Square 12**  
5.24 X 5.22 in.  
133.10 X 132.59 mm  
28,446 St.



# Bella Patchwork Sampler

#12688 / 12 Designs

Listings below indicate color sample, stitching order and suggested thread color number. Most numbers indicate Isacord thread. Colors beginning with 20501 refer to YLI Fine Metallics, 7 refer to Yenmet Metallic, 8 refer to YLI Variations Variegated Thread and 9 refer to Isacord Multicolor Variegated.

### 12688-01 Spring Square 1

<input type="checkbox"/>	1. Pink Section Placement Stitch.....	0017
<input type="checkbox"/>	2. Pink Section Cut Line and Tackdown.....	0017
<input type="checkbox"/>	3. Pink Section White Flowers and Buds.....	0017
<input type="checkbox"/>	4. Dark Pink Detail.....	2532
<input type="checkbox"/>	5. Pink Cover Stitch.....	2530
<input type="checkbox"/>	6. White Triangle Linework.....	0017
<input type="checkbox"/>	7. Purple Checkers.....	3045
<input type="checkbox"/>	8. Green Section Placement Stitch.....	5115
<input type="checkbox"/>	9. Green Section Cut Line and Tackdown.....	5115
<input type="checkbox"/>	10. Dark Green Linework.....	5115
<input type="checkbox"/>	11. Green Section White Flowers.....	0017
<input type="checkbox"/>	12. Light Green Cover Stitch.....	5230
<input type="checkbox"/>	13. Yellow Detail.....	0630
<input type="checkbox"/>	14. Seam Stitch.....	0017

### 12688-02 Spring Square 2

<input type="checkbox"/>	1. Yellow Sections Placement Stitch.....	0017
<input type="checkbox"/>	2. Yellow Sections Cut Line and Tackdown.....	0017
<input type="checkbox"/>	3. White Flowers.....	0017
<input type="checkbox"/>	4. White Linework.....	0017
<input type="checkbox"/>	5. Gold Leaves, Vines and Stamens.....	0622
<input type="checkbox"/>	6. Light Yellow Cover Stitches.....	0630
<input type="checkbox"/>	7. Green Triangle.....	5230
<input type="checkbox"/>	8. Purple Triangle.....	3045
<input type="checkbox"/>	9. Pink Triangle.....	2530
<input type="checkbox"/>	10. Seam Stitch.....	0017

### 12688-03 Spring Square 3

<input type="checkbox"/>	1. Purple Section Placement Stitch.....	0017
<input type="checkbox"/>	2. Purple Section Cut Line and Tackdown.....	0017
<input type="checkbox"/>	3. Green Section Placement Stitch.....	0017
<input type="checkbox"/>	4. Green Section Cut Line and Tackdown.....	0017
<input type="checkbox"/>	5. Purple Section White Flowers.....	0017
<input type="checkbox"/>	6. White Linework.....	0017
<input type="checkbox"/>	7. Dark Purple Leaves, Vines and Stamens.....	2830
<input type="checkbox"/>	8. Pink Triangle Detail.....	2530
<input type="checkbox"/>	9. Yellow Triangle Detail.....	0630
<input type="checkbox"/>	10. Light Purple Cover Stitch.....	3045
<input type="checkbox"/>	11. Green Section White Flowers.....	0017
<input type="checkbox"/>	12. Green Section Linework and Stamens.....	5115
<input type="checkbox"/>	13. Light Green Cover Stitch.....	5230
<input type="checkbox"/>	14. Seam Stitch.....	0017

### 12688-04 Spring Square 4

<input type="checkbox"/>	1. Yellow Section Placement Stitch.....	0017
<input type="checkbox"/>	2. Yellow Section Cut Line and Tackdown.....	0017
<input type="checkbox"/>	3. Pink Section Placement Stitch.....	0017
<input type="checkbox"/>	4. Pink Section Cut Line and Tackdown.....	0017
<input type="checkbox"/>	5. White Linework.....	0017
<input type="checkbox"/>	6. White Flowers.....	0017
<input type="checkbox"/>	7. White Leaves.....	0017
<input type="checkbox"/>	8. Pink Leaves and Vines.....	2532
<input type="checkbox"/>	9. Light Pink Cover Stitch.....	2530
<input type="checkbox"/>	10. Purple Triangle.....	3045
<input type="checkbox"/>	11. Green Triangle.....	5230
<input type="checkbox"/>	12. Green Triangle Linework.....	5115
<input type="checkbox"/>	13. Green Triangle Satin Stitch.....	5230
<input type="checkbox"/>	14. Yellow Cover Stitch.....	0630
<input type="checkbox"/>	15. Seam Stitch.....	0017

### 12688-05 Spring Square 5

<input type="checkbox"/>	1. Pink Section Placement Stitch.....	0017
<input type="checkbox"/>	2. Pink Section Cut Line and Tackdown.....	0017
<input type="checkbox"/>	3. Yellow Sections Placement Stitch.....	0017
<input type="checkbox"/>	4. Yellow Sections Cut Line and Tackdown.....	0017
<input type="checkbox"/>	5. Yellow Sections White Detail.....	0017
<input type="checkbox"/>	6. Pink Section White Flowers.....	0017
<input type="checkbox"/>	7. White Linework.....	0017
<input type="checkbox"/>	8. Pink Leaves and Vines.....	2532
<input type="checkbox"/>	9. Pink Cover Stitch.....	2530
<input type="checkbox"/>	10. Gold Detail.....	0622
<input type="checkbox"/>	11. Green Detail.....	5230
<input type="checkbox"/>	12. Purple Detail.....	3045
<input type="checkbox"/>	13. Yellow Cover Stitches.....	0630
<input type="checkbox"/>	14. Seam Stitch.....	0017

### 12688-06 Spring Square 6

<input type="checkbox"/>	1. Green Section Placement Stitch.....	0017
<input type="checkbox"/>	2. Green Section Cut Line and Tackdown.....	0017
<input type="checkbox"/>	3. Pink Section Placement Stitch.....	0017
<input type="checkbox"/>	4. Pink Section Cut Line and Tackdown.....	0017
<input type="checkbox"/>	5. White Linework.....	0017
<input type="checkbox"/>	6. White Leaves and Flowers.....	0017
<input type="checkbox"/>	7. Green Cover Stitch.....	5230
<input type="checkbox"/>	8. Yellow Detail.....	0630
<input type="checkbox"/>	9. Pink Leaves, Vine and Stamen.....	2532
<input type="checkbox"/>	10. Light Pink Cover Stitch.....	2530
<input type="checkbox"/>	11. Purple Detail.....	3045
<input type="checkbox"/>	12. Dark Purple Linework.....	2830
<input type="checkbox"/>	13. Light Purple Triangle Outline.....	3045
<input type="checkbox"/>	14. Seam Stitch.....	0017

### 12688-07 Spring Square 7

<input type="checkbox"/>	1. Yellow Section Placement Stitch.....	0017
<input type="checkbox"/>	2. Yellow Section Cut Line and Tackdown.....	0017
<input type="checkbox"/>	3. Green Section Placement Stitch.....	0017
<input type="checkbox"/>	4. Green Section Cut Line and Tackdown.....	0017
<input type="checkbox"/>	5. White Linework.....	0017
<input type="checkbox"/>	6. Yellow Square White Flowers.....	0017
<input type="checkbox"/>	7. Green Section White Flowers.....	0017
<input type="checkbox"/>	8. Gold Detail.....	0622
<input type="checkbox"/>	9. Yellow Cover Stitch.....	0630
<input type="checkbox"/>	10. Green Leaves, Vines and Stamens.....	5115
<input type="checkbox"/>	11. Green Cover Stitch.....	5230
<input type="checkbox"/>	12. Pink Detail.....	2530
<input type="checkbox"/>	13. Purple Detail.....	3045
<input type="checkbox"/>	14. Seam Stitch.....	0017

### 12688-08 Spring Square 8

<input type="checkbox"/>	1. Green Section Placement Stitch.....	0017
<input type="checkbox"/>	2. Green Section Cut Line and Tackdown.....	0017
<input type="checkbox"/>	3. Yellow Section Placement Stitch.....	0017
<input type="checkbox"/>	4. Yellow Section Cut Line and Tackdown.....	0017
<input type="checkbox"/>	5. White Leaves.....	0017
<input type="checkbox"/>	6. White Flowers.....	0017
<input type="checkbox"/>	7. White Linework.....	0017
<input type="checkbox"/>	8. Green Leaves and Vines.....	5115
<input type="checkbox"/>	9. Light Green Cover Stitch.....	5230
<input type="checkbox"/>	10. Yellow Cover Stitch.....	0630
<input type="checkbox"/>	11. Pink Detail.....	2530
<input type="checkbox"/>	12. Purple Detail.....	3045
<input type="checkbox"/>	13. Seam Stitch.....	0017

### 12688-09 Spring Square 9

<input type="checkbox"/>	1. Yellow Section Placement Stitch.....	0017
<input type="checkbox"/>	2. Yellow Section Cut Line and Tackdown.....	0017
<input type="checkbox"/>	3. Purple Section Placement Stitch.....	0017
<input type="checkbox"/>	4. Purple Section Cut Line and Tackdown.....	0017
<input type="checkbox"/>	5. Yellow Section White Flowers.....	0017
<input type="checkbox"/>	6. Purple Section White Flowers.....	0017
<input type="checkbox"/>	7. White Linework.....	0017
<input type="checkbox"/>	8. Yellow Section Gold Detail.....	0622
<input type="checkbox"/>	9. Yellow Cover Stitch and Detail.....	0630
<input type="checkbox"/>	10. Purple Leaves and Vines.....	2830
<input type="checkbox"/>	11. Light Purple Cover Stitch.....	3045
<input type="checkbox"/>	12. Pink Detail.....	2530
<input type="checkbox"/>	13. Green Detail.....	5230
<input type="checkbox"/>	14. Dark Green Detail.....	5115
<input type="checkbox"/>	15. Green Section Satin Stitches.....	5230
<input type="checkbox"/>	16. Seam Stitch.....	0017

### 12688-10 Spring Square 10

<input type="checkbox"/>	1. Green Section Placement Stitch.....	0017
<input type="checkbox"/>	2. Green Section Cut Line and Tackdown.....	0017
<input type="checkbox"/>	3. Purple Section Placement Stitch.....	0017
<input type="checkbox"/>	4. Purple Section Cut Line and Tackdown.....	0017
<input type="checkbox"/>	5. Purple Section White Flowers.....	0017
<input type="checkbox"/>	6. Green Section White Flowers.....	0017
<input type="checkbox"/>	7. White Linework.....	0017
<input type="checkbox"/>	8. Purple Leaves and Vines.....	2830
<input type="checkbox"/>	9. Purple Section Cover Stitch.....	3045
<input type="checkbox"/>	10. Green Leaves, Vines and Stamens.....	5115
<input type="checkbox"/>	11. Green Section Cover Stitch.....	5230
<input type="checkbox"/>	12. Pink Detail.....	2530
<input type="checkbox"/>	13. Yellow Detail.....	0630
<input type="checkbox"/>	14. Seam Stitch.....	0017

### 12688-11 Spring Square 11

<input type="checkbox"/>	1. Yellow Section Placement Stitch.....	0017
<input type="checkbox"/>	2. Yellow Section Cut Line and Tackdown.....	0017
<input type="checkbox"/>	3. Pink Section Placement Stitch.....	0017
<input type="checkbox"/>	4. Pink Section Cut Line and Tackdown.....	0017
<input type="checkbox"/>	5. Pink Section White Flowers.....	0017
<input type="checkbox"/>	6. Yellow Sections White Leaves and Vines.....	0017
<input type="checkbox"/>	7. White Linework.....	0017
<input type="checkbox"/>	8. Pink Leaves and Vines.....	2532
<input type="checkbox"/>	9. Pink Section Cover Stitch.....	2530
<input type="checkbox"/>	10. Yellow Detail.....	0630
<input type="checkbox"/>	11. Gold Detail.....	0622
<input type="checkbox"/>	12. Yellow Section Cover Stitch and Detail.....	0630
<input type="checkbox"/>	13. Purple Detail.....	3045
<input type="checkbox"/>	14. Green Detail.....	5230
<input type="checkbox"/>	15. Seam Stitch.....	0017

### 12688-12 Spring Square 12

<input type="checkbox"/>	1. Yellow Section Placement Stitch.....	0017
<input type="checkbox"/>	2. Yellow Section Cut Line and Tackdown.....	0017
<input type="checkbox"/>	3. Pink Sections Placement Stitches.....	0017
<input type="checkbox"/>	4. Pink Sections Cut Line and Tackdown.....	0017
<input type="checkbox"/>	5. Pink Sections White Flowers.....	0017
<input type="checkbox"/>	6. Yellow Section White Flowers.....	0017
<input type="checkbox"/>	7. White Linework.....	0017
<input type="checkbox"/>	8. Gold Leaves, Vines and Stamens.....	0622
<input type="checkbox"/>	9. Yellow Section Cover Stitch.....	0630
<input type="checkbox"/>	10. Pink Detail.....	2532
<input type="checkbox"/>	11. Pink Sections Cover Stitch.....	2530
<input type="checkbox"/>	12. Green Detail.....	5230
<input type="checkbox"/>	13. Purple Detail.....	3045
<input type="checkbox"/>	14. Seam Stitch.....	0017

## Isacord Thread Colors Used in "Bella Patchwork Sampler"

### Collection #12688

0017 Paper White	2530 Rose	3045 Cachet
0622 Star Gold	2532 Pretty in Pink	5115 Baccarat Green
0630 Buttercup	2830 Wild Iris	5230 Bottle Green

### Pre-Cut Appliqué Instructions

1. Print out the necessary pages from the PDF of the appliqué pattern(s).
2. Mark the right side of the pattern pieces so you'll know which direction to lay the pattern on the fabric.
3. Lightly spray the wrong side of the pattern pieces with temporary adhesive spray and allow it to set for a few minutes.
4. Place the pattern pieces on the right side of the fabric and carefully cut them out. **PHOTO 1**
5. Sew the placement stitch on your hooped fabric. **PHOTO 2**
6. With the paper still stuck to the right side of the appliqué fabric, spray the wrong side of the fabric with temporary spray adhesive.
7. Place the fabric inside the placement stitch, so that it completely covers the placement stitch and then remove the paper pattern. **PHOTO 3**
8. Sew the tackdown. **PHOTO 4**
9. Sew the remainder of the design and repeat for any remaining pieces. **PHOTO 5**

**NOTE:** The patterns are sized for the designs as they were made. If you resize the design, you will need to resize the pattern the same amount. You can print out the pattern at the normal size then copy it on a copy machine at the changed size. For example, resize the designs to 80%, resize the printed pattern to 80%.

**TIP:** When Printing the patterns, make sure that the “Fit to page” option is **UNCHECKED** in the Print Dialog Box. If this option is checked the printed patterns will not be actual size.

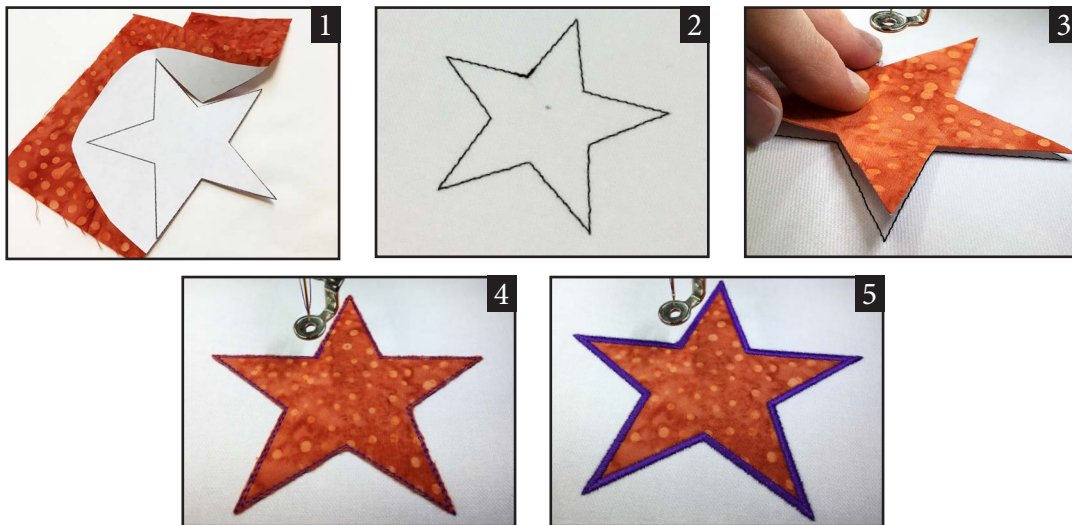

### Cut-in-Place Appliqué Instructions

1. Hoop your fabric and backing.
2. Sew the placement stitch. **PHOTO 1**
3. Place a piece of appliqué fabric over the placement stitch so that it is completely covered.
4. Sew the cut line & tackdown.
5. Carefully cut away the excess appliqué fabric. **PHOTO 2**
6. Sew the remainder of the design and repeat for any remaining pieces. **PHOTO 3**



### ATTENTION

When printing this document, any page scaling or page fitting options in your print dialog box must be turned OFF or set to NONE so that your files will print out at their actual size. Images not printed at actual size will not function as intended.

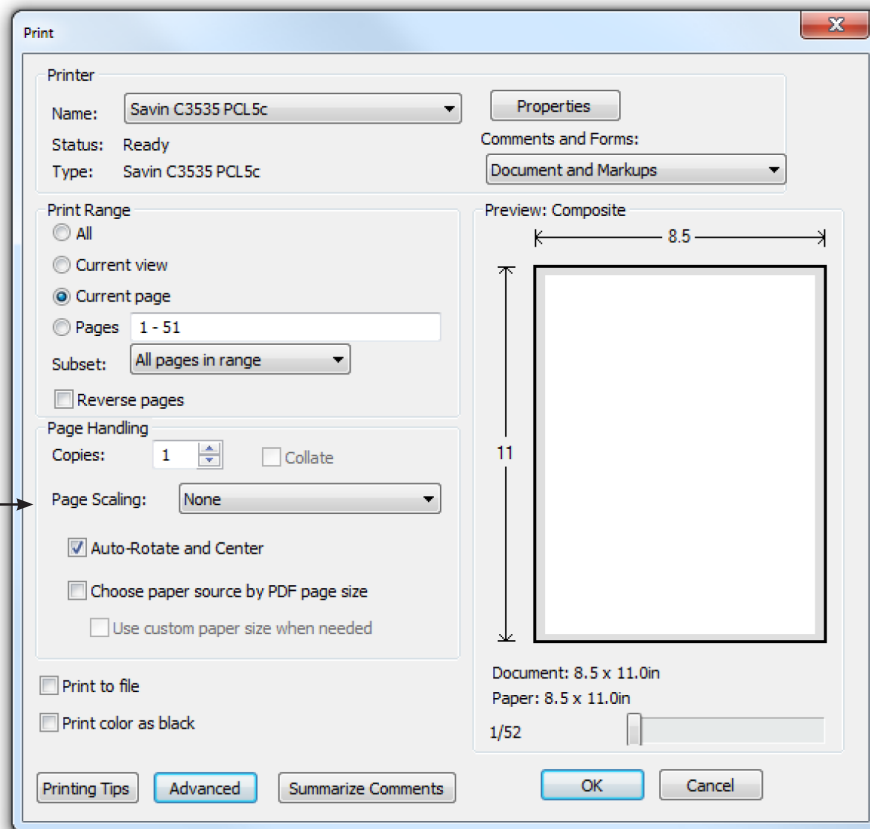

### TO SAVE PAPER

Only print the desired image by navigating to the image's page, go to File > Print and select "Current page" in the print dialog box. Repeat for each desired image.

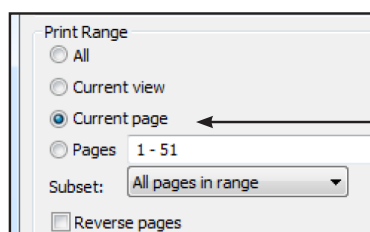

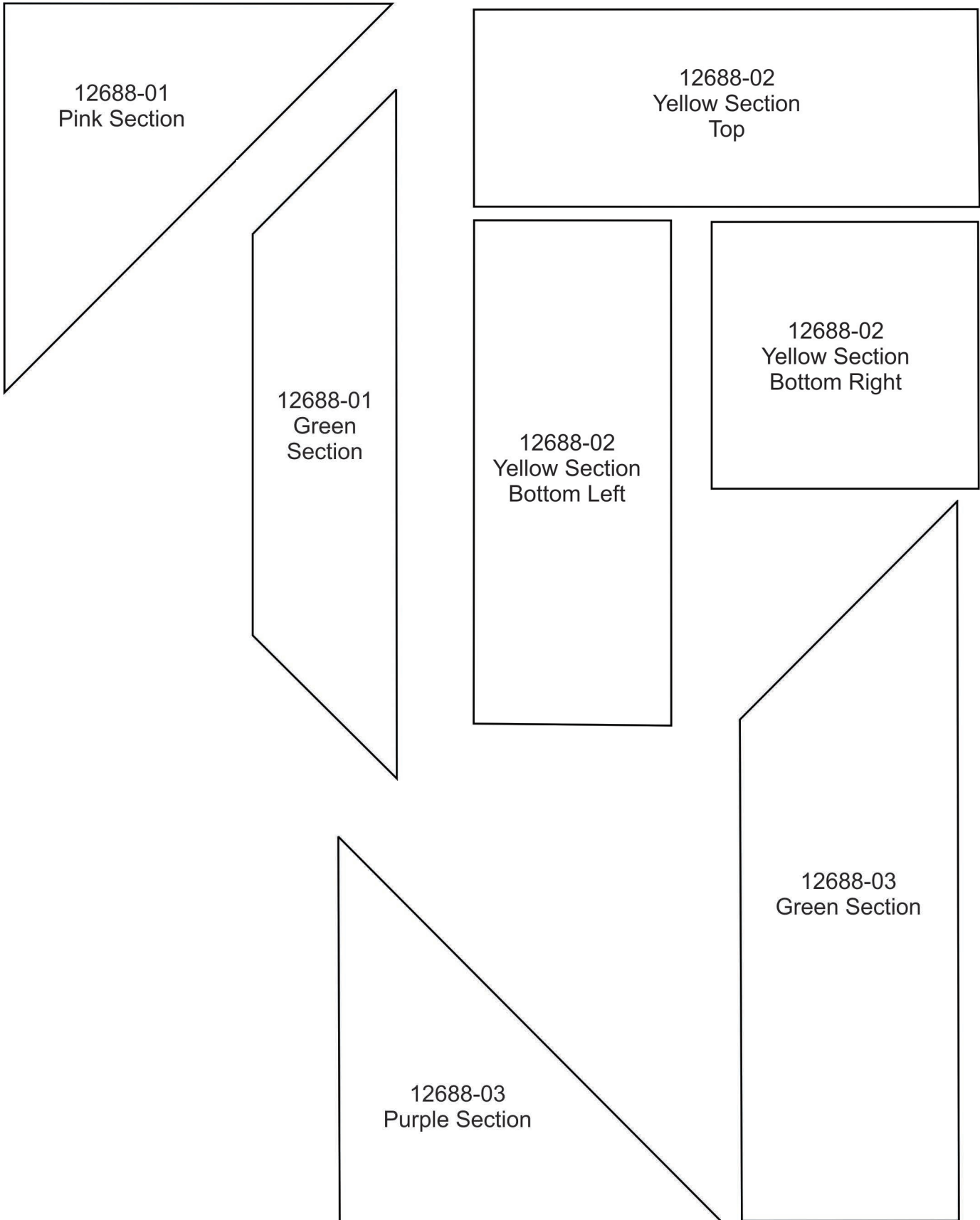

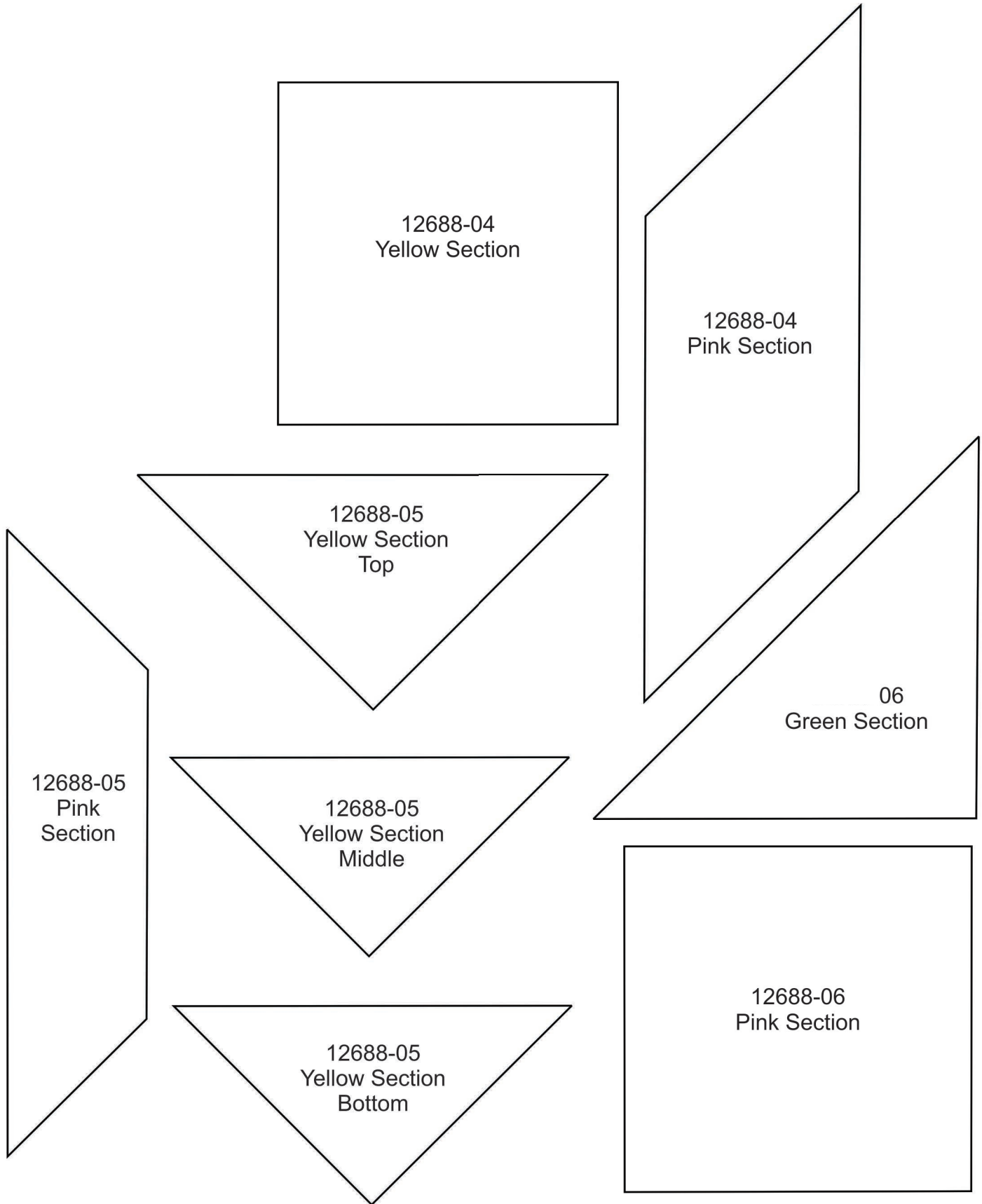

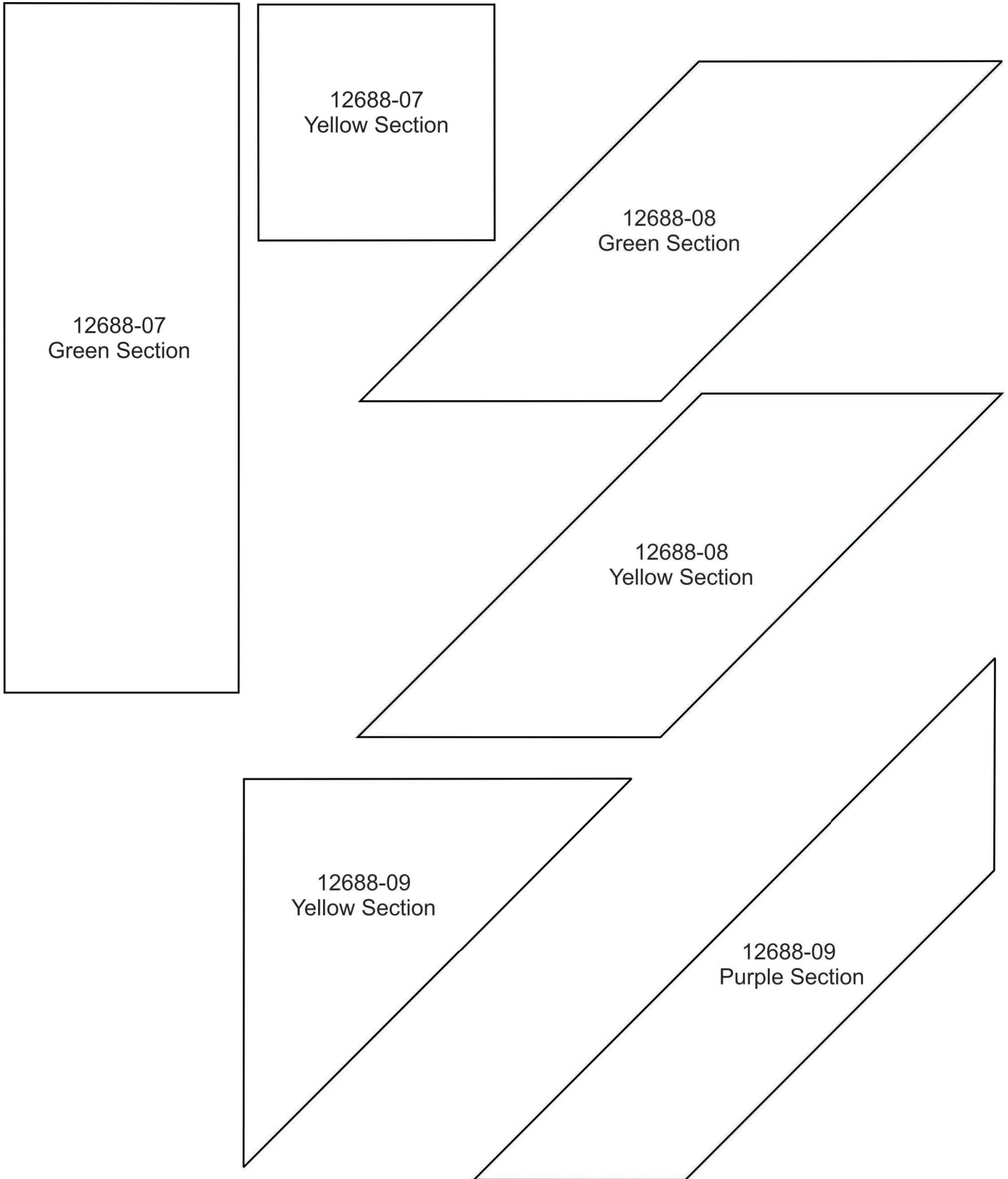

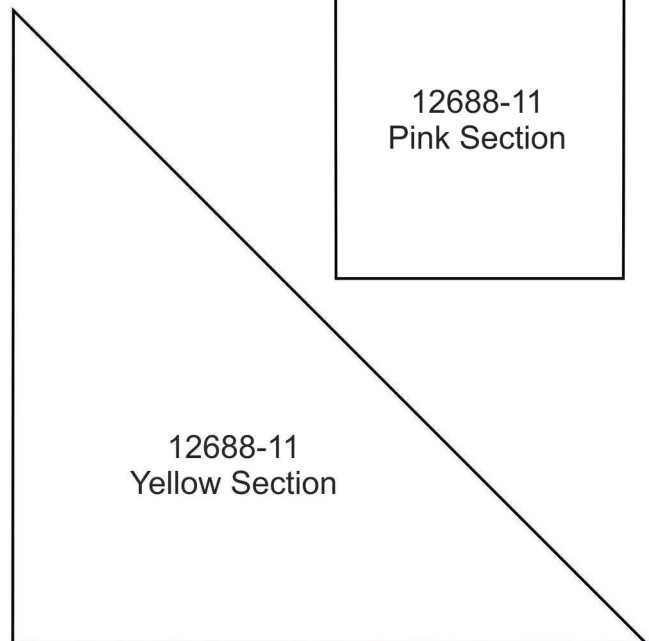
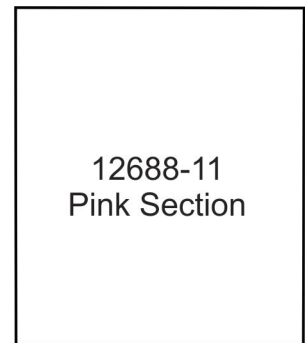
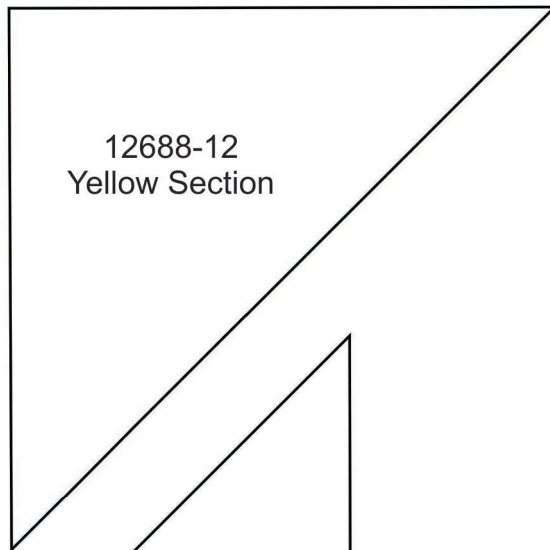
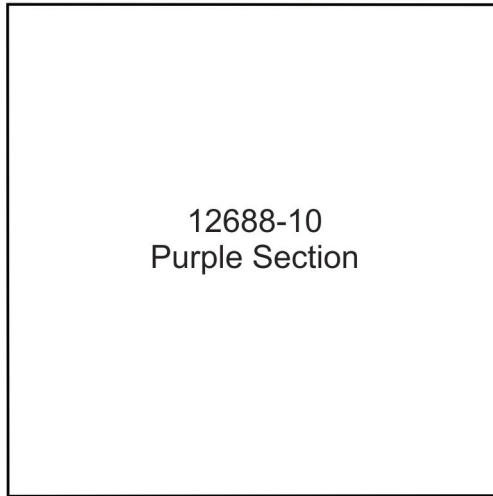
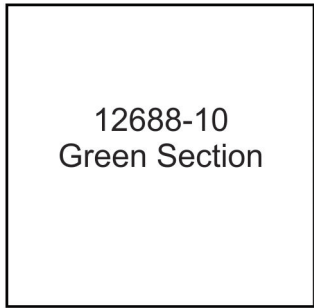



### Supplies:

- Fabrics:
  - 6 yards white
  - ½ yard blue for sashing and tiling
  - 1 ½ yard for backing
  - ⅓ yard for binding
  - ⅓ yard each, for appliqué:
    - Light green
    - Yellow
    - Purple (also used for center tiles for each block)
    - Pink
- Batting: 44" x 55"
- Isacord threads:
  - 0017 Paper White
  - 0622 Star Gold
  - 0630 Buttercup
  - 2530 Rose
  - 2532 Pretty in Pink
  - 2830 Wild Iris
  - 3045 Cachet
  - 5115 Baccarat Green
  - 5230 Bottle Green
- Tools:
  - Quilt ruler
  - Rotary cutter
  - Cutting mat
- Stabilizer:
  - Ultra Clean and Tear stabilizer, (3) 15" rolls if stabilizer cut 10" x 15"
  - Fusible Woven, (1) 15" roll
- From white fabric, cut:
  - (48) 10" x 15" (or large enough to hoop)
  - (17) 11" x 2 ½" strips
  - (2) 36" x 2 ½" strips
  - Cut and piece long outer border:
    - Cut (3) 2 ½" x width of fabric
    - Cut one strip in half (forming two pieces approximately 20" x 2 ½" each)
    - Piece the shorter strips on the diagonal with the two longer strips
    - Trim each of the new strips to 48 ½" strips
- From blue, cut:
  - 15" x width of fabric
  - Fuse Fusible Woven to the entire 15" strip. From the fused strip, cut:
    - (48) 5 ¼" x 1 ½" strips
    - (10) 2 ½" squares
- From purple, cut:
  - 1 ½" x width of fabric
  - Fuse Fusible Woven to the entire 1 ½" strip
  - Cut (12) 1 ½" squares from the fused strip
  - Reserve remaining purple for appliqué.

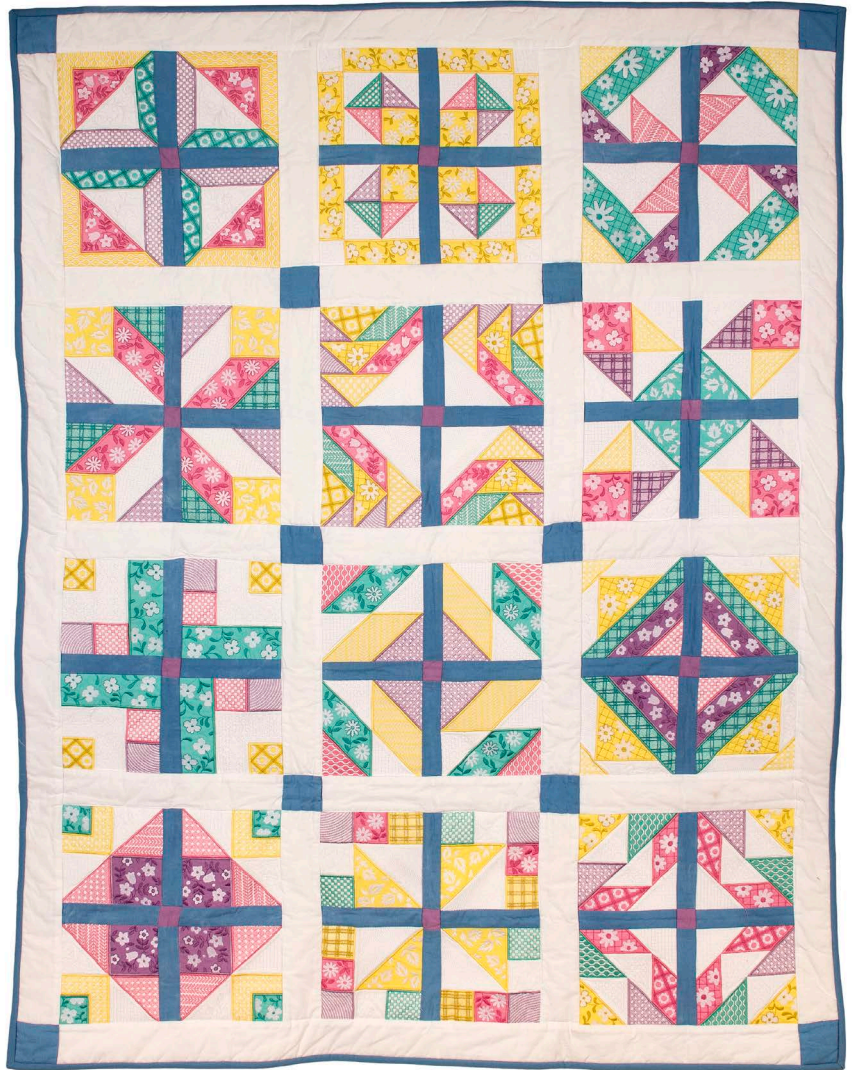

### Embroider the Blocks

- Hoop two layers of Ultra Clean and Tear stabilizer with a 10" x 15" piece of fabric.

- Stitch the design per the thread chart.
- For each placement stitch, stitch the placement line onto the background fabric. **PHOTO 1**
- Place a piece of appliqué fabric slightly larger than the placement stitch over the placement line. **PHOTO 2**
- Stitch the next color change, which will be a cut line/tackdown. **PHOTO 3**
- Trim the appliqué fabric as closely as possible to the cut line. **PHOTO 4**
- Continue to stitch the design, repeating steps 3-6 for each placement/cut line/tackdown set. **PHOTO 5**
- Stitch remaining colors. Note that the design may stitch block details and cover stitches for the appliqué in between appliqué pieces – the order will vary – follow the thread chart. **PHOTO 6**
- Before the last color change, change the bobbin color to black. The top color should be white (or match your background fabric). Stitch the final color change – *Seam stitch*. **PHOTO 7** (Shows the back side of the design.)

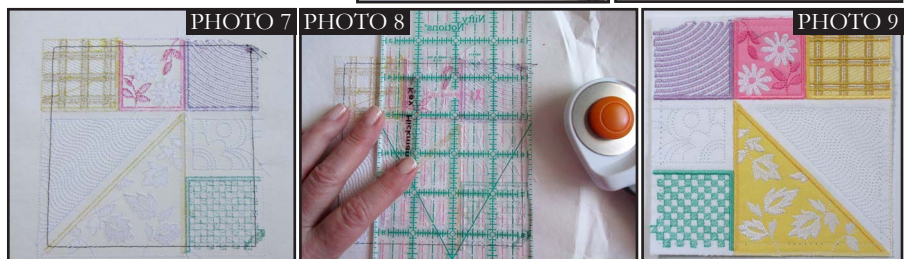
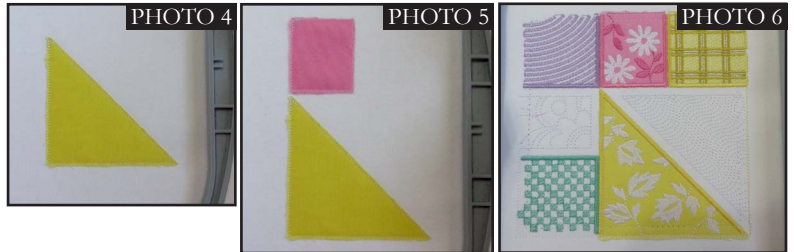
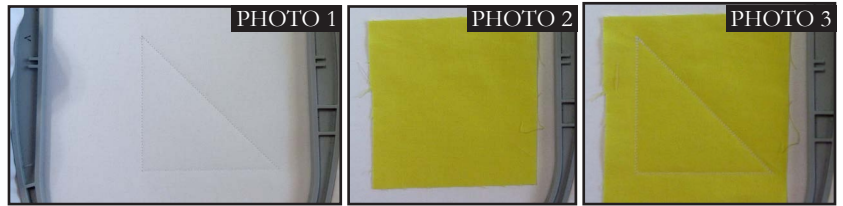

- Remove the project from the hoop. Place the embroidered piece right side down. Using a quilt ruler and rotary cutter, trim the block to  $\frac{1}{4}$ " away from the seam line (the seam line will be easy to see because it was stitched with a black bobbin). **PHOTO 8**
- The trimmed block should measure  $5\frac{1}{4}$ ". **PHOTO 9**
- Stitch (4) each of all twelve designs.

### Piece the Blocks

- Stitch all seams with a  $\frac{1}{4}$ " seam allowance.
- Arrange four like embroidered squares with (4)  $5\frac{1}{4}$ " x  $1\frac{1}{2}$ " blue strips and (1)  $1\frac{1}{2}$ " purple square as shown. Refer to the quilt diagram to determine the orientation of the blocks. **PHOTO 10**
- Place the top blue sashing strip right sides together with the top left embroidered square. Stitch. **PHOTOS 11 & 12**
- Press seam toward sashing. **PHOTO 13**
- Stitch the remaining top block to the other side of the sashing. Press toward the sashing. **PHOTO 14**
- Stitch the center sashing strips to the center tile, pressing toward the sashing pieces. **PHOTO 15**
- Stitch the bottom row as with the top row, pressing toward the sashing. **PHOTO 16**
- Place the center sashing strip right sides together with the top row. **PHOTO 17**
- Stitch, aligning seams. Press toward sashing. **PHOTO 18**
- Add bottom row to center sashing, pressing toward the center sashing. The block is complete. **PHOTO 19**
- Repeat for the remaining eleven blocks.





# Bella Patchwork Sampler

## Instructions

---

### Assemble the Quilt Top

- Following the quilt layout diagram, arrange the blocks, white 11" x 2 1/2" sashing, and six of the blue tiling squares.
- Assemble each row, always pressing toward the sashing.
- Stitch the rows together.
- Add the 48 1/2" white border strips to the right and left of the quilt center.
- Stitch the remaining four tiling squares to either end of the two 36" x 2 1/2" border strips.
- Stitch the top and bottom strips (with tiled corners) to the top and bottom of the quilt, aligning seams.

### Quilt and Bind

- Layer the backing, batting, and quilt top.
- Baste in place with pins or temporary adhesive spray.
- Quilt as desired. Stitch in the ditch is recommended.
- Cut 2 1/2" strips from binding fabric. Piece together to form 200" of continuous bias.
- Bind as desired.

