

Note: Some designs in this collection may have been created using unique special stitches and/or techniques. To preserve design integrity when rescaling or rotating designs in your software, always rescale or rotate designs using the handles directly on-screen.



12695-01 Ornament Appliqué
5.07 X 8.62 in.
128.78 X 218.95 mm
49,488 St.



12695-02 Bell Appliqué
4.38 X 7.35 in.
111.25 X 186.69 mm
33,286 St.



12695-03 Dove Appliqué
5.17 X 6.12 in.
131.32 X 155.45 mm
26,717 St.



12695-04 Gift Appliqué
4.81 X 5.73 in.
122.17 X 145.54 mm
30,827 St.



12695-05 Candle Appliqué
4.78 X 6.15 in.
121.41 X 156.21 mm
17,972 St.



12695-06 Jingle Bells Appliqué
4.37 X 5.87 in.
111.00 X 149.10 mm
18,129 St.



12695-07 Jingle Bell Appliqué
2.58 X 3.26 in.
65.53 X 82.80 mm
8,953 St.



12695-08 Snowflake Appliqué
5.16 X 5.95 in.
131.06 X 151.13 mm
35,433 St.



12695-09 Christmas Medallion Appliqué
5.49 X 5.65 in.
139.45 X 143.51 mm
27,066 St.



12695-10 Christmas Center Appliqué
5.31 X 5.31 in.
134.87 X 134.87 mm
34,660 St.



12695-11 Christmas Wreath Appliqué
5.49 X 5.49 in.
139.45 X 139.45 mm
23,620 St.



12695-12 Jumbo Wreath Appliqué
9.15 X 9.02 in.
232.41 X 229.11 mm
74,266 St.

Note: Some designs in this collection may have been created using unique special stitches and/or techniques. To preserve design integrity when rescaling or rotating designs in your software, always rescale or rotate designs using the handles directly on-screen.



12695-13 Christmas Paisley Appliqué 1
5.29 X 6.00 in.
134.37 X 152.40 mm
19,364 St.



12695-14 Christmas Paisley Appliqué 2
3.22 X 4.08 in.
81.79 X 103.63 mm
9,218 St.



12695-15 Holly Appliqué 1
4.49 X 5.91 in.
114.05 X 150.11 mm
16,275 St.



12695-16 Holly Appliqué 2
3.83 X 3.96 in.
97.28 X 100.58 mm
9,304 St.



12695-17 Joy Appliqué
5.28 X 4.93 in.
134.11 X 125.22 mm
13,330 St.



12695-18 Noel Appliqué
5.85 X 4.65 in.
148.59 X 118.11 mm
15,645 St.



12695-19 Peace FSA
5.69 X 3.60 in.
144.53 X 91.44 mm
10,664 St.



12695-20 Snowflake FSA
4.26 X 4.91 in.
108.20 X 124.71 mm
16,629 St.



12695-21 Holly FSA
3.65 X 3.73 in.
92.71 X 94.74 mm
8,438 St.



12695-22 Golden Dove
3.61 X 5.12 in.
91.69 X 130.05 mm
24,629 St.



12695-23 Golden Pinecone
3.49 X 4.64 in.
88.65 X 117.86 mm
19,616 St.



12695-24 Golden Bow
4.50 X 3.74 in.
114.30 X 95.00 mm
26,132 St.

Note: Some designs in this collection may have been created using unique special stitches and/or techniques. To preserve design integrity when rescaling or rotating designs in your software, always rescale or rotate designs using the handles directly on-screen.



12695-25 Golden Feather
2.99 X 4.18 in.
75.95 X 106.17 mm
13,497 St.



12695-26 Golden Holly
3.34 X 3.01 in.
84.84 X 76.45 mm
11,272 St.



**12695-27 Christmas Holly
Linework 1**
4.83 X 5.48 in.
122.68 X 139.19 mm
5,600 St.



**12695-28 Christmas Holly
Linework 2**
4.16 X 4.53 in.
105.66 X 115.06 mm
3,609 St.



**12695-29 Christmas Holly
Linework 3**
2.61 X 3.13 in.
66.29 X 79.50 mm
2,168 St.



12695-30 Holly Wreath Linework
5.46 X 5.37 in.
138.68 X 136.40 mm
9,341 St.



12695-31 Holly Linework Border
3.34 X 5.80 in.
84.84 X 147.32 mm
5,120 St.



12695-32 Holly Linework Corner
4.32 X 4.31 in.
109.73 X 109.47 mm
5,103 St.



**12695-33 Christmas Feather
Linework 1**
4.41 X 5.23 in.
112.01 X 132.84 mm
4,046 St.



**12695-34 Christmas Feather
Linework 2**
2.96 X 4.36 in.
75.18 X 110.74 mm
2,841 St.



**12695-35 Christmas Feather
Linework 3**
2.74 X 2.65 in.
69.60 X 67.31 mm
1,843 St.



**12695-36 Feather Linework
Border**
6.00 X 1.67 in.
152.40 X 42.42 mm
3,183 St.

Note: Some designs in this collection may have been created using unique special stitches and/or techniques. To preserve design integrity when rescaling or rotating designs in your software, always rescale or rotate designs using the handles directly on-screen.

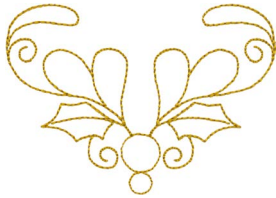

**12695-37 Feather Linework
Corner**
3.32 X 2.37 in.
84.33 X 60.20 mm
2,139 St.



12695-38 Redwork Dove
4.76 X 5.80 in.
120.90 X 147.32 mm
5,479 St.

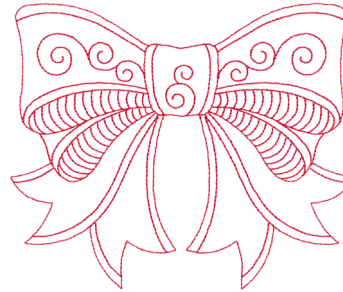

12695-39 Redwork Bow
5.67 X 4.69 in.
144.02 X 119.13 mm
7,426 St.

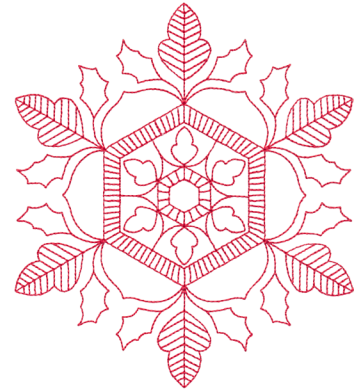

12695-40 Redwork Snowflake
5.41 X 6.23 in.
137.41 X 158.24 mm
11,070 St.

Listings below indicate color sample, stitching order and suggested thread color number. Most numbers indicate Isacord thread. Colors beginning with 20501 refer to YLI Fine Metallics, 7 refer to Yenmet Metallic, 8 refer to YLI Variations Variegated Thread and 9 refer to Isacord Multicolor Variegated.

12695-01 Ornament Appliqué

1. Ornament Placement Stitch	6051
2. Cut Line and Tackdown	6051
3. Light Green Detail	6051
4. White Detail	0015
5. Light Red Detail	1805
6. Pearlescence Pink Highlights	7034
7. Light Gold Filigree Detail	0741
8. Medium Green Detail	5531
9. Red Detail	1902
10. Gold Detail	0542
11. Light Gold Zig Zag	0741
12. Green Detail	5400

12695-02 Bell Appliqué

1. Bell Placement Stitch	0542
2. Cut Line and Tackdown	0542
3. Pearlescence Pink Highlights	7034
4. White Detail	0015
5. Green Bell Detail	5400
6. Light Green Detail	6051
7. Medium Green Detail	5531
8. Gold Detail	0542
9. Light Gold Detail	0741
10. Red Detail	1902
11. Green Filigree Detail	5400
12. Light Red Detail	1805

12695-03 Dove Appliqué

1. Back Wing Placement Stitch	5400
2. Cut Line and Tackdown	5400
3. Body Placement Stitch	5400
4. Cut Line and Tackdown	5400
5. Tail and Front Wing Placement Stitch	5400
6. Cut Line and Tackdown	5400
7. Pearlescence Pink Highlights	7034
8. White Detail	0015
9. Light Green Detail	6051
10. Light Gold Detail	0741
11. Light Red Detail	1805
12. Gold Detail	0542
13. Back Wing Cover Stitch	1902
14. Body and Tail Cover Stitch	5400
15. Front Wing Cover Stitch and Zig Zag	1902

12695-04 Gift Appliqué

1. Gift Placement Stitch	6051
2. Cut Line and Tackdown	6051
3. Light Green Detail	6051
4. White Detail	0015
5. Bow Placement Stitch	0015
6. Cut Line and Tackdown	0015
7. Pearlescence Pink Highlights	7034
8. Gold Detail	0542
9. Medium Green Detail	5531
10. Light Gold Detail	0741
11. Green Detail	5400
12. Light Red Detail	1805
13. Red Detail	1902

12695-05 Candle Appliqué

1. Light Green Detail	6051
2. Candle Holder Placement Stitch	5531
3. Cut Line and Tackdown	5531
4. Medium Green Detail	5531
5. Green Detail	5400
6. Candle Placement Stitch	5400
7. Cut Line and Tackdown	5400
8. Pearlescence Pink Highlights	7034
9. White Detail	0015
10. Red Detail	1902
11. Light Gold Detail	0741
12. Light Red Detail	1805
13. Gold Detail	0542

12695-06 Jingle Bells Appliqué

1. Light Green Detail	6051
2. Medium Green Detail	5531
3. Green Detail	5400
4. Bells Placement Stitch	5400
5. Cut Line and Tackdown	5400
6. Pearlescence Pink Highlights	7034
7. White Detail	0015
8. Light Gold Detail	0741
9. Light Red Detail	1805
10. Gold Detail	0542

12695-07 Jingle Bell Appliqué

1. Light Green Detail	6051
2. Medium Green Detail	5531
3. Green Detail	5400
4. Light Red Detail	1805
5. Bell Placement Stitch	1805
6. Cut Line and Tackdown	1805
7. Pearlescence Pink Highlights	7034
8. White Detail	0015
9. Light Gold Detail	0741
10. Gold Detail	0542

12695-08 Snowflake Appliqué

1. Hexagon Placement Stitch	6051
2. Cut Line and Tackdown	6051
3. Light Green Detail	6051
4. Light Red Detail	1805
5. Medium Green Detail	5531
6. Green Detail	5400
7. White Detail	0015
8. Pearlescence Pink Highlights	7034
9. Light Gold Detail	0741
10. Gold Detail	0542
11. Red Detail	1902

12695-09 Christmas Medallion Appliqué

1. Circle Placement Stitch	1902
2. Cut Line and Tackdown	1902
3. Pearlescence Pink Highlights	7034
4. White Detail	0015
5. Light Red Detail	1805
6. Medium Green Detail	5531
7. Light Green Detail	6051
8. Green Detail	5400
9. Red Detail	1902
10. Gold Detail	0542
11. Light Gold Detail	0741

12695-10 Christmas Center Appliqué

1. Christmas Center Placement Stitch	0015
2. Cut Line and Tackdown	0015
3. White Detail	0015
4. Pearlescence Pink Highlights	7034
5. Light Green Detail	6051
6. Light Red Detail	1805
7. Medium Green Detail	5531
8. Green Detail	5400
9. Light Gold Detail	0741

12695-11 Christmas Wreath Appliqué

1. Wreath Placement Stitch	6051
2. Cut Line and Tackdown	6051
3. Light Green Detail	6051
4. Medium Green Detail	5531
5. Pearlescence Pink Linework	7034
6. White Detail	0015
7. Gold Detail	0542
8. Light Red Detail	1805
9. Red Detail	1902
10. Light Gold Detail	0741

12695-12 Jumbo Wreath Appliqué

1. Light Gold Detail	0741
2. Light Green Detail	6051
3. Gold Detail	0542
4. Medium Green Detail	5531
5. Light Green Leaves Placement	5400
6. Cut Line and Tackdown	5400
7. Dark Green Leaves Placement	5400
8. Cut Line and Tackdown	5400
9. Green Detail	5400
10. Medium Green Cover Stitches	5531
11. White Detail	0015
12. Light Red Detail	1805

12695-13 Christmas Paisley Appliqué 1

1. Light Gold Detail	0741
2. Light Green Detail	6051
3. Gold Detail	0542
4. Light Red Detail	1805
5. Paisley Placement Stitch	0015
6. Cut Line and Tackdown	0015
7. White Detail	0015
8. Medium Green Detail	5531
9. Green Detail	5400

12695-14 Christmas Paisley Appliqué 2

1. Medium Green Detail	5531
2. Light Red Detail	1805
3. Light Green Detail	6051
4. Green Detail	5400
5. Paisley Placement Stitch	0015
6. Cut Line and Tackdown	0015
7. White Detail	0015
8. Pearlescence Pink Highlights	7034
9. Gold Detail	0542
10. Light Gold Detail	0741

12695-15 Holly Appliqué 1

1. Light Gold Detail	0741
2. Holly Placement Stitch	1805
3. Cut Line and Tackdown	1805
4. Light Red Detail	1805
5. White Detail	0015
6. Light Green Detail	6051
7. Green Detail	5400
8. Medium Green Detail	5531

12695-16 Holly Appliqué 2

1. Light Gold Detail	0741
2. Leaf Placement Stitch	0015
3. Cut Line and Tackdown	0015
4. White Detail	0015
5. Light Red Detail	1805
6. Light Green Detail	6051
7. Green Detail	5400
8. Medium Green Detail	5531

12695-17 Joy Appliqué

1. Light Green Detail	6051
2. Green Detail	5400
3. Light Red Detail	1805
4. Word Background Placement Stitch	0741
5. Cut Line and Tackdown	0741
6. Light Gold Detail	0741
7. White Detail	0015
8. Medium Green Detail	5531
9. Red Cover Detail	1902
10. Gold Detail	0542



Deck The Halls Appliqués

#12695 / 40 Designs

Listings below indicate color sample, stitching order and suggested thread color number. Most numbers indicate Isacord thread. Colors beginning with 20501 refer to YLI Fine Metallics, 7 refer to Yenmet Metallic, 8 refer to YLI Variations Variegated Thread and 9 refer to Isacord Multicolor Variegated.

12695-18 Noel Appliqué

1. Light Red Detail.....	1805
2. Green Detail.....	5400
3. Light Gold Detail.....	0741
4. Word Background Placement Stitch.....	6051
5. Cut Line and Tackdown.....	6051
6. Light Green Detail.....	6051
7. White Detail.....	0015
8. Red Detail.....	1902
9. Medium Green Detail.....	5531
10. Gold Detail.....	0542

12695-19 Peace FSA

1. Word Background Placement Stitch.....	0542
2. Cut Line and Tackdown.....	0542
3. Gold Detail.....	0542
4. White Detail.....	0015
5. Backside Placement Stitch.....	1805
6. Cut Line and Tackdown.....	1805
7. Green Detail.....	5400
8. Light Red Detail.....	1805

12695-20 Snowflake FSA

1. Snowflake Background Placement Stitch.....	5400
2. Cut Line and Tackdown.....	5400
3. Green Detail.....	5400
4. Light Green Detail.....	6051
5. Medium Green Detail.....	5531
6. Light Gold Detail.....	0741
7. Gold Inner Detail.....	0542
8. White Detail.....	0015
9. Backside Placement Stitch.....	1902
10. Cut Line and Tackdown.....	1902
11. Red Detail.....	1902
12. Gold Leaves.....	0542

12695-21 Holly FSA

1. Background Placement Stitch.....	1805
2. Cut Line and Tackdown.....	1805
3. Light Red Detail.....	1805
4. Light Gold Detail.....	0741
5. Light Green Detail.....	6051
6. Medium Green Detail.....	5531
7. White Detail.....	0015
8. Backside Placement Stitch.....	0542
9. Cut Line and Tackdown.....	0542
10. Gold Detail.....	0542

12695-22 Golden Dove

1. Light Gold Detail.....	0741
2. White Detail.....	0015
3. Gold Detail.....	0542

12695-23 Golden Pinecone

1. White Detail.....	0015
2. Light Gold Detail.....	0741
3. Gold Detail.....	0542

12695-24 Golden Bow

1. White Detail.....	0015
2. Light Gold Detail.....	0741
3. Gold Detail.....	0542

12695-25 Golden Feather

1. White Fill.....	0015
2. Light Gold Detail.....	0741
3. White Satins.....	0015
4. Gold Detail.....	0542

12695-26 Golden Holly

1. Light Gold Detail.....	0741
2. White Detail.....	0015
3. Gold Detail.....	0542

12695-27 Christmas Holly Linework 1

1. Single Color Design.....	5531
-----------------------------	------

12695-28 Christmas Holly Linework 2

1. Single Color Design.....	5531
-----------------------------	------

12695-29 Christmas Holly Linework 3

1. Single Color Design.....	5531
-----------------------------	------

12695-30 Holly Wreath Linework

1. Single Color Design.....	5531
-----------------------------	------

12695-31 Holly Linework Border

1. Single Color Design.....	5531
-----------------------------	------

12695-32 Holly Linework Corner

1. Single Color Design.....	5531
-----------------------------	------

12695-33 Christmas Feather Linework 1

1. Single Color Design.....	0542
-----------------------------	------

12695-34 Christmas Feather Linework 2

1. Single Color Design.....	0542
-----------------------------	------

12695-35 Christmas Feather Linework 3

1. Single Color Design.....	0542
-----------------------------	------

12695-36 Feather Linework Border

1. Single Color Design.....	0542
-----------------------------	------

12695-37 Feather Linework Corner

1. Single Color Design.....	0542
-----------------------------	------

12695-38 Redwork Dove

1. Single Color Design.....	1805
-----------------------------	------

12695-39 Redwork Bow

1. Single Color Design.....	1805
-----------------------------	------

12695-40 Redwork Snowflake

1. Single Color Design.....	1805
-----------------------------	------

Isacord and Yenmet Metallic Thread Colors Used in "Deck The Halls Appliqués"

Collection #12695

0015 White	1805 Strawberry	5531 Pear
0542 Ochre	1902 Poinsettia	6051 Jalapeno
0741 Wheat	5400 Scrub Green	7034 (AN8) Pearlescence Pink/Rose

FSA - Freestanding Appliqué

FSL - Freestanding Lace

It is a violation of Copyright law to make and distribute copies of electronic designs or artwork. Electronic designs are licensed to the original purchaser for use at one location. ©2017 OESD, LLC. All rights reserved.

General Freestanding Appliqué Guidelines

Supplies:

Embroidery Thread:

- Use the same embroidery thread in the bobbin as the needle.

Needles:

- Use an Organ 80/12 Titanium needle for extended needle life.

Stabilizer:

- Use water-soluble stabilizer or film water-soluble stabilizer.

General Appliqué Instructions

1. Hoop two layers of OESD AquaMesh Stabilizer.
2. Attach the hoop to the machine and select the design of your choice.
3. Stitch the Placement Stitch. **Photo 1**
4. Place a piece of appliqué fabric over the Placement Stitch so that it is completely covered.
5. Stitch the Cut Line & Tackdown stitch.
6. Carefully cut away the excess appliqué fabric. **Photo 2**
7. Stitch the remainder of the design and repeat for any remaining pieces. **Photo 3**
8. Remove the hoop from the machine and the design from the hoop.
9. Trim excess stabilizer from the design.
10. Rinse away remaining stabilizer and allow it to dry face down to prevent curling.

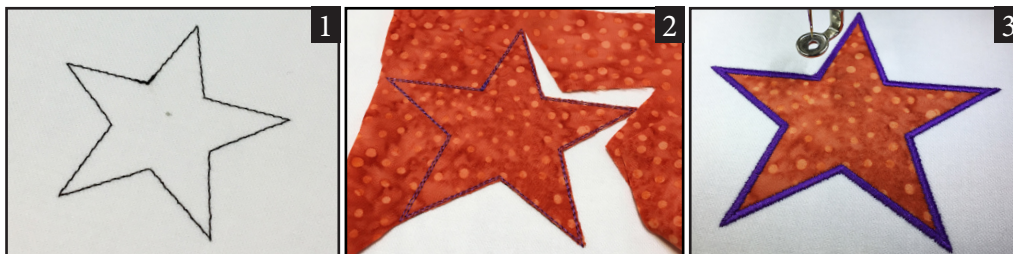

Handy Hints

Drying:

- Freestanding pieces look best when left to dry with right side down. This will minimize the tendency for a piece to curl. Be sure to flatten the piece out entirely and allow ample time to dry.

For 3D Appliqué Projects:

- Adhere 1 layer of OESD StabilStick TearAway to the back of appliqué fabrics with temporary adhesive spray **BEFORE** hooping or placing down for tackdown and cut in place. This gives fabric a more rigid structure.
- A pair of tweezers, hemostats, stiletto or a tiny crochet hook can be extremely helpful when inserting the buttonettes into the eyelets. (See **Diagram 1** for explanation of “buttonette” and “eyelet”.)
- Insert the tip of the tweezers, hemostats or crochet hook into the eyelet, grasp the buttonette and pull through the eyelet. Or a stiletto could be used to push the buttonette through the eyelet.

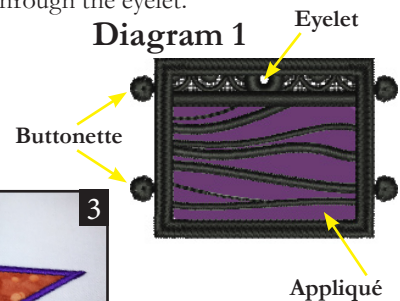

Pre-Cut Appliqué Instructions

1. Print out the necessary pages from the PDF of the appliqué pattern(s).
2. Mark the right side of the pattern pieces so you'll know which direction to lay the pattern on the fabric.
3. Lightly spray the wrong side of the pattern pieces with temporary adhesive spray and allow it to set for a few minutes.
4. Place the pattern pieces on the right side of the fabric and carefully cut them out. **PHOTO 1**
5. Sew the placement stitch on your hooped fabric. **PHOTO 2**
6. With the paper still stuck to the right side of the appliqué fabric, spray the wrong side of the fabric with temporary spray adhesive.
7. Place the fabric inside the placement stitch, so that it completely covers the placement stitch and then remove the paper pattern. **PHOTO 3**
8. Sew the tackdown. **PHOTO 4**
9. Sew the remainder of the design and repeat for any remaining pieces. **PHOTO 5**

NOTE: The patterns are sized for the designs as they were made. If you resize the design, you will need to resize the pattern the same amount. You can print out the pattern at the normal size then copy it on a copy machine at the changed size. For example, resize the designs to 80%, resize the printed pattern to 80%.

TIP: When Printing the patterns, make sure that the "Fit to page" option is **UNCHECKED** in the Print Dialog Box. If this option is checked the printed patterns will not be actual size.

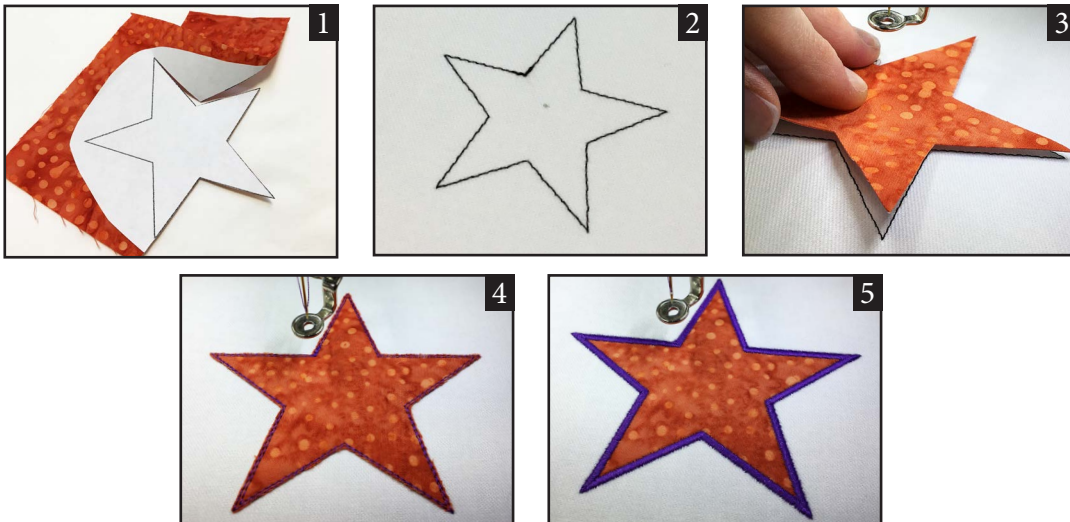

Cut-in-Place Appliqué Instructions

1. Hoop your fabric and backing.
2. Sew the placement stitch. **PHOTO 1**
3. Place a piece of appliqué fabric over the placement stitch so that it is completely covered.
4. Sew the cut line & tackdown.
5. Carefully cut away the excess appliqué fabric. **PHOTO 2**
6. Sew the remainder of the design and repeat for any remaining pieces. **PHOTO 3**



ATTENTION

When printing this document, any page scaling or page fitting options in your print dialog box must be turned OFF or set to NONE so that your files will print out at their actual size. Images not printed at actual size will not function as intended.

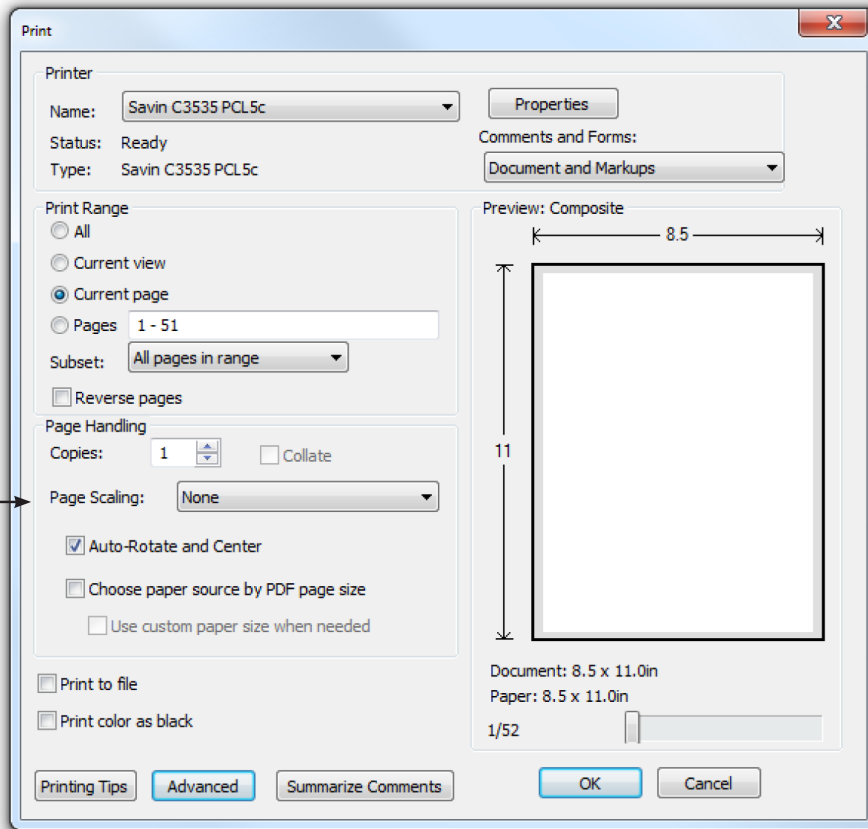

TO SAVE PAPER

Only print the desired image by navigating to the image's page, go to File > Print and select "Current page" in the print dialog box. Repeat for each desired image.

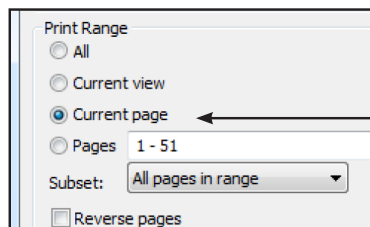

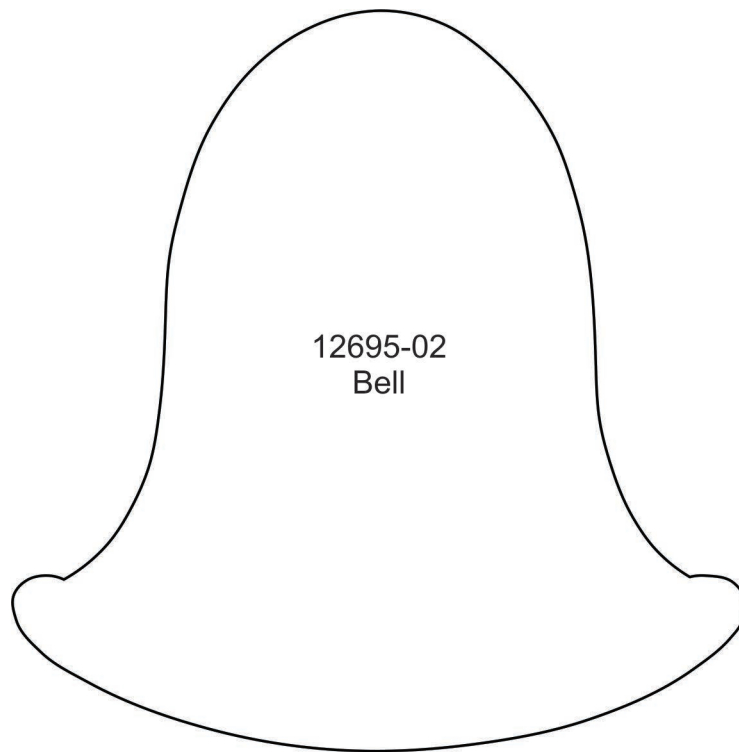
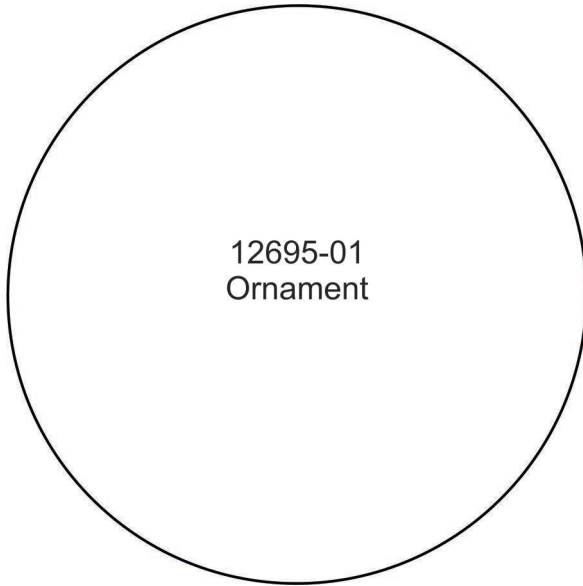

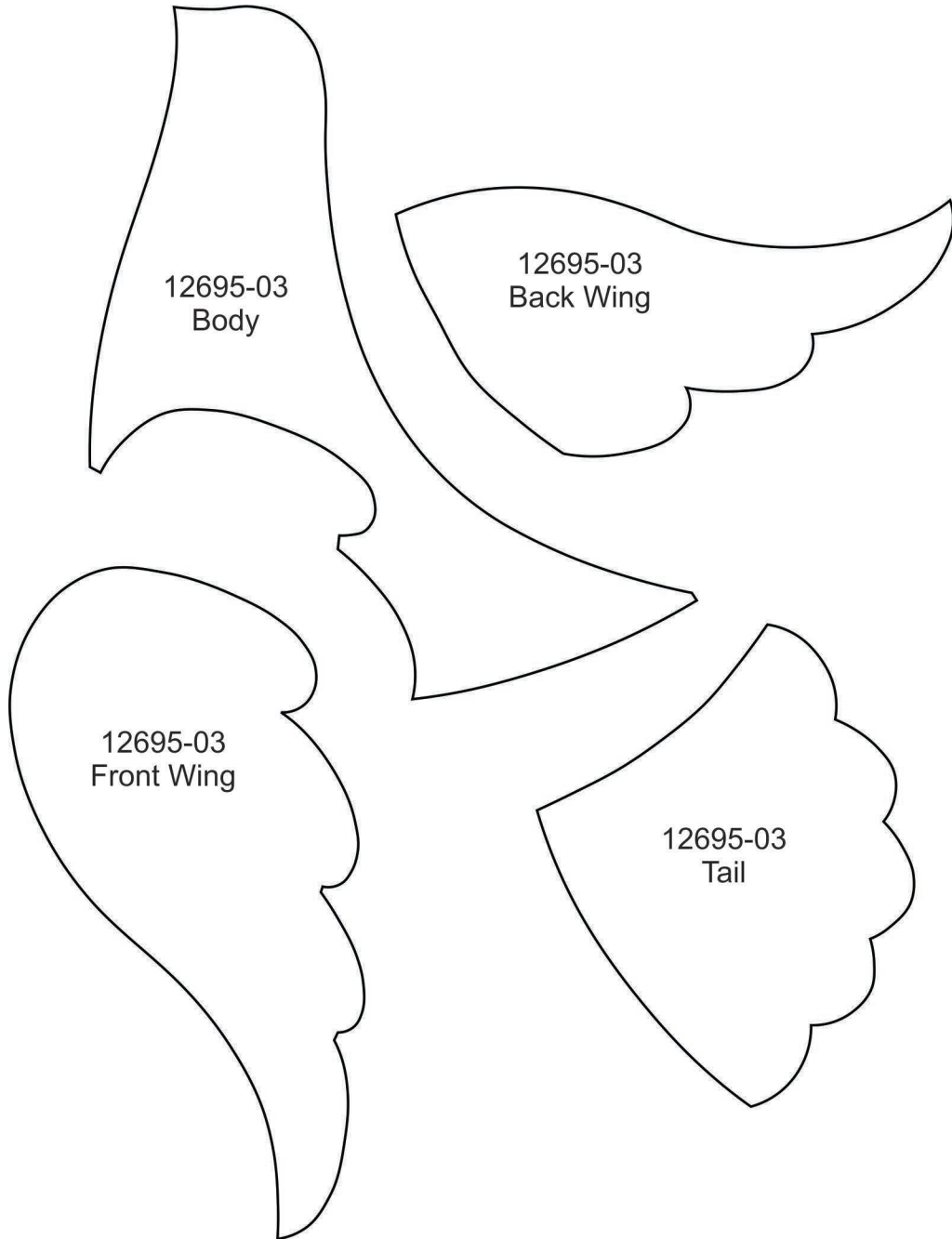

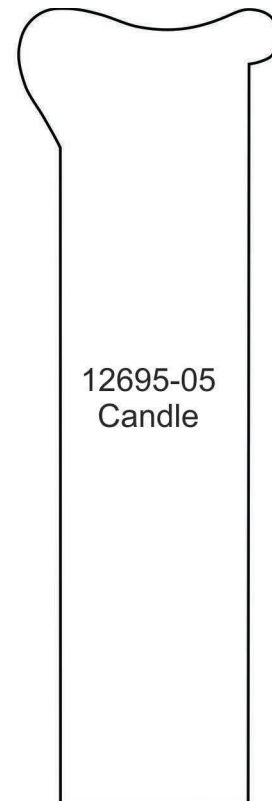
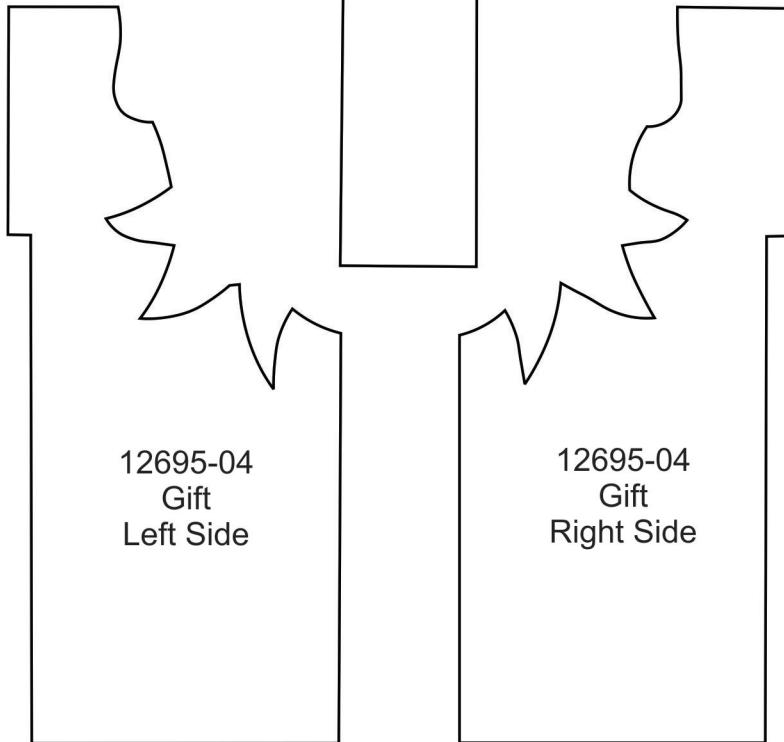
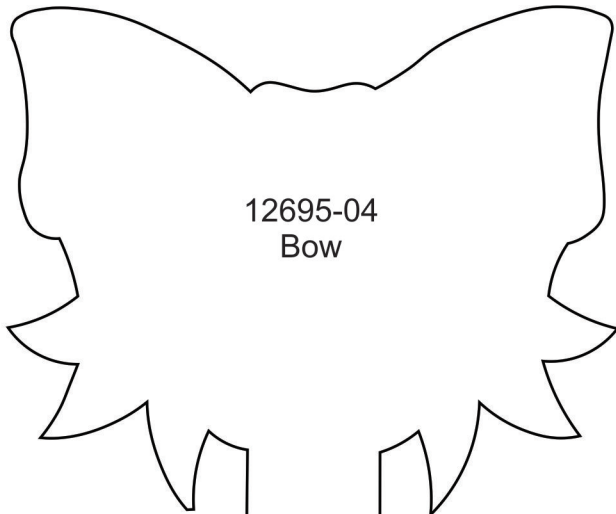

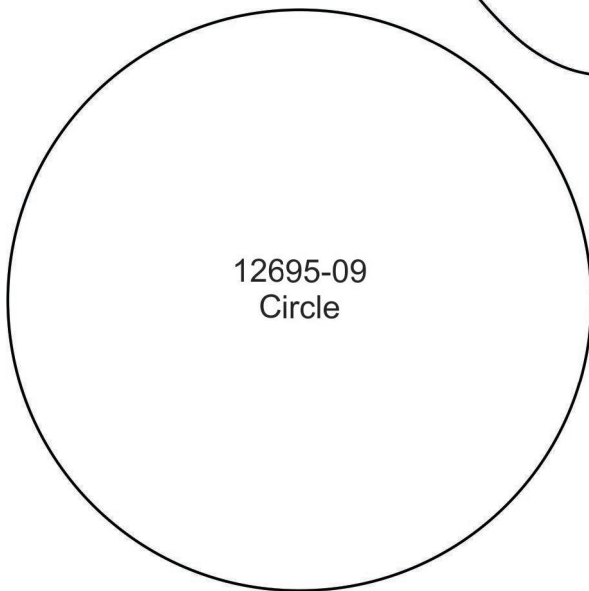
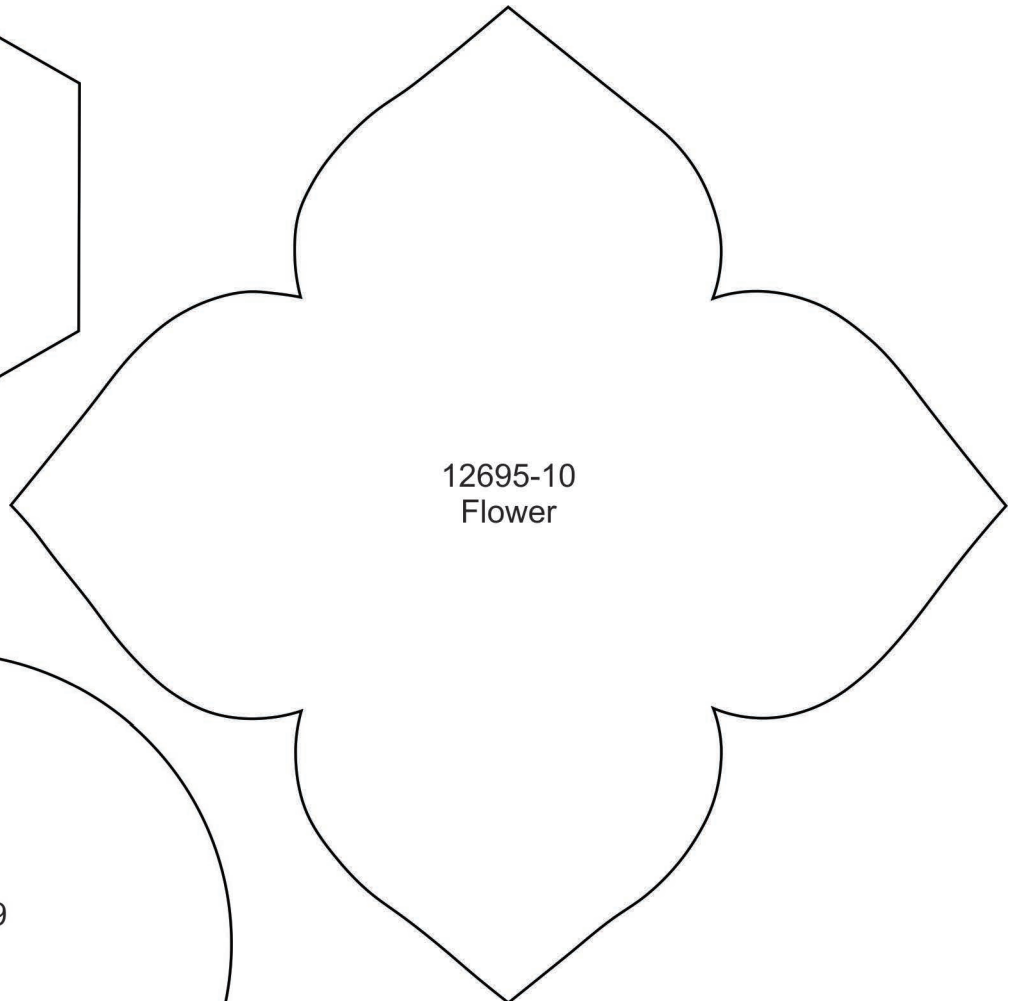
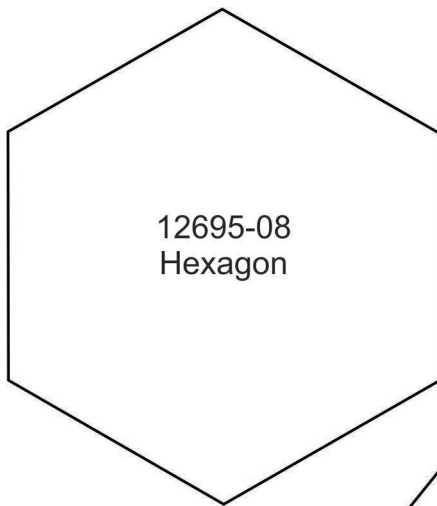
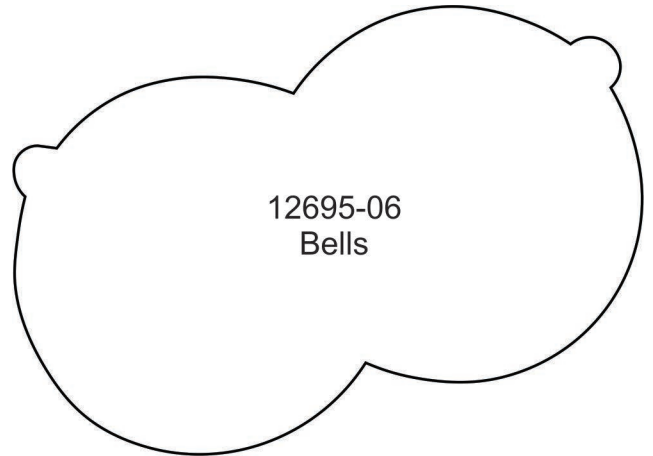
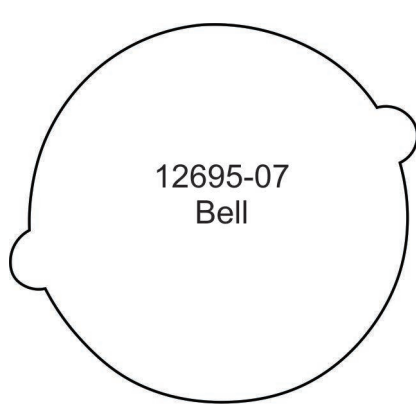

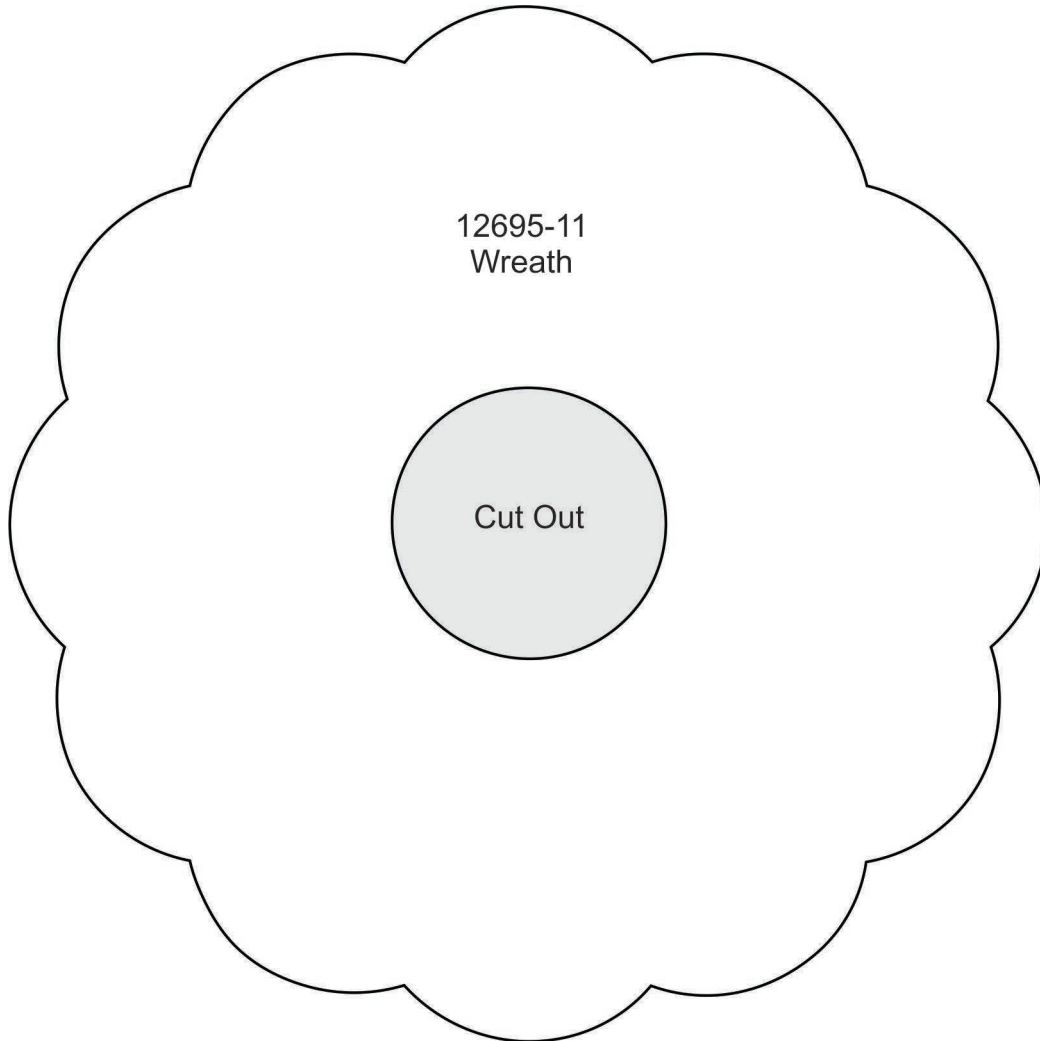

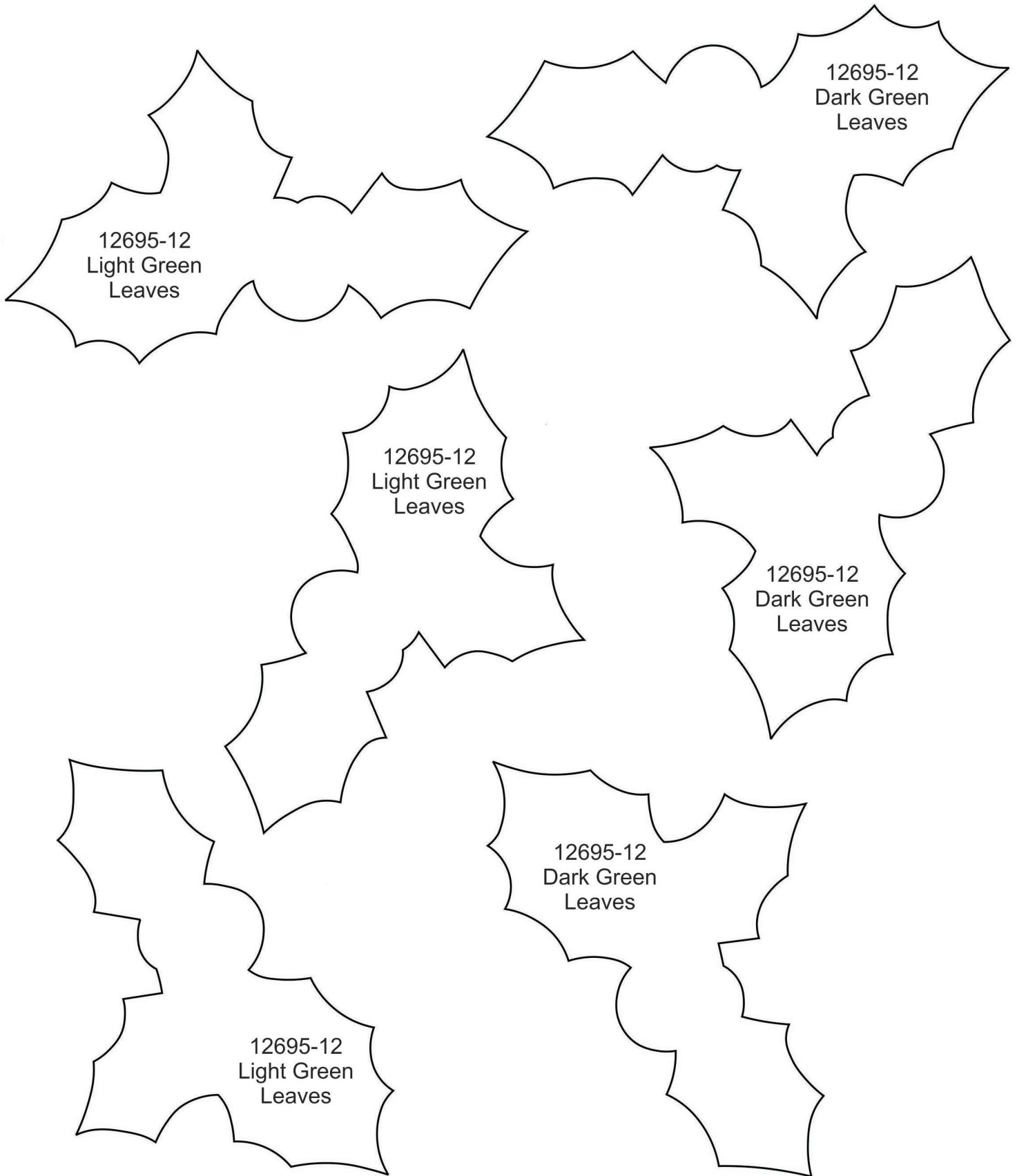

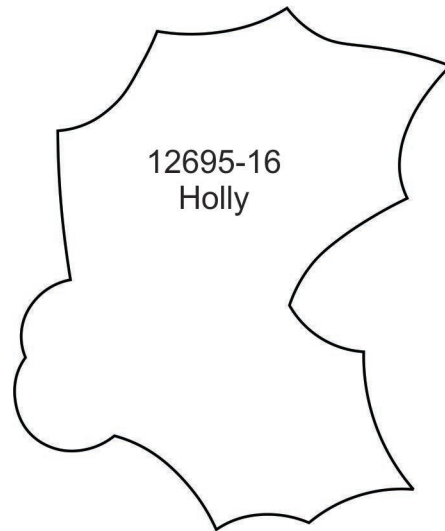
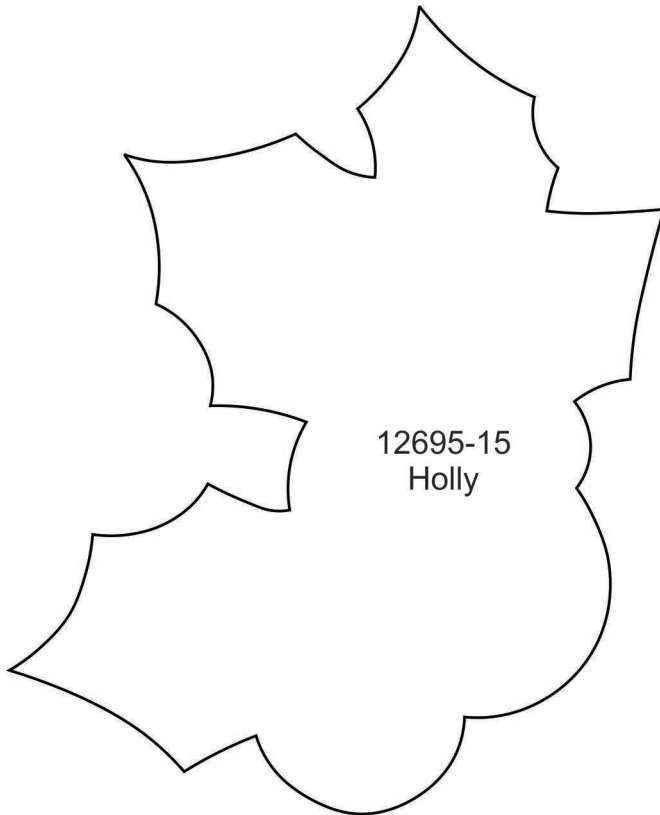
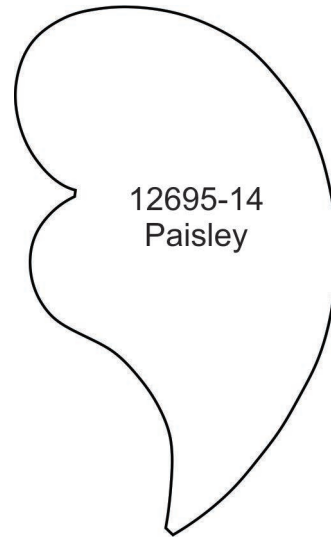
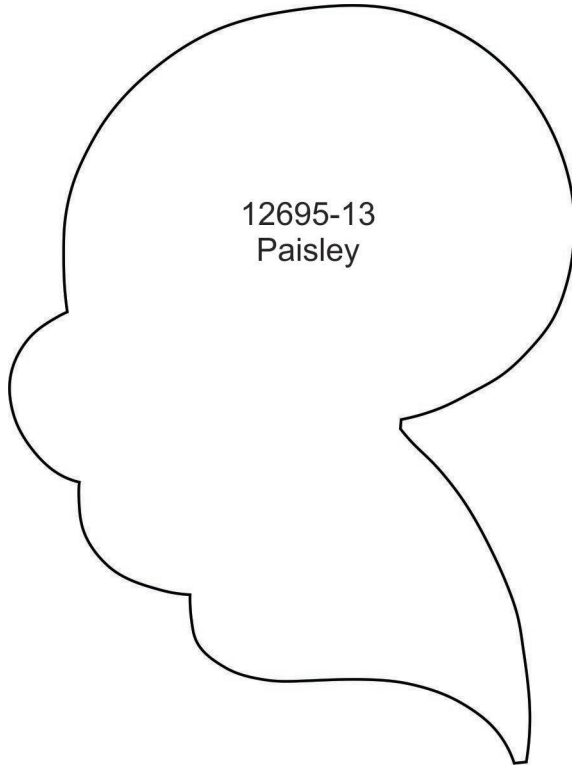

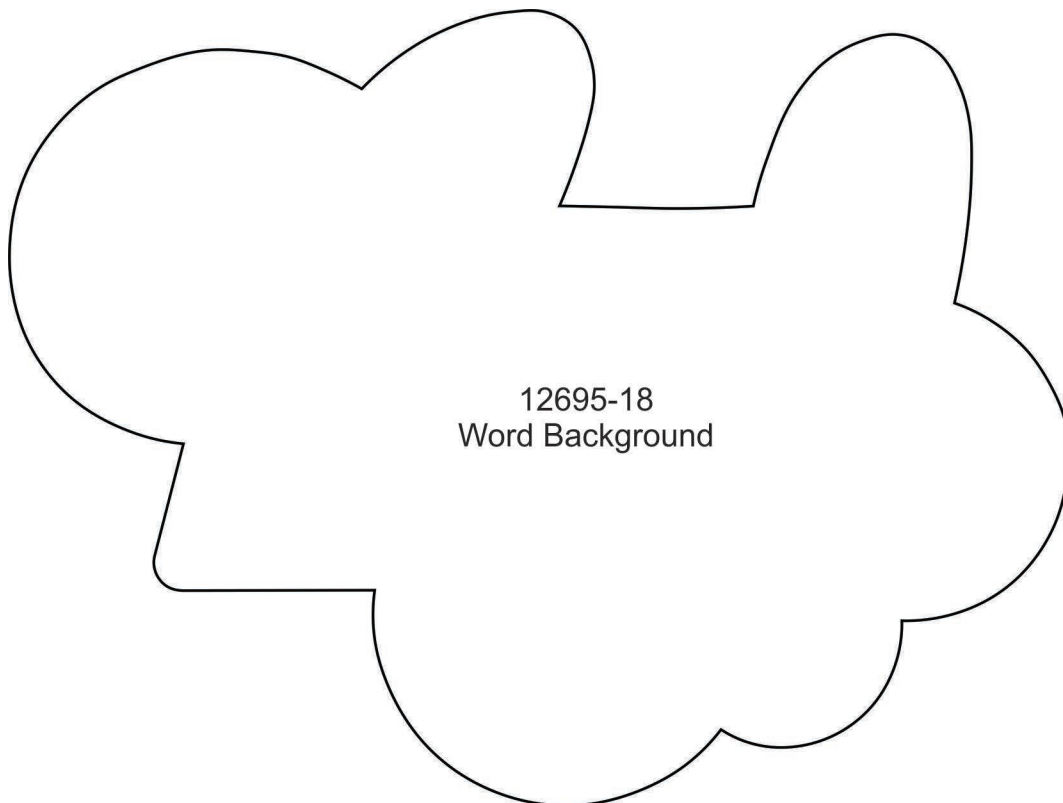
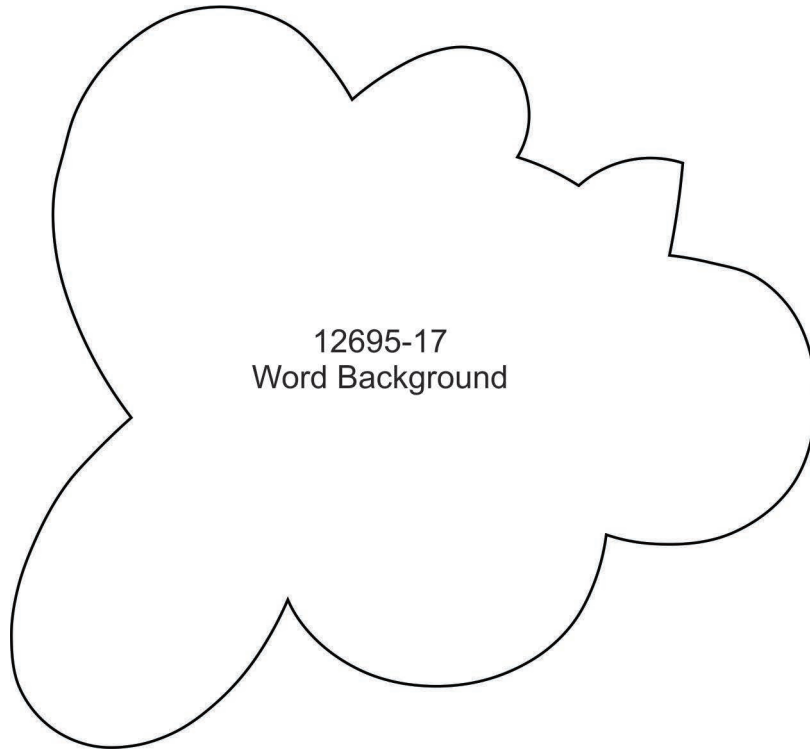

Supplies

- OESD embroidery collection Deck the Halls Applique
- Fabrics
 - $\frac{3}{4}$ yard red fabric
 - $\frac{3}{4}$ yard green fabric
- 2 - 10" x 14" pieces of cotton batting $\frac{3}{8}$ yard fabric for binding or 3 yards of pre-made binding
- 2 - 10" x 14" pieces of Insul-Brite
- Temporary spray adhesive
- Red and green cotton thread
- Embroidery machine

Cut

- Cut from each fabric 2 pieces 10" x 14".
- Cut 1 $\frac{3}{4}$ " wide strips of bias from each fabric to make at least 40 inches of bias from each fabric.

Embroider & Prepare Blocks

- For each fabric color, stack fabrics and batting as follows: fabric piece, Insul-Brite, cotton batting, 2nd fabric piece to make quilt sandwiches of each color. **Photo 1**
- Hoop the green quilt sandwich. Thread the bobbin with the red cotton thread to match the top thread. If your machine uses a different bobbin case or threading for embroidery, thread instead for regular stitching. Open design #38 in the machine and stitch the design.
- Repeat the process for the red quilt sandwich using green cotton thread and design #30.

Pot Holder Construction

- Centering the design, trim the green quilt sandwich into a 9 $\frac{1}{4}$ " square. **Photo 2**
- Round the corners using a corner rounding template or a drinking glass. **Photo 3**
- Using a walking foot, stitch around the quilt sandwich $\frac{1}{8}$ " inside the cut edge.
- Cut 5" of the red bias strip, fold in half and then fold the edges to the center.

Photo 4

- Fold the folded edges together and stitch along the two edges to form a strip for the pot holder loop.
- Place one end of the strip over the other to form a loop and place the raw edges of the loop at the corner of the pot holder on the back side over the dove's wings. Pin or clip in place. **Photo 5**

- Place the raw edge of the bias on the raw edge of the pot holder. Fold up a small hem at the beginning of the strip (the raw edge of the hem will be facing up). Begin stitching bias to the back side of the pot holder, starting at the folded edge of the hem. Use a $\frac{3}{8}$ " seam. Ease extra fabric into the corners of the pot holder to keep the corners from curling in when the pot holder is completed.

Photos 6 & 7

- Finish the stitching with the bias overlapping the beginning stitching about $\frac{3}{8}$ ". Trim the bias off where the stitching ends.
- Press the bias toward the edge of the pot holder. When the pot holder is turned

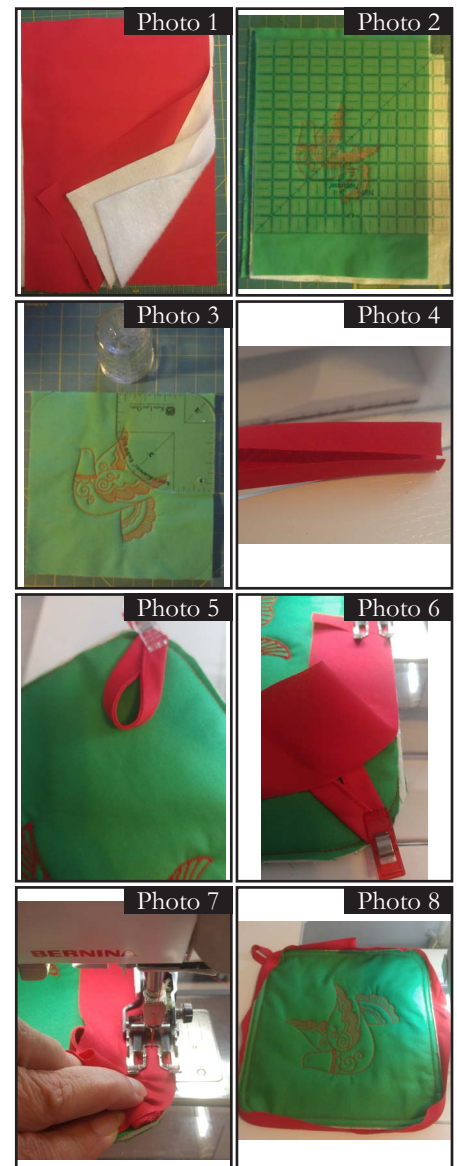

over it should look like **Photo 8**

- Fold the bias over the edge of the pot holder and fold in the raw edges to cover the stitching line. Clips are helpful for holding the bias in place to stitch. Edge stitch the bias in place to complete the pot holder. **Photo 9**
- Draw around a round object 9" in diameter on transparent paper or stabilizer to create a circle template for the red quilt sandwich. Center the template on the design and draw around the template for the outer edge of the circular potholder. **Photos 10 & 11**
- Before trimming around the circle, stitch 1/8" inside the circle with a walking foot. Now trim the marked circle.
- Use the same method as described above for adding the bias binding to the circle potholder. Note that with the circle potholder, the bias will need to be eased in around the entire circle. **Photo 12**

