

FREESTANDING MRS. CLAUS



1

Design

Fits hoop sizes 6" x 10" and larger

THREAD LIST



Isacord Thread Colors

0015 White
0145 Skylight
1060 Shrimp Pink
1430 Melon
1912 Winterberry
2101 Country Red
2155 Pink Tulip
4174 Charcoal

*** Project instructions included after design list.**

Note: One spool of 1000 meter thread is adequate for the project unless otherwise noted.

Table of Contents

Designs.....	3
Collection Supplies.....	11
Summary	12
Embroidery	13
Assembly	16
Freestanding Lace Instructions.....	21
Applique Patterns.....	23
Mirrored Patterns.....	28

Interactive menu

Click to navigate to section.

DESIGNS

Note: Some designs in this collection may have been created using unique special stitches and/or techniques. To preserve design integrity when rescaling or rotating designs in your software, always rescale or rotate designs using the handles directly on-screen.

*Fabric Required

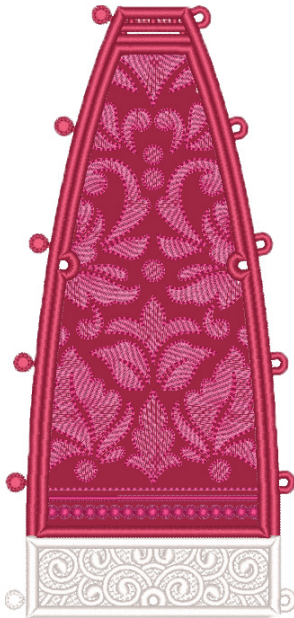

12762-01 Mrs. Claus Dress Slice 1 FSA

Size Inches: Size mm: Stitch Count:
3.39 X 7.12 in. 86.11 X 180.85 mm 31,226 St.

- 1. Placement Stitch..... 2101
- 2. Cut Line and Tackdown 2101
- 3. Outer Cover Stitch..... 2101
- 4. White Robe Detail 0015
- 5. Inner Robe Design Work 1912
- 6. Inner Cover Stitch..... 2101

*Fabric Required



12762-02 Mrs. Claus Dress Slice 2 FSA

Size Inches: Size mm: Stitch Count:
3.39 X 7.12 in. 86.11 X 180.85 mm 34,600 St.

- 1. Placement Stitch 2101
- 2. Cut Line and Tackdown 2101
- 3. Outer Cover Stitch..... 2101
- 4. White Robe Detail 0015
- 5. Inner Robe Design Work 1912
- 6. Inner Cover Stitch..... 2101

Note: Some designs in this collection may have been created using unique special stitches and/or techniques. To preserve design integrity when rescaling or rotating designs in your software, always rescale or rotate designs using the handles directly on-screen.

***Fabric Required**

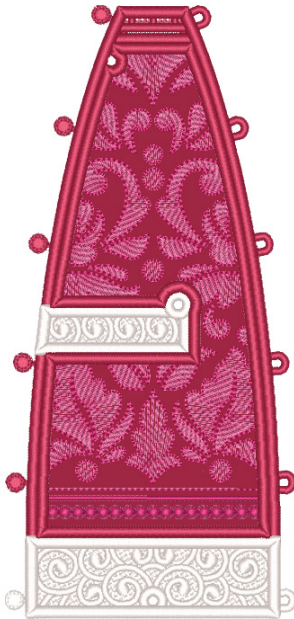

12762-03 Mrs. Claus Dress Slice 3 FSA

Size Inches: Size mm: Stitch Count:
3.39 X 7.12 in. 86.11 X 180.85 mm 34,570 St.

- 1. Placement Stitch 2101
- 2. Cut Line and Tackdown 2101
- 3. Outer Cover Stitch 2101
- 4. White Robe Detail 0015
- 5. Inner Robe Design Work 1912
- 6. Inner Cover Stitch..... 2101

***Fabric Required**

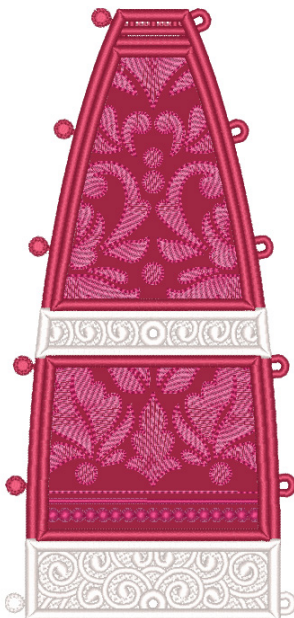

12762-04 Mrs. Claus Dress Slice 4 FSA

Size Inches: Size mm: Stitch Count:
3.39 X 7.12 in. 86.11 X 180.85 mm 35,519 St.

- 1. Placement Stitch 2101
- 2. Cut Line and Tackdown 2101
- 3. Outer Cover Stitch 2101
- 4. White Robe Detail 0015
- 5. Inner Robe Design Work 1912
- 6. Inner Cover Stitch..... 2101

Note: Some designs in this collection may have been created using unique special stitches and/or techniques. To preserve design integrity when rescaling or rotating designs in your software, always rescale or rotate designs using the handles directly on-screen.

***Fabric Required**

12762-05 Mrs. Claus Apron FSA

Size Inches: Size mm: Stitch Count:
2.80 X 5.41 in. 71.12 X 137.41 mm 24,182 St.

- 1. Placement Stitch 0015
- 2. Cut Line and Tackdown 0015
- 3. Design Work and Cover Stitch 0015



***Fabric Required**

12762-06 Mrs. Claus Arms FSA

Size Inches: Size mm: Stitch Count:
3.40 X 6.19 in. 86.36 X 157.23 mm 22,748 St.

- 1. Placement Stitch 1912
- 2. Cut Line and Tackdown 1912
- 3. Inner Sleeve Design Work..... 1912
- 4. Sleeve Cover Stitch..... 2101
- 5. Gloves and Sleeve Trim 0015



Note: Some designs in this collection may have been created using unique special stitches and/or techniques. To preserve design integrity when rescaling or rotating designs in your software, always rescale or rotate designs using the handles directly on-screen.

12762-07 Mrs. Claus Apron Bow FSL

Size Inches: Size mm: Stitch Count:
2.77 X 2.34 in. 70.36 X 59.44 mm 10,948 St.

1. Single Color Design..... 0015



*Fabric Required

12762-08 Mrs. Claus Face FSA

Size Inches: Size mm: Stitch Count:
1.92 X 4.05 in. 48.77 X 102.87 mm 7,494 St.

1. Placement Stitch 1060
 2. Cut Line and Tackdown 1060
 3. Tab and Face Cover Stitch 1060
 4. Hair 0015
 5. Cheeks 2155
 6. Eyes and Mouth 4174
 7. Nose 1430
 8. Lenses 0015
 9. Frames 0145



Note: Some designs in this collection may have been created using unique special stitches and/or techniques. To preserve design integrity when rescaling or rotating designs in your software, always rescale or rotate designs using the handles directly on-screen.

***Fabric Required**

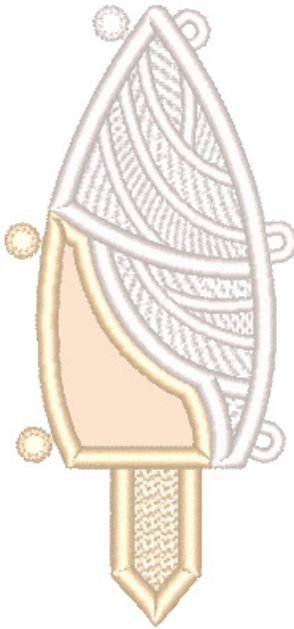

12762-09 Mrs. Claus Hair & Face 1 FSA

Size Inches: Size mm: Stitch Count:
1.92 X 4.08 in. 48.77 X 103.63 mm 9,079 St.

- 1. Placement Stitch 1060
- 2. Cut Line and Tackdown 1060
- 3. Tab and Face Cover Stitch 1060
- 4. Hair 0015

***Fabric Required**



12762-10 Mrs. Claus Hair & Face 2 FSA

Size Inches: Size mm: Stitch Count:
1.92 X 4.06 in. 48.77 X 103.12 mm 9,053 St.

- 1. Placement Stitch 1060
- 2. Cut Line and Tackdown 1060
- 3. Tab and Face Cover Stitch 1060
- 4. Hair 0015

Note: Some designs in this collection may have been created using unique special stitches and/or techniques. To preserve design integrity when rescaling or rotating designs in your software, always rescale or rotate designs using the handles directly on-screen.

12762-11 Mrs. Claus Hair FSL

Size Inches: Size mm: Stitch Count:
1.92 X 4.08 in. 48.77 X 103.63 mm 9,789 St.

1. Single Color Design..... 0015



12762-12 Mrs. Claus Dress Collar FSL

Size Inches: Size mm: Stitch Count:
4.15 X 3.91 in. 105.41 X 99.31 mm 17,537 St.

1. Single Color Design..... 0015



Note: Some designs in this collection may have been created using unique special stitches and/or techniques. To preserve design integrity when rescaling or rotating designs in your software, always rescale or rotate designs using the handles directly on-screen.

***Fabric Required**

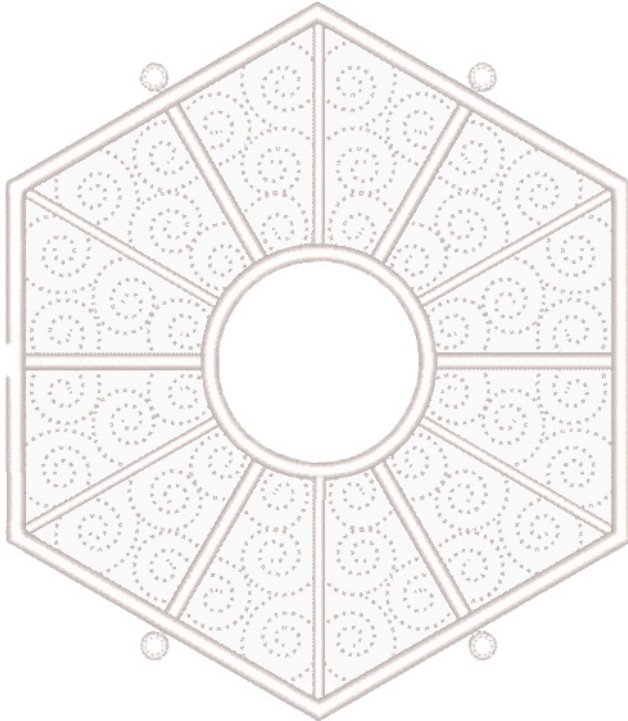

12762-13 Mrs. Claus Foundation FSA

Size Inches: Size mm: Stitch Count:
5.57 X 5.85 in. 141.48 X 148.59 mm 17,748 St.

- 1. Placement Stitch 0015
- 2. Cut Line and Tackdown 0015
- 3. White Detail and Cover Stitch 0015

***Fabric Required**



12762-14 Mrs. Claus Bonnet Top FSA

Size Inches: Size mm: Stitch Count:
3.65 X 3.81 in. 92.71 X 96.78 mm 10,933 St.

- 1. Placement Stitch 1912
- 2. Cut Line and Tackdown 0015
- 2. Buttonettes 0015
- 4. Inner Hat Design Work 1912
- 3. Cover Stitch 2101

Note: Some designs in this collection may have been created using unique special stitches and/or techniques. To preserve design integrity when rescaling or rotating designs in your software, always rescale or rotate designs using the handles directly on-screen.

12762-15 Mrs. Claus Bonnet Bottom FSL

Size Inches: Size mm: Stitch Count:
3.95 X 4.48 in. 100.33 X 113.8 mm 16,580 St.

1. Single Color Design..... 0015



Stabilizers

- OESD AquaMesh WashAway
- OESD BadgeMaster WashAway
- OESD StabilStick CutAway

Fabrics/Textiles

- Red quilter's cotton ¼ yard
- White quilter's cotton (1) 6" x 6"
- Skin Tone quilter's cotton (1) 7.5" x 6"
- Note: Fabric sizes are estimates and may result in overage.

Notions & Tools

- OESD Alligator Clamps
- OESD Button Clips
- OESD Expert Embroidery Tape WashAway
- OESD Expert Point and Press Tool
- OESD Perfect Embroidery Press Cloth
- Embroidery Needle Sharp 75/11

Isacord Thread Colors

- Per thread chart
- Match the bobbin thread to the upper thread.

SUMMARY



Completed Size: 9" H x 6" W x 6" D

<p>12762-01</p> <p>Requires 1 Design</p>	<p>12762-02</p> <p>Requires 1 Design</p>	<p>12762-03</p> <p>Requires 1 Design</p>	<p>12762-04</p> <p>Requires 3 Designs</p>	<p>12762-05</p> <p>Requires 1 Design</p>
<p>12762-06</p> <p>Requires 1 Design</p>	<p>12762-07</p> <p>Requires 1 Design</p>	<p>12762-08</p> <p>Requires 1 Design</p>	<p>12762-09</p> <p>Requires 1 Design</p>	<p>12762-10</p> <p>Requires 1 Design</p>
<p>12762-11</p> <p>Requires 1 Design</p>	<p>12762-12</p> <p>Requires 1 Design</p>	<p>12762-13</p> <p>Requires 1 Design</p>	<p>12762-14</p> <p>Requires 1 Design</p>	<p>12762-15</p> <p>Requires 1 Design</p>
<p>12762-16</p> <p>Requires 3 Designs</p>	<p>12762-17</p> <p>Requires 1 Design</p>	<p>12762-18</p> <p>Requires 1 Design</p>	<p>12762-19</p> <p>Requires 1 Design</p>	<p>12762-20</p> <p>Requires 1 Design</p>

Notes

The freestanding applique instructions, included in the collection, are general instructions. For demonstration purposes, a sample design that best demonstrates the technique is shown. Fabric and thread requirements will vary by design, but the general technique is the same.

All designs are stitched with matching thread, top and bobbin.

Note: Some thread colors in instructions have been changed or digitally enhanced for better visibility.

STEP 1

- Hoop one layer of AquaMesh and one layer of BadgeMaster in the hoop for all designs.



STEP 2

- Adhere two layers of StabilStick CutAway to the wrong side of all applique fabrics, to provide stiffness to the finished structure.

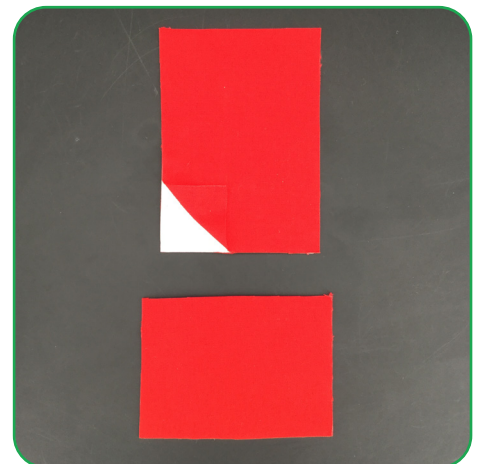

EMBROIDERY



STEP 3

- Load selected design into the machine.
- Example design is 12762-04.
- Thread the machine per the thread chart.
- Place hoop on the machine.
- Stitch Machine Step 1, Placement Stitch.

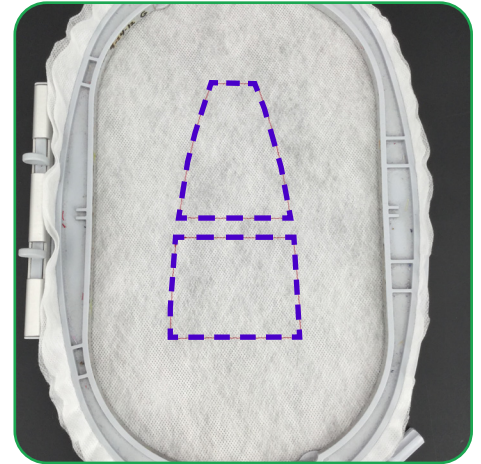

STEP 4

- Remove the hoop from the machine, but NOT the project from the hoop.
- Lay the hoop on a flat surface.
- Completely cover the placement stitch with the prepared fabric.
- Tape in place to secure.

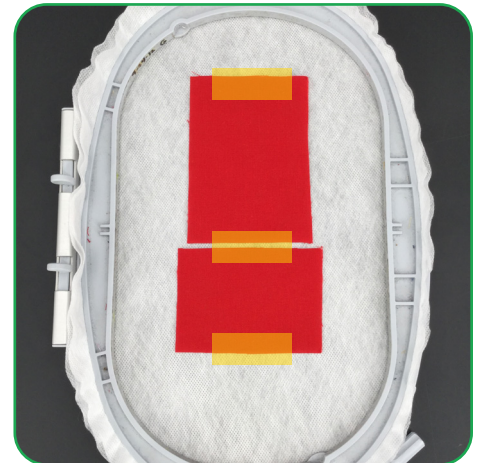

STEP 5

- Place the hoop on the machine.
- Stitch Machine Step 2, Cut Line and Tackdown.

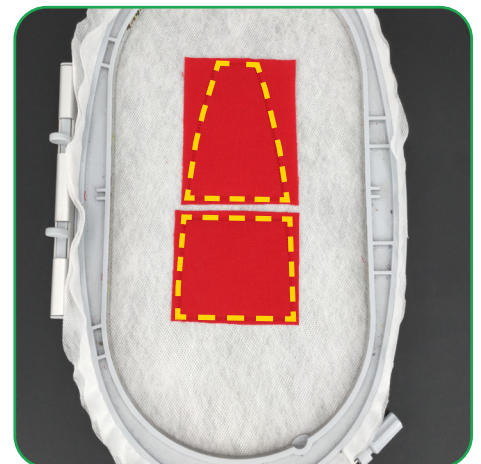

EMBROIDERY



STEP 6

- Remove the hoop from the machine, but NOT the project from the hoop.
- Trim the excess fabric as close to the cut line as possible. If the outermost stitches (cut line) are cut, the inner stitches (tackdown) will hold the applique in place.
- Tip: If the AquaMesh is cut or a hole is created while trimming the fabric, use OESD Expert Embroidery Tape WashAway as a patch.



STEP 7

- Return the hoop to the machine and stitch the remaining machine steps, per the thread chart.



ASSEMBLY



STEP 8

- When the design is complete, remove the project from the hoop and trim the stabilizer 1/4" - 1/2" outside the design.
- Rinse each piece in warm running water until the design is only slightly tacky.
- Lay right side down on a non-stick surface to dry. Parchment paper or a cooling rack work well to prevent curling. Dry completely.
- Once dry, press right side down on a Perfect Embroidery Press Cloth



STEP 9

- Lay out Mrs. Claus Dress sections as shown starting with Mrs. Claus Dress Slice 3 FSA (12762-03), Mrs. Claus Dress Slice 1 FSA (12762-01) Mrs. Claus Dress Slice 2 FSA (12762-02) and three Mrs. Claus Dress Slice 4 FSA (12762-04). Match the eyelets to the buttonettes. Pull each buttonette through the corresponding eyelet. Attach a button clip to hold the buttonettes in place temporarily, when needed.



ASSEMBLY



STEP 10

- Attach Mrs. Claus Apron Bow FSL (12762-07) buttonette to Mrs. Claus Dress Slice 4 FSA (12762-04) center eyelet.



STEP 11

- Attach Mrs. Claus Apron FSA buttonettes to the corresponding eyelets of Mrs. Claus Dress Slice 3 FSA (12762-02) and Mrs. Claus Dress Slice 4 (12762-03).



STEP 12

- Attach Mrs. Claus Arm FSA (12762-06) to Mrs. Claus Dress Slice 3 FSA (12762-03). Match the two buttonettes to the two eyelets on the right. Pull each buttonette through the corresponding eyelet. Repeat the process for the left side by attaching Mrs. Claus Arm FSA (12762-06) to Mrs. Claus Dress Slice 2 FSA (12762-02).



STEP 13

- Attach head sections by lining up Mrs. Claus Hair and Face 2 (12762-10), Mrs. Claus Face FSA (12762-08), Mrs. Claus Hair and Face 1 FSA (12762-09), and three of Mrs. Claus Hair FSL (12762-11).
- Note: Pull buttonettes inside the head to create a smooth blemish free shape.

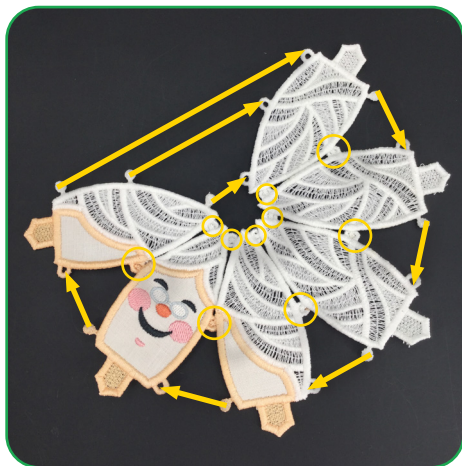

ASSEMBLY



STEP 14

- Insert the tabs of the Mrs. Claus head into the corresponding tab entries of the Mrs. Claus body.
- Tip: Once all six tabs are halfway inserted, pull tabs from inside the Mrs. Claus body into the tab entries to secure.
- Note: After putting the tabs into the slots, twist them slightly to help them stay in place, or use button clips to temporarily hold in place.



STEP 15

- Wrap Mrs. Claus Dress Collar (12762-12) around the Mrs. Claus neck. Pull the buttonette located at the back of the collar through the corresponding eyelet.



STEP 16

- Attach the Mrs. Claus Foundation FSA (12762-13) buttonettes to the Mrs. Claus body eyelets.



STEP 17

- Attach Mrs. Claus Bonnet Top FSA (12762-14) buttonettes to and Mrs. Claus Bonnet Bottom FSL (12762-15).
- Connect the back buttonette of the ruffle to the corresponding eyelet.

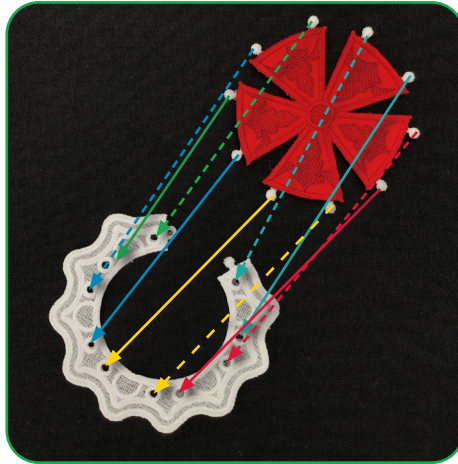

Finishing Touches

- Place the Mrs. Claus bonnet onto Mrs. Claus's head.
- Add tea lights or pixie lights to create a glow.



Stabilizer

- OESD AquaMesh
- OESD BadgeMaster

Notions/Tools

- 80/12 Embroidery Ballpoint Titanium needle for extended needle life
- OESD Alligator Clamps
- OESD Button Clips
- OESD Perfect Point and Press Tool

Isacord Thread Colors

- All OESD designs are digitized with Isacord 40 wt. polyester thread as the top thread and in the bobbin.
- Refer to the thread chart for color specifications.
- Match bobbin thread color to the top thread.

Instructions

Step 1 - Hoop

For FSL structures, hoop one layer of OESD AquaMesh and one layer of OESD BadgeMaster. BadgeMaster contains more starch so, combined with the AquaMesh, the lace is more rigid. For other FSL, where a softer lace is desired, hoop two layers of AquaMesh.

Step 2 - Embroider

Stitch the design per the thread chart with matching thread in the bobbin at each color change. When complete, remove from the hoop and trim away excess stabilizer about 1/4"-1/2" from the stitching.

Step 3 - Rinse

Rinse remaining stabilizer out in warm running water. For stiffer lace and FSL structures, DO NOT rinse away all of the stabilizer. The lace should be just slightly tacky. For softer lace, rinse until all traces of the stabilizer are removed.

Step 4 - Dry

Lay right side down flat on a non-stick surface, such as a cooling rack, parchment paper or Teflon sheet. This minimizes the tendency for the lace to curl. Let the pieces dry completely before proceeding with any assembly.

Step 5 - Press

Once completely dry, press right side down on a OESD Perfect Embroidery Press Cloth.

Step 6 - Assemble Structure

Note: Specific assembly instructions for a design/collection may be found in the thread chart pdf following the individual design color charts.

Lace must be COMPLETELY DRY before assembly. Wetting the buttonettes or eyelets to assemble is not recommended and may result in them stretching and coming "unbuttoned" when dry.

Use a pair of OESD Alligator Clamps to insert the buttonettes into the eyelets. Insert the tip of the OESD Alligator Clamps into the eyelet, grasp the buttonette and pull through the eyelet. Alternatively, use a stiletto or tweezers to push the buttonette through the eyelet.

Helpful Tips

Limp Lace

If the design is not stiff enough, press the lace pieces on the wrong side while applying spray starch. After ironing, spray again with starch and allow to dry completely. This will stiffen the lace pieces nicely and aid in construction. Or easily re-stiffen by diluting some stabilizer scraps in water (or use liquid starch) and dipping the item in the solution. Lay flat to dry.

Eyelets Too Small

If any of the eyelets appear closed or too small to penetrate with Alligator Clamps, they may be stretched by inserting the small end of the OESD Perfect Point and Press Tool into the eyelet opening and stretching it open wide enough to accommodate the OESD Alligator Clamps.

Button Clips

During the assembly process, some structures pull on buttonettes that have already been inserted and could pull them out altogether. Putting a Button Clip on the assembled buttonette will keep it in position during the assembly process. Remove the Button Clips when the assembly is complete.

Alternative Construction Option

In some cases, the buttonettes may be pulled to the inside of a project, instead of being visible on the outside. Insert the OESD Alligator Clamps through the eyelet from the wrong, or inside, of the lace and grasp the corresponding buttonette. Pull the buttonette to the wrong side of the lace. Pulling the buttonettes to the inside may cause stress on the ones already done. Button clips may be placed on the completed buttonette(s) to prevent them from pulling out of the eyelet during construction.

ATTENTION

When printing this document, any page scaling or page fitting options in your print dialog box must be turned OFF or set to NONE so that your files will print out at their actual size. Images not printed at actual size will not function as intended.

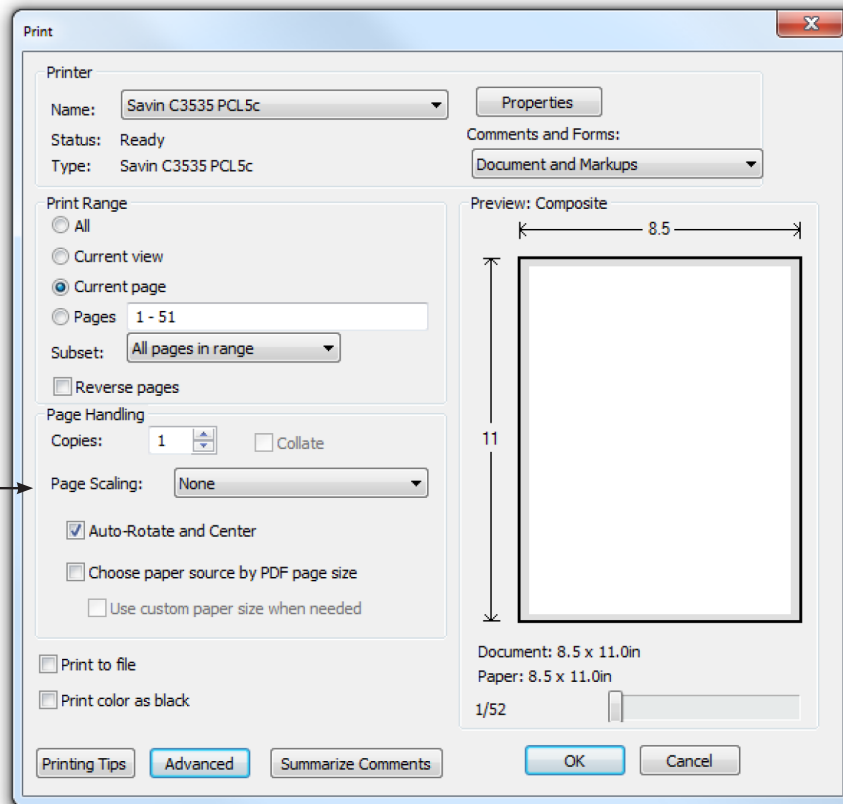

TO SAVE PAPER

Only print the desired image by navigating to the image's page, go to File > Print and select "Current page" in the print dialog box. Repeat for each desired image.

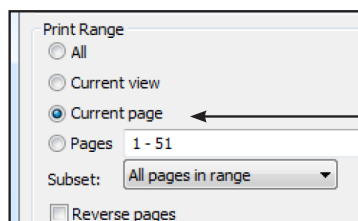

APPLIQUE PATTERNS



Print at 100%. No scaling. This box measures 1" x 1". Use the box as an accuracy guide when printing templates.

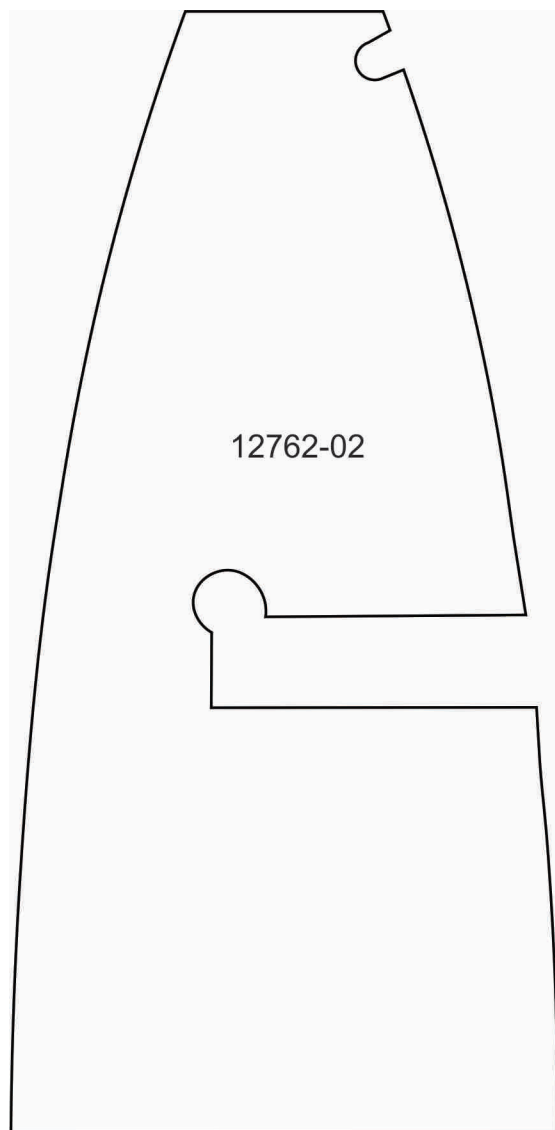
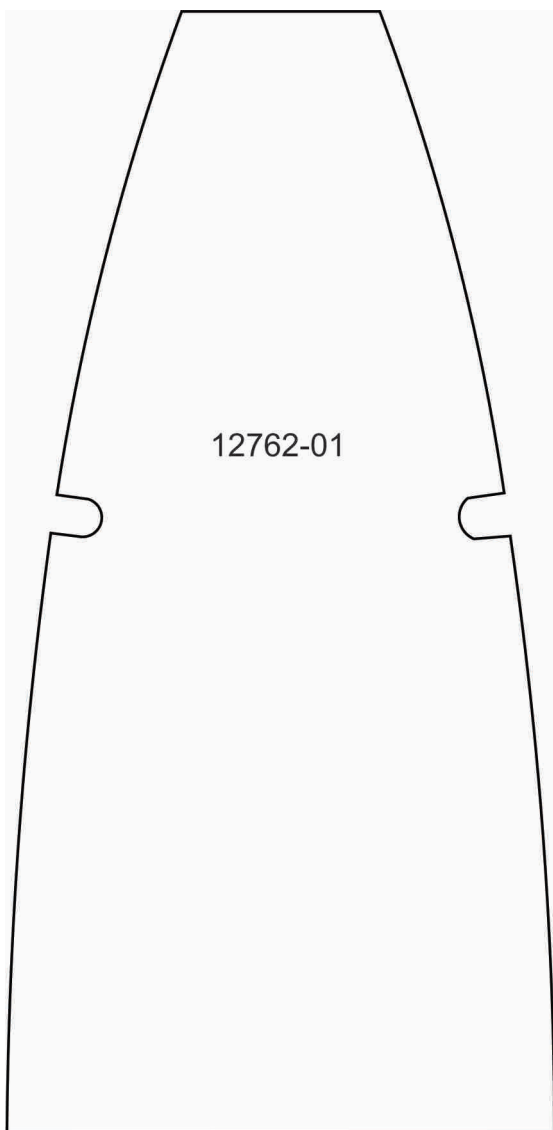

APPLIQUE PATTERNS



Print at 100%. No scaling. This box measures 1" x 1". Use the box as an accuracy guide when printing templates.

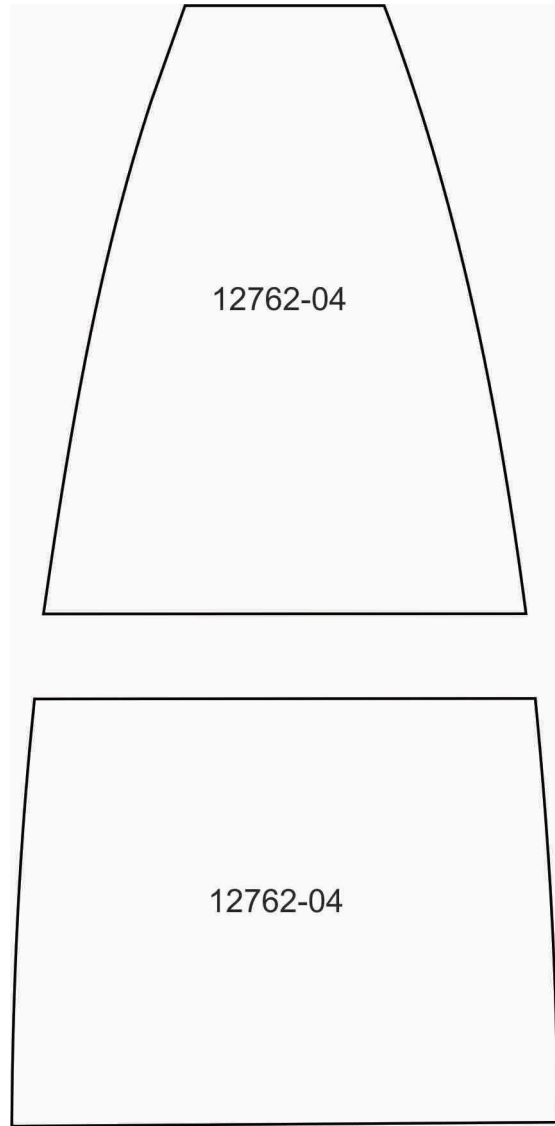
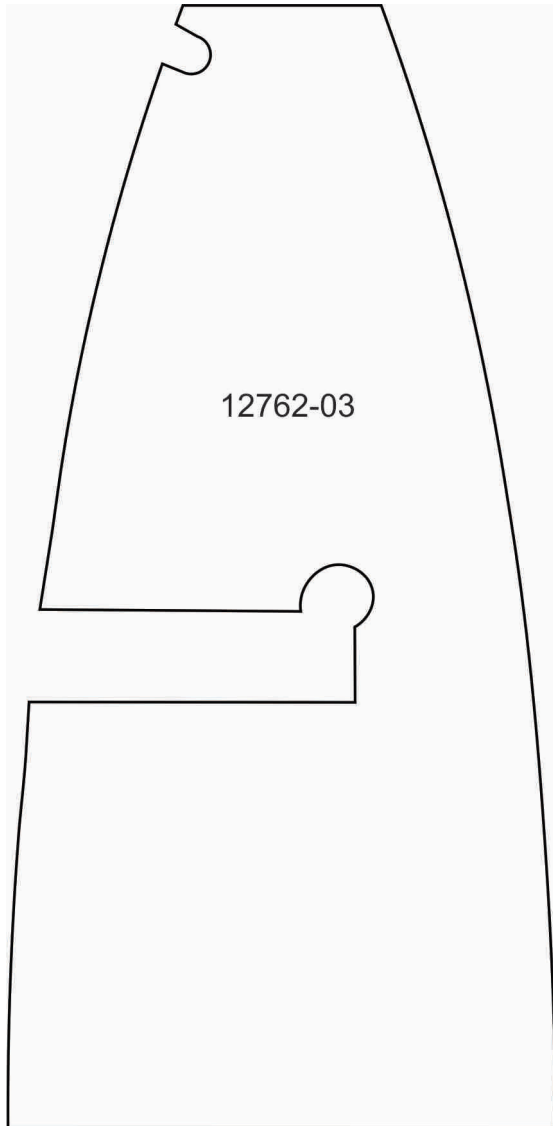

APPLIQUE PATTERNS



Print at 100%. No scaling. This box measures 1" x 1". Use the box as an accuracy guide when printing templates.

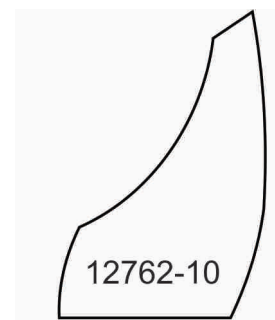
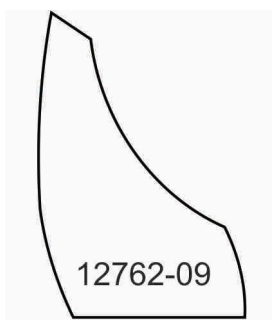
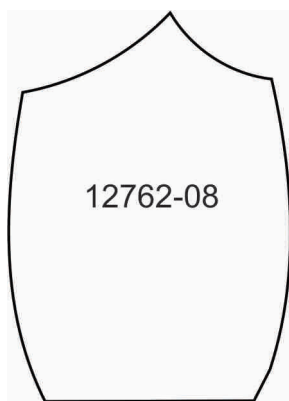
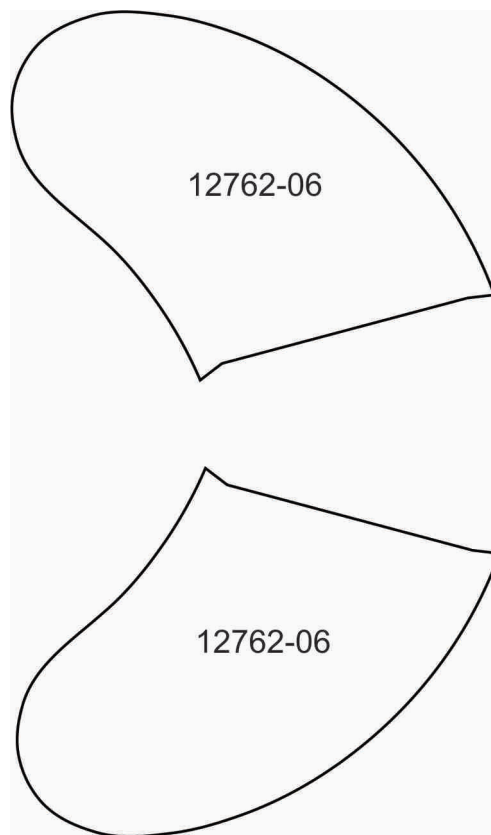

APPLIQUE PATTERNS



Print at 100%. No scaling. This box measures 1" x 1". Use the box as an accuracy guide when printing templates.

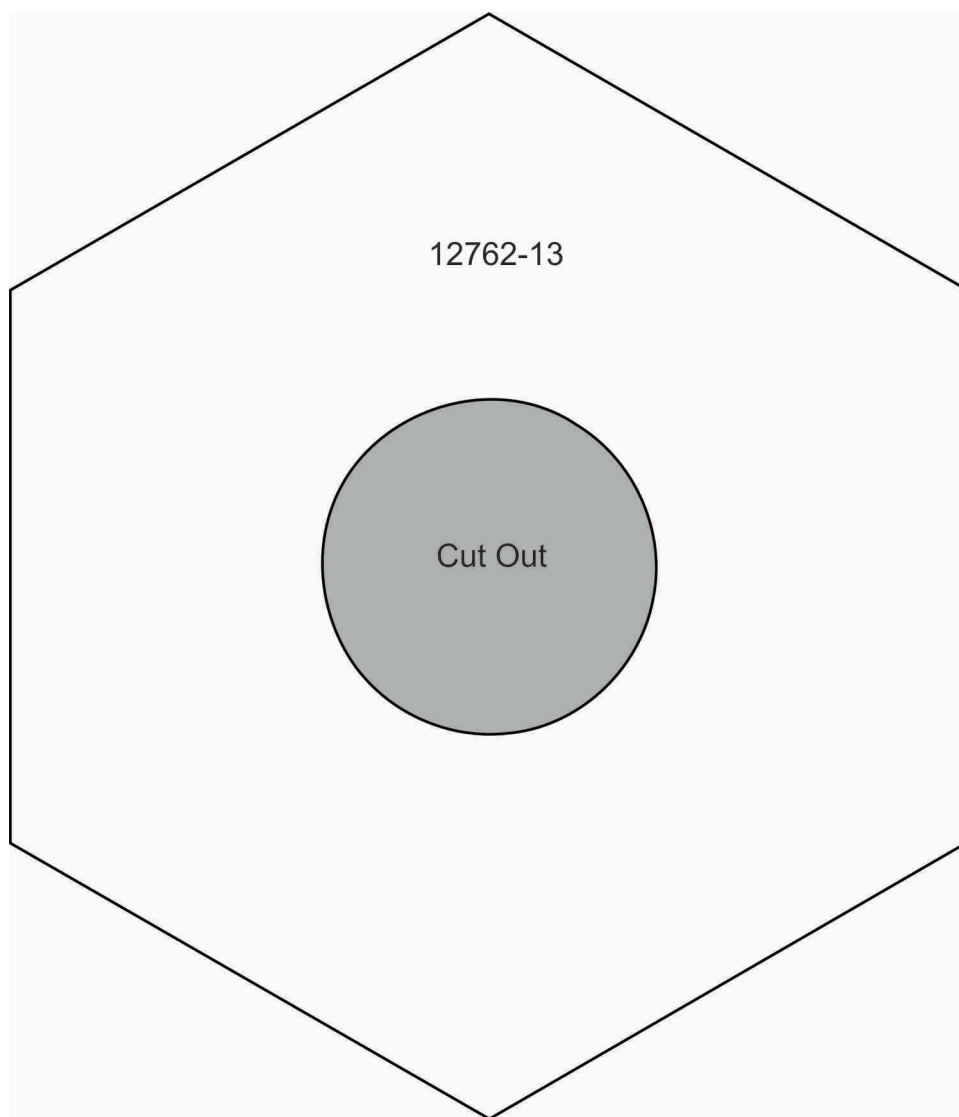

APPLIQUE PATTERNS



Print at 100%. No scaling. This box measures 1" x 1". Use the box as an accuracy guide when printing templates.

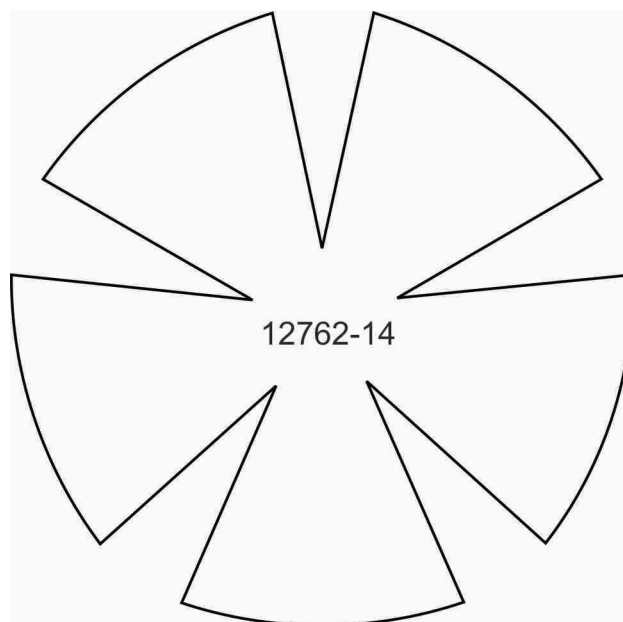

MIRRORED PATTERNS



Print at 100%. No scaling. This box measures 1" x 1". Use the box as an accuracy guide when printing templates.

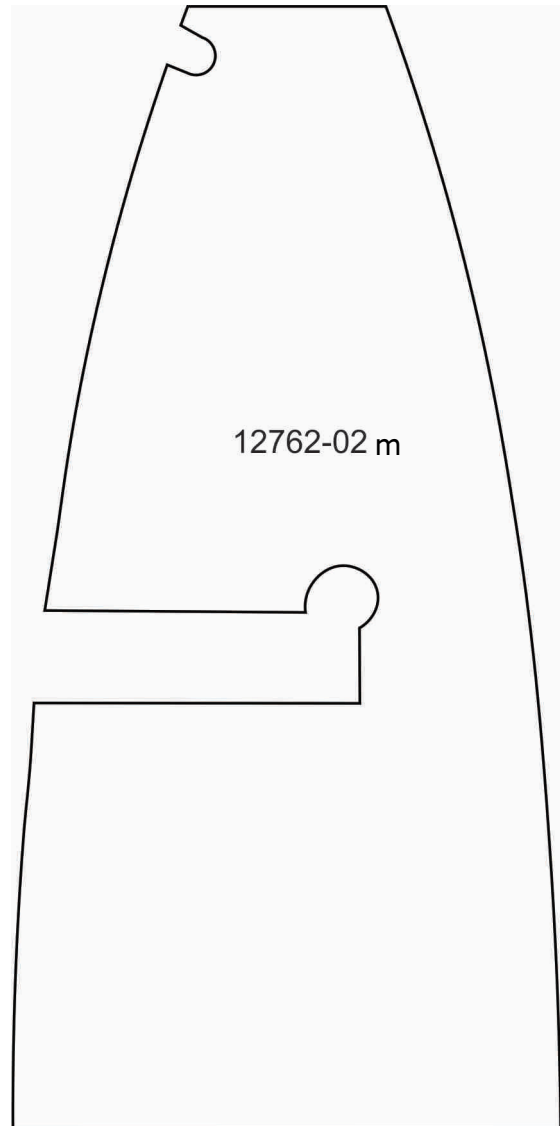
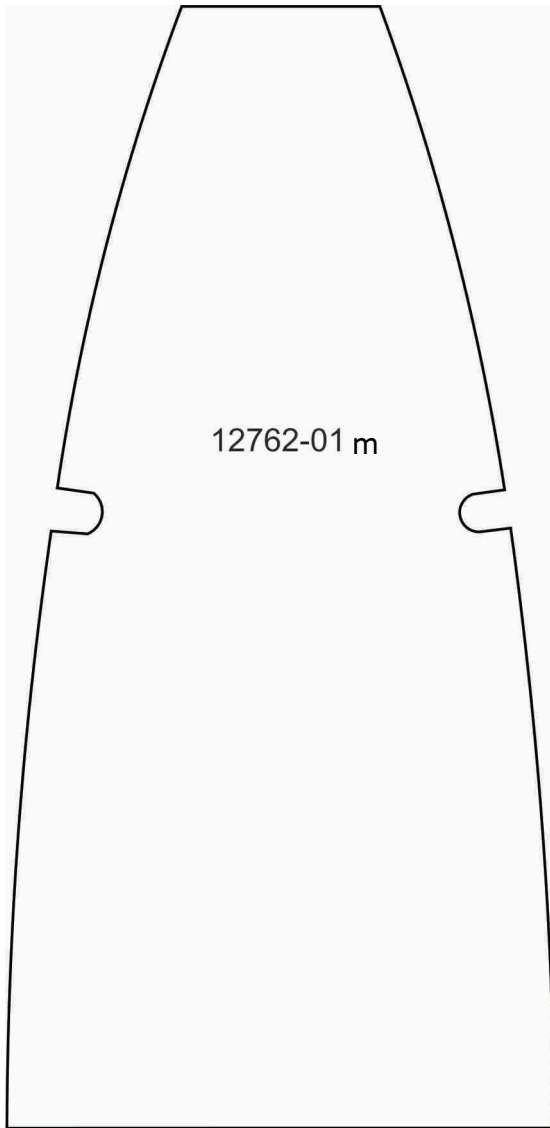

MIRRORED PATTERNS



Print at 100%. No scaling. This box measures 1" x 1". Use the box as an accuracy guide when printing templates.

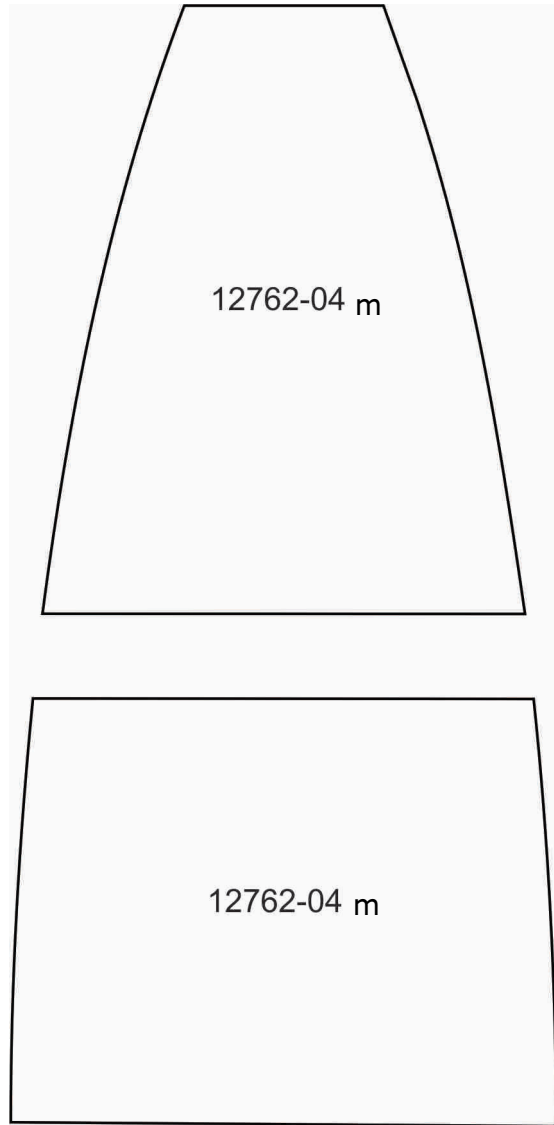
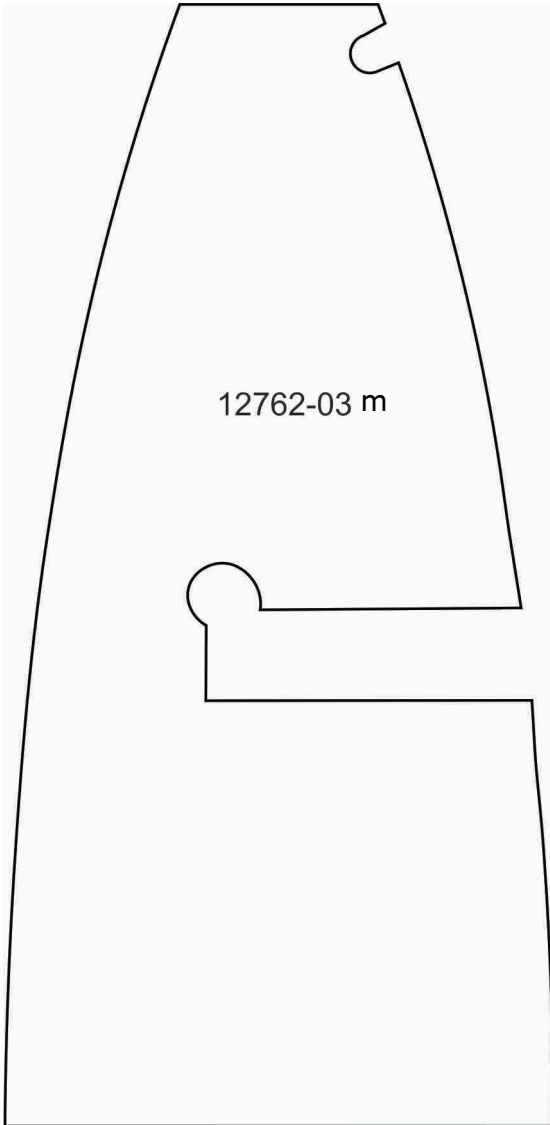

MIRRORED PATTERNS



Print at 100%. No scaling. This box measures 1" x 1". Use the box as an accuracy guide when printing templates.

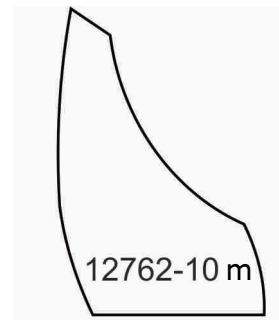
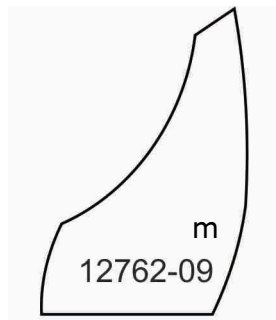
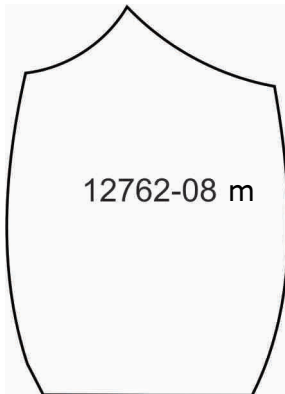
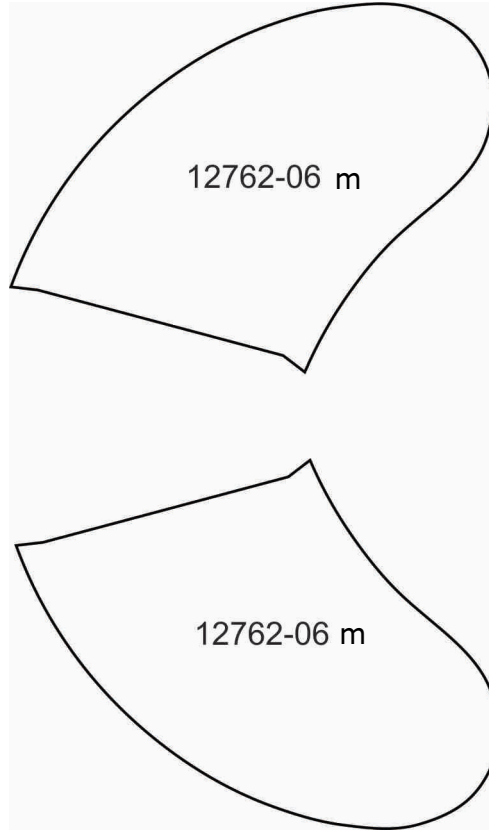
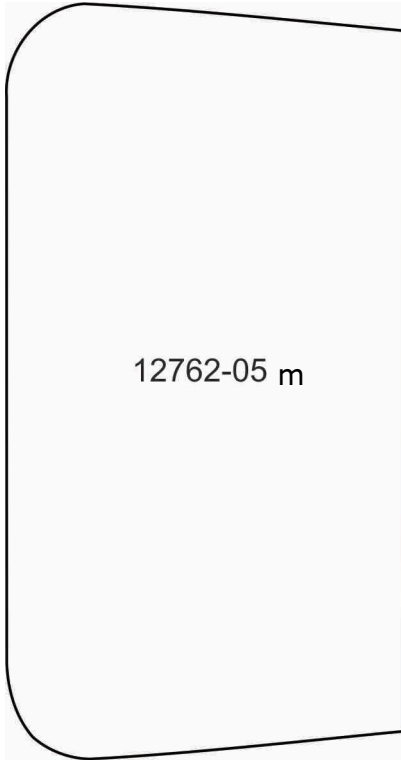

MIRRORED PATTERNS



Print at 100%. No scaling. This box measures 1" x 1". Use the box as an accuracy guide when printing templates.

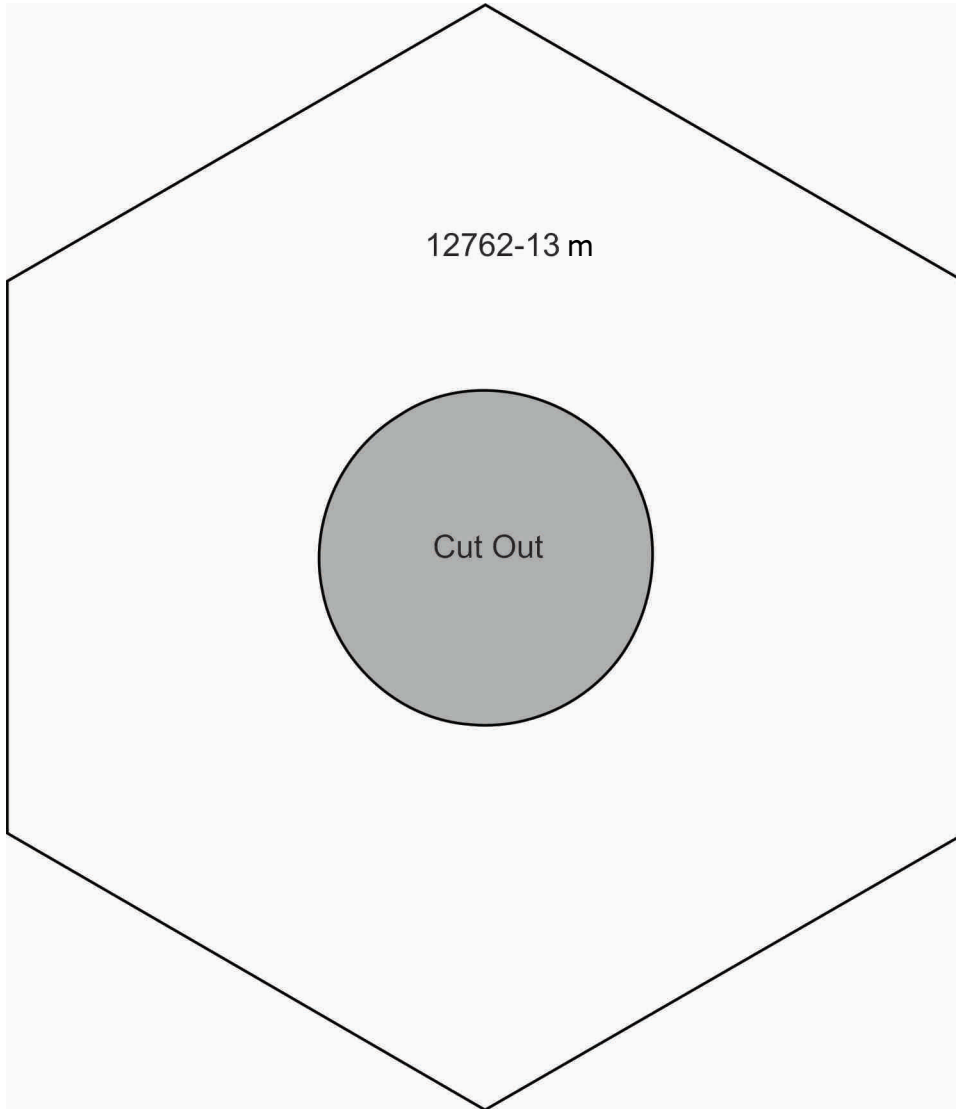

MIRRORED PATTERNS



Print at 100%. No scaling. This box measures 1" x 1". Use the box as an accuracy guide when printing templates.

