

# Sparkle IN THE USA

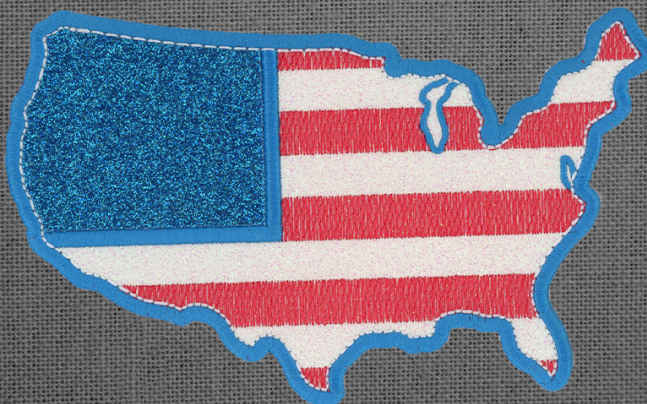

8

Designs

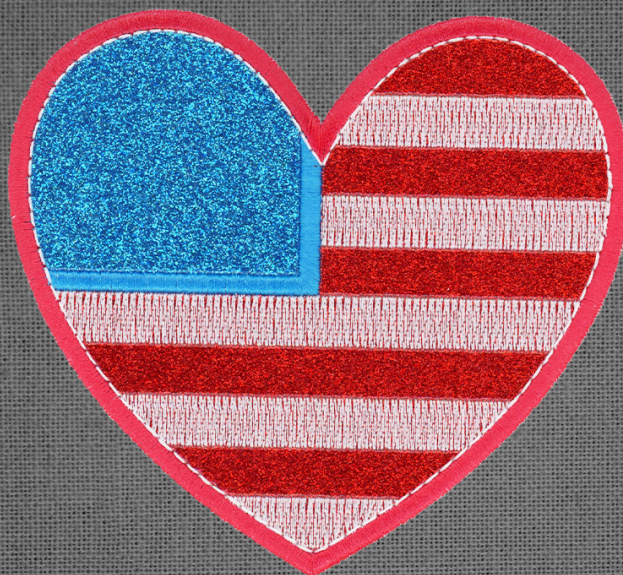

# THREAD LIST



## Isacord Thread Colors

0015 White  
1805 Strawberry  
3906 Pacific Blue

**\* Project instructions included after design list.**

**Note: One spool of 1000 meter thread is adequate for the project unless otherwise noted.**

# TABLE OF CONTENTS

## Interactive Menu

Click to navigate to section.

Designs.....	3
Collection Supplies.....	7
Embroidery .....	8
Printing Instructions.....	11
Applique Patterns.....	12
Mirrored Patterns.....	17

Note: Some designs in this collection may have been created using unique special stitches and/or techniques. To preserve design integrity when rescaling or rotating designs in your software, always rescale or rotate designs using the handles directly on-screen.

**\*Fabric Required**

## 12923-01 Star Applique



Size Inches:                      Size mm:                      Stitch Count:  
**4.94 X 5.18 in. 125.6 X 131.6 mm    6645 St.**

- 1. White Vinyl Placement Stitch ..... 3906
- 2. Cut Line and Tackdown ..... 3906
- 3. Red Vinyl Placement Stitch ..... 3906
- 4. Cut Line and Tackdown ..... 3906
- 5. Blue Vinyl Placement Stitch ..... 3906
- 6. Cut Line and Tackdown ..... 3906
- 7. Blue Inside Detail ..... 3906
- 8. Red Detail..... 1805
- 9. White Inside Detail ..... 0015
- 10. Blue Cover Stitch..... 3906
- 11. White Outline..... 0015

**\*Fabric Required**

## 12923-02 USA Applique

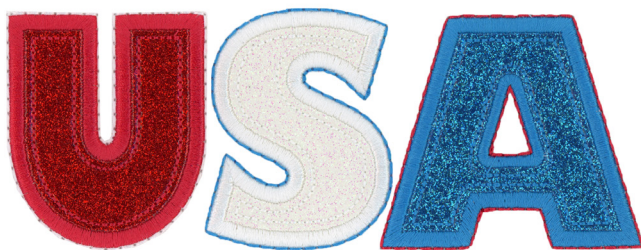

Size Inches:                      Size mm:                      Stitch Count:  
**6.34 X 2.42 in. 161.0 X 61.4 mm    9653 St.**

- 1. White Vinyl Placement Stitch ..... 0015
- 2. Cut Line and Tackdown ..... 0015
- 3. Red Vinyl Placement Stitch ..... 0015
- 4. Cut Line and Tackdown ..... 0015
- 5. Blue Vinyl Placement Stitch ..... 0015
- 6. Cut Line and Tackdown ..... 0015
- 7. White S Detail..... 0015
- 8. Blue Detail..... 3906
- 9. Red Detail..... 1805
- 10. White U Outline ..... 0015

Note: Some designs in this collection may have been created using unique special stitches and/or techniques. To preserve design integrity when rescaling or rotating designs in your software, always rescale or rotate designs using the handles directly on-screen.

**\*Fabric Required**

## 12923-03 Heart Applique

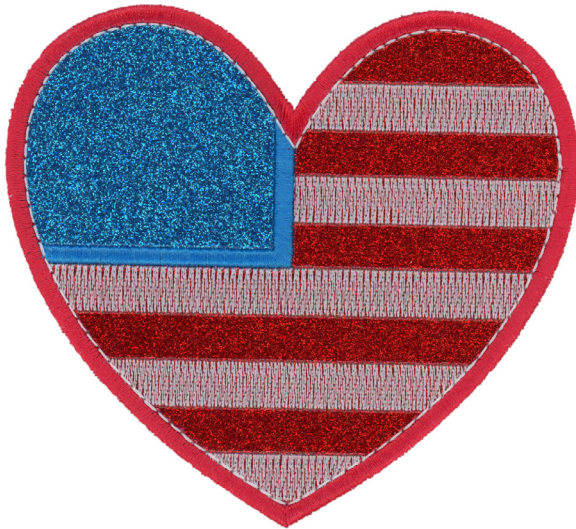

Size Inches:                      Size mm:                      Stitch Count:  
**4.37 X 4.83 in. 111.0 X 122.7 mm 8576 St.**

- 1. Blue Vinyl Placement Stitch ..... 0015
- 2. Cut Line and Tackdown ..... 0015
- 3. Red Vinyl Placement Stitch ..... 0015
- 4. Cut Line and Tackdown ..... 0015
- 5. White Stripes ..... 0015
- 6. Blue Detail ..... 3906
- 7. Red Detail ..... 1805
- 8. White Heart Outline ..... 0015

**\*Fabric Required**

## 12923-04 Liberty Bell Applique

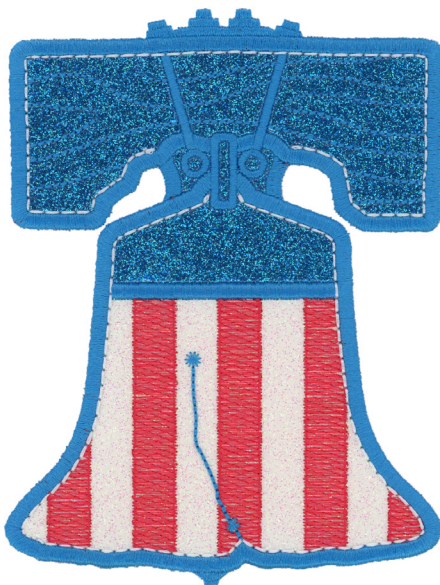

Size Inches:                      Size mm:                      Stitch Count:  
**5.55 X 4.26 in. 141.1 X 108.1 mm 13628 St.**

- 1. Blue Vinyl Placement Stitch ..... 1805
- 2. Cut Line and Tackdown ..... 1805
- 3. White Vinyl Placement Stitch ..... 1805
- 4. Cut Line and Tackdown ..... 1805
- 5. Red Detail ..... 1805
- 6. Blue Detail ..... 3906
- 7. White Detail ..... 0015



Note: Some designs in this collection may have been created using unique special stitches and/or techniques. To preserve design integrity when rescaling or rotating designs in your software, always rescale or rotate designs using the handles directly on-screen.

**\*Fabric Required**

### 12923-05 United States Applique

Size Inches:                      Size mm:                      Stitch Count:  
**6.58 X 4.12 in. 167.1 X 104.6 mm 12425 St.**

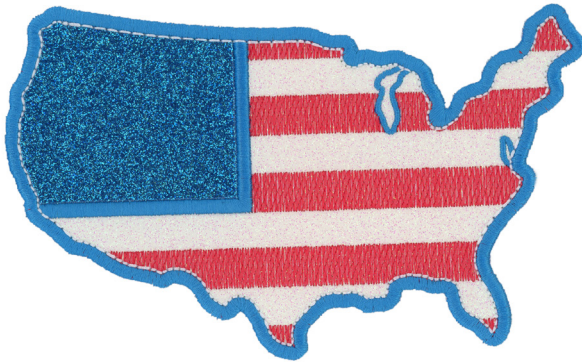

- 1. Blue Vinyl Placement Stitch ..... 1805
- 2. Cut Line and Tackdown ..... 1805
- 3. White Vinyl Placement Stitch ..... 1805
- 4. Cut Line and Tackdown ..... 1805
- 5. Red Detail..... 1805
- 6. Blue Detail..... 3906
- 7. White Detail..... 0015

**\*Fabric Required**

### 12923-06 American Eagle Applique

Size Inches:                      Size mm:                      Stitch Count:  
**6.03 X 5.12 in. 153.1 X 130.2 mm 18214 St.**



- 1. White Vinyl Placement Stitch ..... 1805
- 2. Cut Line and Tackdown ..... 1805
- 3. Red Detail..... 1805
- 4. Blue Detail..... 3906
- 5. White Detail..... 0015

Note: Some designs in this collection may have been created using unique special stitches and/or techniques. To preserve design integrity when rescaling or rotating designs in your software, always rescale or rotate designs using the handles directly on-screen.

**\*Fabric Required**

### 12923-07 American Ribbon Applique



Size Inches:                      Size mm:                      Stitch Count:  
**6.22 X 3.36 in. 158.1 X 85.3 mm 8983 St.**

- 1. Red Vinyl Placement Stitch ..... 3906
- 2. Cut Line and Tackdown ..... 3906
- 3. Blue Vinyl Placement Stitch ..... 3906
- 4. Cut Line and Tackdown ..... 3906
- 5. Blue Ribbon Detail..... 3906
- 6. Red Detail..... 1805
- 7. White Detail ..... 0015
- 8. Blue Bow Detail ..... 3906

**\*Fabric Required**

### 12923-08 American Flag Applique



Size Inches:                      Size mm:                      Stitch Count:  
**5.19 X 3.97 in. 131.9 X 100.7 mm 8631 St.**

- 1. Blue Vinyl Placement Stitch ..... 1805
- 2. Cut Line and Tackdown ..... 1805
- 3. White Vinyl Placement Stitch ..... 1805
- 4. Cut Line and Tackdown ..... 1805
- 5. Red Detail..... 1805
- 6. Blue Detail ..... 3906
- 7. White Detail ..... 0015



# COLLECTION SUPPLIES



## Stabilizers

- OESD Ultra Clean and Tear Fusible

## Fabrics/Textiles

- OESD Luxe Sparkle Vinyl
- Cotton background fabric

## Notions & Tools

- OESD Expert Embroidery Tape TearAway
- OESD Perfect Embroidery Press Cloth
- Applique scissors
- Embroidery Needle Sharp 75/11

## Isacord Thread Colors

- Per thread chart

## General Instructions

The applique instructions, included in the collection, are general instructions. For demonstration purposes, a sample design that best demonstrates the technique is shown.

Fabric and thread requirements will vary by design, but the general technique is the same.

For other designs in the collection, use the applique templates as a guide to the dimensions of the various applique pieces.

Note: Some thread colors in instructions have been changed or digitally enhanced for better visibility.

### STEP 1

- Apply 2 layers of Ultra Clean and Tear Fusible to the back of the desired background fabric by fusing one layer at a time.
- Hoop fabric.



### STEP 2

- Cut a piece of Luxe Sparkle Vinyl large enough to cover the placement stitch. Templates are provided.
- Press right side down on a Perfect Embroidery Press Cloth.





## STEP 3

- Load selected design into the machine.
- Example design is Look on the Brightside silver frames design 51266-05.
- Thread the machine per the thread chart.
- Place the hoop on the machine.
- Stitch Machine Step 1, Blue Fabric Placement Stitch.

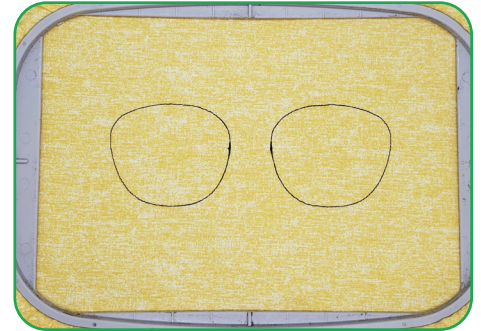

## STEP 4

- Remove the hoop from the machine, but NOT the project from the hoop.
- Place the hoop on a flat surface.
- Place the Luxe Sparkle Vinyl, right side up, completely covering the placement stitch.
- Tape in place to secure.
- Return the hoop to the machine.

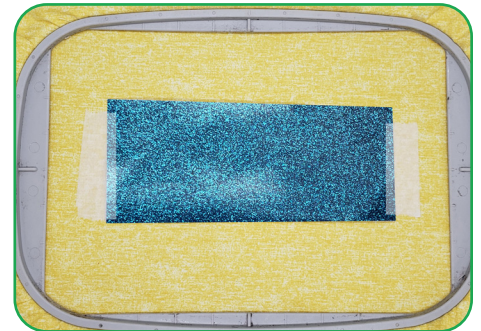

## STEP 5

- Stitch Machine Step 2, Cut Line and Tackdown.

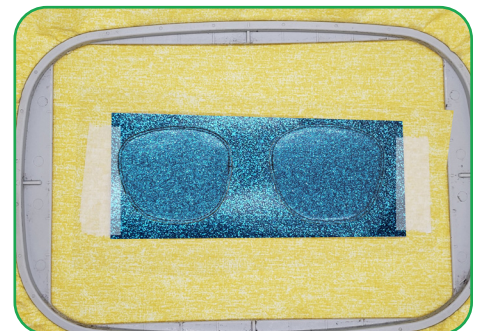

## STEP 6

- Remove the hoop from the machine, but NOT the project from the hoop.
- Place hoop on a flat surface.
- Trim the excess fabric as close to the cut line as possible. If the outermost stitches (cut line) are cut, the inner stitches (tackdown) will hold the applique in place.

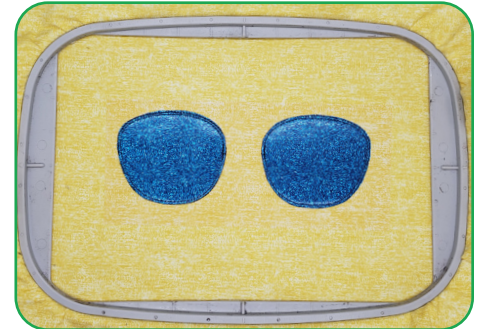

## STEP 7

- Return the hoop to the machine and stitch the remaining machine steps per the thread chart.
- When the design is complete, remove the project from the hoop and gently tear away the stabilizer, one layer at a time. Press face down on a Perfect Embroidery Press Cloth.
- The project is complete, Enjoy!





## ATTENTION

When printing this document, any page scaling or page fitting options in your print dialog box must be turned OFF or set to NONE so that your files will print out at their actual size. Images not printed at actual size will not function as intended.

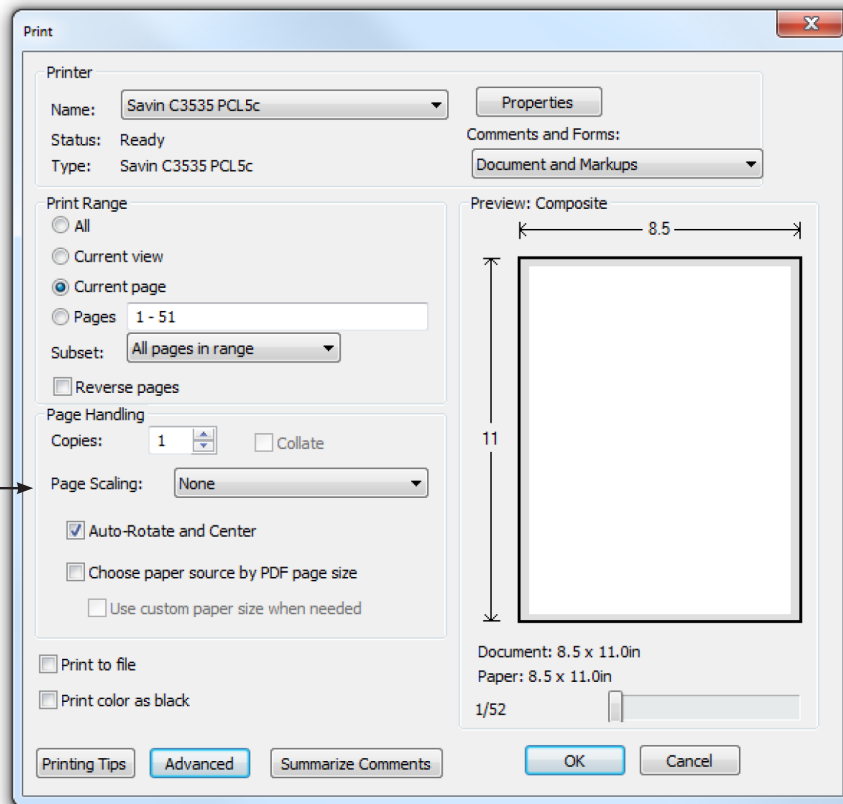

## TO SAVE PAPER

Only print the desired image by navigating to the image's page, go to File > Print and select "Current page" in the print dialog box. Repeat for each desired image.

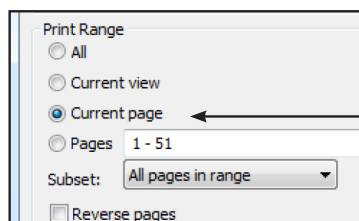

# APPLIQUE PATTERNS



Print at 100%. No scaling. This box measures 1" x 1". Use the box as an accuracy guide when printing templates.

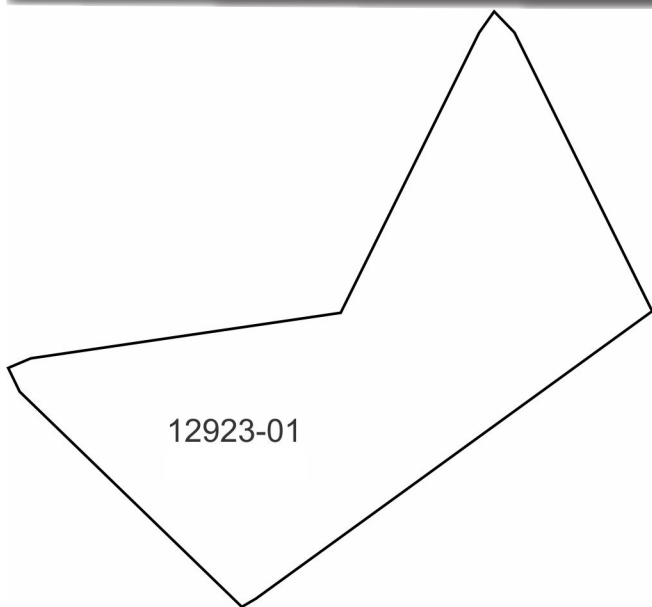

12923-01

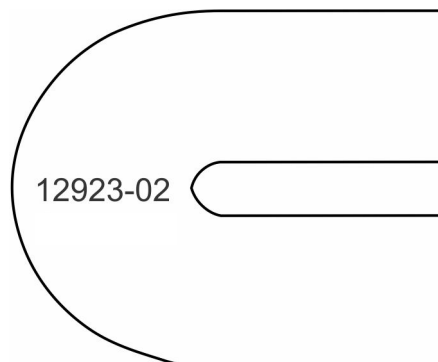

12923-02

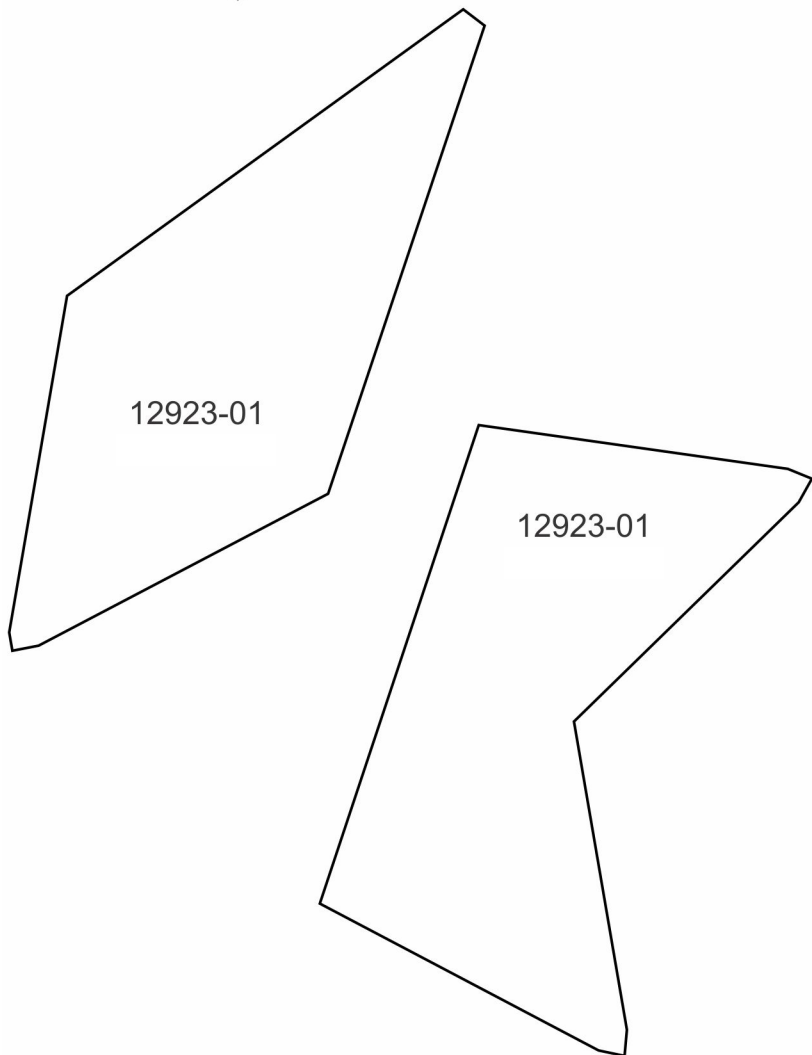

12923-01

12923-01

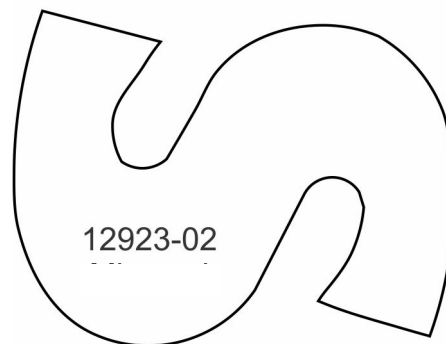

12923-02

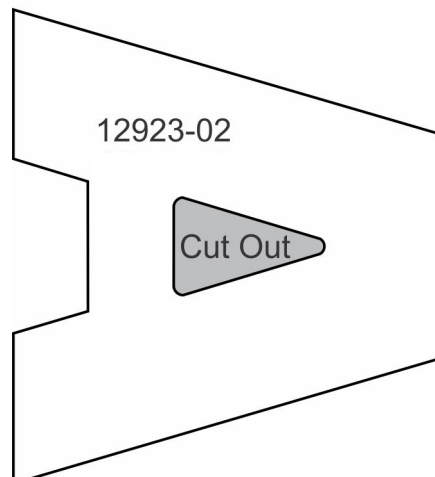

12923-02

Cut Out

# APPLIQUE PATTERNS



Print at 100%. No scaling. This box measures 1" x 1". Use the box as an accuracy guide when printing templates.

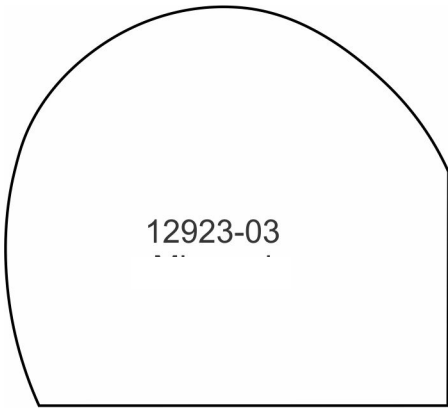

12923-03

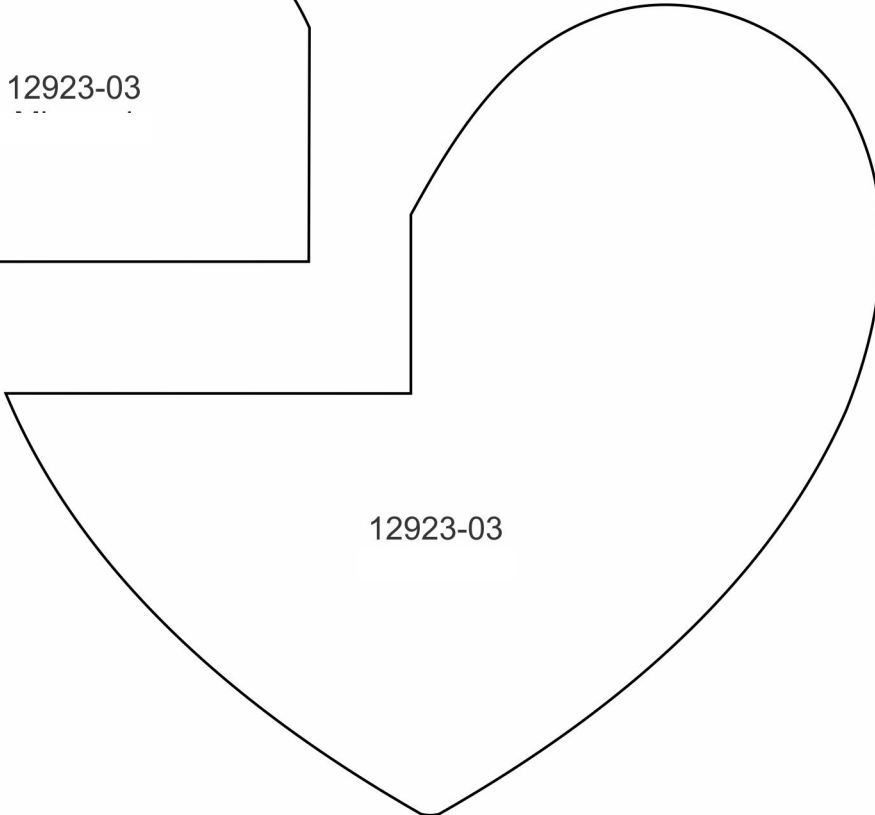

12923-03

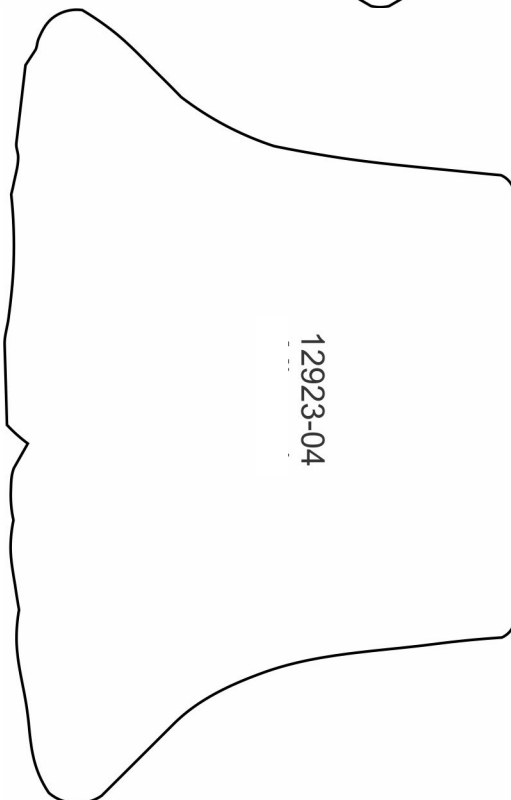

12923-04

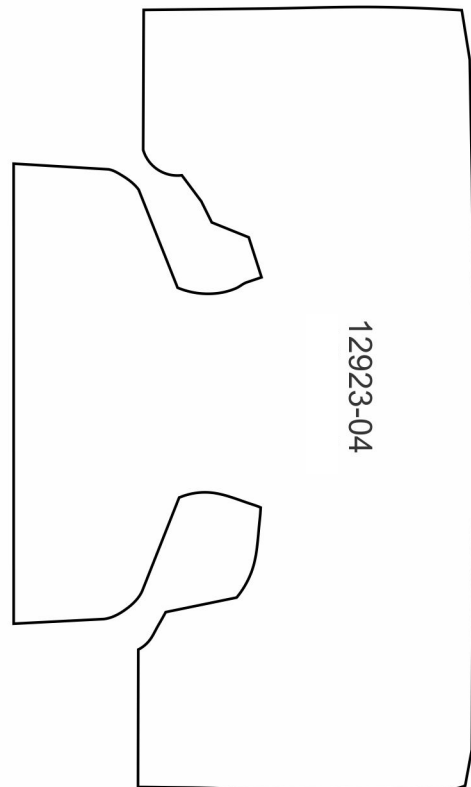

12923-04



# APPLIQUE PATTERNS



Print at 100%. No scaling. This box measures 1" x 1". Use the box as an accuracy guide when printing templates.

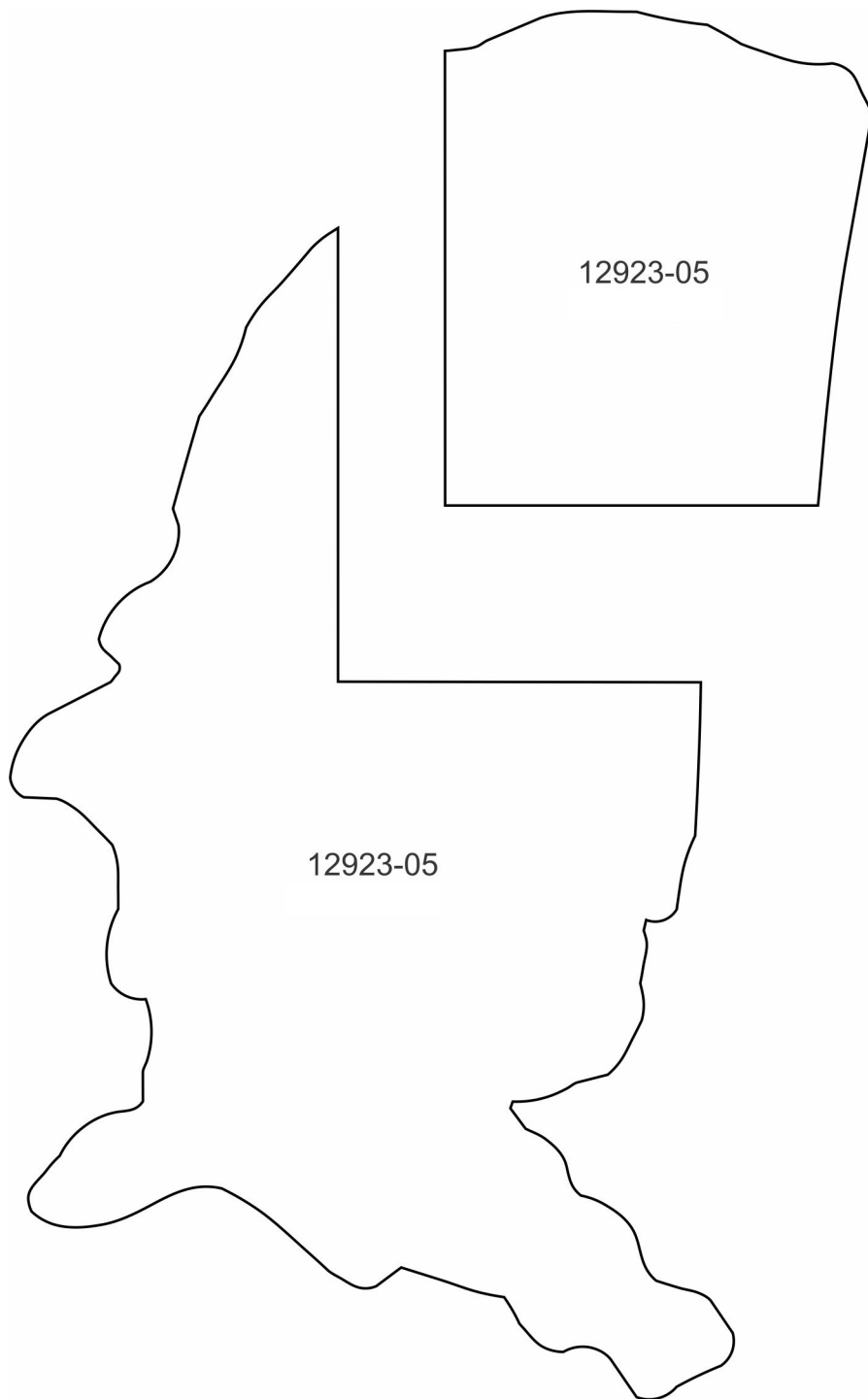

# APPLIQUE PATTERNS



Print at 100%. No scaling. This box measures 1" x 1". Use the box as an accuracy guide when printing templates.

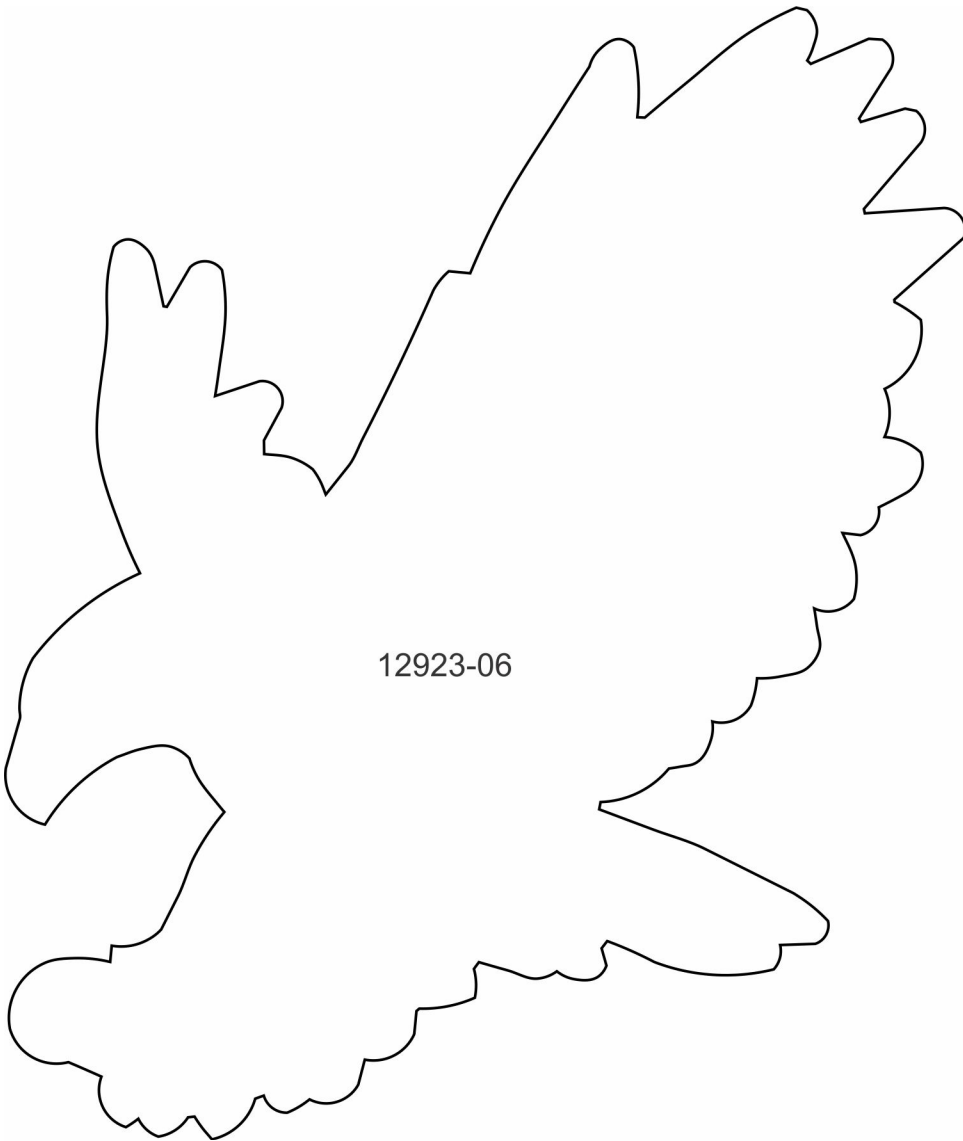

12923-06

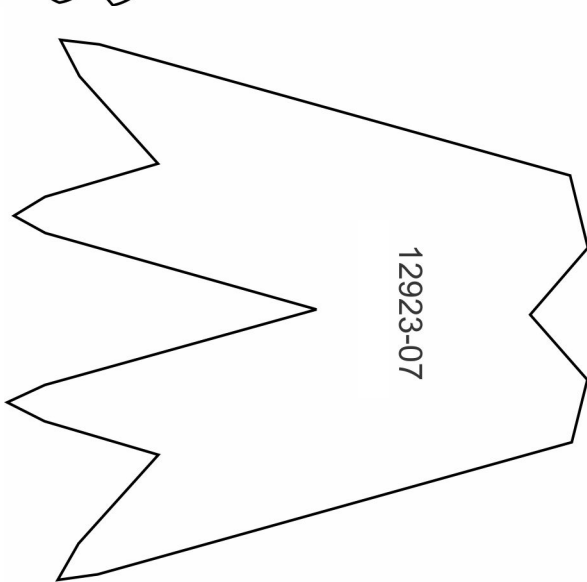

12923-07

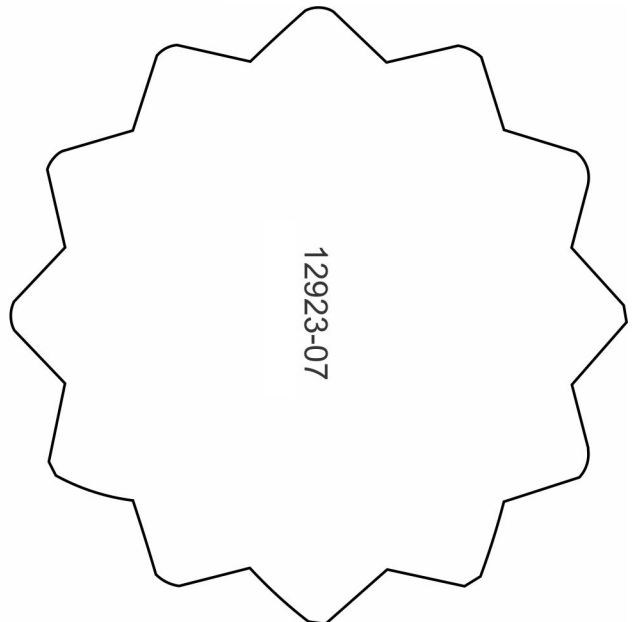

12923-07

# APPLIQUE PATTERNS



Print at 100%. No scaling. This box measures 1" x 1". Use the box as an accuracy guide when printing templates.

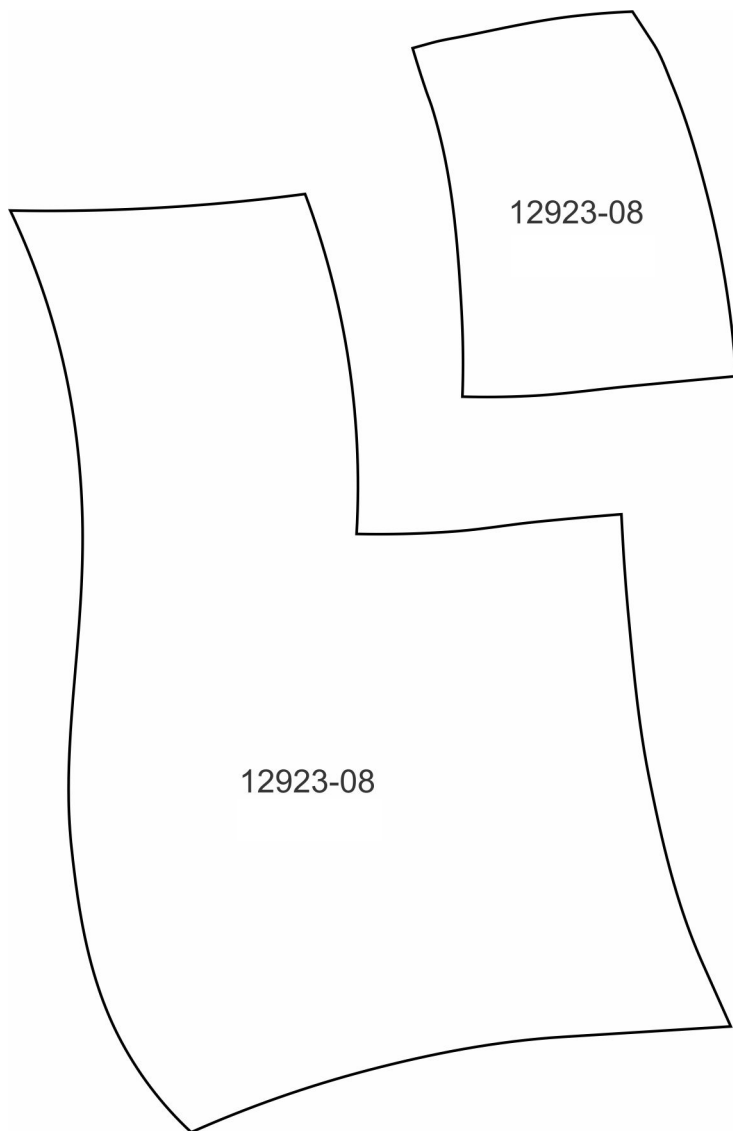



# MIRRORED PATTERNS



Print at 100%. No scaling. This box measures 1" x 1". Use the box as an accuracy guide when printing templates.

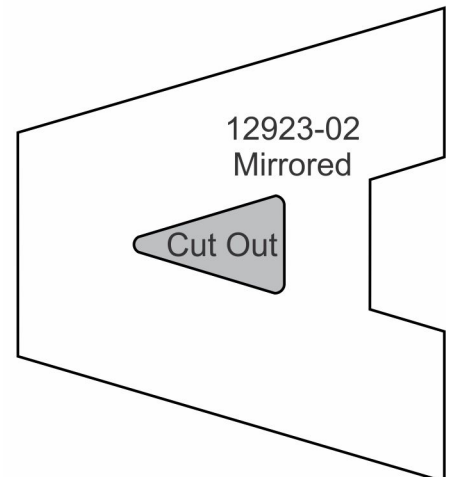
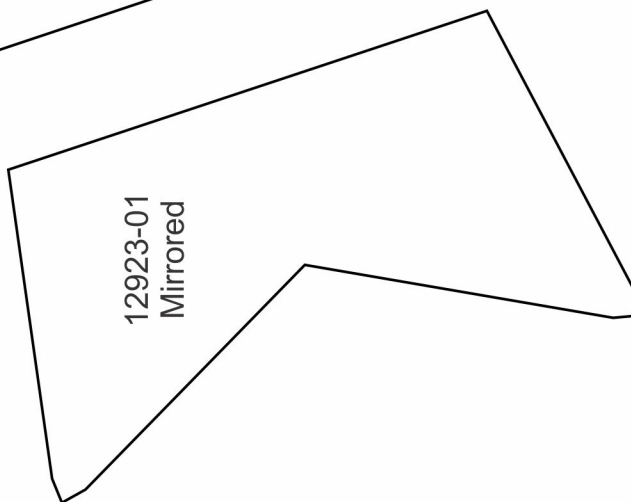
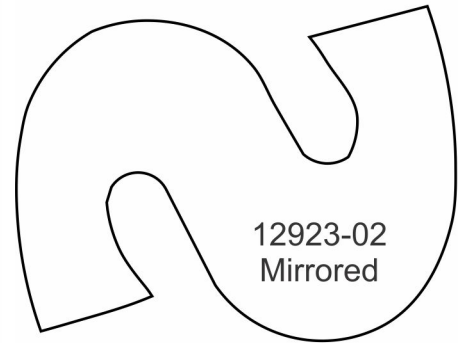
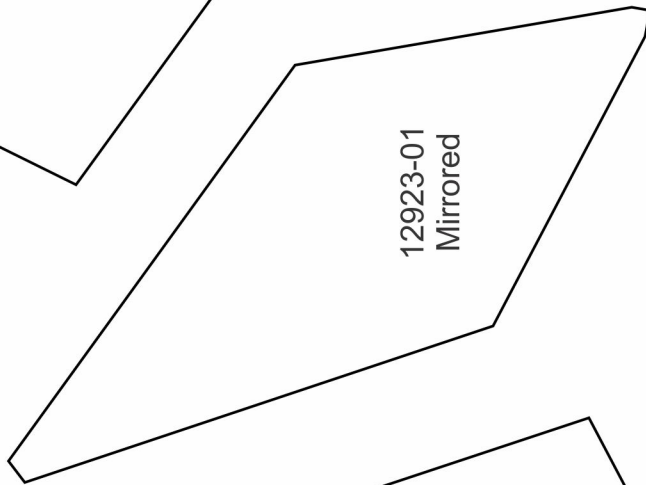
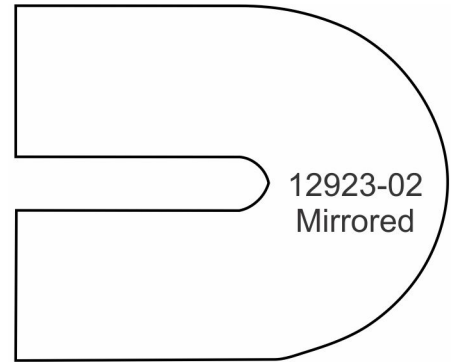
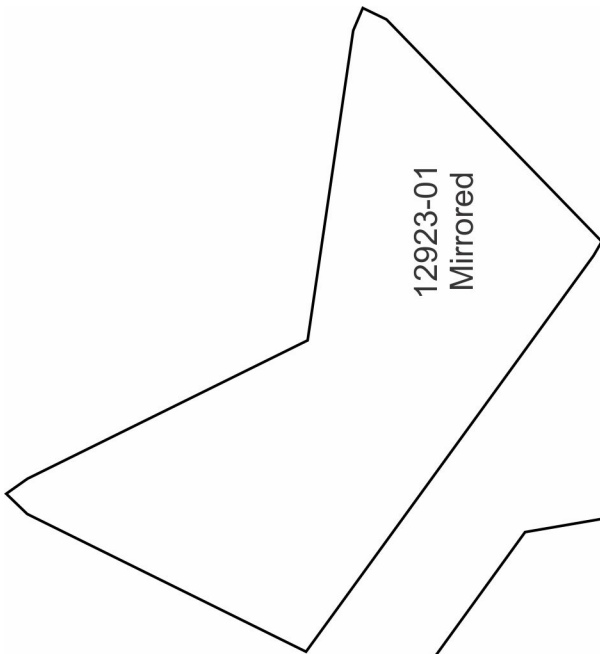

# MIRRORED PATTERNS



Print at 100%. No scaling. This box measures 1" x 1". Use the box as an accuracy guide when printing templates.

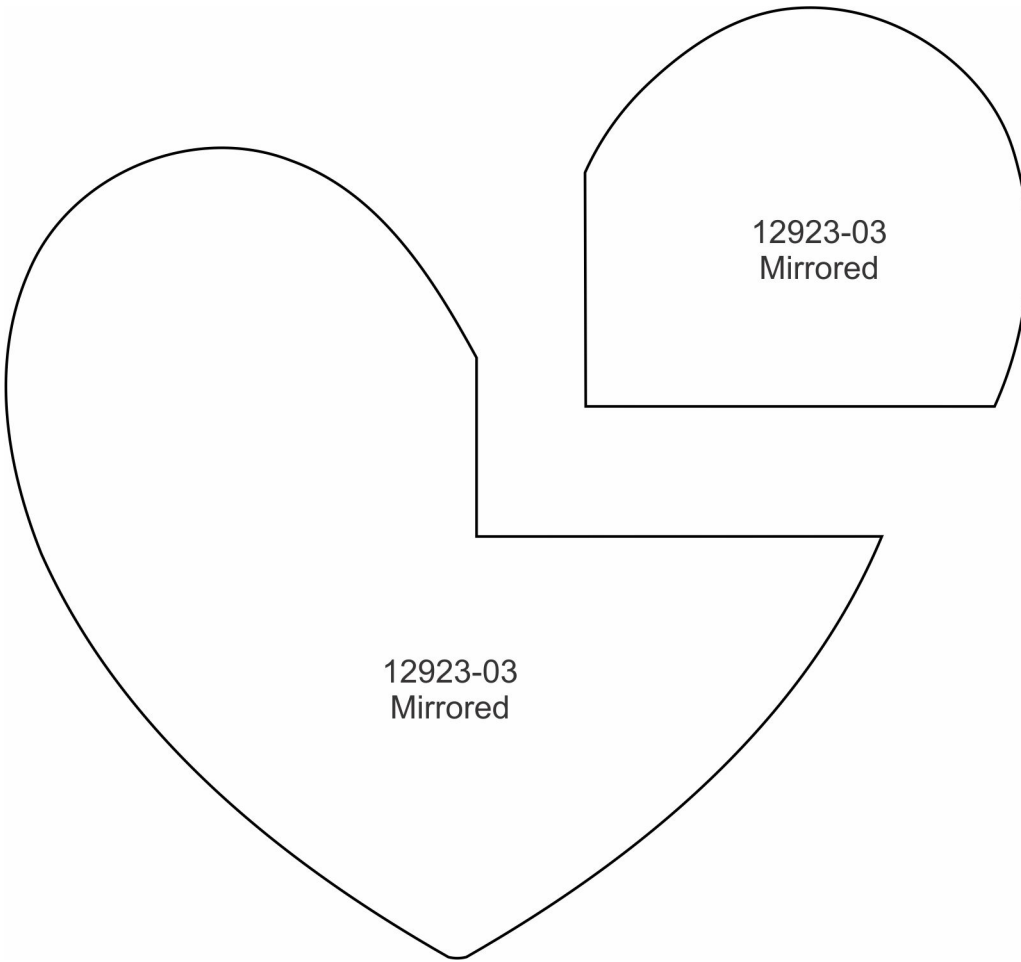

# MIRRORED PATTERNS



Print at 100%. No scaling. This box measures 1" x 1". Use the box as an accuracy guide when printing templates.

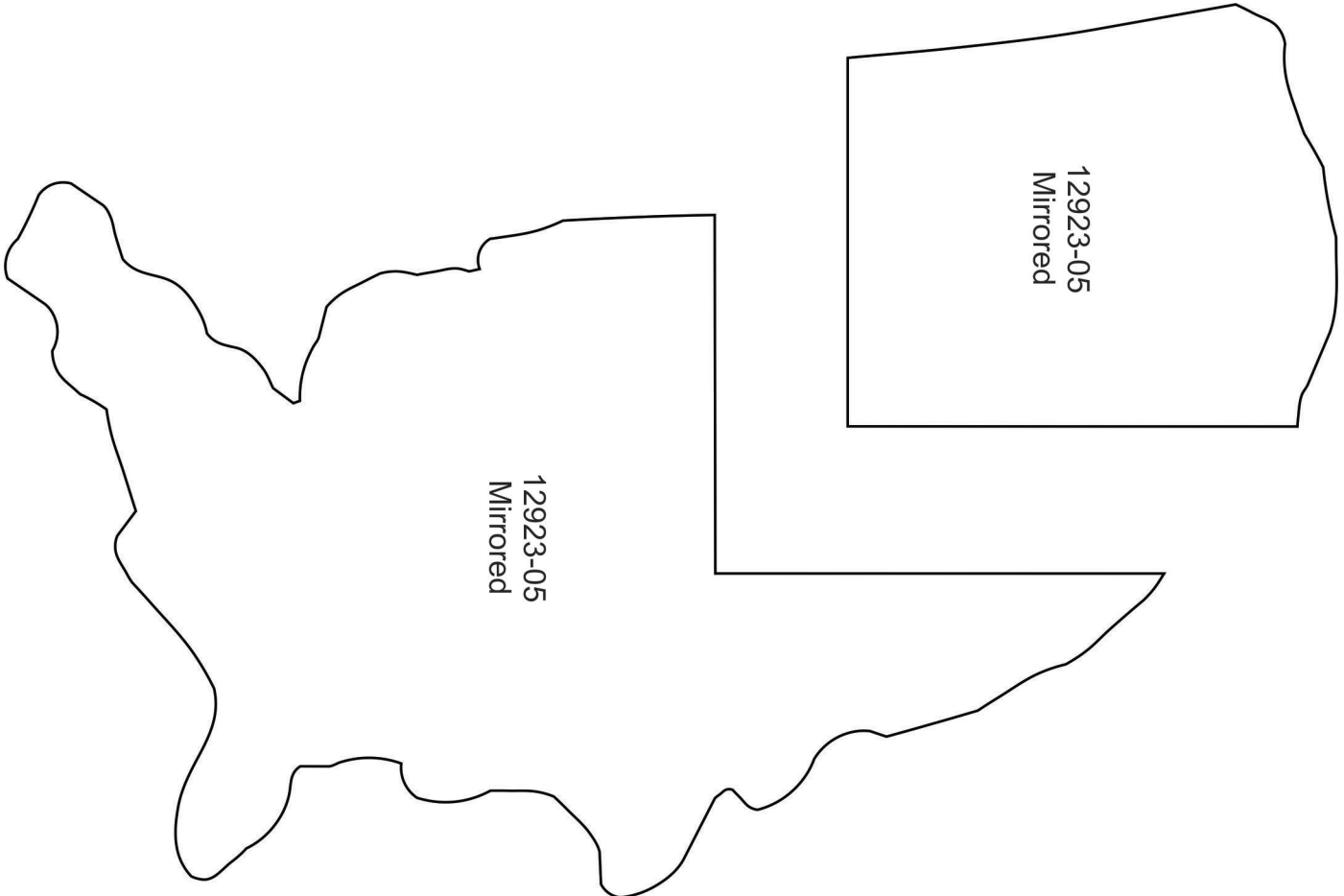
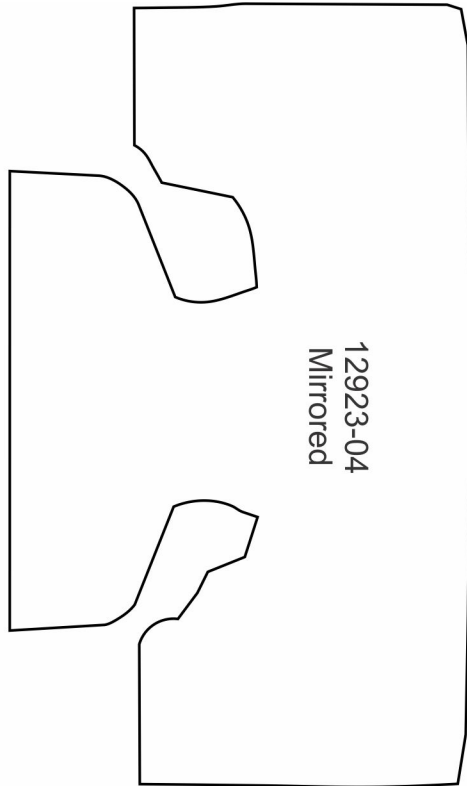
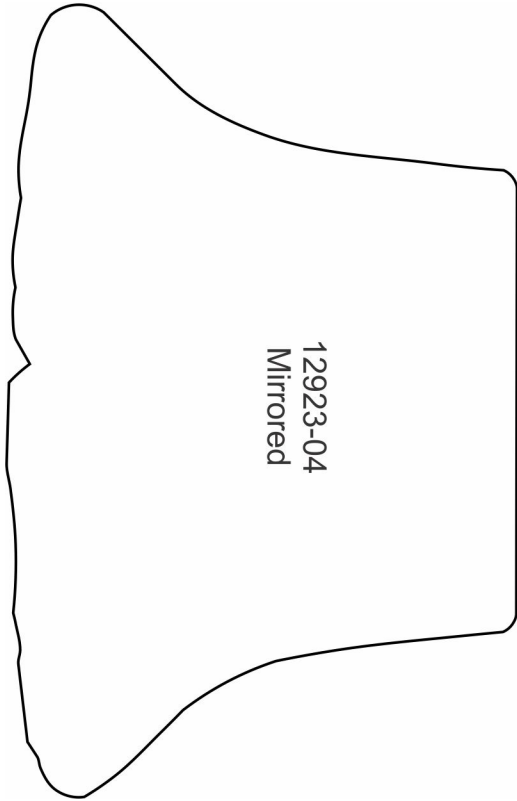



# MIRRORED PATTERNS



Print at 100%. No scaling. This box measures 1" x 1". Use the box as an accuracy guide when printing templates.

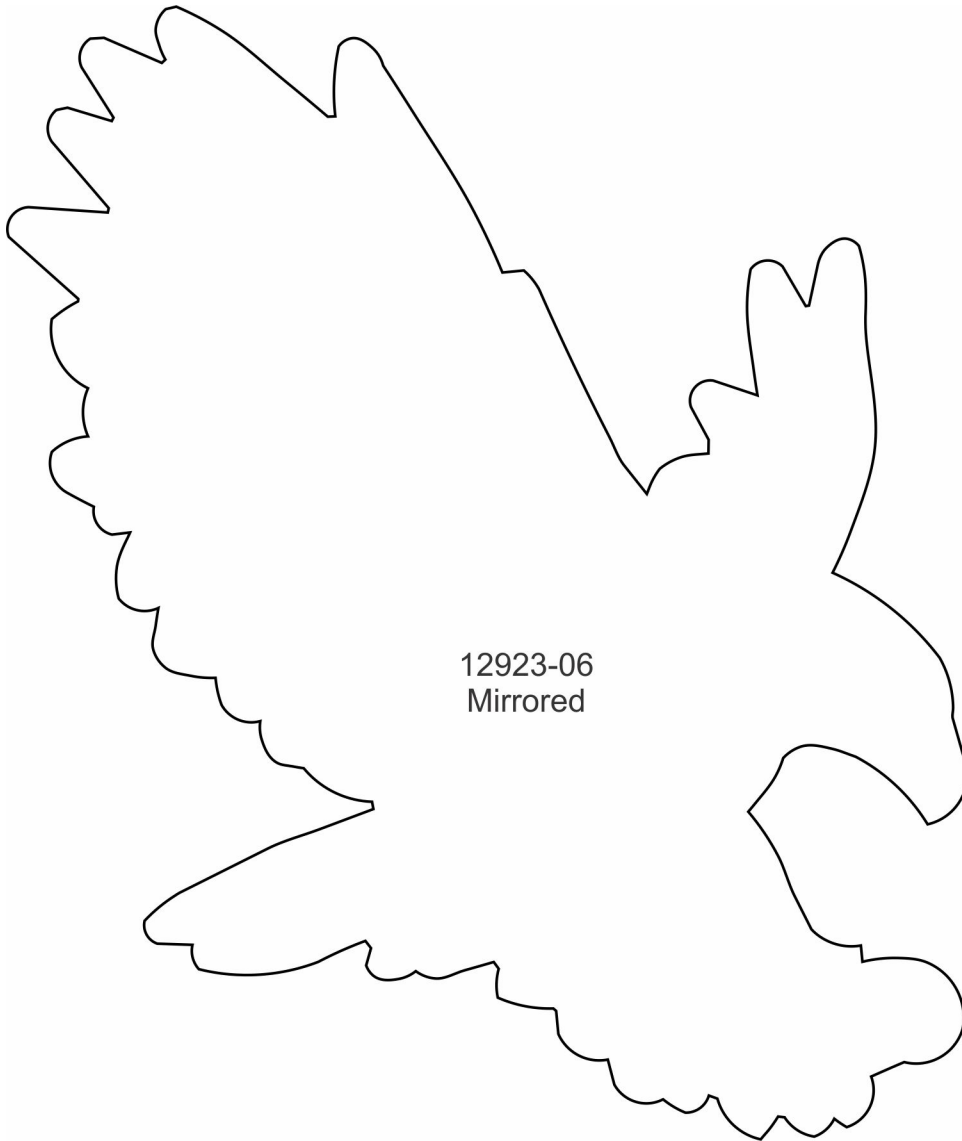

12923-06  
Mirrored

# MIRRORED PATTERNS



Print at 100%. No scaling. This box measures 1" x 1". Use the box as an accuracy guide when printing templates.

