

AUTUMN WELCOME GARDEN FLAG



1

Design

Isacord Thread Colors

0643 Barewood	1055 Bark	4116 Dark Teal
0670 Cream	1753 Strawberries N' Cream	4230 Aqua
0842 Toffee	1900 Geranium	5832 Celery
1010 Toast	2532 Pretty in Pink	5933 Grasshopper
1030 Passion Fruit	2723 Peony	

*** Project instructions included after design list.**

Note: One spool of 1000 meter thread is adequate for the project unless otherwise noted.

TABLE OF CONTENTS

Designs.....	3
Collection Supplies.....	9
Summary	10
Embroidery	11
Assembly	16
Applique Patterns.....	21
Mirrored Patterns.....	25

Note: Some designs in this collection may have been created using unique special stitches and/or techniques. To preserve design integrity when rescaling or rotating designs in your software, always rescale or rotate designs using the handles directly on-screen.

***Fabric Required**

***Fabric Required**



12933-01 Tile 1

12933-02 Tile 2

Size Inches: Size mm: Stitch Count:
6.32 X 3.82 in. 160.6 X 97.1 mm 20742 St.

Size Inches: Size mm: Stitch Count:
6.36 X 3.84 in. 161.5 X 97.6 mm 16059 St.

	1. Light Yellow Fabric Placement Stitch	5832
	2. Cut Line and Tackdown	5832
	3. Brown Fabric Placement Stitch	5832
	4. Cut Line and Tackdown	5832
	5. Light Green Detail	5832
	6. Dark Green Detail.....	5933
	7. Light Blue Detail	4230
	8. Tan Cover Stitch and Detail.....	0643
	9. Dark Orange Detail.....	1010
	10. Brown Cover Stitch and Detail	1055
	11. Purple Detail.....	2723
	12. Pink Detail	2532
	13. Dark Blue Detail	4116
	14. Seam Match Fabric	0020





	1. Purple Fabric Placement Stitch	2532
	2. Cut Line and Tackdown	2532
	3. Orange Fabric Placement Stitch	2532
	4. Cut Line and Tackdown	2532
	5. Pink Detail	2532
	6. Gold Detail.....	0842
	7. Tan Detail	0643
	8. Dark Orange Detail.....	1010
	9. Purple Cover Stitch and Detail	2723
	10. Light Red Detail.....	1753
	11. Dark Blue Detail	4116
	12. Light Orange Cover Stitch and Detail	1030
	13. Brown Detail	1055
	14. Light Blue Detail	4230
	15. Seam Match Fabric	0020

Note: Some designs in this collection may have been created using unique special stitches and/or techniques. To preserve design integrity when rescaling or rotating designs in your software, always rescale or rotate designs using the handles directly on-screen.



12933-03 Tile 3

Size Inches: Size mm: Stitch Count:
3.75 X 2.27 in. 95.3 X 57.5 mm 8155 St.

	1. Light Green Detail	5832
	2. Dark Green Detail.....	5933
	3. Dark Orange Detail.....	1010
	4. Red Detail.....	1900
	5. Seam Match Fabric	0020

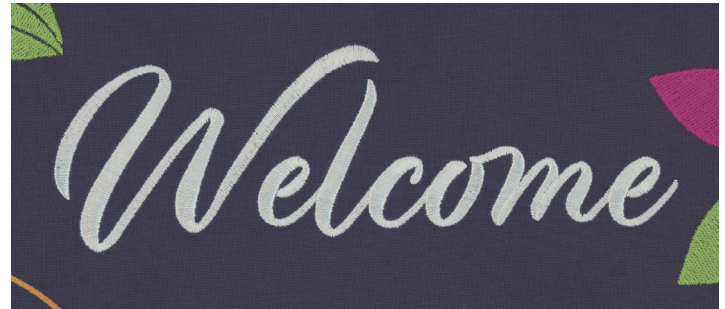

12933-04 Tile 4

Size Inches: Size mm: Stitch Count:
8.28 X 3.75 in. 210.2 X 95.3 mm 7945 St.

	1. Lettering	0670
	2. Light Green Detail	5832
	3. Orange Detail	1010
	4. Purple Detail.....	2723
	5. Seam Match Fabric	0020

Note: Some designs in this collection may have been created using unique special stitches and/or techniques. To preserve design integrity when rescaling or rotating designs in your software, always rescale or rotate designs using the handles directly on-screen.

***Fabric Required**



12933-05 Tile 5

Size Inches: 3.77 X 2.36 in. Size mm: 95.8 X 60.0 mm Stitch Count: 6354 St.

1.	Blue Fabric Placement Stitch	5832
2.	Cut Line and Tackdown	5832
3.	Light Green Detail	5832
4.	Dark Green Detail.....	5933
5.	Orange Detail	1010
6.	Light Blue Detail	4230
7.	Purple Detail.....	2723
8.	Dark Blue Cover Stitch	4116
9.	Seam Match Fabric	0020

***Fabric Required**



12933-06 Tile 6

Size Inches: 6.18 X 5.84 in. Size mm: 156.9 X 148.3 mm Stitch Count: 18928 St.

1.	Yellow Fabric Placement Stitch	5832
2.	Cut Line and Tackdown	5832
3.	Light Yellow Fabric Placement Stitch	5832
4.	Cut Line and Tackdown	5832
5.	Orange Fabric Placement Stitch	5832
6.	Cut Line and Tackdown	5832
7.	Light Green Detail	5832
8.	Dark Green Detail.....	5933
9.	Purple Detail.....	2723
10.	Pink Detail	2532
11.	Gold Detail.....	0842
12.	Tan Cover Stitch and Detail.....	0643
13.	Dark Orange Cover Stitch and Detail	1010
14.	Red Detail.....	1900
15.	Light Red Detail.....	1753
16.	Light Orange Cover Stitch and Detail.....	1030
17.	Light Blue Detail	4230
18.	Dark Blue Detail	4116
19.	Seam Match Fabric	0020

Note: Some designs in this collection may have been created using unique special stitches and/or techniques. To preserve design integrity when rescaling or rotating designs in your software, always rescale or rotate designs using the handles directly on-screen.

***Fabric Required**



12933-07 Tile 7

Size Inches: 6.21 X 5.77 in. Size mm: 157.7 X 146.7 mm Stitch Count: 23933 St.

	1. Red Fabric Placement Stitch.....	1900
	2. Cut Line and Tackdown.....	1900
	3. Red Detail.....	1900
	4. Dark Orange Detail.....	1010
	5. Light Blue Detail.....	4230
	6. Dark Blue Detail.....	4116
	7. Light Red Cover Stitch.....	1753
	8. Seam Match Fabric.....	0020

***Fabric Required**



12933-08 Tile 8

Size Inches: 6.38 X 5.85 in. Size mm: 162.1 X 148.5 mm Stitch Count: 19557 St.

	1. Yellow Fabric Placement Stitch.....	1030
	2. Cut Line and Tackdown.....	1030
	3. Light Yellow Fabric Placement Stitch.....	1030
	4. Cut Line and Tackdown.....	1030
	5. Blue Fabric Placement Stitch.....	1030
	6. Cut Line and Tackdown.....	1030
	7. Purple Fabric Placement Stitch.....	1030
	8. Cut Line and Tackdown.....	1030
	9. Light Orange Detail.....	1030
	10. Dark Orange Cover Stitch.....	1010
	11. Gold Detail.....	0842
	12. Tan Cover Stitch and Detail.....	0643
	13. Brown Detail.....	1055
	14. Red Detail.....	1900
	15. Light Red Detail.....	1753
	16. Purple Cover Stitch Detail.....	2723
	17. Dark Teal Cover Stitch and Detail.....	4116
	18. Pink Detail.....	2532
	19. Light Blue Detail.....	4230
	20. Seam Match Fabric.....	0020

Note: Some designs in this collection may have been created using unique special stitches and/or techniques. To preserve design integrity when rescaling or rotating designs in your software, always rescale or rotate designs using the handles directly on-screen.

***Fabric Required**



12933-09 Tile 9

Size Inches: Size mm: Stitch Count:
6.43 X 5.84 in. 163.2 X 148.2 mm 17152 St.

	1. Yellow Fabric Placement Stitch	4230
	2. Cut Line and Tackdown	4230
	3. Orange Fabric Placement Stitch	4230
	4. Cut Line and Tackdown	4230
	5. Red Fabric Placement Stitch	4230
	6. Cut Line and Tackdown	4230
	7. Light Blue Detail	4230
	8. Dark Green Detail.....	5933
	9. Dark Blue Detail	4116
	10. Light Orange Cover Stitch and Detail.....	1030
	11. Light Green Detail	5832
	12. Dark Orange Cover Stitch	1010
	13. Purple Detail.....	2723
	14. Pink Detail	2532
	15. Red Cover Stitch	1900
	16. Light Red Detail.....	1753
	17. Seam Match Fabric	0020



12933-10 Hello Option Tile

Size Inches: Size mm: Stitch Count:
8.28 X 3.75 in. 210.2 X 95.3 mm 7431 St.

	1. Lettering	0670
	2. Light Green Detail	5832
	3. Orange Detail	1010
	4. Purple Detail.....	2723
	5. Seam Match Fabric	0020

Note: Some designs in this collection may have been created using unique special stitches and/or techniques. To preserve design integrity when rescaling or rotating designs in your software, always rescale or rotate designs using the handles directly on-screen.

12933-11 Blank Option Tile

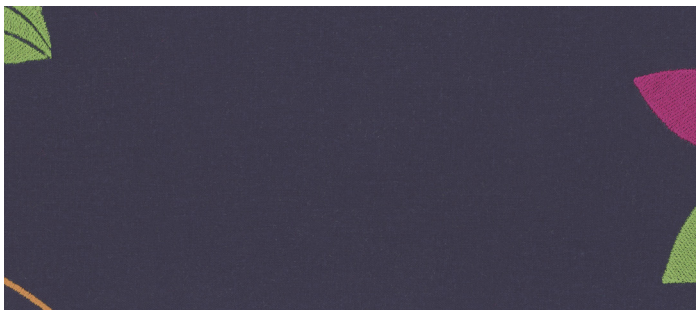

Size Inches: Size mm: Stitch Count:
8.28 X 3.75 in. 210.2 X 95.3 mm 3084 St.

	1. Light Green Detail	5832
	2. Orange Detail	1010
	3. Purple Detail.....	2723
	4. Seam Match Fabric	0020

Stabilizers

- OESD Ultra Clean and Tear
- OESD Fusible Woven

Fabrics/Textiles

- Background fabric- 1 yard navy cotton
- Batting 22" x 16"
- Backing 1/2 yard
- Assorted small pieces of quilter's cotton for applique: light yellow, brown, purple, orange, blue, yellow, red.
Note: Use the printed templates as a guide to determine the size of each applique fabric.
- Binding 1/4 yard, cut 2 strips width of fabric x 2 1/2", stitch together at 45° angle to create one long strip
- Tabs: Cut (1) 3" strip of binding fabric for the hang tabs

Notions & Tools

- OESD Expert Point and Press Tool
- OESD Perfect Embroidery Press Cloth
- OESD Expert Embroidery Tape TearAway
- OESD Button Clips
- Ruler, rotary cutter, mat
- 505 Temporary Spray Adhesive
- Water soluble thread or Monofilament thread (optional)
- Contrasting bobbin thread (seam stitch only, may be different colors)
- Fabric marking pen or pencil
- Embroidery Needle Sharp 75/11
- Walking Foot

Isacord Thread Colors

- Per thread chart

SUMMARY



Finished project size: 18.5" x 12.5"
not including hanging tabs



Choose from 3 Options

12933-04

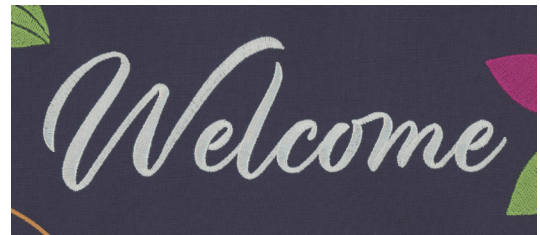

12933-10



12933-11

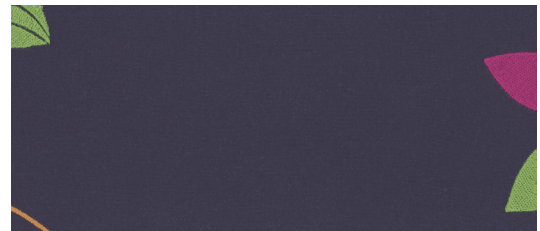

Notes

Cut the background fabric into a 10" x 15" piece for all designs except 03 and 05. These can be stitched in a smaller hoop.

Note: To economize on fabric, cut the fabric 15" wide (or the height of the hoop + 2") x the width of the fabric. Apply the stabilizers. Move the hoop down the length of the fabric as each block is stitched. Leave a minimum of 1.5" between the blocks.

Note: Blocks 4, 10, and 11 are interchangeable, select block based on personal preference.

STEP 1

- Apply one layer of Fusible Woven to the wrong side of the background fabric and applique fabrics.

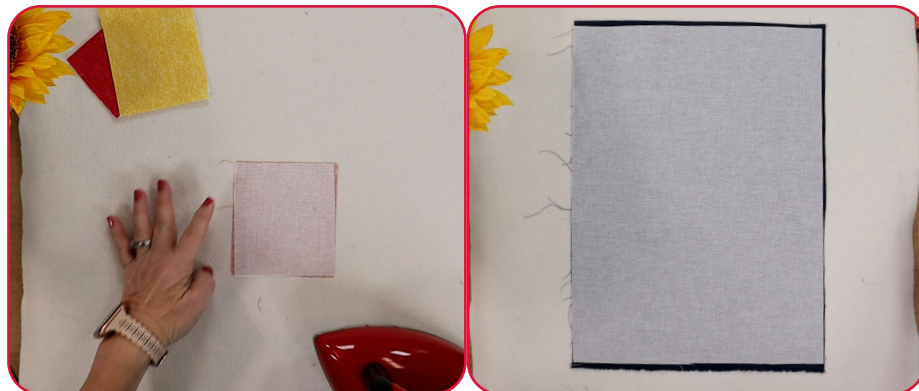

STEP 2

- Apply two layers of Ultra Clean and Tear to the back of the background fabric with temporary adhesive spray and place in the hoop.



STEP 3

- Hoop the stabilizers and background fabric.
- Note: The applique instructions included in the design pack are general instructions for the collection. For demonstration purposes, a sample design that best represents the entire collection is shown. Fabric and thread requirements will vary by design, but the general technique will be the same.



STEP 4

- Load the selected design into the machine.
- Example design is 12933-09.
- Place the hoop on the machine.
- Thread the machine per the thread chart.
- Stitch Machine Step 1, Dark Yellow Fabric Placement Stitch.



STEP 5

- Remove the hoop from the machine, but NOT the project from the hoop.
- Place the hoop on a flat surface.
- Completely cover the placement stitch with the prepared fabric.
- Tape to secure.



STEP 6

- Return the hoop to the machine.
- Stitch Machine Step 2, Cut Line and Tackdown.



STEP 7

- Remove the hoop from the machine, but NOT the project from the hoop.
- Place on a flat surface.
- Trim the excess fabric as close to the tackdown stitching as possible.
- Note: If the outermost stitches (cut line) are cut, the inner stitches (tackdown) will hold the applique in place.



STEP 8

- Return the hoop to the machine.
- Repeat the applique process (steps 4-7) with the next two appliques.



STEP 9

- Return the hoop to the machine and stitch the remaining steps per the thread chart.
- STOP before the last step.



STEP 10

- Before stitching the last machine step, change the bobbin thread to a high contrast thread. Match the top thread to the background fabric.
- Note: The last color change in each block is called "Seam". This line is the guide when trimming and stitching the tiles together and needs to be highly visible on the back side of the tile. Stitch the top color in a thread that blends with the fabric or monofilament thread.
- Use a color in the bobbin that contrasts sharply with the wrong side of the tile.

Tip: Since the bobbin color does not have to be the same on each tile, this is a great time to use up partially wound bobbins.



STEP 11

- After the embroidery is complete, press each block face down on a Perfect Embroidery Press Cloth.

STEP 12

- At the cutting mat, place the block right side down. Identify the “seam” stitch line. Trim 1/2” inch out from the seam stitch line, on all four sides, to create the seam allowance.
- Note: Accuracy will significantly facilitate the construction of the scene.

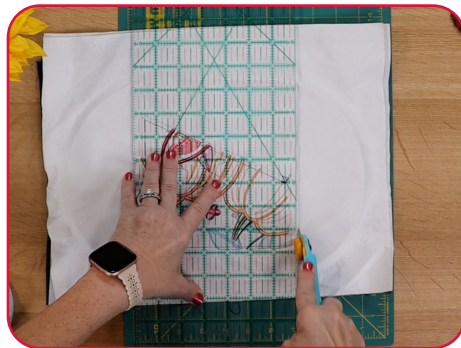

STEP 13

- Write the number of the block on the back so it is easily identified during construction! Use a pen or pencil that will not bleed through to the front side.

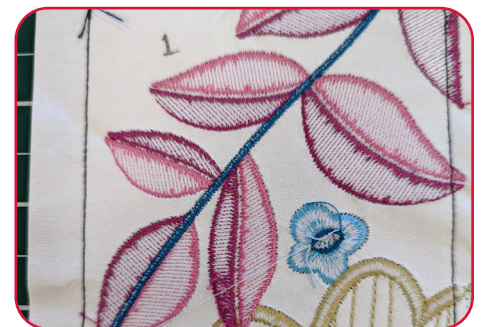

ASSEMBLY



STEP 14

- Arrange the tiles in the layout for the scene. See Summary on page 10 for layout.



STEP 15

- Stitch two adjacent tiles, right sides together.
- Align the matching edges and stitch just inside of the seam line.
- Repeat until all the blocks have been paired.



STEP 16

- Press each seam open.
- Note: If the seams do not come apart easily, press both seam allowances to one side using steam and a cotton or linen setting.
- While warm, open the seam allowance with the large ball of the Expert Point & Press Tool.
- Press again and allow to cool.
- Once cool, remove the excess stabilizer in the seam allowance.
- Do not remove the excess stabilizer from inside the seam line.

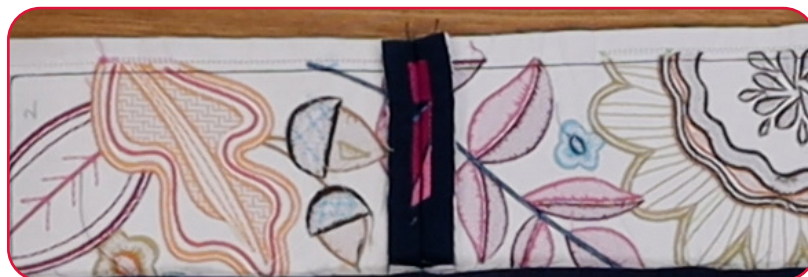

ASSEMBLY



STEP 17

- Lay out the pressed tiles.
- Sew each row together to complete the flag.
- Press seams open.
- Note: If the seams or major points of matching do not match up, try stitching those parts first. Check for accuracy. Then stitch across the tiles.



STEP 18

- Cut batting and backing at least 2" larger than the tiling scene.
- Center the tiling scene over the batting and backing.
- Spray baste all 3 layers with temporary spray adhesive.



STEP 19

- Load the sewing machine with a thread color that blends with the scene or monofilament thread.
- Stitch in the ditch where the tiles connect to attach the batting and backing to the top. For best results use a walking foot or a dual feed foot.



STEP 20

- Trim 1/4" from the edge, through all three layers to square up the finished scene.
- Zigzag over the raw edges to join the edges together.
- Set aside.



STEP 21

- Make the hanging tabs:
- Cut (1) 3" strip of desired fabric for hanging tabs.
- Cut (1) 3" strip of Fusible Woven.
- Apply the Fusible Woven to the wrong side of the fabric.

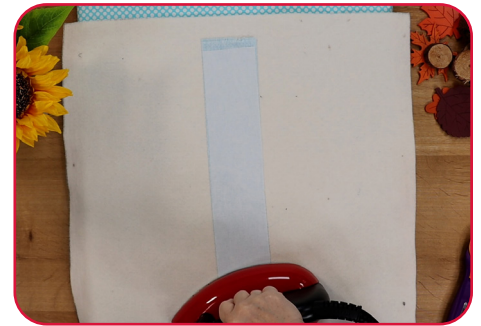

STEP 22

- Fold in half, wrong sides together and press.
- Open and fold outer edges to the crease in the center. Press.
- Fold over and press again.
- Topstitch each long edge.

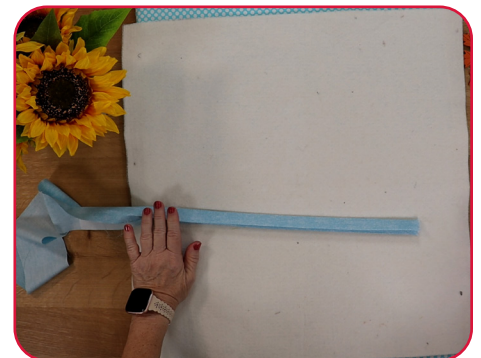

ASSEMBLY



STEP 23

- Cut (4) 5" strips and fold in half.
- Place the folded strips evenly across the top of the flag on the wrong side. The raw edges of the tabs should line up with the raw edge of the top of the flag.
- Baste in place.

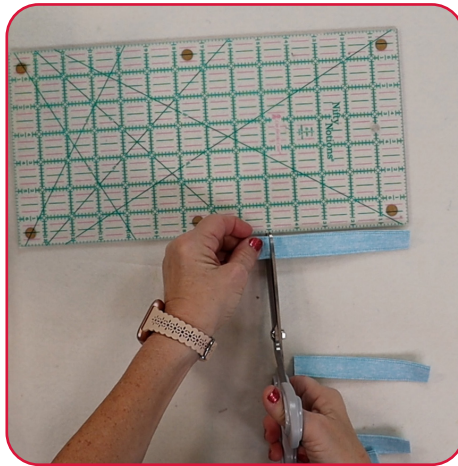

STEP 24

- Bind as desired.



ATTENTION

When printing this document, any page scaling or page fitting options in your print dialog box must be turned OFF or set to NONE so that your files will print out at their actual size. Images not printed at actual size will not function as intended.

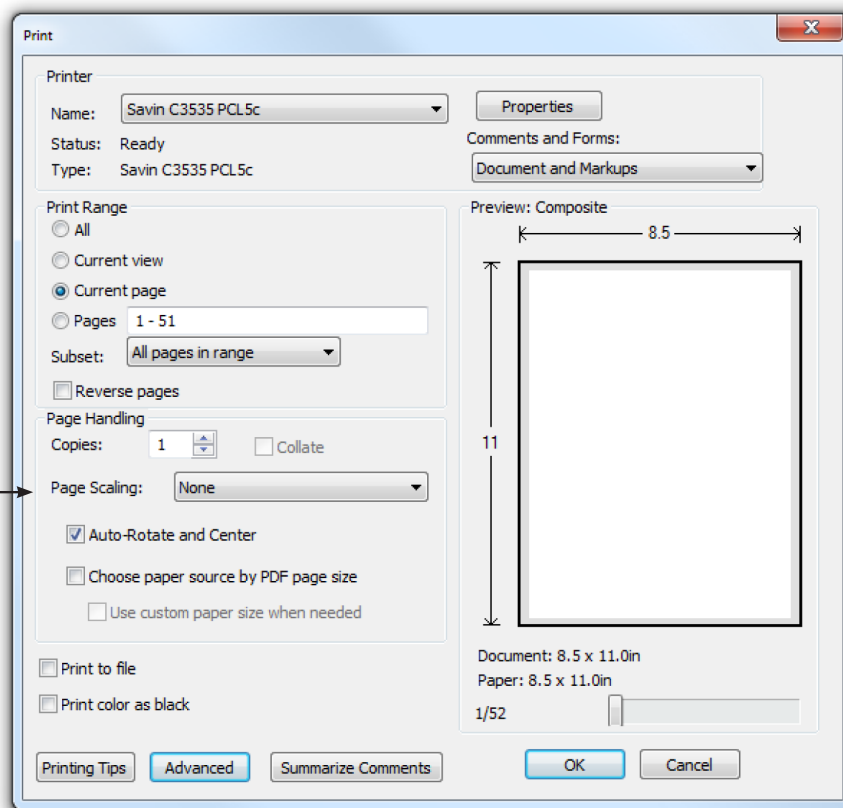

TO SAVE PAPER

Only print the desired image by navigating to the image's page, go to File > Print and select "Current page" in the print dialog box. Repeat for each desired image.

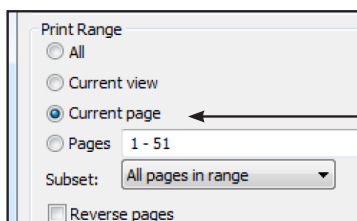

APPLIQUE PATTERNS



Print at 100%. No scaling. This box measures 1" x 1". Use the box as an accuracy guide when printing templates.

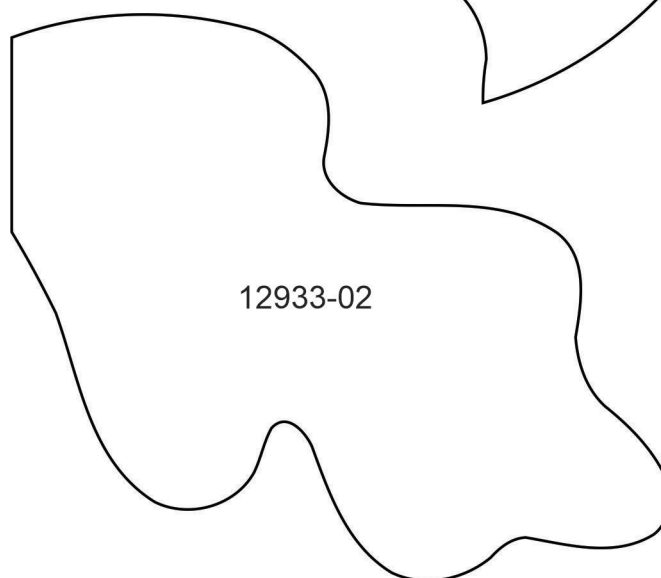
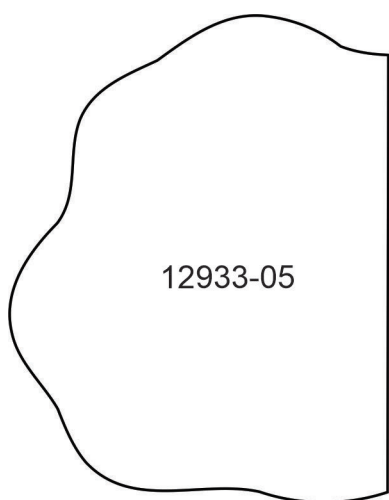
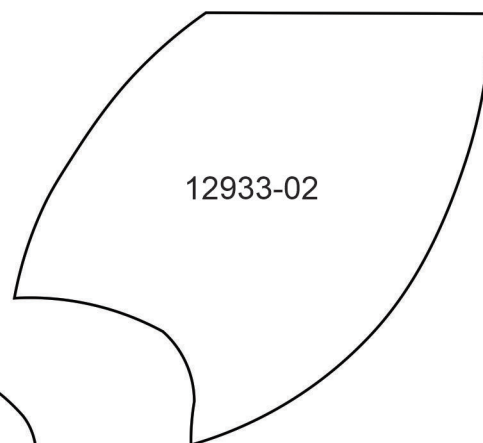
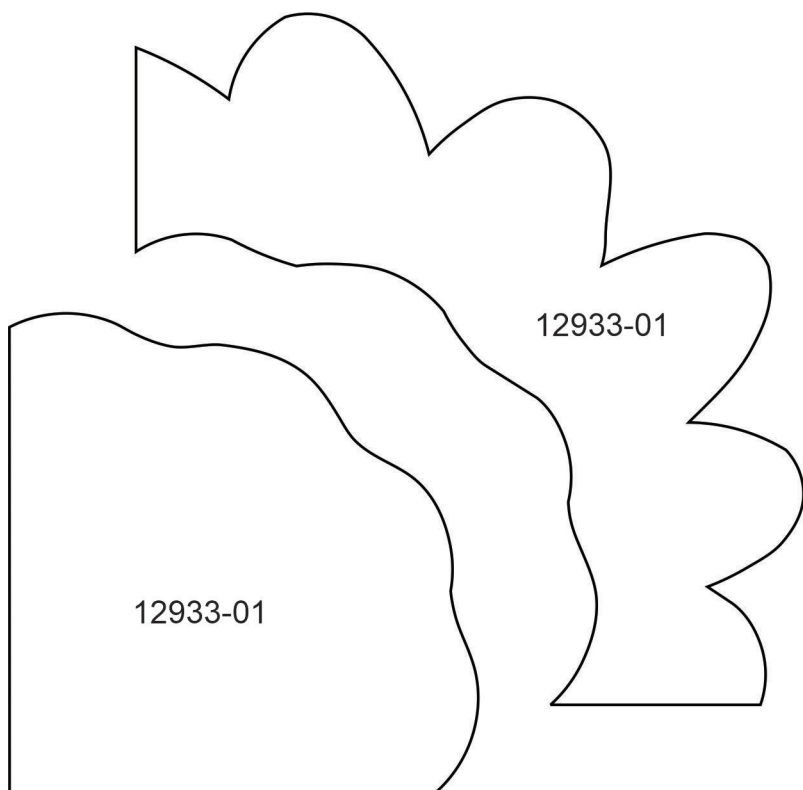

APPLIQUE PATTERNS



Print at 100%. No scaling. This box measures 1" x 1". Use the box as an accuracy guide when printing templates.

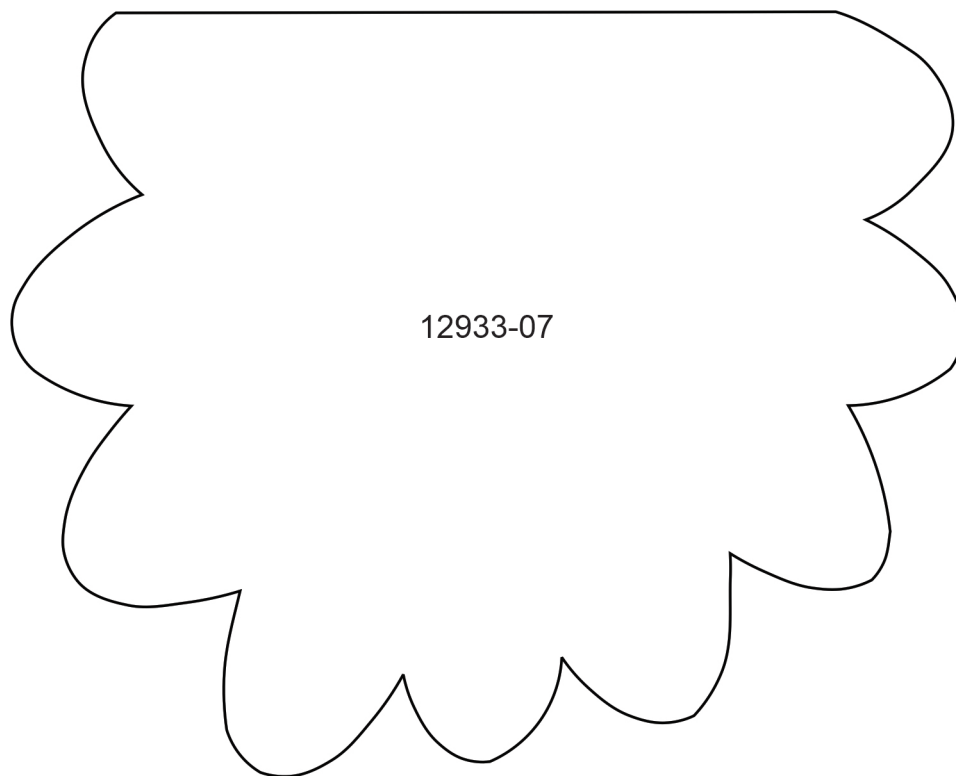
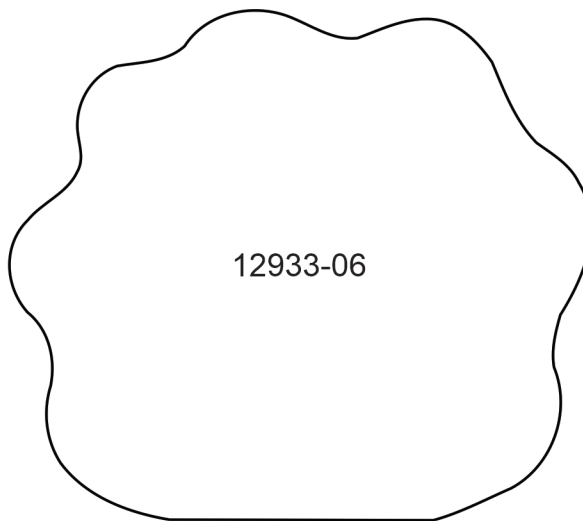
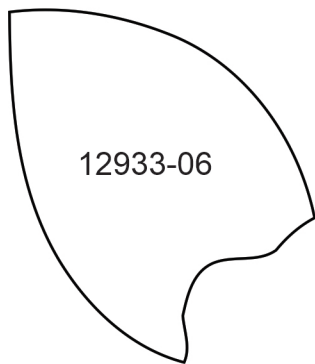

APPLIQUE PATTERNS



Print at 100%. No scaling. This box measures 1" x 1". Use the box as an accuracy guide when printing templates.

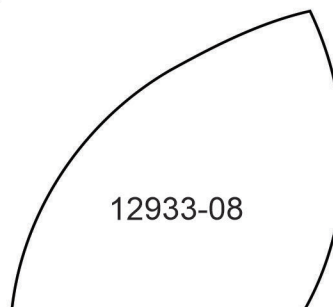
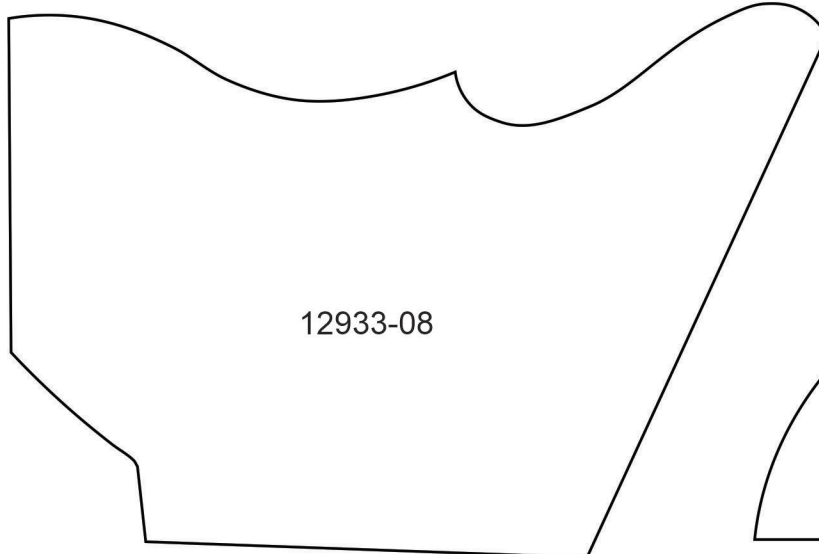
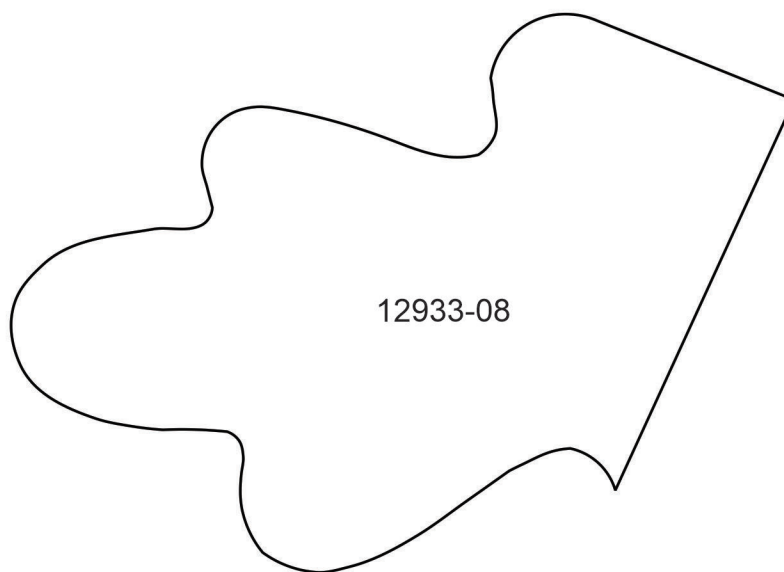
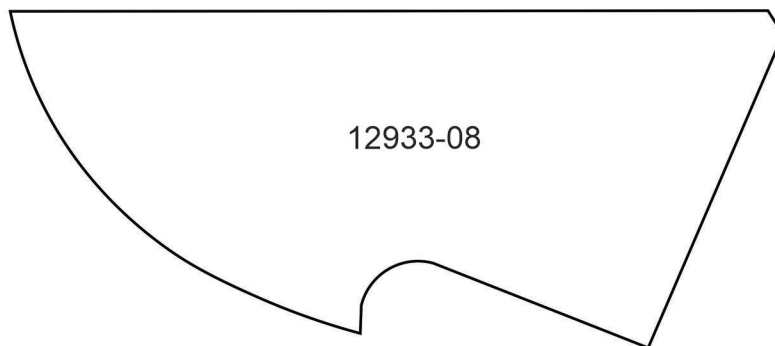

APPLIQUE PATTERNS



Print at 100%. No scaling. This box measures 1" x 1". Use the box as an accuracy guide when printing templates.

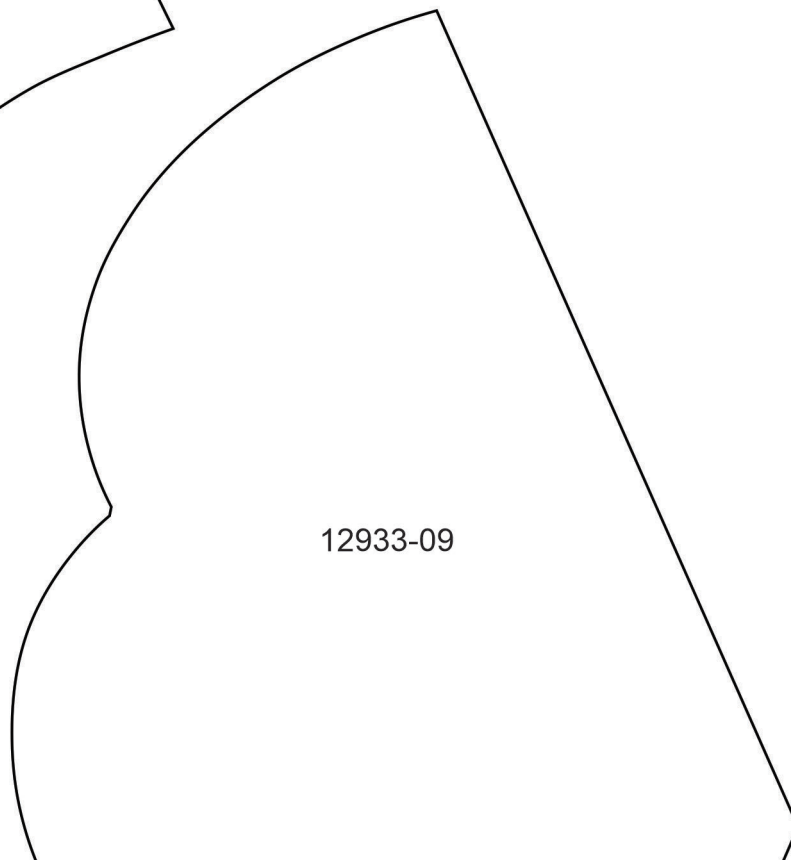
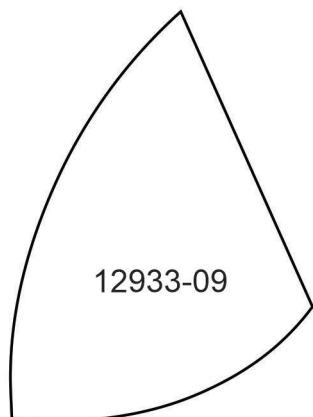
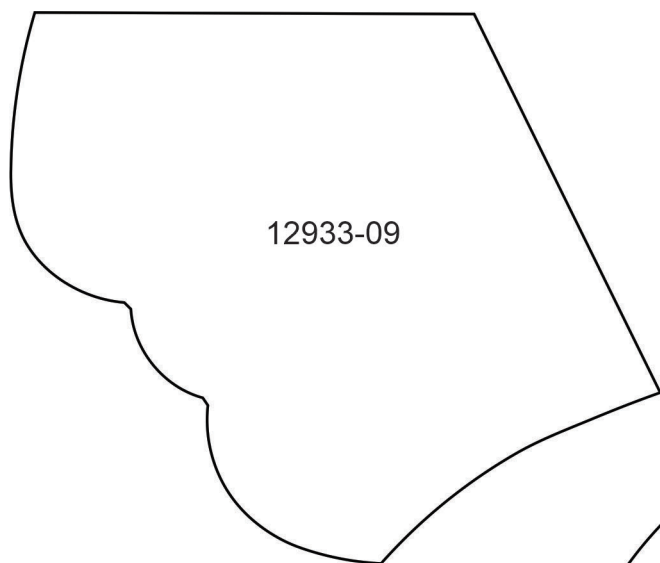

MIRRORED PATTERNS



Print at 100%. No scaling. This box measures 1" x 1". Use the box as an accuracy guide when printing templates.

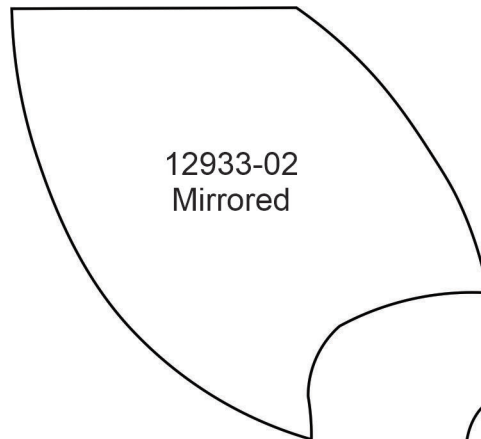
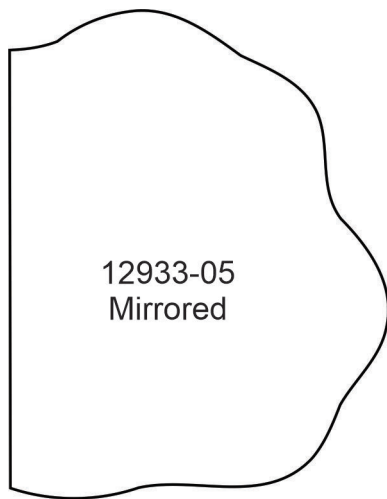
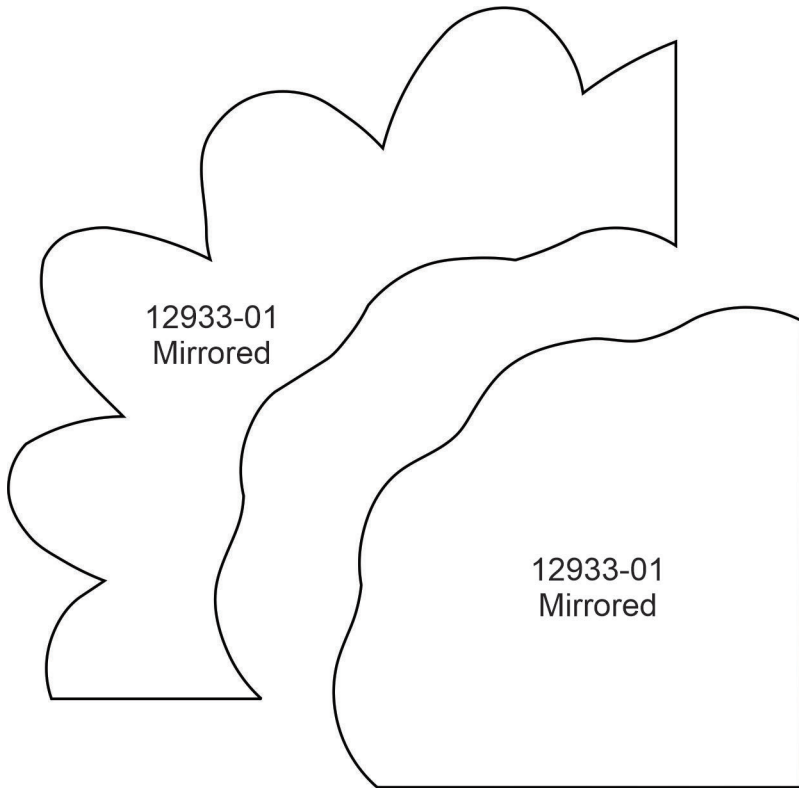

MIRRORED PATTERNS



Print at 100%. No scaling. This box measures 1" x 1". Use the box as an accuracy guide when printing templates.

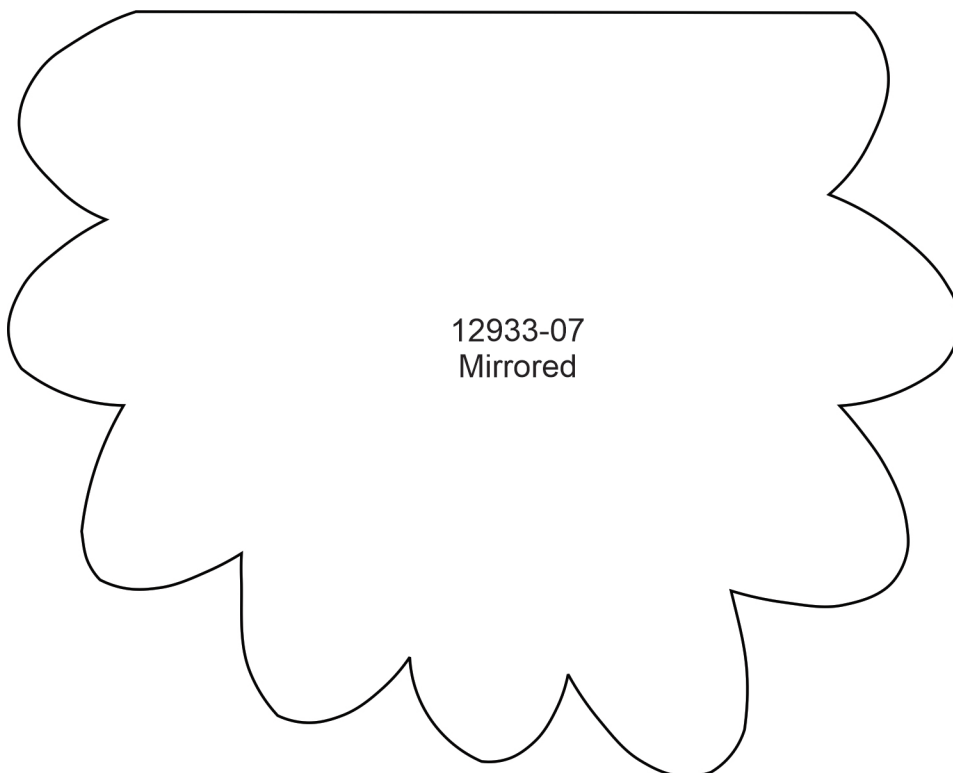
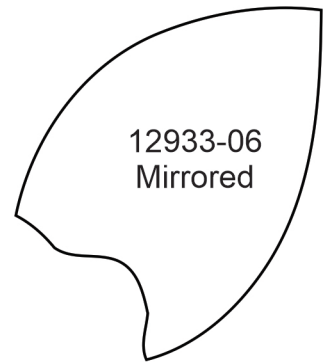
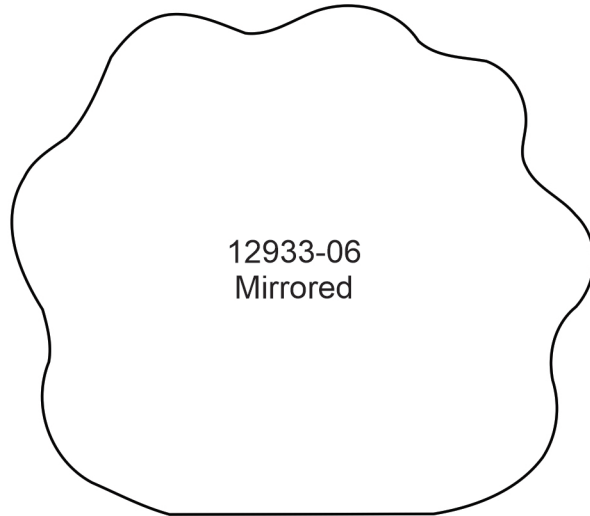

MIRRORED PATTERNS



Print at 100%. No scaling. This box measures 1" x 1". Use the box as an accuracy guide when printing templates.

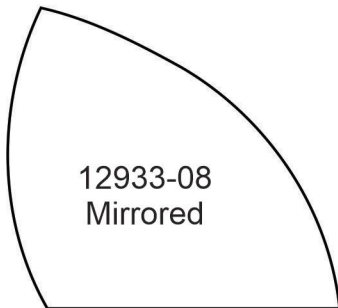
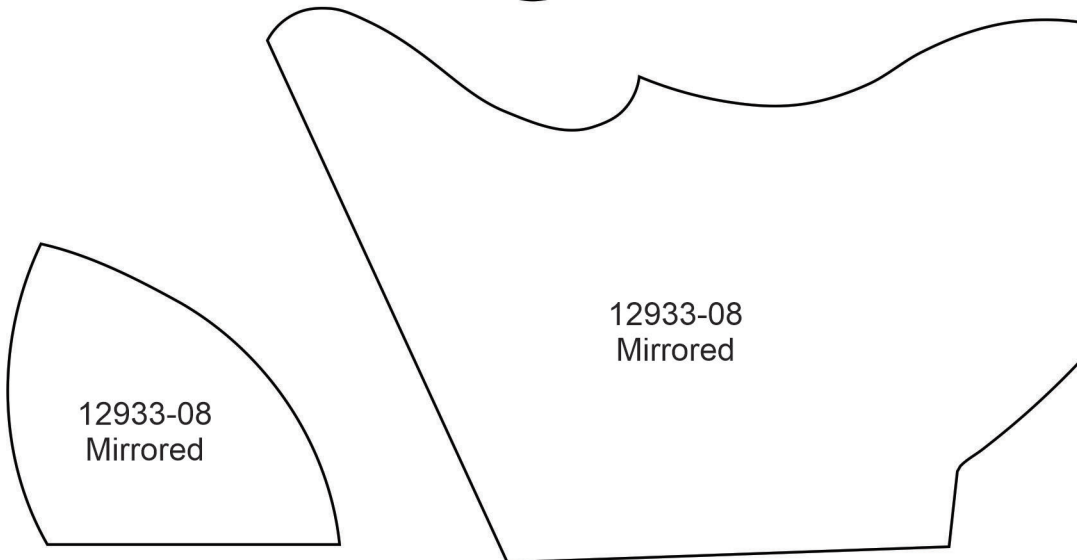
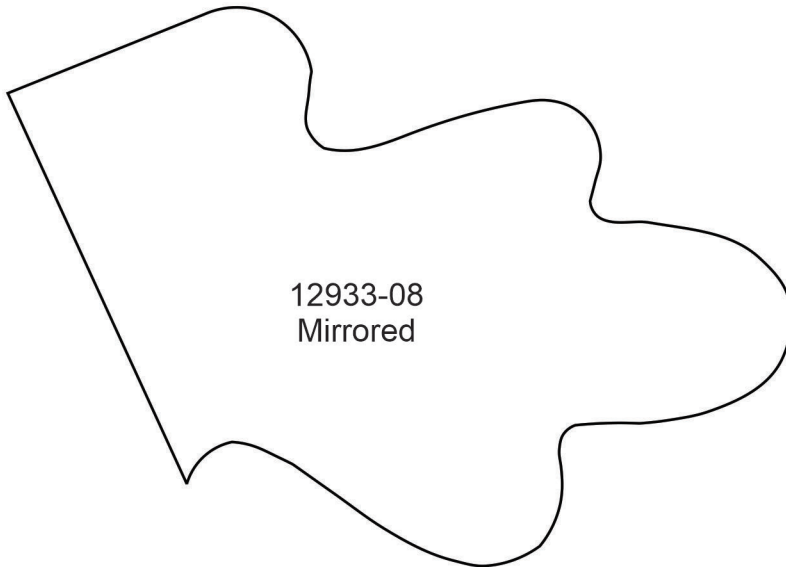
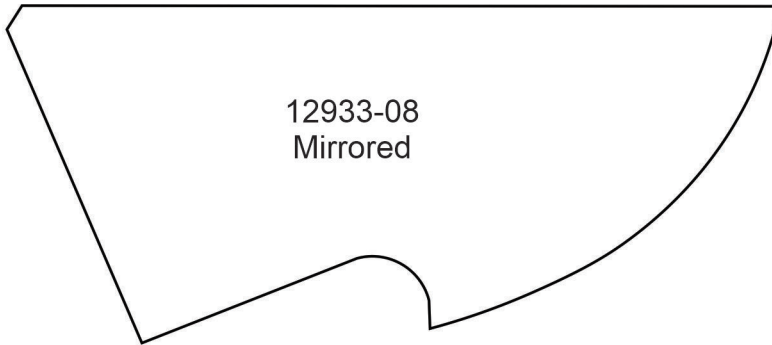

MIRRORED PATTERNS



Print at 100%. No scaling. This box measures 1" x 1". Use the box as an accuracy guide when printing templates.

