

SHIMMERING HOLIDAY CARDS



15
Designs

THREAD LIST

Isacord Thread Colors

0015 White
1840 Corsage
2650 Impatiens
3770 Oyster
3962 River Mist
5440 Mint
7009 (S1) Platinum

Note: One spool of 1000 meter thread is adequate for the project unless otherwise noted.

Stabilizers

- OESD StabilStick TearAway
- OESD AquaMesh WashAway
- OESD BadgeMaster WashAway
- OESD Applique Fuse and Fix
- OESD Fuse and Seal

Fabrics/Textiles

- OESD Start Here Greeting Cards, size A7 (5" x 7")
- OESD Start Here Greeting Cards, size A6 (4.5" x 6.25")
- Quilter's cotton various colors

Notions & Tools

- OESD Grippy GRID
- OESD Perfect Punch Tool
- OESD MiniMAT
- OESD Perfect Embroidery Press Cloth
- White Brads
- Embroidery Needle Sharp 75/11
- Embroidery Needle Ballpoint 80/12 (FSL)

Isacord Thread Colors

- Per the thread chart
- Match bobbin thread to top thread (FSL)

SUMMARY



Embroidery Hoop to accommodate: 5.00" x 7.00"
Finished project size: Size 5.00" x 7.00"

12959-01



Requires 1 Design

12959-02



Requires 1 Design



Size 7.00" X 5.00"

12959-03



Requires 1 Design

12959-04



Requires 1 Design



Size 7.00" X 5.00"

SUMMARY

12959-05

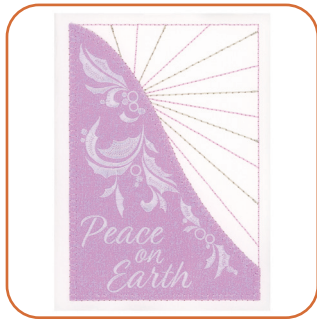

Requires 1 Design



12959-06



Requires 1 Design

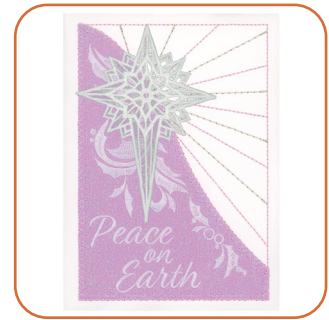

Size 7.00" X 5.00"

12959-07



Requires 1 Design



12959-08



Requires 1 Design



Size 7.00" X 5.00"

12959-09



Requires 1 Design



12959-10



Requires 1 Design



Size 7.00" X 5.00"

12959-11



Requires 1 Design



12959-12



Requires 1 Design



Size 7.00" X 5.00"

SUMMARY

12959-13



Requires 1 Design



12959-14



Requires 1 Design



Size 7.00" X 5.00"

12959-15



Requires 1 Design



12959-16



Requires 1 Design



Size 7.00" X 5.00"

12959-17

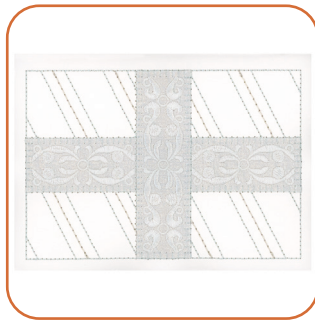

Requires 1 Design



12959-18



Requires 1 Design

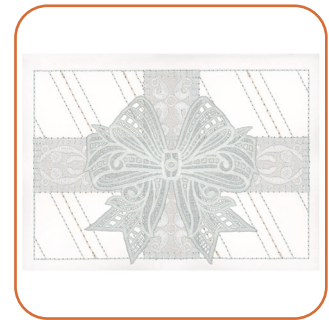

Size 7.00" X 5.00"

12959-19



Requires 1 Design



12959-20



Requires 1 Design



Size 7.00" X 5.00"

SUMMARY

12959-21



Size: 6.25 X 4.62 in.

12959-22



Size: 6.25 X 4.62 in.

12959-23



Size: 6.25 X 4.62 in.

12959-24



Size: 6.25 X 4.62 in.

12959-25



Size: 6.25 X 4.62 in.

Notes

The greeting card instructions included in the collection are general instructions for all the greeting card designs. For demonstration purposes, a sample design that best demonstrates the technique is shown. Fabric and thread requirements will vary by design, consult the templates at the end of the instructions for specific size requirements.

The sample design is 12959-01.

Freestanding Lace designs are stitched with matching thread, top and bobbin.

Note: Some thread colors in instructions have been changed or digitally enhanced for better visibility.

STEP 1

- Print the mirrored version of the templates (at 100% scale or 1:1 ratio) onto the paper side of Applique Fuse and Fix.
- Cut approximately $\frac{1}{4}$ " - $\frac{1}{2}$ " outside the printed applique templates.

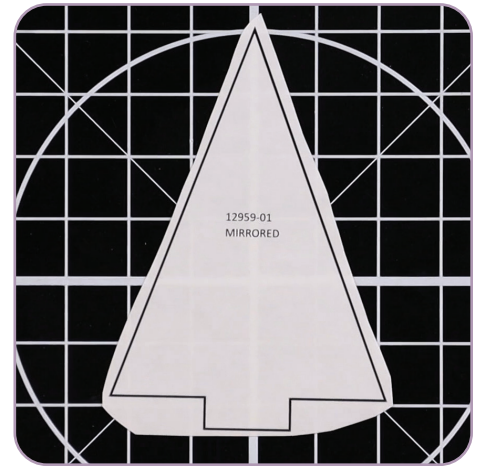

STEP 2

- Cut the applique fabric $\frac{1}{4}$ " - $\frac{1}{2}$ " larger than the applique templates.
- Fuse the trimmed templates to the back of the applique fabric with the paper side of the printed template up.
- Hold the iron on the template for 10-15 seconds for a secure fuse.

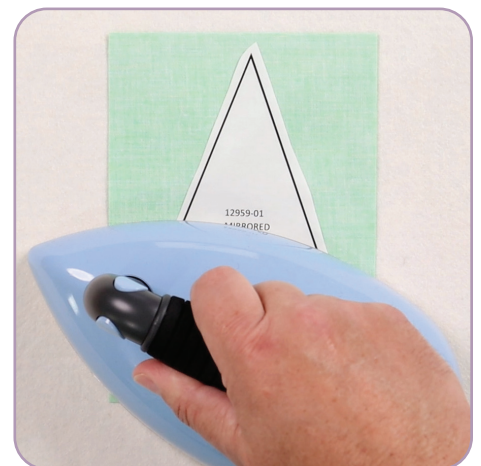

STEP 3

- Trim the applique fabric on the edge of the black outline.
- Set aside.

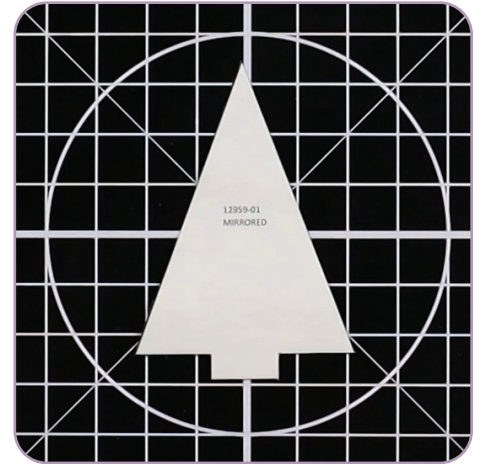

STEP 4

- Hoop one layer of StabilStick TearAway stabilizer (shiny side up).



STEP 5

- Score and remove the paper to reveal the adhesive surface.



STEP 6

- Load selected design into the machine.
- Example design is 12959-01.
- Thread the machine per the thread chart.
- Place the hoop on the machine.
- Stitch Machine Step 1, Card Placement Guide.

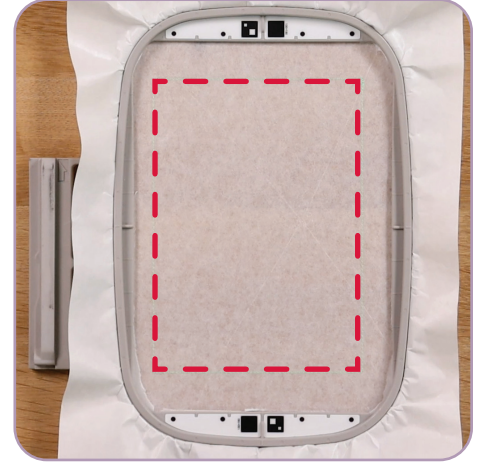

STEP 7

- Remove the hoop from the machine, but NOT the project from the hoop.
- Place the hoop on a flat surface.
- Place the front of the card face up within the placement stitch, lining up all edges.
- Gently finger press the card to secure to the adhesive surface.



STEP 8

- Return the hoop to the machine.
- Stitch Machine Step 2, Fabric Placement Stitch.

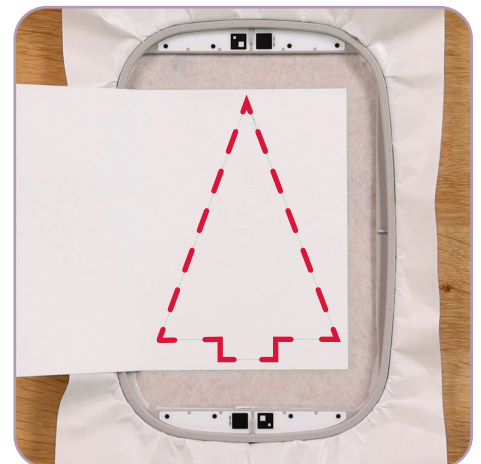

STEP 9

- Remove the hoop from the machine, but NOT the project from the hoop.
- Place the hoop on a flat surface.
- On the back of the applique fabric, score and remove the paper backing to reveal the adhesive surface.
- Place the applique fabric within the placement stitching.
- Finger press to secure.

Note: Applique Fuse and Fix is repositionable.



STEP 10

- Return the hoop to the machine.
- Stitch Machine Step 3, Fabric Tackdown.



STEP 11

- Return the hoop to the machine and stitch the remaining steps per the thread chart.



STEP 12

- When the design is complete, remove the project from the hoop.
- Place the card face down and fold the stabilizer towards the card. Carefully cut the stabilizer away, close to the stitching.

Note: Cutting away the excess tearaway stabilizer will prevent creasing and bending the cardstock.

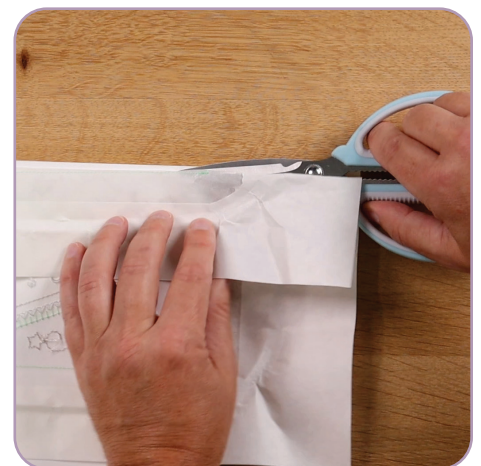

Stabilizer

- OESD AquaMesh
- OESD BadgeMaster

Notions/Tools

- 80/12 Embroidery Ballpoint Titanium needle for extended needle life
- OESD Alligator Clamps
- OESD Button Clips
- OESD Perfect Point and Press Tool

Isacord Thread Colors

- All OESD designs are digitized with Isacord 40 wt. polyester thread as the top thread and in the bobbin.
- Refer to the thread chart for color specifications.
- Match bobbin thread color to the top thread.

Instructions

Step 1 - Hoop

For FSL structures, hoop one layer of OESD AquaMesh and one layer of OESD BadgeMaster. BadgeMaster contains more starch so, combined with the AquaMesh, the lace is more rigid. For other FSL, where a softer lace is desired, hoop two layers of AquaMesh.

Step 2 - Embroider

Stitch the design per the thread chart with matching thread in the bobbin at each color change. When complete, remove from the hoop and trim away excess stabilizer about 1/4"-1/2" from the stitching.

Step 3 - Rinse

Rinse remaining stabilizer out in warm running water. For stiffer lace and FSL structures, DO NOT rinse away all of the stabilizer. The lace should be just slightly tacky. For softer lace, rinse until all traces of the stabilizer are removed.

Step 4 - Dry

Lay right side down flat on a non-stick surface, such as a cooling rack, parchment paper or Teflon sheet. This minimizes the tendency for the lace to curl. Let the pieces dry completely before proceeding with any assembly.

Step 5 - Press

Once completely dry, press right side down on a OESD Perfect Embroidery Press Cloth.

Step 6 - Assemble Structure

Note: Specific assembly instructions for a design/collection may be found in the thread chart pdf following the individual design color charts.

Lace must be COMPLETELY DRY before assembly. Wetting the buttonettes or eyelets to assemble is not recommended and may result in them stretching and coming "unbuttoned" when dry.

Use a pair of OESD Alligator Clamps to insert the buttonettes into the eyelets. Insert the tip of the OESD Alligator Clamps into the eyelet, grasp the buttonette and pull through the eyelet. Alternatively, use a stiletto or tweezers to push the buttonette through the eyelet.

Helpful Tips

Limp Lace

If the design is not stiff enough, press the lace pieces on the wrong side while applying spray starch. After ironing, spray again with starch and allow to dry completely. This will stiffen the lace pieces nicely and aid in construction. Or easily re-stiffen by diluting some stabilizer scraps in water (or use liquid starch) and dipping the item in the solution. Lay flat to dry.

Eyelets Too Small

If any of the eyelets appear closed or too small to penetrate with Alligator Clamps, they may be stretched by inserting the small end of the OESD Perfect Point and Press Tool into the eyelet opening and stretching it open wide enough to accommodate the OESD Alligator Clamps.

Button Clips

During the assembly process, some structures pull on buttonettes that have already been inserted and could pull them out altogether. Putting a Button Clip on the assembled buttonette will keep it in position during the assembly process. Remove the Button Clips when the assembly is complete.

Alternative Construction Option

In some cases, the buttonettes may be pulled to the inside of a project, instead of being visible on the outside. Insert the OESD Alligator Clamps through the eyelet from the wrong, or inside, of the lace and grasp the corresponding buttonette. Pull the buttonette to the wrong side of the lace.

Pulling the buttonettes to the inside may cause stress on the ones already done. Button clips may be placed on the completed buttonette(s) to prevent them from pulling out of the eyelet during construction.

STEP 13

- Cut coordinating cardstock paper (or scrapbook paper) slightly smaller than the front of the card.
- Cut a piece of Fuse and Seal to fit.
- Following the package instructions, with a medium-warm iron, press the Fuse and Seal to the wrong side of the cardstock (scrapbook paper).
- Let cool.

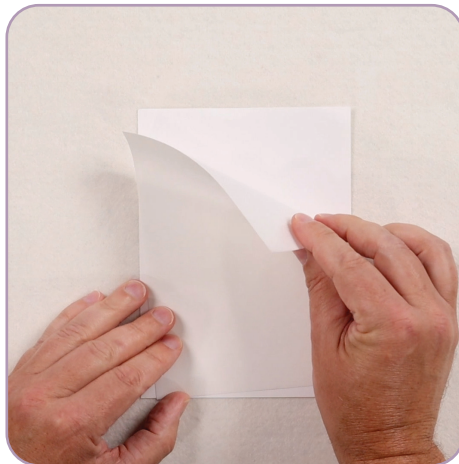

STEP 14

- Remove paper from Fuse and Seal, line up cardstock (scrapbook paper) over the backside of the card, and press to fuse.

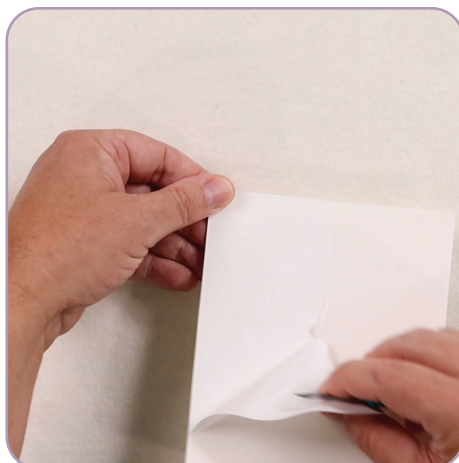

ASSEMBLY

STEP 15

- Use the OESD MiniMAT and Punch Tool with the 3mm attachment to create the eyelets indicated in the diagram.
- **Tip:** Take care to not cut the satin stitching.
- Reference the Punch Tool Guide on pages 16-17.



STEP 16

- Match the eyelets of the freestanding lace tree (12959-02) to the eyelets of the card.

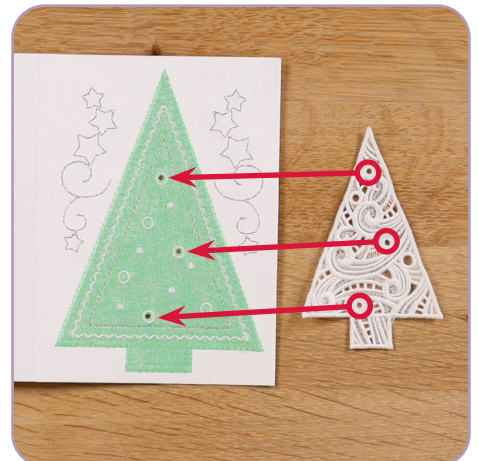

ASSEMBLY

STEP 17

- Insert a brad in each eyelet.
- Bend each tab of the brad back against the card to secure.

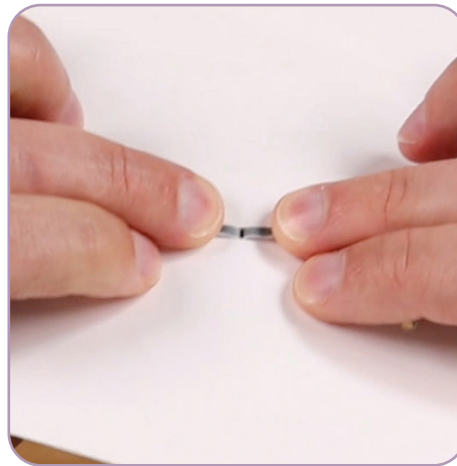

STEP 18

- The card is complete. Enjoy!



12959-01

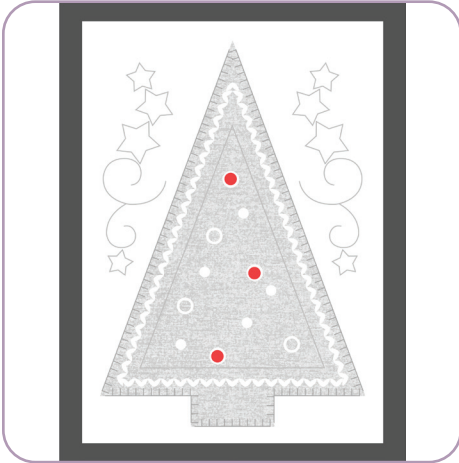

12959-03



12959-05



12959-07



12959-09

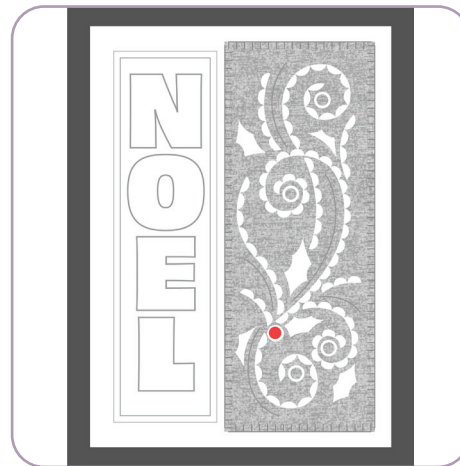

-  = 2 MM
-  = 3 MM
-  = 4 MM

12959-11



12959-13



12959-15



12959-17

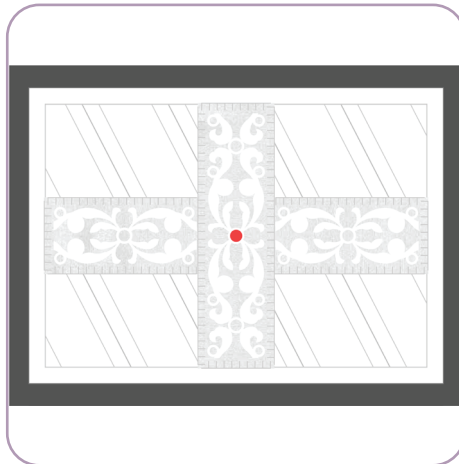

12959-19



-  = 2 MM
-  = 3 MM
-  = 4 MM

ATTENTION

When printing this document, any page scaling or page fitting options in your print dialog box must be turned OFF or set to NONE so that your files will print out at their actual size. Images not printed at actual size will not function as intended.

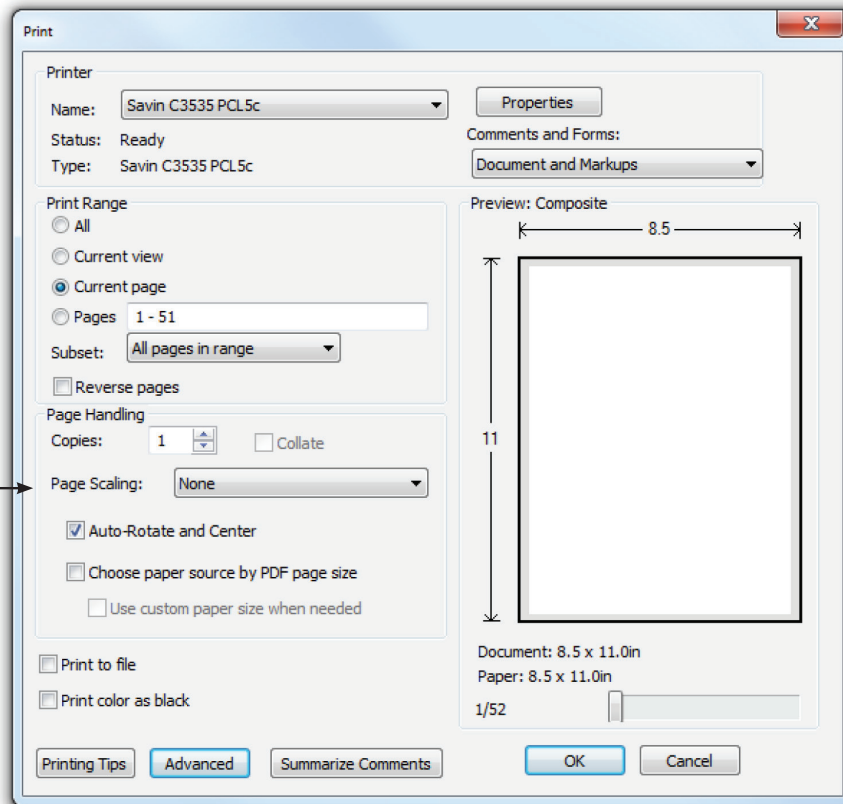

TO SAVE PAPER

Only print the desired image by navigating to the image's page, go to File > Print and select "Current page" in the print dialog box. Repeat for each desired image.

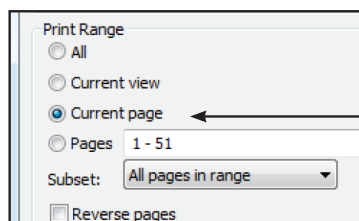

APPLIQUE PATTERNS

Print at 100%. No scaling. This box measures 1" x 1". Use the box as an accuracy guide when printing templates.

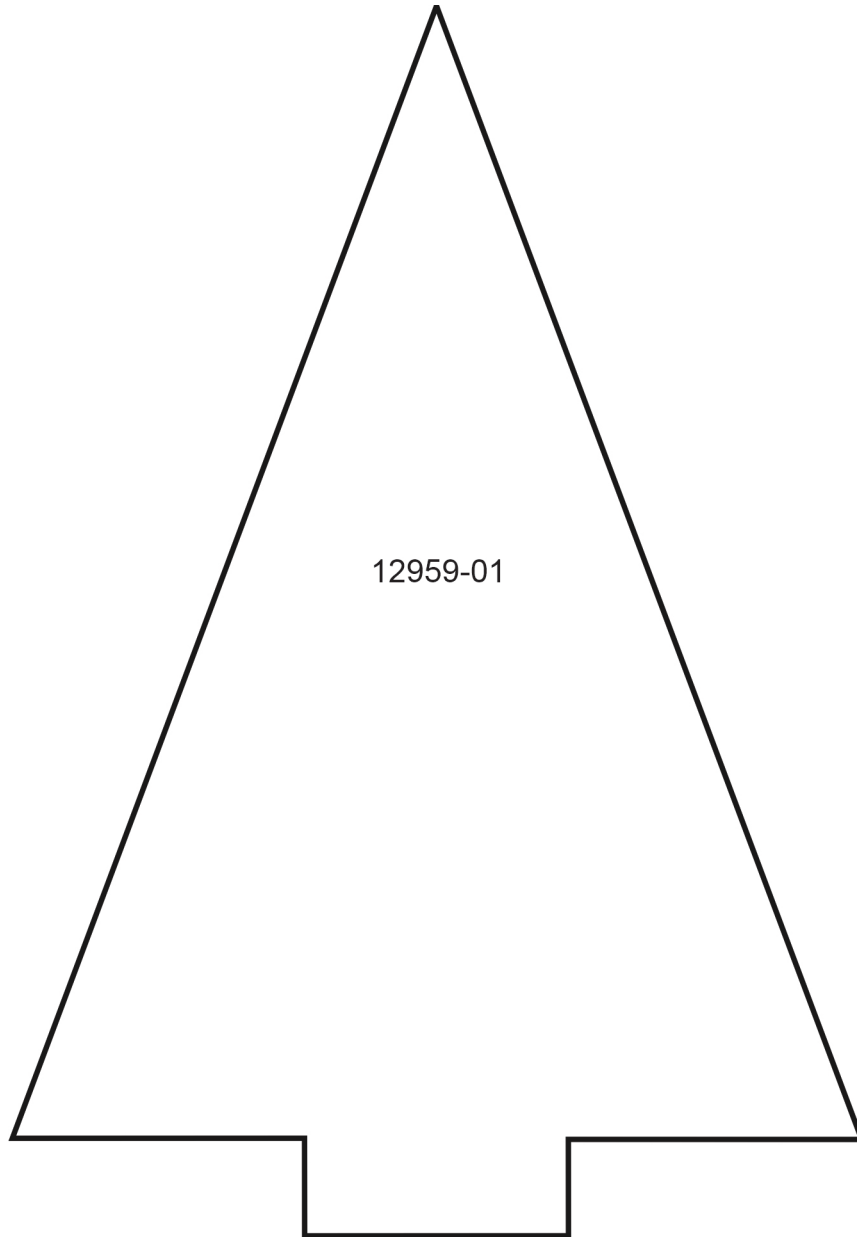

APPLIQUE PATTERNS

Print at 100%. No scaling. This box measures 1" x 1". Use the box as an accuracy guide when printing templates.

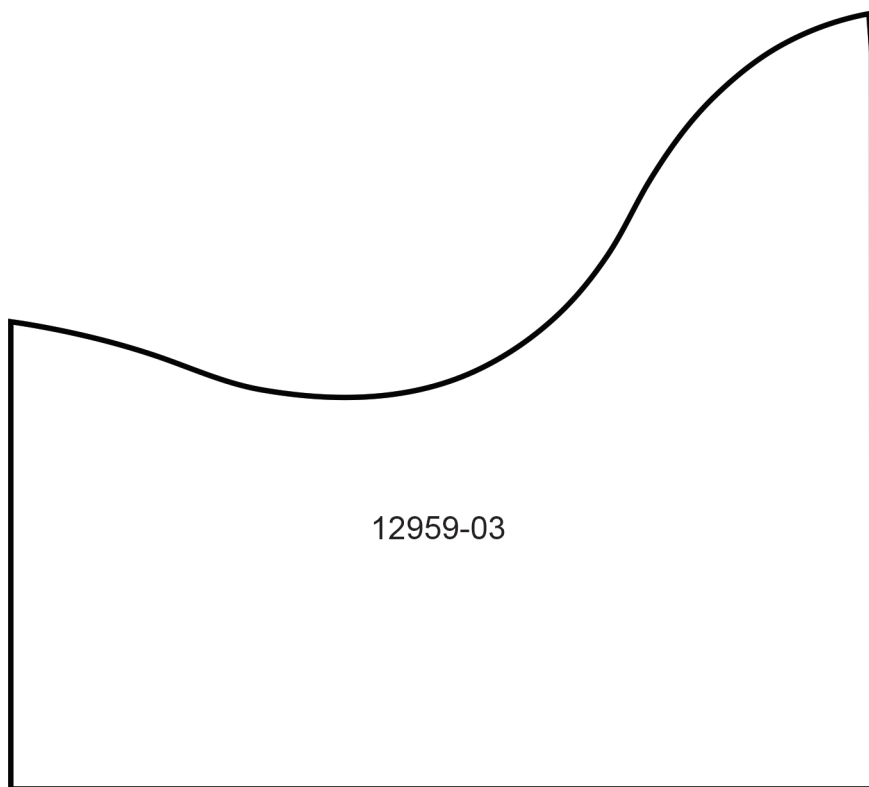
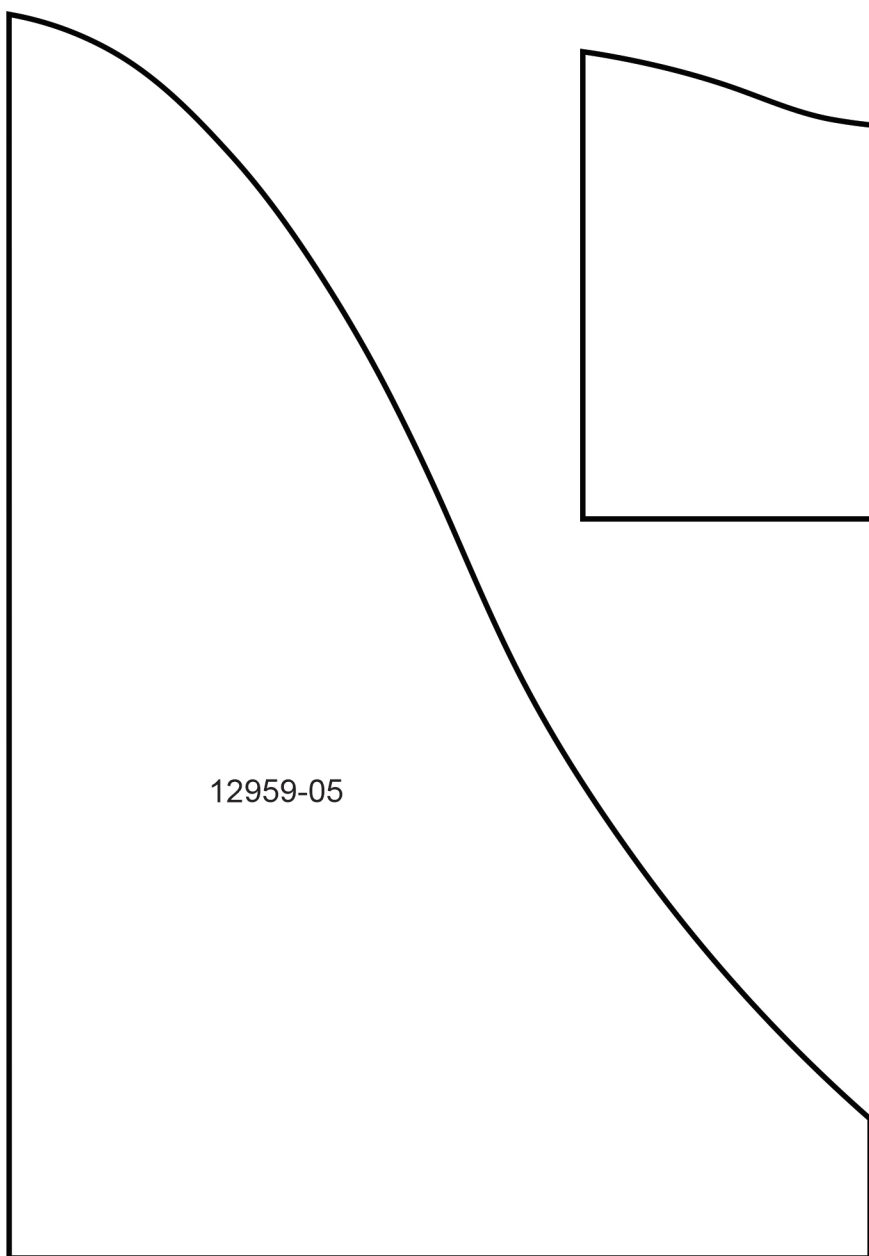

APPLIQUE PATTERNS

Print at 100%. No scaling. This box measures 1" x 1". Use the box as an accuracy guide when printing templates.

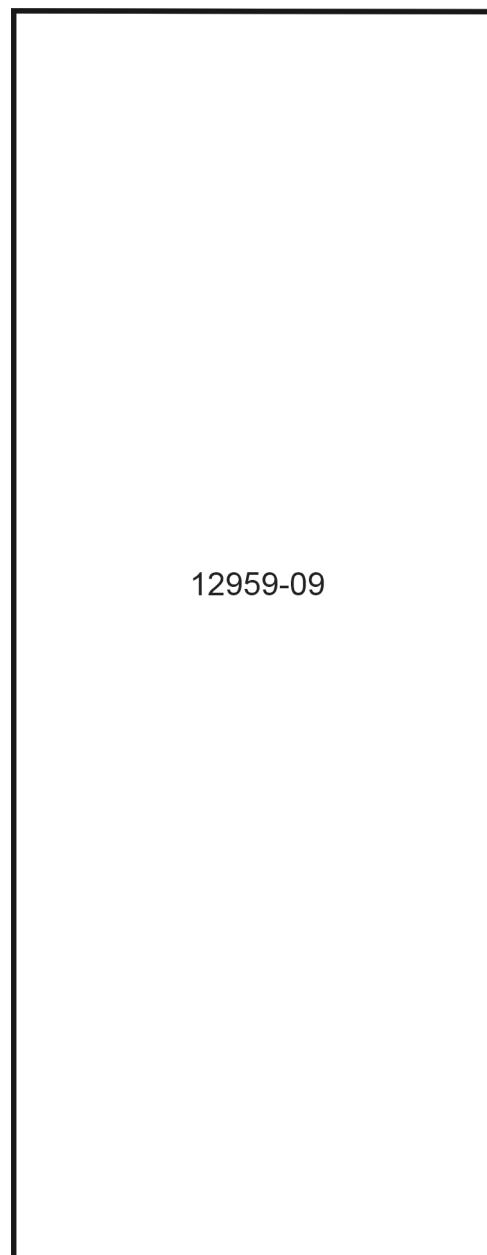
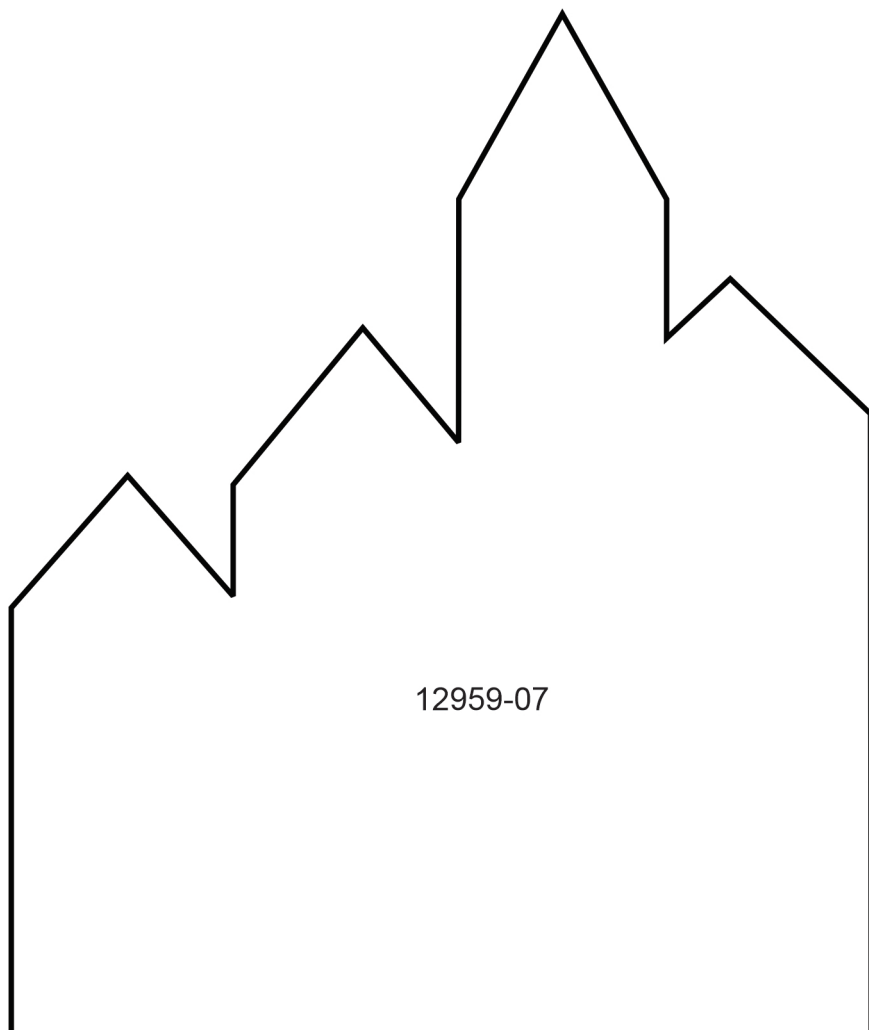

APPLIQUE PATTERNS

Print at 100%. No scaling. This box measures 1" x 1". Use the box as an accuracy guide when printing templates.

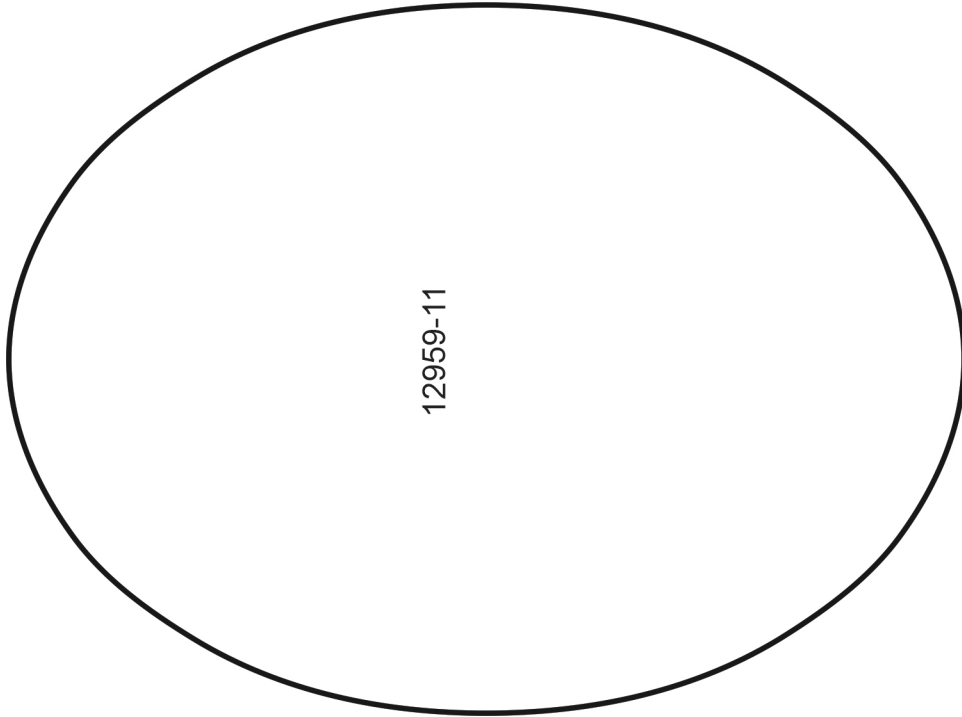

12959-11

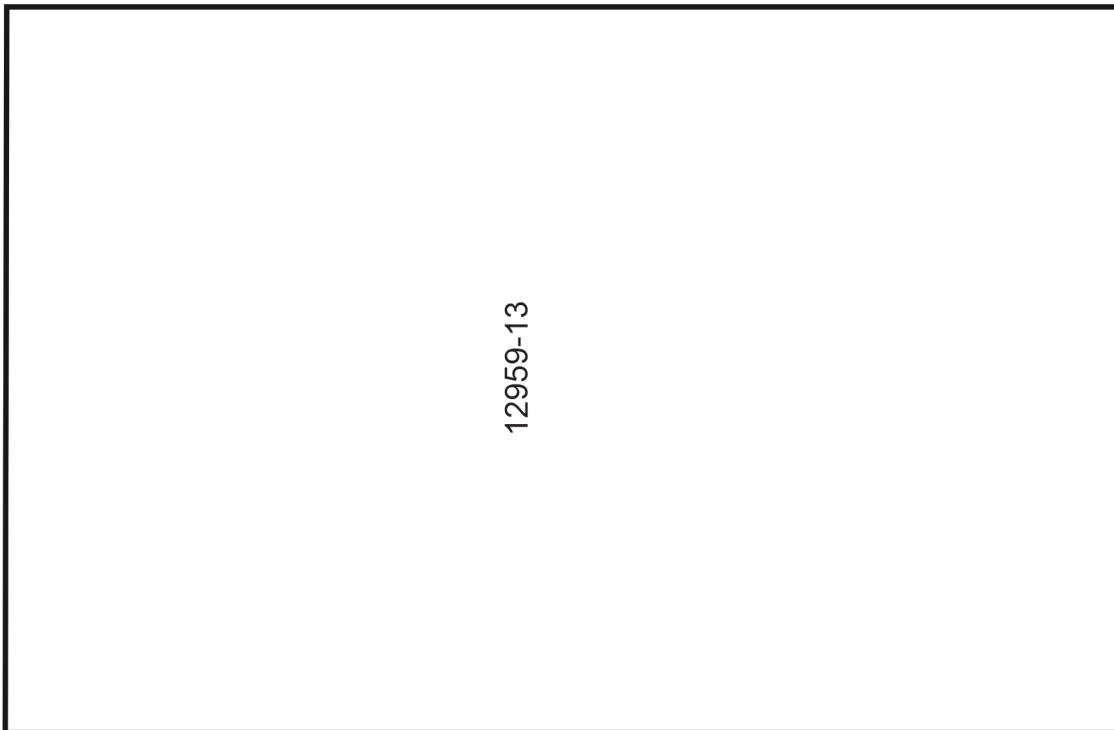

12959-13

APPLIQUE PATTERNS

Print at 100%. No scaling. This box measures 1" x 1". Use the box as an accuracy guide when printing templates.

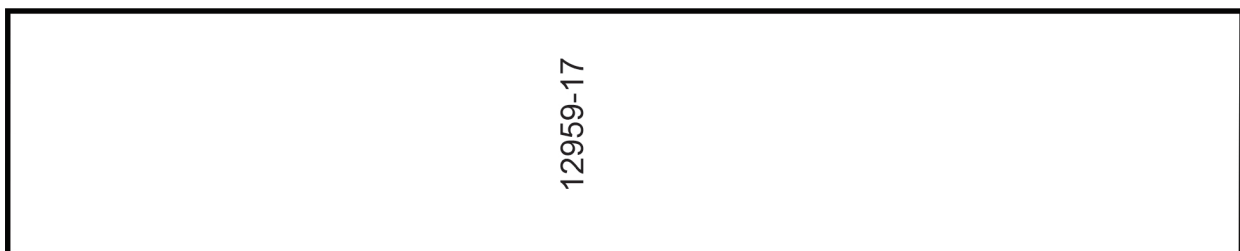
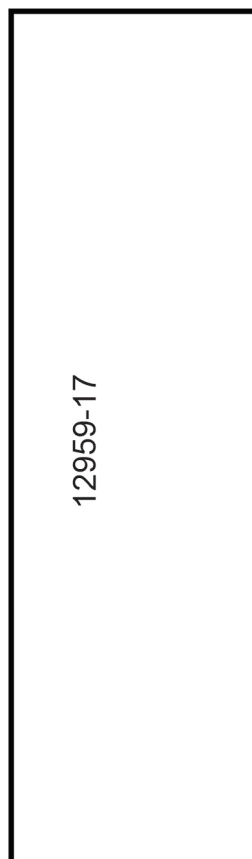

APPLIQUE PATTERNS

Print at 100%. No scaling. This box measures 1" x 1". Use the box as an accuracy guide when printing templates.

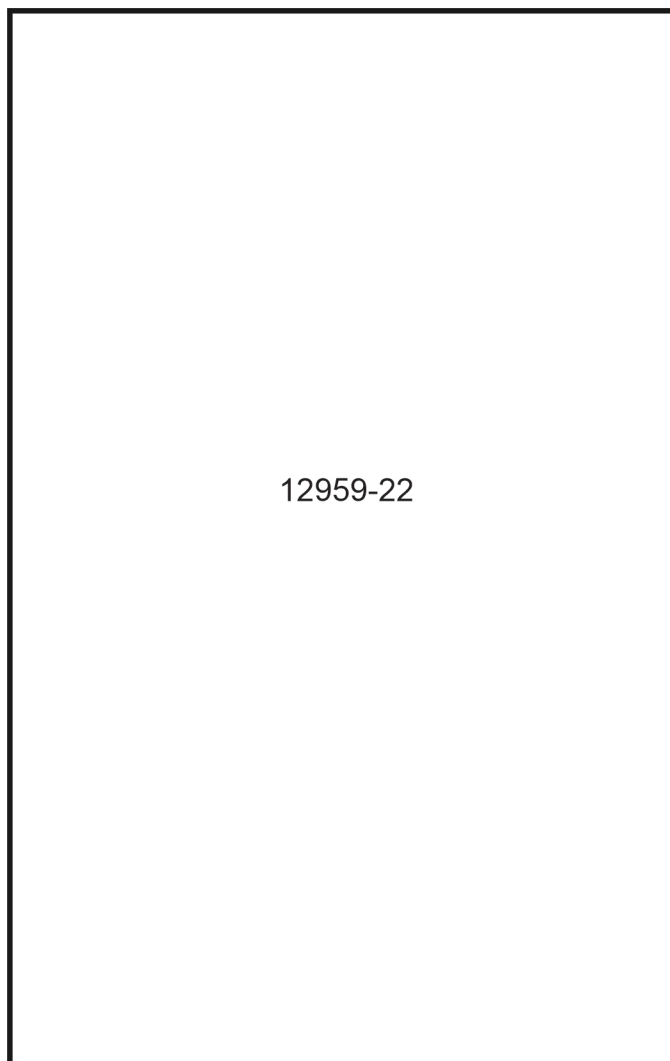
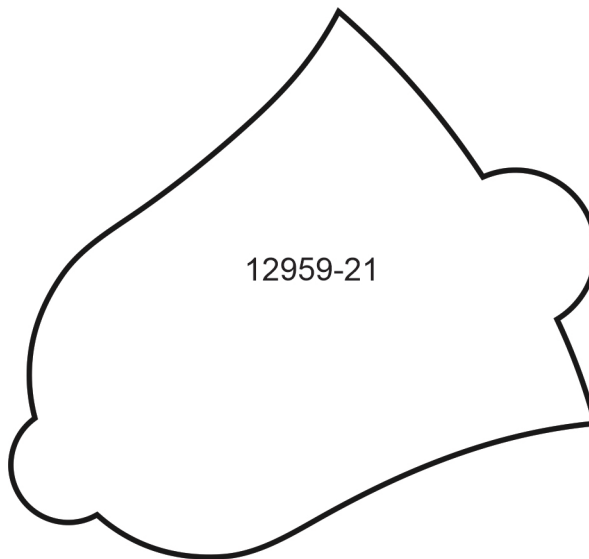
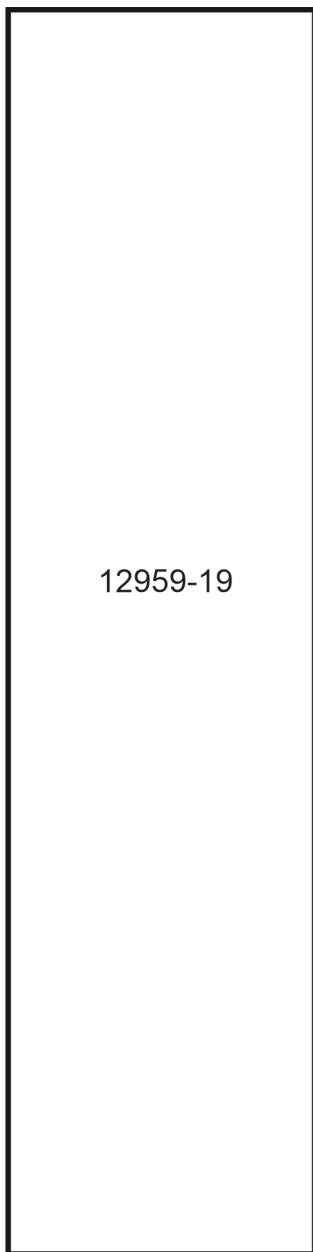

APPLIQUE PATTERNS

Print at 100%. No scaling. This box measures 1" x 1". Use the box as an accuracy guide when printing templates.

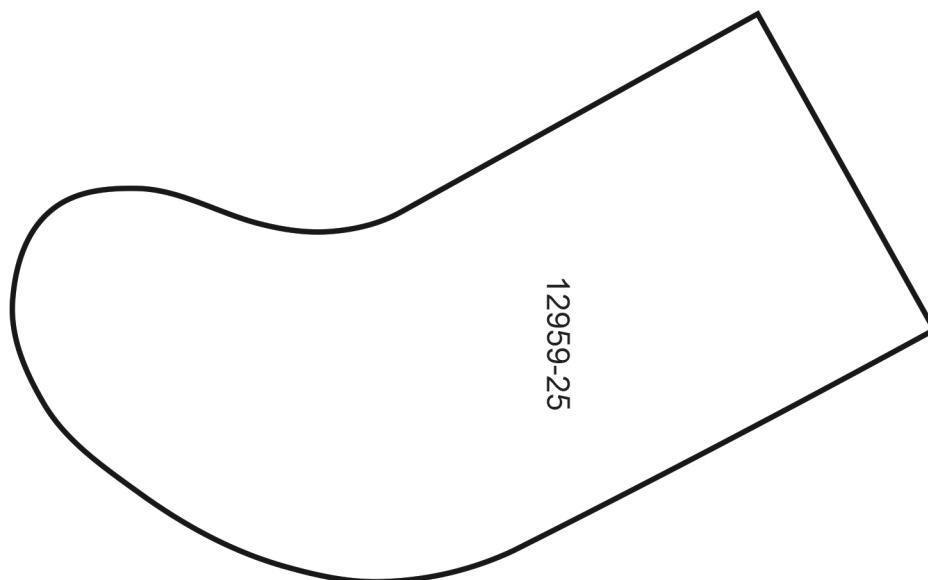
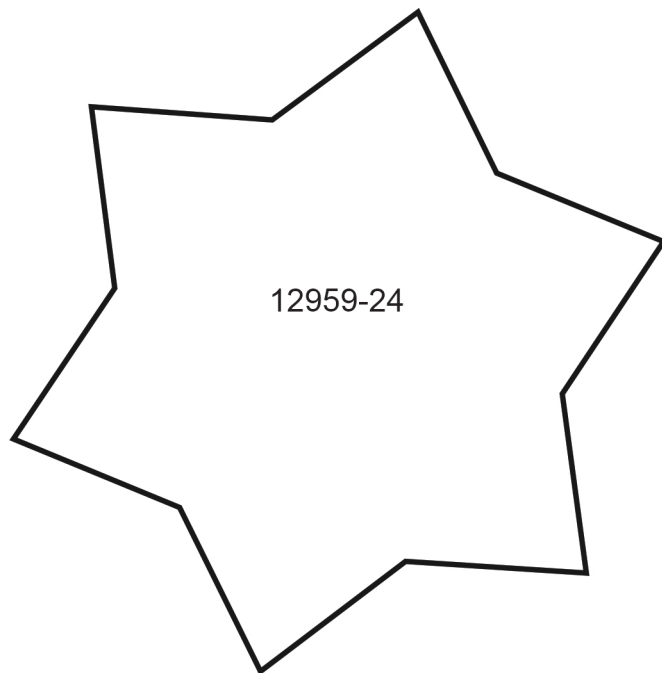
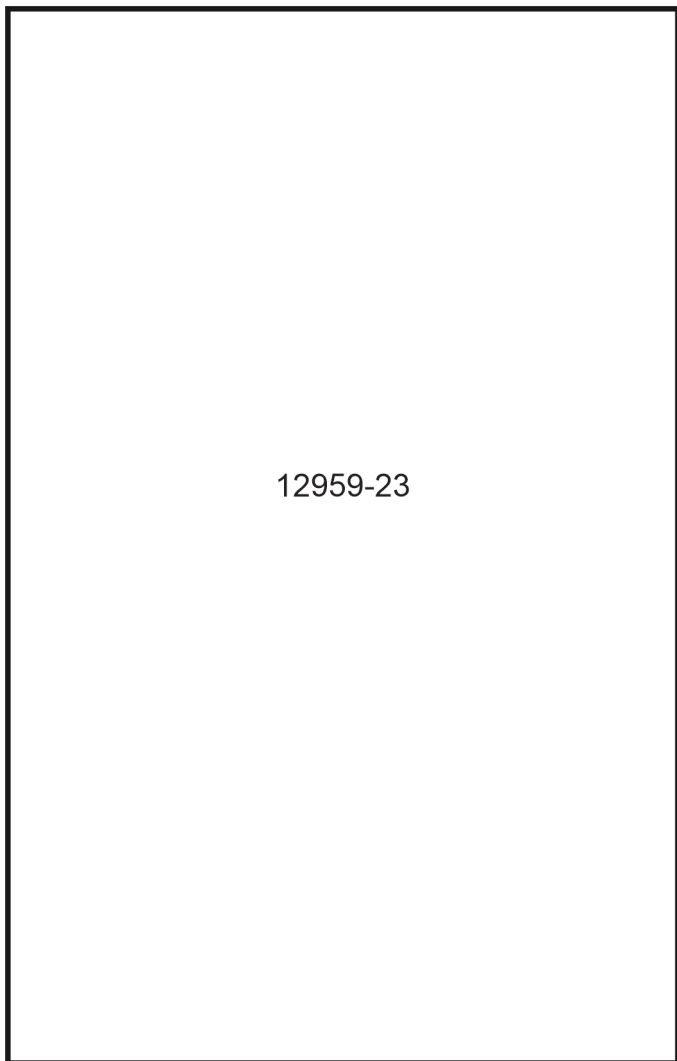

MIRRORED PATTERNS

Print at 100%. No scaling. This box measures 1" x 1". Use the box as an accuracy guide when printing templates.

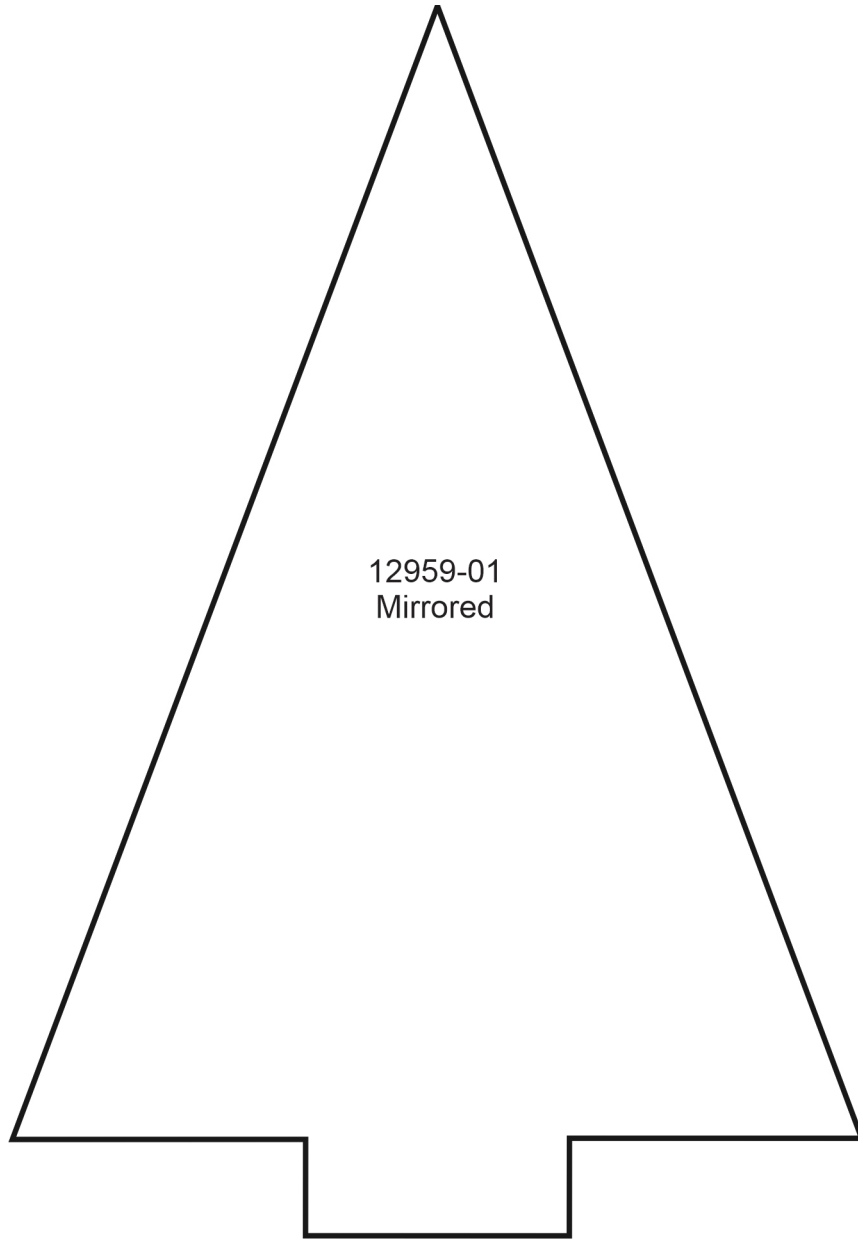

MIRRORED PATTERNS

Print at 100%. No scaling. This box measures 1" x 1". Use the box as an accuracy guide when printing templates.

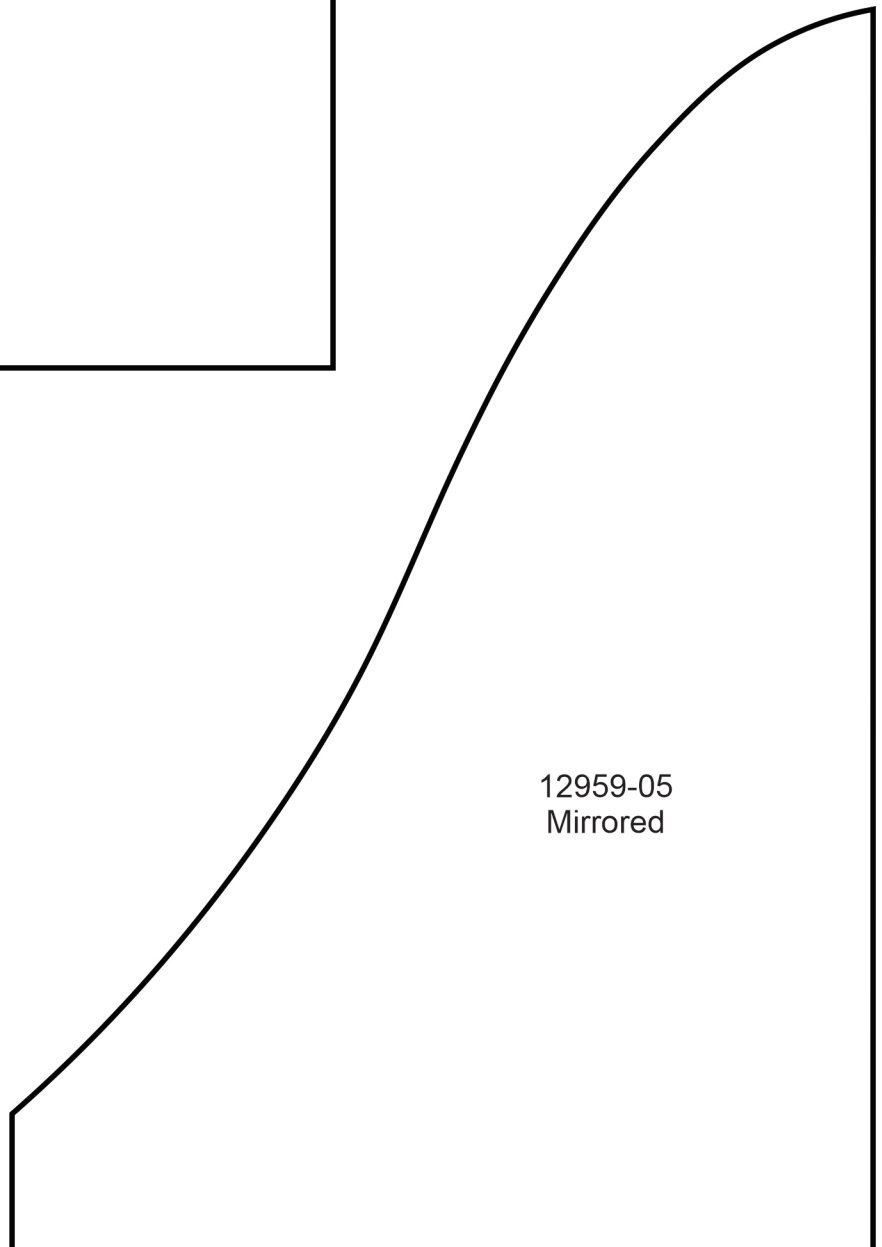
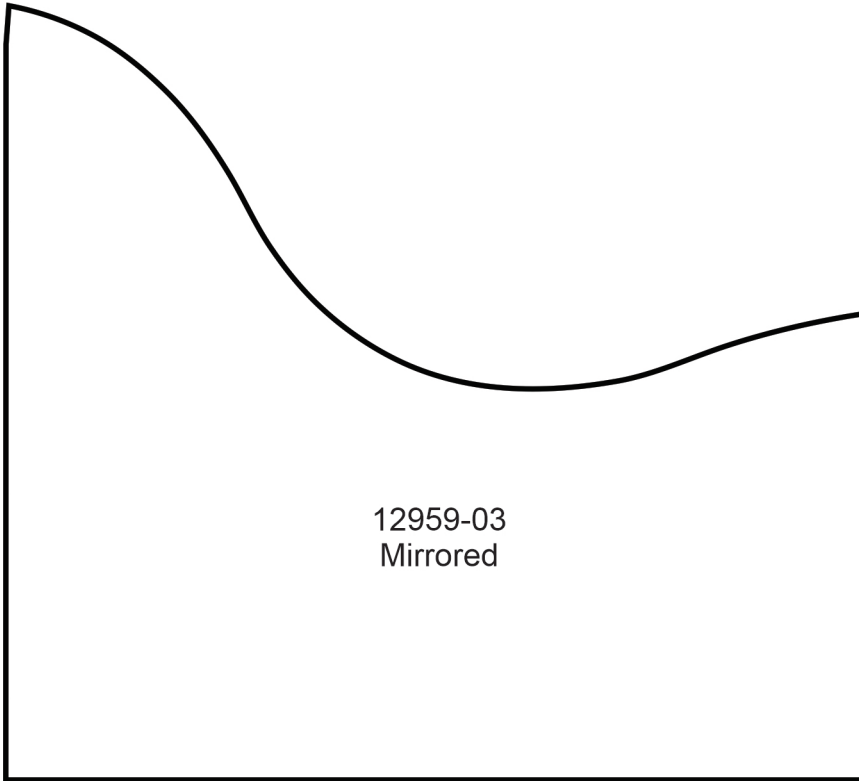

MIRRORED PATTERNS

Print at 100%. No scaling. This box measures 1" x 1". Use the box as an accuracy guide when printing templates.

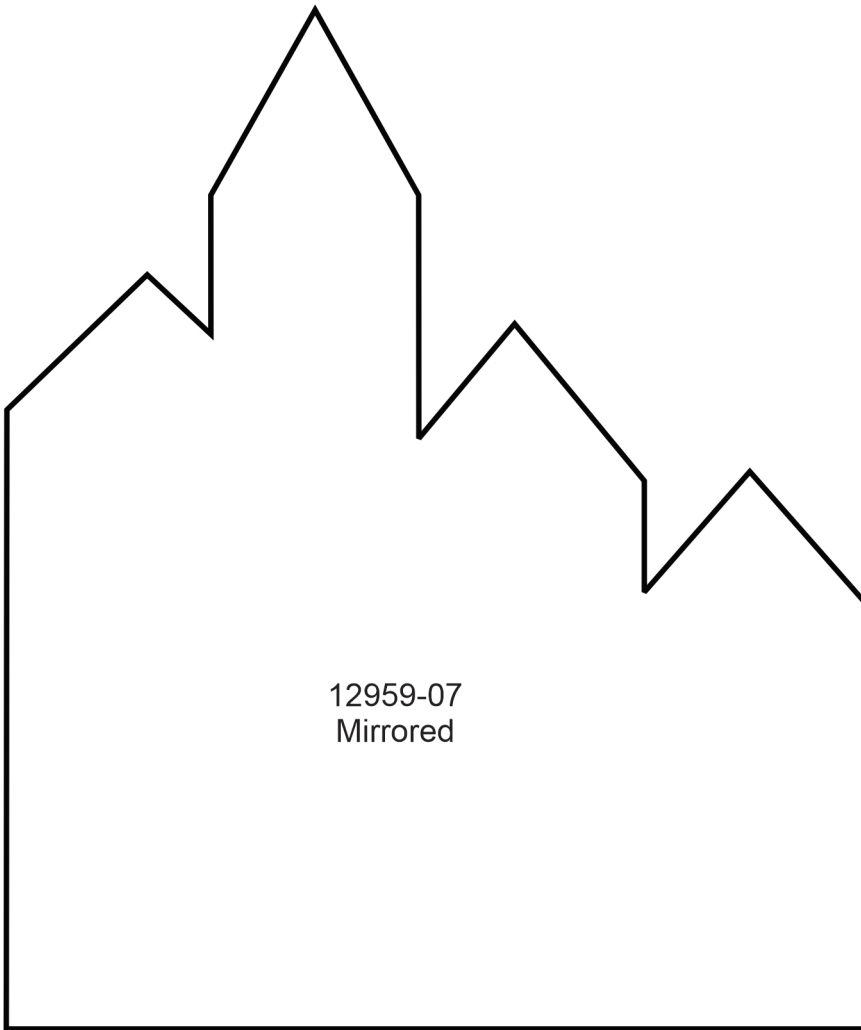

MIRRORED PATTERNS

Print at 100%. No scaling. This box measures 1" x 1". Use the box as an accuracy guide when printing templates.

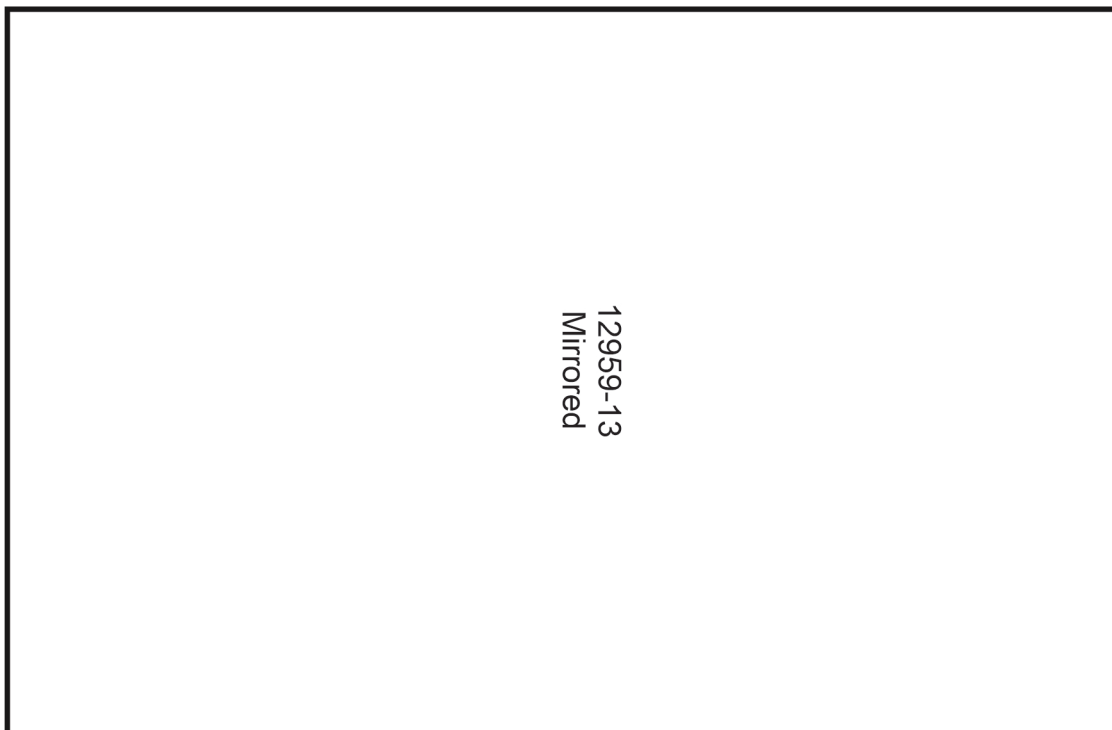
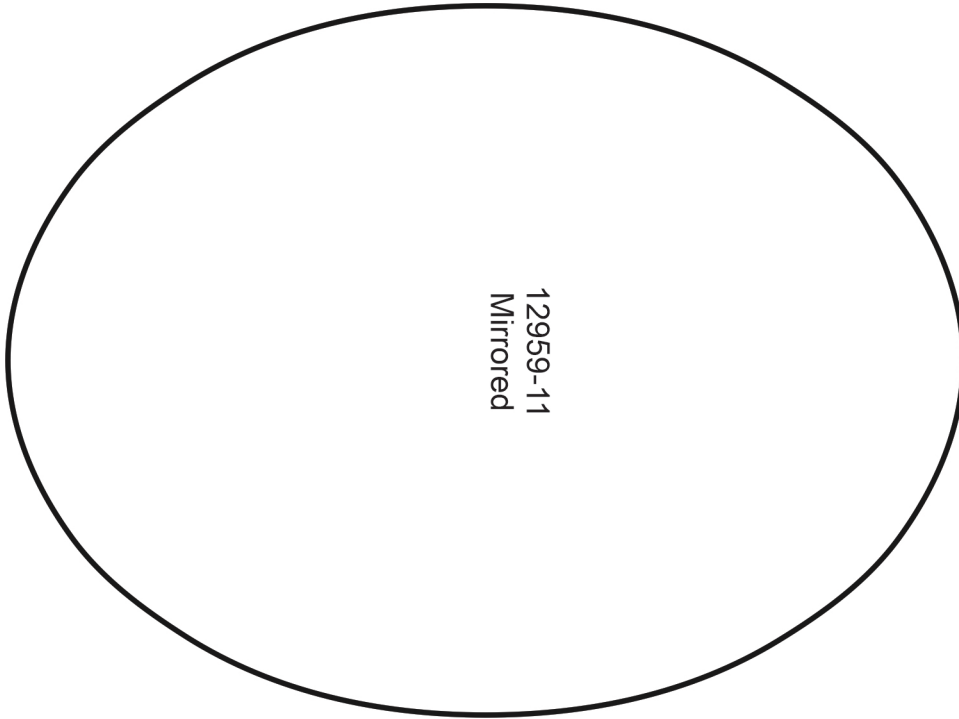

MIRRORED PATTERNS

Print at 100%. No scaling. This box measures 1" x 1". Use the box as an accuracy guide when printing templates.

12959-15
Mirrored

12959-17
Mirrored

12959-17
Mirrored

MIRRORED PATTERNS

Print at 100%. No scaling. This box measures 1" x 1". Use the box as an accuracy guide when printing templates.

12959-19
Mirrored

12959-21
Mirrored

12959-22
Mirrored

MIRRORED PATTERNS

Print at 100%. No scaling. This box measures 1" x 1". Use the box as an accuracy guide when printing templates.

