



Freestanding Flower Shop of Horrors



Collection No. 12970
1 Design/23 Files

MATERIALS



Isacord Thread Colors

- 0010 Silky White
- 0020 Black
- 0132 Dark Pewter
- 0150 Mystik Grey
- 0811 Candlelight
- 0904 Spanish Gold
- 1114 Clay
- 6043 Yellowgreen
- 6141 Spring Green

Note: One spool of 1000 meter thread is adequate for the project unless otherwise noted.



MATERIALS



Stabilizers

- OESD AquaMesh WashAway
- OESD BadgeMaster WashAway
- OESD StabilStick CutAway
- OESD Fiber Form
- OESD Applique Fuse and Fix

Fabrics/Textiles

- OESD Clear Vinyl
- Orange quilter's cotton
- Gray quilter's cotton

Notion & Tools

- OESD Grippy GRID
- OESD Expert Embroidery Tape TearAway
- OESD Expert Embroidery Tape WashAway
- OESD Perfect Punch Tool
- OESD MiniMAT
- OESD Alligator Clamps
- OESD Button Clips
- OESD Perfect Embroidery Press Cloth
- Embroidery Needle Sharp 75/11 (FSA)
- Embroidery Needle Ballpoint 80/12 (FSL)

Isacord Thread Colors

- Per the thread chart
- Match bobbin thread to top thread



SUMMARY



Finished project size: 10" H x 9.75" L x 6" W

12970-01
Inner Wall 1 FSA



Requires 1 Design

12970-02
Front Window Wall FSA



Requires 1 Design

12970-03
Inner Wall 2 FSA



Requires 1 Design

12970-04
Back Door Wall FSA



Requires 1 Design

12970-05
Awning FSA



Requires 1 Design

12970-06
Front Door Wall FSA



Requires 1 Design

SUMMARY

12970-07
Side Wall FSA



Requires 1 Design

12970-08
Back Wall FSA



Requires 1 Design

12970-09
Side Roof FSA

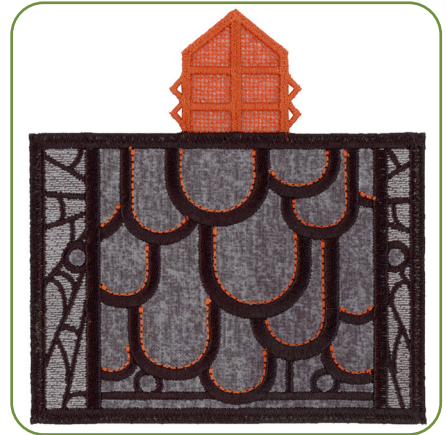

Requires 1 Design

12970-10
Side Floor FSA



Requires 1 Design

12970-11
Greenhouse Back Wall FSA



Requires 1 Design

12970-12
Greenhouse Side Wall FSA

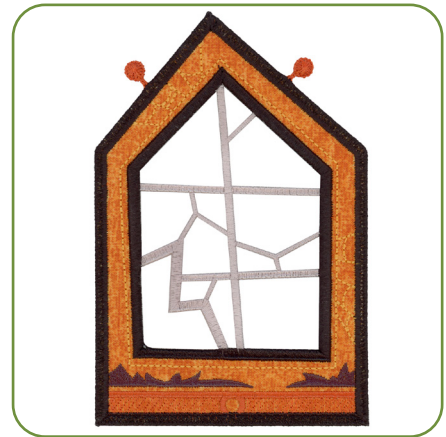

Requires 1 Design

SUMMARY

12970-13

Greenhouse Front Wall FSA



Requires 1 Design

12970-14

Greenhouse Roof FSA

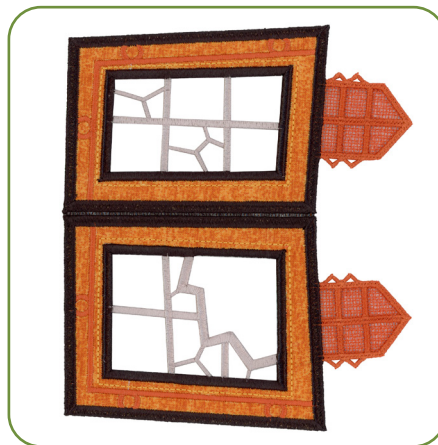

Requires 1 Design

12970-15

Greenhouse Floor FSA

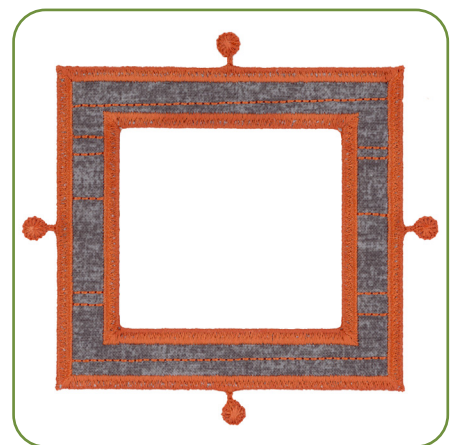

Requires 1 Design

12970-16

Main Roof 1 FSA

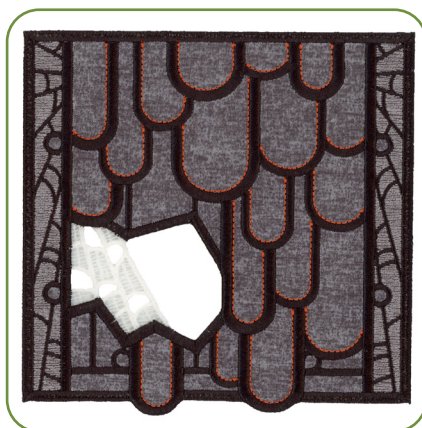

Requires 1 Design

12970-17

Main Roof 2 FSA



Requires 1 Design

12970-18

Chimney FSA



Requires 1 Design



SUMMARY

12970-19
Inner Floor FSA

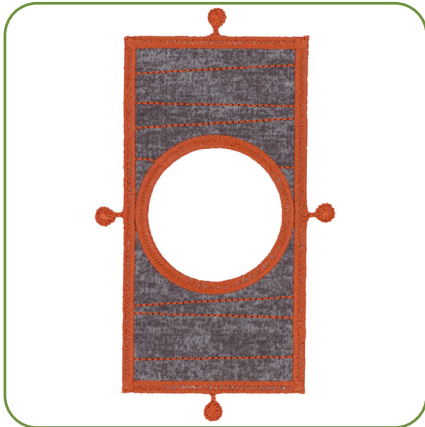

Requires 1 Design

12970-20
Man-Eating Plant FSA



Requires 1 Design

12970-21
Little Man-Eating Plants FSA

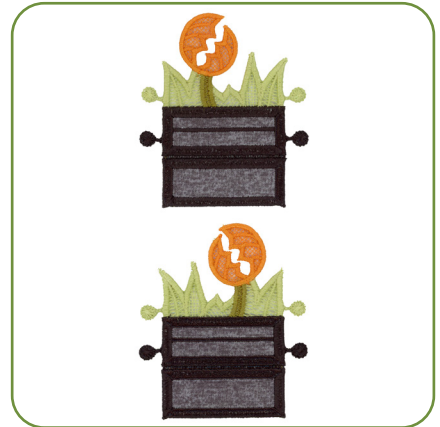

Requires 1 Design

12970-22
Plant Stands FSA

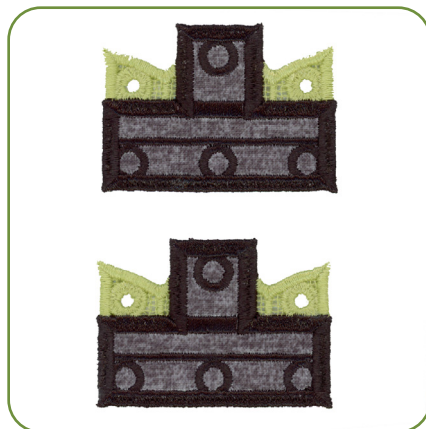

Requires 1 Design

12970-23
Vines FSL



Requires 1 Design



General Instructions

The freestanding applique instructions, included in the collection, are general instructions. For demonstration purposes, a sample design that best demonstrates the technique is shown. Fabric and thread requirements will vary by design, but the general technique is the same.

All designs are stitched with matching thread, top and bobbin.

Note: Some thread colors in the instructions have been changed or digitally enhanced for better visibility.

Step 1

- Print the mirrored version of the templates (at 100% scale or 1:1 ratio) onto the paper side of Applique Fuse and Fix.
- Cut approximately 1/4" - 1/2" outside the printed applique templates.



Step 2

- Cut the Fiber Form 1/4"-1/2" larger than the applique templates.
- Fuse the trimmed templates to the back of the Fiber Form with the paper side of the printed template up. Hold the iron on the template for 10-15 seconds for a secure fuse.



Step 3

- Trim the Fiber Form on the edge of the black outline.
- Set aside.



Step 4

- Cut the prepared applique fabrics 1/4"-1/2" larger than the templates that are included at the end of the instructions.
- Adhere one layer of StabilStick CutAway to the wrong side of all applique fabrics to provide stiffness to the finished structure.

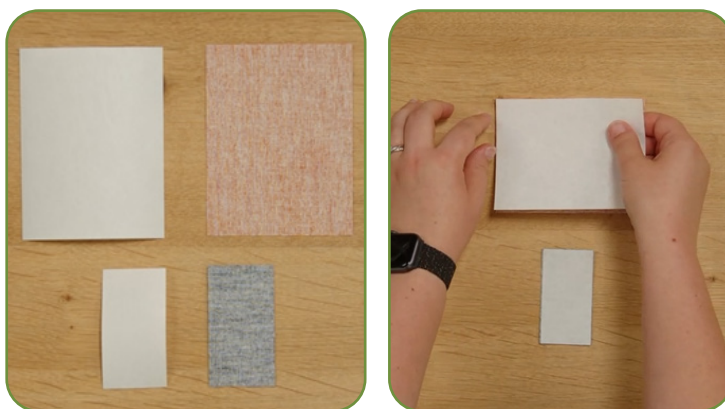

Step 5

- Hoop one layer of AquaMesh and one layer of BadgeMaster for all designs.



Step 6

- Load selected design into the machine.
- Example design is 12970-06.
- Thread the machine per the thread chart.
- Place the hoop on the machine.
- Stitch Machine Step 1, Fiber Form/Orange Fabric Placement Stitch.

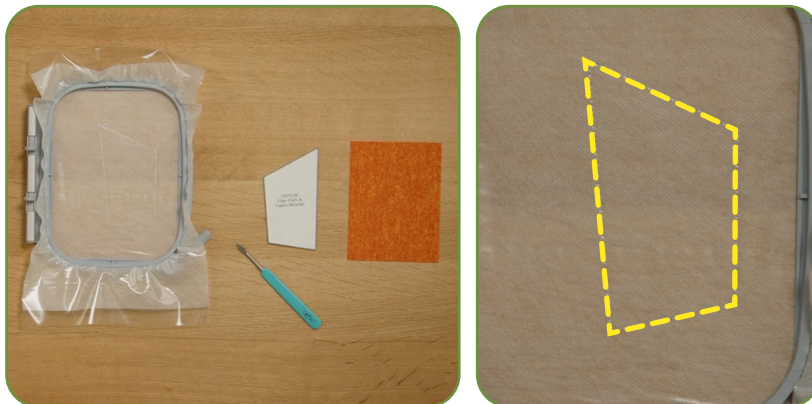

Step 7

- Remove the hoop from the machine, but NOT the project from the hoop.
- Place the hoop on a flat surface.
- On the back of the Fiber Form, use the OESD Perfect Scoring Tool to score and remove the paper backing to reveal the adhesive surface.
- Place the Fiber Form within the placement stitching.
- Finger press to secure.

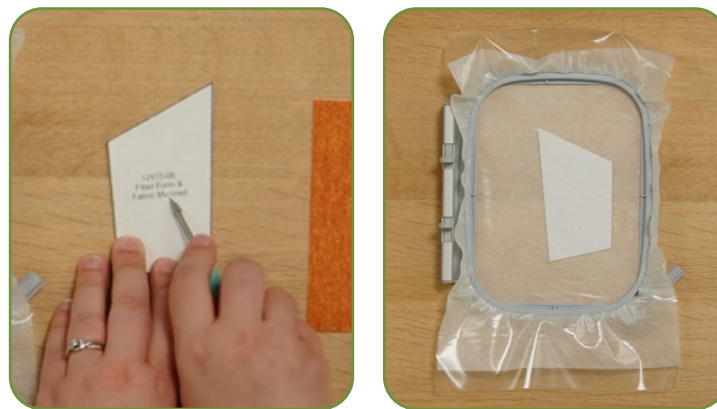

Step 8

- Completely cover the Fiber Form with the prepared orange applique fabric.
- Tape in place to secure.



Step 9

- Return the hoop to the machine.
- Stitch Machine Step 2, Cut Line and Tackdown.

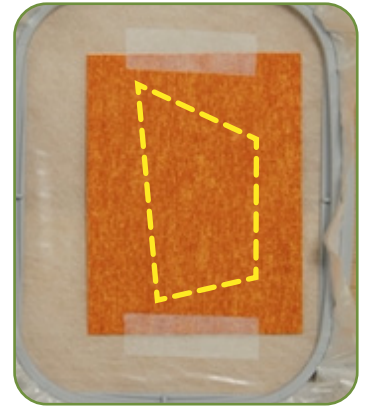

Step 10

- Remove the hoop from the machine, but NOT the project from the hoop.
- Trim the excess fabric as close to the cut line as possible. If the outermost stitches (cut line) are cut, the inner stitches (tackdown) will hold the applique in place.
- Tip: If the stabilizer is cut or a hole is created while trimming the fabric, use OESD Expert Embroidery Tape WashAway as a patch.



Step 11

- Return the hoop to the machine.
- Stitch Machine Step 3, Gray Fabric Placement Stitch.



□ Step 12

- Remove the hoop from the machine, but NOT the project from the hoop.
- Place the hoop on a flat surface.
- Completely cover the placement stitch with the prepared gray applique fabric.
- Tape in place to secure.



□ Step 13

- Return the hoop to the machine.
- Stitch Machine Step 4, Cut Line and Tackdown.

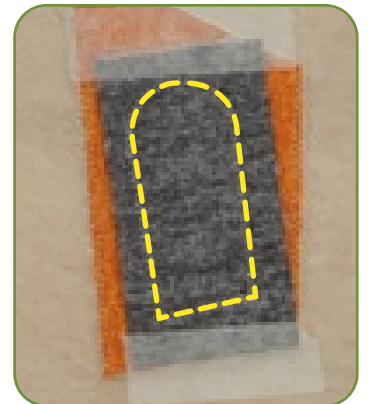

□ Step 14

- Remove the hoop from the machine, but NOT the project from the hoop.
- Trim the excess fabric as close to the cut line as possible.



GENERAL FREESTANDING LACE GUIDE



Stabilizer

- OESD AquaMesh
- OESD BadgeMaster

Notion/Tools

- 80/12 Embroidery Ballpoint Titanium needle for extended needle life
- OESD Alligator Clamps
- OESD Button Clips
- OESD Perfect Point and Press Tool

Isacord Thread Colors

- All OESD designs are digitized with Isacord 40 wt. polyester thread as the top thread and in the bobbin.
- Refer to the thread chart for color specifications.
- Match bobbin thread color to the top thread.

Instructions

Step 1 - Hoop

For FSL structures, hoop one layer of OESD AquaMesh and one layer of OESD BadgeMaster. BadgeMaster contains more starch so, combined with the AquaMesh, the lace is more rigid.

For other FSL, where a softer lace is desired, hoop two layers of AquaMesh.

Step 2 - Embroider

Stitch the design per the thread chart with matching thread in the bobbin at each color change.

When complete, remove from the hoop and trim away excess stabilizer about 1/4"-1/2" from the stitching.

Step 3 - Rinse

Rinse remaining stabilizer out in warm running water.

For stiffer lace and FSL structures, DO NOT rinse away all of the stabilizer. The lace should be just slightly tacky.

For softer lace, rinse until all traces of the stabilizer is removed.

Step 4 - Dry

Lay right side down flat on a non-stick surface, such as a cookie rack, parchment paper or Teflon sheet. This minimizes the tendency for the lace to curl.

Let the pieces dry completely before proceeding with any assembly.

Step 5 - Press

Once completely dry, press right side down on a OESD Perfect Embroidery Press Cloth.

Step 6 - Assemble Structure

Note: Specific assembly instructions for a design/collection may be found in the thread chart pdf following the individual design color charts.

Lace must be COMPLETELY DRY before assembly. Wetting the buttonettes or eyelets to assemble is not recommended and may result in them stretching and coming "unbuttoned" when dry.

Use a pair of OESD Alligator Clamps to insert the buttonettes into the eyelets. Insert the tip of the OESD Alligator Clamps into the eyelet, grasp the buttonette and pull through the eyelet. Alternatively, use a stiletto or tweezers to push the buttonette through the eyelet.

Helpful Tips

Limp Lace

If the design is not stiff enough, press the lace pieces on the wrong side while applying spray starch. After ironing, spray again with starch and allow to dry completely. This will stiffen the lace pieces nicely and aid in construction. Or easily re-stiffen by diluting some stabilizer scraps in water (or use liquid starch) and dipping the item in the solution. Lay flat to dry.

Eyelets Too Small

If any of the eyelets appear closed or too small to penetrate with Alligator Clamps, they may be stretched by inserting the small end of the OESD Perfect Point and Press Tool into the eyelet opening and stretching it open wide enough to accommodate the OESD Alligator Clamps.

Button Clips

During the assembly process, some structures pull on buttonettes that have already been inserted and could pull them out altogether. Putting a Button Clip on the assembled buttonette will keep it in position during the assembly process. Remove the Button Clips when the assembly is complete.

Alternative Construction Option

In some cases, the buttonettes may be pulled to the inside of a project, instead of being visible on the outside.

Insert the OESD Alligator Clamps through the eyelet from the wrong, or inside, of the lace and grasp the corresponding buttonette. Pull the buttonette to the wrong side of the lace.

Pulling the buttonettes to the inside may cause stress on the ones already done. Button clips may be placed on the completed buttonette(s) to prevent them from pulling out of the eyelet.

ASSEMBLY

□ Step 17

- Rinse each piece in warm running water until the design is only slightly tacky.
- Place right side down on a non-stick surface to dry. Parchment paper or a cooling rack work well. Dry completely.
- Once dry, press right side down on a Perfect Embroidery Press Cloth.



□ Step 18

- Before assembly, use the OESD Mini MAT and a craft knife to cut through all the layers of the tab entries.
- Use the OESD Mini MAT and Punch Tool with the 3mm attachment to create the eyelets indicated in the diagram.
- Tip: Take care to not cut the satin stitching.
- Reference the Punch Tool Guide on pages 29-31.

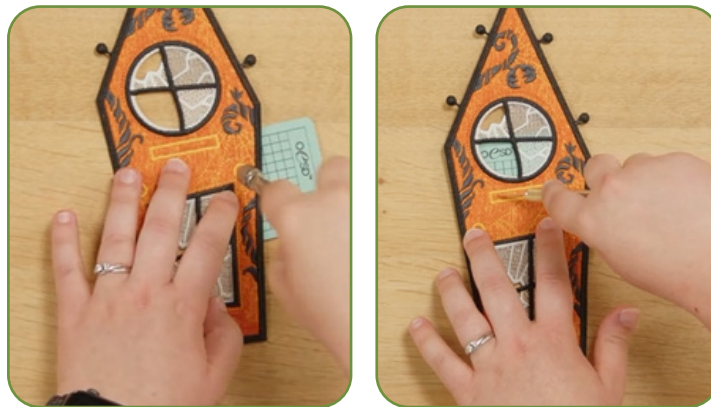

ASSEMBLY

□ Step 19

- Line up the Inner Wall 1 FSA (12970-01), Front Window Wall FSA (12970-02), Inner Wall 2 FSA (12970-03), and Back Door Wall FSA (12970-04) to connect.
- Thread the sewing machine with matching thread in the top and bobbin.
- Stitch together using a multi-step zigzag stitch.
- Back stitch at the beginning and end to secure.
- Trim thread tails.
- Fold and press into shape.



ASSEMBLY

□ Step 20

- Line up the Front Door Wall FSA (12970-06), Side Wall FSA (12970-07), and Back Wall FSA (12970-08) to connect.
- Stitch together using a multi-step zigzag stitch.
- Back stitch at the beginning and end to secure.
- Trim thread tails.
- Fold and press into shape.



□ Step 21

- Line up the Greenhouse Back Wall FSA (12970-11), Greenhouse Side Wall FSA (12970-12), and Greenhouse Front Wall FSA (12970-13) to connect.
- Stitch together using a multi-step zigzag stitch.
- Back stitch at the beginning and end to secure.
- Trim thread tails.
- Fold and press into shape.



ASSEMBLY

□ Step 22

- Line up the Main Roof 1 FSA (12970-16), and Main Roof 2 FSA (12970-17) to connect.
- Stitch together using a multi-step zigzag stitch.
- Back stitch at the beginning and end to secure.
- Trim thread tails.
- Fold and press into shape.

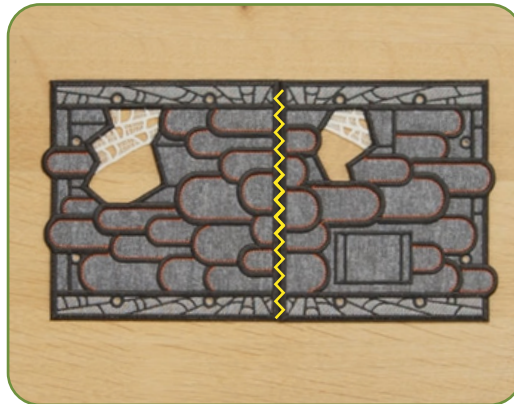

□ Step 23

- Match the eyelets and buttonettes of the Chimney FSA (12970-18).
- Use Alligator Clamps to pull each buttonette through the corresponding eyelet, using button clips to temporarily hold them in place, as needed.



ASSEMBLY

Step 24

- Match the buttonettes of the side walls to the eyelets of the Side Roof FSA (12970-09).
- Use Alligator Clamps to pull each buttonette through the corresponding eyelet, using button clips to temporarily hold them in place, as needed.

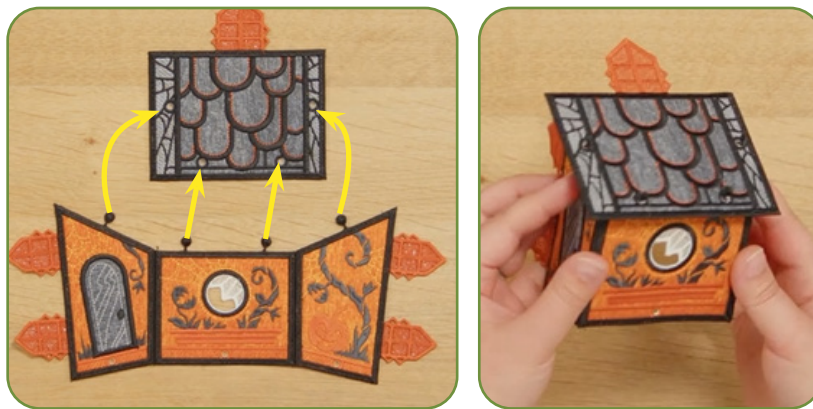

Step 25

- Match the buttonettes of Awning FSA (12970-05) sides to the eyelets of the Awning.
- The two buttonettes on the curved side will be the ones used.
- Pull each buttonette through the corresponding eyelet.
- Slightly shape the awning into a curve.

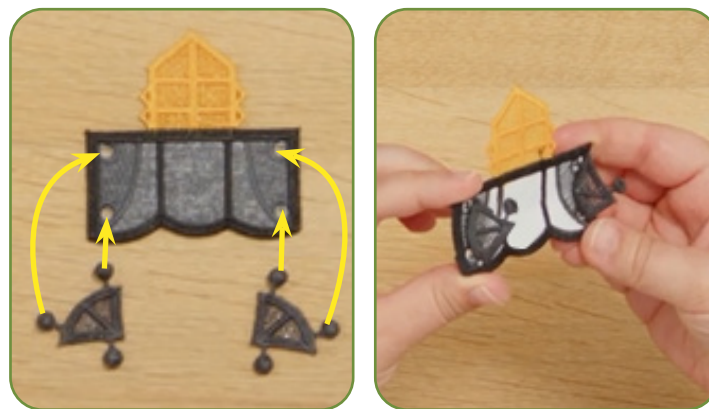

ASSEMBLY

□ Step 26

- Insert the locking tab of the Awning FSA (12970-05) into the tab entry of Front Window Wall FSA (12970-02).



□ Step 27

- Match the buttonettes of Awning FSA (12970-05) to the eyelets of Front Window Wall FSA (12970-02).
- Pull each buttonette through the corresponding eyelet.

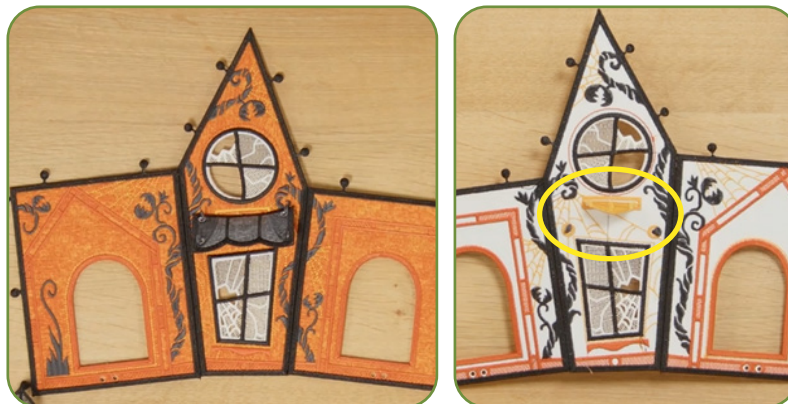

ASSEMBLY

□ Step 28

- Match the buttonettes of Inner Wall 1 FSA (12970-01) to the eyelets of Back Door Wall FSA (12970-04).
- Pull each buttonette through the corresponding eyelet.



□ Step 29

- Insert the locking tabs of the side walls and roof assembly into the tab entries of the Inner Wall 2 FSA (12970-03).

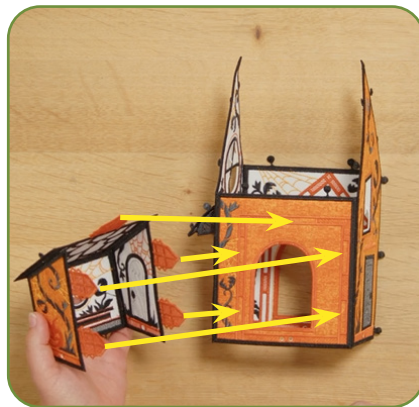

ASSEMBLY

Step 30

- Match the buttonettes of the greenhouse walls to the eyelets of the Greenhouse Roof FSA (12970-14).
- Pull each buttonette through the corresponding eyelet.

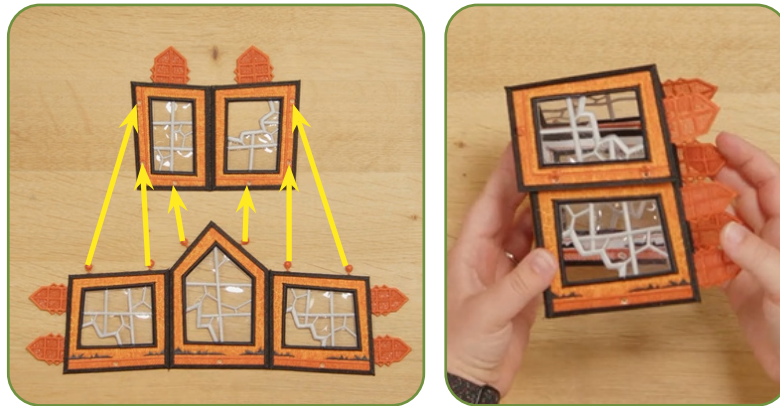

Step 31

- Insert the locking tabs of the greenhouse walls and roof assembly into the tab entries of the Inner Wall 1 FSA (12970-01).

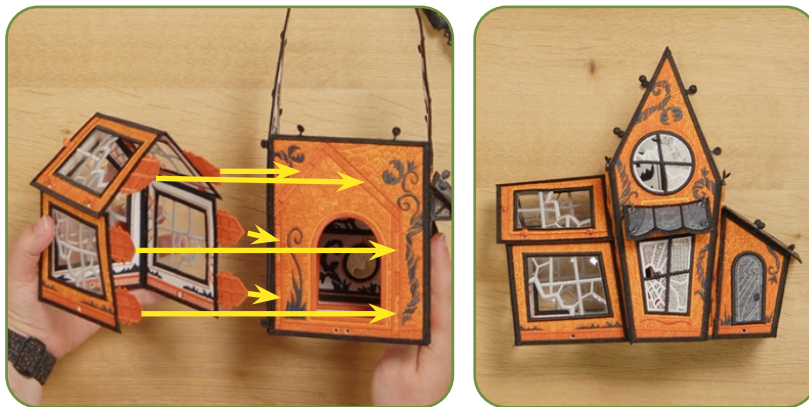

ASSEMBLY

Step 32

- Insert the locking tabs of the Chimney FSA (12970-18) into the tab entries of the main roof assembly.



Step 33

- Match the buttonettes of the flower shop walls to the eyelets of the main roof assembly.
- Pull each buttonette through the corresponding eyelet.



ASSEMBLY

□ Step 34

- Match the buttonettes of Side Floor FSA (12970-10) to the eyelets of the side walls and Inner Wall 2 FSA (12970-03).
- Pull each buttonette through the corresponding eyelet.



□ Step 35

- Match the buttonettes of Greenhouse Floor FSA (12970-15) to the eyelets of the greenhouse walls and Inner Wall 1 FSA (12970-01).
- Pull each buttonette through the corresponding eyelet.



ASSEMBLY

Step 36

- Match the buttonettes of Inner Floor FSA (12970-19) to the eyelets of the flower shop walls.
- Pull each buttonette through the corresponding eyelet.



Step 37

- Match the buttonettes of Man-Eating Plant 1 FSA (12970-20) to the center eyelets of the two Plant Stands FSA (12970-22) pieces.
- Pull each buttonette through the corresponding eyelet.

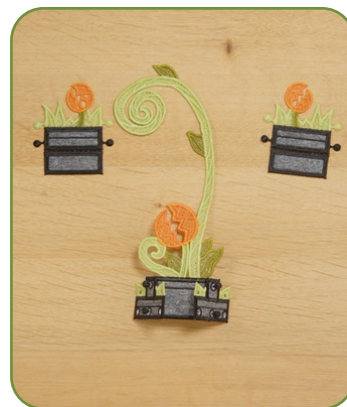
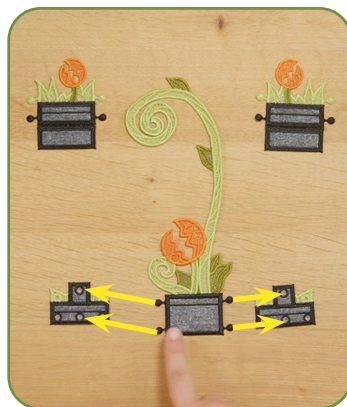

ASSEMBLY

Step 38

- Match the buttonettes of Little Man-Eating Plants FSA (12970-21) to the eyelets of the two Plant Stands FSA (12970-22) pieces.
- Pull each buttonette through the corresponding eyelet.

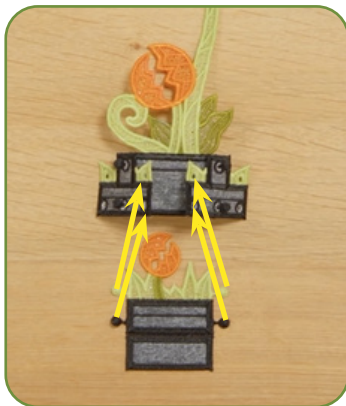

Step 39

- Insert the assembled flowers through the Greenhouse Floor FSA (12970-15).
- Bend the two bottom flaps outward to help hold it in place.
- Pull long vine through hole in roof and wrap around the chimney.



ASSEMBLY

Step 40

- Insert the Vines FSL (12970-23) through broken windows, roof and/or chimney as desired.



Step 41

- The project is complete. Enjoy!



PUNCH TOOL GUIDES



12970-01

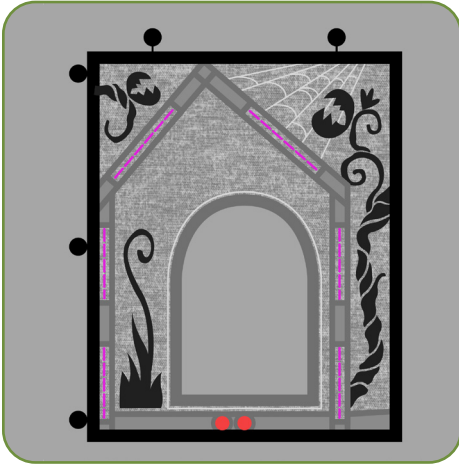

12970-02

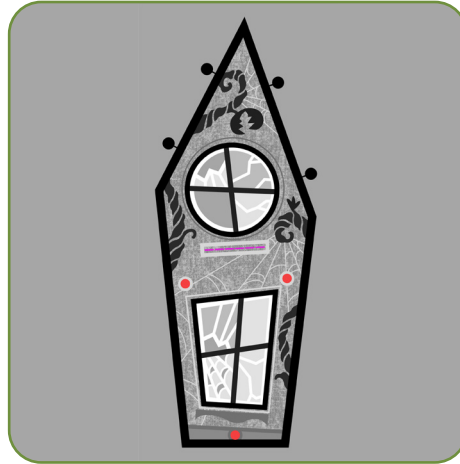

12970-03

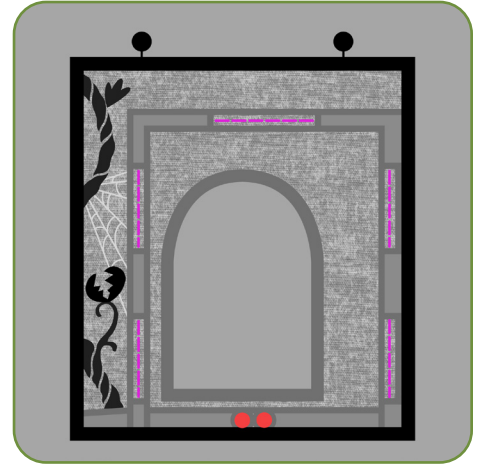

12970-04

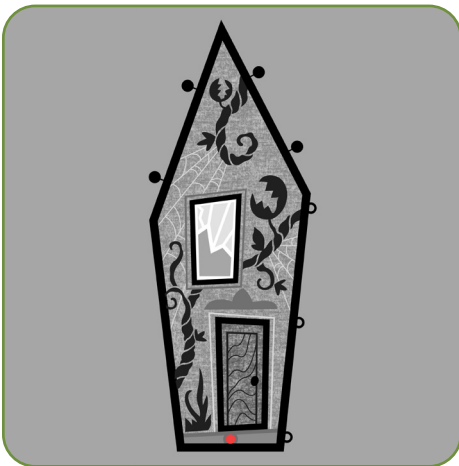

12970-05

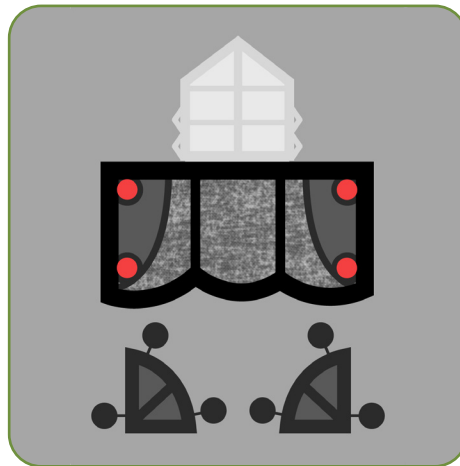

12970-06

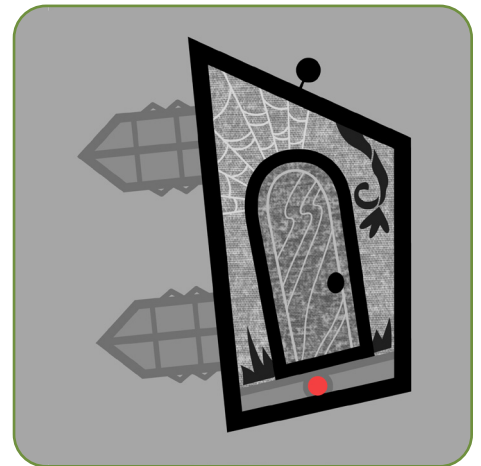

● = 2 MM

● = 3 MM

● = 4 MM

CRAFT KNIFE



PUNCH TOOL GUIDES



12970-07

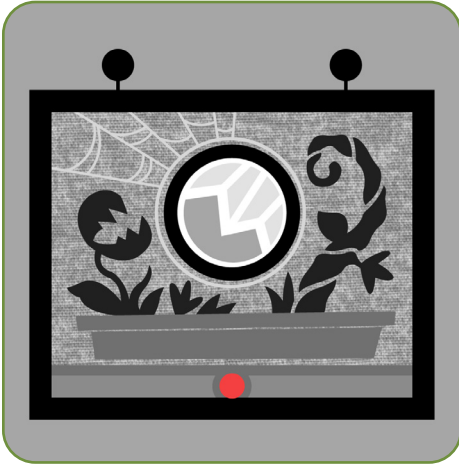

12970-08

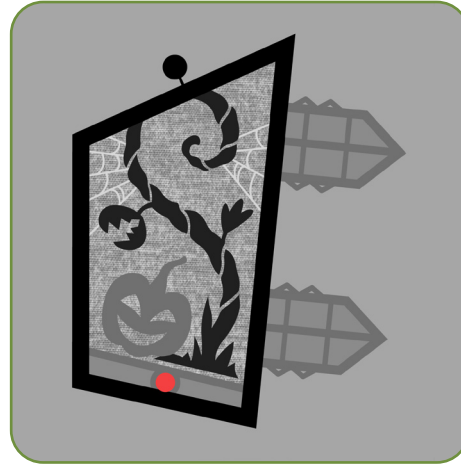

12970-09

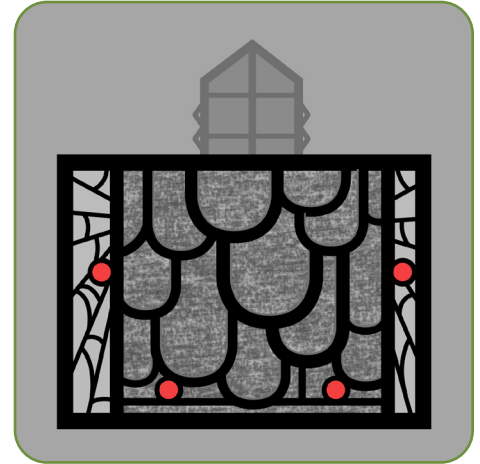

12970-11

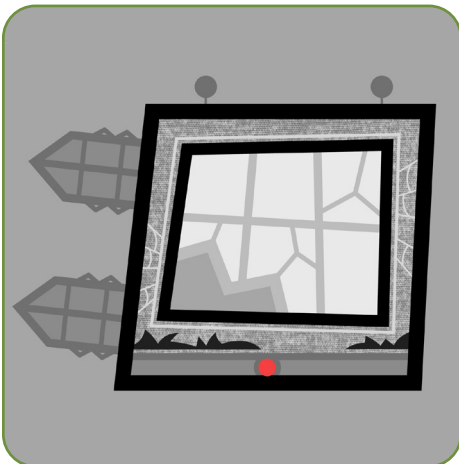

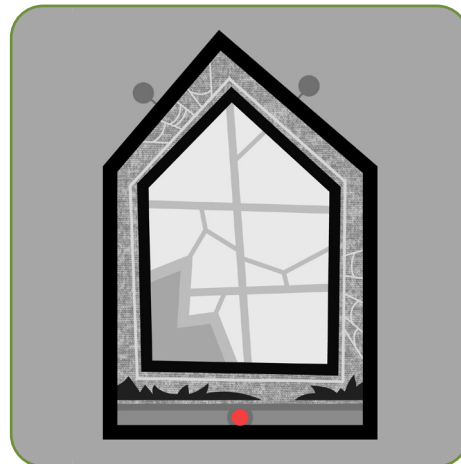

12970-12

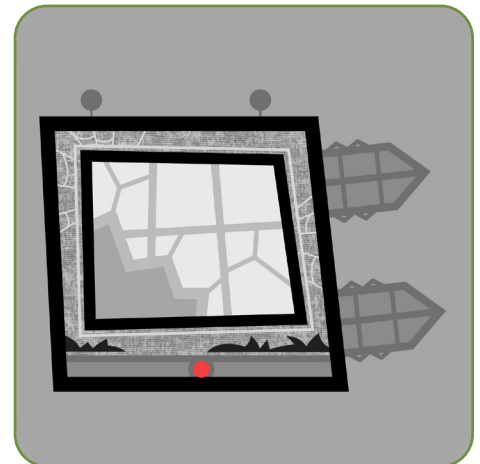

12970-13



 = 2 MM

 = 3 MM

 = 4 MM

CRAFT KNIFE



PUNCH TOOL GUIDES



12970-14

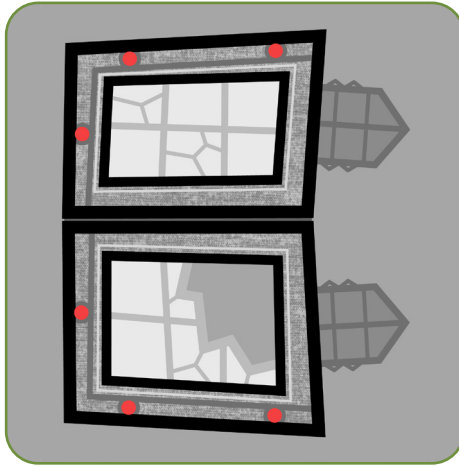

12970-16

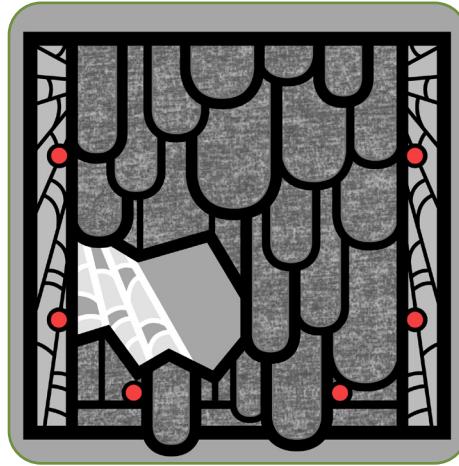

12970-17

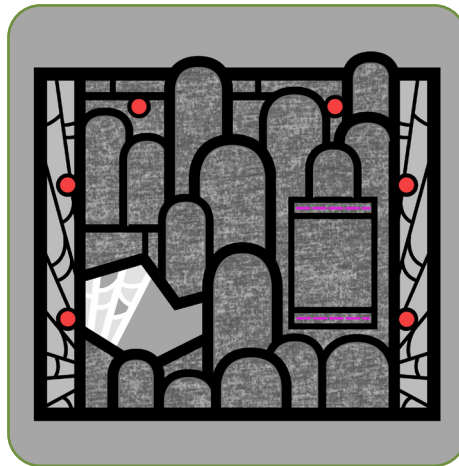

12970-22

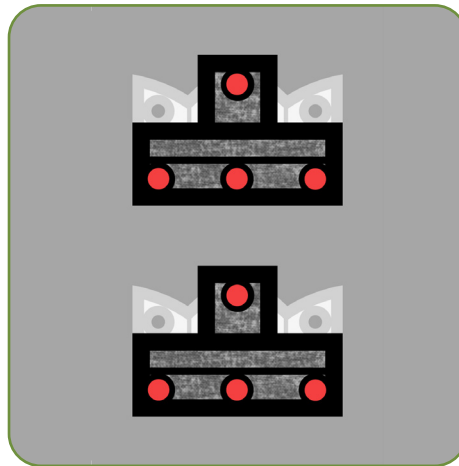

● = 2 MM

● = 3 MM

● = 4 MM

CRAFT KNIFE



ATTENTION

When printing this document, any page scaling or page fitting options in your print dialog box must be turned OFF or set to NONE so that your files will print out at their actual size. Images not printed at actual size will not function as intended.

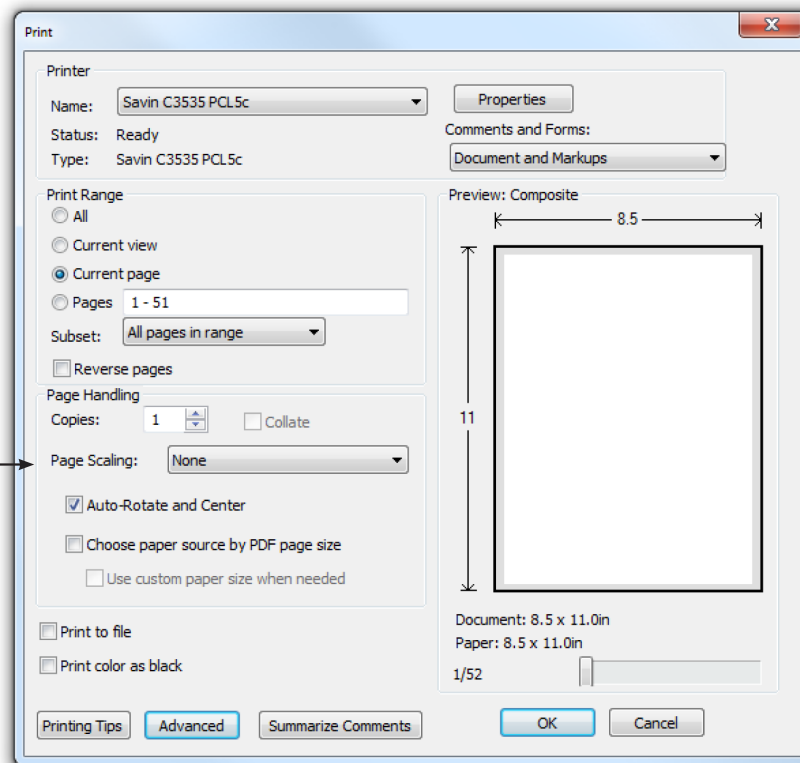

TO SAVE PAPER

Only print the desired image by navigating to the image's page, go to File > Print and select "Current page" in the print dialog box. Repeat for each desired image.

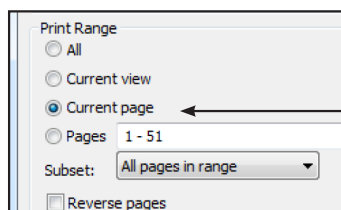

APPLIQUE PATTERNS

Print at 100%. No
scaling. This box
measures 1" x 1".
Use the box as an
accuracy guide
when printing
templates.

12970-01
Fiber Form &
Fabric

Cut Out

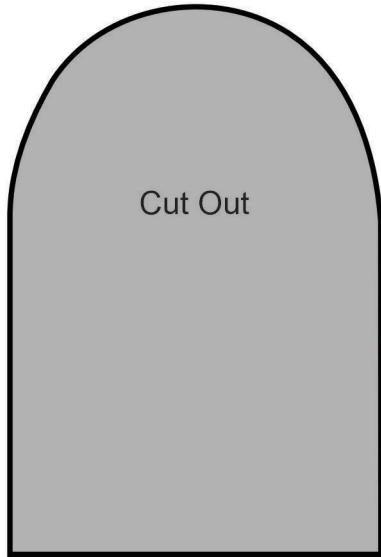
A large rectangular frame contains a gray, arched fabric pattern piece. The piece has a semi-circular top and a straight bottom edge. The text 'Cut Out' is centered within the gray area.

APPLIQUE PATTERNS

Print at 100%. No scaling. This box measures 1" x 1". Use the box as an accuracy guide when printing templates.

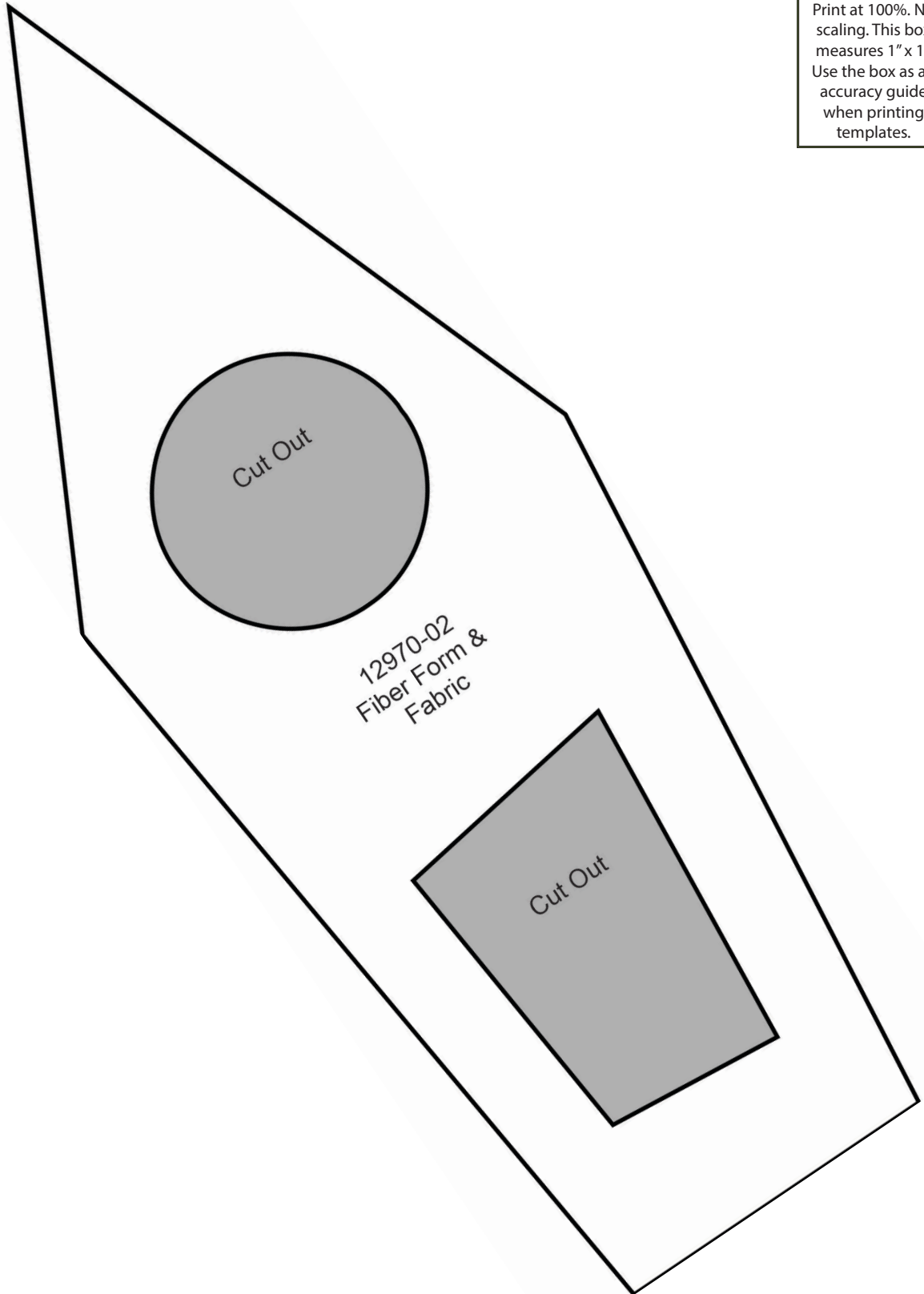

APPLIQUE PATTERNS

Print at 100%. No scaling. This box measures 1" x 1". Use the box as an accuracy guide when printing templates.

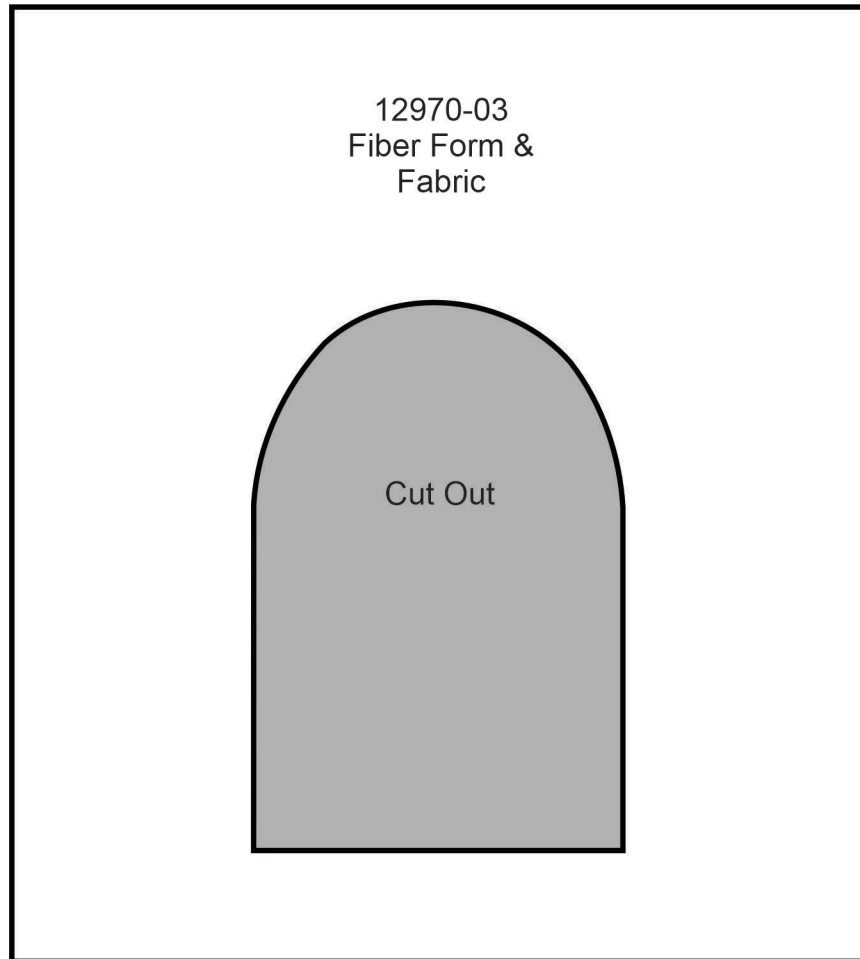

APPLIQUE PATTERNS

Print at 100%. No scaling. This box measures 1" x 1". Use the box as an accuracy guide when printing templates.

12970-04
Fiber Form &
Fabric

Cut Out

12970-04
Fabric

APPLIQUE PATTERNS



Print at 100%. No scaling. This box measures 1" x 1". Use the box as an accuracy guide when printing templates.

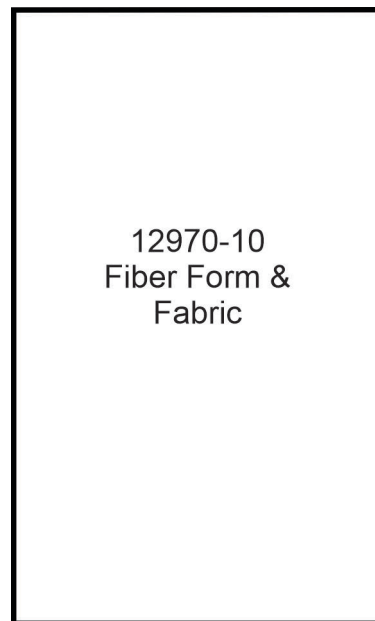
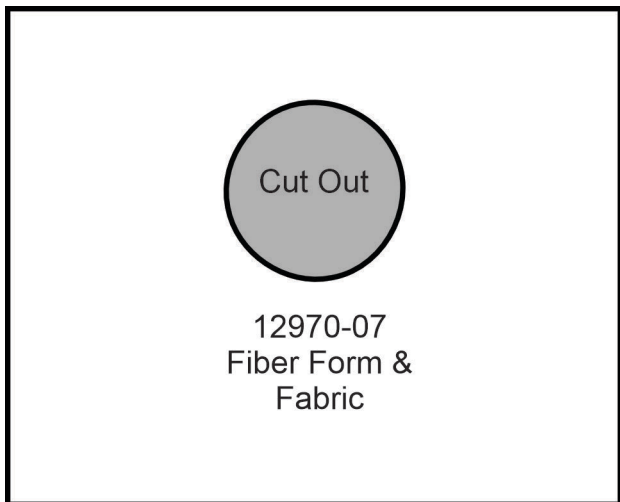
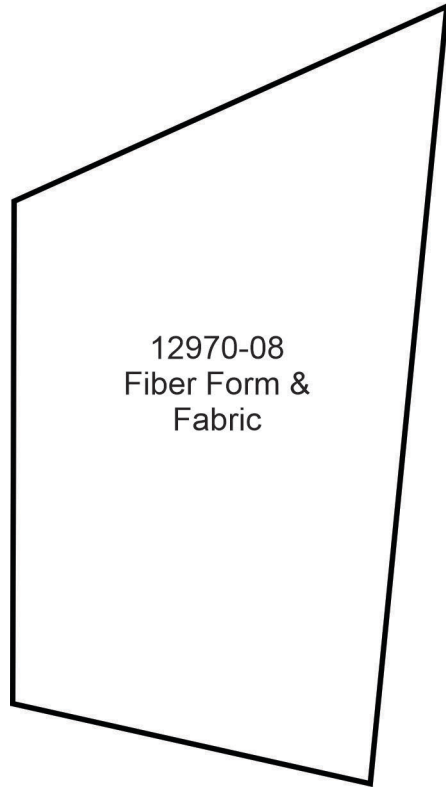
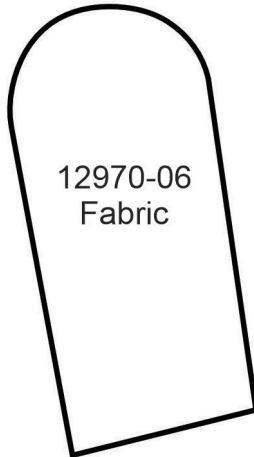
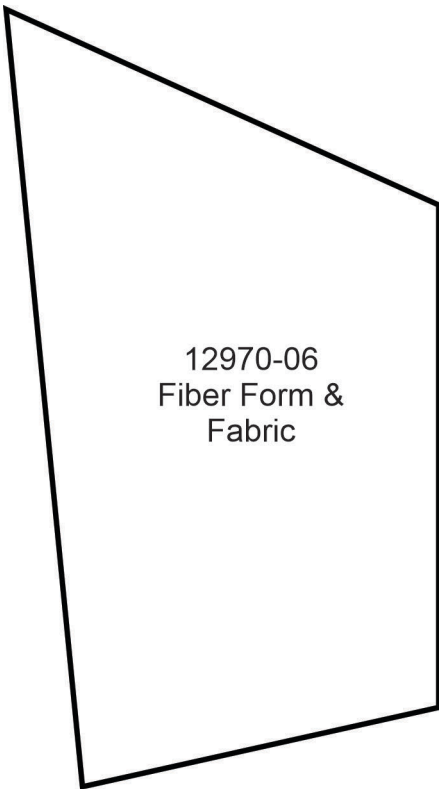

APPLIQUE PATTERNS

Print at 100%. No scaling. This box measures 1" x 1". Use the box as an accuracy guide when printing templates.

12970-09
Fiber Form &
Fabric

Cut Out

12970-11
Fiber Form &
Fabric

12970-11
Clear Vinyl

APPLIQUE PATTERNS

Print at 100%. No scaling. This box measures 1" x 1". Use the box as an accuracy guide when printing templates.

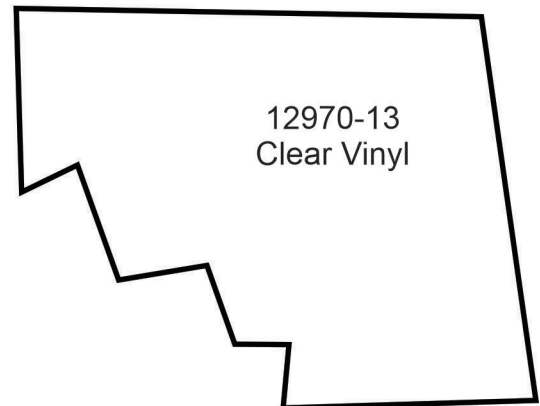
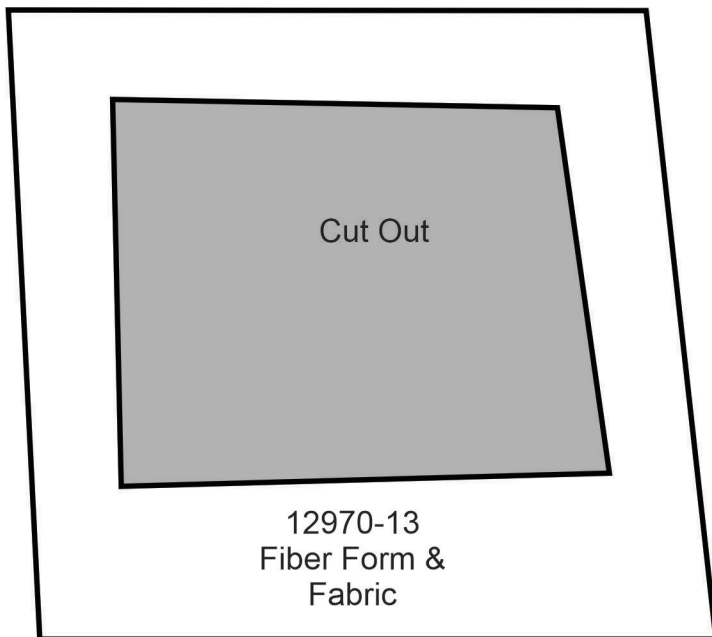
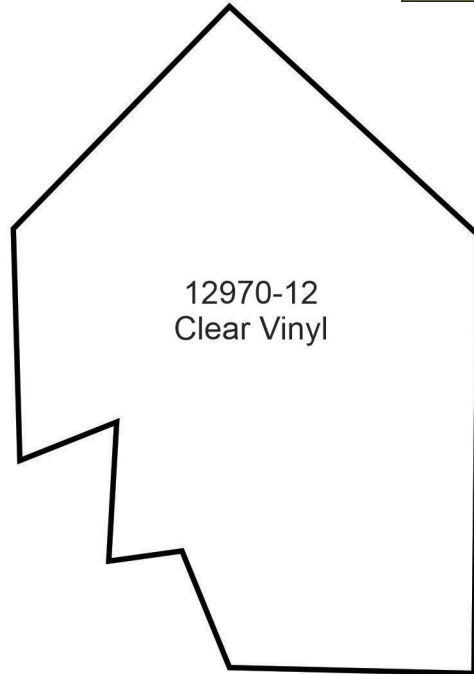
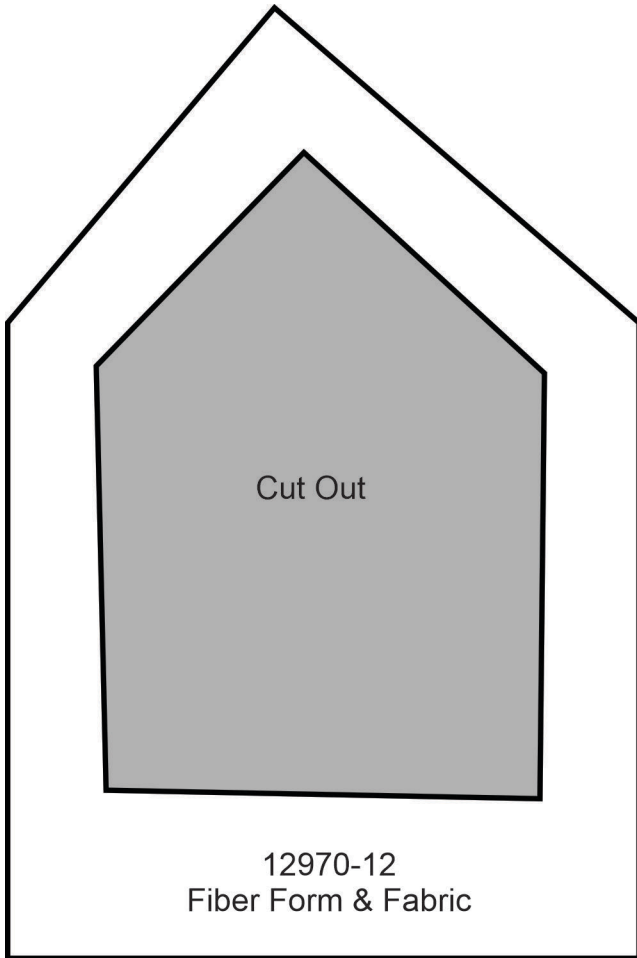

APPLIQUE PATTERNS

Print at 100%. No scaling. This box measures 1" x 1". Use the box as an accuracy guide when printing templates.

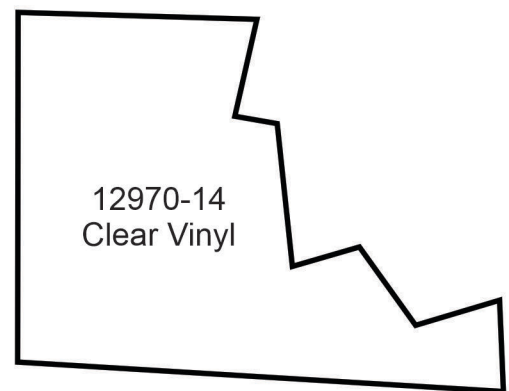
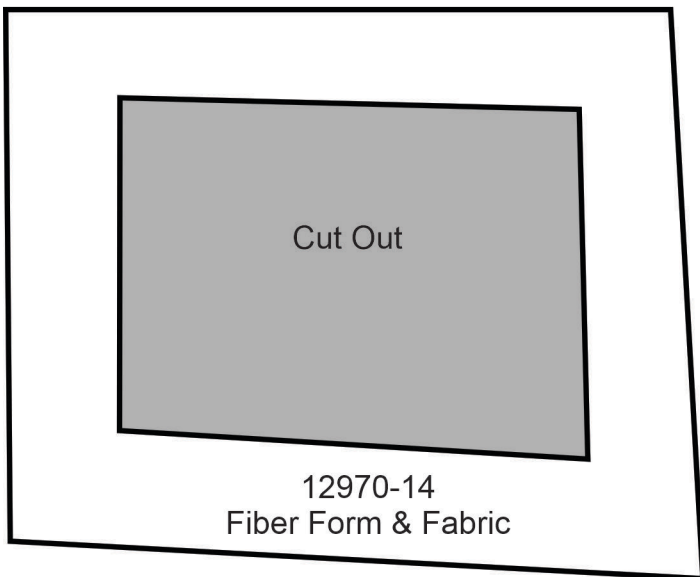
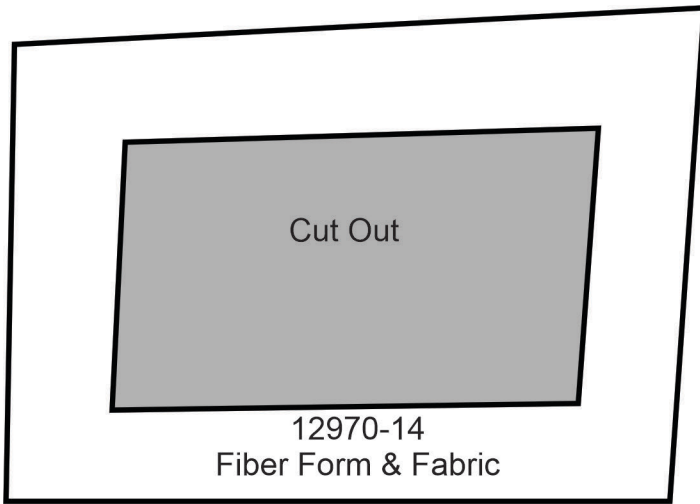

APPLIQUE PATTERNS

Print at 100%. No scaling. This box measures 1" x 1". Use the box as an accuracy guide when printing templates.

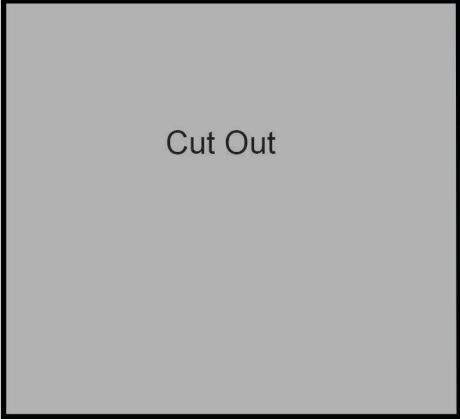

Cut Out

12970-15
Fiber Form & Fabric



12970-16
Fiber Form &
Fabric



Cut Out

APPLIQUE PATTERNS

Print at 100%. No scaling. This box measures 1" x 1". Use the box as an accuracy guide when printing templates.

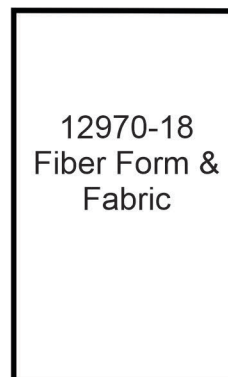
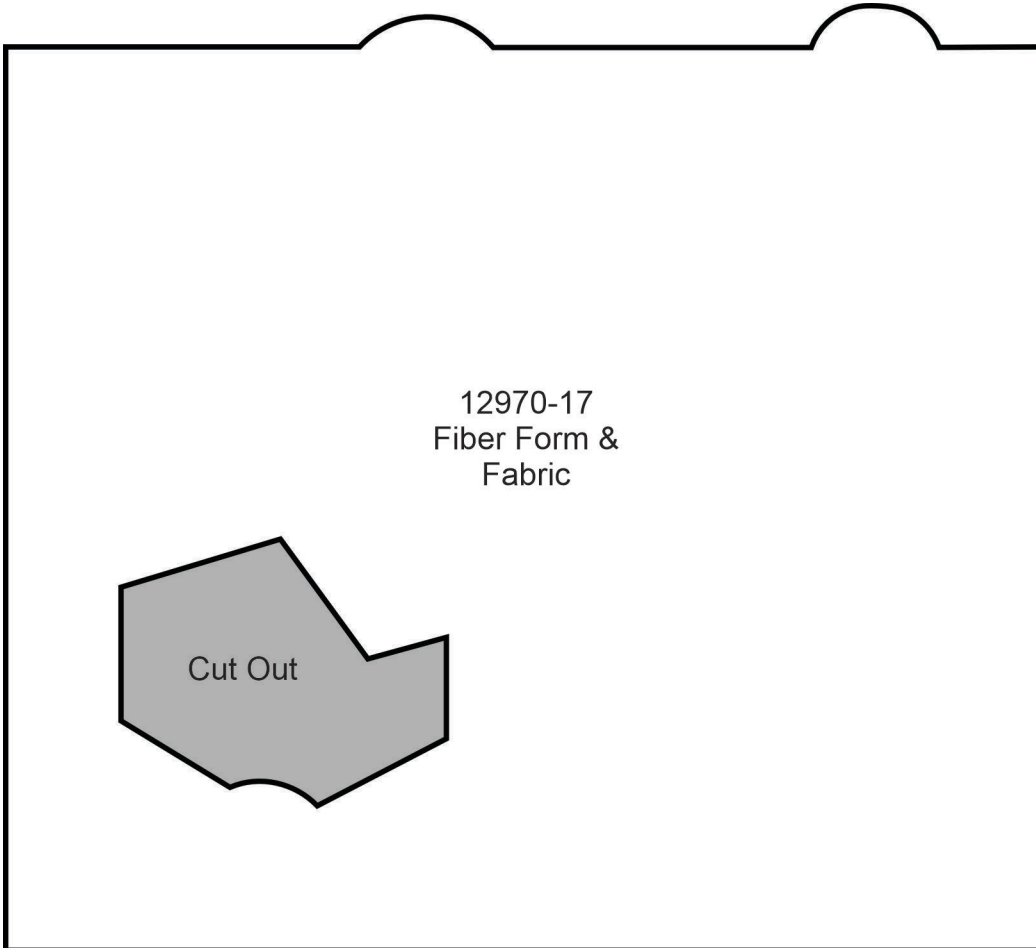

APPLIQUE PATTERNS

Print at 100%. No scaling. This box measures 1" x 1". Use the box as an accuracy guide when printing templates.

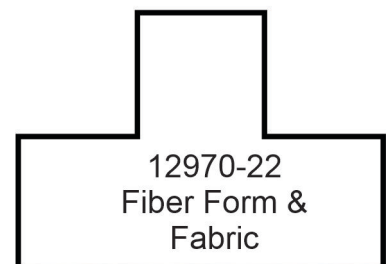
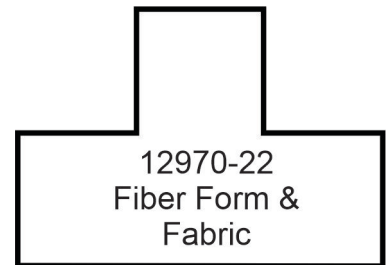
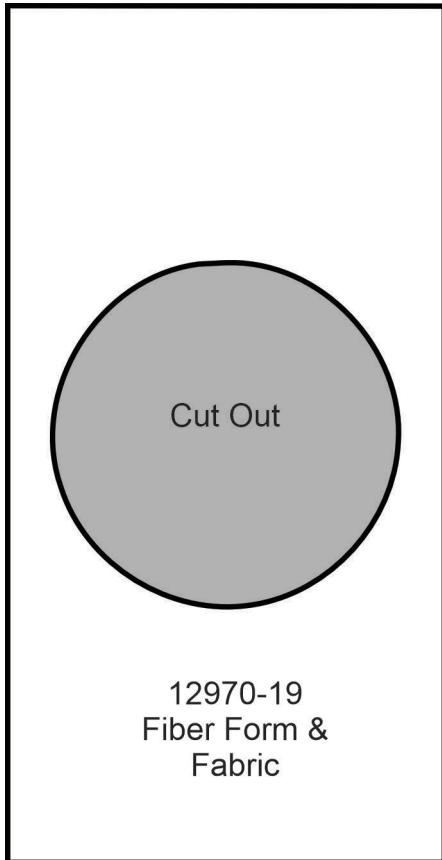

MIRRORED PATTERNS PREMIER COLLECTION

Print at 100%. No scaling. This box measures 1" x 1". Use the box as an accuracy guide when printing templates.

12970-01
Fiber Form &
Fabric Mirrored

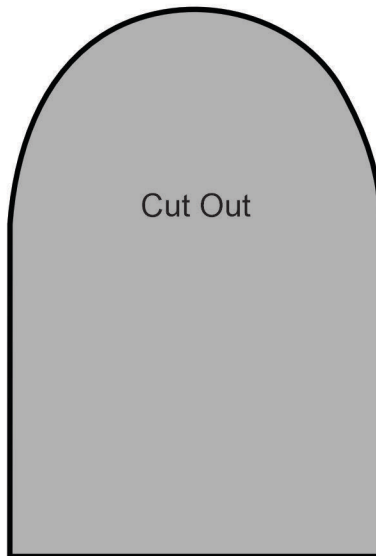

MIRRORED PATTERNS **oesd**™ PREMIER COLLECTION

Print at 100%. No scaling. This box measures 1" x 1". Use the box as an accuracy guide when printing templates.

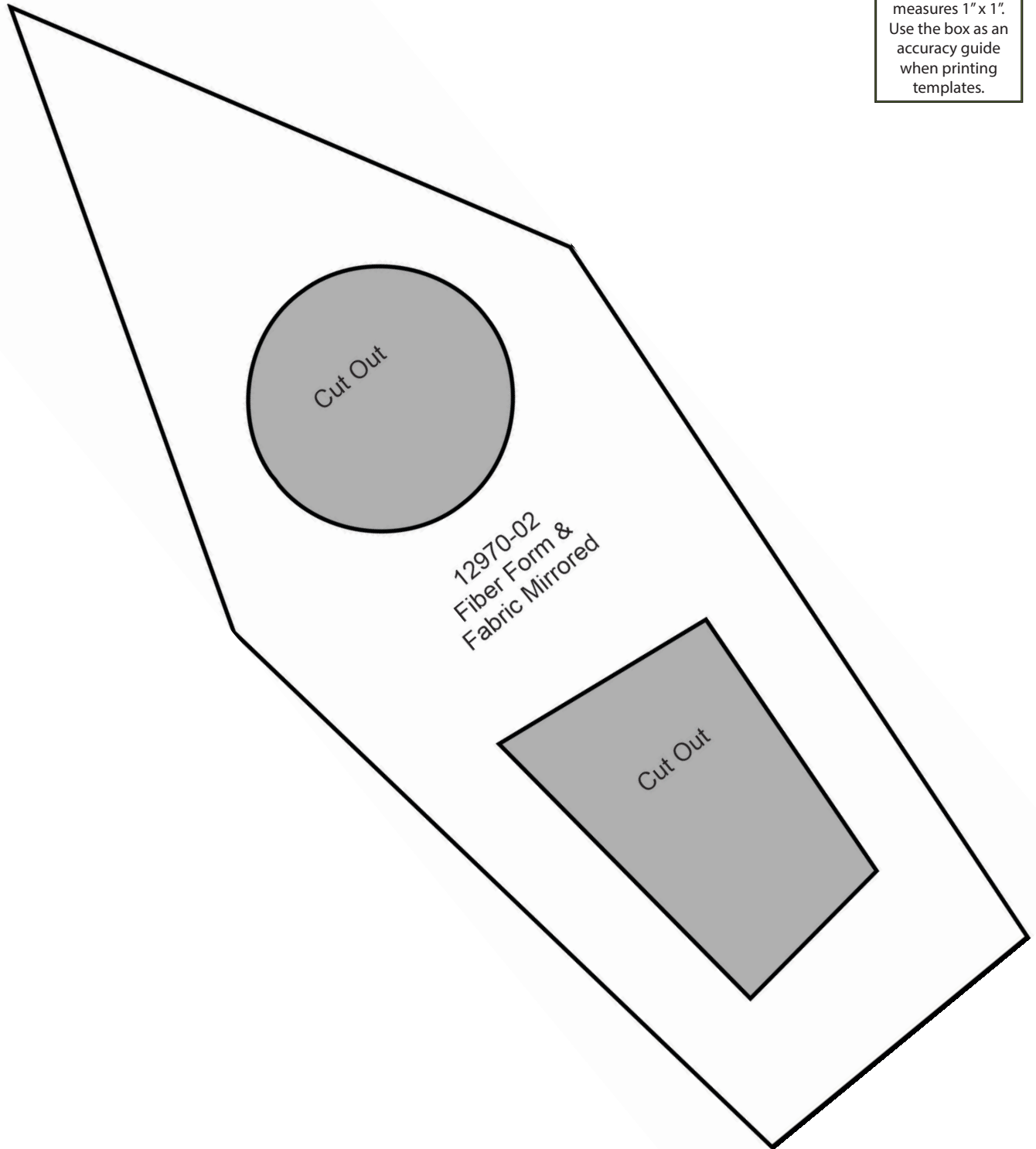

MIRRORED PATTERNS PREMIER COLLECTION

Print at 100%. No scaling. This box measures 1" x 1". Use the box as an accuracy guide when printing templates.

12970-03
Fiber Form &
Fabric Mirrored

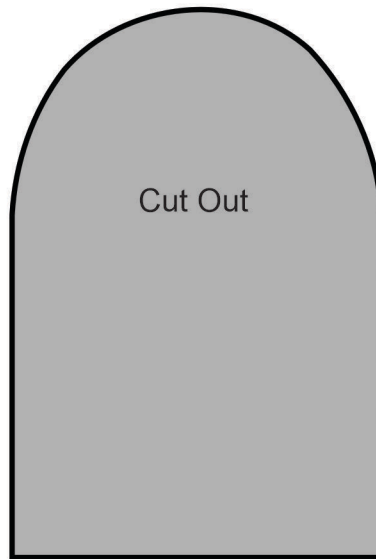

MIRRORED PATTERNS PREMIER COLLECTION

Print at 100%. No scaling. This box measures 1" x 1". Use the box as an accuracy guide when printing templates.

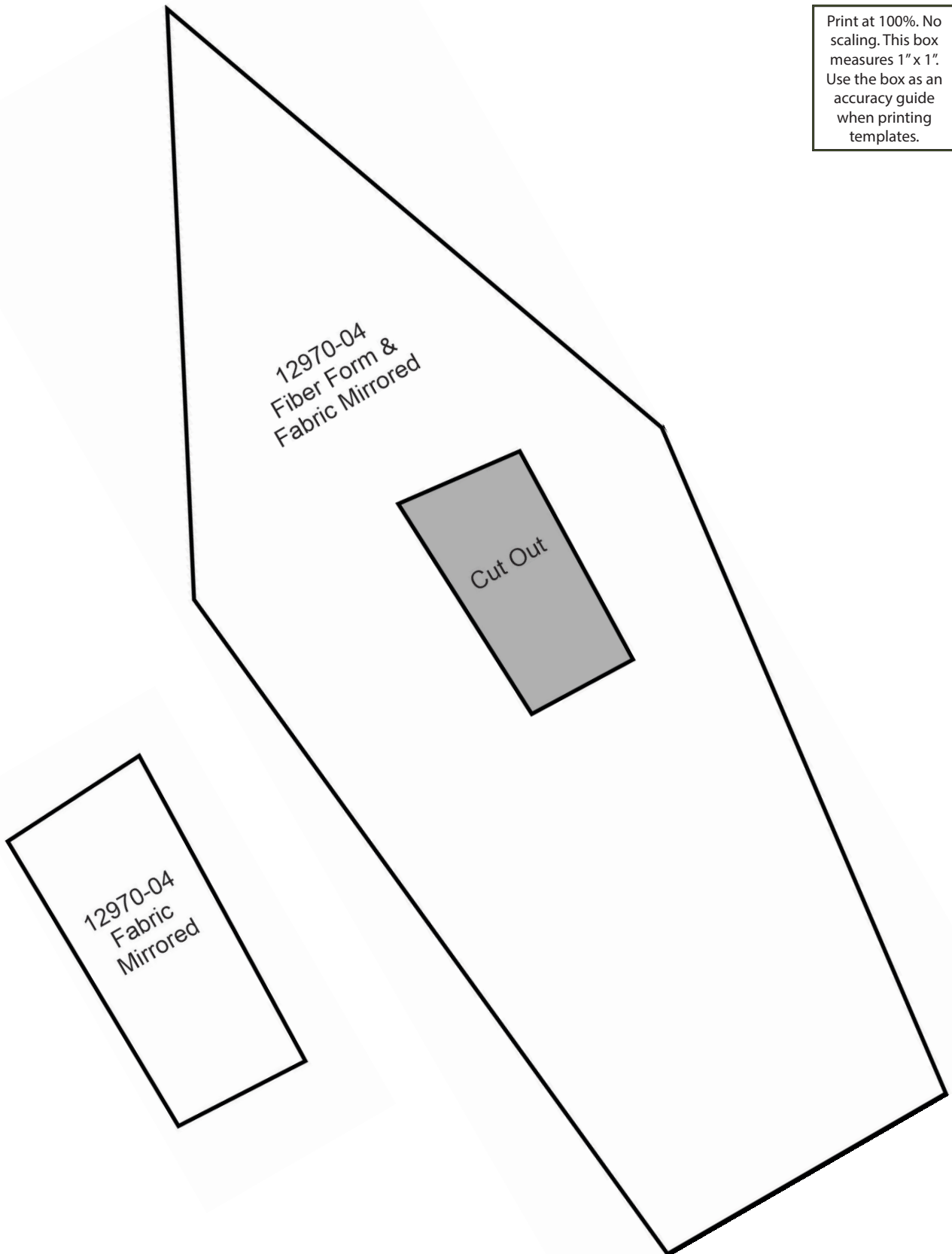

MIRRORED PATTERNS

12970-05
Fiber Form &
Fabric Mirrored

Print at 100%. No scaling. This box measures 1" x 1". Use the box as an accuracy guide when printing templates.

12970-06
Fabric
Mirrored

12970-06
Fiber Form &
Fabric Mirrored

12970-08
Fiber Form &
Fabric Mirrored

Cut Out

12970-07
Fiber Form &
Fabric Mirrored

12970-10
Fiber Form &
Fabric Mirrored

MIRRORED PATTERNS **oesd**™ PREMIER COLLECTION

Print at 100%. No scaling. This box measures 1" x 1". Use the box as an accuracy guide when printing templates.

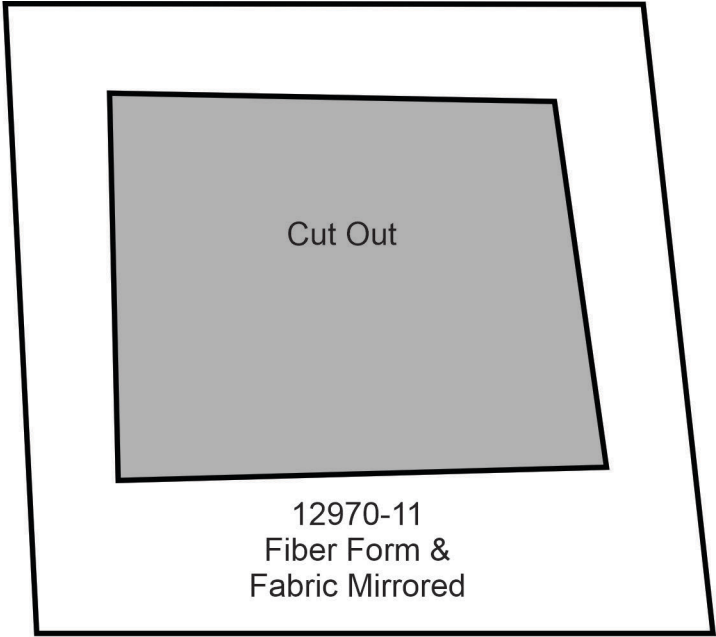
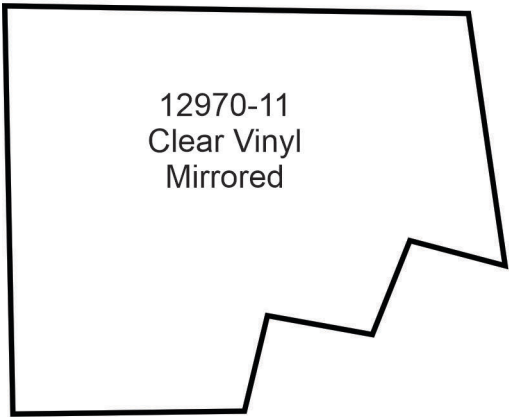

MIRRORED PATTERNS PREMIER COLLECTION

Print at 100%. No scaling. This box measures 1" x 1". Use the box as an accuracy guide when printing templates.

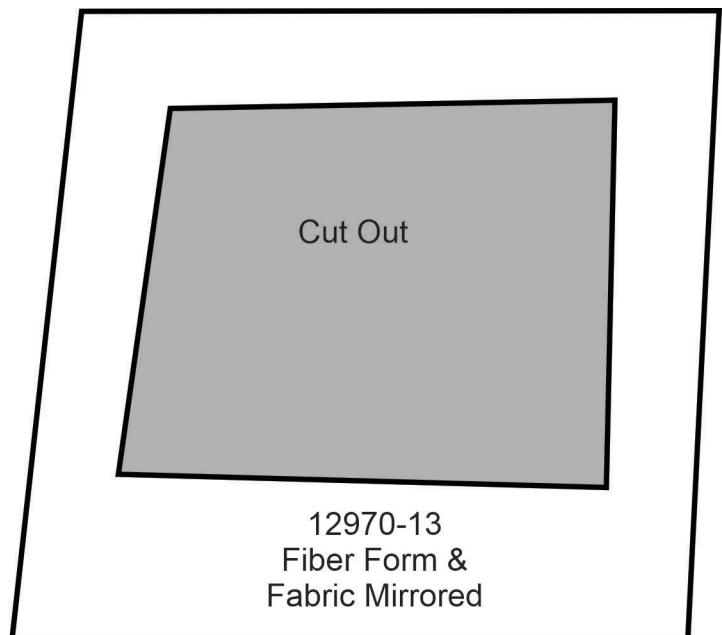
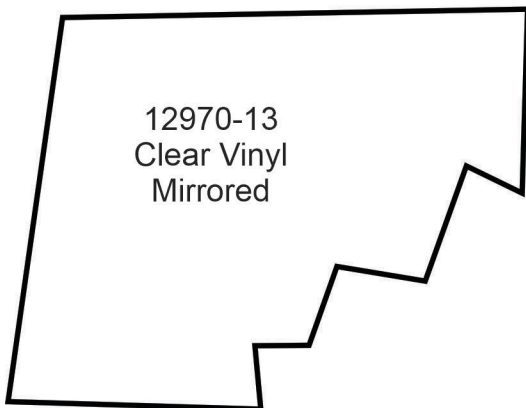
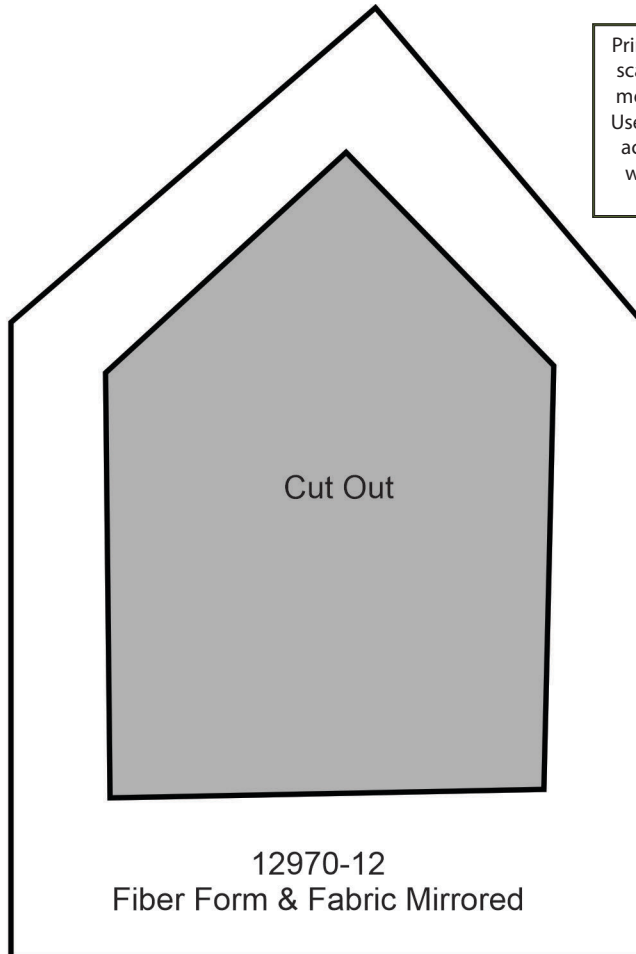

MIRRORED PATTERNS

Print at 100%. No scaling. This box measures 1" x 1". Use the box as an accuracy guide when printing templates.

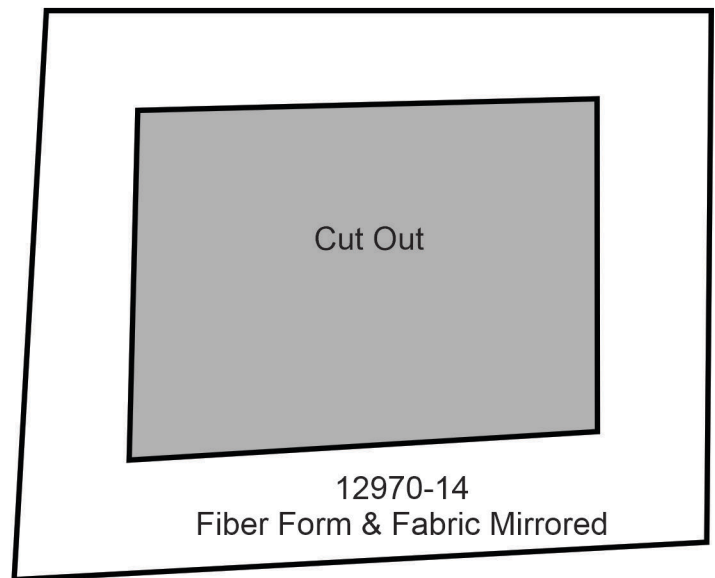
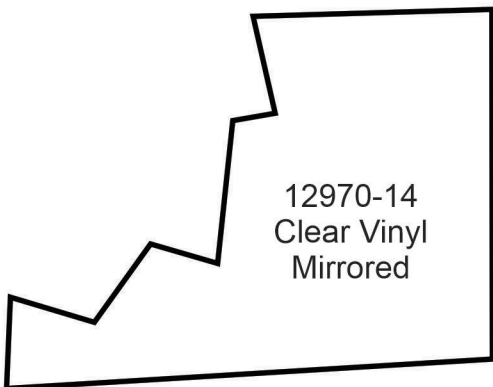
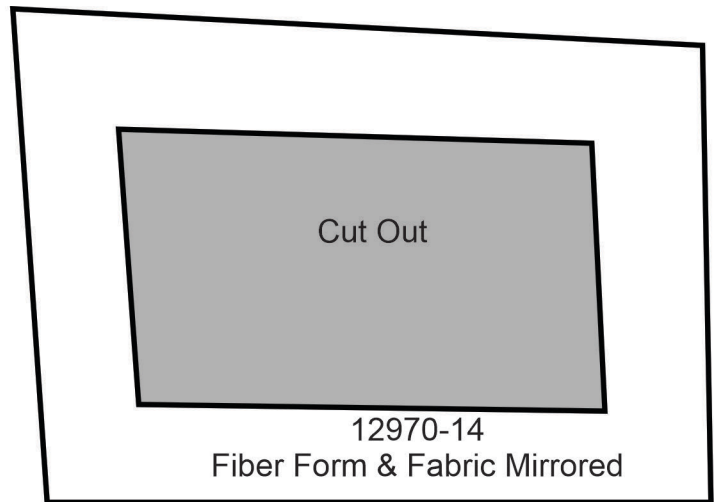

MIRRORED PATTERNS

Print at 100%. No scaling. This box measures 1" x 1". Use the box as an accuracy guide when printing templates.

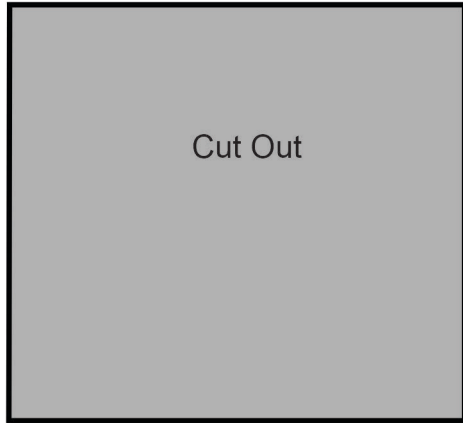

Cut Out

12970-15
Fiber Form & Fabric Mirrored

12970-16
Fiber Form &
Fabric Mirrored

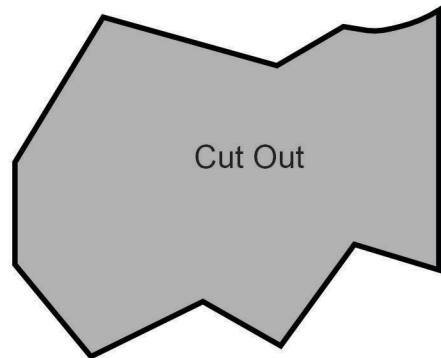

Cut Out

MIRRORED PATTERNS

Print at 100%. No scaling. This box measures 1" x 1". Use the box as an accuracy guide when printing templates.

12970-17
Fiber Form &
Fabric Mirrored

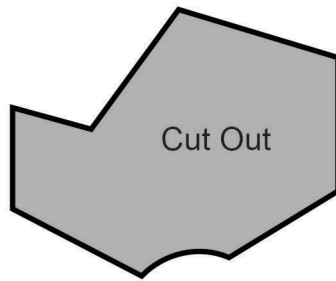

12970-20
Fiber Form &
Fabric Mirrored

12970-18
Fiber Form &
Fabric Mirrored

12970-18
Fiber Form &
Fabric Mirrored

12970-18
Fiber Form &
Fabric Mirrored

12970-18
Fiber Form &
Fabric Mirrored

MIRRORED PATTERNS

Print at 100%. No scaling. This box measures 1" x 1". Use the box as an accuracy guide when printing templates.

