

Primitive Autumn Appliques



Collection No. 12985
14 Designs

MATERIALS



Isacord Thread Colors

- 0134 Smoky
- 0176 Fog
- 1010 Toast
- 1252 Dark Tan
- 1321 Dark Orange
- 1335 Dark Rust

Note: One spool of 1000 meter thread is adequate for the project unless otherwise noted.



INSPIRATION



Designs 12985-06, 12985-07



Design 12985-09



Designs 12985-10, 12985-11, 12985-12, 12985-14



Design 12985-05



INSPIRATION



Designs 12985-10, 12985-11



Design 12985-11



Designs 12985-01, 12985-11,
12985-12, 12985-13



Designs 12985-01, 12985-09, 12985-10



INSPIRATION



Designs 12985-05, 12985-08, 12985-11



Designs 12985-11, 12985-14

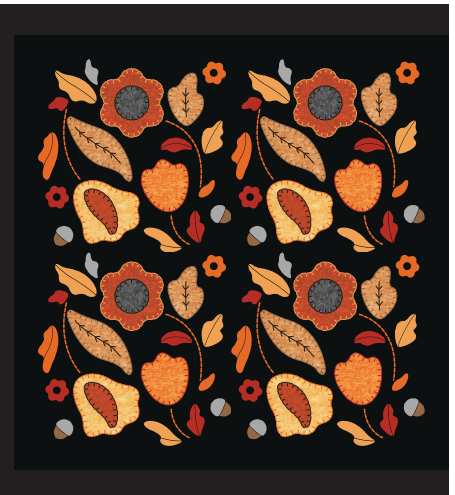
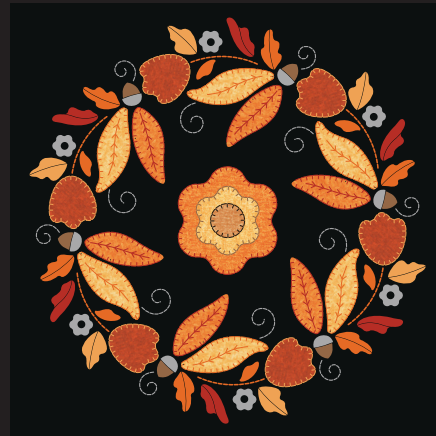

Designs 12985-02, 12985-12, 12985-13



GENERAL APPLIQUE SUPPLIES CUT IN PLACE

Stabilizers

- OESD Fusible Woven
- OESD StabilStick TearAway

Fabrics/Textiles

- Assorted fabric
- Cut the prepared applique fabrics 1/4" - 1/2" larger than the applique templates.

Notion & Tools

- OESD Expert Embroidery Tape TearAway
- OESD Perfect Embroidery Press Cloth
- OESD Grippy Grid
- Embroidery Needle Sharp 75/11

Isacord Thread Colors

- Per thread chart

GENERAL CUT IN PLACE APPLIQUE INSTRUCTIONS

The applique instructions, included in the collection, are general instructions. For demonstration purposes, a sample design that best demonstrates the technique is shown.

Fabric and thread requirements will vary by design, but the general technique is the same.

Note: Some thread colors in instructions have been changed or digitally enhanced for better visibility.

Example design is Sweeter Than Pumpkin Pie Applique 51303-3, from the collection Adorable Autumn 51303.

Step 1

- Apply one layer of Fusible Woven to the wrong side of the applique fabric.



Step 2

- Hoop the desired stabilizer and fabric for the project.
- Stabilizer used in the example is StabilStick TearAway.



GENERAL CUT IN PLACE APPLIQUE INSTRUCTIONS

Step 3

- Load selected design into the machine.
- Example design is Sweeter Than Pumpkin Pie Applique 51303-3, from the collection Adorable Autumn 51303.
- Thread the machine per the thread chart.
- Place the hoop on the machine.
- Stitch Machine Step 1, Tan Placement Stitch.



Step 4

- Remove the hoop from the machine, but NOT the project from the hoop.
- Completely cover the placement stitch with the prepared fabric.
- Tape in place to secure.
- Return the hoop to the machine.



Step 5

- Stitch Machine Step 2, Cut Line and Tackdown.



GENERAL CUT IN PLACE APPLIQUE INSTRUCTIONS

Step 6

- Remove the hoop from the machine, but NOT the project from the hoop.
- Place on a flat surface.
- Trim the excess fabric as close to the cut line as possible.
Note: If the outermost stitches (cut line) are cut, the inner stitches (tackdown) will hold the applique in place.



Step 7

- Place the hoop on the machine.
- Stitch Machine Step 3, Orange Fabric Placement Stitch.

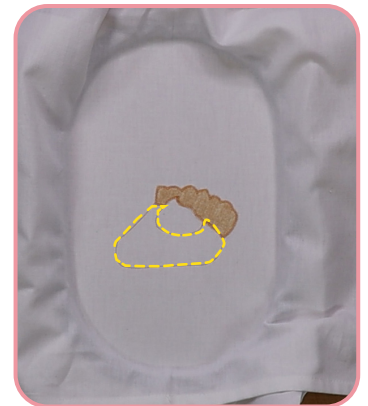

Step 8

- Remove the hoop from the machine, but NOT the project from the hoop.
- Completely cover the placement stitch with the prepared fabric.
- Tape in place to secure.
- Return the hoop to the machine.



GENERAL CUT IN PLACE APPLIQUE INSTRUCTIONS

Step 9

- Stitch Machine Step 4, Cut Line and Tackdown.



Step 10

- Remove the hoop from the machine, but NOT the project from the hoop.
- Place on a flat surface.
- Trim the excess fabric as close to the cut line as possible.



Step 11

- Repeat the applique process as many times as needed following the thread chart.



GENERAL CUT IN PLACE APPLIQUE INSTRUCTIONS

Step 12

- Return the hoop to the machine and stitch the remaining steps per the thread chart.



Step 13

- When the design is complete, remove excess stabilizer.
- Press right side down on a Perfect Embroidery Press Cloth.



GENERAL APPLIQUE SUPPLIES RAW EDGE

Stabilizers

- OESD Applique Fuse and Fix
- OESD Ultra Clean and Tear

Fabrics/Textiles

- Assorted fabric
- Cut the prepared applique fabrics 1/4" - 1/2" larger than the applique templates.

Notion & Tools

- OESD Perfect Embroidery Press Cloth
- OESD Grippy Grid
- Embroidery Needle Sharp 75/11

Isacord Thread Colors

- Per thread chart

GENERAL RAW EDGE APPLIQUE INSTRUCTIONS

The General Raw Edge applique instructions, included in the collection, are general instructions. For demonstration purposes, a sample design that best demonstrates the technique is shown.

Fabric and thread requirements will vary by design, but the general technique is the same.

Note: Some thread colors in instructions have been changed or digitally enhanced for better visibility.

Example design is Flower Applique Border 12925-01, from the collection Whimsical Borders 12925.

Step 1

- Print the mirrored version of the templates (at 100% scale or 1:1 ratio) onto the paper side of Applique Fuse and Fix.
- Cut the prepared applique fabrics $\frac{1}{4}$ "- $\frac{1}{2}$ " larger than the applique templates.

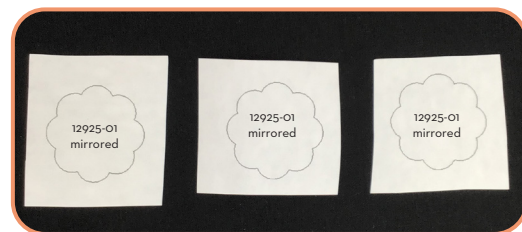
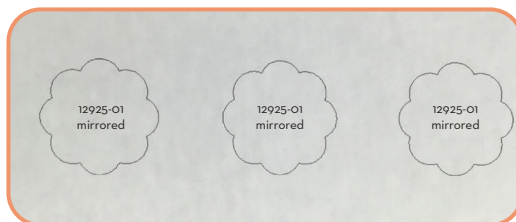

Step 2

- Cut the prepared applique fabrics $\frac{1}{4}$ "- $\frac{1}{2}$ " larger than the applique templates.
- Fuse the trimmed templates to the wrong side of the appropriate applique fabric with the paper side of the printed template up.
- For a secure fuse, hold the iron on the template for 10-15 seconds.

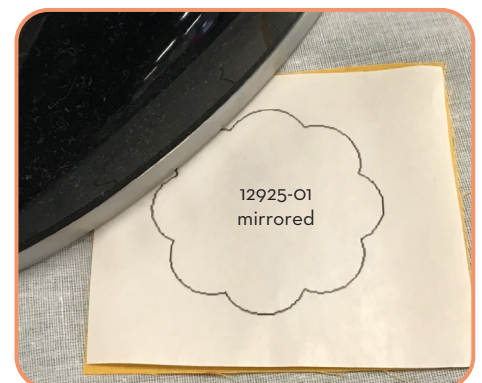

GENERAL RAW EDGE APPLIQUE INSTRUCTIONS

Step 3

- Trim the prepared appliques on the outer edge of the black outline. Set aside.



Step 4

- Hoop the desired stabilizer and fabric for the project.
- In the example, we used Ultra Clean and Tear stabilizer and white quilter's cotton fabric.

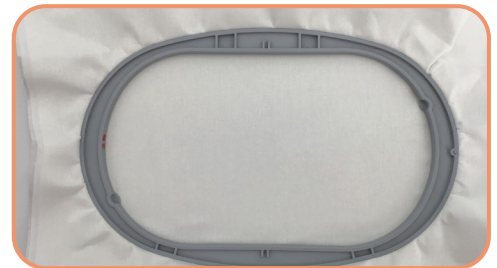

Step 5

- Load selected design into the machine.
- Example design is Flower Applique Border 12925-01, from the collection Whimsical Borders 12925.
- Thread the machine per the thread chart.
- Place the hoop on the machine.
- Stitch Machine Step 1, Fabric Placement Stitch/ Match Fabric.

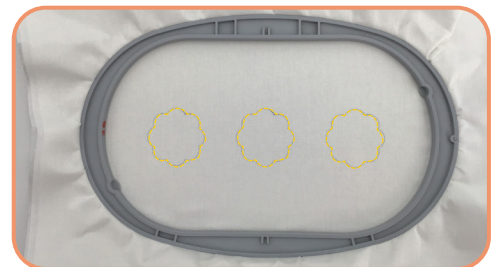

Note: Some thread colors in instructions have been changed or digitally enhanced for better visibility.

GENERAL RAW EDGE APPLIQUE INSTRUCTIONS

Step 6

- Remove the hoop from the machine, but NOT the project from the hoop.
- Place the hoop on a flat surface.
- On the back of the prepared applique fabric, score and remove the paper backing to reveal the adhesive surface.
- Place the applique within the placement stitching.
- Finger press to secure.
- Return the hoop to the machine.
- Tip: Applique Fuse and Fix is repositionable.

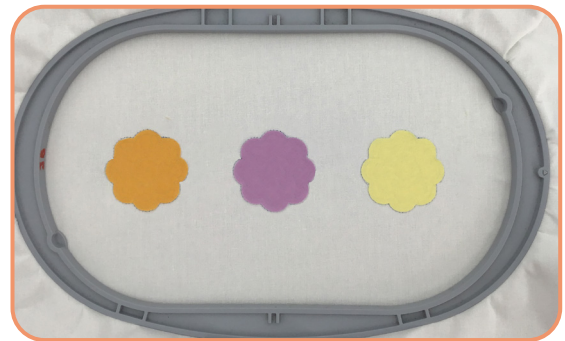
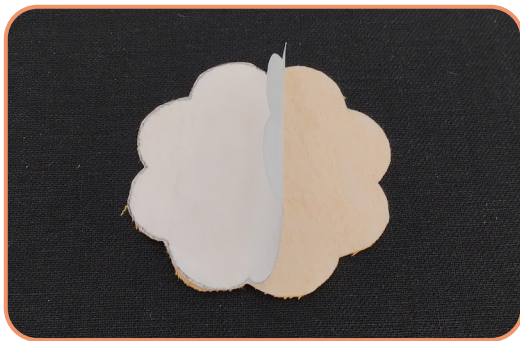

Step 7

- Stitch Machine Step 2, Linework/Tackdown.



GENERAL RAW EDGE APPLIQUE INSTRUCTIONS

Step 8

- When the design is complete, remove the hoop from the machine AND remove the project from the hoop.
- When the design is complete, remove excess stabilizer.
- The project is complete. Enjoy!



GENERAL APPLIQUE SUPPLIES PRE-CUT APPLIQUE INSTRUCTIONS

Stabilizers

- OESD Applique Fuse and Fix
- OESD Medium Weight TearAway

Fabrics/Textiles

- Assorted fabric
Note: Refer to the applique templates for sizes.

Notion & Tools

- OESD Perfect Embroidery Press Cloth
- OESD Grippy Grid

Isacord Thread Colors

- Per thread chart

GENERAL PRE-CUT APPLIQUE INSTRUCTIONS

The applique instructions included in the design pack are general instructions for the collection. For demonstration purposes, a sample design that best represents the entire collection is shown. Fabric and thread requirements will vary by design, but the general technique will be the same.

Sample design is Cake Mixing 12932-05, from the collection Live Love Bake 12932.

Step 1

- Print the mirrored version of the required templates (at 100% or 1:1 ratio) onto the paper side of Applique Fuse and Fix.
- Cut approximately 1/2" - 1/4" outside the printed applique templates.

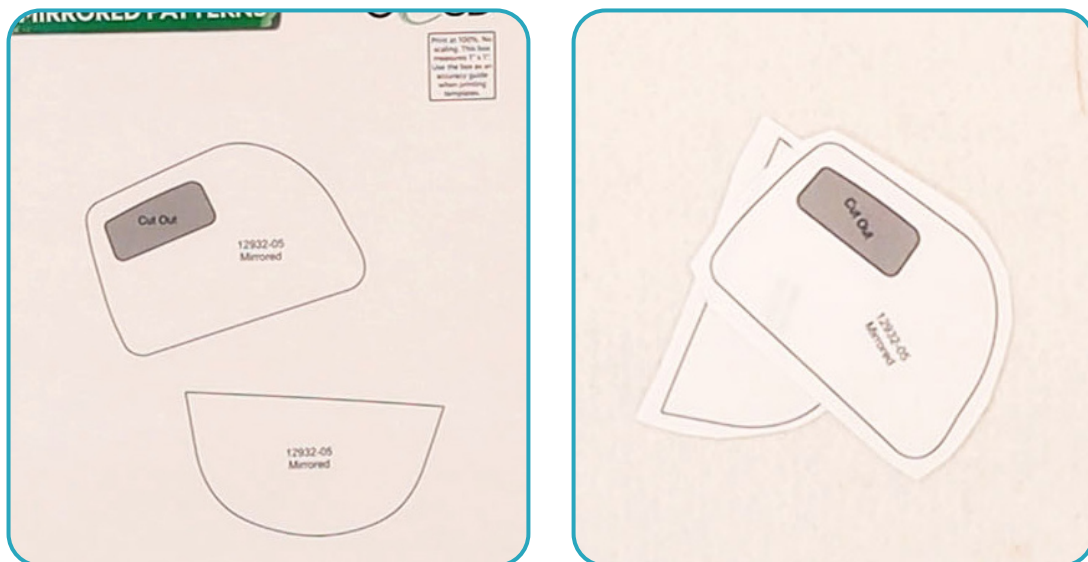

GENERAL PRE-CUT APPLIQUE INSTRUCTIONS

Step 2

- Fuse the trimmed templates to the back of the appropriate applique fabric with the paper side of the printed template up.
- For a secure fuse, hold the iron on the template for 10-15 seconds.

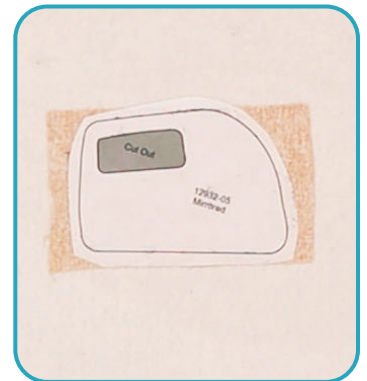

Step 3

- Trim the prepared appliques on the outer edge of the black outline. Set aside.

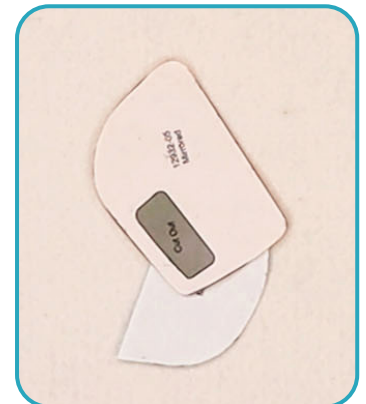

Step 4

- Hoop the desired stabilizer and fabric for the project.
- In the example we used Medium Weight TearAway Black.



GENERAL PRE-CUT APPLIQUE INSTRUCTIONS

Step 5

- Load the selected design into the machine.
- The example design is Cake Mixing 12932-05, from the collection Live Love Bake 12932.
- Thread the machine per the thread chart.
- Stitch Machine Step 1, Blue Whisks.
- Stitch Machine Step 2, Purple Detail.



Step 6

- Stitch Machine Step 3, Blue Fabric Placement Stitch.

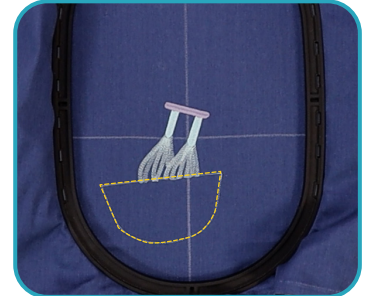

Step 7

- Remove the hoop from the machine, but NOT the project from the hoop.
- Place the hoop on a flat surface.
- On the back of the prepared applique fabric, score and remove the paper backing to reveal the adhesive surface.
- Position the applique, fabric side up, within the placement stitch, matching the cut edges with the stitching line.
- Finger press to secure.
- Note: Applique Fuse and Fix is repositionable.



GENERAL PRE-CUT APPLIQUE INSTRUCTIONS

Step 8

- Return the hoop to the machine.
- Stitch Machine Step 4, Blanket Stitch Tackdown.



Step 9

- Stitch Machine Step 5, Orange Fabric Placement Stitch.
- Remove the hoop from the machine, but NOT the project from the hoop.
- Place the hoop on a flat surface.



Step 10

- On the back of the prepared applique fabric, score and remove the paper backing to reveal the adhesive surface.
- Position the applique, fabric side up, within the placement stitch, matching the cut edges with the stitching line.
- Finger press to secure.



GENERAL PRE-CUT APPLIQUE INSTRUCTIONS

Step 11

- Return the hoop to the machine.
- Stitch Machine Step 6, Blanket Stitch Tackdown.



Step 12

- Stitch the remaining steps per the thread chart.



Step 13

- Remove the project from the hoop and any excess stabilizer from the project.
- Press face down on a Perfect Embroidery Press Cloth.

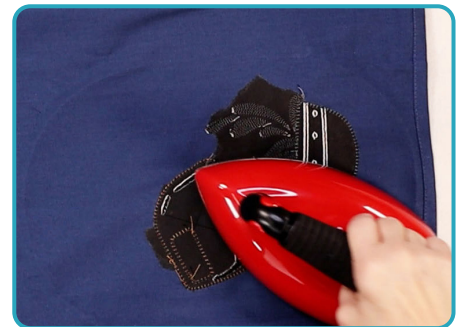

GENERAL PRE-CUT APPLIQUE INSTRUCTIONS

Step 14

- The project is complete. Enjoy!



ATTENTION

When printing this document, any page scaling or page fitting options in your print dialog box must be turned OFF or set to NONE so that your files will print out at their actual size. Images not printed at actual size will not function as intended.

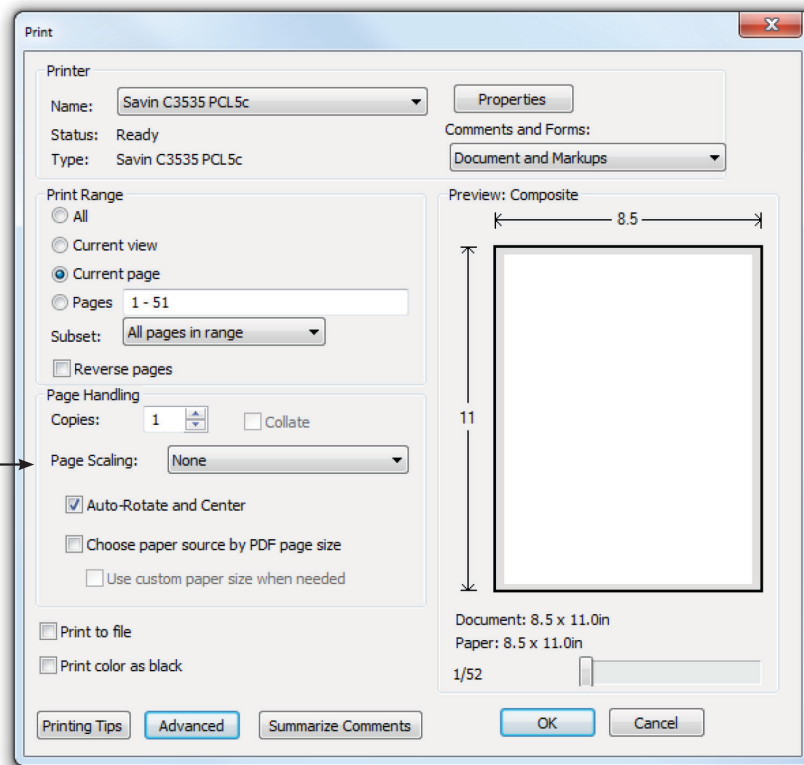

TO SAVE PAPER

Only print the desired image by navigating to the image's page, go to File > Print and select "Current page" in the print dialog box. Repeat for each desired image.

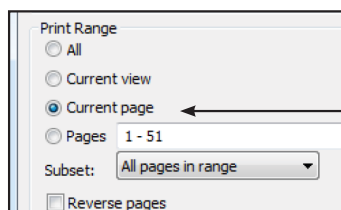

APPLIQUE PATTERNS

Print at 100%. No scaling. This box measures 1" x 1". Use the box as an accuracy guide when printing templates.

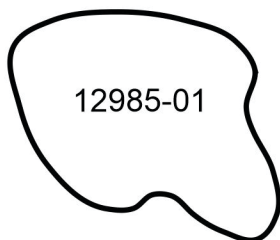
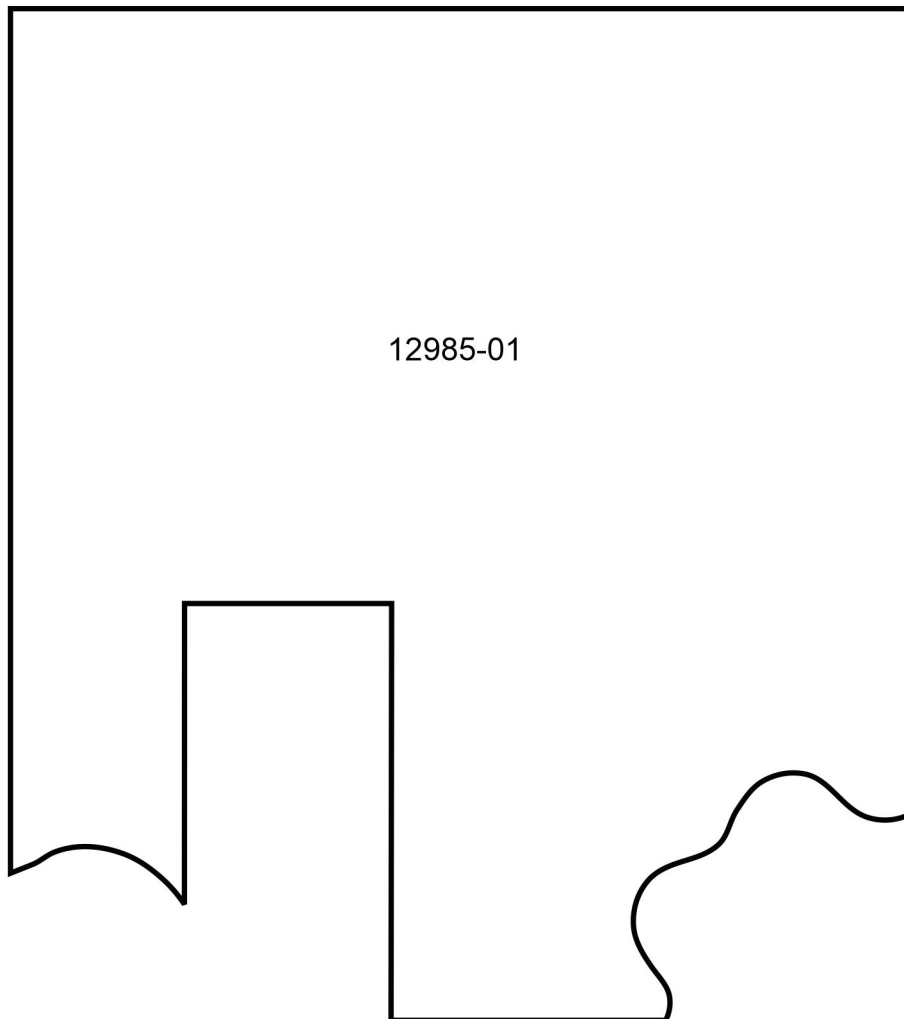
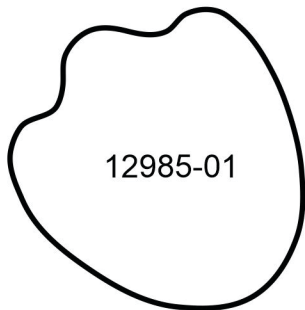
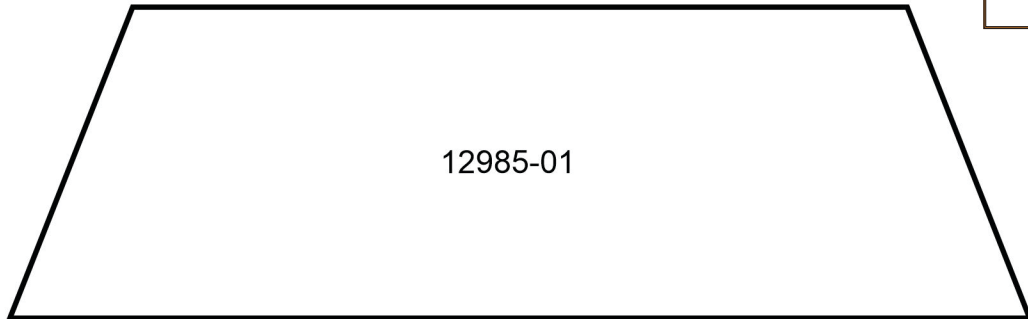

APPLIQUE PATTERNS

Print at 100%. No scaling. This box measures 1" x 1". Use the box as an accuracy guide when printing templates.

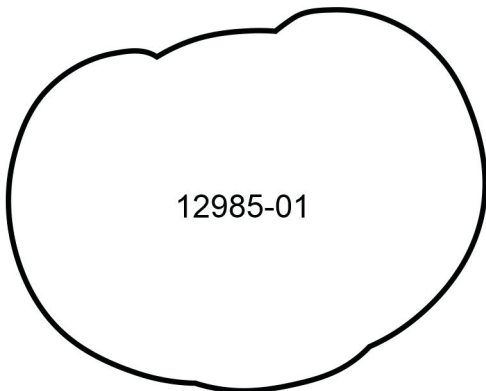
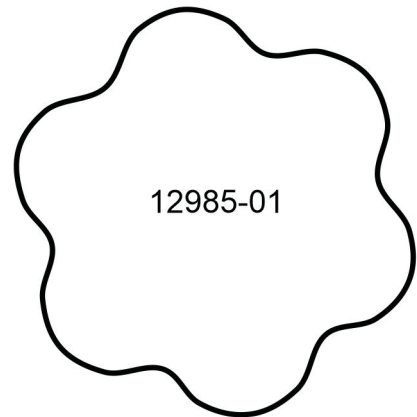
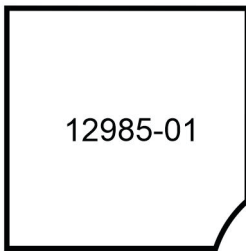
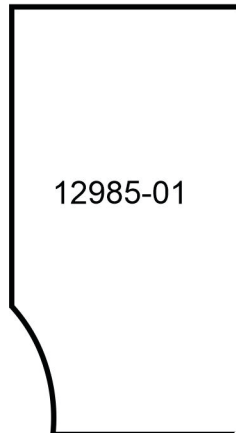
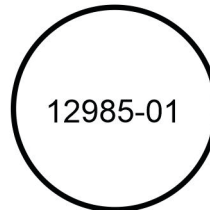
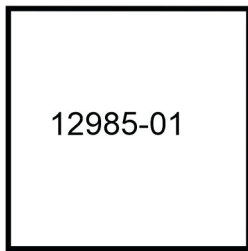
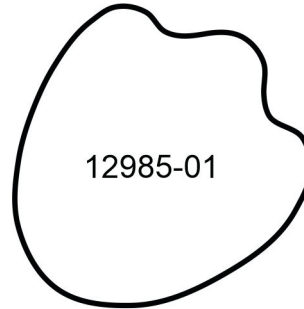
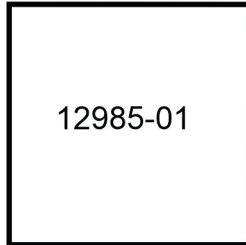
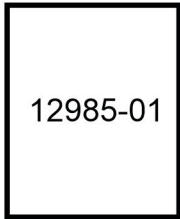

APPLIQUE PATTERNS

Print at 100%. No scaling. This box measures 1" x 1". Use the box as an accuracy guide when printing templates.

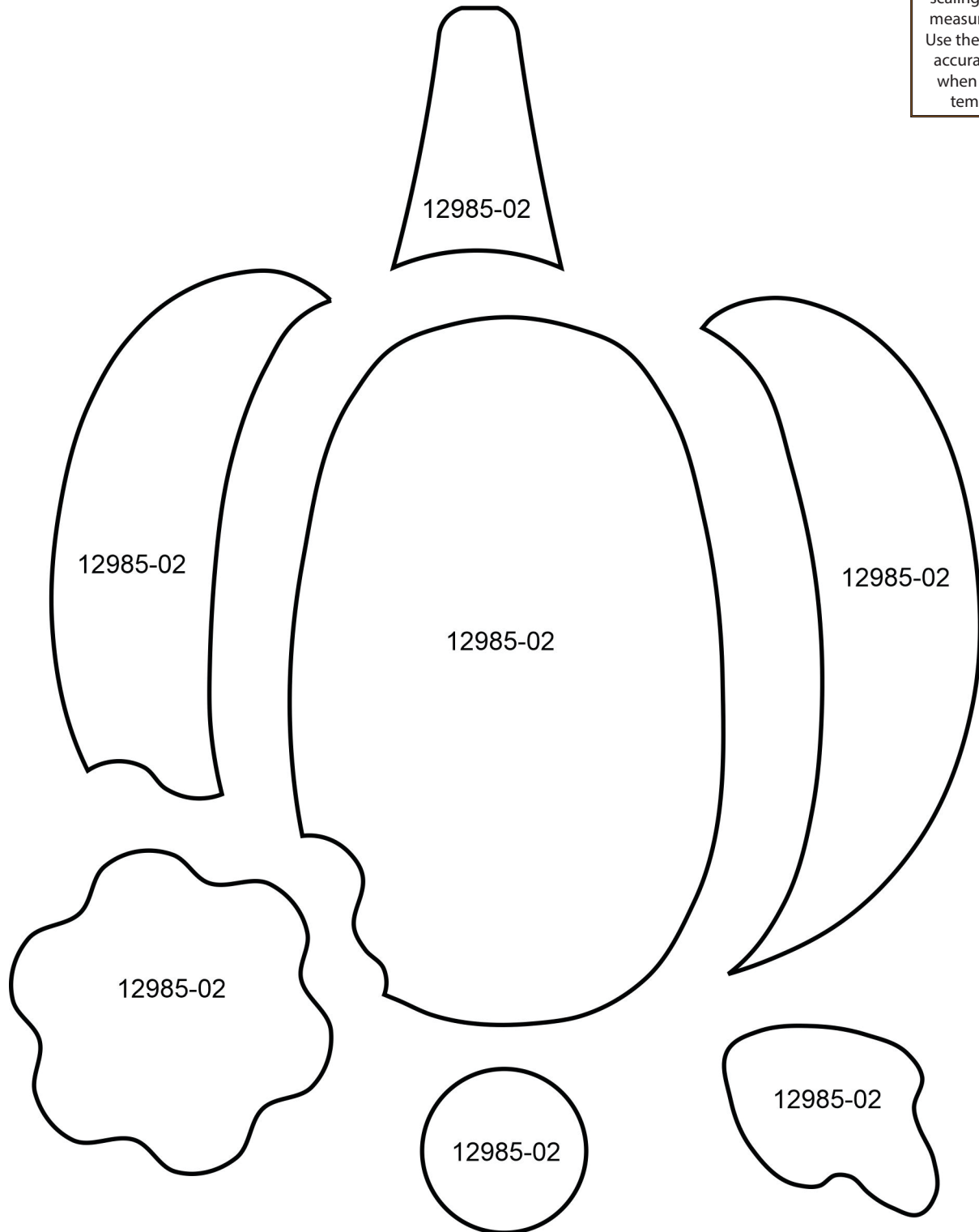

APPLIQUE PATTERNS

Print at 100%. No scaling. This box measures 1" x 1". Use the box as an accuracy guide when printing templates.

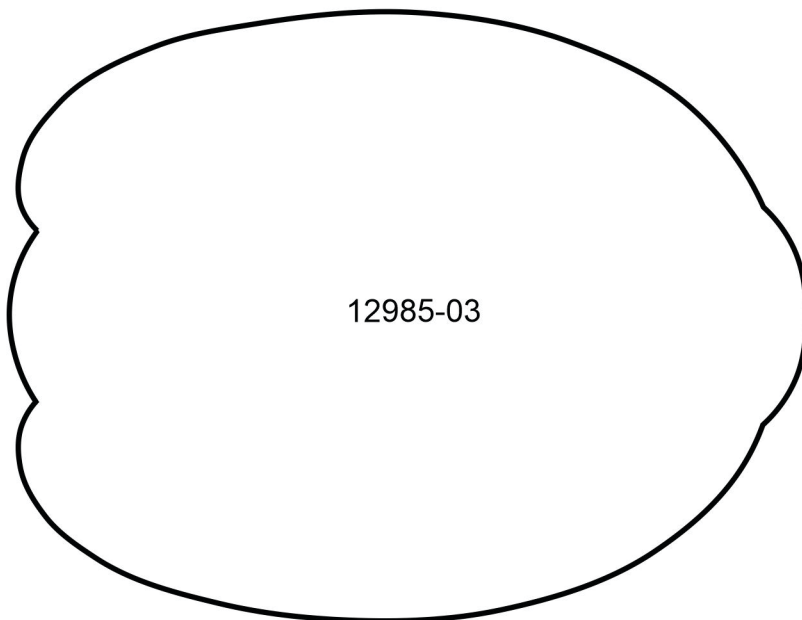
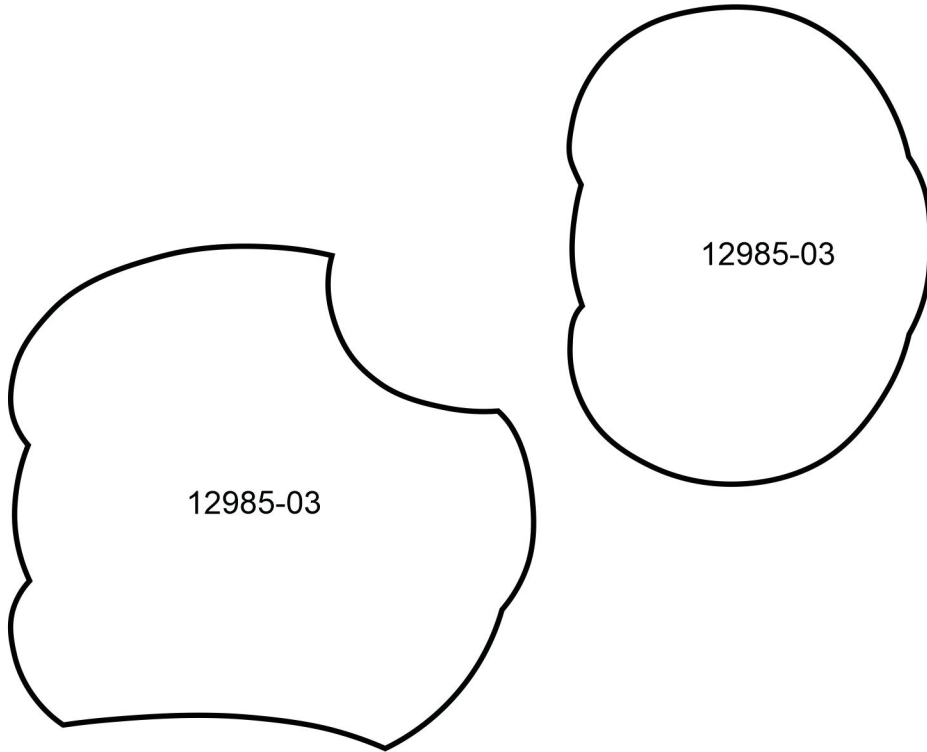

APPLIQUE PATTERNS



Print at 100%. No scaling. This box measures 1" x 1". Use the box as an accuracy guide when printing templates.

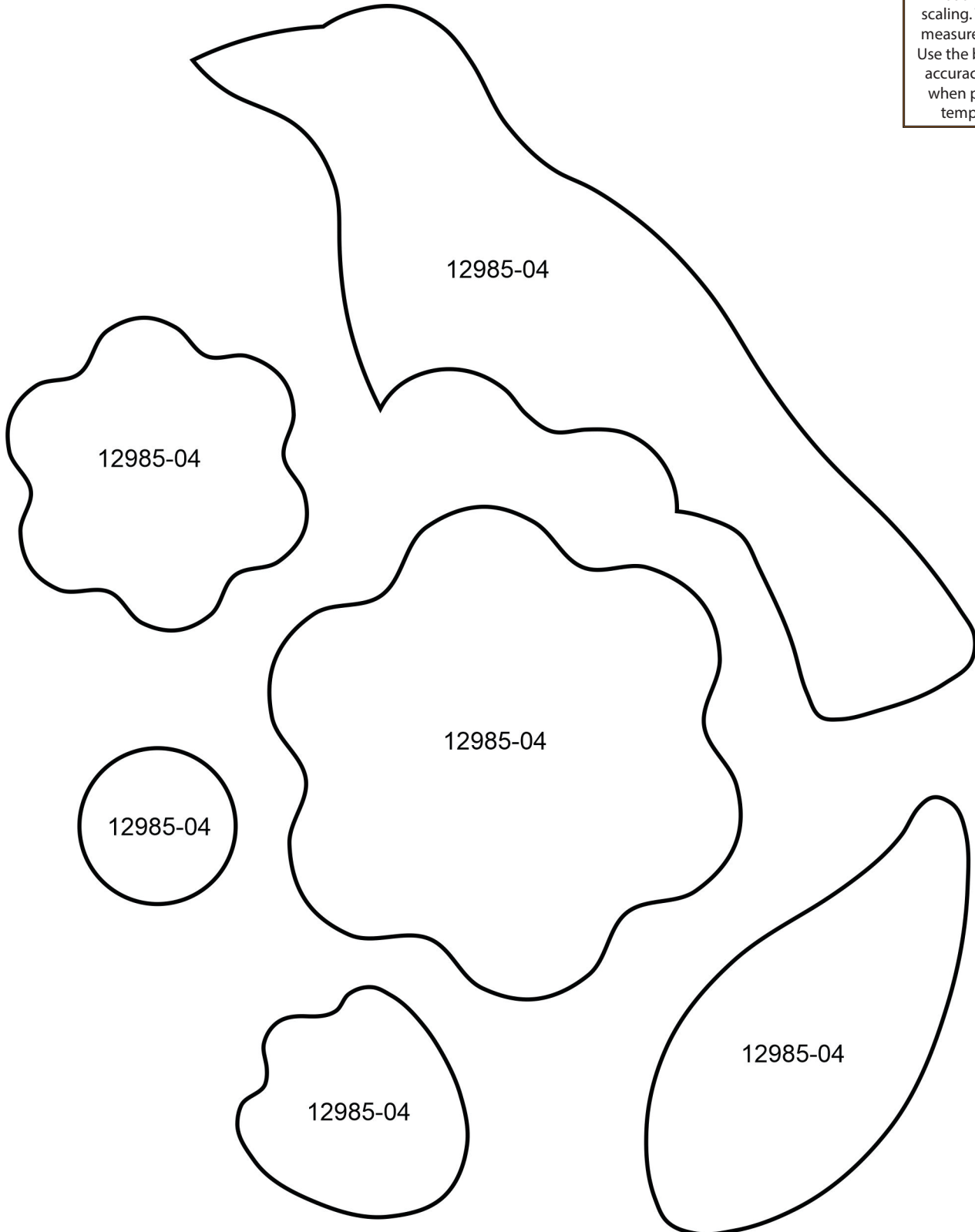

APPLIQUE PATTERNS

Print at 100%. No scaling. This box measures 1" x 1". Use the box as an accuracy guide when printing templates.

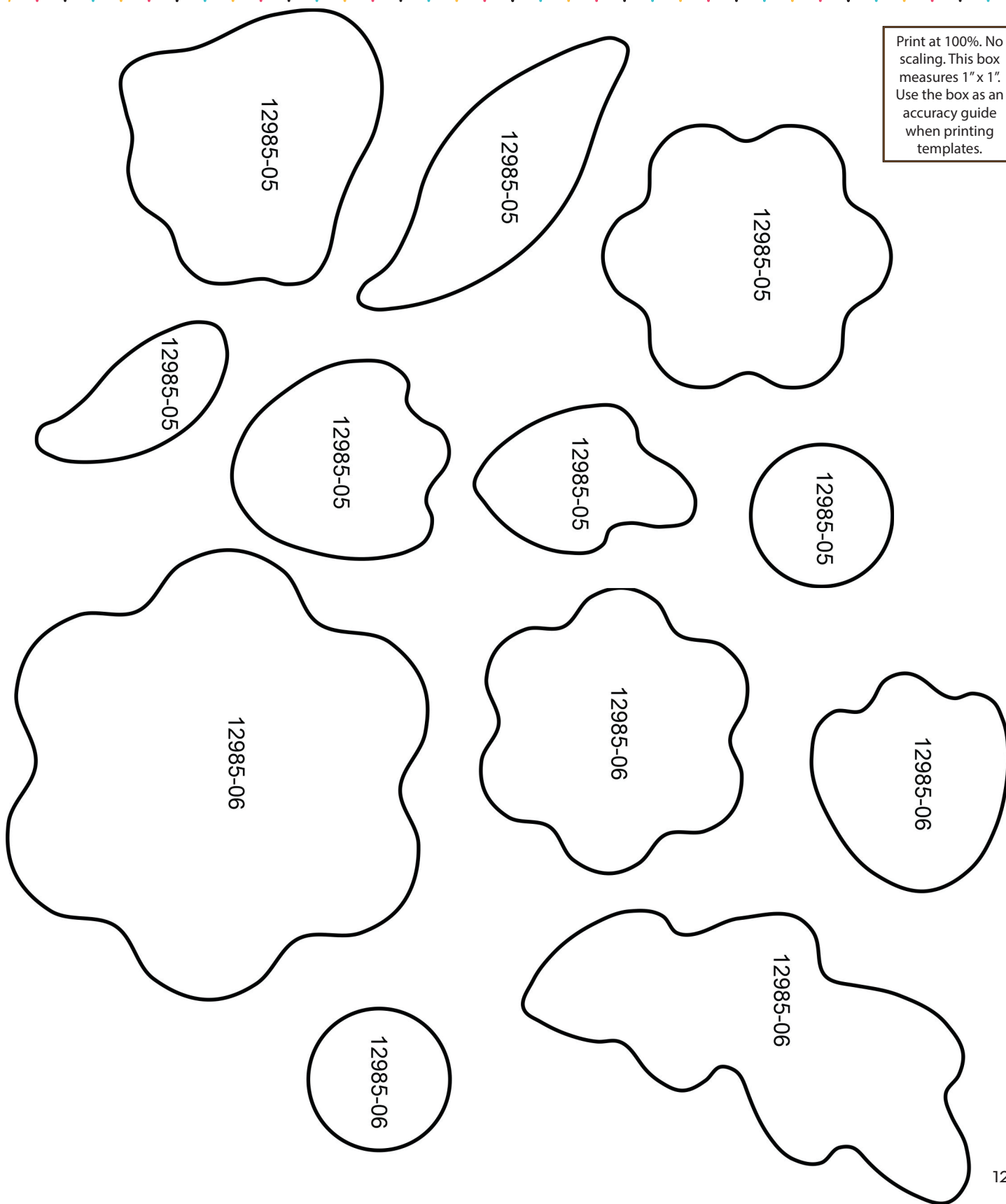

APPLIQUE PATTERNS

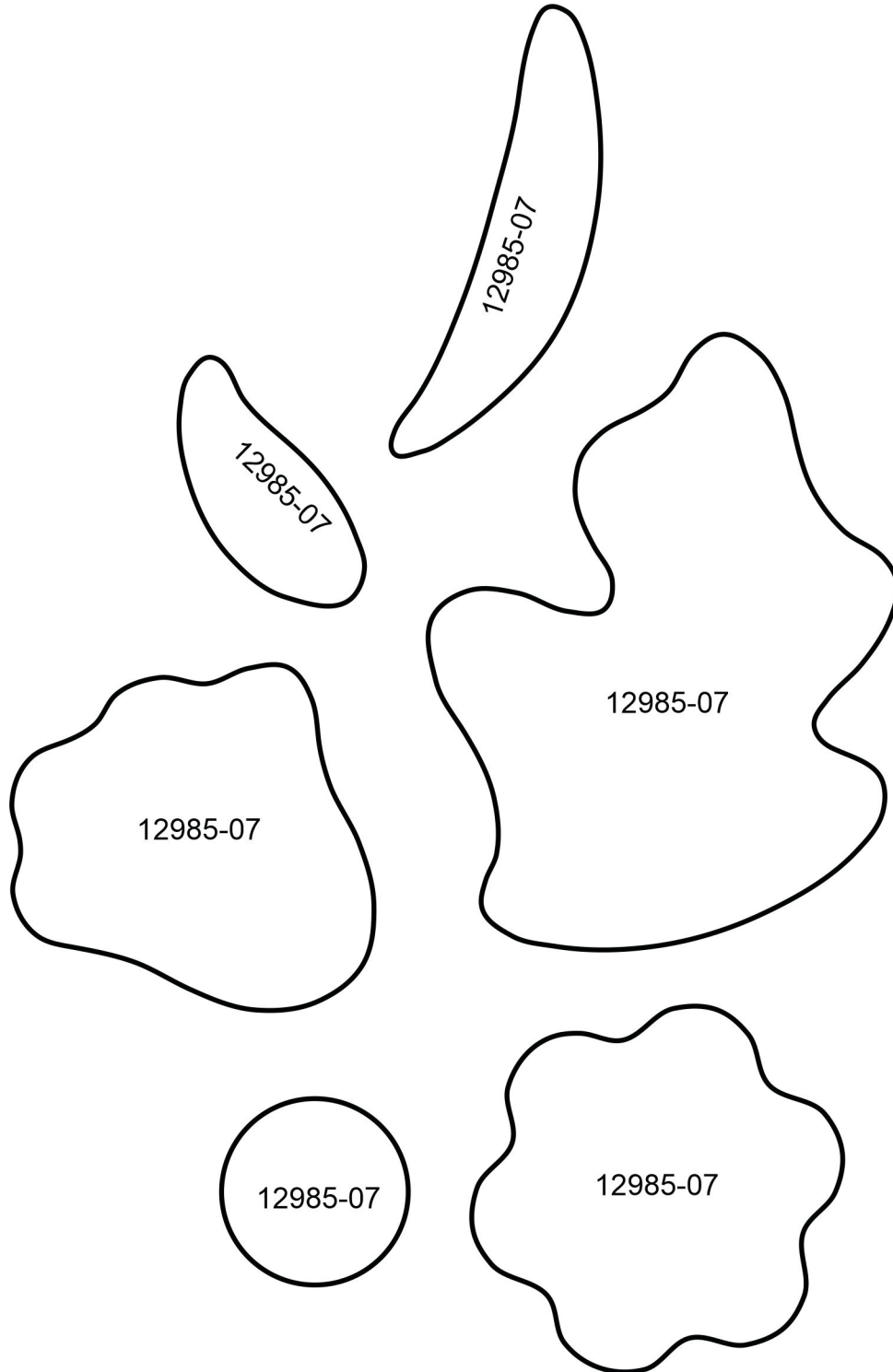

Print at 100%. No scaling. This box measures 1" x 1". Use the box as an accuracy guide when printing templates.

APPLIQUE PATTERNS

Print at 100%. No scaling. This box measures 1" x 1". Use the box as an accuracy guide when printing templates.

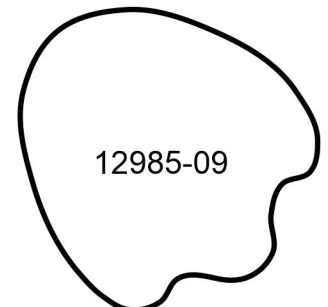
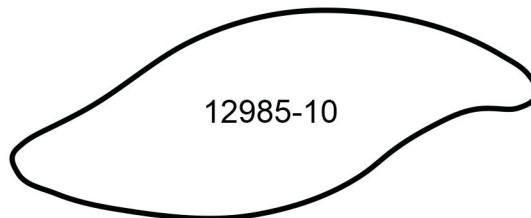
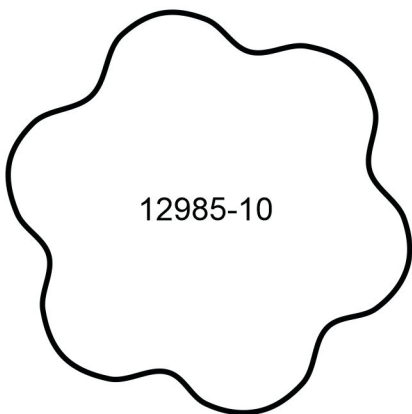
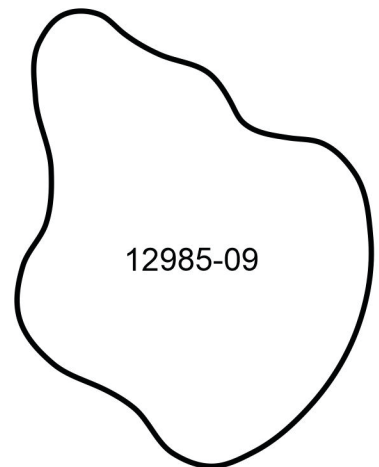
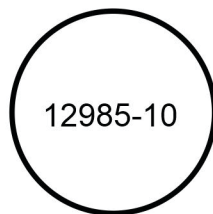
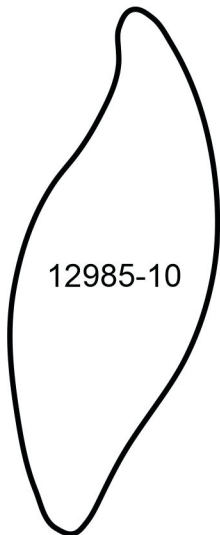
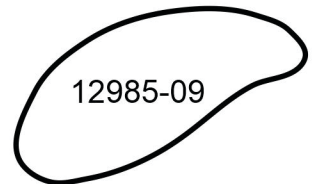
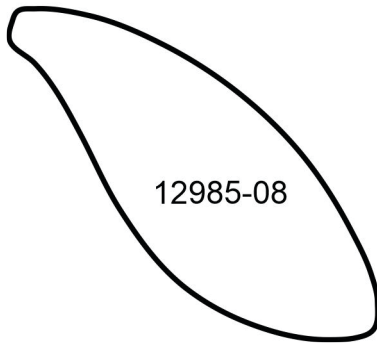
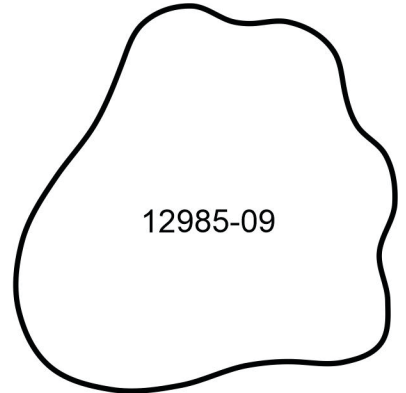
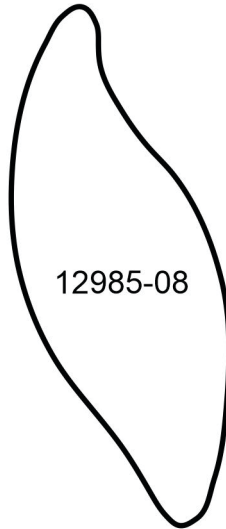
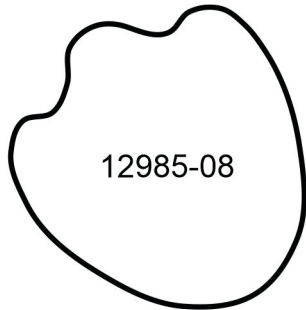

APPLIQUE PATTERNS



12985-11

12985-11

12985-11

Print at 100%. No scaling. This box measures 1" x 1". Use the box as an accuracy guide when printing templates.

MIRRORED PATTERNS



Print at 100%. No scaling. This box measures 1" x 1". Use the box as an accuracy guide when printing templates.

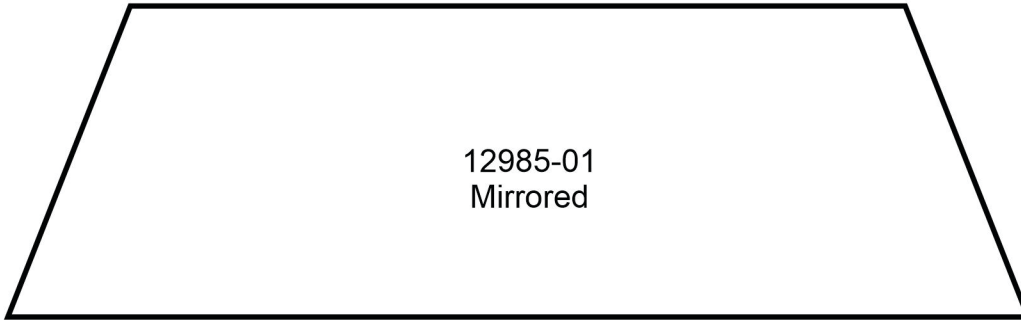

12985-01
Mirrored

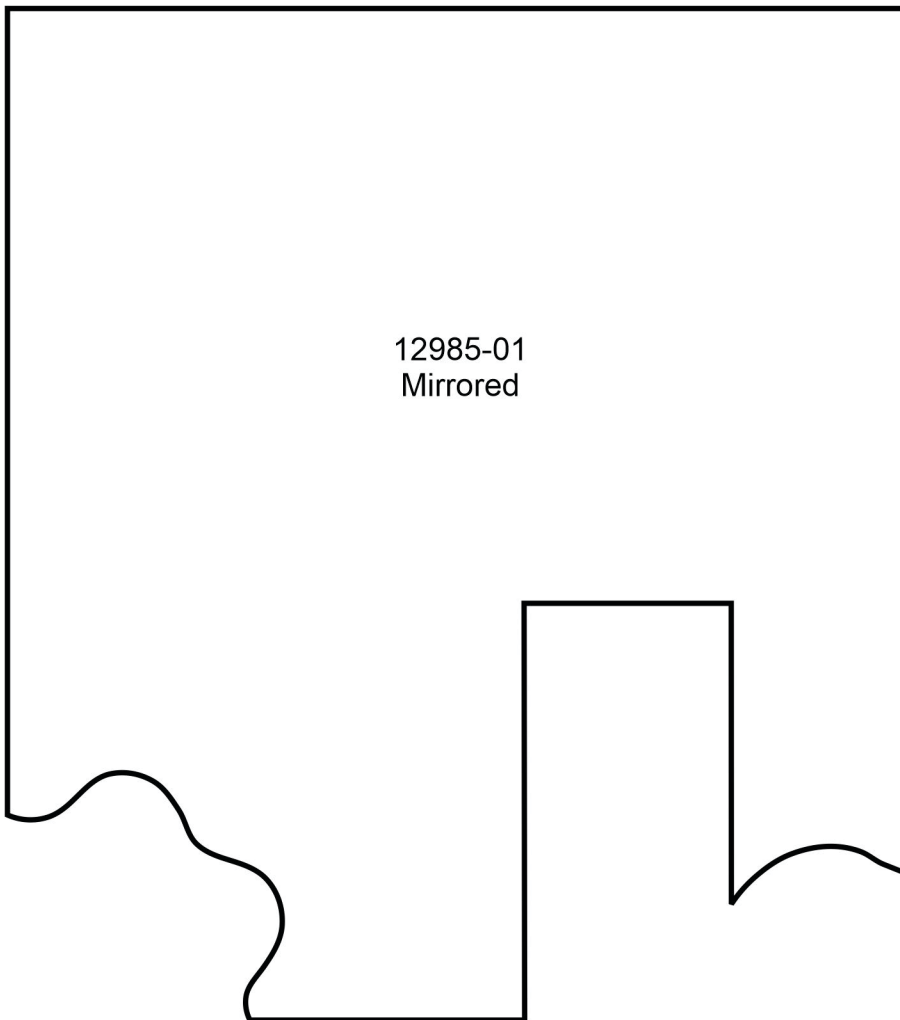

12985-01
Mirrored

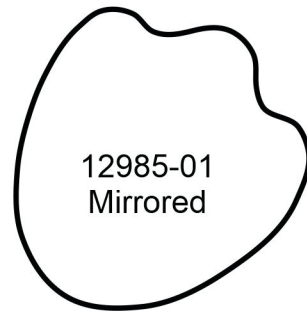

12985-01
Mirrored

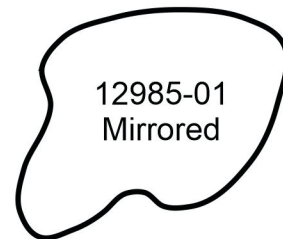

12985-01
Mirrored

MIRRORED PATTERNS

Print at 100%. No scaling. This box measures 1" x 1". Use the box as an accuracy guide when printing templates.

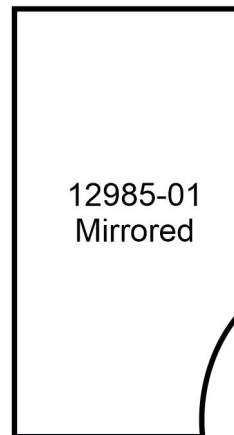
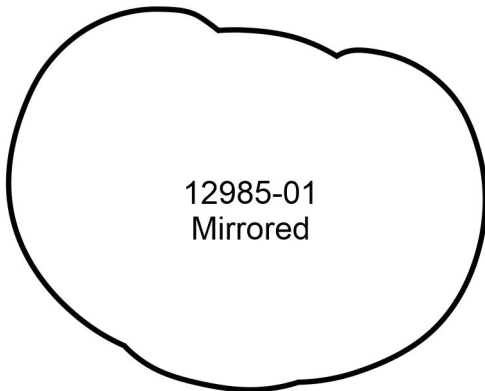
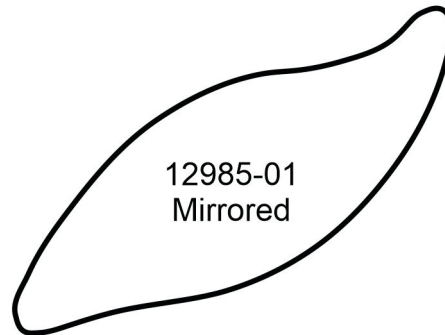
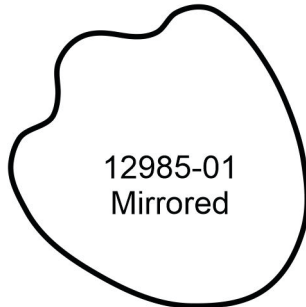
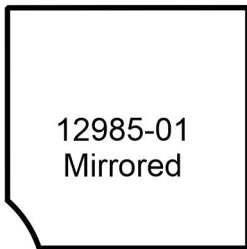
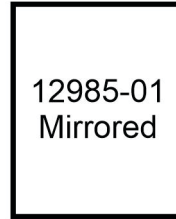

MIRRORED PATTERNS



Print at 100%. No scaling. This box measures 1" x 1". Use the box as an accuracy guide when printing templates.

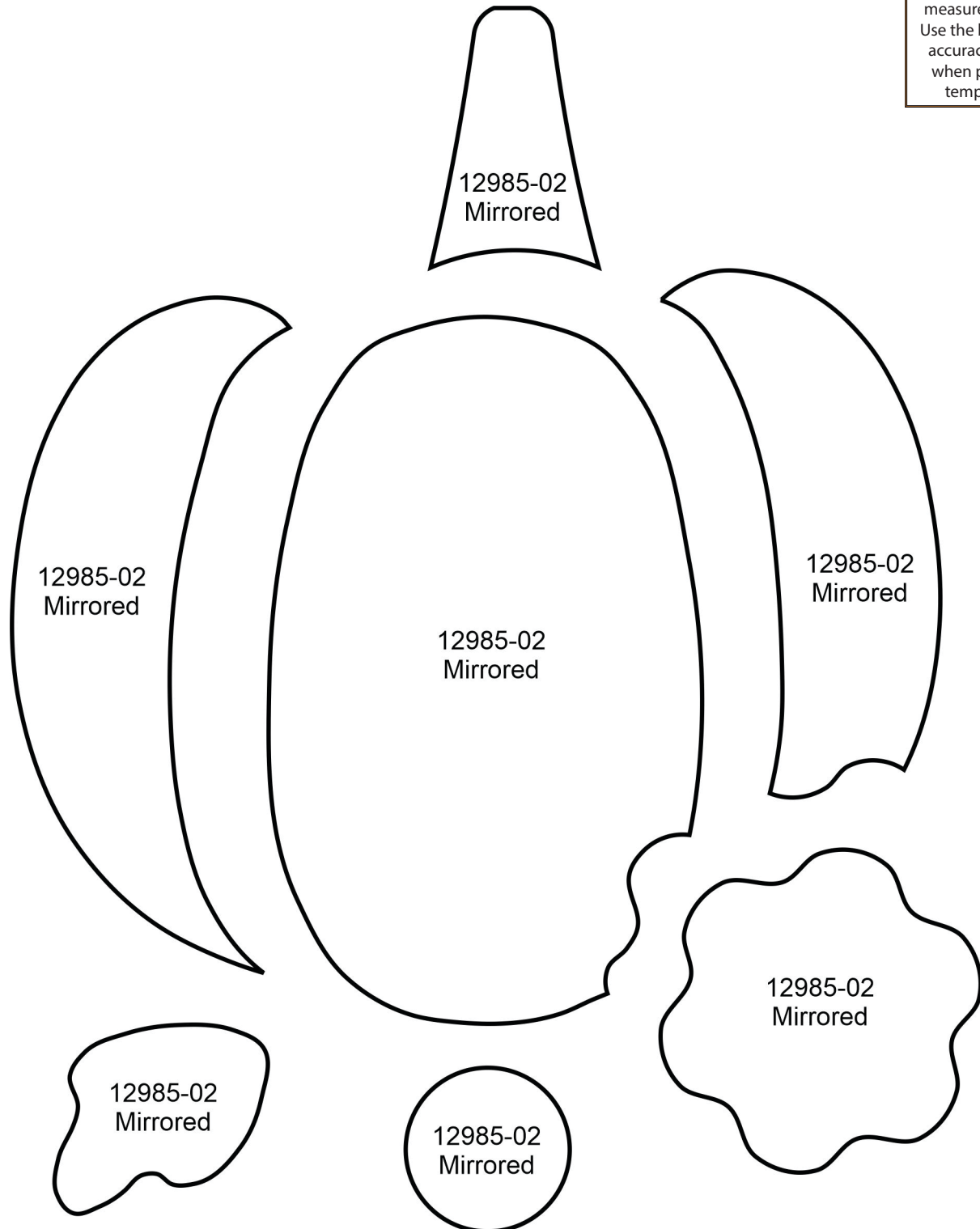

MIRRORED PATTERNS PREMIER COLLECTION

Print at 100%. No scaling. This box measures 1" x 1". Use the box as an accuracy guide when printing templates.

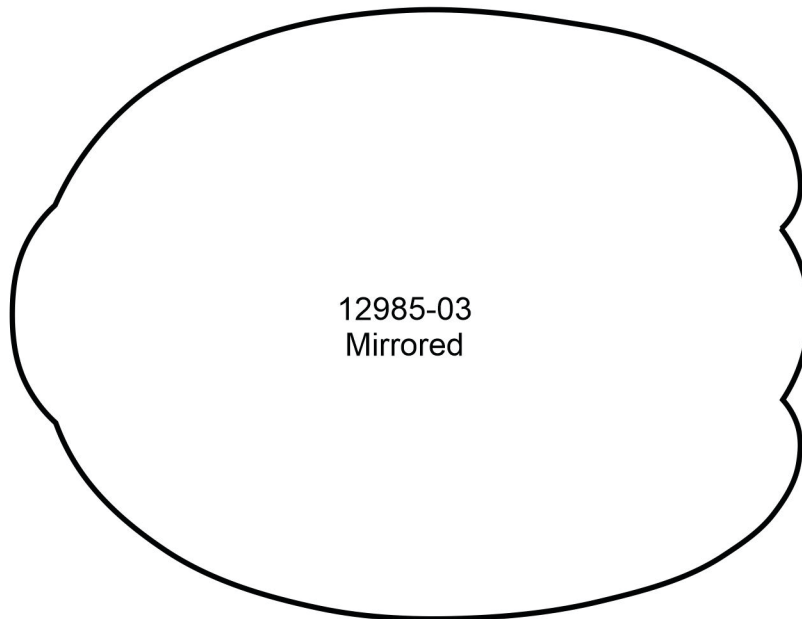
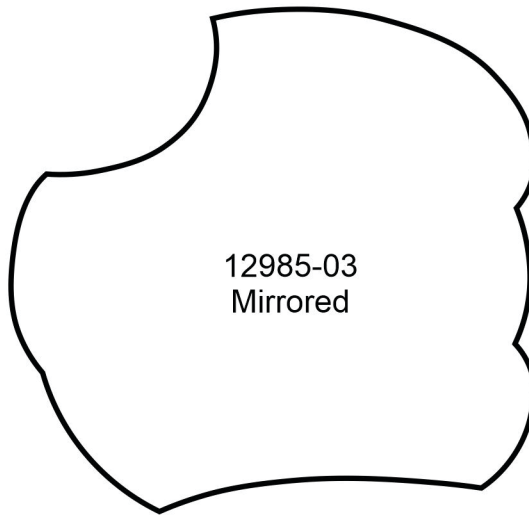
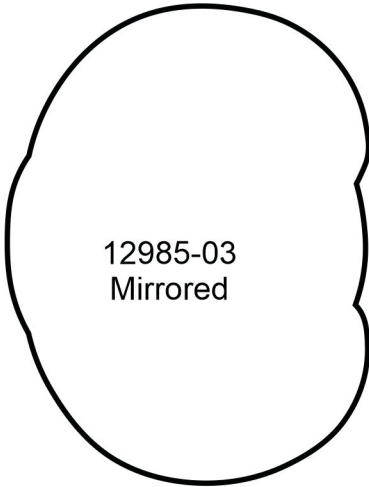

MIRRORED PATTERNS PREMIER COLLECTION

Print at 100%. No scaling. This box measures 1" x 1". Use the box as an accuracy guide when printing templates.

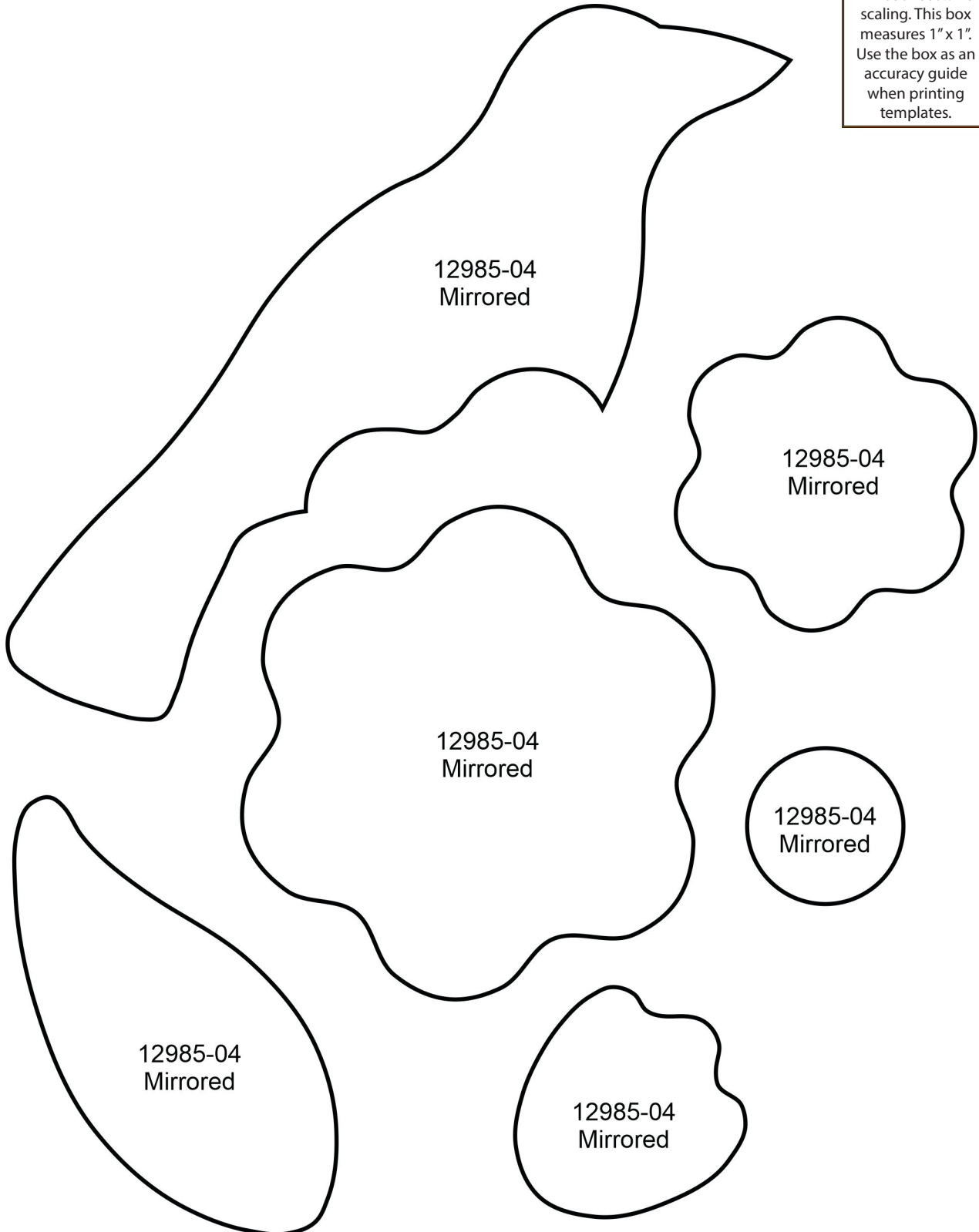

MIRRORED PATTERNS

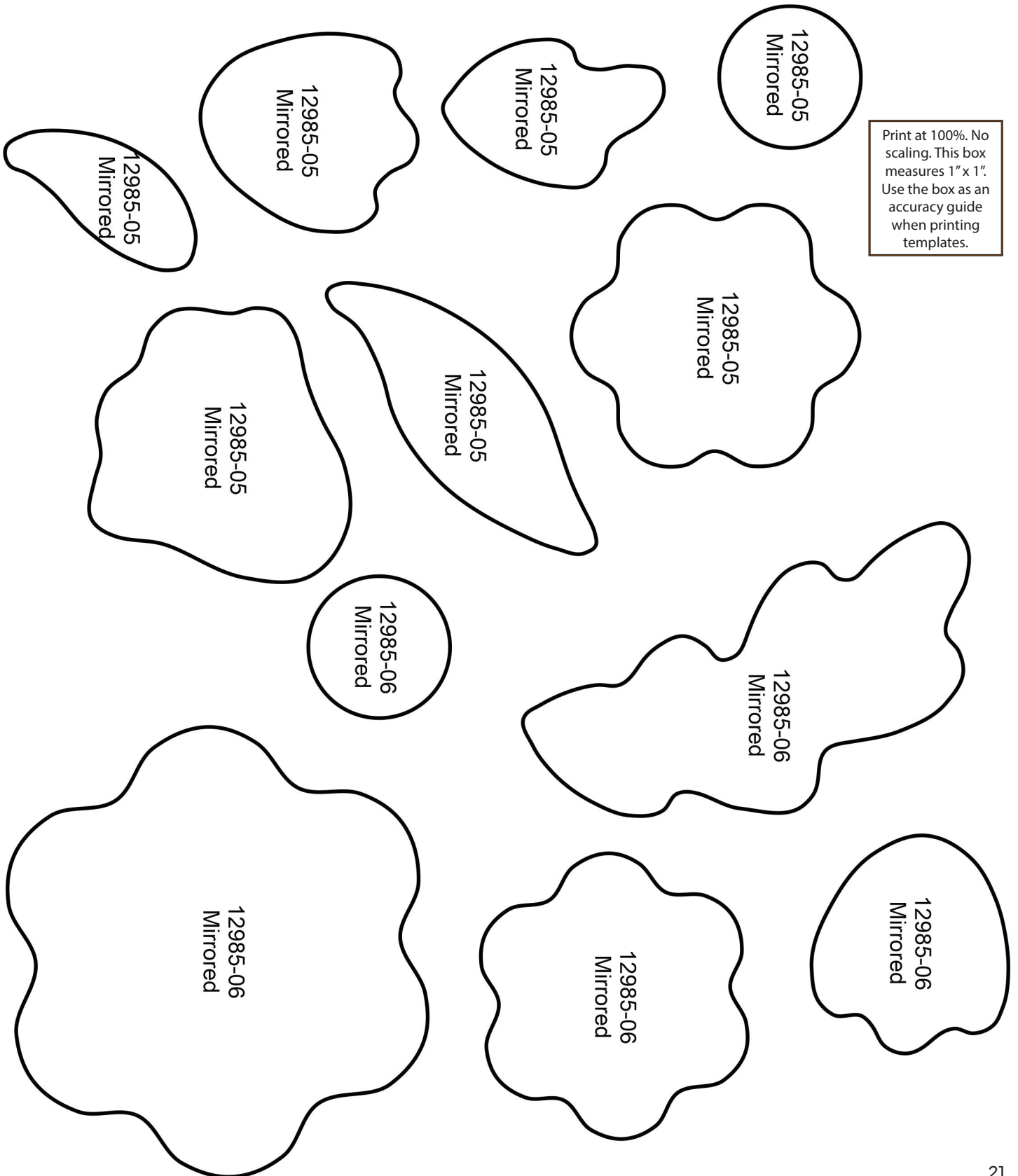

Print at 100%. No scaling. This box measures 1" x 1". Use the box as an accuracy guide when printing templates.

MIRRORED PATTERNS PREMIER COLLECTION

Print at 100%. No scaling. This box measures 1" x 1". Use the box as an accuracy guide when printing templates.

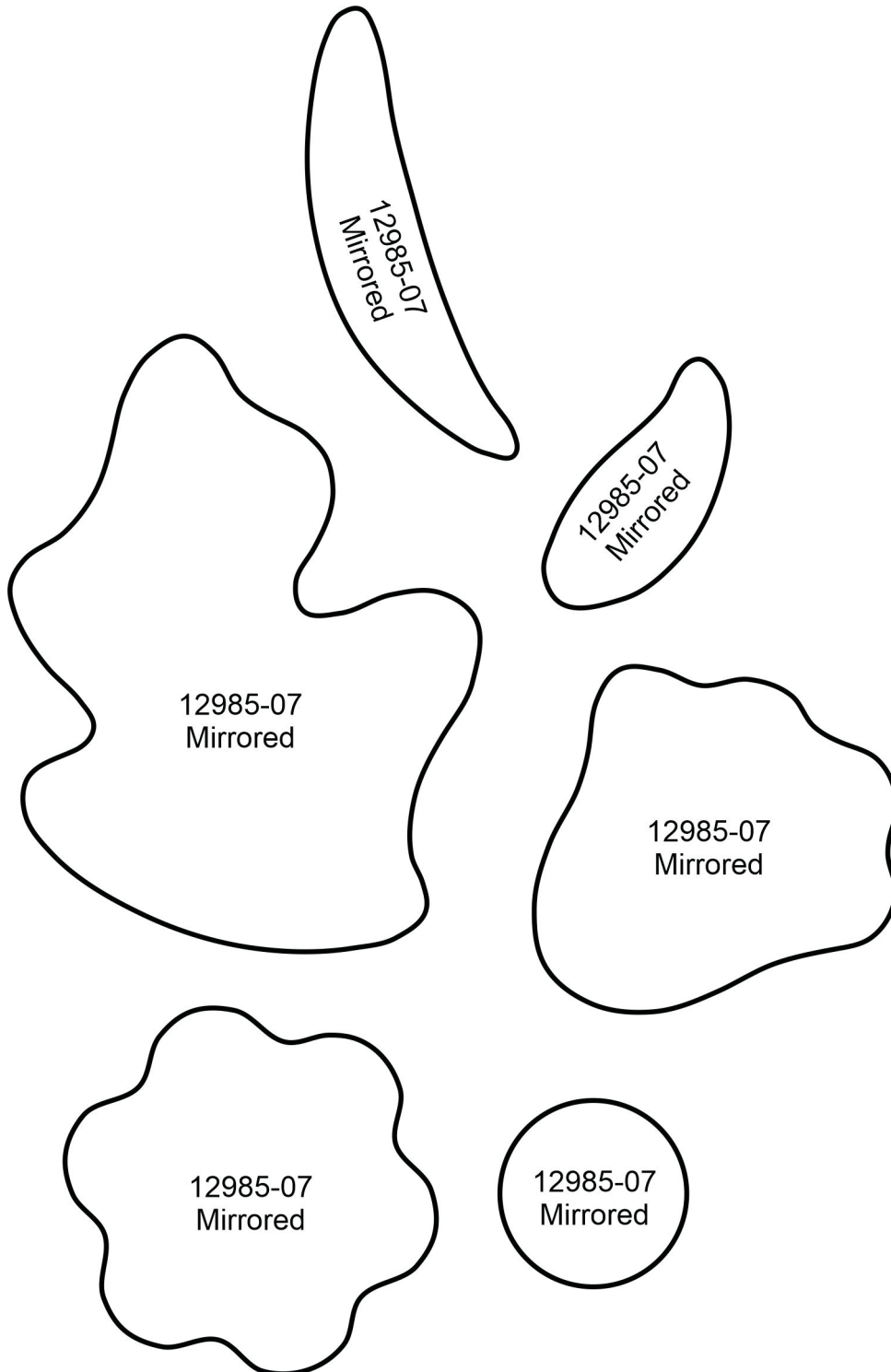

MIRRORED PATTERNS PREMIER COLLECTION

Print at 100%. No scaling. This box measures 1" x 1". Use the box as an accuracy guide when printing templates.

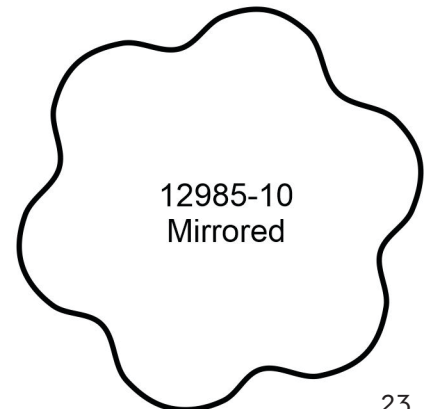
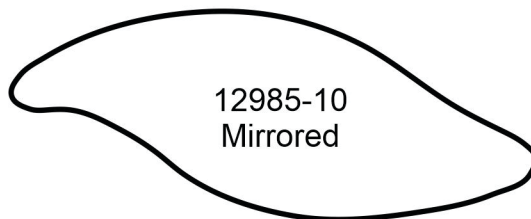
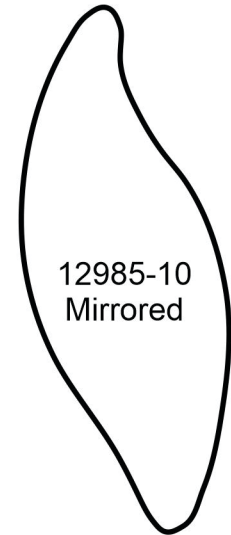
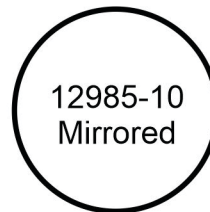
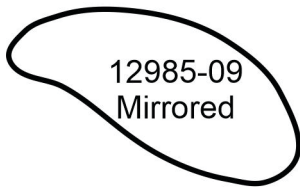
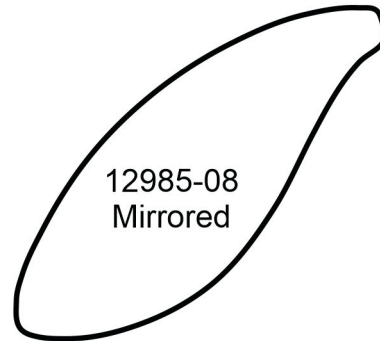
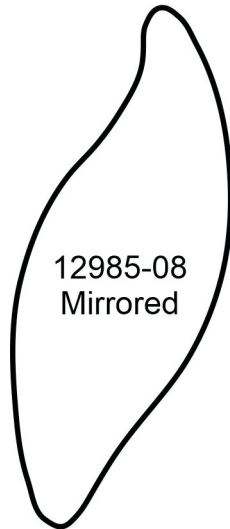
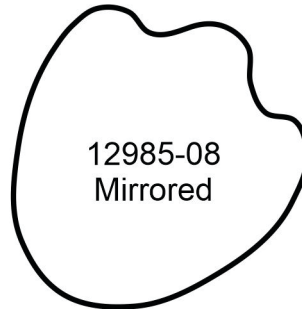

MIRRORED PATTERNS PREMIER COLLECTION

Print at 100%. No scaling. This box measures 1" x 1". Use the box as an accuracy guide when printing templates.

