

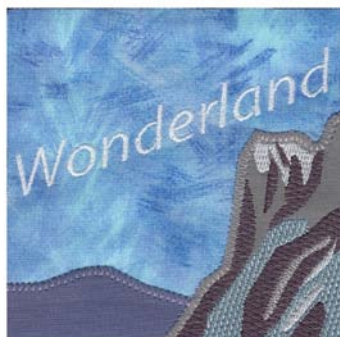


Finished size approx. 12" x 16"

Note: Some designs in this collection may have been created using unique special stitches and/or techniques. To preserve design integrity when rescaling or rotating designs in your software, always rescale or rotate designs using the handles directly on-screen.



12434-01 Winter Tile 1
4.50 X 4.50 in.
114.30 X 114.30 mm
5,386 St.



12434-02 Winter Tile 2
4.50 X 4.50 in.
114.30 X 114.30 mm
6,435 St.



12434-03 Winter Tile 3
4.50 X 4.50 in.
114.30 X 114.30 mm
11,978 St.



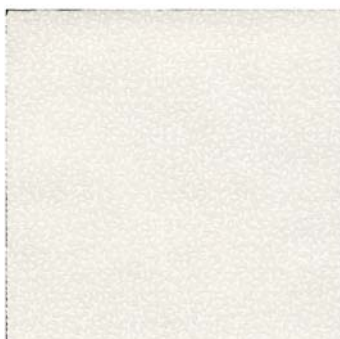
12434-04 Winter Tile 4
4.50 X 4.50 in.
114.30 X 114.30 mm
16,086 St.



12434-05 Winter Tile 5
4.50 X 4.50 in.
114.30 X 114.30 mm
9,694 St.



12434-06 Winter Tile 6
4.50 X 4.50 in.
114.30 X 114.30 mm
7,662 St.



12434-07 Winter Tile 7
4.50 X 4.50 in.
114.30 X 114.30 mm
765 St.



12434-08 Winter Tile 8
4.50 X 4.50 in.
114.30 X 114.30 mm
4,247 St.



12434-09 Winter Tile 9
4.50 X 4.50 in.
114.30 X 114.30 mm
3,080 St.



12434-10 Winter Tile 10
4.50 X 4.50 in.
114.30 X 114.30 mm
1,258 St.



12434-11 Winter Tile 11
4.50 X 4.50 in.
114.30 X 114.30 mm
7,915 St.



12434-12 Winter Tile 12
4.50 X 4.50 in.
114.30 X 114.30 mm
10,956 St.

- ⌘ Design contains a loose fill.
- ⚙ Some white areas shown are not stitched.

- L Design is larger than 5" (127 mm) in either direction.
- S Design is smaller than 1.5" (38.1 mm) in either direction.

Note: Some designs in this collection may have been created using unique special stitches and/or techniques. To preserve design integrity when rescaling or rotating designs in your software, always rescale or rotate designs using the handles directly on-screen.



12434-13 Redwork Scene

4.86 X 6.73 in.

123.44 X 170.94 mm

9,414 St. **L**

- ⌘ Design contains a loose fill.
- ⚙ Some white areas shown are not stitched.

- L** Design is larger than 5" (127 mm) in either direction.
- S** Design is smaller than 1.5" (38.1 mm) in either direction.

Listings below indicate color sample, stitching order and suggested thread color number. Most numbers indicate Isacord thread. However, colors beginning with 20501 refer to YLI Fine Metallics, 7 refer to Yenmet Metallic, 8 refer to YLI Variations Variegated Thread and 9 refer to Isacord Multicolor Variegated.

12434-01 Winter Tile 1

1. Sky Placement Stitch	0015
2. Sky Tackdown	3962
3. Background Mountain Placement Stitch	3962
4. Background Mountain Tackdown	3853
5. Letters	0015
6. Seam Stitch	0020

12434-02 Winter Tile 2

1. Sky Placement Stitch	0015
2. Sky Tackdown	3962
3. Background Mountain Placement Stitch	3962
4. Background Mountain Tackdown	3853
5. Mountain Placement Stitch	3962
6. Mountain Tackdown	0131
7. Dark Grey Mountain Shading	0132
8. Light Grey Mountain Shading	0105
9. Blue Mountain Shading	3962
10. White Mountain Shading	0015
11. Letters	0015
12. Seam Stitch	0020

12434-03 Winter Tile 3

1. Sky Placement Stitch	0015
2. Sky Tackdown	3962
3. Mountain Placement Stitch	3962
4. Mountain Tackdown	0131
5. Dark Grey Mountain Shading	0132
6. Blue Mountain Shading	3962
7. Light Grey Mountain Shading	0105
8. White Mountain Shading	0015
9. Seam Stitch	0020

12434-04 Winter Tile 4

1. Mountain Placement Stitch	0015
2. Mountain Tackdown	0015
3. Snow Placement Stitch	0015
4. Snow Tackdown	0015
5. Trees	0465
6. Trees Shading	6133
7. Building Placement Stitch	0015
8. Building Tackdown & Shading	0822
9. Windows	0520
10. Door	0842
11. Window Outlines	1565
12. Dark Roof Shading	1876
13. Light Roof Shading & Awnings	0853
14. Awning Shading	1161
15. Roof Snow Placement Stitch	3853
16. Roof Snow Tackdown & Ground Snow	0015
17. Seam Stitch	0020

12434-05 Winter Tile 5

1. Background Mountain Placement Stitch	0015
2. Background Mountain Tackdown	3853
3. Mountain Placement Stitch	3853
4. Mountain Tackdown	0131
5. Dark Grey Mountain Shading	0132
6. Light Grey Mountain Shading	0105
7. Blue Mountain Shading	3962
8. Snow Placement Stitch	0131
9. Snow Tackdown & Shading	0015
10. Coat Placement Stitch	0015
11. Coat Tackdown & Shading	0453
12. Skin	1140
13. Skin Shading	0853
14. Hat	0853
15. Skin Outlines	1161
16. Hat Outlines	1161
17. Tree	0465
18. Tree Shading	6133
19. Lips	1755
20. Seam Stitch	0020

12434-06 Winter Tile 6

1. Mountain Placement Stitch	0015
2. Mountain Tackdown	0131
3. Dark Grey Mountain Shading	0132
4. Light Grey Mountain Shading	0105
5. Blue Mountain Shading	3962
6. Snow Placement Stitch	0131
7. Snow Tackdown	0015
8. Seam Stitch	0020

12434-07 Winter Tile 7

1. Snow Placement Stitch	0015
2. Snow Tackdown	0015
3. Seam Stitch	0020

12434-08 Winter Tile 8

1. Snow Placement Stitch	0015
2. Snow Tackdown	0015
3. Pants Placement Stitch	0015
4. Pants Tackdown	0108
5. Poles	4174
6. Gloves	0853
7. Coat Placement Stitch	0015
8. Coat Tackdown & Shading	0453
9. Seam Stitch	0020

12434-09 Winter Tile 9

1. Snow Placement Stitch	0015
2. Snow Tackdown	4071
3. Pants Placement Stitch	0015
4. Pants Tackdown	0108
5. Coat Placement Stitch	0015
6. Coat Tackdown	0453
7. Pole	4174
8. Snow Splatter	0015
9. Seam Stitch	0020

12434-10 Winter Tile 10

1. Snow Placement Stitch	0015
2. Snow Tackdown	0015
3. Ski	1154
4. Seam Stitch	0020

12434-11 Winter Tile 11

1. Snow Placement Stitch	0015
2. Snow Tackdown	0015
3. Skis	1154
4. Pole	4174
5. Snow	4071
6. Boot	1876
7. Snow Splatter	0015
8. Pants Placement Stitch	0015
9. Pants Tackdown	0108
10. Seam Stitch	0020

12434-12 Winter Tile 12

1. Snow Placement Stitch	0015
2. Snow Tackdown	0015
3. Skis	1154
4. Boot	1876
5. Snow	4071
6. Snow Splatter	0015
7. Pants Placement Stitch	0015
8. Pants Tackdown	0108
9. Seam Stitch	0020

12434-13 Redwork Scene

1. Single Color Design	1904
------------------------	------

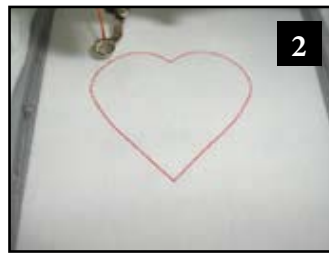
Note: Appliqué fabric not included. Some appliqué edges in this collection are covered with stitches that may not completely cover the fabric edges. This is done intentionally to create the beautiful end result.

Pre-Cut Appliqué Instructions

1. Print out the necessary pages from the PDF of the appliqué pattern(s).
2. Mark the right side of the pattern pieces so you'll know which direction to lay the pattern on the fabric.
3. Lightly spray the wrong side of the pattern pieces with temporary adhesive spray and allow it to set for a few minutes.
4. Place the pattern pieces on the right side of the fabric and carefully cut them out. **PHOTO 1**
5. Sew the placement stitch on your hooped fabric. **PHOTO 2**
6. With the paper still stuck to the right side of the appliqué fabric, spray the wrong side of the fabric with temporary spray adhesive.
7. Place the fabric inside the sewing placement stitch so that it matches the stitching line then remove the paper pattern. **PHOTO 3**
8. Sew the tackdown. **PHOTO 4**
9. Sew the remainder of the design and repeat for any remaining pieces. **PHOTO 5**

NOTE: The patterns are sized for the designs as they were made. If you resize the design, you will need to resize the pattern the same amount. You can print out the pattern at the normal size then copy it on a copy machine at the changed size, i.e. resize the designs to 80%, resize the printed pattern to 80%.

TIP: When Printing the patterns, make sure that the "Fit to page" option is **UNCHECKED** in the Print Dialog Box. If this option is checked the printed patterns will not be actual size.



A Vintage Winter Wall Hanging

Supplies:

- OESD Signature Pack #12434 A Vintage Winter
- Polyester Embroidery Thread
- Bobbin Thread
- Temporary Adhesive Spray
- Medium Weight Tear-Away Stabilizer
- 2 yards of fabric (this will include the blocks, backing and binding)
- Quilt Batting 14"x 18"
- Appliqué fabric for each piece. See the appliqué patterns included in this document for reference.

Optional:

- Stitch Witchery Fusible Bonding Web ¼" wide roll (widely available in 20yd roll)
- 3 yards satin ribbon ¼" wide

Embroidery:

1. Embroider one of each design file 12434-01 through 12434-12 for the wall hanging using two layers of medium weight tear-away stabilizer in each hooping. Be sure to use temporary adhesive spray to adhere all layers of stabilizer and fabric together for best stitch results.
2. Refer to the Pre-Cut Appliqué Instructions for directions to apply the appliqué areas.
3. The last color stop that will stitch in each of these designs is a border that is referred to on the thread chart as "Seam Stitch". This stitch is very important in the process of assembling the wall hanging. It is vital that it is not skipped when embroidering. Stitch this in the same thread color as your background fabric. *NOTE: In our sample pictures we stitched our "Seam Stitches" in black to ensure they would show in photographs.*
4. Once the embroidery process is complete, remove excess stabilizer then trim away excess fabric by cutting ½" outside the "Seam Stitch". This process is easily done using a rotary cutter and ruler. *NOTE: It may be easier to cut with the back of the block showing since the "Seam Stitch" was stitched in the same color as your background fabric.*

(Photo 01)

Construction:

1. After each block has been trimmed, lay out the pieces near your machine so that it is easy to put the blocks together. Refer to **Diagram A** (On next page).
2. Stitch the horizontal rows together by laying the first two pieces together with right sides together. Cut edges should match, but more importantly, the "Seam Stitch" on both pieces must match. Stitch the pieces together by straight stitching just to the inside of the "Seam Stitch". (Photo 02)



Photo 1



Photo 2

3. Attach the third square to the first two squares in the same fashion to complete your first row. (**Photo 03**)
4. Press seams open.
5. Referring to **Diagram A**, repeat for rows two through four.
6. When step five is complete you will have four stitched rows. (**Photo 04**)
7. Stitch the four rows together in the same manner to complete the front of the wall hanging. Make sure as you sew that your intersections line up between the rows and that the “Seam Stitch” stays matched. (**Photo 05**)
8. Cut backing fabric and batting to be at least 2 inches larger than the finished size of your project. Using temporary adhesive spray, spray the batting and adhere it to the wrong side of the backing fabric.
9. Using temporary adhesive spray, spray the batting and adhere it to the wrong side of the completed wall hanging. This will create a “quilters’ sandwich”.
10. Quilt as desired. In our sample we simply stitched in the ditch
NOTE: Steps 11-13 are optional, follow these steps if you would like to add ribbon to cover the seams of the wall hanging (this can be useful if your stitching ended up a bit crooked). If you do not want to add ribbon, simply skip to step 14 to finish the wall hanging.
11. Cover all of the seams with satin ribbon. Cut ribbon into strips approximately 1” longer than the seam you are covering. Spray one side of ribbon with temporary spray adhesive. Adhere a layer of Stitch Witchery to each ribbon strip. Be careful not to stretch the Stitch Witchery as this will cause your ribbons to draw up and not lay flat. Lay ribbon in place, making sure each is straight, and iron to permanently fuse ribbon in place. Since Stitch Witchery is permanent, stitching ribbons in place is not necessary.
12. Place ribbons in the following order:
 Place the two vertical ribbons first followed by the three horizontal ribbons.
13. Trim away any excess strips of ribbon so that the outer edges of the project are even.
14. Trim away the excess backing fabric and batting then bind the wall hanging using your favorite binding method.

Diagram A

12434-01	12434-02	12434-03
12434-04	12434-05	12434-06
12434-07	12434-08	12434-09
12434-10	12434-11	12434-12



Photo 3



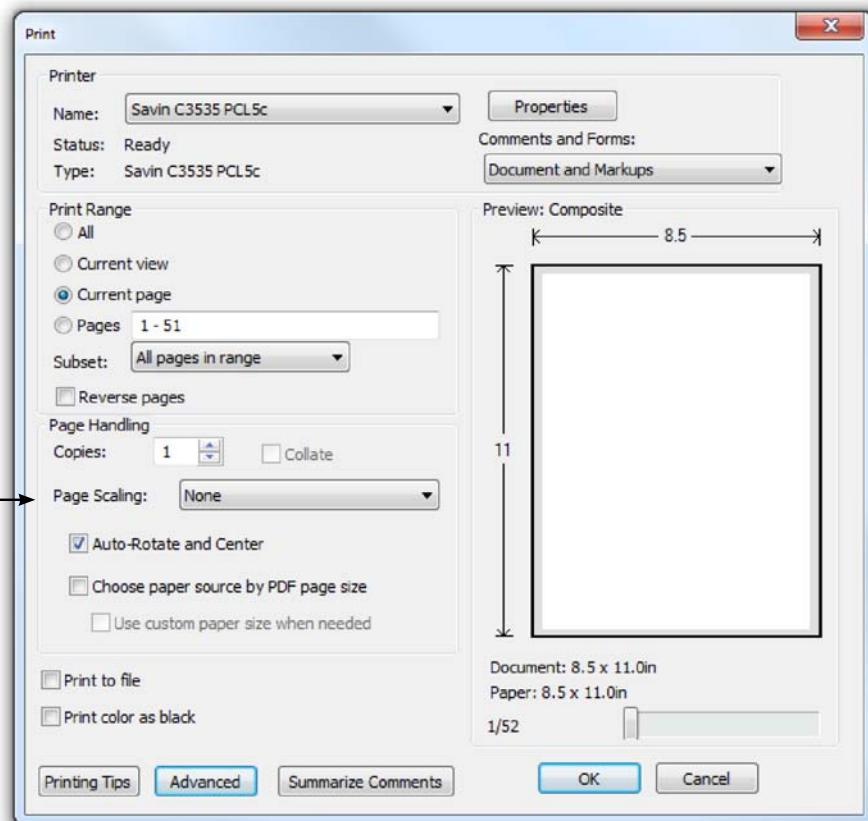
Photo 4



Photo 5

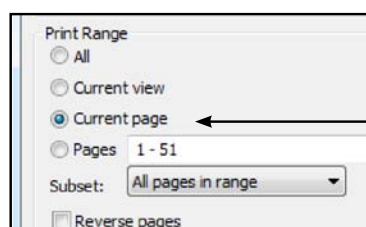
ATTENTION

When printing this document, any page scaling or page fitting options in your print dialog box must be turned OFF or set to NONE so that your files will print out at their actual size. Images not printed at actual size will not function as intended.



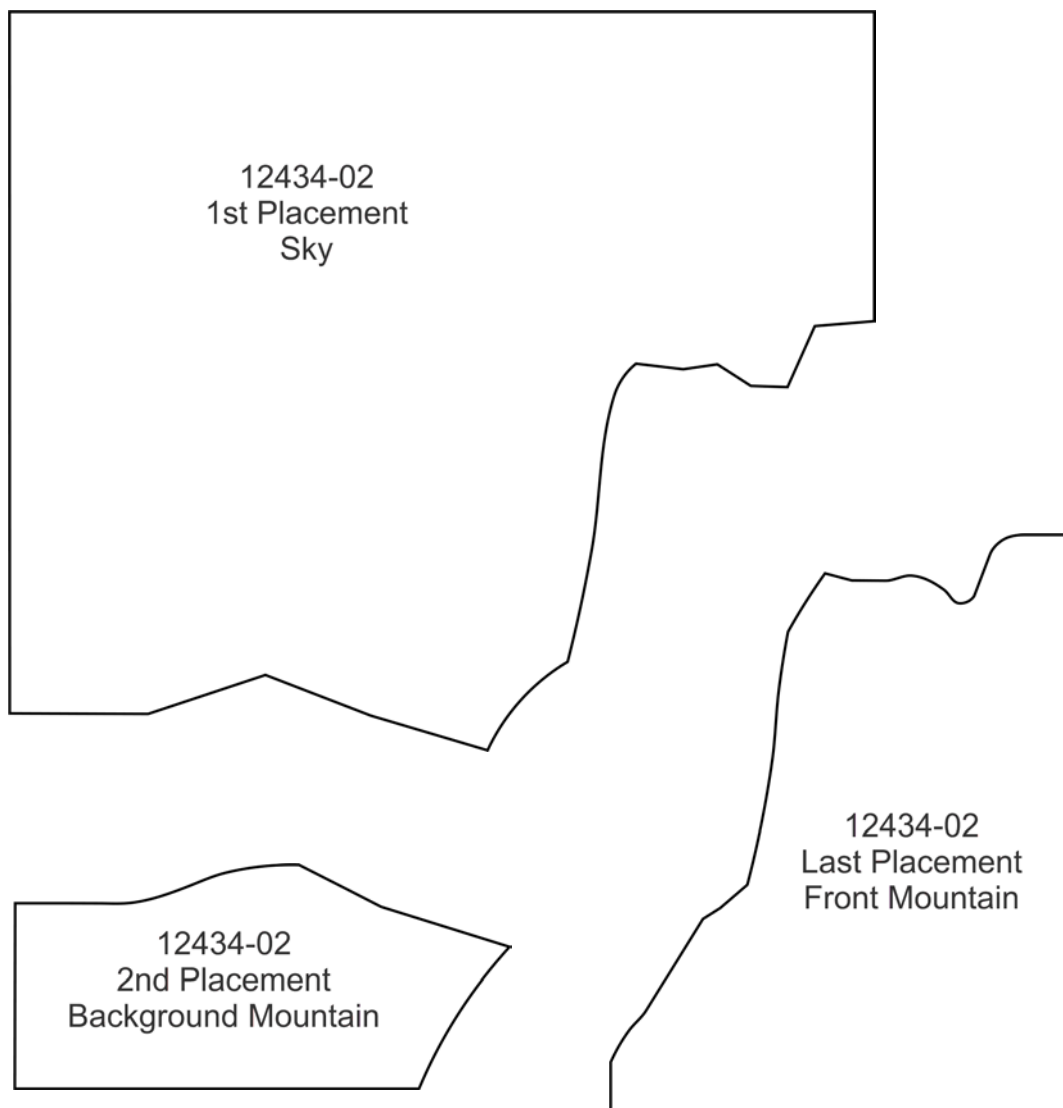
TO SAVE PAPER

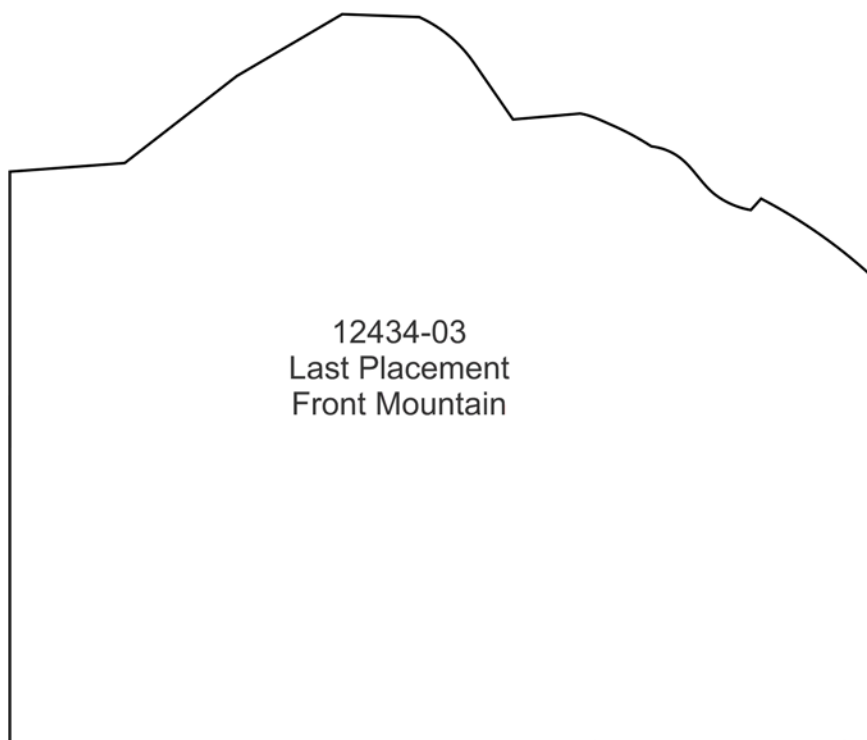
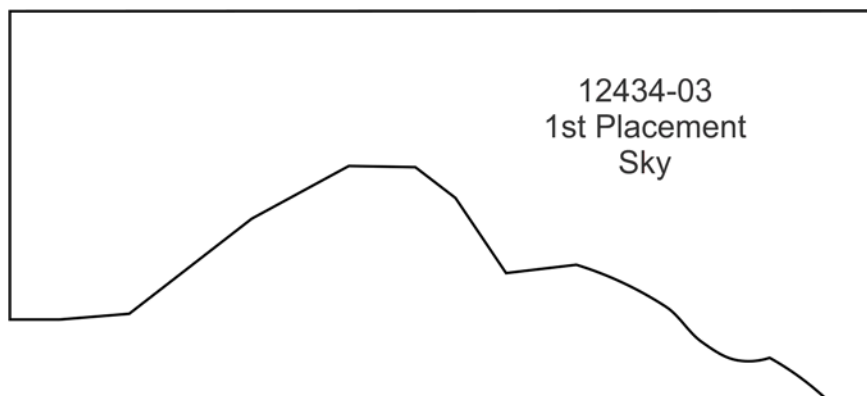
Only print the desired image by navigating to the image's page, go to File > Print and select "Current page" in the print dialog box. Repeat for each desired image.

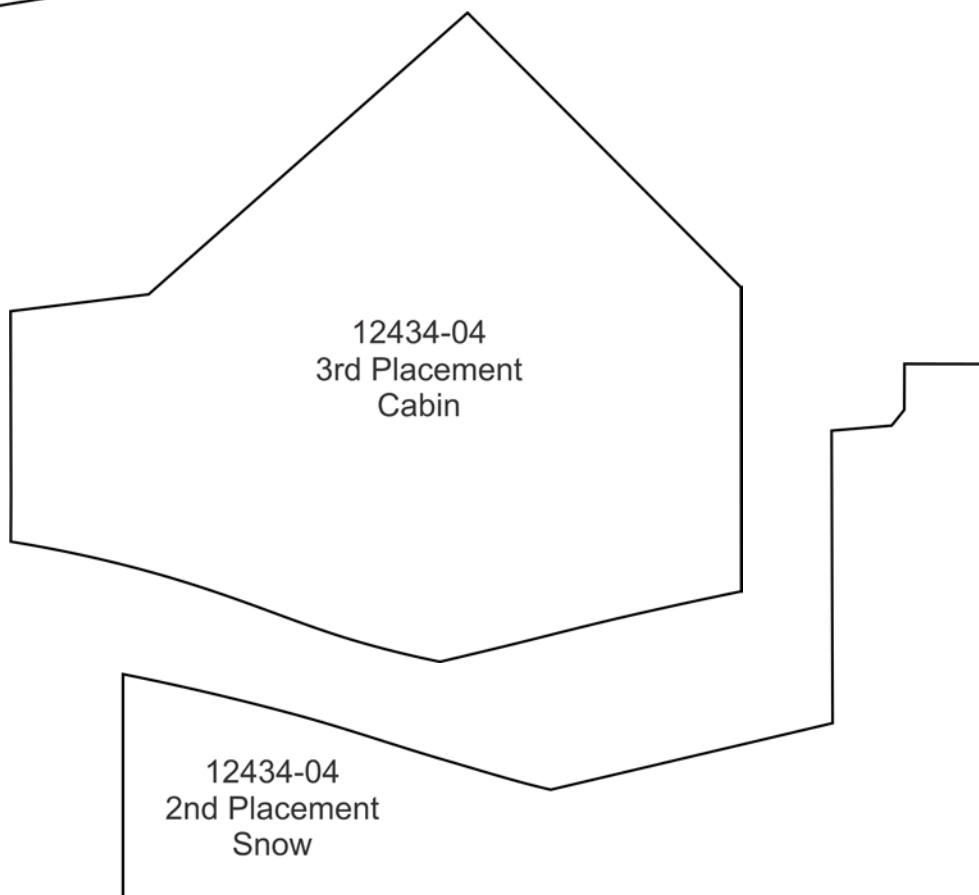
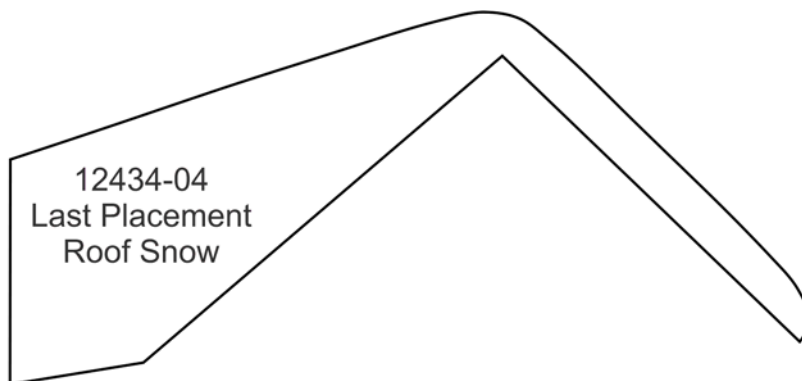
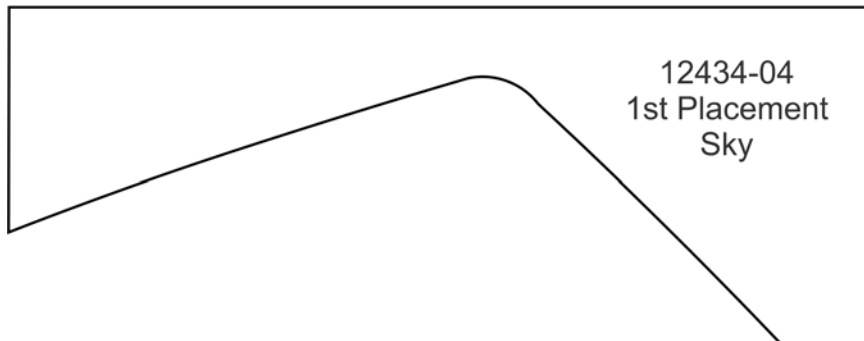


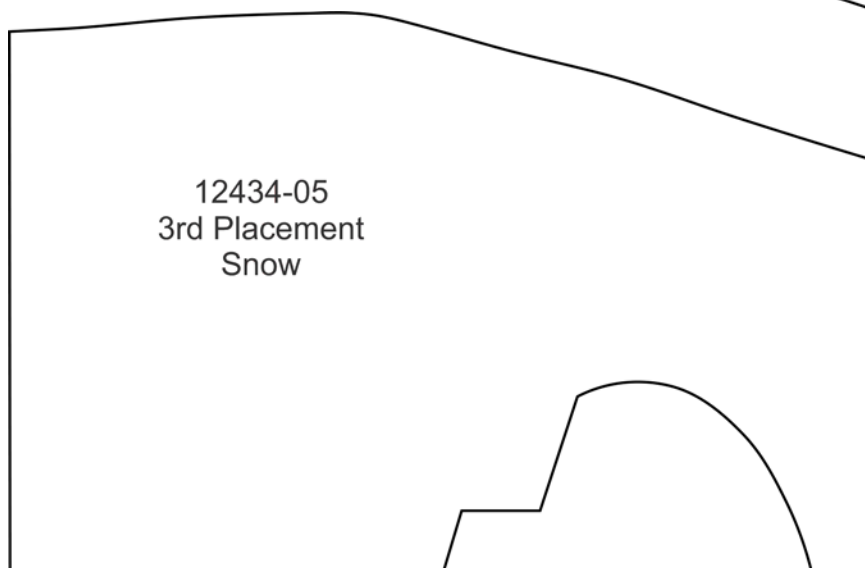
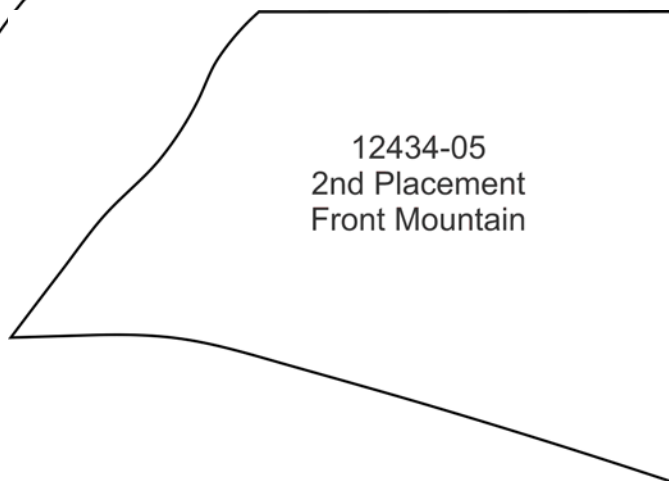
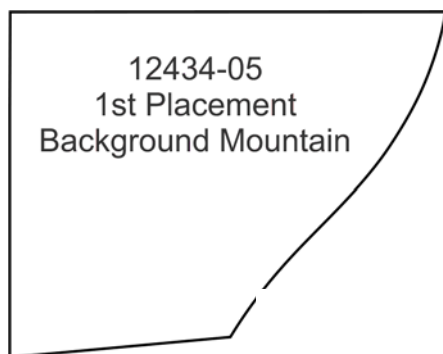
12434-01
1st Placement
Sky

12434-01
Last Placement
Background Mountain





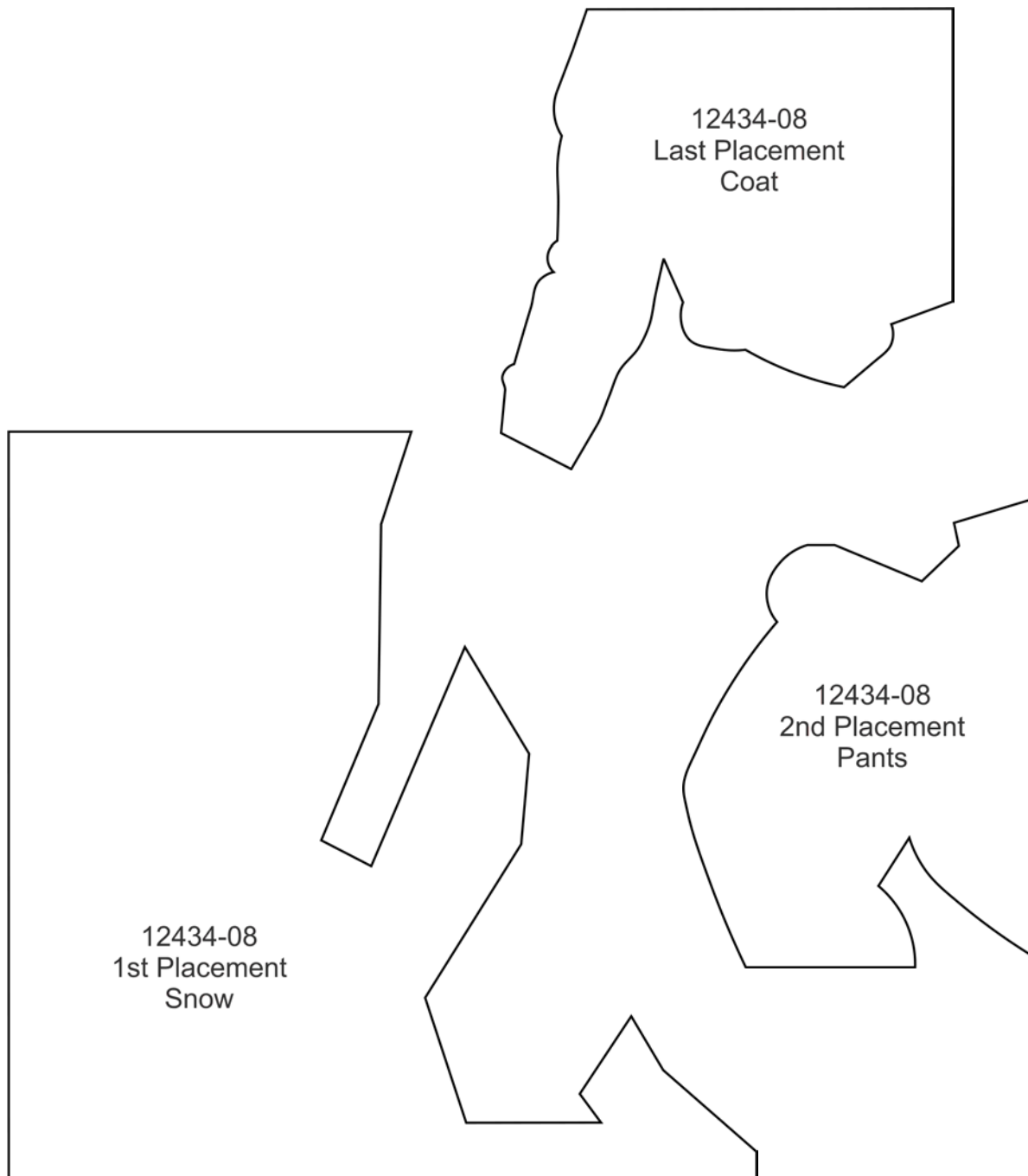




12434-06
1st Placement
Front Mountain

12434-06
Last Placement
Snow

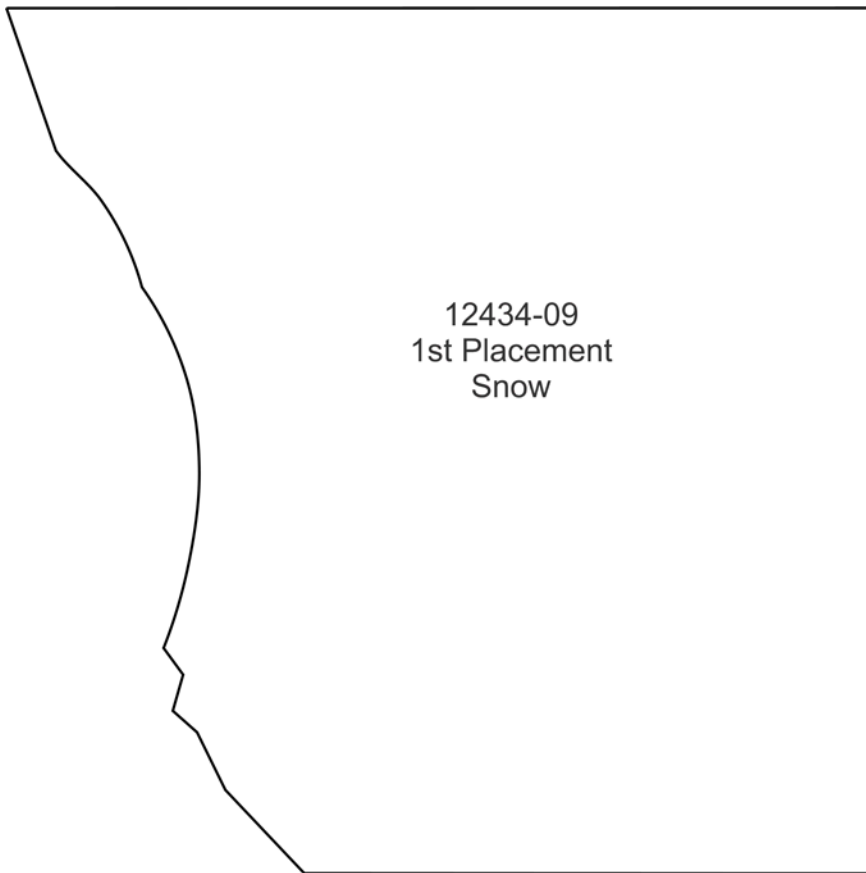
12434-07
1st Placement
Snow



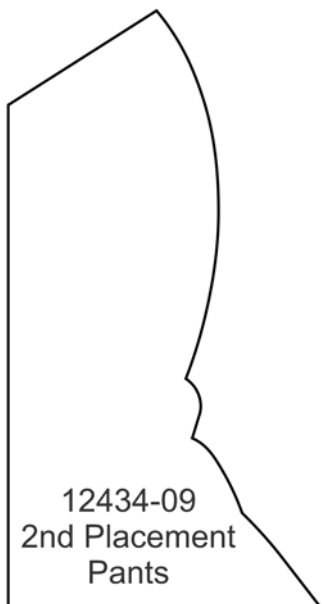
12434-09
Last Placement
Coat



12434-09
1st Placement
Snow

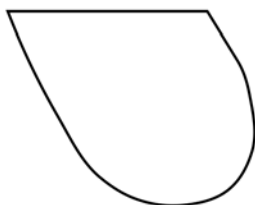


12434-09
2nd Placement
Pants

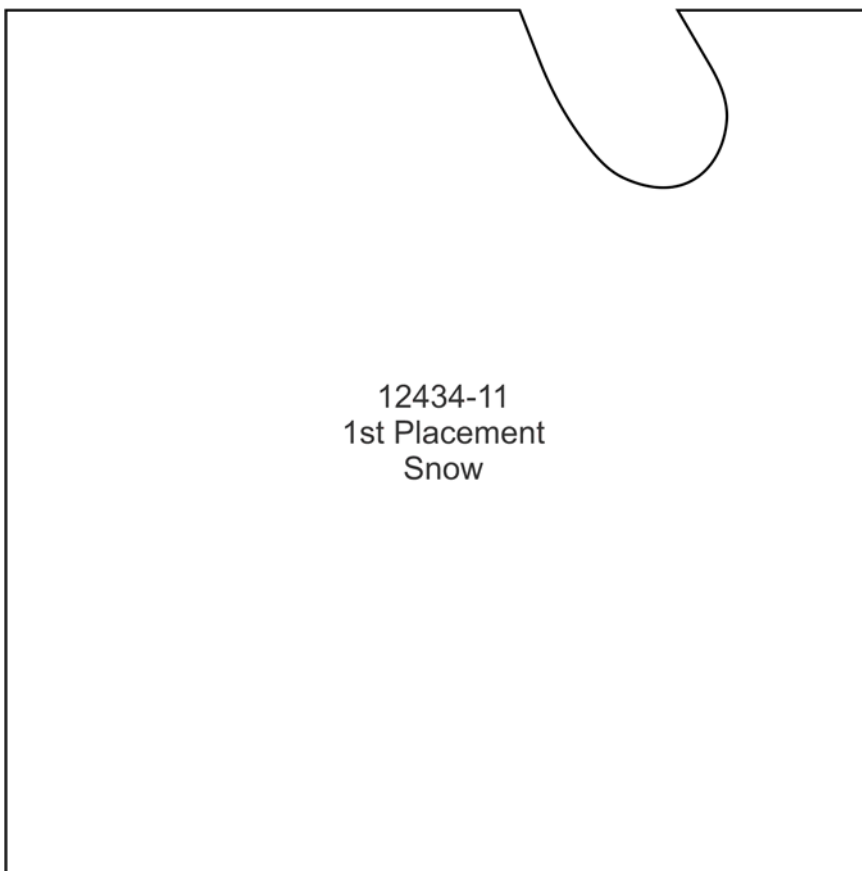


12434-10
1st Placement
Snow

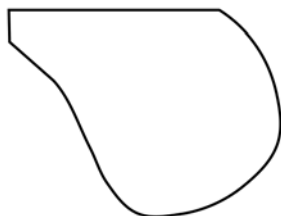
12434-11
Last Placement
Pants



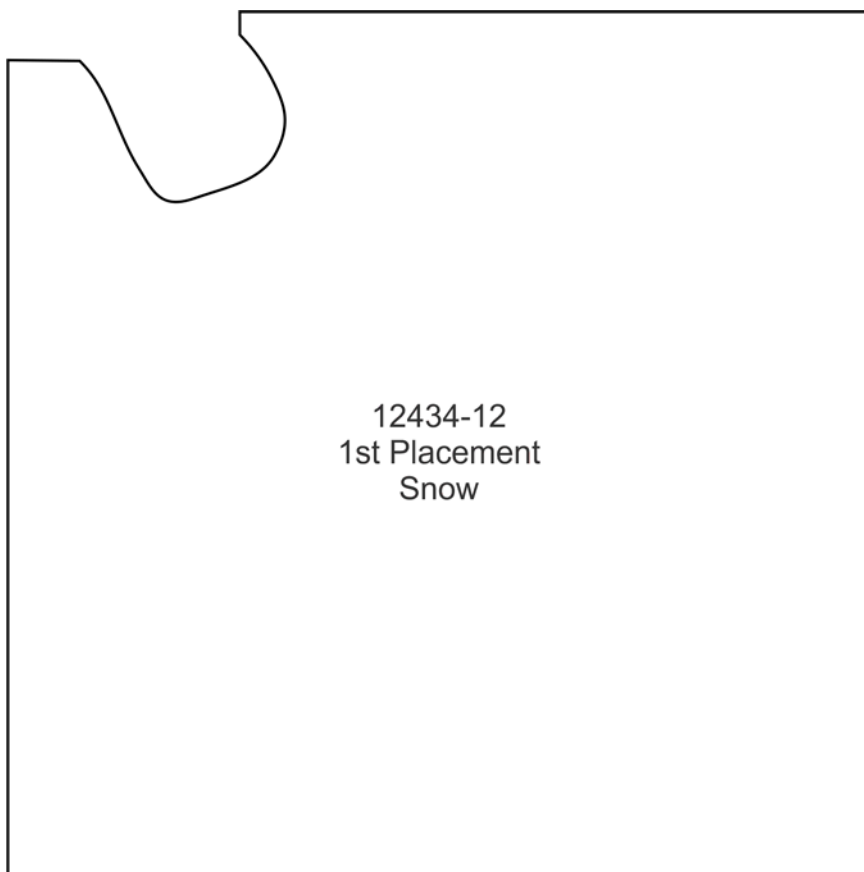
12434-11
1st Placement
Snow

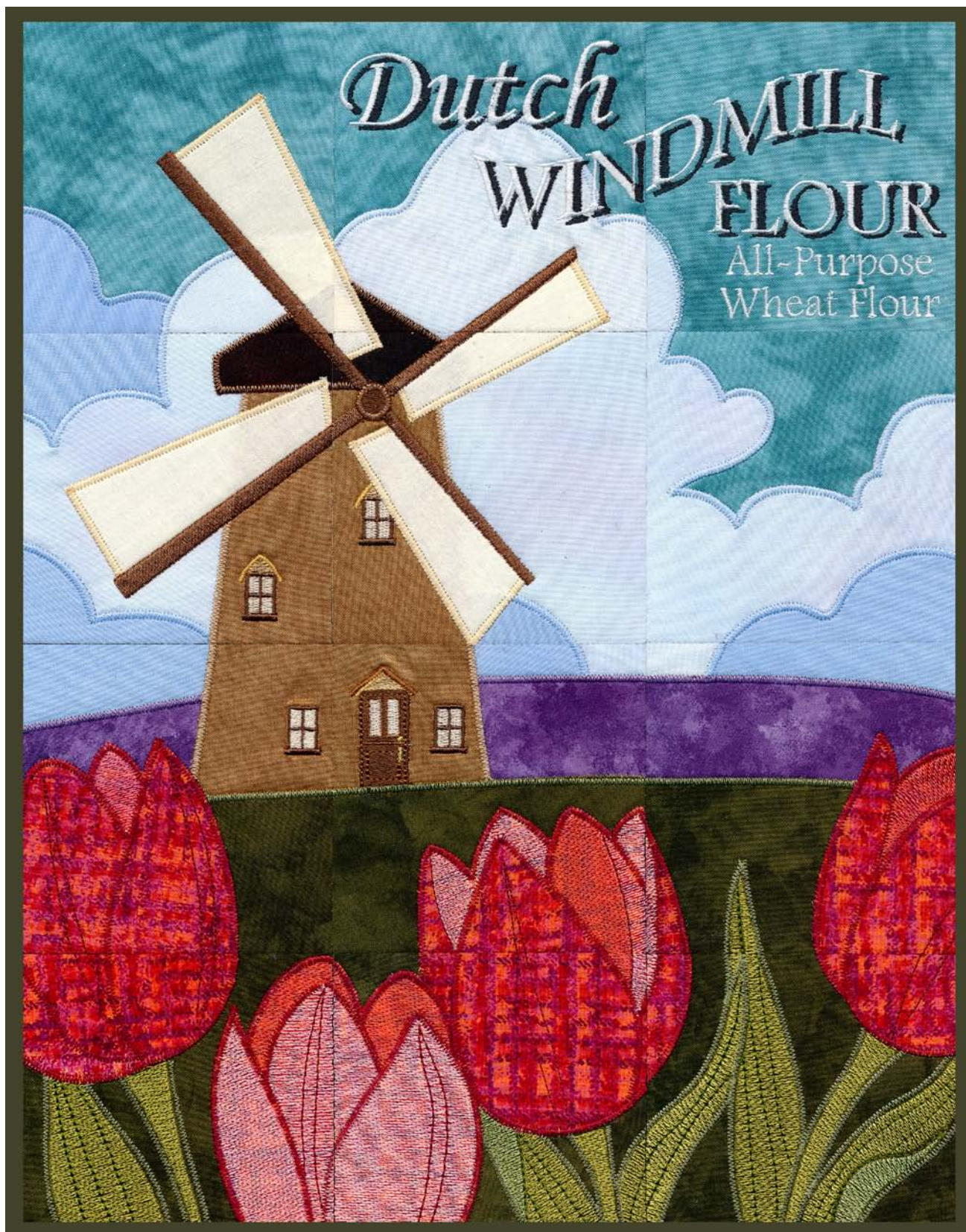


12434-12
Last Placement
Pants



12434-12
1st Placement
Snow

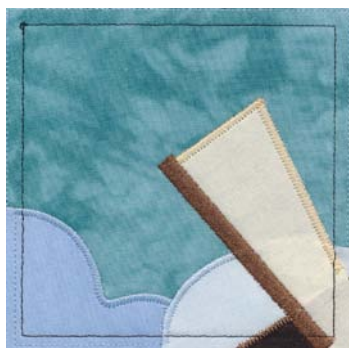




Finished size approx. 12" x 16"

It is a violation of Copyright law to make and distribute copies of software or artwork.
Software is licensed to the original purchaser for use at one location. ©2012 OESD, LLC. All rights reserved.

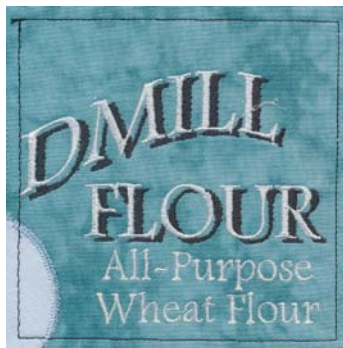
Note: Some designs in this collection may have been created using unique special stitches and/or techniques. To preserve design integrity when rescaling or rotating designs in your software, always rescale or rotate designs using the handles directly on-screen.



12377-01 Tile 1
4.52 X 4.50 in.
114.81 X 114.30 mm
3,392 St.



12377-02 Tile 2
4.50 X 4.49 in.
114.30 X 114.05 mm
10,702 St.



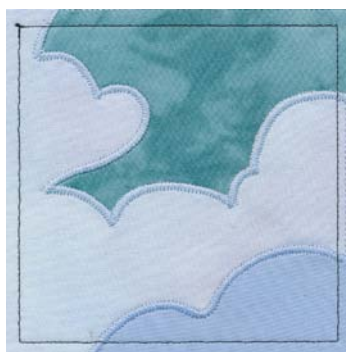
12377-03 Tile 3
4.49 X 4.50 in.
114.05 X 114.30 mm
11,645 St.



12377-04 Tile 4
4.50 X 4.50 in.
114.30 X 114.30 mm
5,205 St.



12377-05 Tile 5
4.49 X 4.50 in.
114.05 X 114.30 mm
6,058 St.



12377-06 Tile 6
4.49 X 4.49 in.
114.05 X 114.05 mm
1,794 St.



12377-07 Tile 7
4.48 X 4.49 in.
113.79 X 114.05 mm
2,901 St.



12377-08 Tile 8
4.49 X 4.49 in.
114.05 X 114.05 mm
7,276 St.



12377-09 Tile 9
4.49 X 4.49 in.
114.05 X 114.05 mm
3,622 St.



12377-10 Tile 10
4.50 X 4.50 in.
114.30 X 114.30 mm
7,698 St.



12377-11 Tile 11
4.49 X 4.49 in.
114.05 X 114.05 mm
8,656 St.



12377-12 Tile 12
4.49 X 4.49 in.
114.05 X 114.05 mm
7,919 St.

- ⌘ Design contains a loose fill.
- ⚙ Some white areas shown are not stitched.

- L Design is larger than 5" (127 mm) in either direction.
- S Design is smaller than 1.5" (38.1 mm) in either direction.



A VINTAGE SPRING

PACK 12377 • 12 DESIGNS

Listings below indicate color sample, stitching order and suggested thread color number in Isacord, YLI Fine Metallic, Yenmet or YLI Variegated threads.

12377-01 Tile 1

1. Sky Appliqué Placement Stitch	3761
2. Sky Appliqué Tackdown	3761
3. Dark Blue Cloud Appliqué Placement Stitch	3761
4. Light Blue Cloud Appliqué Placement Stitch	3761
5. Cloud Appliqués Cover Stitch	3761
6. Roof Appliqué Placement Stitch	0853
7. Roof Appliqué Cover Stitch	0853
8. Windmill Blade Appliqué Placement Stitch	0651
9. Windmill Blade Appliqué Cover Stitch	0651
10. Brown Edge on Windmill Blade	1055
11. Seam Stitch	0020

12377-02 Tile 2

1. Sky Appliqué Placement Stitch	3761
2. Sky Appliqué Tackdown	3761
3. Cloud Appliqué Placement Stitch	3761
4. Cloud Appliqué Cover Stitch	3761
5. Roof Appliqué Placement Stitch	0853
6. Roof Appliqué Cover Stitch	0853
7. Windmill Blade Appliqué Placement Stitch	0651
8. Windmill Blade Appliqué Cover Stitch	0651
9. Brown Edge on Windmill Blade	1055
10. Shadows on Lettering	4174
11. White Lettering	0015
12. Seam Stitch	0020

12377-03 Tile 3

1. Sky Appliqué Placement Stitch	3761
2. Sky Appliqué Tackdown	3761
3. Cloud Appliqué Placement Stitch	3761
4. Cloud Appliqué Cover Stitch	3761
5. Shadows on Lettering	4174
6. White Lettering	0015
7. Seam Stitch	0020

12377-04 Tile 4

1. Top Dark Cloud Appliqué Placement Stitch	3761
2. Top Dark Cloud Appliqué Tackdown	3761
3. Light Cloud Appliqué Placement Stitch	3761
4. Bottom Dark Cloud Appliqué Placement Stitch	3761
5. Clouds Appliqué Cover Stitch	3761
6. Windmill Building Appliqué Placement Stitch	1172
7. Windmill Building Appliqué Cover Stitch	1172
8. Roof Appliqué Placement Stitch	0853
9. Roof Appliqué Cover Stitch	0853
10. Windmill Blade Appliqué Placement Stitch	0651
11. Windmill Blade Appliqué Cover Stitch	0651
12. Brown Edge on Windmill Blade	1055
13. Light Yellow Inside Window	0660
14. Tan Above Window	0651
15. Window Frame	0945
16. Dark Tan Detail Above Window	0832
17. Seam Stitch	0020

12377-05 Tile 5

1. Light Cloud Appliqué Placement Stitch	3761
2. Light Cloud Appliqué Tackdown	3761
3. Dark Cloud Appliqué Placement Stitch	3761
4. Dark Cloud Appliqué Cover Stitch	3761
5. Windmill Building Appliqué Placement Stitch	1172
6. Windmill Building Appliqué Tackdown	1172
7. Windmill Building Appliqué Cover Stitch	1172
8. Light Yellow Inside Window	0660
9. Tan Above Window	0651
10. Brown Line Details	0722
11. Window Frame	0945
12. Dark Tan Detail Above Window	0832
13. Roof Appliqué Placement Stitch	0945
14. Center of Windmill Blades	0945
15. Roof Appliqué Cover Stitch	0853
16. Windmill Blades Appliqué Placement Stitch	0651
17. Windmill Blades Appliqué Cover Stitch	0651
18. Brown Edges on Windmill Blades	1055
19. Seam Stitch	0020

12377-06 Tile 6

1. Sky Appliqué Placement Stitch	3761
2. Sky Appliqué Tackdown	3761
3. Light Cloud Appliqué Placement Stitch	3761
4. Dark Cloud Appliqué Placement Stitch	3761
5. Clouds Cover Stitch	3761
6. Seam Stitch	0020

12377-07 Tile 7

1. Dark Cloud Appliqué Placement Stitch	3251
2. Purple Background Appliqué Placement Stitch	3251
3. Purple Background Appliqué Cover Stitch	3251
4. Windmill Building Appliqué Placement Stitch	1172
5. Windmill Building Appliqué Cover Stitch	1172
6. Ground Appliqué Placement Stitch	0453
7. Ground Appliqué Cover Stitch	0453
8. Light Yellow Inside Window	0660
9. Window Frame	0945
10. Flower Appliqué Placement Stitch	2022
11. Light Pink Petal Highlights	1840
12. Flower Appliqué Cover Stitch	2022
13. Seam Stitch	0020

12377-08 Tile 8

1. Light Cloud Appliqué Placement Stitch	3761
2. Dark Cloud Appliqué Placement Stitch	3761
3. Clouds Appliqué Cover Stitch	3761
4. Purple Background Appliqué Placement Stitch	3251
5. Purple Background Appliqué Cover Stitch	3251
6. Windmill Building Appliqué Placement Stitch	1172
7. Windmill Building Appliqué Tackdown	1172
8. Windmill Building Cover Stitch	1172
9. Tan Above Door	0651
10. Dark Tan Above Door	0832
11. Light Yellow Inside Window and Door	0660
12. Window Frame and Door	0945
13. Door Details	1154
14. Door Knob	0552
15. Ground Appliqué Placement Stitch	0453
16. Ground Appliqué Cover Stitch	0453
17. Flower Appliqué Placement Stitch	1860
18. Flower Highlights	1860
19. Flower Shading	1521
20. Flower Appliqué Cover Stitch	2022
21. Seam Stitch	0020

12377-09 Tile 9

1. Light Cloud Appliqué Placement Stitch	3761
2. Dark Cloud Appliqué Placement Stitch	3761
3. Clouds Appliqué Cover Stitch	3761
4. Purple Background Appliqué Placement Stitch	3251
5. Purple Background Appliqué Cover Stitch	3251
6. Ground Appliqué Placement Stitch	0232
7. Medium Green Leaf Shade	0232
8. Dark Green Leaf Lines	5933
9. Ground Appliqué Cover Stitch & Leaf Border	0453
10. Flower Appliqué Placement Stitch	1521
11. Flower Shading	1521
12. Flower Highlights	1860
13. Flower Appliqué Cover Stitch	2022
14. Seam Stitch	0020

12377-10 Tile 10

1. Ground Appliqué Placement Stitch	0232
2. Ground Appliqué Tackdown	0232
3. Medium Green Leaf & Stem Shade	0232
4. Dark Green Leaf Lines	5933
5. Leaf & Stem Outlines	0453
6. Flower Appliqué Placement Stitch	2022
7. Flower Highlights	1860
8. Flower Shading	1521
9. Flower Appliqué Cover Stitch & Linework	2022
10. Seam Stitch	0020

Listings below indicate color sample, stitching order and suggested thread color number in Isacord, YLI Fine Metallic, Yenmet or YLI Variegated threads.

12377-11 Tile 11

1.	Ground Appliqué Placement Stitch6141
2.	Light Green Leaf Shade6141
3.	Medium Green Leaf & Stem Shade0232
4.	Dark Green Leaf Lines5933
5.	Leaf & Stem Borders0453
6.	Flower Appliqué Placement Stitch1521
7.	Flower Appliqué Tackdown1521
8.	Flower Shading1521
9.	Flower Highlights1860
10.	Flower Appliqué Cover Stitch2022
11.	Seam Stitch0020

12377-12 Tile 12

1.	Ground Appliqué Placement Stitch0232
2.	Ground Appliqué Tackdown0232
3.	Green Leaf Shading0232
4.	Light Green Leaf Shading6141
5.	Dark Green Leaf Lines5933
6.	Leaf Outlines0453
7.	Flower Appliqué Placement Stitch1860
8.	Flower Highlights1860
9.	Flower Appliqué Cover Stitch & Linework2022
10.	Seam Stitch0020

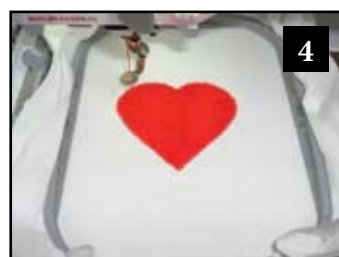
NOTE: Appliqué fabric not included.

Appliqué Instructions

1. Print out the necessary pages from the PDF of the appliqué pattern(s).
2. Mark the right side of the pattern pieces so you'll know which direction to lay the pattern on the fabric.
3. Lightly spray the wrong side of the pattern pieces with temporary adhesive spray and allow it to set for a few minutes.
4. Place the pattern pieces on the right side of the fabric and carefully cut them out. **PHOTO 1**
5. Sew the placement stitch on your hooped fabric. **PHOTO 2**
6. With the paper still stuck to the right side of the appliqué fabric, spray the wrong side of the fabric with temporary spray adhesive.
7. Place the fabric inside the sewing placement stitch so that it matches the stitching line then remove the paper pattern. **PHOTO 3**
8. Sew the tackdown. **PHOTO 4**
9. Sew the remainder of the design and repeat for any remaining pieces. **PHOTO 5**

NOTE: The patterns are sized for the designs as they were made. If you resize the design, you will need to resize the pattern the same amount. You can print out the pattern at the normal size then copy it on a copy machine at the changed size, i.e. resize the designs to 80%, resize the printed pattern to 80%.

TIP: When Printing the patterns, make sure that the "Fit to page" option is UNCHECKED in the Print Dialog Box. If this option is checked the printed patterns will not be actual size.



A Vintage Spring Wall Hanging

Supplies:

- OESD Signature Pack #12377 A Vintage Spring
- Polyester Embroidery Thread
- Bobbin Thread
- Temporary Spray Adhesive
- Medium Weight Tear-Away Stabilizer
- 2 yards of fabric (this will include the blocks, backing and binding)
- Quilt Batting 12"x 20"

Optional:

- Stitch Witchery Fusible Bonding Web 1/4" wide roll (widely available in 20yd roll)
- 3 yards satin ribbon 1/4" wide

Embroidery:

1. Embroider one of each design file 12377-01 through 12377-12 for the wall hanging using two layers of Medium Weight Tear-Away stabilizer in each hooping. Be sure to use temporary spray adhesive to adhere all layers of stabilizer and fabric together for best stitch results.
2. Refer to the Pre-Cut Applique Instructions for directions to apply the applique areas.
3. The last thing that will stitch in each of these designs is a border that is referred to on the thread chart as "Seam Stitch". This stitch is very important in the process assembling the wall hanging. It is vital that it is not skipped when embroidering. Stitch this in the same thread color as your background fabric. **NOTE:** *In our sample pictures we stitched our "Seam Stitch" in black to ensure they would show in photographs.*
4. Once the embroidery process is complete, remove excess stabilizer then trim away excess fabric by cutting 1/2" outside the "Seam Stitch". This process is easily done using a rotary cutter and ruler. **NOTE:** *It may be easier to cut with the back of the block showing since the "Seam Stitch" was stitched in the same color as your background fabric. (Photo 01)*

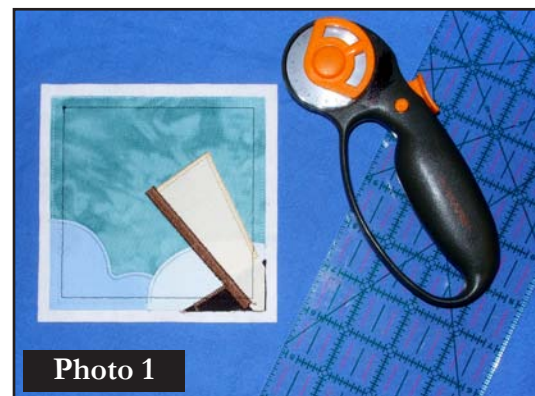
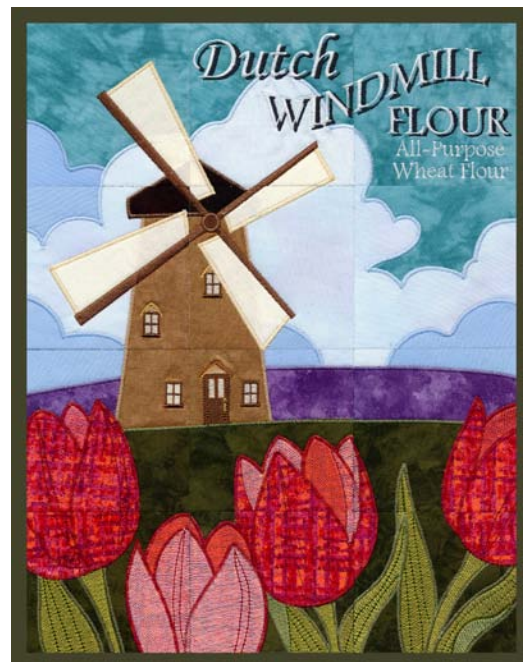


Photo 1

Construction:

1. After each block has been trimmed, lay out the pieces near your machine so that it is easy to put the blocks together. Refer to **Diagram A (On next page)**.
2. Stitch the horizontal rows together by laying the first two pieces together with right sides matching. Cut edges should match but more importantly, the "Seam Stitch" on both pieces must match. Stitch the pieces together by straight stitching just to the inside of the "Seam Stitch". **(Photo 02)**



Photo 2

3. Attach the third square to the first two squares in the same fashion to complete your first row. (**Photo 03**)
4. Press seams open.
5. Referring to diagram A, repeat for rows two through four.
6. When step five is complete you will have four stitched rows. (**Photo 04**)
7. Stitch the four rows together in the same manner to complete the front of the wall hanging. Make sure as you sew that your intersections line up between the rows and that the "Seam Stitch" stays matched. (**Photo 05**)
8. Cut backing fabric and batting to be at least 2 inches larger than the finished size of your project. Using temporary spray adhesive, spray the batting and adhere it to the wrong side of the backing fabric.
9. Using temporary spray adhesive, spray the batting and adhere it to the wrong side of the completed wall hanging. This will create a "quilters' sandwich".
10. Quilt as desired. In our sample we simply stitched in the ditch. ***NOTE:** steps 11-13 are optional, follow these steps if you would like to add ribbon to cover the seams of the wall hanging (this can be useful if your stitching ended up a bit crooked). If you do not want to add ribbon, simply skip to step 14 to finish the wall hanging.*
11. Cover all of the seams with satin ribbon. Cut ribbon into strips approximately 1" longer than the seam you are covering. Spray one side of ribbon with temporary spray adhesive. Adhere a layer of Stitch Witchery to each ribbon strip. Be careful not to stretch the Stitch Witchery as this will cause your ribbons to draw up and tend to not want to lay flat. Lay ribbon in place, making sure each is straight, and iron to permanently fuse ribbon in place. Since Stitch Witchery is permanent, stitching ribbons in place is not necessary.
12. Place ribbons in the following order:
Place the two vertical ribbons first followed by the three horizontal ribbons.
13. Trim away any excess strips of ribbon so that the outer edges of the project are even.
14. Trim away the excess backing fabric and batting then bind the wall hanging using your favorite binding method.

Diagram A

12377-01	12377-02	12377-03
12377-04	12377-05	12377-06
12377-07	12377-08	12377-09
12377-10	12377-11	12377-12



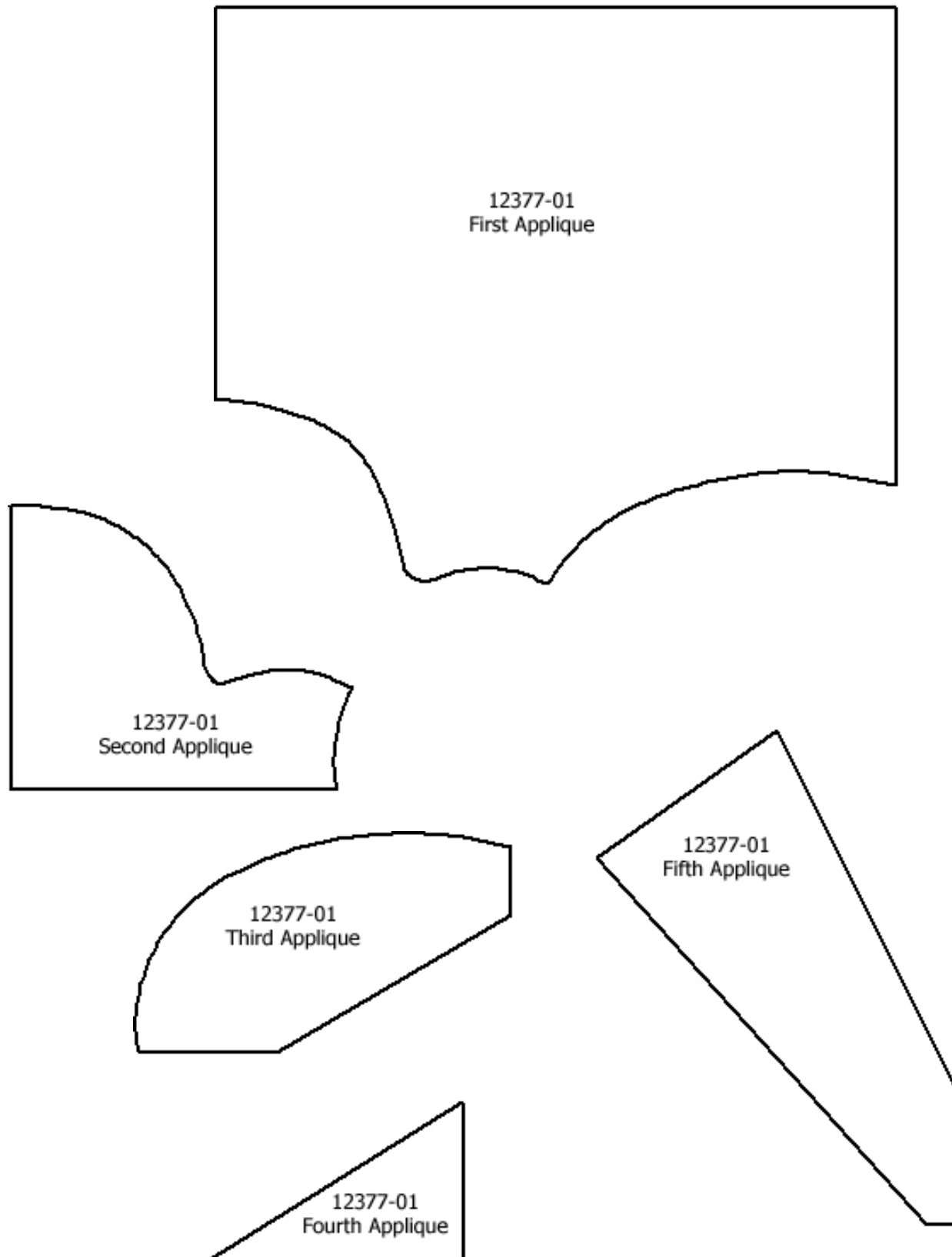
Photo 3

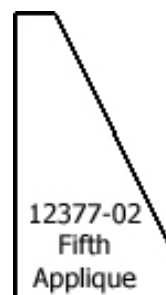
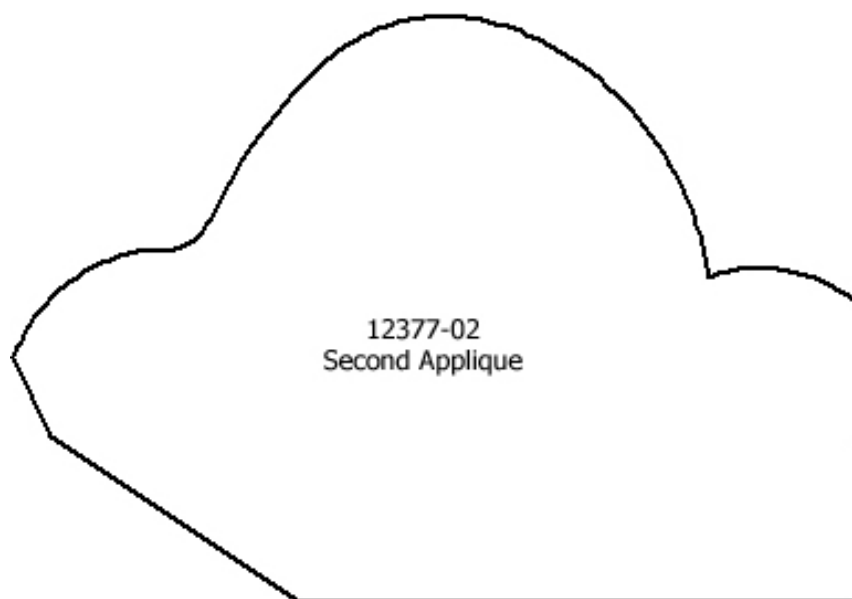
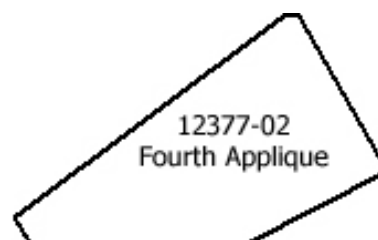
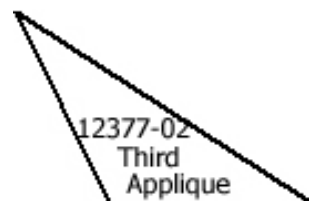
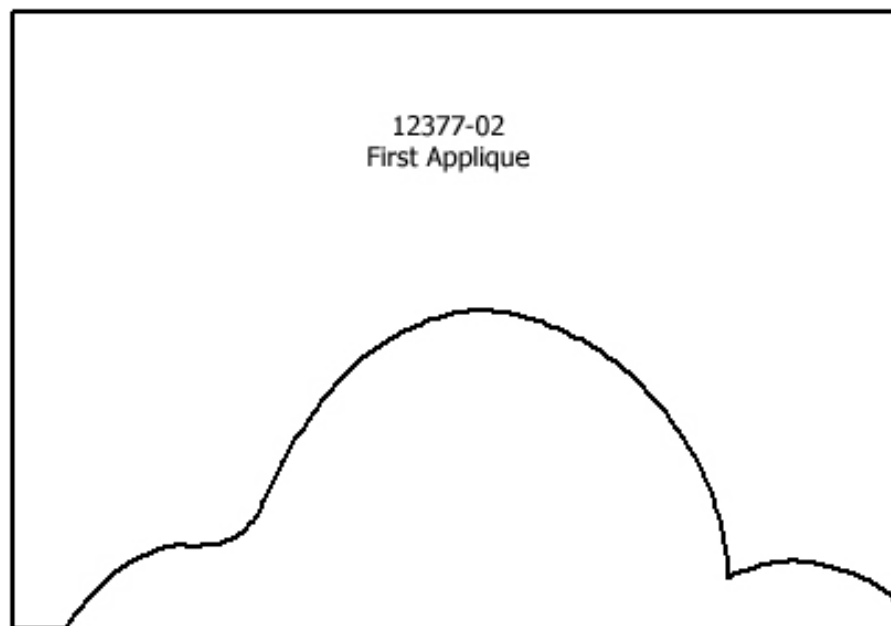


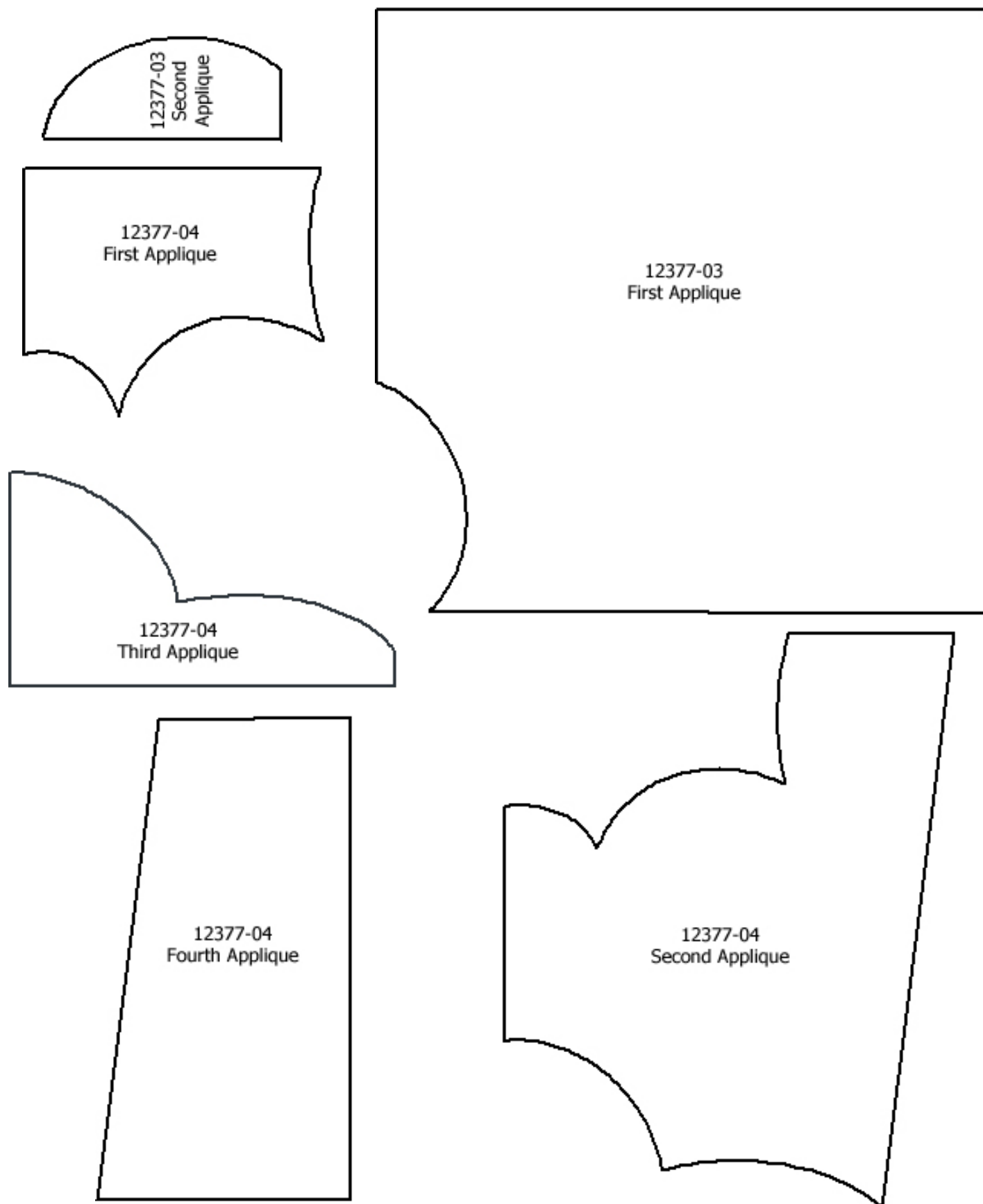
Photo 4

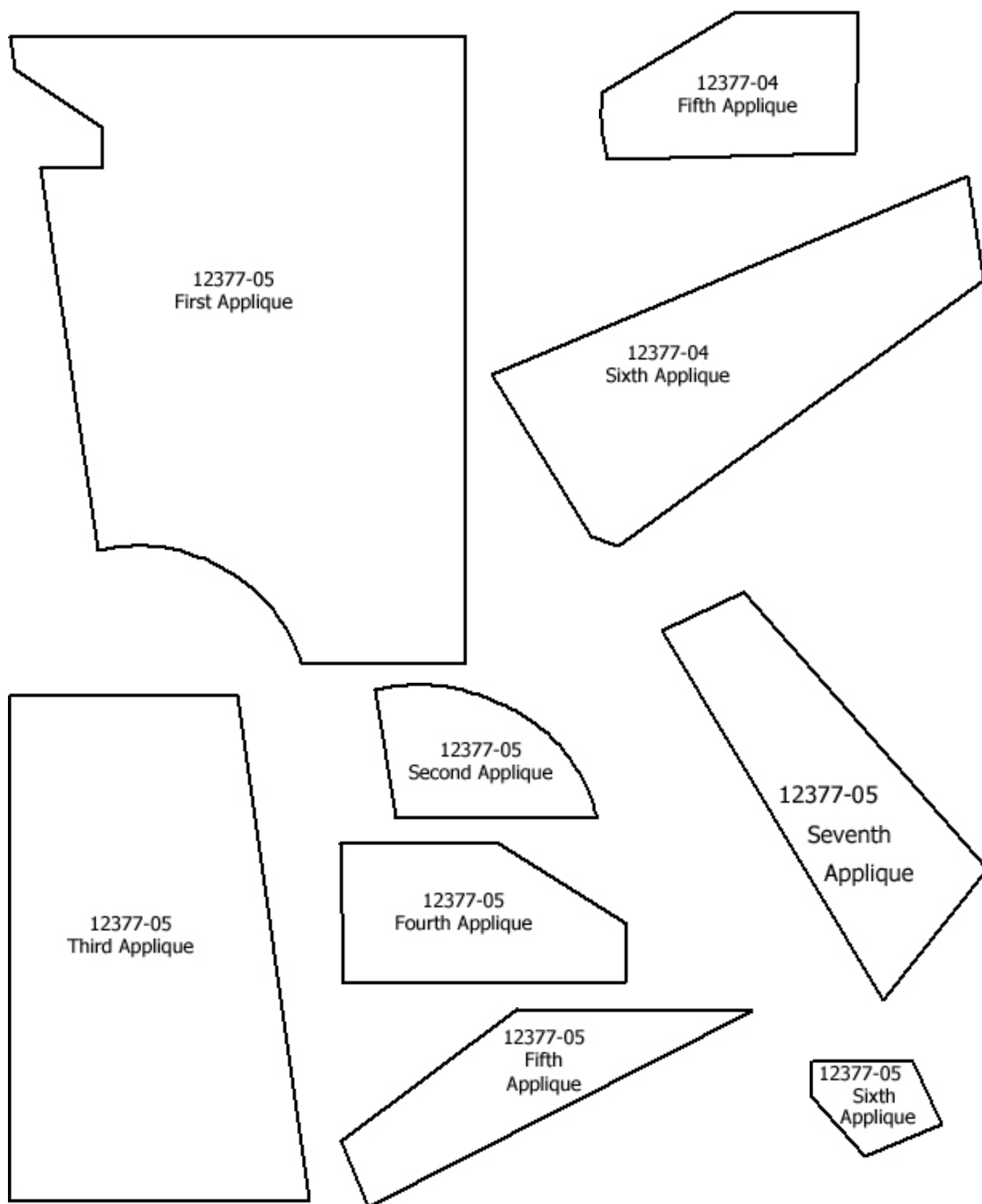


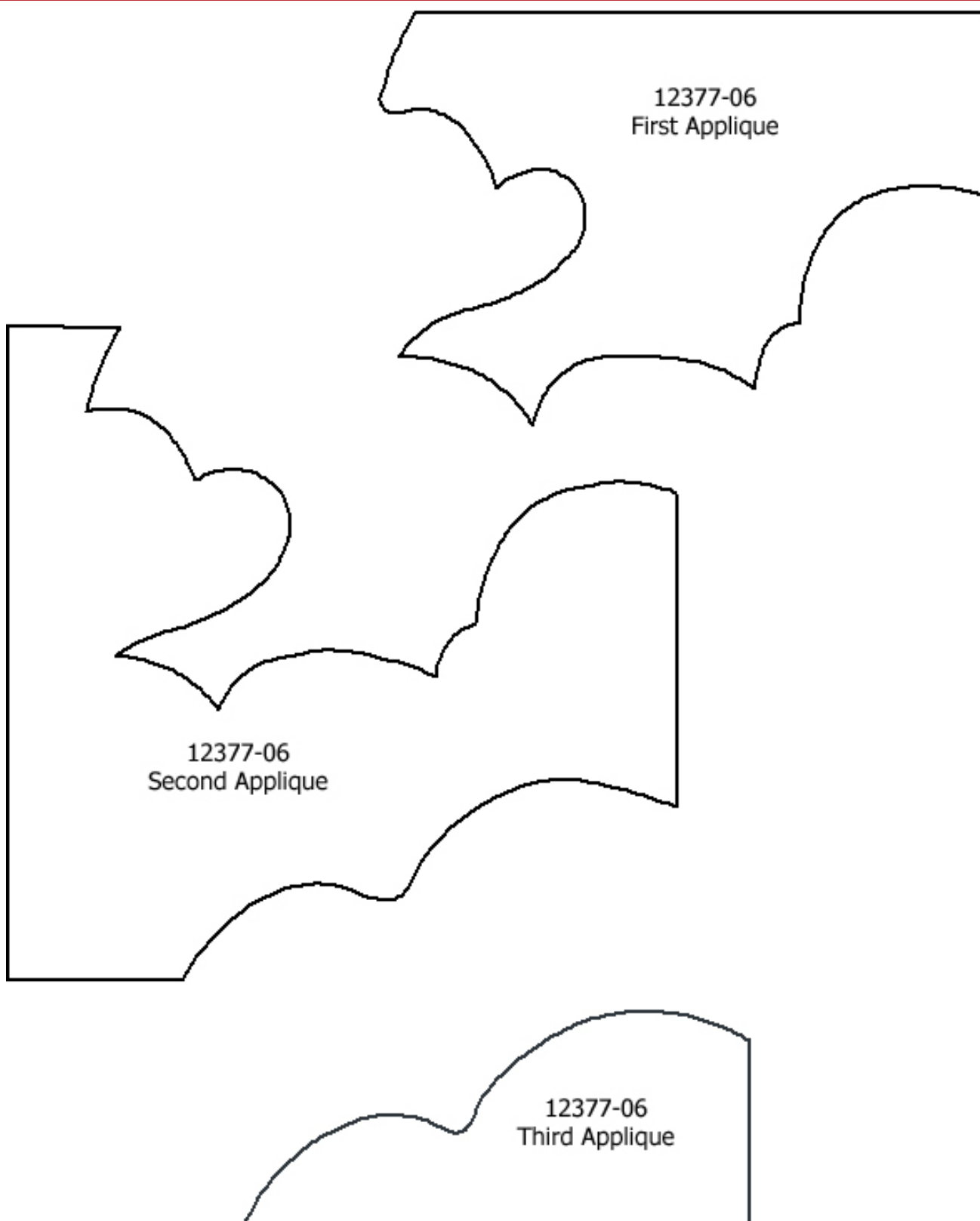
Photo 5

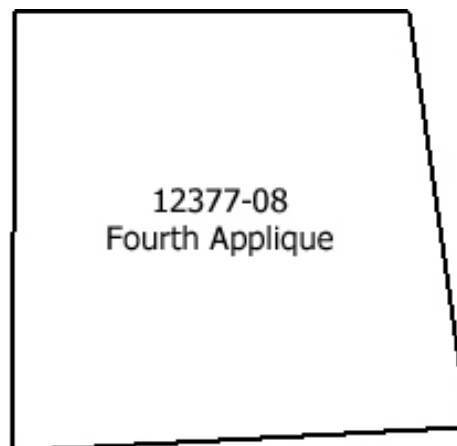
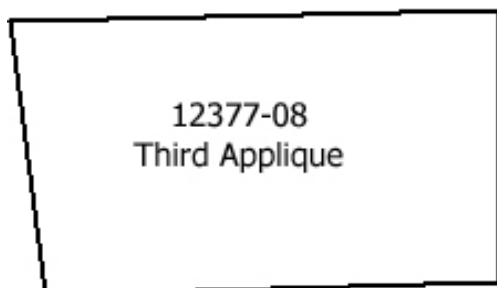
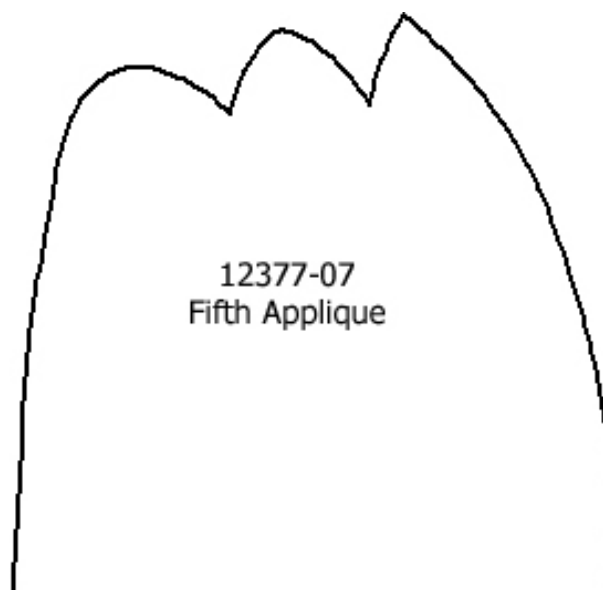
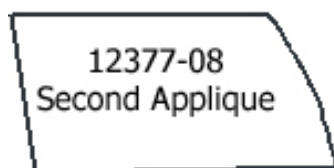
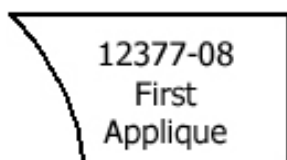
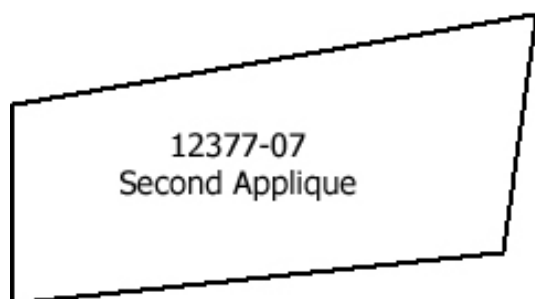
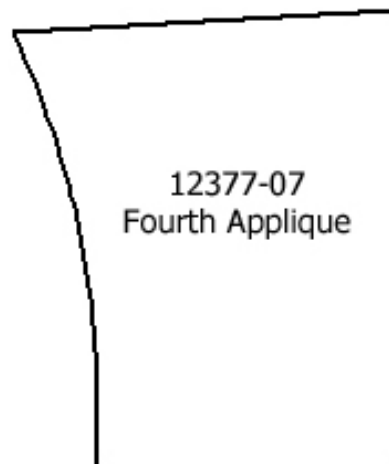
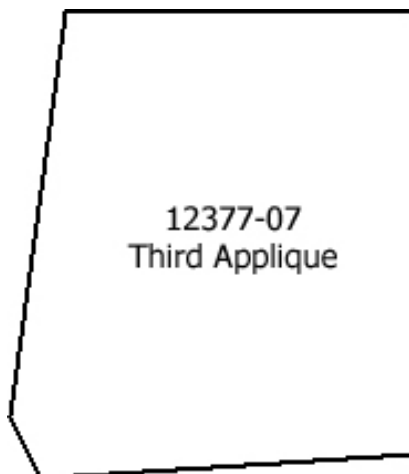
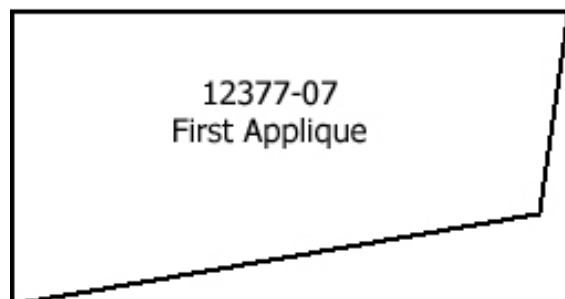


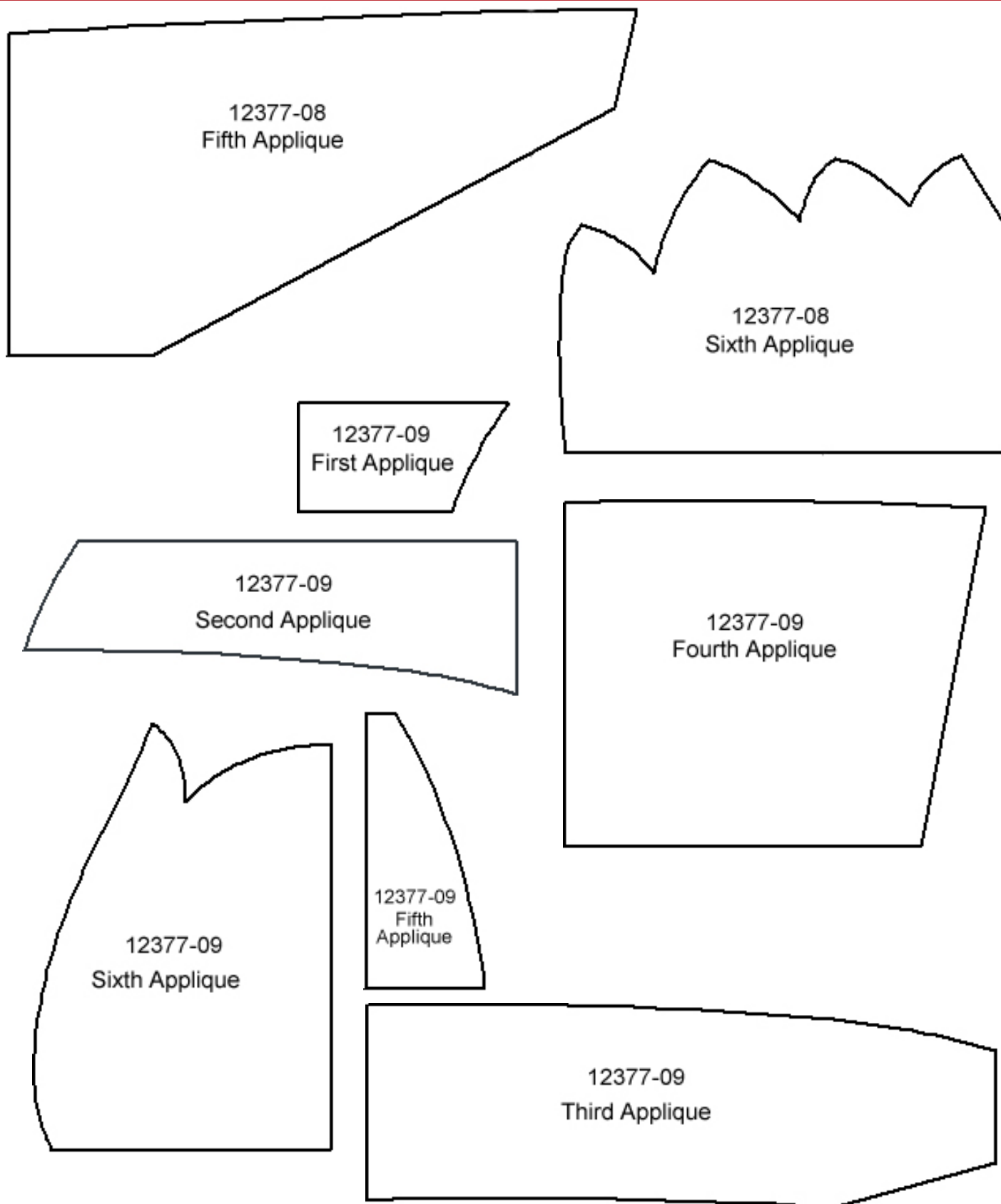


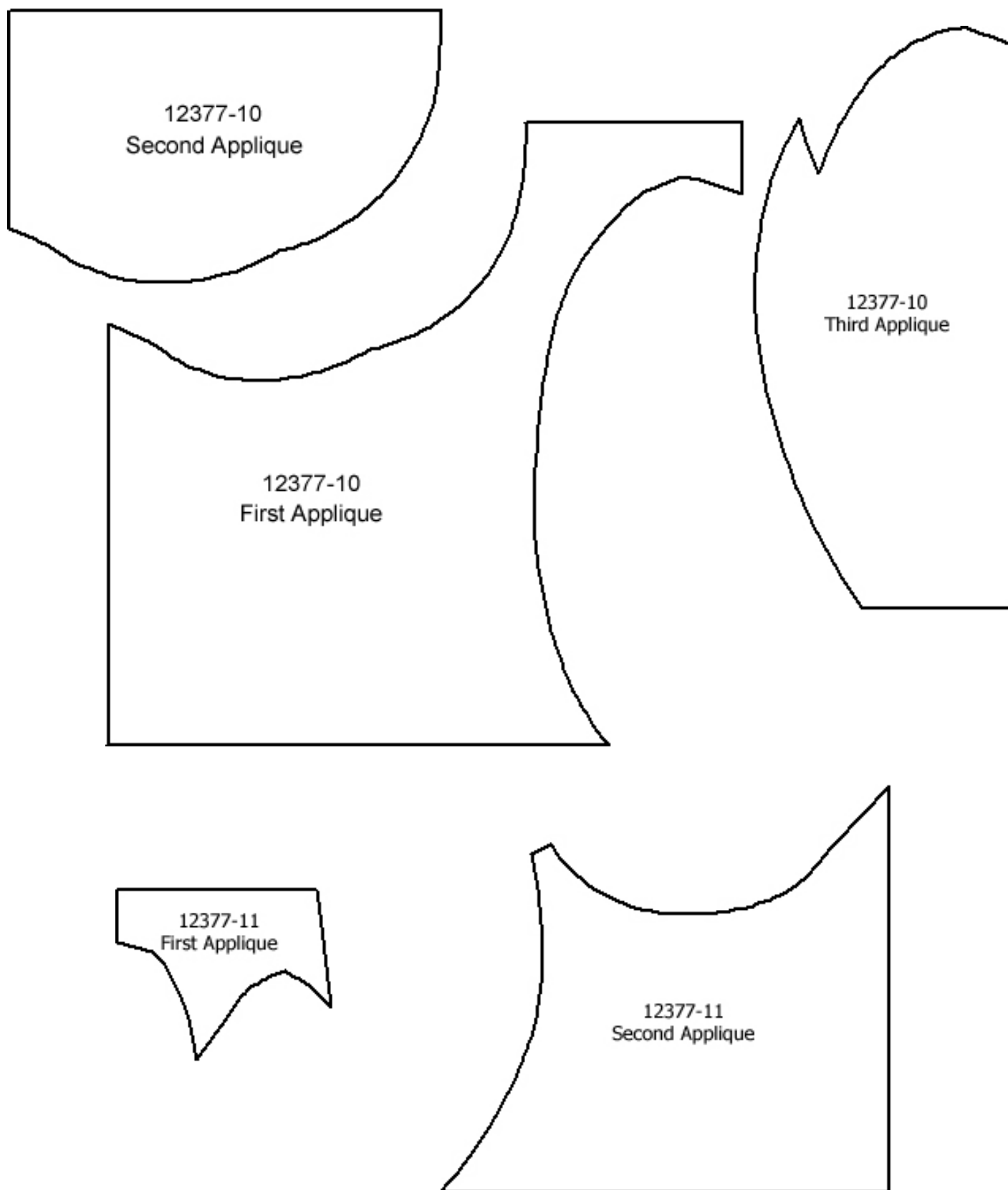


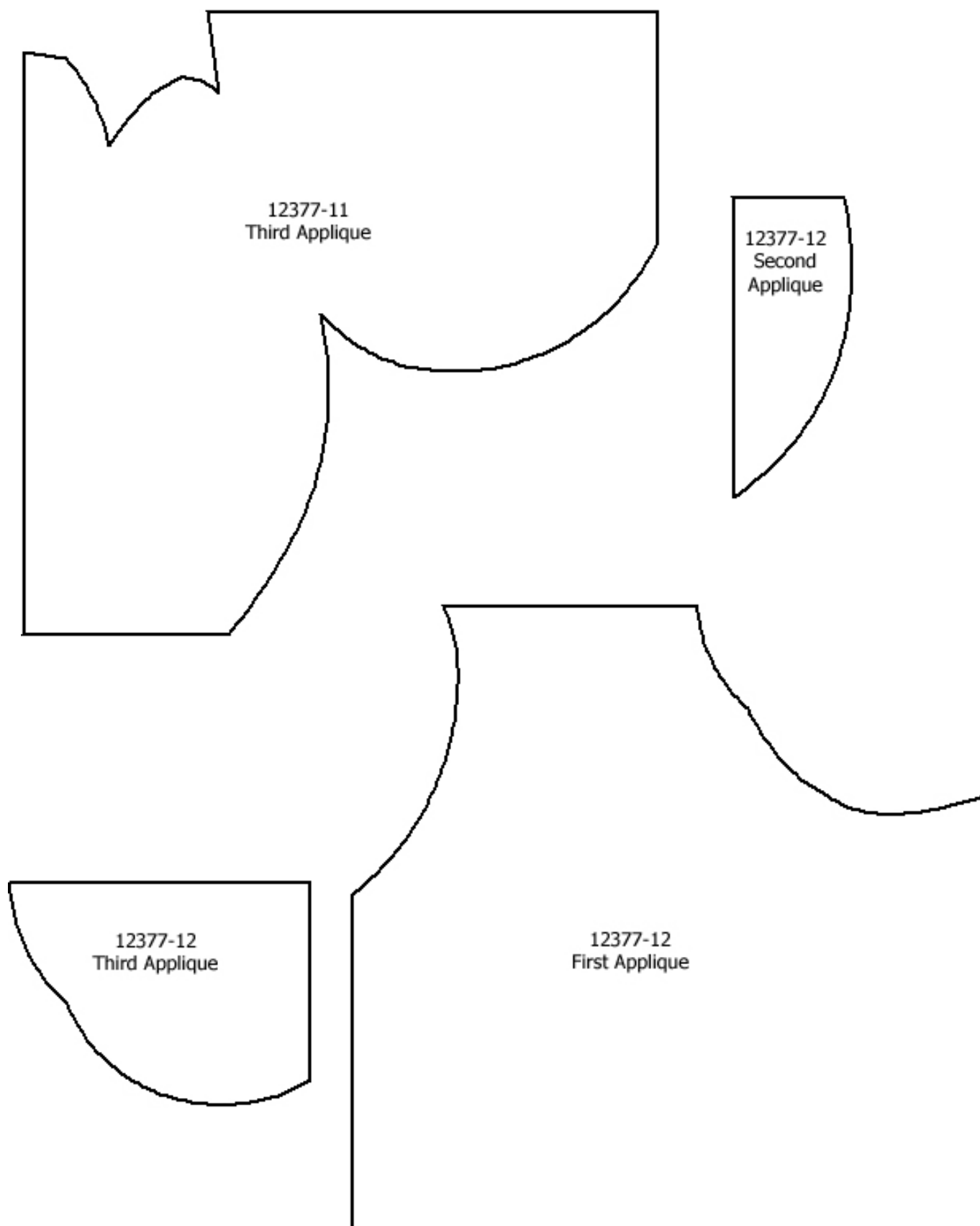


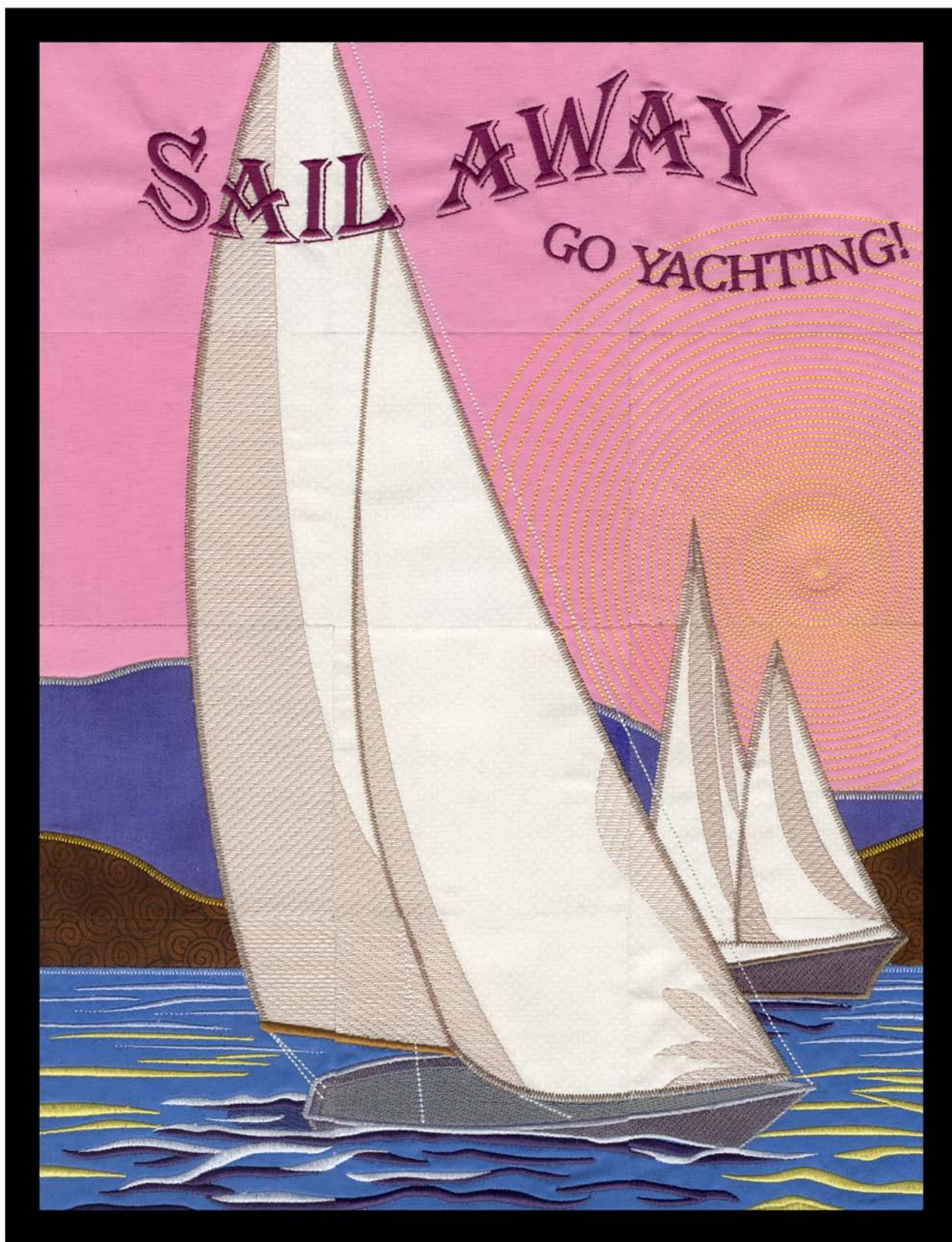












Finished size approx. 12" x 16"

Note: Some designs in this collection may have been created using unique special stitches and/or techniques. To preserve design integrity when rescaling or rotating designs in your software, always rescale or rotate designs using the handles directly on-screen.



12391-01 Tile 1
4.48 X 4.49 in.
113.79 X 114.05 mm
3,943 St.



12391-02 Tile 2
4.47 X 4.47 in.
113.54 X 113.54 mm
4,726 St.



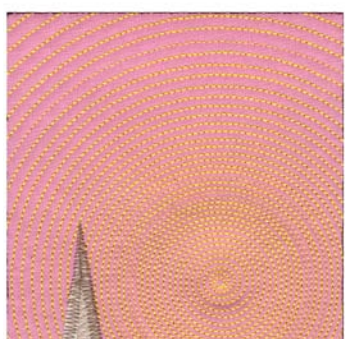
12391-03 Tile 3
4.50 X 4.50 in.
114.30 X 114.30 mm
5,687 St.



12391-04 Tile 4
4.49 X 4.50 in.
114.05 X 114.30 mm
2,407 St.



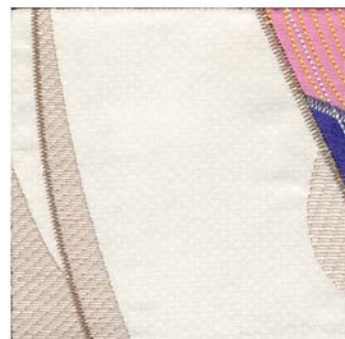
12391-05 Tile 5
4.44 X 4.47 in.
112.78 X 113.54 mm
3,477 St.



12391-06 Tile 6
4.38 X 4.46 in.
111.25 X 113.28 mm
9,065 St.



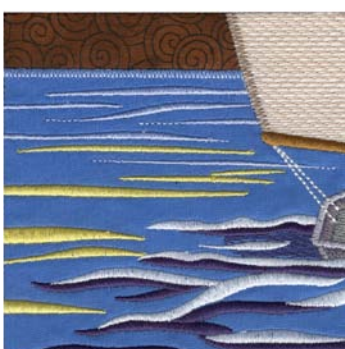
12391-07 Tile 7
4.47 X 4.48 in.
113.54 X 113.79 mm
3,230 St.



12391-08 Tile 8
4.44 X 4.46 in.
112.78 X 113.28 mm
3,178 St.



12391-09 Tile 9
4.45 X 4.45 in.
113.03 X 113.03 mm
7,474 St.



12391-10 Tile 10
4.46 X 4.47 in.
113.28 X 113.54 mm
11,674 St.



12391-11 Tile 11
4.48 X 4.45 in.
113.79 X 113.03 mm
10,476 St.

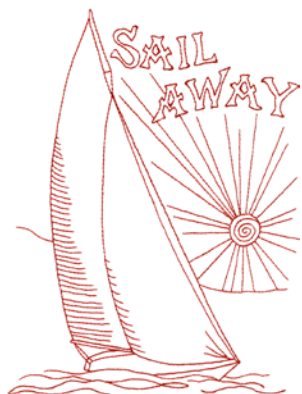


12391-12 Tile 12
4.47 X 4.45 in.
113.54 X 113.03 mm
13,113 St.

⌘ Design contains a loose fill.
⚙ Some white areas shown are not stitched.

L Design is larger than 5" (127 mm) in either direction.
S Design is smaller than 1.5" (38.1 mm) in either direction.

Note: Some designs in this collection may have been created using unique special stitches and/or techniques. To preserve design integrity when rescaling or rotating designs in your software, always rescale or rotate designs using the handles directly on-screen.



12391-13 Redwork Yacht

4.83 X 6.48 in.

122.68 X 164.59 mm

5,242 St. ⚙️ L

- ⚙️ Design contains a loose fill.
- ⚙️ Some white areas shown are not stitched.

- L Design is larger than 5" (127 mm) in either direction.
- S Design is smaller than 1.5" (38.1 mm) in either direction.

Listings below indicate color sample, stitching order and suggested thread color number in Isacord thread.

12391-01 Tile 1

1. Pink Background Placement Stitch.....	0101
2. Sail Placement Stitch.....	0101
3. Sail Shading.....	0874
4. Sail Tackdown.....	0776
5. Letters.....	2711
6. Seam Stitch.....	0020

12391-02 Tile 2

1. Pink Background Placement Stitch.....	0101
2. Off White Linework.....	0101
3. Sail Placement Stitch.....	0101
4. Sail Tackdown.....	0776
5. Yellow Linework.....	0310
6. Letters.....	2711
7. Seam Stitch.....	0020

12391-03 Tile 3

1. Pink Background Placement Stitch.....	0101
2. Yellow Linework.....	0310
3. Letters.....	2711
4. Seam Stitch.....	0020

12391-04 Tile 4

1. Pink Background Placement Stitch.....	0101
2. Sail Placement Stitch.....	0101
3. Sail Shading.....	0874
4. Sail Tackdown.....	0776
5. Seam Stitch.....	0020

12391-05 Tile 5

1. Pink Placement Stitch.....	0101
2. Yellow Linework.....	0310
3. Off White Linework.....	0101
4. Sail Placement Stitch.....	0101
5. Sail Shading.....	0874
6. Sail Tackdown.....	0776
7. Seam Stitch.....	0020

12391-06 Tile 6

1. Pink Background Placement Stitch.....	0101
2. Yellow Linework.....	0310
3. Sail Placement Stitch.....	0101
4. Sail Shading.....	0874
5. Sail Tackdown.....	0776
6. Seam Stitch.....	0020

12391-07 Tile 7

1. Pink Background Placement Stitch.....	0101
2. Purple Mountains Placement Stitch.....	0101
3. Purple Mountains Tackdown.....	0520
4. Brown Mountains Stitch.....	0101
5. Brown Mountains Tackdown.....	0702
6. Sail Placement Stitch.....	0101
7. Sail Shading.....	0874
8. Sail Tackdown.....	0776
9. Seam Stitch.....	0020

12391-08 Tile 8

1. Pink Background Placement Stitch.....	0101
2. Yellow Linework.....	0310
3. Purple Mountains Placement Stitch.....	0101
4. Purple Mountains Tackdown.....	0520
5. Off White Linework.....	0101
6. Sail Placement Stitch.....	0101
7. Sail Shading.....	0874
8. Sail Tackdown.....	0776
9. Seam Stitch.....	0020

12391-09 Tile 9

1. Pink Background Placement Stitch.....	0101
2. Yellow Linework.....	0310
3. Purple Mountains Placement Stitch.....	0101
4. Purple Mountains Tackdown.....	0520
5. Brown Mountains Placement Stitch.....	0101
6. Brown Mountains Tackdown.....	0702
7. Sails Placement Stitch.....	0101
8. Sails Shading.....	0722
9. Sails Light Shading.....	0874
10. Sails Tackdown.....	0776
11. Off White Linework.....	0101
12. Seam Stitch.....	0020

12391-10 Tile 10

1. Brown Mountains Placement Stitch.....	0101
2. Blue Water Placement Stitch.....	0101
3. Water Tackdown & Highlights.....	3652
4. Yellow Water Highlights.....	0630
5. Dark Blue Waves & Shading.....	3732
6. Medium Grey on Boat.....	0112
7. White Water Highlights.....	0015
8. Boat Bottom.....	4073
9. Light Grey Boat Edge.....	3572
10. Off White Linework.....	0101
11. Sail Placement Stitch.....	0101
12. Sail Shading.....	0874
13. Sail Tackdown.....	0776
14. Boom.....	0941
15. Seam Stitch.....	0020

12391-11 Tile 11

1. Blue Water Placement Stitch.....	0101
2. Boat Bottom.....	4073
3. Medium Grey Boat.....	0112
4. Light Grey Boat Edge.....	3572
5. Sail Placement Stitch.....	0101
6. Sail Shading.....	0874
7. Boom.....	0941
8. Sail Tackdown.....	0776
9. Dark Blue Waves.....	3732
10. Off White Linework.....	0101
11. White Water Highlights.....	0015
12. Seam Stitch.....	0020

12391-12 Tile 12

1. Brown Mountains Placement Stitch.....	0101
2. Blue Water Placement Stitch.....	0101
3. Light Blue Water Tackdown & Highlights.....	3652
4. Yellow Water Highlights.....	0630
5. Farther Boat Side.....	0138
6. Boat Bottom.....	4073
7. Near Boat Side.....	0112
8. Near Boat Outline.....	3572
9. Dark Blue Waves.....	3732
10. White Waves.....	0015
11. Sail Placement Stitch.....	0101
12. Near Boat Sail Shading.....	0874
13. Farther Boat Sail Shading.....	0722
14. Sail Tackdown & Farther Boat Outline.....	0776
15. Off White Linework.....	0015
16. Seam Stitch.....	0020

12391-13 Redwork Yacht

1. Single Color Design.....	1902
-----------------------------	------

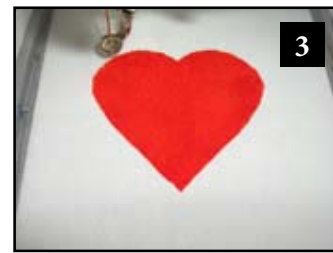
Note: Appliqué fabric not included.

Pre-Cut Appliqué Instructions

1. Print out the necessary pages from the PDF of the appliqué pattern(s).
2. Mark the right side of the pattern pieces so you'll know which direction to lay the pattern on the fabric.
3. Lightly spray the wrong side of the pattern pieces with temporary adhesive spray and allow it to set for a few minutes.
4. Place the pattern pieces on the right side of the fabric and carefully cut them out. **PHOTO 1**
5. Sew the placement stitch on your hooped fabric. **PHOTO 2**
6. With the paper still stuck to the right side of the appliqué fabric, spray the wrong side of the fabric with temporary spray adhesive.
7. Place the fabric inside the sewing placement stitch so that it matches the stitching line then remove the paper pattern. **PHOTO 3**
8. Sew the tackdown. **PHOTO 4**
9. Sew the remainder of the design and repeat for any remaining pieces. **PHOTO 5**

NOTE: The patterns are sized for the designs as they were made. If you resize the design, you will need to resize the pattern the same amount. You can print out the pattern at the normal size then copy it on a copy machine at the changed size, i.e. resize the designs to 80%, resize the printed pattern to 80%.

TIP: When Printing the patterns, make sure that the “Fit to page” option is **UNCHECKED** in the Print Dialog Box. If this option is checked the printed patterns will not be actual size.



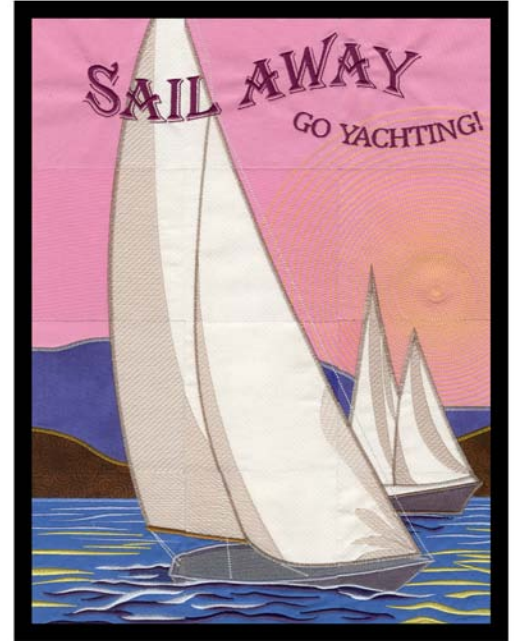
A Vintage Summer Wall Hanging

Supplies:

- OESD Signature Pack #12391 A Vintage Summer
- Polyester Embroidery Thread
- Bobbin Thread
- Temporary Spray Adhesive
- Medium Weight Tear-Away Stabilizer
- 2 yards of fabric (this will include the blocks, backing and binding)
- Quilt Batting 12"x 20"

Optional:

- Stitch Witchery Fusible Bonding Web 1/4" wide roll (widely available in 20yd roll)
- 3 yards satin ribbon 1/4" wide



Embroidery:

1. Embroider one of each design file 12391-01 through 12391-12 for the wall hanging using two layers of Medium Weight Tear-Away stabilizer in each hooping. Be sure to use temporary spray adhesive to adhere all layers of stabilizer and fabric together for best stitch results.
2. Refer to the Pre-Cut Applique Instructions for directions to apply the applique areas.
3. The last thing that will stitch in each of these designs is a border that is referred to on the thread chart as "Seam Stitch". This stitch is very important in the process assembling the wall hanging. It is vital that it is not skipped when embroidering. Stitch this in the same thread color as your background fabric. **NOTE:** In our sample pictures we stitched our "Seam Stitch" in black to ensure they would show in photographs.
4. Once the embroidery process is complete, remove excess stabilizer then trim away excess fabric by cutting 1/2" outside the "Seam Stitch". This process is easily done using a rotary cutter and ruler. **NOTE:** It may be easier to cut with the back of the block showing since the "Seam Stitch" was stitched in the same color as your background fabric. (Photo 01)



Construction:

1. After each block has been trimmed, lay out the pieces near your machine so that it is easy to put the blocks together. Refer to **Diagram A (On next page)**.
2. Stitch the horizontal rows together by laying the first two pieces together with right sides matching. Cut edges should match but more importantly, the "Seam Stitch" on both pieces must match. Stitch the pieces together by straight stitching just to the inside of the "Seam Stitch". (Photo 02)



1. Attach the third square to the first two squares in the same fashion to complete your first row. (**Photo 03**)
2. Press seams open.
3. Referring to diagram A, repeat for rows two through four.
4. When step five is complete you will have four stitched rows. (**Photo 04**)
5. Stitch the four rows together in the same manner to complete the front of the wall hanging. Make sure as you sew that your intersections line up between the rows and that the "Seam Stitch" stays matched. (**Photo 05**)
6. Cut backing fabric and batting to be at least 2 inches larger than the finished size of your project. Using temporary spray adhesive, spray the batting and adhere it to the wrong side of the backing fabric.
7. Using temporary spray adhesive, spray the batting and adhere it to the wrong side of the completed wall hanging. This will create a "quilters' sandwich".
8. Quilt as desired. In our sample we simply stitched in the ditch. ***NOTE:** steps 11-13 are optional, follow these steps if you would like to add ribbon to cover the seams of the wall hanging (this can be useful if your stitching ended up a bit crooked). If you do not want to add ribbon, simply skip to step 14 to finish the wall hanging.*
9. Cover all of the seams with satin ribbon. Cut ribbon into strips approximately 1" longer than the seam you are covering. Spray one side of ribbon with temporary spray adhesive. Adhere a layer of Stitch Witchery to each ribbon strip. Be careful not to stretch the Stitch Witchery as this will cause your ribbons to draw up and tend to not want to lay flat. Lay ribbon in place, making sure each is straight, and iron to permanently fuse ribbon in place. Since Stitch Witchery is permanent, stitching ribbons in place is not necessary.
10. Place ribbons in the following order: Place the two vertical ribbons first followed by the three horizontal ribbons.
11. Trim away any excess strips of ribbon so that the outer edges of the project are even.
12. Trim away the excess backing fabric and batting then bind the wall hanging using your favorite binding method.

Diagram A

12391-01	12391-02	12391-03
12391-04	12391-05	12391-06
12391-07	12391-08	12391-09
12391-10	12391-11	12391-12



Photo 3

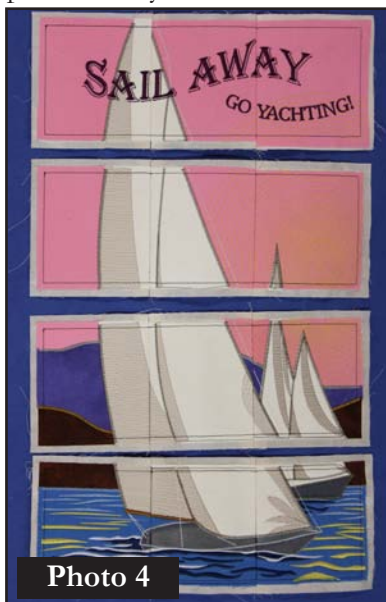


Photo 4

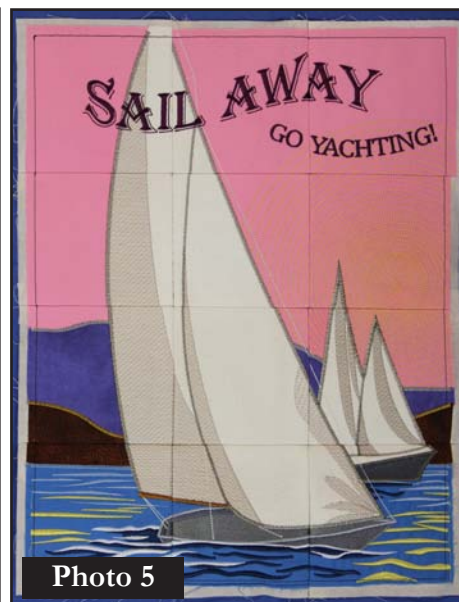
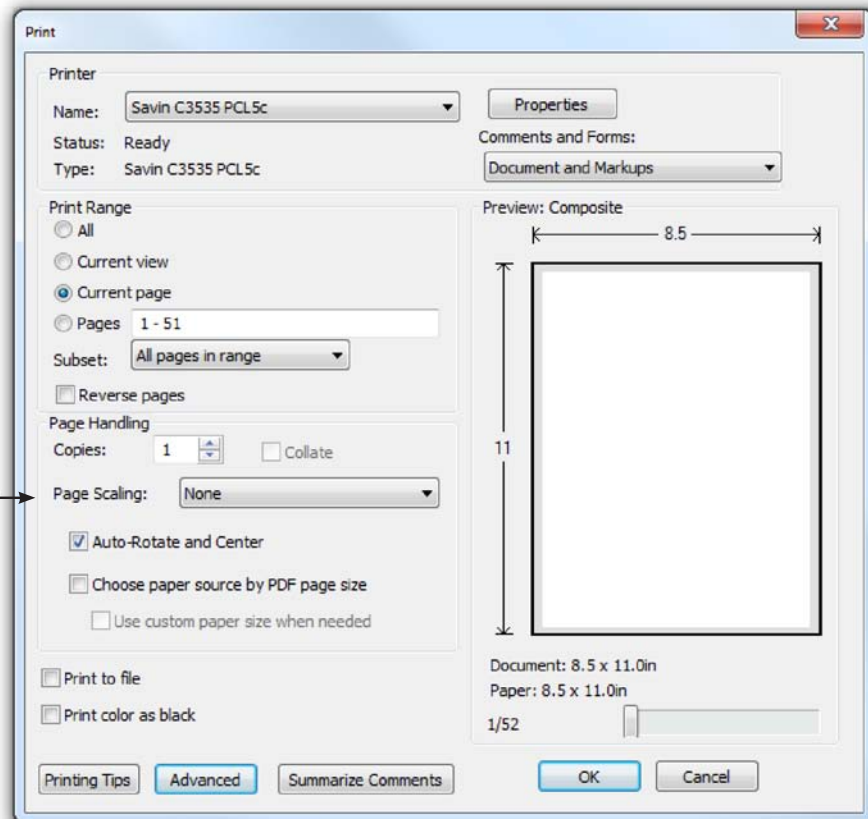


Photo 5

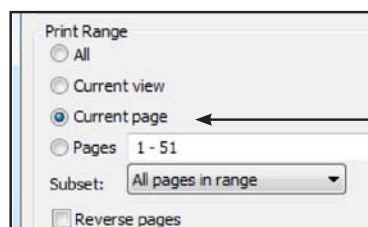
ATTENTION

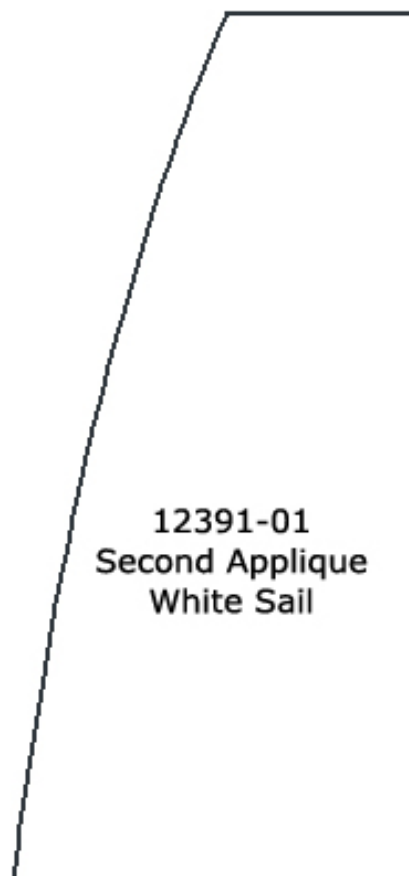
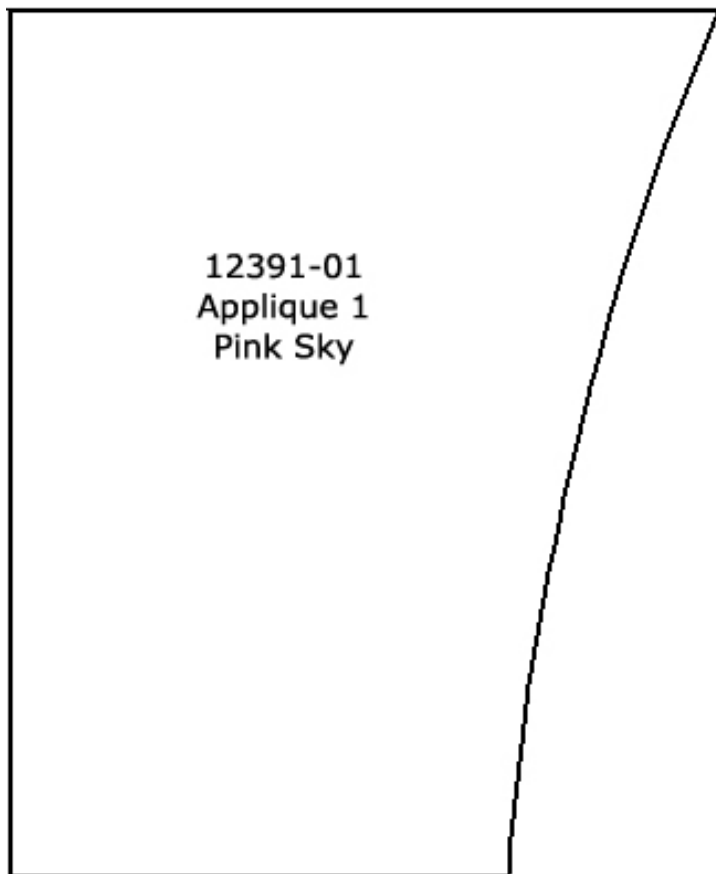
When printing this document, any page scaling or page fitting options in your print dialog box must be turned OFF or set to NONE so that your files will print out at their actual size. Images not printed at actual size will not function as intended.

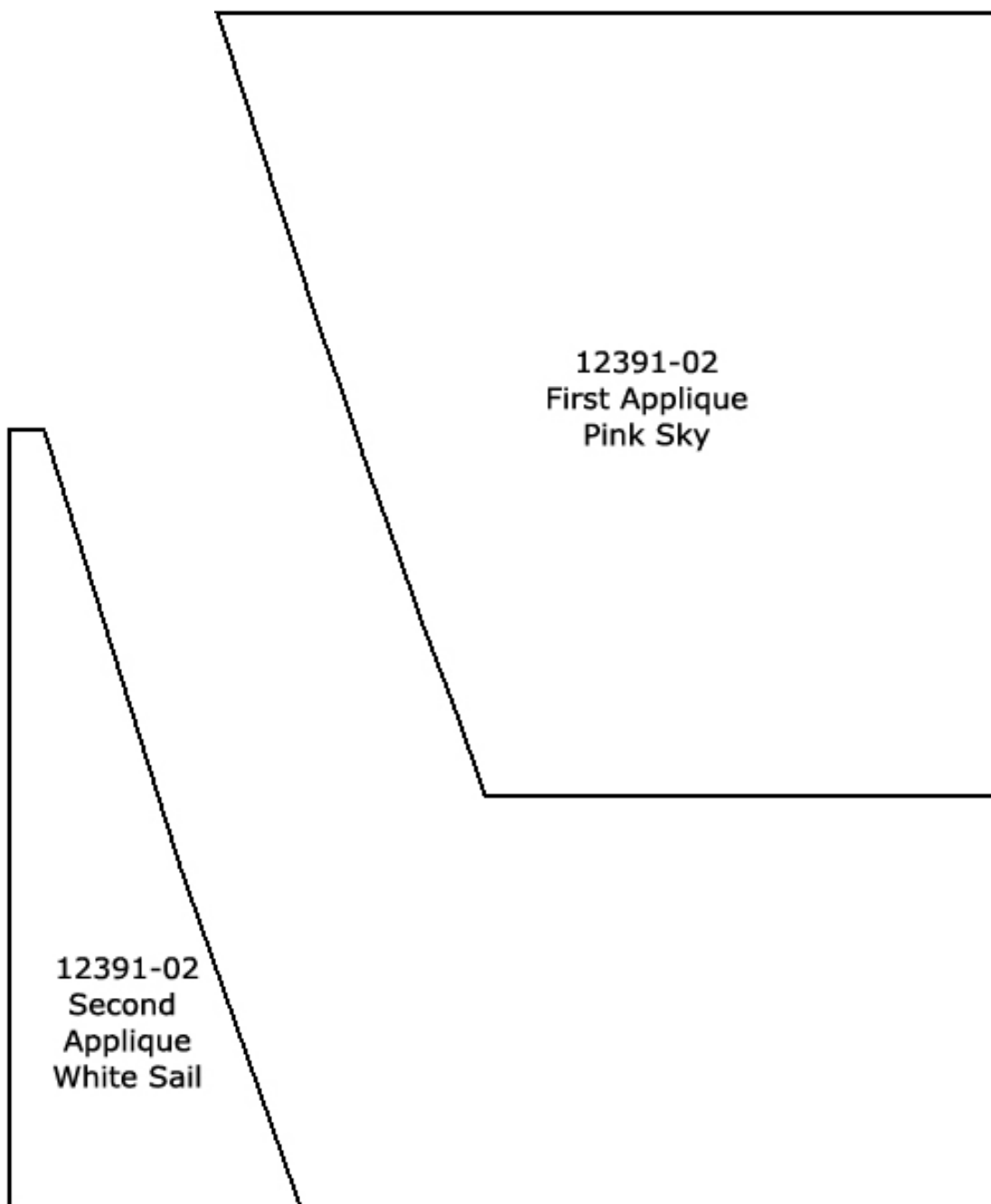


TO SAVE PAPER

Only print the desired image by navigating to the image's page, go to File > Print and select "Current page" in the print dialog box. Repeat for each desired image.

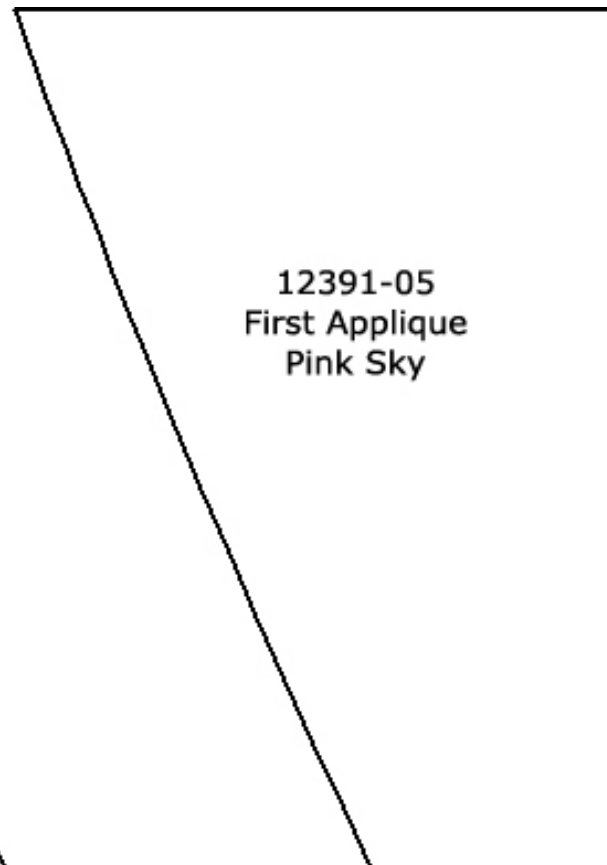
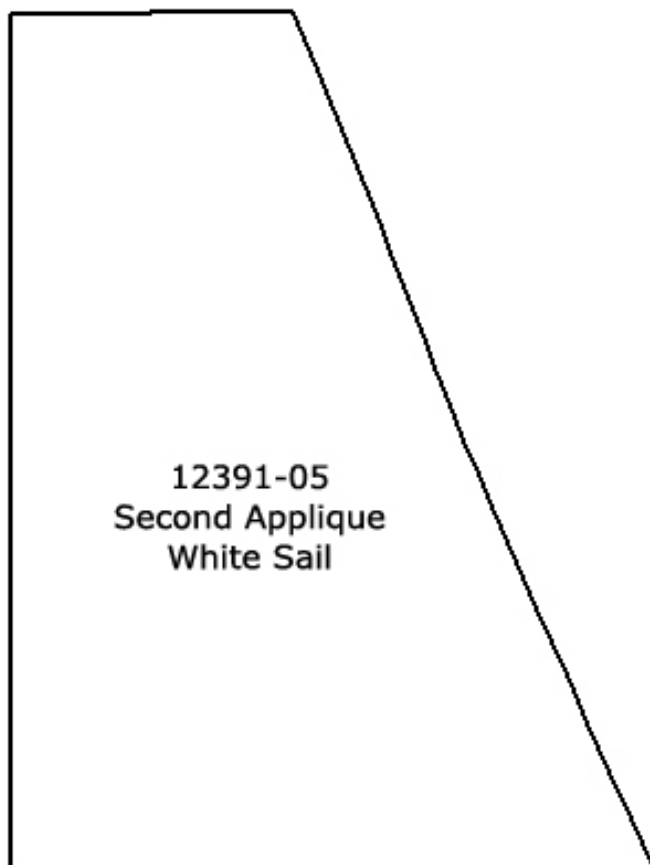
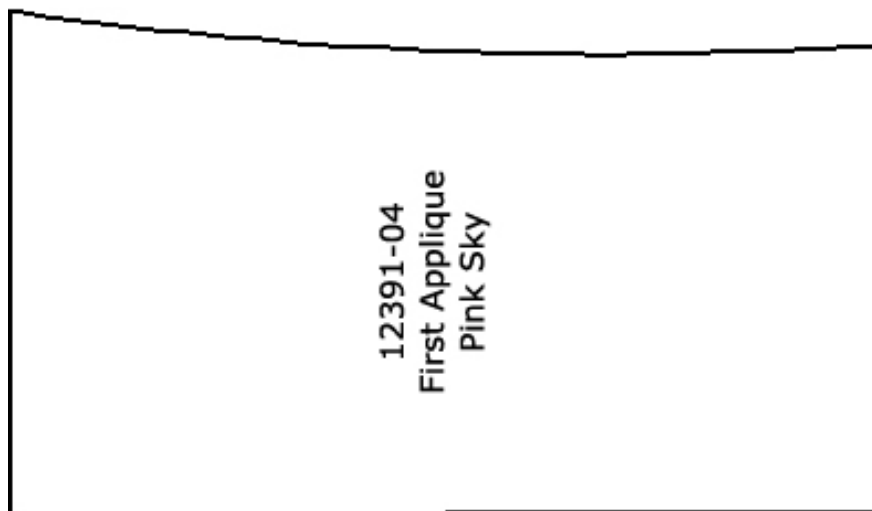


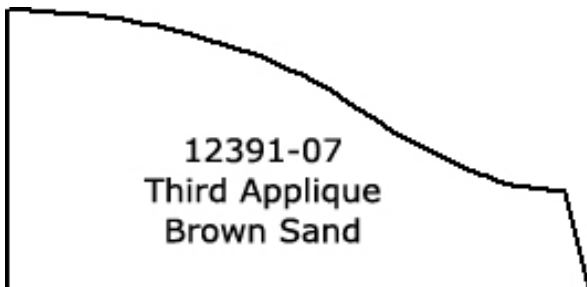
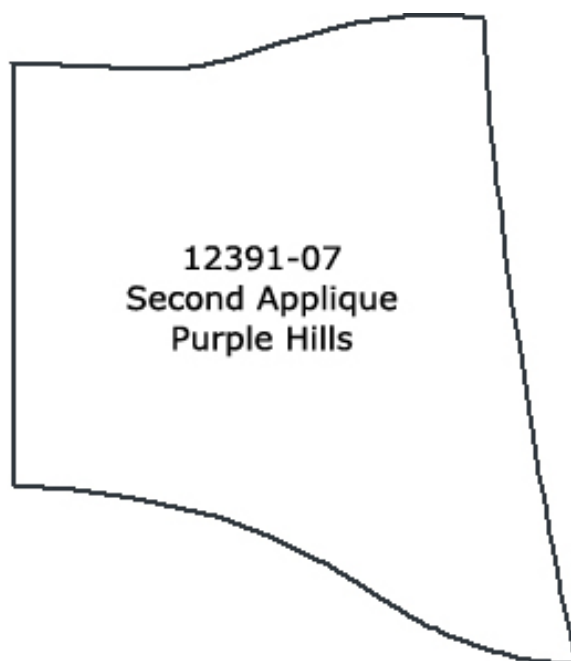
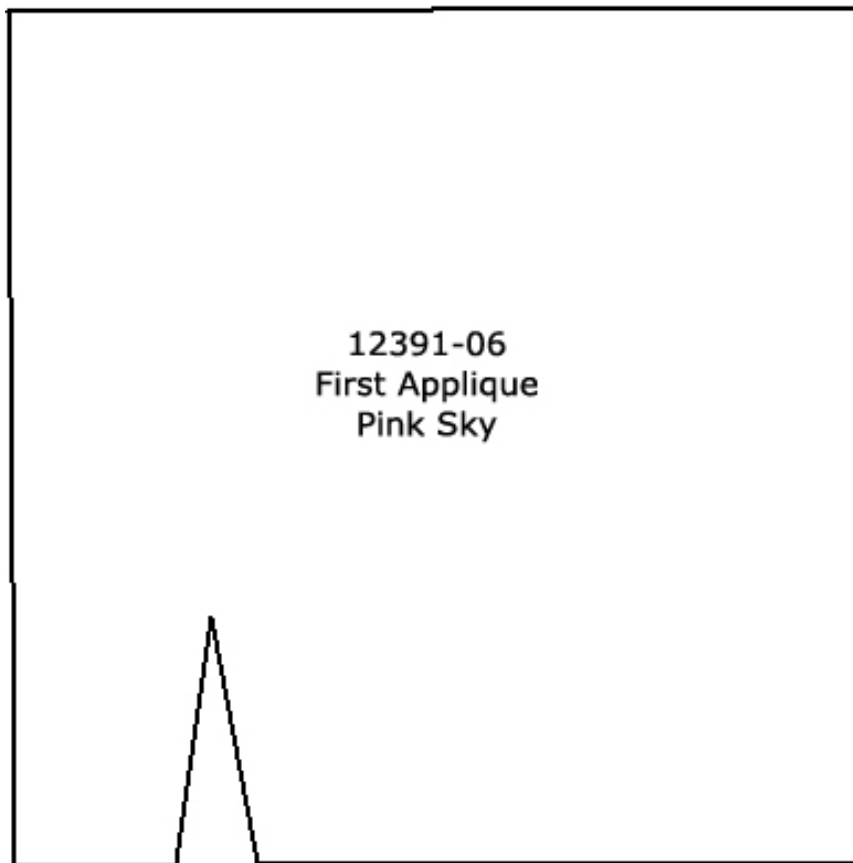


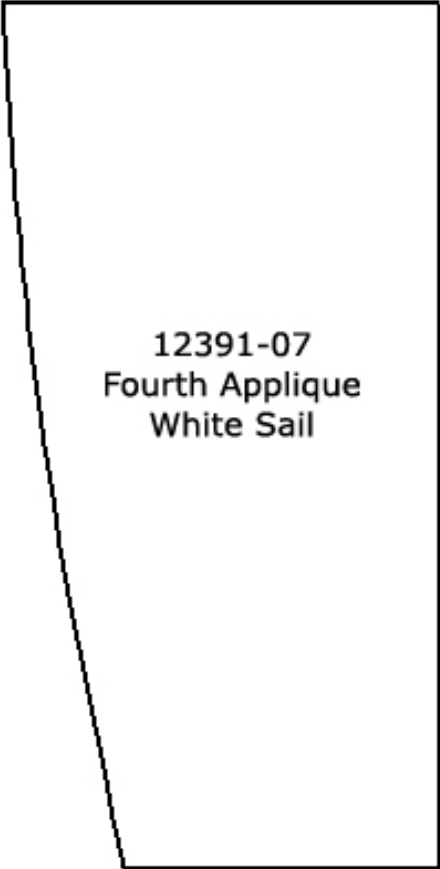


12391-03
Pink Sky

12391-04
Second Applique
White Sail



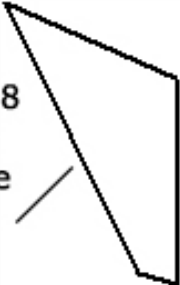




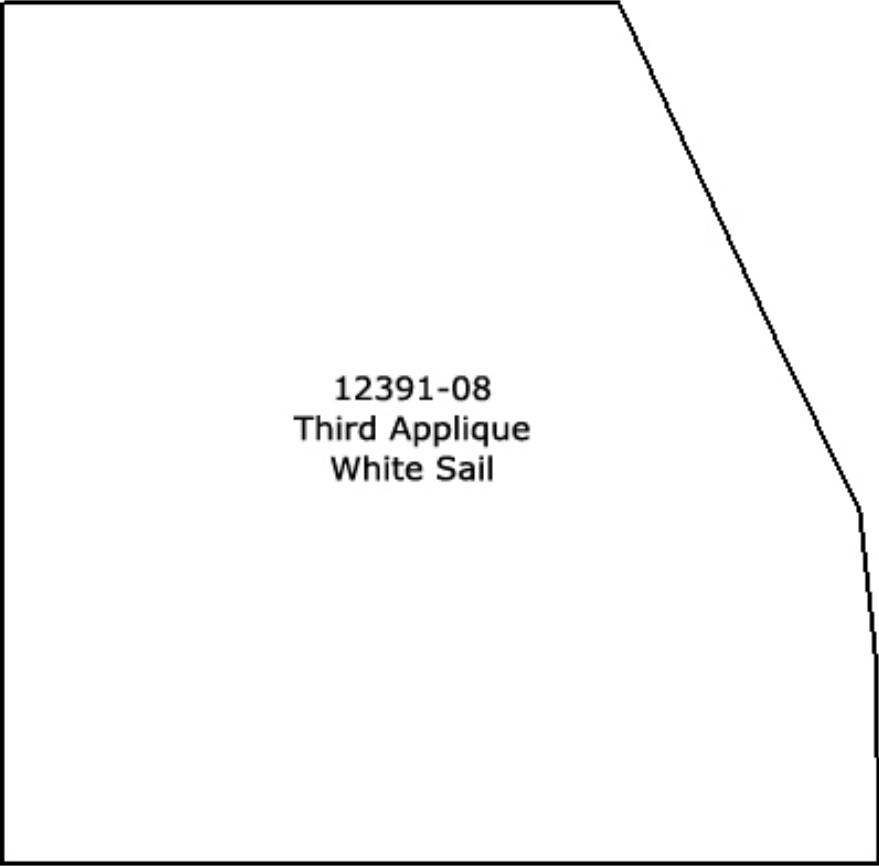
12391-07
Fourth Applique
White Sail



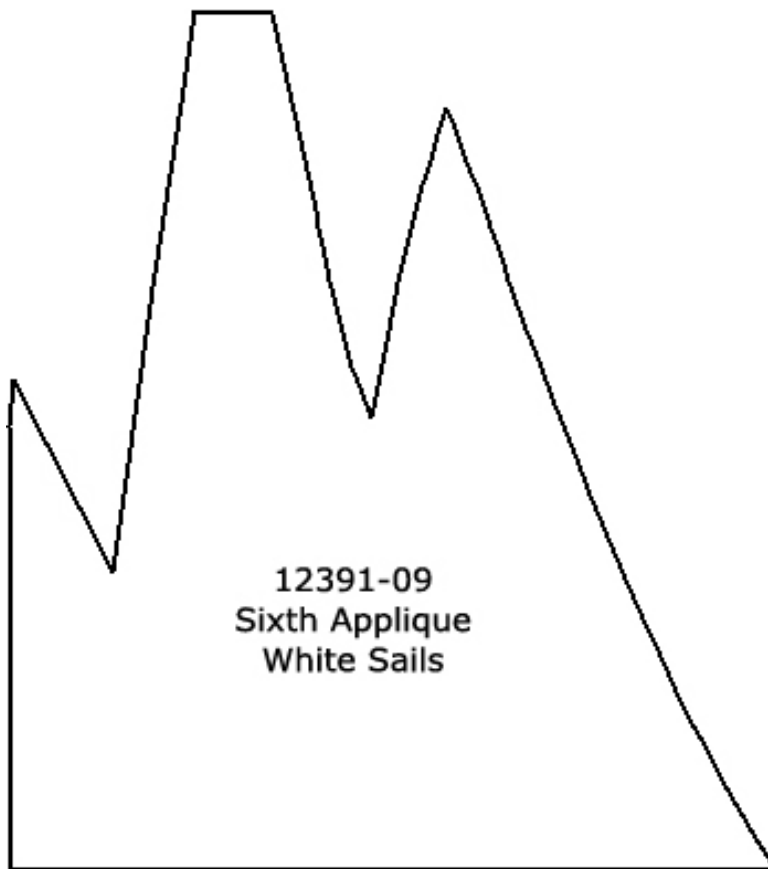
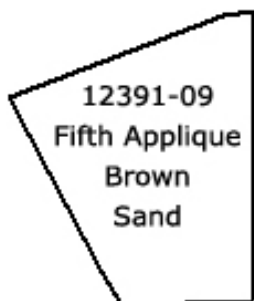
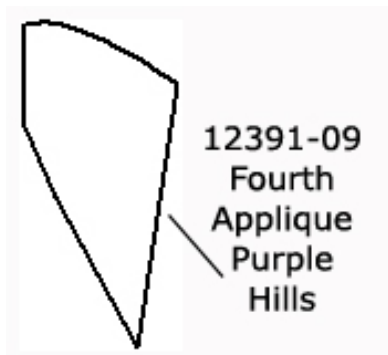
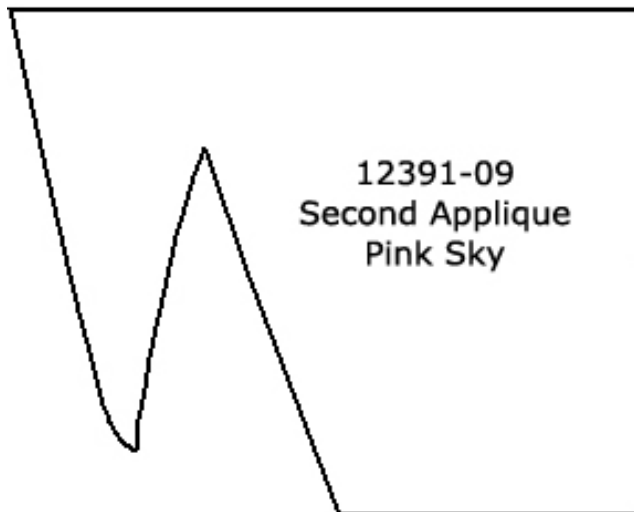
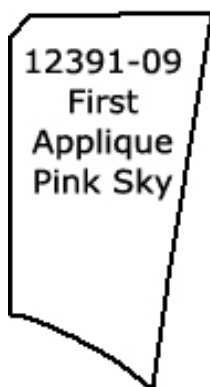
12391-08
First
Applique
Pink Sky




12391-08
Second
Applique
Purple
Hills



12391-08
Third Applique
White Sail

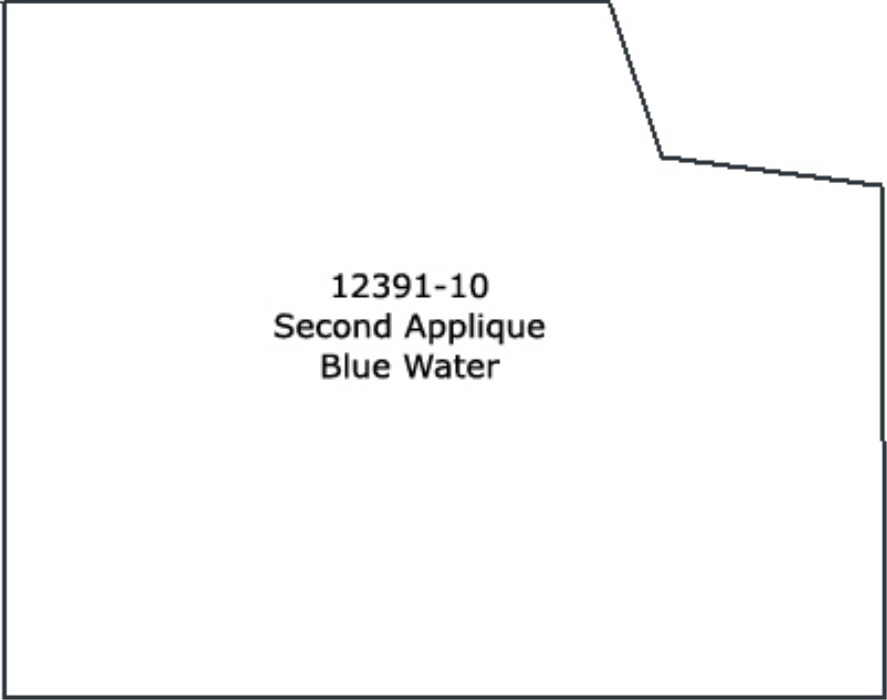




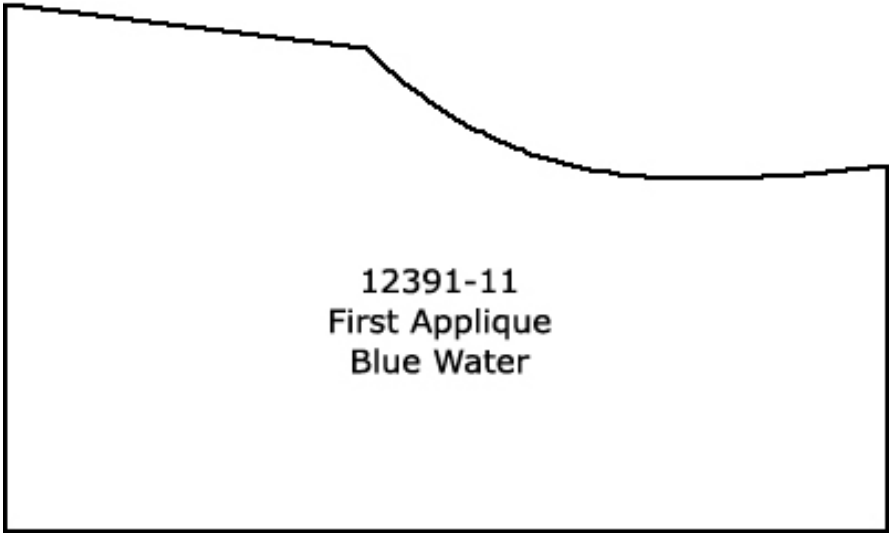
12391-10
First Applique
Brown Sand



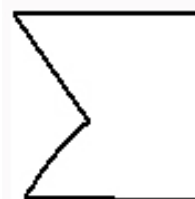
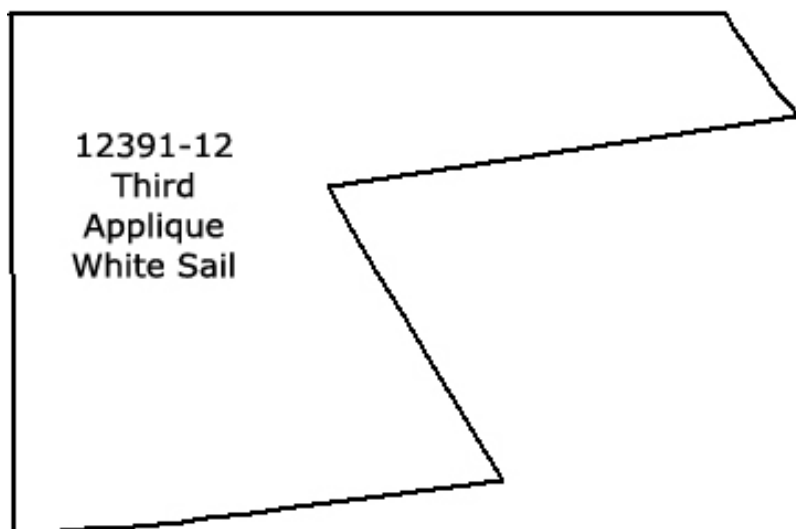
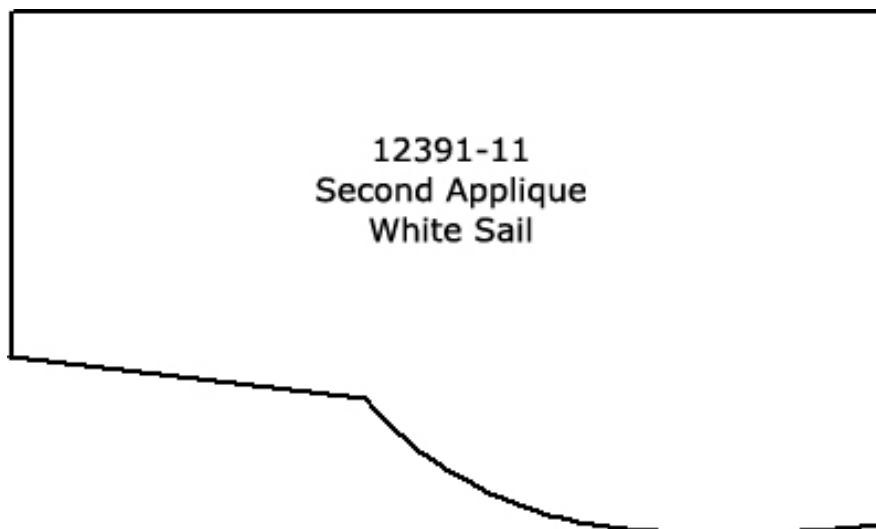
12391-10
Third
Applique
White Sail



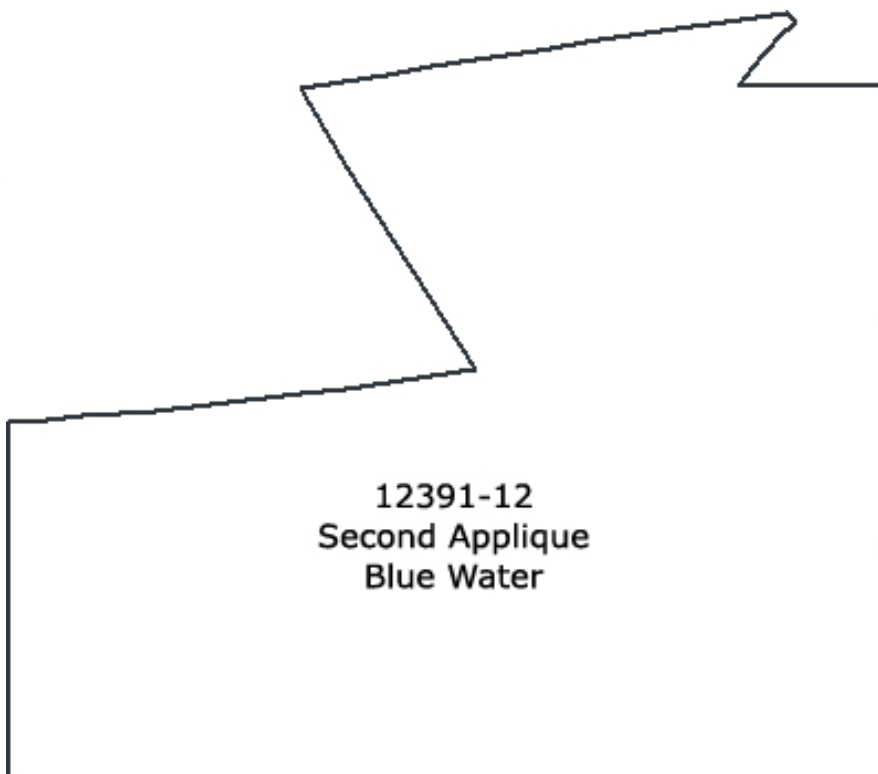
12391-10
Second Applique
Blue Water

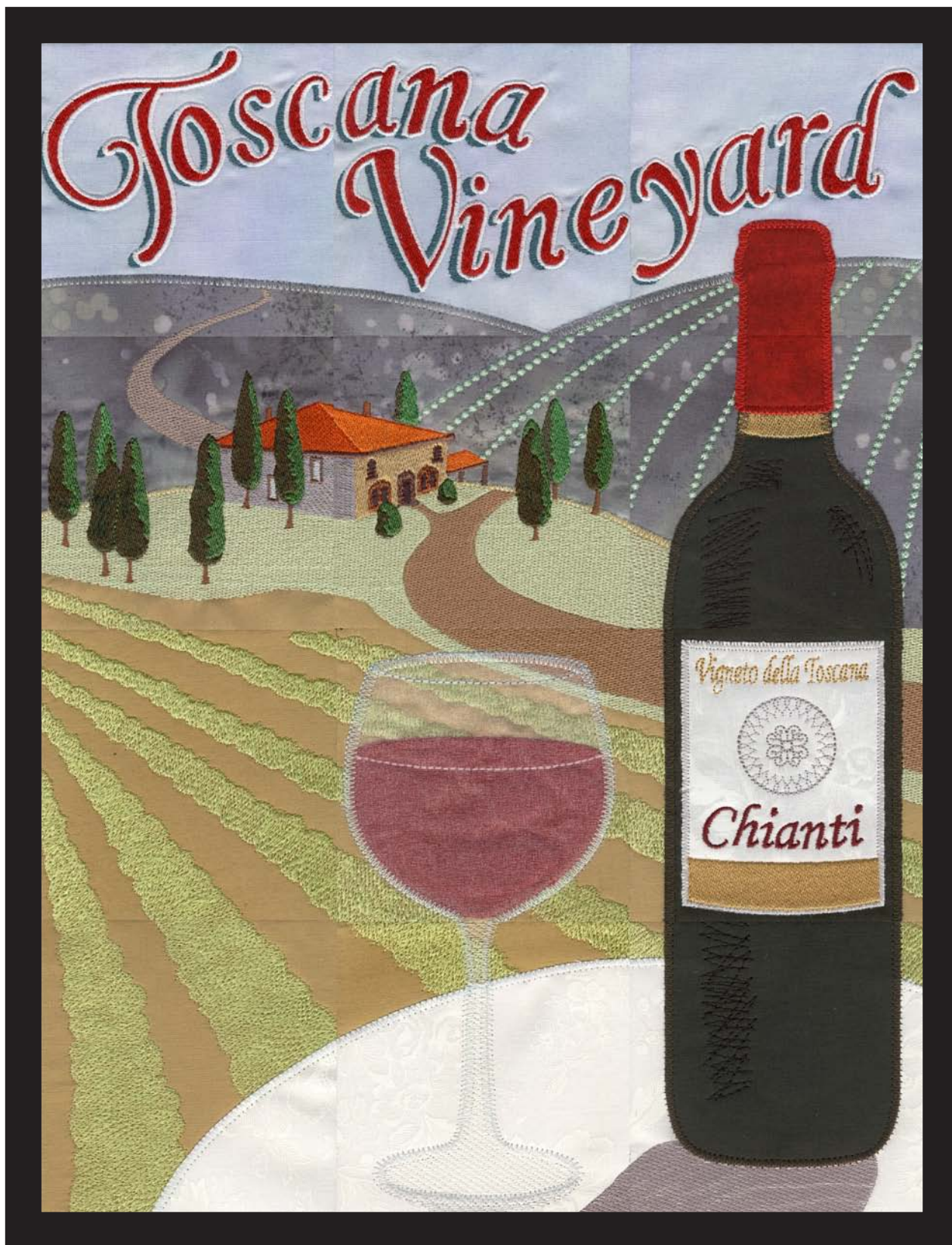


12391-11
First Applique
Blue Water



12391-12
First
Applique
Brown
Sand





Finished size approx. 12" x 16"

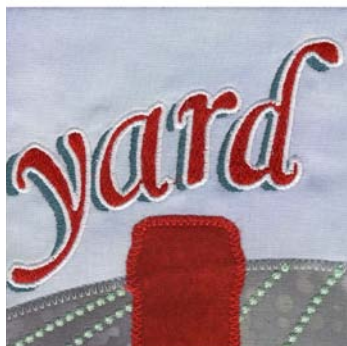
Note: Some designs in this collection may have been created using unique special stitches and/or techniques. To preserve design integrity when rescaling or rotating designs in your software, always rescale or rotate designs using the handles directly on-screen.



12405-01 Tile 1
4.47 X 4.46 in.
113.54 X 113.28 mm
12,649 St.



12405-02 Tile 2
4.48 X 4.47 in.
113.79 X 113.54 mm
17,552 St.



12405-03 Tile 3
4.48 X 4.48 in.
113.79 X 113.79 mm
11,884 St.



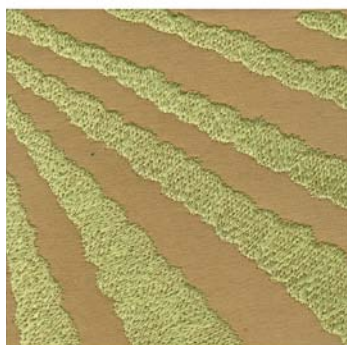
12405-04 Tile 4
4.45 X 4.47 in.
113.03 X 113.54 mm
17,240 St.



12405-05 Tile 5
4.46 X 4.48 in.
113.28 X 113.79 mm
17,624 St.



12405-06 Tile 6
4.46 X 4.48 in.
113.28 X 113.79 mm
4,873 St.



12405-07 Tile 7
4.50 X 4.50 in.
114.30 X 114.30 mm
11,305 St.



12405-08 Tile 8
4.51 X 4.52 in.
114.55 X 114.81 mm
10,587 St.



12405-09 Tile 9
4.50 X 4.48 in.
114.30 X 113.79 mm
11,804 St.



12405-10 Tile 10
4.48 X 4.49 in.
113.79 X 114.05 mm
9,075 St.



12405-11 Tile 11
4.49 X 4.46 in.
114.05 X 113.28 mm
5,553 St.



12405-12 Tile 12
4.49 X 4.48 in.
114.05 X 113.79 mm
4,442 St.

- ⌘ Design contains a loose fill.
- ⚙ Some white areas shown are not stitched.

- L Design is larger than 5" (127 mm) in either direction.
- S Design is smaller than 1.5" (38.1 mm) in either direction.

Note: Some designs in this collection may have been created using unique special stitches and/or techniques. To preserve design integrity when rescaling or rotating designs in your software, always rescale or rotate designs using the handles directly on-screen.





12405-13 Redwork Wine

4.89 X 6.50 in.

124.21 X 165.10 mm

5,970 St.  **L**

-  Design contains a loose fill.
-  Some white areas shown are not stitched.

- L** Design is larger than 5" (127 mm) in either direction.
- S** Design is smaller than 1.5" (38.1 mm) in either direction.



A Vintage Autumn

#12405 / 13 Designs

Listings below indicate color sample, stitching order and suggested thread color number. Most numbers indicate Isacord thread. However, colors beginning with 20501 refer to YLI Fine Metallics, 7 refer to Yenmet Metallic, 8 refer to YLI Variations Variegated Thread and 9 refer to Isacord Multicolor Variegated.

12405-01 Tile 1

1. Sky Placement Stitch	4752
2. Hill Placement Stitch	4752
3. Hill Cover Stitch	4752
4. Road	0874
5. Letters Shadow	4625
6. Letters	1902
7. Letters Outlines	0015
8. Seam Stitch	0020

12405-02 Tile 2

1. Sky Placement Stitch	4752
2. Hill Placement Stitch	4752
3. Hill Cover Stitch	4752
4. Hill Details	5450
5. Letters Shadows	4625
6. Letters	1902
7. Letters Outlines	0015
8. Seam Stitch	0020

12405-03 Tile 3

1. Sky Placement Stitch	4752
2. Hill Placement Stitch	4752
3. Hill Cover Stitch	4752
4. Hill Details	5450
5. Bottle Placement Stitch	1720
6. Bottle Cover Stitch	1720
7. Letters Shadows	4625
8. Letters	1902
9. Letters Outlines	0015
10. Seam Stitch	0020

12405-04 Tile 4

1. Hill Placement Stitch	4752
2. Field Placement Stitch	4752
3. Field Cover Stitch	5650
4. Road	0874
5. Grass	5650
6. Grey Wall	0131
7. Windows	4071
8. Chimney	1233
9. Dark Orange Roof	1301
10. Light Orange Roof	1300
11. House Details	1565
12. Tree Trunks	1154
13. Medium Green Tree Shading	5643
14. Light Green Tree Shading	5510
15. Dark Green Tree Shading	5944
16. Green Tree Shading	5633
17. Crops Row	6141
18. Seam Stitch	0020

12405-05 Tile 5

1. Hill Placement Stitch	4752
2. Field Placement Stitch	4752
3. Field Cover Stitch	5650
4. Hill Details	5450
5. Grass	5650
6. Windows	4174
7. Grey Wall	0131
8. Tan Wall	0851
9. Light Orange Roof	1300
10. Dark Orange Roof	1301
11. House Details	1565
12. House Details	1233
13. Driveway	1252
14. Steps	1874
15. Medium Green Trees Shading	5643
16. Tree Trunks	1154
17. Light Green Trees Shading	5510
18. Dark Green Trees Shading	5944
19. Green Trees Shading	5633
20. Seam Stitch	0020

12405-06 Tile 6

1. Hill Placement Stitch	4752
2. Field Placement Stitch	4752
3. Cover Stitch & Grass	5650
4. Hill Details	5450
5. Bottle Placement Stitch	6156
6. Bottle Details	0832
7. Bottle Cover Stitch	6156
8. Top of Bottle Placement Stitch	1720
9. Top of Bottle Cover Stitch	1720
10. Bottle Shading	0020
11. Seam Stitch	0020

12405-07 Tile 7

1. Field Placement Stitch	6141
2. Field Tackdown	6141
3. Crops	6141
4. Seam Stitch	0020

12405-08 Tile 8 *Additional Instructions

1. Field Placement Stitch	1252
2. Field Tackdown	1252
3. Driveway	1252
4. Grass	5650
5. Crops	6141
6. Wine Placement Stitch	1911
7. Wine Cover Stitch	1911
8. Wine Details	2250
9. Glass Placement Stitch	4071
10. Glass Cut Line & Tackdown	4071
11. Glass Cover Stitch	4071
12. Seam Stitch	0020

12405-09 Tile 9

1. Field Placement Stitch	5650
2. Grass	5650
3. Driveway	1252
4. Crops	6141
5. Bottle Placement Stitch	6156
6. Bottle Cover Stitch	6156
7. Label Placement Stitch	0142
8. Label Cover Stitch & Medallion	0142
9. Gold Top Words & Stripe on Label	0832
10. Chianti Red Lettering	2123
11. Seam Stitch	0020

12405-10 Tile 10

1. Field Placement Stitch	6141
2. Crops	6141
3. Tablecloth Placement Stitch	4071
4. Tablecloth Cover Stitch	4071
5. Seam Stitch	0020

12405-11 Tile 11

1. Field Placement Stitch	6141
2. Crops	6141
3. Tablecloth Placement Stitch	0101
4. Glass	0101
5. Glass Shadow	3971
6. Tablecloth Cover & Glass Cover Stitch	4071
7. Bottle Shadow	0108
8. Seam Stitch	0020

12405-12 Tile 12

1. Ground Placement Stitch	6141
2. Crops	6141
3. Tablecloth Placement Stitch	4071
4. Tablecloth Cover Stitch	4071
5. Bottle Shadow	0108
6. Bottle Placement Stitch	6156
7. Bottle Cover Stitch	6156
8. Bottle Shading	0020
9. Seam Stitch	0020

12405-13 Redwork Wine

1. Single Color Design	1902
------------------------	------

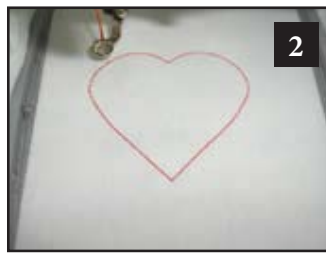
Note: Appliqué fabric not included.

Pre-Cut Appliqué Instructions

1. Print out the necessary pages from the PDF of the appliqué pattern(s).
2. Mark the right side of the pattern pieces so you'll know which direction to lay the pattern on the fabric.
3. Lightly spray the wrong side of the pattern pieces with temporary adhesive spray and allow it to set for a few minutes.
4. Place the pattern pieces on the right side of the fabric and carefully cut them out. **PHOTO 1**
5. Sew the placement stitch on your hooped fabric. **PHOTO 2**
6. With the paper still stuck to the right side of the appliqué fabric, spray the wrong side of the fabric with temporary spray adhesive.
7. Place the fabric inside the sewing placement stitch so that it matches the stitching line then remove the paper pattern. **PHOTO 3**
8. Sew the tackdown. **PHOTO 4**
9. Sew the remainder of the design and repeat for any remaining pieces. **PHOTO 5**

NOTE: The patterns are sized for the designs as they were made. If you resize the design, you will need to resize the pattern the same amount. You can print out the pattern at the normal size then copy it on a copy machine at the changed size, i.e. resize the designs to 80%, resize the printed pattern to 80%.

TIP: When Printing the patterns, make sure that the “Fit to page” option is **UNCHECKED** in the Print Dialog Box. If this option is checked the printed patterns will not be actual size.



A Vintage Autumn Wall Hanging

Supplies:

- OESD Signature Pack #12405 A Vintage Autumn
- Polyester Embroidery Thread
- Bobbin Thread
- Temporary Adhesive Spray
- Medium Weight Tear-Away Stabilizer
- 2 yards of fabric (this will include the blocks, backing and binding)
- Quilt Batting 12"x 20"
- 4" square of sheer fabric (such as organza) for wine glass
- Appliqué fabric for each piece. See the appliqué patterns included in this document for reference.

Optional:

- Stitch Witchery Fusible Bonding Web ¼" wide roll (widely available in 20yd roll)
- 3 yards satin ribbon ¼" wide

Embroidery:

1. Embroider one of each design file 12405-01 through 12405-12 for the wall hanging using two layers of medium weight tear-away stabilizer in each hooping. Be sure to use temporary adhesive spray to adhere all layers of stabilizer and fabric together for best stitch results.
 2. Refer to the Pre-Cut Appliqué Instructions for directions to apply the appliqué areas.
 3. The last thing that will stitch in each of these designs is a border that is referred to on the thread chart as "Seam Stitch". This stitch is very important in the process assembling the wall hanging. It is vital that it is not skipped when embroidering. Stitch this in the same thread color as your background fabric. **NOTE:** In our sample pictures we stitched our "Seam Stitch" in black to ensure they would show in photographs.
 4. Once the embroidery process is complete, remove excess stabilizer then trim away excess fabric by cutting ½" outside the "Seam Stitch". This process is easily done using a rotary cutter and ruler. **NOTE:** It may be easier to cut with the back of the block showing since the "Seam Stitch" was stitched in the same color as your background fabric.
- (Photo 01)

Construction:

1. After each block has been trimmed, lay out the pieces near your machine so that it is easy to put the blocks together. Refer to **Diagram A** (On next page).
2. Stitch the horizontal rows together by laying the first two pieces together with right sides matching. Cut edges should match but more importantly, the "Seam Stitch" on both pieces must match. Stitch the pieces together by straight stitching just to the inside of the "Seam Stitch". (Photo 02)

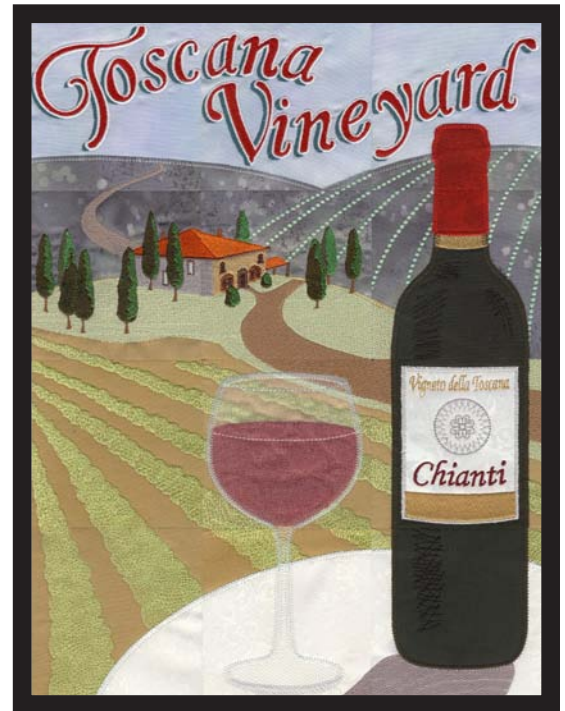


Photo 1



Photo 2

3. Attach the third square to the first two squares in the same fashion to complete your first row. (**Photo 03**)
4. Press seams open.
5. Referring to **Diagram A**, repeat for rows two through four.
6. When step five is complete you will have four stitched rows. (**Photo 04**)
7. Stitch the four rows together in the same manner to complete the front of the wall hanging. Make sure as you sew that your intersections line up between the rows and that the “Seam Stitch” stays matched. (**Photo 05**)
8. Cut backing fabric and batting to be at least 2 inches larger than the finished size of your project. Using temporary adhesive spray, spray the batting and adhere it to the wrong side of the backing fabric.
9. Using temporary adhesive spray, spray the batting and adhere it to the wrong side of the completed wall hanging. This will create a “quilters’ sandwich”.
10. Quilt as desired. In our sample we simply stitched in the ditch
NOTE: Steps 11-13 are optional, follow these steps if you would like to add ribbon to cover the seams of the wall hanging (this can be useful if your stitching ended up a bit crooked). If you do not want to add ribbon, simply skip to step 14 to finish the wall hanging.
11. Cover all of the seams with satin ribbon. Cut ribbon into strips approximately 1" longer than the seam you are covering. Spray one side of ribbon with temporary spray adhesive. Adhere a layer of Stitch Witchery to each ribbon strip. Be careful not to stretch the Stitch Witchery as this will cause your ribbons to draw up and not lay flat. Lay ribbon in place, making sure each is straight, and iron to permanently fuse ribbon in place. Since Stitch Witchery is permanent, stitching ribbons in place is not necessary.
12. Place ribbons in the following order:
Place the two vertical ribbons first followed by the three horizontal ribbons.
13. Trim away any excess strips of ribbon so that the outer edges of the project are even.
14. Trim away the excess backing fabric and batting then bind the wall hanging using your favorite binding method.

Diagram A

12405-01	12405-02	12405-03
12405-04	12405-05	12405-06
12405-07	12405-08	12405-09
12405-10	12405-11	12405-12



Photo 3



Photo 4

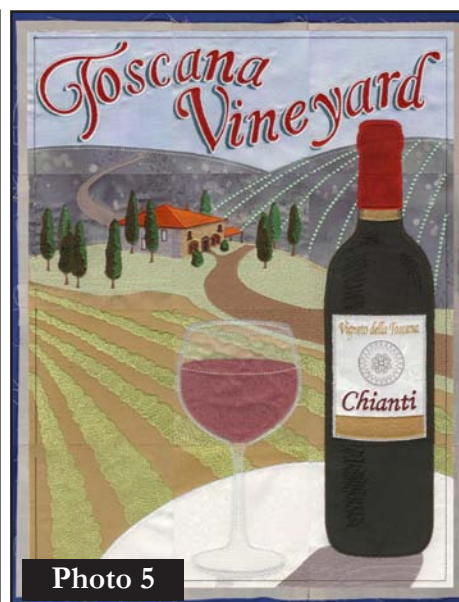
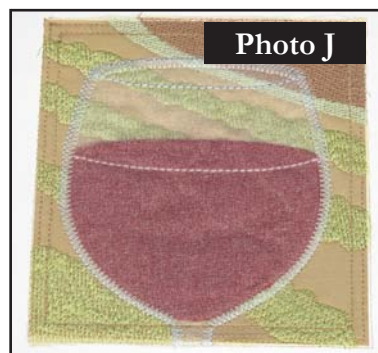
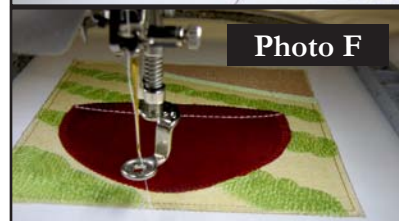
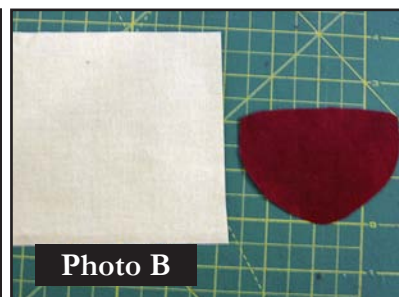
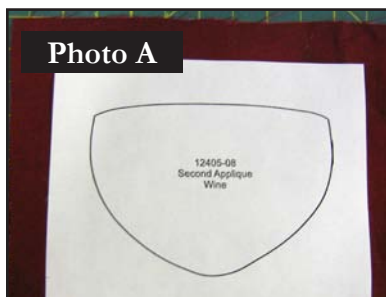


Photo 5

Tile number 8 requires two appliqué techniques—pre-cut appliqués for the background and wine, and a cut-in-place appliqué for the sheer fabric used for the wine glass. (The sheer fabric should be done as a cut-in-place appliqué because pre-cutting the sheer fabric will cause it to unravel.)

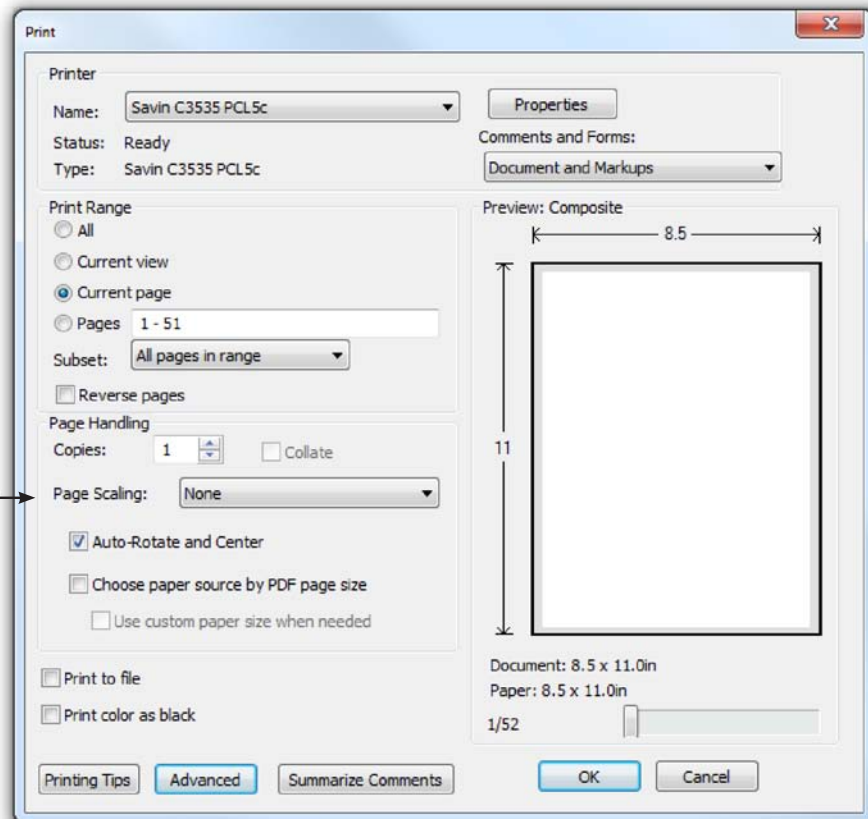
To Embroider Tile 8:

- Cut both pieces of appliqué fabric using the patterns included in this document. See **Photos A and B**
- Hoop a piece of fabric using two layers of medium weight tear-away stabilizer. See **Photo C**
- Stitch the guide stitch for the first appliqué. Place the first appliqué fabric over the guide stitch, then stitch the tack down. See **Photo C**
- Stitch the driveway, grass, and crops. (Color changes 3-5)
- Stitch the placement stitch for the wine. See **Photo D**
- Place the wine appliqué fabric, aligning it with the guide stitch. See **Photo E**
- Stitch the tackdown for the wine, the wine details, and the guide stitch for the wine glass appliqué. (Color changes 7-9) See **Photo F**
- Place a piece of sheer fabric over the guide stitch. See **Photo G**
- Stitch the glass cut line and tack down. (Color change 10) See **Photo H**
- Remove the hoop from the machine, but do not remove the fabric from the hoop. Trim the sheer fabric very close to the cut line. See **Photo I**
- Stitch the remaining color changes to complete the tile. See **Photo J**



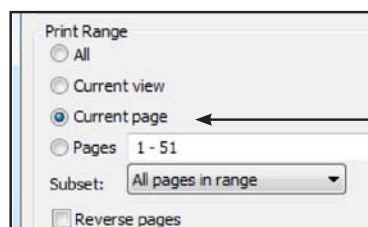
ATTENTION

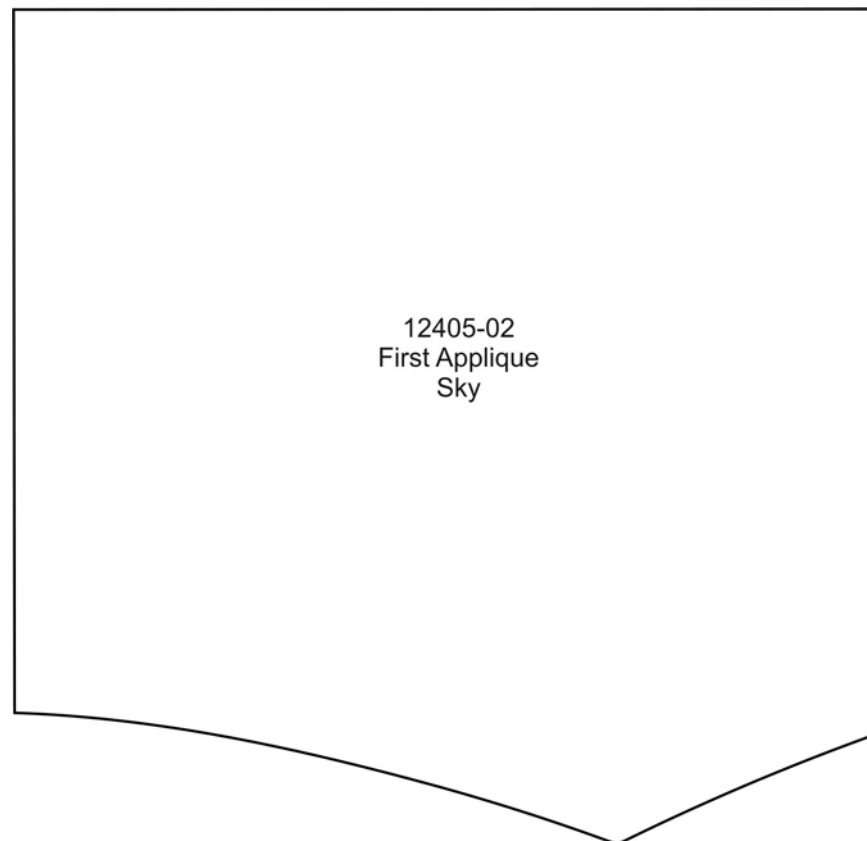
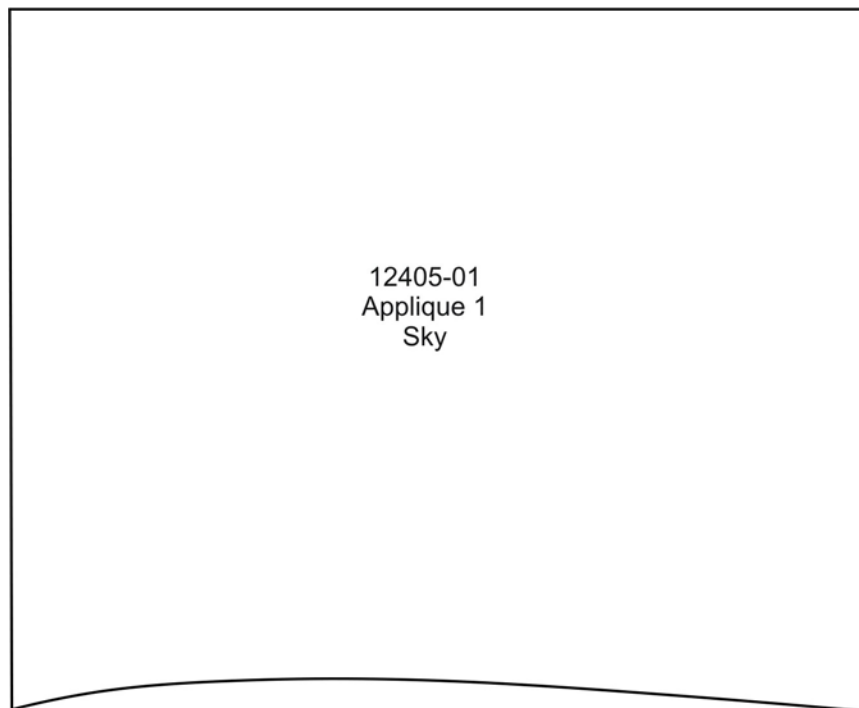
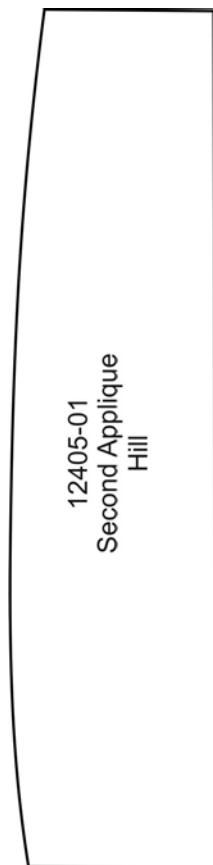
When printing this document, any page scaling or page fitting options in your print dialog box must be turned OFF or set to NONE so that your files will print out at their actual size. Images not printed at actual size will not function as intended.



TO SAVE PAPER

Only print the desired image by navigating to the image's page, go to File > Print and select "Current page" in the print dialog box. Repeat for each desired image.





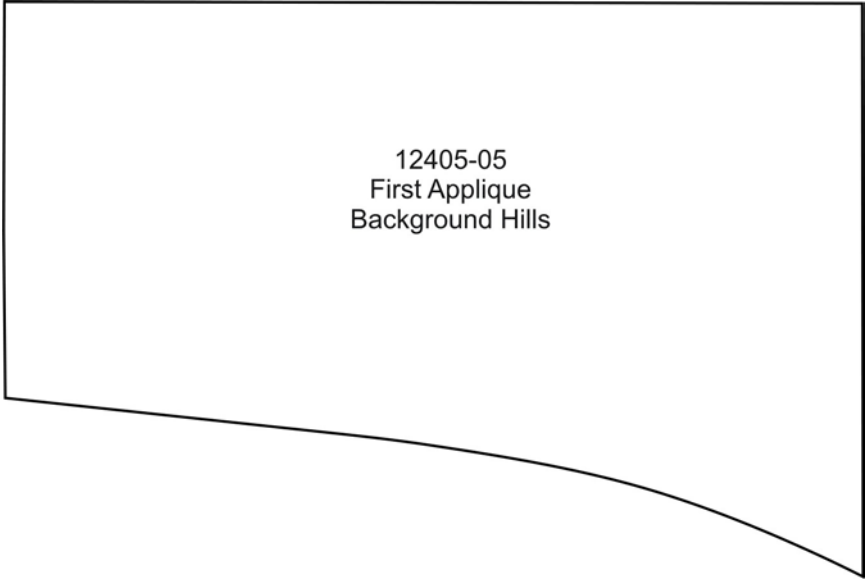
12405-03
First Applique
Sky

12405-03
Second Applique
Hill

12405-04
First Applique
Background Hills

12405-03
Third Applique
Bottle Top

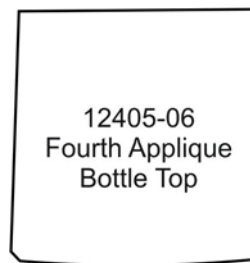
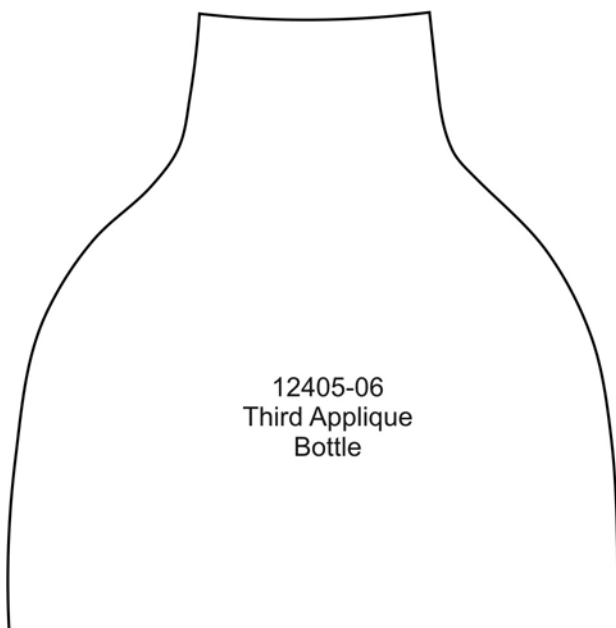
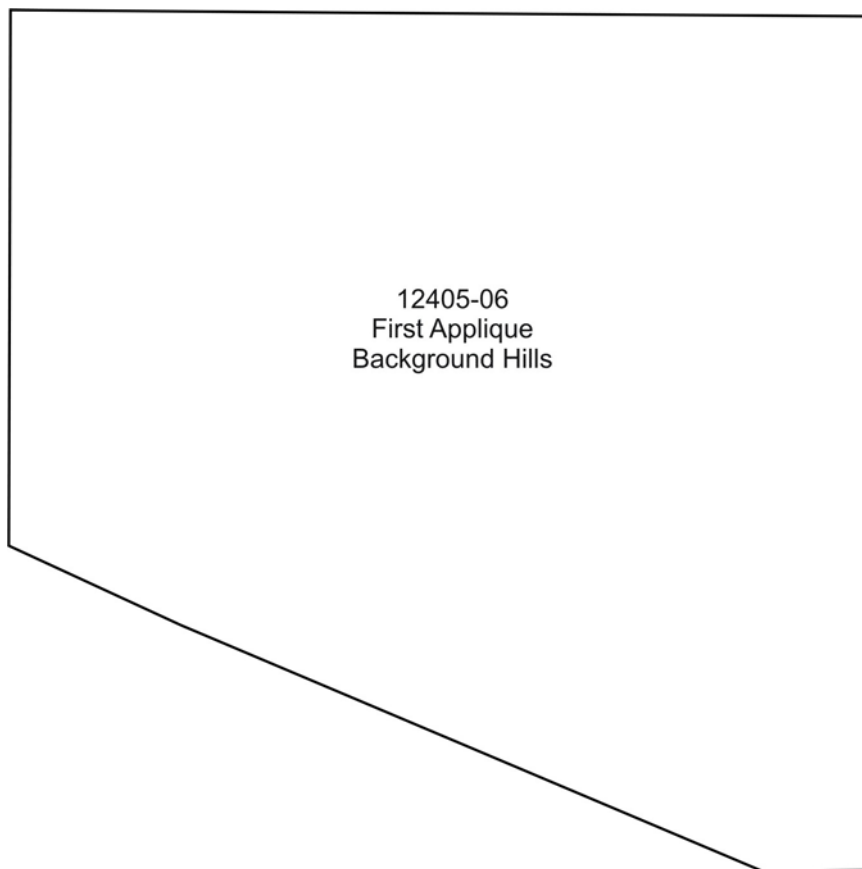
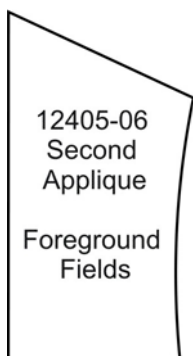
12405-04
Second Applique
Foreground Fields



12405-05
First Applique
Background Hills



12405-05
Second Applique
Foreground Fields



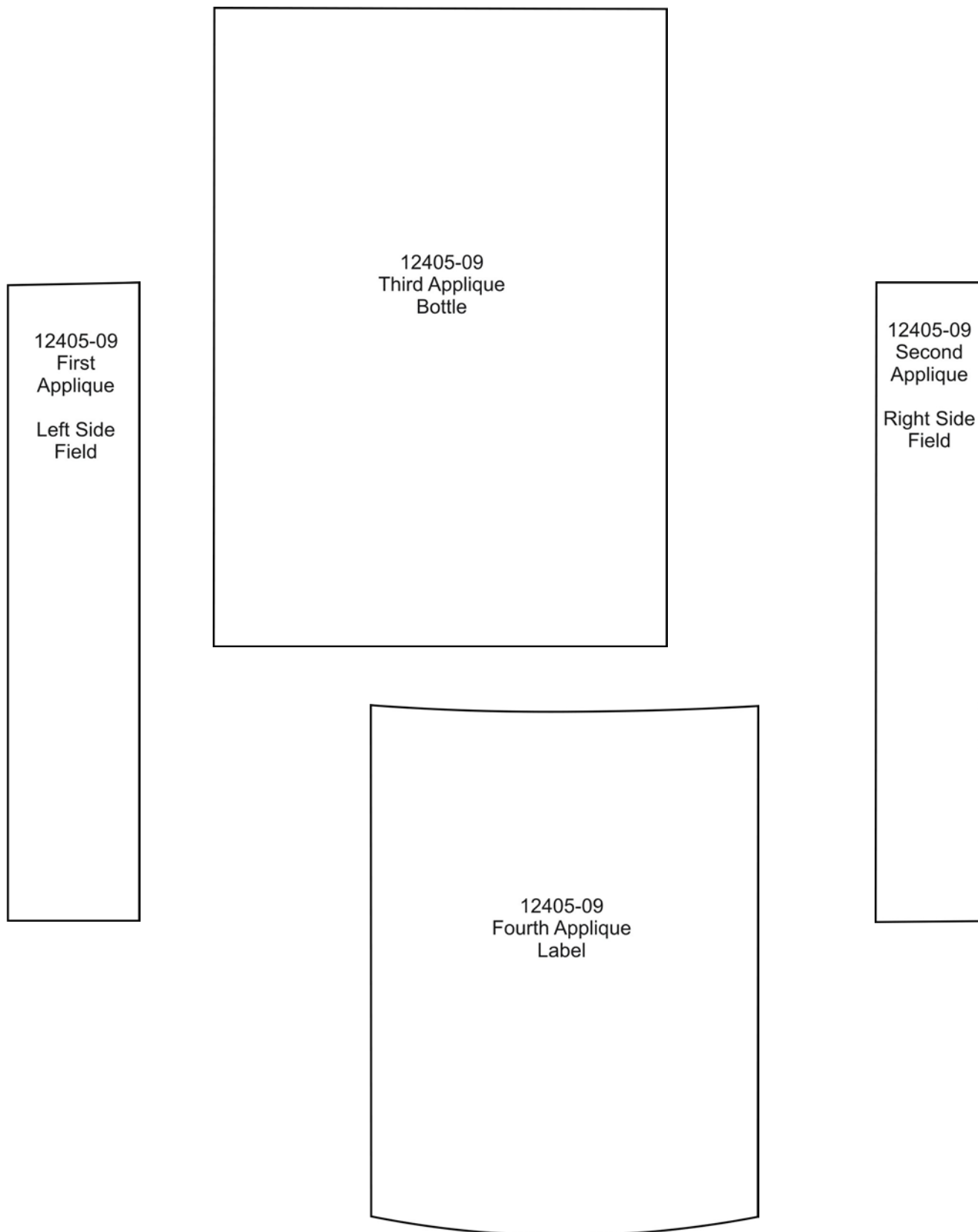
12405-07
Fields

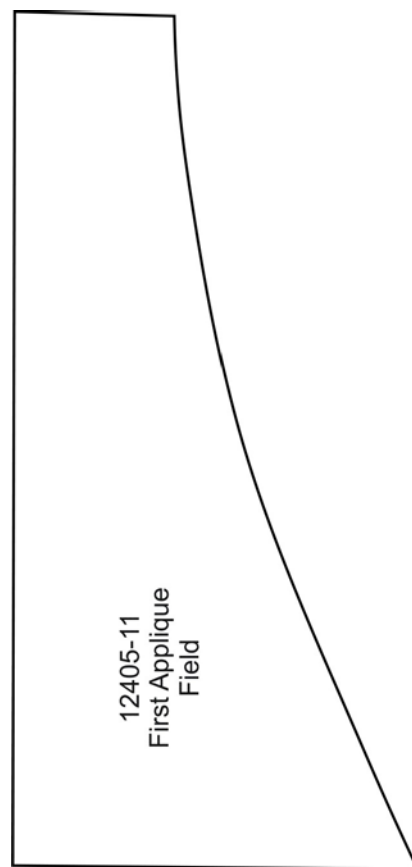
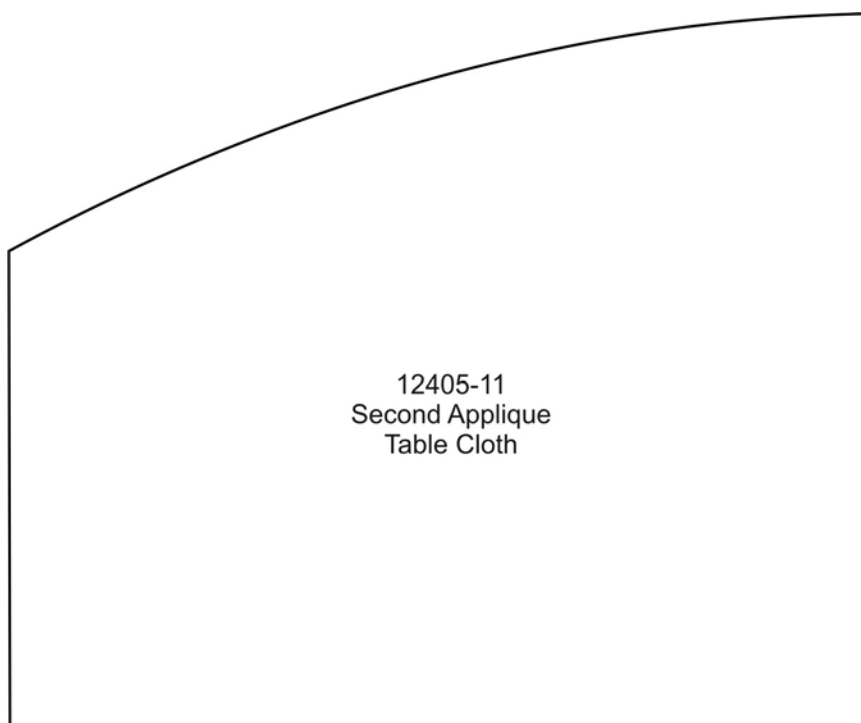
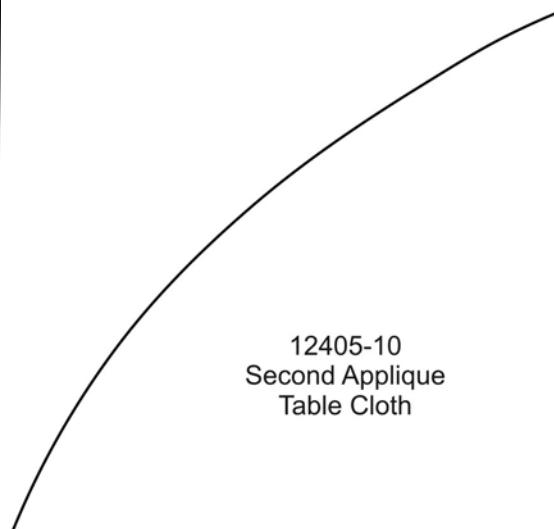
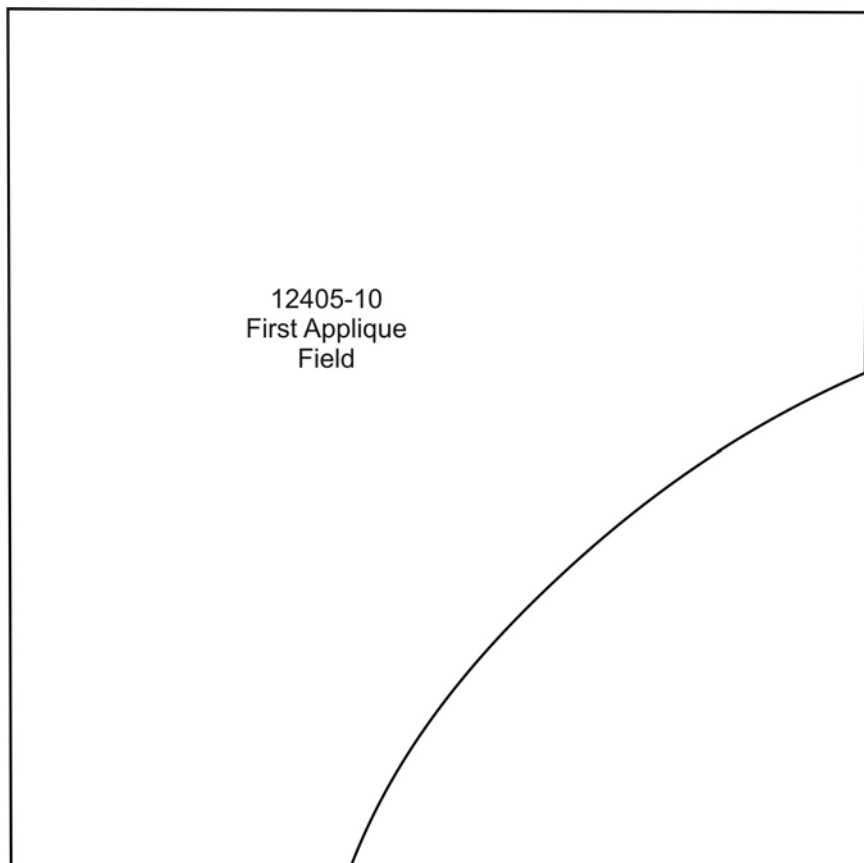


12405-08
First Applique
Fields



12405-08
Second Applique
Wine





12405-12
First Applique
Field

12405-12
Second Applique
Table Cloth

12405-12
Third Applique
Bottle