

Note: Some designs in this collection may have been created using unique specialDetails and/or techniques. To preserve design integrity when rescaling or rotating designs in your software, always rescale or rotate designs using the handles directly on-screen.

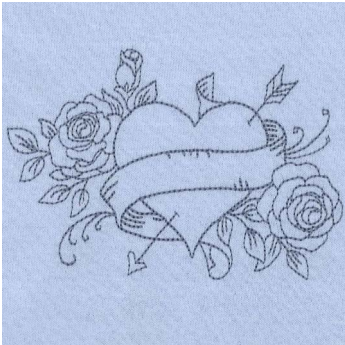

NC064 Heart & Roses

4.52 X 3.04 in.
114.81 X 77.22 mm
5,044 St.



12515-33 Heart Appliqué 2

2.35 X 3.36 in.
59.69 X 85.34 mm
4,825 St.



12381-15 Heart Banner Appliqué

4.27 X 4.10 in.
108.46 X 104.14 mm
9,065 St.



12445-13 Folk Heart

4.99 X 4.75 in.
126.75 X 120.65 mm
16,859 St.



FB427 Ribbon Heart

3.46 X 2.83 in.
87.88 X 71.88 mm
6,994 St.



12525-06 Merry Heart

4.81 X 5.28 in.
122.17 X 134.11 mm
8,279 St.



DC047 Heart Swirls

2.41 X 2.05 in.
61.21 X 52.07 mm
1,495 St.

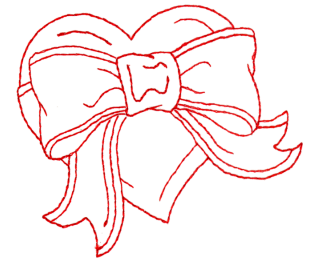

HD720 Heart Wrapped with a Ribbon

3.87 X 3.36 in.
98.30 X 85.34 mm
1,450 St.



HE733 Satin Heart 18

4.17 X 3.72 in.
105.92 X 94.49 mm
12,195 St.

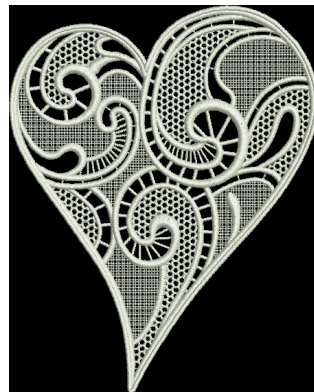

12469-11 FSL Large Heart

4.49 X 5.60 in.
114.05 X 142.24 mm
35,801 St.

Listings below indicate color sample, stitching order and suggested thread color number. Most numbers indicate Isacord thread. Colors beginning with 20501 refer to YLI Fine Metallics, 7 refer to Yenmet Metallic, 8 refer to YLI Variations Variegated Thread and 9 refer to Isacord Multicolor Variegated.

NC064 Heart & Roses

■ 1. Single Color Design..... 3953

12515-33 Heart Appliqué 2

□ 1. Heart Placement Stitch..... 0151
 ■ 2. Heart Tackdown & Red Detail 1911
 ■ 3. Tan Detail 0874

12381-15 Heart Banner Appliqué

■ 1. Pink Shading 2153
 ■ 2. Placement Stitch 2153
 ■ 3. Cut Line & Tackdown..... 2153
 ■ 4. Red Shading..... 2011

12445-13 Folk Heart

■ 1. Center Heart..... 2520
 ■ 2. Small Flowers & Leaves 2550
 ■ 3. Large Tulip & Flowers..... 2504
 ■ 4. Small Hearts & Dot Outlines..... 2520
 ■ 5. Small Tulips 2715

FB427 Ribbon Heart

■ 1. Heart..... 4240
 ■ 2. Dark Ribbon Shading 3130
 ■ 3. Light Ribbon Shading 3150

12525-06 Merry Heart Appliqué

□ 1. Heart Placement Stitch..... 0015
 □ 2. Cut Line & Tackdown..... 0015
 □ 3. Heart Left Side Placement Stitch 0015
 □ 4. Cut Line & Tackdown..... 0015
 □ 5. Heart Right Side Placement Stitch 0015
 □ 6. Cut Line & Tackdown..... 0015
 □ 7. Heart Bottom Placement Stitch 0015
 □ 8. Cut Line & Tackdown..... 0015
 □ 9. Heart Center Placement Stitch..... 0015
 □ 10. Cut Line & Tackdown..... 0015
 □ 11. Cover Stitch..... 0015

DC047 Heart Swirls

■ 1. Medium Pink Linework 2220
 ■ 2. Light Pink Linework 1840
 ■ 3. Hearts..... 1921

HD720 Heart Wrapped with a Ribbon

■ 1. Single Color Design..... 1902

HE733 Satin Heart 18

■ 1. Single Color Design..... 2320

12469-11 FSL Large Heart

□ 1. Single Color Design..... 0015

Pre-Cut Appliqué Instructions

1. Print out the necessary pages from the PDF of the appliqué pattern(s).
2. Mark the right side of the pattern pieces so you'll know which direction to lay the pattern on the fabric.
3. Lightly spray the wrong side of the pattern pieces with temporary adhesive spray and allow it to set for a few minutes.
4. Place the pattern pieces on the right side of the fabric and carefully cut them out. **PHOTO 1**
5. Sew the placement stitch on your hooped fabric. **PHOTO 2**
6. With the paper still stuck to the right side of the appliqué fabric, spray the wrong side of the fabric with temporary spray adhesive.
7. Place the fabric inside the sewing placement stitch so that it matches the stitching line, and then remove the paper pattern. **PHOTO 3**
8. Sew the tackdown. **PHOTO 4**
9. Sew the remainder of the design and repeat for any remaining pieces. **PHOTO 5**

NOTE: The patterns are sized for the designs as they were made. If you resize the design, you will need to resize the pattern the same amount. You can print out the pattern at the normal size then copy it on a copy machine at the changed size. For example, resize the designs to 80%, resize the printed pattern to 80%.

TIP: When Printing the patterns, make sure that the “Fit to page” option is **UNCHECKED** in the Print Dialog Box. If this option is checked the printed patterns will not be actual size.

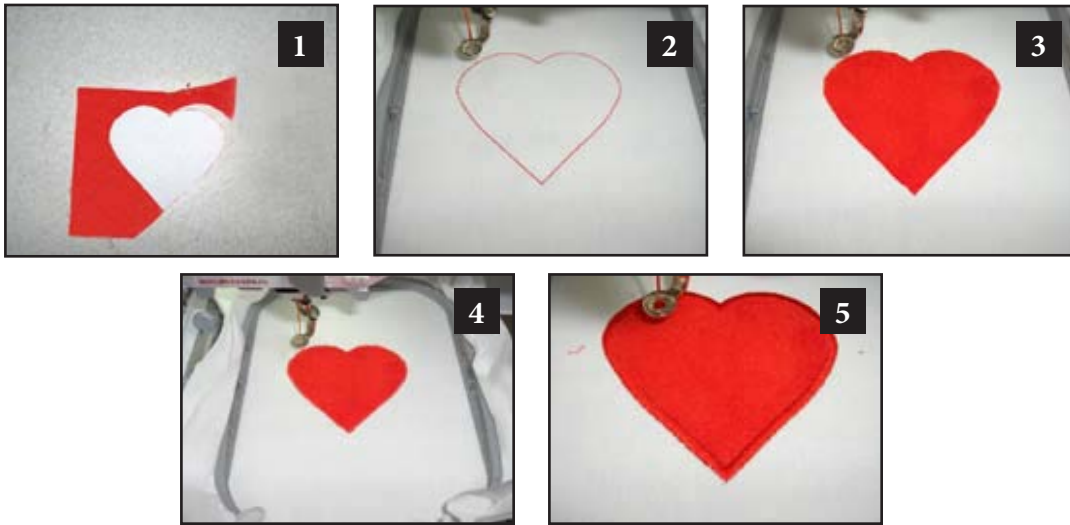

ATTENTION

When printing this document, any page scaling or page fitting options in your print dialog box must be turned OFF or set to NONE so that your files will print out at their actual size. Images not printed at actual size will not function as intended.

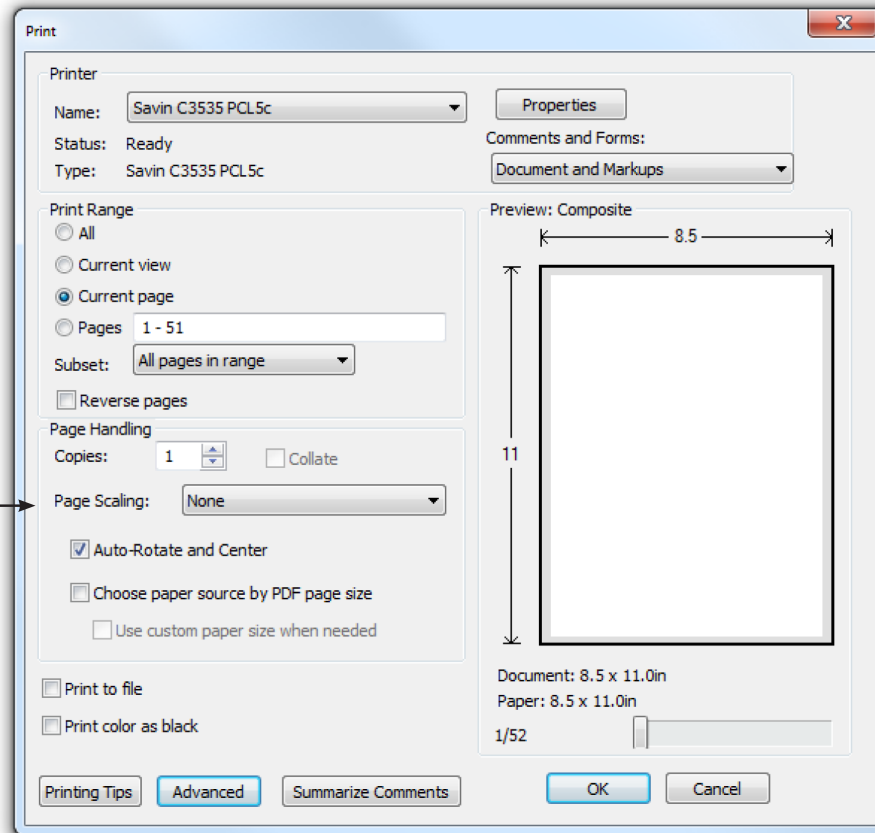

TO SAVE PAPER

Only print the desired image by navigating to the image's page, go to File > Print and select "Current page" in the print dialog box. Repeat for each desired image.

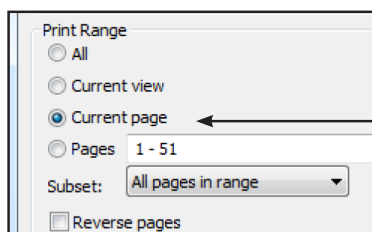

Designs in this collection use loose-edge appliqué. This means that the edges of the appliqué fabric are not tacked down, the tack down is slightly inside the edge so that the edge is left loose and able to fray naturally.

1. Print out the necessary pages from the PDF of the appliqué pattern(s).
2. Loosely cut patterns out of paper. **(Photo 1)**
3. Lightly spray the wrong side of the pattern pieces with temporary spray adhesive and allow it to set for a few minutes.
4. Place the pattern pieces on the right side of the fabric and carefully cut them out just outside the drawn line. **(Photo 2)**
5. Sew the pattern placement stitch on your hooped fabric. **(Photo 3)**
 - *NOTE: When using this method of appliqué the pattern placement stitch should blend with your background fabric. Photo 3 uses a contrasting color for photography purposes only.*
6. With the paper still stuck to the right side of the appliqué fabric, spray the wrong side of the fabric with temporary spray adhesive and allow it to set for a few minutes.
7. Place the fabric over the sewn guide stitch so that it covers the sewn stitching line then remove the paper pattern. **(Photo 4)**
8. Sew the tack down. **(Photo 5)**
9. Sew the rest of the design and repeat for any remaining pieces. **(Photo 6)**

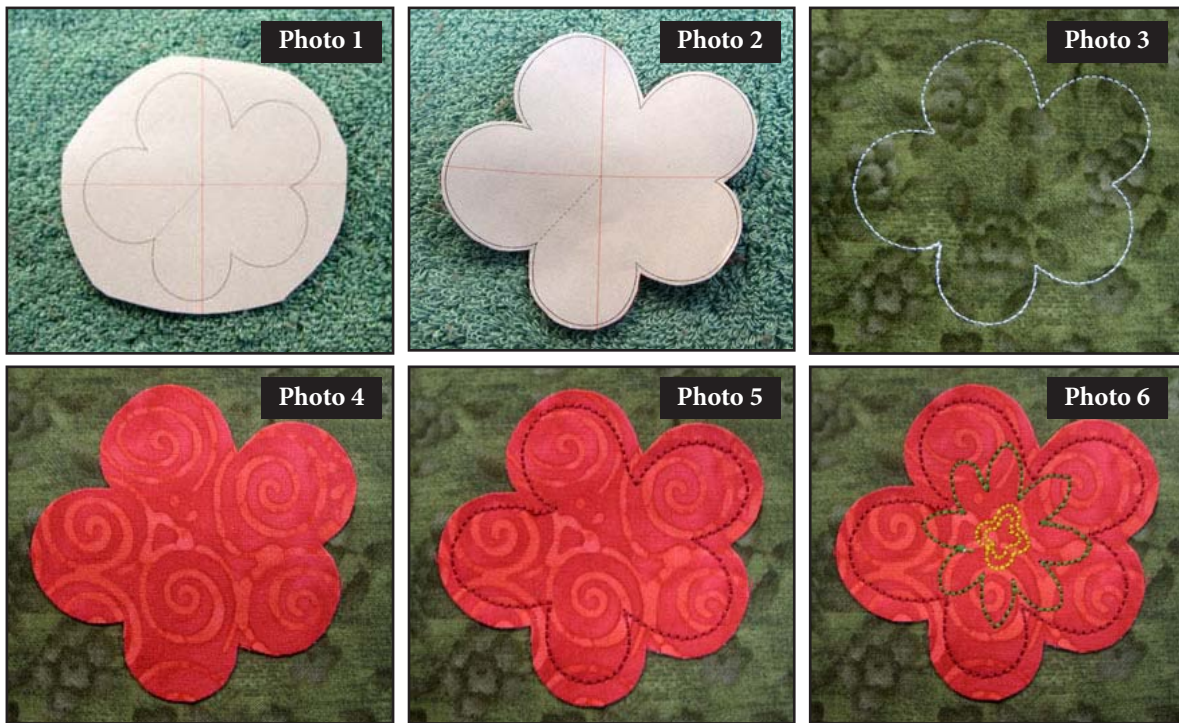

Note: Some of the appliqué pieces in this collection are attached to the design by a looser density stitch rather than the traditional full satin stitch. This means that the edges of the appliqué may begin to fray, creating a more informal and natural look. The collection was created with this effect in mind. If you wish the appliqué pieces to keep a sharper edge, you will need to select the appliqué fabric with this in mind. You may also choose to apply a non-fray treatment to the appliqué fabric before attaching it, or use a sticky backing on the appliqué fabric before cutting out the appliqué pattern piece.

General Freestanding Lace Guidelines

Supplies:

Embroidery Thread:

- Use the same embroidery thread in the bobbin as the needle.

Needles:

- Use an Organ 80/12 Titanium needle for extended needle life.

Stabilizer:

- Use water-soluble stabilizer or film water-soluble stabilizer.

Handy Hints:

For Stiffer Lace:

- DO NOT rinse away all of the stabilizer for a “stiffer” lace. Note that the thread may appear a shade darker if stabilizer is not removed completely.
- If you happen to wash too much out, easily re-stiffen by diluting some stabilizer scraps in water and dipping the item in the solution.

For Very Soft Lace:

- Cut away excess stabilizer. Remove remaining stabilizer by rinsing under warm running water until all traces of the stabilizer are gone. **Note:** If lace should become too limp to work with, dissolve stabilizer scraps in warm water and apply to the lace.

Drying Lace:

- The lace looks best when left to dry completely. Lay lace piece with right side down to dry. This will minimize the tendency for the lace to curl. Be sure to flatten the piece out entirely and allow ample time to dry.

General Instructions

1. Hoop two layers of water-soluble stabilizer.
2. Attach the hoop to the machine and select the design of your choice.
3. Stitch the design.
4. Remove the hoop from the machine and the design from the hoop. Trim excess stabilizer from the design.
5. Rinse away remaining stabilizer and allow it to dry.

Handy Hints:

For 3D Lace Projects:

- Rinsing out lace with very hot water can cause wrinkles in some fabrics after it has been embroidered. To prevent this, pre-shrink cotton fabric by washing it in warm water and drying it in a dryer.
- If item becomes too limp to work with, iron the appliqué pieces on the wrong side while applying spray starch. After ironing, spray again with starch and allow to dry completely. This will stiffen the lace pieces nicely and aid in construction.
- A pair of tweezers, hemostats, stiletto or a tiny crochet hook can be extremely helpful when inserting the buttonettes into the eyelets. (Please see **Diagram 1** for explanation of “buttonette” and “eyelet”.)
- Insert the tip of the tweezers, hemostats or crochet hook into the eyelet, grasp the buttonette and pull through the eyelet. Or a stiletto could be used to push the buttonette through the eyelet.

Diagram 1

