



#51308
1 DESIGN

FREESTANDING *Twilight Witch's Hat*



It is a violation of Copyright law to make and distribute copies of electronic designs or artwork.
Electronic designs are licensed to the original purchaser for use at one location. ©2022 OESD, LLC. All rights reserved.

MATERIALS



Isacord Thread Colors

0138 Heavy Storm
0142 Sterling
0811 Candlelight

1114 Clay
1260 ISA TEXLIGHT
3045 Cachet

4174 Charcoal
5722 Green Grass

*** Project instructions included after design list.**

Note: One spool of 1000 meter thread is adequate for the project unless otherwise noted.

Table of Contents

Designs.....	03
Collection Supplies	09
Summary	10
Embroidery.....	11
Punch Tool Guides.....	20
Applique Patterns.....	22
Mirrored Patterns.....	26

DESIGNS



Note: Some designs in this collection may have been created using unique special stitches and/or techniques. To preserve design integrity when rescaling or rotating designs in your software, always rescale or rotate designs using the handles directly on-screen.

FABRIC REQUIRED



51308-01 Hat Part 1 FSA

Size Inches: Size mm: Stitch Count:
9.74 X 3.96 in. 247.5 X 100.6 mm 22881 St.

- 1. Orange Fabric Placement Stitch 0138
- 2. Cut Line and Tackdown 0138
- 3. Black Fabric Placement Stitch..... 0138
- 4. Cut Line and Tackdown 0138
- 5. Cover Stitch and Lace 0138
- 6. Orange Detail 1114
- 7. Light Gray Detail..... 0142
- 8. Glowing Stars 1260

FABRIC REQUIRED

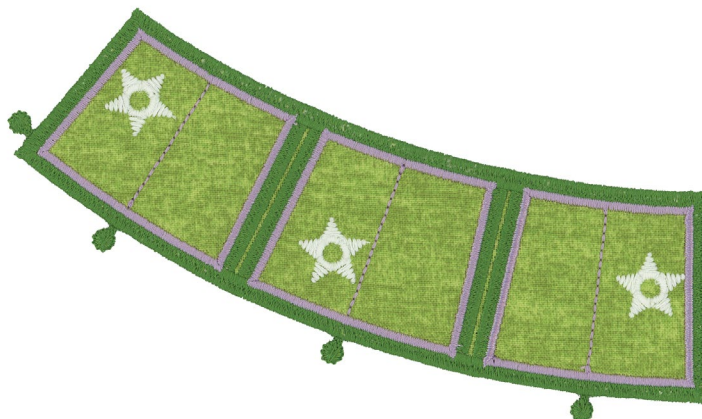

51308-02 Hat Part 2 FSA

Size Inches: Size mm: Stitch Count:
5.99 X 3.60 in. 152.1 X 91.5 mm 11742 St.

- 1. Green Fabric Placement Stitch 5722
- 2. Cut Line and Tackdown 5722
- 3. Cover Stitch and Lace 5722
- 4. Purple Detail..... 3045
- 5. Glowing Stars 1260

DESIGNS



Note: Some designs in this collection may have been created using unique special stitches and/or techniques. To preserve design integrity when rescaling or rotating designs in your software, always rescale or rotate designs using the handles directly on-screen.

FABRIC REQUIRED

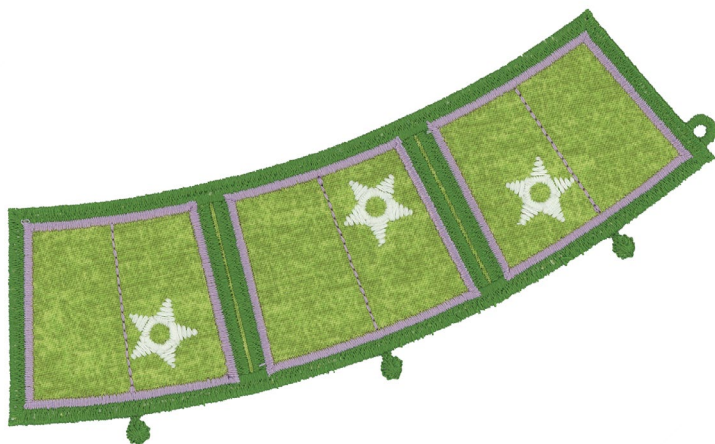

51308-03 Hat Part 3 FSA

Size Inches: 5.95 X 3.60 in. Size mm: 151.2 X 91.3 mm Stitch Count: 11818 St.

- 1. Green Fabric Placement Stitch 5722
- 2. Cut Line and Tackdown 5722
- 3. Cover Stitch and Lace 5722
- 4. Purple Detail 3045
- 5. Glowing Stars 1260

FABRIC REQUIRED



51308-04 Hat Part 4 FSA

Size Inches: 6.43 X 2.17 in. Size mm: 163.4 X 55.1 mm Stitch Count: 9843 St.

- 1. Gray Fabric Placement Stitch 1114
- 2. Cut Line and Tackdown 1114
- 3. Orange Buttonettes 1114
- 4. Cover Stitch and Lace 0138
- 5. Charcoal Detail 4174
- 6. Glowing Stars 1260

DESIGNS



Note: Some designs in this collection may have been created using unique special stitches and/or techniques. To preserve design integrity when rescaling or rotating designs in your software, always rescale or rotate designs using the handles directly on-screen.

FABRIC REQUIRED



51308-05 Hat Part 5 FSA

Size Inches: 5.50 X 1.74 in. Size mm: 139.7 X 44.2 mm Stitch Count: 8280 St.

- 1. Purple Fabric Placement Stitch 4174
- 2. Cut Line and Tackdown 4174
- 3. Charcoal Buttonettes 4174
- 4. Cover Stitch and Lace 0138
- 5. Purple Detail 3045
- 6. Glowing Stars 1260

FABRIC REQUIRED



51308-06 Hat Part 6 FSA

Size Inches: 4.92 X 1.47 in. Size mm: 124.9 X 37.3 mm Stitch Count: 6625 St.

- 1. Black Fabric Placement Stitch 3045
- 2. Cut Line and Tackdown 3045
- 3. Purple Buttonettes 3045
- 4. Cover Stitch and Lace 0138
- 5. Light Gray Detail 0142
- 6. Glowing Star 1260

DESIGNS



Note: Some designs in this collection may have been created using unique special stitches and/or techniques. To preserve design integrity when rescaling or rotating designs in your software, always rescale or rotate designs using the handles directly on-screen.

FABRIC REQUIRED



51308-07 Hat Part 7 FSA

Size Inches: Size mm: Stitch Count:
4.21 X 2.12 in. 107.0 X 53.7 mm 6708 St.

- 1. Orange Fabric Placement Stitch 0142
- 2. Cut Line and Tackdown 0142
- 3. Light Gray Buttonettes..... 0142
- 4. Cover Stitch and Lace 0138
- 5. Orange Detail 1114
- 6. Glowing Stars 1260

FABRIC REQUIRED

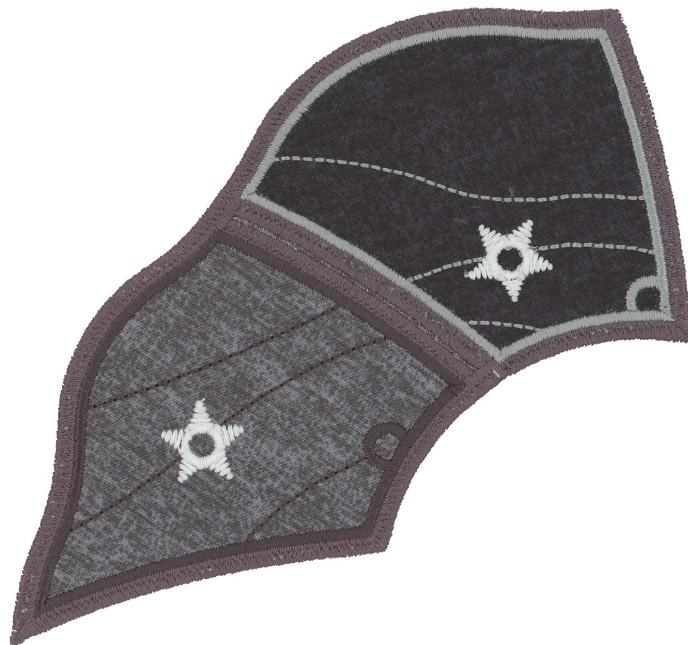

51308-08 Brim Part 1 FSA

Size Inches: Size mm: Stitch Count:
4.90 X 4.17 in. 124.6 X 105.9 mm 10716 St.

- 1. Gray Fabric Placement Stitch..... 0138
- 2. Cut Line and Tackdown 0138
- 3. Black Fabric Placement Stitch..... 0138
- 4. Cut Line and Tackdown 0138
- 5. Cover Stitch and Lace 0138
- 6. Charcoal Detail..... 4174
- 7. Light Gray Detail..... 0142
- 8. Glowing Stars 1260

DESIGNS



Note: Some designs in this collection may have been created using unique special stitches and/or techniques. To preserve design integrity when rescaling or rotating designs in your software, always rescale or rotate designs using the handles directly on-screen.

FABRIC REQUIRED

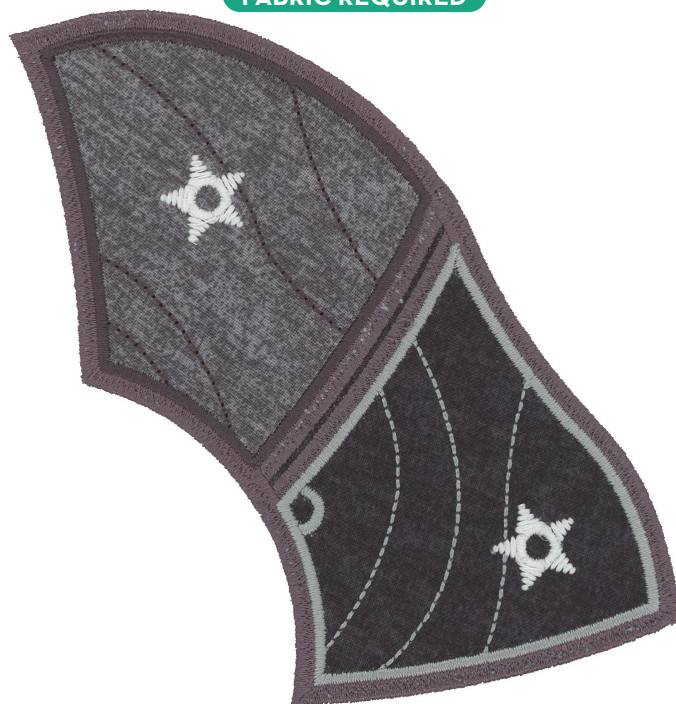

51308-09 Brim Part 2 FSA

Size Inches: 4.74 X 4.26 in. Size mm: 120.4 X 108.1 mm Stitch Count: 10629 St.

- 1. Black Fabric Placement Stitch..... 0138
- 2. Cut Line and Tackdown 0138
- 3. Gray Fabric Placement Stitch..... 0138
- 4. Cut Line and Tackdown 0138
- 5. Cover Stitch and Lace 0138
- 6. Light Gray Detail..... 0142
- 7. Charcoal Detail..... 4174
- 8. Glowing Stars 1260



51308-10 Moon FSL

Size Inches: 3.61 X 2.72 in. Size mm: 91.8 X 69.2 mm Stitch Count: 9450 St.

- 1. Single Color Design.....0811

DESIGNS



Note: Some designs in this collection may have been created using unique special stitches and/or techniques. To preserve design integrity when rescaling or rotating designs in your software, always rescale or rotate designs using the handles directly on-screen.

51308-11 Stars FSL



Size Inches: Size mm: Stitch Count:
5.34 X 2.00 in. 135.6 X 50.8 mm 8890 St.

- 1. Purple Lace 3045
- 2. Orange Lace..... 1114
- 3. Yellow Lace0811

MATERIALS



Stabilizers

- OESD AquaMesh WashAway
- OESD BadgeMaster WashAway
- OESD StabilStick CutAway

Fabrics/Textiles

- Orange quilter's cotton
 - (1) 8" x 3"
 - (1) 3" x 4.5"
- Black quilter's cotton
 - (1) 10" x 3"
 - (1) 5" x 2"
 - (4) 4" x 4"
- Green quilter's cotton
 - (2) 7" x 3"
- Gray quilter's cotton
 - (1) 7" x 3"
 - (4) 4" x 4"
- Purple quilter's cotton
 - (1) 6" x 2"

Notion & Tools

- OESD Alligator Clamps
- OESD Button Clips
- OESD Expert Embroidery Tape TearAway
- OESD Expert Embroidery Tape WashAway
- OESD Perfect Punch Tool
- OESD Perfect Embroidery Press Cloth
- Embroidery Needles Sharp 75/11

Isacord Thread Colors

- Per thread chart
- Optional - Monofilament Thread (invisible thread)

SUMMARY



Fabrics Required

- | | |
|---|-----------------------|
| 01 - orange - 8" x 3"
black 10" x 3" | 07 - orange 3" x 4.5" |
| 02 - green 7" x 3" | 08 - black 4" x 4" |
| 03 - green 7" x 3" | gray 4" x 4" |
| 04 - gray 7" x 3" | requires 2 designs |
| 05 - purple 6" x 2" | 09 - black 4" x 4" |
| 06 - black 5" x 2" | gray 4" x 4" |
| | requires 2 designs |



Completed Size: 7H x 9W x 9D

51308-01

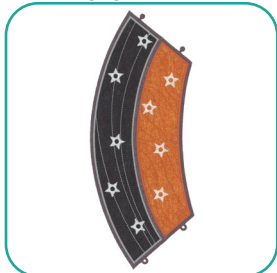

Requires 1 Design

51308-02

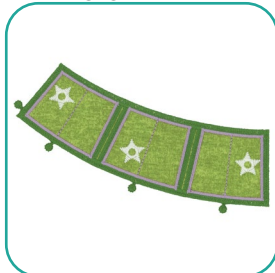

Requires 1 Design

51308-03

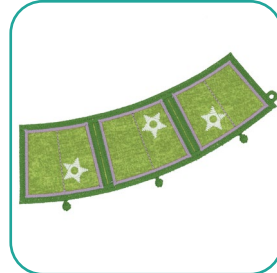

Requires 1 Design

51308-04



Requires 1 Design

51308-05

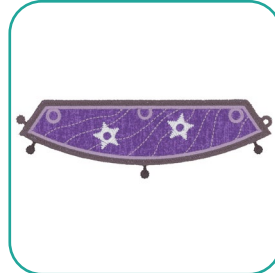

Requires 1 Design

51308-06

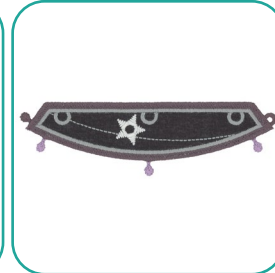

Requires 1 Design

51308-07

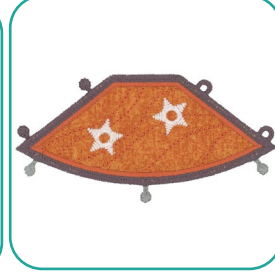

Requires 1 Design

51308-08



Requires 2 Designs

51308-09

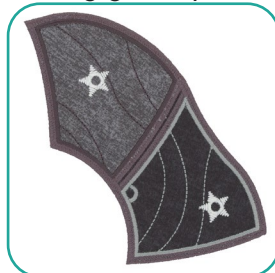

Requires 2 Designs

51308-10



Requires 1 Design

51308-11



Requires 1 Design

EMBROIDERY



General Instructions

The applique instructions, included in the collection, are general instructions. For demonstration purposes, a sample design that best demonstrates the technique is shown.

Fabric and thread requirements will vary by design, but the general technique is the same.

Note: Some thread colors in instructions have been changed or digitally enhanced for better visibility.

□ Step 1

- Hoop one layer of AquaMesh and one layer of BadgeMaster for all designs.



□ Step 2

- Adhere two layers of StabilStick CutAway to the wrong side of all applique fabrics, to provide stiffness to the finished structure.



EMBROIDERY



□ Step 3

- Load selected design into the machine.
- Example design is 51308-01.
- Thread the machine per the thread chart.
- Stitch Machine Step 1, Orange Fabric Placement Stitch.

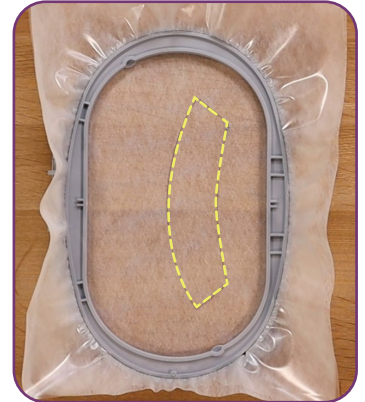

□ Step 4

- Remove the hoop from the machine, but NOT the project from the hoop.
- Place the hoop on a flat surface.
- Completely cover the placement stitch with the orange prepared fabric.
- Tape in place to secure.

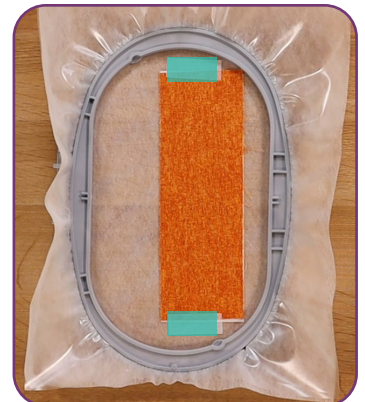

□ Step 5

- Return the hoop to the machine.
- Stitch Machine Step 2, Cut Line and Tackdown.



EMBROIDERY



□ Step 6

- Remove the hoop from the machine, but NOT the project from the hoop.
- Trim the excess fabric as close to the cut line as possible. If the outermost stitches (cut line) are cut, the inner stitches (tackdown) will hold the applique in place.
- Tip: If the AquaMesh is cut or a hole is created while trimming the fabric, use OESD Expert Embroidery Tape WashAway as a patch.



□ Step 7

- Return the hoop to the machine.
- Stitch Machine Step 3, Black Fabric Placement Stitch.

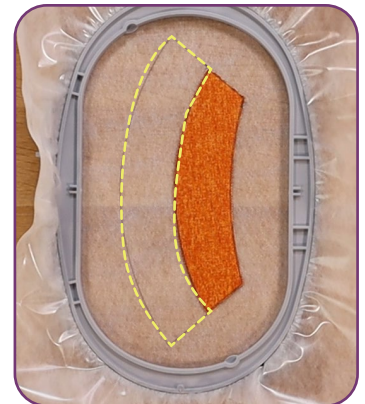

□ Step 8

- Remove the hoop from the machine, but NOT the project from the hoop.
- Place the hoop on a flat surface.
- Completely cover the placement stitch with the black prepared fabric.
- Tape in place to secure.

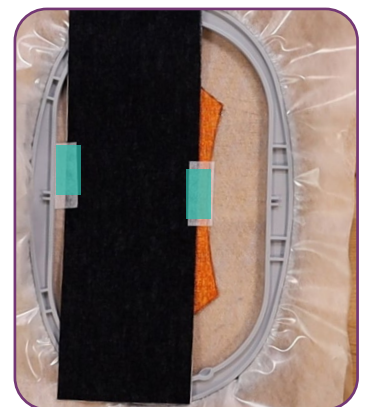

EMBROIDERY



Step 9

- Return the hoop to the machine.
- Stitch Machine Step 4, Cut Line and Tackdown.



Step 10

- Remove the hoop from the machine, but NOT the project from the hoop.
- Trim the excess fabric as close to the cut line as possible.
- Stitch Machine Step 5, Cover Stitch and Lace.
- Match the bobbin thread to the upper thread.



Step 11

- Note: Matching the bobbin thread is only necessary on the cover stitch and lace machine steps.
- Return the hoop to the machine and stitch the remaining machine steps, according to the thread chart.
- When the design is complete, remove the project from the hoop and trim the stabilizer 1/4" - 1/2" outside the design.



EMBROIDERY



□ Step 12

- Rinse each piece in warm running water until the design is only slightly tacky.
- Place right side down on a non-stick surface to dry. Parchment paper or a cooling rack work well to prevent curling. Dry completely.
- Once dry, press right side down on a Perfect Embroidery Press Cloth.



□ Step 13

- Use the OESD Punch Tool fitted with the 3mm tip to create the eyelets indicated in the diagram.

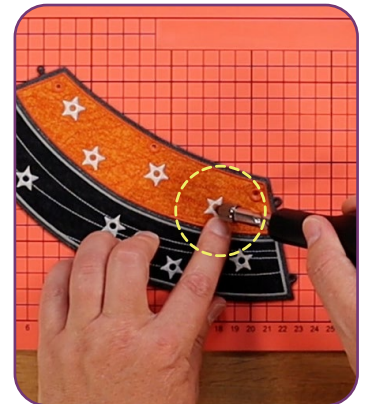

□ Step 14

- To connect, line up the pieces Brim Part 1 FSA (51308-08) and Brim Part 2 FSA (51308-09), right sides up.
- Thread the sewing machine with matching thread in the top and bobbin.
- Stitch together using a multi-step zigzag stitch (also known as a serpentine stitch). Backstitch at the beginning and end to secure. Trim thread tails.
- TIP: An open toe or edge stitch foot is helpful.

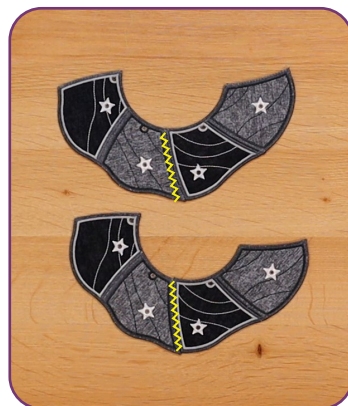

EMBROIDERY



Step 15

- Align and stitch, Hat Part 2 FSA (51308-02) and Hat Part 3 FSA (51308-03) as shown.

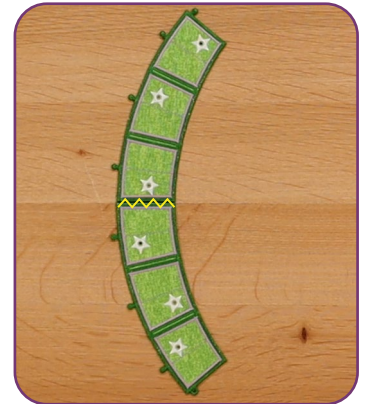

Step 16

- Align and stitch, green Hat Part 2 FSA and green Hat Part 3 FSA with Hat Part 1 FSA (51308-01) as shown.
- Tip: Invisible thread is recommended as the top thread in this step between the green and gray coverstitches.



Step 17

- Match the eyelets in Hat Part 1 FSA (51308-01) to the buttonettes in Hat Part 4 (51308-04). Pull each buttonette through the corresponding eyelet. Attach a button clip to hold the eyelet in place temporarily when needed.

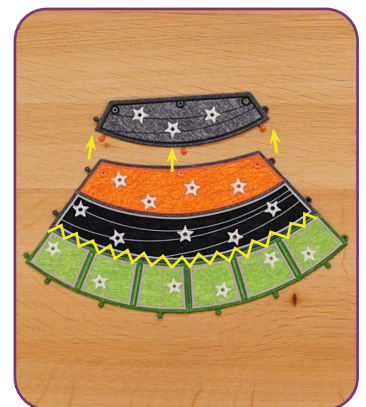

EMBROIDERY



Step 18

- Match the three eyelets in Hat Part 4 FSA (51308-04) to the three buttonettes in Hat Part 5 FSA (51308-05). Pull each buttonette through the corresponding eyelet.



Step 19

- Match the three eyelets in Hat Part 5 FSA (51308-05) to the three buttonettes in Hat Part 6 FSA (51308-06). Pull each buttonette through the corresponding eyelet.

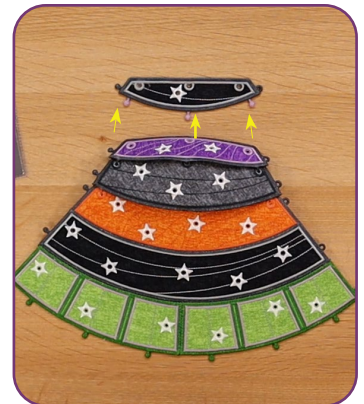

Step 20

- Match the three eyelets in Hat Part 6 FSA (51308-06) to the three buttonettes in Hat Part 7 FSA (51308-07). Pull each buttonette through the corresponding eyelet.



EMBROIDERY



Step 21

- Take the top of the witch's hat and gently create a cone shape. Attach the back eyelets to the corresponding buttonettes. Attach a button clip to hold the eyelet in place temporarily when needed.

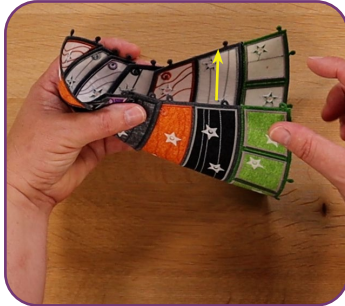

Step 22

- Match the bottom buttonettes of the witch's hat to the eyelets on the witch's brim. Pull each buttonette through the corresponding eyelet.
- Attach the top and bottom buttonettes of the Moon FSL (51308-10) to the star eyelets on the front of the hat.



Step 23

- Finishing Touches
- Attach FSL stars with glue to embellish.
- Add tea lights or pixie lights to create a glow.



GENERAL FREESTANDING LACE GUIDE



Stabilizer

- OESD AquaMesh
- OESD BadgeMaster

Notion/Tools

- 80/12 Embroidery Ballpoint Titanium needle for extended needle life
- OESD Alligator Clamps
- OESD Button Clips
- OESD Perfect Point and Press Tool

Isacord Thread Colors

- All OESD designs are digitized with Isacord 40 wt. polyester thread as the top thread and in the bobbin.
- Refer to the thread chart for color specifications.
- Match bobbin thread color to the top thread.

Instructions

Step 1 - Hoop

For FSL structures, hoop one layer of OESD AquaMesh and one layer of OESD BadgeMaster. BadgeMaster contains more starch so, combined with the AquaMesh, the lace is more rigid.

For other FSL, where a softer lace is desired, hoop two layers of AquaMesh.

Step 2 - Embroider

Stitch the design per the thread chart with matching thread in the bobbin at each color change.

When complete, remove from the hoop and trim away excess stabilizer about 1/4"-1/2" from the stitching.

Step 3 - Rinse

Rinse remaining stabilizer out in warm running water.

For stiffer lace and FSL structures, DO NOT rinse away all of the stabilizer. The lace should be just slightly tacky.

For softer lace, rinse until all traces of the stabilizer is removed.

Step 4 - Dry

Lay right side down flat on a non-stick surface, such as a cookie rack, parchment paper or Teflon sheet. This minimizes the tendency for the lace to curl.

Let the pieces dry completely before proceeding with any assembly.

Step 5 - Press

Once completely dry, press right side down on a OESD Perfect Embroidery Press Cloth.

Step 6 - Assemble Structure

Note: Specific assembly instructions for a design/collection may be found in the thread chart pdf following the individual design color charts.

Lace must be COMPLETELY DRY before assembly. Wetting the buttonettes or eyelets to assemble is not recommended and may result in them stretching and coming "unbuttoned" when dry.

Use a pair of OESD Alligator Clamps to insert the buttonettes into the eyelets. Insert the tip of the OESD Alligator Clamps into the eyelet, grasp the buttonette and pull through the eyelet. Alternatively, use a stiletto or tweezers to push the buttonette through the eyelet.

Helpful Tips

Limp Lace

If the design is not stiff enough, press the lace pieces on the wrong side while applying spray starch. After ironing, spray again with starch and allow to dry completely. This will stiffen the lace pieces nicely and aid in construction. Or easily re-stiffen by diluting some stabilizer scraps in water (or use liquid starch) and dipping the item in the solution. Lay flat to dry.

Eyelets Too Small

If any of the eyelets appear closed or too small to penetrate with Alligator Clamps, they may be stretched by inserting the small end of the OESD Perfect Point and Press Tool into the eyelet opening and stretching it open wide enough to accommodate the OESD Alligator Clamps.

Button Clips

During the assembly process, some structures pull on buttonettes that have already been inserted and could pull them out altogether. Putting a Button Clip on the assembled buttonette will keep it in position during the assembly process.

Remove the Button Clips when the assembly is complete.

Alternative Construction Option

In some cases, the buttonettes may be pulled to the inside of a project, instead of being visible on the outside.

Insert the OESD Alligator Clamps through the eyelet from the wrong, or inside, of the lace and grasp the corresponding buttonette. Pull the buttonette to the wrong side of the lace.

Pulling the buttonettes to the inside may cause stress on the ones already done. Button clips may be placed on the completed buttonette(s) to prevent them from pulling out of the eyelet.

- = 2 MM
- = 3 MM
- = 4 MM

PUNCH TOOL GUIDES



51308-01

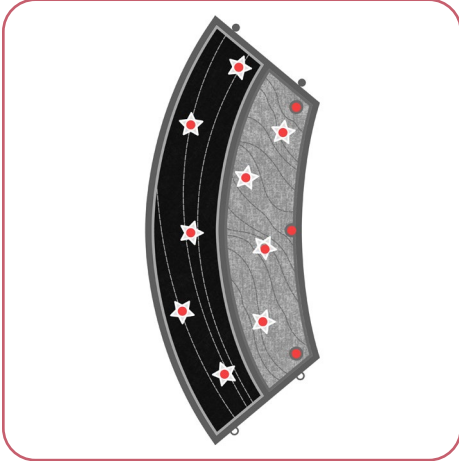

51308-02

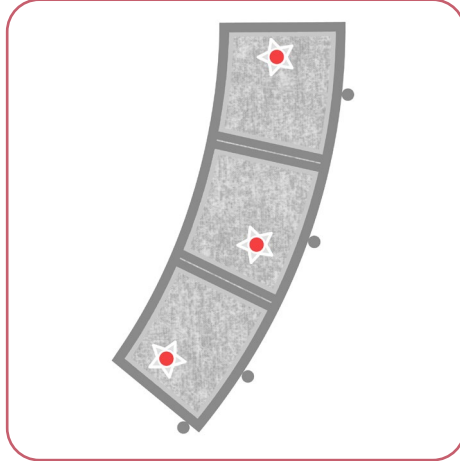

51308-03

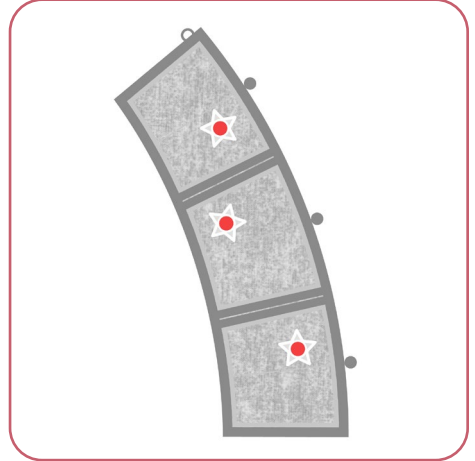

51308-04



51308-05

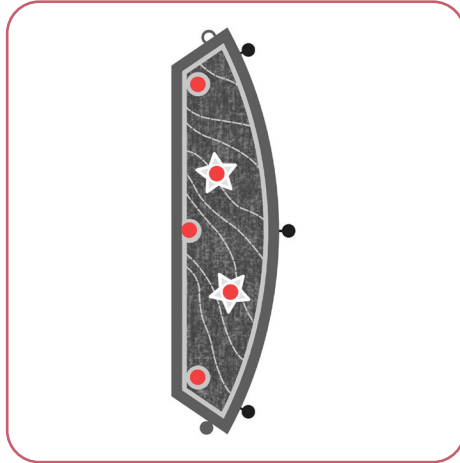

51308-06

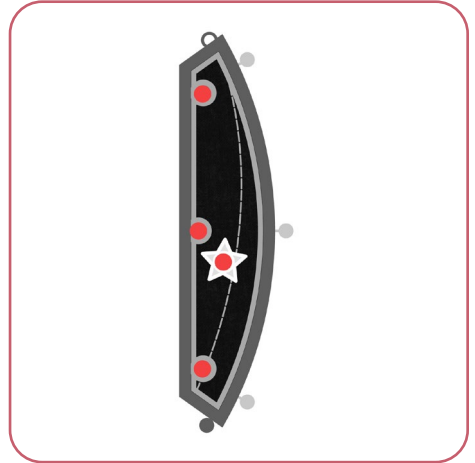

51308-07

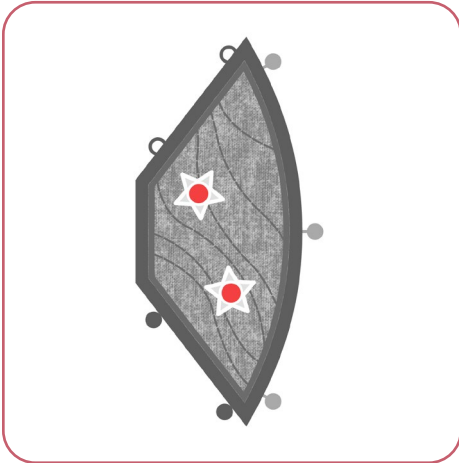

51308-08



51308-09

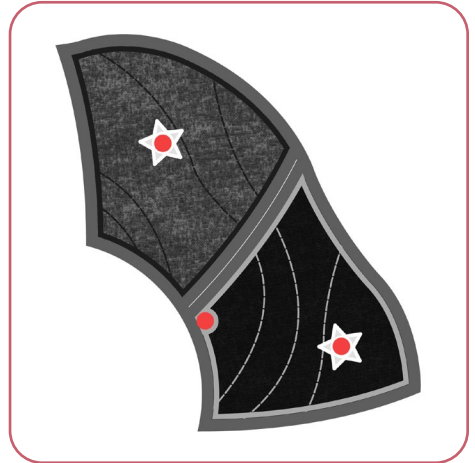

PRINTING INSTRUCTIONS



ATTENTION

When printing this document, any page scaling or page fitting options in your print dialog box must be turned OFF or set to NONE so that your files will print out at their actual size. Images not printed at actual size will not function as intended.

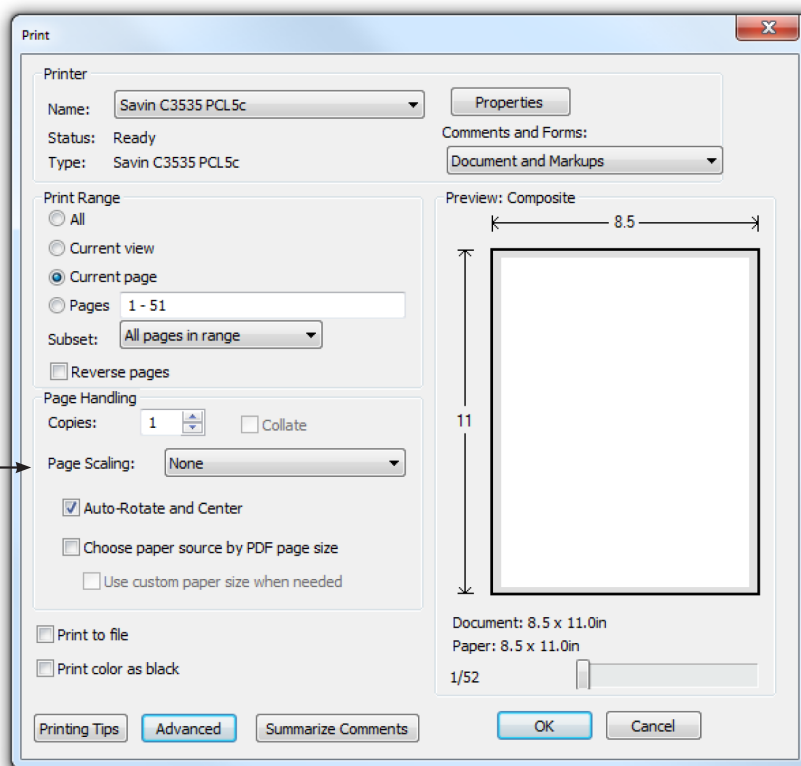

TO SAVE PAPER

Only print the desired image by navigating to the image's page, go to File > Print and select "Current page" in the print dialog box. Repeat for each desired image.

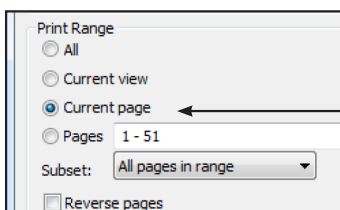

APPLIQUE PATTERNS



Print at 100%. No scaling. This box measures 1" x 1". Use the box as an accuracy guide when printing templates.

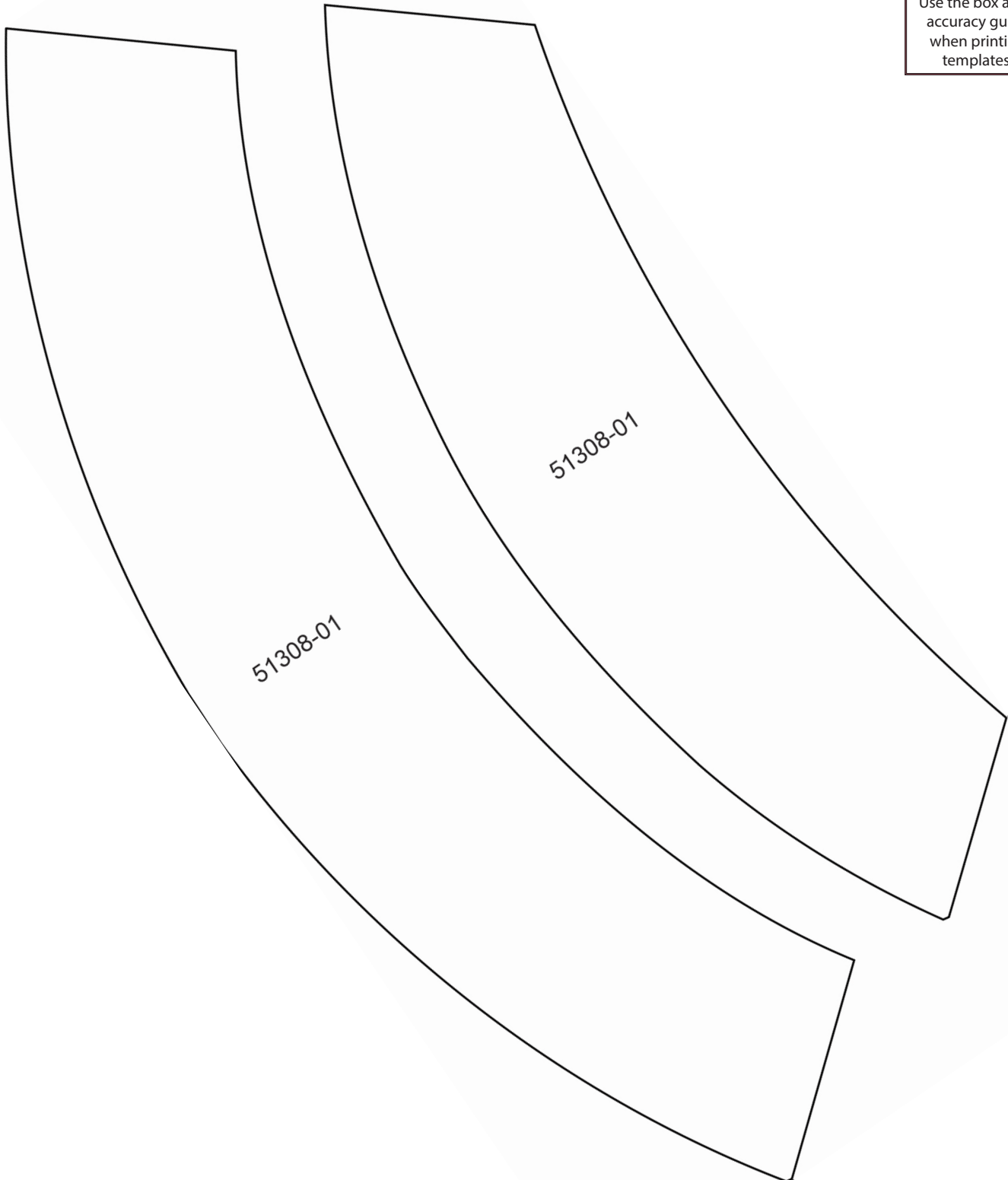

APPLIQUE PATTERNS



Print at 100%. No scaling. This box measures 1" x 1". Use the box as an accuracy guide when printing templates.

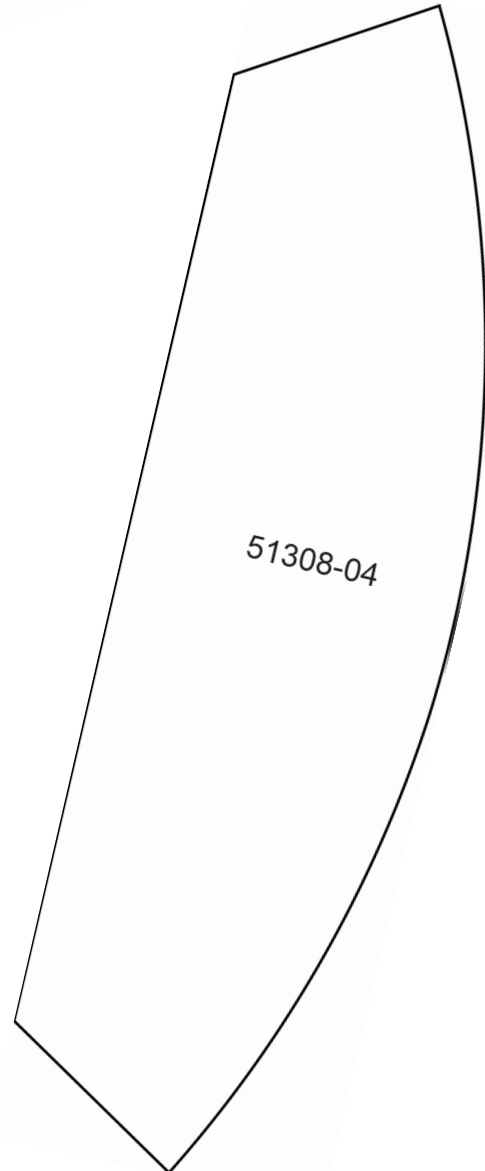
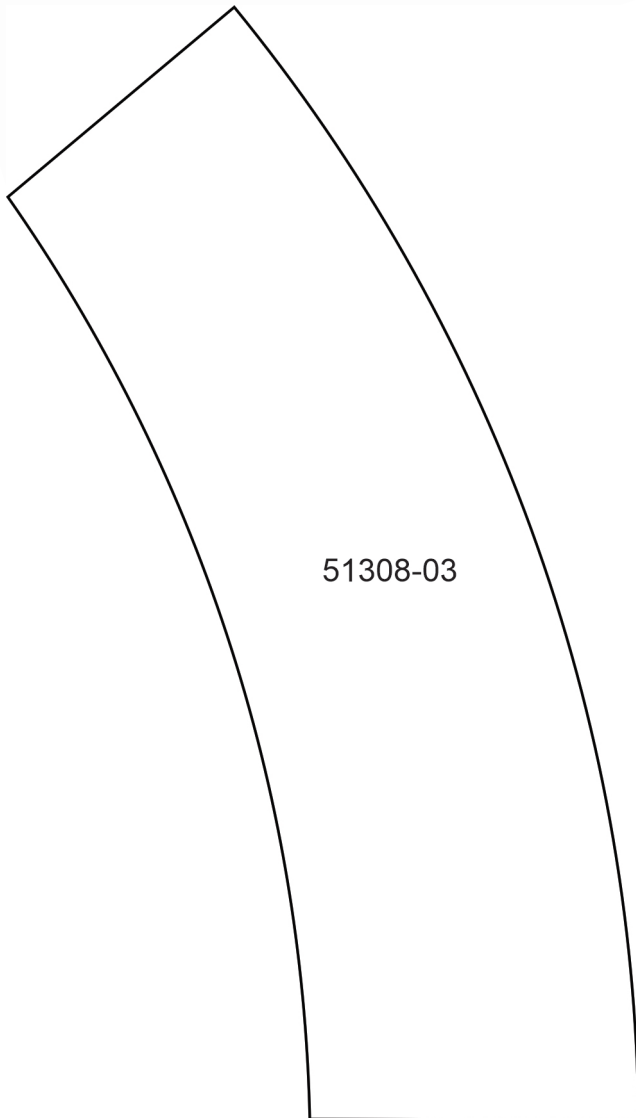
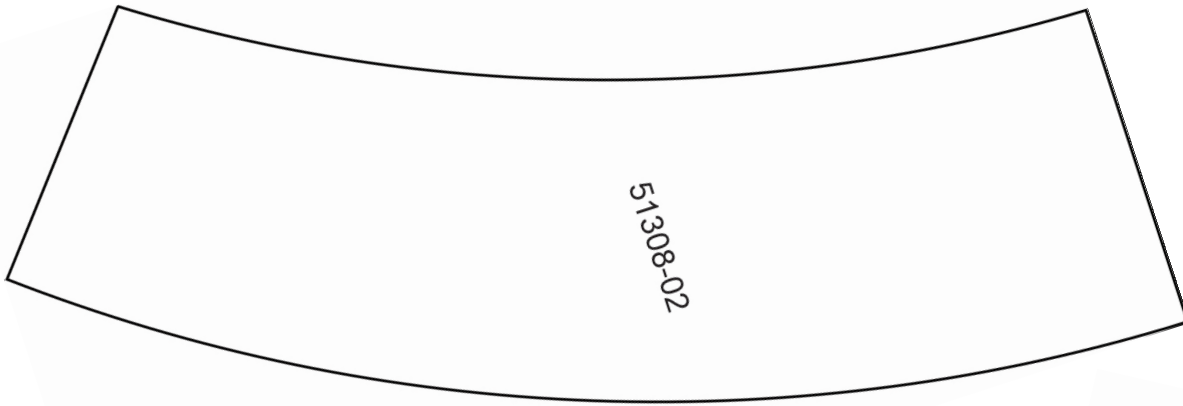

APPLIQUE PATTERNS



Print at 100%. No scaling. This box measures 1" x 1". Use the box as an accuracy guide when printing templates.

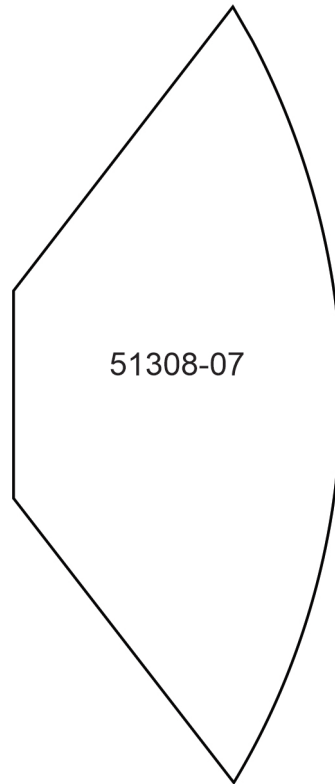
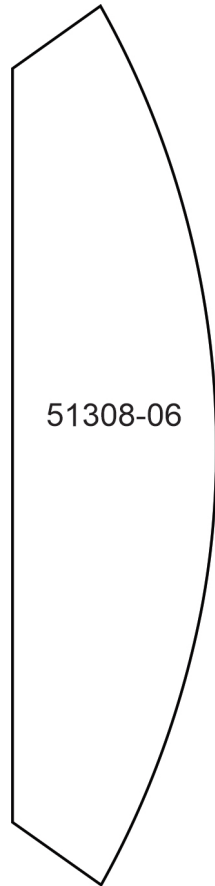
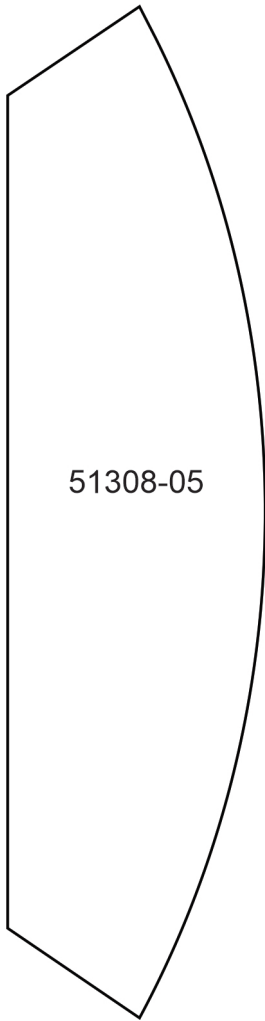

APPLIQUE PATTERNS



Print at 100%. No scaling. This box measures 1" x 1". Use the box as an accuracy guide when printing templates.

51308-09

51308-09

51308-08

51308-08

MIRRORED PATTERNS



Print at 100%. No scaling. This box measures 1" x 1". Use the box as an accuracy guide when printing templates.

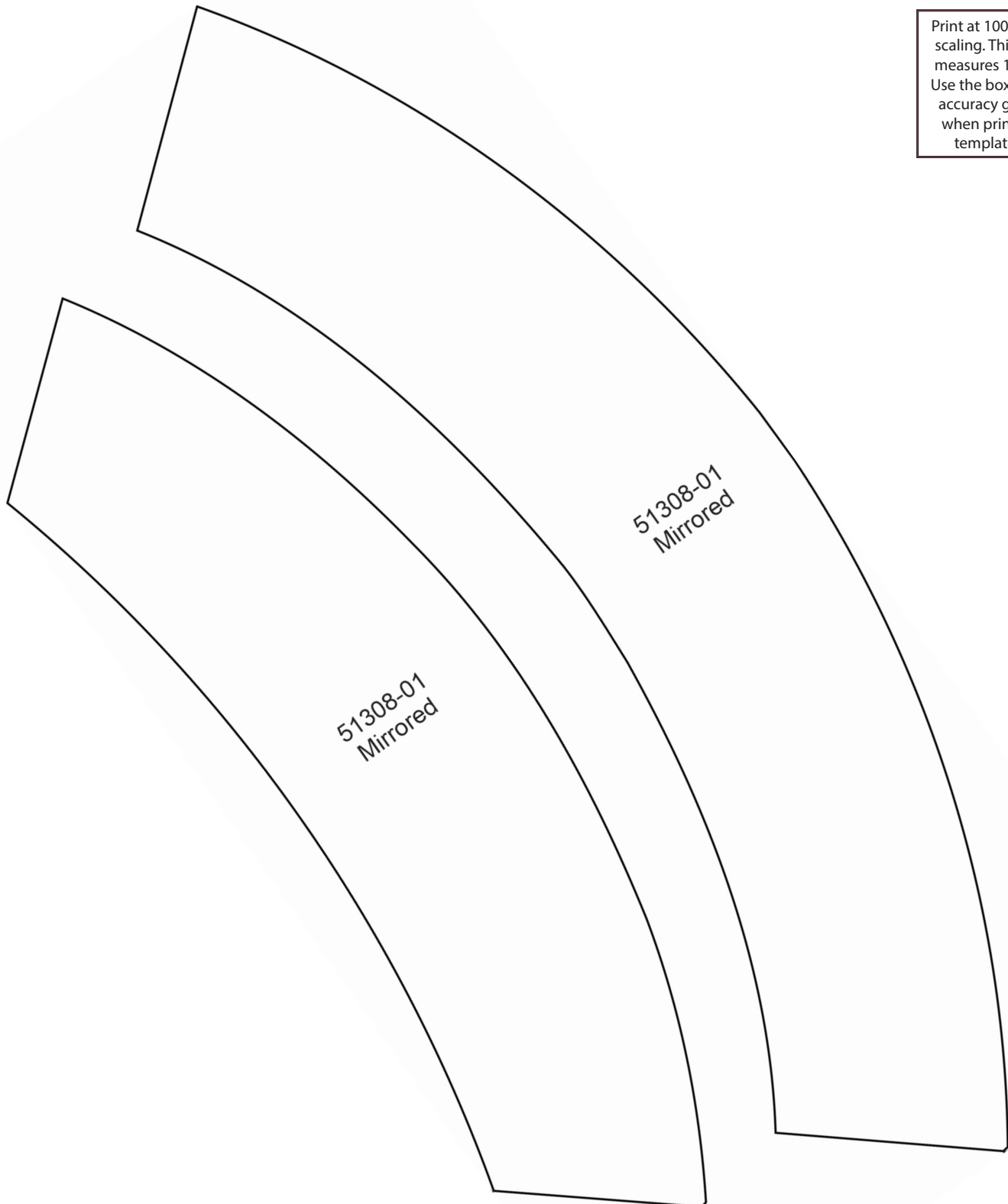

MIRRORED PATTERNS



Print at 100%. No scaling. This box measures 1" x 1". Use the box as an accuracy guide when printing templates.

51308-02
Mirrored

51308-03
Mirrored

51308-04
Mirrored

MIRRORED PATTERNS

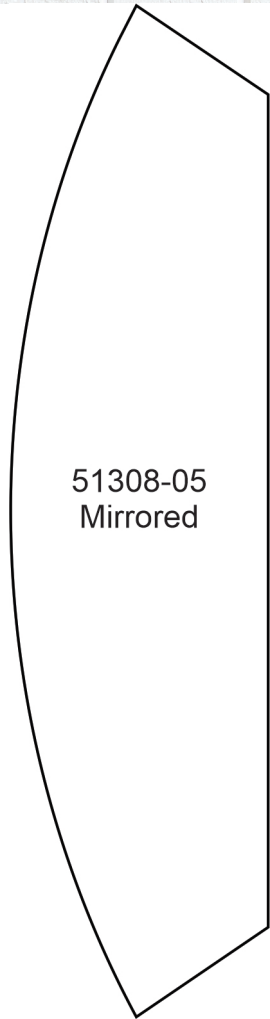

51308-05
Mirrored



51308-06
Mirrored

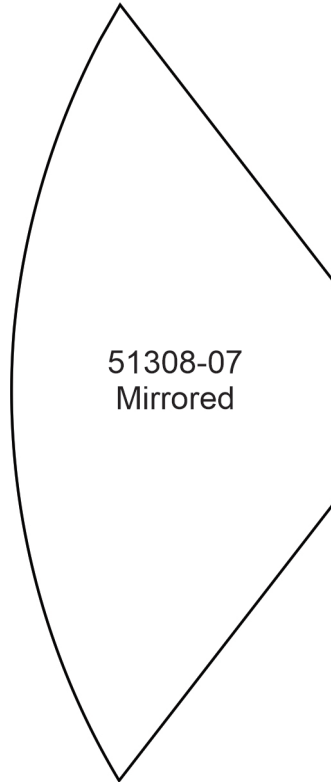

51308-07
Mirrored

Print at 100%. No scaling. This box measures 1" x 1". Use the box as an accuracy guide when printing templates.

MIRRORED PATTERNS



Print at 100%. No scaling. This box measures 1" x 1". Use the box as an accuracy guide when printing templates.

51308-08
Mirrored

51308-08
Mirrored

51308-09
Mirrored

51308-09
Mirrored