

Freestanding Celebrations Cake Box



Collection No. 51337
1 Design/8 Files

MATERIALS



Isacord Thread Colors

- 0270 Buttercream
- 0630 Buttercup
- 2155 Pink Tulip
- 4122 Peacock

Note: One spool of 1000 meter thread is adequate for the project unless otherwise noted.



MATERIALS



Stabilizers

- OESD AquaMesh WashAway
- OESD BadgeMaster WashAway
- OESD StabilStick CutAway
- OESD Fiber Form
- OESD Applique Fuse and Fix

Fabrics/Textiles

- Pink quilter's cotton
- Yellow quilter's cotton
- Blue quilter's cotton

Notion & Tools

- OESD Grippy GRID
- OESD Perfect Scoring Tool
- OESD Expert Embroidery Tape TearAway
- OESD Expert Embroidery Tape WashAway
- OESD Perfect Punch Tool
- OESD Mini MAT
- OESD Alligator Clamps
- OESD Button Clips
- OESD Perfect Embroidery Press Cloth
- Embroidery Needle Sharp 75/11 (FSA)
- Embroidery Needle Ballpoint 80/12 (FSL)

Isacord Thread Colors

- Per the thread chart
- Match bobbin thread to top thread



SUMMARY



Embroidery Hoop to accommodate: 6.22" x 5.97"

Finished project size:

Without Candle: 3 3/8" H x 5 1/4" L x 4" W

With Candle: 6 1/8" H x 5 1/4" L x 4" W

51337-01



Requires 1 Design

51337-02



Requires 1 Design

51337-03

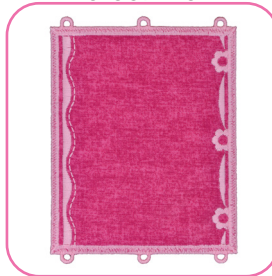

Requires 1 Design

51337-04

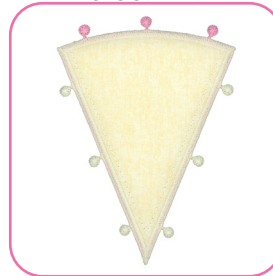

Requires 1 Design

51337-06

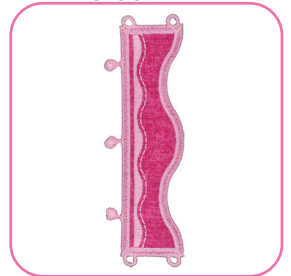

Requires 1 Design

**With
Candle:**

51337-05

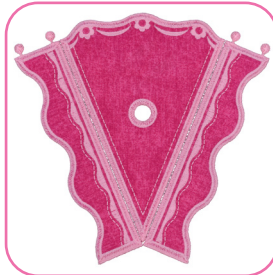

Requires 1 Design

51337-07

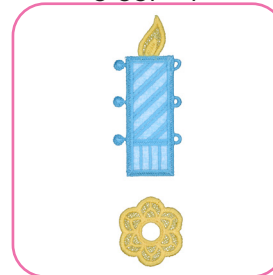

Requires 1 Design

**Without
Candle:**

51337-08



Requires 1 Design

General Instructions

The freestanding applique instructions, included in the collection, are general instructions. For demonstration purposes, a sample design that best demonstrates the technique is shown. Fabric and thread requirements will vary by design, but the general technique is the same.

All designs are stitched with matching thread, top and bobbin.

Note: Some thread colors in instructions have been changed or digitally enhanced for better visibility.

□ Step 1

- Print the mirrored version of the templates (at 100% scale or 1:1 ratio) onto the paper side of Applique Fuse and Fix.
- Cut approximately 1/4" - 1/2" outside the printed applique templates.



EMBROIDERY - DOUBLE SIDED FREESTANDING APPLIQUE

□ Step 2

- Cut the Fiber Form 1/4" -1/2" larger than the applique templates.
- Fuse the trimmed templates to the back of the Fiber Form with the paper side of the printed template up. Hold the iron on the template for 10-15 seconds for a secure fuse.



□ Step 3

- Trim the Fiber Form on the edge of the black outline.
- Set aside.



EMBROIDERY - DOUBLE SIDED FREESTANDING APPLIQUE

Step 4

- Adhere one layer of StabilStick CutAway to the wrong side of all applique fabrics to provide stiffness to the finished structure.
- Cut the prepared applique fabrics 1/4"-1/2" larger than the templates that are included at the end of the instructions.

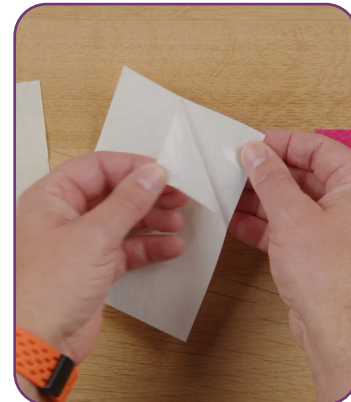

Step 5

- Hoop one layer of AquaMesh and one layer of BadgeMaster for all designs.

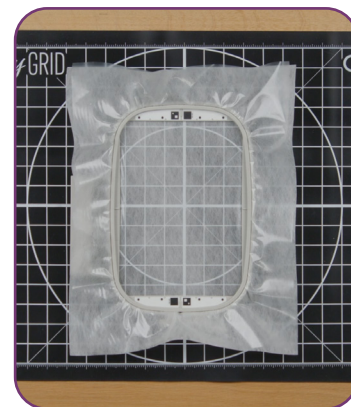

EMBROIDERY - DOUBLE SIDED FREESTANDING APPLIQUE

Step 6

- Load selected design into the machine.
- Example design is 51337-01.
- Thread the machine per the thread chart.
- Place the hoop on the machine.
- Stitch Machine Step 1, Fiber Form Placement Stitch.

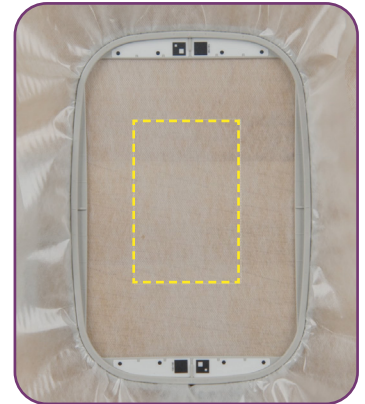

Step 7

- Remove the hoop from the machine, but NOT the project from the hoop.
- Place the hoop on a flat surface.
- On the back of the Fiber Form, use the OESD Perfect Scoring Tool to score and remove the paper backing to reveal the adhesive surface.
- Place the Fiber Form within the placement stitching.
- Finger press to secure.



EMBROIDERY - DOUBLE SIDED FREESTANDING APPLIQUE

Step 10

- Remove the hoop from the machine, but NOT the project from the hoop.
- Place the hoop on a flat surface.
- Completely cover the placement stitch with the prepared applique fabric.
- Tape in place to secure.



Step 11

- Turn the hoop over and place the prepared applique fabric, right side up, completely covering the placement stitch.
- Carefully tape to secure.
Tip: Avoid pushing too hard on the stabilizer to prevent it from dislodging from the hoop.



EMBROIDERY - DOUBLE SIDED FREESTANDING APPLIQUE

Step 12

- Return the hoop to the machine.
- Stitch Machine Step 4, Cut Line and Tackdown.



Step 13

- Remove the hoop from the machine, but NOT the project from the hoop.
- Trim the excess fabric as close to the cut line as possible. If the outermost stitches (cut line) are cut, the inner stitches (tackdown) will hold the applique in place. Tip: If the stabilizer is cut or a hole is created while trimming the fabric, use OESD Expert Embroidery Tape WashAway as a patch.



Step 14

- Turn the hoop over and trim the excess fabric as close to the cut line as possible.



EMBROIDERY - DOUBLE SIDED FREESTANDING APPLIQUE

□ Step 15

- Return the hoop to the machine.
- Stitch Machine Step 5, Front and Back Pink Fabric Placement Stitch.

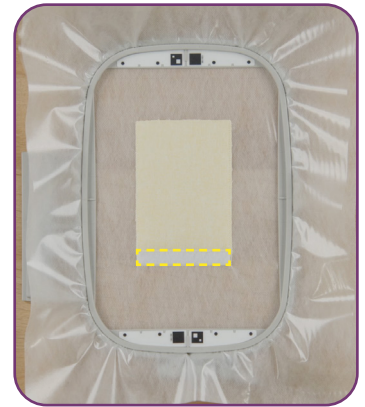

□ Step 16

- Remove the hoop from the machine, but NOT the project from the hoop.
- Place the hoop on a flat surface.
- Completely cover the placement stitch with the prepared applique fabric.
- Tape in place to secure.

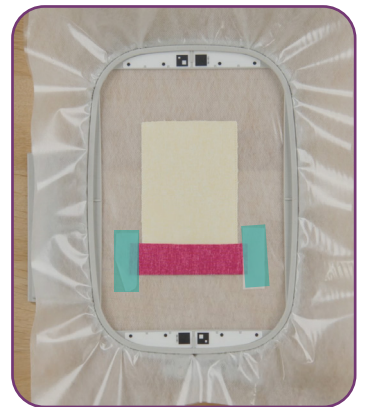

EMBROIDERY - DOUBLE SIDED FREESTANDING APPLIQUE

Step 17

- Turn the hoop over and place the prepared applique fabric, right side up, completely covering the placement stitch.
- Carefully tape to secure.
- Tip: Avoid pushing too hard on the stabilizer to prevent it from dislodging from the hoop.



Step 18

- Return the hoop to the machine.
- Stitch Machine Step 6, Cut Line and Tackdown.

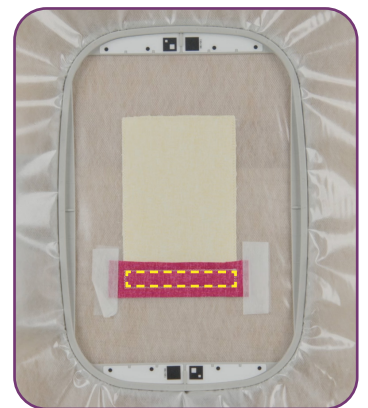

EMBROIDERY - DOUBLE SIDED FREESTANDING APPLIQUE

□ Step 19

- Remove the hoop from the machine, but NOT the project from the hoop.
- Place the hoop on a flat surface.
- Trim the excess fabric as close to the cut line as possible.



□ Step 20

- Turn the hoop over and trim the excess fabric as close to the cut line as possible.



□ Step 21

- Return the hoop to the machine.
- Stitch the remaining machine steps per the thread with matching bobbin thread.



EMBROIDERY - DOUBLE SIDED
FREESTANDING APPLIQUE

□ Step 22

- When the design is complete, remove the project from the hoop and trim the stabilizer 1/4" - 1/2" outside the design.



GENERAL FREESTANDING LACE GUIDE



Stabilizer

- OESD AquaMesh
- OESD BadgeMaster

Notion/Tools

- 80/12 Embroidery Ballpoint Titanium needle for extended needle life
- OESD Alligator Clamps
- OESD Button Clips
- OESD Perfect Point and Press Tool

Isacord Thread Colors

- All OESD designs are digitized with Isacord 40 wt. polyester thread as the top thread and in the bobbin.
- Refer to the thread chart for color specifications.
- Match bobbin thread color to the top thread.

Instructions

Step 1 - Hoop

For FSL structures, hoop one layer of OESD AquaMesh and one layer of OESD BadgeMaster. BadgeMaster contains more starch so, combined with the AquaMesh, the lace is more rigid.

For other FSL, where a softer lace is desired, hoop two layers of AquaMesh.

Step 2 - Embroider

Stitch the design per the thread chart with matching thread in the bobbin at each color change.

When complete, remove from the hoop and trim away excess stabilizer about 1/4"-1/2" from the stitching.

Step 3 - Rinse

Rinse remaining stabilizer out in warm running water.

For stiffer lace and FSL structures, DO NOT rinse away all of the stabilizer. The lace should be just slightly tacky.

For softer lace, rinse until all traces of the stabilizer is removed.

Step 4 - Dry

Lay right side down flat on a non-stick surface, such as a cookie rack, parchment paper or Teflon sheet. This minimizes the tendency for the lace to curl.

Let the pieces dry completely before proceeding with any assembly.

Step 5 - Press

Once completely dry, press right side down on a OESD Perfect Embroidery Press Cloth.

Step 6 - Assemble Structure

Note: Specific assembly instructions for a design/collection may be found in the thread chart pdf following the individual design color charts.

Lace must be COMPLETELY DRY before assembly. Wetting the buttonettes or eyelets to assemble is not recommended and may result in them stretching and coming "unbuttoned" when dry.

Use a pair of OESD Alligator Clamps to insert the buttonettes into the eyelets. Insert the tip of the OESD Alligator Clamps into the eyelet, grasp the buttonette and pull through the eyelet. Alternatively, use a stiletto or tweezers to push the buttonette through the eyelet.

Helpful Tips

Limp Lace

If the design is not stiff enough, press the lace pieces on the wrong side while applying spray starch. After ironing, spray again with starch and allow to dry completely. This will stiffen the lace pieces nicely and aid in construction. Or easily re-stiffen by diluting some stabilizer scraps in water (or use liquid starch) and dipping the item in the solution. Lay flat to dry.

Eyelets Too Small

If any of the eyelets appear closed or too small to penetrate with Alligator Clamps, they may be stretched by inserting the small end of the OESD Perfect Point and Press Tool into the eyelet opening and stretching it open wide enough to accommodate the OESD Alligator Clamps.

Button Clips

During the assembly process, some structures pull on buttonettes that have already been inserted and could pull them out altogether. Putting a Button Clip on the assembled buttonette will keep it in position during the assembly process. Remove the Button Clips when the assembly is complete.

Alternative Construction Option

In some cases, the buttonettes may be pulled to the inside of a project, instead of being visible on the outside.

Insert the OESD Alligator Clamps through the eyelet from the wrong, or inside, of the lace and grasp the corresponding buttonette. Pull the buttonette to the wrong side of the lace.

Pulling the buttonettes to the inside may cause stress on the ones already done. Button clips may be placed on the completed buttonette(s) to prevent them from pulling out of the eyelet.

ASSEMBLY

□ Step 23

- Rinse each piece in warm running water until the design is only slightly tacky.
- Place right side down on a non-stick surface to dry. Parchment paper or a cooling rack work well to prevent curling. Dry completely.
- Wrap and dry the Birthday Candle FSA (51337-07) around a pencil or wooden dowel.
- Once dry, press right side down on a Perfect Embroidery Press Cloth.



□ Step 24

- Use the OESD Mini MAT and Punch Tool with the 3mm attachment to create the eyelets indicated in the diagram.
Tip: Take care to not cut the satin stitching.
- Reference the Punch Tool Guide on page 22.

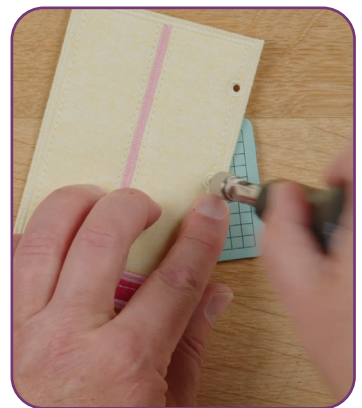

ASSEMBLY

□ Step 25

- Line up the Cake Box Side pieces 51337-01 and 51337-02 to connect.
- Thread the sewing machine with matching thread in the top and bobbin.
- Stitch together using a multi-step zigzag stitch.
- Back stitch at the beginning and end to secure.
- Trim thread tails.
- Fold and press into shape.

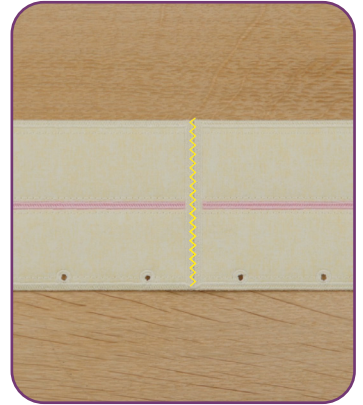

□ Step 26

- Fold the sides of the Cake Box Top (51337-05 or 51337-08) aligning the narrow edges of the sides.
- Use a button clip to secure.
- Stitch together with a straight stitch beginning at the bottom.
- Stop stitching approximately 1/4" from the top to avoid pinching the top point of the Cake Box Top.



ASSEMBLY

Step 27

- Match the buttonettes of the cake box sides to the eyelets of the Cake Box Back FSA (51337-03)
- Use Alligator Clamps to pull each buttonette through the corresponding eyelet, using button clips to temporarily hold them in place, as needed. Note: The top two buttonettes need to be pulled to the inside of the project.

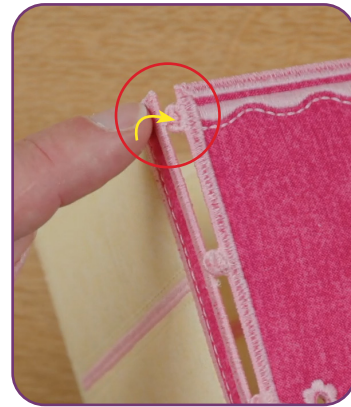
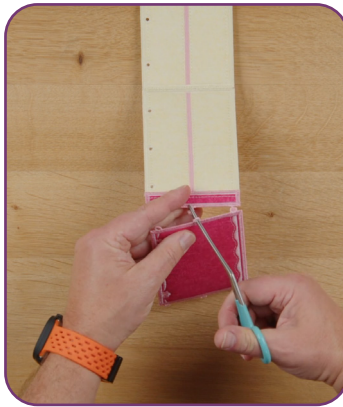
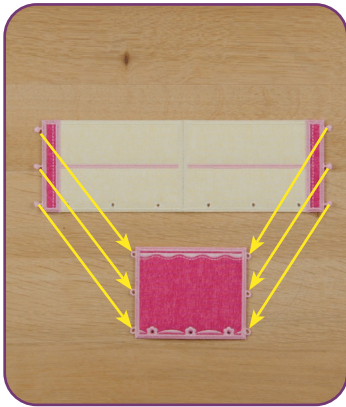

Step 28

- Match the buttonettes of the Cake Box Bottom FSA (51337-04) to the eyelets of the assembled cake box sides and back.
- Pull each buttonette through the corresponding eyelet.

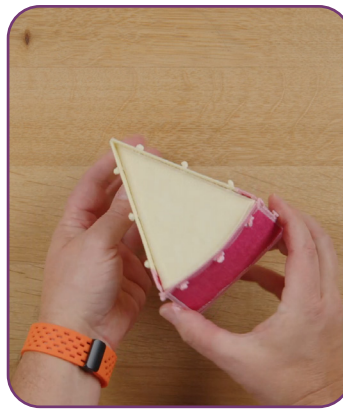
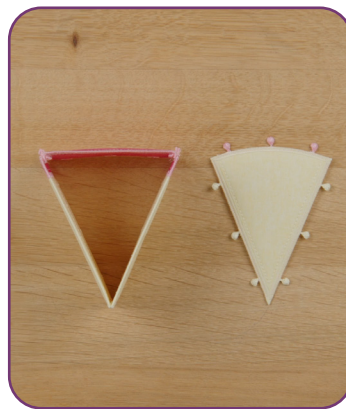

ASSEMBLY

Step 29

- Match the buttonettes of the Cake Box Top Side FSA (51337-06) to the eyelets of the Cake Box Top (51337-05 or 51337-08).
- Pull each buttonette through the corresponding eyelet.

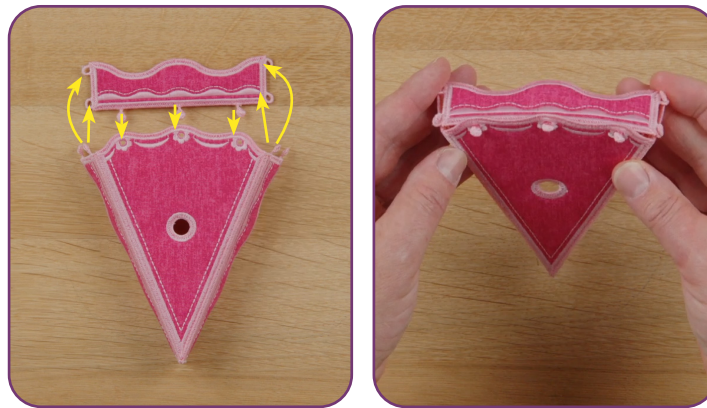

Step 30

- Match the buttonettes to the eyelets of the Birthday Candle FSA (51337-07).
- Pull each buttonette through the corresponding eyelet.

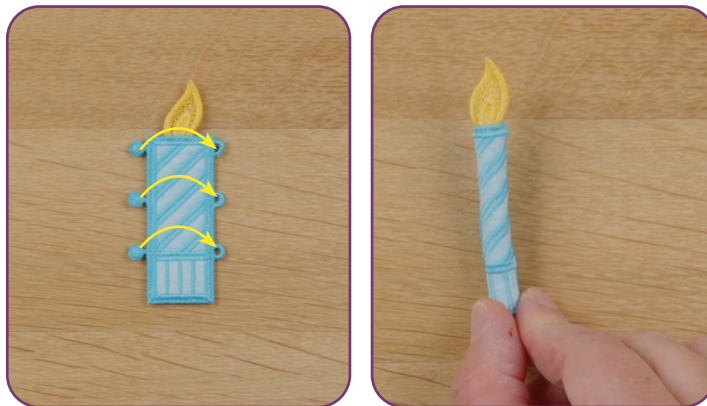

ASSEMBLY

□ Step 31

- Insert the base of the Birthday Candle FSA (51337-07) through the candle flower lace accent and then into the eyelet of the Birthday Cake Box Top FSA (51337-05).

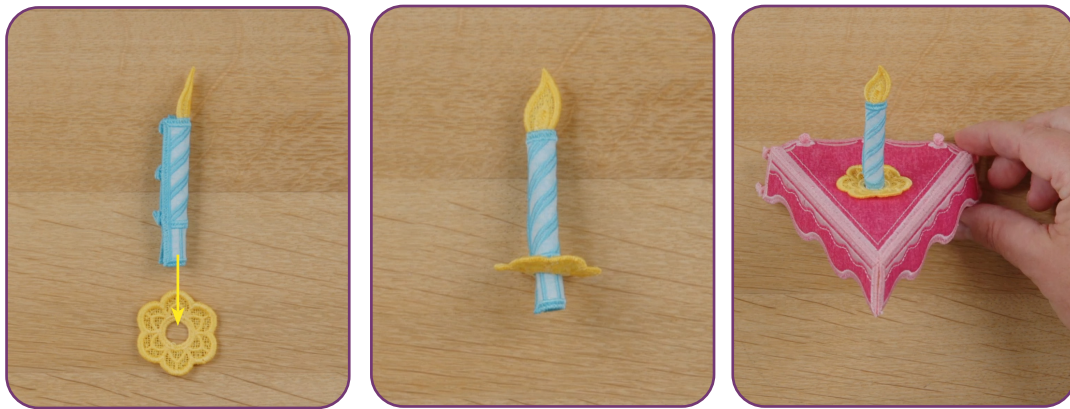

□ Step 32

- Place the assembled cake box top on the assembled cake slice.
- The project is complete. Enjoy!

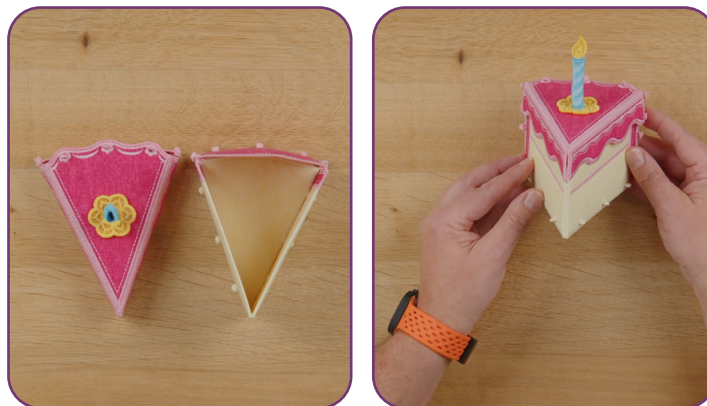

PUNCH TOOL GUIDES

OESD™ PREMIER COLLECTION



51337-01

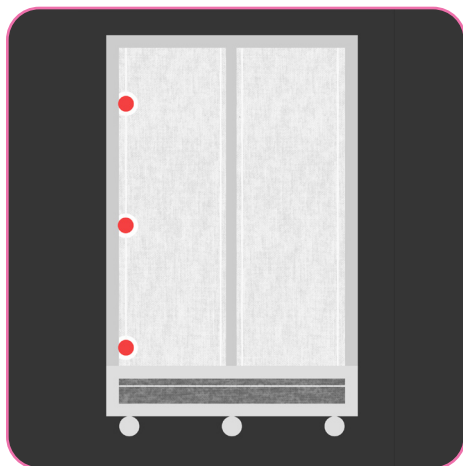

51337-02

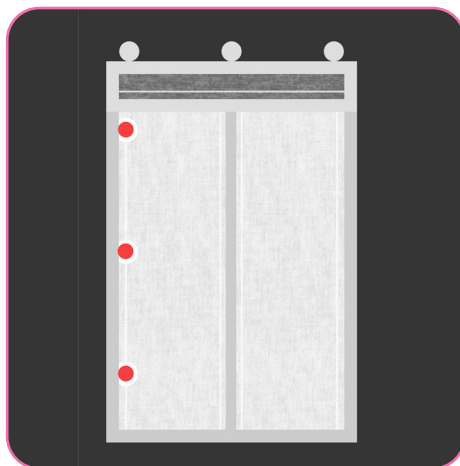

51337-03

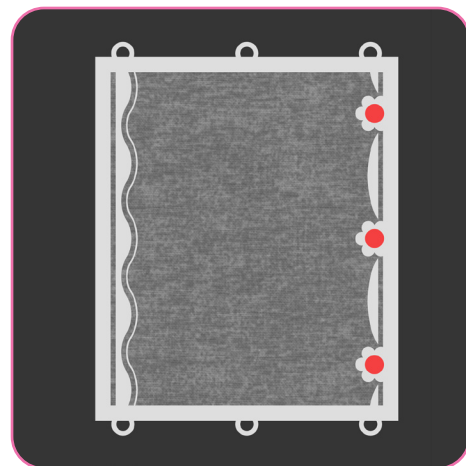

51337-05

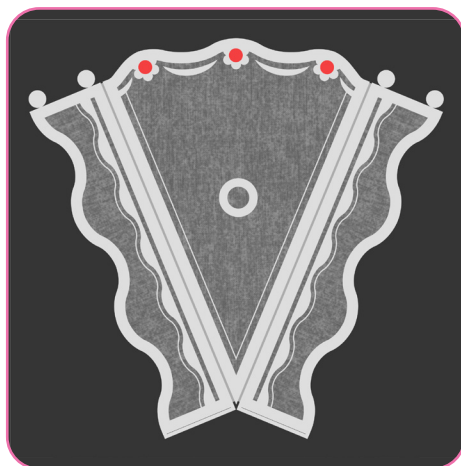

51337-08

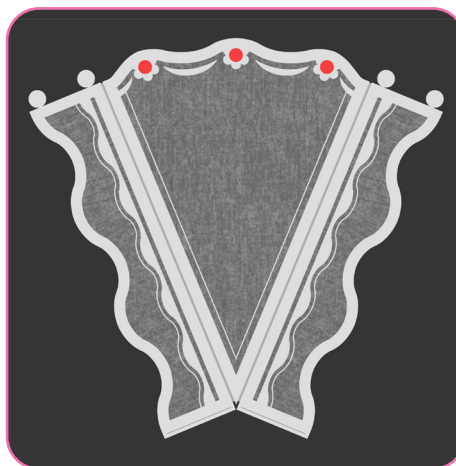

● = 2 MM

● = 3 MM

● = 4 MM

ATTENTION

When printing this document, any page scaling or page fitting options in your print dialog box must be turned OFF or set to NONE so that your files will print out at their actual size. Images not printed at actual size will not function as intended.

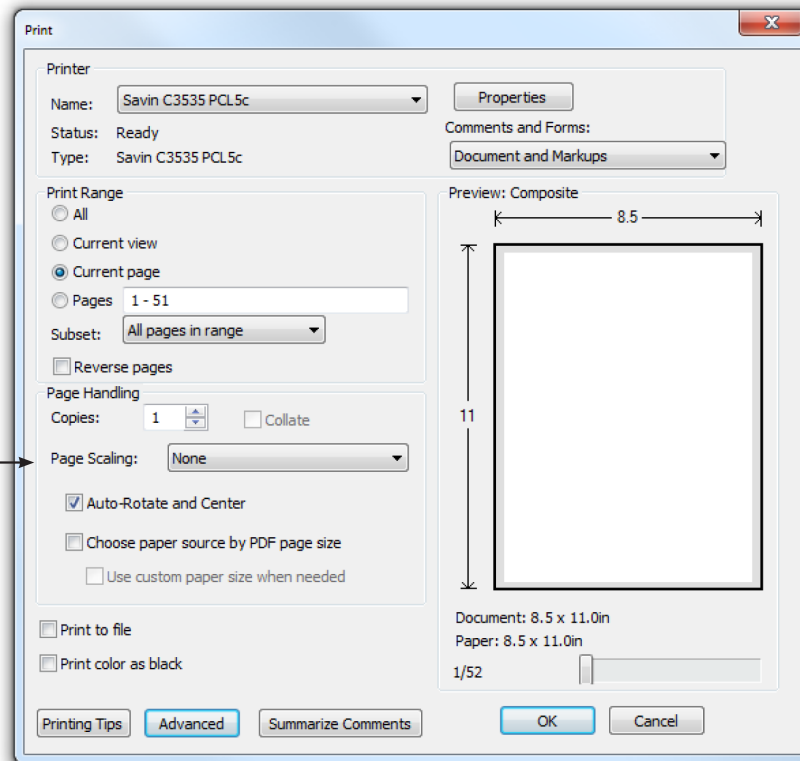

TO SAVE PAPER

Only print the desired image by navigating to the image's page, go to File > Print and select "Current page" in the print dialog box. Repeat for each desired image.

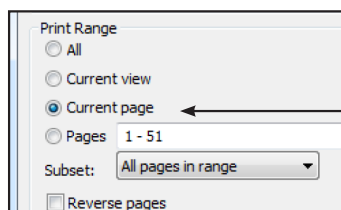

APPLIQUE PATTERNS

oeSD™ PREMIER COLLECTION



Print at 100%. No scaling. This box measures 1" x 1". Use the box as an accuracy guide when printing templates.

51337-01
Fiber Form

51337-01
Front Fabric

51337-01
Back Fabric

APPLIQUE PATTERNS

oeSD™ PREMIER COLLECTION



Print at 100%. No scaling. This box measures 1" x 1". Use the box as an accuracy guide when printing templates.

51337-01
Front Fabric

51337-01
Back Fabric

APPLIQUE PATTERNS

oeSD™ PREMIER COLLECTION



Print at 100%. No scaling. This box measures 1" x 1". Use the box as an accuracy guide when printing templates.

51337-02
Fiber Form

51337-02
Front Fabric

51337-02
Back Fabric

APPLIQUE PATTERNS

oeSD™ PREMIER COLLECTION



Print at 100%. No scaling. This box measures 1" x 1". Use the box as an accuracy guide when printing templates.

51337-02
Front Fabric

51337-02
Back Fabric

APPLIQUE PATTERNS

OESD™ PREMIER COLLECTION



Print at 100%. No scaling. This box measures 1" x 1". Use the box as an accuracy guide when printing templates.

51337-03
Fiber Form

51337-03
Front Fabric

APPLIQUE PATTERNS

oeSD™ PREMIER COLLECTION



Print at 100%. No scaling. This box measures 1" x 1". Use the box as an accuracy guide when printing templates.

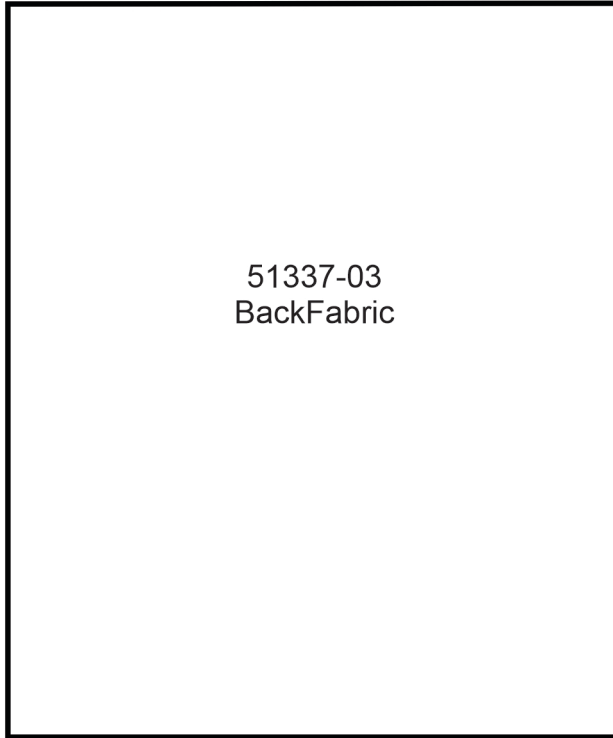

51337-03
BackFabric

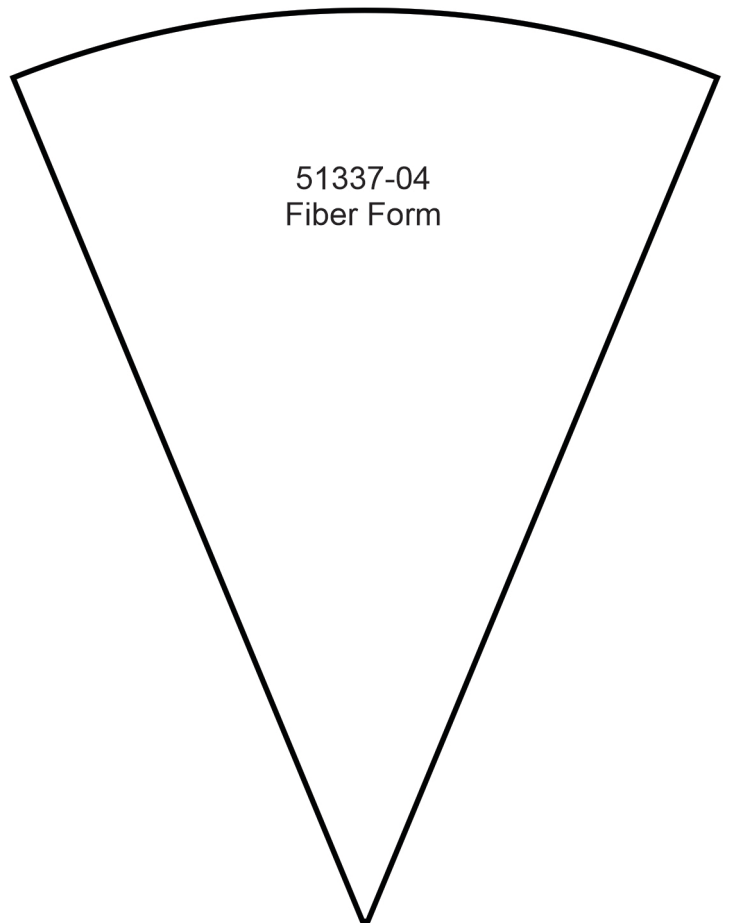

51337-04
Fiber Form

APPLIQUE PATTERNS

OESD™ PREMIER COLLECTION



Print at 100%. No scaling. This box measures 1" x 1". Use the box as an accuracy guide when printing templates.

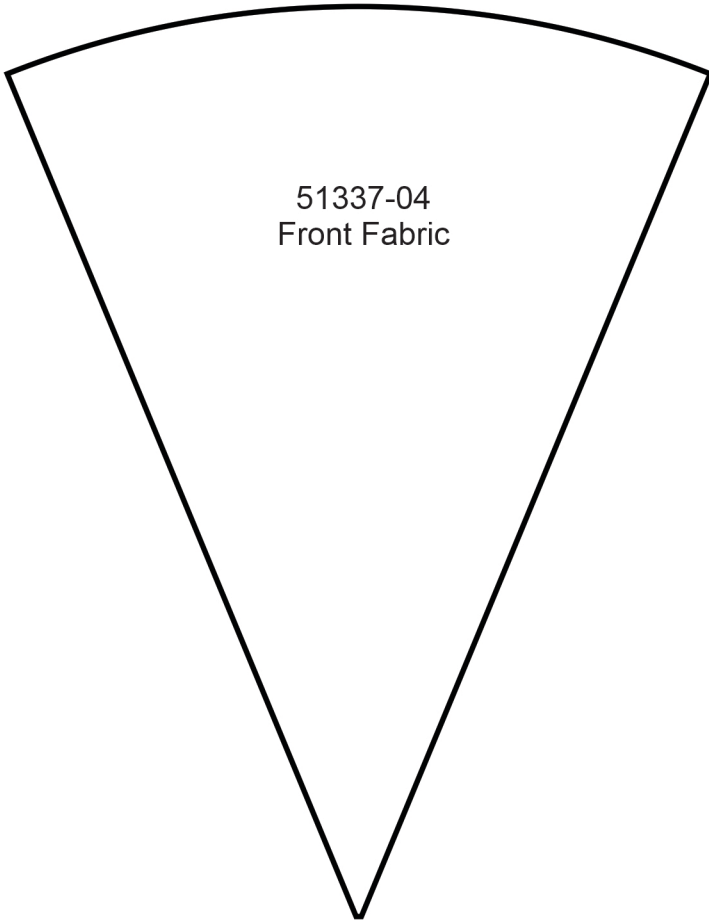

51337-04
Front Fabric

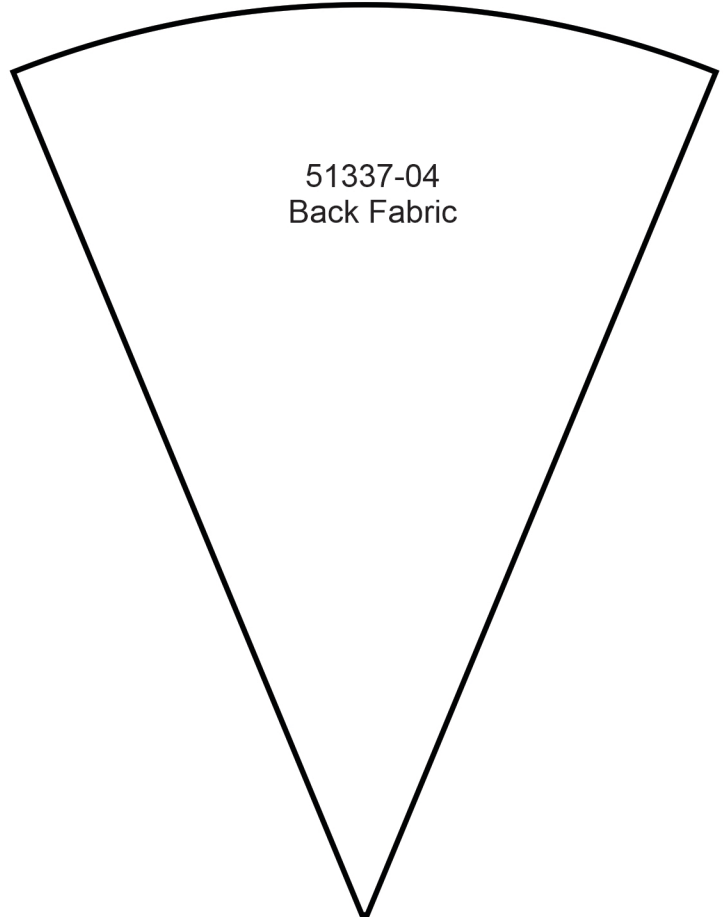

51337-04
Back Fabric

APPLIQUE PATTERNS

oeSD™ PREMIER COLLECTION



Print at 100%. No scaling. This box measures 1" x 1". Use the box as an accuracy guide when printing templates.

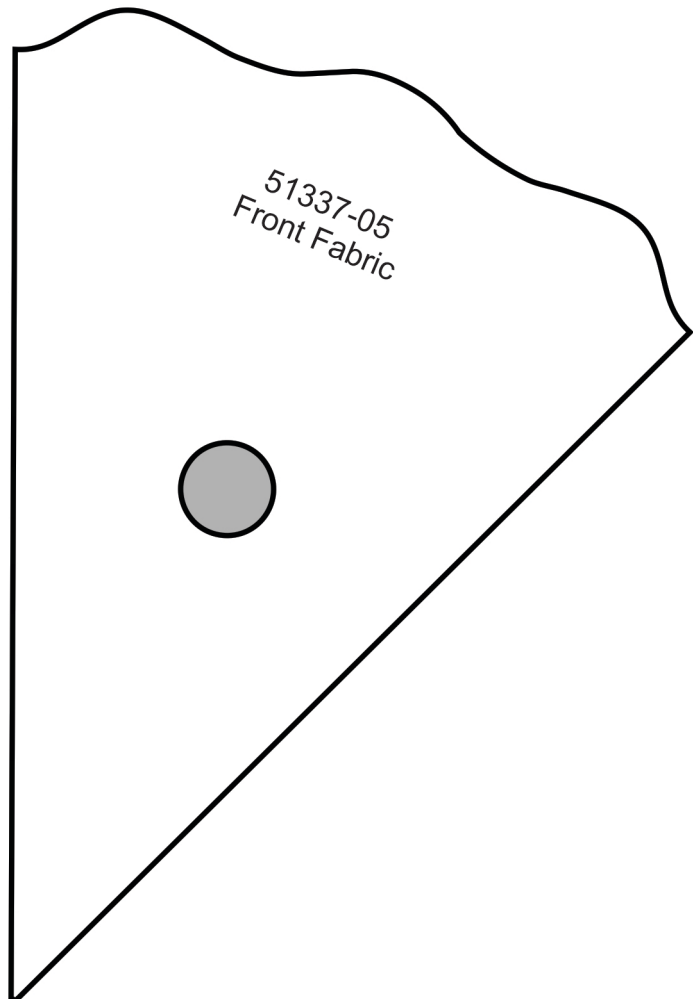
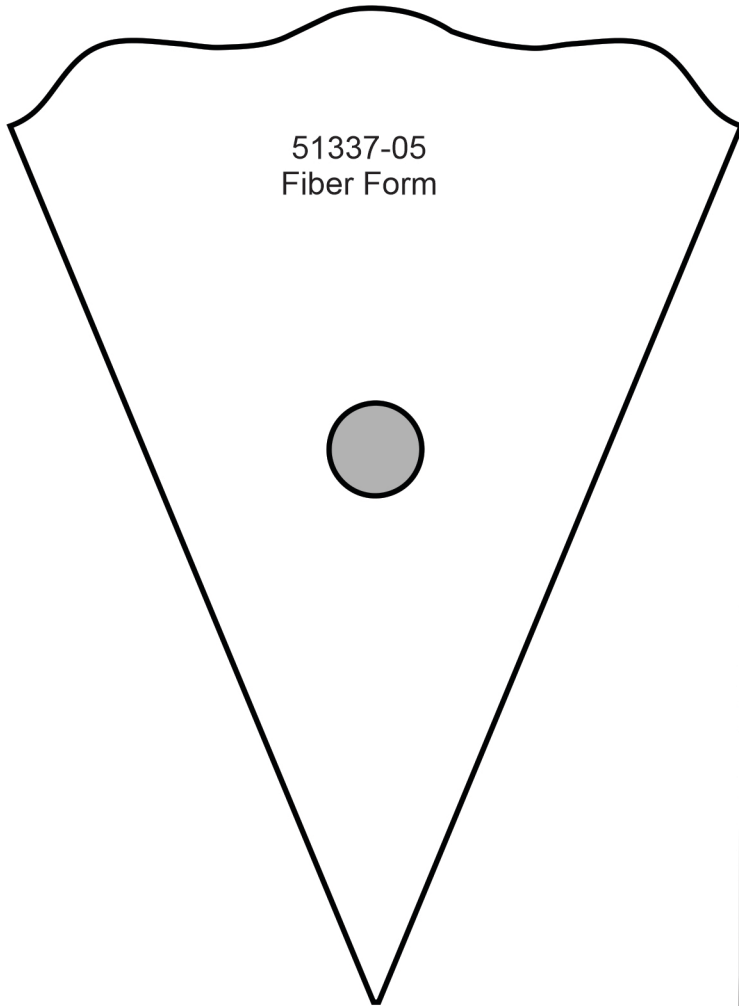

APPLIQUE PATTERNS

OESD™ PREMIER COLLECTION



Print at 100%. No scaling. This box measures 1" x 1". Use the box as an accuracy guide when printing templates.

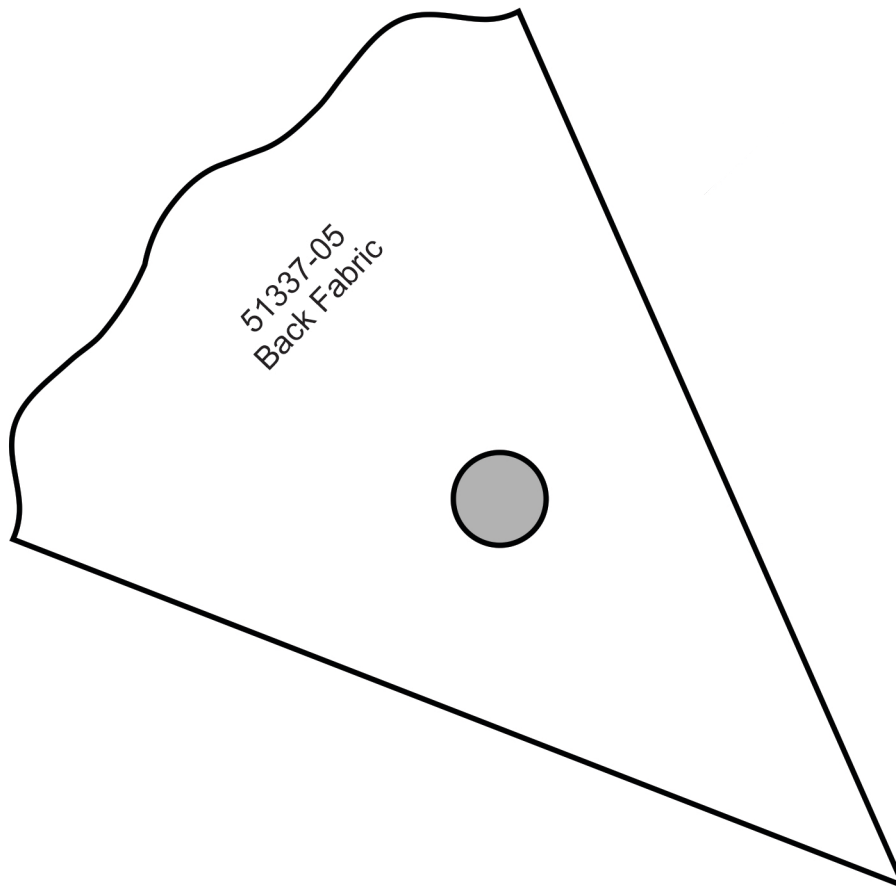

APPLIQUE PATTERNS

Print at 100%. No scaling. This box measures 1" x 1". Use the box as an accuracy guide when printing templates.

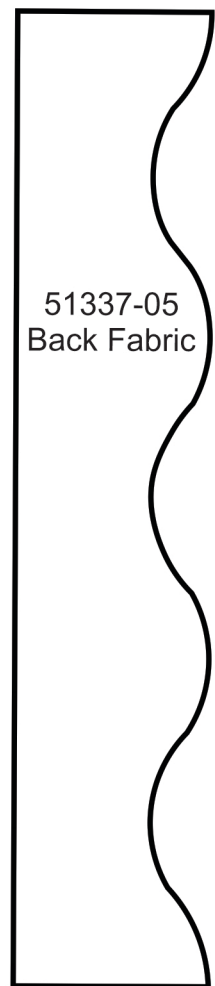
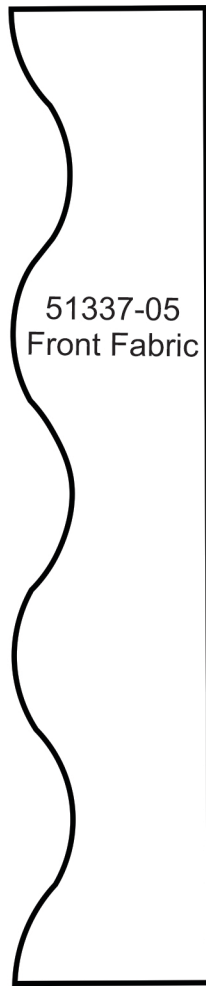
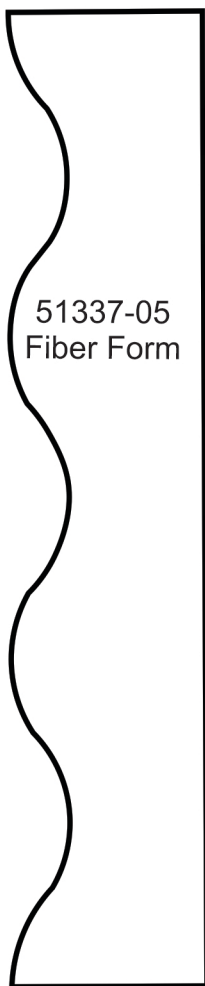

APPLIQUE PATTERNS

OESD™ PREMIER COLLECTION



Print at 100%. No scaling. This box measures 1" x 1". Use the box as an accuracy guide when printing templates.

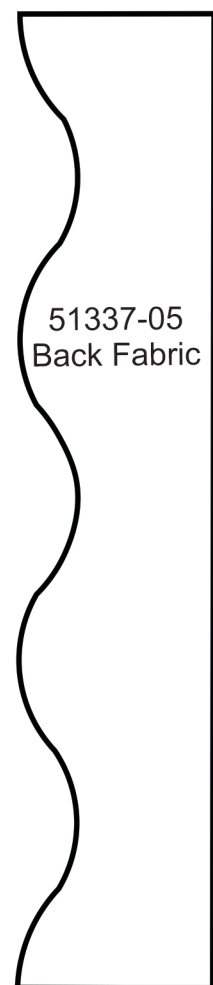
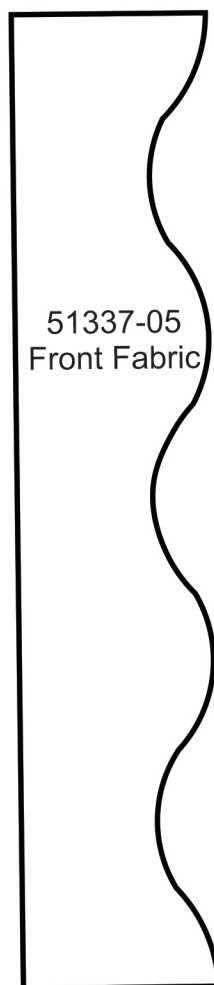
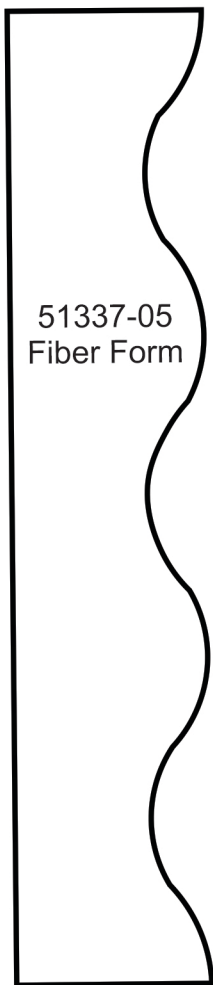

APPLIQUE PATTERNS

Print at 100%. No scaling. This box measures 1" x 1". Use the box as an accuracy guide when printing templates.

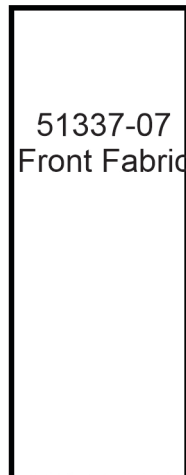

APPLIQUE PATTERNS

OESD™ PREMIER COLLECTION



Print at 100%. No scaling. This box measures 1" x 1". Use the box as an accuracy guide when printing templates.

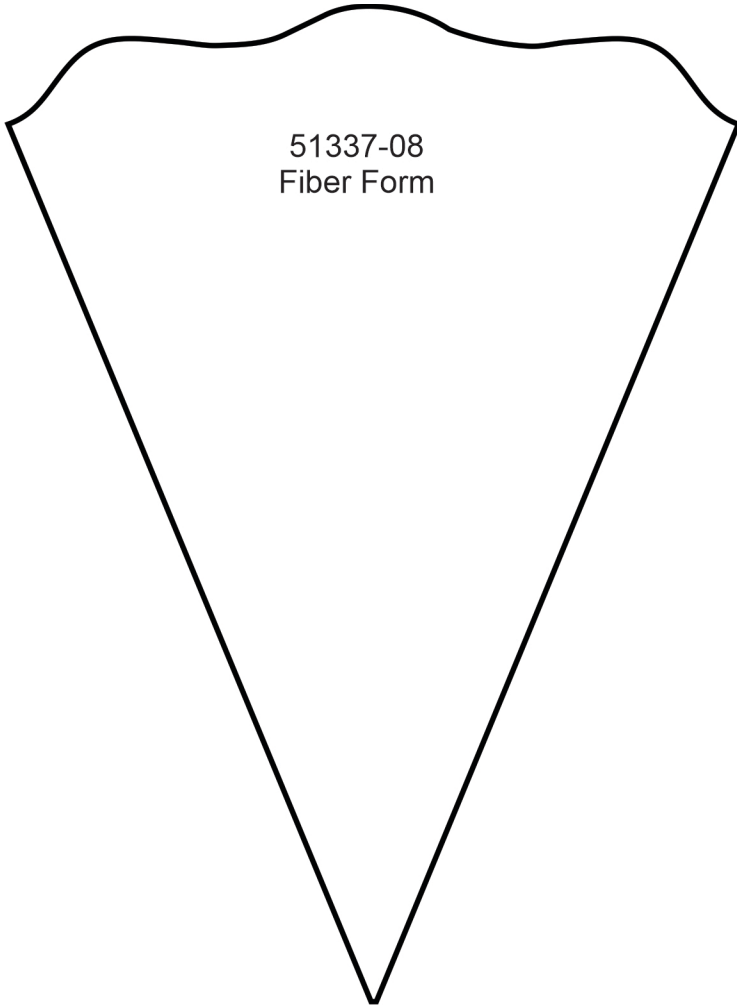

51337-08
Fiber Form

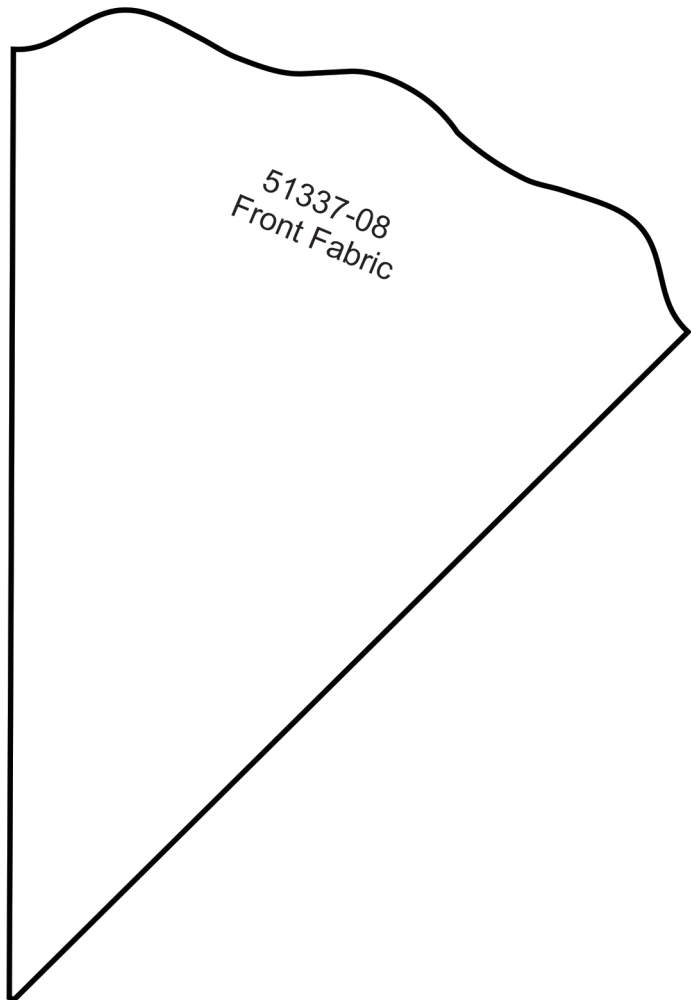

51337-08
Front Fabric

APPLIQUE PATTERNS

OESD™ PREMIER COLLECTION



Print at 100%. No scaling. This box measures 1" x 1". Use the box as an accuracy guide when printing templates.

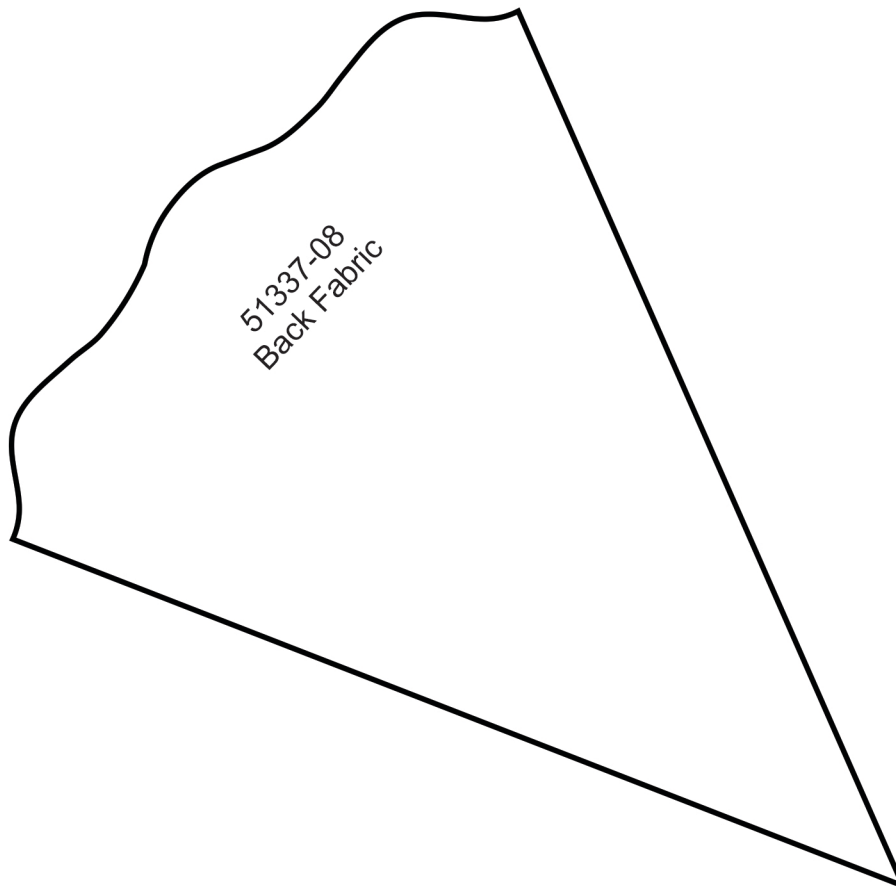

APPLIQUE PATTERNS

OESD™ PREMIER COLLECTION



Print at 100%. No scaling. This box measures 1" x 1". Use the box as an accuracy guide when printing templates.

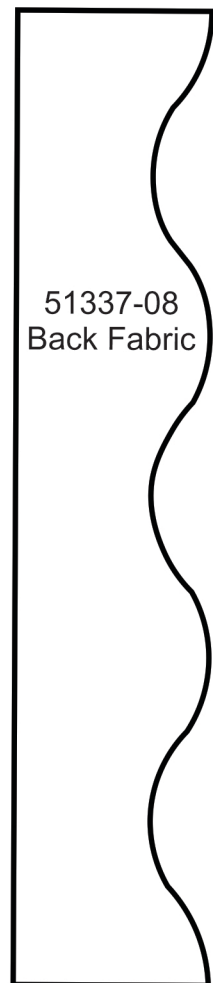
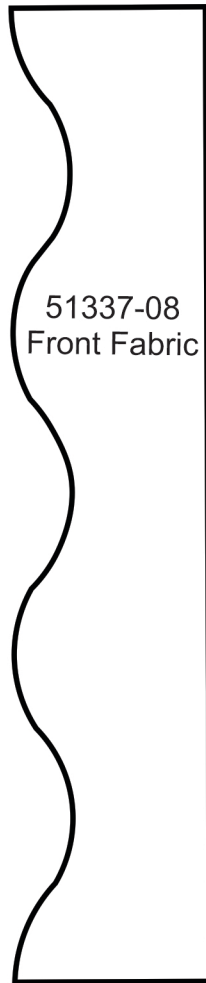
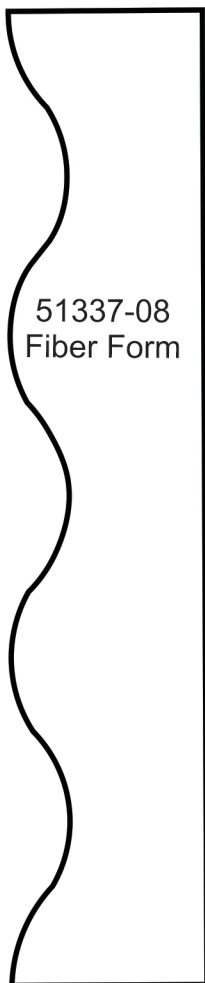

APPLIQUE PATTERNS

Print at 100%. No scaling. This box measures 1" x 1". Use the box as an accuracy guide when printing templates.

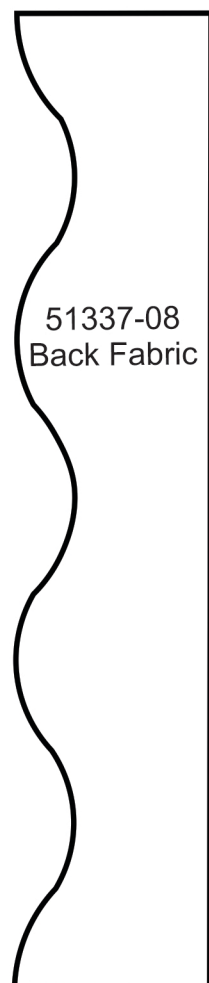
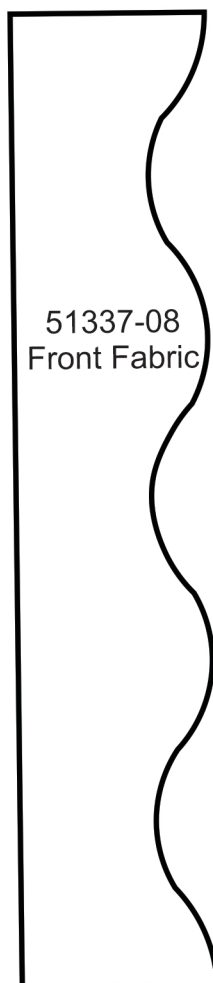
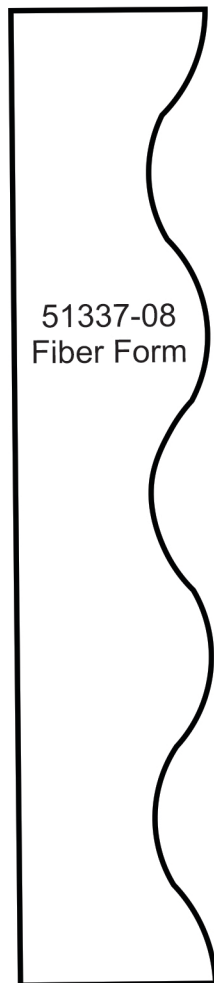

MIRRORED PATTERNS



Print at 100%. No scaling. This box measures 1" x 1". Use the box as an accuracy guide when printing templates.

51337-01
Front Fabric
Mirrored

51337-01
Back Fabric
Mirrored

51337-01
Fiber Form
Mirrored

MIRRORED PATTERNS

oeSD™ PREMIER COLLECTION



Print at 100%. No scaling. This box measures 1" x 1". Use the box as an accuracy guide when printing templates.

51337-01
Back Fabric
Mirrored

51337-01
Front Fabric
Mirrored

MIRRORED PATTERNS

oeSD™ PREMIER COLLECTION



Print at 100%. No scaling. This box measures 1" x 1". Use the box as an accuracy guide when printing templates.

51337-02
Front Fabric
Mirrored

51337-02
Back Fabric
Mirrored

51337-02
Fiber Form
Mirrored

MIRRORED PATTERNS

oeSD™ PREMIER COLLECTION



Print at 100%. No scaling. This box measures 1" x 1". Use the box as an accuracy guide when printing templates.

51337-02
Back Fabric
Mirrored

51337-02
Front Fabric
Mirrored

MIRRORED PATTERNS

oeSD™ PREMIER COLLECTION



Print at 100%. No scaling. This box measures 1" x 1". Use the box as an accuracy guide when printing templates.

51337-03
Fiber Form
Mirrored

51337-03
BackFabric
Mirrored

51337-03
Front Fabric
Mirrored

MIRRORED PATTERNS

oeSD™ PREMIER COLLECTION



Print at 100%. No scaling. This box measures 1" x 1". Use the box as an accuracy guide when printing templates.

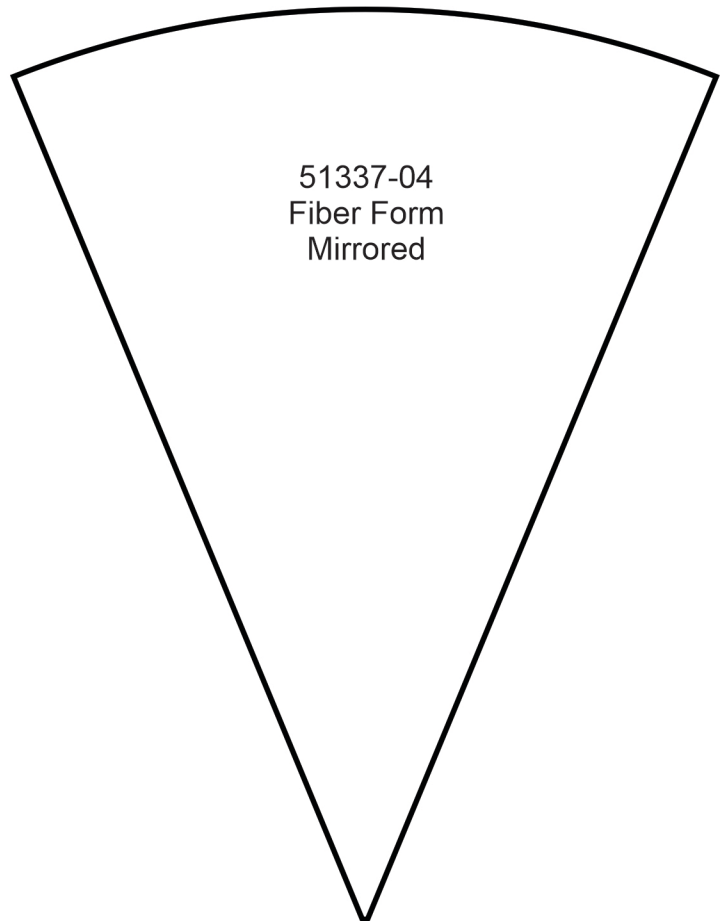
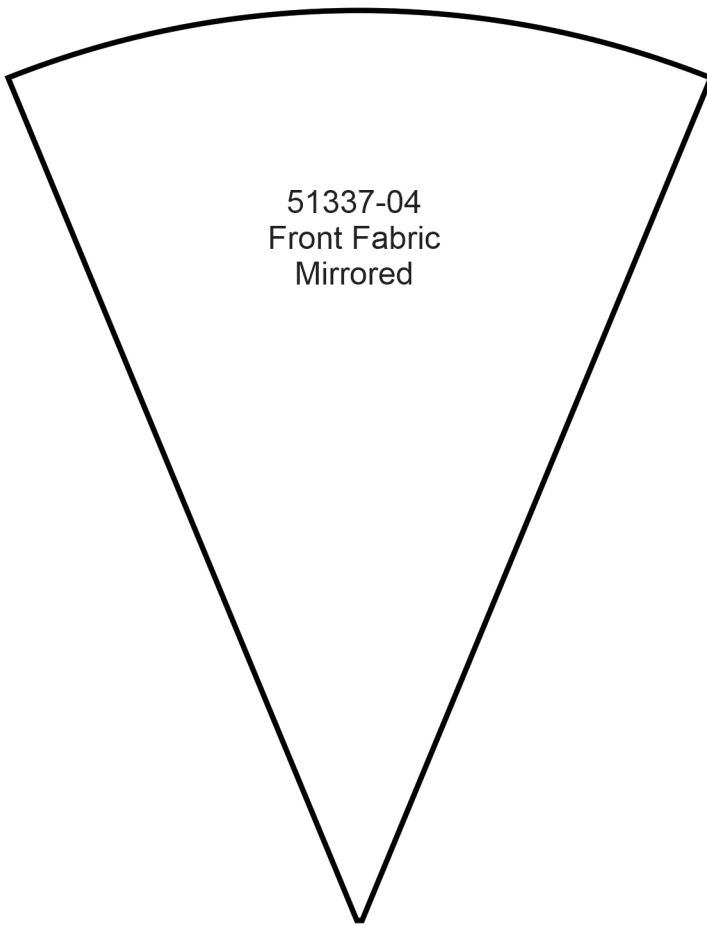

MIRRORED PATTERNS

oeSD™ PREMIER COLLECTION



Print at 100%. No scaling. This box measures 1" x 1". Use the box as an accuracy guide when printing templates.

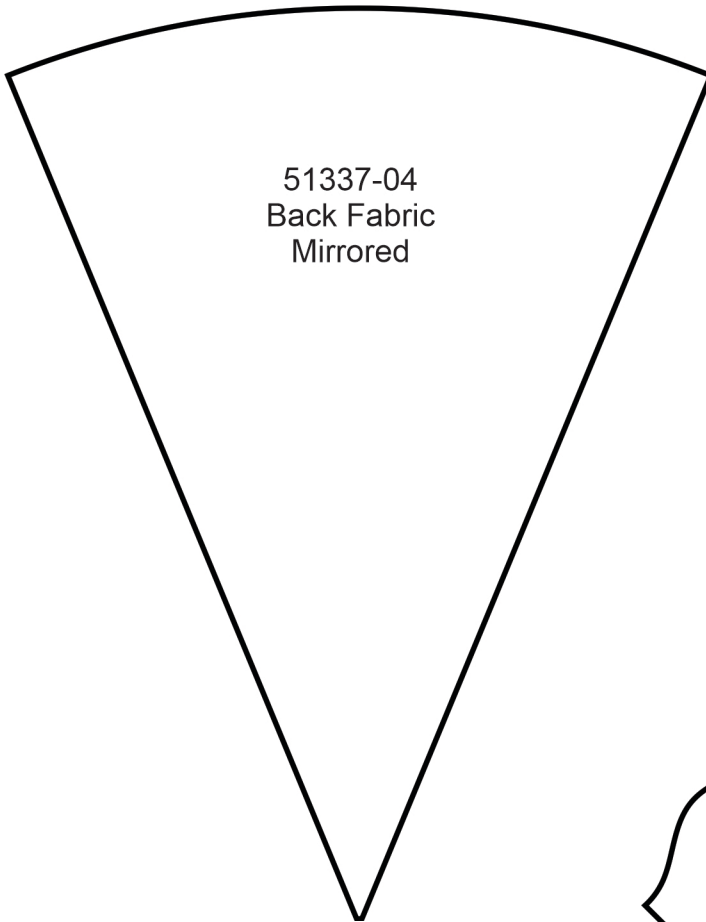

51337-04
Back Fabric
Mirrored

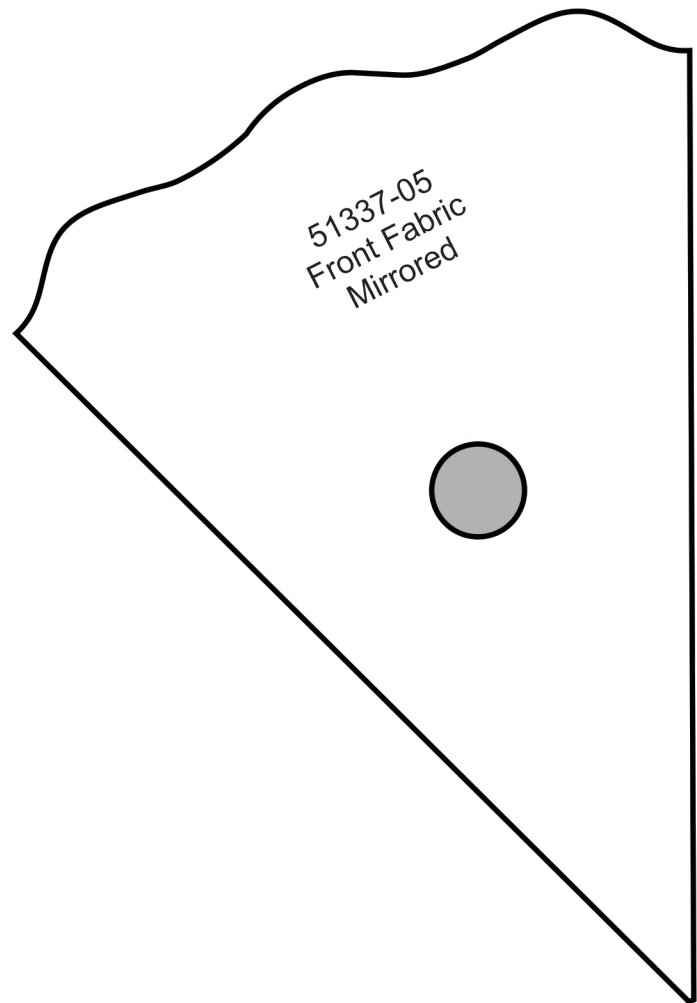

51337-05
Front Fabric
Mirrored

MIRRORED PATTERNS

Print at 100%. No scaling. This box measures 1" x 1". Use the box as an accuracy guide when printing templates.

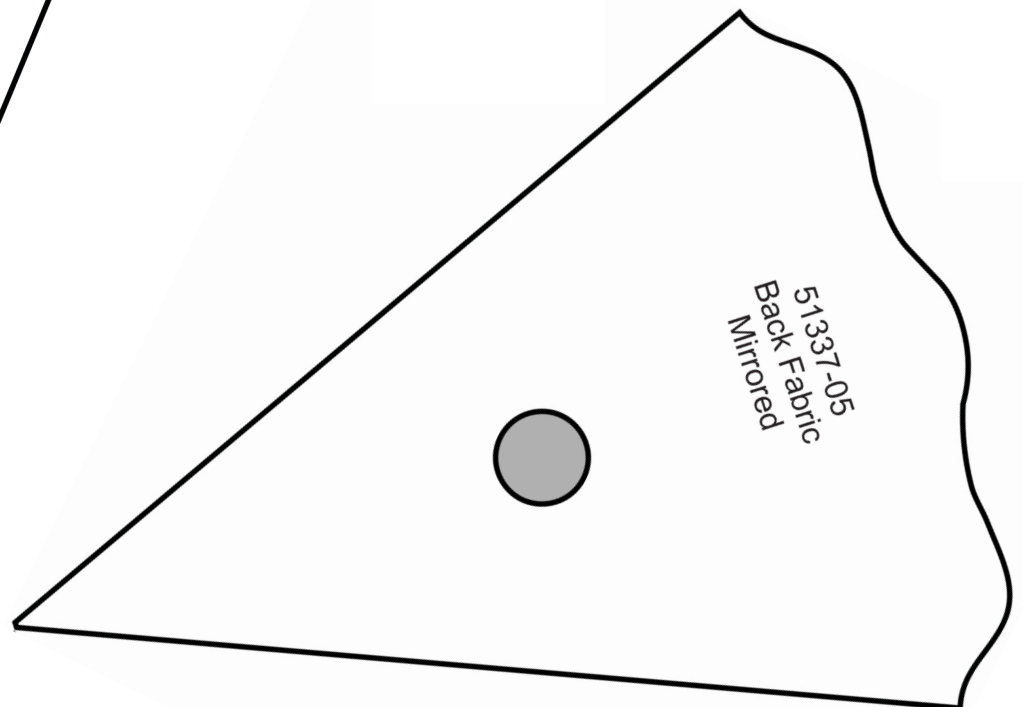
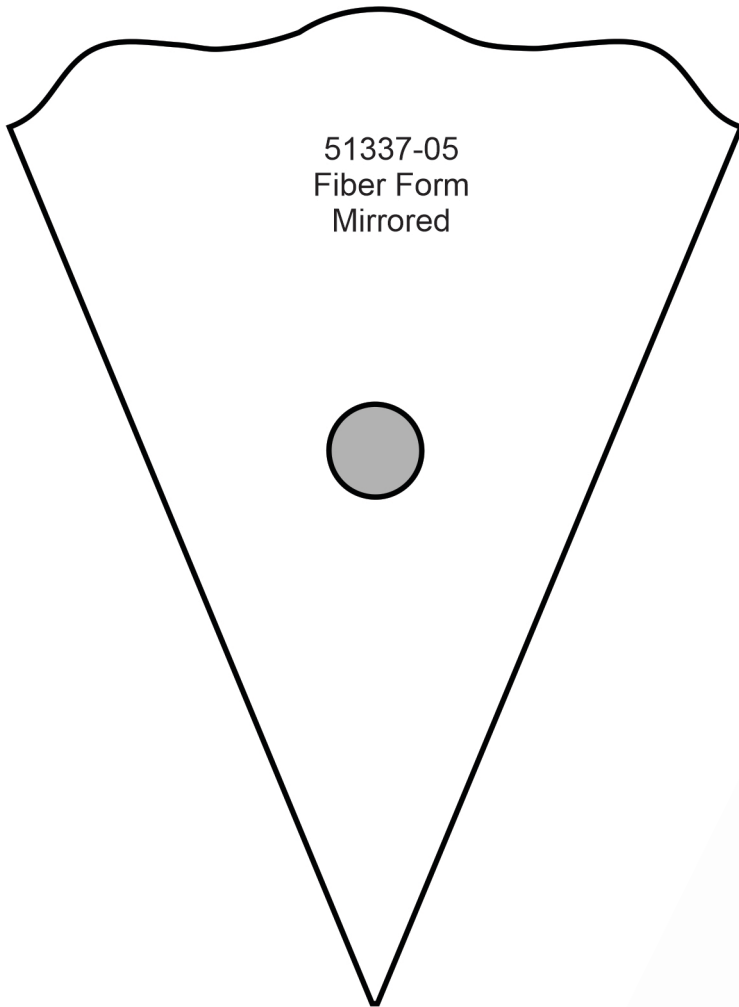

MIRRORED PATTERNS

oeSD™ PREMIER COLLECTION



Print at 100%. No scaling. This box measures 1" x 1". Use the box as an accuracy guide when printing templates.

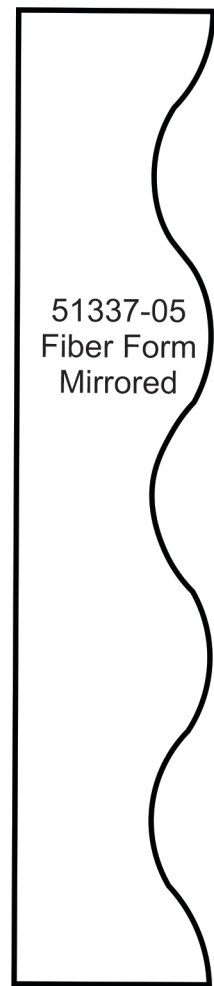
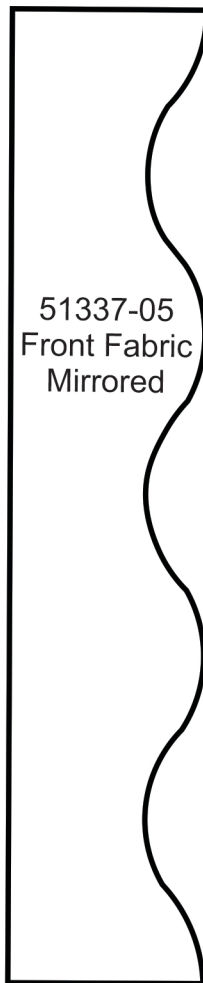
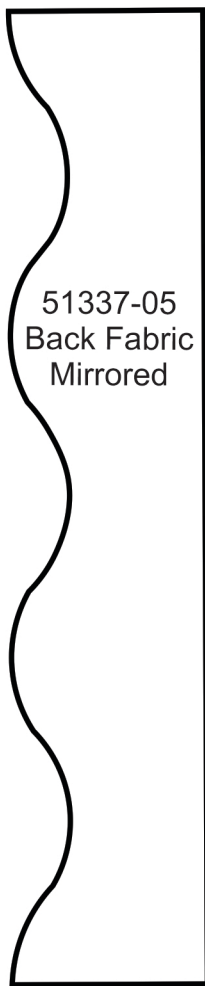

MIRRORED PATTERNS



Print at 100%. No scaling. This box measures 1" x 1". Use the box as an accuracy guide when printing templates.

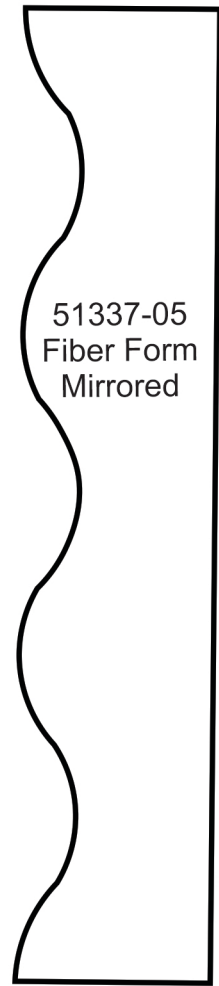
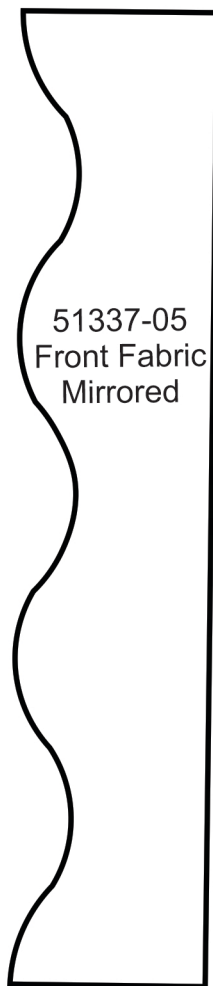
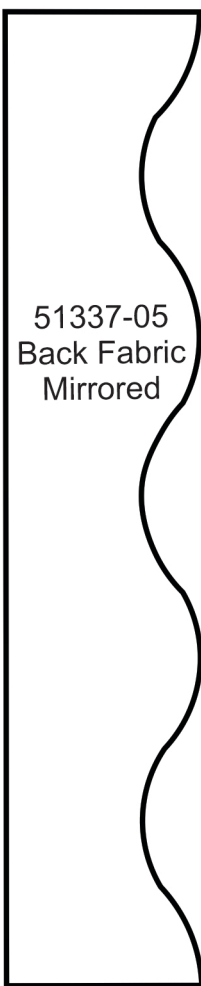

MIRRORED PATTERNS



Print at 100%. No scaling. This box measures 1" x 1". Use the box as an accuracy guide when printing templates.

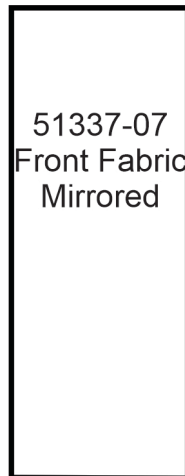

MIRRORED PATTERNS

oeSD™ PREMIER COLLECTION

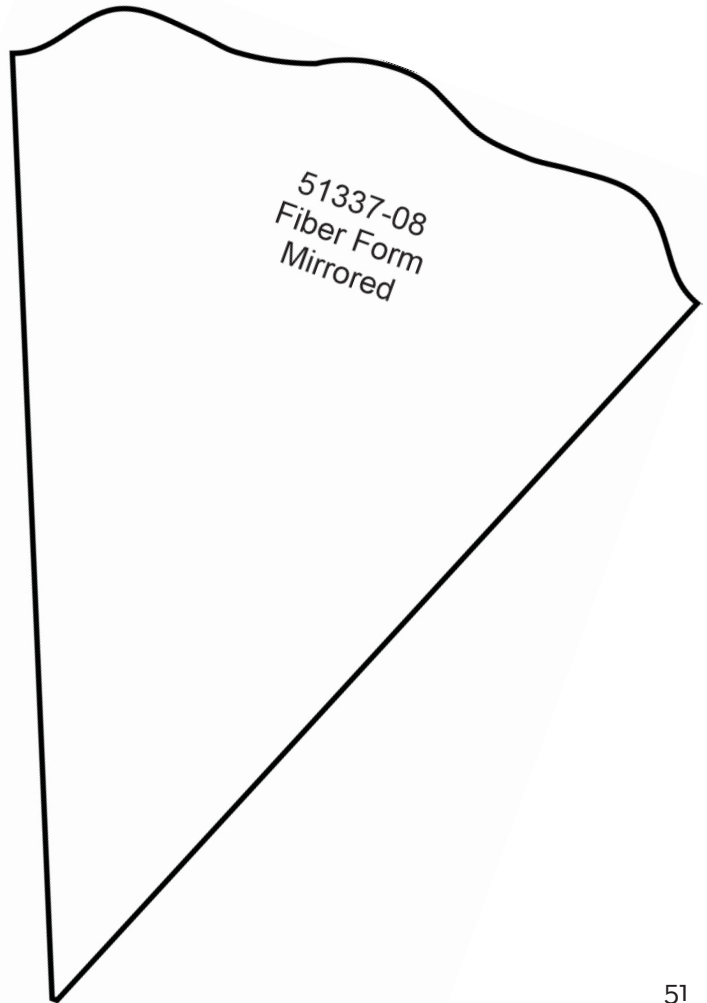
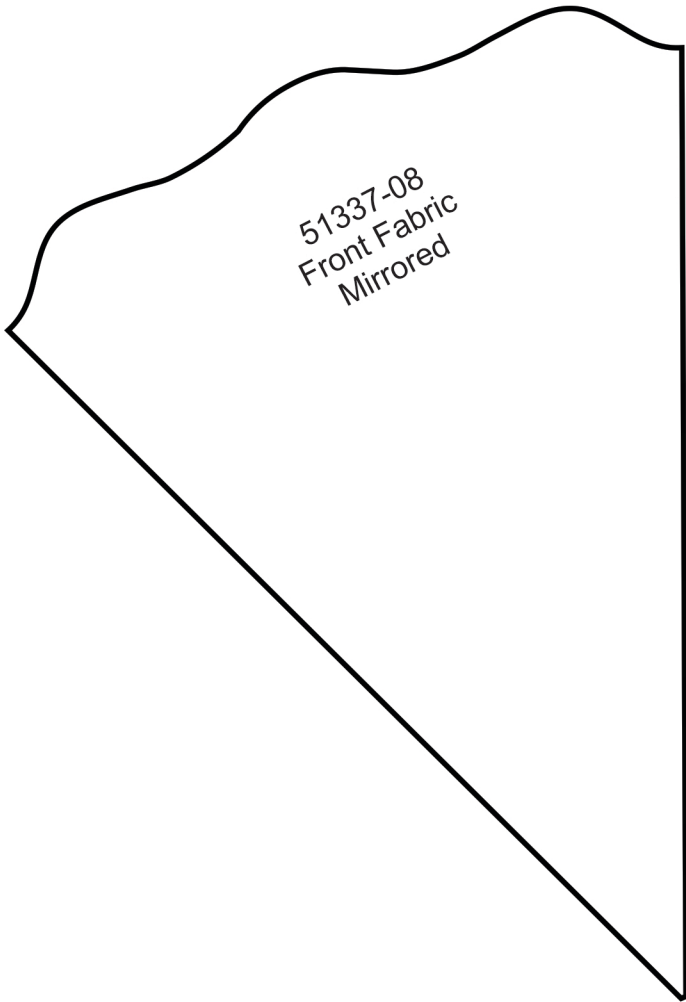

Print at 100%. No scaling. This box measures 1" x 1". Use the box as an accuracy guide when printing templates.

MIRRORED PATTERNS

oeSD™ PREMIER COLLECTION



Print at 100%. No scaling. This box measures 1" x 1". Use the box as an accuracy guide when printing templates.

51337-08
Back Fabric
Mirrored

MIRRORED PATTERNS



Print at 100%. No scaling. This box measures 1" x 1". Use the box as an accuracy guide when printing templates.

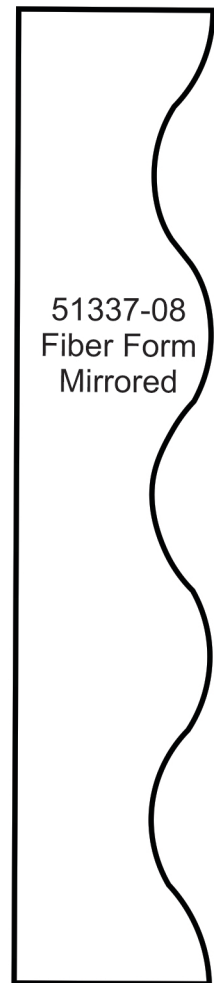
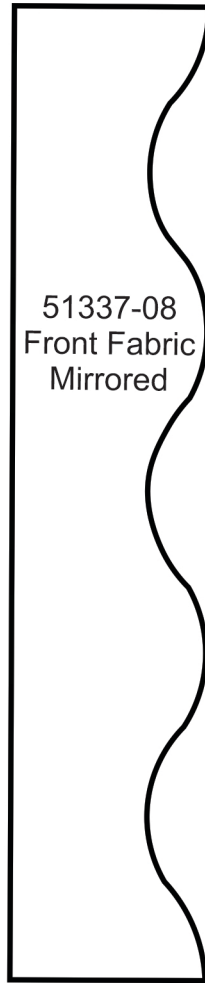
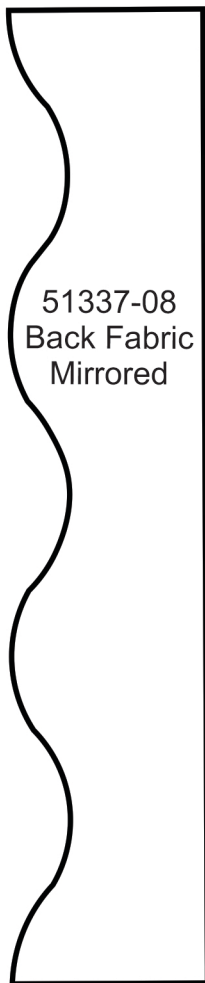

MIRRORED PATTERNS



Print at 100%. No scaling. This box measures 1" x 1". Use the box as an accuracy guide when printing templates.

