



Freestanding Carousel



Collection No. 51339
1 Design/13 Files

MATERIALS



Isacord Thread Colors

- 0015 White
- 0934 Fawn
- 1900 Geranium
- 5440 Mint

Note: One spool of 1000 meter thread is adequate for the project unless otherwise noted.



MATERIALS



Stabilizers

- OESD AquaMesh WashAway
- OESD BadgeMaster WashAway
- OESD StabilStick CutAway
- OESD Fiber Form
- OESD Applique Fuse and Fix

Fabrics/Textiles

- 1/2 yard Brown quilter's cotton
- Note: Fabric amounts are estimates and may result in overages.

Notion & Tools

- OESD Grippy GRID
- OESD Perfect Scoring Tool
- OESD Expert Embroidery Tape TearAway
- OESD Expert Embroidery Tape WashAway
- OESD Perfect Punch Tool
- OESD Mini MAT
- OESD Alligator Clamps
- OESD Button Clips
- OESD Perfect Embroidery Press Cloth
- 1/4" Dowel cut to 5.25" up to 6" long (5 pieces needed)
- Embroidery Needle Sharp 75/11 (FSA)

Isacord Thread Colors

- Per the thread chart
- Match bobbin thread to top thread



SUMMARY



Finished project size: 8" H x 6 1/4" L x 6 1/4" W

51339-01
Pillar Panels 1 FSA



Requires 1 Design

51339-02
Pillar Panels 2 FSA



Requires 1 Design

51339-03
Platform Top FSA



Requires 1 Design

51339-04
Platform Walls FSA

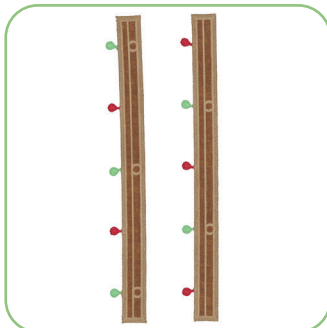

Requires 1 Design

51339-05
Platform Foundation FSA

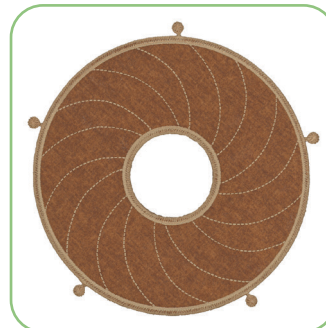

Requires 1 Design

51339-06
Canopy Panels 1 FSA



Requires 1 Design

SUMMARY

51339-07
Canopy Panels 2 FSA



Requires 1 Design

51339-08
Cresting Panels 1 FSA

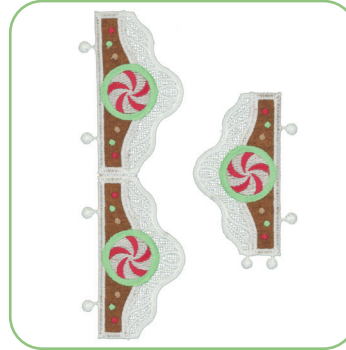

Requires 1 Design

51339-09
Cresting Panels 2 FSA

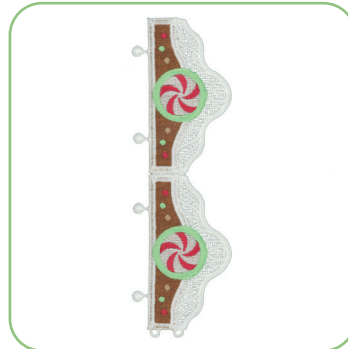

Requires 1 Design

51339-10
Ceiling FSA

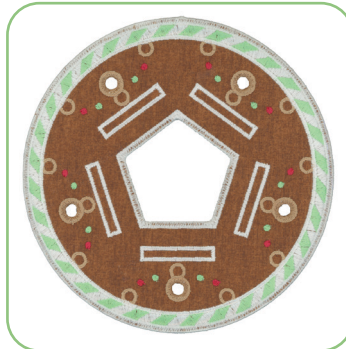

Requires 1 Design

51339-11
Horse 1 FSA

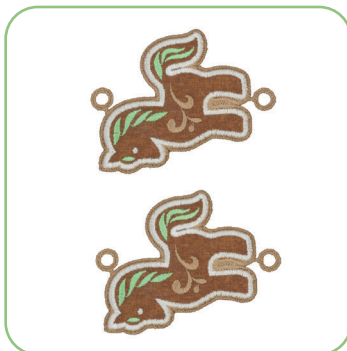

Requires 1 Design

51339-12
Horse 2 FSA



Requires 1 Design

51339-13
Horse 3 FSA



Requires 1 Design

General Instructions

The freestanding applique instructions, included in the collection, are general instructions. For demonstration purposes, a sample design that best demonstrates the technique is shown. Fabric and thread requirements will vary by design, but the general technique is the same. All designs are stitched with matching thread, top and bobbin.

Note: Some thread colors in the instructions have been changed or digitally enhanced for better visibility.

Designs

Design Name	Design Number	Requires
Pillar Panels 1 FSA	51339-01	1
Pillar Panels 2 FSA	51339-02	1
Platform Top FSA	51339-03	1
Platform Walls FSA	51339-04	1
Platform Foundation FSA	51339-05	1
Canopy Panels 1 FSA	51339-06	1
Canopy Panels 2 FSA	51339-07	1



Step 1

- Print the mirrored version of the templates (at 100% scale or 1:1 ratio) onto the paper side of Applique Fuse and Fix.
- Cut approximately 1/4" - 1/2" outside the printed applique templates.

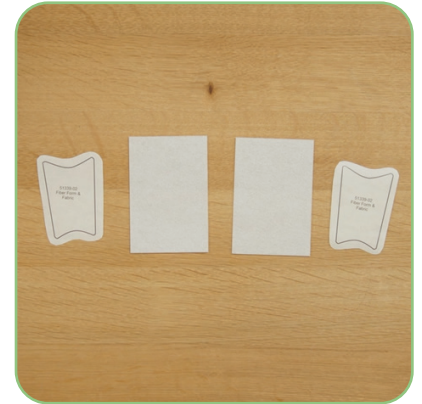

Step 2

- Cut the Fiber Form 1/4" - 1/2" larger than the applique templates.
- Fuse the trimmed templates to the back of the Fiber Form with the paper side of the printed template up. Hold the iron on the template for 10-15 seconds for a secure fuse.



Step 3

- Trim the Fiber Form on the edge of the black outline.
- Set aside.



Step 4

- Adhere one layer of StabilStick CutAway to the wrong side of all applique fabrics to provide stiffness to the finished structure.
- Cut the prepared applique fabrics 1/4"-1/2" larger than the templates that are included at the end of the instructions.

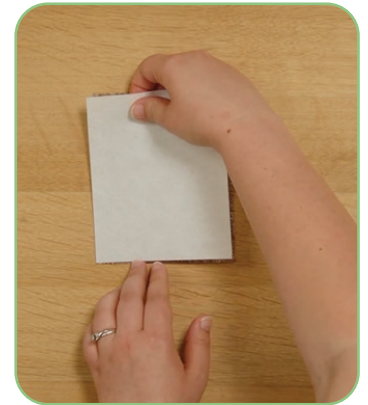
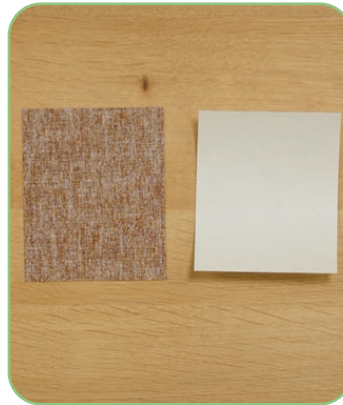

Step 5

- Hoop one layer of AquaMesh and one layer of BadgeMaster for all designs.



Step 6

- Load selected design into the machine.
- Example design is 51339-02.
- Thread the machine per the thread chart.
- Place the hoop on the machine.
- Stitch Machine Step 1, Fiber Form and Brown Fabric Placement Stitch.

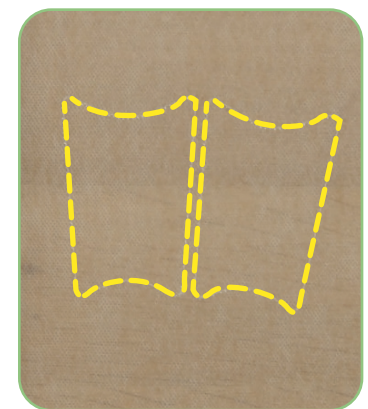

Step 7

- Remove the hoop from the machine, but NOT the project from the hoop.
- Place the hoop on a flat surface.
- On the back of the Fiber Form, use the OESD Perfect Scoring Tool to score and remove the paper backing to reveal the adhesive surface.
- Place the Fiber Form within the placement stitching.
- Finger press to secure.



Step 8

- Completely cover the Fiber Form with the prepared applique fabric.
- Tape in place to secure.

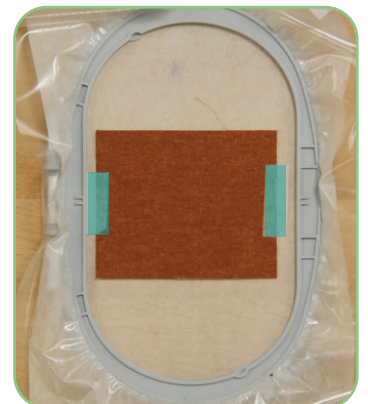

Step 9

- Return the hoop to the machine.
- Stitch Machine Step 2, Cut Line and Tackdown.

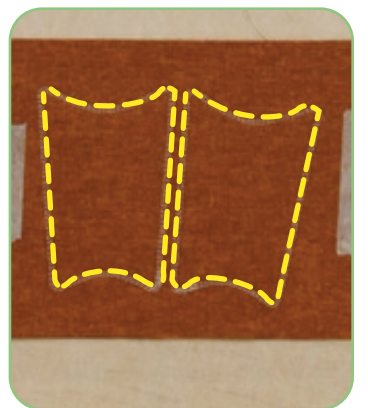

□ Step 10

- Remove the hoop from the machine, but NOT the project from the hoop.
- Trim the excess fabric as close to the cut line as possible. If the outermost stitches (cut line) are cut, the inner stitches (tackdown) will hold the applique in place.
- Tip: If the stabilizer is cut or a hole is created while trimming the fabric, use OESD Expert Embroidery Tape WashAway as a patch.



□ Step 11

- Return the hoop to the machine.
- Stitch the remaining machine steps per the thread chart with matching bobbin thread.



□ Step 12

- When the design is complete, remove the project from the hoop and trim the stabilizer 1/4" - 1/2" outside the design.



Designs

Design Name	Design Number	Requires
Cresting Panels 1 FSA	51339-08	1
Cresting Panels 2 FSA	51339-09	1
Ceiling FSA	51339-10	1
Horse 1 FSA	51339-11	1
Horse 2 FSA	51339-12	1
Horse 3 FSA	51339-13	1

Step 13

- Print the mirrored version of the templates (at 100% scale or 1:1 ratio) onto the paper side of Applique Fuse and Fix.
- Cut approximately 1/4" - 1/2" outside the printed applique templates.



Step 14

- Cut the Fiber Form 1/4" - 1/2" larger than the applique templates.
- Fuse the trimmed templates to the back of the Fiber Form with the paper side of the printed template up. Hold the iron on the template for 10-15 seconds for a secure fuse.



Step 15

- Trim the Fiber Form on the edge of the black outline.
- Set aside.



Step 16

- Adhere one layer of StabilStick CutAway to the wrong side of all applique fabrics to provide stiffness to the finished structure.
- Cut the prepared applique fabrics 1/4"-1/2" larger than the templates that are included at the end of the instructions.

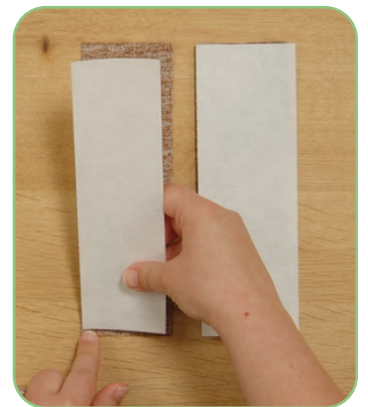

Step 17

- Hoop one layer of AquaMesh and one layer of BadgeMaster for all designs.

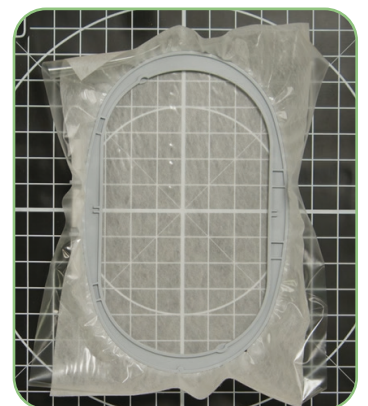

Step 18

- Load selected design into the machine.
- Example design is 51339-09.
- Thread the machine per the thread chart.
- Place the hoop on the machine.
- Stitch Machine Step 1, Fiber Form and Brown Fabric Placement Stitch.

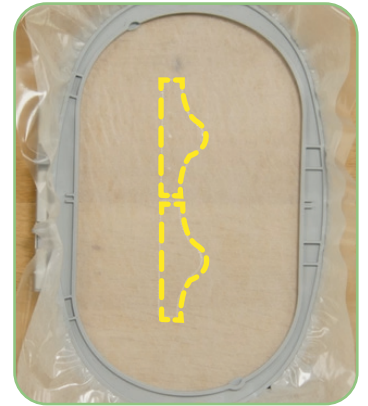

Step 19

- Remove the hoop from the machine, but NOT the project from the hoop.
- Place the hoop on a flat surface.
- On the back of the Fiber Form, use the OESD Perfect Scoring Tool to score and remove the paper backing to reveal the adhesive surface.
- Place the Fiber Form within the placement stitching.
- Finger press to secure.



Step 20

- Completely cover the Fiber Form with the prepared applique fabric.
- Tape in place to secure.



□ Step 21

- Return the hoop to the machine.
- Stitch Machine Step 2, Cut Line and Tackdown.

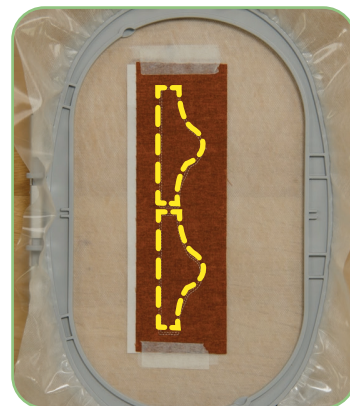

□ Step 22

- Remove the hoop from the machine, but NOT the project from the hoop.
- Trim the excess fabric as close to the cut line as possible.



□ Step 23

- Return the hoop to the machine.
- Stitch Machine Steps 3-6 per the thread chart.



Step 24

- Remove the hoop from the machine, but NOT the project from the hoop.
- Turn the hoop over and place the prepared applique fabric, right side up, completely covering the placement stitch.
- Carefully tape to secure.
- Tip: Avoid pushing too hard on the stabilizer to prevent it from dislodging from the hoop.



Step 25

- Return the hoop to the machine.
- Stitch Machine Step 7, Back Fabric Cut Line and Tackdown.



Step 26

- Remove the hoop from the machine, but NOT the project from the hoop.
- Turn the hoop over and trim the excess fabric as close to the cut line as possible.



Step 27

- Return the hoop to the machine.
- Stitch the remaining machine steps per the thread chart with matching bobbin thread.



Step 28

- When the design is complete, remove the project from the hoop and trim the stabilizer 1/4" - 1/2" outside the design.



ASSEMBLY

□ Step 29

- Rinse each piece in warm running water until the design is only slightly tacky.
- Place right side down on a non-stick surface to dry. Parchment paper or a cooling rack work well to prevent curling. Dry completely.
- Once dry, press right side down on a Perfect Embroidery Press Cloth.



□ Step 30

- Before assembly, use the OESD Mini MAT and a craft knife to cut through all the layers of the tab entries.
- Use the OESD Mini MAT and Punch Tool with the 3mm attachment to create the eyelets indicated in the diagram.
- Tip: Take care to not cut the satin stitching.
- Reference the Punch Tool Guide on page 28.



ASSEMBLY

□ Step 31

- Line up the 2 Platform Walls FSA (51339-04) to connect on the short ends.
- Thread the sewing machine with matching thread in the top and bobbin.
- Stitch together using a multi-step zigzag stitch.
- Back stitch at the beginning and end to secure.
- Trim thread tails.

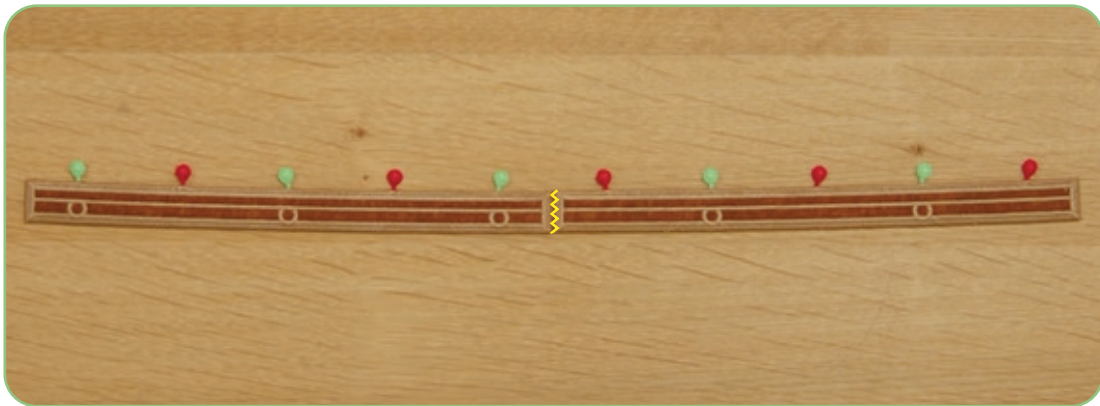

□ Step 32

- Bend the Platform walls so that the unsewn short ends meet.
- Stitch together using a multi-step zigzag stitch.
- Back stitch at the beginning and end to secure.
- Trim thread tails.



ASSEMBLY

Step 33

- Line up the Pillar Panels 1 (51339-01) and Pillar Panels 2 (51339-02) to connect.
- Stitch together using a multi-step zigzag stitch to create the Pillar Panels unit.
- Back stitch at the beginning and end to secure.
- Trim thread tails.



Step 34

- Line up the Canopy Panels 1 FSA (51339-06) and Canopy Panels 2 FSA (51339-07) to connect.
- Stitch together using a multi-step zigzag stitch to create the Canopy Panels unit.
- Back stitch at the beginning and end to secure.
- Trim thread tails.



ASSEMBLY

Step 36

- Bend and fold the Pillar Panels unit to match up the buttonettes and eyelets.
- Use Alligator Clamps to pull each buttonette through the corresponding eyelet, using button clips to temporarily hold them in place, as needed.
- Set aside.



Step 37

- Bend and fold the Canopy Panels unit to match up the buttonettes and eyelets.
- Use Alligator Clamps to pull each buttonette through the corresponding eyelet, using button clips to temporarily hold them in place, as needed.
- Set aside.



ASSEMBLY

Step 38

- Bend and fold the Cresting Panels unit to match up the buttonettes and eyelets.
- Pull each buttonette through the corresponding eyelet.
- Set aside.

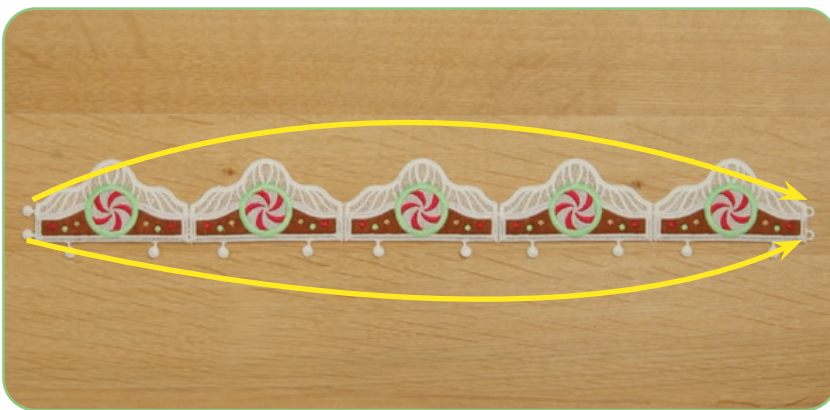

Step 39

- Match the locking tabs on the wider end of the Pillar Panel unit into the tab entries on the bottom of the Ceiling FSA (51339-10).
- Insert each locking tab through the corresponding tab entry.

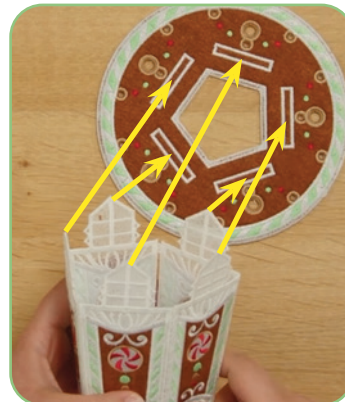

ASSEMBLY

□ Step 40

- Match the buttonettes at the bottom of the Canopy Panels unit with the inner eyelets of the Ceiling.
- Pull the buttonettes through to the wrong side of the Ceiling.

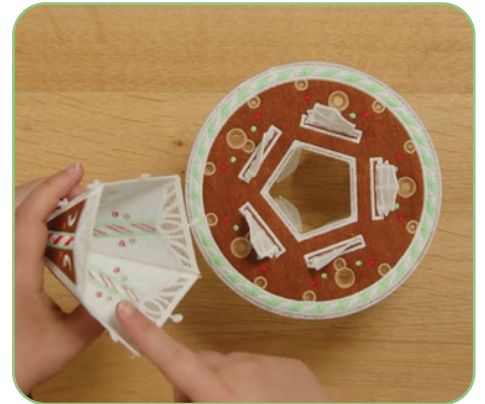

□ Step 41

- Match the buttonettes of the Cresting Panels unit to the outer eyelets of the Ceiling.
- Pull each buttonette through the corresponding eyelet.

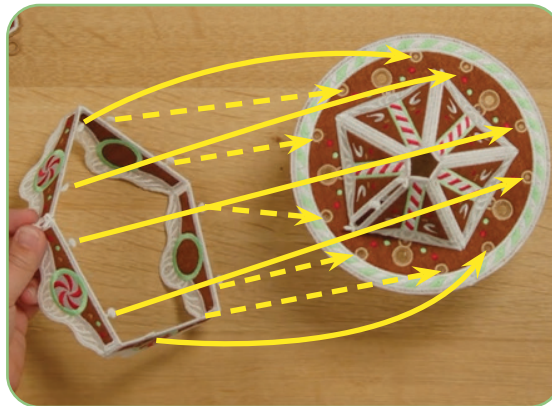

ASSEMBLY

□ Step 42

- Match the locking tabs on the narrower end of the Pillar Panel unit with the tab entries on the top of the Platform Top FSA (51339-03).
- Insert each locking tab through the corresponding tab entry.

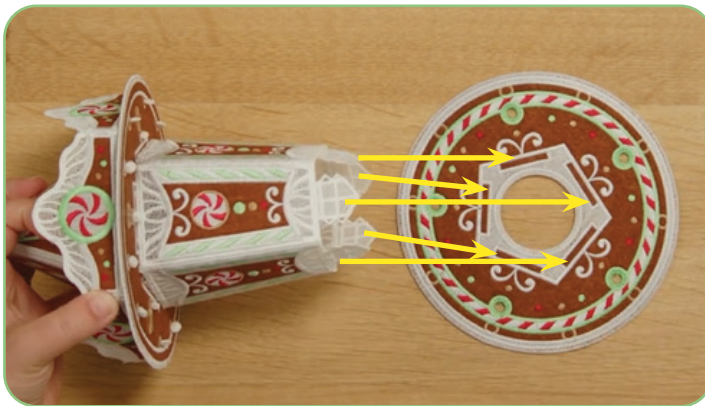

□ Step 43

- Match the buttonettes of the Platform Walls unit to the eyelets of the Platform Top. Make sure the green buttonettes are aligned with the green dowel rod eyelet.
- Pull each buttonette through the corresponding eyelet.

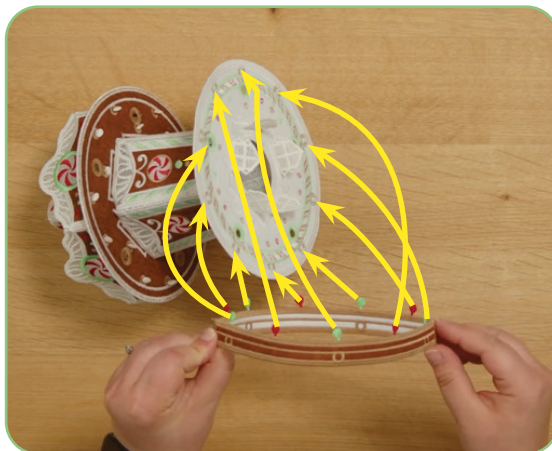

ASSEMBLY

□ Step 44

- Match the buttonettes of the Platform Foundation (51339-05) to the eyelets of the Platform Walls.
- Pull each buttonette through the corresponding eyelet.

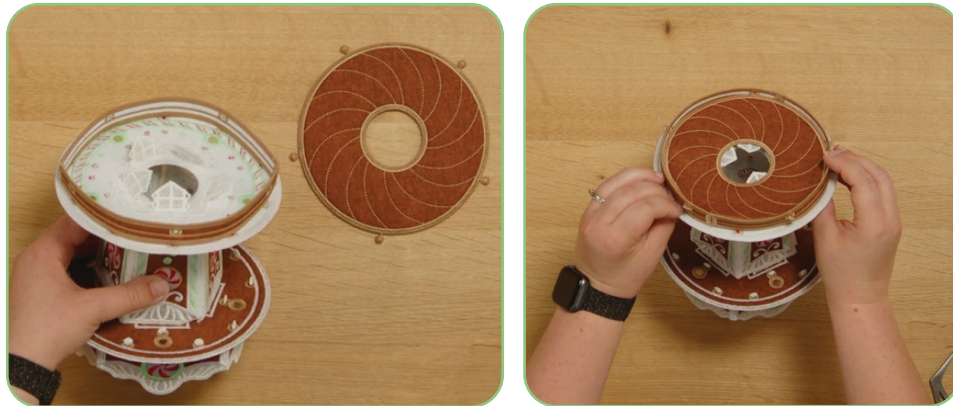

□ Step 45

- Insert a 1/4" dowel rod into one of the dowel rod eyelets on the top of the Ceiling.
- Insert the same dowel rod into the top loop of Horse 1 FSA (51339-11) then into the bottom loop. The dowel rod will be on the backside of the horse.
- Finally, insert the dowel rod into the Platform Top.
- Repeat for the other 4 dowel rods and horses.



ASSEMBLY

□ Step 46

- The project is complete. Enjoy!



PUNCH TOOL GUIDES



51339-03



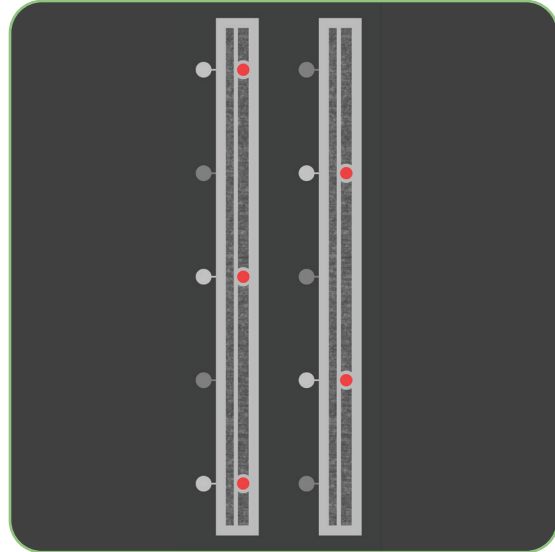

51339-04

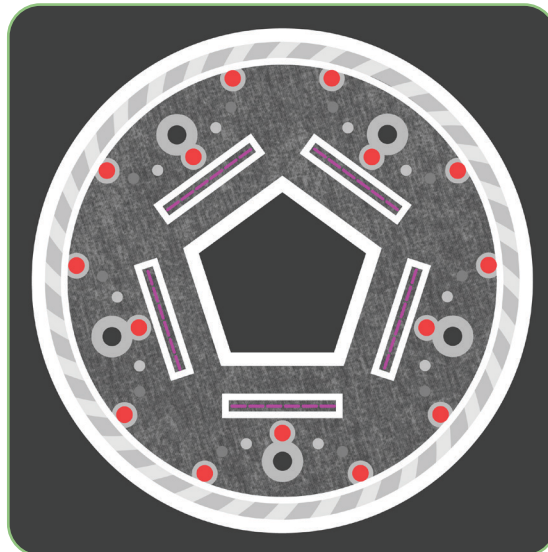

51339-10



 = 2 MM

 = 3 MM

 = 4 MM

CRAFT KNIFE



ATTENTION

When printing this document, any page scaling or page fitting options in your print dialog box must be turned OFF or set to NONE so that your files will print out at their actual size. Images not printed at actual size will not function as intended.

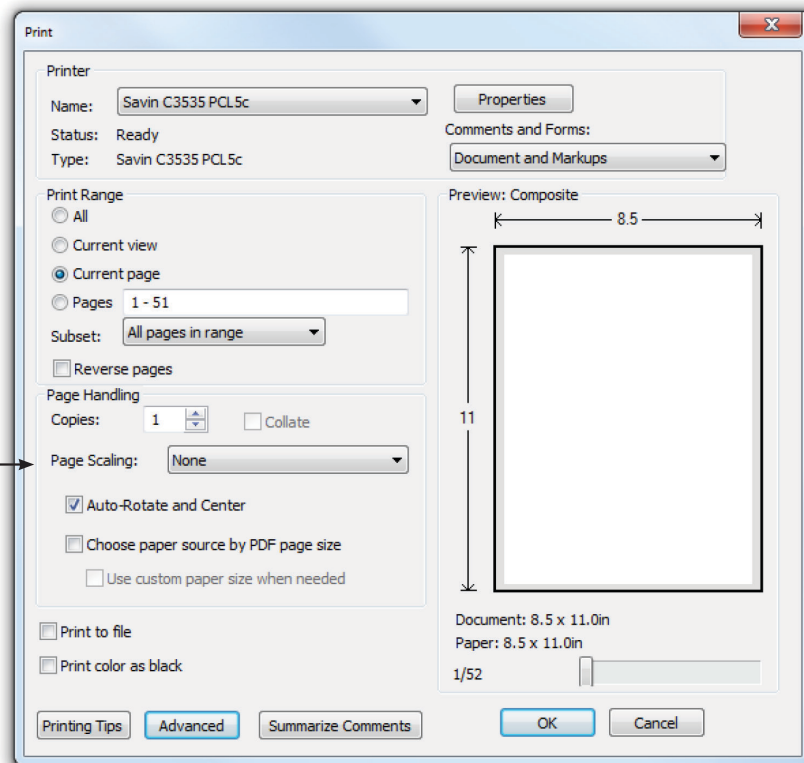

TO SAVE PAPER

Only print the desired image by navigating to the image's page, go to File > Print and select "Current page" in the print dialog box. Repeat for each desired image.

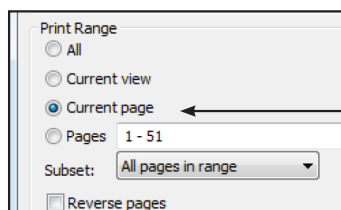

APPLIQUE PATTERNS

Print at 100%. No scaling. This box measures 1" x 1". Use the box as an accuracy guide when printing templates.

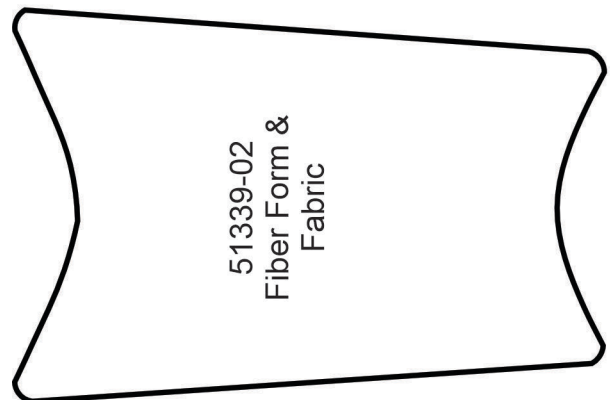
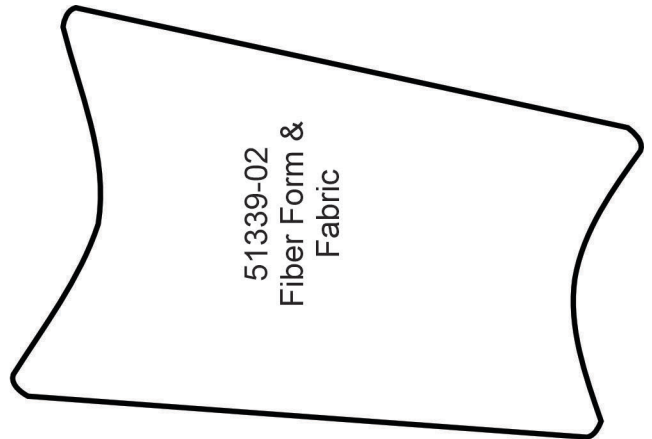
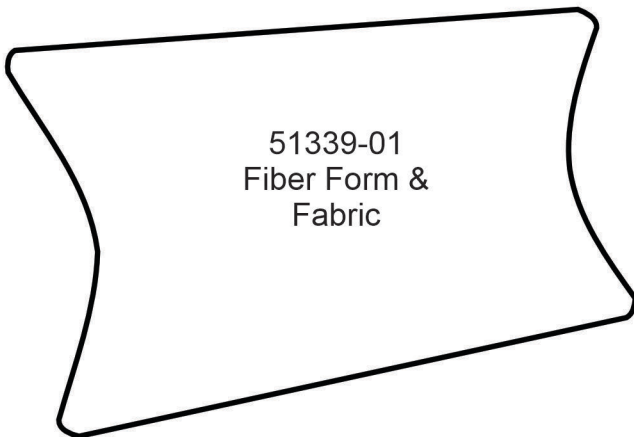
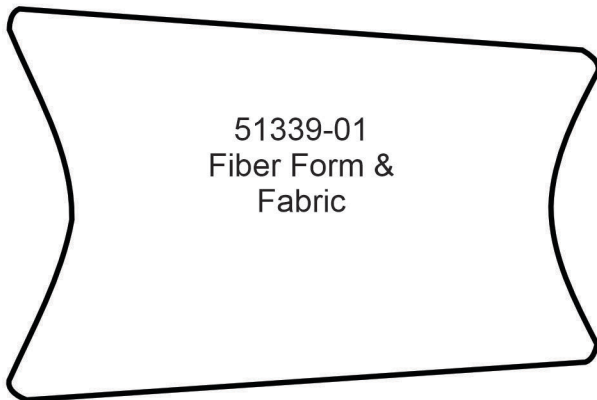
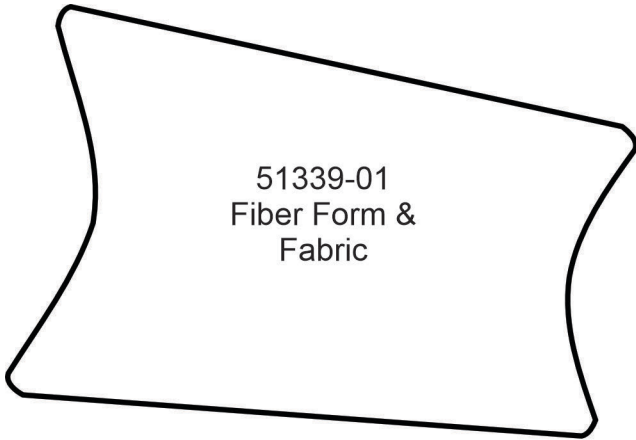

APPLIQUE PATTERNS

Print at 100%. No scaling. This box measures 1" x 1". Use the box as an accuracy guide when printing templates.

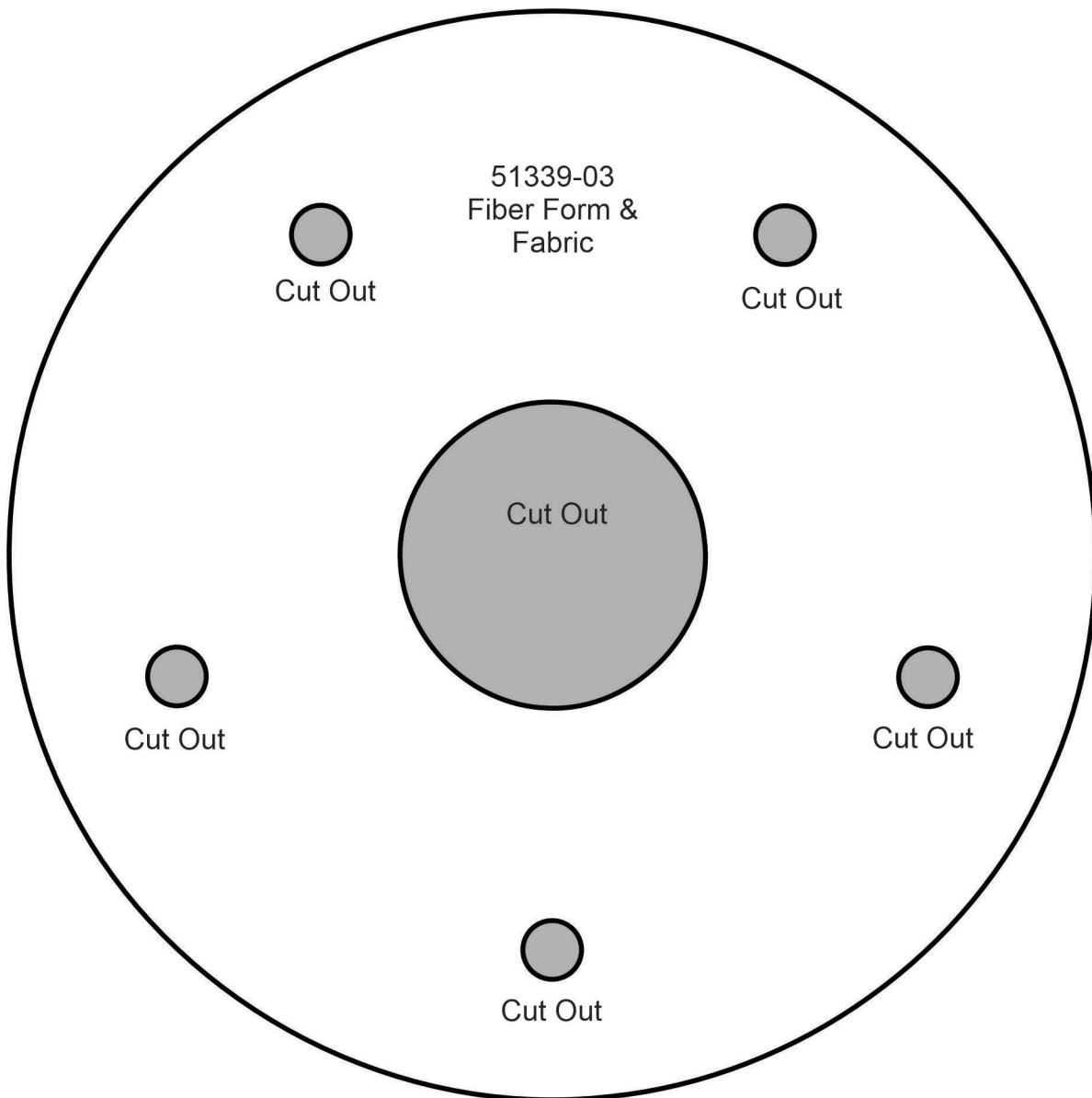

APPLIQUE PATTERNS



Print at 100%. No scaling. This box measures 1" x 1". Use the box as an accuracy guide when printing templates.

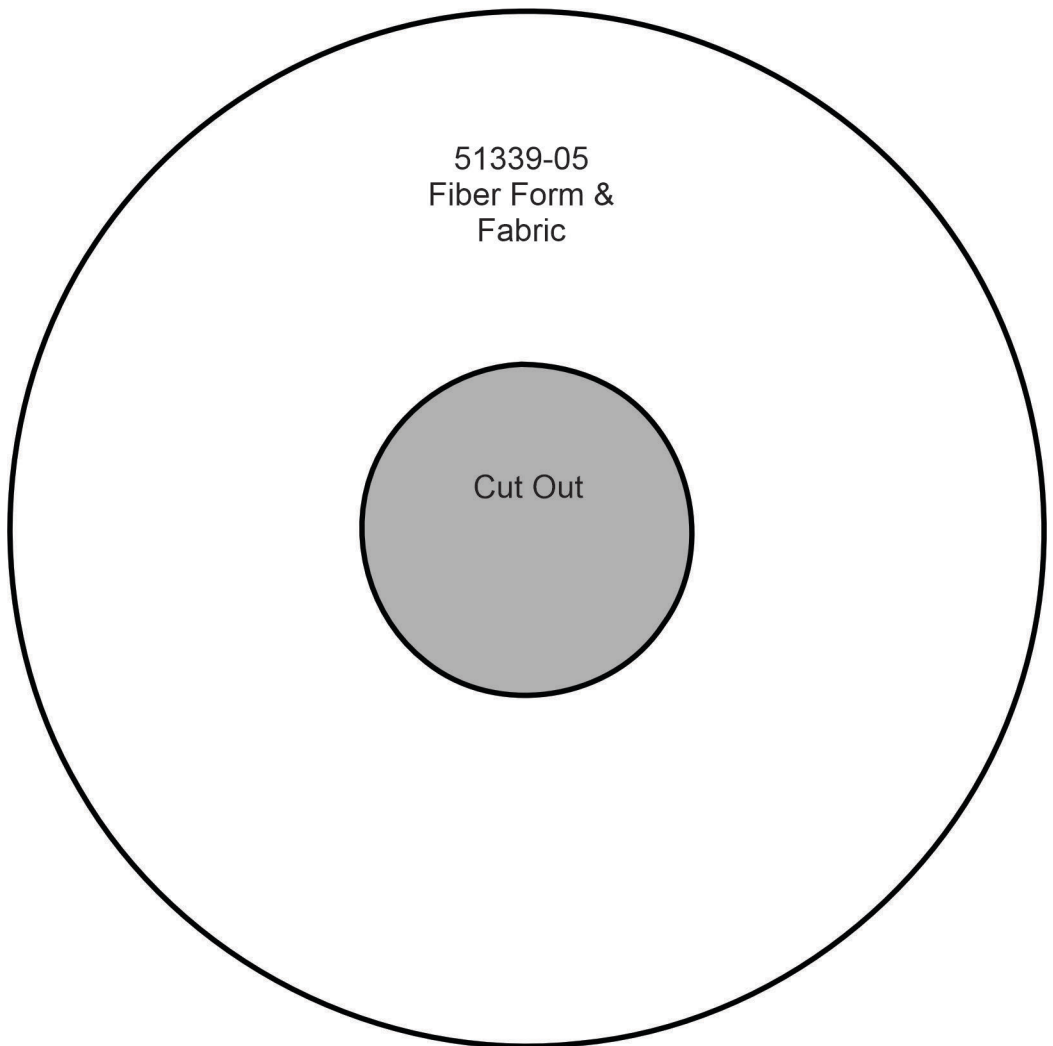

APPLIQUE PATTERNS

Print at 100%. No scaling. This box measures 1" x 1". Use the box as an accuracy guide when printing templates.

51339-06
Fiber Form &
Fabric

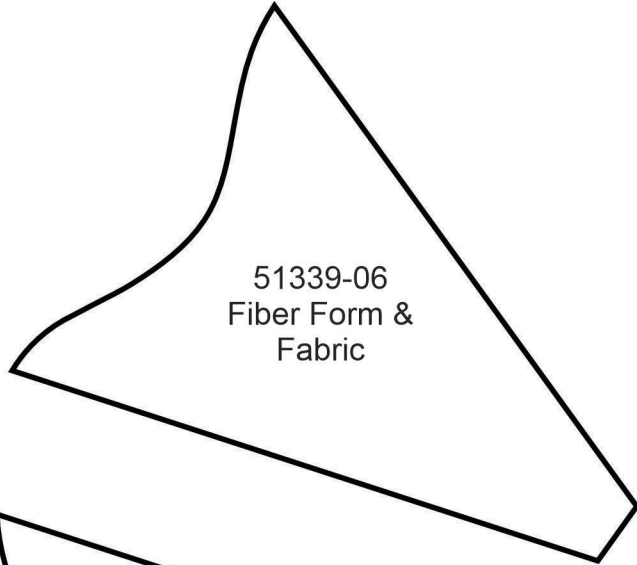

51339-06
Fiber Form &
Fabric

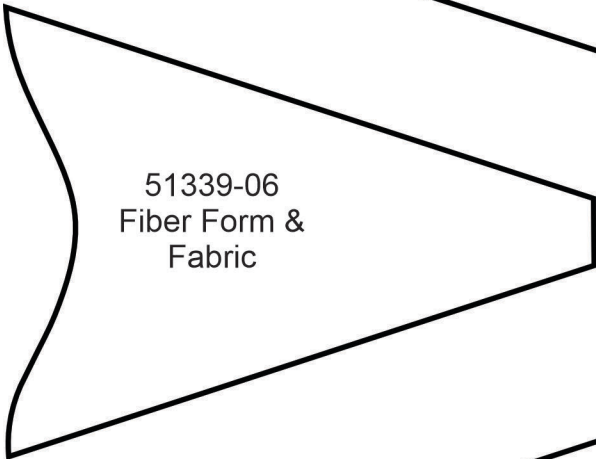

51339-07
Fiber Form &
Fabric

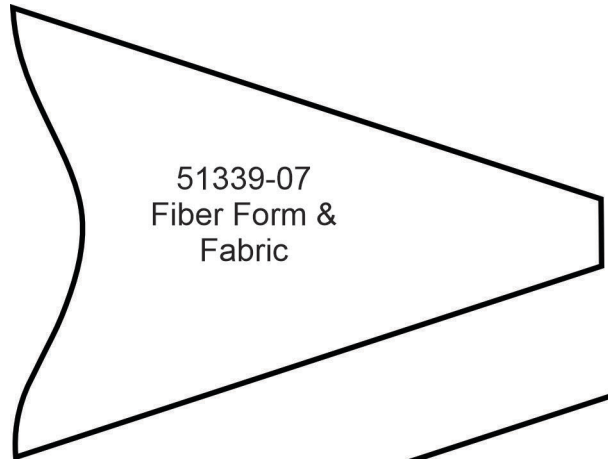

51339-07
Fiber Form &
Fabric

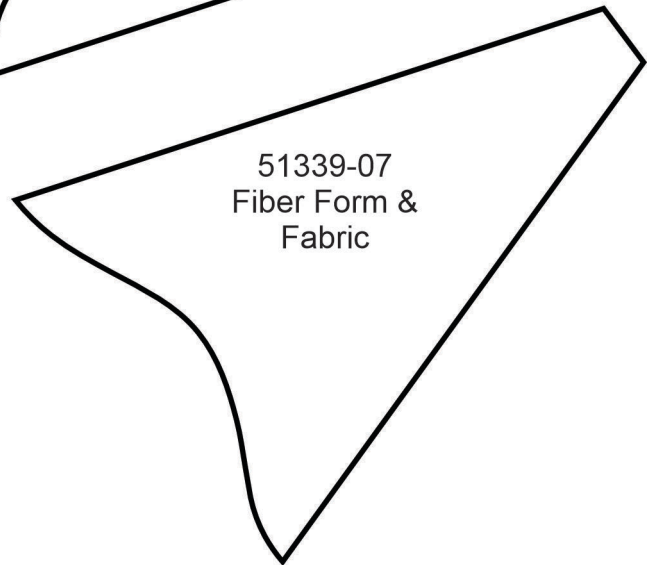

51339-06
Fiber Form &
Fabric

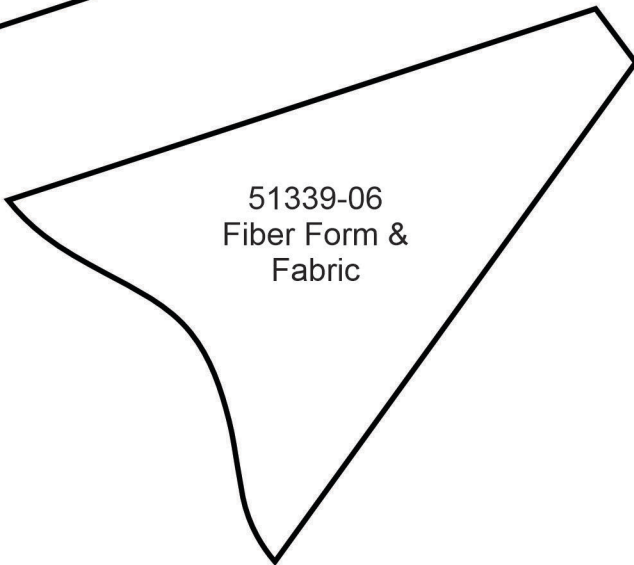

APPLIQUE PATTERNS

Print at 100%. No scaling. This box measures 1" x 1". Use the box as an accuracy guide when printing templates.



APPLIQUE PATTERNS



Print at 100%. No scaling. This box measures 1" x 1". Use the box as an accuracy guide when printing templates.



APPLIQUE PATTERNS

Print at 100%. No scaling. This box measures 1" x 1". Use the box as an accuracy guide when printing templates.

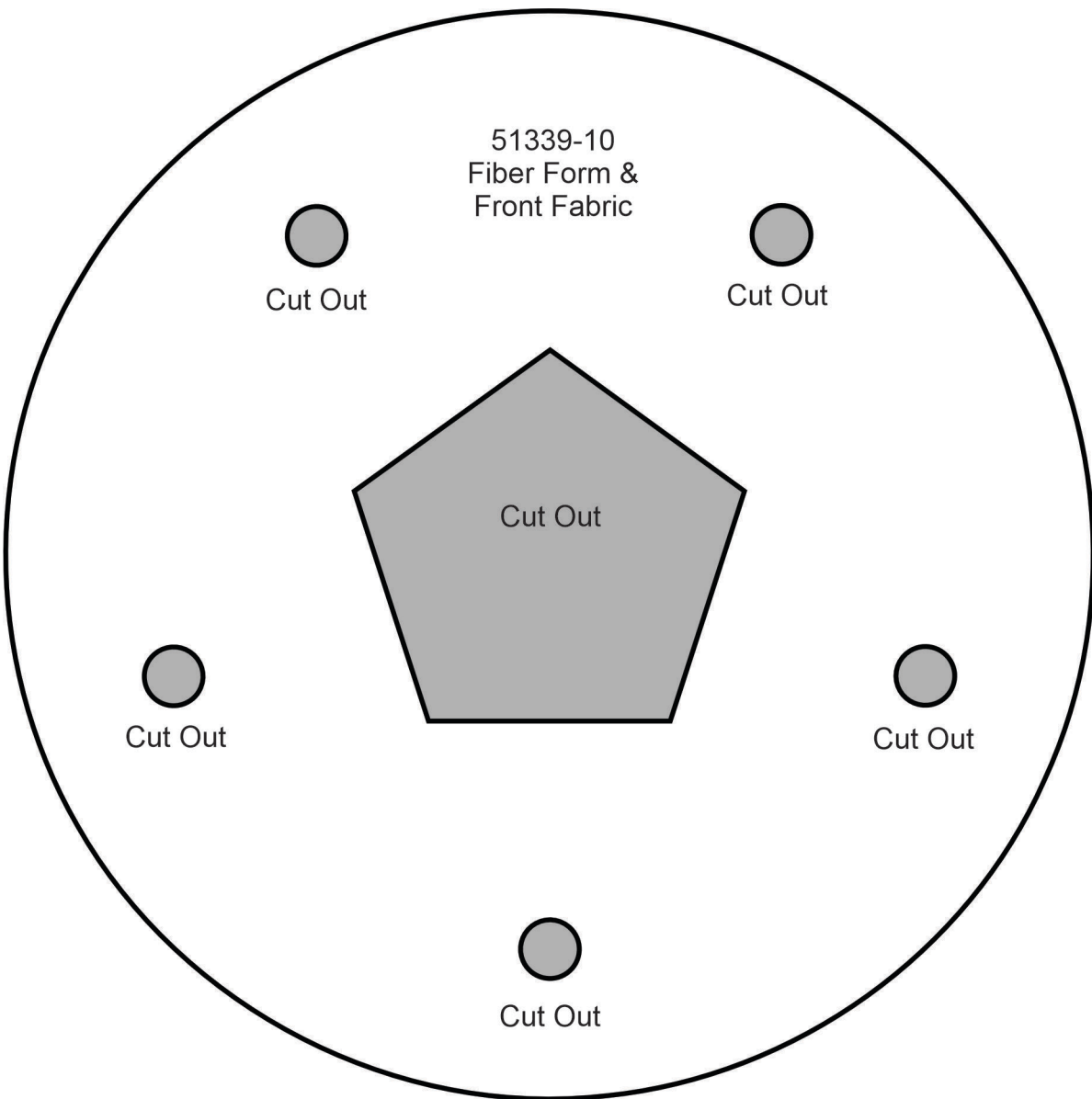

APPLIQUE PATTERNS

Print at 100%. No scaling. This box measures 1" x 1". Use the box as an accuracy guide when printing templates.

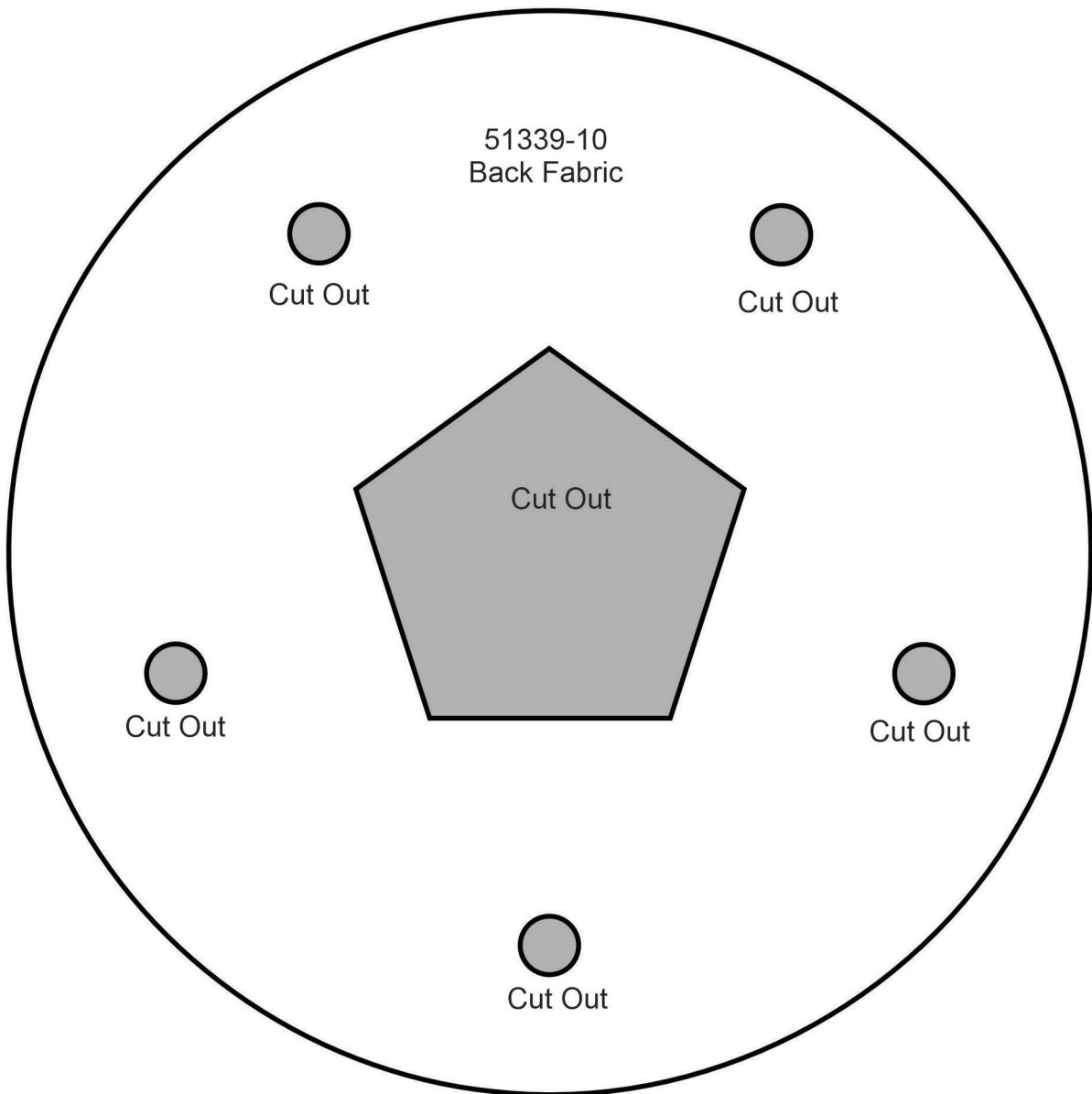

APPLIQUE PATTERNS

Print at 100%. No scaling. This box measures 1" x 1". Use the box as an accuracy guide when printing templates.

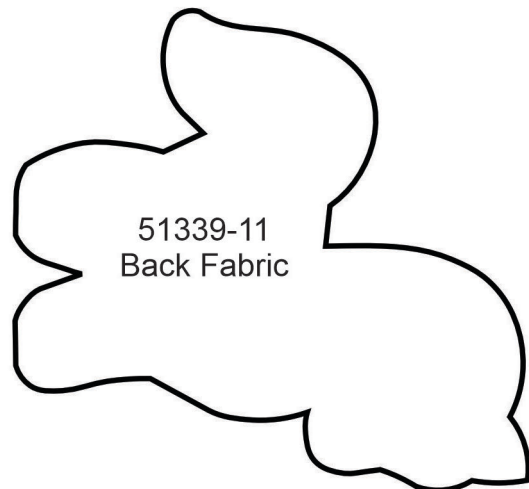
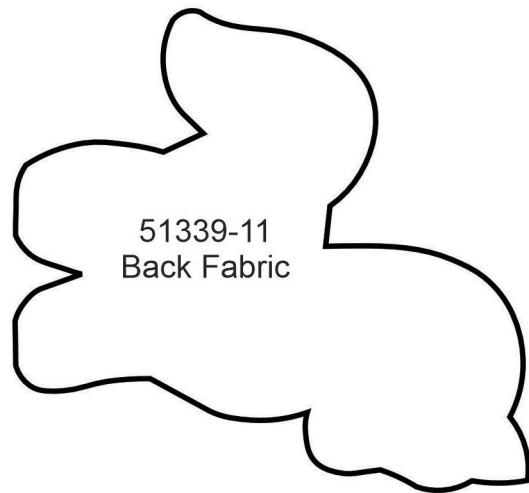
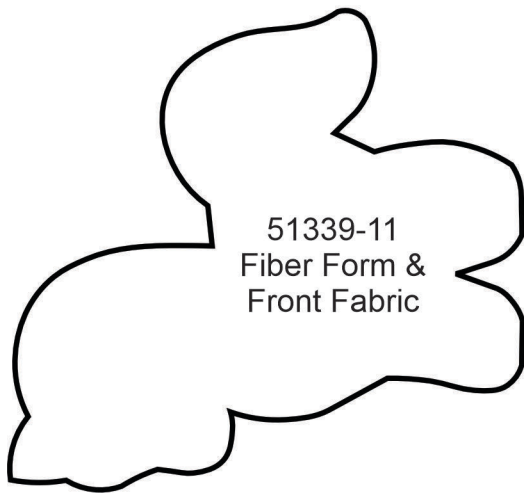
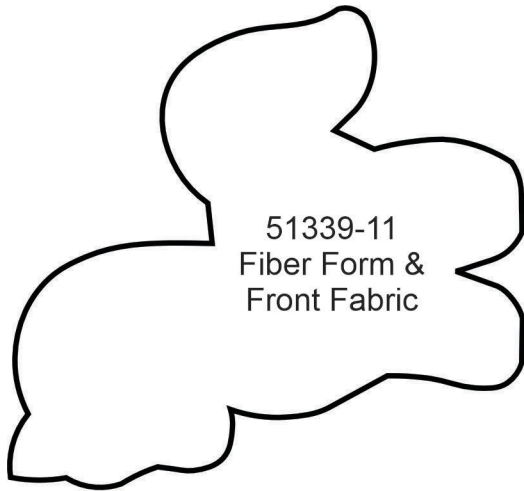

APPLIQUE PATTERNS

Print at 100%. No scaling. This box measures 1" x 1". Use the box as an accuracy guide when printing templates.

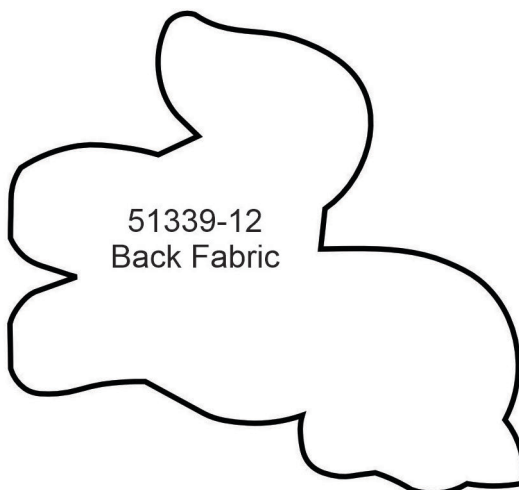
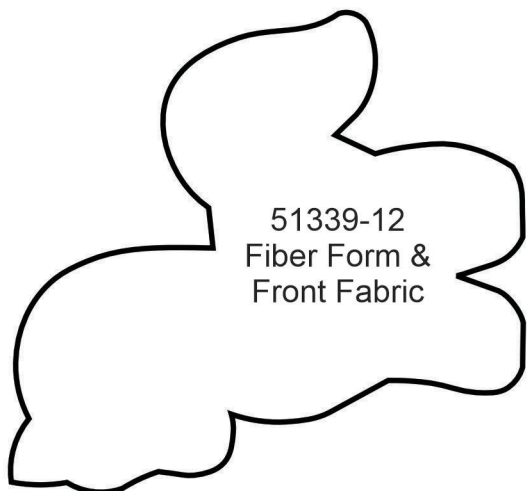
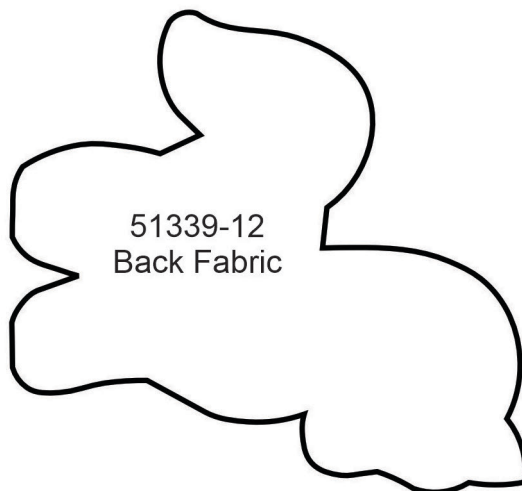

MIRRORED PATTERNS

Print at 100%. No scaling. This box measures 1" x 1". Use the box as an accuracy guide when printing templates.

51339-01
Fiber Form &
Fabric
Mirrored

51339-01
Fiber Form &
Fabric
Mirrored

51339-01
Fiber Form &
Fabric
Mirrored

51339-02
Fiber Form &
Fabric
Mirrored

51339-02
Fiber Form &
Fabric
Mirrored

MIRRORED PATTERNS



Print at 100%. No scaling. This box measures 1" x 1". Use the box as an accuracy guide when printing templates.

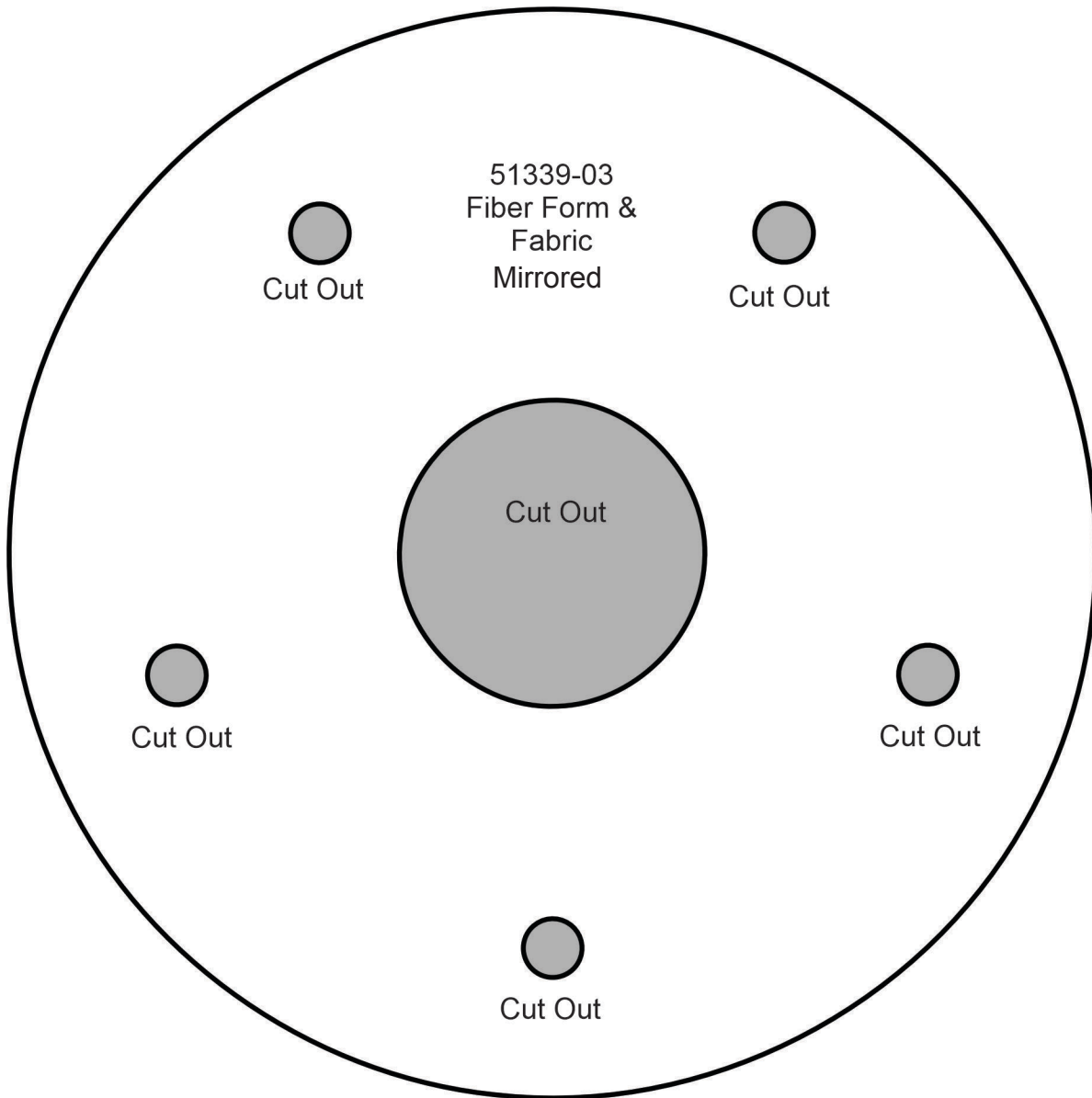

MIRRORED PATTERNS **oesd**™ PREMIER COLLECTION

Print at 100%. No scaling. This box measures 1" x 1". Use the box as an accuracy guide when printing templates.

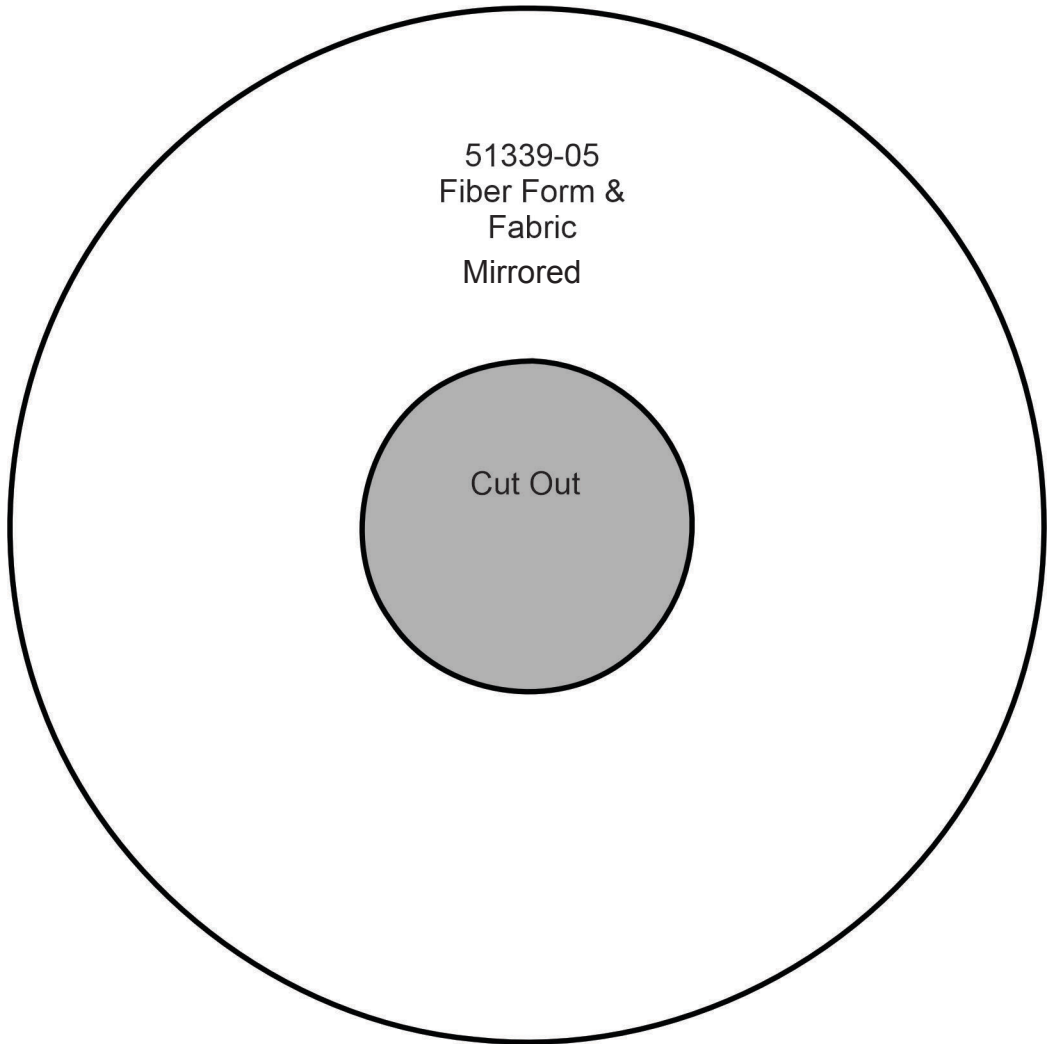

MIRRORED PATTERNS PREMIER COLLECTION

Print at 100%. No scaling. This box measures 1" x 1". Use the box as an accuracy guide when printing templates.



51339-06
Fiber Form &
Fabric
Mirrored



51339-07
Fiber Form &
Fabric
Mirrored



51339-06
Fiber Form &
Fabric
Mirrored



51339-07
Fiber Form &
Fabric
Mirrored



51339-06
Fiber Form &
Fabric
Mirrored

MIRRORED PATTERNS PREMIER COLLECTION

Print at 100%. No scaling. This box measures 1" x 1". Use the box as an accuracy guide when printing templates.



MIRRORED PATTERNS



Print at 100%. No scaling. This box measures 1" x 1". Use the box as an accuracy guide when printing templates.



MIRRORED PATTERNS PREMIER COLLECTION

Print at 100%. No scaling. This box measures 1" x 1". Use the box as an accuracy guide when printing templates.

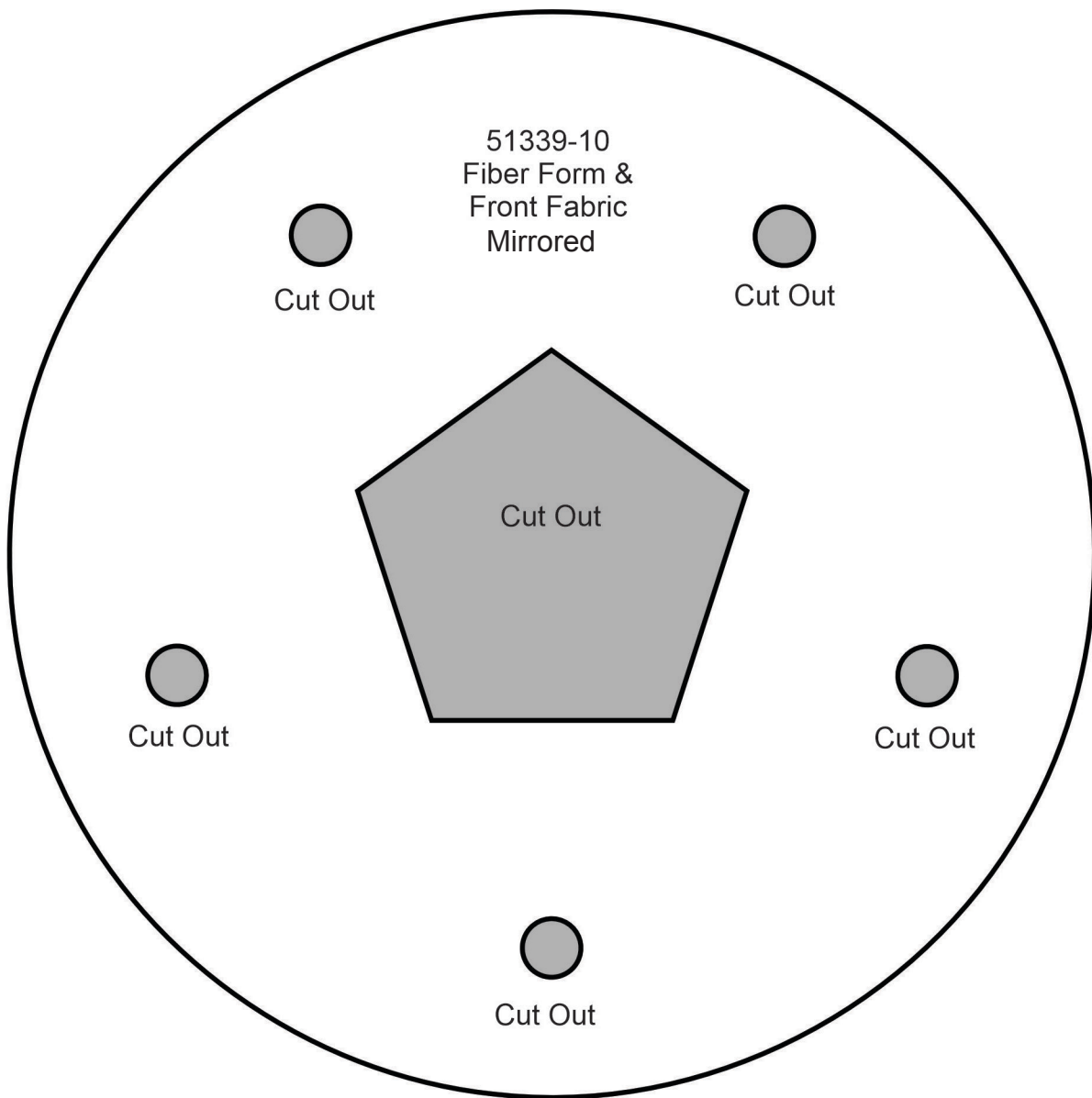

MIRRORED PATTERNS



Print at 100%. No scaling. This box measures 1" x 1". Use the box as an accuracy guide when printing templates.

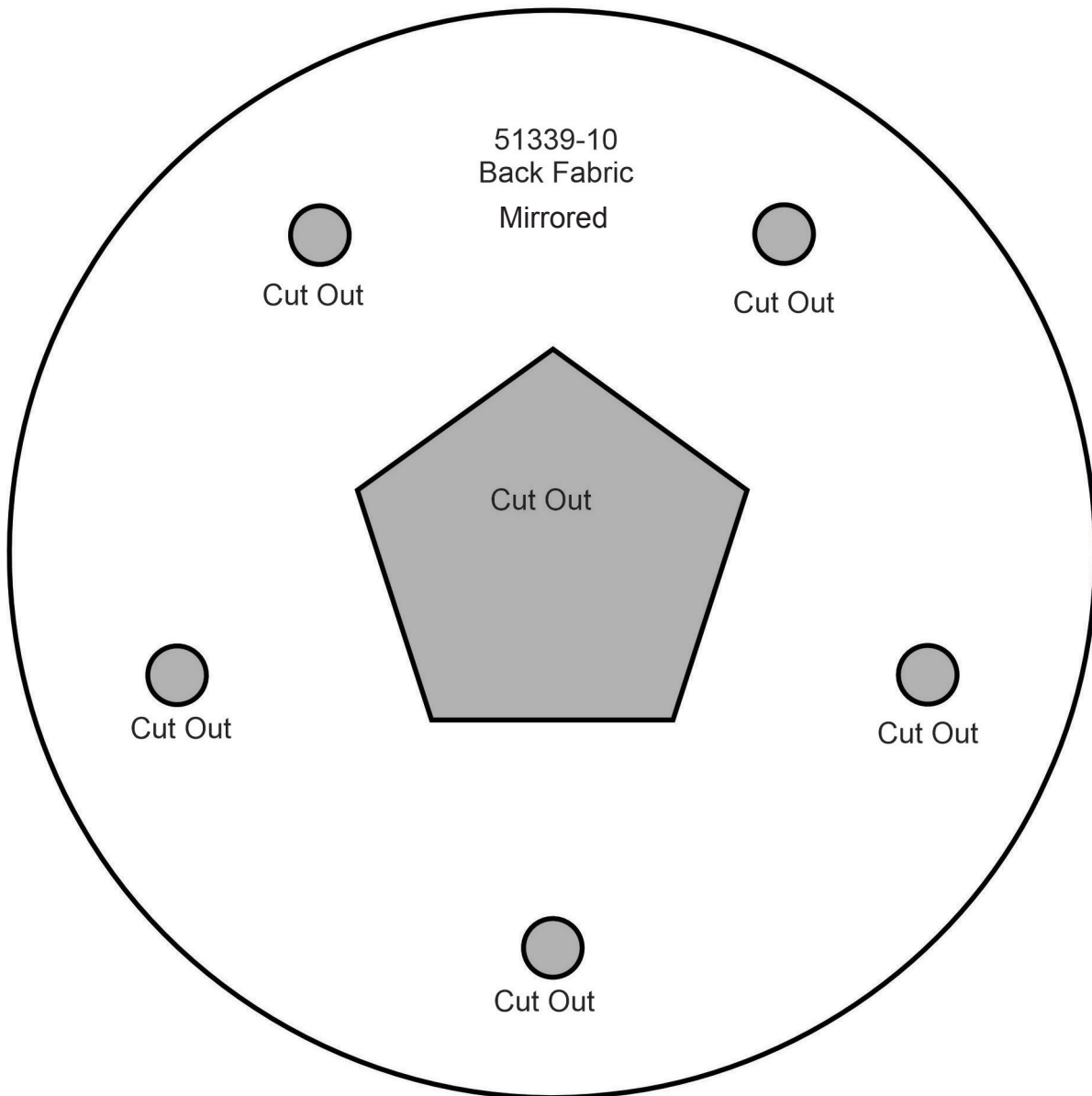

MIRRORED PATTERNS PREMIER COLLECTION

Print at 100%. No scaling. This box measures 1" x 1". Use the box as an accuracy guide when printing templates.

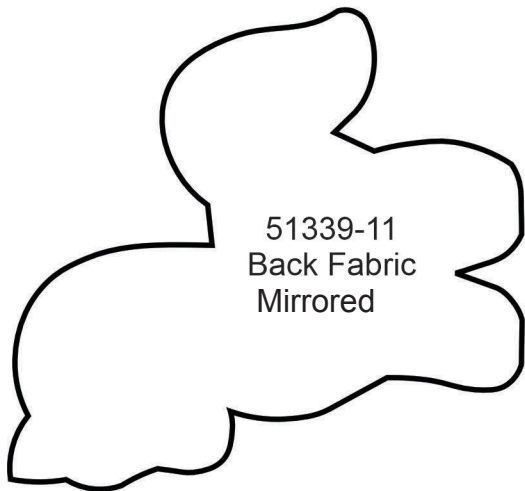
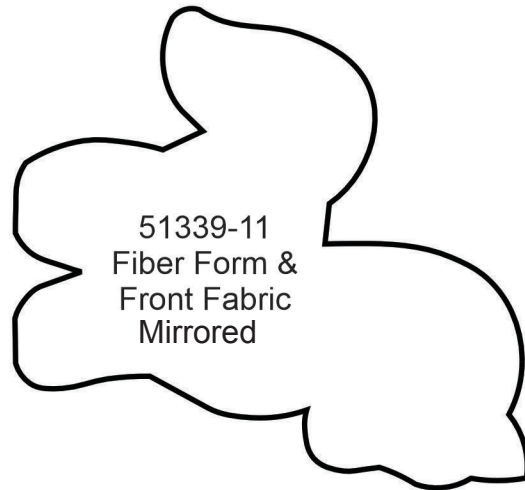
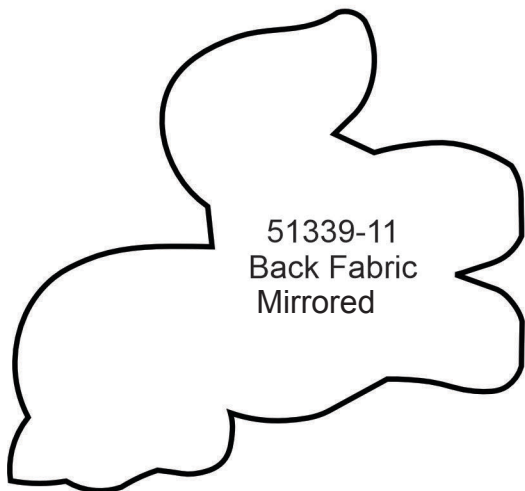
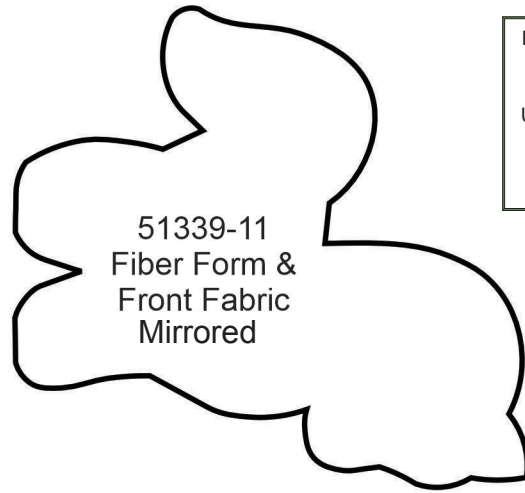

MIRRORED PATTERNS



Print at 100%. No scaling. This box measures 1" x 1". Use the box as an accuracy guide when printing templates.

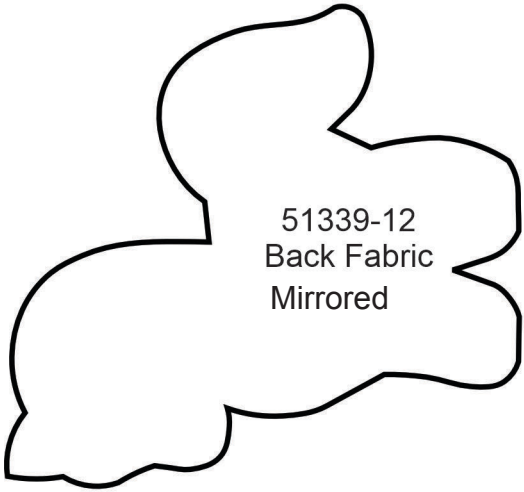

51339-12
Back Fabric
Mirrored

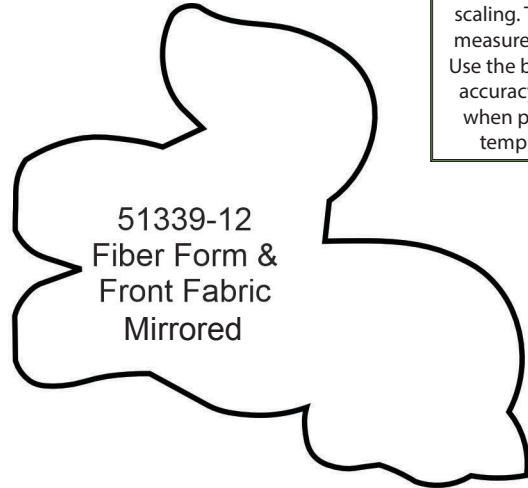

51339-12
Fiber Form &
Front Fabric
Mirrored

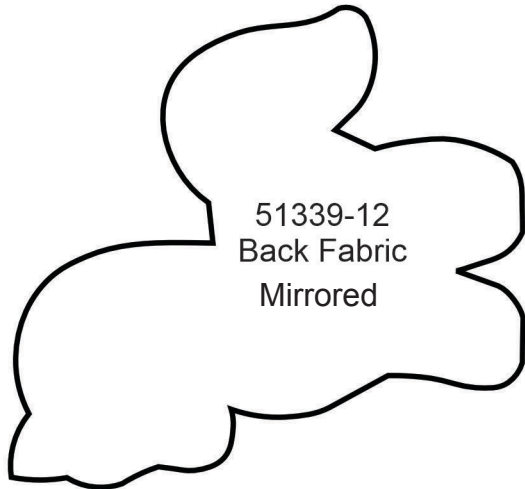

51339-12
Back Fabric
Mirrored



51339-12
Fiber Form &
Front Fabric
Mirrored



51339-13
Back Fabric
Mirrored



51339-13
Fiber Form &
Front Fabric
Mirrored