

Note: Some designs in this collection may have been created using unique special stitches and/or techniques. To preserve design integrity when rescaling or rotating designs in your software, always rescale or rotate designs using the handles directly on-screen.



JUMBO Appliqué CC03201
5.85 X 10.59 in.
148.59 X 268.99 mm
27,708 St. ❁ L



JUMBO Appliqué CC03202
6.71 X 10.39 in.
170.43 X 263.91 mm
21,924 St. ❁ L



JUMBO Appliqué CC03203
5.39 X 10.26 in.
136.91 X 260.60 mm
26,343 St. ❁ L



JUMBO Appliqué CC03204
4.82 X 10.21 in.
122.43 X 259.33 mm
27,646 St. ❁ L



JUMBO Appliqué CC03205
4.91 X 10.34 in.
124.71 X 262.64 mm
14,134 St. ❁ L



JUMBO Appliqué CC03206
5.36 X 10.10 in.
136.14 X 256.54 mm
36,614 St. ❁ L



JUMBO Appliqué CC03207
4.76 X 10.66 in.
120.90 X 270.76 mm
14,537 St. ❁ L



JUMBO Appliqué CC03208
5.13 X 11.37 in.
130.30 X 288.80 mm
21,074 St. ❁ L



JUMBO Appliqué CC03209
4.59 X 10.45 in.
116.59 X 265.43 mm
19,807 St. ❁ L

❁ Design contains a loose fill.
⚙ Some white areas shown are not stitched.

L Design is larger than 5" (127 mm) in either direction.
S Design is smaller than 1.5" (38.1 mm) in either direction.



DRESSED TO IMPRESS BY CAROL TRATT

PACK 61032 • 9 DESIGNS

Listings below indicate color sample, stitching order and suggested thread color number in Isacord, YLI Fine Metallic, Yenmet or YLI Variegated threads.

JUMBO Appliqué CC03201

1. Pants & Jacket.....	4174
2. Skin.....	1141
3. White Shirt.....	0015
4. Girls Hair.....	3644
5. Girls Hair Highlights, Bow Tie & Cumberbund.....	3830
6. Hair Highlights, Suit Trim & Inside Bow.....	3620
7. Tux Outlines & Mans Shoes.....	0020
8. Skin Highlights, Mans Hair & Ladies Shoes.....	0781
9. Mans Face Details.....	0853
10. Outlines.....	4174
11. Cheeks.....	2532
12. Necklace.....	0713
13. Necklace & Lips.....	2152
14. Necklace.....	5531
15. Ribbon Applique Placement Stitch.....	3622
16. Ribbon Tackdown.....	3622
17. Dress Applique Placement Stitch.....	3572
18. Dress Tackdown.....	3572
19. Sash Applique Placement Stitch.....	3622
20. Sash Tackdown.....	3622

JUMBO Appliqué CC03202

1. Dress Applique Placement Stitch.....	0781
2. Dress Tackdown.....	0781
3. Skin.....	1141
4. Hair.....	0020
5. Skin Outlines & Shoes.....	4174
6. Dark Fur.....	8014
7. Fur Highlights.....	8013
8. Fur Highlights.....	1874
9. Necklace.....	0622
10. Hair Band.....	0015
11. Tan Dots in Hair.....	0552
12. Purple Dots in Hair.....	2510
13. Heart Charm.....	1921
14. Heart Outlines.....	4174
15. Face Highlights.....	0781
16. Cheeks.....	2532
17. Lips.....	2510

JUMBO Appliqué CC03203

1. Dog.....	0532
2. Hair.....	0853
3. Green Dots in Hair, Cupcake Paper, Dog Fur & Hair Bands.....	5531
4. Dark Green Dots in Hair, Dog Fur Shading & Inside Bow.....	5633
5. Ribbon Applique Placement Stitch.....	5643
6. Ribbon Tackdown.....	5643
7. Dress Applique Placement Stitch.....	0608
8. Dress Tackdown.....	0608
9. Sash Applique Placement Stitch.....	5643
10. Sash Tackdown.....	5643
11. Skin.....	1141
12. Cupcakes.....	1123
13. Fur Highlights & Top of Dress.....	6051
14. Cupcakes, Dog Nose & Hearts on Dress.....	2530
15. Outlines.....	4174
16. Stars & Moons on Dress, Cupcakes, Necklace & Yellow Dots in Hair.....	0713
17. Cupcakes.....	0015
18. Purple Hearts on Dress, Lips & Dots in Hair.....	2510
19. Purple Diamonds on Dress & Cupcakes.....	2910
20. Cupcakes & Blue Diamonds on Dress.....	3840
21. Skin Highlights.....	0781
22. Cheeks.....	2532
23. Outlines of Heart on Bodice of Dress.....	4174
24. Cherries on Cupcakes.....	1902
25. Gold Cupcakes & Diamonds on Dress.....	0904

JUMBO Appliqué CC03204

1. Underside of Ribbon.....	0184
2. Bow Applique Placement Stitch.....	0142
3. Bow Tackdown.....	0142
4. Hair.....	0532
5. Hair Highlights.....	0520
6. Skin.....	1141
7. Dress Applique Placement Stitch.....	1902
8. Dress Tackdown.....	1902
9. Ribbon Applique Placement Stitch.....	0142
10. Ribbon Tackdown.....	0142
11. Tree.....	5633
12. Tree Highlights.....	5822
13. Trunk.....	0932
14. Angel Wings & Blue Ornaments.....	3840
15. Dress Swirls & Pink Ornaments.....	2560
16. Dress Swirls & Purple Ornaments.....	2920
17. Yellow Ornaments, Angel & Star.....	0703
18. Angel Skin.....	2155
19. Outlines.....	4174
20. Gold Ornaments.....	0904
21. White Ornaments, Tinsel, Dress, Hair & Skin Highlights.....	0101
22. Lips & Red Ornaments.....	1921
23. Cheeks.....	2532

JUMBO Appliqué CC03205

1. Skin.....	1141
2. Dress Applique Placement Stitch.....	5944
3. Dress Tackdown.....	5944
4. Hair.....	6156
5. Gift Box & Hair Band.....	5912
6. Ribbon & Hearts.....	2510
7. Outlines.....	4174
8. Hair Highlights.....	5664
9. Dress Trim & Dots in Hair.....	5552
10. Linework in Dress.....	5944
11. Stars & Moon.....	0630
12. Blue Drops & Necklace.....	3840
13. Bright Green Beads.....	5912
14. Skin Highlights.....	0781
15. Cheeks.....	2532
16. Lips.....	1921

JUMBO Appliqué CC03206

1. Bow Applique Placement Stitch.....	1900
2. Bow Tackdown.....	1900
3. Dress Applique Placement Stitch.....	0904
4. Dress Tackdown.....	0904
5. Sash Applique Placement Stitch.....	1900
6. Sash Tackdown.....	1900
7. Tray.....	1123
8. Tray Highlights, Dog Skin & Paper Cupcake Liners.....	0761
9. Hair & Drink.....	1010
10. Cupcakes.....	0853
11. Hair Highlights.....	0811
12. Hair Highlights, Straw & Drink Umbrella.....	0608
13. Straw, Paper Cupcake Liner, Dog Collar, Heart & Cupcake Platter.....	3840
14. Straws, Paper Cupcake Liner, Dog Collar, Heart & Cupcake Platter.....	5633
15. Drink Umbrella & Cherries.....	1913
16. Skin.....	1141
17. Cupcake Platter Highlights & Necklace.....	5531
18. Drink Cups.....	0182
19. Outlines.....	4174
20. Icing, Drink Cups Details, Dog Fur & Dress Trim.....	0015
21. Skin, Dog Fur & Dress Trim Shading.....	1760
22. Dog Fur & Dress Trim Shading.....	2170
23. Necklace.....	3840
24. Necklace, Hair Bands, Dog Collar & Dog Nail Polish.....	2510

JUMBO Appliqué CC03207

1. Dress Applique Placement Stitch.....	3902
2. Dress Tackdown.....	3902
3. Ribbon Applique Placement Stitch.....	3902
4. Ribbon Tackdown.....	3902
5. Inside Collar.....	3820
6. Hair.....	3574
7. Hair Highlights.....	3544
8. Drink & Umbrella.....	0811
9. Glass & Umbrella.....	1060
10. Skin.....	1141
11. Collar & Hair Band.....	3650
12. Collar Shading.....	3652
13. Face Highlights.....	0781
14. Cheeks.....	2532
15. Hair Outlines.....	1902
16. Large Heart.....	1902
17. Outlines.....	4174
18. Cherry, Lips & Small Heart.....	1902
19. Stars.....	0310
20. Pink Details.....	2155
21. White Dots & Highlight on Glass.....	0101
22. Dots in Hair & Gem on Necklace.....	3840

JUMBO Appliqué CC03208

1. Skin.....	1141
2. Hair, Inside Bow & Pink Ornaments.....	2153
3. Hair Highlights & Cheeks.....	1755
4. Gold Ornaments.....	0904
5. Skin & Hair Highlights, White Ornaments.....	0781
6. Green Ornaments & Beads.....	5531
7. Light Blue Ornaments & Beads.....	3840
8. Yellow Ornaments & Beads.....	0713
9. Dark Blue Ornaments & Beads.....	3815
10. Red Ornaments, Lips & Hair Band.....	1725
11. Outlines.....	4174
12. Bow & Ribbon Applique Placement Stitch.....	2241
13. Bow & Ribbon Tackdown.....	2241
14. Dress Applique Placement Stitch.....	1921
15. Dress Tackdown.....	1921
16. Sash Applique Placement Stitch.....	2241
17. Sash Tackdown.....	2241
18. Dress & Red Ornaments Highlights.....	0015

JUMBO Appliqué CC03209

1. Hair & Cat Body.....	0622
2. Skin & Insoles of Shoes.....	1141
3. Beads, Bows & Cat Collar.....	3840
4. Bodice Applique Placement Stitch.....	2832
5. Bodice Tackdown.....	2832
6. Dress Applique Placement Stitch.....	2832
7. Dress Tackdown.....	2832
8. Sash Applique Placement Stitch.....	2241
9. Sash Tackdown.....	2241
10. Shoes.....	2810
11. Cat Head.....	0622
12. Skin, Hair & Cat Highlights.....	0781
13. Cheeks, Beads, Hearts & Cats Ears.....	2532
14. Outlines.....	4174
15. Fuzzy Collar.....	8007
16. Collar Highlights.....	0015
17. Yellow Beads.....	0608
18. Green Beads.....	5531
19. Red Beads.....	1725

It is a violation of Copyright law to make and distribute copies of software or artwork.

Software is licensed to the original purchaser for use at one location. ©2010 Carol Tratt for use in home embroidery. All rights reserved.

1. Print out the necessary pages from the PDF of the appliqué pattern(s).
2. Mark the right side of the pattern pieces so you'll know which direction to lay the pattern on the fabric.
3. Lightly spray the wrong side of the pattern pieces with temporary adhesive spray and allow it to set for a few minutes.
4. Place the pattern pieces on the right side of the fabric and carefully cut them out. **PHOTO 01**
5. Sew the guide stitch on your hooped fabric. **PHOTO 02**
6. With the paper still stuck to the right side of the appliqué fabric, spray the wrong side of the fabric with temporary spray adhesive.
7. Place the fabric inside the sewn guide stitch so that it matches the stitching line then remove the paper pattern. **PHOTO 03**
8. Sew the tackdown. **PHOTO 04**
9. Sew the remainder of the design and repeat for any remaining pieces. **PHOTO 05**

NOTE: The patterns are sized for the designs as they were made. If you resize the design, you will need to resize the pattern the same amount. You can print out the pattern at the normal size and then copy it on a copy machine at the changed size, i.e. resize the design to 80%, resize the printed pattern to 80%.

TIP: When printing the patterns, make sure that the “Fit to page” option is **UNCHECKED** in the Print Dialog Box. If this option is checked the printed patterns will not be actual size.

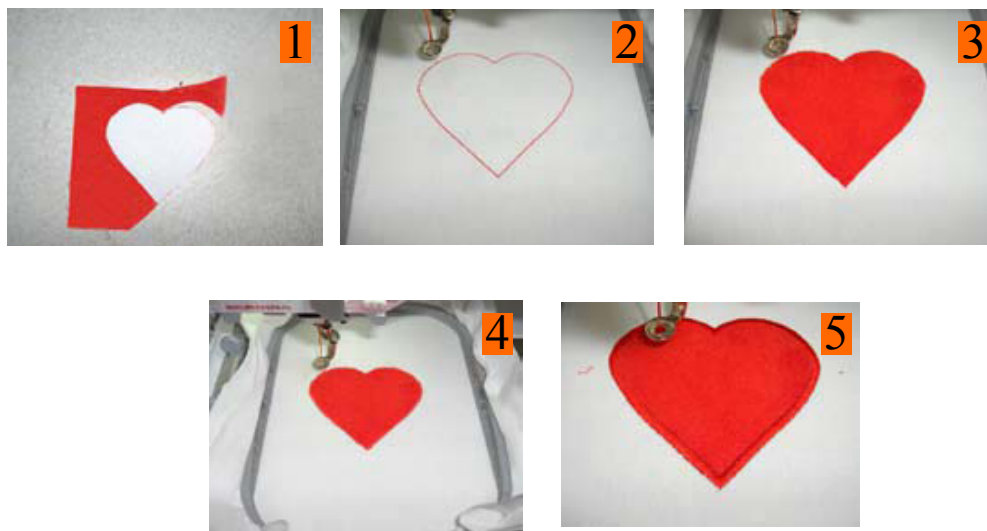

IMPORTANT:

When printing this document, the “Fit to page” option must be UNCHECKED or the “Page Scaling” option must be set to NONE depending on your printer’s options. If this option is set incorrectly, the prints will not work correctly as patterns because they will not print at actual size.

