



**FREESTANDING
Town Hall**



1

Design

Fits hoop size 5" x 7"

THREAD LIST



Isacord Thread Colors

0015 White (2 spools)

*** Project instructions included after design list.**

Note: One spool of 1000 meter thread is adequate for the project unless otherwise noted.

DESIGNS

Note: Some designs in this collection may have been created using unique special stitches and/or techniques. To preserve design integrity when rescaling or rotating designs in your software, always rescale or rotate designs using the handles directly on-screen.

*Fabric Required

OC08901 Front Wall / Back Wall FSA

Size Inches: Size mm: Stitch Count:
4.87 X 6.65 in. 123.7 X 168.91 mm 60,606 St.

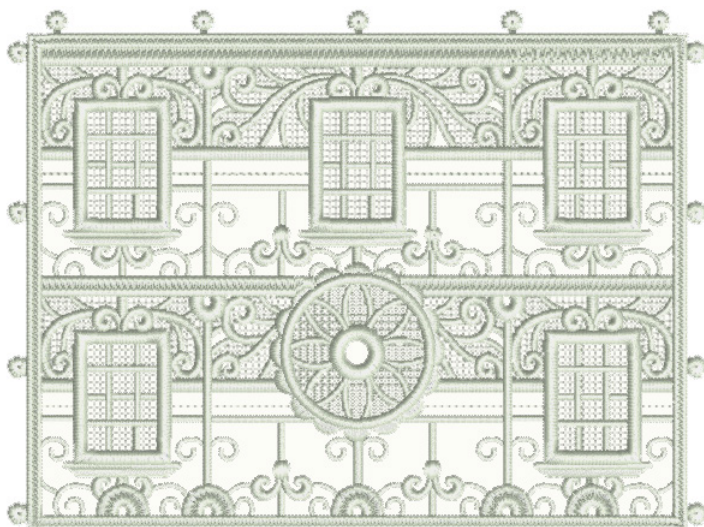

- 1. Placement Stitch 0015
- 2. Cut Line and Tackdown 0015
- 3. Lace..... 0015

Note: Some designs in this collection may have been created using unique special stitches and/or techniques. To preserve design integrity when rescaling or rotating designs in your software, always rescale or rotate designs using the handles directly on-screen.

***Fabric Required**

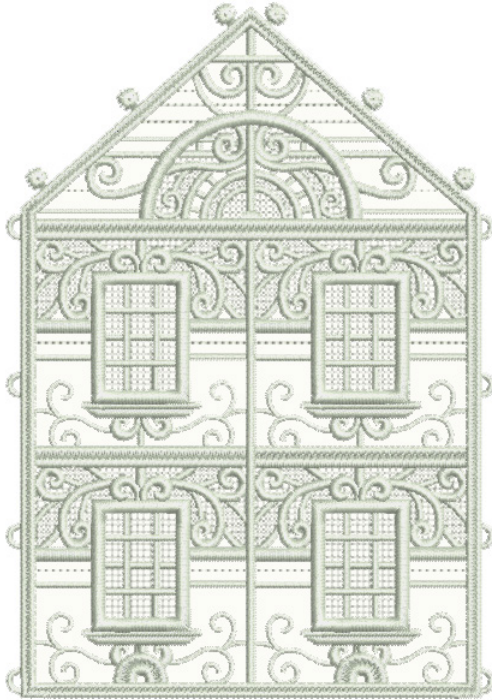

OC08902 Side Wall FSA

Size Inches: Size mm: Stitch Count:
4.58 X 6.6 in. 116.33 X 167.64 mm 47,315 St.

- 1. Placement Stitch 0015
- 2. Cut Line and Tackdown 0015
- 3. Lace..... 0015

***Fabric Required**

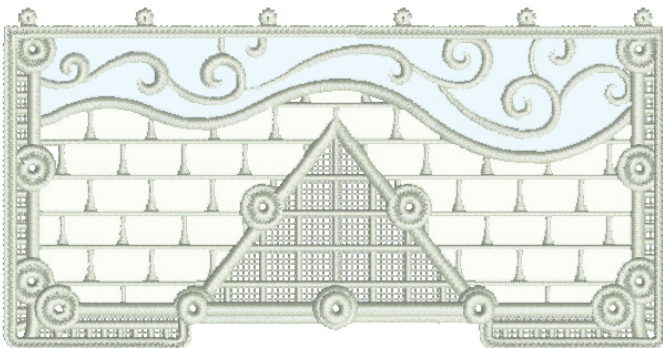

OC08903 Front Roof FSA

Size Inches: Size mm: Stitch Count:
3.5 X 6.86 in. 88.9 X 174.24 mm 30,992 St.

- 1. Shingles Placement Stitch..... 0015
- 2. Cut Line and Tackdown 0015
- 3. Snow Placement Stitch 0015
- 4. Cut Line and Tackdown 0015
- 5. Lace..... 0015

Note: Some designs in this collection may have been created using unique special stitches and/or techniques. To preserve design integrity when rescaling or rotating designs in your software, always rescale or rotate designs using the handles directly on-screen.

***Fabric Required**

OC08904 Back Roof FSA

Size Inches: Size mm: Stitch Count:
3.45 X 6.86 in. 87.63 X 174.24 mm 28,677 St.

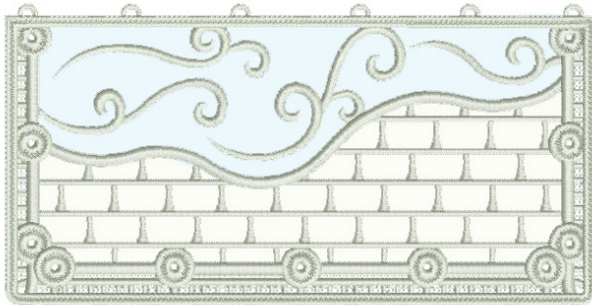

- 1. Shingles Placement Stitch..... 0015
- 2. Cut Line and Tackdown 0015
- 3. Snow Placement Stitch 0015
- 4. Cut Line and Tackdown 0015
- 5. Lace..... 0015

***Fabric Required**

OC08905 Clock Front FSA

Size Inches: Size mm: Stitch Count:
4.87 X 5.8 in. 123.7 X 147.32 mm 51,981 St.

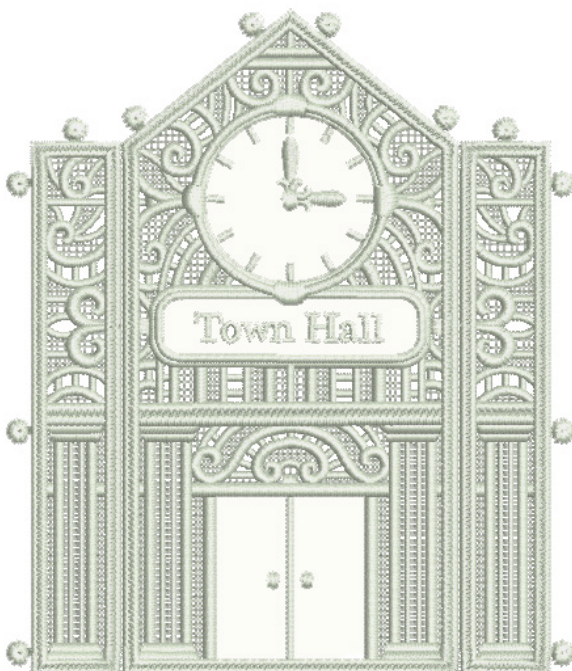

- 1. Clock Placement Stitch 0015
- 2. Cut Line and Tackdown 0015
- 3. Sign Placement Stitch 0015
- 4. Cut Line and Tackdown 0015
- 5. Door Placement Stitch..... 0015
- 6. Cut Line and Tackdown 0015
- 7. Lace..... 0015
- 8. Lettering 0015

Note: Some designs in this collection may have been created using unique special stitches and/or techniques. To preserve design integrity when rescaling or rotating designs in your software, always rescale or rotate designs using the handles directly on-screen.

***Fabric Required**

OC08906 Roof Extension FSA

Size Inches: Size mm: Stitch Count:
2.58 X 4.28 in. 65.53 X 108.71 mm 11,764 St.

- 1. Placement Stitch 0015
- 2. Cut Line and Tackdown 0015
- 3. Lace..... 0015

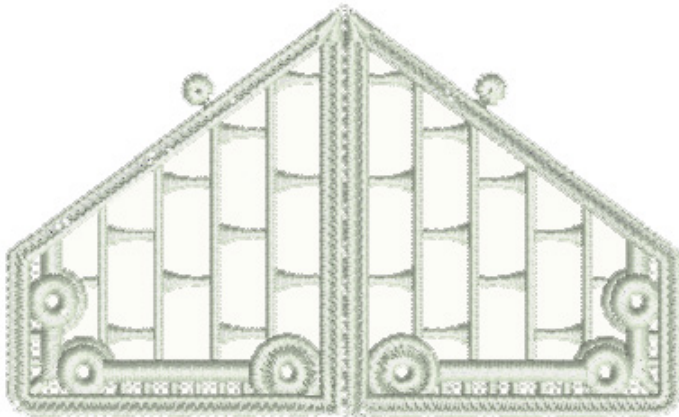

***Fabric Required**

OC08907 Foundation FSA

Size Inches: Size mm: Stitch Count:
4.68 X 6.68 in. 118.87 X 169.67 mm 16,422 St.

- 1. Placement Stitch 0015
- 2. Cut Line and Tackdown 0015
- 3. Lace..... 0015

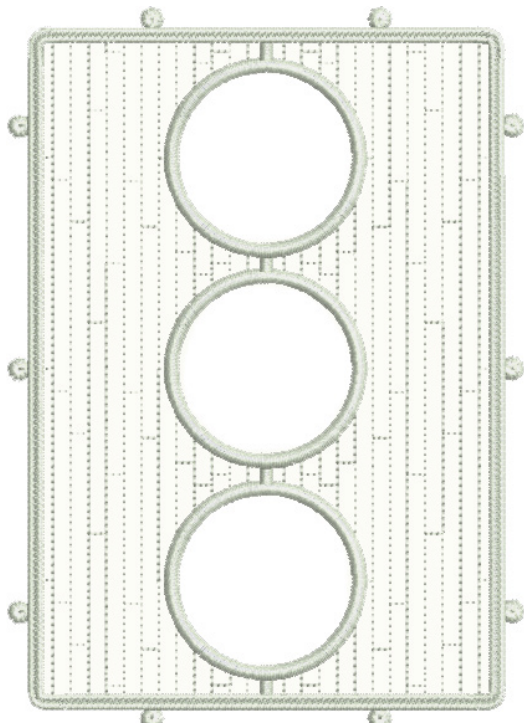

Stabilizers

- OESD AquaMesh WashAway
- OESD BadgeMaster WashAway
- OESD StabilStick CutAway

Fabrics/Textiles

- White cotton fabric 1/4 yd
- Note: Fabric sizes are estimates and may result in overage.

Notions & Tools

- OESD Alligator Clamps
- OESD Button Clips
- OESD Expert Embroidery Tape WashAway
- OESD Perfect Embroidery Press Cloth
- OESD Perfect Point and Press Tool
- Embroidery Needle Sharp 75/11

Isacord Thread Colors

- Per thread chart
- Match bobbin thread to top thread
- 0015 White 2 spools

SUMMARY



Completed Size: 6 1/2" H x 6 1/4" W x 5" D

OC08901

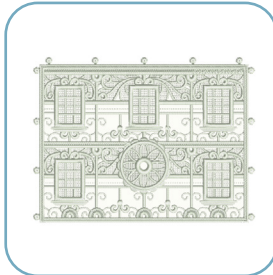

Requires 2 Designs

OC08902

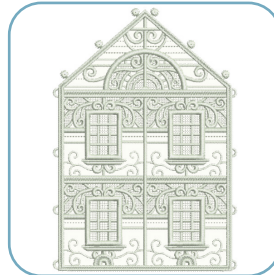

Requires 2 Designs

OC08903

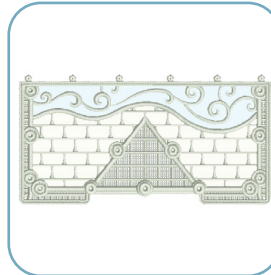

Requires 1 Design

OC08904

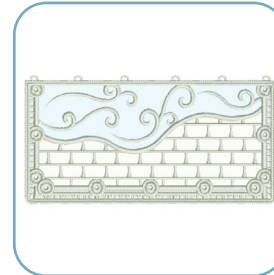

Requires 1 Design

OC08905

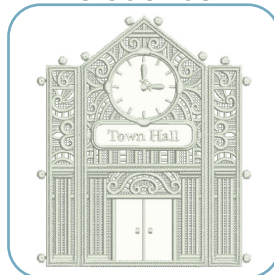

Requires 1 Design

OC08906

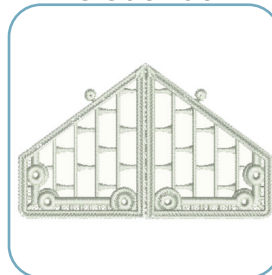

Requires 1 Design

OC08907

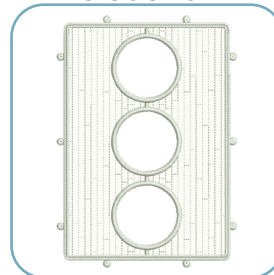

Requires 1 Design

Notes

The freestanding applique instructions, included in the collection, are general instructions. For demonstration purposes, a sample design that best demonstrates the technique is shown. Fabric and thread requirements will vary by design, but the general technique is the same.

All designs are stitched with matching thread in the top and bobbin.

For other designs in the collection, use the applique templates as a guide to the dimensions of the various applique pieces.

Note: Some thread colors in instructions have been changed or digitally enhanced for better visibility.

STEP 1

- Hoop one layer of AquaMesh and one layer of BadgeMaster for all designs.



STEP 2

- Cut the prepared applique fabrics 1/4"-1/2" larger than the templates.
- Adhere two layers of StabilStick CutAway to the wrong side of all applique fabrics to provide stiffness to the finished structure.



STEP 3

- Load selected design into the machine.
- Example design is OC08905.
- Thread the machine per the thread chart.
- Place hoop on the machine.
- Stitch Machine Step 1, Clock Placement Stitch.



STEP 4

- Remove the hoop from the machine, but NOT the project from the hoop.
- Place the hoop on a flat surface.
- Place the prepared applique fabric, right side up, completely covering the placement stitch.
- Tape in place to secure.

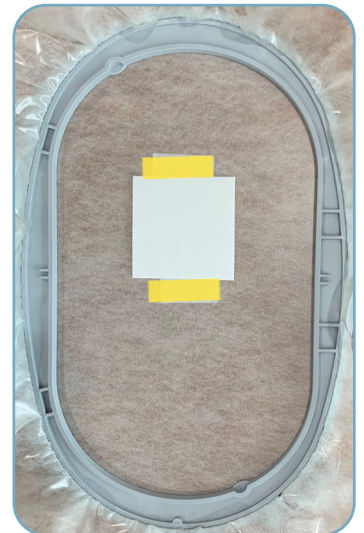

STEP 5

- Return the hoop to the machine.
- Stitch Machine Step 2, Cut Line and Tackdown.



STEP 6

- Remove the hoop from the machine, but NOT the project from the hoop.
- Trim the excess fabric as close to the cut line as possible. If the outermost stitches (cut line) are cut, the inner stitches (tackdown) will hold the applique in place.



STEP 7

- Return the hoop to the machine.
- Stitch Machine Step 3, Sign Placement Stitch.

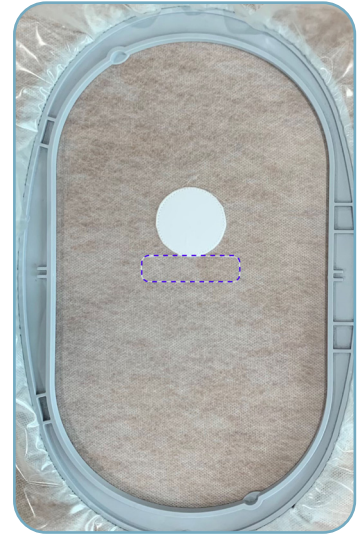

STEP 8

- Remove the hoop from the machine, but NOT the project from the hoop.
- Place the hoop on a flat surface.
- Place the prepared applique fabric, right side up, completely covering the placement stitch.
- Tape in place to secure.

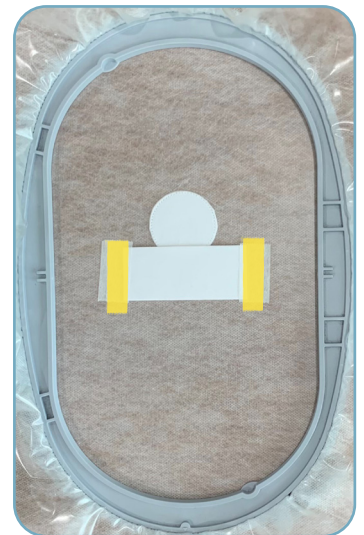

STEP 9

- Return the hoop to the machine.
- Stitch Machine Step 4, Cut Line & Tackdown.



STEP 10

- Remove the hoop from the machine, but NOT the project from the hoop.
- Place the hoop on a flat surface.
- Trim the excess fabric as close to the cut line stitching as possible.



STEP 11

- Return the hoop to the machine.
- Stitch Machine Step 5, Door Placement Stitch.

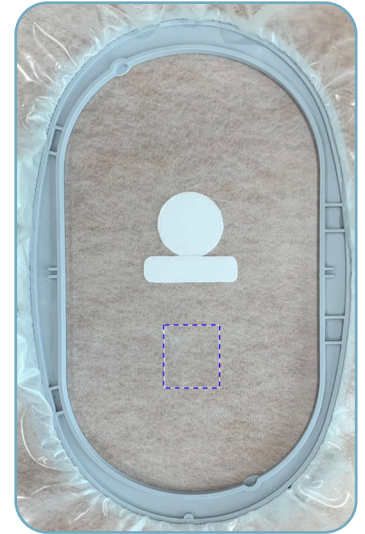

STEP 12

- Remove the hoop from the machine, but NOT the project from the hoop.
- Place the hoop on a flat surface.
- Place the prepared applique fabric, right side up, completely covering the placement stitch.
- Tape in place to secure.



STEP 13

- Return the hoop to the machine.
- Stitch Machine Step 6, Cut Line & Tackdown.

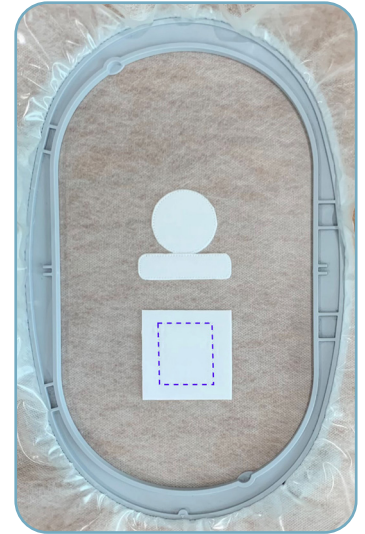

STEP 14

- Remove the hoop from the machine, but NOT the project from the hoop.
- Place the hoop on a flat surface.
- Trim the excess fabric as close to the cut line stitching as possible.
- Return the hoop to the machine.



STEP 15

- Stitch Machine Step 7, Lace.
- Stitch the remaining machine steps according to the thread chart.
- When design is complete, remove the project from the hoop and trim the stabilizer 1/4" - 1/2" outside the design.

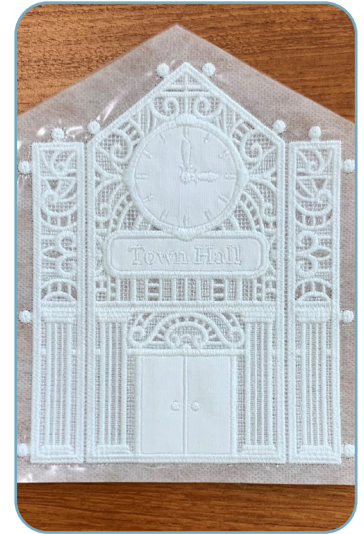

ASSEMBLY



STEP 16

- Rinse each piece in warm running water until the design is only slightly sticky.
- Lay face down on a non-stick surface to dry. Parchment paper or a cooling rack work well. This prevents the piece from curling.
- Press each piece, right side down, on a Perfect Embroidery Press Cloth.



STEP 17

- Using alligator clamps, attach Clock Front FSA (OC08905) to the Roof Extension FSA (OC08906) by pulling the buttonettes through the corresponding eyelets.
- Fold the side flap toward the back and attach to the upper inner buttonhole.
- Set the clock and roof unit aside.



STEP 18

- Attach the Front Wall/Back Wall FSA (OC08901) to Front Roof FSA (OC08903) by pulling the five buttonettes along the top edge of the front wall into the five eyelets along bottom edge of the front roof.
- Apply button clips as needed when assembling.

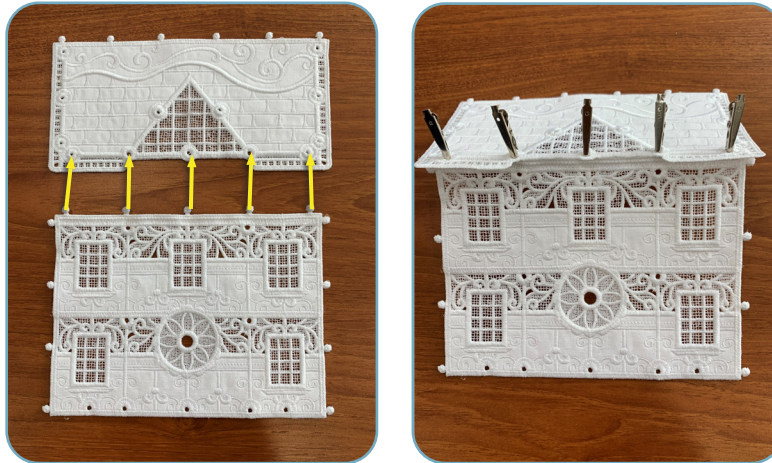

STEP 19

- Attach the Clock Front FSA (OC08905) to the Front Wall/Back Wall FSA (OC08901) by pulling the six buttonettes of the clock front into the six eyelets of the front wall.
- The clock and front wall section is complete.
- Set aside.

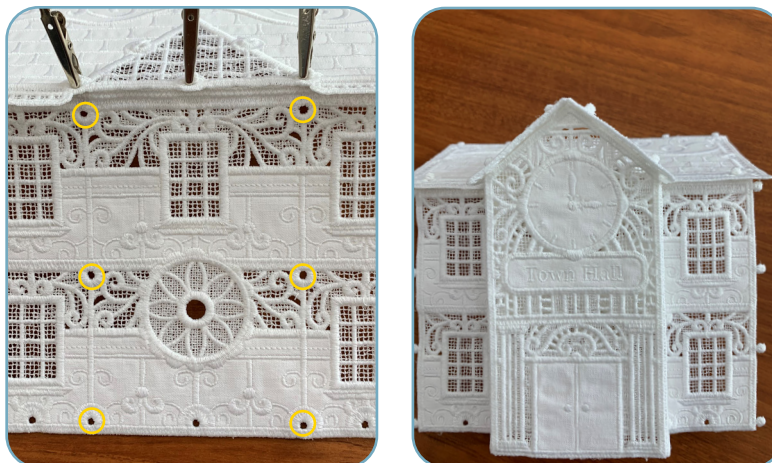

ASSEMBLY



STEP 20

- Attach the Roof Extension FSA (OC08906) to the Front Roof FSA (OC08903) by pulling the two buttonettes on the roof extension into the two eyelets on the front roof.



STEP 21

- Attach one of the Side Wall FSA (OC08902) to the Front Roof FSA (OC08903) by pulling the three buttonettes along the angled edge of the side wall into the three eyelets along the side edges of the front roof.



ASSEMBLY



STEP 22

- Attach the same Side Wall FSA (OC08902) to the Front Wall/Back Wall FSA (OC08901) by pulling the four buttonettes along the side of front wall into the eyelets along the front side of the wall.
- Attach the other side.



STEP 23

- Attach the Front Wall/Back Wall FSA (OC08901) to the Back Roof FSA (OC08904) by pulling the 5 buttonettes of the back wall into the five eyelets along the bottom edge of the back roof.

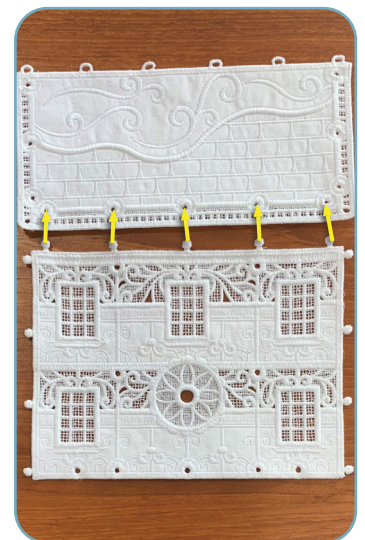

ASSEMBLY



STEP 24

- Attach the Back Roof FSA (OC08904) to one Side Wall FSA (OC08902) by pulling the three buttonettes along the angled edge of the side wall into the three eyelets along the side edge of the back roof.

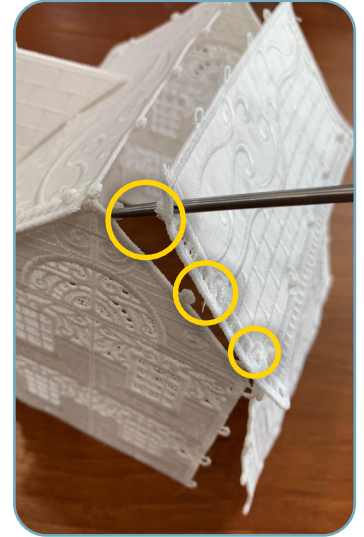

STEP 25

- Attach the same Side Wall FSA (OC08902) to the Front Wall/Back Wall FSA by pulling the four buttonettes along the side of the back wall in the four eyelets along the side wall. Start with the top buttonettes and work your way to the bottom.
- Repeat for opposite side.



ASSEMBLY



STEP 26

- Attach the Front Roof FSA (OC08903) to Back Roof FSA (OC08904) by pulling the six buttonettes along the edge of the front roof into the six eyelets along the edge of the back roof.

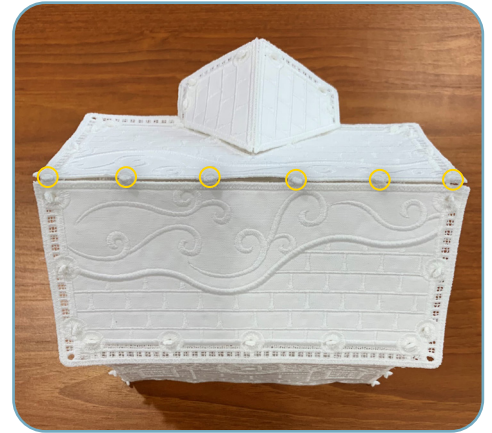

STEP 27

- Attach Foundation FSA (OC08907) to Front Wall/Back Wall FSA (OC08901), going under Clock Front FSA (OC08905) first by pulling the center buttonette through the center of front wall.
- Continue pulling the buttonettes of the Foundation FSA (OC08907) into the eyelets of the front, sides and back.

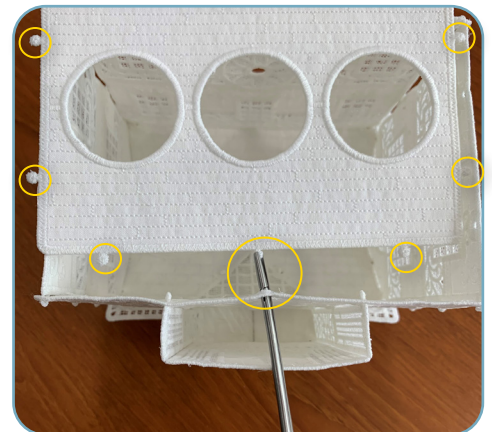

ASSEMBLY



FINISHING TOUCHES

- The town hall is complete. Enjoy.
- Add tea lights or pixie lights to create a glow.



ATTENTION

When printing this document, any page scaling or page fitting options in your print dialog box must be turned OFF or set to NONE so that your files will print out at their actual size. Images not printed at actual size will not function as intended.

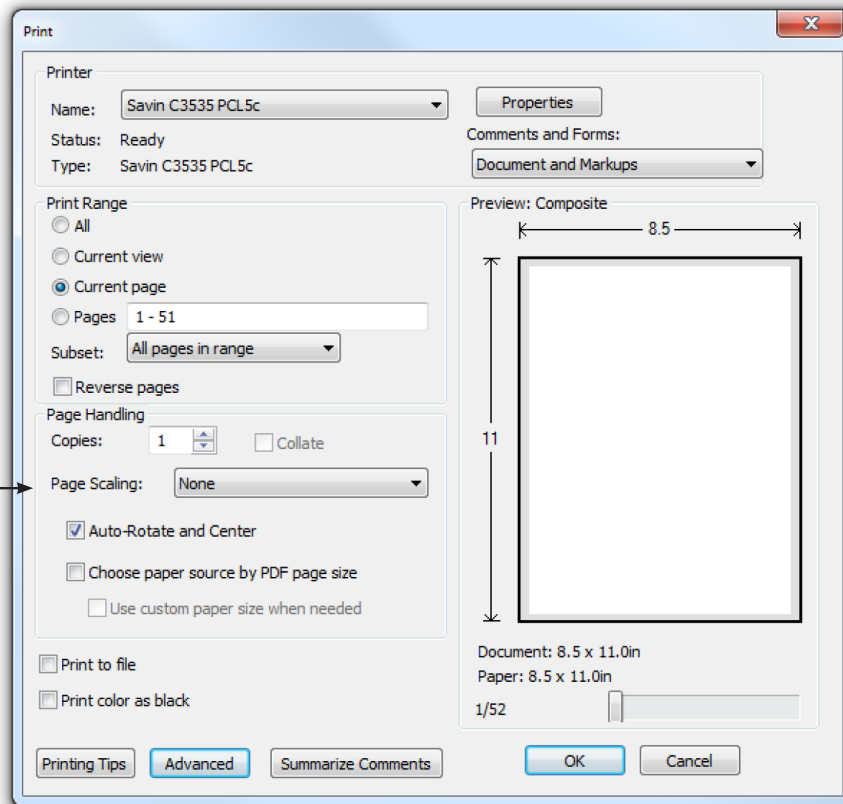

TO SAVE PAPER

Only print the desired image by navigating to the image's page, go to File > Print and select "Current page" in the print dialog box. Repeat for each desired image.

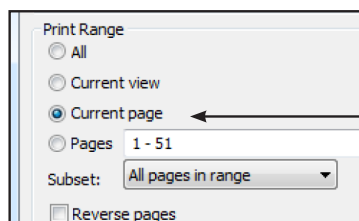

APPLIQUE PATTERNS



Print at 100%. No scaling. This box measures 1" x 1". Use the box as an accuracy guide when printing templates.

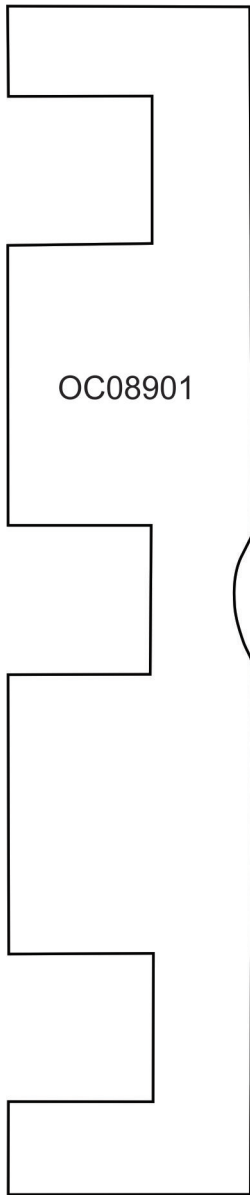

OC08901

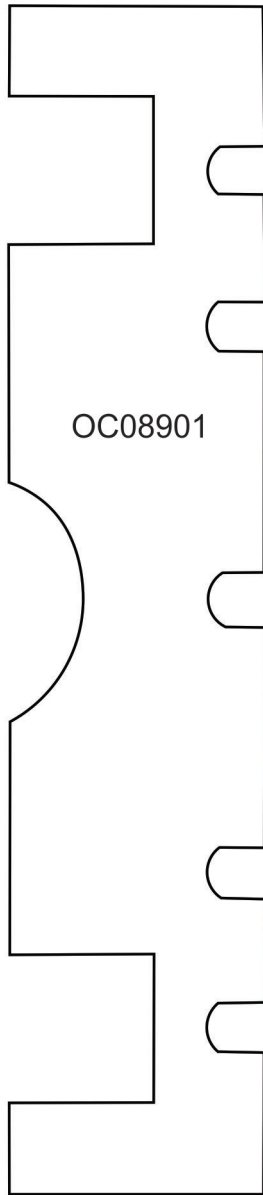

OC08901

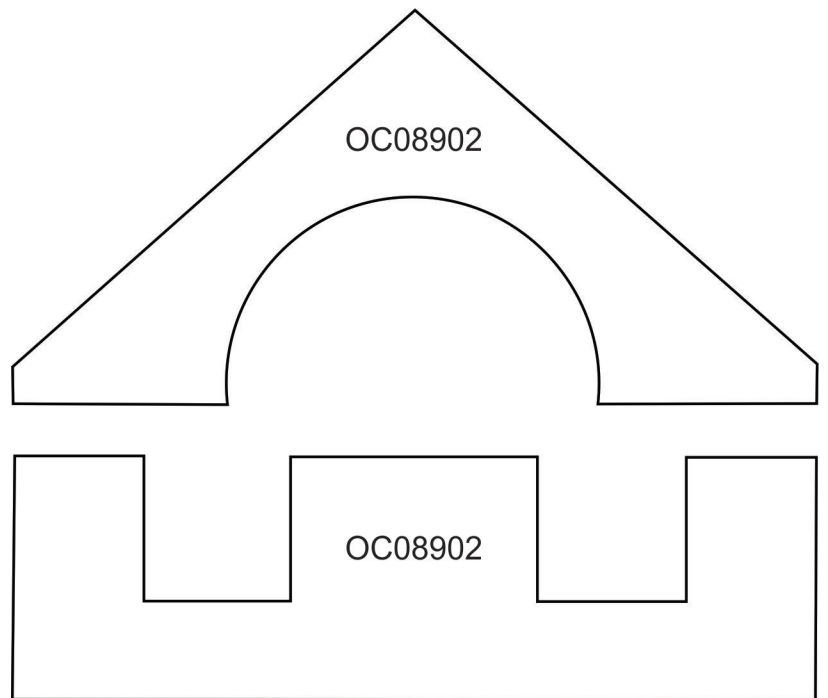

OC08902

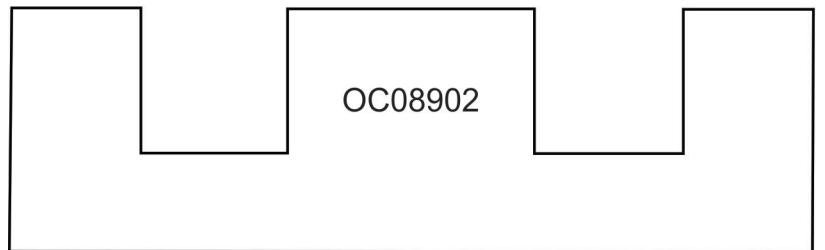

OC08902

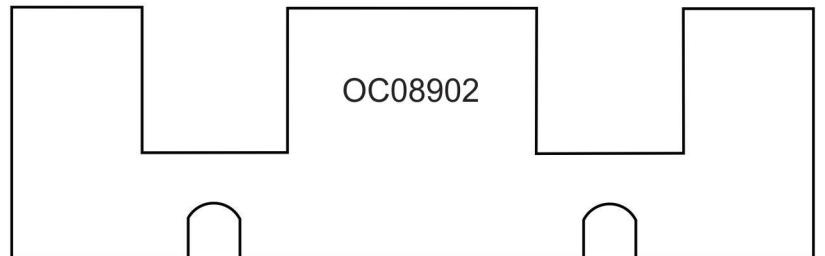

OC08902

APPLIQUE PATTERNS



Print at 100%. No scaling. This box measures 1" x 1". Use the box as an accuracy guide when printing templates.

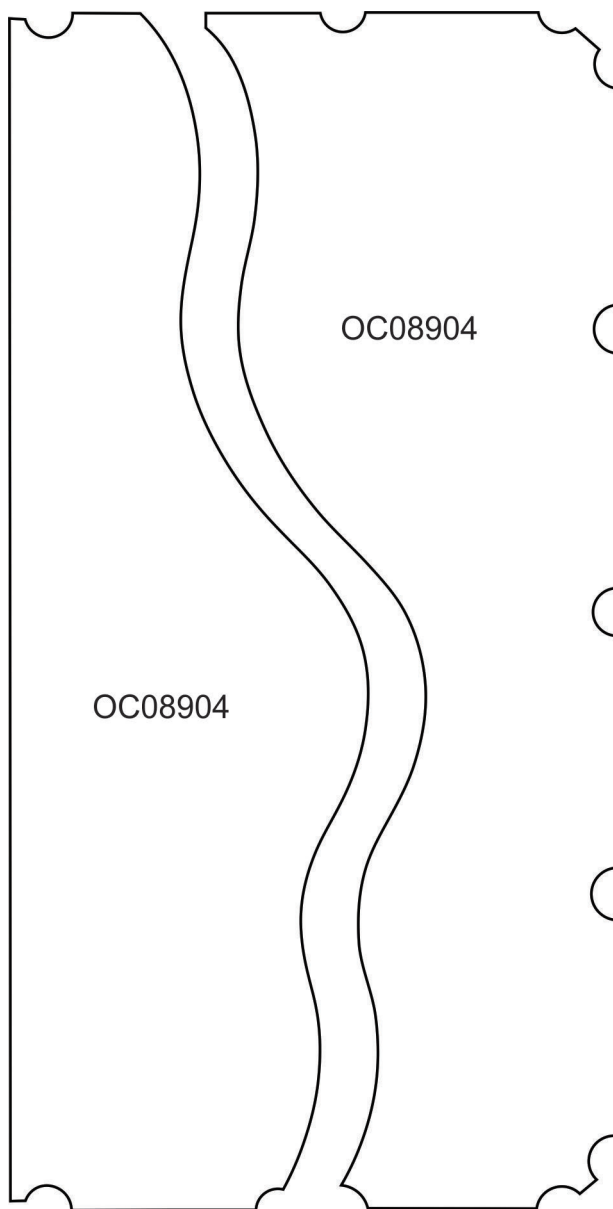
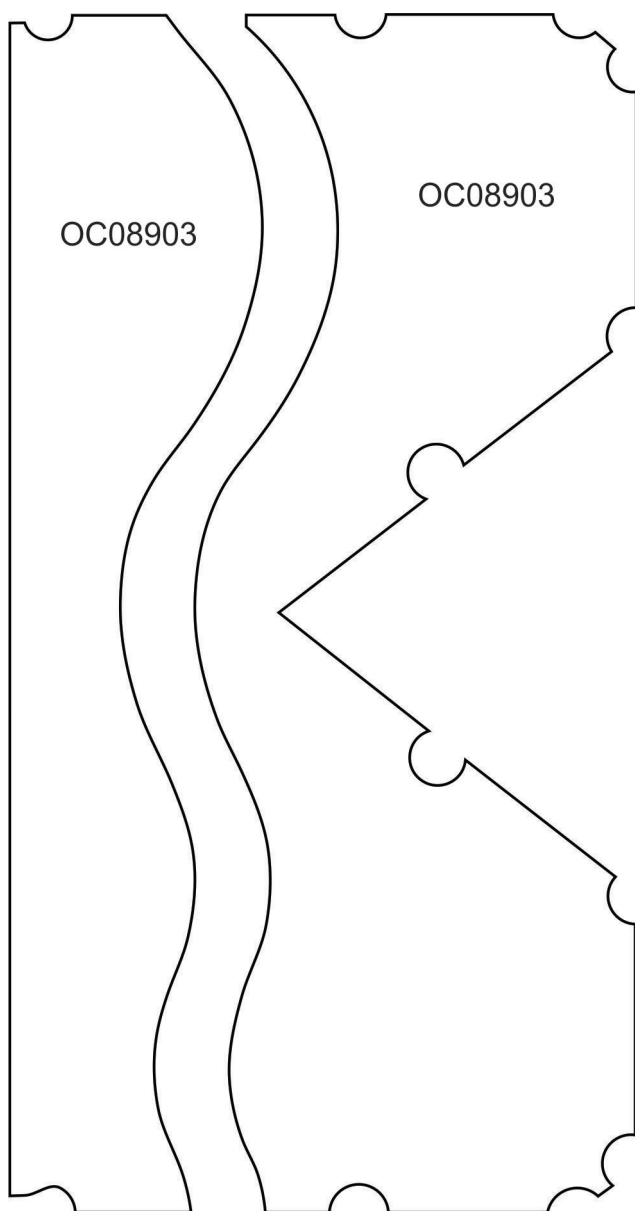

APPLIQUE PATTERNS



Print at 100%. No scaling. This box measures 1" x 1". Use the box as an accuracy guide when printing templates.

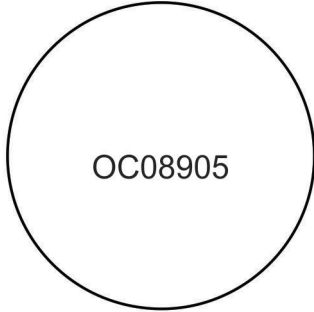

OC08905



OC08905

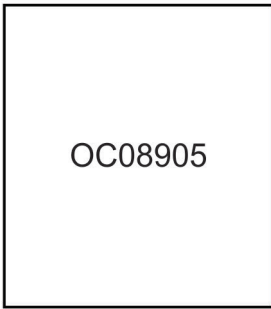

OC08905

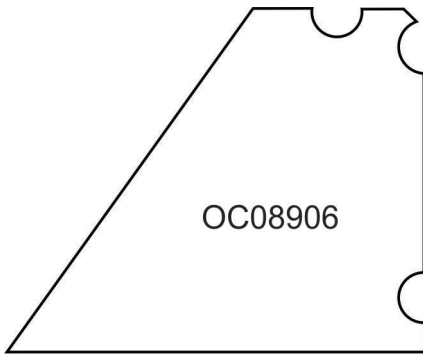

OC08906

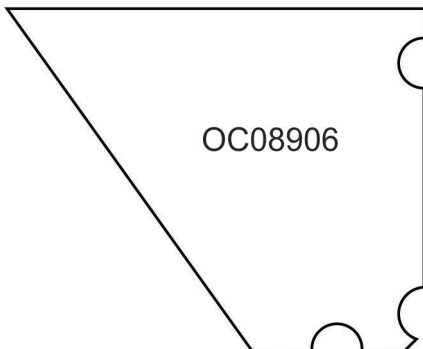

OC08906

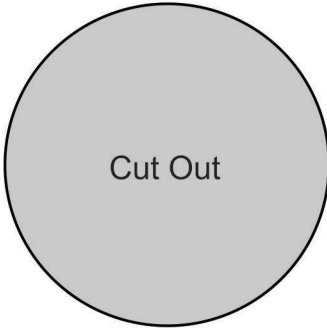
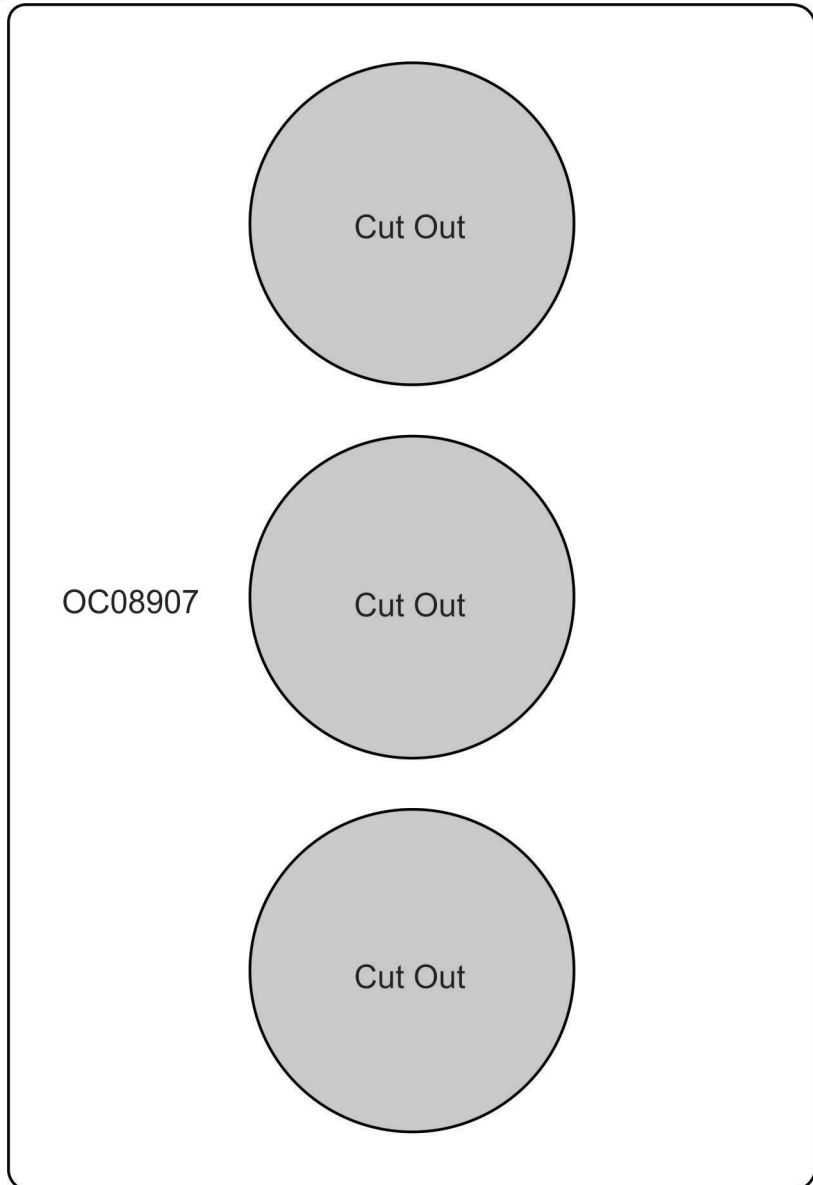

Cut Out

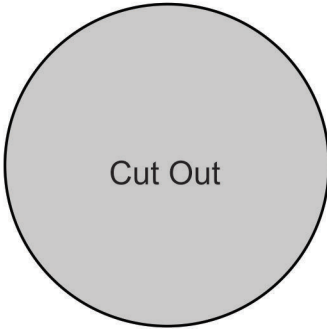

Cut Out

OC08907

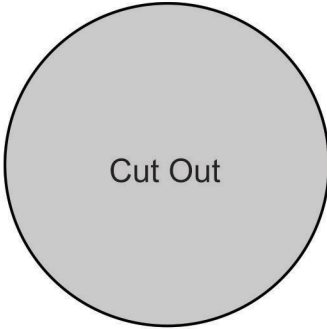

Cut Out

MIRRORED PATTERNS



Print at 100%. No scaling. This box measures 1" x 1". Use the box as an accuracy guide when printing templates.

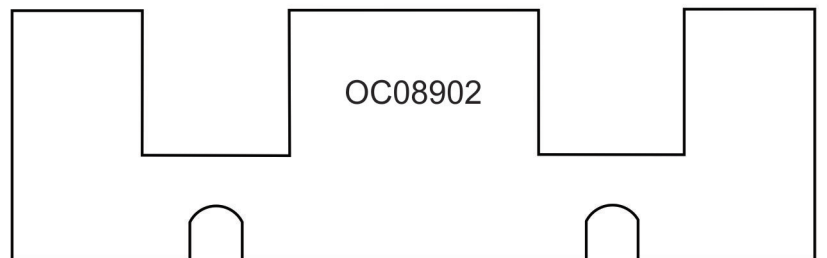
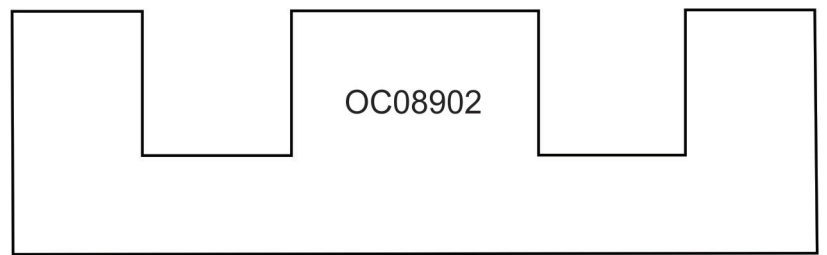
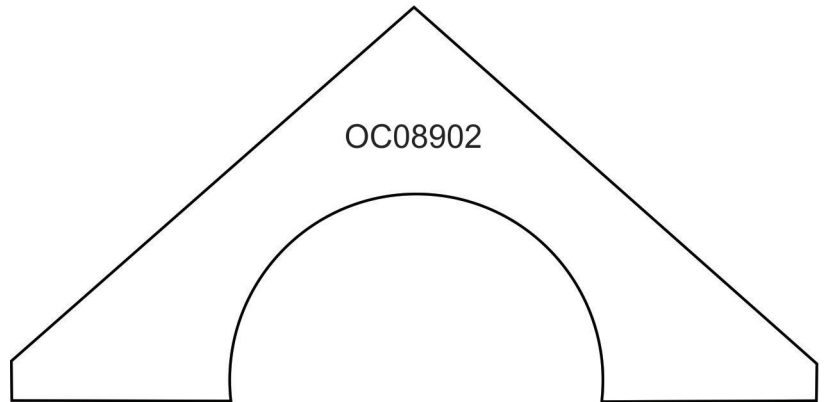
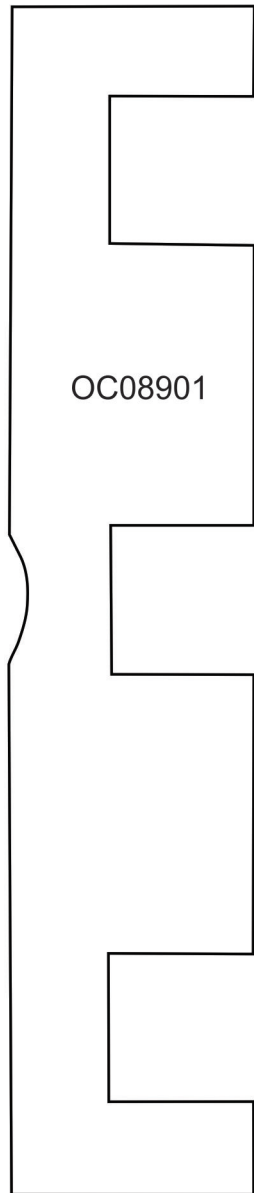
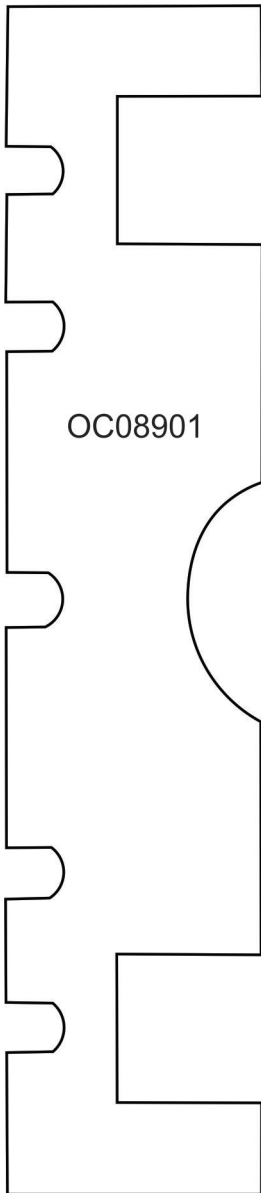

MIRRORED PATTERNS



Print at 100%. No scaling. This box measures 1" x 1". Use the box as an accuracy guide when printing templates.

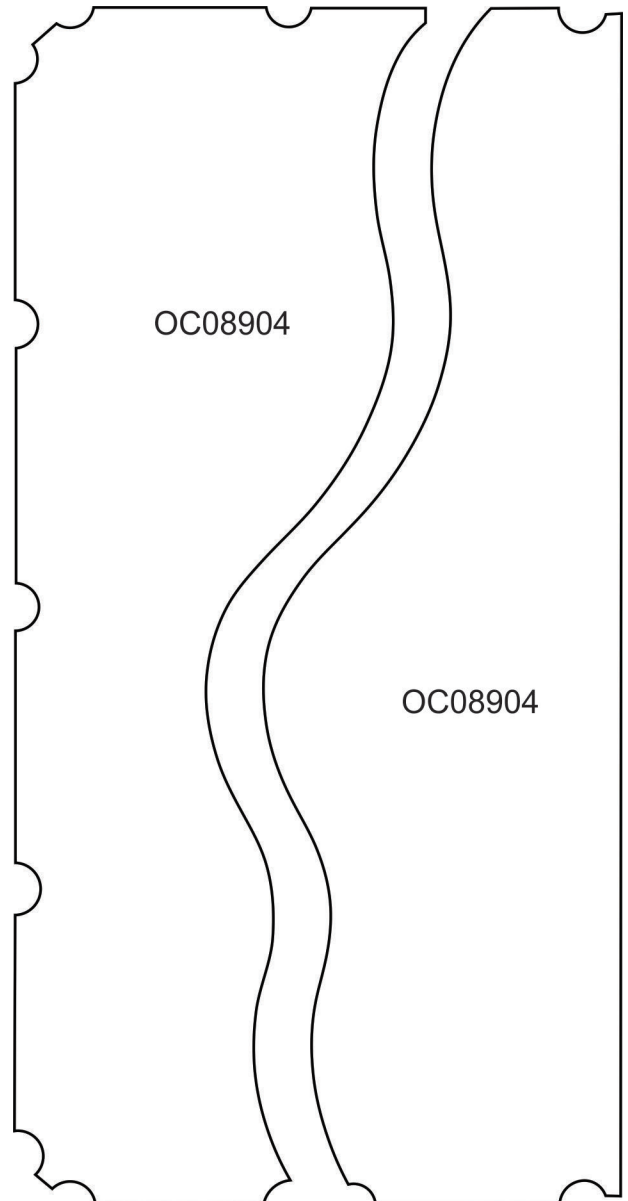
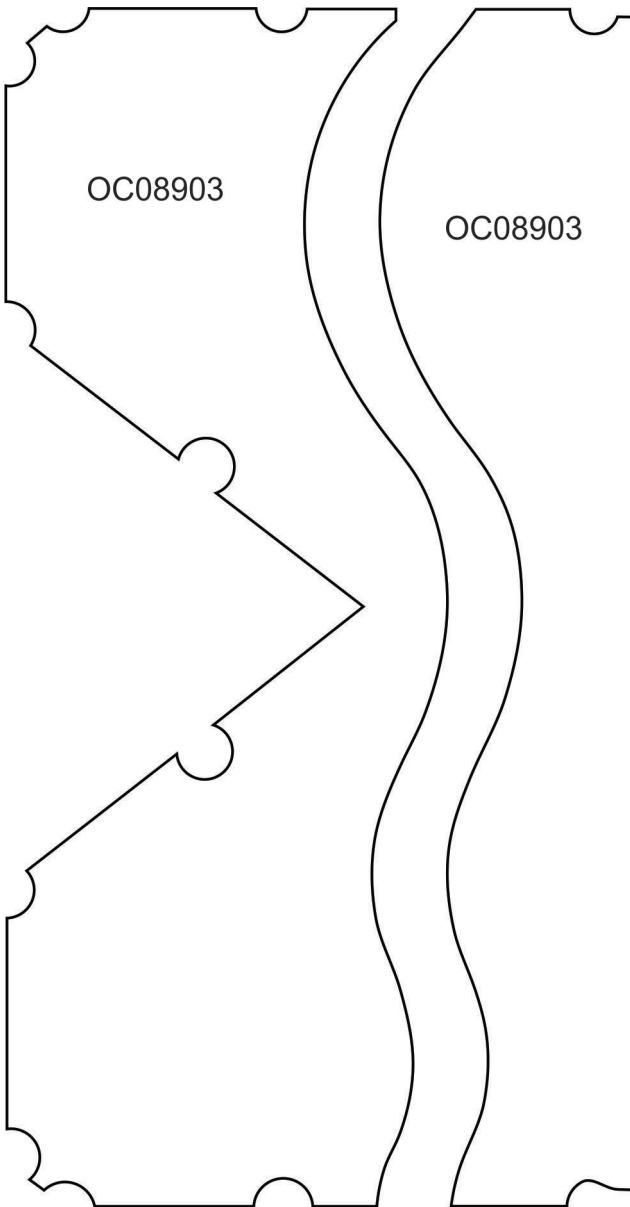

MIRRORED PATTERNS



Print at 100%. No scaling. This box measures 1" x 1". Use the box as an accuracy guide when printing templates.

