



FREESTANDING
Bakery



1

Design

Fits hoop size 5" x 7" and larger

THREAD LIST



Isacord Thread Colors

0015 White (2 spools)

*** Project instructions included after design list.**

Note: One spool of 1000 meter thread is adequate for the project unless otherwise noted.

DESIGNS

Note: Some designs in this collection may have been created using unique special stitches and/or techniques. To preserve design integrity when rescaling or rotating designs in your software, always rescale or rotate designs using the handles directly on-screen.

*Fabric Required

OC09001 Window FSA

Size Inches:	Size mm:	Stitch Count:
3.75 X 2.2 in.	95.25 X 55.88 mm	14,848 St.

- 1. Placement Stitch 0015
- 2. Cut Line and Tackdown 0015
- 3. Lace..... 0015

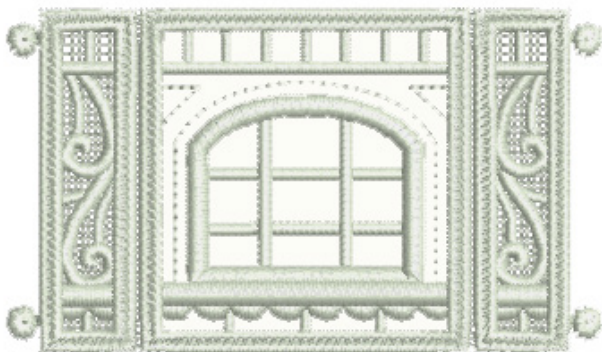

Note: Some designs in this collection may have been created using unique special stitches and/or techniques. To preserve design integrity when rescaling or rotating designs in your software, always rescale or rotate designs using the handles directly on-screen.

***Fabric Required**

OC09002 Awning FSA

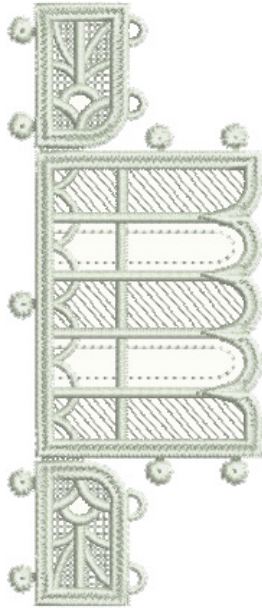

Size Inches: Size mm: Stitch Count:
1.98 X 4.76 in. 50.29 X 120.9 mm 11,511 St.

- 1. Placement Stitch 0015
- 2. Cut Line and Tackdown 0015
- 3. Lace..... 0015

***Fabric Required**

OC09003 Front Wall FSA



Size Inches: Size mm: Stitch Count:
4.65 X 4.53 in. 118.11 X 115.06 mm 32,181 St.

- 1. Window Placement Stitch..... 0015
- 2. Cut Line and Tackdown 0015
- 3. Door Placement Stitch..... 0015
- 4. Cut Line and Tackdown 0015
- 5. Sign Placement Stitch 0015
- 6. Cut Line and Tackdown 0015
- 7. Lace..... 0015
- 8. Lettering 0015

Note: Some designs in this collection may have been created using unique special stitches and/or techniques. To preserve design integrity when rescaling or rotating designs in your software, always rescale or rotate designs using the handles directly on-screen.

***Fabric Required**

OC09004 Back Wall FSA

Size Inches: Size mm: Stitch Count:
 4.65 X 4.53 in. 118.11 X 115.06 mm 32,519 St.

- 1. Placement Stitch 0015
- 2. Cut Line and Tackdown 0015
- 3. Lace..... 0015

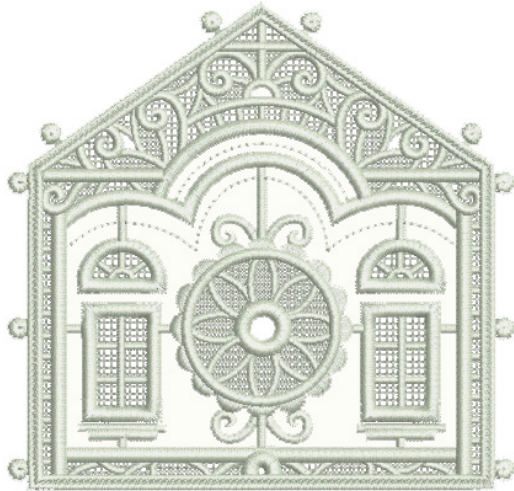

***Fabric Required**

OC09005 Side Walls FSA

Size Inches: Size mm: Stitch Count:
 3.79 X 3.24 in. 96.27 X 82.3 mm 24,163 St.

- 1. Placement Stitch 0015
- 2. Cut Line and Tackdown 0015
- 3. Lace..... 0015

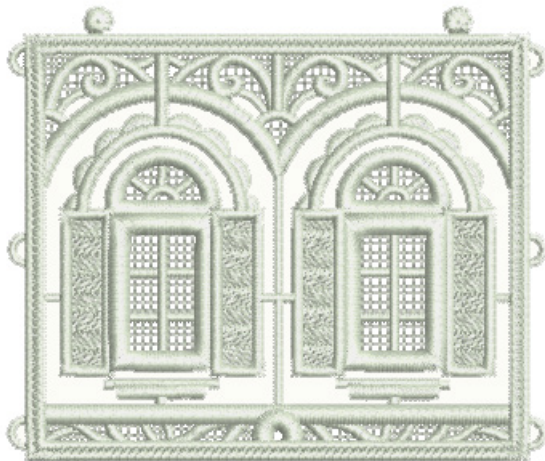

Note: Some designs in this collection may have been created using unique special stitches and/or techniques. To preserve design integrity when rescaling or rotating designs in your software, always rescale or rotate designs using the handles directly on-screen.

***Fabric Required**

OC09006 Foundation FSA

Size Inches: Size mm: Stitch Count:
3.9 X 4.65 in. 99.06 X 118.11 mm 8,628 St.

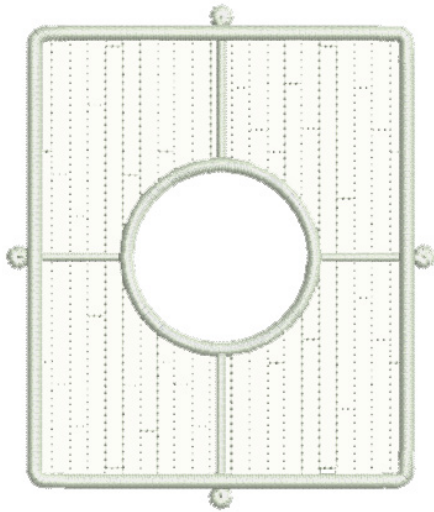

- 1. Placement Stitch 0015
- 2. Cut Line and Tackdown 0015
- 3. Lace..... 0015

***Fabric Required**

OC09007 Roof FSA

Size Inches: Size mm: Stitch Count:
4.28 X 6.09 in. 108.71 X 154.69 mm 40,508 St.

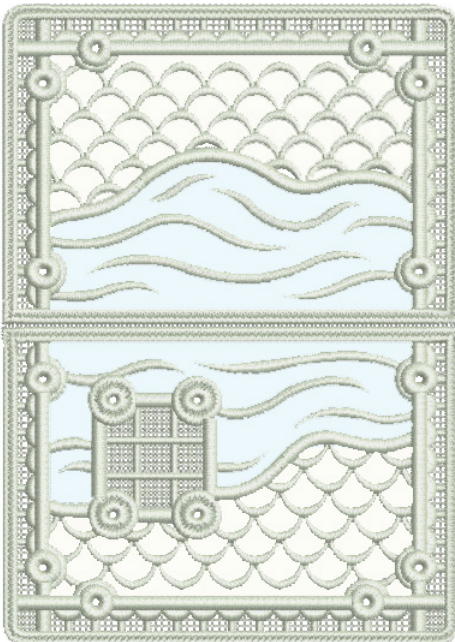

- 1. Shingles Placement Stitch..... 0015
- 2. Cut Line and Tackdown 0015
- 3. Snow Placement Stitch 0015
- 4. Cut Line and Tackdown 0015
- 5. Lace..... 0015

Note: Some designs in this collection may have been created using unique special stitches and/or techniques. To preserve design integrity when rescaling or rotating designs in your software, always rescale or rotate designs using the handles directly on-screen.

OC09008 Chimney FSL

Size Inches:	Size mm:	Stitch Count:
1.7 X 4.37 in.	43.18 X 111 mm	13,425 St.

1. Lace..... 0015



COLLECTION SUPPLIES



Stabilizers

- OESD AquaMesh WashAway
- OESD BadgeMaster WashAway
- OESD StabilStick CutAway

Fabrics/Textiles

- White cotton fabric 1/4 yard
- Note: Fabric sizes are estimates and may result in overage.

Notions & Tools

- OESD Alligator Clamps
- OESD Button Clips
- OESD Expert Embroidery Tape WashAway
- OESD Expert Point and Press Tool
- Embroidery Needle Sharp 75/11

Isacord Thread Colors

- Per thread chart
- Match bobbin thread to top thread
- 0015 White (2 spools)

SUMMARY



Completed Size: 5" H x 4.25" W x 4.25" D

OC09001



Requires 1 Design

OC09002

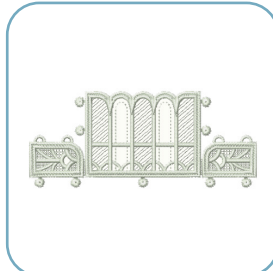

Requires 1 Design

OC09003



Requires 1 Design

OC09004

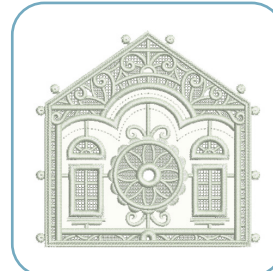

Requires 1 Design

OC09005

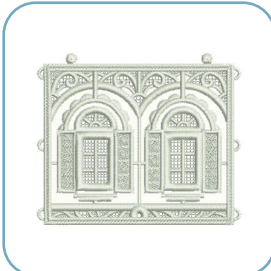

Requires 2 Designs

OC09006

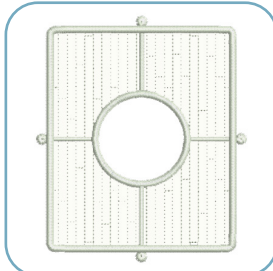

Requires 1 Design

OC09007

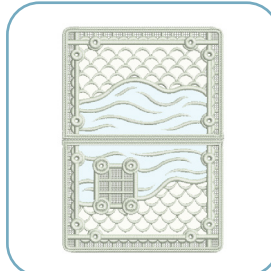

Requires 1 Design

OC09008



Requires 1 Design

Notes

The freestanding applique instructions, included in the collection, are general instructions. For demonstration purposes, a sample design that best demonstrates the technique is shown. Fabric and thread requirements will vary by design, but the general technique is the same.

All designs are stitched with matching thread in the top and bobbin.

For other designs in the collection, use the applique templates as a guide to the dimensions of the various applique pieces.

Note: Some thread colors in instructions have been changed or digitally enhanced for better visibility.

STEP 1

- Hoop one layer of AquaMesh and one layer of BadgeMaster for all designs.



STEP 2

- Adhere two layers of StabilStick CutAway to the wrong side of all applique fabrics to provide stiffness to the finished structure.
- Cut the prepared applique fabrics 1/4"-1/2" larger than the templates.



STEP 3

- Load selected design into the machine.
- Example design is OC09003.
- Thread the machine per the thread chart.
- Place hoop on the machine.
- Stitch Machine Step 1, Window Placement Stitch.

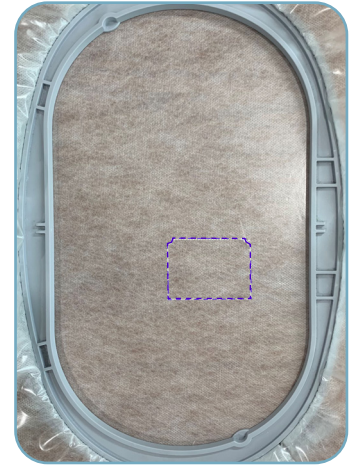

STEP 4

- Remove the hoop from the machine, but NOT the project from the hoop.
- Place the hoop on a flat surface.
- Cut a piece of prepared fabric slightly larger than the placement line.
- Cover the placement line completely with the prepared fabric.
- Tape in place to secure.



EMBROIDERY



STEP 5

- Return the hoop to machine.
- Stitch Machine Step 2, Cut Line & Tackdown.

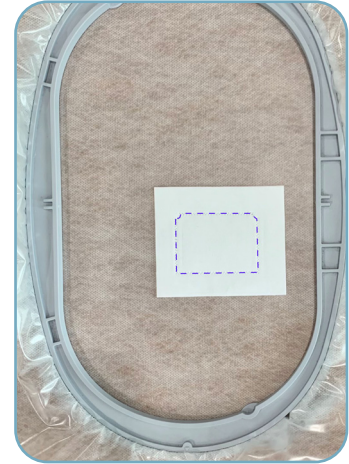

STEP 6

- Remove the hoop from the machine, but NOT the project from the hoop.
- Trim the excess fabric as close to the cut line as possible. If the outermost stitches (cut line) are cut, the inner stitches (tackdown) will still hold the applique in place.



STEP 7

- Return the hoop to machine.
- Stitch Machine Step 3, Door Placement Stitch.



STEP 8

- Remove the hoop from the machine, but NOT the project from the hoop.
- Place the hoop on a flat surface.
- Place the prepared applique fabric, right side up, completely covering the placement stitch.
- Tape in place to secure.



EMBROIDERY



STEP 9

- Return the hoop to machine.
- Stitch Machine Step 4, Cut Line & Tackdown.

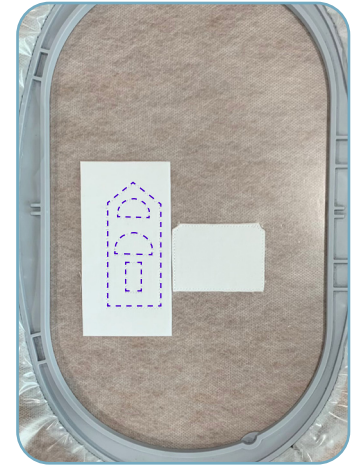

STEP 10

- Remove the hoop from the machine, but NOT the project from the hoop.
- Trim the excess fabric as close to the cut line stitching as possible.
- Note: Trim excess fabric away from interior window area. See applique patterns in the back of the instructions for cut outs.
- Tip: If the OESD AquaMesh is cut or a hole is created while trimming the fabric, use OESD Expert Embroidery Tape WashAway as a patch.



STEP 11

- Return the hoop to machine.
- Stitch Machine Step 5, Sign Placement Stitch.

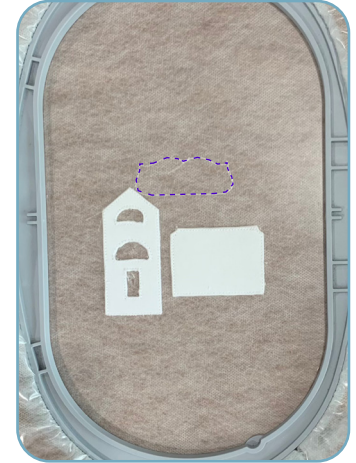

STEP 12

- Remove the hoop from the machine, but NOT the project from the hoop.
- Place the hoop on a flat surface.
- Place the prepared applique fabric, right side up, completely covering the placement stitch.
- Tape in place to secure.



STEP 13

- Return the hoop to machine.
- Stitch Machine Step 6, Cut Line & Tackdown.

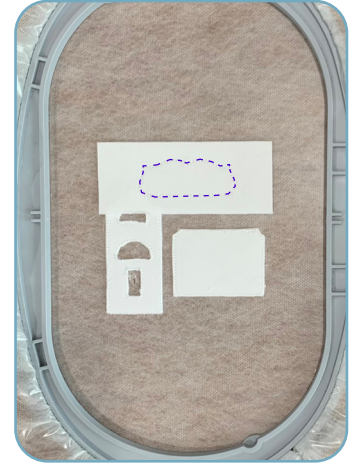

STEP 14

- Remove the hoop from the machine, but NOT the project from the hoop.
- Trim the excess fabric as close to the cut line stitching as possible.



EMBROIDERY



STEP 15

- Return the hoop to the machine.
- Stitch Machine Step 7, Lace.
- Stitch the remaining steps according to the thread chart.
- NOTE: Stitch all required designs. Design #OC09008 is lace only, fabric is not required.
- When the design is complete, remove the project from the hoop and trim the stabilizer 1/4" - 1/2" outside the design.



ASSEMBLY



STEP 16

- Rinse each piece in warm running water until the design is only slightly tacky.
- Place right side down on a non-stick surface to dry. Parchment paper or a cooling rack will prevent curling. Dry completely.
- Once dry, press right side down on a Perfect Embroidery Press Cloth.

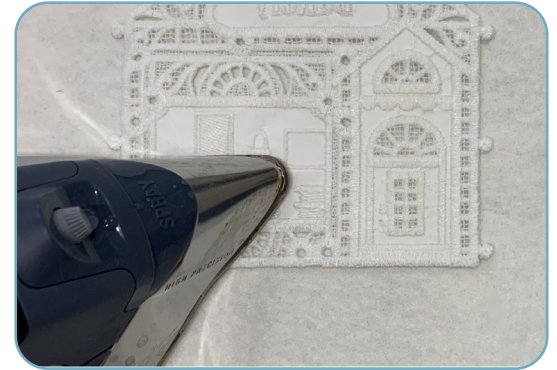

STEP 17

- Fold the flaps of the Window FSA (OC09001) toward the back, finger press the edge.



ASSEMBLY



STEP 18

- Using alligator clamps, attach Window FSA (OC09001) to the Front Wall FSA (OC09003) by pulling the four buttonettes on the window flaps into the four eyelets on the front wall.

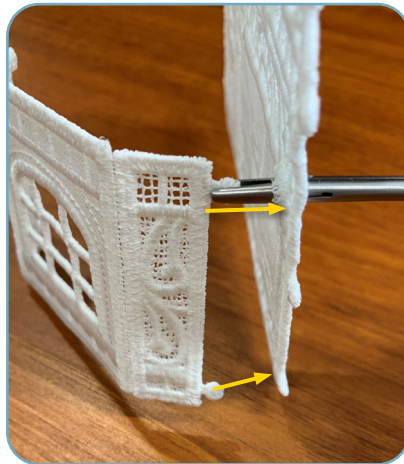

STEP 19

- Form the Awning FSA (OC09003) by folding the side flaps of the awning down and pulling the two buttonettes on each side of the awning into the 2 eyelets located on each side flap.
- Insert the Alligator Clamps through the loops from the back side of the design.
- Grasp the buttonettes and pull through to inside the awning where they will not show when the assembly is complete.

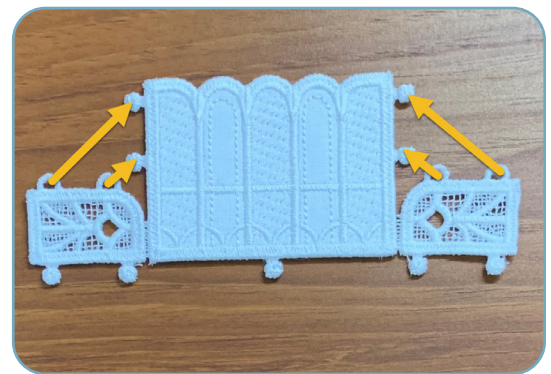

STEP 20

- Attach the Awning FSA (OC09002) to the Front Wall FSA (OC09003) by pulling the five buttonettes on the awning into the five remaining eyelets surrounding the top half of the window.



STEP 21

- Attach one of the Side Walls FSA (OC09005) to the Front Wall FSA (OC09003) by pulling the three buttonettes along the side of the front wall into the three eyelets along the edge of the side wall.

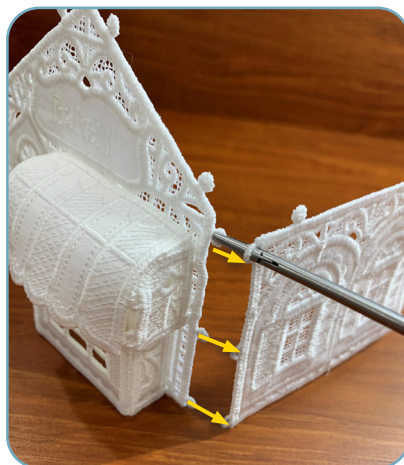

STEP 22

- Repeat for other side.



STEP 23

- Form the Chimney (OC09008) by folding it into a square and pressing each corner for defined fold.
- Pull the two buttonettes on one end into the two eyelets into the opposite end.

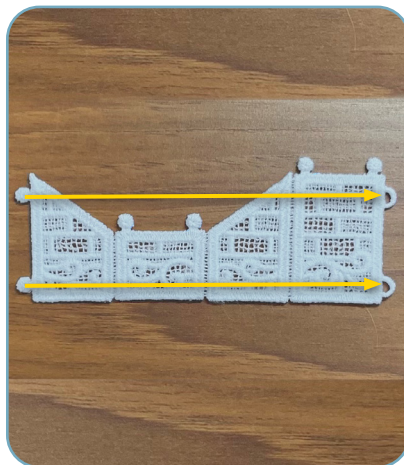

STEP 24

- Attach the formed Chimney (OC09008) to the Roof FSA (OC09007) by pulling the four buttonettes on the corners of the chimney through the four eyelets in the roof.



STEP 25

- Attach Roof FSA (OC09007) to the Front Wall FSA (OC09003) by slightly folding the roof into a V shape. Position the roof over the building with the chimney on the left side of the roof and toward the back half of the building.
- Attach Roof FSA (OC09007) to the Side Walls FSA (OC09005).
- Attach the Back Wall FSA (OC09004) to the Side Walls FSA (OC09005).
- Attach Roof FSA (OC09007) to Back Wall FSA (OC09004).

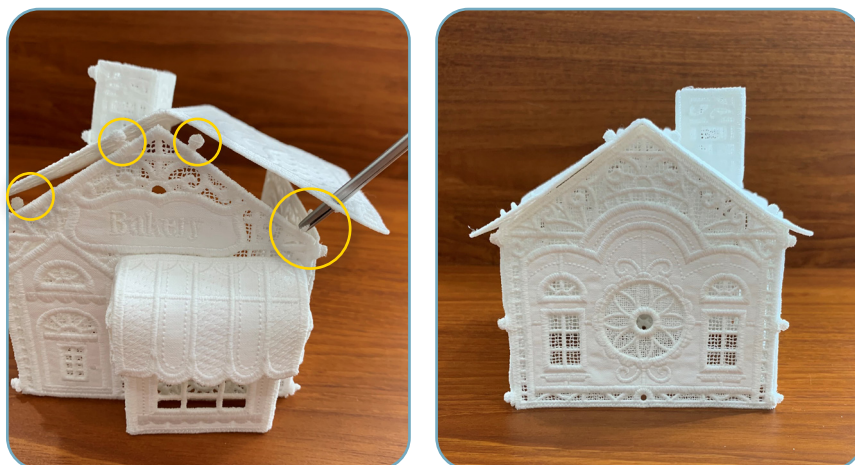

ASSEMBLY



STEP 26

- Attach Foundation FSA (OC09006) to Front Wall FSA (OC09003) and to both Side Walls FSA (OC09005) and to Back Wall FSA (OC09004).



ASSEMBLY



FINISHING TOUCHES

- The bakery is complete. Enjoy.
- Add tea lights or pixie lights to create a glow.



Stabilizer

- OESD AquaMesh
- OESD BadgeMaster

Notions/Tools

- 80/12 Embroidery Ballpoint Titanium needle for extended needle life
- OESD Alligator Clamps
- OESD Button Clips
- OESD Perfect Point and Press Tool

Isacord Thread Colors

- All OESD designs are digitized with Isacord 40 wt. polyester thread as the top thread and in the bobbin.
- Refer to the thread chart for color specifications.
- Match bobbin thread color to the top thread.

Instructions

Step 1 - Hoop

For FSL structures, hoop one layer of OESD AquaMesh and one layer of OESD BadgeMaster. BadgeMaster contains more starch so, combined with the AquaMesh, the lace is more rigid. For other FSL, where a softer lace is desired, hoop two layers of AquaMesh.

Step 2 - Embroider

Stitch the design per the thread chart with matching thread in the bobbin at each color change. When complete, remove from the hoop and trim away excess stabilizer about 1/4"-1/2" from the stitching.

Step 3 - Rinse

Rinse remaining stabilizer out in warm running water. For stiffer lace and FSL structures, DO NOT rinse away all of the stabilizer. The lace should be just slightly tacky. For softer lace, rinse until all traces of the stabilizer are removed.

Step 4 - Dry

Lay right side down flat on a non-stick surface, such as a cooling rack, parchment paper or Teflon sheet. This minimizes the tendency for the lace to curl. Let the pieces dry completely before proceeding with any assembly.

Step 5 - Press

Once completely dry, press right side down on a OESD Perfect Embroidery Press Cloth.

Step 6 - Assemble Structure

Note: Specific assembly instructions for a design/collection may be found in the thread chart pdf following the individual design color charts.

Lace must be COMPLETELY DRY before assembly. Wetting the buttonettes or eyelets to assemble is not recommended and may result in them stretching and coming "unbuttoned" when dry.

Use a pair of OESD Alligator Clamps to insert the buttonettes into the eyelets. Insert the tip of the OESD Alligator Clamps into the eyelet, grasp the buttonette and pull through the eyelet. Alternatively, use a stiletto or tweezers to push the buttonette through the eyelet.

Helpful Tips

Limp Lace

If the design is not stiff enough, press the lace pieces on the wrong side while applying spray starch. After ironing, spray again with starch and allow to dry completely. This will stiffen the lace pieces nicely and aid in construction. Or easily re-stiffen by diluting some stabilizer scraps in water (or use liquid starch) and dipping the item in the solution. Lay flat to dry.

Eyelets Too Small

If any of the eyelets appear closed or too small to penetrate with Alligator Clamps, they may be stretched by inserting the small end of the OESD Perfect Point and Press Tool into the eyelet opening and stretching it open wide enough to accommodate the OESD Alligator Clamps.

Button Clips

During the assembly process, some structures pull on buttonettes that have already been inserted and could pull them out altogether. Putting a Button Clip on the assembled buttonette will keep it in position during the assembly process. Remove the Button Clips when the assembly is complete.

Alternative Construction Option

In some cases, the buttonettes may be pulled to the inside of a project, instead of being visible on the outside. Insert the OESD Alligator Clamps through the eyelet from the wrong, or inside, of the lace and grasp the corresponding buttonette. Pull the buttonette to the wrong side of the lace.

Pulling the buttonettes to the inside may cause stress on the ones already done. Button clips may be placed on the completed buttonette(s) to prevent them from pulling out of the eyelet during construction.

ATTENTION

When printing this document, any page scaling or page fitting options in your print dialog box must be turned OFF or set to NONE so that your files will print out at their actual size. Images not printed at actual size will not function as intended.

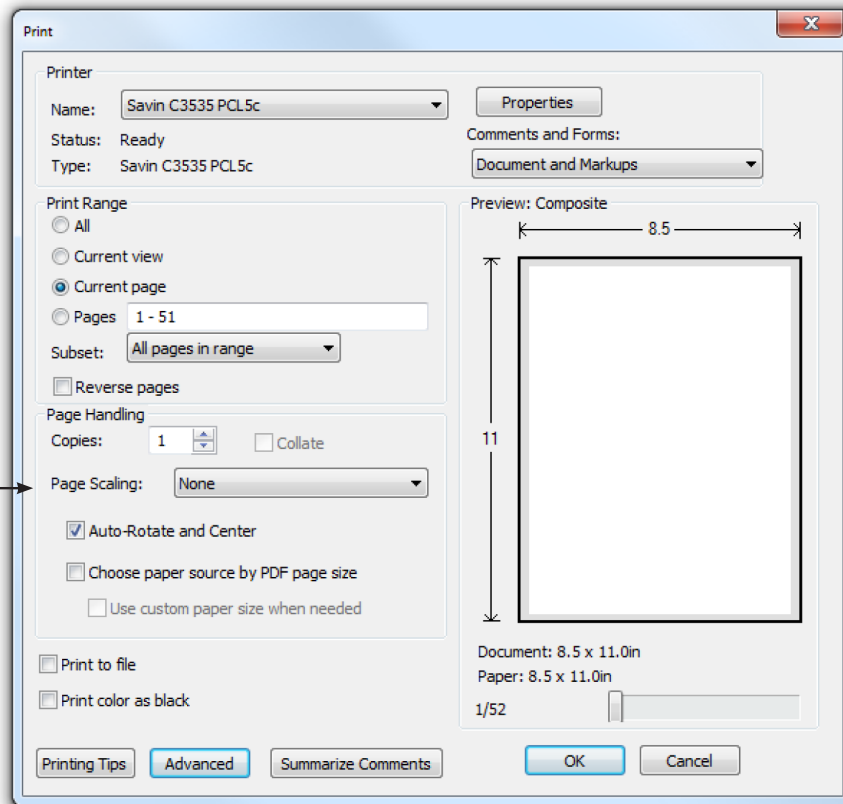

TO SAVE PAPER

Only print the desired image by navigating to the image's page, go to File > Print and select "Current page" in the print dialog box. Repeat for each desired image.

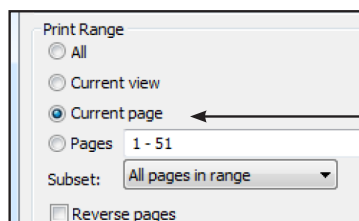

APPLIQUE PATTERNS



Print at 100%. No scaling. This box measures 1" x 1". Use the box as an accuracy guide when printing templates.

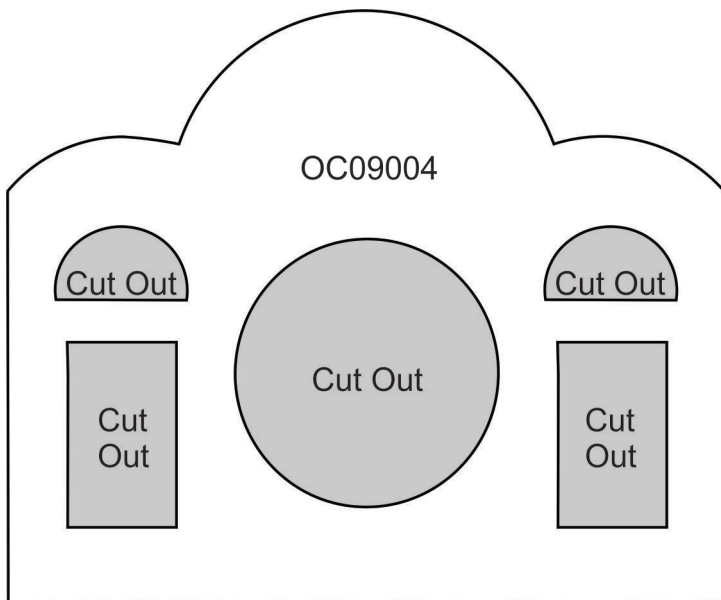
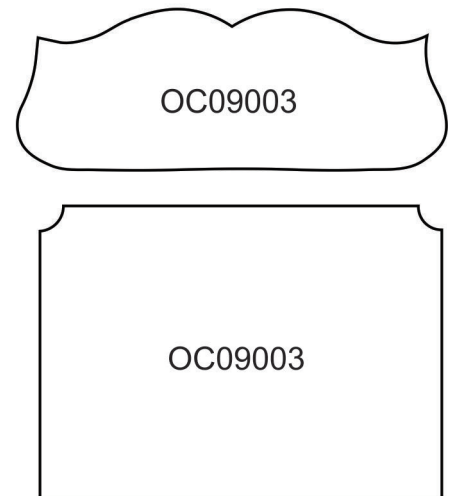
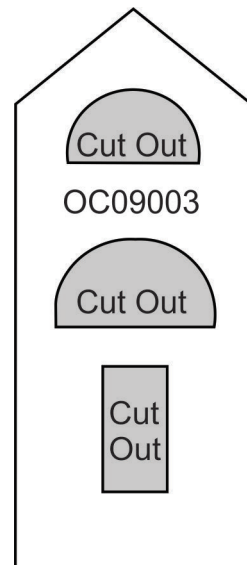
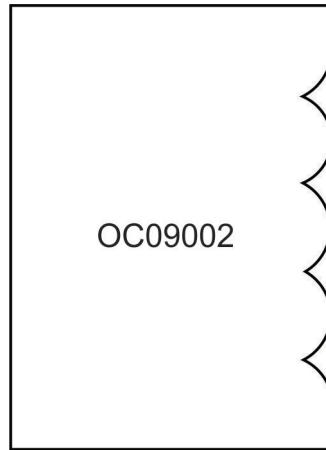
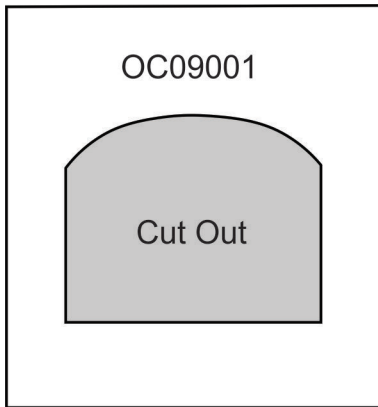

APPLIQUE PATTERNS



Print at 100%. No scaling. This box measures 1" x 1". Use the box as an accuracy guide when printing templates.

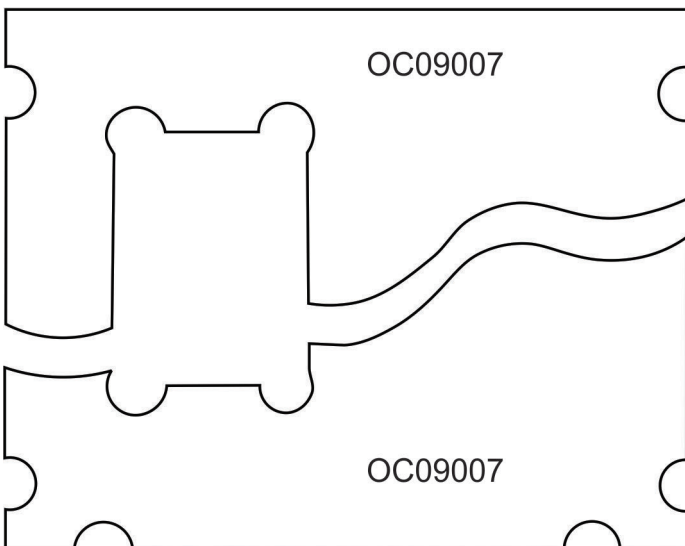
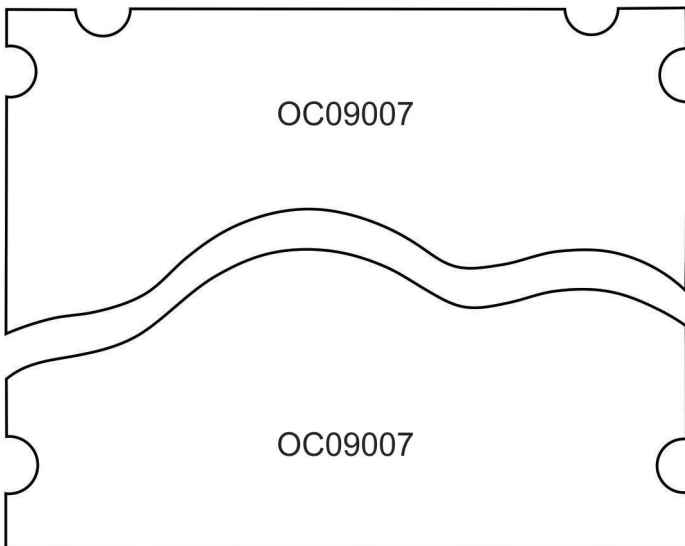
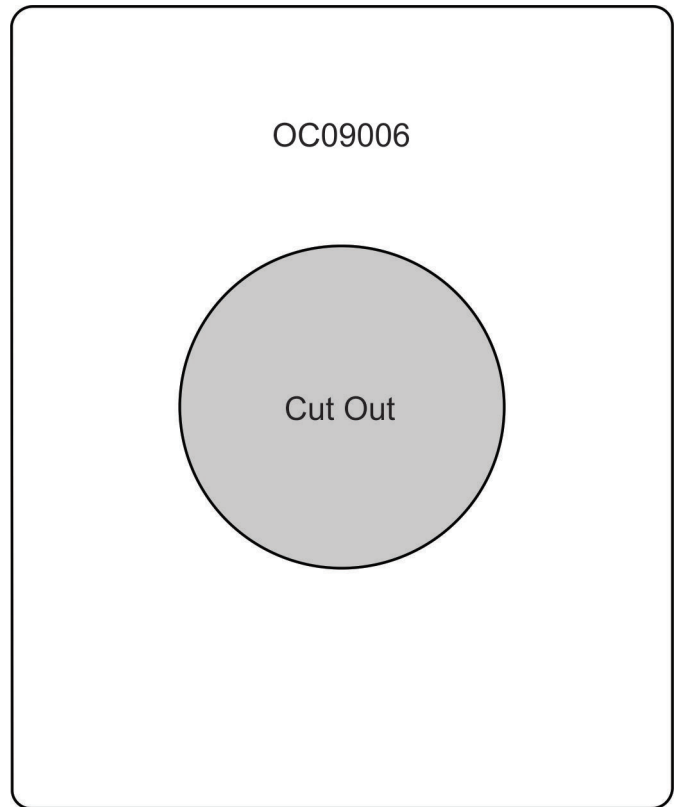
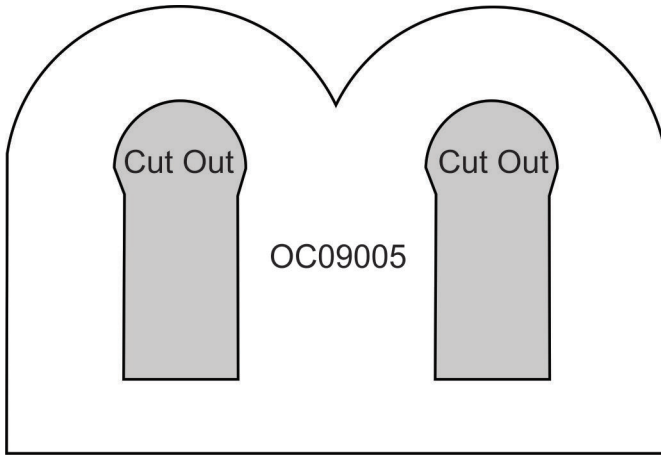

MIRRORED PATTERNS



Print at 100%. No scaling. This box measures 1" x 1". Use the box as an accuracy guide when printing templates.

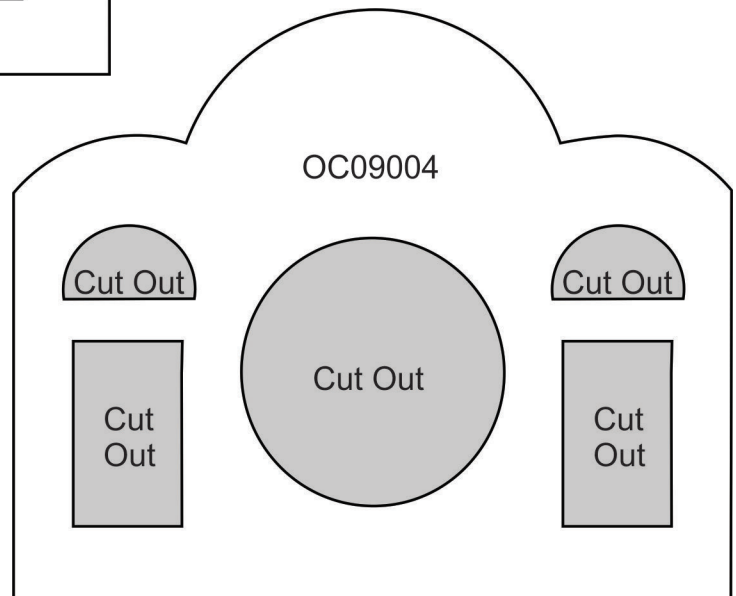
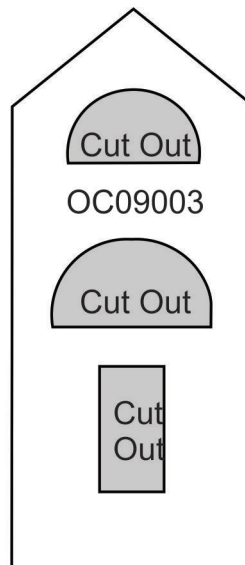
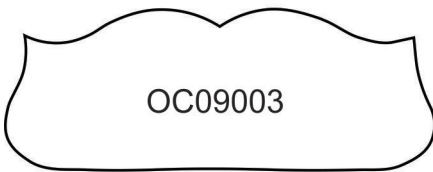
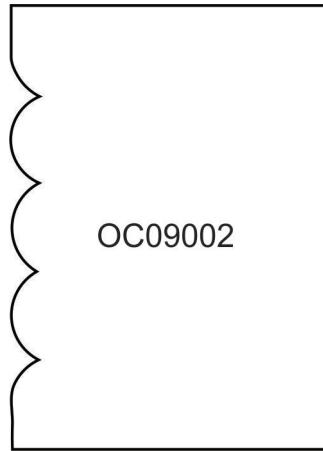
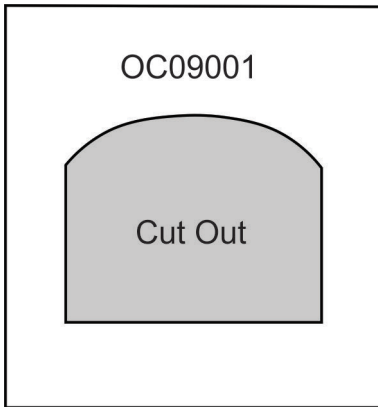

MIRRORED PATTERNS



Print at 100%. No scaling. This box measures 1" x 1". Use the box as an accuracy guide when printing templates.

