

Note: Some designs in this collection may have been created using unique special stitches and/or techniques. To preserve design integrity when rescaling or rotating designs in your software, always rescale or rotate designs using the handles directly on-screen.

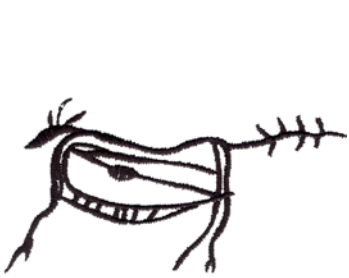

80011-01
3.51 X 1.82 in.
89.15 X 46.23 mm
3,285 St.



80011-02
3.29 X 3.51 in.
83.57 X 89.15 mm
4,740 St.



80011-03
3.51 X 2.08 in.
89.15 X 52.83 mm
2,884 St.



80011-04
3.51 X 2.29 in.
89.15 X 58.17 mm
2,888 St.



80011-05
3.51 X 2.85 in.
89.15 X 72.39 mm
3,121 St.



80011-06
3.51 X 1.93 in.
89.15 X 49.02 mm
2,191 St.

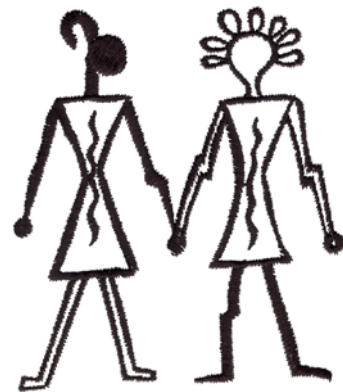

80011-07
2.99 X 3.51 in.
75.95 X 89.15 mm
5,540 St.



80011-08
2.90 X 3.85 in.
75.95 X 97.79 mm
9,263 St.



80011-09
1.49 X 3.50 in.
37.85 X 88.90 mm
2,221 St.



80011-10
2.19 X 3.51 in.
55.63 X 89.15 mm
2,606 St.



80011-11
2.43 X 3.51 in.
61.72 X 89.15 mm
1,973 St.



80011-12
1.81 X 3.50 in.
45.97 X 88.90 mm
800 St.

Design contains a loose fill.
 Some white areas shown are not stitched.

L Design is larger than 5" (127 mm) in either direction.
S Design is smaller than 1.5" (38.1 mm) in either direction.

Note: Some designs in this collection may have been created using unique special stitches and/or techniques. To preserve design integrity when rescaling or rotating designs in your software, always rescale or rotate designs using the handles directly on-screen.



80011-13
3.11 X 3.50 in.
78.99 X 88.90 mm
3,690 St. ⚙️



80011-14
3.51 X 1.77 in.
89.15 X 44.96 mm
3,165 St. ⚙️



80011-15
1.88 X 4.31 in.
47.75 X 109.47 mm
13,532 St.



80011-16
1.52 X 3.91 in.
38.61 X 99.31 mm
10,919 St.



80011-17
1.67 X 3.90 in.
42.42 X 99.06 mm
9,378 St.

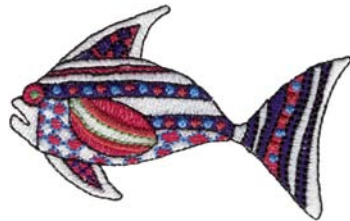

80011-18
2.18 X 3.47 in.
55.37 X 88.14 mm
10,528 St.



80011-19
1.84 X 4.26 in.
46.74 X 108.20 mm
12,803 St.



80011-20
1.89 X 4.25 in.
48.01 X 107.95 mm
14,392 St.



80011-21 Appliqué
2.41 X 6.25 in.
61.21 X 158.75 mm
7,597 St. L



80011-22 Appliqué
2.78 X 6.25 in.
70.61 X 158.75 mm
10,804 St. L

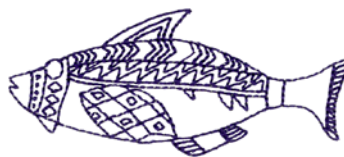

80011-23
1.36 X 3.18 in.
34.54 X 80.77 mm
2,547 St. ⚙️ S

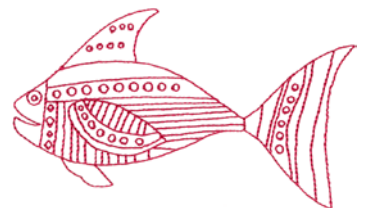

80011-24
2.91 X 4.96 in.
73.91 X 125.98 mm
4,279 St. ⚙️

⚙️ Design contains a loose fill.
⚙️ Some white areas shown are not stitched.

L Design is larger than 5" (127 mm) in either direction.
S Design is smaller than 1.5" (38.1 mm) in either direction.

Note: Some designs in this collection may have been created using unique special stitches and/or techniques. To preserve design integrity when rescaling or rotating designs in your software, always rescale or rotate designs using the handles directly on-screen.



80011-25 Appliqué
3.64 X 4.07 in.
92.46 X 103.38 mm
4,272 St.

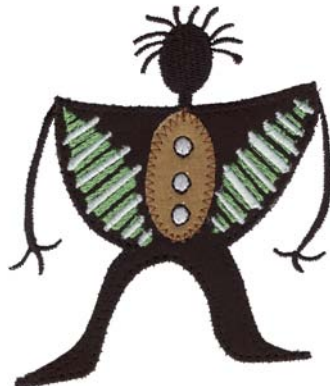

80011-26 Appliqué
3.48 X 4.16 in.
88.39 X 105.66 mm
6,217 St.



80011-27
3.75 X 4.16 in.
95.25 X 105.66 mm
2,566 St. ⚙️

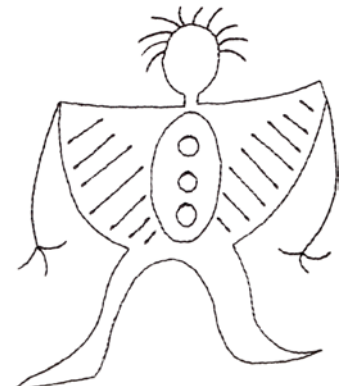

80011-28
3.47 X 4.16 in.
88.14 X 105.66 mm
2,060 St. ⚙️



80011-29 Border Jumbo
1.88 X 7.60 in.
47.75 X 193.04 mm
10,048 St. ⚙️ L

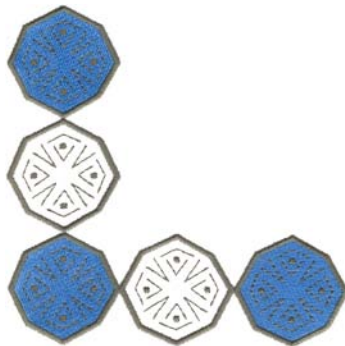

80011-30 Corner Jumbo
5.65 X 5.70 in.
143.51 X 144.78 mm
13,732 St. ⚙️ L



80011-31 Jumbo
5.50 X 5.51 in.
139.70 X 139.95 mm
19,179 St. ⚙️ L



80011-32
1.92 X 1.88 in.
48.77 X 47.75 mm
1,329 St. ⚙️



80011-33
1.92 X 1.88 in.
48.77 X 47.75 mm
3,589 St.



80011-34 Appliqué
3.01 X 2.98 in.
76.45 X 75.69 mm
4,335 St.



80011-35
1.02 X 1.04 in.
25.91 X 26.42 mm
1,531 St. S



80011-36
1.02 X 1.04 in.
25.91 X 26.42 mm
806 St. ⚙️ S

⚙️ Design contains a loose fill.
⚙️ Some white areas shown are not stitched.

L Design is larger than 5" (127 mm) in either direction.
S Design is smaller than 1.5" (38.1 mm) in either direction.

Note: Some designs in this collection may have been created using unique special stitches and/or techniques. To preserve design integrity when rescaling or rotating designs in your software, always rescale or rotate designs using the handles directly on-screen.



80011-37 Appliqué
2.81 X 2.88 in.
71.37 X 73.15 mm
4,835 St.



80011-38 Border
4.38 X 1.33 in.
111.25 X 33.78 mm
4,242 St. ⚡ ⚙ S

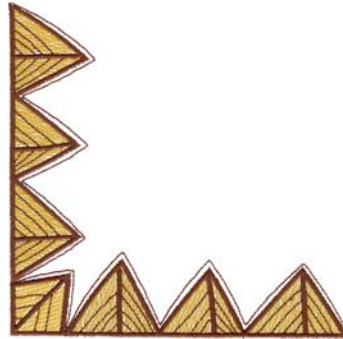

80011-39 Corner Jumbo
5.22 X 5.21 in.
132.59 X 132.33 mm
9,676 St. ⚡ ⚙ L



80011-40
3.51 X 1.85 in.
89.15 X 46.99 mm
4,455 St. ⚡



80011-41
3.51 X 1.85 in.
89.15 X 46.99 mm
5,045 St. ⚡



80011-42 Appliqué
3.00 X 3.00 in.
76.20 X 76.20 mm
2,961 St.

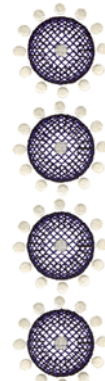

80011-43 Border
1.49 X 6.15 in.
37.85 X 156.21 mm
8,554 St. ⚡ L S

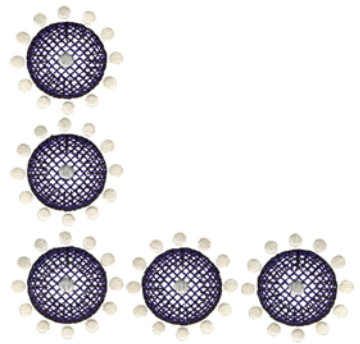

80011-44 Corner
4.61 X 4.57 in.
117.09 X 116.08 mm
10,576 St. ⚡



80011-45
1.51 X 1.49 in.
38.35 X 37.85 mm
2,135 St. ⚡ S

⚡ Design contains a loose fill.
⚙ Some white areas shown are not stitched.

L Design is larger than 5" (127 mm) in either direction.
S Design is smaller than 1.5" (38.1 mm) in either direction.



African Inspirations

by Kaye England / #80011 / 45 Designs

Listings below indicate color sample, stitching order and suggested thread color number. Most numbers indicate Isacord thread. However, colors beginning with 20501 refer to YLI Fine Metallics, 7 refer to Yenmet Metallic, 8 refer to YLI Variations Variegated Thread and 9 refer to Isacord Multicolor Variegated.

| | | |
|-----------------|----------------------------------|------|
| 80011-01 | 1. Single Color Design..... | 0020 |
| 80011-02 | 1. Single Color Design..... | 0020 |
| 80011-03 | 1. Single Color Design..... | 0020 |
| 80011-04 | 1. Single Color Design..... | 0020 |
| 80011-05 | 1. Single Color Design..... | 0020 |
| 80011-06 | 1. Single Color Design..... | 0020 |
| 80011-07 | 1. Single Color Design..... | 0020 |
| 80011-08 | 1. Single Color Design..... | 0020 |
| 80011-09 | 1. Single Color Design..... | 0020 |
| 80011-10 | 1. Single Color Design..... | 0020 |
| 80011-11 | 1. Single Color Design..... | 0020 |
| 80011-12 | 1. Single Color Design..... | 0020 |
| 80011-13 | 1. Single Color Design..... | 0020 |
| 80011-14 | 1. Single Color Design..... | 0020 |
| 80011-15 | 1. Light Pink Details..... | 2300 |
| | 2. Dark Purple Details..... | 3102 |
| | 3. Blue Details..... | 3815 |
| | 4. Red Details..... | 1921 |
| | 5. Dark Pink Details..... | 2521 |
| | 6. White Details..... | 0015 |
| | 7. Black Details & Linework..... | 0020 |
| 80011-16 | 1. Yellow Details..... | 0704 |
| | 2. Blue Details..... | 3815 |
| | 3. Brown Details..... | 1355 |
| | 4. Green Details..... | 5531 |
| | 5. Dark Purple Details..... | 3102 |
| | 6. Pink Details..... | 2521 |
| | 7. Black Details & Linework..... | 0020 |
| 80011-17 | 1. Green Details..... | 5531 |
| | 2. Pink Details..... | 2300 |
| | 3. Dark Purple Details..... | 3102 |
| | 4. Red Details..... | 1921 |
| | 5. Blue Details..... | 3815 |
| | 6. Black Details & Linework..... | 0020 |

| | | |
|--------------------------|----------------------------------|------|
| 80011-18 | 1. Pink Details..... | 2300 |
| | 2. Dark Purple Details..... | 3102 |
| | 3. White Details..... | 0015 |
| | 4. Black Linework..... | 0020 |
| | 5. Blue Details..... | 3815 |
| | 6. Red Details..... | 1921 |
| | 7. Green Details..... | 5531 |
| 80011-19 | 1. Pink Details..... | 2300 |
| | 2. Dark Pink Details..... | 2521 |
| | 3. Dark Purple Details..... | 3102 |
| | 4. Orange Details..... | 1114 |
| | 5. Blue Details..... | 3815 |
| | 6. White Details..... | 0015 |
| | 7. Black Details & Linework..... | 0020 |
| 80011-20 | 1. White Details..... | 0015 |
| | 2. Yellow Details..... | 0704 |
| | 3. Green Details..... | 5531 |
| | 4. Pink Details..... | 2300 |
| | 5. Red Details..... | 1921 |
| | 6. Blue Details..... | 3815 |
| | 7. Brown Details..... | 1355 |
| | 8. Orange Details..... | 1114 |
| | 9. Black Linework..... | 0020 |
| 80011-21 Appliqué | 1. Placement Stitch..... | 0015 |
| | 2. Tackdown..... | 0020 |
| | 3. White Details..... | 0015 |
| | 4. Red Details..... | 1921 |
| | 5. Pink Details..... | 2300 |
| | 6. Dark Purple Details..... | 3102 |
| | 7. Green Details..... | 5531 |
| | 8. Black Linework..... | 0020 |
| 80011-22 Appliqué | 1. Placement Stitch..... | 0015 |
| | 2. Tackdown..... | 0020 |
| | 3. White Details..... | 0015 |
| | 4. Green Details..... | 5531 |
| | 5. Blue Details..... | 3815 |
| | 6. Orange Details..... | 1114 |
| | 7. Purple Details..... | 3102 |
| | 8. Black Linework..... | 0020 |
| 80011-23 | 1. Single Color Design..... | 3102 |
| 80011-24 | 1. Single Color Design..... | 2300 |
| 80011-25 Appliqué | 1. Arms & Head..... | 0020 |
| | 2. Body Placement Stitch..... | 0015 |
| | 3. Body Tackdown..... | 0020 |
| | 4. Chest Placement Stitch..... | 0020 |
| | 5. Chest Tackdown..... | 0015 |
| | 6. Orange Details..... | 1114 |
| 80011-26 Appliqué | 1. Arms & Head..... | 0020 |
| | 2. Body Placement Stitch..... | 0015 |
| | 3. Body Tackdown..... | 0020 |
| | 4. Chest Placement Stitch..... | 0020 |
| | 5. Chest Tackdown..... | 1355 |
| | 6. Green Details..... | 5531 |
| | 7. White Details..... | 0015 |
| | 8. Black Circles..... | 0020 |

| | | |
|------------------------------|--------------------------------------|------|
| 80011-27 | 1. Single Color Design..... | 0020 |
| 80011-28 | 1. Single Color Design..... | 0020 |
| 80011-29 Border Jumbo | 1. Blue Details..... | 3815 |
| | 2. Dark Green Details..... | 5664 |
| 80011-30 Corner Jumbo | 1. Blue Details..... | 3815 |
| | 2. Dark Green Details..... | 5664 |
| 80011-31 Jumbo | 1. Blue Details..... | 3815 |
| | 2. Dark Green Details..... | 5664 |
| | 3. Green Flower Centers..... | 5531 |
| 80011-32 | 1. Single Color Design..... | 5664 |
| 80011-33 | 1. Blue Details..... | 3815 |
| | 2. Dark Green Details..... | 5664 |
| 80011-34 Appliqué | 1. Placement Stitch..... | 0015 |
| | 2. Cut Line & Tackdown..... | 0015 |
| | 3. Green Cover Stitch & Details..... | 5664 |
| 80011-35 | 1. Blue Details..... | 3815 |
| | 2. Dark Green Details..... | 5664 |
| | 3. Light Green Center..... | 5531 |
| 80011-36 | 1. Dark Green Details..... | 5664 |
| | 2. Light Green Center..... | 5531 |
| 80011-37 Appliqué | 1. Placement Stitch..... | 0015 |
| | 2. Cut Line & Tackdown..... | 0015 |
| | 3. Dark Green Details..... | 5664 |
| | 4. Light Green Center..... | 5531 |
| 80011-38 Border | 1. Yellow Details..... | 0704 |
| | 2. Brown Details..... | 1355 |
| 80011-39 Corner Jumbo | 1. Yellow Details..... | 0704 |
| | 2. Brown Details..... | 1355 |
| 80011-40 | 1. Orange Details..... | 1114 |
| | 2. White Details..... | 0015 |
| | 3. Black Details..... | 0020 |
| 80011-41 | 1. Orange Details..... | 1114 |
| | 2. Green Details..... | 5531 |
| | 3. White Details..... | 0015 |
| | 4. Black Details..... | 0020 |
| 80011-42 Appliqué | 1. Placement Stitch..... | 0015 |
| | 2. Tackdown..... | 0020 |
| | 3. White Details..... | 0015 |

Listings below indicate color sample, stitching order and suggested thread color number. Most numbers indicate Isacord thread. However, colors beginning with 20501 refer to YLI Fine Metallics, 7 refer to Yenmet Metallic, 8 refer to YLI Variations Variegated Thread and 9 refer to Isacord Multicolor Variegated.

80011-43 Border

| | |
|--------------------------------|------|
| ■ 1. Dark Purple Grids..... | 3102 |
| ■ 2. Black Shading & Rims..... | 0020 |
| □ 3. White Dots..... | 0015 |

80011-44 Corner

| | |
|--------------------------------|------|
| ■ 1. Dark Purple Grids..... | 3102 |
| ■ 2. Black Shading & Rims..... | 0020 |
| □ 3. White Dots..... | 0015 |

80011-45

| | |
|-------------------------------|------|
| ■ 1. Dark Purple Grid..... | 3102 |
| ■ 2. Black Shading & Rim..... | 0020 |
| □ 3. White Dots..... | 0015 |

Note: Appliqué fabric not included.

Check with your local dealer for a companion Kaye England thread kit by Aurifil that coordinates with this collection.

| Color | Isacord | Aurifil |
|-------------|---------|---------|
| Dark Purple | 3102 | 1200 |
| White | 0015 | 2021 |
| Light Pink | 2300 | 4020 |
| Dark Pink | 2521 | 1100 |
| Red | 1921 | 2250 |
| Dark Green | 5664 | 2850 |
| Blue | 3815 | 4140 |
| Black | 0020 | 2692 |
| Green | 5531 | 2884 |
| Yellow | 0704 | 2140 |
| Brown | 1355 | 4012 |
| Orange | 1114 | 2240 |

Cut-in-Place Appliqué Instructions

1. Hoop your fabric and backing.
2. Sew the pattern/placement. **PHOTO 1**
3. Place a piece of appliqué fabric over the pattern/placement so that it is completely covered.
4. Sew the trim stitch/tackdown.
5. Carefully cut away the excess appliqué fabric. **PHOTO 2**
6. Sew the remainder of the design and repeat for any remaining pieces. **PHOTO 3**

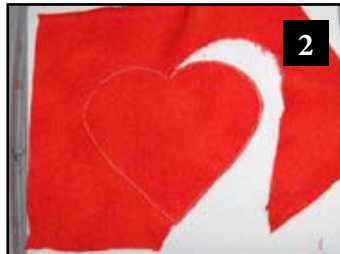
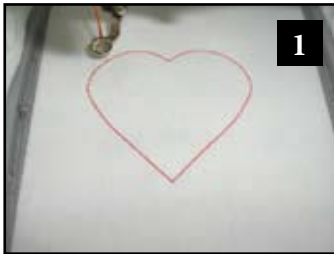

Pre-Cut Appliqué Instructions

1. Print out the necessary pages from the PDF of the appliqué pattern(s).
2. Mark the right side of the pattern pieces so you'll know which direction to lay the pattern on the fabric.
3. Lightly spray the wrong side of the pattern pieces with temporary adhesive spray and allow it to set for a few minutes.
4. Place the pattern pieces on the right side of the fabric and carefully cut them out. **PHOTO 1**
5. Sew the placement stitch on your hooped fabric. **PHOTO 2**
6. With the paper still stuck to the right side of the appliqué fabric, spray the wrong side of the fabric with temporary spray adhesive.
7. Place the fabric inside the sewing placement stitch so that it matches the stitching line then remove the paper pattern. **PHOTO 3**
8. Sew the tackdown. **PHOTO 4**
9. Sew the remainder of the design and repeat for any remaining pieces. **PHOTO 5**

NOTE: The patterns are sized for the designs as they were made. If you resize the design, you will need to resize the pattern the same amount. You can print out the pattern at the normal size then copy it on a copy machine at the changed size, i.e. resize the designs to 80%, resize the printed pattern to 80%.

TIP: When Printing the patterns, make sure that the “Fit to page” option is **UNCHECKED** in the Print Dialog Box. If this option is checked the printed patterns will not be actual size.

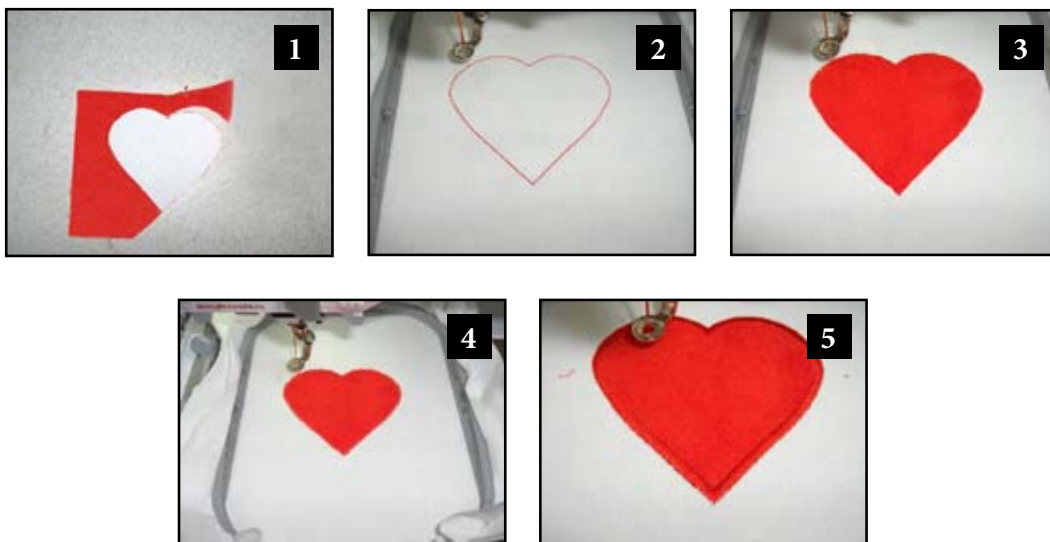

Note: Designs 21, 22, 25, 26 and 42 require the pre-cut appliqué method.
 Designs 34 and 37 can be done using either appliqué method.

ATTENTION

When printing this document, any page scaling or page fitting options in your print dialog box must be turned OFF or set to NONE so that your files will print out at their actual size. Images not printed at actual size will not function as intended.

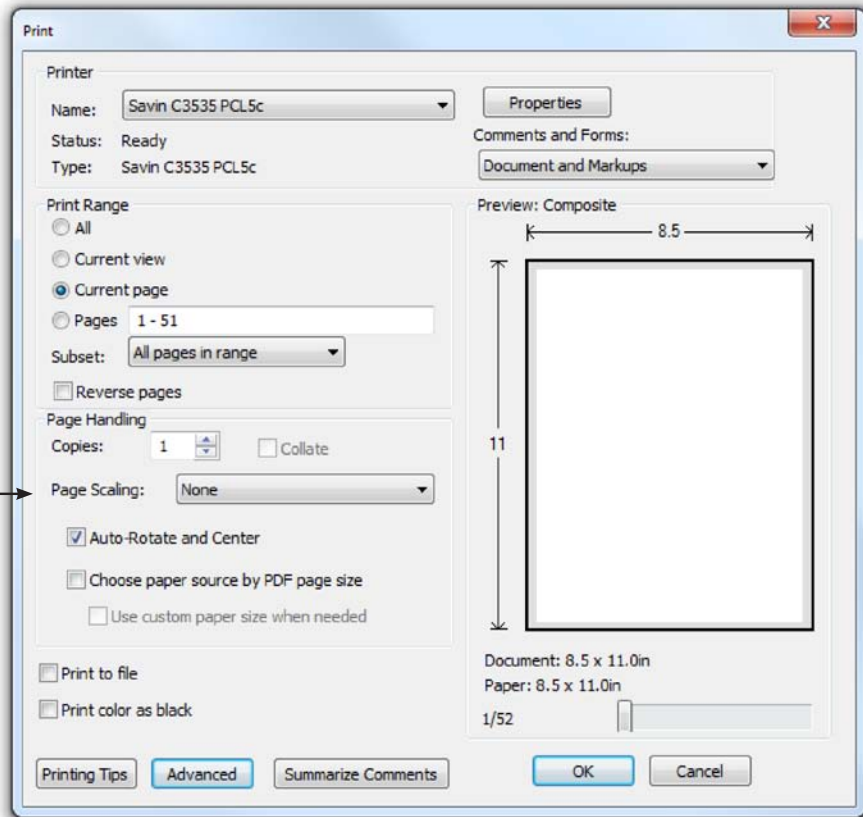

TO SAVE PAPER

Only print the desired image by navigating to the image's page, go to File > Print and select "Current page" in the print dialog box. Repeat for each desired image.

