

Note: Some designs in this collection may have been created using unique special stitches and/or techniques. To preserve design integrity when rescaling or rotating designs in your software, always rescale or rotate designs using the handles directly on-screen.



80012-01 Tufted Satins Appliqué
4.76 X 5.86 in.
120.90 X 148.84 mm
23,382 St. **L**



80012-02 Tufted Satins
3.66 X 4.01 in.
92.96 X 101.85 mm
13,541 St.



80012-03 Appliqué
3.02 X 3.70 in.
76.71 X 93.98 mm
4,631 St.



80012-04 Appliqué
2.81 X 4.98 in.
71.37 X 126.49 mm
5,842 St. **S**



80012-05
3.14 X 3.43 in.
79.76 X 87.12 mm
14,886 St. **S**



80012-06
2.64 X 2.85 in.
67.06 X 72.39 mm
10,048 St. **S**



80012-07
2.40 X 1.52 in.
60.96 X 38.61 mm
4,144 St.



80012-08
2.65 X 1.28 in.
67.31 X 32.51 mm
4,319 St. **S**



80012-09
3.14 X 1.26 in.
79.76 X 32.00 mm
4,386 St. **S**



80012-10
6.27 X 1.29 in.
159.26 X 32.77 mm
7,781 St. **L S**



80012-11
2.79 X 2.99 in.
70.87 X 75.95 mm
7,363 St. **S**



80012-12
2.52 X 2.26 in.
64.01 X 57.40 mm
3,577 St. **S**

⌘ Design contains a loose fill.
⚙ Some white areas shown are not stitched.

L Design is larger than 5" (127 mm) in either direction.
S Design is smaller than 1.5" (38.1 mm) in either direction.

Note: Some designs in this collection may have been created using unique special stitches and/or techniques. To preserve design integrity when rescaling or rotating designs in your software, always rescale or rotate designs using the handles directly on-screen.



80012-13
1.97 X 2.05 in.
50.04 X 52.07 mm
5,892 St. ⚡



80012-14
3.21 X .71 in.
81.53 X 18.03 mm
2,701 St. S



80012-15
3.68 X 3.67 in.
93.47 X 93.22 mm
14,660 St. ⚡



80012-16
3.59 X 3.76 in.
91.19 X 95.50 mm
13,921 St. ⚡



80012-17
3.25 X 2.60 in.
82.55 X 66.04 mm
8,566 St. ⚡



80012-18 Tufted Satins Appliqué
2.30 X 3.89 in.
58.42 X 98.81 mm
7,600 St.



80012-19
2.03 X 4.01 in.
51.56 X 101.85 mm
7,184 St. ⚡



80012-20 Appliqué
2.21 X 2.49 in.
56.13 X 63.25 mm
6,953 St.



80012-21 Appliqué
2.18 X 2.50 in.
55.37 X 63.50 mm
5,414 St.



80012-22 Appliqué
2.41 X 2.61 in.
61.21 X 66.29 mm
7,336 St.



80012-23
2.14 X 6.02 in.
54.36 X 152.91 mm
12,405 St. L



80012-24 Appliqué
4.77 X 3.96 in.
121.16 X 100.58 mm
15,754 St. ⚡

⚡ Design contains a loose fill.
⚡ Some white areas shown are not stitched.

L Design is larger than 5" (127 mm) in either direction.
S Design is smaller than 1.5" (38.1 mm) in either direction.

Note: Some designs in this collection may have been created using unique special stitches and/or techniques. To preserve design integrity when rescaling or rotating designs in your software, always rescale or rotate designs using the handles directly on-screen.



80012-25 Appliqué
4.76 X 3.77 in.
120.90 X 95.76 mm
15,305 St.



80012-26 Appliqué Jumbo
4.27 X 8.55 in.
108.46 X 217.17 mm
28,239 St. ✿ L



80012-27 Appliqué Jumbo
4.65 X 7.95 in.
118.11 X 201.93 mm
23,181 St. ✿ L

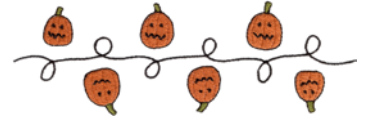

80012-28
6.06 X 2.01 in.
153.92 X 51.05 mm
7,097 St. ✿ L

✿ Design contains a loose fill.
✿ Some white areas shown are not stitched.

L Design is larger than 5" (127 mm) in either direction.
S Design is smaller than 1.5" (38.1 mm) in either direction.



Cats, Bats & Bones

by Debbie Mumm / #80012 / 28 Designs

Listings below indicate color sample, stitching order and suggested thread color number. Most numbers indicate Isacord thread. However, colors beginning with 20501 refer to YLI Fine Metallics, 7 refer to Yenmet Metallic, 8 refer to YLI Variations Variegated Thread and 9 refer to Isacord Multicolor Variegated.

80012-01 Tufted Satins Appliqué

1. Trunk Placement Stitch	0015
2. Trunk Tackdown	1355
3. Branches & Details	1342
4. Tree Details	0922
5. Cats	4174
6. Pumpkins	1114
7. Stems	5833
8. Cat & Pumpkin Details	0020
9. Cat Eyes	0622
10. Leaves	0622
11. Leaves	5833
12. Leaves	1332
13. Leaf Details	0922

80012-02 Tufted Satins

1. Cats & Tufted Tails	4174
2. Cat Details	0020
3. Eyes & Noses	0622
4. Highlights	0138

80012-03 Appliqué

1. Cat Placement Stitch	0015
2. Cat Tackdown	4174
3. Cat Eyes	0622
4. Cat Highlights	0015
5. Cat Nose & Whiskers & Pumpkin	1114
6. Stem	5833
7. Black on Cat's Eyes, Pumpkin Features, & Pumpkin Outlines	0020
8. White on Pumpkin Features	0015

80012-04 Appliqué

1. Pumpkin Placement Stitch	0015
2. Pumpkin Tackdown	1310
3. Cat Placement Stitch	0015
4. Cat Tackdown	4174
5. Pumpkin Face	0020
6. White Cat Markings	0015
7. Yellow Cat Eyes & Star	0622
8. Orange Spider, Cat Nose, Whiskers, & Mouth, & Cat Necklace	1114
9. Black Spider Outlines & Cats Eyes	0020

80012-05

1. Cat	4174
2. Cat Shading	0020
3. Stems	5833
4. Orange Cat Nose, Mouth, Whiskers, & Pumpkins	1114
5. Yellow Cat Eyes	0622
6. Black Faces & Outlines on Pumpkins	0020
7. White Linework on Pumpkins & Spots on Cat	0015

80012-06

1. Pumpkin	1114
2. Stem	5833
3. Cat	4174
4. Cat Eyes	0015
5. Grey Highlights on Cat	0138
6. Collar	5833
7. Black Outlines, Pumpkin Features, & Cat Dots	0020
8. Orange Cat Nose, Ears, & Whiskers	1114
9. Purple Bat & Pendant	2830
10. Dark Purple on Bat	2905
11. Yellow Crescent on Pendant	0622
12. Fangs on Bat	0015
13. Black Bat Outlines, Pendant Outlines, and Black in Cat Eyes	0020

80012-07

1. Bat	4174
2. Highlights	0138
3. Eyes	0015
4. Fangs	0622
5. Stripes	1332

80012-08

1. Bat	4174
2. Eyes & Fangs	0622
3. Black Details	0020
4. Spots	1332
5. Cheeks	1114

80012-09

1. Bat	1114
2. Eyes & Fangs	0015
3. Eyes	5822
4. Black Details	0020
5. Spots	4174

80012-10

1. Bats	2905
2. Bat Details	0020
3. Stars	0622
4. Swirls	1114
5. Design Outlines	0020

80012-11

1. Bird	4174
2. Beak & Curly String	0622
3. Purple Boots, Mask, & Hatband	2905
4. Orange Hat, Mask, Wingtips, & Tail Tips	1114
5. Black Outlines & Shading on Crow	0020
6. White Linework & Eyes	0015

80012-12

1. Spider	4174
2. Highlights	0138
3. Mouth	0020
4. Cheeks	1332
5. Eyes	0622

80012-13

1. Pumpkin	1114
2. Stem	5833
3. Black Features & Outlines	0020
4. Highlights	0015

80012-14

1. White Stripes	0015
2. Orange Stripes	1332
3. Bristles	0622
4. Bristle Shading	0822
5. Black Stripes, Stitching, & Outlines	0020

80012-15

1. Skin	0781
2. Cheeks	1755
3. Dress & Hat	2905
4. Dress Shading	3114
5. Hat & Collar	0015
6. Bristles	0941
7. Pumpkin, Hat, & Boots	1114
8. Black Outlines & Facial Features	0020
9. Moons	0703
10. Hair	0622
11. Hair & Bristles	0822
12. Broomstick & Bands	1332
13. Bristle Band	0112

80012-16

1. Broomstick	1332
2. Skin	0781
3. Cheeks	1755
4. Hair	0703
5. Pumpkins & Hat	1114
6. Skin	0781
7. Dress & Hat	2830
8. Dress Shading	2920
9. Stems & Bristles	0941
10. Bristles & Hair	0822
11. Design Details	0020
12. Knots	2905
13. Moon	0622
14. Bristle Band	0112

80012-17

1. Broom Handle	2830
2. Handle Stripes	2905
3. Ghost	0101
4. Ghost Shading	0170
5. Ghost Outlines	0112
6. Bristles	0941
7. Bristles Highlights	0822
8. Orange Details	1114
9. Black Details	0020
10. Chain	0703
11. Bristle Band	0112
12. Star	0622

80012-18 Tufted Satins Appliqué

1. Boots	2830
2. Pants Placement Stitch	0015
3. Pants Tackdown	4174
4. Black Outlines on Shoes & Pants & Checks on Pants	0020
5. Green Face & Hands	5833
6. Dark Green Shading on Neck & Facial Features	5944
7. Shirt Placement Stitch	0015
8. Shirt Tackdown & Patch	1300
9. Shirt Outlines & Spirals	1334
10. Patch	2905
11. Eyes	0015
12. Grey Hair, Eyes, Bolts, & Linework on Shirt & Patch	4174
13. Tufted Hair	0020

80012-19

1. Bones	0182
2. Face	4174

80012-20 Appliqué

1. Tombstone Placement Stitch	0015
2. Tombstone Tackdown	1172
3. Brown Crosshatching	0776
4. Tan Cover Stitch	0941
5. Black Tombstone Outlines & Cracks	0020
6. Orange Letters	1114
7. Bat	2905
8. Bat & Boo Design Outlines	0020

80012-21 Appliqué

1. Tombstone Placement Stitch	0015
2. Tombstone Tackdown	1172
3. Brown Crosshatching	0776
4. Tan Cover Stitch	0941
5. Design Outlines & Letters	0020

80012-22 Appliqué

1. Tombstone Placement Stitch	0015
2. Tombstone Tackdown	1172
3. Wood Grain	0842
4. Tombstone Border	0941
5. Letters	2905
6. Design Outlines	0020

It is a violation of Copyright law to make and distribute copies of software or artwork.

Software is licensed to the original purchaser for use at one location. ©Debbie Mumm for use in Home Embroidery. All Rights Reserved.



Cats, Bats & Bones

by Debbie Mumm / #80012 / 28 Designs

Listings below indicate color sample, stitching order and suggested thread color number. Most numbers indicate Isacord thread. However, colors beginning with 20501 refer to YLI Fine Metallics, 7 refer to Yenmet Metallic, 8 refer to YLI Variations Variegated Thread and 9 refer to Isacord Multicolor Variegated.

80012-23

1. Hole.....	1776
2. Trunk.....	1876
3. Branches & Details.....	1565
4. Dark Details.....	1776

80012-24 Appliqué

1. House Placement Stitch.....	0015
2. House Tackdown.....	1114
3. Orange Checkers.....	1114
4. House Outline.....	0020
5. Base of House.....	2905
6. Broom Bristles.....	0622
7. Bristle Shading.....	0822
8. Spider, Broom Handle, & Roof.....	4174
9. Spider Highlights.....	0138
10. Bats & Broom.....	2830
11. Holds, Outlines on Broom, Spider, Bats, & Spiderweb.....	0020

80012-25 Appliqué

1. House Placement Stitch.....	0015
2. House Tackdown.....	4174
3. Roof & Skull Hole.....	2905
4. Skull Hole & Bones.....	0182
5. Steps.....	0870
6. Base.....	0822
7. Outlines on Base, Steps, Skull Hole, Stripes on Base, & Shading under Roof.....	0020
8. Steps & Bones Shading.....	0672
9. Shutter Placement Stitch.....	0020
10. Shutter Tackdown.....	1114
11. Shutter Linework.....	0941
12. Hole Shading.....	3536
13. Shutter Highlights.....	1362

80012-26 Appliqué Jumbo

1. House Placement Stitch.....	0015
2. House Tackdown.....	2830
3. Black in Windows.....	0020
4. House Sides.....	2905
5. Orange on House & Windows.....	1114
6. Shutters.....	0112
7. Moon Placement Stitch.....	0015
8. Moon Tackdown.....	0822
9. House & Moon Details.....	0020
10. Bird Placement Stitch.....	4174
11. Bird Tackdown.....	4174
12. Ledges & Bird Eye Linework.....	3150
13. Bird Wing, Ledge Shading, & Smoke.....	0112
14. Beak.....	0622

80012-27 Appliqué Jumbo

1. Moon Placement Stitch.....	0015
2. Moon Tackdown.....	0822
3. House Placement Stitch.....	0015
4. House Tackdown.....	4174
5. House Stripes.....	0020
6. Crescent Moon.....	0622
7. Pumpkin, Roofs, & Top of Chimney.....	1114
8. Pumpkin Stem.....	5833
9. Ghost.....	0015
10. Ghost Shading.....	0170
11. Base.....	2905
12. Holes, Shading Under Roofs, Bat Spring, Chimney, & Outlines on Ghost, Pumpkin, Roofs, & Crescent.....	0020
13. Bat & Spider.....	2830
14. Bat & Spider Outlines.....	0020

80012-28

1. Black Center Loopy Linework.....	0020
2. Pumpkins.....	1114
3. Stems.....	5833
4. Design Outlines.....	0020

Note: Appliqué fabric not included.

General Tufted Satin Embroidery Instructions

1. Lay embroidered design flat.
2. Refer to the *Tufted Satin Guide* to determine which satins are to be cut.
3. With a craft knife, lightly slice through the satins. You may need to repeat slicing the satins until you have achieved the desired look while being careful not to cut the fabric.

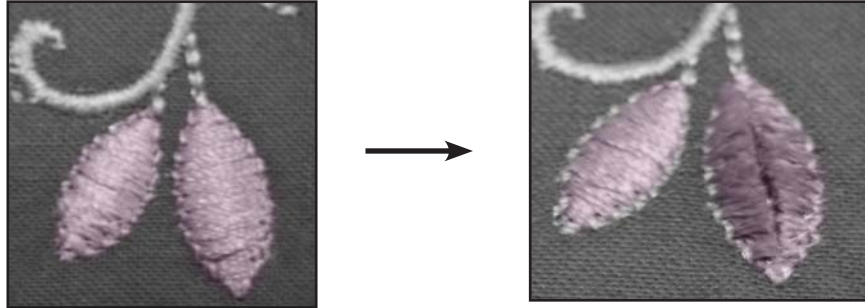

Tufted Satin Guide

Solid pink areas denote tufted satin cut areas.

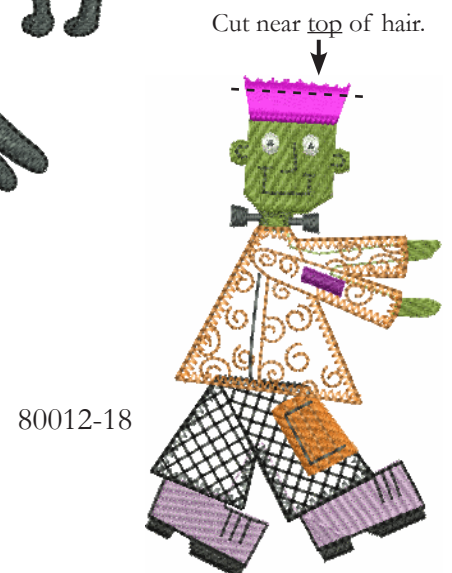
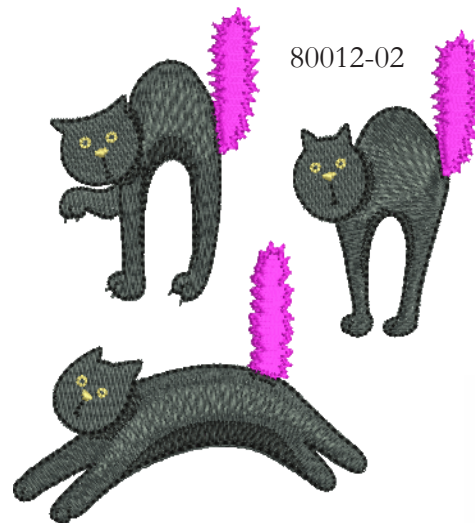

Pre-cut Appliqué Instructions

1. Print out the necessary pages from the PDF of the appliqué pattern(s).
2. Mark the right side of the pattern pieces so you'll know which direction to lay the pattern on the fabric.
3. Lightly spray the wrong side of the pattern pieces with temporary adhesive spray and allow it to set for a few minutes.
4. Place the pattern pieces on the right side of the fabric and carefully cut them out. **PHOTO 1**
5. Sew the placement stitch on your hooped fabric. **PHOTO 2**
6. With the paper still stuck to the right side of the appliqué fabric, spray the wrong side of the fabric with temporary spray adhesive.
7. Place the fabric inside the sewing placement stitch so that it matches the stitching line then remove the paper pattern. **PHOTO 3**
8. Sew the tackdown. **PHOTO 4**
9. Sew the remainder of the design and repeat for any remaining pieces. **PHOTO 5**

NOTE: The patterns are sized for the designs as they were made. If you resize the design, you will need to resize the pattern the same amount. You can print out the pattern at the normal size then copy it on a copy machine at the changed size, i.e. resize the designs to 80%, resize the printed pattern to 80%.

TIP: When Printing the patterns, make sure that the “Fit to page” option is **UNCHECKED** in the Print Dialog Box. If this option is checked the printed patterns will not be actual size.

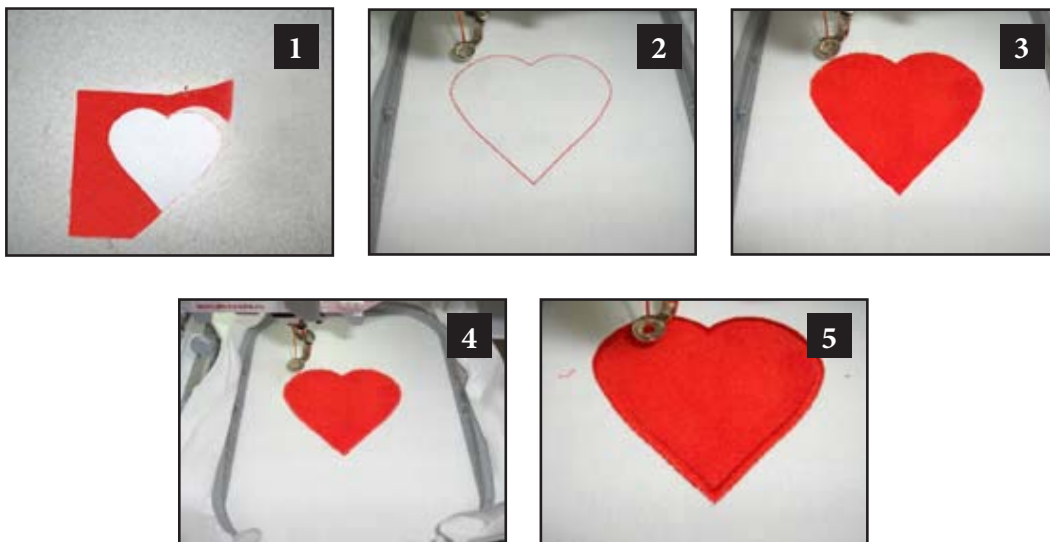

Note: Some appliqué edges in this collection are covered with stitches that may not completely cover the fabric edges. This is done intentionally to create the beautiful end result.

ATTENTION

When printing this document, any page scaling or page fitting options in your print dialog box must be turned OFF or set to NONE so that your files will print out at their actual size. Images not printed at actual size will not function as intended.

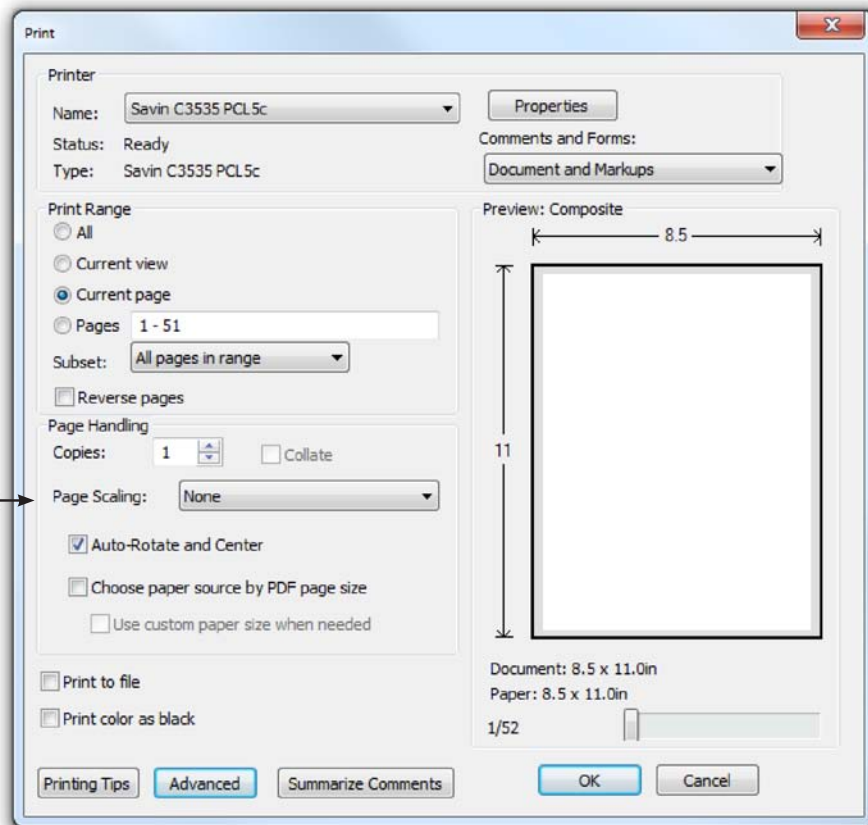

TO SAVE PAPER

Only print the desired image by navigating to the image's page, go to File > Print and select "Current page" in the print dialog box. Repeat for each desired image.

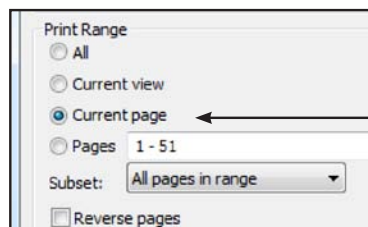

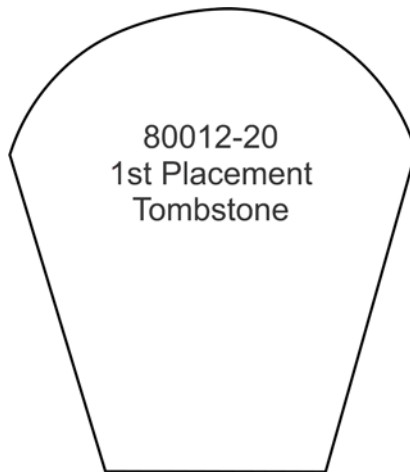
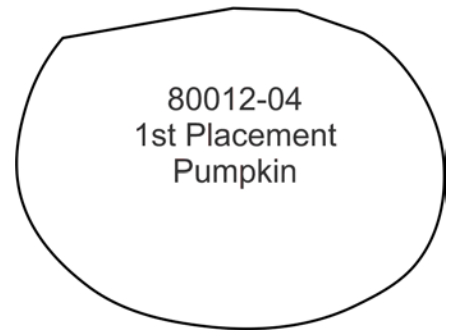
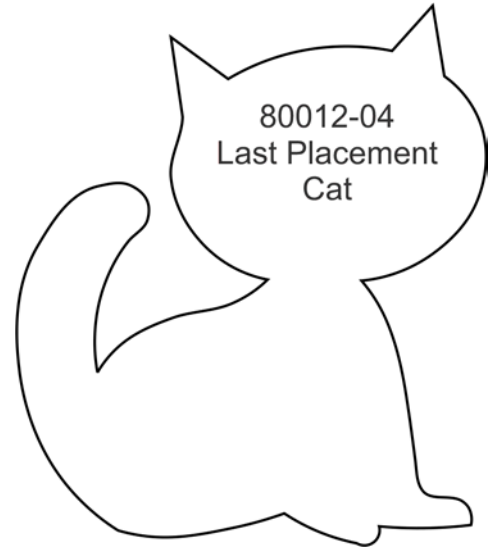
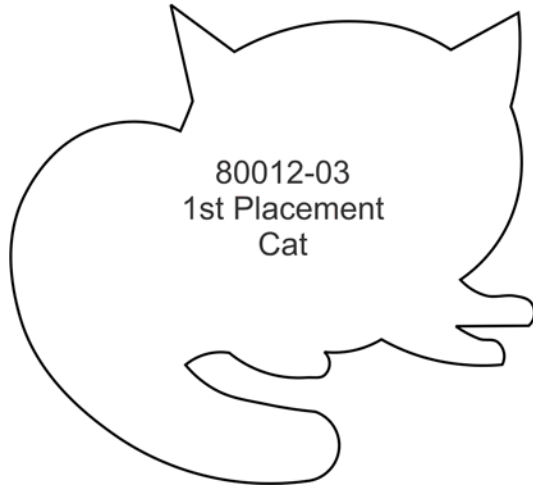
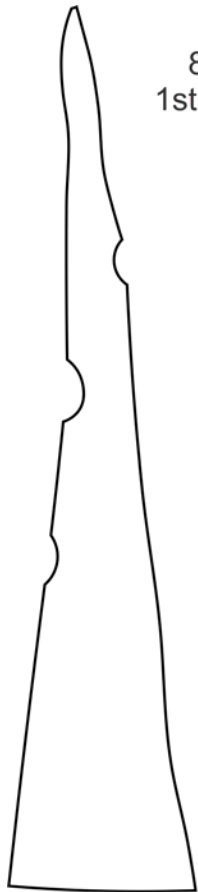

80012-18
Last Placement
Shirt

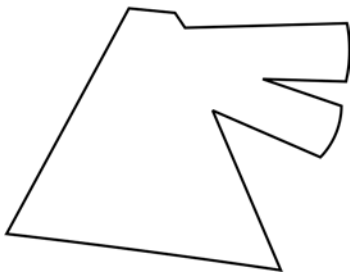

80012-18
1st Placement
Pants

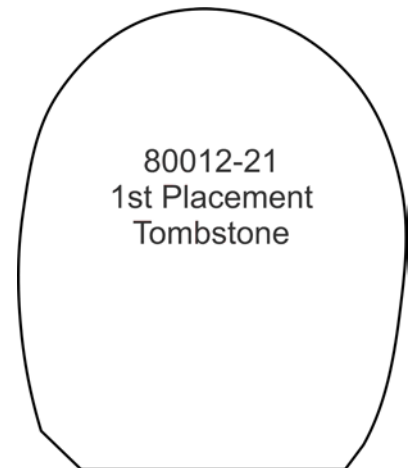
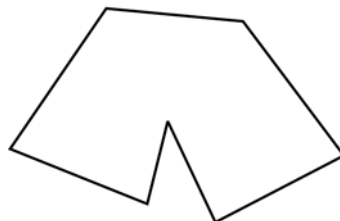

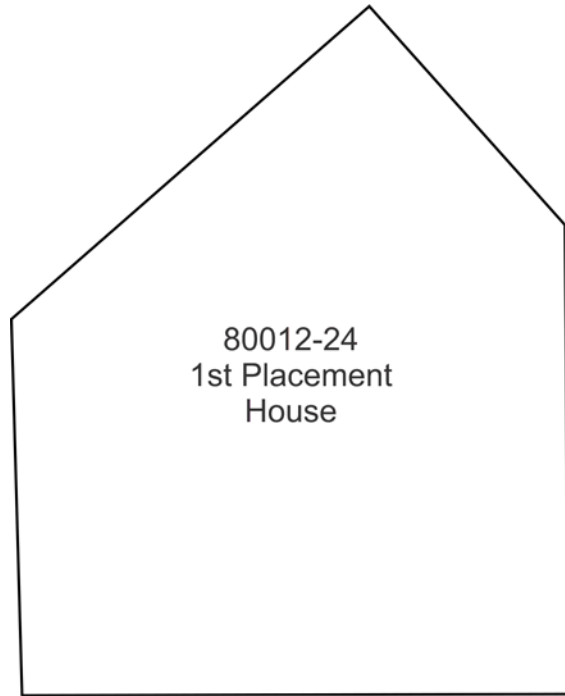
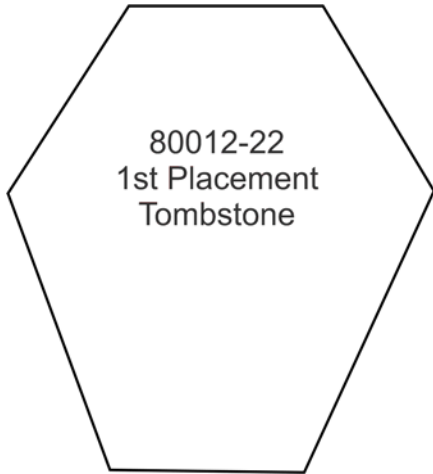

80012-25
Last Placement
Left Shutter

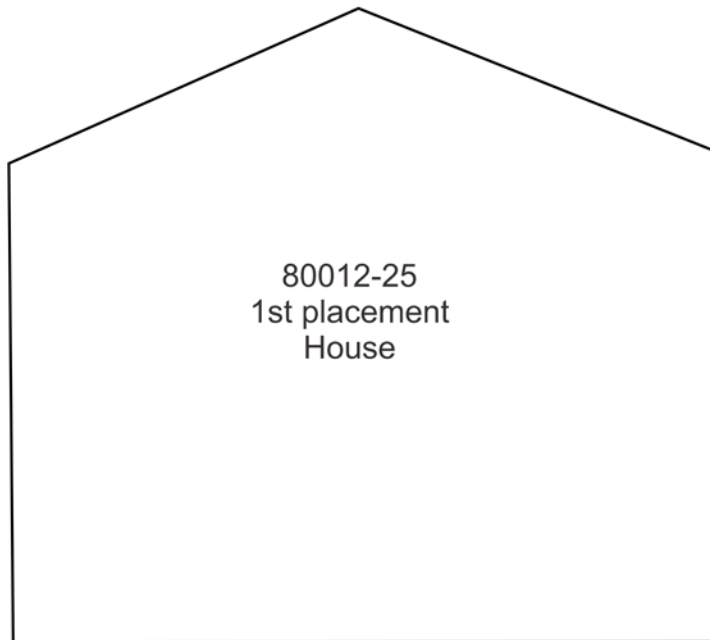
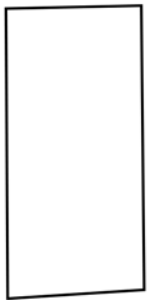

80012-25
Last Placement
Right Shutter



