

Note: Some designs in this collection may have been created using unique special stitches and/or techniques. To preserve design integrity when rescaling or rotating designs in your software, always rescale or rotate designs using the handles directly on-screen.



80014-01 Tufted
2.05 X 2.05 in.
52.07 X 52.07 mm
4,796 St.



80014-02 Tufted
2.24 X 2.24 in.
56.90 X 56.90 mm
4,609 St.



80014-03
1.58 X 1.85 in.
40.13 X 46.99 mm
2,857 St.



80014-04
1.77 X 1.70 in.
44.96 X 43.18 mm
2,481 St.



80014-05
1.79 X 1.54 in.
45.47 X 39.12 mm
2,653 St.



80014-06
1.66 X 1.67 in.
42.16 X 42.42 mm
2,483 St.



80014-07
2.66 X 2.08 in.
67.56 X 52.83 mm
6,355 St.



80014-08
1.72 X 2.19 in.
43.69 X 55.63 mm
5,646 St.



80014-09
1.40 X 2.02 in.
35.56 X 51.31 mm
5,217 St. **S**

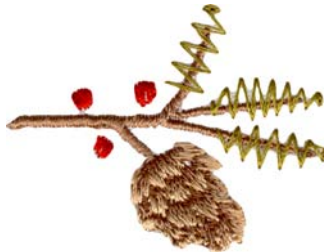

80014-10
1.64 X 1.29 in.
41.66 X 32.77 mm
1,339 St. **S**



80014-11
.63 X .98 in.
16.00 X 24.89 mm
1,175 St. **S**



80014-12
1.99 X .89 in.
50.55 X 22.61 mm
1,749 St. **S**

⌘ Design contains a loose fill.
⚙ Some white areas shown are not stitched.

L Design is larger than 5" (127 mm) in either direction.
S Design is smaller than 1.5" (38.1 mm) in either direction.

Note: Some designs in this collection may have been created using unique special stitches and/or techniques. To preserve design integrity when rescaling or rotating designs in your software, always rescale or rotate designs using the handles directly on-screen.



80014-13 Appliqué
2.76 X 2.87 in.
70.10 X 72.90 mm
6,032 St.



80014-14 Appliqué
3.48 X 2.99 in.
88.39 X 75.95 mm
6,327 St.



80014-15 Appliqué
3.53 X 3.06 in.
89.66 X 77.72 mm
7,104 St.



80014-16
4.13 X 6.86 in.
104.90 X 174.24 mm
28,420 St. **L**



80014-17 Appliqué
4.87 X 4.87 in.
123.70 X 123.70 mm
15,666 St.



80014-18 Tufted Appliqué
2.14 X 3.49 in.
54.36 X 88.65 mm
4,157 St.



80014-19 Appliqué
3.03 X 3.50 in.
76.96 X 88.90 mm
3,223 St.



80014-20
2.00 X 3.50 in.
50.80 X 88.90 mm
3,074 St.



80014-21
2.64 X 2.98 in.
67.06 X 75.69 mm
5,984 St.



80014-22
2.08 X 3.00 in.
52.83 X 76.20 mm
6,891 St.

⌘ Design contains a loose fill.
⚙ Some white areas shown are not stitched.

L Design is larger than 5" (127 mm) in either direction.
S Design is smaller than 1.5" (38.1 mm) in either direction.

Note: Some designs in this collection may have been created using unique special stitches and/or techniques. To preserve design integrity when rescaling or rotating designs in your software, always rescale or rotate designs using the handles directly on-screen.



80014-23
2.07 X 2.98 in.
52.58 X 75.69 mm
5,872 St.



80014-24
.62 X 3.01 in.
15.75 X 76.45 mm
2,504 St. **S**



80014-25
2.71 X 2.97 in.
68.83 X 75.44 mm
8,311 St.



80014-26
4.39 X 1.00 in.
111.51 X 25.40 mm
1,184 St. **S**

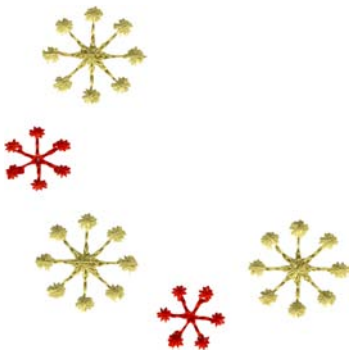

80014-27
2.50 X 2.50 in.
63.50 X 63.50 mm
1,038 St.



80014-28
.76 X .76 in.
19.30 X 19.30 mm
333 St. **S**



80014-29
.51 X .51 in.
12.95 X 12.95 mm
138 St. **S**



80014-30
4.67 X 1.29 in.
118.62 X 32.77 mm
3,469 St. **S**

⌘ Design contains a loose fill.
⚙ Some white areas shown are not stitched.

L Design is larger than 5" (127 mm) in either direction.
S Design is smaller than 1.5" (38.1 mm) in either direction.



Christmas Joy

by Debbie Mumm / #80014 / 30 Designs

Listings below indicate color sample, stitching order and suggested thread color number. Most numbers indicate Isacord thread. However, colors beginning with 20501 refer to YLI Fine Metallics, 7 refer to Yenmet Metallic, 8 refer to YLI Variations Variegated Thread and 9 refer to Isacord Multicolor Variegated.

80014-01 Tufted

1. Light Blue Petals	3963
2. Light Green Leaves	0352
3. Dark Green Stamen	6133

80014-02 Tufted

1. Red Petals	1904
2. Dark Green Linework	6133
3. Light Green Stamen	0352

80014-03

1. Red Body	1904
2. Dark Red Outlines	1911
3. Black Face & Legs	4174
4. Beak	1141
5. Light Green Eye Details	0352
6. Black Eye Details	4174

80014-04

1. Light Blue Body	3750
2. Grey Outlines	0142
3. Beak	1141
4. Black Face & Legs	4174
5. Green Eye Details	0352
6. Black Eye Details	4174

80014-05

1. Light Green Body	0352
2. Dark Green Outlines	6133
3. Beak	1141
4. Black Face & Legs	4174
5. Light Blue Eye	3963
6. Black Eye Details	4174

80014-06

1. Brown Body	0853
2. Dark Brown Outlines	1055
3. Beak	1141
4. Black Face & Legs	4174
5. Light Blue Eye Details	3963
6. Black Eye Details	4174

80014-07

1. Hole	4174
2. House	0853
3. House Outlines	1055
4. Base & Roof	6133
5. Roof Details	0761
6. Wreath	0352
7. Bow	1904

80014-08

1. Hole	4174
2. House	1904
3. House Outlines	1911
4. Ring at Top of House	0853
5. Border Around Hole	0761
6. Dots	0015
7. Roof	0352
8. Dark Green Roof Stripes	6133

80014-09

1. Hole	4174
2. White House	0015
3. Green House Stripes	6133
4. Roof & Border Around Hole	1141
5. Roof Outlines	0853
6. Holly Leaves	6133
7. Candy Cane White Stripes	0015
8. Holly Berries & Candy Cane Red Stripes	1904

80014-10

1. Pine Cone	1055
2. Branch & Pine Cone	0853
3. Pine Cone Shading	1141
4. Leaves	6133
5. Berries	1904

80014-11

1. Branch	0853
2. Leaves	6133
3. Berries	1904

80014-12

1. Leaves	6133
2. Berries	1904

80014-13 Appliqué

1. Outer Body Placement Stitch	0015
2. Outer Body Tackdown, Shading, & Wings	0853
3. Inner Body Placement Stitch	1141
4. Inner Body Tackdown & Breast Feathers	1055
5. Eyes Placement Stitch	0853
6. Eyes Tackdown & Shading	0853
7. Feet, Beak, & Black in Eyes	4174
8. Hat	1904
9. White Eye Details & Hat Stripes & Trim	0015

80014-14 Appliqué

1. Outer Body Placement Stitch	0015
2. Outer Body Tackdown	0352
3. Inner Body Placement Stitch	0352
4. Inner Body Tackdown & Breast Feathers	1055
5. Eyes Placement Stitch	0853
6. Eyes Tackdown	0853
7. Green Eye Details	0352
8. Black in Eyes & Beak	4174
9. White Eye Details	0015
10. Wings	6133
11. Leaves	6133
12. Branch	0853
13. Berries	1904

80014-15 Appliqué

1. Branch	0352
2. Body Placement Stitch	0015
3. Body Tackdown, Wings, & Top of Head	1055
4. Cream Checks on Scarf & Top of Head Outlines	0761
5. Red Checks on Scarf	1904
6. Green Checks on Scarf	0352
7. Pale Blue Checks on Scarf	3963
8. Brown Checks & Fringe on Scarf	0853
9. Eye Placement Stitch	0853
10. Eye Tackdown	0853
11. Pale Blue Eyes	3963
12. Dark Grey Linework in Eyes	0152
13. White In Eyes	0015
14. Black in Eyes	4174

80014-16

1. Light Tan Around Eyes	0761
2. Light Brown Faces & Bodies	1141
3. Red Ornaments	1904
4. Pine Needles	6133
5. Brown Eye Outlines, Outer Bodies, & Branch	0853
6. Owl Outlines	1055
7. Green Eyes	0352
8. Green on Scarves & Ornament	0352
9. Outline Green Ornament	6133
10. Outline Red Ornaments	1911
11. Silver Ornament Toppers	0142
12. Ornament Hooks	0152
13. Red on Scarves	1904
14. White Stripes on Scarf & Right Owl Eyes	3963
15. Black in Eyes & Beaks	4174
16. White Scarf Dots & Eyes Highlights	0015

80014-17 Appliqué

1. Wreath Placement Stitch	0015
2. Wreath Tackdown	0352
3. Dark Leaves	6133
4. Owl Placement Stitch	0015
5. Owl Tackdown, Breast Feathers, & Branches	0853
6. Beak, Wings, & Feet	1055
7. Hat Placement Stitch	0015
8. Hat Tackdown, Berries, & Scarf	1904
9. Eye Placement Stitch	1141
10. Eye Tackdown & Hat Trim	0853
11. Green Eyes	0352
12. Black in Eyes	4174
13. White Dots on Hat, Hat Trim & Highlights in Eyes	0015

80014-18 Tufted Appliqué

1. Placement Stitch	0015
2. Tackdown	3963
3. Leaves	0352
4. Berries	1904
5. Trunk	0853

80014-19 Appliqué

1. Trunk	0853
2. Placement Stitch	0015
3. Tackdown	3963
4. Light Blue Spots	3963
5. Dark Green Stripes	6133

80014-20

1. Light Green Branches	0352
2. Dark Green Branches	6133
3. Trunk	0853
4. Star	1904

80014-21

1. Red Ornament	1904
2. Ornament Outlines	1911
3. Silver Loop at Top	0152
4. Green Cap At Top	0352
5. Cap Outlines	6133
6. Gold Rays on Star	0761
7. White on Star & Dots	0015

80014-22

1. Light Green Ornament	0352
2. Bulb Outlines	6133
3. Silver Loop at Top	0152
4. Red Design on Ornament	1904
5. Outlines on Red	1911
6. White Design on Ornament	0015

It is a violation of Copyright law to make and distribute copies of software or artwork.

Software is licensed to the original purchaser for use at one location. ©Debbie Mumm for use in Home Embroidery. All Rights Reserved.

Listings below indicate color sample, stitching order and suggested thread color number. Most numbers indicate Isacord thread. However, colors beginning with 20501 refer to YLI Fine Metallics, 7 refer to Yenmet Metallic, 8 refer to YLI Variations Variegated Thread and 9 refer to Isacord Multicolor Variegated.

80014-23

■ 1. Red Ornament	1904
■ 2. Ornament Outlines	1911
■ 3. Silver Loop at Top	0152
■ 4. Green Cap & Designs on Ornament	6133
□ 5. White Designs on Ornament	0015

80014-24

■ 1. Light Green on Ornament	0352
□ 2. White Zigzags on Ornament	0015
■ 3. Silver Loop at Top	0152
■ 4. Red Zigzags & Cap on Ornament	1904
■ 5. Outlines on Cap	1911
■ 6. Outlines on Ornament	6133

80014-25

■ 1. Red Ornament	1904
■ 2. Silver Loop at Top	0152
■ 3. Ornament Outlines	1911
■ 4. Leaves & Cap on Ornament	6133
□ 5. Berries	0015

80014-26

■ 1. Red Stars	1904
■ 2. Green Stars	0352

80014-27

■ 1. Green Stars	0352
■ 2. Red Stars	1904

80014-28

■ 1. Single Color Design	0352
--------------------------------	------

80014-29

■ 1. Single Color Design	1904
--------------------------------	------

80014-30

■ 1. Dark Green Details	6133
□ 2. White Details	0015

Note: Appliqué fabric not included. Some appliqué edges in this collection are covered with stitches that may not completely cover the fabric edges. This is done intentionally to create the beautiful end result.

General Tufted Satin Embroidery Instructions

1. Lay embroidered design flat.
2. Refer to the *Tufted Satin Guide* to determine which satins are to be cut.
3. With a craft knife, lightly slice through the satins. You may need to repeat slicing the satins until you have achieved the desired look while being careful not to cut the fabric.

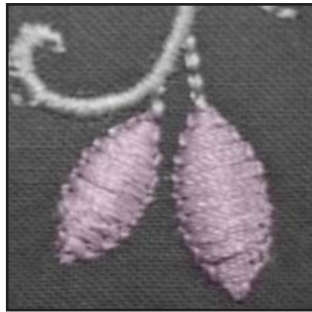

Tufted Satin Guide

Solid pink areas denote tufted satin cut areas.

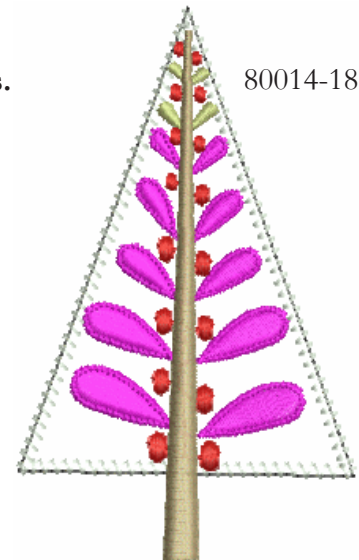
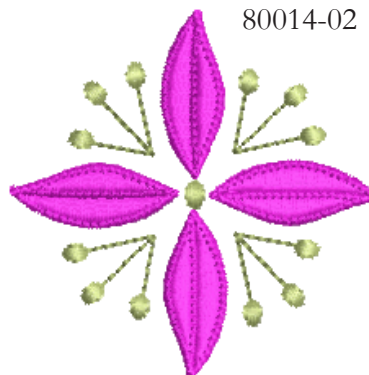

Pre-cut Appliqué Instructions

1. Print out the necessary pages from the PDF of the appliqué pattern(s).
2. Mark the right side of the pattern pieces so you'll know which direction to lay the pattern on the fabric.
3. Lightly spray the wrong side of the pattern pieces with temporary adhesive spray and allow it to set for a few minutes.
4. Place the pattern pieces on the right side of the fabric and carefully cut them out. **PHOTO 1**
5. Sew the placement stitch on your hooped fabric. **PHOTO 2**
6. With the paper still stuck to the right side of the appliqué fabric, spray the wrong side of the fabric with temporary spray adhesive.
7. Place the fabric inside the sewing placement stitch so that it matches the stitching line then remove the paper pattern. **PHOTO 3**
8. Sew the tackdown. **PHOTO 4**
9. Sew the remainder of the design and repeat for any remaining pieces. **PHOTO 5**

NOTE: The patterns are sized for the designs as they were made. If you resize the design, you will need to resize the pattern the same amount. You can print out the pattern at the normal size then copy it on a copy machine at the changed size, i.e. resize the designs to 80%, resize the printed pattern to 80%.

TIP: When Printing the patterns, make sure that the "Fit to page" option is **UNCHECKED** in the Print Dialog Box. If this option is checked the printed patterns will not be actual size.

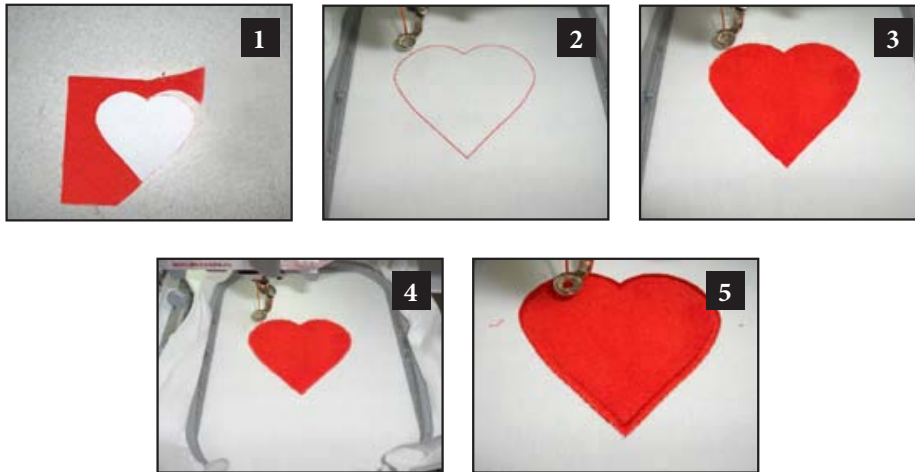

ATTENTION

When printing this document, any page scaling or page fitting options in your print dialog box must be turned OFF or set to NONE so that your files will print out at their actual size. Images not printed at actual size will not function as intended.

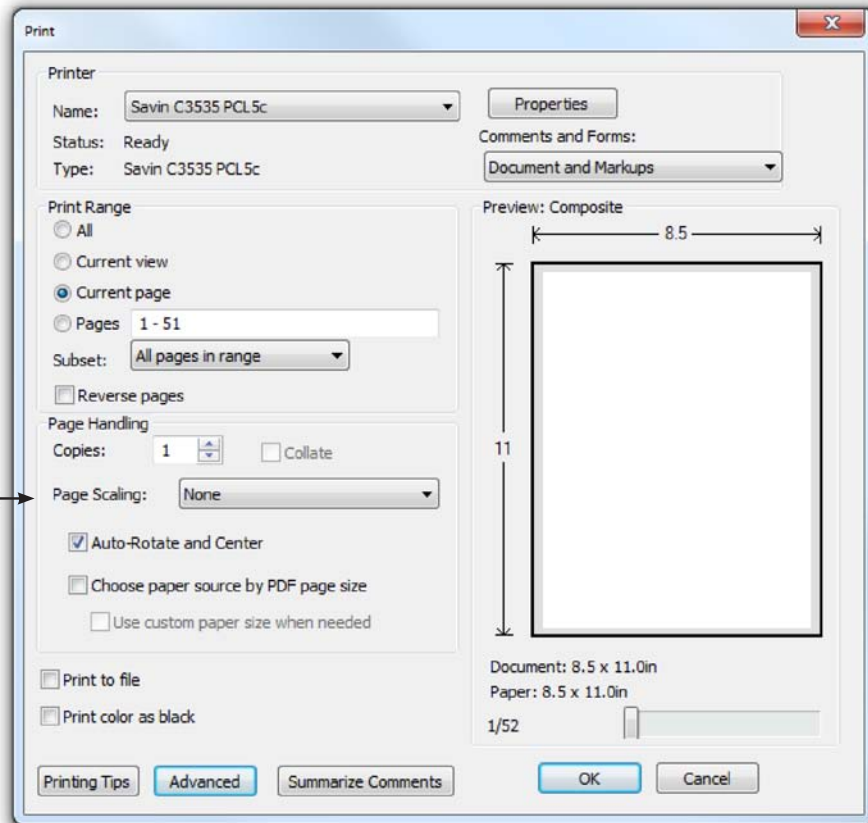

TO SAVE PAPER

Only print the desired image by navigating to the image's page, go to File > Print and select "Current page" in the print dialog box. Repeat for each desired image.

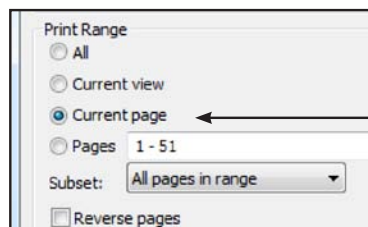

80014-13
Last Placement
Left & Right Eyes

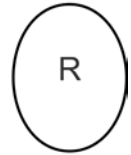
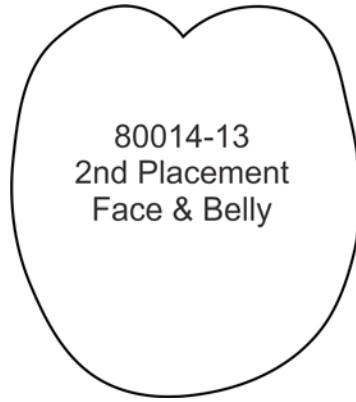
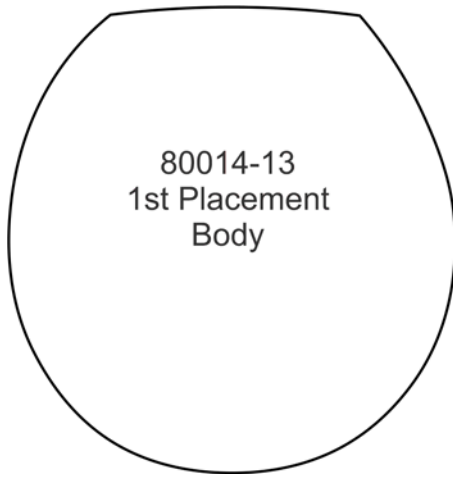

80014-14
Last Placement
Left & Right Eyes

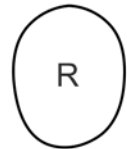
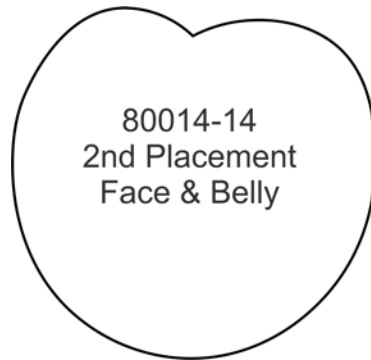
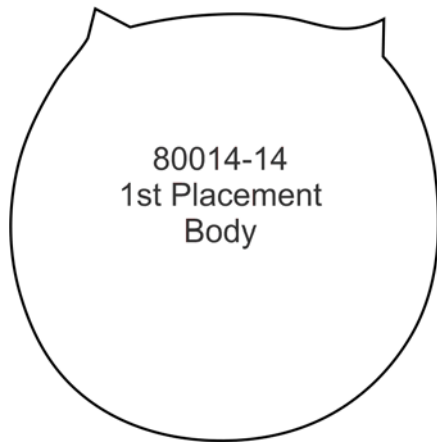

80014-15
Last Placement
Left & Right Eyes

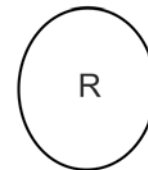
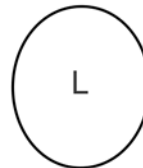
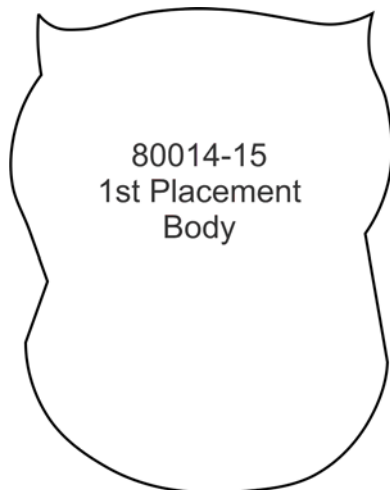

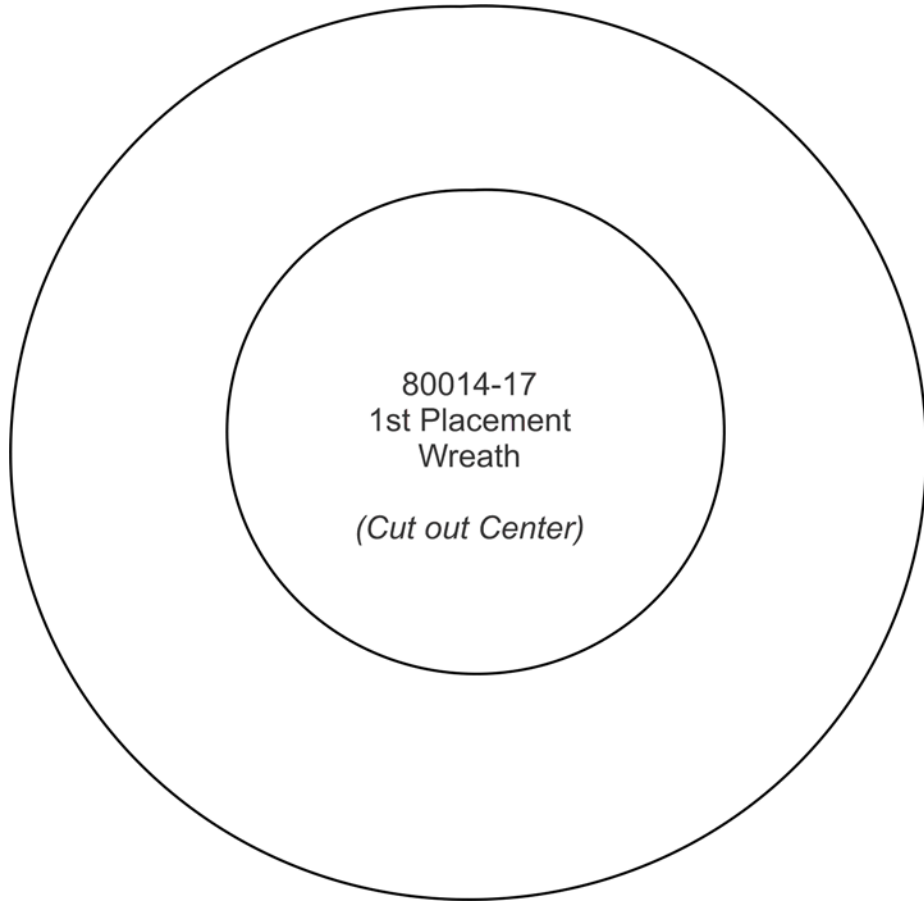

80014-17
3rd Placement
Hat

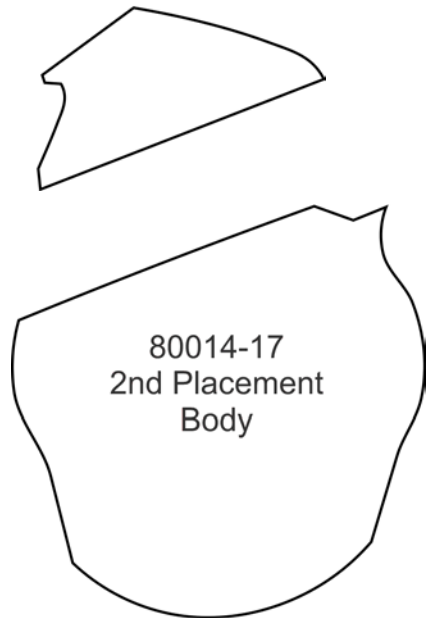

80014-17
Last Placement
Left & Right Eyes

