

Note: Some designs in this collection may have been created using unique special stitches and/or techniques. To preserve design integrity when rescaling or rotating designs in your software, always rescale or rotate designs using the handles directly on-screen.



80026-01 Scottie
2.46 X 2.51 in.
62.48 X 63.75 mm
8,554 St.



80026-02 Mastiff
3.49 X 2.92 in.
88.65 X 74.17 mm
11,585 St. ✪

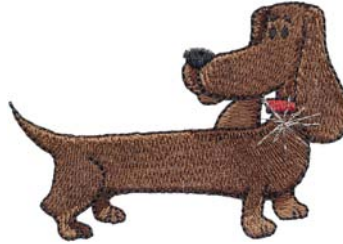

80026-03 Dachshund
3.00 X 2.14 in.
76.20 X 54.36 mm
6,556 St. ✪



80026-04 Puli
3.00 X 2.15 in.
76.20 X 54.61 mm
9,407 St.



80026-05 Westie
2.22 X 2.53 in.
56.39 X 64.26 mm
8,261 St.



80026-06 Beagle
2.50 X 2.24 in.
63.50 X 56.90 mm
6,618 St.



80026-07 Dalmatian
2.10 X 3.01 in.
53.34 X 76.45 mm
10,367 St.



80026-08 Pomeranian
2.50 X 2.40 in.
63.50 X 60.96 mm
8,524 St.



80026-09 Collie
3.00 X 2.10 in.
76.20 X 53.34 mm
9,675 St.



80026-10 Yorkie
2.50 X 2.48 in.
63.50 X 62.99 mm
10,646 St.



80026-11 Poodle
2.67 X 3.00 in.
67.82 X 76.20 mm
10,558 St.

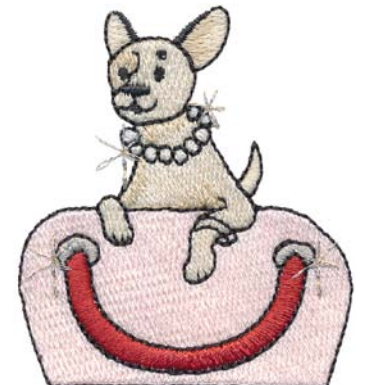

80026-12 Chihuahua in Purse
2.12 X 2.49 in.
53.85 X 63.25 mm
6,587 St.

✪ Design contains a loose fill.
✪ Some white areas shown are not stitched.

L Design is larger than 5" (127 mm) in either direction.
S Design is smaller than 1.5" (38.1 mm) in either direction.

Note: Some designs in this collection may have been created using unique special stitches and/or techniques. To preserve design integrity when rescaling or rotating designs in your software, always rescale or rotate designs using the handles directly on-screen.

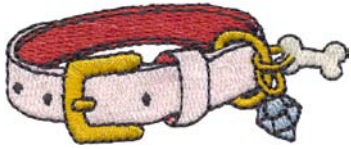

80026-13 Collar
2.47 X 1.03 in.
62.74 X 26.16 mm
4,345 St. ⚡ S



80026-14 Food Bowl Crest Appliqué
4.49 X 3.11 in.
114.05 X 78.99 mm
7,688 St. ⚡



80026-15 Silhouette Crest Appliqué
2.66 X 4.01 in.
67.56 X 101.85 mm
7,092 St. ⚡



80026-16 Bone Appliqué
4.03 X 2.26 in.
102.36 X 57.40 mm
565 St.



80026-17 Paw Print Appliqué
3.25 X 3.26 in.
82.55 X 82.80 mm
3,773 St.



80026-18 Paw Prints
1.41 X 3.70 in.
35.81 X 93.98 mm
2,349 St. S

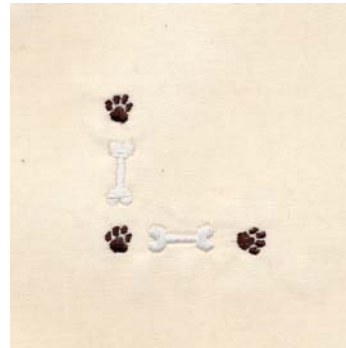

80026-19 Bones & Prints Corner
1.56 X 1.56 in.
39.62 X 39.62 mm
834 St. ⚡

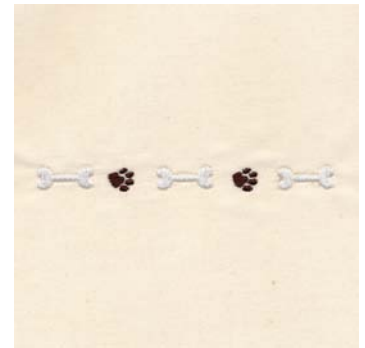

80026-20 Bones & Prints Border
3.34 X .30 in.
84.84 X 7.62 mm
854 St. ⚡ S

⚡ Design contains a loose fill.
⚡ Some white areas shown are not stitched.

L Design is larger than 5" (127 mm) in either direction.
S Design is smaller than 1.5" (38.1 mm) in either direction.



Privileged Pups

by Benartex Studios / #80026 / 20 Designs

Listings below indicate color sample, stitching order and suggested thread color number. "I" refers to Isacord Thread and "T" refers to Timeless. Colors beginning with 20501 refer to YLI Fine Metallics, 7 refer to Yenmet Metallic, 8 refer to YLI Variations Variegated Thread and 9 refer to Isacord Multicolor Variegated.

	I	T		I	T		I	T
80026-01 Scottie			80026-08 Pomeranian			80026-14 Food Bowl Crest Appliqué		
■ 1. Fur	0111	28139	■ 1. Feet	0861	20100	■ 1. Oval Placement Stitch	0870	20148
■ 2. Medium Fur Shading	0132	28145	■ 2. Fur	0870	20148	■ 2. Oval Tackdown	0870	20148
■ 3. Dark Fur Shading	4174	28148	■ 3. Tongue	2171	10100	■ 3. Dark Leash	0861	20100
■ 4. Fur Outlines, Eyes, & Nose	0020	28151	■ 4. Light Fur Shading	0015	28154	■ 4. Light Leash	0761	20103
□ 5. White Eye Shading	0015	28154	■ 5. Medium Fur Shading	0761	20103	■ 5. Leash Hardware	0124	28163
□ 6. Collar	0015	28154	■ 6. Bow	1725	12106	■ 6. Oval Cover Stitch	0853	26115
■ 7. Collar Shading	1725	12106	■ 7. Design Outlines	4174	28148	■ 7. Bows	4073	28101
■ 8. Collar Outlines	0020	28151				□ 8. Jewels	0015	28154
						□ 9. Bones	0015	28154
80026-02 Mastiff			80026-09 Collie			80026-15 Silhouette Crest Appliqué		
■ 1. Fur	0870	20148	■ 1. Light Fur Shading	0870	20148	□ 1. Bones	0015	28154
■ 2. Dark Fur Shading	0776	28175	■ 2. Light Brown Shading	0776	28175	■ 2. Background Placement Stitch	0870	20148
■ 3. Medium Fur Shading	0861	20100	■ 3. Medium Fur Shading	0761	20103	■ 3. Background Tackdown	1172	20109
■ 4. Light Fur Shading	0761	20103	□ 4. White Shading & Paws	0015	28154	■ 4. Design Outlines	4174	28148
■ 5. Bandana	0704	22118	■ 5. Brown Fur	1055	26151	■ 5. Silhouette	0020	28151
■ 6. Bandana Outlines	0020	28151	■ 6. Dark Brown Fur Shading	1876	26157			
■ 7. Dog Outlines	4174	28148	■ 7. Design Outlines	4174	28148			
			■ 8. Tag	0704	22118			
			■ 9. Tag Chain Outlines	0020	28151			
			■ 10. Sparkle	7009				
80026-03 Dachshund			80026-10 Yorkie			80026-16 Bone Appliqué		
■ 1. Fur	1055	26151	□ 1. Fur	0015	28154	■ 1. Bone Placement Stitch	0870	20148
■ 2. Dark Fur Shading	1876	26157	■ 2. Medium Fur Shading	0761	20103	□ 2. Bone Tackdown	0015	28154
■ 3. Light Fur Shading	0853	26115	■ 3. Dark Fur Shading	1161	20104			
■ 4. Collar	1725	12106	■ 4. Bows	1725	12106			
■ 5. Design Outlines	4174	28148	■ 5. Design Outlines	4174	28148			
■ 6. Sparkle	7009							
80026-04 Puli			80026-11 Poodle			80026-17 Paw Print Appliqué		
■ 1. Light Fur Shading	0124	28163	□ 1. Fur	0015	28154	■ 1. Paw Placement Stitch	0870	20148
■ 2. Fur	0111	28139	■ 2. Grey Fur Shading	0124	28163	■ 2. Paw Tackdown	1876	26157
■ 3. Dark Fur Shading	0132	28145	■ 3. Tan Fur Shading	0870	20148	■ 3. Toes	1876	26157
■ 4. Bow	0704	22118	■ 4. Bows	1725	12106			
■ 5. Design Outlines	0020	28151	■ 5. Design Outlines	4174	28148			
80026-05 Westie			80026-12 Chihuahua in Purse			80026-18 Paw Prints		
■ 1. Tongue	2171	10100	■ 1. Purse	2171	10100	■ 1. Single Color Design	1876	26157
□ 2. Fur	0015	28154	■ 2. Purse Hardware	0124	28163			
■ 3. Fur Shading	0124	28163	■ 3. Handle	1725	12106			
■ 4. Design Outlines	4174	28148	■ 4. Dog	0870	20148			
			■ 5. Dog Shading	0761	20103			
80026-06 Beagle			80026-13 Collar			80026-19 Bones & Prints Corner		
■ 1. Medium Brown Spots	1055	26151	■ 1. Inside Collar	1725	12106	□ 1. Bones	0015	28154
■ 2. Ears	1876	26157	■ 2. Collar	2171	10100	■ 2. Paws	1876	26157
■ 3. Light Brown Spots	0853	26115	■ 3. Bone	0870	20148			
□ 4. White Fur	0015	28154	■ 4. Jewel	3750	14112			
■ 5. Grey Fur Shading	0124	28163	■ 5. Design Outlines	4174	28148			
■ 6. Design Outlines	4174	28148	■ 6. Hardware	0704	22118			
■ 7. Collar	3750	14112	■ 7. Hardware Outlines	4174	28148			
■ 8. Sparkles	7009							
80026-07 Dalmatian								
■ 1. Spots	4174	28148						
□ 2. Fur	0015	28154						
■ 3. Fur Shading	0145	14103						
■ 4. Collar	1725	12106						
■ 5. Eyes, Nose, Ears, & Outlines	0020	28151						
■ 6. Sparkle	7009							

1. Print out the necessary pages from the PDF of the appliqué pattern(s).
2. Mark the right side of the pattern pieces so you'll know which direction to lay the pattern on the fabric.
3. Lightly spray the wrong side of the pattern pieces with temporary adhesive spray and allow it to set for a few minutes.
4. Place the pattern pieces on the right side of the fabric and carefully cut them out. **PHOTO 1**
5. Sew the placement stitch on your hooped fabric. **PHOTO 2**
6. With the paper still stuck to the right side of the appliqué fabric, spray the wrong side of the fabric with temporary spray adhesive.
7. Place the fabric inside the sewing placement stitch so that it matches the stitching line, and then remove the paper pattern. **PHOTO 3**
8. Sew the tackdown. **PHOTO 4**
9. Sew the remainder of the design and repeat for any remaining pieces. **PHOTO 5**

NOTE: The patterns are sized for the designs as they were made. If you resize the design, you will need to resize the pattern the same amount. You can print out the pattern at the normal size then copy it on a copy machine at the changed size. For example, resize the designs to 80%, resize the printed pattern to 80%.

TIP: When Printing the patterns, make sure that the “Fit to page” option is UNCHECKED in the Print Dialog Box. If this option is checked the printed patterns will not be actual size.

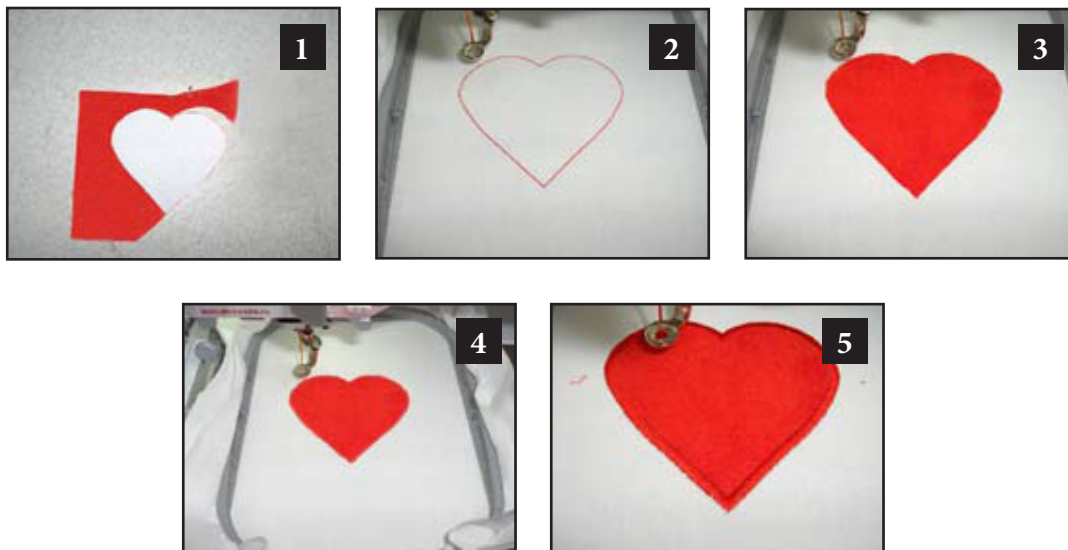

Note: Some of the appliqué pieces in this collection are attached to the design by a looser density stitch rather than the traditional full satin stitch. This means that the edges of the appliqué may begin to fray, creating a more informal and natural look. The collection was created with this effect in mind. If you wish the appliqué pieces to keep a sharper edge, you will need to select the appliqué fabric with this in mind. You may also choose to apply a non-fray treatment to the appliqué fabric before attaching it, or use a sticky backing on the appliqué fabric before cutting out the appliqué pattern piece.

ATTENTION

When printing this document, any page scaling or page fitting options in your print dialog box must be turned OFF or set to NONE so that your files will print out at their actual size. Images not printed at actual size will not function as intended.

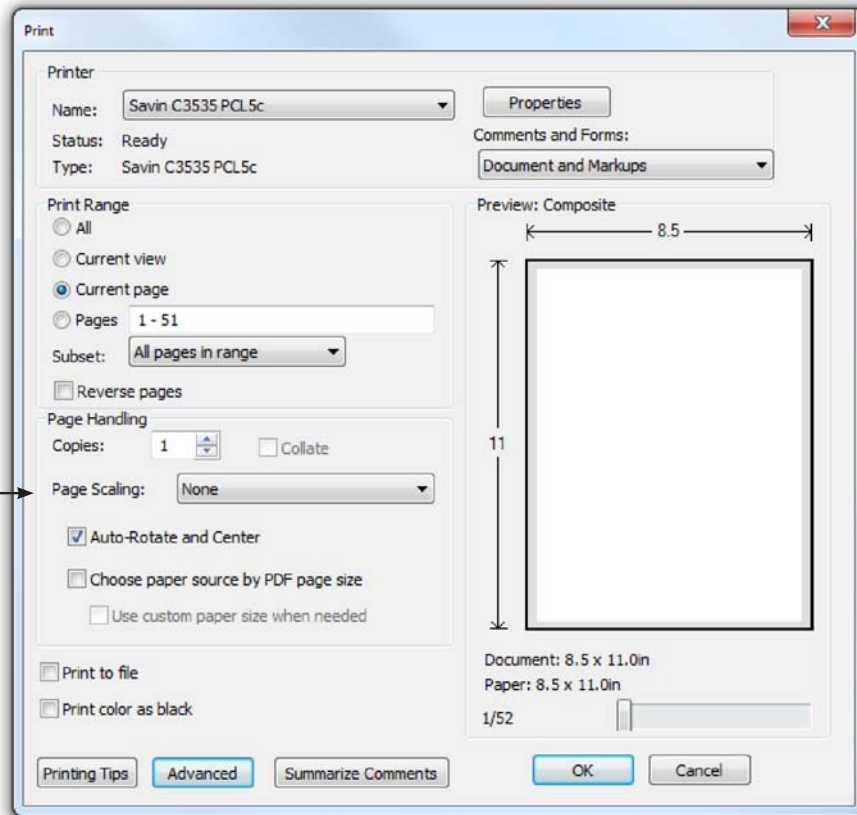

TO SAVE PAPER

Only print the desired image by navigating to the image's page, go to File > Print and select "Current page" in the print dialog box. Repeat for each desired image.

