

Note: Some designs in this collection may have been created using unique special stitches and/or techniques. To preserve design integrity when rescaling or rotating designs in your software, always rescale or rotate designs using the handles directly on-screen.



80040-01 Flower 1 Appliqué

3.25 X 3.01 in.
82.55 X 76.45 mm
12,937 St.



80040-02 Flower 2 Appliqué

4.88 X 4.72 in.
123.95 X 119.89 mm
12,302 St.



80040-03 Flower 3 3D

3.96 X 4.07 in.
100.58 X 103.38 mm
11,245 St.



80040-03A Flower 3 3D-Outer
Petals Appliqué

3.96 X 4.07 in.
100.58 X 103.38 mm
5,138 St.



80040-03B Flower 3 3D-Middle
Petals Appliqué

3.27 X 3.38 in.
83.06 X 85.85 mm
3,811 St.



80040-03C Flower 3 3D-Inner
Petals Appliqué

1.56 X 1.63 in.
39.62 X 41.40 mm
1,833 St.



80040-03D Flower 3 3D-Stamen
Tackdown

.43 X .41 in.
10.92 X 10.41 mm
463 St. S

⌘ Design contains a loose fill.
⚙ Some white areas shown are not stitched.

L Design is larger than 5" (127 mm) in either direction.
S Design is smaller than 1.5" (38.1 mm) in either direction.

It is a violation of Copyright law to make and distribute copies of electronic designs or artwork. Electronic designs are licensed to the original purchaser for use at one location. ©2013 Laurel Burch for use in home embroidery. All rights reserved

Note: Some designs in this collection may have been created using unique special stitches and/or techniques. To preserve design integrity when rescaling or rotating designs in your software, always rescale or rotate designs using the handles directly on-screen.



80040-04 Flower 4 3D
3.81 X 3.59 in.
96.77 X 91.19 mm
13,786 St.

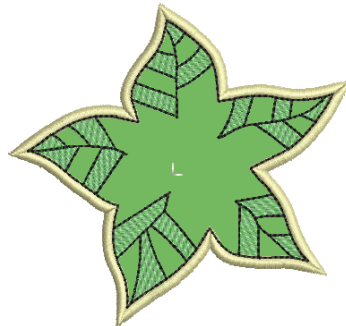

**80040-04A Flower 4 3D-Outer
Petals Appliqué**
3.81 X 3.59 in.
96.77 X 91.19 mm
6,286 St.



**80040-04B Flower 4 3D-Inner
Petals Appliqué**
2.16 X 2.09 in.
54.86 X 53.09 mm
3,088 St.

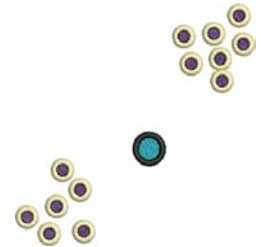

**80040-04C Flower 4 3D-Stamen
Tackdown and Background**
3.61 X 3.62 in.
91.69 X 91.95 mm
4,412 St.



80040-05 Flower 5 Appliqué
4.85 X 4.67 in.
123.19 X 118.62 mm
9,215 St.



80040-06 Flower 6 3D
3.90 X 4.44 in.
99.06 X 112.78 mm
10,755 St.



**80040-06A Flower 6 3D-Outer
Petals Appliqué**
3.90 X 4.44 in.
99.06 X 112.78 mm
3,698 St.

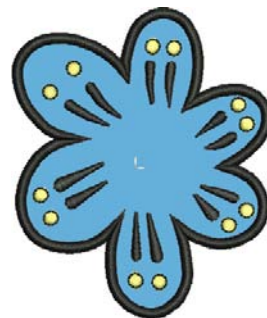

**80040-06B Flower 6 3D-Inner
Petals Appliqué**
3.19 X 3.80 in.
81.03 X 96.52 mm
5,365 St.



**80040-06C Flower 6 3D-Stamen
Tackdown Petals**
1.03 X 1.03 in.
26.16 X 26.16 mm
1,692 St. **S**

⌘ Design contains a loose fill.
⚙ Some white areas shown are not stitched.

L Design is larger than 5" (127 mm) in either direction.
S Design is smaller than 1.5" (38.1 mm) in either direction.

It is a violation of Copyright law to make and distribute copies of electronic designs or artwork. Electronic designs are licensed to the original purchaser for use at one location. ©2013 Laurel Burch for use in home embroidery. All rights reserved

Note: Some designs in this collection may have been created using unique special stitches and/or techniques. To preserve design integrity when rescaling or rotating designs in your software, always rescale or rotate designs using the handles directly on-screen.



80040-07 Flower 7 Appliqué
3.50 X 6.05 in.
88.90 X 153.67 mm
12,417 St. **L**



80040-08 Heart Appliqué
6.26 X 3.36 in.
159.00 X 85.34 mm
8,186 St. **L**



80040-09 Flowers 1 Blackwork
3.89 X 5.00 in.
98.81 X 127.00 mm
9,123 St. **⚡**



80040-10 Flowers 2 Blackwork
2.87 X 6.01 in.
72.64 X 152.65 mm
11,862 St. **⚡ L**



80040-11 Flowers 3 Blackwork
3.77 X 4.80 in.
95.76 X 121.92 mm
7,585 St. **⚡**



80040-12 Small Flower Corner
2.62 X 2.57 in.
66.55 X 65.28 mm
2,365 St. **⚡**



80040-13 Small Flower Border
1.59 X 5.86 in.
40.39 X 148.84 mm
3,844 St. **⚡ L**



80040-14 Leaf Corner
1.75 X 1.48 in.
44.45 X 37.59 mm
2,875 St. **S**



80040-15 Leaf Border
4.50 X .57 in.
114.30 X 14.48 mm
4,928 St. **S**



80040-16 Flower 1
2.18 X 2.02 in.
55.37 X 51.31 mm
9,359 St.



80040-17 Flower 2
2.54 X 2.46 in.
64.52 X 62.48 mm
10,386 St.



80040-18 Flower 3
3.05 X 3.14 in.
77.47 X 79.76 mm
13,482 St.

⚡ Design contains a loose fill.

⚡ Some white areas shown are not stitched.

L Design is larger than 5" (127 mm) in either direction.

S Design is smaller than 1.5" (38.1 mm) in either direction.

It is a violation of Copyright law to make and distribute copies of electronic designs or artwork. Electronic designs are licensed to the original purchaser for use at one location. ©2013 Laurel Burch for use in home embroidery. All rights reserved

Note: Some designs in this collection may have been created using unique special stitches and/or techniques. To preserve design integrity when rescaling or rotating designs in your software, always rescale or rotate designs using the handles directly on-screen.



80040-19 Flower 4
3.97 X 3.91 in.
100.84 X 99.57 mm
18,337 St.



80040-20 Flower 5
3.56 X 3.43 in.
90.42 X 87.12 mm
12,928 St.



80040-21 Flower 6
2.51 X 2.85 in.
63.75 X 72.39 mm
10,768 St.



80040-22 Flower 7
3.50 X 6.05 in.
88.90 X 153.67 mm
20,316 St. **L**



80040-23 Flowers 1
3.47 X 4.47 in.
88.14 X 113.54 mm
23,207 St. **S**



80040-24 Flowers 2
2.15 X 4.50 in.
54.61 X 114.30 mm
15,935 St. **S**



80040-25 Flowers 3
2.76 X 1.87 in.
70.10 X 47.50 mm
10,311 St. **S**



80040-26 Heart
4.40 X 2.34 in.
111.76 X 59.44 mm
8,109 St.



80040-27 Small Accent Flower 1
1.30 X 1.25 in.
33.02 X 31.75 mm
2,956 St. **S**



80040-28 Small Accent Flower 2
1.57 X 1.46 in.
39.88 X 37.08 mm
3,635 St. **S**

S Design contains a loose fill.

S Some white areas shown are not stitched.

L Design is larger than 5" (127 mm) in either direction.

S Design is smaller than 1.5" (38.1 mm) in either direction.

It is a violation of Copyright law to make and distribute copies of electronic designs or artwork. Electronic designs are licensed to the original purchaser for use at one location. ©2013 Laurel Burch for use in home embroidery. All rights reserved

Listings below indicate color sample, stitching order and suggested thread color number. "I" refers to Isacord thread and "T" refers to Timeless thread. Colors beginning with 20501 refer to YLI Fine Metallics, 7 refer to Yenmet Metallic, 8 refer to YLI Variations Variegated Thread and 9 refer to Isacord Multicolor Variegated.

	I	T		I	T		I	T
80040-01 Flower 1 Appliqué			80040-05 Flower 5 Appliqué			80040-14 Leaf Corner		
■ 1. Purple Background.....	2900	16139	■ 1. Outer Petal Placement Stitch.....	0532	20139	■ 1. Dark Leaf Shading.....	5510	18142
■ 2. Flower Placement Stitch.....	0506	22133	■ 2. Cut Line & Tackdown.....	0532	20139	■ 2. Light Leaf Shading.....	5500	18133
■ 3. Cut Line & Tackdown.....	0506	22133	■ 3. Inner Petal Placement Stitch.....	0020	28151	■ 3. Design Outlines.....	0020	28151
■ 4. Red Spots.....	1902	12121	■ 4. Cut Line & Tackdown.....	0020	28151			
■ 5. Stamen.....	3910	14199	■ 5. Outer Petal Cover Stitch.....	0532	20139	80040-15 Leaf Border		
■ 6. Stamen & Petal Outline.....	0532	20139	□ 6. White Spots & Stamen.....	0015	28154	■ 1. Dark Leaf Shading.....	5510	18142
■ 7. Yellow Cover Stitch.....	0506	22133	■ 7. Inner Cover Stitch & Black Detail.....	0020	28151	■ 2. Light Leaf Shading.....	5500	18133
■ 8. Black Details.....	0020	28151				■ 3. Design Outlines.....	0020	28151
			80040-06A Flower 6 3D-Outer Petals Appliqué					
80040-02 Flower 2 Appliqué			■ 1. Flower Placement Stitch.....	0532	20139	80040-16 Flower 1		
■ 1. Outer Petal Placement Stitch.....	0020	28151	■ 2. Cut Line & Tackdown.....	0532	20139	■ 1. Stamen.....	3910	14199
■ 2. Cut Line & Tackdown.....	0020	28151	■ 3. Cover Stitch.....	0532	20139	■ 2. Pink Petals.....	2300	10163
■ 3. Inner Petal Placement Stitch.....	0020	28151	■ 4. Black Outline.....	0020	28151	■ 3. Purple Background.....	2900	16139
■ 4. Cut Line & Tackdown.....	0020	28151	□ 5. Layer Placement Guide.....	0015	28154	■ 4. Red Spots.....	1902	12121
■ 5. Stamen Placement Stitch.....	0020	28151				■ 5. Stamen & Petal Outlines.....	0532	20139
■ 6. Cut Line & Tackdown.....	0020	28151	80040-06B Flower 6 3D-Inner Petals Appliqué			■ 6. Yellow Petal Outlines.....	0506	22133
■ 7. Outer Petal Cover Stitch.....	0532	20139	■ 1. Flower Placement Stitch.....	0020	28151	■ 7. Black Outlines.....	0020	28151
■ 8. Spots & Swirl.....	0506	22133	■ 2. Cut Line & Tackdown.....	0020	28151			
■ 9. Black Details.....	0020	28151	■ 3. Yellow Spots.....	0506	22133	80040-17 Flower 2		
			■ 4. Cover Stitch & Detail.....	0020	28151	■ 1. Orange Stamen.....	1300	24121
80040-03A Flower 3 3D-Outer Petals Appliqué			□ 5. Layer Placement Guide.....	0015	28154	■ 2. Light Orange Flower.....	0811	22145
■ 1. Flower Placement Stitch.....	0532	20139	80040-06C Flower 6 3D-Stamen Tackdown Petals			■ 3. Yellow Spots & Swirl.....	0506	22133
■ 2. Cut Line & Tackdown.....	0532	20139	□ 1. Layer Placement Guide.....	0015	28154	■ 4. Purple Edge.....	2900	16139
■ 3. Cover Stitch.....	0532	20139	■ 1. Stamen.....	2520	10151	■ 5. Gold Outline.....	0532	20139
■ 4. Black Detail.....	0020	28151	■ 3. Spots.....	0506	22133	■ 6. Black Outlines.....	0020	28151
□ 5. Layer Placement Guide.....	0015	28154	■ 4. Stamen Outline.....	1220	24118			
			■ 5. Black Detail.....	0020	28151	80040-18 Flower 3		
80040-03B Flower 3 3D-Middle Petals Appliqué						■ 1. Pink Edge.....	2520	10151
■ 1. Flower Placement Stitch.....	0020	28151	80040-07 Flower 7 Appliqué			■ 2. Orange Petals.....	1300	24121
■ 2. Cut Line & Tackdown.....	0020	28151	■ 1. Outer Petal Placement Stitch.....	0532	20139	■ 3. Light Orange Petals.....	0811	22145
■ 3. Cover Stitch & Detail.....	0020	28151	■ 2. Outer Petal Cut Line & Tackdown.....	0532	20139	■ 4. Yellow Spots.....	0506	22133
□ 4. Layer Placement Guide.....	0015	28154	■ 3. Inner Petal Placement Stitch.....	0811	22145	■ 5. Gold Outlines.....	0532	20139
			■ 4. Inner Petal Cut Line & Tackdown.....	0811	22145	■ 6. Black Details.....	0020	28151
80040-03C Flower 3 3D-Inner Petals Appliqué			■ 5. Stem & Leaf Placement Stitch.....	0532	20139			
■ 1. Flower Placement Stitch.....	0020	28151	■ 6. Stem & Leaf Cut Line & Tackdown.....	0532	20139	80040-19 Flower 4		
■ 2. Cut Line & Tackdown.....	0020	28151	■ 7. Stem & Leaf Shading.....	5510	18142	■ 1. Light Green Sections.....	5500	18133
■ 3. Spots.....	0506	22133	■ 8. Orange Cover Stitch.....	0811	22145	■ 2. Dark green Sections.....	5510	18142
■ 4. Cover Stitch & Detail.....	0020	28151	■ 9. Pink Cover Stitch.....	2300	10163	■ 3. Blue Stamen.....	4103	14202
□ 5. Layer Placement Guide.....	0015	28154	■ 10. Gold Cover Stitch.....	0532	20139	■ 4. Flower.....	0811	22145
			■ 11. Black Details.....	0020	28151	■ 5. Purple Spots.....	2900	16139
80040-03D Flower 3 3D-Stamen Tackdown						■ 6. Gold Outlines.....	0532	20139
□ 1. Layer Placement Guide.....	0015	28154	80040-08 Heart Appliqué			■ 7. Orange Spots.....	1300	24121
■ 2. Yellow Stamen.....	0506	22133	■ 1. Leaf Placement Stitch.....	0020	28151	■ 8. Black Detail.....	0020	28151
■ 3. Black Detail.....	0020	28151	■ 2. Cut Line & Tackdown.....	0020	28151			
			■ 3. Heart Placement Stitch.....	0020	28151	80040-20 Flower 5		
80040-04A Flower 4 3D-Outer Petals Appliqué			■ 4. Cut Line & Tackdown.....	0020	28151	■ 1. Purple Flower.....	2900	16139
■ 1. Flower Placement Stitch.....	0532	20139	■ 5. Light Pink Heart Shading.....	2520	10151	■ 2. Blue Flower.....	3910	14199
■ 2. Cut Line & Tackdown.....	0532	20139	■ 6. Orange Heart Shading.....	1220	24118	■ 3. Gold Outline.....	0532	20139
■ 3. Green Petal Shading.....	5510	18142	■ 7. Purple Heart Shading.....	2900	16139	□ 4. White Spots & Stamen.....	0015	28154
■ 4. Cover Stitch.....	0532	20139	■ 8. Dark Pink Heart Shading.....	2300	10163	■ 5. Black Detail.....	0020	28151
■ 5. Black Details.....	0020	28151	■ 9. Flower Placement Stitch.....	0020	28151			
□ 6. Layer Placement Guide.....	0015	28154	■ 10. Cut Line & Tackdown.....	0020	28151	80040-21 Flower 6		
			■ 11. Light Blue Stamen.....	3910	14199	■ 1. Pink Stamen.....	2520	10151
80040-04B Flower 4 3D-Inner Petals Appliqué			■ 12. Cover Stitch & Detail.....	0020	28151	■ 2. Light Blue Petals.....	3910	14199
■ 1. Flower Placement Stitch.....	0020	28151				■ 3. Yellow Spots.....	0506	22133
■ 2. Cut Line & Tackdown.....	0020	28151	80040-09 Flowers 1 Blackwork			■ 4. Dark Blue Edge.....	4103	14202
■ 3. Orange Spots.....	1300	24121	■ 1. Single Color Design.....	0020	28151	■ 5. Stamen Outline.....	1220	24118
■ 4. Cover Stitch & Details.....	0020	28151				■ 6. Gold Outline.....	0532	20139
□ 5. Layer Placement Guide.....	0015	28154	80040-10 Flowers 2 Blackwork			■ 7. Black Detail.....	0020	28151
			■ 1. Single Color Design.....	0020	28151			
80040-04C Flower 4 3D-Stamen Tackdown & Background						80040-22 Flower 7		
■ 1. Purple Spots.....	2900	16139	80040-11 Flowers 3 Blackwork			■ 1. Purple Flower.....	2900	16139
■ 2. Gold Outlines.....	0532	20139	■ 1. Single Color Design.....	0020	28151	■ 2. Yellow Flower.....	0506	22133
■ 3. Black Outlines.....	0020	28151				■ 3. Pink Detail.....	2300	10163
□ 4. Layer Placement Guide.....	0015	28154	80040-12 Small Flower Corner			■ 4. Inner Flower Outline.....	0811	22145
■ 5. Blue Stamen.....	4103	14202	■ 1. Single Color Design.....	0020	28151	■ 5. Leaves & Stem.....	5500	18133
■ 6. Stamen Outline.....	0020	28151				■ 6. Leaves & Stem Shading.....	5510	18142
			80040-13 Small Flower Border			■ 7. Gold Outline.....	0532	20139
			■ 1. Single Color Design.....	0020	28151	■ 8. Black Detail.....	0020	28151

Listings below indicate color sample, stitching order and suggested thread color number. "I" refers to Isacord thread and "T" refers to Timeless thread. Colors beginning with 20501 refer to YLI Fine Metallics, 7 refer to Yenmet Metallic, 8 refer to YLI Variations Variegated Thread and 9 refer to Isacord Multicolor Variegated.

80040-23 Flowers 1			80040-25 Flowers 3			80040-27 Small Accent Flower 1		
	I	T		I	T		I	T
1. Orange Flower Background	1300	24121	1. Orange Stamen	0811	22145	1. Flower	0015	28154
2. Orange Flower	1220	24118	2. Dark Pink Flower	2300	10163	2. Blue Stamen	3910	14199
3. Pink Flower	2300	10163	3. Green Flower	5510	18142	3. Green Stamen Detail	5500	18133
4. Yellow Spots	0506	22133	4. Yellow Stamen & Swirl	0506	22133	4. Red Stamen Detail	1902	12121
5. Blue Spots & Stamen	4103	14202	5. Purple Detail	2900	16139	5. Black Detail	0020	28151
6. Top Flower Blue Edge & Stamen	4103	14202	6. Pink Edge	2520	10151			
7. Stamen Spots & Swirl	0506	22133	7. Gold Outlines	0532	20139			
8. Pink Outline	2520	10151	8. Black Detail	0020	28151			
9. Stamen Outline	5510	18142						
10. Gold Outlines	0532	20139						
11. Black Details	0020	28151						

80040-24 Flowers 2			80040-26 Heart			80040-28 Small Accent Flower 2		
	I	T		I	T		I	T
1. White Stamens	0015	28154	1. Leaves	5500	18133	1. Orange Petals	0811	22145
2. Green Flower	5500	18133	2. Yellow Heart	0506	22133	2. Yellow Petals	0506	22133
3. Orange Petals	1300	24121	3. Light Pink Heart Shading	2520	10151	3. Orange Stamen	0811	22145
4. Light Orange Flower	1220	24118	4. Orange Heart Shading	1220	24118	4. Dark Orange Stamen Shading	1220	24118
5. Dark Pink Detail	2300	10163	5. Purple Heart Shading	2900	16139	5. White Stamen Detail	0015	28154
6. Pink Petals	2520	10151	6. Dark Pink Heart Shading	2300	10163	6. Black Outlines	0020	28151
7. Yellow Petals	0506	22133	7. Flower	0015	28154			
8. Gold Outlines	0532	20139	8. Light Blue Stamen	3910	14199			
9. Black Details	0020	28151	9. Black Detail	0020	28151			

Pre-Cut Appliqué Instructions

1. Print out the necessary pages from the PDF of the appliqué pattern(s).
2. Mark the right side of the pattern pieces so you'll know which direction to lay the pattern on the fabric.
3. Lightly spray the wrong side of the pattern pieces with temporary adhesive spray and allow it to set for a few minutes.
4. Place the pattern pieces on the right side of the fabric and carefully cut them out. **PHOTO 1**
5. Sew the placement stitch on your hooped fabric. **PHOTO 2**
6. With the paper still stuck to the right side of the appliqué fabric, spray the wrong side of the fabric with temporary adhesive.
7. Place the fabric inside the sewing placement stitch so that it matches the stitching line, and then remove the paper pattern. **PHOTO 3**
8. Sew the tackdown. **PHOTO 4**
9. Sew the remainder of the design and repeat for any remaining pieces. **PHOTO 5**

NOTE: The patterns are sized for the designs as they were made. If you resize the design, you will need to resize the pattern the same amount. You can print out the pattern at the normal size then copy it on a copy machine at the changed size. For example, resize the designs to 80%, resize the printed pattern to 80%.

TIP: When Printing the patterns, make sure that the "Fit to page" option is **UNCHECKED** in the Print Dialog Box. If this option is checked the printed patterns will not be actual size.

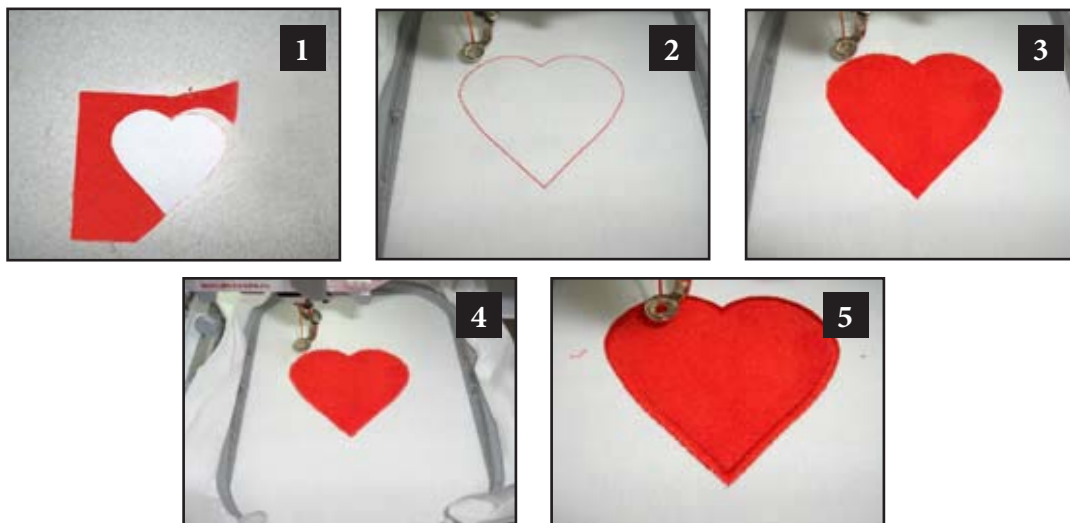

Stitch out Freestanding Appliqué Pieces

1. Hoop two layers of water-soluble stabilizer.
2. Select the thread colors of your choice and wind bobbins to match. It is recommended that you use matching bobbin thread for these designs as the wrong sides may be visible depending on the use of your layered appliqué.
3. Attach the hoop to the machine and select the design of your choice.
4. Stitch the placement stitch.
5. Remove the hoop from machine but DO NOT unhoop the stabilizer. Place a portion of the fabric of your choice on the top side of the stabilizer. You may use a very small amount of spray adhesive if you wish. Be sure to use sparingly as too much may begin to dissolve your water soluble stabilizer. Ensure the fabric covers the placement stitch entirely.
6. Re-attach the hoop to the machine. Stitch the tack down stitch.
7. Continue sewing out design, changing thread colors as necessary. When design is complete, remove from hoop.
8. Trim away excess stabilizer and rinse in warm water. Allow to dry completely.
9. Repeat this process for all required pieces for layered appliqué. **(Photo 1)**



Assemble Layered Freestanding Appliqué

1. After all pieces are sewn out, rinsed and dried, begin by stacking the pieces together by matching up the 90° angle or “L”.
2. You may want to pin the pieces together to be sure they remain still during the final step of sew out. Be sure not to pin where the center tack down stitch will be. Pin toward the edges. You may also use a small amount of temporary adhesive spray. **(Photo 2)**
3. Hoop the item or fabric to which you would like to affix the layered appliqué piece. Attach the hoop to the machine and select the stamen tack down design.
4. Complete color order up to “Layer Placement Guide” stitch. AFTER sewing the layer placement guide stitch, remove the hoop from the machine, but DO NOT unhoop the item or fabric.
5. Place the freestanding appliqué pieces so that the placement “L” is aligned with the placement “L” on the hooped design. You may use a small amount of temporary adhesive spray to secure the layered freestanding appliqué pieces. **(Photo 3)**
6. Re-attach hoop to the machine. Sew the center tack down stitch. This stitch will secure all layers of the freestanding appliqué as well as affix the piece to your item or fabric. **(Photo 4)**
7. Your layered freestanding appliqué is now complete. **(Photo 5)**



ATTENTION

When printing this document, any page scaling or page fitting options in your print dialog box must be turned OFF or set to NONE so that your files will print out at their actual size. Images not printed at actual size will not function as intended.

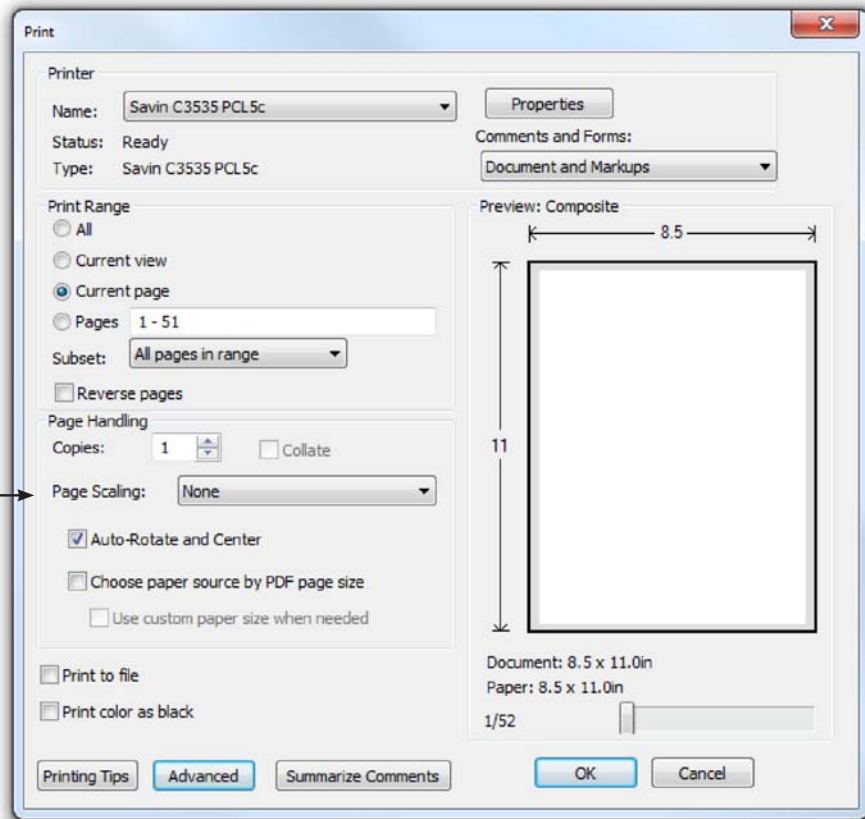

TO SAVE PAPER

Only print the desired image by navigating to the image's page, go to File > Print and select "Current page" in the print dialog box. Repeat for each desired image.

