

Note: Some designs in this collection may have been created using unique special stitches and/or techniques. To preserve design integrity when rescaling or rotating designs in your software, always rescale or rotate designs using the handles directly on-screen.



80043-01 Kimono Cutie Stitch 'N' Turn Appliqué Girl 1
3.93 X 5.71 in.
99.82 X 145.03 mm
9,893 St. **L**



80043-02 Kimono Cutie Stitch 'N' Turn Appliqué Girl 2
3.60 X 5.69 in.
91.44 X 144.53 mm
11,061 St. **L**



80043-03 Kimono Cutie Stitch 'N' Turn Appliqué Kitten 1
4.03 X 5.44 in.
102.36 X 138.18 mm
9,687 St. **L**



80043-04 Kimono Cutie Appliqué Girl 1
2.09 X 3.12 in.
53.09 X 79.25 mm
6,336 St.



80043-05 Kimono Cutie Appliqué Girl 2
2.09 X 3.13 in.
53.09 X 79.50 mm
7,277 St.



80043-06 Kimono Cutie Appliqué Kitten
2.39 X 3.02 in.
60.71 X 76.71 mm
6,182 St.



80043-07 Kimono Cutie Appliqué Clouds
5.71 X 5.45 in.
145.03 X 138.43 mm
8,592 St. **L**



80043-08 Kimono Cutie Appliqué Border
6.03 X 1.85 in.
153.16 X 46.99 mm
6,627 St. **L**



80043-09 Kimono Cutie Appliqué Corner
2.29 X 2.83 in.
58.17 X 71.88 mm
4,710 St. **S**



80043-10 Kimono Cutie Appliqué Flowers
4.31 X 4.35 in.
109.47 X 110.49 mm
12,171 St. **S**



80043-11 Kimono Cutie Appliqué Fan and Flowers
4.38 X 4.82 in.
111.25 X 122.43 mm
11,824 St.



80043-12 Kimono Cutie Branch
6.34 X 3.38 in.
161.04 X 85.85 mm
6,927 St. **L**

S Design contains a loose fill.

S Some white areas shown are not stitched.

L Design is larger than 5" (127 mm) in either direction.

S Design is smaller than 1.5" (38.1 mm) in either direction.

Note: Some designs in this collection may have been created using unique special stitches and/or techniques. To preserve design integrity when rescaling or rotating designs in your software, always rescale or rotate designs using the handles directly on-screen.



80043-13 Kimono Cutie Appliqué
Dog 1
 2.71 X 2.87 in.
 68.83 X 72.90 mm
 5,040 St.



80043-14 Kimono Cutie Appliqué
Dog 2
 2.77 X 3.00 in.
 70.36 X 76.20 mm
 4,807 St.



80043-15 Kimono Cutie Appliqué
Dog 3
 2.82 X 2.95 in.
 71.63 X 74.93 mm
 5,391 St.



80043-16 Kimono Cutie Appliqué
Koi 1
 4.23 X 3.24 in.
 107.44 X 82.30 mm
 9,039 St. ⚡



80043-17 Kimono Cutie Appliqué
Koi Fishes
 3.14 X 5.27 in.
 79.76 X 133.86 mm
 16,830 St. ⚡ ⚡ L



80043-18 Kimono Cutie Appliqué
Koi 2
 3.21 X 2.85 in.
 81.53 X 72.39 mm
 6,805 St. ⚡ ⚡



80043-19 Kimono Cutie Appliqué
Sumo Wrestler
 2.66 X 3.17 in.
 67.56 X 80.52 mm
 6,432 St.



80043-20 Kimono Cutie Cherries
 1.54 X 1.66 in.
 39.12 X 42.16 mm
 2,010 St.



80043-21 Kimono Cutie Appliqué
Fan
 2.81 X 3.02 in.
 71.37 X 76.71 mm
 5,784 St.

⚡ Design contains a loose fill.

⚡ Some white areas shown are not stitched.

L Design is larger than 5" (127 mm) in either direction.

S Design is smaller than 1.5" (38.1 mm) in either direction.

Listings below indicate color sample, stitching order and suggested thread color number. "I" refers to Isacord thread and "T" refers to Timeless thread. Colors beginning with 20501 refer to YLI Fine Metallics, 7 refer to Yenmet Metallic, 8 refer to YLI Variations Variegated Thread and 9 refer to Isacord Multicolor Variegated.

	I	T
80043-17 Kimono Cutie Appliqué Koi Fishes		
1. Black Fish Placement Stitch.....	0020	28151
2. Black Fish Cut Line & Tackdown.....	0020	28151
3. Pink Fish Placement Stitch.....	0020	28151
4. Pink Fish Cut Line & Tackdown.....	0020	28151
5. Black Fish Fins & Tail.....	2300	10163
6. Black Detail.....	0020	28151
7. Pink Detail & Cover Stitch.....	2530	10145
8. Dark Pink Detail.....	2300	10163
9. Blue Detail & Cover Stitch.....	3910	14199
10. Blue Fish Head Detail.....	0020	28151

	I	T
80043-19 Kimono Cutie Appliqué Sumo Wrestler		
1. Body Placement Stitch.....	1115	24109
2. Body Cut Line & Tackdown.....	1115	24109
3. Hair, Eyes & Brows.....	1366	26139
4. Shorts.....	0015	28154
5. Body Cover Stitch.....	1115	24109
6. Hair Outline.....	3910	14199
7. Cone.....	2155	10136
8. Ice Cream.....	2530	10145
9. Cone Outline.....	1912	12133
10. Ice Cream Outline.....	2520	10151
11. Cherry.....	2300	10163

	I	T
80043-20 Kimono Cutie Cherries		
1. Stems.....	1912	12133
2. Cherries.....	1902	12121
3. Cherry Shading.....	2115	12145
4. Cherry Highlights.....	2155	10136

	I	T
80043-21 Kimono Cutie Appliqué Fan		
1. Fan Placement Stitch.....	4610	14193
2. Fan Cut Line & Tackdown.....	4610	14193
3. Black Detail.....	0020	28151
4. Fan Cover Stitch & Detail.....	4610	14193

	I	T
80043-18 Kimono Cutie Appliqué Koi 2		
1. Body Placement Stitch.....	2530	10145
2. Body Cut Line & Tackdown.....	2530	10145
3. Head Placement Stitch.....	2520	10151
4. Head Cut Line & Tackdown.....	2520	10151
5. Light Pink Cover Stitch & Detail.....	2530	10145
6. Dark Pink Cover Stitch & Detail.....	2520	10151

Pre-Cut Appliqué Instructions

1. Print out the necessary pages from the PDF of the appliqué pattern(s).
2. Mark the right side of the pattern pieces so you'll know which direction to lay the pattern on the fabric.
3. Lightly spray the wrong side of the pattern pieces with temporary adhesive spray and allow it to set for a few minutes.
4. Place the pattern pieces on the right side of the fabric and carefully cut them out. **PHOTO 1**
5. Sew the placement stitch on your hooped fabric. **PHOTO 2**
6. With the paper still stuck to the right side of the appliqué fabric, spray the wrong side of the fabric with temporary spray adhesive.
7. Place the fabric inside the sewing placement stitch so that it matches the stitching line, and then remove the paper pattern. **PHOTO 3**
8. Sew the tackdown. **PHOTO 4**
9. Sew the remainder of the design and repeat for any remaining pieces. **PHOTO 5**

NOTE: The patterns are sized for the designs as they were made. If you resize the design, you will need to resize the pattern the same amount. You can print out the pattern at the normal size then copy it on a copy machine at the changed size. For example, resize the designs to 80%, resize the printed pattern to 80%.

TIP: When Printing the patterns, make sure that the "Fit to page" option is UNCHECKED in the Print Dialog Box. If this option is checked the printed patterns will not be actual size.

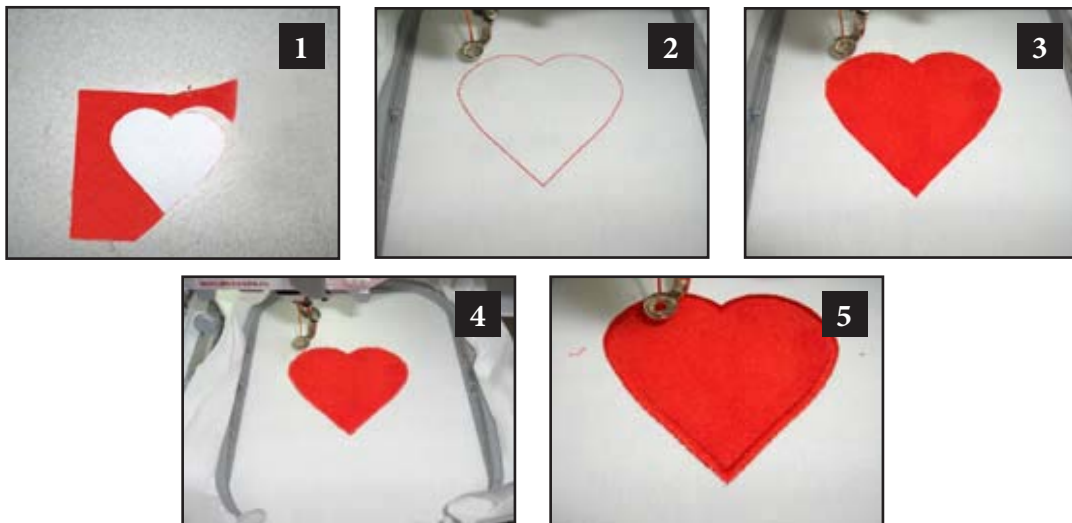

Stitch 'n' Turn Instructions

1. Hoop a single layer of Mesh Cut-Away stabilizer.
2. Spray the stabilizer lightly with Temporary Adhesive Spray.
3. Stitch the first color, which is the "Placement Guide Stitch". Use a thread color that blends with your fabric choice.
4. Place a piece of fabric right side up onto the Mesh Stabilizer, being sure to cover the "Placement Guide Stitch". **See Photo 1**

Note: If using fabric with pile, lightly spray a piece of Wash-Away topping with Temporary Adhesive Spray. Place the topping sprayed side down onto the fabric.
5. Attach the hoop to the machine and stitch the second color, which is the "Basting Stitch" to keep fabric in place.
6. Embroider all but the last color of the design. **See Photo 2.**
7. Remove the hoop from the machine, but DO NOT remove the fabric from the hoop.
8. Clip all jump threads.
9. Gently tear away excess Wash-Away topping. (Do not wet to remove at this time).
10. Place another piece of fabric right side down directly over the first piece. If desired, pin or tape at corners to secure.
11. Reattach the hoop to the machine and stitch the final color change (through both layers of fabric). Use a thread color that blends with your fabric color. For photography purposes we've purposely used a contrasting thread.
12. Remove the hoop from the machine and the fabric from the hoop.
13. Using embroidery scissors, carefully cut out the stitch 'n' turn project close to the stitching line. Cut around the stitches at the opening to create a tab. **See Photo 3.**
14. Clip curves and corners as needed.
15. Turn the project right side out. Use a chopstick to turn out corners and curves.
16. Stuff with polyester stuffing. **Hint:** To speed up the stuffing process cut the bottom off of a cone shaped cup (such as the ones from a water cooler) and use it as a funnel to insert the stuffing. **See Photo 4.**
17. Fold tabs in and slip stitch the slit closed with hand needle or insert a piece of fusible webbing and fuse closed.

Supplies:

- 2 pieces of fabric one inch larger (in all dimensions) than chosen design
- Mesh Cut-Away Stabilizer
- Wash-Away topping (if using fabric with pile such as Minkee® or terrycloth)
- Temporary Adhesive Spray
- Embroidery Thread
- Polyester bobbin thread
- Embroidery machine
- Polyester stuffing
- Hand needle or fusible webbing

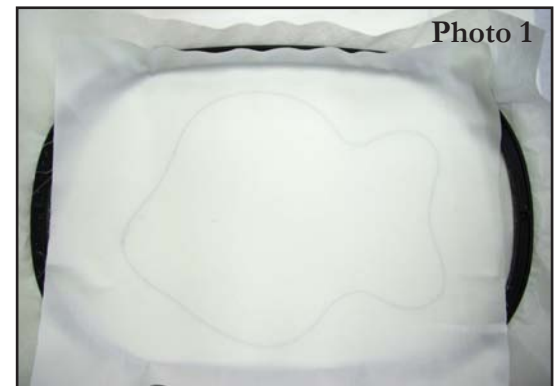

Photo 1

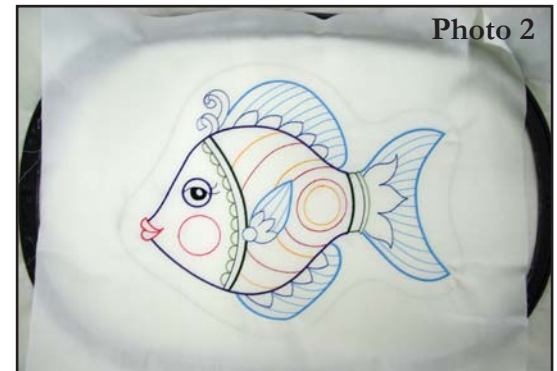

Photo 2

For Extra Fun:

- Add definition stitching with a sewing machine or by hand.
- Stitch ribbon bows or embellishments on your projects to dress them up. Please keep in mind the age of the person to be using them then plan (or omit) add-ons accordingly.

NOTE: Some designs may contain a Ribbon Placement Guide. This is an optional feature that allows you to turn your designs into ornaments if you so wish. To create a hanging loop, after stitching the Ribbon Placement Guide, create a loop out of 1/4" ribbon and place it within the guide with loop facing into the center of the project and tails of the ribbon facing out. Lightly spray ribbon with Temporary Adhesive Spray to hold in place.

NOTE: Design pictured is for instructional purposes and may not be included in this collection.



Photo 3



Photo 4

ATTENTION

When printing this document, any page scaling or page fitting options in your print dialog box must be turned OFF or set to NONE so that your files will print out at their actual size. Images not printed at actual size will not function as intended.

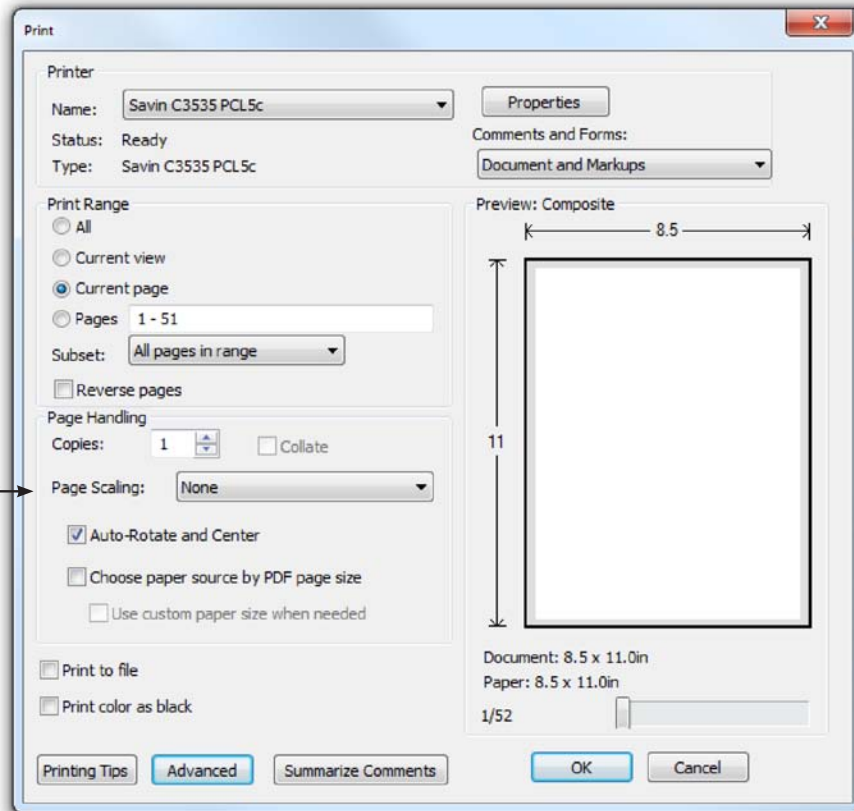

TO SAVE PAPER

Only print the desired image by navigating to the image's page, go to File > Print and select "Current page" in the print dialog box. Repeat for each desired image.

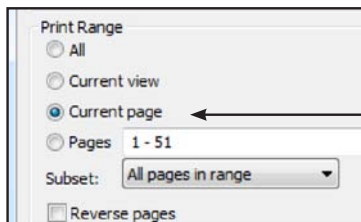

80043-01
4th Placement
Bottom Felt Flower

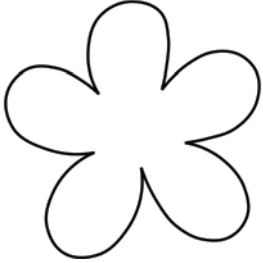

80043-01
Last Placement
Top Felt Flower

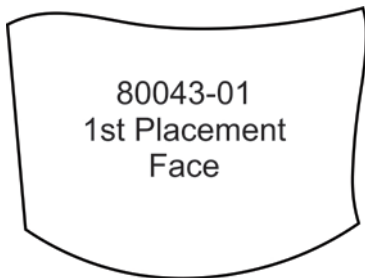
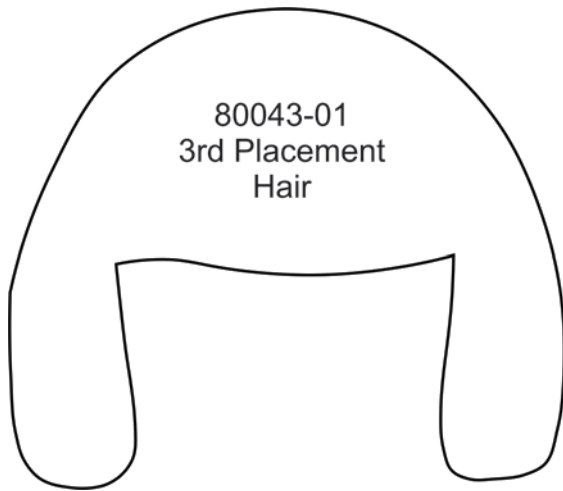
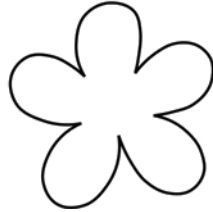

80043-03
3rd Placement
Bottom Felt Flower



80043-03
Last Placement
Top Felt Flower



80043-04
4th Placement
Bottom Felt Flower

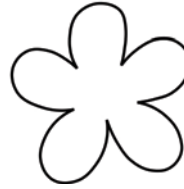

80043-04
Last Placement
Top Felt Flower

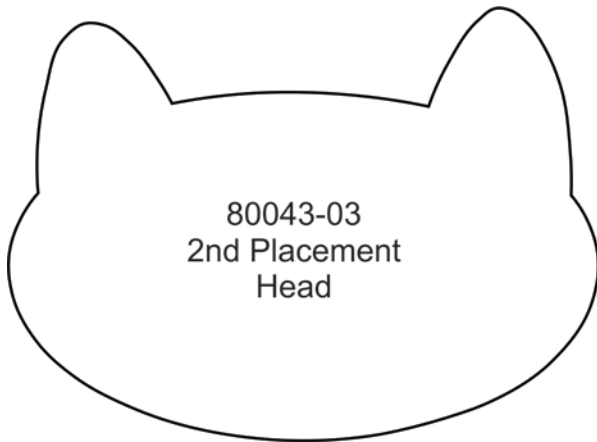
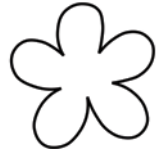



80043-06
Last Placement
Top Felt Flower



80043-06
3rd Placement
Bottom Felt Flower

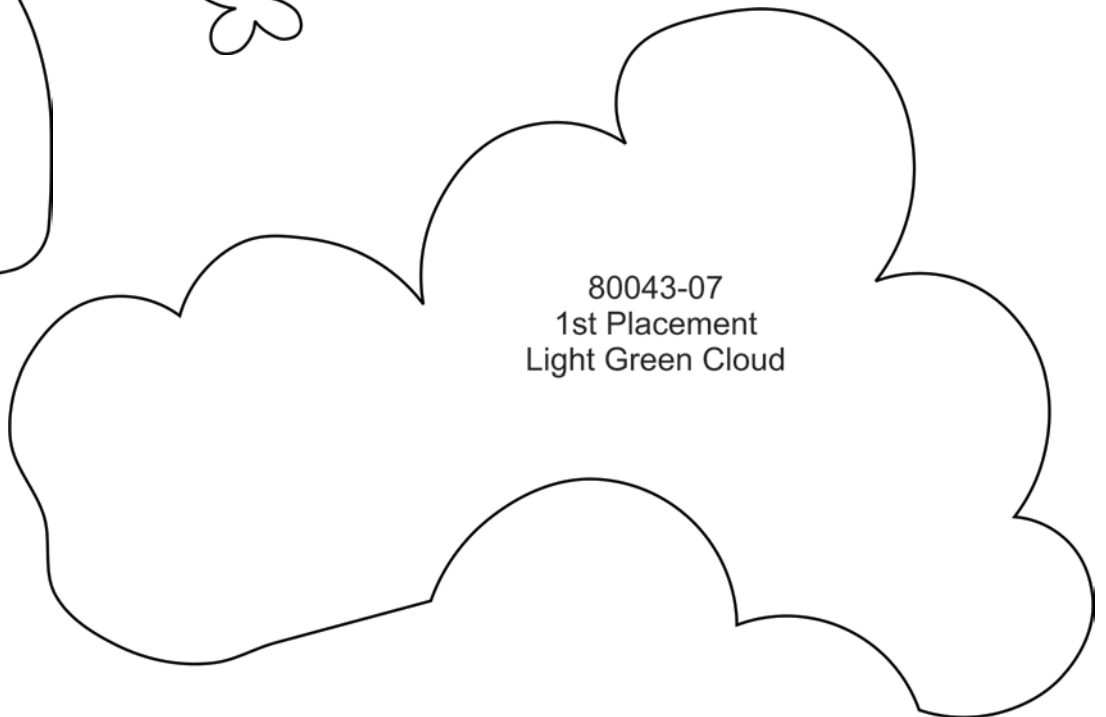



80043-08
Flower

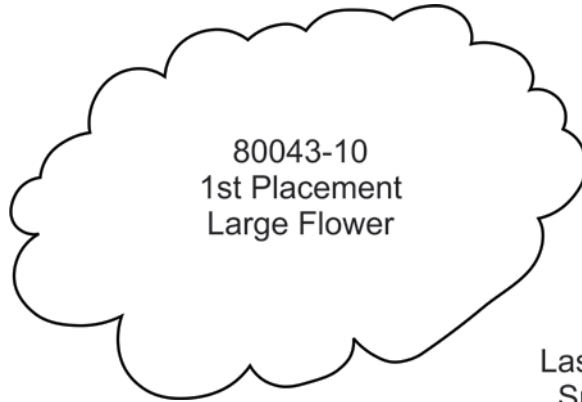

80043-10
1st Placement
Large Flower

80043-09
Last Placement
Small Flower



80043-10
Last Placement
Small Flower



80043-09
1st Placement
Large Flower

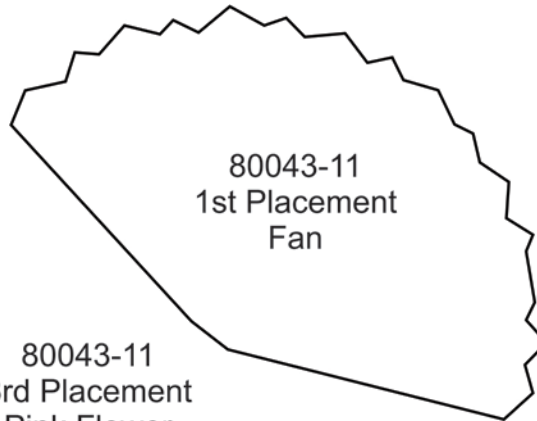

80043-11
1st Placement
Fan

80043-11
2nd Placement
Black Flower



80043-11
Last Placement
Blue Flower



80043-11
3rd Placement
Pink Flower



80043-15
Last Placement
Ice Cream

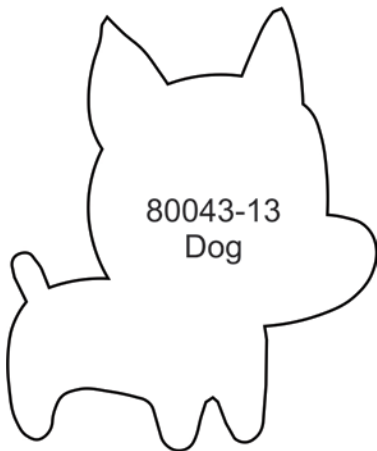

80043-13
Dog



80043-14
Dog



80043-15
1st Placement
Dog

