

Note: Some designs in this collection may have been created using unique special stitches and/or techniques. To preserve design integrity when rescaling or rotating designs in your software, always rescale or rotate designs using the handles directly on-screen.



80057-01 Auk Appliqué
4.22 X 5.24 in.
107.19 X 133.10 mm
15,960 St. **L**



80057-02 Bullfinch Appliqué
4.22 X 5.24 in.
107.19 X 133.10 mm
16,537 St. **L**



80057-03 Crane Appliqué
4.22 X 5.24 in.
107.19 X 133.10 mm
17,198 St. **L**



80057-04 Dove Appliqué
4.23 X 5.24 in.
107.44 X 133.10 mm
13,056 St. **L**



80057-05 Eagle Appliqué
4.23 X 5.24 in.
107.44 X 133.10 mm
19,868 St. **L**



80057-06 Flamingo Appliqué
4.23 X 5.24 in.
107.44 X 133.10 mm
15,678 St. **L**



80057-07 Grebe Appliqué
4.23 X 5.24 in.
107.44 X 133.10 mm
14,371 St. **L**



80057-08 Hawk Appliqué
4.23 X 5.24 in.
107.44 X 133.10 mm
16,818 St. **L**



80057-09 Ibis Appliqué
4.23 X 5.24 in.
107.44 X 133.10 mm
16,053 St. **L**



80057-10 Jay Appliqué
4.22 X 5.24 in.
107.19 X 133.10 mm
16,359 St. **L**



80057-11 Kingfisher Appliqué
4.22 X 5.24 in.
107.19 X 133.10 mm
14,831 St. **L**



80057-12 Linnet Appliqué
4.22 X 5.24 in.
107.19 X 133.10 mm
16,136 St. **L**

⌘ Design contains a loose fill.

⚙ Some solid areas shown are not stitched.

L Design is larger than 5" (127 mm) in either direction.

S Design is smaller than 1.5" (38.1 mm) in either direction.

It is a violation of Copyright law to make and distribute copies of electronic designs or artwork. Electronic designs are licensed to the original purchaser for use at one location. ©Kaye England for use in Home Embroidery. All rights reserved.

Note: Some designs in this collection may have been created using unique special stitches and/or techniques. To preserve design integrity when rescaling or rotating designs in your software, always rescale or rotate designs using the handles directly on-screen.



80057-13 Magpie Appliqué
4.22 X 5.24 in.
107.19 X 133.10 mm
18,149 St. **L**



80057-14 Nightingale Appliqué
4.22 X 5.24 in.
107.19 X 133.10 mm
14,854 St. **L**



80057-15 Ostrich Appliqué
4.22 X 5.24 in.
107.19 X 133.10 mm
17,049 St. **L**



80057-16 Peacock Appliqué
4.23 X 5.24 in.
107.44 X 133.10 mm
23,764 St. **L**



80057-17 Quail Appliqué
4.23 X 5.24 in.
107.44 X 133.10 mm
18,209 St. **L**

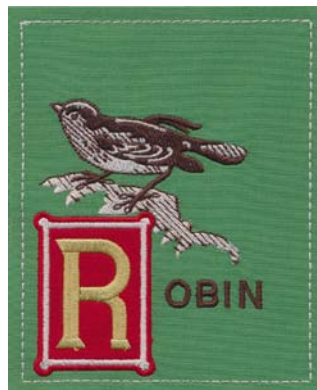

80057-18 Robin Appliqué
4.23 X 5.24 in.
107.44 X 133.10 mm
14,117 St. **L**

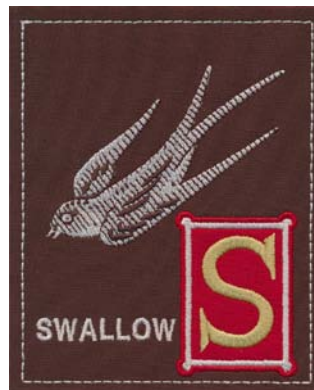

80057-19 Swallow Appliqué
4.23 X 5.24 in.
107.44 X 133.10 mm
12,944 St. **L**



80057-20 Teal Appliqué
4.23 X 5.24 in.
107.44 X 133.10 mm
16,137 St. **L**



80057-21 Umbrellabird Appliqué
4.23 X 5.24 in.
107.44 X 133.10 mm
13,894 St. **L**

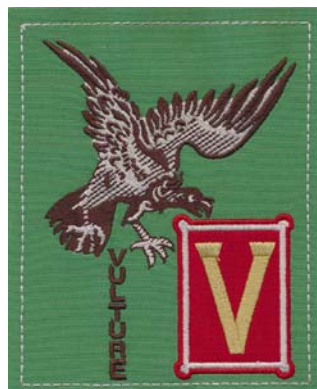

80057-22 Vulture Appliqué
4.23 X 5.24 in.
107.44 X 133.10 mm
19,792 St. **L**

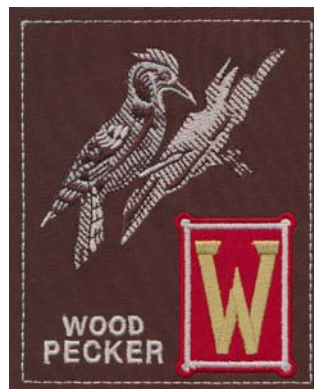

80057-23 Woodpecker Appliqué
4.23 X 5.24 in.
107.44 X 133.10 mm
18,965 St. **L**



80057-24 Xmas Greeting Appliqué
4.23 X 5.24 in.
107.44 X 133.10 mm
12,395 St. **L**

☞ Design contains a loose fill.

⚙ Some solid areas shown are not stitched.

L Design is larger than 5" (127 mm) in either direction.

S Design is smaller than 1.5" (38.1 mm) in either direction.

It is a violation of Copyright law to make and distribute copies of electronic designs or artwork. Electronic designs are licensed to the original purchaser for use at one location. ©Kaye England for use in Home Embroidery. All rights reserved.

Note: Some designs in this collection may have been created using unique special stitches and/or techniques. To preserve design integrity when rescaling or rotating designs in your software, always rescale or rotate designs using the handles directly on-screen.



80057-25 Yellow Bird Appliqué

4.23 X 5.24 in.
107.44 X 133.10 mm
10,750 St. **L**



80057-26 Zosterops Appliqué

4.23 X 5.24 in.
107.44 X 133.10 mm
14,061 St. **L**

⌘ Design contains a loose fill.
⚙ Some solid areas shown are not stitched.

L Design is larger than 5" (127 mm) in either direction.
S Design is smaller than 1.5" (38.1 mm) in either direction.

It is a violation of Copyright law to make and distribute copies of electronic designs or artwork. Electronic designs are licensed to the original purchaser for use at one location. ©Kaye England for use in Home Embroidery. All rights reserved.



Birds of a Feather

by Kaye England / #80057 / 26 Designs

Listings below indicate color sample, stitching order and suggested thread color number. "I" refers to Isacord thread and "T" refers to Timeless thread. Colors beginning with 20501 refer to YLI Fine Metallics, 7 refer to Yenmet Metallic, 8 refer to YLI Variations Variegated Thread and 9 refer to Isacord Multicolor Variegated.

	I	T
80057-01 Auk Appliqué		
1. Design Placement Stitch.....	0170	28166
2. Tackdown.....	0170	28166
3. Letter Background Placement Stitch.....	1902	12121
4. Cut Line & Tackdown.....	1902	12121
5. Red Cover Stitch.....	1902	12121
6. Off White Cover Stitch.....	0170	28166
7. Letter.....	0552	20145
8. Bird.....	0170	28166
9. Brown Detail.....	1876	26157
10. Off White Detail.....	0170	28166
11. Small Letters.....	0170	28166

80057-02 Bullfinch Appliqué		
1. Design Placement Stitch.....	0170	28166
2. Tackdown.....	0170	28166
3. Letter Background Placement Stitch.....	5633	18154
4. Cut Line & Tackdown.....	5633	18154
5. Green Cover Stitch.....	5633	18154
6. Off White Cover Stitch.....	0170	28166
7. Letter.....	0552	20145
8. Bird & Branch.....	0170	28166
9. Brown Detail.....	1876	26157
10. Off White Detail.....	0170	28166
11. Small Letters.....	0170	28166

80057-03 Crane Appliqué		
1. Design Placement Stitch.....	0170	28166
2. Tackdown.....	0170	28166
3. Letter Background Placement Stitch.....	5633	18154
4. Cut Line & Tackdown.....	5633	18154
5. Green Cover Stitch.....	5633	18154
6. Off White Cover Stitch.....	0170	28166
7. Letter.....	0552	20145
8. Bird.....	0170	28166
9. Brown Detail.....	1876	26157
10. Small Letters.....	0170	28166

80057-04 Dove Appliqué		
1. Design Placement Stitch.....	0170	28166
2. Tackdown.....	0170	28166
3. Letter Background Placement Stitch.....	1902	12121
4. Cut Line & Tackdown.....	1902	12121
5. Red Cover Stitch.....	1902	12121
6. Off White Cover Stitch.....	0170	28166
7. Letter.....	0552	20145
8. Bird.....	0170	28166
9. Brown Detail.....	1876	26157
10. Off White Detail.....	0170	28166
11. Small Letters.....	0170	28166

80057-05 Eagle Appliqué		
1. Design Placement Stitch.....	0170	28166
2. Tackdown.....	0170	28166
3. Letter Background Placement Stitch.....	5633	18154
4. Cut Line & Tackdown.....	5633	18154
5. Green Cover Stitch.....	5633	18154
6. Off White Cover Stitch.....	0170	28166
7. Letter.....	0552	20145
8. Bird.....	0170	28166
9. Brown Detail.....	1876	26157
10. Off White Detail.....	0170	28166
11. Small Letters.....	0170	28166

	I	T
80057-06 Flamingo Appliqué		
1. Design Placement Stitch.....	0170	28166
2. Tackdown.....	0170	28166
3. Letter Background Placement Stitch.....	1902	12121
4. Cut Line & Tackdown.....	1902	12121
5. Red Cover Stitch.....	1902	12121
6. Off White Cover Stitch.....	0170	28166
7. Letter.....	0552	20145
8. Bird.....	0170	28166
9. Brown Detail.....	1876	26157
10. Off White Detail.....	0170	28166
11. Small Letters.....	0170	28166

80057-07 Grebe Appliqué		
1. Design Placement Stitch.....	0170	28166
2. Tackdown.....	0170	28166
3. Letter Background Placement Stitch.....	5633	18154
4. Cut Line & Tackdown.....	5633	18154
5. Green Cover Stitch.....	5633	18154
6. Off White Cover Stitch.....	0170	28166
7. Letter.....	0552	20145
8. Bird.....	0170	28166
9. Brown Detail.....	1876	26157
10. Off White Detail.....	0170	28166
11. Small Letters.....	0170	28166

80057-08 Hawk Appliqué		
1. Design Placement Stitch.....	0170	28166
2. Tackdown.....	0170	28166
3. Letter Background Placement Stitch.....	5633	18154
4. Cut Line & Tackdown.....	5633	18154
5. Green Cover Stitch.....	5633	18154
6. Off White Cover Stitch.....	0170	28166
7. Letter.....	0552	20145
8. Hawk Feathers.....	0170	28166
9. Brown Detail.....	1876	26157
10. Off White Detail.....	0170	28166
11. Small Letters.....	0170	28166

80057-09 Ibis Appliqué		
1. Design Placement Stitch.....	0170	28166
2. Tackdown.....	0170	28166
3. Letter Background Placement Stitch.....	1902	12121
4. Cut Line & Tackdown.....	1902	12121
5. Red Cover Stitch.....	1902	12121
6. Off White Cover Stitch.....	0170	28166
7. Letter.....	0552	20145
8. Bird.....	0170	28166
9. Brown Detail.....	1876	26157
10. Small Letters.....	1876	26157

80057-10 Jay Appliqué		
1. Design Placement Stitch.....	0170	28166
2. Tackdown.....	0170	28166
3. Letter Background Placement Stitch.....	1902	12121
4. Cut Line & Tackdown.....	1902	12121
5. Red Cover Stitch.....	1902	12121
6. Off White Cover Stitch.....	0170	28166
7. Letter.....	0552	20145
8. Bird.....	0170	28166
9. Brown Detail.....	1876	26157
10. Off White Detail.....	0170	28166
11. Small Letters.....	0170	28166

	I	T
80057-11 Kingfisher Appliqué		
1. Design Placement Stitch.....	0170	28166
2. Tackdown.....	0170	28166
3. Letter Background Placement Stitch.....	5633	18154
4. Cut Line & Tackdown.....	5633	18154
5. Green Cover Stitch.....	5633	18154
6. Off White Cover Stitch.....	0170	28166
7. Letter.....	0552	20145
8. Bird.....	0170	28166
9. Brown Detail.....	1876	26157
10. Small Letters.....	0170	28166

80057-12 Linnet Appliqué		
1. Design Placement Stitch.....	0170	28166
2. Tackdown.....	0170	28166
3. Letter Background Placement Stitch.....	5633	18154
4. Cut Line & Tackdown.....	5633	18154
5. Green Cover Stitch.....	5633	18154
6. Off White Cover Stitch.....	0170	28166
7. Letter.....	0552	20145
8. Bird & Branch.....	0170	28166
9. Brown Detail.....	1876	26157
10. Off White Detail.....	0170	28166
11. Small Letters.....	0170	28166

80057-13 Magpie Appliqué		
1. Design Placement Stitch.....	0170	28166
2. Tackdown.....	0170	28166
3. Letter Background Placement Stitch.....	1902	12121
4. Cut Line & Tackdown.....	1902	12121
5. Red Cover Stitch.....	1902	12121
6. Off White Cover Stitch.....	0170	28166
7. Letter.....	0552	20145
8. Bird & Perch.....	0170	28166
9. Brown Detail.....	1876	26157
10. Off White Detail.....	0170	28166
11. Small Letters.....	1876	26157

80057-14 Nightingale Appliqué		
1. Design Placement Stitch.....	0170	28166
2. Tackdown.....	0170	28166
3. Letter Background Placement Stitch.....	1902	12121
4. Cut Line & Tackdown.....	1902	12121
5. Red Cover Stitch.....	1902	12121
6. Off White Cover Stitch.....	0170	28166
7. Letter.....	0552	20145
8. Bird & Branch.....	0170	28166
9. Dark Brown Detail.....	1876	26157
10. Off White Detail.....	0170	28166
11. Small Letters.....	0170	28166

80057-15 Ostrich Appliqué		
1. Design Placement Stitch.....	0170	28166
2. Tackdown.....	0170	28166
3. Letter Background Placement Stitch.....	5633	18154
4. Cut Line & Tackdown.....	5633	18154
5. Green Cover Stitch.....	5633	18154
6. Off White Cover Stitch.....	0170	28166
7. Letter.....	0552	20145
8. Bird.....	0170	28166
9. Dark Brown Detail.....	1876	26157
10. Off White Detail.....	0170	28166
11. Small Letters.....	0170	28166



Birds of a Feather

by Kaye England / #80057 / 26 Designs

Listings below indicate color sample, stitching order and suggested thread color number. "I" refers to Isacord thread and "T" refers to Timeless thread. Colors beginning with 20501 refer to YLI Fine Metallics, 7 refer to Yenmet Metallic, 8 refer to YLI Variations Variegated Thread and 9 refer to Isacord Multicolor Variegated.

80057-16 Peacock Appliqué		I	T
1. Design Placement Stitch	0170	28166	
2. Tackdown	0170	28166	
3. Letter Background Placement Stitch	5633	18154	
4. Cut Line & Tackdown	5633	18154	
5. Green Cover Stitch	5633	18154	
6. Off White Cover Stitch	0170	28166	
7. Letter	0552	20145	
8. Bird	0170	28166	
9. Brown Detail	1876	26157	
10. Off White Detail	0170	28166	
11. Small Letters	0170	28166	

80057-17 Quail Appliqué		I	T
1. Design Placement Stitch	0170	28166	
2. Tackdown	0170	28166	
3. Letter Background Placement Stitch	5633	18154	
4. Cut Line & Tackdown	5633	18154	
5. Green Cover Stitch	5633	18154	
6. Off White Cover Stitch	0170	28166	
7. Letter	0552	20145	
8. Bird	0170	28166	
9. Brown Detail	1876	26157	
10. Off White Detail	0170	28166	
11. Small Letters	0170	28166	

80057-18 Robin Appliqué		I	T
1. Design Placement Stitch	0170	28166	
2. Tackdown	0170	28166	
3. Letter Background Placement Stitch	1902	12121	
4. Cut Line & Tackdown	1902	12121	
5. Red Cover Stitch	1902	12121	
6. Off White Cover Stitch	0170	28166	
7. Letter	0552	20145	
8. Bird & Branch	0170	28166	
9. Brown Detail	1876	26157	
10. Off White Detail	0170	28166	
11. Small Letters	1876	26157	

80057-19 Swallow Appliqué		I	T
1. Design Placement Stitch	0170	28166	
2. Tackdown	0170	28166	
3. Letter Background Placement Stitch	1902	12121	
4. Cut Line & Tackdown	1902	12121	
5. Red Cover Stitch	1902	12121	
6. Off White Cover Stitch	0170	28166	
7. Letter	0552	20145	
8. Bird	0170	28166	
9. Brown Detail	1876	26157	
10. Off White Detail	0170	28166	
11. Small Letters	0170	28166	

80057-20 Teal Appliqué		I	T
1. Design Placement Stitch	0170	28166	
2. Tackdown	0170	28166	
3. Letter Background Placement Stitch	5633	18154	
4. Cut Line & Tackdown	5633	18154	
5. Green Cover Stitch	5633	18154	
6. Off White Cover Stitch	0170	28166	
7. Letter	0552	20145	
8. Bird & Detail	0170	28166	
9. Brown Detail	1876	26157	
10. Off White Detail	0170	28166	
11. Small Letters	0170	28166	

80057-21 Umbrellabird Appliqué		I	T
1. Design Placement Stitch	0170	28166	
2. Tackdown	0170	28166	
3. Letter Background Placement Stitch	5633	18154	
4. Cut Line & Tackdown	5633	18154	
5. Green Cover Stitch	5633	18154	
6. Off White Cover Stitch	0170	28166	
7. Letter	0552	20145	
8. Bird	0170	28166	
9. Brown Detail	1876	26157	
10. Off White Detail	0170	28166	
11. Small Letters	0170	28166	

80057-22 Vulture Appliqué		I	T
1. Design Placement Stitch	0170	28166	
2. Tackdown	0170	28166	
3. Letter Background Placement Stitch	1902	12121	
4. Cut Line & Tackdown	1902	12121	
5. Red Cover Stitch	1902	12121	
6. Off White Cover Stitch	0170	28166	
7. Letter	0552	20145	
8. Bird	0170	28166	
9. Brown Detail	1876	26157	
10. Off White Detail	0170	28166	
11. Small Letters	1876	26157	

80057-23 Woodpecker Appliqué		I	T
1. Design Placement Stitch	0170	28166	
2. Tackdown	0170	28166	
3. Letter Background Placement Stitch	1902	12121	
4. Cut Line & Tackdown	1902	12121	
5. Red Cover Stitch	1902	12121	
6. Off White Cover Stitch	0170	28166	
7. Letter	0552	20145	
8. Birds & Branches	0170	28166	
9. Brown Detail	1876	26157	
10. Off White Detail	0170	28166	
11. Small Letters	0170	28166	

80057-24 Xmas Greeting Appliqué		I	T
1. Design Placement Stitch	0170	28166	
2. Tackdown	0170	28166	
3. Letter Background Placement Stitch	5633	18154	
4. Cut Line & Tackdown	5633	18154	
5. Green Cover Stitch	5633	18154	
6. Off White Cover Stitch	0170	28166	
7. Letter	0552	20145	
8. Bird, Letter & Hand	0170	28166	
9. Brown Detail	1876	26157	
10. Off White Detail	0170	28166	
11. Small Letters	0170	28166	

80057-25 Yellow Bird Appliqué		I	T
1. Design Placement Stitch	0170	28166	
2. Tackdown	0170	28166	
3. Letter Background Placement Stitch	5633	18154	
4. Cut Line & Tackdown	5633	18154	
5. Green Cover Stitch	5633	18154	
6. Off White Cover Stitch	0170	28166	
7. Letter	0552	20145	
8. Bird & Branches	0170	28166	
9. Brown Detail	1876	26157	
10. Off White Detail	0170	28166	
11. Small Letters	0170	28166	

80057-26 Zosterops Appliqué		I	T
1. Design Placement Stitch	0170	28166	
2. Tackdown	0170	28166	
3. Letter Background Placement Stitch	1902	12121	
4. Cut Line & Tackdown	1902	12121	
5. Red Cover Stitch	1902	12121	
6. Off White Cover Stitch	0170	28166	
7. Letter	0552	20145	
8. Bird & Branch	0170	28166	
9. Brown Detail	1876	26157	
10. Off White Detail	0170	28166	
11. Small Letters	1876	26157	

1. Print out the necessary pages from the PDF of the appliqué pattern(s).
2. Mark the right side of the pattern pieces so you'll know which direction to lay the pattern on the fabric.
3. Lightly spray the wrong side of the pattern pieces with temporary adhesive spray and allow it to set for a few minutes.
4. Place the pattern pieces on the right side of the fabric and carefully cut them out. **PHOTO 1**
5. Sew the placement stitch on your hooped fabric. **PHOTO 2**
6. With the paper still stuck to the right side of the appliqué fabric, spray the wrong side of the fabric with temporary spray adhesive.
7. Place the fabric inside the sewing placement stitch so that it matches the stitching line, and then remove the paper pattern. **PHOTO 3**
8. Sew the tackdown. **PHOTO 4**
9. Sew the remainder of the design and repeat for any remaining pieces. **PHOTO 5**

NOTE: The patterns are sized for the designs as they were made. If you resize the design, you will need to resize the pattern the same amount. You can print out the pattern at the normal size then copy it on a copy machine at the changed size. For example, resize the designs to 80%, resize the printed pattern to 80%.

TIP: When Printing the patterns, make sure that the "Fit to page" option is UNCHECKED in the Print Dialog Box. If this option is checked the printed patterns will not be actual size.

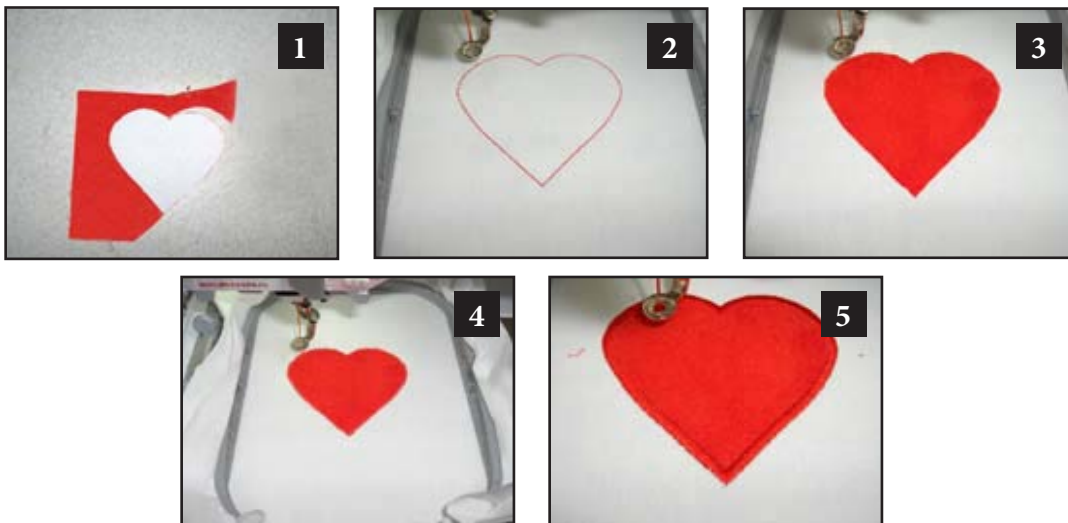

ATTENTION

When printing this document, any page scaling or page fitting options in your print dialog box must be turned OFF or set to NONE so that your files will print out at their actual size. Images not printed at actual size will not function as intended.

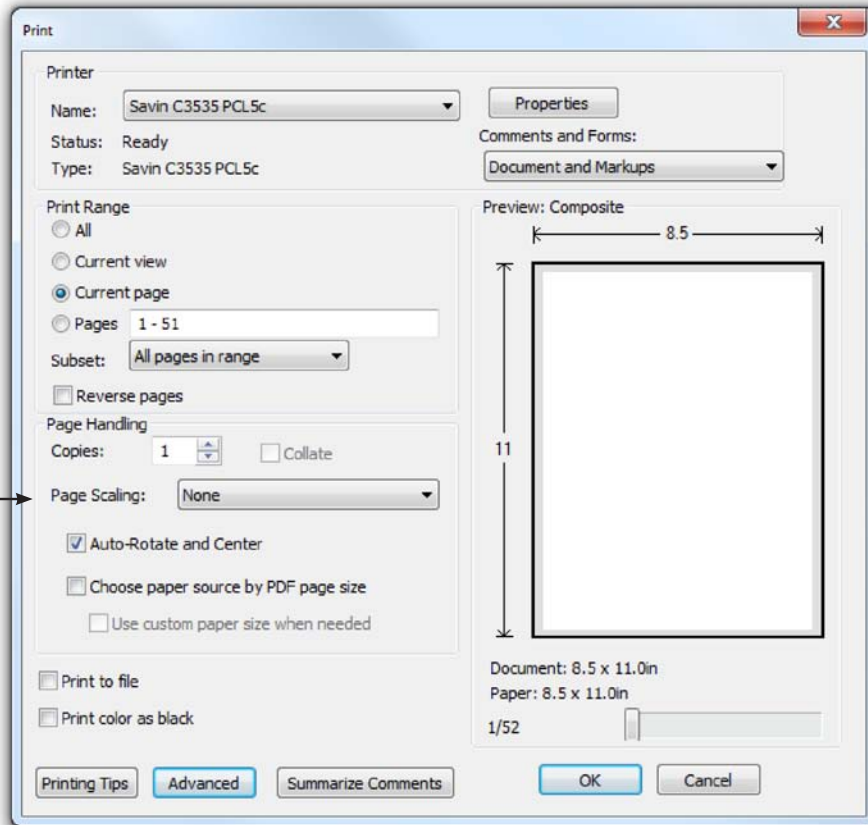

TO SAVE PAPER

Only print the desired image by navigating to the image's page, go to File > Print and select "Current page" in the print dialog box. Repeat for each desired image.

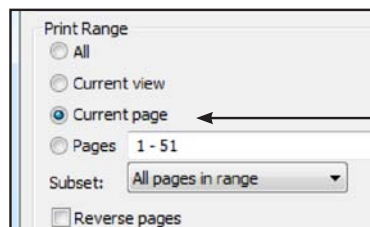

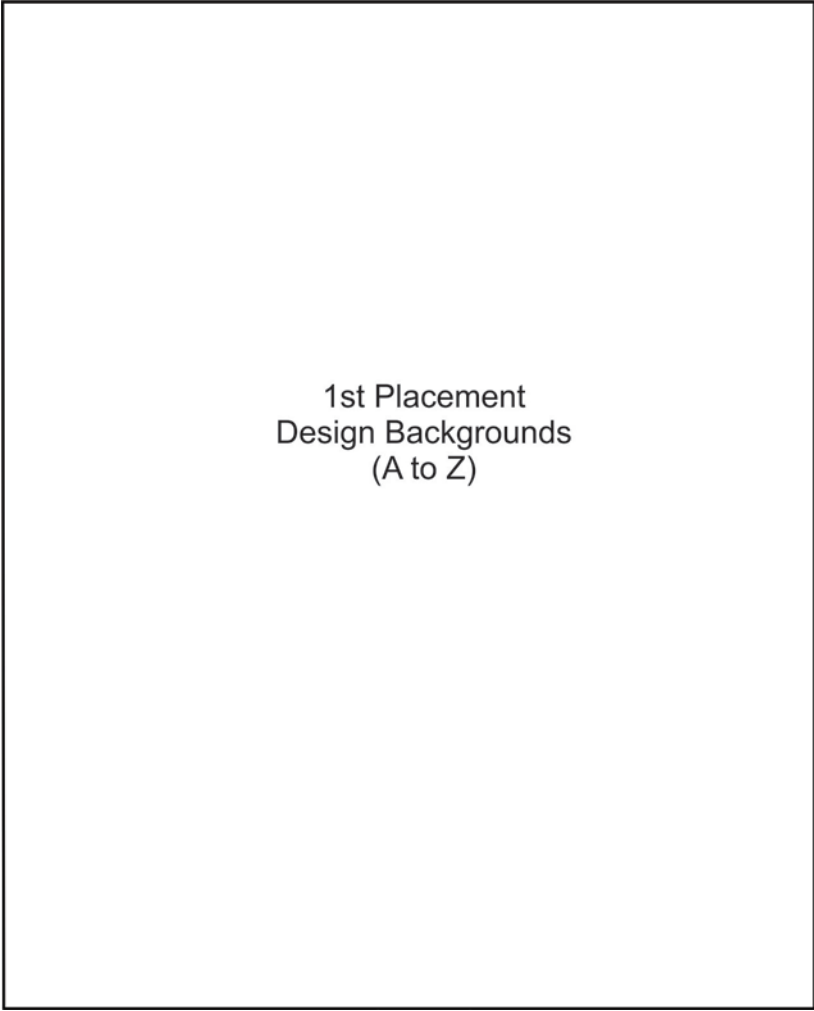

1st Placement
Design Backgrounds
(A to Z)

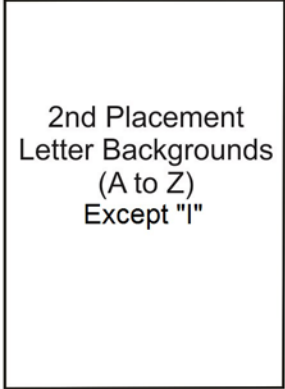

2nd Placement
Letter Backgrounds
(A to Z)
Except "I"

2nd Placement
Letter Background
Letter "I" Only

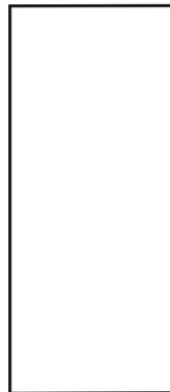

OESD Birds of a Feather by Kaye England #80057 embroidery collection features 26 alphabets of bird appliqué designs. This collection of birds utilizes a simple postcard type appliqué technique. There are many different ways to use the designs. Stitch out one or both of the appliqué pieces. Create a sampler with all the alphabet designs or just choose a few of your favorite birds to stitch. This simple table runner features just a few of the designs.



Supplies

- OESD embroidery collection Birds of a Feather by Kaye England #80057
- 2/3 yd. off-white linen fabric (embroidered blocks and center block)
- 1/4 yd. red fabric (small appliqué and short border)
- 1/4 yd. light green fabric (appliqué and inner border)
- 1 3/4 yd. brown fabric (appliqué, outer border, backing and binding)
- 1/2 yd. or 18" x 55" piece cotton batting
- Embroidery threads
- Medium weight tear away stabilizer
- OESD Appliqué Fuse and Stick (for appliqué pieces)
- Temporary spray adhesive
- Curved safety pins
- Thread for piecing

Cut

- **NOTE:** The bird designs used for the 4 blocks are #80057-04, #80057-14, #80057-19 and #80057-26. They are stitched on off-white linen fabric.
- Fabrics for large appliqué using templates and OESD Appliqué Fuse and Stick following manufacturer's directions.
- (4) 12" x 14" off-white linen fabric for embroidered blocks
- (8) 12" x 14" medium weight tear away stabilizer
- (1) 10" square off-white linen fabric (center block)
- (4) 2" x 10" red fabric (short border)
- (3) 1" x width light green fabric (inner border)
- (4) 3 1/2" x width brown fabric (outer border)
- (1) 18" x 55" brown fabric (back)(will have to piece)
- (3) 2 1/4" x 44" brown fabric (binding)

Embroider

NOTE: There are two appliqués in each design.

- Using temporary spray adhesive, spray between two layers of 12" x 14" pieces tear away stabilizer and adhere to each other and to the wrong side of the corresponding off-white linen fabric. Hoop the layers. Embroider one of the bird designs. Remove from hoop and remove stabilizer. Repeat for the remaining three bird designs. **PHOTO 1**

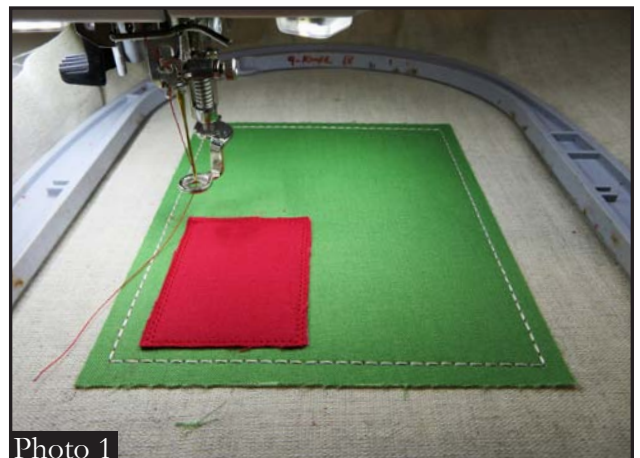

Photo 1

Assembly: 1/4" seam allowance

- Cut the embroidered blocks to measure 10" square with the appliqué to the bottom left of each block. Arrange the birds in the order you want them placed in the table runner with a red short border in between each block and the center block placed in the center.

PHOTO 2

- Right sides together, stitch the blocks and short border pieces. Press. **PHOTO 3**
- Right sides together, stitch an inner border to the long side. Repeat for the other side. Press. Right sides together, stitch an inner border to the short end. Repeat for the other end. Press. **PHOTO 4**

- Right sides together, stitch each long border to either side of the center section. Press. Right sides together, stitch each long border to either end of the center section. (Table runner top)

- Layer a quilt sandwich, by placing back wrong side up, cotton batting, and the tablerunner top right side up. Use curved safety pins to baste the layers together. **PHOTO 5**

- Quilt as desired. Free-motion quilting was the technique used around each of the designs in the blocks, center block and in the outer borders. **PHOTO 6**

- Square up the tablerunner, this is trimming the tablerunner until the sides are equal. This prepares the table runner for stitching on the binding. Stitch on the binding as desired. For stitching on the binding the mitered corner technique was used.



