

Note: Some designs in this collection may have been created using unique special stitches and/or techniques. To preserve design integrity when rescaling or rotating designs in your software, always rescale or rotate designs using the handles directly on-screen.



**80061-01 Route 66 Boot 1**  
**Appliqué**  
 4.94 X 6.04 in.  
 125.48 X 153.42 mm  
 34,215 St. **L**



**80061-02 Route 66 Boot 1**  
**Linework**  
 4.83 X 5.99 in.  
 122.68 X 152.15 mm  
 38,614 St. **L**



**80061-03 Route 66 Boot 1**  
**Linework**  
 5.27 X 6.50 in.  
 133.86 X 165.10 mm  
 13,169 St. **⌘ L**



**80061-04 Route 66 Boot 2**  
**Appliqué**  
 5.47 X 6.07 in.  
 138.94 X 154.18 mm  
 31,370 St. **L**



**80061-05 Route 66 Boot 2**  
**Appliqué**  
 5.41 X 6.02 in.  
 137.41 X 152.91 mm  
 39,611 St. **L**



**80061-06 Route 66 Boot 2**  
**Linework**  
 5.40 X 6.00 in.  
 137.16 X 152.40 mm  
 11,858 St. **⌘ L**



**80061-07 Route 66 Neon Sign**  
**Linework**  
 6.91 X 3.87 in.  
 175.51 X 98.30 mm  
 52,738 St. **L**



**80061-08 Route 66 Road Sign**  
**Appliqué**  
 1.85 X 1.99 in.  
 46.99 X 50.55 mm  
 7,696 St.



**80061-09 Route 66 Strap**  
**Appliqué**  
 .74 X 1.93 in.  
 18.80 X 49.02 mm  
 2,887 St. **S**



**80061-10 Chili Peppers**  
**Appliqué**  
 2.75 X 1.13 in.  
 69.85 X 28.70 mm  
 4,040 St. **⊗ S**



**80061-11 Horseshoes**  
**Appliqué**  
 1.66 X 1.22 in.  
 42.16 X 30.99 mm  
 1,699 St. **S**



**80061-12 Lone Star Medallion**  
**Appliqué**  
 1.37 X 1.39 in.  
 34.80 X 35.31 mm  
 4,007 St. **S**

⌘ Design contains a loose fill.

⊗ Some solid areas shown are not stitched.

**L** Design is larger than 5" (127 mm) in either direction.

**S** Design is smaller than 1.5" (38.1 mm) in either direction.

It is a violation of Copyright law to make and distribute copies of electronic designs or artwork.

Electronic designs are licensed to the original purchaser for use at one location. ©2015 Jacqueline Decker Designs. All rights reserved.

Note: Some designs in this collection may have been created using unique special stitches and/or techniques. To preserve design integrity when rescaling or rotating designs in your software, always rescale or rotate designs using the handles directly on-screen.



**80061-13 Paisley 1**  
1.17 X 1.15 in.  
29.72 X 29.21 mm  
1,225 St.  **S**



**80061-14 Paisley 2**  
2.29 X 1.82 in.  
58.17 X 46.23 mm  
4,446 St. 



**80061-15 Paisley 3**  
1.28 X 1.31 in.  
32.51 X 33.27 mm  
1,522 St.  **S**





**80061-16 Cactus Border**  
5.01 X 1.52 in.  
127.25 X 38.61 mm  
4,341 St. **L**



**80061-17 Cactus Corner**  
.82 X 1.43 in.  
20.83 X 36.32 mm  
723 St. **S**



**80061-18 Route 66 Get Your Kicks**  
4.64 X 2.17 in.  
117.86 X 55.12 mm  
4,582 St. 

**80061-19 Route 66**  
3.84 X .95 in.  
97.54 X 24.13 mm  
2,182 St.  **S**

**80061-20 Get Your Kicks**  
4.40 X 1.10 in.  
111.76 X 27.94 mm  
2,628 St.  **S**

 Design contains a loose fill.

 Some solid areas are not stitched.

**L** Design is larger than 5" (127 mm) in either direction.

**S** Design is smaller than 1.5" (38.1 mm) in either direction.

It is a violation of Copyright law to make and distribute copies of electronic designs or artwork.

Electronic designs are licensed to the original purchaser for use at one location. ©2015 Jacqueline Decker Designs. All rights reserved.



# Everyday Icons

by Jackie Decker / #80061 / 20 Designs

Listings below indicate color sample, stitching order and suggested thread color number. Most numbers indicate Isacord thread. Colors beginning with 20501 refer to YLI Fine Metallics, 7 refer to Yenmet Metallic, 8 refer to YLI Variations Variegated Thread and 9 refer to Isacord Multicolor Variegated.

## 80061-01 Route 66 Boot 1 Appliqué

1. Upper Gold Boot Placement Stitch	4174
2. Upper Gold Boot Cut Line & Tackdown	4174
3. Lower Brown Boot Placement Stitch	4174
4. Lower Brown Boot Cut Line & Tackdown	4174
5. Upper Boot Rust Detail	1342
6. Turquoise Detail	4113
7. Light Yellow Detail	0640
8. Gold Detail	0704
9. Light Green Detail	5822
10. Dark Green Detail	5933
11. Yellow Sun	0713
12. Red Detail	2101
13. White Detail	0015
14. Booty Heel & Sole	1355
15. Boot Heel & Sole Shading	1876
16. Cover Stitch & Outlines	4174
17. Dots	1342

## 80061-02 Route 66 Boot 1

1. Rust Boot Detail	1342
2. Turquoise Detail	4113
3. Light Yellow Detail	0640
4. Gold Boot Detail	0704
5. Light Green Detail	5822
6. Dark Green Detail	5933
7. Yellow Sun	0713
8. Red Detail	2101
9. White Detail	0015
10. Boot Heel & Sole	1355
11. Boot Heel & Sole Shading	1876
12. Design Outlines	4174
13. Rust Dots	1342

## 80061-03 Route 66 Boot 1 Linework

1. Single Color Design	4174
------------------------	------

## 80061-04 Route 66 Boot 2 Appliqué

1. Blue Part of Boot Placement Stitch	4174
2. Blue Part of Boot Cut Line & Tackdown	4174
3. Red Part of Boot Placement Stitch	4174
4. Red Part of Boot Cut Line & Tackdown	4174
5. Light Blue Detail	3750
6. Off White Detail	0870
7. Red Detail	2101
8. Turquoise Detail	3920
9. Tan Detail	0832
10. Light Yellow Detail	0640
11. Boot Heel & Sole	1355
12. Boot Heel & Sole Shading	1876
13. White Paisley Detail	0015
14. Cover Stitch & Detail	4174
15. Strap Detail	1355
16. Dark Red Boot Detail	2123
17. Medium Blue Boot Detail	3641
18. Dots	1355

## 80061-05 Route 66 Boot 2

1. Dark Blue on Boot	3611
2. Light Blue Detail	3750
3. Off White Detail	0870
4. Red Detail	2101
5. Turquoise Detail	3920
6. Tan Detail	0832
7. Light Yellow Detail	0640
8. Boot Heel & Sole	1355
9. Boot Heel & Sole Shading	1876
10. White Paisley Detail	0015
11. Dark Gray Outlines	4174
12. Strap Detail	1355
13. Dark Red Boot Detail	2123
14. Medium Blue Boot Detail	3641
15. Dots	1355

## 80061-06 Route 66 Boot 2 Linework

1. Single Color Design	4174
------------------------	------

## 80061-07 Route 66 Neon Sign

1. Blue Detail	3611
2. Dark Blue Shading	3645
3. Light Yellow Detail	0640
4. Light Yellow Letter Outlines	4174
5. Yellow Detail	0713
6. Gold Detail	0704
7. Bronze Outlines	1032
8. Red Detail	2101
9. Light Gray Detail	0145
10. White Detail	0015
11. Sign Outlines	4174
12. Adventure Awaits & Bulbs	0640

## 80061-08 Route 66 Road Sign

1. Blue Detail	4113
2. Red Detail	2101
3. White Detail	0015
4. Outlines & Letters	4174

## 80061-09 Route 66 Strap

1. Strap	0832
2. Strap Outlines	4174
3. Letters & Numbers	1355

## 80061-10 Chili Peppers

1. Leaves	5933
2. Peppers	2101
3. Outlines	4174

## 80061-11 Horseshoes

1. Horseshoes	0704
2. Design Outlines	4174
3. Dots	1342

## 80061-12 Lone Star Medallion

1. Blue Detail	3920
2. Off White Star	0870
3. Tan Star	0832
4. Yellow Detail	0640
5. Design Outlines	4174
6. Dots & Linework	1355

## 80061-13 Paisley 1

1. Light Blue Detail	3962
2. Dark Blue Detail	3920

## 80061-14 Paisley 2

1. Light Blue Detail	3962
2. Dark Blue Detail	3920

## 80061-15 Paisley 3

1. Light Blue Detail	3962
2. Dark Blue Detail	3920

## 80061-16 Cactus Border

1. Light Green Cactus	5822
2. Dark Green Cactus	5933

## 80061-17 Cactus Corner

1. Light Green Cactus	5822
2. Dark Green Cactus	5933

## 80061-18 Route 66 Get Your Kicks

1. Yellow Letters	0640
2. Red Letters & Numbers	2101

## 80061-19 Route 66

1. Single Color Design	2101
------------------------	------

## 80061-20 Get Your Kicks

1. Single Color Design	0640
------------------------	------

1. Print out the necessary pages from the PDF of the appliqué pattern(s).
2. Mark the right side of the pattern pieces so you'll know which direction to lay the pattern on the fabric.
3. Lightly spray the wrong side of the pattern pieces with temporary adhesive spray and allow it to set for a few minutes.
4. Place the pattern pieces on the right side of the fabric and carefully cut them out. **PHOTO 1**
5. Sew the placement stitch on your hooped fabric. **PHOTO 2**
6. With the paper still stuck to the right side of the appliqué fabric, spray the wrong side of the fabric with temporary spray adhesive.
7. Place the fabric inside the sewing placement stitch so that it matches the stitching line, and then remove the paper pattern. **PHOTO 3**
8. Sew the tackdown. **PHOTO 4**
9. Sew the remainder of the design and repeat for any remaining pieces. **PHOTO 5**

**NOTE:** The patterns are sized for the designs as they were made. If you resize the design, you will need to resize the pattern the same amount. You can print out the pattern at the normal size then copy it on a copy machine at the changed size. For example, resize the designs to 80%, resize the printed pattern to 80%.

**TIP:** When Printing the patterns, make sure that the “Fit to page” option is **UNCHECKED** in the Print Dialog Box. If this option is checked the printed patterns will not be actual size.

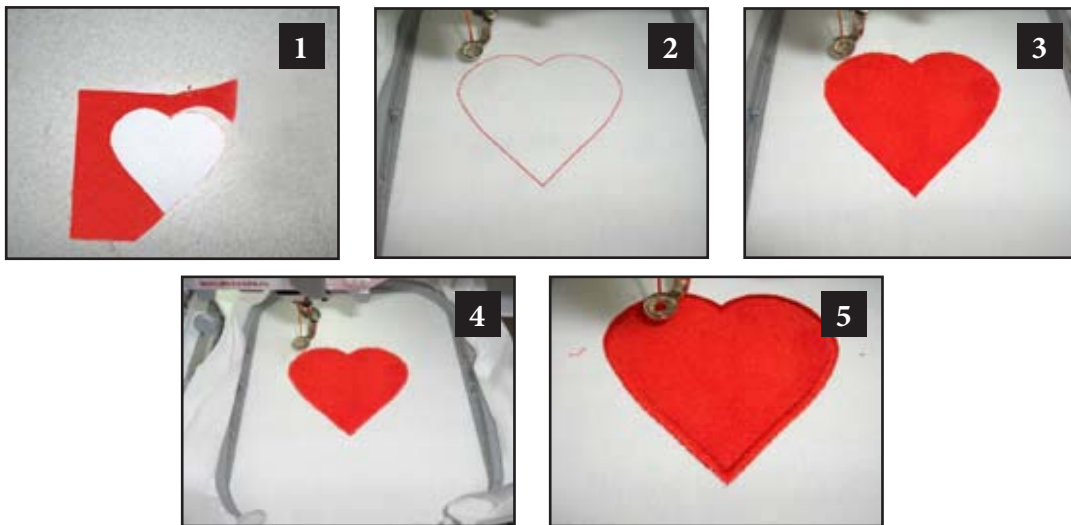

## ATTENTION

When printing this document, any page scaling or page fitting options in your print dialog box must be turned OFF or set to NONE so that your files will print out at their actual size. Images not printed at actual size will not function as intended.

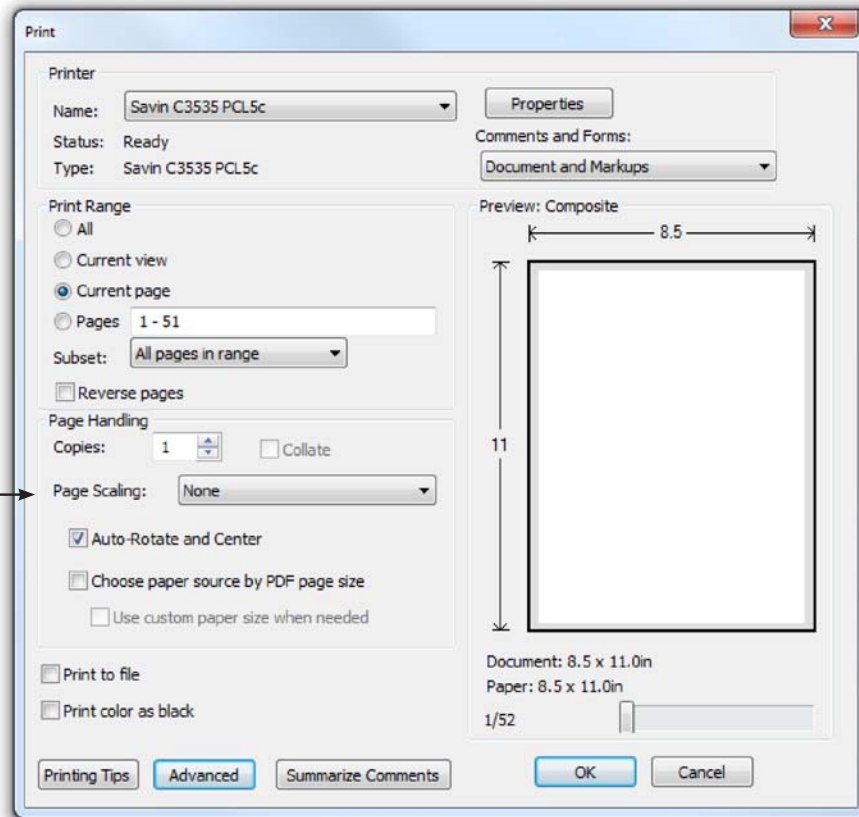

## TO SAVE PAPER

Only print the desired image by navigating to the image's page, go to File > Print and select "Current page" in the print dialog box. Repeat for each desired image.

