

Note: Some designs in this collection may have been created using unique special stitches and/or techniques. To preserve design integrity when rescaling or rotating designs in your software, always rescale or rotate designs using the handles directly on-screen.



80062-01 Garden Cross Appliqué
4.45 X 6.02 in.
113.03 X 152.91 mm
26,283 St. **L**



80062-02 Vine Cross Appliqué
4.30 X 6.46 in.
109.22 X 164.08 mm
25,665 St. **L**



80062-03 Heart Cross Appliqué
4.39 X 6.76 in.
111.51 X 171.70 mm
34,990 St. **L**



80062-04 Butterfly Cross Appliqué
4.66 X 6.71 in.
118.36 X 170.43 mm
33,519 St. **L**



80062-05 Love Flower Appliqué
2.47 X 6.73 in.
62.74 X 170.94 mm
12,789 St. **L**



80062-06 Faith Flower Appliqué
3.14 X 6.72 in.
79.76 X 170.69 mm
25,272 St. **⊗ L**



80062-07 Hope Flower Appliqué
3.23 X 6.27 in.
82.04 X 159.26 mm
28,577 St. **L**



80062-08 Love Lives Here Heart Appliqué
2.26 X 1.99 in.
57.40 X 50.55 mm
4,359 St.



80062-09 Butterfly Medallion Appliqué
2.29 X 2.26 in.
58.17 X 57.40 mm
8,208 St.



80062-10 Nest
.84 X .73 in.
21.34 X 18.54 mm
1,697 St. **⊗ S**



80062-11 Bird
.94 X .78 in.
23.88 X 19.81 mm
1,374 St. **S**



80062-12 Blessed
2.01 X .71 in.
51.05 X 18.03 mm
1,526 St. **⊗ S**

⊗ Design contains a loose fill.

⊗ Some solid areas shown are not stitched.

L Design is larger than 5" (127 mm) in either direction.

S Design is smaller than 1.5" (38.1 mm) in either direction.

It is a violation of Copyright law to make and distribute copies of electronic designs or artwork.

Electronic designs are licensed to the original purchaser for use at one location. ©2015 Jacqueline Decker Designs. All rights reserved.

Note: Some designs in this collection may have been created using unique special stitches and/or techniques. To preserve design integrity when rescaling or rotating designs in your software, always rescale or rotate designs using the handles directly on-screen.



80062-13 Hope

1.45 X 1.36 in.
36.83 X 34.54 mm
1,547 St. ⚙️ S

80062-14 Faith

1.51 X 1.14 in.
38.35 X 28.96 mm
1,090 St. ⚙️ S

80062-15 Love

1.49 X 1.41 in.
37.85 X 35.81 mm
1,321 St. ⚙️ S

⚙️ Design contains a loose fill.

⚙️ Some solid areas shown are not stitched.

L Design is larger than 5" (127 mm) in either direction.

S Design is smaller than 1.5" (38.1 mm) in either direction.

It is a violation of Copyright law to make and distribute copies of electronic designs or artwork.

Electronic designs are licensed to the original purchaser for use at one location. ©2015 Jacqueline Decker Designs. All rights reserved.



Everyday Blessings

by Jackie Decker / #80062 / 15 Designs

Listings below indicate color sample, stitching order and suggested thread color number. Most numbers indicate Isacord thread. Colors beginning with 20501 refer to YLI Fine Metallics, 7 refer to Yenmet Metallic, 8 refer to YLI Variations Variegated Thread and 9 refer to Isacord Multicolor Variegated.

80062-01 Garden Cross Appliqué

1. Cross Placement Stitch.....	3650
2. Cut Line & Tackdown.....	3650
3. Light Green Leaves & Grass.....	5740
4. Green Leaves.....	5531
5. Light Green Leaves.....	5912
6. Flowers.....	3350
7. Flower Shading & Wings.....	2830
8. Peach Detail.....	1352
9. Dark Orange Detail.....	1521
10. Red Detail.....	1800
11. Pink Detail.....	2530
12. Yellow Detail.....	0506
13. Orange Detail.....	1200
14. Dark Green Detail.....	5335
15. Blue Cover Stitch.....	3650
16. Cross Tips Cover Stitch.....	1351
17. Butterfly Body.....	1521
18. Wing Shading.....	0506
19. Design Outlines.....	4174

80062-02 Vine Cross Appliqué

1. Cross Placement Stitch.....	3450
2. Cut Line & Tackdown.....	3450
3. Green Leaves.....	5912
4. Dark Green Leaves.....	5100
5. Blue Green Leaves.....	5115
6. Light Green Leaves.....	6031
7. Mint Leaves.....	5740
8. Stems.....	6156
9. Birds.....	3962
10. Bird Shading.....	3910
11. Eggs.....	4240
12. Egg Highlights & Wings.....	0101
13. Bird Chest & Wings.....	1351
14. Chest Shading.....	1521
15. Nest and Wings.....	0640
16. Yellow Detail.....	0506
17. Design Outlines.....	4174
18. Cover Stitch.....	3450

80062-03 Heart Cross Appliqué

1. Cross Placement Stitch.....	0640
2. Cut Line & Tackdown.....	0640
3. Light Green Leaves.....	6031
4. Green Leaves.....	5912
5. Dark Green Stems & Outlines.....	5722
6. Birds & Petals.....	3910
7. Bird Wings & Petals.....	3962
8. Light Orange Bird Chest & Flowers.....	1351
9. Medium Red Petals & Shading.....	1521
10. Pink Petals & Wing.....	2530
11. Purple Petals & Wings.....	2810
12. Yellow Petals & Beaks.....	0506
13. Orange Petals & Stamens.....	1200
14. Design Outlines.....	4174
15. Cross Tips.....	1521
16. Cover Stitch.....	0640
17. Heart Placement Stitch.....	2152
18. Cut Line & Tackdown.....	2152
19. Heart Vines & Lives.....	5912
20. Love.....	2810
21. Here & Hearts.....	1800
22. Heart Cover Stitch.....	2152

80062-04 Butterfly Cross Appliqué

1. Cross Placement Stitch.....	0640
2. Cut Line & Tackdown.....	0640
3. Light Green Leaves.....	6031
4. Green Leaves.....	5912
5. Stems & Outlines.....	5722
6. Purple Detail.....	3350
7. Dark Purple Detail.....	2830
8. Light Blue Detail.....	3962
9. Dark Blue Detail.....	3910
10. Pink Petals & Heart.....	2530
11. Light Orange Petals.....	1351
12. Medium Red Petals.....	1521
13. Cover Stitch.....	0640
14. Circle Placement Stitch.....	3450
15. Cut Line & Tackdown.....	3450
16. Yellow Detail.....	0506
17. Orange Detail.....	1200
18. Red Detail.....	1800
19. Green Vine.....	5912
20. Butterfly Blue Detail.....	3910
21. Circle Cover Stitch.....	3450
22. Design Outlines.....	4174
23. Yellow Petals on Wings.....	0506
24. White Stamens on Wings.....	0015

80062-05 Love Flower Appliqué

1. Flower Placement Stitch.....	1800
2. Cut Line & Tackdown.....	1800
3. Leaves Placement Stitch.....	5730
4. Cut Line & Tackdown.....	5730
5. Leaf Detail.....	5912
6. Stems.....	6031
7. Stem Detail.....	5555
8. Leaves Cover Stitch.....	5730
9. Flower Cover Stitch.....	1800
10. Pot Placement Stitch.....	3611
11. Cut Line & Tackdown.....	3611
12. Pot Cover Stitch.....	3611
13. Light Purple Detail.....	2830
14. Light Blue Detail.....	3962
15. Heart & Ribbon.....	1521
16. Heart & Ribbon Shading.....	1800
17. Rim Outline.....	2810
18. Heart & Word Outlines.....	0015
19. Rim Details.....	4174

80062-06 Faith Flower Appliqué

1. Pot Placement Stitch.....	3641
2. Cut Line & Tackdown.....	3641
3. Stamen Placement Stitch.....	0640
4. Cut Line & Tackdown.....	0640
5. Pot Stipple.....	3953
6. Light Yellow Detail.....	0640
7. Orange Detail.....	1200
8. Yellow Detail.....	0506
9. Dark Yellow Detail.....	0811
10. Purple Detail.....	2810
11. Pot Cover Stitch & Detail.....	3641
12. Red Detail.....	1800
13. Light Red Detail.....	1521
14. Mint Leaves & Rim.....	5740
15. Light Orange Detail.....	1351
16. Pot Cover Stitch & Detail.....	2530
17. Stamen Cover Stitch.....	0640
18. Light Green Detail.....	6031
19. Green Detail.....	5912
20. White Petals.....	0015
21. Design Outlines & Detail.....	4174

80062-07 Hope Flower Appliqué

1. Stamen Placement Stitch.....	0506
2. Cut Line & Tackdown.....	0506
3. Yellow Detail.....	0506
4. Light Blue Detail.....	3962
5. Dark Blue Detail.....	3910
6. Blue Green Dots.....	5115
7. Dark Blue Dots.....	3901
8. Dark Purple Dots.....	3210
9. Light Yellow Pot Detail.....	0640
10. Light Green Detail.....	6031
11. Medium Purple Detail.....	2830
12. Bug.....	2530
13. Red Detail.....	1800
14. Light Orange Detail.....	1351
15. Green Detail.....	5912
16. Stamen Cover Stitch.....	0506
17. Pot Outlines.....	4174

80062-08 Love Lives Here Heart Appliqué

1. Heart Placement Stitch.....	2152
2. Cut Line & Tackdown.....	2152
3. Lives & Vines.....	5912
4. Love.....	2810
5. Here & Hearts.....	1800
6. Heart Cover Stitch.....	2152

80062-09 Butterfly Medallion Appliqué

1. Circle Placement Stitch.....	3450
2. Cut Line & Tackdown.....	3450
3. Butterfly Wings.....	0506
4. Butterfly Wings Shading.....	1200
5. Red Detail.....	1800
6. Green Detail.....	5912
7. Blue Detail.....	3910
8. Circle Cover Stitch.....	3450
9. Design Outlines.....	4174
10. Yellow Flowers.....	0506
11. White Stamen.....	0015

80062-10 Nest

1. Eggs.....	4240
2. Egg Highlights.....	0101
3. Nest.....	0640
4. Nest Shading.....	0506
5. Design Outlines.....	4174

80062-11 Bird

1. Light Blue Bird.....	3962
2. Shading.....	3910
3. Wing.....	0101
4. Stomach.....	1351
5. Stomach Shading.....	1521
6. Beak & Wing Detail.....	0506
7. Outlines.....	4174

80062-12 Blessed

1. Single Color Design.....	4174
-----------------------------	------

80062-13 Hope

1. Single Color Design.....	1800
-----------------------------	------

80062-14 Faith

1. Single Color Design.....	2810
-----------------------------	------

80062-15 Love

1. Single Color Design.....	2830
-----------------------------	------

It is a violation of Copyright law to make and distribute copies of electronic designs or artwork.

Electronic designs are licensed to the original purchaser for use at one location. ©2015 Jacqueline Decker Designs. All rights reserved.

1. Print out the necessary pages from the PDF of the appliqué pattern(s).
2. Mark the right side of the pattern pieces so you'll know which direction to lay the pattern on the fabric.
3. Lightly spray the wrong side of the pattern pieces with temporary adhesive spray and allow it to set for a few minutes.
4. Place the pattern pieces on the right side of the fabric and carefully cut them out. **PHOTO 1**
5. Sew the placement stitch on your hooped fabric. **PHOTO 2**
6. With the paper still stuck to the right side of the appliqué fabric, spray the wrong side of the fabric with temporary spray adhesive.
7. Place the fabric inside the sewing placement stitch so that it matches the stitching line, and then remove the paper pattern. **PHOTO 3**
8. Sew the tackdown. **PHOTO 4**
9. Sew the remainder of the design and repeat for any remaining pieces. **PHOTO 5**

NOTE: The patterns are sized for the designs as they were made. If you resize the design, you will need to resize the pattern the same amount. You can print out the pattern at the normal size then copy it on a copy machine at the changed size. For example, resize the designs to 80%, resize the printed pattern to 80%.

TIP: When Printing the patterns, make sure that the "Fit to page" option is UNCHECKED in the Print Dialog Box. If this option is checked the printed patterns will not be actual size.

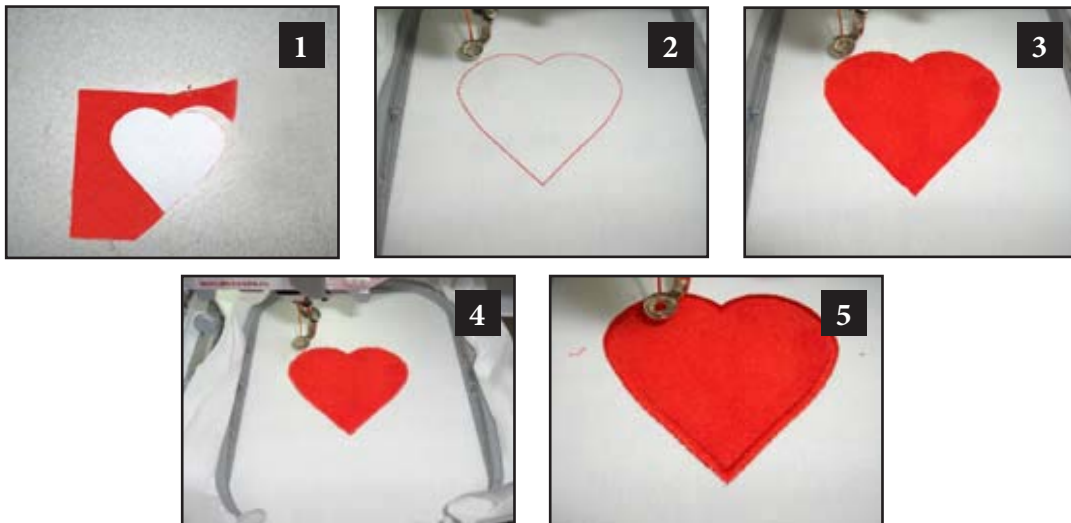

ATTENTION

When printing this document, any page scaling or page fitting options in your print dialog box must be turned OFF or set to NONE so that your files will print out at their actual size. Images not printed at actual size will not function as intended.

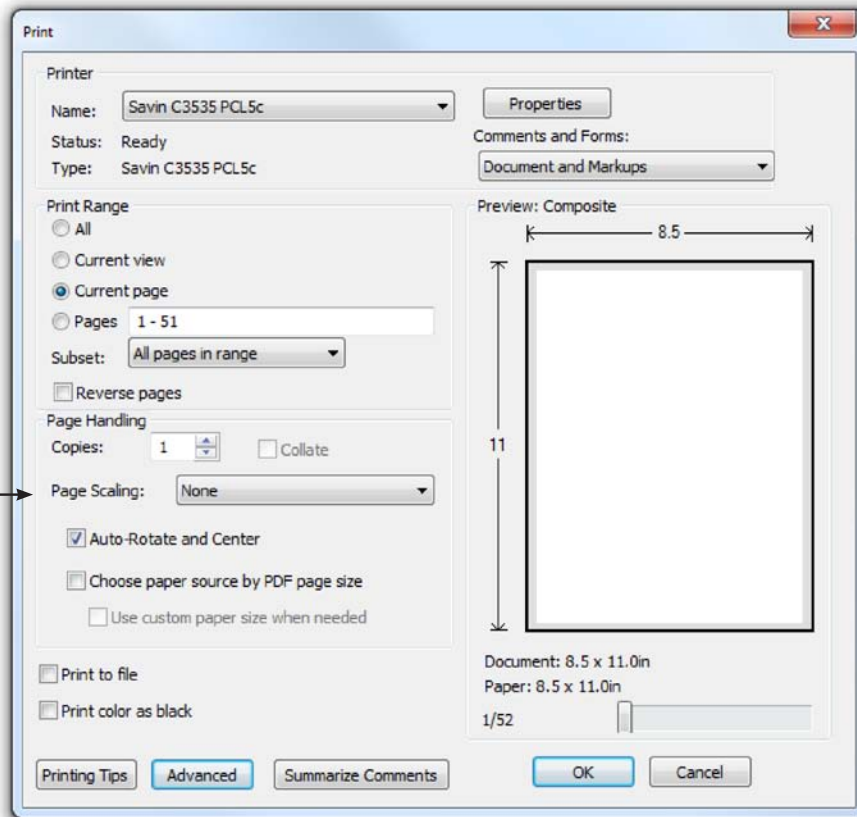

TO SAVE PAPER

Only print the desired image by navigating to the image's page, go to File > Print and select "Current page" in the print dialog box. Repeat for each desired image.

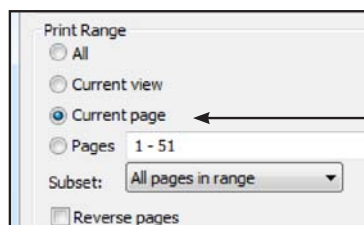

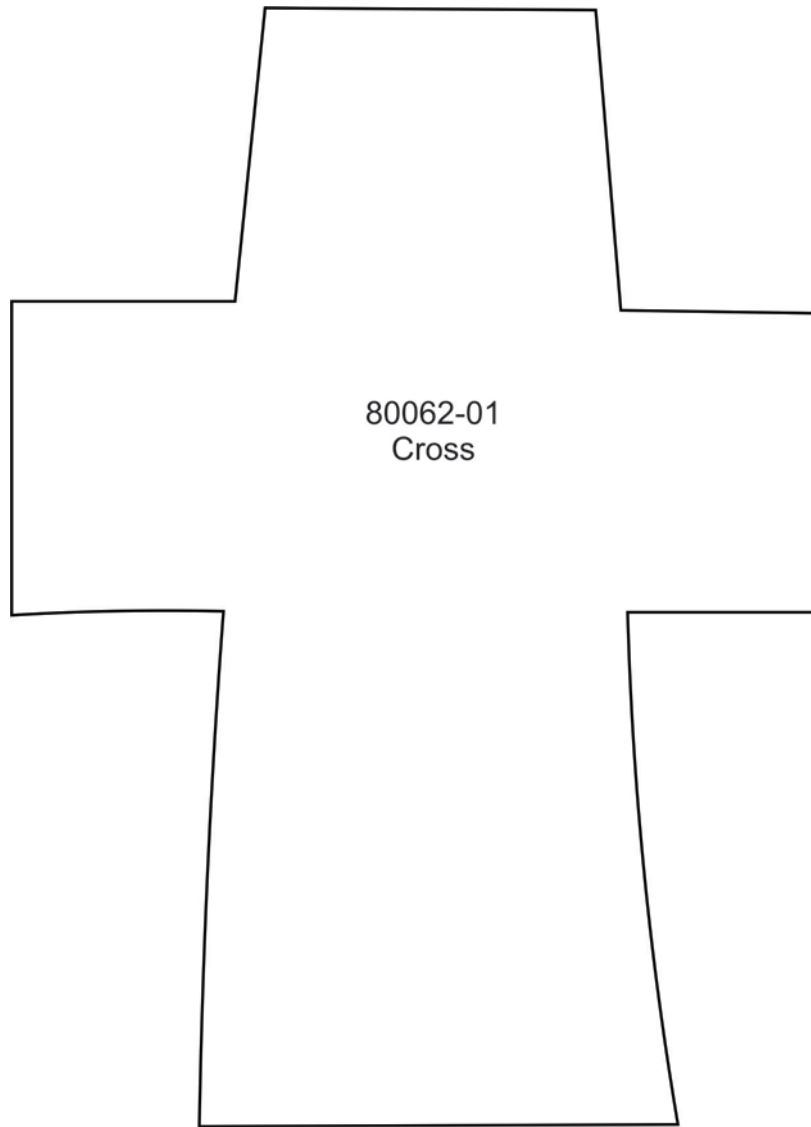

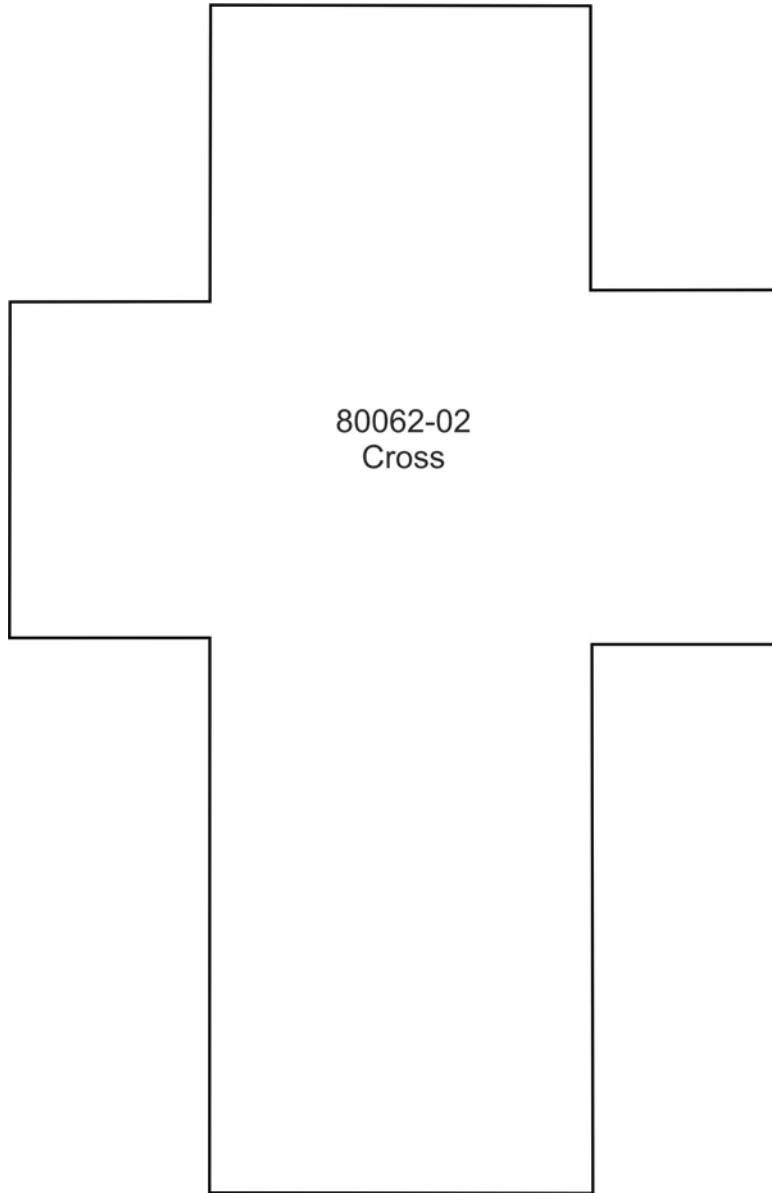

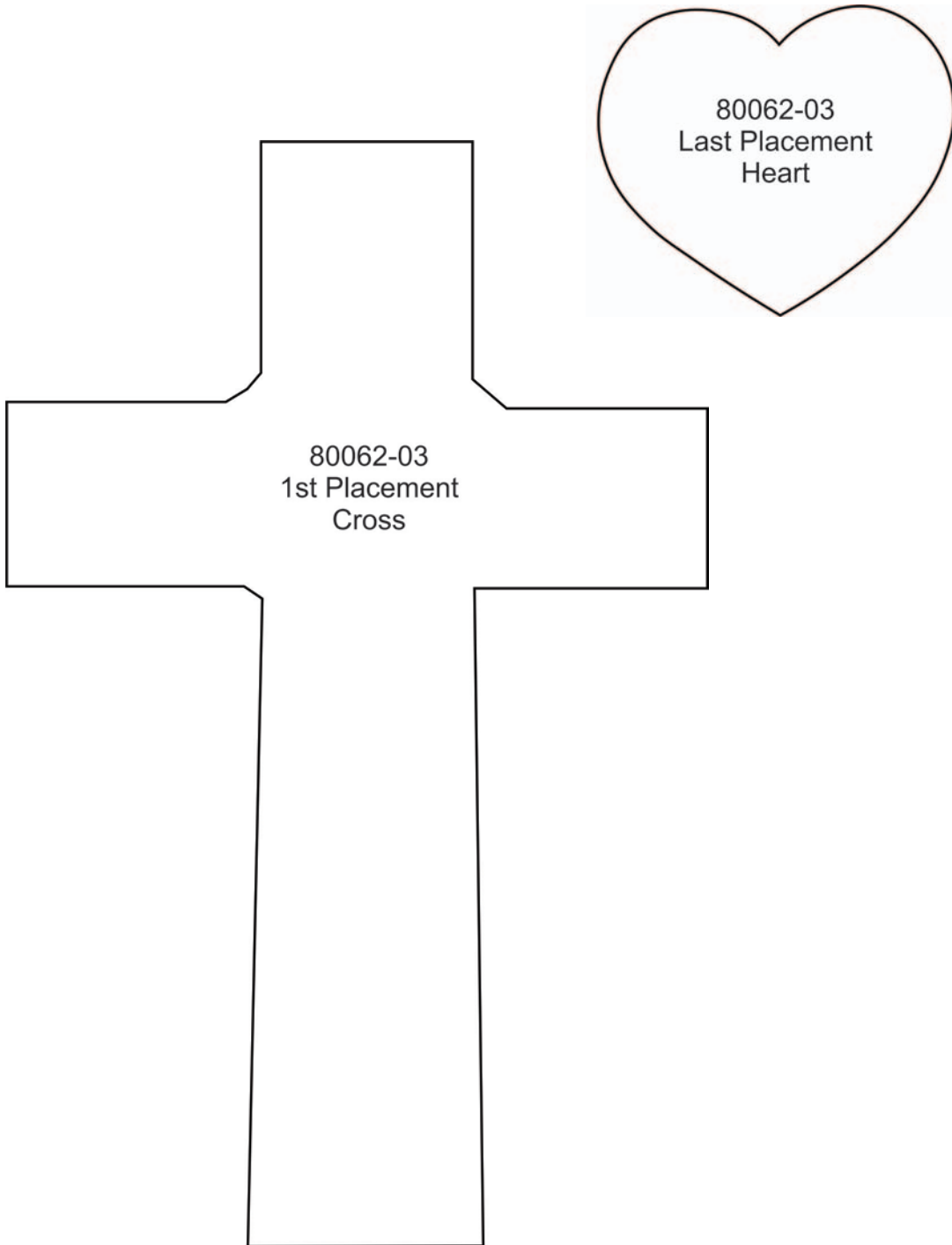

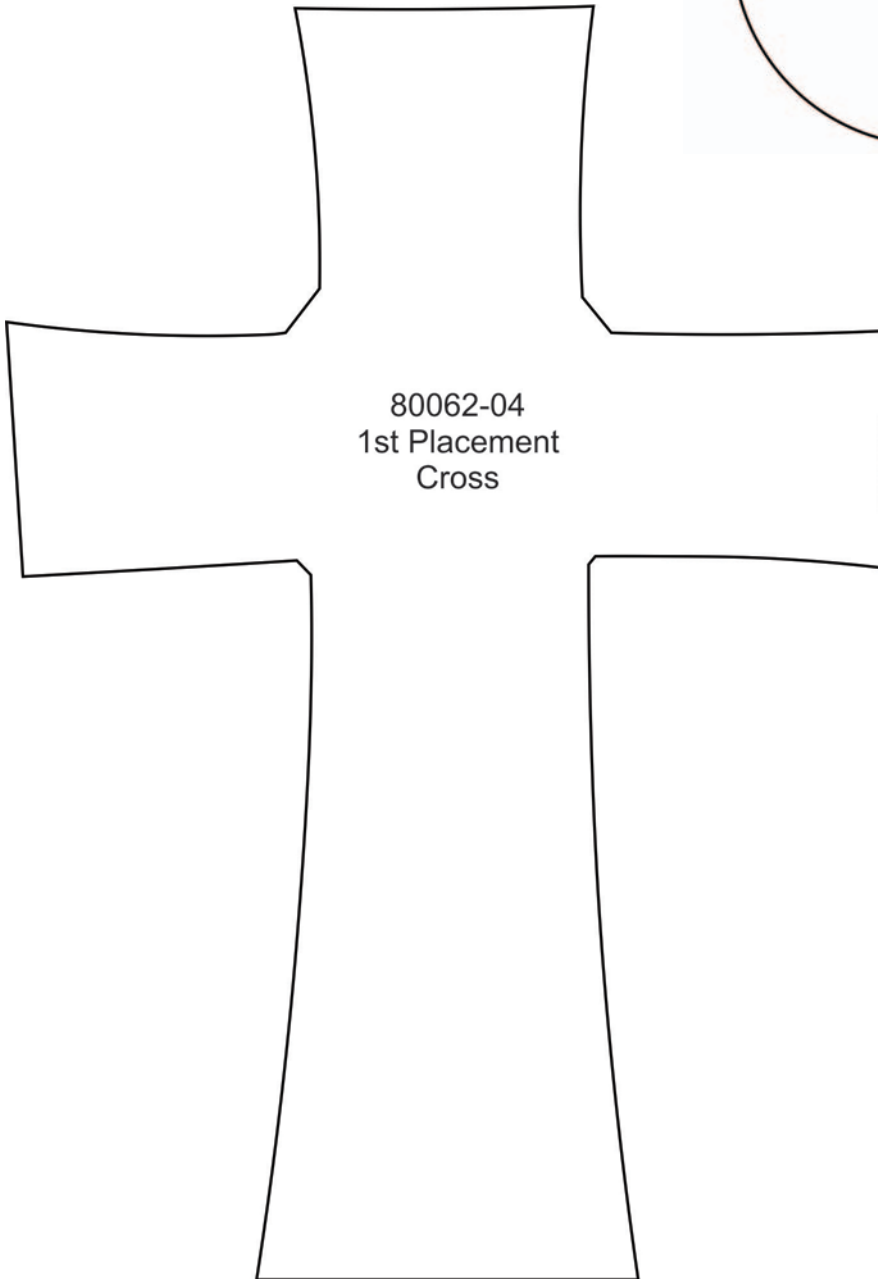

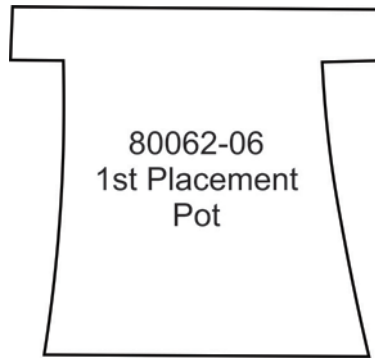
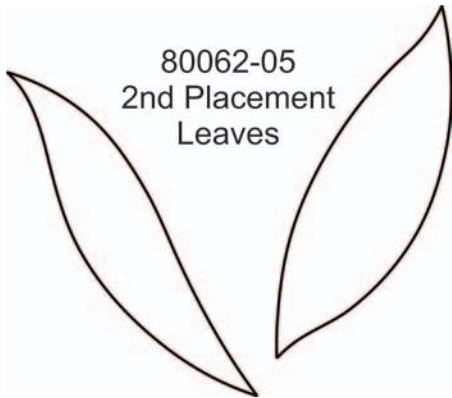

80062-05
Last Placement
Pot

