

Note: Some designs in this collection may have been created using unique special stitches and/or techniques. To preserve design integrity when rescaling or rotating designs in your software, always rescale or rotate designs using the handles directly on-screen.

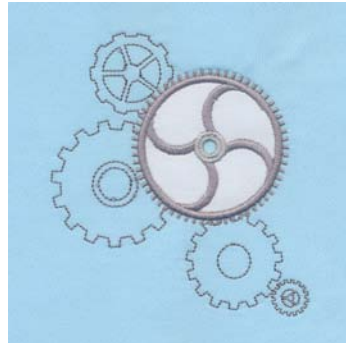

80063-01 Clock Face 1 Appliqué
3.75 X 3.75 in.
95.25 X 95.25 mm
19,232 St. ⚙️🌀



80063-02 Gears Appliqué
3.97 X 4.39 in.
100.84 X 111.51 mm
6,907 St. 🌀

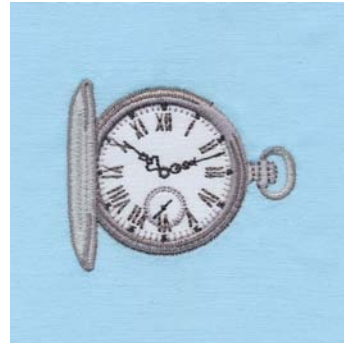

80063-03 Pocket Watch 1 Appliqué
2.44 X 2.05 in.
61.98 X 52.07 mm
5,483 St. 🌀



80063-04 Pocket Watch 2 Appliqué
2.47 X 3.30 in.
62.74 X 83.82 mm
7,625 St. ⚙️🌀



80063-05 Digital Watch Face Appliqué
3.08 X 3.08 in.
78.23 X 78.23 mm
14,392 St.



80063-06 Compass Watch Face Appliqué
3.32 X 3.21 in.
84.33 X 81.53 mm
12,545 St.



80063-07 Gears Clock Face Appliqué
2.16 X 2.16 in.
54.86 X 54.86 mm
8,900 St. ⚙️🌀



80063-08 Gears Appliqué
2.08 X 1.77 in.
52.83 X 44.96 mm
3,143 St. ⚙️🌀

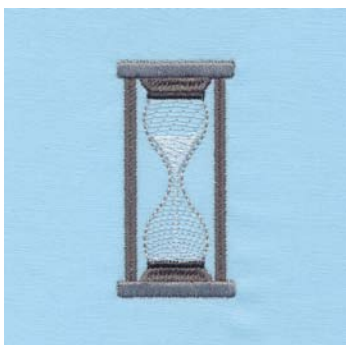

80063-09 Hour Glass Appliqué
1.24 X 2.56 in.
31.50 X 65.02 mm
3,014 St. ⚙️🌀 S

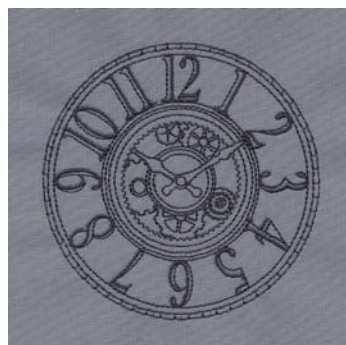

80063-10 Clock Face Linework
3.75 X 3.75 in.
95.25 X 95.25 mm
8,627 St. 🌀

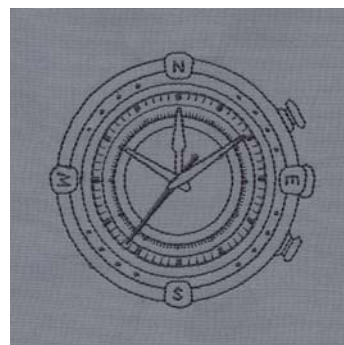

80063-11 Compass Watch Face Linework
3.32 X 3.21 in.
84.33 X 81.53 mm
4,240 St. 🌀

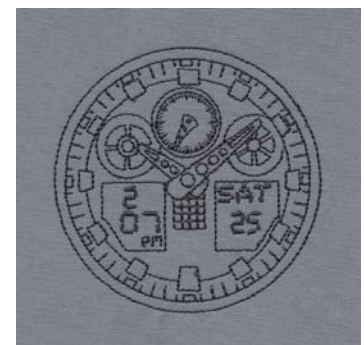

80063-12 Digital Watch Face Linework
3.07 X 3.08 in.
77.98 X 78.23 mm
5,299 St. 🌀

⚙️ Design contains a loose fill.

🌀 Some solid areas shown are not stitched.

L Design is larger than 5" (127 mm) in either direction.

S Design is smaller than 1.5" (38.1 mm) in either direction.

It is a violation of Copyright law to make and distribute copies of electronic designs or artwork. Electronic designs are licensed to the original purchaser for use at one location. ©2015 Amanda Murphy Design, LLC. All rights reserved.

Note: Some designs in this collection may have been created using unique special stitches and/or techniques. To preserve design integrity when rescaling or rotating designs in your software, always rescale or rotate designs using the handles directly on-screen.



80063-13 Pocket Watch Linework
 2.47 X 3.30 in.
 62.74 X 83.82 mm
 4,405 St. ⚙️

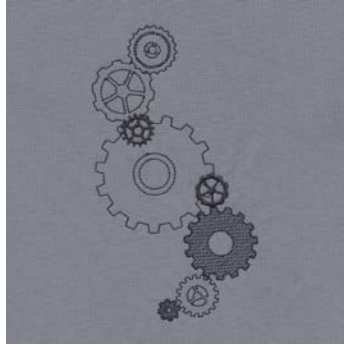

80063-14 Gears 1 Linework
 3.35 X 6.02 in.
 85.09 X 152.91 mm
 5,520 St. ⚙️ ⚙️ L

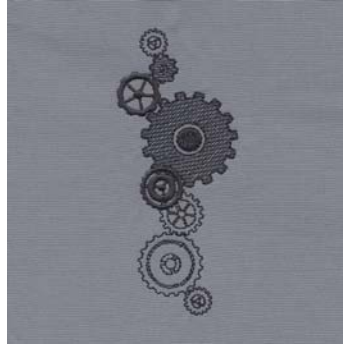

80063-15 Gears 2 Linework
 1.88 X 4.43 in.
 47.75 X 112.52 mm
 5,058 St. ⚙️ ⚙️

⚙️ Design contains a loose fill.

⚙️ Some solid areas shown are not stitched.

L Design is larger than 5" (127 mm) in either direction.

S Design is smaller than 1.5" (38.1 mm) in either direction.

It is a violation of Copyright law to make and distribute copies of electronic designs or artwork. Electronic designs are licensed to the original purchaser for use at one location. ©2015 Amanda Murphy Design, LLC. All rights reserved.

Listings below indicate color sample, stitching order and suggested thread color number. Most numbers indicate Isacord thread. Colors beginning with 20501 refer to YLI Fine Metallics, 7 refer to Yenmet Metallic, 8 refer to YLI Variations Variegated Thread and 9 refer to Isacord Multicolor Variegated.

80063-01 Clock Face 1 Appliqué

■ 1. Clock Face Placement Stitch	4174
■ 2. Cut Line, Tackdown & Center Cut Out	4174
■ 3. Numbers.....	4174
■ 4. Pale Gray Detail	3971
□ 5. White Detail	0015
■ 6. Light Gray.....	1972
■ 7. Medium Gray Detail	0108
■ 8. Dark Gray Detail.....	0111
■ 9. Clock Hands.....	4174

80063-02 Gears Appliqué

■ 1. Background Linework.....	0108
■ 2. Gear Placement Stitch	1972
■ 3. Cut Line & Tackdown	1972
■ 4. Cover Stitch.....	1972
■ 5. Light Gray Gear Center.....	3971

80063-03 Pocket Watch 1 Appliqué

■ 1. Watch Face Placement Stitch	1972
■ 2. Cut Line & Tackdown	1972
■ 3. Cover Stitch & Light Gray Detail	1972
■ 4. Black Detail	4174
■ 5. Gray Cover & Loop	3971
■ 6. Dark Gray Detail.....	0111
■ 7. Gray Cover & Loop Shading	0108

80063-04 Pocket Watch 2 Appliqué

■ 1. Watch Face Placement Stitch	0108
■ 2. Cut Line & Tackdown	0108
■ 3. Light Gray Detail	0108
■ 4. Dark Gray Detail.....	0111
■ 5. Black Detail	4174

80063-05 Digital Watch Face Appliqué

■ 1. Watch Face Placement Stitch	0111
■ 2. Cut Line & Tackdown	0111
■ 3. Dark Gray Detail.....	0111
□ 4. White Detail.....	0015
■ 5. Light Gray Detail	1972
■ 6. Medium Gray Detail	0108
■ 7. Black Detail	4174

80063-06 Compass Watch Face Appliqué

■ 1. Watch Face Placement Stitch	4174
■ 2. Cut Line & Tackdown	4174
■ 3. Dials	4174
■ 4. Dark Gray Detail.....	0111
□ 5. Lettering & White Detail	0015
■ 6. Light Gray Detail	3971
■ 7. Cover Stitch.....	1972
□ 8. White Hands & Detail.....	0015
■ 9. Hands Outlines.....	0111

80063-07 Gears Clock Face

■ 1. Pale Gray Detail	3971
□ 2. White Detail.....	0015
■ 3. Light Gray Detail	1972
■ 4. Medium Gray Detail	0108
■ 5. Dark Gray Detail.....	0111
■ 6. Black Hands.....	4174

80063-08 Gears

■ 1. Dark Gray Gear.....	0111
■ 2. Medium Gray Gear.....	0108
■ 3. Light Gray Gear & Center	1972
□ 4. White Detail.....	0015

80063-09 Hour Glass

□ 1. Sand.....	0015
■ 2. Glass.....	3971
■ 3. Black Detail	4174
■ 4. Dark Gray Detail.....	0111
■ 5. Light Gray Detail	0108

80063-10 Clock Face Linework

■ 1. Single Color Design	4174
--------------------------------	------

80063-11 Compass Watch Face Linework

■ 1. Single Color Design	4174
--------------------------------	------

80063-12 Digital Watch Face Linework

■ 1. Single Color Design	4174
--------------------------------	------

80063-13 Pocket Watch Linework

■ 1. Single Color Design	4174
--------------------------------	------

80063-14 Gears 1 Linework

■ 1. Single Color Design	4174
--------------------------------	------

80063-15 Gears 2 Linework

■ 1. Single Color Design	4174
--------------------------------	------

1. Print out the necessary pages from the PDF of the appliqué pattern(s).
2. Mark the right side of the pattern pieces so you'll know which direction to lay the pattern on the fabric.
3. Lightly spray the wrong side of the pattern pieces with temporary adhesive spray and allow it to set for a few minutes.
4. Place the pattern pieces on the right side of the fabric and carefully cut them out. **PHOTO 1**
5. Sew the placement stitch on your hooped fabric. **PHOTO 2**
6. With the paper still stuck to the right side of the appliqué fabric, spray the wrong side of the fabric with temporary spray adhesive.
7. Place the fabric inside the sewing placement stitch so that it matches the stitching line, and then remove the paper pattern. **PHOTO 3**
8. Sew the tackdown. **PHOTO 4**
9. Sew the remainder of the design and repeat for any remaining pieces. **PHOTO 5**

NOTE: The patterns are sized for the designs as they were made. If you resize the design, you will need to resize the pattern the same amount. You can print out the pattern at the normal size then copy it on a copy machine at the changed size. For example, resize the designs to 80%, resize the printed pattern to 80%.

TIP: When Printing the patterns, make sure that the “Fit to page” option is **UNCHECKED** in the Print Dialog Box. If this option is checked the printed patterns will not be actual size.

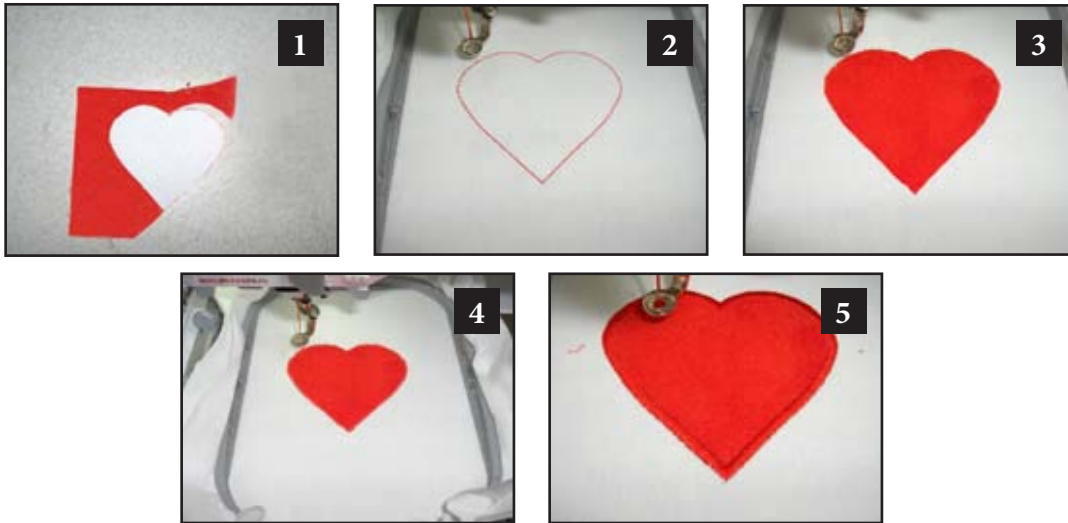

ATTENTION

When printing this document, any page scaling or page fitting options in your print dialog box must be turned OFF or set to NONE so that your files will print out at their actual size. Images not printed at actual size will not function as intended.

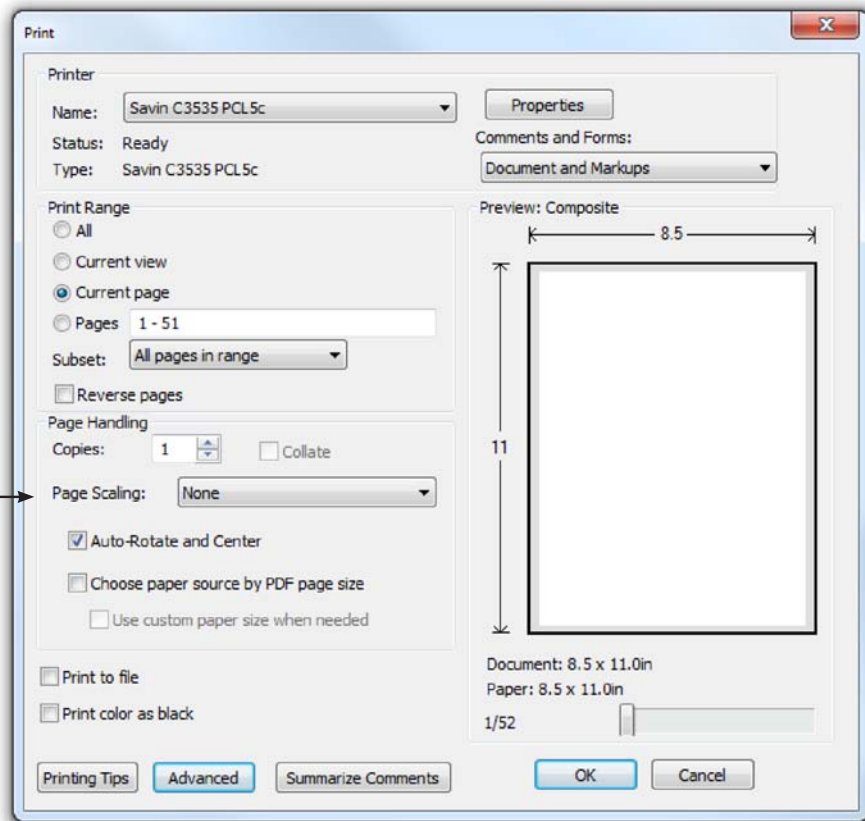

TO SAVE PAPER

Only print the desired image by navigating to the image's page, go to File > Print and select "Current page" in the print dialog box. Repeat for each desired image.

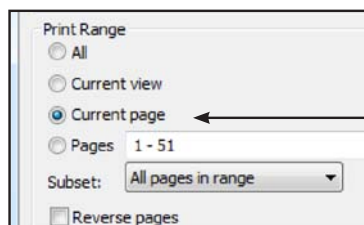

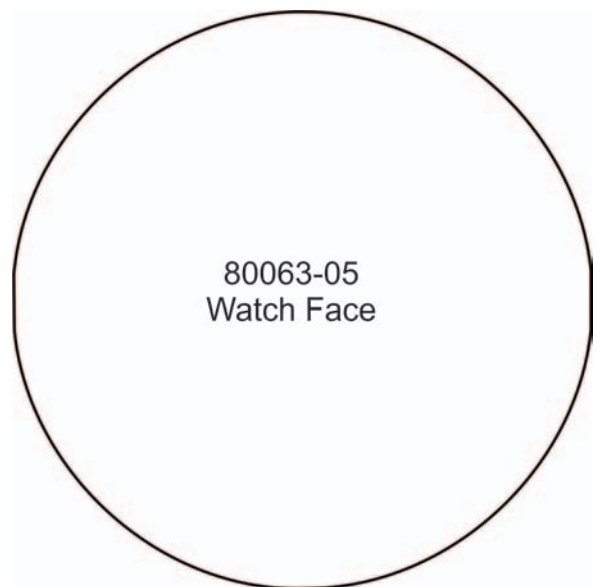
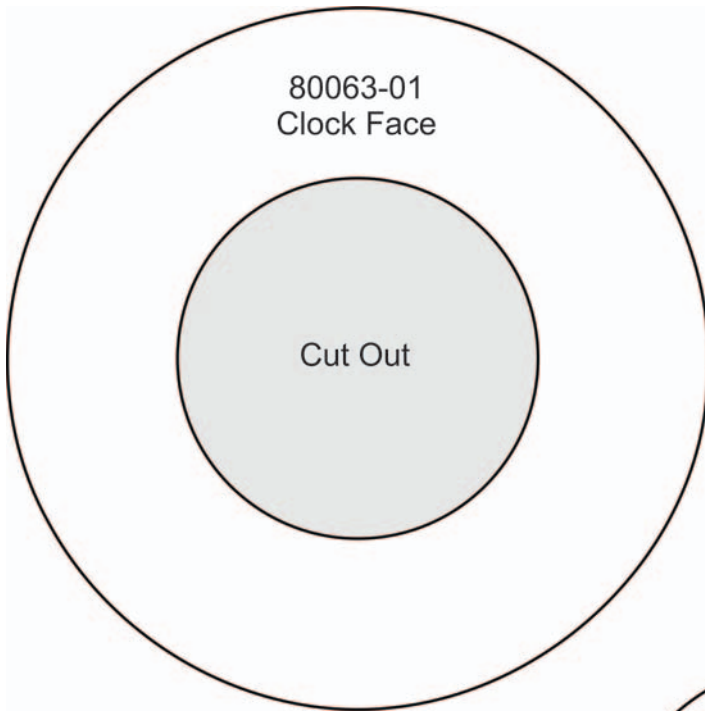

midnight

A 60-1/2" x 80-1/2" quilt pattern for the Chronos collection by Amanda Murphy for OESD



AMANDA *A* MURPHY

midnight

www.amandamurphydesign.com

All seam allowances are 1/4". WOF refers to "width of fabric". Embroidery motifs shown are from the "Chronos" embroidery collection by Amanda Murphy for OESD. Fabrics shown are from Benartex's "Burlap" line, which features a rich burlap texture printed on cotton. SKUs are listed below.

Materials

Embroidery Backgrounds	1 yard (757-76 Cream)
Solid Blocks	1 yard of each of four fabrics (757-04 Sea Mist, 757-40 Sea Grass, 757-50 Marine Blue, and 757-51 Laguna)
Striped Blocks	1-1/4 yards (757-55 Harbor Blue)
Stripes	1/4 yard of each of four fabrics (757-22 Orange, and 757-46 Green, and 757-59 Lagoon, and 757-76 Cream)
Border	1/3 yard (757-22 Orange)
Binding	5/8 yard (757-22 Orange)
Backing	5-1/4 yards (757-55 Harbor Blue)
Other supplies	<i>50 wt. thread for piecing and quilting, stabilizer, embroidery thread and other general embroidery supplies, Warm and Natural batting</i>

Cutting Instructions

From Embroidery Background fabric, cut 5 strips 6" x WOF. Subcut into 27 squares 6" x 6".

From EACH Solid Block fabric, cut 7 stripes 4-1/2" x WOF. Subcut each fabric into 19 rectangles 4-1/2" x 12-1/2".

From Striped Block fabric, cut 8 stripes 4-1/2" x 12-1/2". Subcut into 23 rectangles 4-1/2" x 12-1/2".

From Stripes fabric, cut a TOTAL of 23 or more strips 1" x WOF. Cut these strips into 23 rectangles 1" x 15" and 69 rectangles 1" x 7".

From Border Fabric, cut 4 strips 2-1/2" x WOF.

From Binding fabric cut 8 strips 2-1/4" x WOF.

Blocks A: Embroidery

Embroider a variety of Chronos motifs on the 6" Embroidery Background squares, backed with stabilizer of your choice. Make sure the motifs are sized so they are no bigger than 3-1/2" x 3-1/2" (90 mm x 90 mm.) Remove stabilizer and trim blocks to 4-1/2" x 4-1/2", centering the embroidery.



Embroidered Blocks: Make 27.

midnight

Striped Blocks

Slash one 4-1/2" x 12-1/2" block in half horizontally, not worrying about the angle. Join a strip rectangle 1" x 7" to one of the slashed sides. Press seams open.

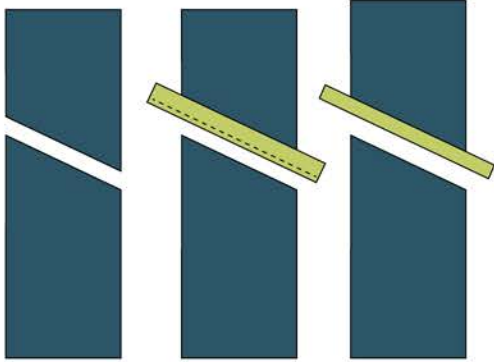

Trim stripe flush with Block. Join the striped unit to the other side of the slashed rectangle, matching the raw edges along the 1/4" seamline. Press seams open.

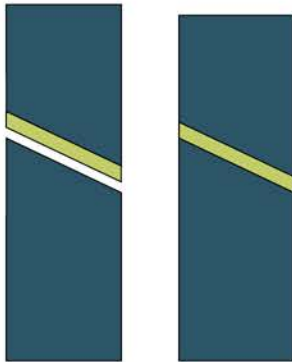

Continue on, inserting 2 other horizontal stripes using the Stripe rectangles 1" x 7" and 1 vertical stripe using the Stripe rectangle 1" x 15". Vary the angle of the stripes to add interest. Repeat the process to make a total of 23 Striped blocks.



Striped Blocks: Make 23

Borders

From Border strips, piece 2 rectangles 2-1/2" x 60-1/2".

Quilt Assembly

Arrange blocks into columns roughly following Quilt Assembly Diagram on the next page, or make your own design! Trim columns to 76-1/2" in height, making sure that the blocks will appear staggered in the final design. Join blocks into columns, pressing seams open. Join columns, pressing seams open.

Add borders to the top and bottom of the quilt top.

Finishing

Divide backing fabric into two lengths. Cut 1 piece lengthwise to make 2 narrow panels. Join 1 narrow panel to each side of wide panel. Press seams open.

Layer the backing, batting, and quilt top. Quilt as desired.

Join the narrow ends of the Binding strips. Fold in half lengthwise, wrong sides together; press.

Bind using a 1/4" seam.

Enjoy your quilt!



Midnight Assembly Diagram

noon

A 32-1/2" x 42-1/2" quilt pattern for the Chronos collection by Amanda Murphy for OESD

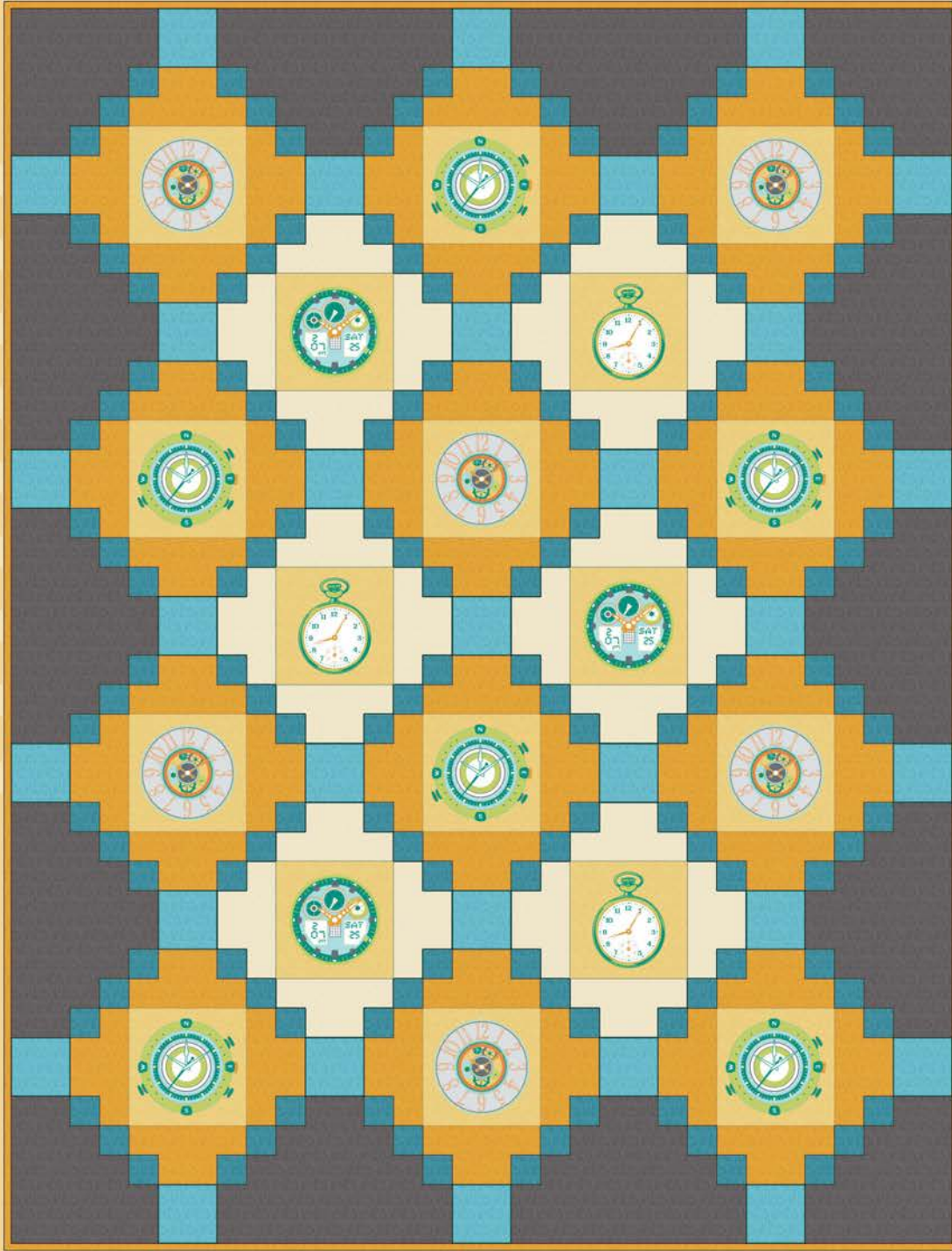

AMANDA *AM* MURPHY

www.amandamurphydesign.com

All seam allowances are 1/4". WOF refers to "width of fabric". Embroidery motifs shown are from the "Chronos" embroidery collection by Amanda Murphy for OESD. Fabrics shown are from Benartex's "Burlap" line, which features a rich burlap texture printed on cotton. SKUs are listed below.

Materials

Embroidery Backgrounds	3/4 yard (757-76 Cream)
Embroidery Border A	1/2 yard (757-30 Gold)
Embroidery Border B	3/8 yard (757-07 Vanilla)
Small Squares	3/8 yard (757-51 Laguna)
Large Squares	1/4 yard (757-59 Lagoon)
Quilt Border	5/8 yard (757-09 Charcoal)
Binding	3/8 yard (757-30 Gold)
Backing	1-1/2 yards (757-59 Lagoon)
Other supplies	50 wt. thread for piecing and quilting, stabilizer, embroidery thread and other general embroidery supplies, Warm and Natural batting

IMPORTANT PRESSING NOTE:

Whenever possible, press seams toward the Large and Small Square fabrics so that the seams lock during assembly!

Cutting Instructions

From Embroidery Background fabric, cut 3 strips 6" x WOF. Subcut into 18 squares 6" x 6".

From Embroidery Border A fabric, cut 2 strips 2-1/2" x WOF. Set aside. Cut 2 strips 4-1/2" x WOF. Subcut into 48 rectangles 4-1/2" x 1-1/2".

From Embroidery Border B fabric, cut 3 strips 1-1/2" x WOF. Set aside. Cut 1 strip 4-1/2" x WOF and subcut into 24 rectangles 1-1/2" x 4-1/2".

From Small Square fabric, cut 6 strips 1-1/2" x WOF and set 4 strips aside. From remaining two strips, subcut 48 squares 1-1/2" x 1-1/2".

From Large Square fabric, cut 3 strips 2-1/2" x WOF.

From Quilt Border fabric, cut 3 strips 1-1/2" x WOF and set aside. Cut 2 strips 3-1/2" x WOF and subcut into 4 rectangles 3-1/2" x 6-1/2", 4 rectangles 3-1/2" x 4-1/2", and 16 rectangles 3-1/2" x 1-1/2". Cut 1 strip 4-1/2" x WOF and subcut into 6 squares 4-1/2" x 4-1/2" and 4 rectangles 4-1/2" x 1-1/2".

From Binding fabric cut 4 strips 2-1/4" x WOF.

Blocks A: Embroidery

Embroider a variety of Chronos motifs on the 6" Embroidery Background squares, backed with stabilizer of your choice. Make sure the motifs are sized so they are no bigger than 3-1/2" x 3-1/2" (90 mm x 90 mm.) Remove stabilizer and trim blocks to 4-1/2" x 4-1/2", centering the embroidery.



Block A: Make 18.

Little Square Units

Join a 1-1/2" Small Square strip to both sides of each 2-1/2" Embroidery Background A strip. Subcut strip sets into 48 units 1-1/2" wide.

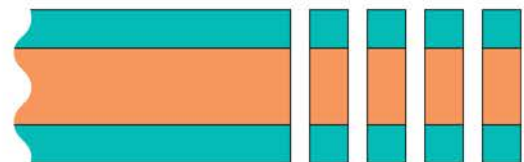

Make 2 strips sets and cut 48 units 1-1/2" wide.

Blocks B

Join a 1-1/2" Quilt Border strip to both sides of one 2-1/2" Large Square strip. Cut 14 units 2-1/2" wide.

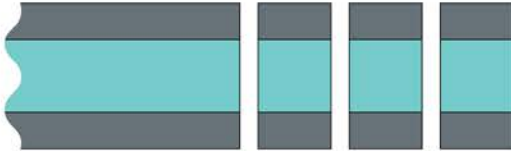

Make 1 strip set and cut 14 units 2-1/2" wide.

Join a Little Square unit to one side of each.

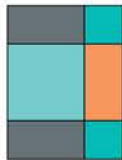

Block B: Make 14. Set 6 aside.
Use the remaining 8 to complete Blocks C.

Blocks C

Join an Embroidery Border A rectangle 1-1/2" x 4-1/2" to one side of the remaining 8 Block B units.

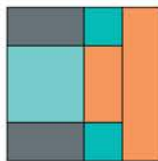

Block C: Make 8,

Blocks D

Join a 1-1/2" Quilt Border strip to one side of one 2-1/2" Large Square strip. Join a 1-1/2" Embroidery Background B strip to the other. Cut 10 units 2-1/2" wide.

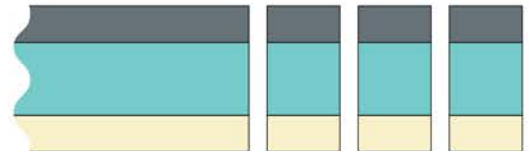

Make 1 strip set and cut 10 units 2-1/2" wide.

Join a Little Square unit to both sides of each and set aside 4 of these units to use for Block E.

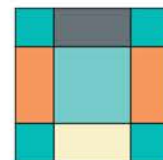

Make 10.
Set aside 4 to use for Blocks E.

Join an Embroidery Border B rectangle 1-1/2" x 4-1/2" to the bottom of the remaining 6 blocks.

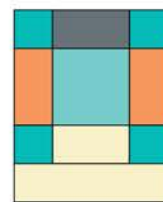

Block D: Make 6.

Blocks E

Join an Embroidery A Border rectangle 1-1/2" x 4-1/2" to each side of the remaining 4 Block D units.

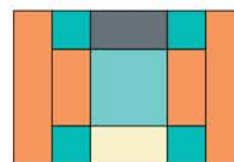

Block E: Make 8,

Blocks F

Join a 1-1/2" Embroidery Background A strip to both sides of one 2-1/2" Large Square strip. Cut 7 units 2-1/2" wide

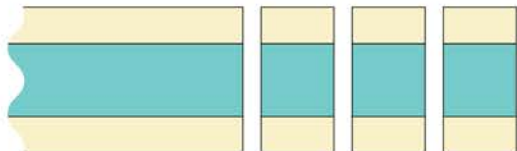

Make 1 strip set and cut 7 units 2-1/2" wide.

Join a Little Square unit to each and set aside 3 of these units to use for Block G.

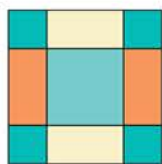

Make 7.

Set aside 3 to use for Blocks G.

Join a Embroidery Border B rectangle 1-1/2" x 4-1/2" to each side of the remaining 4 blocks.

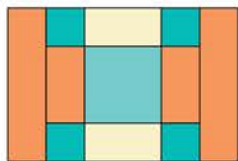

Block F: Make 4.

Blocks G

Join an Embroidery B Border rectangle 1-1/2" x 4-1/2" to the top and bottom of the remaining 3 Block F units.

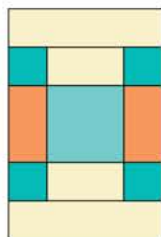

Block G: Make 3.

Blocks H

The Quilt Border squares 4-1/2" x 4-1/2" are Blocks H.

Blocks I

The Quilt Border 3-1/2" x 4-1/2" are Blocks I.

Blocks J

The Quilt Border rectangles 3-1/2" x 6-1/2" are Blocks J.

Rows K and L: Sashing

Join the Little Squares 1-1/2" x 1-1/2", remaining Embroidery Border A and B rectangles 1-1/2" x 4-1/2", and Quilt Border rectangles 1-1/2" x 3-1/2" and 1-1/2" x 4-1/2" to form Blocks K and L as shown in the diagrams.

Note that the 1-1/2" x 3-1/2" rectangles are on each end of the rows and the 1-1/2" x 4-1/2" rectangles are in the middle of rows. (Dimensions indicated on diagram on the right are the cutting dimensions, rather than the finished dimensions.)

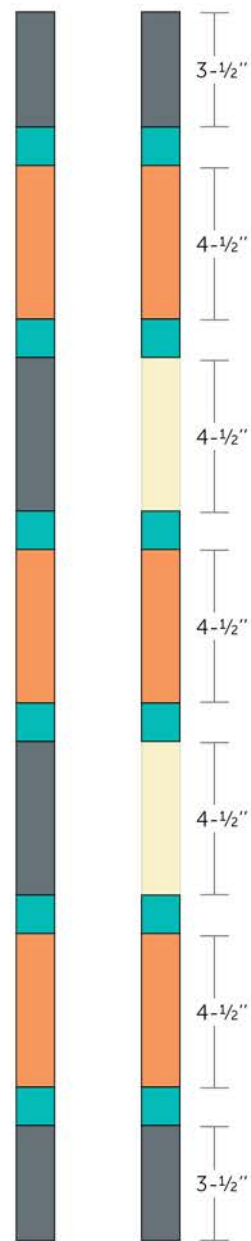

Row K: Make 2.

Row L: Make 6.

Quilt Assembly

Arrange blocks into rows following Quilt Assembly Diagram on the next page. Join blocks into rows. Join rows.

Finishing

Layer the backing, batting, and quilt top. Quilt as desired.

Join the narrow ends of the Binding strips. Fold in half lengthwise, wrong sides together; press.

Bind using a 1/4" seam.

Enjoy your quilt!

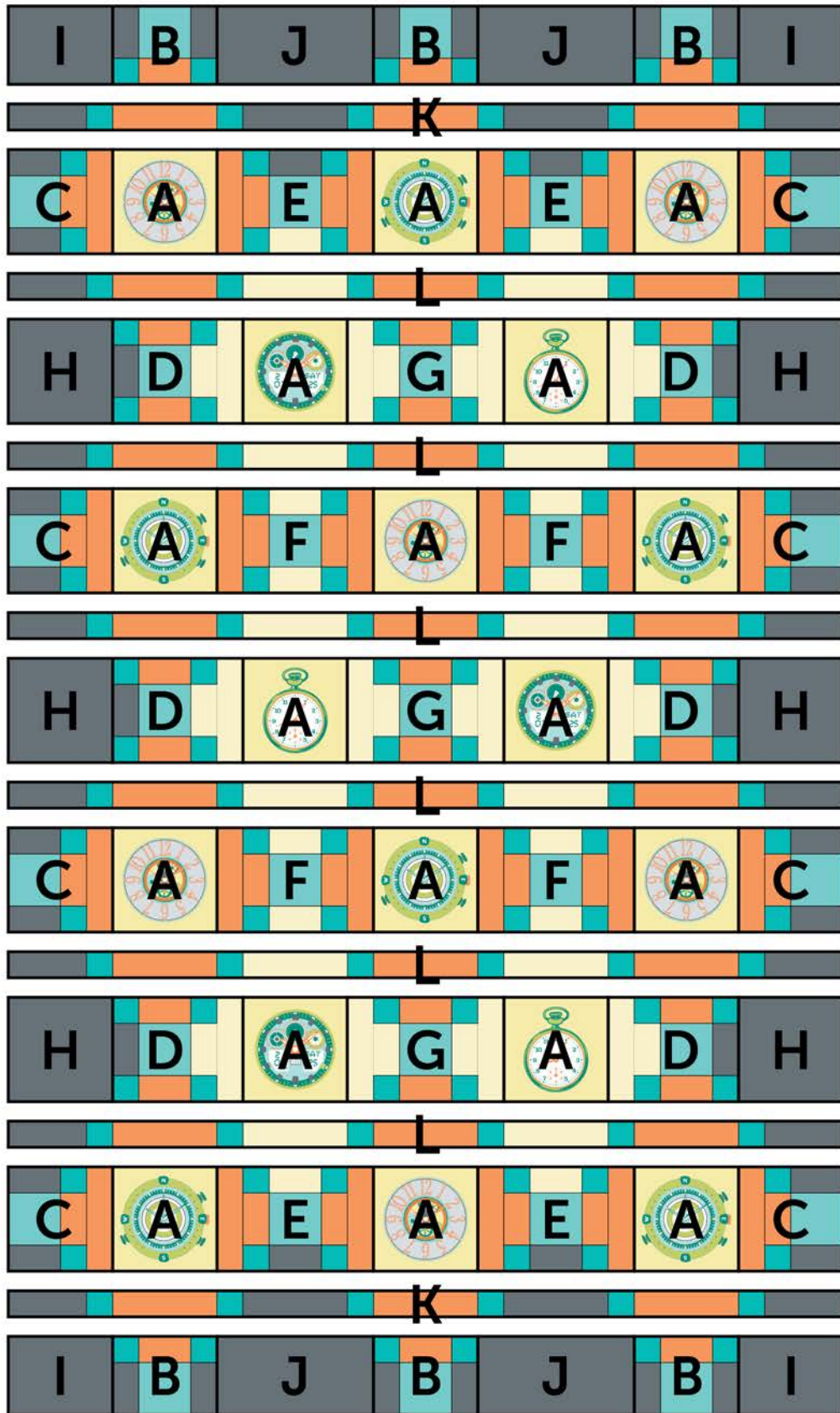

Noon Assembly Diagram