

Note: Some designs in this collection may have been created using unique special stitches and/or techniques. To preserve design integrity when rescaling or rotating designs in your software, always rescale or rotate designs using the handles directly on-screen.

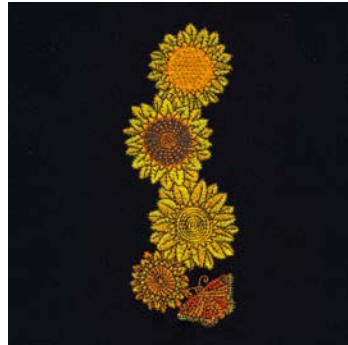

80065-01 Sunflower Square Appliqué
4.90 X 5.22 in.
124.46 X 132.59 mm
26,716 St. ⌘ L



80065-02 Sunflower Border
2.03 X 5.21 in.
51.56 X 132.33 mm
21,435 St. ⌘ L



80065-03 Sunflower Appliqué
4.41 X 4.13 in.
112.01 X 104.90 mm
20,553 St. ⌘



80065-04 Sunflower Accent
2.84 X 2.62 in.
72.14 X 66.55 mm
12,676 St. ⌘



80065-05 Zinnia Square
4.72 X 4.82 in.
119.89 X 122.43 mm
33,073 St. ⌘



80065-06 Zinnia Border
2.01 X 5.50 in.
51.05 X 139.70 mm
20,733 St. ⌘ L



80065-07 Zinnia
3.78 X 4.73 in.
96.01 X 120.14 mm
27,341 St. ⌘

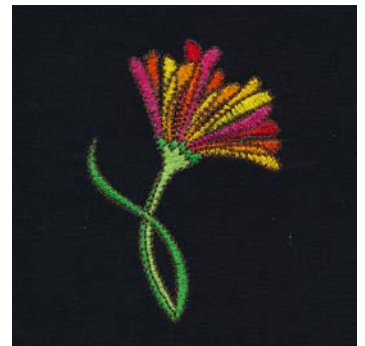

80065-08 Zinnia Accent
2.35 X 3.44 in.
59.69 X 87.38 mm
10,101 St. ⌘



80065-09 Coneflower Square Appliqué
4.94 X 5.20 in.
125.48 X 132.08 mm
40,974 St. ⌘ L



80065-10 Coneflower Border
1.98 X 5.43 in.
50.29 X 137.92 mm
18,316 St. ⌘ L



80065-11 Coneflower Appliqué
4.35 X 4.06 in.
110.49 X 103.12 mm
34,540 St. ⌘



80065-12 Coneflower Accent
2.35 X 3.23 in.
59.69 X 82.04 mm
11,285 St. ⌘

⌘ Design contains a loose fill.

⊗ Some solid areas shown are not stitched.

L Design is larger than 5" (127 mm) in either direction.

S Design is smaller than 1.5" (38.1 mm) in either direction.

It is a violation of Copyright law to make and distribute copies of electronic designs or artwork. Electronic designs are licensed to the original purchaser for use at one location. ©2015 Susan Rooney, for use in home embroidery. All rights reserved.

Note: Some designs in this collection may have been created using unique special stitches and/or techniques. To preserve design integrity when rescaling or rotating designs in your software, always rescale or rotate designs using the handles directly on-screen.



80065-13 Daisy Square Appliqué
4.96 X 5.24 in.
125.98 X 133.10 mm
25,898 St. ⚡ ⚙ L



80065-14 Daisy Border
1.90 X 5.36 in.
48.26 X 136.14 mm
24,471 St. ⚡ ⚙ L



80065-15 Daisy Appliqué
4.03 X 3.96 in.
102.36 X 100.58 mm
20,314 St. ⚡ ⚙



80065-16 Daisy Accent
1.98 X 3.34 in.
50.29 X 84.84 mm
8,703 St. ⚡ ⚙



80065-17 Large Sunflower Appliqué
5.01 X 5.04 in.
127.25 X 128.02 mm
8,234 St. ⚡ ⚙ L



80065-18 Butterfly
2.27 X 1.86 in.
57.66 X 47.24 mm
9,431 St.



80065-19 Small Flower
1.35 X 1.01 in.
34.29 X 25.65 mm
1,511 St. ⚡ S

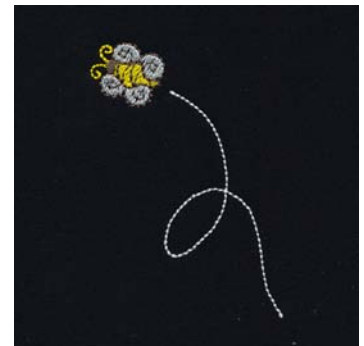

80065-20 Bee
1.98 X 2.86 in.
50.29 X 72.64 mm
1,169 St. ⚙



80065-21 Flower
1.74 X 2.69 in.
44.20 X 68.33 mm
6,747 St. ⚡



80065-22 Flower & Heart
2.41 X 2.26 in.
61.21 X 57.40 mm
4,551 St.



80065-23 Flower Linework 1
3.78 X 4.95 in.
96.01 X 125.73 mm
5,806 St. ⚡ ⚙



80065-24 Flower Linework 2
3.66 X 4.03 in.
92.96 X 102.36 mm
6,737 St. ⚡ ⚙

⚡ Design contains a loose fill.

⚙ Some solid areas shown are not stitched.

L Design is larger than 5" (127 mm) in either direction.

S Design is smaller than 1.5" (38.1 mm) in either direction.

It is a violation of Copyright law to make and distribute copies of electronic designs or artwork. Electronic designs are licensed to the original purchaser for use at one location. ©2015 Susan Rooney, for use in home embroidery. All rights reserved.

Note: Some designs in this collection may have been created using unique special stitches and/or techniques. To preserve design integrity when rescaling or rotating designs in your software, always rescale or rotate designs using the handles directly on-screen.



**80065-25 Flower & Butterfly
Linework**
2.86 X 6.50 in.
72.64 X 165.10 mm
4,864 St. ⚡ ⚙ L

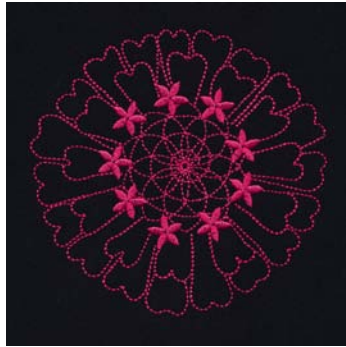

80065-26 Flower Linework 3
4.50 X 4.35 in.
114.30 X 110.49 mm
7,093 St. ⚙



80065-27 Flower Linework 4
2.95 X 3.80 in.
74.93 X 96.52 mm
2,947 St. ⚡ ⚙



**80065-28 Jumbo Stitch 'n' Turn
Sunflower Pillow**
10.01 X 10.85 in.
254.25 X 275.59 mm
18,229 St. ⚡ L

⚡ Design contains a loose fill.

⚙ Some solid areas shown are not stitched.

L Design is larger than 5" (127 mm) in either direction.

S Design is smaller than 1.5" (38.1 mm) in either direction.

It is a violation of Copyright law to make and distribute copies of electronic designs or artwork. Electronic designs are licensed to the original purchaser for use at one location. ©2015 Susan Rooney, for use in home embroidery. All rights reserved.



Breezy Blooms

by Susan Rooney / #80065 / 28 Designs

Listings below indicate color sample, stitching order and suggested thread color number. Most numbers indicate Isacord thread. Colors beginning with 20501 refer to YLI Fine Metallics, 7 refer to Yenmet Metallic, 8 refer to YLI Variations Variegated Thread and 9 refer to Isacord Multicolor Variegated.

80065-01 Sunflower Square Appliqué

1. Orange Border	1102
2. Petals Placement Stitch	0020
3. Petals Tackdown	0600
4. Medium Yellow Petals Shading	0811
5. Petals Shading	0700
6. Stamen Placement Stitch	1102
7. Stamen Tackdowns	1102
8. Orange Stamen Detail	1102
9. Light Orange Petals Shading	0811
10. Stamen Cover Stitch	0700
11. Black Detail	1375
12. Lettering	0700
13. Light Orange Swirl	0811

80065-02 Sunflower Border

1. Orange Petals	0800
2. Yellow Detail	0600
3. Dark Yellow Detail	0700
4. Orange Detail	0800
5. Medium Orange Butterfly & Bottom Flower Detail	1102
6. Dark Orange Butterfly Detail	1301
7. Black Detail	1375
8. Medium Orange Stamens & Butterfly Detail	1102

80065-03 Sunflower Appliqué

1. Petals Placement Stitch	0020
2. Petals Tackdown	0600
3. Medium Yellow Petals Shading	0811
4. Petals Shading	0700
5. Stamen Placement Stitch	1102
6. Stamen Tackdowns	1102
7. Orange Stamen Detail	1102
8. Light Orange Petals Shading	0811
9. Stamen Cover Stitch	0700
10. Black Detail	1375

80065-04 Sunflower Accent

1. Leaf	5730
2. Medium Yellow Petals	0600
3. Light Yellow Petals	0700
4. Dark Yellow Linework	0800
5. Orange Stamen	1102
6. Black Detail	1375

80065-05 Zinnia Square

1. Green Border	5730
2. Flower Underlay	0020
3. Red Petals	1800
4. Yellow Petals	0700
5. Light Orange Petals	1102
6. Dark Orange Petals	1301
7. Medium Pink Petals	2320
8. Light Pink Petals	2520
9. Dark Pink Petals	1906
10. Light Green Detail	5730
11. Dark Green Detail	5510
12. Black Detail	1375
13. Lettering	2320

80065-06 Zinnia Border

1. Medium Orange Petals	1102
2. Light Orange Petals & Stamen	0811
3. Dark Orange Petals	1301
4. Red Petals & Stamen	1800
5. Light Pink Petals & Stamen	2520
6. Dark Pink Petals	1906
7. Medium Pink Petals	2320
8. Purple Petals	2500
9. Medium Orange Stamen	1102
10. Dark Orange Stamen	1301
11. Yellow Stamen	0700
12. Black Outlines	1375
13. Leaves & Stems	5730
14. Yellow Stamen Detail	0600
15. Light Orange Stamen Detail	0811

80065-07 Zinnia

1. Flower Underlay	0020
2. Red Petals	1800
3. Yellow Petals	0700
4. Light Orange Petals	1102
5. Dark Orange Petals	1301
6. Medium Pink Petals	2320
7. Light Pink Petals	2520
8. Dark Pink Petals	1906
9. Light Green Detail	5730
10. Dark Green Detail	5510
11. Black Detail	1375

80065-08 Zinnia Accent

1. Light Yellow Petals	0600
2. Dark Yellow Petals	0700
3. Medium Orange Petals	1102
4. Red Petals	1800
5. Dark Orange Petals	1301
6. Pink Petals	2320
7. Dark Green Stem	5510
8. Light Green Stem	5730
9. Black Outlines	1375

80065-09 Coneflower Square Appliqué

1. Orange Border	1102
2. Stamen Placement Stitch	1375
3. Stamen Tackdown	1375
4. Light Pink Petals	2520
5. Medium Pink Petals	2320
6. Dark Pink Petals Shading	1906
7. Light Orange Petals Detail	0811
8. Black Stamen & Petals Detail	1375
9. Yellow Stamen Detail	0600
10. Dark Orange Stamen Detail	1102
11. Lettering	5730

80065-10 Coneflower Border

1. Light Pink Petals	2520
2. Medium Pink Petals	2320
3. Dark Pink Petals	1906
4. Purple Petals	2500
5. Black Outlines & Stamens	1375
6. Yellow Stamen	0700
7. Light Orange Stamen	0811
8. Dark Orange Stamens	1102
9. Stems	5730

80065-11 Coneflower Appliqué

1. Stamen Placement Stitch	1375
2. Stamen Tackdown	1375
3. Light Pink Petals	2520
4. Medium Pink Petals	2320
5. Dark Pink Petals Shading	1906
6. Light Orange Petals Detail	0811
7. Black Stamen & Petals Detail	1375
8. Yellow Stamen Shading	0600
9. Dark Orange Stamen Shading	1102

80065-12 Coneflower Accent

1. Light Pink Petals	2520
2. Medium Pink Petals	2320
3. Purple Petals Linework	2500
4. Dark Green Stem	5510
5. Light Green Stem	5730
6. Black Detail	1375
7. Orange Stamen	1102

80065-13 Daisy Square Appliqué

1. Orange Border	0811
2. Petal Placement Stitch	0020
3. Petal Tackdown	0015
4. Light Yellow Petals Shading	0270
5. Medium Yellow Petals Shading	0520
6. Stamen Placement Stitch	0811
7. Stamen Tackdown	0811
8. Yellow Stamen Detail	0600
9. Black Detail	1375
10. Dark Orange Flowers	1102
11. Red Stamens	1800
12. Lettering	5730

80065-14 Daisy Border

1. Light Green Detail	5730
2. Dark Green Detail	5510
3. White Petals	0015
4. Light Yellow Petals	0270
5. Medium Yellow Petals	0520
6. Wings	0124
7. Bee Body	0600
8. Bright Yellow Flower Linework	0600
9. Black Outlines	1375
10. Dark Yellow Stamens	0700
11. Medium Orange Stamens	1102
12. Black Stamen Detail	1375
13. Dark Orange Stamen Detail	1301

80065-15 Daisy Appliqué

1. Petals Placement Stitch	0020
2. Petals Tackdown	0015
3. Light Yellow Petals Shading	0270
4. Medium Yellow Petals Shading	0520
5. Stamen Placement Stitch	0811
6. Stamen Tackdown	0811
7. Yellow Stamen Detail	0600
8. Black Detail	1375
9. Dark Orange Flowers	1102
10. Red Stamens	1800

80065-16 Daisy Accent

1. Light Yellow Petals	0520
2. White Petals	0015
3. Stamen & Yellow Linework	0600
4. Dark Green Stem	5510
5. Light Green Stem	5730
6. Black Outlines	1375



Breezy Blooms

by Susan Rooney / #80065 / 28 Designs

Listings below indicate color sample, stitching order and suggested thread color number. Most numbers indicate Isacord thread. Colors beginning with 20501 refer to YLI Fine Metallics, 7 refer to Yenmet Metallic, 8 refer to YLI Variations Variegated Thread and 9 refer to Isacord Multicolor Variegated.

80065-17 Large Sunflower Appliqué

■ 1. Back Left Petals Placement Stitch	0020
■ 2. Back Left Petals Tackdown	0700
■ 3. Back Right Petals Placement Stitch	0600
■ 4. Back Right Petals Tackdown	0600
■ 5. Front Left Petals Placement Stitch	0700
■ 6. Front Left Petals Tackdown	0700
■ 7. Front Right Petals Placement Stitch	0600
■ 8. Front Right Petals Tackdown	0600
■ 9. Stamen Placement Stitch	0600
■ 10. Stamen Tackdown	1375

80065-18 Butterfly

■ 1. Yellow Detail	0600
■ 2. Medium Orange Detail	1102
■ 3. Dark Orange Detail	1301
■ 4. Black Detail	1375
■ 5. Body Linework	1102

80065-19 Small Flower

■ 1. Dark Green Leaf Shading	5510
■ 2. Light Green Leaf Shading	5730
■ 3. Petals	0520
■ 4. Light Yellow Stamen	0700
■ 5. Orange Stamen	1102
■ 6. Design Outlines	1375

80065-20 Bee

□ 1. Wings	0124
■ 2. Body	0600
■ 3. Design Outlines	1375
□ 4. White Linework	0015

80065-21 Flower

■ 1. Light Orange Petals	0811
■ 2. Dark Orange Detail	1102
■ 3. Yellow Petals	0700
■ 4. Dark Green Stem	5510
■ 5. Light Green Stem	5730
■ 6. Black Detail	1375

80065-22 Flower & Heart

■ 1. Purple Detail	2500
■ 2. Red Detail	1906
■ 3. Dark Yellow Detail	0700
■ 4. Yellow Detail	0600
■ 5. Light Pink Detail	2520
■ 6. Design Outlines	1375

80065-23 Flower Linework 1

■ 1. Single Color Design	0700
--------------------------------	------

80065-24 Flower Linework 2

■ 1. Single Color Design	0700
--------------------------------	------

80065-25 Flower & Butterfly Linework

■ 1. Single Color Design	0700
--------------------------------	------

80065-26 Flower Linework 3

■ 1. Single Color Design	2320
--------------------------------	------

80065-27 Flower Linework 4

■ 1. Single Color Design	2320
--------------------------------	------

80065-28 Jumbo Stitch 'n' Turn Sunflower Pillow

■ 1. Back Left Petals Placement Stitch	0020
■ 2. Back Left Petals Tackdown	0700
■ 3. Back Right Petals Placement Stitch	0600
■ 4. Back Right Petals Tackdown	0600
■ 5. Front Left Petals Placement Stitch	0700
■ 6. Front Left Petals Tackdown	0700
■ 7. Front Right Petals Placement Stitch	0600
■ 8. Front Right Petals Tackdown	0600
■ 9. Stamen Placement Stitch	0600
■ 10. Stamen Tackdown & Linework	1375
■ 11. Panel Placement Guides	0020
■ 12. Seam Stitch	0020

Isacord Thread Colors Used in "Breezy Blooms"

By Susan Rooney
Collection #80065

0015 White	0800 Goldenrod	1906 Tulip
0020 Black	0811 Candlelight	2320 Raspberry
0124 Fieldstone	1102 Pumpkin	2500 Boysenberry
0270 Buttercream	1301 Paprika	2520 Garden Rose
0520 Daffodil	1375 Dark Charcoal	5510 Emerald
0600 Citrus	1800 Wildfire	5730 Apple Green
0700 Bright Yellow		

1. Print out the necessary pages from the PDF of the appliqué pattern(s).
2. Mark the right side of the pattern pieces so you'll know which direction to lay the pattern on the fabric.
3. Lightly spray the wrong side of the pattern pieces with temporary adhesive spray and allow it to set for a few minutes.
4. Place the pattern pieces on the right side of the fabric and carefully cut them out. **PHOTO 1**
5. Sew the placement stitch on your hooped fabric. **PHOTO 2**
6. With the paper still stuck to the right side of the appliqué fabric, spray the wrong side of the fabric with temporary spray adhesive.
7. Place the fabric inside the sewing placement stitch so that it matches the stitching line, and then remove the paper pattern. **PHOTO 3**
8. Sew the tackdown. **PHOTO 4**
9. Sew the remainder of the design and repeat for any remaining pieces. **PHOTO 5**

NOTE: The patterns are sized for the designs as they were made. If you resize the design, you will need to resize the pattern the same amount. You can print out the pattern at the normal size then copy it on a copy machine at the changed size. For example, resize the designs to 80%, resize the printed pattern to 80%.

TIP: When Printing the patterns, make sure that the “Fit to page” option is **UNCHECKED** in the Print Dialog Box. If this option is checked the printed patterns will not be actual size.

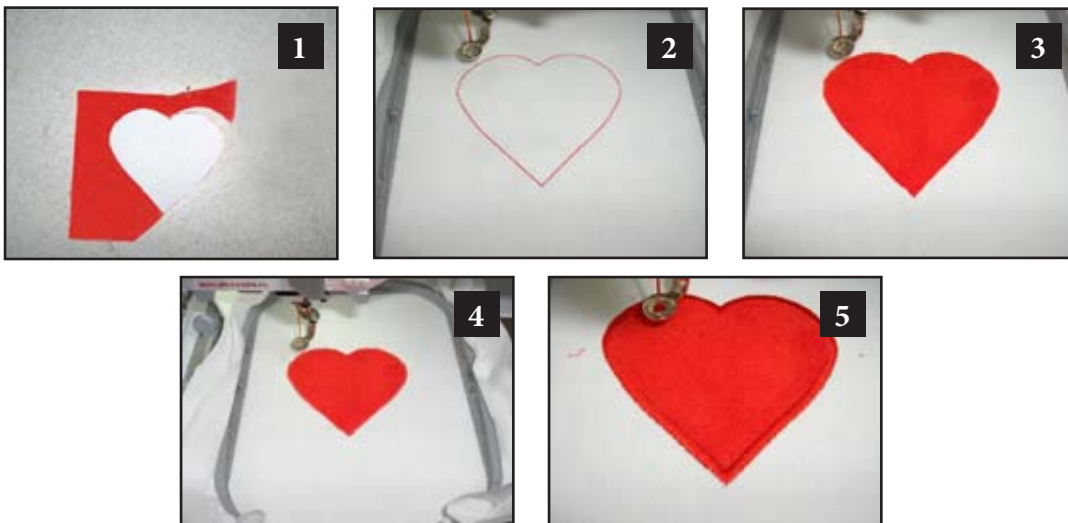

The Jumbo Stitch 'n' Turn Sunflower Pillow from Breezy Blooms by Susan Rooney #80065 embroidery collection makes a 10" round pillow cover. Make your own pillow form using our instructions to stuff. This jumbo pillow features an applique sunflower with stitched details. It is a lovely addition to the beautiful blooms in this embroidery collection.

Supplies

- OESD embroidery collection Breezy Blooms by Susan Rooney #80065
- Mesh cut away stabilizer
- ½ yd. black fabric (background and back pieces)
- ⅛ yd. two yellow fabrics (sunflower petals applique)
- 5" square dark green fabric (sunflower center applique)
- ½ yd. muslin (pillow form)
- ½ yd. cotton batting
- Polyester fiberfill
- Temporary spray adhesive
- OESD Applique Fuse & Stick
- Isacord embroidery threads
- Embroidery machine

Cut

NOTE: Use the design #80065-28 Jumbo Stitch 'n' Turn Sunflower Pillow. Pre-cut the applique pieces, using the pattern pieces and OESD Applique Fuse & Stick.

- (2) 12" X 13" pieces black fabric (back panel pieces) (fold each in half to measure 6" x 6 ½")
- (2) 10" circles muslin & cotton batting

Stitch 'n' Turn Instructions

- Cut mesh cut away stabilizer big enough to fit your hoop. Using temporary spray adhesive, spray the stabilizer and adhere to the wrong side of black fabric (background). Hoop the layers. Embroider the applique sunflower design.

PHOTO 1

- The next stitch will be the Panel Placement Guides. Place the left back panel piece to line up with the far right ends of the Panel Placement Guides. **PHOTO 2**

- Place the right back panel piece to line up with the far left ends of the Panel Placement Guides, overlapping with the left back panel piece.

PHOTO 3

- Stitch the final color called Seam Stitch. (Making sure the LEFT panel went on first.) **PHOTO 4**

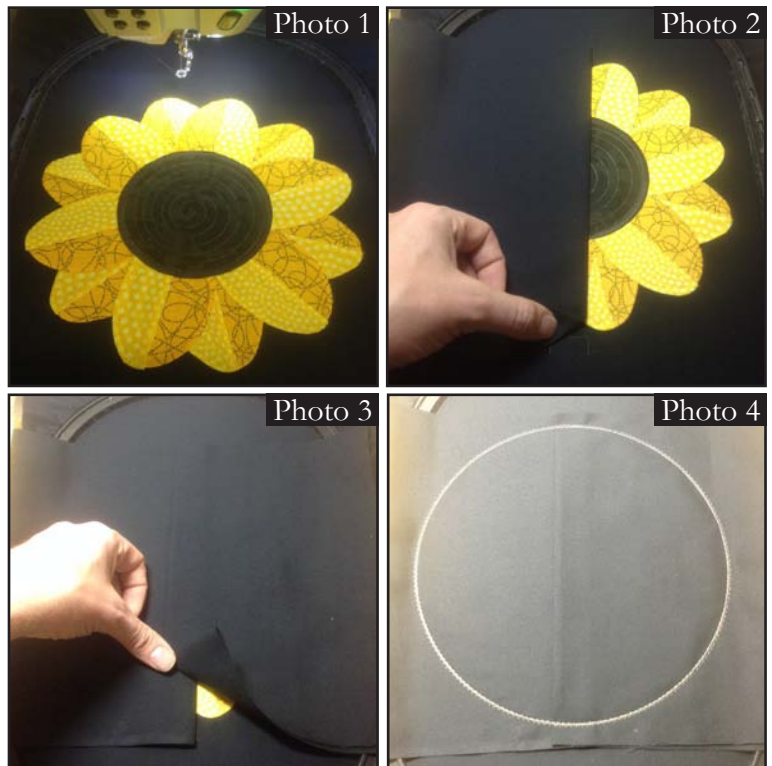

- Remove the hoop from the machine and the fabric from the hoop. Carefully cut out the stitch 'n' turn pillow close to the stitching line. **PHOTO 5**
- Turn the pillow right side out. Use a chopstick or point turner to smooth out curves. Press. **PHOTO 6**

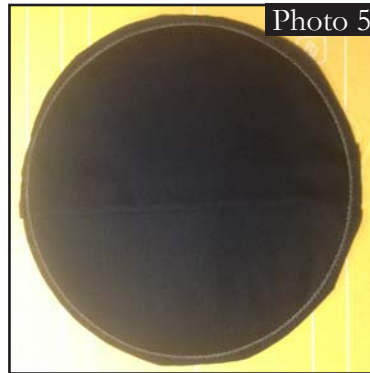

Photo 5



Photo 6

Pillow Form

1/4" seam allowance

- Baste the cotton batting to the wrong side of each of the 10" circles of muslin. Right sides together, stitch, leaving an opening. Turn right side out. Use a chopstick or point turner to smooth out curves. Press. **PHOTO 7**
- Stuff with fiberfill. Slipstitch opening closed. **PHOTO 8**
- Insert into the Sunflower Pillow. Enjoy! **PHOTOS 9 & 10**



Photo 7



Photo 8



Photo 9



Photo 10

ATTENTION

When printing this document, any page scaling or page fitting options in your print dialog box must be turned OFF or set to NONE so that your files will print out at their actual size. Images not printed at actual size will not function as intended.

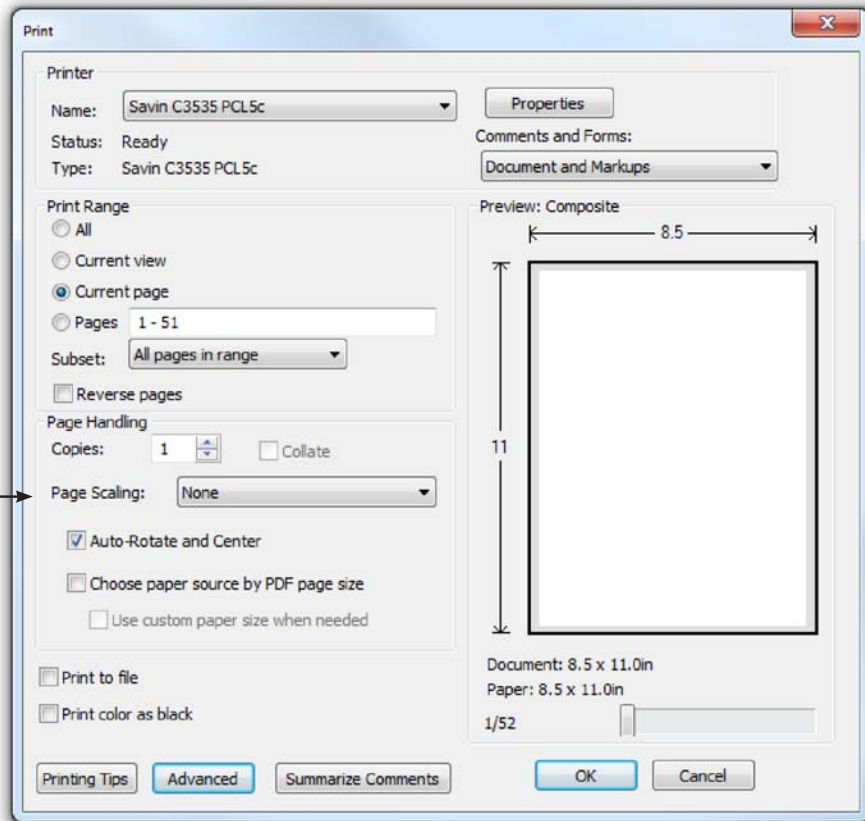

TO SAVE PAPER

Only print the desired image by navigating to the image's page, go to File > Print and select "Current page" in the print dialog box. Repeat for each desired image.

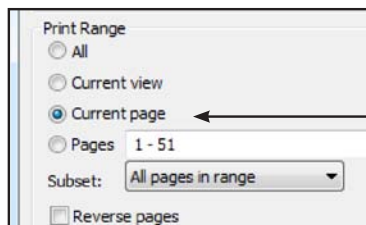



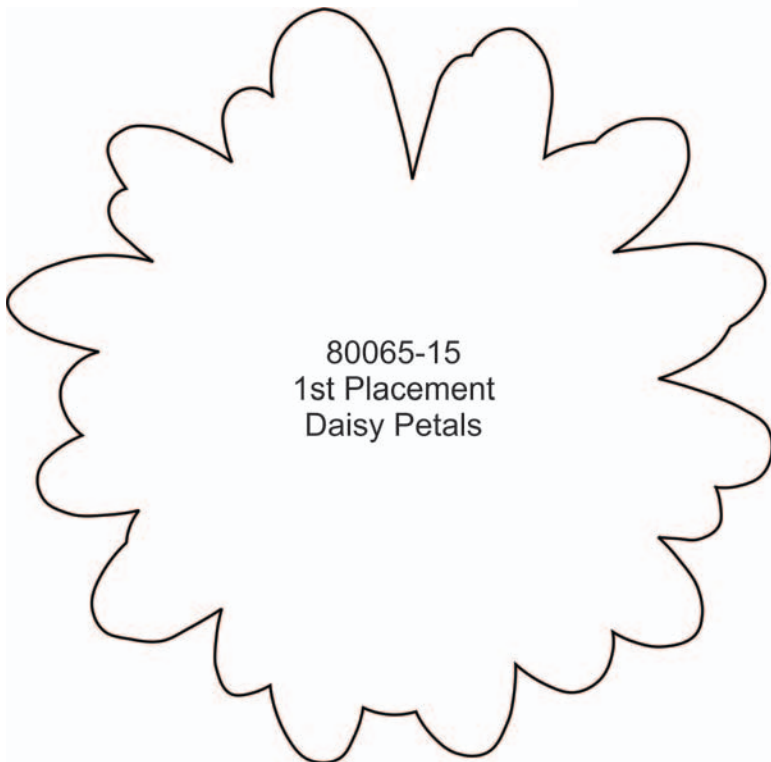
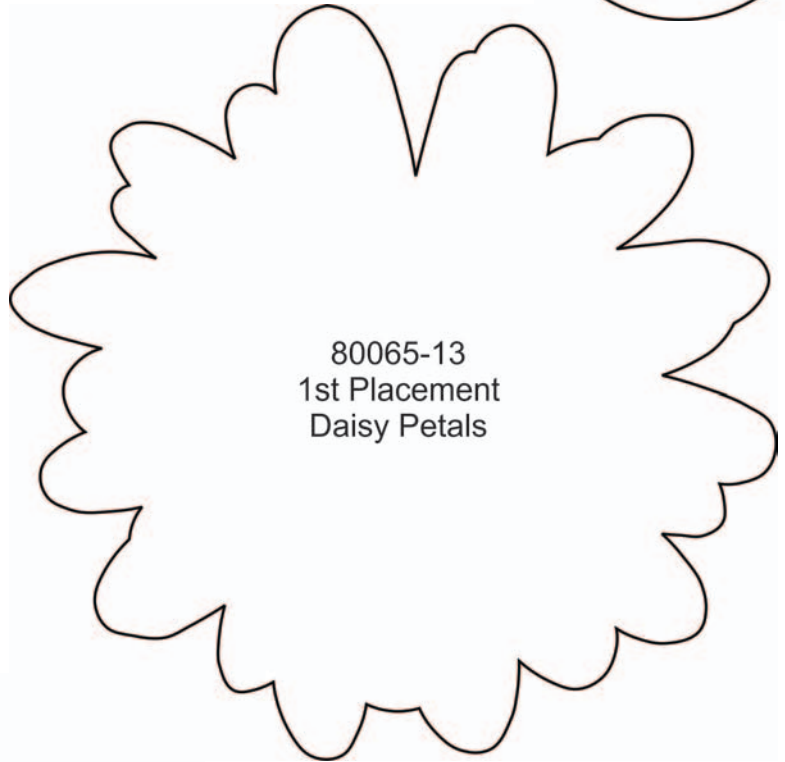

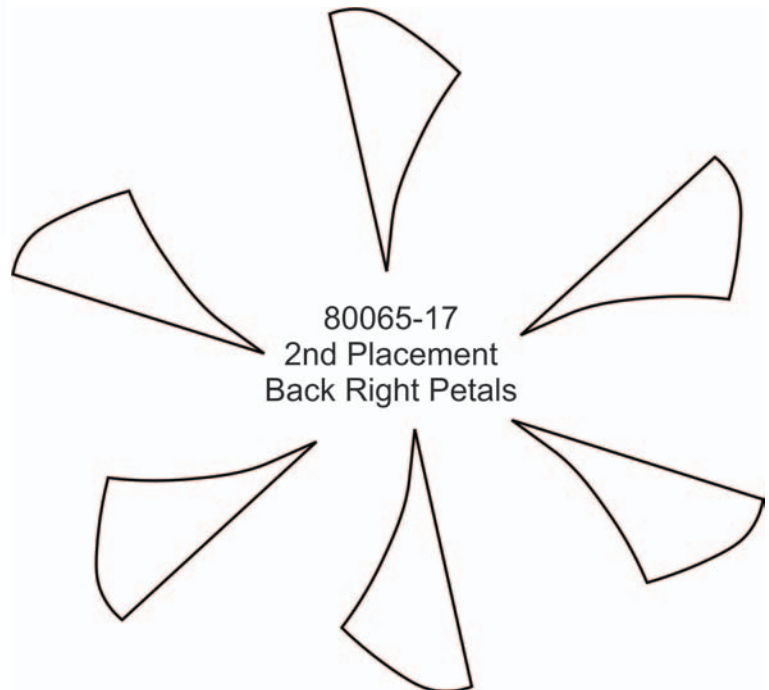
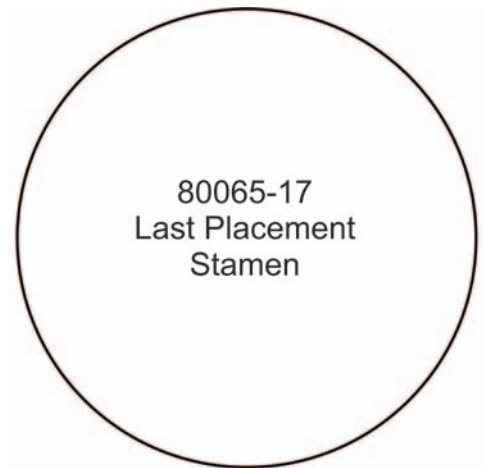
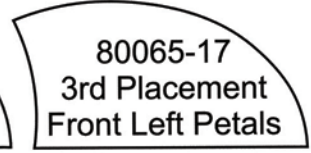
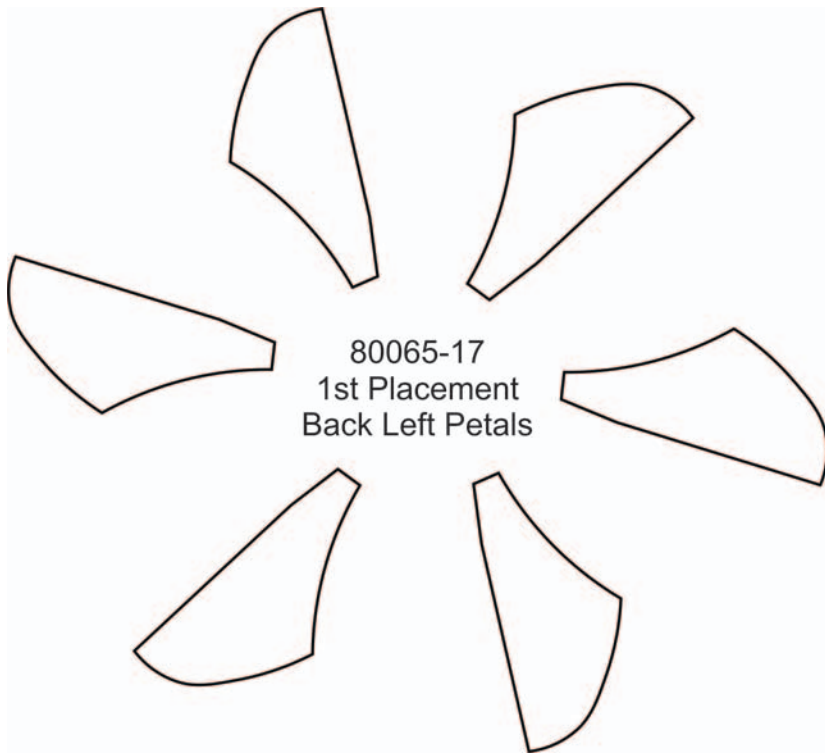

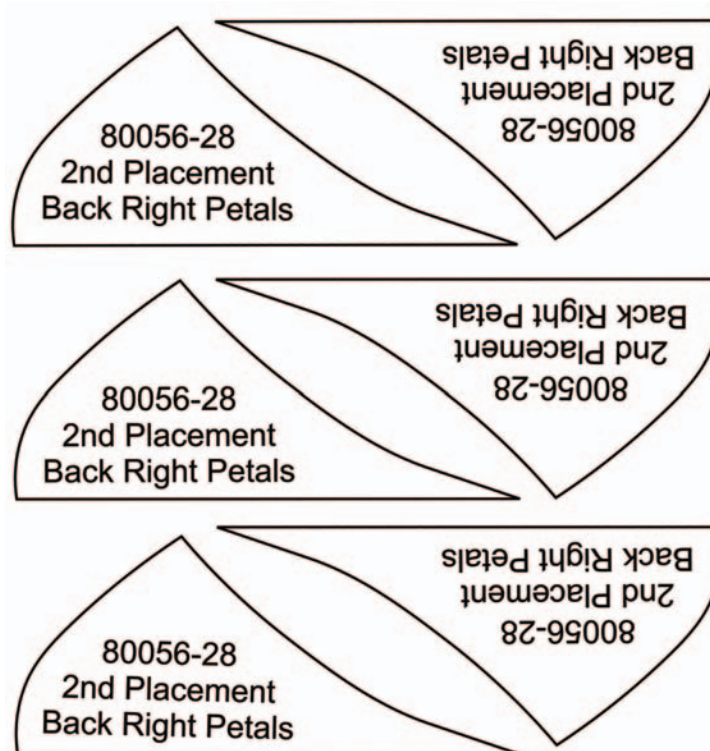
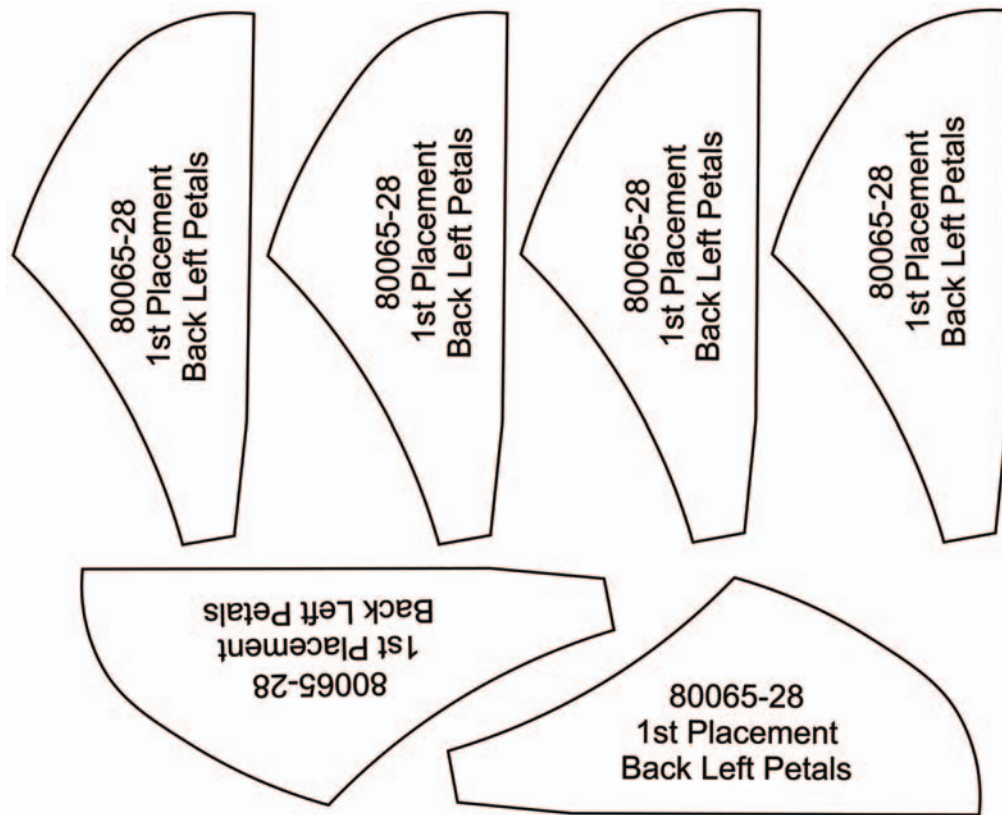

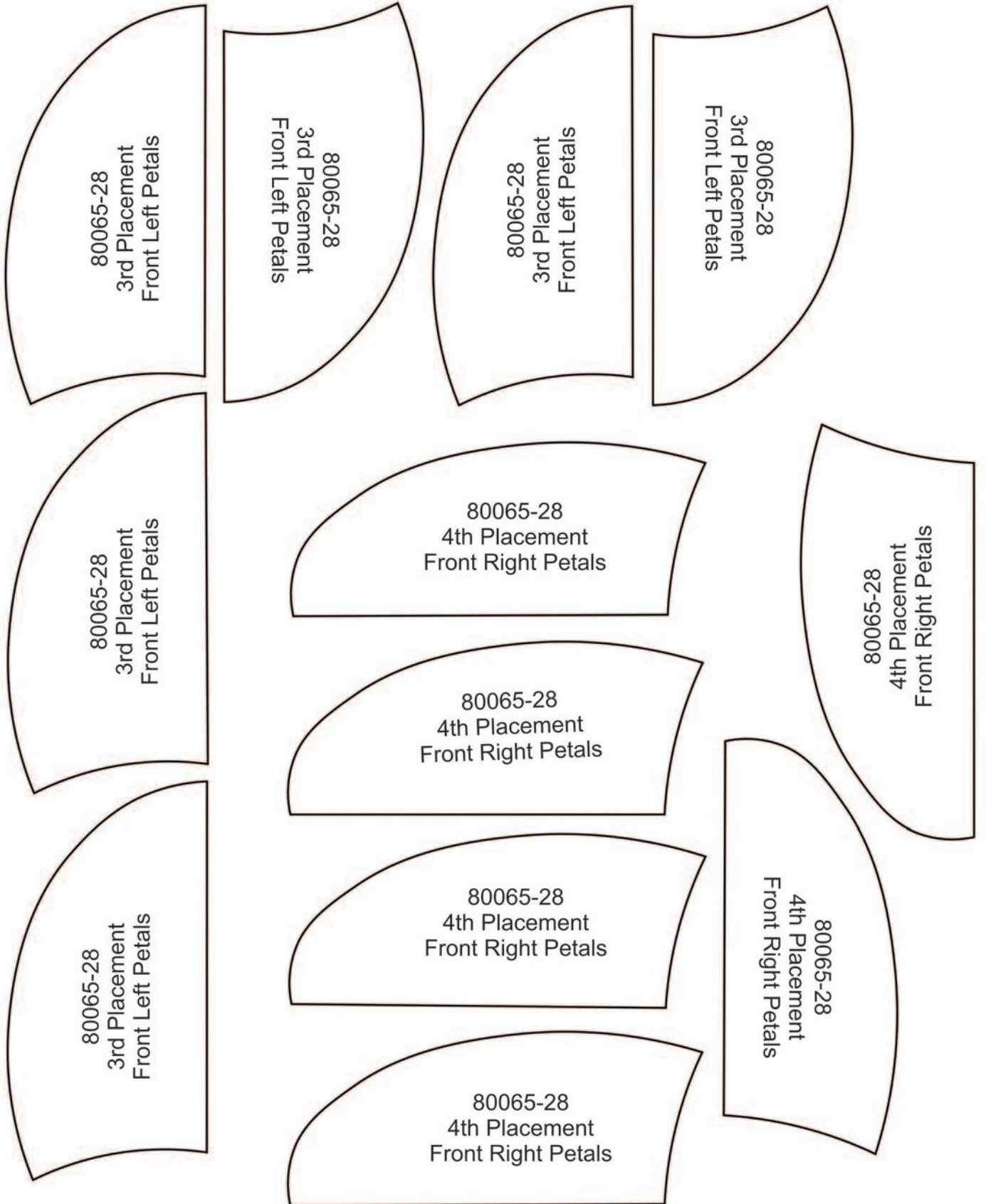

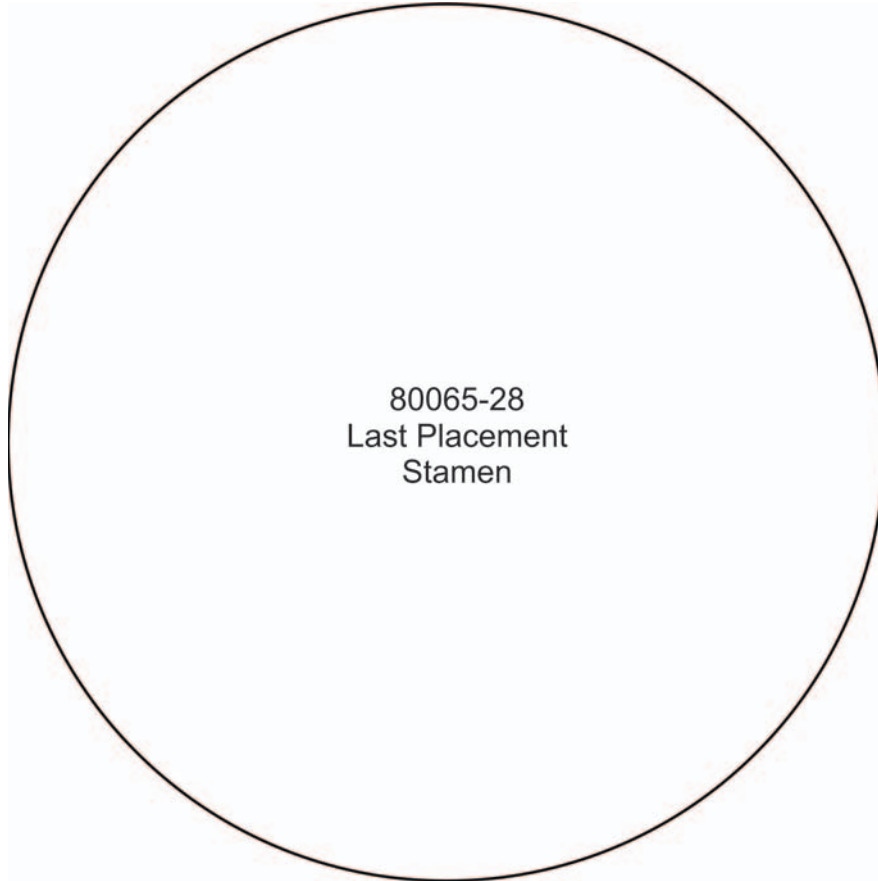

Supplies

- OESD embroidery collection Breezy Blooms by Susan Rooney #80065
- Susan Rooney patterns - Breezy Blooms Bag - Wristlet Pouch & Mini Pouch - #2BB8
- Medium weight tear away
- Isacord embroidery threads
- Temporary spray adhesive
- **Wristlet Pouch Fabrics**
 - ½ yd. fabric (embroidered front, back)
 - ¼ yd. fabric (lining, strap & zipper pull)
 - Fusible interfacing
 - 2 metal rings
 - 1 swivel hook clamp
- **Mini Pouch Fabrics**
 - ½ yd. fabric (embroidered front, back)
 - ¼ yd. fabric (lining & zipper pull)
 - Fusible interfacing

Cut

NOTE: Embroider the designs for the embroidered fronts before cutting the pattern pieces for the Wristlet Pouch and Mini Pouch. Follow the pattern instructions for cutting the lining and interfacing pieces for each bag.

- **Wristlet Pouch**
 - (1) 2" x 14" piece lining fabric (strap)
 - (1) 1" x 5" piece lining fabric (zipper pull)
- **Mini Pouch**
 - (1) 1" x 5" piece lining fabric (zipper pull)

Embroider

NOTE: The designs used in the Wristlet Pouch are #80065-08 & #80065-08 mirror horizontal. The designs used in the Mini Pouch are #80065-20 & #80065-04.

- Cut tear away stabilizer big enough to fit your hoop. Using temporary spray adhesive, spray between two pieces of tear away stabilizer and adhere to each other and to the wrong side of embroidered front piece for the Wristlet Pouch. Hoop the layers. Embroider. Remove from hoop and remove stabilizer. Repeat for the Mini Pouch.

Wristlet Pouch

Assembly: ¼" seam allowance

- Center the pattern over the design and cut out the pattern. **PHOTOS 1 & 2**
- Strap: Using the strap piece, fold and press in half, wrong sides together. Fold raw edges in to meet fold line. Press. Edgestitch both sides. Cut 2" from length of strap. Using a metal ring, place on 2" piece of strap and bring raw edges together. Baste. Set aside. (Ring loop) With remaining strap piece and a swivel hook clamp, place the swivel clamp onto the strap and bring raw edges together. Stitch. Turn strap right side out and move the swivel clamp to the stitched end. Stitch across the strap. Set aside. (Swivel strap) **PHOTO 3**



Photo 1



Photo 2



Photo 3

- Follow the Wristlet Pouch instructions to make the front and back pieces, and adding the zipper.
- After adding the zipper, then follow these instructions for adding the ring loop, and finishing the bag with the swivel strap.
- Unzip the zipper most of the way. Right sides together, match up and pin the pouch adding the ring loop with the raw edges lining up with the edges of the pouch about 1" below the end of the zipper. Stitch. Turn right side out. Press.
- Using 1" x 5" piece fabric (zipper pull), fold and press in half, wrong sides together. Fold raw edges in to meet fold line. Press. Topstitch. Cut one end at an angle to insert into the end of the zipper pull. Fold the strip over onto itself, and stitch the two pieces together. Trim other end of strip at an angle.
- Add the swivel strap to the ring loop. **PHOTO 4**



Mini Pouch

- Center the pattern over the design and cut out the pattern. **PHOTO 5**
- Follow the Mini Pouch instructions to make the bag.
- Using 1" x 5" piece fabric (zipper pull), fold and press in half, wrong sides together. Fold raw edges in to meet fold line. Press. Topstitch. Cut one end at an angle to insert into the end of the zipper pull. Fold the strip over onto itself, and stitch the two pieces together. Trim other end of strip at an angle. **PHOTO 6**



Supplies

- OESD embroidery collection Breezy Blooms by Susan Rooney #80065
- Susan Rooney patterns - Dream Weaver Bed Runner & Pillow Shams #2BDW10
- Medium weight tear away
- Isacord embroidery threads
- Temporary spray adhesive
- OESD Applique Fuse & Stick
- Fabrics - Twin Size Bed Runner
 - 1 ½ yds. Fabric A (embroidered center blocks, setting triangles & ribbon sashes)
 - ½ yd. Fabric B (squares and triangle)
 - ½ yd. Fabric C (square and triangle)
 - ¼ yd. Fabric F (border setting triangles and triangle)
 - ¼ yd. or 7 ½" square Fabric G (triangle)
 - Applique fabrics
 - 1 yd. backing

Cut

NOTE: Do not follow the cut instructions in the Dream Weaver Bed Runner pattern, follow below:

- **Fabric A**
 - (5) 10" x 14" pieces (embroidered center squares)
 - (4) 4 ½" x 25" strips (ribbon sashes)
 - (3) 9 ¾" squares - cut diagonally to make 12 setting triangles (use 10)
- **Fabric B**
 - (6) 6 ½" squares
 - (1) 7 ½" square - cut diagonally to make 4 triangles (use 2)
- **Fabric C**
 - (6) 6 ½" squares
 - (1) 7 ½" square - cut diagonally to make 4 triangles (use 2)
- **Fabric F**
 - (1) 5 ⅛" square - cut diagonally to make 4 border setting triangles (use 2)
 - (1) 7 ½" square - cut diagonally to make 4 triangles (use 2)
- **Fabric G**
 - (1) 7 1½" square - cut diagonally to make 4 triangles (use 2)
- **Backing**
 - (2) 32" x 22" pieces

Embroider

NOTE: The designs used in the bed runner are #80065-03, #80065-07, #80065-11 & #80065-15. (#80065-11 was stitched twice for a total of 5 designs). Using the applique patterns, pre-cut the applique fabrics using the OESD Applique Fuse & Stick, following manufacturer's directions.

- Cut tear away stabilizer big enough to fit your hoop. Using temporary spray adhesive, spray between two pieces of tear away stabilizer and adhere to each other and to the wrong side of Fabric A piece. Hoop the layers. Embroider one of the designs. Remove from hoop and remove stabilizer. Repeat for the remaining designs.

Assembly

$\frac{1}{4}$ " seam allowance

- Center design and cut the embroidered center block to measure $6\frac{1}{2}$ " square. **PHOTOS 1 & 2**
- Repeat for the remaining embroidered center blocks.

PHOTO 3

- Using one of each triangle Fabric B, C, F & G, stitch together to form a block. Cut block down to measure $6\frac{1}{2}$ ". Repeat with another set of triangle Fabric B, C, F & G. These blocks will be used at either end in place of Fabric A in the pattern instructions. (Multi-colored block)
- Follow the Dream Weaver Bed Runner size twin instructions to finish the bed runner using the fabric changes. **PHOTOS 4 & 5**
- The quilting in our sample features stitch-in-the ditch quilting. **PHOTO 6**

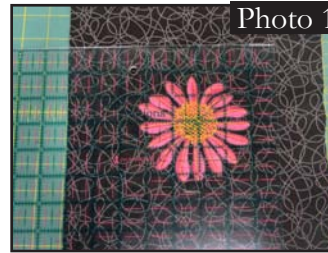

Photo 1



Photo 2



Photo 3



Photo 4



Photo 5



Photo 6