



Note: Some designs in this collection may have been created using unique special stitches and/or techniques. To preserve design integrity when rescaling or rotating designs in your software, always rescale or rotate designs using the handles directly on-screen.



**80071-01 Appliqué**  
6.00 X 5.00 in.  
152.40 X 127.00 mm  
13,153 St. ❄️ L



**80071-02 Buttons**  
7.00 X 5.00 in.  
177.80 X 127.00 mm  
29,586 St. ❄️ L



**80071-03 Calico Appliqué**  
6.00 X 5.00 in.  
152.40 X 127.00 mm  
15,053 St. ❄️ L



**80071-04 Darning**  
6.00 X 5.00 in.  
152.40 X 127.00 mm  
26,899 St. ❄️ L



**80071-05 Embroidery**  
5.00 X 5.00 in.  
127.00 X 127.00 mm  
8,405 St. ❄️



**80071-06 French Knot**  
5.00 X 5.00 in.  
127.00 X 127.00 mm  
9,641 St. ❄️



**80071-07 Gingham**  
6.00 X 5.00 in.  
152.40 X 127.00 mm  
9,985 St. ❄️ L



**80071-08 Handcrafted with Love (A)**  
4.09 X 7.05 in.  
103.89 X 179.07 mm  
19,042 St. ❄️ L

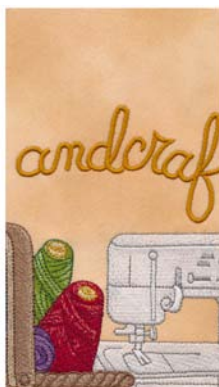

**80071-09 Handcrafted with Love (B)**  
4.13 X 7.04 in.  
104.90 X 178.82 mm  
25,329 St. ❄️ L



**80071-10 Handcrafted with Love (C)**  
4.07 X 7.04 in.  
103.38 X 178.82 mm  
11,929 St. ❄️ L



**80071-11 Handcrafted with Love (D) Appliqué**  
4.10 X 7.04 in.  
104.14 X 178.82 mm  
18,103 St. ❄️ L



**80071-12 Handcrafted with Love (E) Appliqué**  
4.21 X 7.04 in.  
106.93 X 178.82 mm  
24,387 St. ❄️ L

❄️ Design contains a loose fill.

❄️ Some solid areas shown are not stitched.

L Design is larger than 5" (127 mm) in either direction.

S Design is smaller than 1.5" (38.1 mm) in either direction.

Note: Some designs in this collection may have been created using unique special stitches and/or techniques. To preserve design integrity when rescaling or rotating designs in your software, always rescale or rotate designs using the handles directly on-screen.

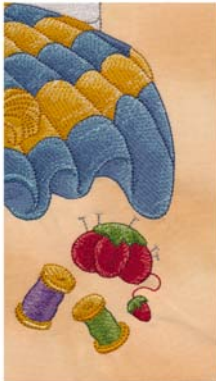

**80071-13 Handcrafted with Love (F)**  
4.10 X 7.04 in.  
104.14 X 178.82 mm  
30,080 St. **L**

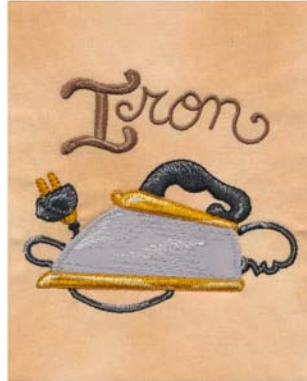

**80071-14 Iron Appliqué**  
4.00 X 5.00 in.  
101.60 X 127.00 mm  
9,166 St. **☼**



**80071-15 Jacquard**  
4.38 X 5.33 in.  
111.25 X 135.38 mm  
17,535 St. **☼ L**



**80071-16 Knitting**  
7.00 X 4.00 in.  
177.80 X 101.60 mm  
23,189 St. **☼ L**



**80071-17 Lace**  
4.13 X 4.00 in.  
104.90 X 101.60 mm  
13,919 St. **☼**



**80071-18 Sewing Machine**  
7.00 X 4.00 in.  
177.80 X 101.60 mm  
22,465 St. **☼ L**



**80071-19 Notions Appliqué**  
7.00 X 4.00 in.  
177.80 X 101.60 mm  
19,870 St. **☼ L**



**80071-20 Organza**  
4.00 X 4.00 in.  
101.60 X 101.60 mm  
12,626 St. **☼**



**80071-21 Pattern**  
7.27 X 4.07 in.  
184.66 X 103.38 mm  
20,529 St. **☼☼ L**



**80071-22 Quilt Appliqué**  
5.15 X 5.15 in.  
130.81 X 130.81 mm  
17,898 St. **☼☼ L**



**80071-23 Ruffle**  
5.14 X 5.05 in.  
130.56 X 128.27 mm  
24,953 St. **☼ L**



**80071-24 Scissors**  
6.00 X 5.00 in.  
152.40 X 127.00 mm  
15,862 St. **☼ L**

☼ Design contains a loose fill.

☼ Some solid areas shown are not stitched.

**L** Design is larger than 5" (127 mm) in either direction.

**S** Design is smaller than 1.5" (38.1 mm) in either direction.

It is a violation of Copyright law to make and distribute copies of electronic designs or artwork. Electronic designs are licensed to the original purchaser for use at one location. ©2015 Krista Hamrick, for use in home embroidery. All rights reserved.

Note: Some designs in this collection may have been created using unique special stitches and/or techniques. To preserve design integrity when rescaling or rotating designs in your software, always rescale or rotate designs using the handles directly on-screen.

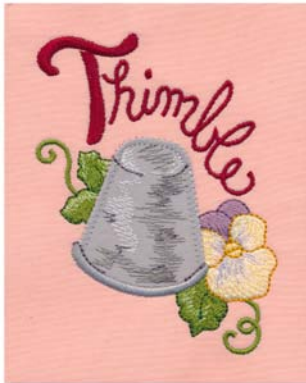

**80071-25 Thimble Appliqué**  
4.00 X 5.00 in.  
101.60 X 127.00 mm  
9,424 St. ❁

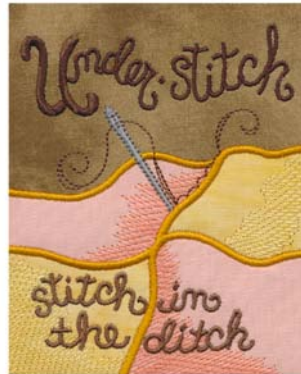

**80071-26 Under Stitch - Stitch in the Ditch Appliqué**  
4.24 X 5.10 in.  
107.70 X 129.54 mm  
13,633 St. ❁ L



**80071-27 Venice Lace**  
4.16 X 5.00 in.  
105.66 X 127.00 mm  
11,520 St. ❁❁



**80071-28 Wool**  
5.00 X 5.00 in.  
127.00 X 127.00 mm  
24,611 St. ❁



**80071-29 Cross Stitch**  
6.00 X 5.00 in.  
152.40 X 127.00 mm  
12,020 St. ❁ L

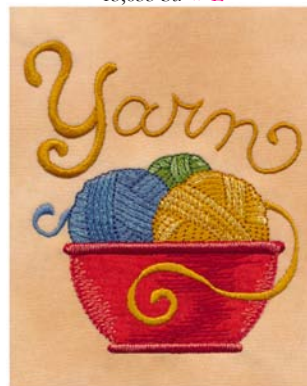

**80071-30 Yarn Appliqué**  
4.00 X 5.00 in.  
101.60 X 127.00 mm  
13,368 St. ❁

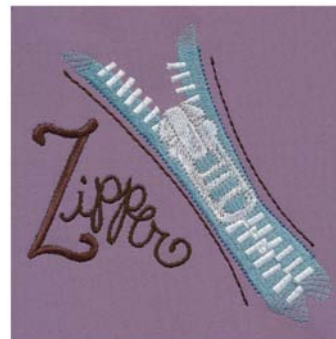

**80071-31 Zipper**  
5.00 X 5.00 in.  
127.00 X 127.00 mm  
12,955 St. ❁❁



**80071-32 Sewing Keeps Me in Stitches**  
2.00 X 4.00 in.  
50.80 X 101.60 mm  
5,161 St. ❁



**80071-33 A Stitch in Time**  
2.00 X 4.00 in.  
50.80 X 101.60 mm  
3,333 St. ❁

❁ Design contains a loose fill.

❁ Some solid areas shown are not stitched.

L Design is larger than 5" (127 mm) in either direction.

S Design is smaller than 1.5" (38.1 mm) in either direction.

It is a violation of Copyright law to make and distribute copies of electronic designs or artwork. Electronic designs are licensed to the original purchaser for use at one location. ©2015 Krista Hamrick, for use in home embroidery. All rights reserved.

Listings below indicate color sample, stitching order and suggested thread color number. Most numbers indicate Isacord thread. Colors beginning with 20501 refer to YLI Fine Metallics, 7 refer to Yenmet Metallic, 8 refer to YLI Variations Variegated Thread and 9 refer to Isacord Multicolor Variegated.

### 80071-01 Appliqué

1. Flowers Placement Stitch.....	2101
2. Tackdown.....	2101
3. Flower Shading.....	1912
4. Light Flower Shading.....	1521
5. Flower Stitches.....	2123
6. Stamen.....	0771
7. Light Leaf Shading.....	6141
8. Dark Leaf Shading.....	5833
9. Leaf Stitches.....	5643
10. Lettering & Swirls.....	1055
11. A Highlights.....	0853
12. Seam Stitch.....	0020

### 80071-02 Buttons

1. Blue Buttons.....	4332
2. Blue Button Highlights.....	4152
3. Gold Button.....	0824
4. Gold Button Highlights.....	0640
5. Light Brown Buttons & Detail.....	0853
6. Dark Brown Button & Detail.....	1055
7. Gold Outlines & Thread.....	0824
8. Brown Button Highlights.....	1161
9. Light Yellow Highlights.....	0660
10. Dark Brown Button Outline.....	1876
11. White Thread.....	0015
12. Dark Blue Thread & Detail.....	3654
13. Lettering.....	1876
14. B Highlights.....	1055
15. Seam Stitch.....	0020

### 80071-03 Calico Appliqué

1. Cat Placement Stitch.....	0870
2. Tackdown.....	0870
3. Cat Light Shading.....	0771
4. Cat Dark Shading.....	0862
5. Ears & Nose.....	1430
6. Ears Dark Shading & Spot.....	1332
7. Gold Spot.....	0824
8. Gold Spot Shading.....	0853
9. Dark Brown Spot.....	1055
10. Mouth & Eyes.....	4174
11. Whiskers.....	0015
12. Lettering.....	1912
13. C Highlights.....	2101
14. White Flowers.....	0015
15. Leaves.....	6141
16. Red Flowers.....	2101
17. Stamens.....	0824
18. Dark Red Swirls.....	2123
19. Seam Stitch.....	0020

### 80071-04 Darning

1. Heel & Toes.....	1322
2. Heel & Toe Shading.....	1055
3. Socks.....	0824
4. Dark Gold Shading.....	0940
5. Light Yellow Shading.....	0640
6. Pale Yellow Shading.....	0660
7. Blue Stripes.....	4332
8. White Stripes.....	0015
9. Heel & Toe Outlines.....	1876
10. Sock Outlines.....	0940
11. Needles.....	0131
12. Needle Shading.....	0152
13. Lettering.....	4152
14. D Highlights.....	3963
15. Seam Stitch.....	0020

### 80071-05 Embroidery

1. Dark Red Petals.....	2101
2. Light Red Petals.....	1521
3. Gold Petals.....	0824
4. Leaves.....	5833
5. Flower & Leaf Outlines.....	0651
6. Lettering.....	4152
7. E Highlights.....	3963
8. Seam Stitch.....	0020

### 80071-06 French Knot

1. Needle.....	0131
2. Needle Dark Shading.....	0152
3. Needle Highlights.....	0015
4. Thread.....	0824
5. Thread Highlights.....	0640
6. Thread Dark Shading.....	0940
7. Lettering.....	1876
8. F Highlights.....	1055
9. Seam Stitch.....	0020

### 80071-07 Gingham

1. Shell.....	2101
2. Shell Shading.....	2123
3. Head, Spots & Rear.....	4174
4. Head & Spots Highlights.....	0152
5. Antennae, Head & Rear Shading.....	0020
6. Lettering.....	0020
7. G Highlights.....	4174
8. Seam Stitch.....	0020

### 80071-08 Handcrafted with Love (A)

1. Basket.....	0853
2. Basket Highlights.....	1161
3. Needles.....	0015
4. Needle Outlines.....	0131
5. Blue Yarn.....	3953
6. Blue Yarn Highlights.....	4332
7. Blue Yarn Dark Detail.....	3654
8. Purple Yarn.....	2832
9. Purple Yarn Highlights.....	2764
10. Purple Yarn Dark Detail.....	3114
11. Basket Dark Detail.....	1055
12. Lettering.....	0940
13. H Highlights.....	0824
14. Seam Stitch.....	0020

### 80071-09 Handcrafted with Love (B)

1. Green Thread.....	5833
2. Green Thread Highlights.....	6141
3. Green Thread Dark Detail.....	5643
4. Machine.....	0015
5. Machine Shading.....	0150
6. Machine Dark Detail.....	0152
7. Red Thread.....	2101
8. Red Thread Highlights.....	1521
9. Red Thread Dark Detail.....	2123
10. Spool Tops.....	0651
11. Spool Tops Highlights.....	0660
12. Spool Tops Outlines.....	0824
13. Blue Yarn.....	3953
14. Blue Yarn Highlights.....	4332
15. Blue Yarn Dark Detail.....	3654
16. Purple Yarn.....	2832
17. Purple Yarn Highlights.....	2764
18. Purple Yarn Dark Detail.....	3114
19. Basket.....	0853
20. Basket Highlights.....	1161
21. Basket Dark Detail.....	1055
22. Lettering.....	0940
23. Seam Stitch.....	0020

### 80071-10 Handcrafted with Love (C)

1. Thread.....	1521
2. Thread Detail.....	2101
3. Spool.....	0824
4. Spool Outlines.....	0940
5. Machine.....	0015
6. Machine Light Shading.....	0150
7. Machine Dark Detail.....	0152
8. Lettering.....	0940
9. Seam Stitch.....	0020

### 80071-11 Handcrafted with Love (D) Appliqué

1. Basket.....	0853
2. Basket Highlights.....	1161
3. Basket Dark Detail.....	1055
4. Pillow Placement Stitch.....	5833
5. Tackdown & Shading.....	5833
6. Pillow Highlights.....	6141
7. Pillow Dark Detail.....	5643
8. Cat Placement Stitch.....	0651
9. Tackdown.....	0651
10. Cat Light Brown Shading.....	0862
11. Cat Medium Brown Shading.....	0776
12. Cat Dark Brown Shading.....	1375
13. Cat Light Yellow Shading.....	0660
14. Blades.....	0131
15. Blade Outlines.....	0152
16. Handles.....	0020
17. Red Thread.....	2101
18. Red Thread Detail.....	2123
19. Blue Thread.....	4332
20. Blue Thread Detail.....	3953
21. Tassel & Spools.....	0824
22. Tassel & Spools Highlights.....	0640
23. Tassel & Spool Dark Detail.....	0940
24. Lettering.....	0940
25. Red Thread Highlights.....	1521
26. Blue Thread Highlights.....	3963
27. Seam Stitch.....	0020

### 80071-12 Handcrafted with Love (E) Appliqué

1. Machine.....	0015
2. Orange Fabric.....	0824
3. Orange Fabric Highlights.....	0640
4. Orange Fabric Light Yellow Shading.....	0660
5. Orange Fabric Dark Shading.....	0940
6. Blue Fabric.....	3953
7. Blue Fabric Medium Shading.....	4332
8. Blue Fabric Highlights.....	4152
9. Blue Fabric Dark Detail.....	3654
10. Basket.....	0853
11. Basket Highlights.....	1161
12. Basket Dark Detail.....	1055
13. Pillow Placement Stitch.....	5833
14. Tackdown & Shading.....	5833
15. Pillow Highlights.....	6141
16. Pillow Dark Detail.....	5643
17. Cat Placement Stitch.....	0651
18. Tackdown.....	0651
19. Cat Light Yellow Shading.....	0660
20. Cat Light Brown Shading.....	0862
21. Cat Medium Brown Shading.....	0776
22. Cat Dark Brown Shading.....	1375
23. Cat White Shading.....	0015
24. Pink Ear & Nose.....	2153
25. Tassels.....	0824
26. Tassel Light Shading.....	0640
27. Tassel Dark Detail.....	0940
28. Lettering.....	0940
29. Seam Stitch.....	0020

Listings below indicate color sample, stitching order and suggested thread color number. Most numbers indicate Isacord thread. Colors beginning with 20501 refer to YLI Fine Metallics, 7 refer to Yenmet Metallic, 8 refer to YLI Variations Variegated Thread and 9 refer to Isacord Multicolor Variegated.

### 80071-13 Handcrafted with Love (F)

1. Machine.....	0015
2. Orange Fabric.....	0824
3. Orange Fabric Highlights.....	0640
4. Orange Fabric Light Highlights.....	0660
5. Orange Fabric Dark Detail.....	0940
6. Blue Fabric.....	3953
7. Blue Fabric Medium Shading.....	4332
8. Blue Fabric Light Highlights.....	4152
9. Blue Fabric Dark Detail.....	3654
10. Machine Outlines.....	0152
11. Tassel.....	0824
12. Tassel Highlights.....	0640
13. Tassel Dark Details.....	0940
14. Pins.....	0152
15. Cushions.....	2101
16. Cushion Highlights.....	1521
17. Cushion Medium Shading.....	1912
18. Cushion Outlines.....	2123
19. Green Detail.....	5833
20. Green Thread Highlights.....	6141
21. Green Thread Dark Detail.....	5643
22. Purple Thread.....	2832
23. Purple Thread Highlights.....	2764
24. Purple Thread Dark Details.....	3114
25. Spools.....	0824
26. Spool Highlights.....	0640
27. Spool Details.....	0940
28. Seam Stitch.....	0020

### 80071-14 Iron Appliqué

1. Iron Placement Stitch.....	0131
2. Tackdown & Iron Shading.....	0131
3. Gold Detail.....	0824
4. Iron White Shading.....	0015
5. Gold Detail Highlights.....	0640
6. Plug & Handle.....	4174
7. Plug & Handle Highlights.....	0152
8. Black Detail.....	0020
9. Dark Gold Outlines.....	0940
10. Pale Yellow Shading.....	0660
11. Cord Highlights.....	0152
12. Cord Light Highlights.....	0131
13. Lettering.....	1055
14. I Highlights.....	0853
15. Seam Stitch.....	0020

### 80071-15 Jacquard

1. Vines.....	1912
2. Dark Red Lettering.....	2123
3. Lettering.....	2153
4. Letter J Highlights.....	2171
5. Hearts.....	1755
6. Heart Outlines.....	2241
7. Seam Stitch.....	0020

### 80071-16 Knitting

1. Needles.....	0131
2. Needle Highlights.....	0015
3. Yarn.....	0824
4. Yarn Highlights.....	0640
5. Yarn Pale Highlights.....	0660
6. Yarn Dark Detail.....	0940
7. Lettering.....	2123
8. K Highlights.....	1912
9. Seam Stitch.....	0020

### 80071-17 Lace

1. Lace.....	0015
2. Lettering.....	3114
3. L Highlights.....	3211
4. Seam Stitch.....	0020

### 80071-18 Sewing Machine

1. Machine.....	4174
2. Machine Highlights.....	0152
3. Machine Light Grey Shading.....	0131
4. Thread.....	4152
5. Foot.....	0015
6. Spool.....	0824
7. Black Machine Detail.....	0020
8. Gold Machine Detail.....	0824
9. Gold Detail Highlights.....	0640
10. Lettering.....	1912
11. M Highlights.....	2101
12. Seam Stitch.....	0020

### 80071-19 Notions Appliqué

1. Blue Thread.....	4332
2. Blue Thread Highlights.....	4152
3. Blue Thread Dark Detail.....	3953
4. Purple Thread.....	2832
5. Purple Thread Dark Detail.....	3114
6. Purple Thread Highlights.....	2764
7. Spools.....	0824
8. Spool Highlights.....	0640
9. Spool Pale Highlights.....	0660
10. Spool Dark Detail.....	0940
11. Pincushion Placement Stitch.....	2101
12. Tackdown & Strawberry.....	2101
13. Pincushion & Strawberry Medium Shading.....	1912
14. Pincushion & Strawberry Dark Red Outlines.....	2123
15. Button.....	0853
16. Button Highlights.....	1161
17. Button Brown Detail.....	1055
18. Needle & Pins.....	0131
19. Blue Thread & Pin Heads.....	3953
20. Purple Thread.....	2832
21. Leaves & Pin Heads.....	5833
22. Leaf Highlights.....	6141
23. Leaf Outlines.....	5643
24. Lettering.....	1055
25. N Highlights.....	0853
26. Seam Stitch.....	0020

### 80071-20 Organza

1. Ribbon.....	0824
2. Ribbon Highlights.....	0640
3. Dark Gold Detail.....	0940
4. Pale Yellow Highlights.....	0660
5. Lettering.....	3654
6. O Highlights.....	3953
7. Seam Stitch.....	0020

### 80071-21 Pattern

1. Blue Pattern Detail.....	4332
2. Red Pattern Detail.....	2101
3. Gold Pattern Detail.....	0824
4. Light Yellow Pattern Detail.....	0660
5. Brown Outlines.....	0853
6. Lettering.....	4152
7. P Highlights.....	3963
8. Seam Stitch.....	0020

### 80071-22 Quilt Appliqué

1. Yellow Shapes.....	0640
2. Blue Shapes.....	4332
3. Red Shapes.....	2101
4. Dark Blue Shapes.....	3654
5. Background Placement Stitch.....	0651
6. Tackdown.....	0651
7. Lettering.....	0940
8. Q Highlights.....	0824
9. Seam Stitch.....	0020

### 80071-23 Ruffle

1. Ruffles.....	0015
2. Ruffle Shading.....	3963
3. Ruffle Dark Detail.....	4332
4. Lettering.....	1876
5. R Highlights.....	1055
6. Seam Stitch.....	0020

### 80071-24 Scissors

1. Spool.....	0824
2. Spool Highlights.....	0660
3. Spool Yellow Shading.....	0640
4. Thread.....	2832
5. Thread Dark Shading.....	3114
6. Spool Outlines.....	0940
7. Thread Highlights.....	2764
8. Blades.....	0131
9. Blade Shading.....	0152
10. Blade Outlines & Handles.....	4174
11. Handle Light Shading.....	0152
12. Handle Dark Shading & Outlines.....	0020
13. Lettering.....	2123
14. S Highlights.....	1912
15. Seam Stitch.....	0020

### 80071-25 Thimble Appliqué

1. Leaves & Vines.....	5833
2. Light Leaf Shading.....	6141
3. Dark Leaf Detail.....	5643
4. Purple Petals.....	2764
5. Purple Petal Shading.....	2832
6. Pale Yellow Petals.....	0660
7. Light Yellow Petal Shading.....	0640
8. Pale Purple Shading.....	3150
9. Gold Petal Outlines.....	0824
10. Thimble Placement Stitch.....	0131
11. Tackdown & Shading.....	0131
12. Medium Thimble Shading.....	0152
13. White Thimble Shading.....	0015
14. Dark Grey Thimble Shading.....	0138
15. Lettering.....	1912
16. T Highlights.....	2101
17. Seam Stitch.....	0020

### 80071-26 Under Stitch - Stitch in the Ditch Appliqué

1. Pink Fabric Placement Stitch.....	1430
2. Tackdown.....	1430
3. Yellow Fabric Placement Stitch.....	1430
4. Tackdown.....	1430
5. Pink Fabric Shading.....	1430
6. Yellow Fabric Shading.....	0640
7. Cover Stitch.....	0824
8. Thread.....	1055
9. Bottom Lettering.....	1055
10. Needle.....	0131
11. Needle Outlines.....	0152
12. Top Lettering.....	1876
13. U Highlights.....	1055
14. Seam Stitch.....	0020

### 80071-27 Venice Lace

1. Lace.....	0015
2. Lettering.....	3114
3. V Highlights.....	3211
4. Seam Stitch.....	0020



# Sewing Quilt

by Krista Hamrick / #80071 / 33 Designs

Listings below indicate color sample, stitching order and suggested thread color number. Most numbers indicate Isacord thread. Colors beginning with 20501 refer to YLI Fine Metallics, 7 refer to Yenmet Metallic, 8 refer to YLI Variations Variegated Thread and 9 refer to Isacord Multicolor Variegated.

### 80071-28 Wool

1. Green Thread.....	5833
2. Green Thread Highlights.....	6141
3. Green Thread Dark Detail.....	5643
4. Purple Thread.....	2832
5. Purple Thread Highlights.....	2764
6. Purple Thread Dark Detail.....	3114
7. Blue Thread.....	3953
8. Blue Thread Highlights.....	4332
9. Blue Thread Dark Detail.....	3654
10. Orange Thread.....	0824
11. Orange Thread Highlights.....	0640
12. Orange Thread Dark Detail.....	0940
13. Spool Ends.....	0651
14. Spool End Outlines.....	0824
15. Lettering.....	2123
16. W Highlights.....	1912
17. Seam Stitch.....	0020

### 80071-29 Cross Stitch

1. Numbering & Linework.....	0020
2. Needle.....	0131
3. Needle Shading & Outlines.....	0152
4. Thread.....	5833
5. Light Green Shading.....	6141
6. Dark Green Shading & Outlines.....	5643
7. Lettering.....	4152
8. Seam Stitch.....	0020

### 80071-30 Yarn Appliqué

1. Green Yarn.....	5833
2. Green Yarn Highlights.....	6141
3. Green Yarn Outlines.....	5643
4. Blue Yarn.....	3953
5. Blue Yarn Highlights.....	4332
6. Blue Yarn Outlines.....	3654
7. Orange Yarn.....	0824
8. Orange Yarn Highlights.....	0640
9. Orange Yarn Outlines.....	0940
10. Bowl Placement Stitch.....	0651
11. Tackdown & Detail.....	2101
12. Bowl Highlights.....	1521
13. Orange Yarn.....	0824
14. Lettering.....	0940
15. Y Highlights.....	0824
16. Seam Stitch.....	0020

### 80071-31 Zipper

1. Zipper Fabric.....	4332
2. Teeth & Pull.....	0015
3. Zipper Outlines.....	3953
4. Pull Shading & Outlines.....	0131
5. Stitching.....	3114
13. Lettering.....	1876
14. Z Highlights.....	1055
8. Seam Stitch.....	0020

### 80071-32 Sewing Keeps Me in Stitches

1. Lettering.....	1876
2. Heart.....	1521
3. Heart Outlines.....	2101
4. Vines.....	5833
5. Seam Stitch.....	0020

### 80071-33 A Stitch in Time

1. Lettering.....	1876
2. Seam Stitch.....	0020

## Isacord Thread Colors Used in "Sewing Quilt"

By Krista Hamrick

Collection #80071

0015 White	0940 Autumn leaf	2241 Mauve
0020 Black	1055 Bark	2764 Violet
0131 Smoke	1161 Straw	2832 Easter purple
0138 Heavy storm	1322 Dirty penny	3114 Purple twist
0150 Mystik grey	1332 Harvest	3150 Stainless
0152 Dolphin	1375 Dark charcoal	3211 Twilight
0640 Parchment	1430 Melon	3654 Blue shadow
0651 Cornsilk	1521 Flamingo	3953 Ocean blue
0660 Vanilla	1755 Hyacinth	3963 Hint of blue
0771 Rattan	1876 Chocolate	4152 Serenity
0776 Sage	1912 Winterberry	4174 Charcoal
0824 Liberty gold	2101 Country red	4332 Rough sea
0853 Pecan	2123 Bordeaux	5643 Green dust
0862 Wild rice	2153 Dusty mauve	5833 Lima bean
0870 Muslin	2171 Blush	6141 Spring green

1. Print out the necessary pages from the PDF of the appliqué pattern(s).
2. Mark the right side of the pattern pieces so you'll know which direction to lay the pattern on the fabric.
3. Lightly spray the wrong side of the pattern pieces with temporary adhesive spray and allow it to set for a few minutes.
4. Place the pattern pieces on the right side of the fabric and carefully cut them out. **PHOTO 1**
5. Sew the placement stitch on your hooped fabric. **PHOTO 2**
6. With the paper still stuck to the right side of the appliqué fabric, spray the wrong side of the fabric with temporary spray adhesive.
7. Place the fabric inside the sewing placement stitch so that it matches the stitching line, and then remove the paper pattern. **PHOTO 3**
8. Sew the tackdown. **PHOTO 4**
9. Sew the remainder of the design and repeat for any remaining pieces. **PHOTO 5**

**NOTE: The patterns are sized for the designs as they were made. If you resize the design, you will need to resize the pattern the same amount. You can print out the pattern at the normal size then copy it on a copy machine at the changed size. For example, resize the designs to 80%, resize the printed pattern to 80%.**

**TIP: When Printing the patterns, make sure that the “Fit to page” option is UNCHECKED in the Print Dialog Box. If this option is checked the printed patterns will not be actual size.**

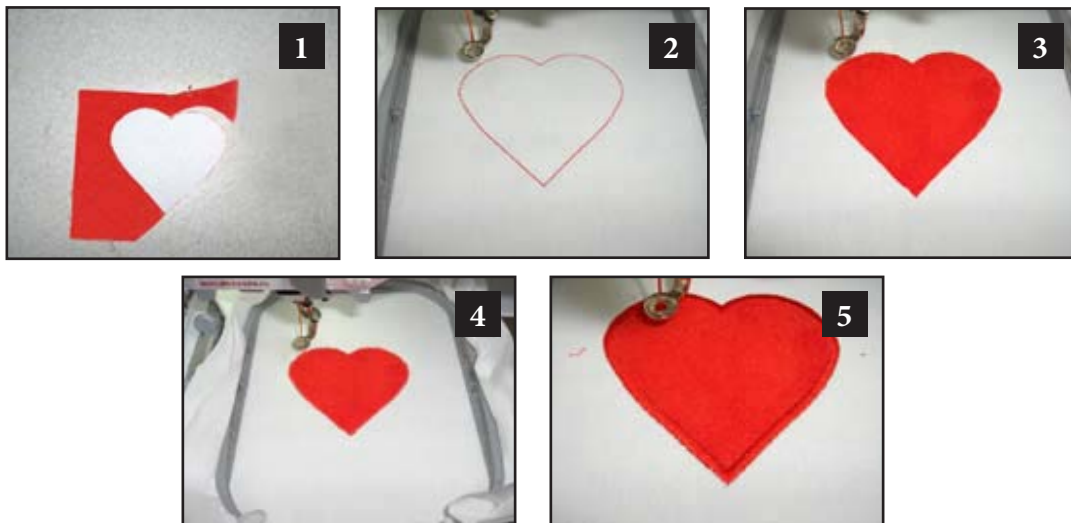



## ATTENTION

When printing this document, any page scaling or page fitting options in your print dialog box must be turned OFF or set to NONE so that your files will print out at their actual size. Images not printed at actual size will not function as intended.

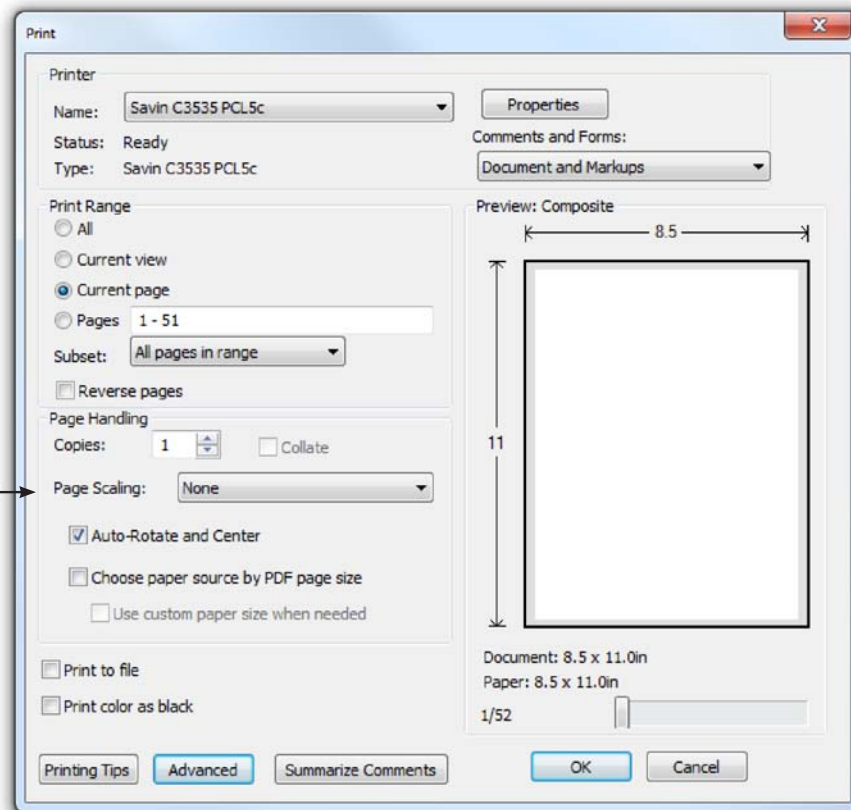

## TO SAVE PAPER

Only print the desired image by navigating to the image's page, go to File > Print and select "Current page" in the print dialog box. Repeat for each desired image.

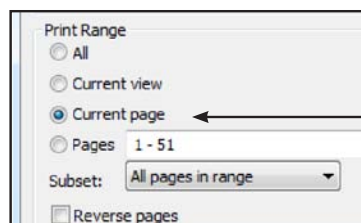

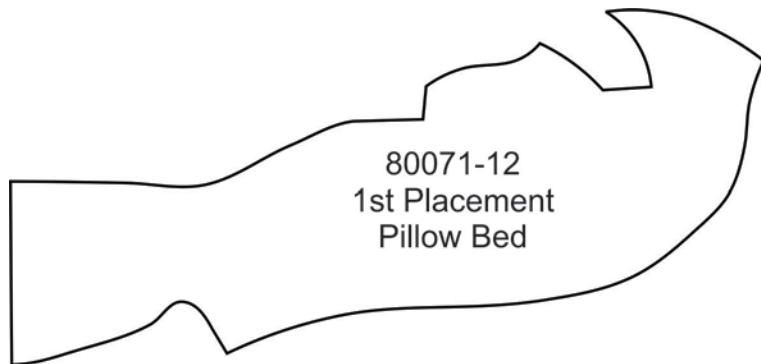
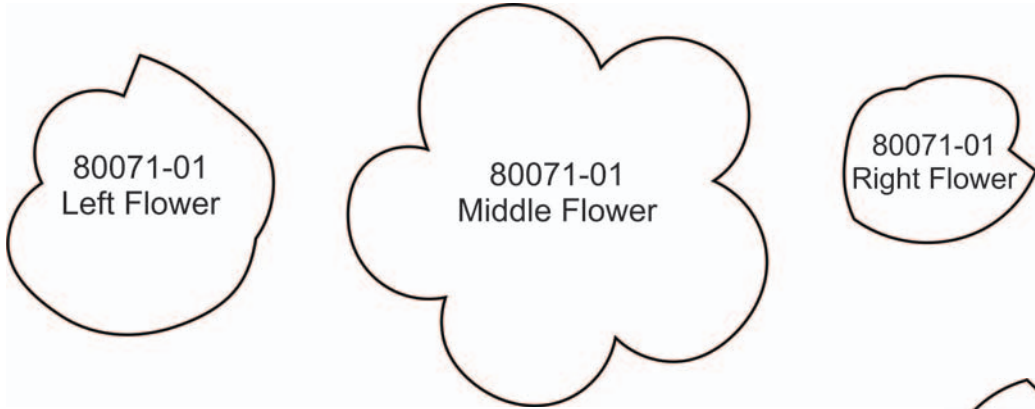

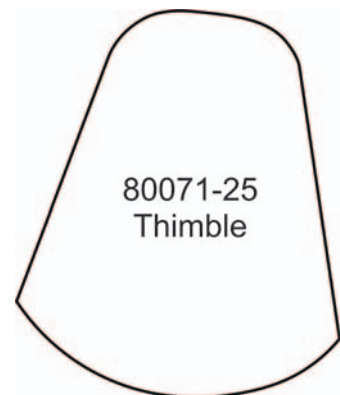
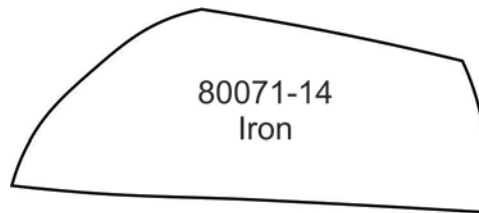
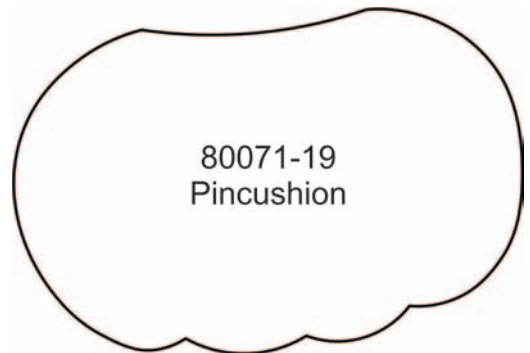
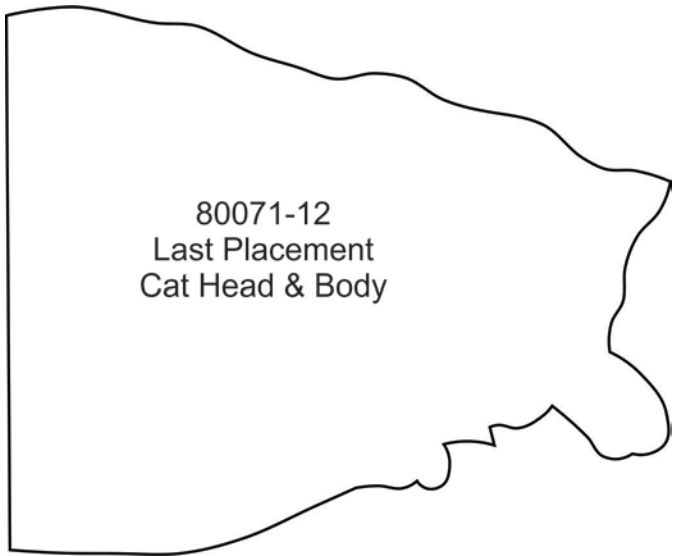

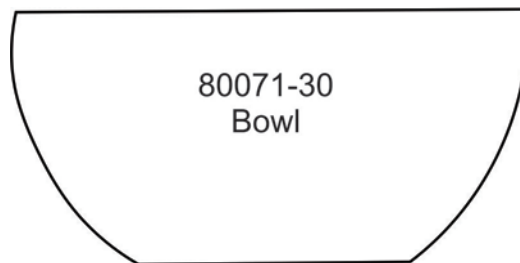
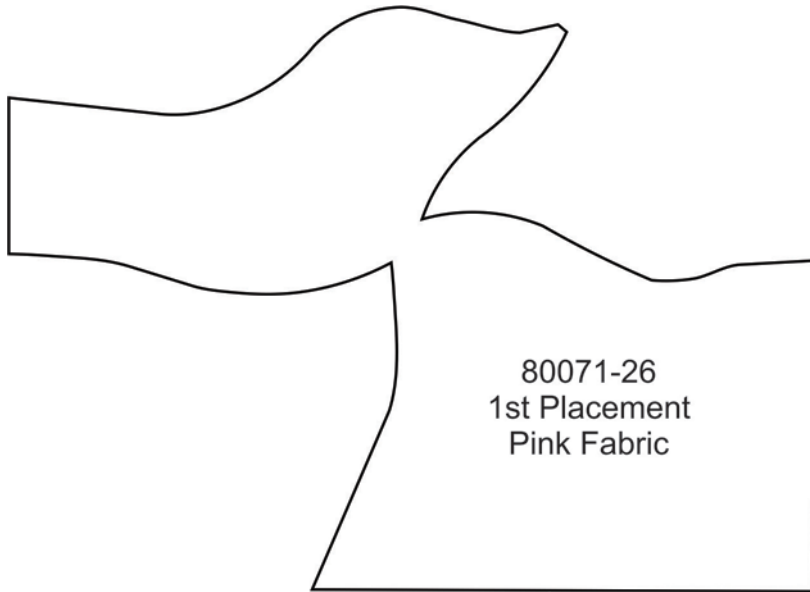

### Supplies

- OESD embroidery collection #80071 Sewing Quilt by Krista Hamrick
- OESD Light Weight Tear-away stabilizer
- OESD Heavy Weight Tear-away stabilizer
- Background fabrics
  - 1 ¼ yard cream background fabric
  - ¾ yard or fat quarter dark purple background fabric
  - ½ yard pink background fabric
  - ½ yard dark blue background fabric
  - 1 yard brown background fabric
  - Fat quarter (or scrap large enough to hoop) blue gingham fabric
  - ½ yard red background fabric
  - ¾ yard or fat quarter light purple background fabric
  - ¾ yard or fat quarter dark blue background fabric
- 1 ½ yard of fabric for quilt backing
- 1 yard dark brown sashing fabric, cut into 12 1 ½" strips
- 1 yard print for border, cut into 4 ½" strips
- ½ yard fabric for binding or 5 yards of pre-made binding
- ⅛ yard or scraps of several fabrics for the appliqué design pieces
- 42" x 52" batting (crib size)
- Temporary spray adhesive

### Embroider & Prepare Blocks

- Spray a hoop-sized piece of OESD Heavyweight Tear-away stabilizer with temporary adhesive spray and apply to the wrong side of a hoop-sized piece of background fabric. Spray a hoop-sized piece of OESD Lightweight Tear-away stabilizer with temporary adhesive spray and apply to the stabilizer. Hoop the background fabric and stabilizer together.
- Place the hoop on the machine and stitch the first embroidery design. Use the chart below to determine which background fabric to use for each design. The final color on each design is notated on the thread chart as "Seam Stitch". This color change should be stitched in a thread color that will blend with the background fabric used for each design. **\*Tip:** Stitch the seam stitch using a dark colored bobbin thread to make it easier to trim the finished block later.
- Remove the hoop from the machine and the fabric from the hoop.
- Carefully trim all jump threads and gently remove excess stabilizer following the manufacturer's instructions.
- Repeat for all embroidery files, applying appliqué fabric where required. (Refer to appliqué instructions if needed.)
- Turn each block over and trim to ¼" outside the seam stitch. **SEE PHOTO 01**



<b>Cream Background Blocks</b> 80071-01 80071-08 80071-09 80071-10 80071-11 80071-12 80071-13 80071-14 80071-19 80071-30	<b>Pink Background Blocks</b> 80071-03 80071-18 80071-25	<b>Blue Gingham Background Block</b> 80071-07
<b>Dark Purple Background Blocks</b> 80071-02 80071-31	<b>Dark Blue Background Blocks</b> 80071-04 80071-05 80071-21 80071-29	<b>Red Background Blocks</b> 80071-15 80071-16 80071-24 80071-28
	<b>Brown Background Blocks</b> 80071-06 80071-23 80071-26 80071-32 80071-33	<b>Light Purple Background Blocks</b> 80071-17 80071-27
		<b>Light Blue Background Blocks</b> 80071-20 80071-22

## Construction of Blocks

This center of the quilt is assembled in sections, which are then assembled into a row. The remaining blocks are assembled into rows, and then the rows are assembled into the final quilt top.

### Section 1 – Center “Handmade” tiling section

- 80071-08 Handcrafted with Love (A)
- 80071-09 Handcrafted with Love (B)
- 80071-10 Handcrafted with Love (C)
- 80071-11 Handcrafted with Love (D)
- 80071-12 Handcrafted with Love (E)
- 80071-13 Handcrafted with Love (F)

### Section 2

- 80071-32 Sewing Keeps Me in Stitches
- 80071-20 Organza

### Section 3

- 80071-16 Knitting
- 80071-18 Sewing Machine

### Section 4

- 80071-17 Lace
- 80071-33 A Stitch in Time

### Section 5

- 80071-19 Notions
- 80071-21 Pattern

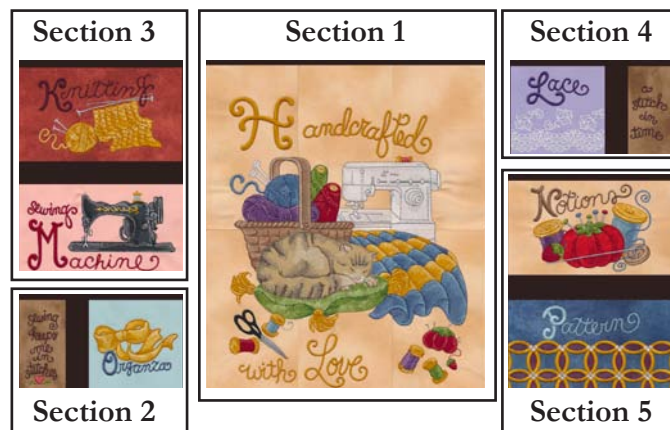

## Row 1

- 80071-01 Applique
- 80071-02 Buttons
- 80071-03 Calico
- 80071-04 Darning



## Row 2

- 80071-05 Embroidery
- 80071-06 French Knot
- 80071-07 Gingham
- 80071-14 Iron
- 80071-15 Jacquard



## Row 3

Sections 1-5 will be combined to form Row 3.

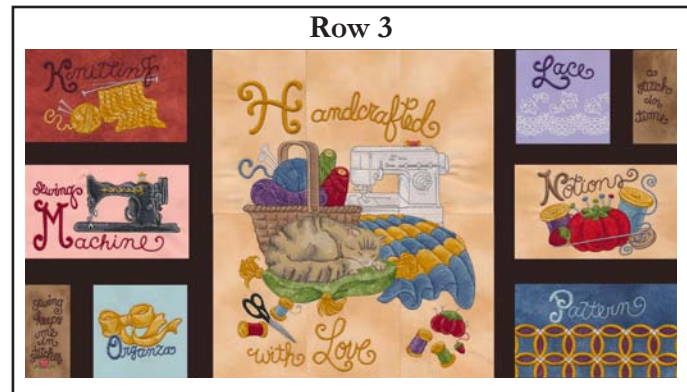

## Row 4

- 80071-22 Quilt
- 80071-23 Ruffle
- 80071-24 Scissors
- 80071-25 Thimble
- 80071-26 Understitch



## Row 5

- 80071-27 Venice
- 80071-28 Wool
- 80071-29 Cross Stitch
- 80071-30 Yarn
- 80071-31 Zipper

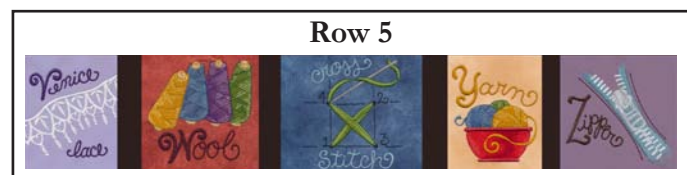

## Assembly

With right sides together and pressing seams to the sashing as you go, use a 1/4" seam allowance, or simply stitch directly on top of the seam stitch that sewed last during the embroidery process and stitch together in the following order: (**NOTE:** After stitching each combination, square each block component by trimming the excess sashing fabric even with embroidery blocks.)

### Section 1

\*Section 1 is assembled with NO sashing

- Assemble a row with Design 08 + Design 09 + Design 10
- Assemble a second row with 11 + 12 + 13
- Assemble these two rows together to form section 1.



### Section 2

- 32 + sashing + 20



### Section 3

- 16 + sashing + 18



### Section 4

- 17 + sashing + 33



### Section 5

- 19 + sashing + 21



## Combine Sections

- Section 2 + sashing + Section 3 = left of center section
- Section 4 + sashing + Section 5 = right of center section
- Left of center section + sashing + Section 1 + sashing + right of center section = Row 3

## Create Rows

- Assemble the remaining rows (1, 2, 4, & 5) each in numerical order from left to right, with sashing in between each block.
- Assemble rows together with long sashing pieces between each row.
- Add another sashing piece to the top and bottom of the rows.
- Add sashing to the left and right of the quilt.

## Finishing

- Sew the 4 1/2" border strips to the top and bottom of the quilt center then to the sides of the quilt.
- Place backing fabric right side down. Stack batting on wrong side of backing fabric and stack the quilt top down last, right side up. You may wish to use temporary spray adhesive when layering quilt to hold the layers in place.
- Pin layers together and quilt as desired. We simply stitched in the ditch in our sample.
- Trim batting and backing to the same size as the quilt top.
- Bind the quilt edges using your favorite method.

