

# Travel Patches by The Whiskey Ginger



Collection No. 80368  
9 Designs

# MATERIALS



## Isacord Thread Colors

0010 Silky White	0853 Pecan	1902 Poinsettia
0020 Black	0870 Muslin	2022 Rio Red
0111 Whale	0945 Pine Park	2123 Bordeaux
0124 Fieldstone	1010 Toast	3444 Concord
0138 Heavy Storm	1114 Clay	4074 Dimgray
0145 Skylight	1115 Copper	4174 Charcoal
0310 Yellow	1134 Light Cocoa	4952 Mystic Ocean
0504 Mimosa	1154 Penny	5230 Bottle Green
0555 Light Sage	1352 Salmon	5513 Ming
0576 Very Dark Brown	1362 Shrimp	5542 Garden Moss
0640 Parchment	1430 Melon	5555 Deep Green
0672 Baquette	1521 Flamingo	5664 Willow
0704 Gold	1532 Coral	5933 Grasshopper
0721 Antique	1600 Spanish Tile	5944 Backyard Green
0811 Candlelight	1725 Terra Cotta	6133 Caper
0824 Liberty Gold	1755 Hyacinth	

**Note: One spool of 1000 meter thread is adequate for the project unless otherwise noted.**



It is a violation of Copyright law to make and distribute copies of electronic designs or artwork.

Electronic designs are licensed to the original purchaser for use at one location. ©2024 Jewel Branding & Licensing, Inc. All rights reserved.

# MATERIALS



## Stabilizers

- OESD BadgeMaster WashAway
- OESD StabilStick CutAway
- OESD Fuse and Seal

## Fabrics/Textiles

- Assorted colors cotton fabric 4" squares

Note: Fabric sizes are estimates and may result in overage.

## Notion & Tools

- OESD Expert Embroidery Tape TearAway
- OESD Expert Embroidery Tape WashAway
- OESD Perfect Embroidery Press Cloth
- OESD Grippy Grid
- Embroidery Needle Sharp 75/11

## Isacord Thread Colors

- Per thread chart
- Match bobbin thread to top thread



# EMBROIDERY

## General Instructions

The applique instructions, included in the collection, are general instructions. For demonstration purposes, a sample design that best demonstrates the technique is shown.

Fabric and thread requirements will vary by design, but the general technique is the same. These instructions use images from 12930 Magic Potion Labels.

Note: Some thread colors in instructions have been changed or digitally enhanced for better visibility.

### Step 1

- Hoop two layers of BadgeMaster for all designs.



### Step 2

- Adhere two layers of StabilStick CutAway to the wrong side of applique fabric.

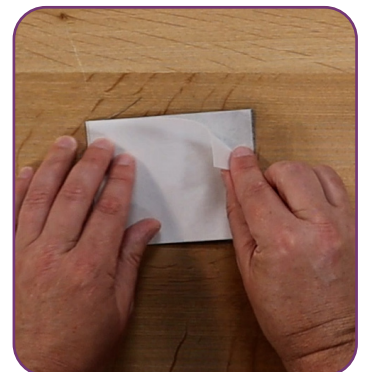

# EMBROIDERY

## General Instructions

### Step 3

- Load selected design into the machine.
- Example design is 12930-03.
- Thread the machine per the thread chart.
- Stitch Machine Step 1, Black Fabric Placement Stitch.

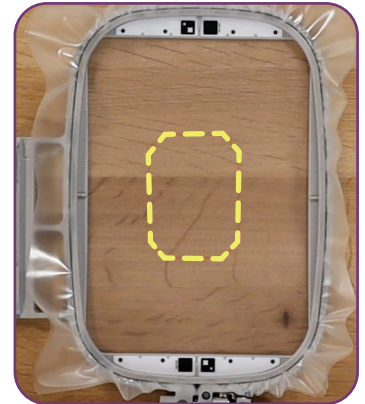

### Step 4

- Remove the hoop from the machine, but NOT the project from the hoop.
- Place the hoop on a flat surface.
- Completely cover the placement stitch with the prepared fabric.
- Tape in place to secure.



### Step 5

- Return the hoop to the machine.
- Stitch Machine Step 2, Cut Line and Tackdown.

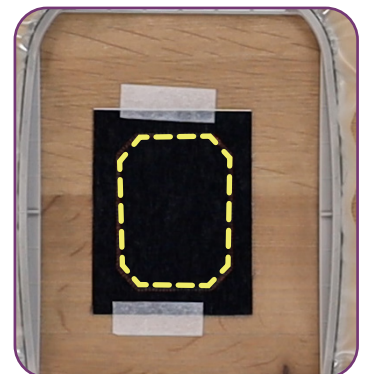

## General Instructions

### Step 6

- Remove the hoop from the machine, but NOT the project from the hoop.
- Trim the excess fabric as close to the cut line as possible. If the outermost stitches (cut line) are cut, the inner stitches (tackdown) will hold the applique in place.

**Tip:** If the BadgeMaster is cut or a hole is created while trimming the fabric, use OESD Expert Embroidery Tape WashAway as a patch.



### Step 7

- Return the hoop to the machine and stitch the remaining machine steps, according to the thread chart.
- Remember to match the bobbin thread to the upper thread.



# ASSEMBLY

## General Instructions

### Step 8

- When the design is complete, remove the project from the hoop and gently tear away the BadgeMaster, one layer at a time.
- Rinse each piece in warm running water until the design is only slightly tacky.
- Lay right side down on a non-stick surface to dry. Parchment paper or a cooling rack work well to prevent curling. Dry completely.



### Step 9

- Trace the applique shape or print mirrored version of the template on the paper side of Fuse and Seal.



# ASSEMBLY

## General Instructions

### Step 10

- Cut just inside the outline.
- Following the package instructions, iron the Fuse and Seal to the wrong side of the applique.
- Cool completely.



### Step 11

- Remove the paper from the Fuse and Seal.
- Place the design on the project and press to adhere.



### Step 12

- Enjoy!





# APPLIQUE PATTERNS

oeSD™ PREMIER COLLECTION



Print at 100%. No scaling. This box measures 1" x 1". Use the box as an accuracy guide when printing templates.

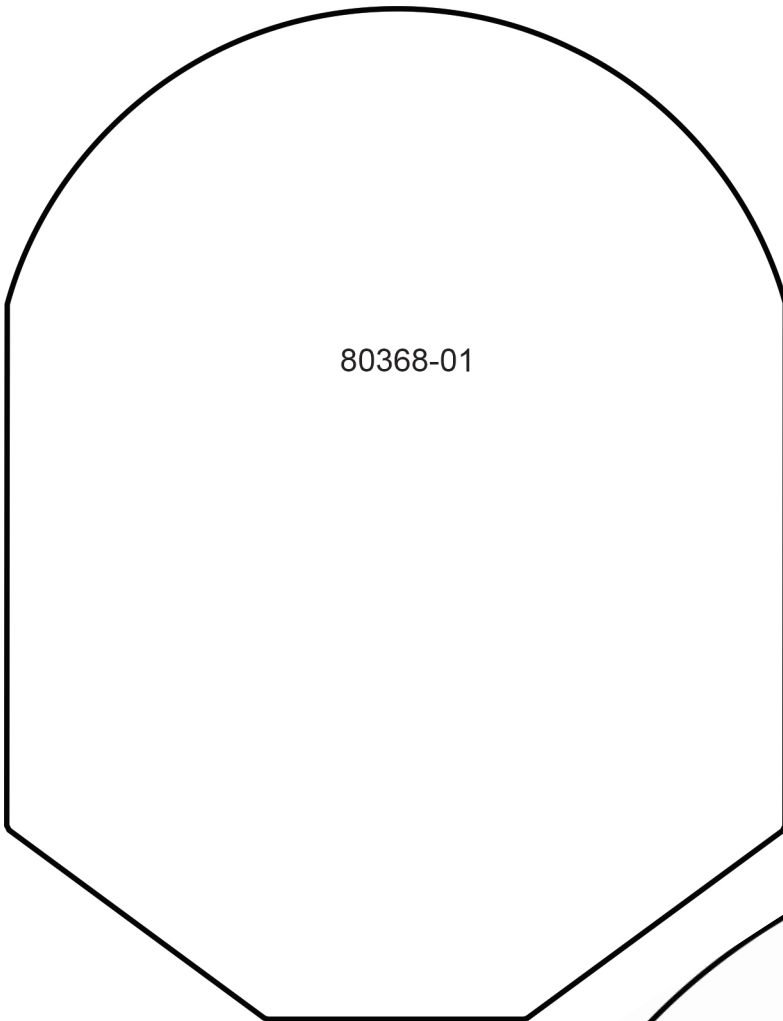

80368-01

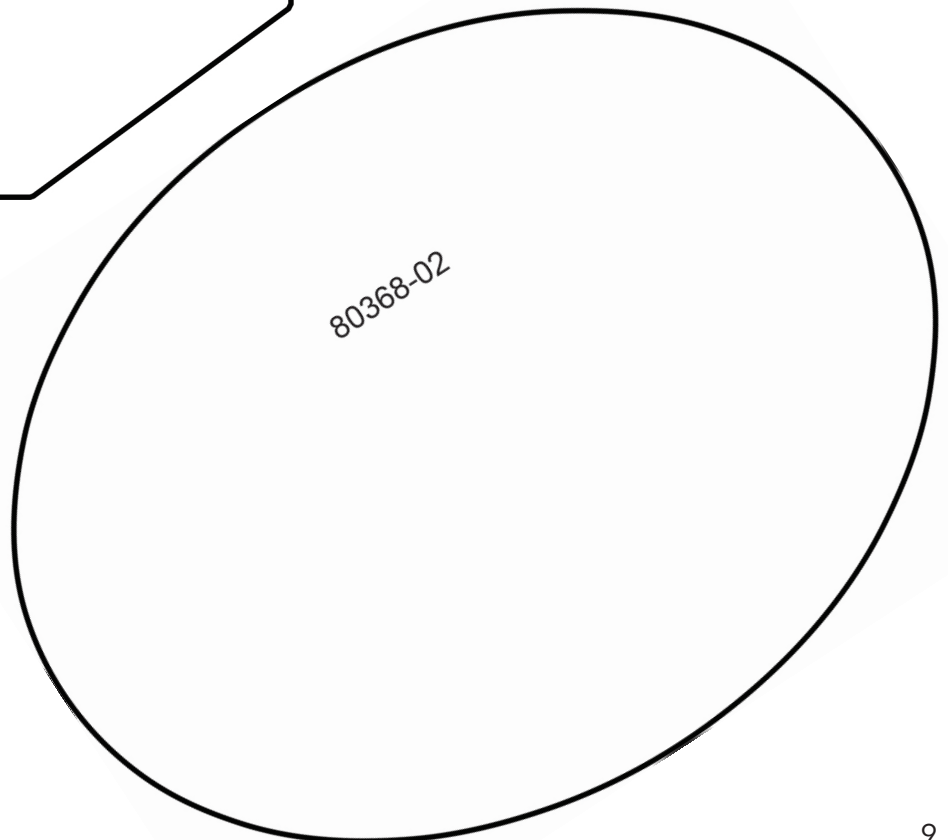

80368-02

# APPLIQUE PATTERNS

oeSD™ PREMIER COLLECTION



Print at 100%. No scaling. This box measures 1" x 1". Use the box as an accuracy guide when printing templates.

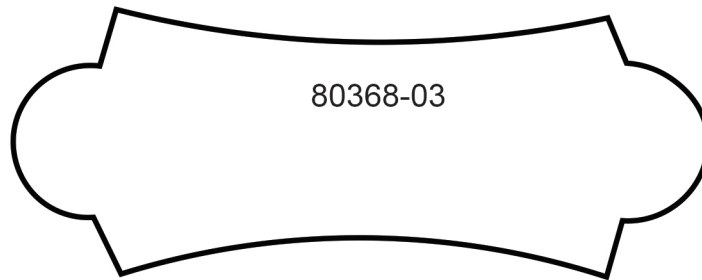
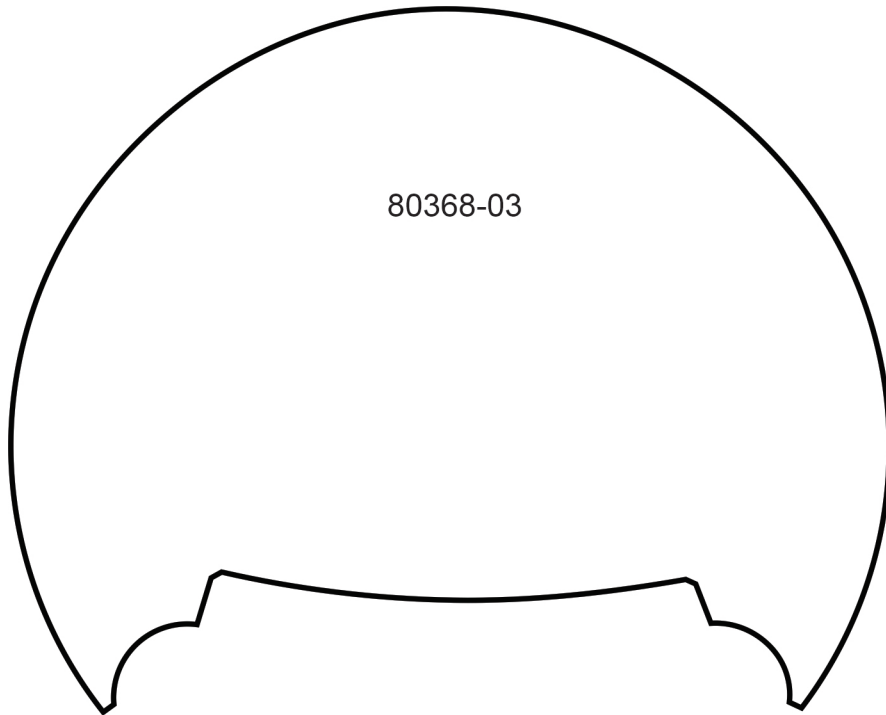

# APPLIQUE PATTERNS

OESD™ PREMIER COLLECTION



Print at 100%. No scaling. This box measures 1" x 1". Use the box as an accuracy guide when printing templates.

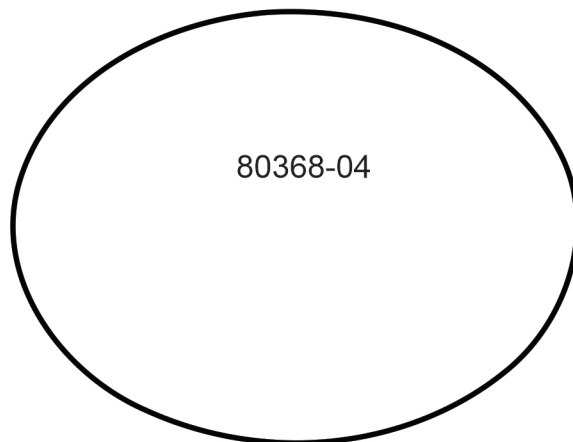
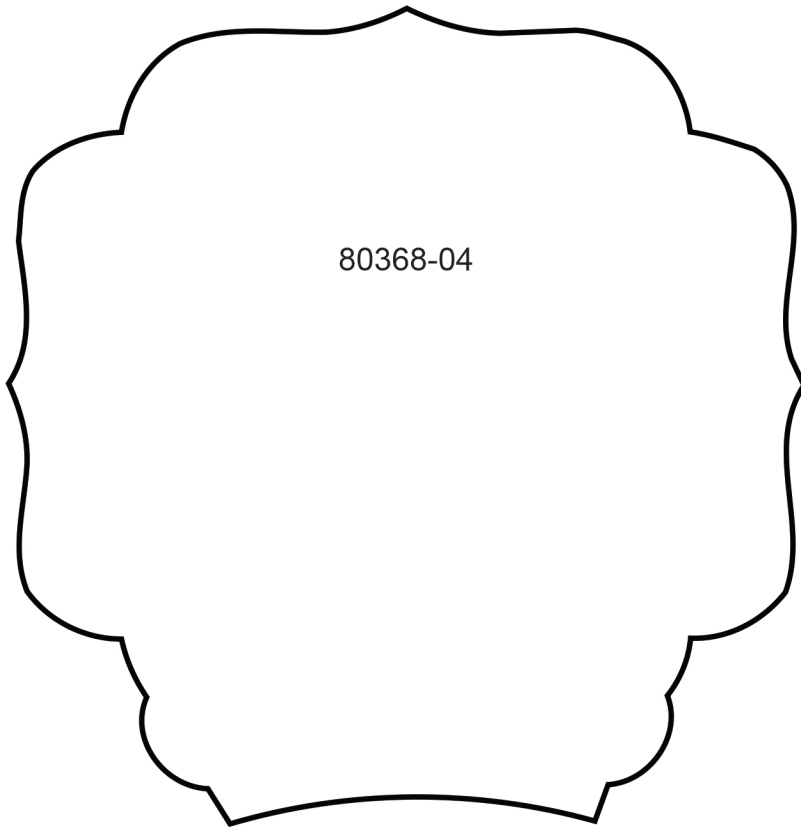

# APPLIQUE PATTERNS

oeSD™ PREMIER COLLECTION



Print at 100%. No scaling. This box measures 1" x 1". Use the box as an accuracy guide when printing templates.

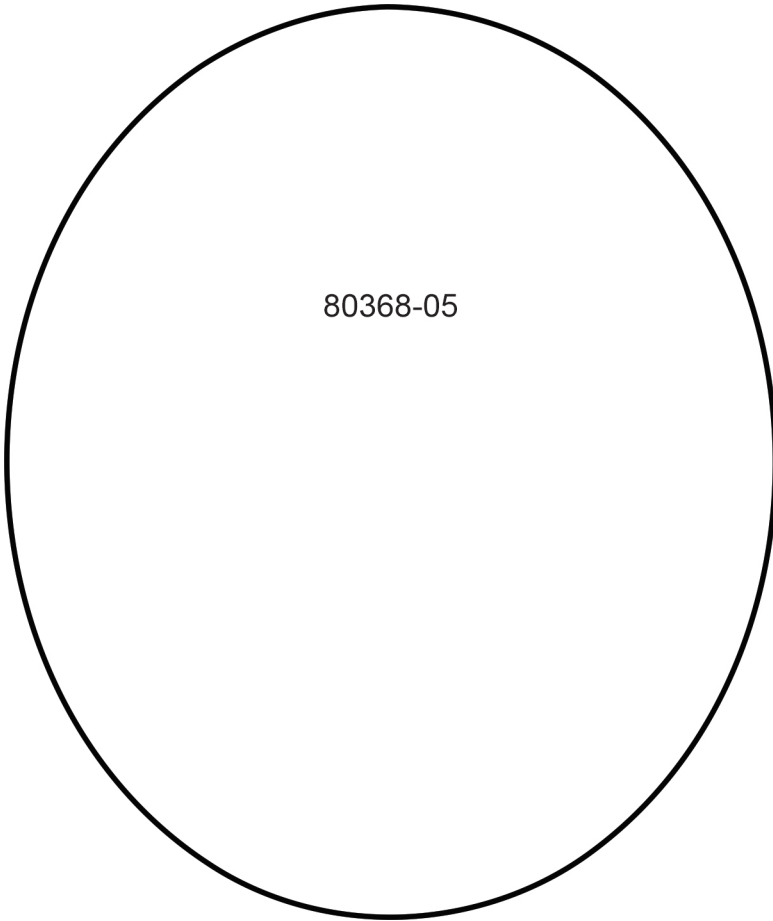

80368-05

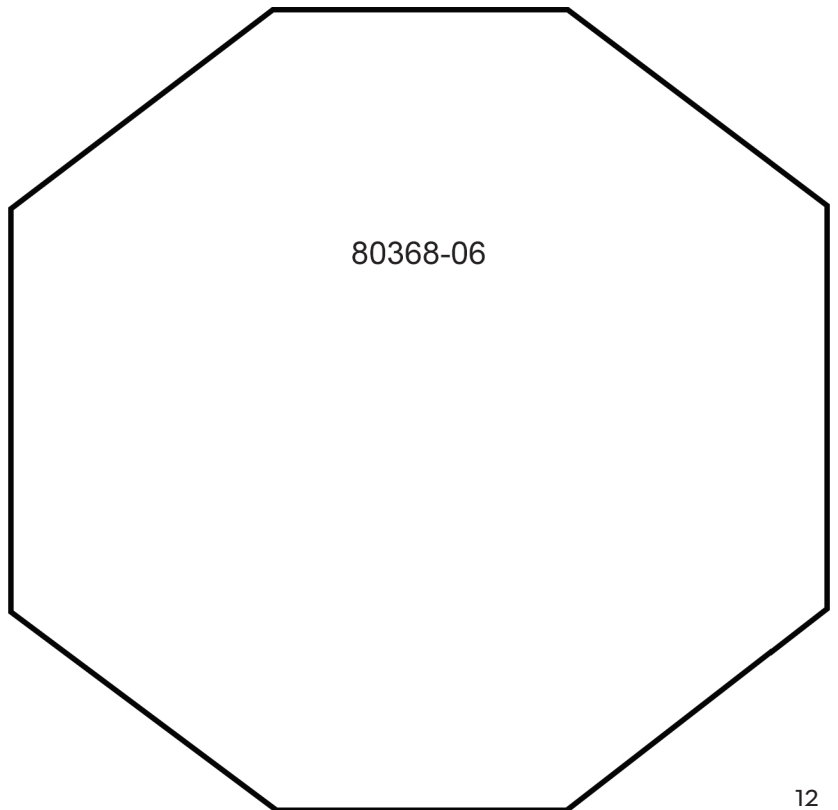

80368-06

# APPLIQUE PATTERNS

OESD™ PREMIER COLLECTION



Print at 100%. No scaling. This box measures 1" x 1". Use the box as an accuracy guide when printing templates.

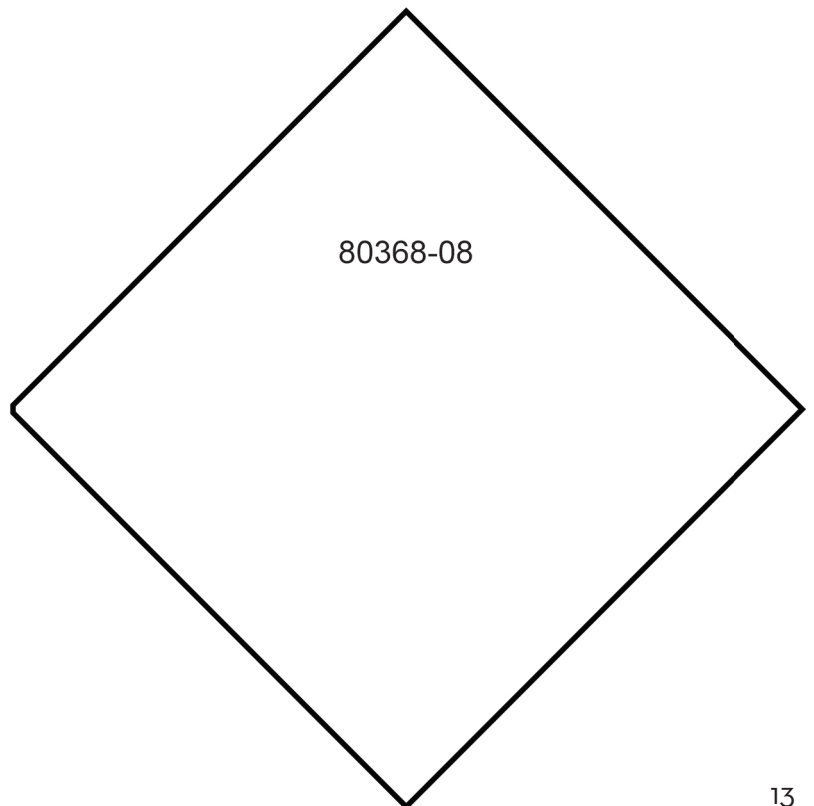
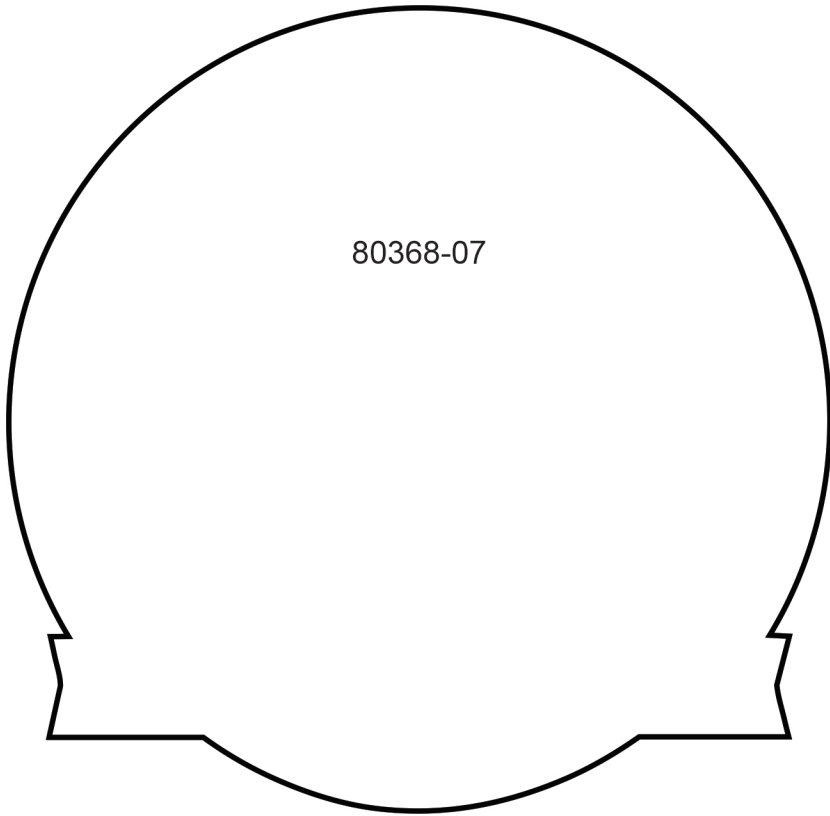

# APPLIQUE PATTERNS

OESD™ PREMIER COLLECTION



Print at 100%. No scaling. This box measures 1" x 1". Use the box as an accuracy guide when printing templates.

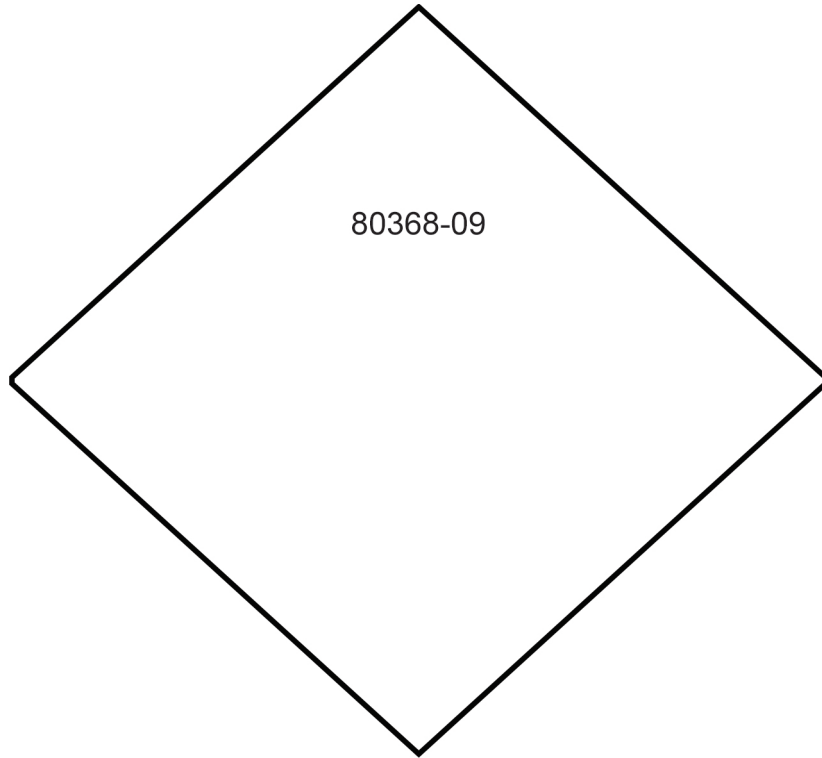

# MIRRORED PATTERNS

oeSD™ PREMIER COLLECTION



Print at 100%. No scaling. This box measures 1" x 1". Use the box as an accuracy guide when printing templates.

80368-01  
Mirrored

80368-02  
Mirrored

# MIRRORED PATTERNS

oeSD™ PREMIER COLLECTION



Print at 100%. No scaling. This box measures 1" x 1". Use the box as an accuracy guide when printing templates.

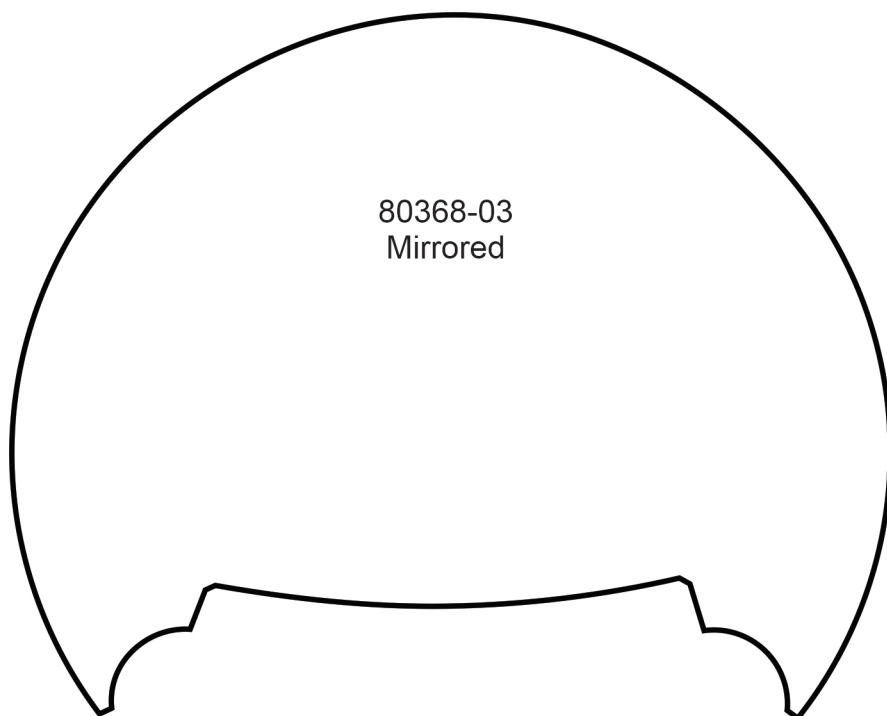

80368-03  
Mirrored

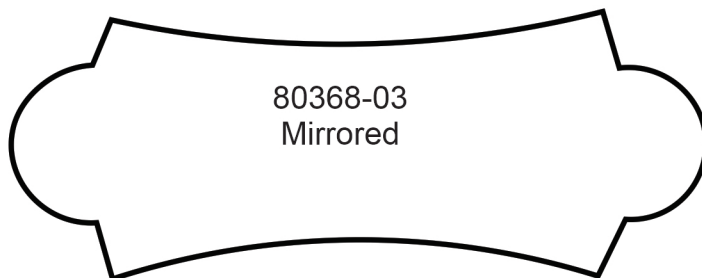

80368-03  
Mirrored



# MIRRORED PATTERNS



Print at 100%. No scaling. This box measures 1" x 1". Use the box as an accuracy guide when printing templates.

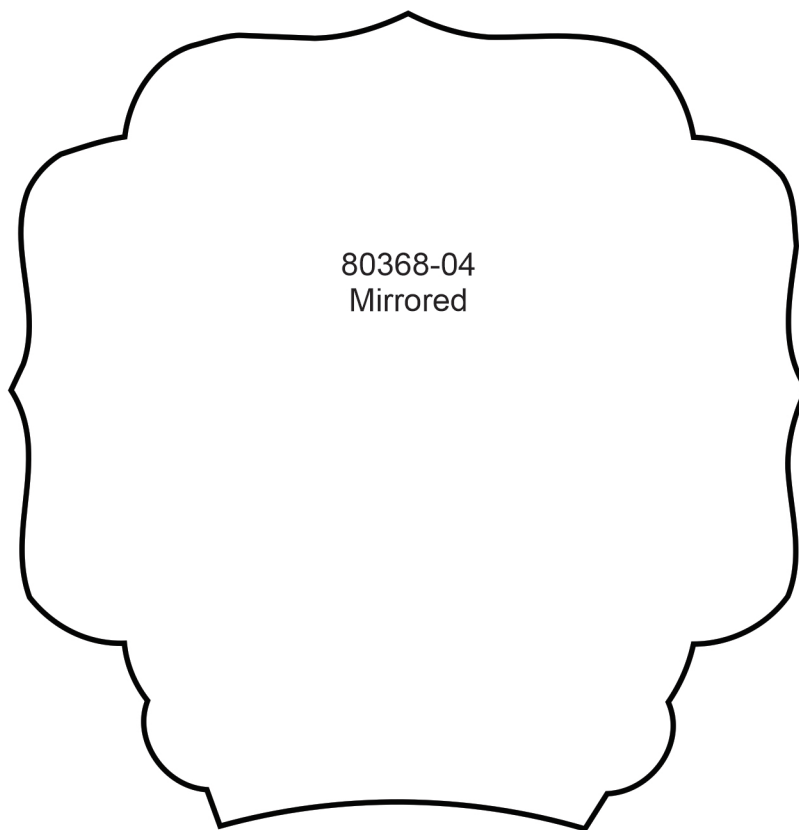

# MIRRORED PATTERNS

oeSD™ PREMIER COLLECTION



Print at 100%. No scaling. This box measures 1" x 1". Use the box as an accuracy guide when printing templates.

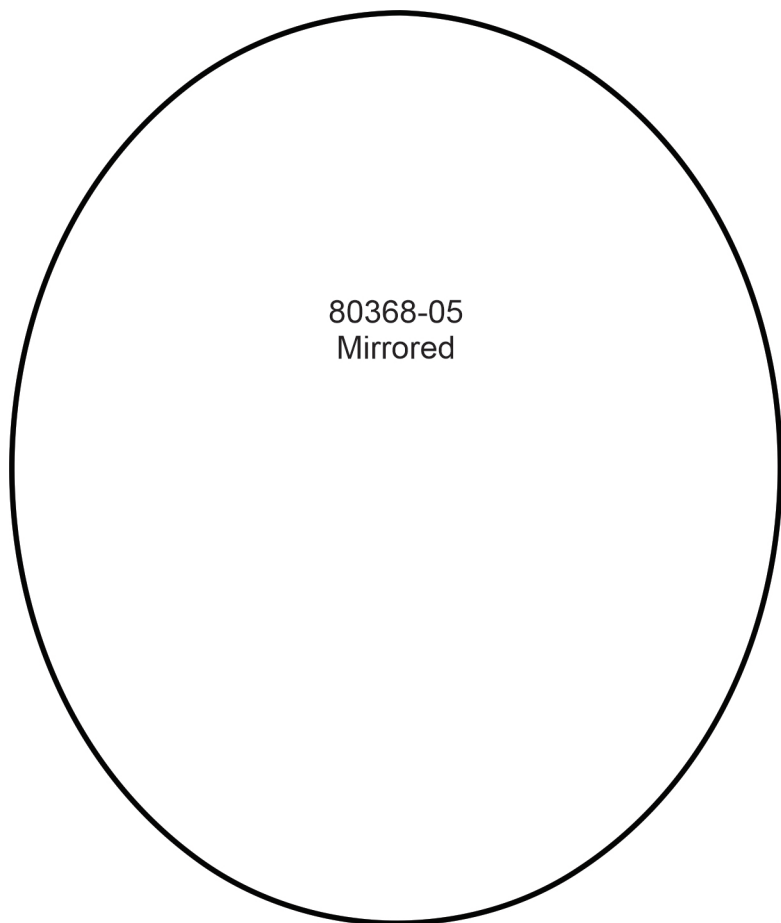

80368-05  
Mirrored

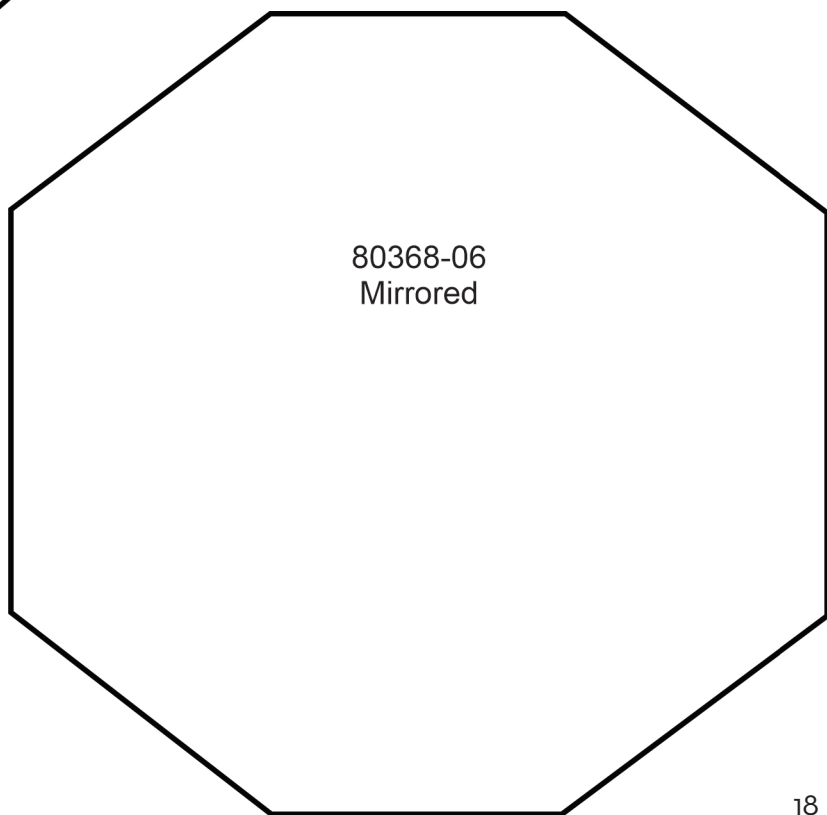

80368-06  
Mirrored

# MIRRORED PATTERNS

oeSD™ PREMIER COLLECTION



Print at 100%. No scaling. This box measures 1" x 1". Use the box as an accuracy guide when printing templates.

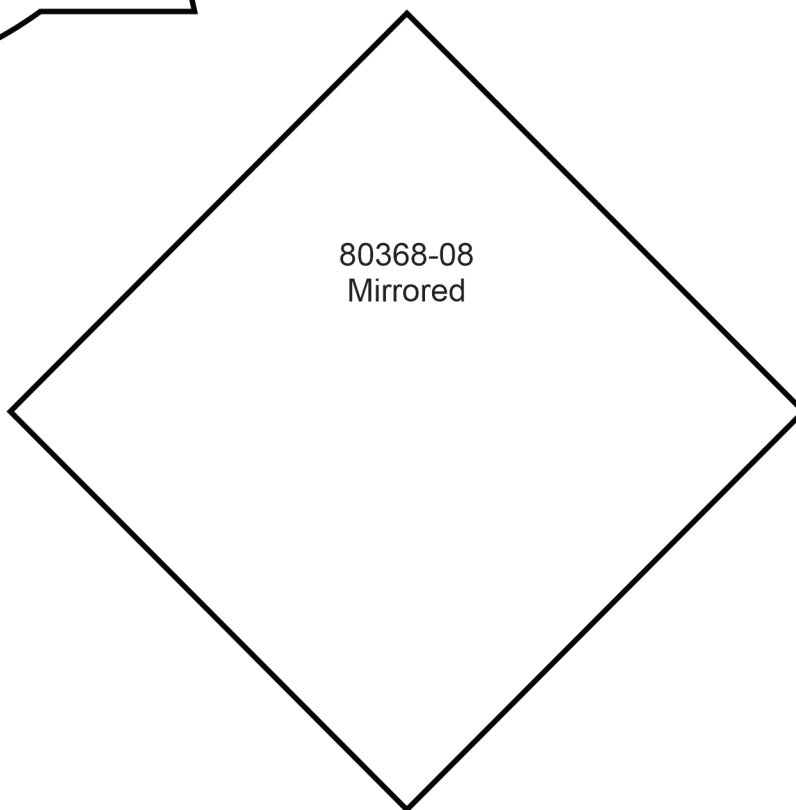
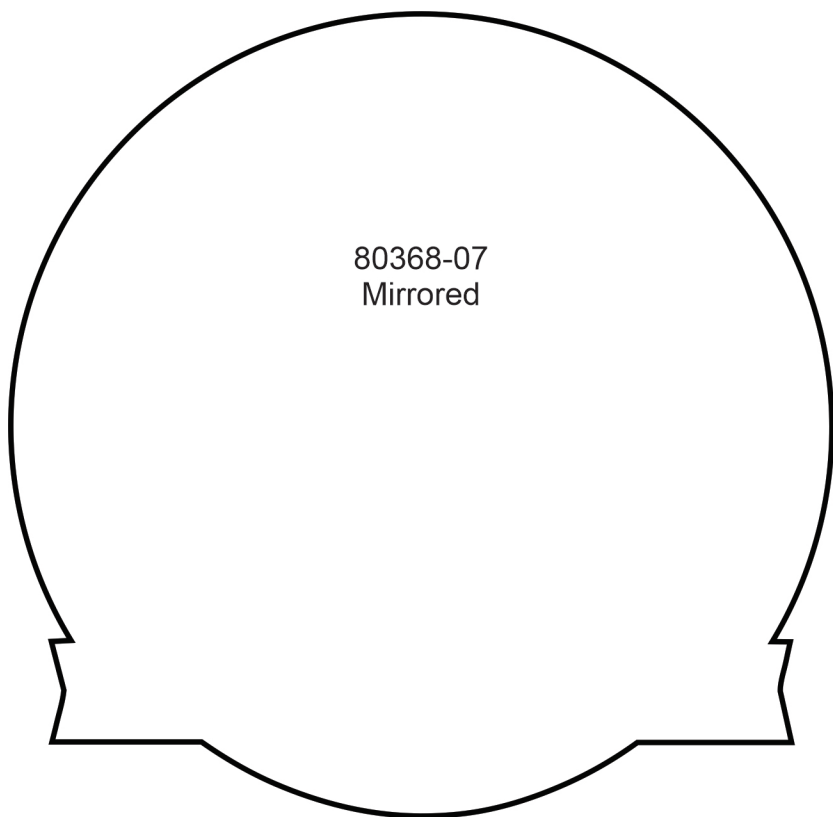

# MIRRORED PATTERNS

oeSD™ PREMIER COLLECTION



Print at 100%. No scaling. This box measures 1" x 1". Use the box as an accuracy guide when printing templates.

