

Note: Some designs in this collection may have been created using unique special stitches and/or techniques. To preserve design integrity when rescaling or rotating designs in your software, always rescale or rotate designs using the handles directly on-screen.



BC01401 Appliqué
4.87 X 4.15 in.
123.70 X 105.41 mm
6,985 St.



BC01402
2.46 X 2.44 in.
62.48 X 61.98 mm
6,857 St.

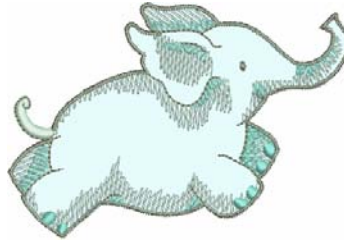

BC01403 Appliqué
4.88 X 3.33 in.
123.95 X 84.58 mm
4,403 St.



BC01404
2.50 X 1.69 in.
63.50 X 42.93 mm
4,765 St.

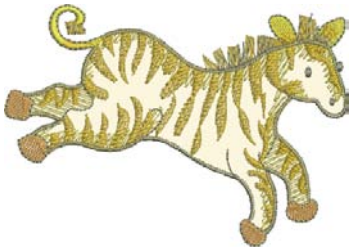

BC01405 Appliqué
4.86 X 3.39 in.
123.44 X 86.11 mm
8,969 St.

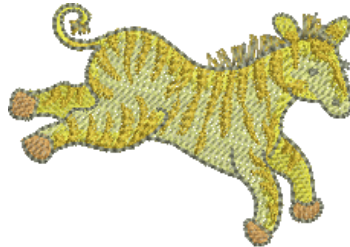

BC01406
2.50 X 1.75 in.
63.50 X 44.45 mm
5,642 St.



BC01407 Appliqué
4.87 X 3.25 in.
123.70 X 82.55 mm
4,046 St.



BC01408
2.50 X 1.68 in.
63.50 X 42.67 mm
4,347 St.

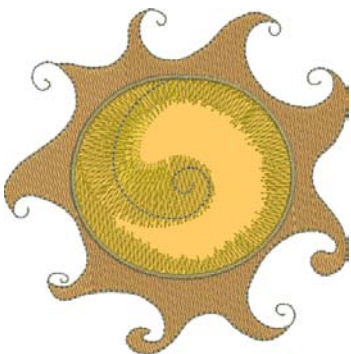

BC01409 Appliqué
4.86 X 4.87 in.
123.44 X 123.70 mm
12,004 St.

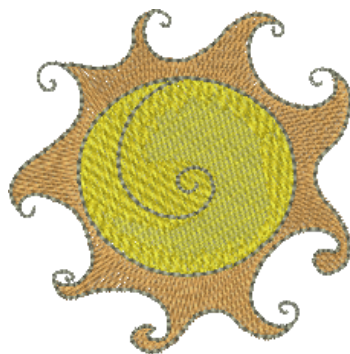

BC01410
2.51 X 2.50 in.
63.75 X 63.50 mm
5,789 St.



BC01411 Appliqué
4.86 X 4.86 in.
123.44 X 123.44 mm
10,778 St.



BC01412
2.51 X 2.45 in.
63.75 X 62.23 mm
8,276 St.

- ☞ Design contains a loose fill.
- ⚙ Some white areas shown are not stitched.

- L Design is larger than 5" (127 mm) in either direction.
- S Design is smaller than 1.5" (38.1 mm) in either direction.

Note: Some designs in this collection may have been created using unique special stitches and/or techniques. To preserve design integrity when rescaling or rotating designs in your software, always rescale or rotate designs using the handles directly on-screen.

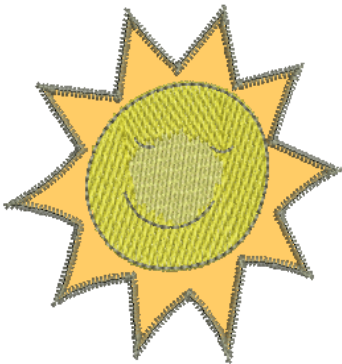

BC01413 Appliqué
2.87 X 3.01 in.
72.90 X 76.45 mm
3,672 St.



BC01414 Appliqué
2.38 X 3.16 in.
60.45 X 80.26 mm
8,724 St.



BC01415
2.06 X 2.18 in.
52.32 X 55.37 mm
8,709 St.



BC01416
2.56 X 2.96 in.
65.02 X 75.18 mm
9,772 St.



BC01417
3.21 X 4.87 in.
81.53 X 123.70 mm
13,935 St.



BC01418
1.55 X 1.26 in.
39.37 X 32.00 mm
3,274 St. **S**



BC01419
1.25 X 2.51 in.
31.75 X 63.75 mm
3,596 St. **S**



BC01420
2.04 X 1.99 in.
51.82 X 50.55 mm
4,336 St.

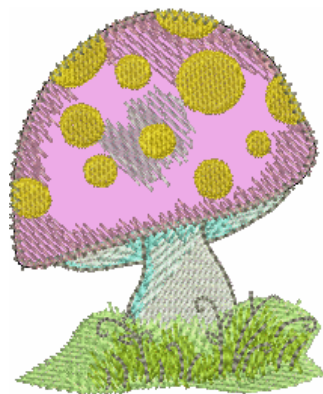

BC01421 Appliqué
2.33 X 2.84 in.
59.18 X 72.14 mm
6,756 St.



BC01422 Appliqué
4.76 X 6.51 in.
120.90 X 165.35 mm
13,576 St. **L**

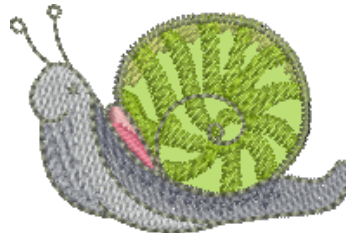

BC01423 Appliqué
2.20 X 1.45 in.
55.88 X 36.83 mm
3,507 St. **S**

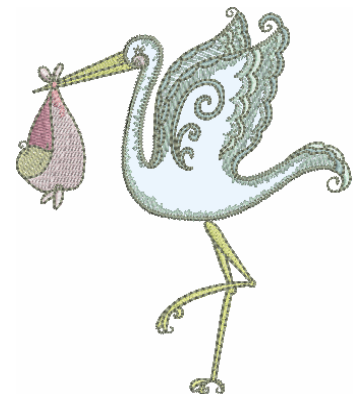

BC01424 Appliqué
3.69 X 4.23 in.
93.73 X 107.44 mm
10,030 St.

☞ Design contains a loose fill.
⚙ Some white areas shown are not stitched.

L Design is larger than 5" (127 mm) in either direction.
S Design is smaller than 1.5" (38.1 mm) in either direction.

Note: Some designs in this collection may have been created using unique special stitches and/or techniques. To preserve design integrity when rescaling or rotating designs in your software, always rescale or rotate designs using the handles directly on-screen.

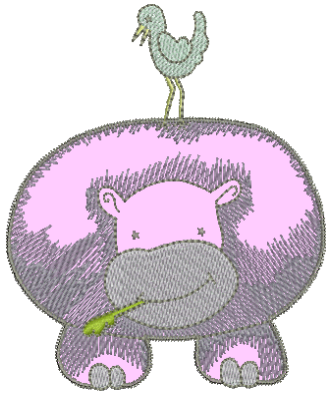

BC01425 Appliqué
3.67 X 4.39 in.
93.22 X 111.51 mm
8,157 St.

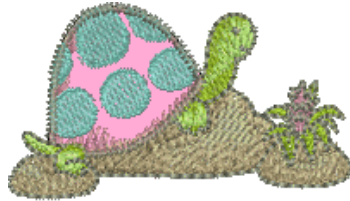

BC01426 Appliqué
2.21 X 1.25 in.
56.13 X 31.75 mm
5,051 St. **S**

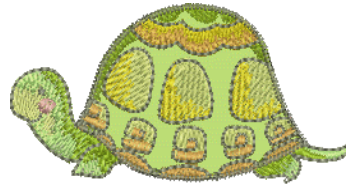

BC01427 Appliqué
3.00 X 1.55 in.
76.20 X 39.37 mm
6,226 St.



BC01428
4.85 X 6.32 in.
123.19 X 160.53 mm
17,312 St. **L**

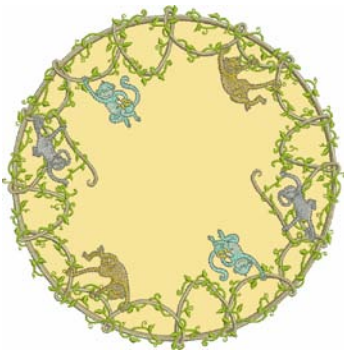

BC01429 Jumbo Appliqué (Use cut in place method)
8.03 X 8.01 in.
203.96 X 203.45 mm
52,209 St. **L**



BC01430 Jumbo
6.27 X 13.06 in.
159.26 X 331.72 mm
41,793 St. **L**



BC01431 Appliqué
3.07 X 6.75 in.
77.98 X 171.45 mm
25,683 St. **L**



BC01432 Jumbo Appliqué
3.19 X 14.85 in.
81.03 X 377.19 mm
66,275 St. **L**



BC01433 Appliqué
4.88 X 6.53 in.
123.95 X 165.86 mm
37,147 St. **L**



BC01434
3.13 X 6.23 in.
79.50 X 158.24 mm
5,735 St. **L**

- ⌘ Design contains a loose fill.
- ⚙ Some white areas shown are not stitched.

- L** Design is larger than 5" (127 mm) in either direction.
- S** Design is smaller than 1.5" (38.1 mm) in either direction.

Listings below indicate color sample, stitching order and suggested thread color number. Most numbers indicate Isacord thread. However, colors beginning with 20501 refer to YLI Fine Metallics, 7 refer to Yenmet Metallic, 8 refer to YLI Variations Variegated Thread and 9 refer to Isacord Multicolor Variegated.

BC01401 Appliqué

1. Appliqué Placement Stitch.....	0520
2. Appliqué Tackdown & Monkey Highlights.....	0520
3. Monkey Shading.....	5740
4. Monkey Shading.....	5912
5. Appliqué Cover Stitch & Monkey Details.....	0152

BC01402

1. Monkey.....	0520
2. Monkey Shading.....	5740
3. Monkey Shading.....	5912
4. Monkey Outlines.....	0152

BC01403 Appliqué

1. Appliqué Placement Stitch.....	5050
2. Appliqué Tackdown & Elephant Shading.....	5050
3. Elephant Shading.....	4430
4. Appliqué Cover Stitch & Elephant Details.....	0152

BC01404

1. Elephant.....	0101
2. Elephant Shading.....	5050
3. Elephant Shading.....	4430
4. Outlines.....	0152

BC01405 Appliqué

1. Appliqué Placement Stitch.....	0600
2. Appliqué Tackdown, Zebra Shading & Ears.....	0600
3. Stripes & Mane.....	0821
4. Hooves.....	1010
5. Appliqué Cover Stitch, Outlines & Mane Shading.....	0152

BC01406

1. Zebra.....	0520
2. Zebra Shading.....	0600
3. Stripes.....	0821
4. Hooves.....	1010
5. Outlines.....	0152

BC01407 Appliqué

1. Appliqué Placement Stitch.....	3150
2. Appliqué Tackdown & Hippo Shading.....	3150
3. Hippo Shading.....	3241
4. Appliqué Cover Stitch & Outlines.....	0152

BC01408

1. Hippo.....	0184
2. Hippo Shading.....	3150
3. Hippo Shading.....	3241
4. Outlines.....	0152

BC01409 Appliqué

1. Sun Rays.....	1010
2. Appliqué Placement Stitch.....	0311
3. Appliqué Tackdown & Sun Shading.....	0311
4. Appliqué Cover Stitch & Outlines.....	0152

BC01410

1. Sun Rays.....	1010
2. Sun.....	0600
3. Sun Shading.....	0311
4. Outlines.....	0152

BC01411 Appliqué

1. Leaves Appliqué Placement Stitch.....	5740
2. Leaves Appliqué Tackdown and Shading.....	5740
3. Leaves Shading.....	5912
4. Flower Appliqué Placement Stitch.....	2650
5. Flower Appliqué Tackdown and Flower Shading.....	2650
6. Flower Shading.....	2152
7. Flower Center.....	0520
8. Flower Center Shading.....	0731
9. Appliqué Cover Stitch and Flower Outlines.....	0152

BC01412

1. Leaves.....	5740
2. Leaves Shading.....	5912
3. Flower.....	2650
4. Flower Shading.....	2152
5. Flower Center.....	0520
6. Flower Center Shading.....	0731
7. Outlines.....	0152

BC01413 Appliqué

1. Appliqué Placement Stitch.....	0152
2. Appliqué Tack Down and Cover Stitch.....	0152
3. Sun.....	0520
4. Sun Shading.....	0600
5. Outlines.....	0152

BC01414 Appliqué

1. Rocks.....	0771
2. Rocks Shading.....	1123
3. Rocks Shading.....	0853
4. Turtle Necks and Tails.....	5912
5. Turtle Necks and Tails Highlights.....	5740
6. Bottom Appliqué Placement Stitch.....	2152
7. Bottom Appliqué Tackdown and Shell Shading.....	2152
8. Blue Spots on Bottom Turtle.....	4430
9. Top Appliqué Placement Stitch.....	1010
10. Top Appliqué Tackdown and Shell Shading.....	1010
11. Yellow Spots on Top Turtle.....	0311
12. Monkey.....	3150
13. Monkey Shading.....	3241
14. Turtle Legs.....	5912
15. Turtle Legs Highlights.....	5740
16. Appliqué Cover Stitches and Outlines.....	0152

BC01415

1. Rocks.....	0771
2. Rocks Shading.....	1123
3. Rocks Shading.....	0853
4. Greenery.....	5912
5. Flowers.....	1600
6. Monkey.....	3150
7. Monkey Shading.....	3241
8. Outlines.....	0152

BC01416

1. Light Greenery.....	5740
2. Greenery Shading & Dark Greenery.....	5912
3. Trunk.....	0731
4. Trunk Shading.....	0821
5. Outlines.....	0152
6. Vine.....	5912

BC01417

1. Greenery.....	5740
2. Greenery Shading.....	5912
3. Trunk.....	0731
4. Trunk Shading.....	0821
5. Coconuts.....	1123
6. Coconuts Shading.....	0853
7. Outlines.....	0152

BC01418

1. Greenery.....	5912
2. Greenery Highlights.....	5740
3. Outlines.....	0152

BC01419

1. Greenery.....	5912
2. Greenery Highlights.....	5740
3. Outlines.....	0152
4. Flowers.....	2152

BC01420

1. Greenery.....	5912
2. Greenery Highlights.....	5740
3. Outlines.....	0152

BC01421 Appliqué

1. Stem and Underside of Mushroom.....	0101
2. Stem and Underside of Mushroom Shading.....	5050
3. Stem and Underside of Mushroom Shading.....	4430
4. Grass.....	5740
5. Grass Shading.....	5912
6. Appliqué Placement Stitch.....	2152
7. Appliqué Tackdown and Mushroom Shading.....	2152
8. Mushroom Highlights.....	0101
9. Yellow Spots on Mushroom.....	0311
10. Appliqué Cover Stitch and Outlines.....	0152

BC01422 Appliqué

1. Water.....	0015
2. Leaf.....	5912
3. Leaf Highlights.....	5740
4. Water Shading.....	4430
5. Monkey.....	0731
6. Monkey Shading.....	0821
7. Water Droplets.....	3762
8. Appliqué Placement Stitch.....	4430
9. Appliqué Tackdown and Elephant Shading.....	4430
10. Nails.....	5050
11. Appliqué Cover Stitch and Outlines.....	0152

BC01423 Appliqué

1. Appliqué Placement Stitch.....	0713
2. Shell Shading.....	0713
3. Stripes on Shell.....	5912
4. Pink Between Body and Shell.....	2152
5. Pink Shading.....	2320
6. Body.....	3150
7. Body Shading.....	3241
8. Body Shading.....	3211
9. Appliqué Tack Down and Outlines.....	0152

BC01424 Appliqué

1. Baby.....	1060
2. Beak and Legs.....	0520
3. Inside Pouch.....	2532
4. Appliqué Placement Stitch.....	5050
5. Appliqué Tackdown and Stork Shading.....	5050
6. Pouch and Stork Cheek.....	2650
7. Pouch Shading.....	2152
8. Details on Stork.....	3762
9. Appliqué Cover Stitch and Outlines.....	0152

BC01425 Appliqué

1. Appliqué Placement Stitch.....	3241
2. Appliqué Tackdown and Hippo Shading.....	3241
3. Hippo Face and Nails.....	3150
4. Grass.....	5912
5. Bird.....	5050
6. Beak and Legs.....	0520
7. Appliqué Cover Stitch and Outlines.....	0152

Listings below indicate color sample, stitching order and suggested thread color number. Most numbers indicate Isacord thread. However, colors beginning with 20501 refer to YLI Fine Metallics, 7 refer to Yenmet Metallic, 8 refer to YLI Variations Variegated Thread and 9 refer to Isacord Multicolor Variegated.

BC01426 Appliqué

1. Rocks.....	0771
2. Rocks Shading.....	1123
3. Rocks Shading.....	0853
4. Turtle Neck and Front Leg/ Greenery.....	5912
5. Neck and Front Leg Highlights.....	5740
6. Appliqué Placement Stitch.....	2152
7. Appliqué Tackdown and Turtle Shell Shading.....	2152
8. Blue Spots on Turtle Shell.....	4430
9. Back Leg and Tail.....	5912
10. Back Leg and Tail Highlights.....	5740
11. Flower.....	2532
12. Appliqué Tackdown and Outlines.....	0152

BC01427 Appliqué

1. Face.....	0520
2. Face Shading/ Legs/ Tail.....	5740
3. Neck/ Legs/ Tail Shading.....	5912
4. Cheek.....	2152
5. Outlines.....	0152
6. Appliqué Placement Stitch.....	5912
7. Appliqué Tackdown and Shell Shading.....	5912
8. Yellow Spots on Shell.....	0520
9. Yellow Spots Shading/ Scallop.....	0311
10. Scallop and Spots Shading/ Orange Spots Along Bottom of Shell.....	1010
11. Appliqué Cover Stitch and Outlines.....	0152

BC01428

1. Vines.....	0853
2. Vines Highlights.....	0771
3. Greenery.....	5912
4. Monkey.....	5050
5. Monkey Shading.....	4430
6. Banana.....	0660
7. Banana Peel.....	0311
8. Outlines.....	0152

BC01429 Jumbo Appliqué (Use cut in place method)

1. Appliqué Placement Stitch.....	0853
2. Appliqué Outline and Tackdown.....	0853
3. Vines and Appliqué Cover Stitch.....	1061
4. Vines Highlights.....	0771
5. Greenery.....	5912
6. Blue Monkeys.....	5050
7. Blue Monkeys Shading.....	4430
8. Bananas.....	0660
9. Banana Peels.....	0311
10. Purple Monkeys.....	3150
11. Purple Monkeys Shading.....	3241
12. Brown Monkeys.....	0731
13. Brown Monkeys Shading.....	0821
14. Outlines.....	0152

BC01430 Jumbo

1. Vines.....	0853
2. Vines Highlights.....	0771
3. Greenery.....	5912
4. Blue Monkey.....	5050
5. Blue Monkey Shading.....	4430
6. Banana.....	0660
7. Banana Peel.....	0311
8. Bird.....	2650
9. Bird Shading.....	2152
10. Brown Monkey.....	0731
11. Brown Monkey Shading.....	0821
12. Purple Monkey.....	3150
13. Purple Monkey Shading.....	3241
14. Outlines.....	0152

BC01431 Appliqué

1. Leaves.....	5912
2. Branch.....	0853
3. Leaves Highlights/ Stems/ Grass.....	5740
4. Grass Shading/ Turtle Heads/ Necks/ Legs.....	5912
5. Turtle Heads/ Necks/ Legs Shading.....	5510
6. Leaf and Turtle Outlines.....	0152
7. Small Turtle Shell.....	3241
8. Green Spots on Small Turtle Shell.....	5912
9. Appliqué Placement Stitches.....	3762
10. Large Turtle Shell Appliqué Tackdown and Shading.....	3762
11. Medium Turtle Shell Appliqué Tackdown and Shading/ Flowers.....	1600
12. Blue Spots on Large Turtle Shell.....	4430
13. Tiny Turtle Shell.....	2152
14. Yellow Spots on Medium and Tiny Turtle Shells.....	0311
15. Appliqué Cover Stitches and Outlines.....	0152

BC01432 Jumbo Appliqué

1. Leaves.....	5912
2. Branches.....	0853
3. Leaves Highlights/ Stems/ Grass.....	5740
4. Grass Shading/ Turtle heads/ Legs/ Tails.....	5912
5. Turtles Heads/ Legs/ Tails Shading.....	5510
6. Leaves and Turtles Outlines.....	0152
7. Purple Turtle Shells.....	3241
8. Green Spots on Purple Turtle Shells.....	5912
9. Appliqué Placement Stitches.....	3762
10. Appliqué Tackdown and Shading on Large Turtle Shell/ Blue Turtle Shells.....	3762
11. Small Appliqué Tackdown and Shading/ Flowers/ Berries.....	1600
12. Medium Appliqué Tackdown and Shading/ Spots on Large Appliqué Turtle Shell.....	4430
13. Yellow Spots on Medium Turtle Shell.....	0520
14. Tiny Pink Turtle Shells.....	2152
15. Gold Spots on Turtle Shells.....	0311
16. Appliqué Cover Stitches and Outlines.....	0152

BC01433 Appliqué

1. Appliqué Placement Stitch.....	5220
2. Appliqué Cut Line and Tackdown.....	5220
3. Blanket Shading.....	5220
4. Appliqué Cover Stitch.....	1010
5. Giraffe/ Bear Muzzle/ Bottom of Elephant Feet.....	0520
6. Bird Back and Book Cover.....	5740
7. Bird Back Shading/ Bear Bow Tie.....	5912
8. Giraffe Shading/ Bear Muzzle Shading/ Bird Belly/ Duck.....	0600
9. Whites of Eyes/ Giraffe Belly/ Elephant Overalls/ Book Pages.....	0101
10. Giraffe Belly Shading/ Inside Ears.....	2650
11. Inside Ears Shading/ Red Spots on Giraffe.....	2152
12. Elephant/ Bear Bow Tie/ Pages of Book Shading.....	5050
13. Elephant Shading and Turquoise Spots on Giraffe.....	4430
14. Giraffe Hooves/ Wagon/ Bear.....	1123
15. Bear and Wagon Shading.....	0853
16. Orange Spots on Giraffe/ Bookmark/ Ducks Bill.....	1010
17. Blue Spots on Giraffe and Mane.....	3762
18. Stripes on Elephants Overalls/ Wheels on Wagon.....	1600
19. Book.....	3241
20. Outlines.....	0152

BC01434

1. Single Color Design.....	5912
-----------------------------	------

Note: Appliqué fabric not included.

Pre-Cut Appliqué Instructions

1. Print out the necessary pages from the PDF of the appliqué pattern(s).
2. Mark the right side of the pattern pieces so you'll know which direction to lay the pattern on the fabric.
3. Lightly spray the wrong side of the pattern pieces with temporary adhesive spray and allow it to set for a few minutes.
4. Place the pattern pieces on the right side of the fabric and carefully cut them out. **PHOTO 1**
5. Sew the placement stitch on your hooped fabric. **PHOTO 2**
6. With the paper still stuck to the right side of the appliqué fabric, spray the wrong side of the fabric with temporary adhesive.
7. Place the fabric inside the sewing placement stitch so that it matches the stitching line then remove the paper pattern. **PHOTO 3**
8. Sew the tackdown. **PHOTO 4**
9. Sew the remainder of the design and repeat for any remaining pieces. **PHOTO 5**

NOTE: The patterns are sized for the designs as they were made. If you resize the design, you will need to resize the pattern the same amount. You can print out the pattern at the normal size then copy it on a copy machine at the changed size, i.e. resize the designs to 80%, resize the printed pattern to 80%.

TIP: When Printing the patterns, make sure that the "Fit to page" option is UNCHECKED in the Print Dialog Box. If this option is checked the printed patterns will not be actual size.

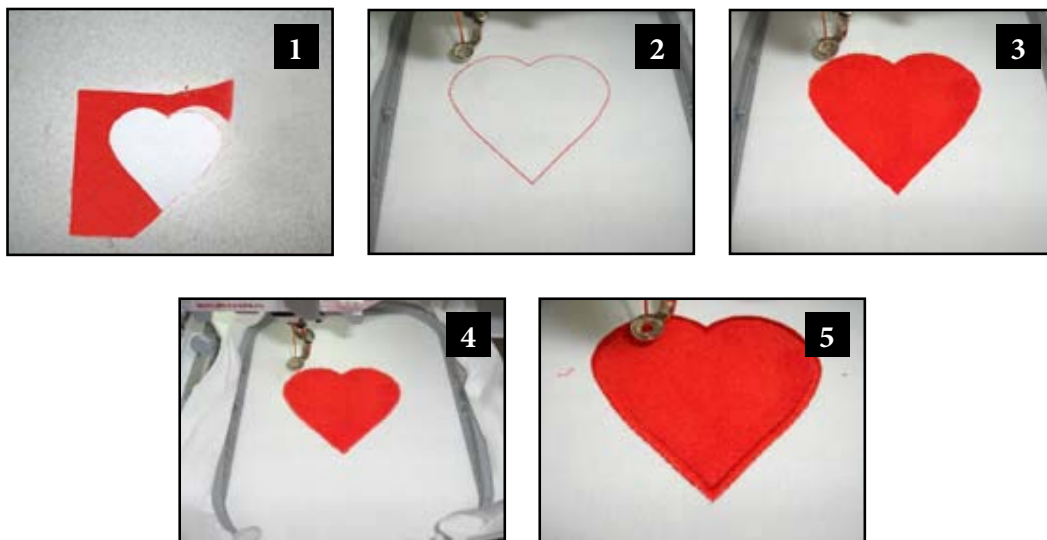

Cut-in-Place Appliqué Instructions

1. Hoop your fabric and backing.
2. Sew the pattern/placement. **PHOTO 1**
3. Place a piece of appliqué fabric over the pattern/placement so that it is completely covered.
4. Sew the trim stitch/tackdown.
5. Carefully cut away the excess appliqué fabric. **PHOTO 2**
6. Sew the remainder of the design and repeat for any remaining pieces. **PHOTO 3**

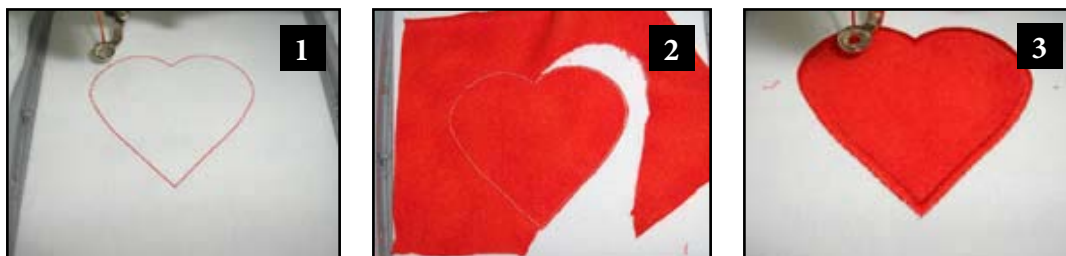

ATTENTION

When printing this document, any page scaling or page fitting options in your print dialog box must be turned OFF or set to NONE so that your files will print out at their actual size. Images not printed at actual size will not function as intended.

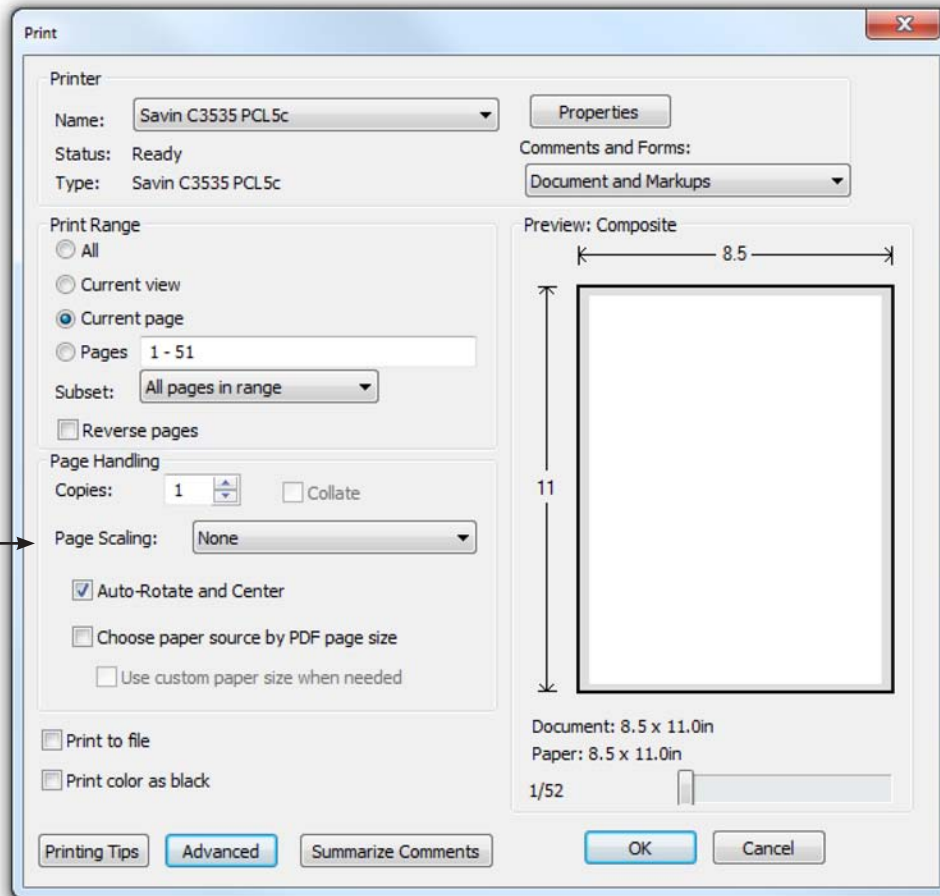

TO SAVE PAPER

Only print the desired image by navigating to the image's page, go to File > Print and select "Current page" in the print dialog box. Repeat for each desired image.

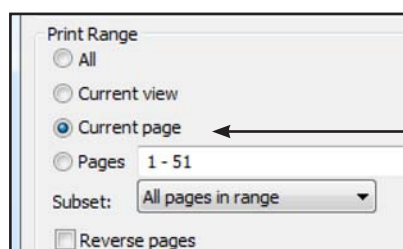

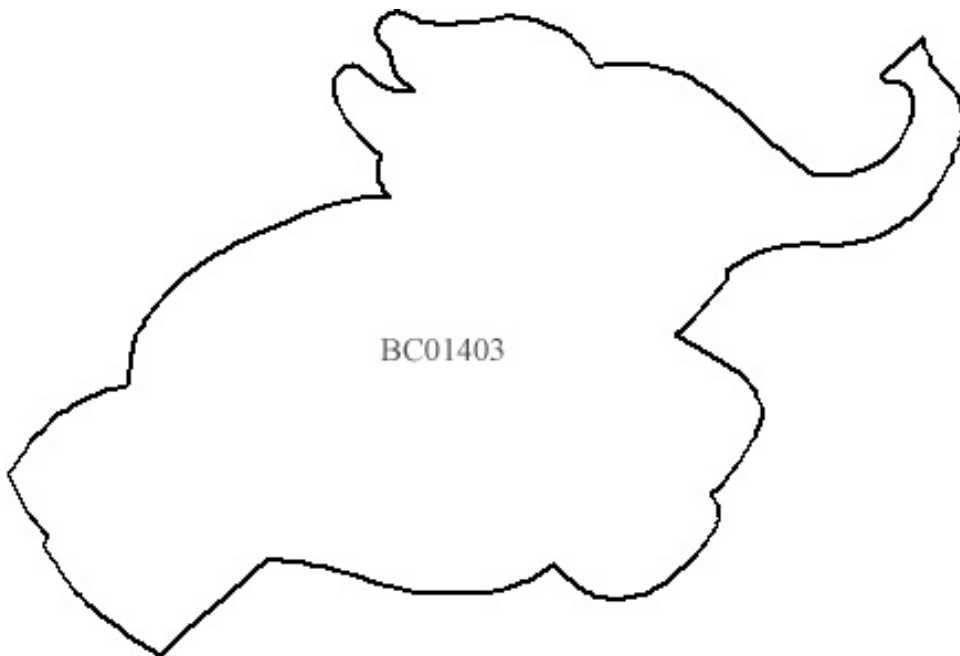
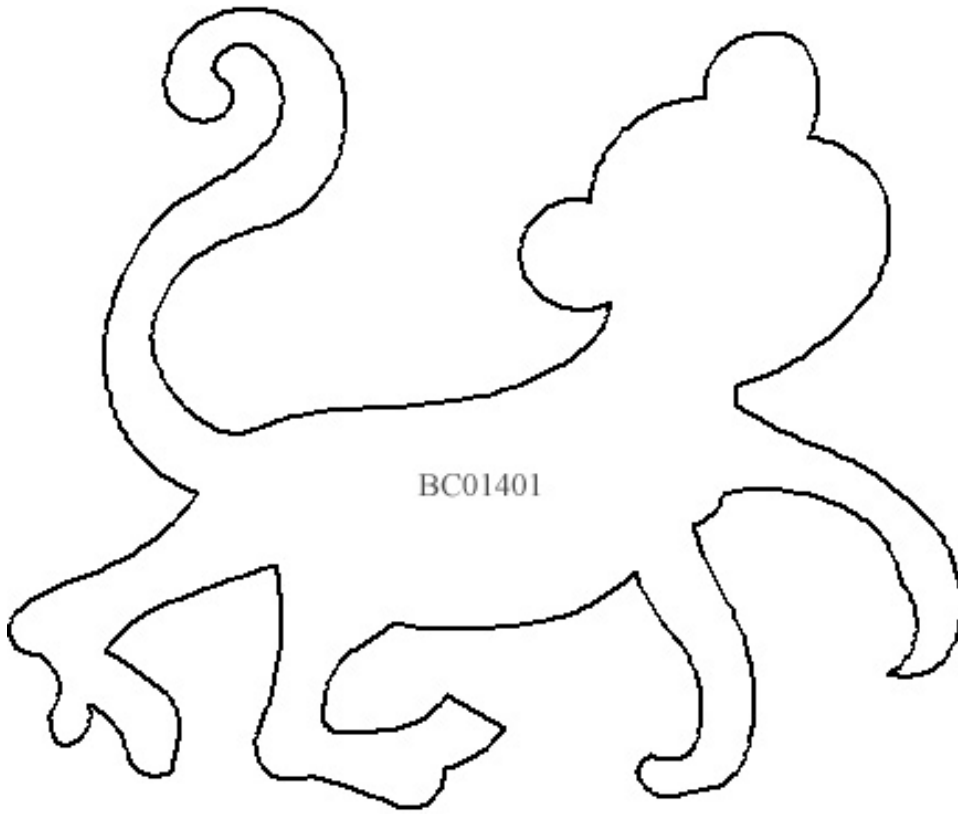

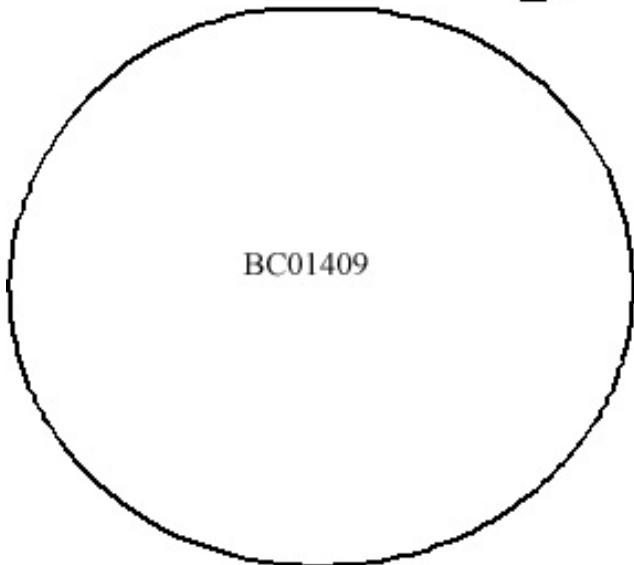
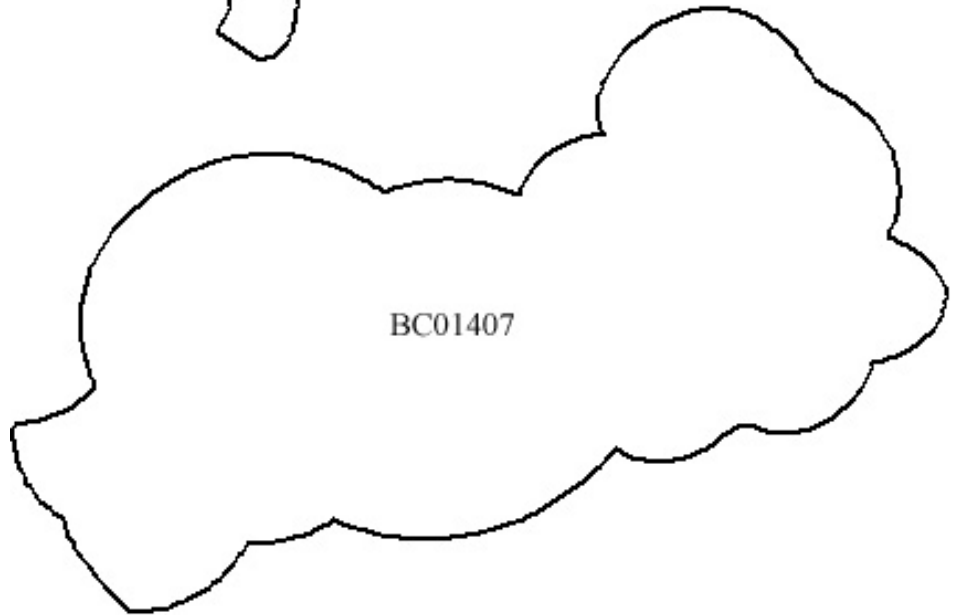
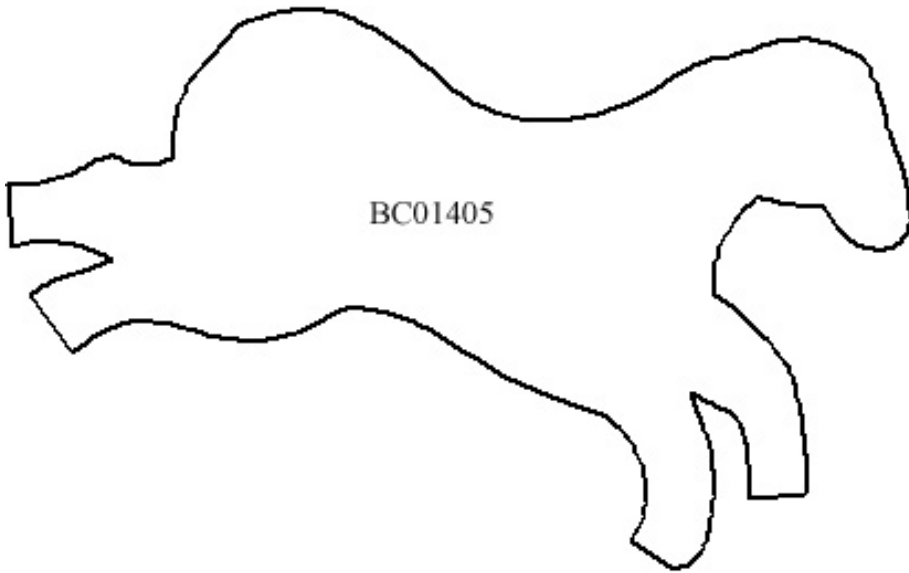

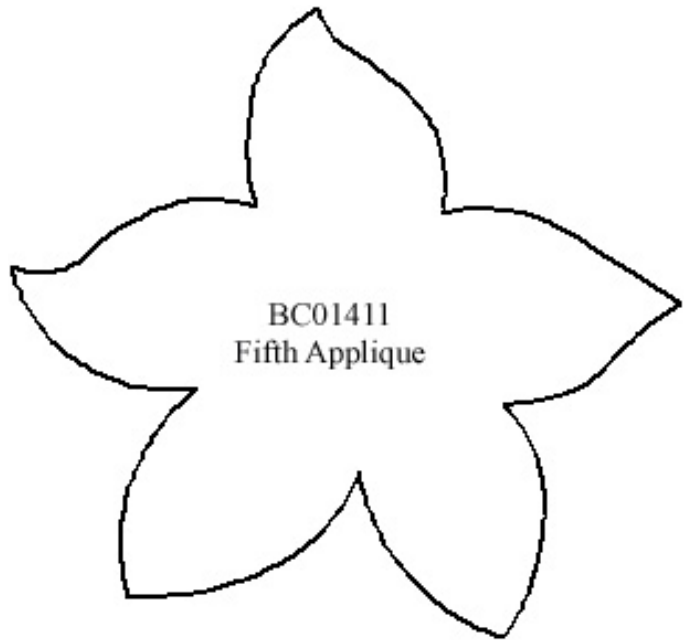

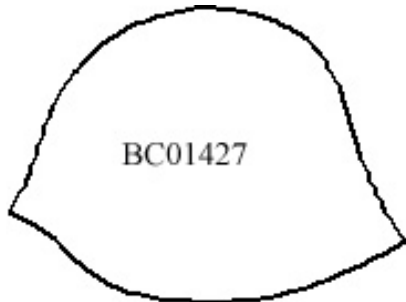
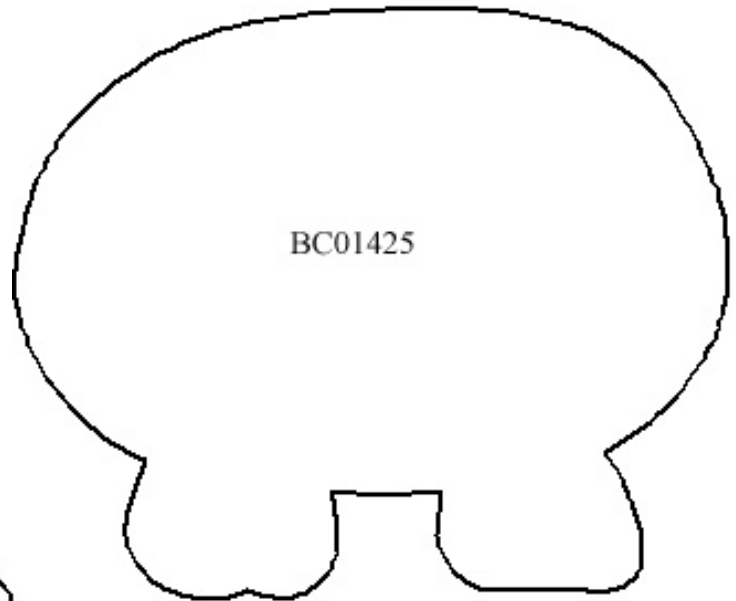
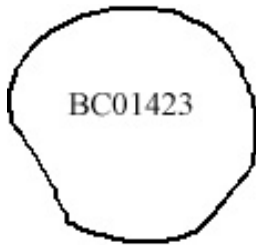
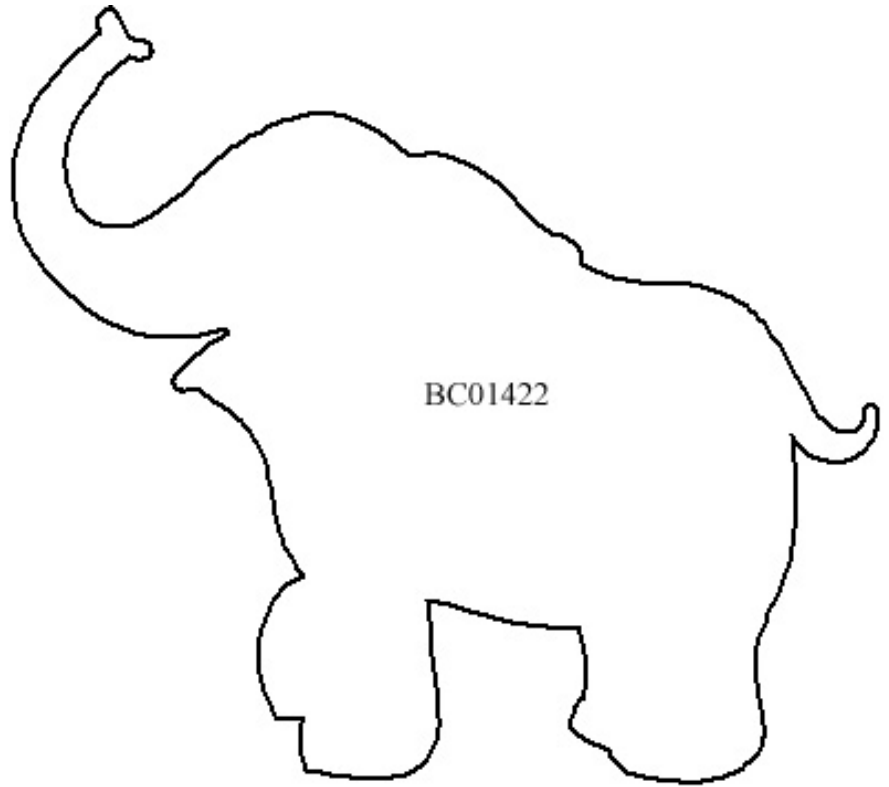
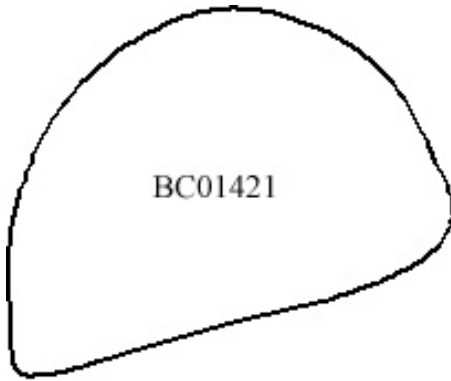

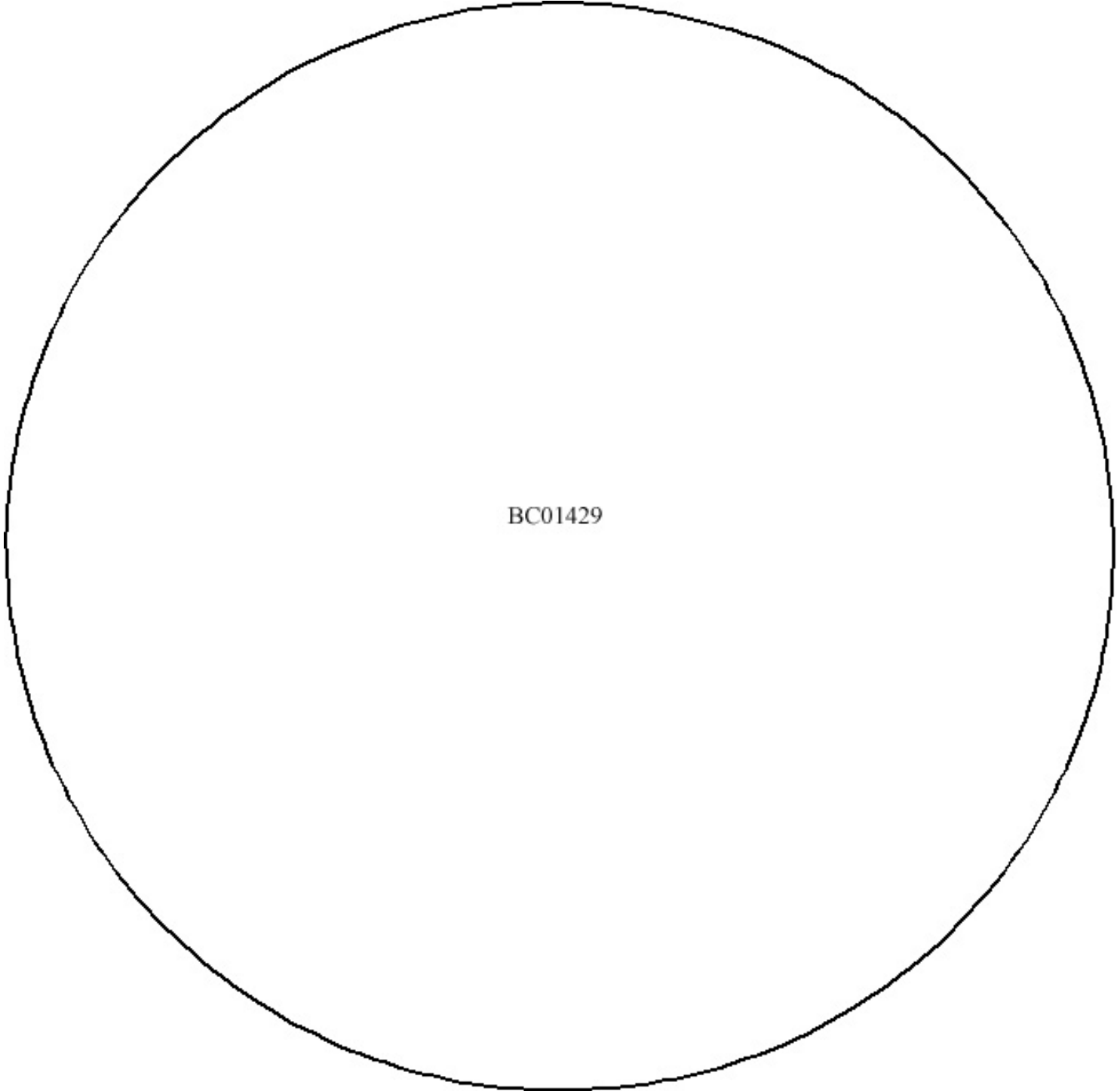

BC01429

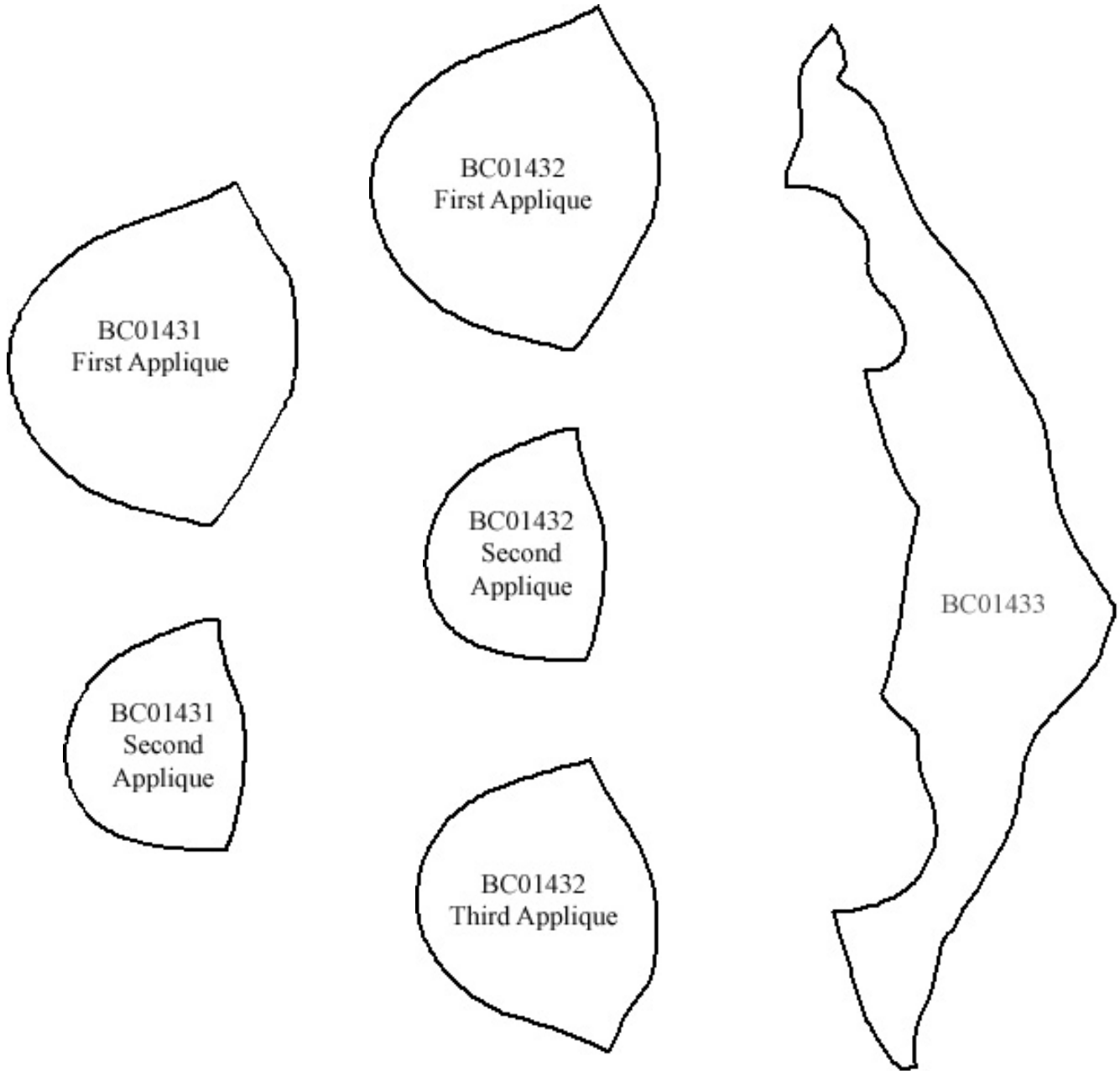

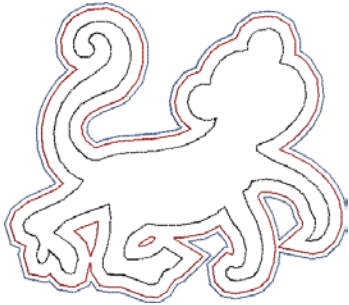

BC01401_CWA For use with the BERNINA CutWork Accessory
5.41 X 4.67 in.
137.41 X 118.62 mm
6,893 St. **L**

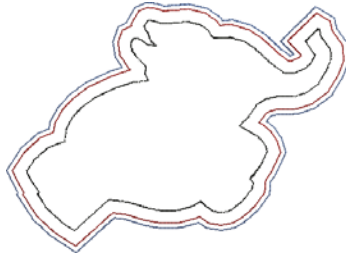

BC01403_CWA For use with the BERNINA CutWork Accessory
5.44 X 3.93 in.
138.18 X 99.82 mm
3,400 St. **L**

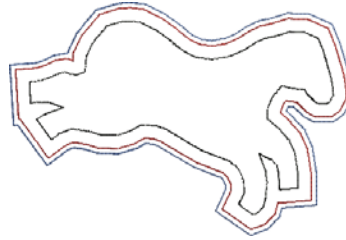

BC01405_CWA For use with the BERNINA CutWork Accessory
5.16 X 3.47 in.
131.06 X 88.14 mm
3,489 St. **L**

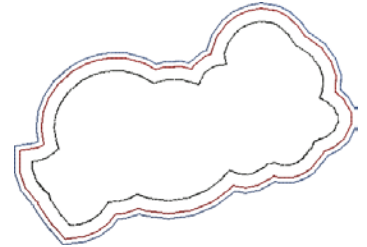

BC01407_CWA For use with the BERNINA CutWork Accessory
5.29 X 3.69 in.
134.37 X 93.73 mm
2,949 St. **L**

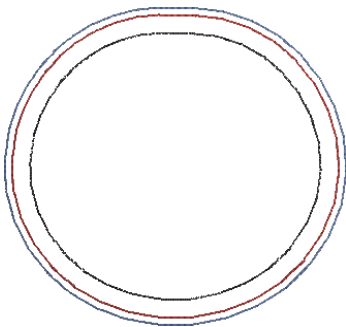

BC01409_CWA For use with the BERNINA CutWork Accessory
3.71 X 3.41 in.
94.23 X 86.61 mm
2,026 St.

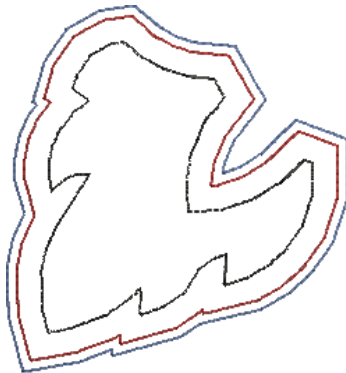

BC01411_CWA For use with the BERNINA CutWork Accessory
2.74 X 2.92 in.
69.60 X 74.17 mm
2,023 St.

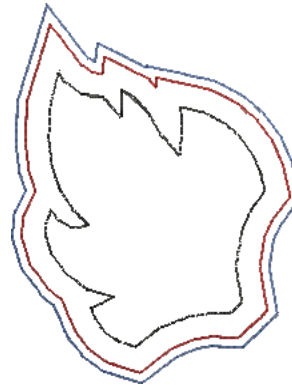

BC01411_CWA02 For use with the BERNINA CutWork Accessory
2.43 X 3.16 in.
61.72 X 80.26 mm
1,778 St.

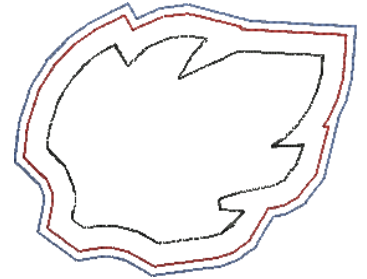

BC01411_CWA03 For use with the BERNINA CutWork Accessory
3.08 X 2.43 in.
78.23 X 61.72 mm
1,833 St.

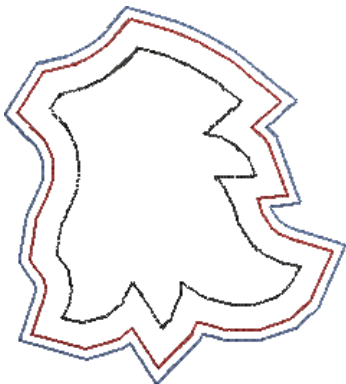

BC01411_CWA04 For use with the BERNINA CutWork Accessory
2.65 X 2.91 in.
67.31 X 73.91 mm
1,888 St.

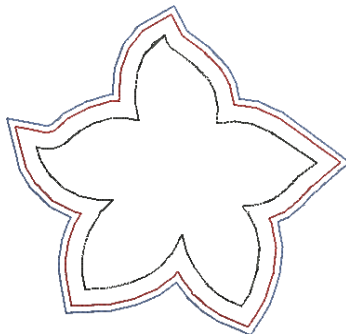

BC01411_CWA05 For use with the BERNINA CutWork Accessory
4.13 X 3.94 in.
104.90 X 100.08 mm
2,561 St.

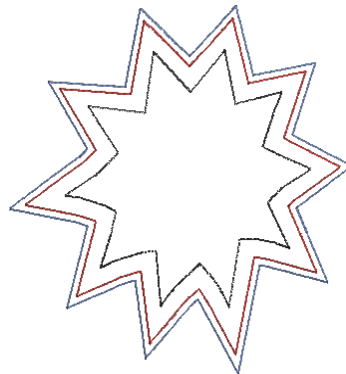

BC01413_CWA For use with the BERNINA CutWork Accessory
3.84 X 4.11 in.
97.54 X 104.39 mm
2,736 St.

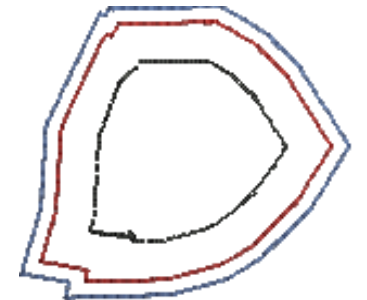

BC01414_CWA01 For use with the BERNINA CutWork Accessory
1.69 X 1.48 in.
42.93 X 37.59 mm
768 St. **S**

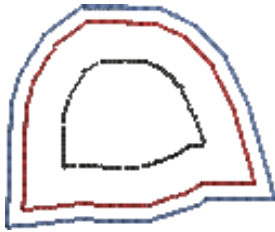

BC01414_CWA02 For use with the BERNINA CutWork Accessory
1.38 X 1.12 in.
35.05 X 28.45 mm
583 St. **S**

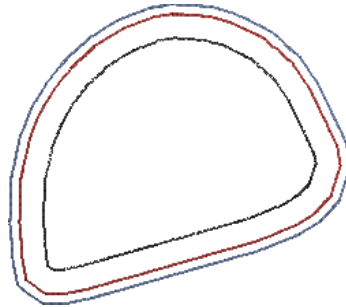

BC01421_CWA For use with the BERNINA CutWork Accessory
2.80 X 2.43 in.
71.12 X 61.72 mm
1,447 St.

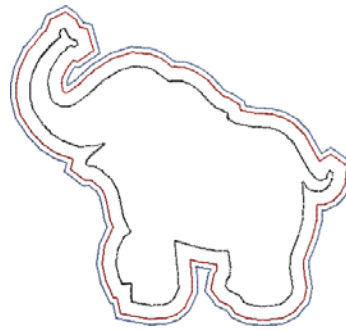

BC01422_CWA For use with the BERNINA CutWork Accessory
4.96 X 4.59 in.
125.98 X 116.59 mm
3,753 St.

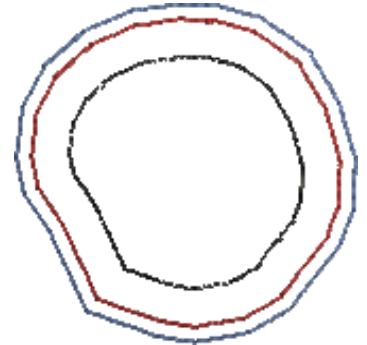

BC01423_CWA For use with the BERNINA CutWork Accessory
1.79 X 1.76 in.
45.47 X 44.70 mm
926 St.

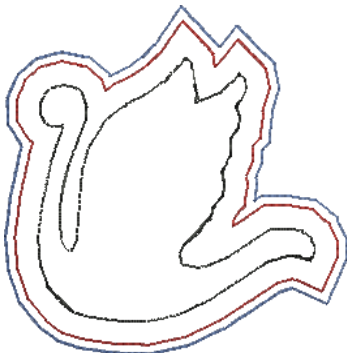

BC01424_CWA For use with the BERNINA CutWork Accessory
2.93 X 2.96 in.
74.42 X 75.18 mm
2,513 St.

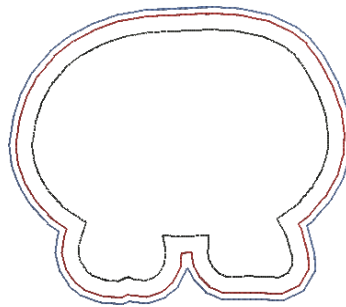

BC01425_CWA For use with the BERNINA CutWork Accessory
4.18 X 3.60 in.
106.17 X 91.44 mm
2,552 St.

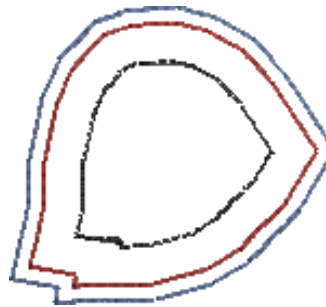

BC01426_CWA For use with the BERNINA CutWork Accessory
1.68 X 1.51 in.
42.67 X 38.35 mm
766 St.

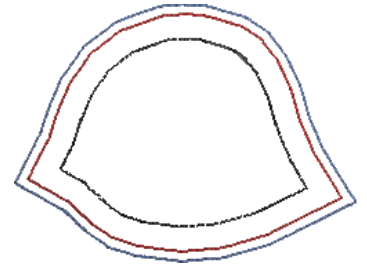

BC01427_CWA For use with the BERNINA CutWork Accessory
2.76 X 2.06 in.
70.10 X 52.32 mm
1,272 St.

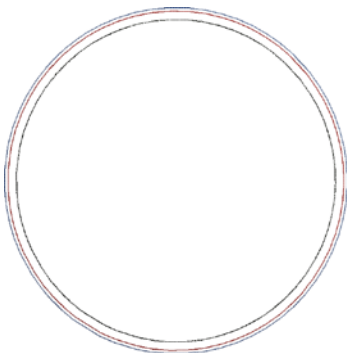

BC01429_CWA For use with the BERNINA CutWork Accessory (Jumbo)
8.02 X 8.00 in.
203.71 X 203.20 mm
4,755 St. **L**

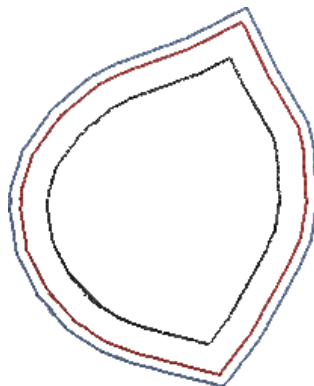

BC01431_CWA01 For use with the BERNINA CutWork Accessory
2.28 X 2.78 in.
57.91 X 70.61 mm
1,368 St.

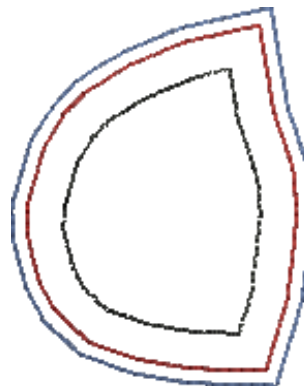

BC01431_CWA02 For use with the BERNINA CutWork Accessory
1.62 X 2.03 in.
41.15 X 51.56 mm
900 St.

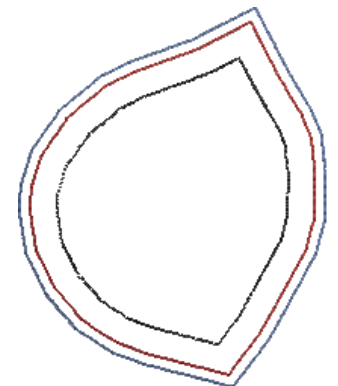

BC01432_CWA01 For use with the BERNINA CutWork Accessory
2.27 X 2.78 in.
57.66 X 70.61 mm
1,353 St.

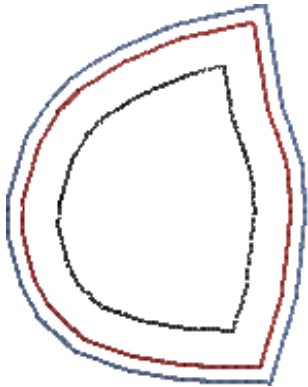

BC01432_CWA02 For use with the
BERNINA CutWork Accessory
1.62 X 2.03 in.
41.15 X 51.56 mm
914 St.

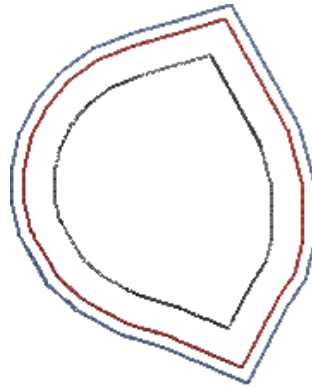

BC01432_CWA03 For use with the
BERNINA CutWork Accessory
1.98 X 2.44 in.
50.29 X 61.98 mm
1,133 St.



BC01433_CWA For use with the
BERNINA CutWork Accessory
2.56 X 7.18 in.
65.02 X 182.37 mm
3,276 St. **L**



Snuggle Up

Pre-cut appliqué files for use with BERNINA® CutWork Accessory

NOTE: Placement Stitch and Basting Stitch should match your background fabric.

BC01431_CWA01 For use with the BERNINA

CutWork Accessory

1. Placement Stitch	3600
2. Basting Stitch	1902
3. BERNINA CutWork Accessory Cut 1	Cut 1
4. BERNINA CutWork Accessory Cut 2	Cut 2
5. BERNINA CutWork Accessory Cut 3	Cut 3
6. BERNINA CutWork Accessory Cut 4	Cut 4

BC01432_CWA01 For use with the BERNINA

CutWork Accessory

1. Placement Stitch	3600
2. Basting Stitch	1902
3. BERNINA CutWork Accessory Cut 1	Cut 1
4. BERNINA CutWork Accessory Cut 2	Cut 2
5. BERNINA CutWork Accessory Cut 3	Cut 3
6. BERNINA CutWork Accessory Cut 4	Cut 4

BC01432_CWA03 For use with the BERNINA

CutWork Accessory

1. Placement Stitch	3600
2. Basting Stitch	1902
3. BERNINA CutWork Accessory Cut 1	Cut 1
4. BERNINA CutWork Accessory Cut 2	Cut 2
5. BERNINA CutWork Accessory Cut 3	Cut 3
6. BERNINA CutWork Accessory Cut 4	Cut 4

BC01431_CWA02 For use with the BERNINA

CutWork Accessory

1. Placement Stitch	3600
2. Basting Stitch	1902
3. BERNINA CutWork Accessory Cut 1	Cut 1
4. BERNINA CutWork Accessory Cut 2	Cut 2
5. BERNINA CutWork Accessory Cut 3	Cut 3
6. BERNINA CutWork Accessory Cut 4	Cut 4

BC01432_CWA02 For use with the BERNINA

CutWork Accessory

1. Placement Stitch	3600
2. Basting Stitch	1902
3. BERNINA CutWork Accessory Cut 1	Cut 1
4. BERNINA CutWork Accessory Cut 2	Cut 2
5. BERNINA CutWork Accessory Cut 3	Cut 3
6. BERNINA CutWork Accessory Cut 4	Cut 4

BC01433_CWA For use with the BERNINA

CutWork Accessory

1. Placement Stitch	3600
2. Basting Stitch	1902
3. BERNINA CutWork Accessory Cut 1	Cut 1
4. BERNINA CutWork Accessory Cut 2	Cut 2
5. BERNINA CutWork Accessory Cut 3	Cut 3
6. BERNINA CutWork Accessory Cut 4	Cut 4

SUPPLIES

- Cut-Away Stabilizer
- Temporary Spray Adhesive
- Appliqué Fuse & Fix Stabilizer
- Embroidery Thread
- Stabilizer that is appropriate for your project
- BERNINA® CutWork Accessory

PREPARE APPLIQUE FABRIC

1. Starch appliqué fabric 2-3 times following manufacturer's instructions.
2. Appliqué fabric should be crisp.
3. Iron Appliqué Fuse & Fix to the wrong side of the starched appliqué fabric following instructions on product packaging.

CUT APPLIQUE PIECES

1. Hoop one layer of Cut-Away Stabilizer.
2. Send first CWA file to the embroidery machine. (CWA files are the pre-cut appliqué files to use with the CutWork Accessory; these files will end in CWA01, CWA02, and CWA03 etc. The number of CWA files available for each design will depend upon how many separate appliqués each design contains.)
3. Stitch the first color, this will be the placement stitch.
4. Remove the hoop from the machine but do not remove the stabilizer from the hoop. Spray the hooped stabilizer with temporary spray adhesive. Lay prepared appliqué fabric over the placement stitch, being sure to completely cover the stitching. Apply pressure to appliqué fabric to ensure it is adhered.
5. Stitch the second color, this will be the basting stitch. It is meant to baste the appliqué fabric to your hooped stabilizer.
6. Replace normal stitch plate with the CutWork stitch plate.
7. Unthread the machine.
8. If necessary, turn off the upper thread control on your machine. Refer to your machine's user manual. Note that the most recent version of the 830 will perform this task automatically.
9. Replace embroidery needle with the CutWork Accessory.
10. Replace embroidery foot with foot #44 (If you do not have foot #44 you can leave foot #15 on the machine; foot #44 will simply keep the cut fabric from flagging as much).
11. Attach the hoop to the machine.
12. To cut the first appliqué piece follow the "thread changes" on your machine screen and turn the dial on the CutWork tool as required.
13. Remove the hoop from the machine.
14. Gently remove cut appliqué piece, trimming any thread that may have not been cut completely. **PHOTO 1**
15. Repeat as needed for designs with multiple appliqué pieces.

TACKDOWN APPLIQUE AND COMPLETE EMBROIDERY DESIGN

1. Replace the embroidery needle and rethread the machine.
2. Replace the embroidery foot #15.
3. Spray hoop sized piece of stabilizer that is appropriate for your project and adhere to wrong side of background fabric or project that is to be hooped.
4. Hoop fabric/project and stabilizer.
5. Attach hoop to machine.
6. Send the embroidery file to the machine (this is not a CWA file).
7. Stitch design as normal following the thread changes on the provided thread chart stopping after each Appliqué Placement Stitch.
8. After stitching an Appliqué Placement Stitch, take the precut appliqué pieces required and peel off the cutaway backing and the release paper revealing a sticky backing. **PHOTO 2**
9. Remove hoop from machine, but do not remove the fabric from the hoop.
10. Adhere precut appliqué piece evenly over the Appliqué Placement Stitch; use pressure to make sure pieces stick well. **PHOTO 3**
11. Reattach hoop to machine.
12. Continue stitching design until all appliqué pieces are placed and all stitching is complete. **PHOTO 4**

NOTE: Design pictured is for instructional purposes and may not be included in this collection.

