



Love You More Greeting Cards

#PK10001

4 DESIGNS/ Project Instructions Included

MATERIALS

OESD™ DESIGN
PACK

Isacord Thread Colors

1902 Poinsettia
2152 Heather Pink
2830 Wild Iris
4430 Island Waters

*** Project instructions included after design list.**

Note: One spool of 1000 meter thread is adequate for the project unless otherwise noted.

DESIGNS





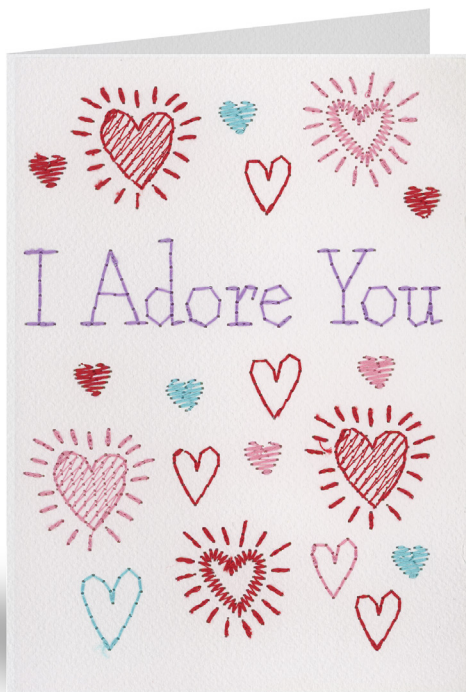

Note: Some designs in this collection may have been created using unique special stitches and/or techniques. To preserve design integrity when rescaling or rotating designs in your software, always rescale or rotate designs using the handles directly on-screen.



PK10001-01 I Adore You Card



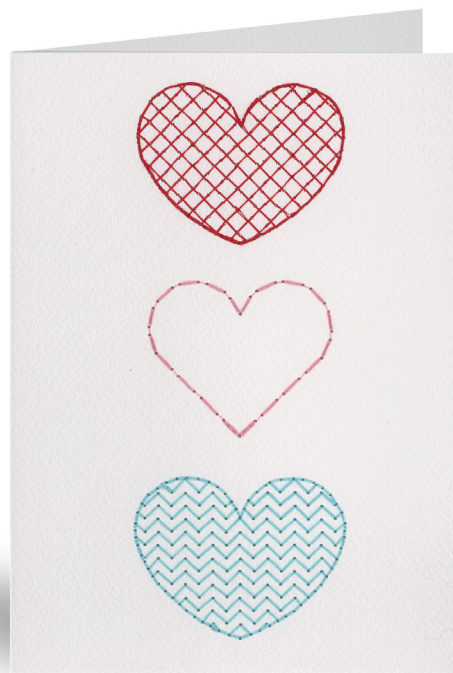

Size Inches:	Size mm:	Stitch Count:
S 6.25 X 4.62 in.	158.8 X 117.5 mm	4178 St.
L 7.00 X 5.00 in.	177.8 X 127.0 mm	4479 St.

	1. Card Placement Guide	2830
	2. Purple Detail	2830
	3. Red Detail	1902
	4. Pink Detail	2152
	5. Teal Detail	4430



PK10001-02 Patterned Hearts Card

Size Inches:	Size mm:	Stitch Count:
S 6.25 X 4.62 in.	158.7 X 117.5 mm	1807 St.
L 7.00 X 5.00 in.	177.8 X 127.0 mm	2373 St.

	1. Card Placement Guide	2152
	2. Pink Detail	2152
	3. Teal Detail	4430
	4. Red Detail	1902

DESIGNS



Note: Some designs in this collection may have been created using unique special stitches and/or techniques. To preserve design integrity when rescaling or rotating designs in your software, always rescale or rotate designs using the handles directly on-screen.



PK10001-03 To the Moon and Back Card



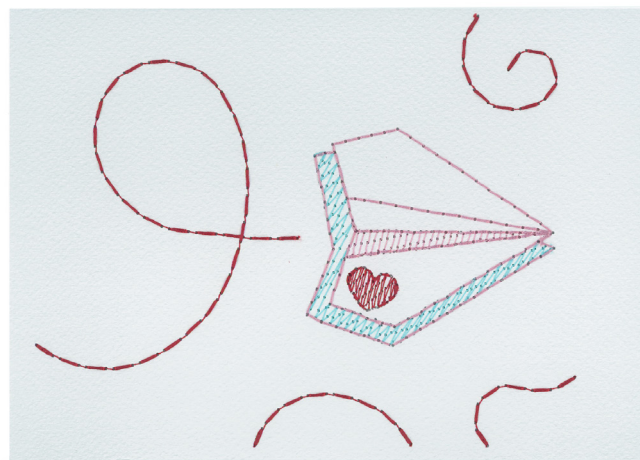

Size Inches:	Size mm:	Stitch Count:
S 6.25 X 4.65 in.	158.8 X 118.1 mm	4310 St.
L 7.00 X 5.00 in.	177.8 X 127.0 mm	4625 St.

	1. Card Placement Guide	2830
	2. Purple Lettering	2830
	3. Pink Detail	2152
	4. Teal Detail.....	4430
	5. Purple Detail.....	2830



PK10001-04 Paper Airplane Card

Size Inches:	Size mm:	Stitch Count:
S 6.25 X 4.62 in.	158.8 X 117.5 mm	1563 St.
L 7.00 X 5.00 in.	177.8 X 127.0 mm	1735 St.

	1. Card Placement Guide	4430
	2. Teal Detail.....	4430
	3. Pink Detail	2152
	4. Red Detail.....	1902

MATERIALS



Stabilizers

- OESD StabilStick TearAway (variation 1)
- OESD Medium Weight TearAway (variation 2)
- OESD Fuse and Seal CutAway

Fabrics/Textiles

- Start Here Embroidery Blanks by OESD - Greeting Card size A7 (5" x 7") folded.
- Start Here Embroidery Blanks by OESD - Greeting Card size A6 (4.5" x 6.25") folded.

Notion & Tools

- OESD Expert Embroidery Tape TearAway
- OESD Grippy Grid
- OESD Perfect Embroidery Press Cloth
- Embroidery Needle 75/11

Isacord Thread Colors

- Per thread chart

General Instructions

The card instructions included in the collection are general. A sample card design that best demonstrates the technique is shown for demonstration purposes. Thread requirements will vary by design.

Note: Some thread colors in instructions have been changed or digitally enhanced for better visibility.

Step 1

- Hoop one layer of StabilStick TearAway paper (shiny) side up.
- Use a pin or needle to score the paper.
- Remove the paper to reveal the adhesive surface.



Step 2

- Load selected design into the machine.
- Design in the example is PK10001-02L.
- Thread the machine per the thread chart.
- Stitch Machine Step 1, Card Placement Guide.

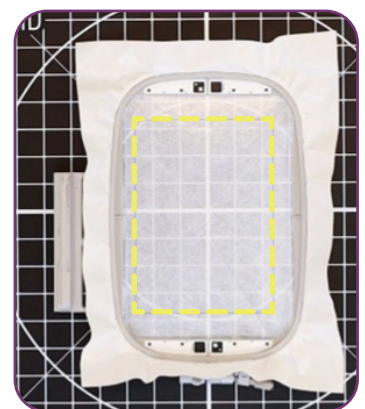

□ Step 3

- Place the front of the card face up within the Card Placement Guide, lining up all edges.



□ Step 4

- Stitch the remaining steps per the thread chart.



□ Step 5

- Remove the hoop from the machine.
- Remove the card and stabilizer from the hoop.
- On a flat surface, fold the stabilizer back and carefully cut the stabilizer away, close to the stitching.
- Note: Cutting away the excess TearAway stabilizer prevents bending or creasing the cardstock.



EMBROIDERY VARIATION 1



Step 6

- Cut coordinating cardstock (or scrapbook paper) slightly smaller than the front of the card.
- Cut a piece of Fuse and Seal to fit. Following the package instructions, iron the Fuse and Seal to the wrong side of the cardstock (scrapbook paper).
- Let cool completely.

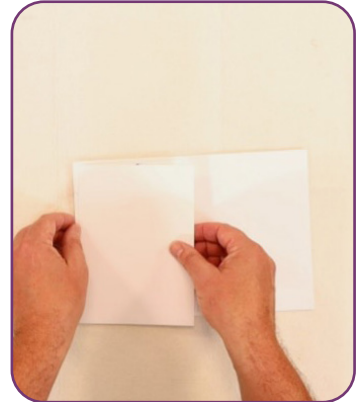

Step 7

- Place the card, front side down, onto a Perfect Embroidery Press Cloth.
- Remove paper from Fuse and Seal.
- Place the cardstock (scrapbook paper), right side up, onto the wrong side of the stitching.
- Iron to fuse to the card.
- Let cool completely.



Step 8

- The card is complete. Enjoy!



EMBROIDERY VARIATION 2



Step 1

- 2 cards folded to 5" x 7"
- Cut one card in half on the fold.

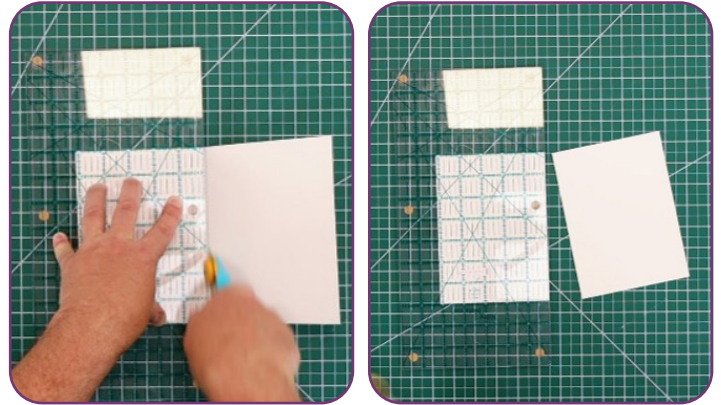

Step 2

- Hoop 1 layer of OESD Medium Weight TearAway stabilizer.
- Load selected design into the machine.
- Design in the example is PK10001-03L.
- Thread the machine per the thread chart.
- Stitch Machine Step 1, Card Placement Guide.

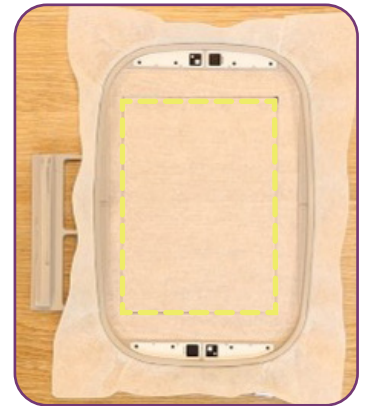

Step 3

- Place 5" x 7" piece of cardstock within the Card Placement Guide, lining up all edges.
- Tape in place to secure.
- Note: Expert Embroidery Tape TearAway will not leave residue on the paper or tear the cardstock.



EMBROIDERY VARIATION 2



Step 4

- Stitch the remaining steps per the thread chart.



Step 5

- Remove the hoop from the machine.
- Remove the card and stabilizer from the hoop.
- On a flat surface, fold the stabilizer back and carefully cut the stabilizer away, close to the stitching.

Note: Cutting away the excess TearAway stabilizer prevents bending or creasing the cardstock.



Step 6

- Cut 1 piece of Fuse and Seal slightly smaller than the size of your card.



EMBROIDERY VARIATION 2



Step 7

- Following the package instructions, iron the Fuse and Seal to the wrong side of the embroidered card.
- Let cool completely.

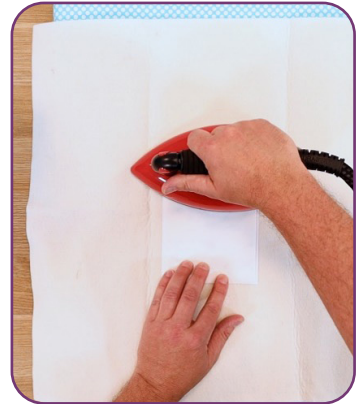

Step 8

- Once cool, remove the paper backing.

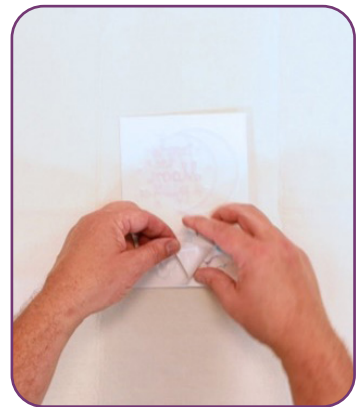

Step 9

- Place the embroidered card over the front of the second card.
- Iron to fuse to the card.
- Let cool completely.



EMBROIDERY VARIATION 2



Step 10

- The card is complete. Enjoy!

