



Freestanding Summer Straw Toppers

#PK50024
4 DESIGNS

MATERIALS



Isacord Thread Colors

0010 Silky White
0504 Mimosa
2160 Iced Pink
2520 Garden Rose
2550 Soft Pink
4174 Charcoal
5500 Limesdrop
5510 Emerald
5740 Mint

Note: One spool of 1000 meter thread is adequate for the project unless otherwise noted.

MATERIALS



Stabilizers

- OESD AquaMesh WashAway
- OESD BadgeMaster WashAway
- OESD StabilStick CutAway

Fabrics/Textiles

- Quilter's cotton

Notion & Tools

- OESD Expert Embroidery Tape TearAway
- OESD Expert Embroidery Tape WashAway
- OESD Perfect Embroidery Press Cloth
- OESD Grippy GRID
- Embroidery Needle Sharp 75/11 (FSA)

Isacord Thread Colors

- Per thread chart
- Match the bobbin thread to the upper thread.

EMBROIDERY



Instructions

The freestanding applique instructions, included in the collection, are general instructions. For demonstration purposes, a sample design that best demonstrates the technique is shown. Fabric and thread requirements will vary by design, but the general technique is the same.

All designs are stitched with matching thread, top and bobbin.

Note: Some thread colors in instructions have been changed or digitally enhanced for better visibility.

□ Step 1

- Adhere one layer of StabilStick CutAway to the wrong side of all applique fabrics to provide stiffness to the finished structure.
- Cut the prepared applique fabrics 1/4"-1/2" larger than the templates that are included at the end of the instructions.

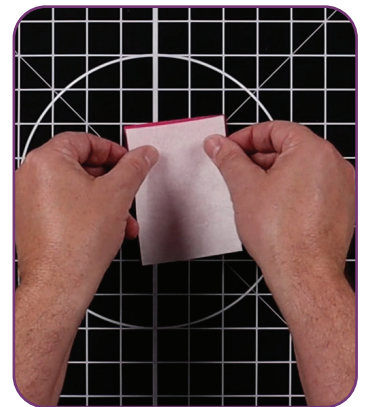

□ Step 2

- Hoop one layer of AquaMesh and one layer of BadgeMaster for all designs.



EMBROIDERY



□ Step 3

- Load selected design into the machine.
- Example design is PK50024-01.
- Thread the machine per the thread chart.
- Place hoop on the machine.
- Stitch Machine Step 1, Front/Back Pink Fabric Placement Stitch.



□ Step 4

- Remove the hoop from the machine, but NOT the project from the hoop.
- Place the hoop on a flat surface.
- Completely cover the placement stitch with the prepared applique fabric.
- Tape in place to secure.



EMBROIDERY

□ Step 5

- Turn the hoop over and place the prepared applique fabric, right side up, completely covering the placement stitch.
- Carefully tape to secure.
Tip: Avoid pushing too hard on the stabilizer to prevent it from dislodging from the hoop.



□ Step 6

- Return the hoop to the machine.
- Stitch Machine Step 2, Cut Line and Tackdown.



EMBROIDERY

Step 7

- Remove the hoop from the machine, but NOT the project from the hoop.
- Trim the excess fabric as close to the cut line as possible. If the outermost stitches (cut line) are cut, the inner stitches (tackdown) will hold the applique in place. Tip: If the stabilizer is cut or a hole is created while trimming the fabric, use OESD Expert Embroidery Tape WashAway as a patch.



Step 8

- Turn the hoop over and trim the excess fabric as close to the cut line as possible.



EMBROIDERY



Step 9

- Return the hoop to the machine and stitch the machine steps per the thread chart with matching bobbin thread.



Step 10

- When the design is complete, remove the project from the hoop and trim the stabilizer 1/4" - 1/2" outside the design.



ASSEMBLY

□ Step 11

- Rinse the straw topper in warm running water until the design is only slightly tacky.
- Place right side down on a non-stick surface to dry. Parchment paper or a cooling rack work well to prevent curling. Dry completely.
- Once dry, press right side down on a Perfect Embroidery Press Cloth.

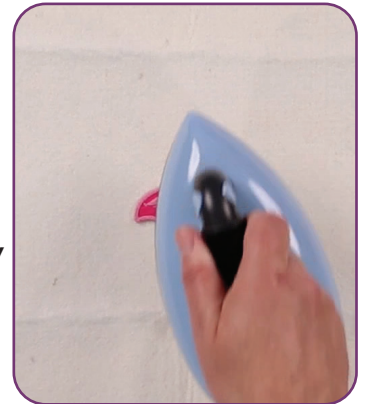

□ Step 12

- Use a craft knife to cut through all the layers of the straw cut guides.
Tip: Take care to not cut the satin stitching.
Reference the Cut Guide on page 11.



ASSEMBLY

□ Step 13

- Insert a straw through the openings.
- The project is complete. Enjoy!

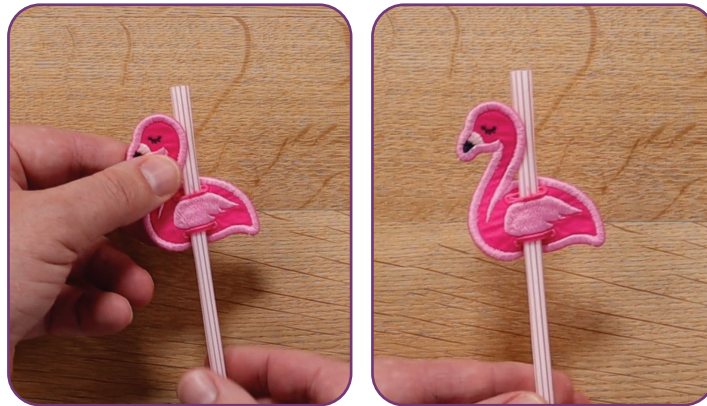

PUNCH TOOL GUIDES



PK50024-01

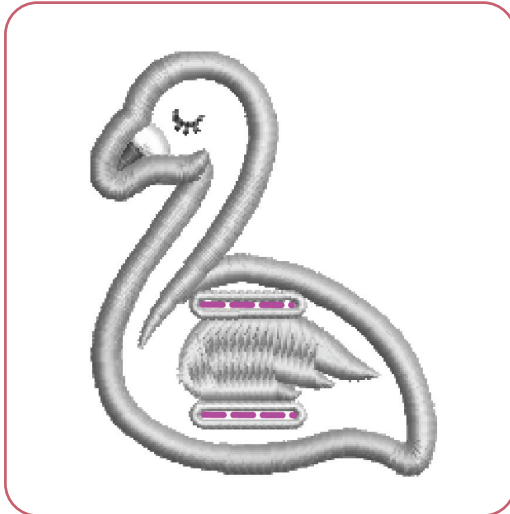

PK50024-02

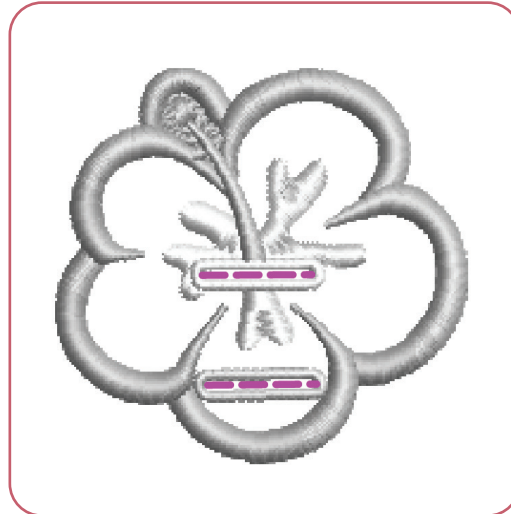

PK50024-03



PK50024-04



CRAFT KNIFE

PRINTING INSTRUCTIONS



ATTENTION

When printing this document, any page scaling or page fitting options in your print dialog box must be turned OFF or set to NONE so that your files will print out at their actual size. Images not printed at actual size will not function as intended.

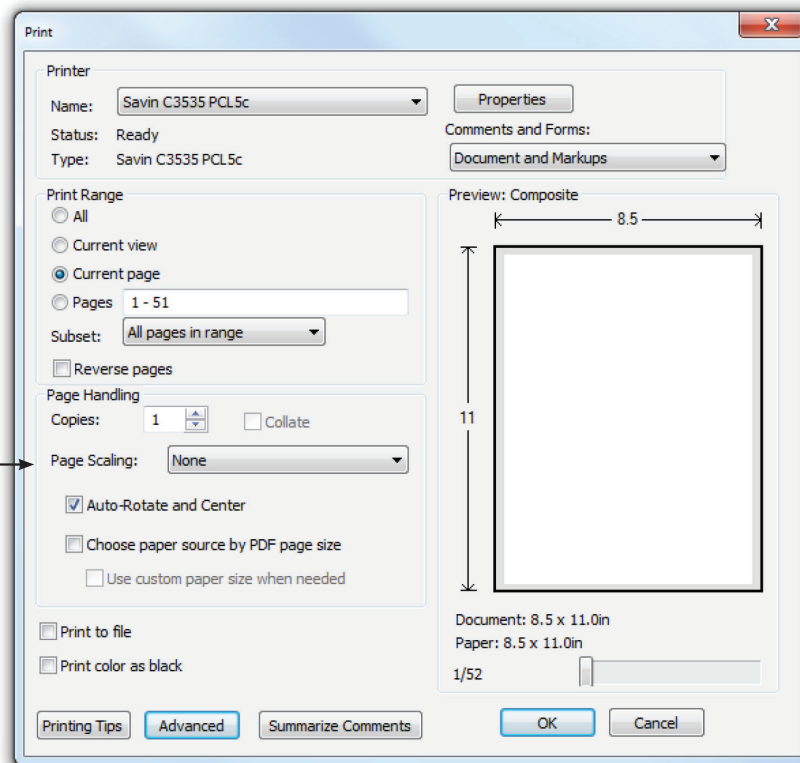

TO SAVE PAPER

Only print the desired image by navigating to the image's page, go to File > Print and select "Current page" in the print dialog box. Repeat for each desired image.

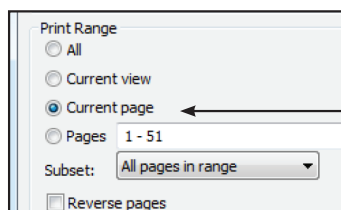

APPLIQUE PATTERNS



Print at 100%. No scaling. This box measures 1" x 1". Use the box as an accuracy guide when printing templates.

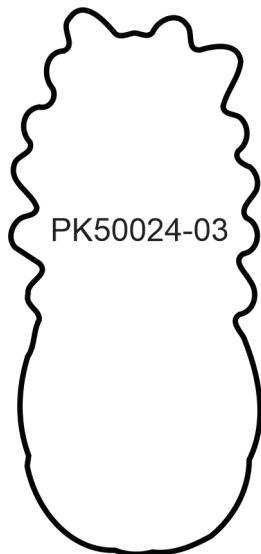
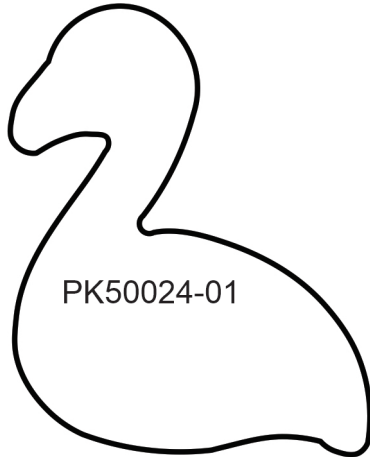

MIRRORED PATTERNS



Print at 100%. No scaling. This box measures 1" x 1". Use the box as an accuracy guide when printing templates.

